

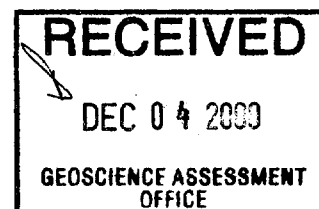

2.20786

**Report on Prospecting Work**  
**Carried out on Claim 1184524**  
**Afton Township**  
**Sudbury Mining Division (G-2900)**  
**Province of Ontario**  
**August 22, 2000**



**William S. Ferreira, M.Sc.**  
**Senior Geologist**

**LONDON**

275 Dundas Street, Suite 1605, London, Ontario N6B 3L1 Ph: (519) 858-4000 Fax: (519) 858-4825

**MONTREAL**

3431 Drummond Street, Suite 200, Montreal, Quebec H3G 1X6 Ph: (514) 953-1584 Fax: (514) 695-4323

**WINNIPEG**

5 Donald Street, Suite 200, Winnipeg, Manitoba R3L 2T4 Ph: (204) 477-0695 Fax: (204) 284-0130

**LAC DU BONNET**

36B McArthur Avenue, P.O. Box 1349, Lac Du Bonnet, Manitoba R0E 1A0 Ph: (204) 345-1922 Fax: (204) 345-2092

One-half day was spent on claim S1184524 to locate and sample a copper showing shown on a 1977 Ontario Geological Survey map of the area (Meyn, 1977). Murphy (1998) had previously carried out reconnaissance mapping and prospecting on the claim for Canmine Resources Corporation, but did not locate the showing.

The work described in this report was done on August 22, 2000. The work was done by William S. Ferreira, holder of Ontario Prospector's Licence H13941, for Canmine Resources Corporation. Claim S1184524 is held by Canmine Resources Corporation.

The claim is accessible by traverse from Provincial Highway 805.

During this prospecting survey, the mineralized outcrop was located and three grab samples were collected for assay. The outcrop consists of laminated to thin bedded, aphanitic to fine grained, intermediate to felsic volcanic fragmental rocks. In places, the rocks are quite siliceous; the more siliceous rocks are lighter grey. Bedding in the laminated rocks strikes  $073^{\circ}$  and dips  $85^{\circ}$ N. The rock breaks along bedding planes. Outcrop is sparse. The exposed sequence is only about ten metres wide perpendicular to strike.

Pyrite is fine grained, disseminated in the laminated to thin bedded rocks. In the coarser fragmental rocks, pyrite occurs in the matrix. Overall, the rock contains about 5% pyrite. No chalcopyrite was found.

The location of the showing and the samples are marked on the accompanying figure. Sample 2000-1 consisted of rusty, laminated, grey, intermediate to felsic tuff with 5% pyrite. Sample 2000-2 consisted of rusty, grey, intermediate to felsic tuff with 10% pyrite. Sample 2000-3 consisted of rusty, buff, felsic lapilli-tuff with 10% pyrite in the matrix. Sample locations were flagged in the field, with sample numbers marked on the flags.

The samples were shipped to TSL Laboratories in Saskatoon, Saskatchewan, where they were assayed for gold, silver, copper, lead, zinc and cobalt. The assay report from TSL Laboratories and the description of their sample preparation and analysis methods are attached.

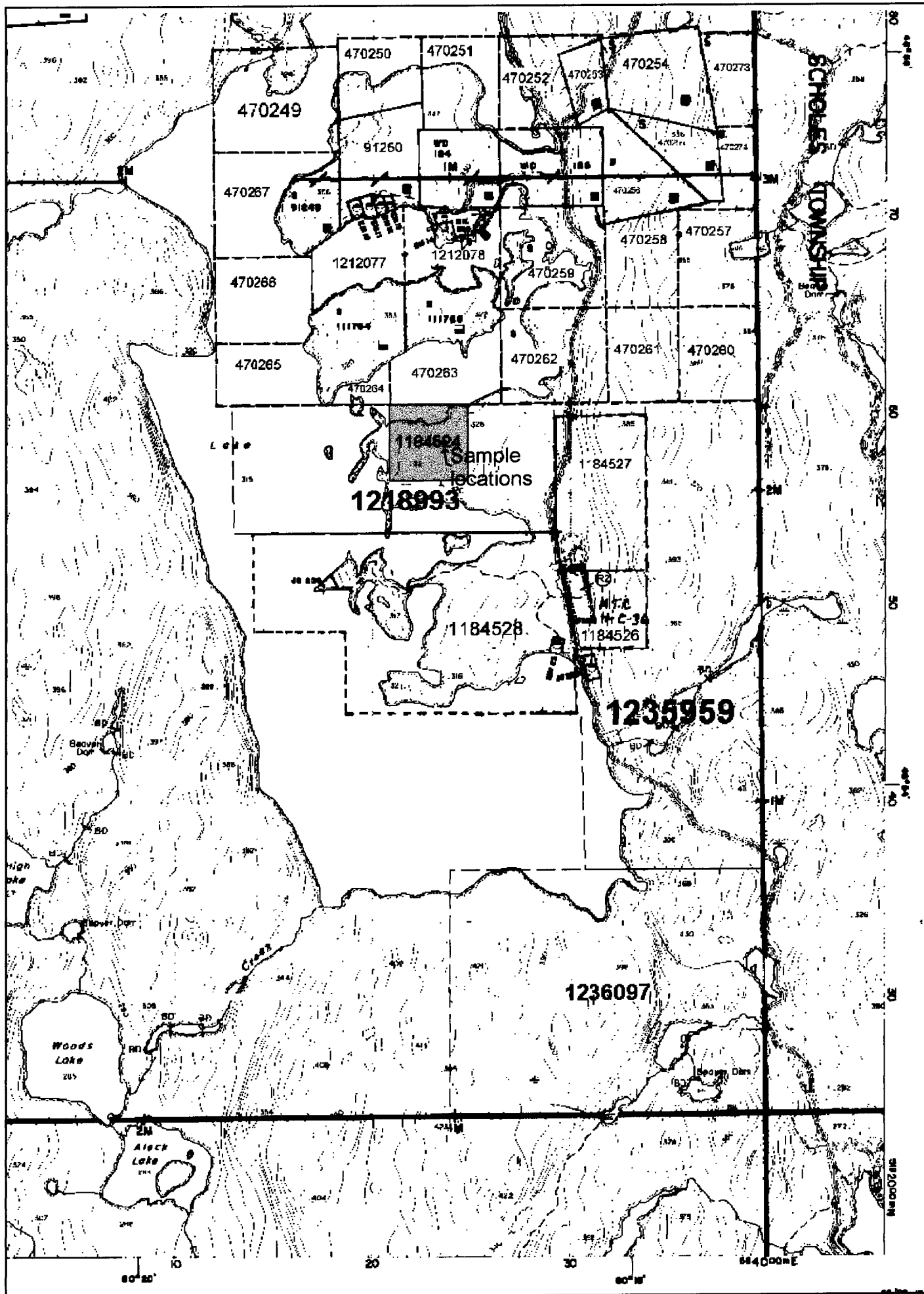

0 500 1000 2000 metres  
 Claim location (S1184524), Afton Township, Sudbury District, Province of Ontario.

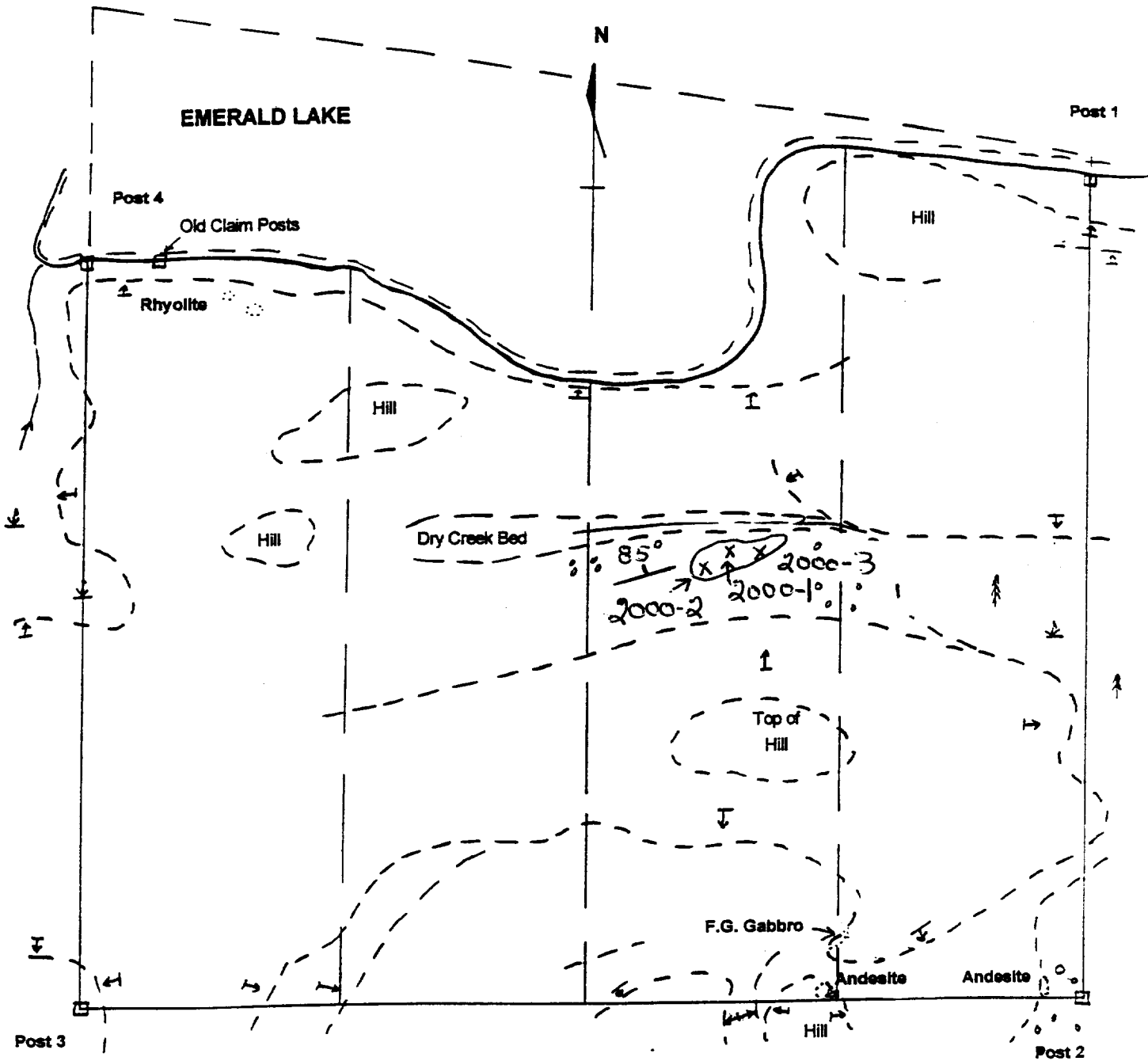

Location of grab samples and mineralized outcrop (modified after Murphy, 1998).

## References

Meyn, H.D., 1977. Geology of Afton, Scholes, Macbeth, and Clement Townships, Districts of Sudbury and Nipissing; Ontario Geological Survey Report 170, 77p.

Murphy, K.G., 1998. Assessment Report of Work Done: Mapping and Prospecting (August 26-28, 1998) on claim 1184524, Emerald Lake area (Afton Township), Sudbury Mining Division, Claim Map G-2900.

Respectfully submitted,



William S. Ferreira

---

**LONDON**

275 Dundas Street, Suite 1605, London, Ontario N6B 3L1 Ph: (519) 858-4000 Fax: (519) 858-4825

**MONTREAL**

3431 Drummond Street, Suite 200, Montreal, Quebec H3G 1X6 Ph: (514) 953-1584 Fax: (514) 695-4323

**WINNIPEG**

5 Donald Street, Suite 200, Winnipeg, Manitoba R3L 2T4 Ph: (204) 477-0695 Fax: (204) 284-0130

**LAC DU BONNET**

36B McArthur Avenue, P.O. Box 1349, Lac Du Bonnet, Manitoba R0E 1A0 Ph: (204) 345-1922 Fax: (204) 345-2092

---



#2 - 302 48<sup>th</sup> Street · Saskatoon, SK · S7K 6A4  
P (306) 931-1033 F (306) 242-4717 E tsllab@sk.sympatico.ca

### CERTIFICATE OF ANALYSIS

**SAMPLE(S) FROM** Canmine Resources Corporation  
200 - 5 Donald Street  
Winnipeg, Manitoba  
R3L 2T4

REPORT No. S1518
---------------------

**SAMPLE(S) OF** Rock

INVOICE #: 11268  
P.O.:

W. Ferreira  
Project:

	Au ppb	Ag ppm	Cu ppm	Pb ppm	Zn ppm	Co ppm
2000-1	<5	.6	89	59	46	41
2000-2	5	.6	200	38	66	47
2000-3	<5	<.2	200	24	110	28

COPIES TO: W. Ferreira  
INVOICE TO: Canmine Resources - Winnipeg

Aug 29/00

SIGNED \_\_\_\_\_



2 - 302 48th Street • Saskatoon, SK • S7K 6A4  
 P (306) 931-1033 F (306) 242-4717 E tsllab@sk.sympatico.ca

Company: Canmine Resources Corporation  
 Geologist: W. Ferreira  
 Project:

TSL Report: S1518  
 Date Received: Aug 25, 2000  
 Date Reported: Aug 29, 2000  
 Invoice: 11268

Sample Type:	Number	Size Fraction	Sample Preparation
Rock	3	Reject 90% at 10 mesh (1.70 mm) Pulp 95% at 150 mesh (106 µm)	Crush, Riffle, Pulverize

*All samples for Au Fire Assay/AA (ppb) are weighed at 30 grams.  
 All samples for Au Fire Assay/Gravimetric (g/t) are weighed at 29.16 grams.  
 All samples for Ag, Base Metals (ppm) are weighed at 1 gram.  
 All samples for Base Metals (%) are weighed at .5 gram.*

Element Name	Unit	Extraction Technique	Lower Detection Limit	Upper Detection Limit
Au	ppb	Fire Assay/AA	5	1000
Au	g/t	Fire Assay/Gravimetric	.03	100%
Ag	ppm	HCl-HNO <sub>3</sub> /AA	.2	50
Base Metals	ppm	HCl-HNO <sub>3</sub> /AA	1	5000
Base Metals	%	HCl-HNO <sub>3</sub> /AA	.01	100



Declaration of Assessment Work Performed on Mining Land

Mining Act, Subsection 65(2) and 66(3), R.S.O. 1990

Transaction Number (office use)
W0070.00256
Assessment Files Research Imaging



41I16NW2013 2.20786 AFTON

900

subsection 65(2) and 66(3) of the Mining Act. Under section 8 of the Mining Act, assessment work and correspond with the mining land holder. Questions about this lorthern Development and Mines, 3rd Floor, 933 Ramsey Lake Road, Sudbury,

Instructions: - For work performed on Crown Lands before recording a claim, use form 0240.
- Please type or print in ink.

1. Recorded holder(s) (Attach a list if necessary)

Form with fields for Name, Address, Client Number, Telephone Number, Fax Number for Canmine Resources Corporation and another entity.

2. Type of work performed: Check (✓) and report on only ONE of the following groups for this declaration.

Form with checkboxes for Geotechnical, Physical, and Rehabilitation work types. Includes fields for Work Type, Dates Work Performed, Global Positioning System Data, Township/Area, Mining Division, and Resident Geologist District.

Please remember to: - obtain a work permit from the Ministry of Natural Resources as required;
- provide proper notice to surface rights holders before starting work;
- complete and attach a Statement of Costs, form 0212;
- provide a map showing contiguous mining lands that are linked for assigning work;
- include two copies of your technical report.

3. Person or companies who prepared the technical report (Attach a list if necessary)

Form with fields for Name, Address, Telephone Number, and Fax Number for the person or company that prepared the technical report.

4. Certification by Recorded Holder or Agent

I, William S. Ferreira, do hereby certify that I have personal knowledge of the facts set forth in this Declaration of Assessment Work having caused the work to be performed or witnessed the same during or after its Completion and, to the best of my knowledge, the annexed report is true.

Form with fields for Signature of Recorded Holder or Agent, Date, Agent's Address, Telephone Number, and Fax Number.

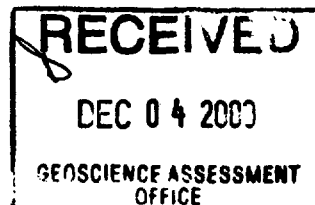

#291



5. **Work to be recorded and distributed.** Work can only be assigned to claims that are contiguous (adjoining) to the mining land where work was performed, at the time work was performed. A map showing the contiguous link must accompany this form.

W0070.00256

	Mining Claim Number. Or if work was done on other eligible mining land, show in this column the location number indicated on the claim map.	Number of Claim Units. For other mining land, list hectares.	Value of work performed on this claim or other mining land.	Value of work applied to this claim.	Value of work assigned to other mining claims.	Bank. Value of work to be distributed at a future date
1	1184524 <sup>e</sup>	1	\$237.92	\$237.92	0	0
2						
3						
4						
5						
6						
7						
8						
9						
10						
11						
12						
13						
14						
15						
	<b>Column Totals</b>	1	\$237.92	\$237.92	0	0

I, William S. Ferreira, do hereby certify that the above work credits are eligible under subsection 7 (1) of the Assessment Work Regulation 6/96 for assignment to contiguous claims or for application to the claim where the work was done.  
(Print Full Name)

Signature of Recorded Holder or Agent Authorized in Writing:  Date: Nov 22, 2000

6. **Instruction for cutting back credits that are not approved.**

Some of the credits claimed in this declaration may be cut back. Please check (✓) in the boxes below to show how you wish to prioritize the deletion of credits:

- 1. Credits are to be cut back from the Bank first, followed by option 2 or 3 or 4 as indicated.
- 2. Credits are to be cut back starting with the claims listed last, working backwards; or
- 3. Credits are to be cut back equally over all claims listed in this declaration; or
- 4. Credits are to be cut back as prioritized on the attached appendix or as follows (describe):

Note: If you have not indicated how your credits are to be deleted, credits will be cut back from the Bank first, followed by option number 2 if necessary.

**For Office Use Only**

Received Stamp	Deemed Approved Date	Date Notification Sent
	Date Approved	Total Value of Credit Approved
	Approved for Recording by Mining Recorder (Signature)	

0241 (03/97)

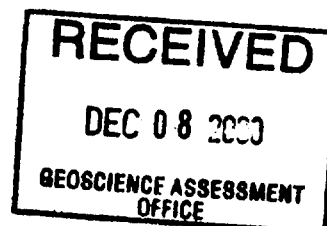
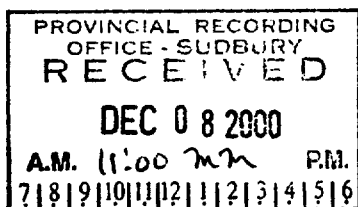



Statement of Costs for Assessment Credit

Transaction Number (office use) W0070.00a56

Personal information collected on this form is obtained under the authority of subsection 6 (1) of the Assessment Work Regulation 6/96. Under section 8 of the Mining Act, this information is a public record. This information will be used to review the assessment work and correspond with the mining land holder. Questions about this collection should be directed to a Provincial Mining Recorder, Ministry of Northern Development and Mines, 3rd Floor, 933 Ramsey Lake Road, Sudbury, Ontario, P3E 6B5.

Table with 4 columns: Work Type, Units of work, Cost Per Unit of work, Total Cost. Rows include Rock sample assays, Field Geologist, Associated Costs, Transportation Costs, Food and Lodging Costs, and Total Value of Assessment Work (\$237.92).

Calculations of Filing Discounts:

- 1. Work filed within two years of performance is claimed at 100% of the above Total Value of Assessment Work.
2. If work is filed after two years and up to five years after performance, it can only be claimed at 50% of the Total Value of Assessment Work. If this situation applies to your claims, use the calculation below:

TOTAL VALUE OF ASSESSMENT WORK x 0.50 = Total \$ value of worked claimed.

Note: - Work older than 5 years is not eligible for credit. - A recorded holder may be required to verify expenditures claimed in this statement of costs within 45 days of a request for verification and/or correction/clarification. If verification and/or correction/clarification is not made, the Minister may reject all or part of the assessment work submitted.

Certification verifying costs:

I, William S. Ferreira, do hereby certify, that the amounts shown are as accurate as may reasonably be determined and the costs were incurred while conducting assessment work on the lands indicated on the accompanying

Declaration of Work form as Senior Geologist I am authorized to make this certification.

Signature [Handwritten Signature] Date Nov. 22, 2000

RECEIVED DEC 04 2000 GEOSCIENCE ASSESSMENT OFFICE

Geoscience Assessment Office  
933 Ramsey Lake Road  
6th Floor  
Sudbury, Ontario  
P3E 6B5

Telephone: (888) 415-9845  
Fax: (877) 670-1555

January 10, 2001

CANMINE RESOURCES CORPORATION  
275 DUNDAS ST., SUITE 1605  
LONDON, ONTARIO  
N6B-3L1

Visit our website at:  
[www.gov.on.ca/MNDM/MINES/LANDS/mlsmnpge.htm](http://www.gov.on.ca/MNDM/MINES/LANDS/mlsmnpge.htm)

Dear Sir or Madam:

**Submission Number:** 2.20786

**Status**

**Subject: Transaction Number(s):** W0070.00256 Approval

---

We have reviewed your Assessment Work submission with the above noted Transaction Number(s). The attached summary page(s) indicate the results of the review. **WE RECOMMEND YOU READ THIS SUMMARY FOR THE DETAILS PERTAINING TO YOUR ASSESSMENT WORK.**

If the status for a transaction is a 45 Day Notice, the summary will outline the reasons for the notice, and any steps you can take to remedy deficiencies. The 90-day deemed approval provision, subsection 6(7) of the Assessment Work Regulation, will no longer be in effect for assessment work which has received a 45 Day Notice. Allowable changes to your credit distribution can be made by contacting the Geoscience Assessment Office within this 45 Day period, otherwise assessment credit will be cut back and distributed as outlined in Section #6 of the Declaration of Assessment work form.

Please note any revisions must be submitted in **DUPLICATE** to the Geoscience Assessment Office, by the response date on the summary.

If you have any questions regarding this correspondence, please contact **BRUCE GATES** by e-mail at [bruce.gates@ndm.gov.on.ca](mailto:bruce.gates@ndm.gov.on.ca) or by telephone at (705) 670-5856.

Yours sincerely,



ORIGINAL SIGNED BY  
Lucille Jerome  
Acting Supervisor, Geoscience Assessment Office  
Mining Lands Section

# Work Report Assessment Results

---

**Submission Number:** 2.20786

**Date Correspondence Sent:** January 10, 2001

**Assessor:** BRUCE GATES

---

<b>Transaction Number</b>	<b>First Claim Number</b>	<b>Township(s) / Area(s)</b>	<b>Status</b>	<b>Approval Date</b>
W0070.00256	1184524	AFTON	Approval	January 09, 2001

**Section:**  
9 Prospecting PROSP

**Correspondence to:**  
Resident Geologist  
Sudbury, ON

Assessment Files Library  
Sudbury, ON

**Recorded Holder(s) and/or Agent(s):**  
Williams S Ferreira  
WINNIPEG, MANITOBA

CANMINE RESOURCES CORPORATION  
LONDON, ONTARIO

---

