



41116SW0012 0015B1 CLEMENT

010

RECEIVED

MAY 27 1975

PROJECTS UNIT

Phelan

REPORT ON

A MAGNETOMETER SURVEY

OF

MANITOU LAKE CLAIMS

Performed for

M. GREENE & ASSOCIATES LTD.

by

P R O J E X L I M I T E D

330 Bay Street

Toronto

April 21, 1975

L. G. Phelan, M.A.Sc., P.Eng.,
Consulting Geologist

REPORT ON
A MAGNETOMETER SURVEY
OF
MANITOU LAKE CLAIMS
Performed for
M. GREENE & ASSOCIATES LTD.

During April 1975 Projex Limited carried out a magnetometer survey over a claim group at Manitou Lake in the Sudbury district of Ontario, on behalf of M. Greene & Associates Ltd. The following is a resume of pertinent observations:

PROPERTY:

The property consists of 14 contiguous unleased mining claims numbered S411552 to 411565 inclusive and totalling approximately 550 acres. The claims straddle the boundary between Macbeth and Clement Townships some 40 miles northeast of Sudbury or about 20 miles southwest of Temagami. Highway 805, an all-weather gravel road, traverses the easterly part of the property.

GENERAL GEOLOGY:

The limited available data indicate the northwesterly and southeasterly parts of the claim group are underlain by a relatively flat-lying Keweenaw diabase sill, with the central part of the claims occupied by Archaean intermediate and mafic volcanics exposed through a "window" in the sill. Huronian conglomerates of the Gowganda formation are found immediately northwest of the claim group and may extend on to the extreme northwesterly claim of the group.

An occurrence of gold mineralization is reported in the volcanics in the southwesterly part of the claim group. Trenching and a quartz vein, which may be the same gold occurrence, were noted during the course of the magnetometer survey. They were deeply buried in snow and were not examined in detail.

WORK DONE:

An east-west base line was cut and chained across the south-central part of the claim group. From this base line north-south picket lines were cut and chained at 400 foot interval and extended to the property boundaries. Tie lines were cut and chained along north and south boundaries. Stations were established at 100 foot intervals on all lines. A total of 17.5 miles of line were cut and chained under contract by Leo Savard.

A base station was established at a convenient location where the base line crosses the road, and all magnetometer readings are relative to this point. Magnetometer readings were taken at all stations on the above line grid and at intervening points where necessary for detail. Results, corrected for diurnal variations, are plotted and contoured on the accompanying plan, drawn at a scale of one inch to 200 feet. Instrument used was a Sharpe MF1 flux gate magnetometer, measuring the vertical component of the magnetic field to a

sensitivity of 20 gammas per scale division. Field work was performed by T. O'Connor, P.Eng., and G. Beier. A total of 905 readings were taken.

DISCUSSION OF RESULTS:

The most prominent magnetic feature is a strong magnetic high trending across the south-central part of the property for almost its full width. This is interpreted as representing a band of iron formation within the volcanics. A lesser but marked narrow linear high with a northeast trend circa 2400W, 500S' is believed to represent a diabase dike.

The northwesterly volcanic-diabase sill contact is readily apparent and trending about along the line 4800W at the Base Line to 1600W at the north boundary. It is notable that the iron formation can be seen extending beneath the sill; the narrowing of the anomaly west of the diabase contact can be attributed to the greater depth of the iron. The shape of the high suggests a steep southerly dip to the iron formation.

The southeasterly volcanics — sill contact is not as clearly defined, but is tentatively placed at 400W on the Base Line.

All the magnetic trends appear to die out in Manitou Lake, and the extreme easterly part of the property is quite uniform magnetically. This, plus the marked linear shape of

the lake and the outfall river extending southward, suggest a north-south fault through this area.

A moderate magnetic high is evident on lines 24 and 28W right at the north boundary of the property. It has an east-west or northeast strike, but little can be said since only one side of the anomaly falls within the area surveyed.

As noted above a quartz vein was observed in an outcrop at 350N on line 36W, and a snow-filled trench at 360S on the same line. There does not appear to be any particular magnetic association with either of these.

CONCLUSIONS:

The magnetometer survey has outlined the major geological features of the claim group. More information can undoubtedly be extracted from the subtler irregularities in the same data once the snow is gone and an examination of the outcrop of the area can be made.

It is understood that there is an association between iron formation and certain gold deposits or occurrences in the vicinity. The irregularities in the magnetic imprint of the iron formation may represent structural deformation and should be investigated.

Respectfully submitted,

PROJECT LIMITED,
L. G. Phelan, F.A.S.C. P.Eng.,
Consulting Geologist

Toronto, Ontario
21 April, 1975



Ontario



900

RECEIVED

Ministry of
Natural
Resources

OCT 20 1975

October 10, 1975

Our file number 2.1806

Your file number

Mrs. R. M. Charnesky
Mining Recorder
Ministry of Natural Resources
174 Douglas Street West
Sudbury, Ontario
P3E 1G1

Dear Madam:

Re: Mining Claims S.411552 et al,
Clement and MacBeth Townships
File 2.1806

The Geophysical (Magnetometer) assessment work credits as shown on the attached statement have been approved as of the above date.

Please inform the recorded holder of these mining claims and so indicate on your records.

Yours very truly,

J. R. McGinn
Director
Lands Administration Branch

Whitney Block, Room 1617
Queen's Park
Toronto, Ontario
M7A 1X1
Phone: 416-965-6918

DN/mw

cc: Mr. C. Marshall Hames
Toronto, Ontario

cc: Mr. Tom Heale, P. Eng.,
Richmond Hill, Ontario

cc: Deputy Regional Director
Attn: Resident Geologist
Sudbury, Ontario



Ministry of
Natural
Resources

Ontario

Lands
Administration
Branch

Projects
Unit

**Technical Assessment
Work Credits**

File
2.1806

Recorded Holder	Mr. C. Marshall Hames
Township or Area	Clement and MacBeth Townships

Type of survey and number of Assessment days credit per claim	Mining Claims
Geophysical Electromagnetic _____ days Magnetometer <u>40</u> _____ days Radiometric _____ days Induced polarization _____ days Section 86 (18) _____ days Geological _____ days Geochemical _____ days Man days <input type="checkbox"/> Airborne <input type="checkbox"/> Special provision <input checked="" type="checkbox"/> Ground <input checked="" type="checkbox"/>	S. 411552 to 65 inclusive
Notice of Intent to be Issued: <input type="checkbox"/> Credits have been reduced because of partial coverage of claims. <input type="checkbox"/> Credits have been reduced because of corrections to work dates and figures of applicant. <input type="checkbox"/> No credits have been allowed for the following mining claims as they were not sufficiently covered by the survey: _____ _____ _____ _____ _____	

The Mining Recorder may reduce the above credits if necessary in order that the total number of approved assessment days recorded on each claim does not exceed the maximum allowed as follows: Geophysical — 80; Geological — 40; Geochemical — 40;

File 2.1806

**GEOPHYSICAL - GEOLOGICAL - GEOCHEMICAL
TECHNICAL DATA STATEMENT**

RECEIVED

MAY 27 1975

PROJECTS UNIT

TO BE ATTACHED AS AN APPENDIX TO TECHNICAL REPORT
FACTS SHOWN HERE NEED NOT BE REPEATED IN REPORT
TECHNICAL REPORT MUST CONTAIN INTERPRETATION, CONCLUSIONS ETC.

Type of Survey Magnetometer
Township or Area Masbath and Clement Twp
Claim holder(s) Marshall Harris, A-37903
32nd Floor
Toronto Dominion Bank Building, Toronto
Author of Report L.G. Phelan P. Eng.
Address 330 Bay St. Toronto
Covering Dates of Survey Feb 25 to Apr 20, 1975
(linecutting to office)
Total Miles of Line cut 16.5

MINING CLAIMS TRAVERSED
List numerically

(prefix) (number)

- S-411552 ✓
- S-411553 ✓
- S-411554 ✓
- S-411555 ✓
- S-411556 ✓
- S-411557 ✓
- S-411558 ✓
- S-411559 ✓
- S-411560 ✓
- S-411561 ✓
- S-411562 ✓
- S-411563 ✓
- S-411564 ✓
- S-411565 ✓

**SPECIAL PROVISIONS
CREDITS REQUESTED**

DAYS
per claim

ENTER 40 days (includes
line cutting) for first
survey.

ENTER 20 days for each
additional survey using
same grid.

Geophysical

-Electromagnetic

-Magnetometer 40

-Radiometric

-Other DN

Geological

Geochemical

AIRBORNE CREDITS (Special provision credits do not apply to airborne surveys)

Magnetometer _____ Electromagnetic _____ Radiometric _____
(enter days per claim)

DATE: May 23/75 SIGNATURE: T. Phelan
L.G. Phelan Author of Report or Agent

PROJECTS SECTION

Res. Geol. _____ Qualifications 63A.389

Previous Surveys L.O. LID

Checked by _____ date _____

GEOLOGICAL BRANCH _____

Approved by _____ date _____

GEOLOGICAL BRANCH _____

Approved by _____ date _____

TOTAL CLAIMS 14

Show instrument technical data in each space for type of survey submitted or indicate "not applicable"

GEOPHYSICAL TECHNICAL DATA

GROUND SURVEYS

Number of Stations 800 Number of Readings 905
Station interval 100 ft, less where required
Line spacing 400 feet
Profile scale or Contour intervals 100 ft on flat areas, 100 in high intensity areas
(specify for each type of survey)

MAGNETIC

Instrument Sharp MF 1 fluxgate magnetometer
Accuracy - Scale constant 20 γ per scale division
Diurnal correction method linear method
Base station location line 400 W, 100 S

ELECTROMAGNETIC

Instrument _____
Coil configuration _____
Coil separation _____
Accuracy _____
Method: Fixed transmitter Shoot back In line Parallel line
Frequency _____
(specify V.L.F. station)

Parameters measured _____

GRAVITY

Instrument _____
Scale constant _____
Corrections made _____
Base station value and location _____
Elevation accuracy _____

INDUCED POLARIZATION - RESISTIVITY

Instrument _____
Time domain _____ Frequency domain _____
Frequency _____ Range _____
Power _____
Electrode array _____
Electrode spacing _____
Type of electrode _____

CLEMENT & MACBETH
RECEIVED W.P.S.

75-38

FILE S. 411552

JAN 13 1976



ONTARIO

THE MINING ACT REPORT OF WORK

A separate form is required for each type of work to be recorded.

To the Recorder of Suburb Mining Division
I, Marshal Hamer A 37903

Toronto Dominion Bank Building Toronto Ontario
name of Recorded Holder Post Office Address

do hereby report the performance of 560 days of Geophysical type of work
(Mag + Linecutting)

not before reported to be applied on the following contiguous claims

Claim No.	Days	Claim No.	Days	Claim No.	Days
411552	40	411558	40	411564	40
411553	40	411559	40	411565	40
411554	40	411560	40		
411555	40	411561	40		
411556	40	411562	40		
411557	40	411563	40		

All the work was performed on Mining Claim (s) All equally
(In the case of geological and/or geophysical survey (s) where more than 18 claims are involved attach a schedule)

READ CAREFULLY: THE FOLLOWING INFORMATION IS REQUIRED BY THE MINING RECORDER.

- For Manual Work, Stripping or Opening up of Mines, Sinking Shafts or Other Actual Mining Operations - Names and addresses of the men who performed the work and the dates and hours of their employment.
- For Diamond and other Core Drilling - Footage, No. and angle of holes and diameter of core. Name and address of owner or operator of drill. Dates when drilling was done. Signed core log and sketch in duplicate.
- For Compressed Air or Other Power Driven or Mechanical Equipment
Type of drill or equipment. Names and addresses of men engaged in operating equipment and the dates and hours of their employment.
- For Power Stripping - Type of equipment. Name and address of owner or operator. Amount expended. Dates on which work was done. Proof of actual cost must be submitted within 30 days of recording.
- With each of the above types of work sketches are required to show the location and extent of the work in relation to the nearest claim post. In the case of diamond or other core drilling the sketch must be submitted in duplicate.
- For Geophysical, Geological, Geochemical Surveys and Expenditure Credits - the name of author of report. Covering dates of survey (linecutting & office). Type of instrument used. Total amount of expenditure. Technical reports, maps, expenditure breakdown, receipts must be filed in duplicate with the Minister within 60 days of recording.
- For Land Survey - the name and address of Ontario Land surveyor.

The Required Information is as Follows: (Attach a list if this space is insufficient)

Line Cutting, Period Feb 25 - March 16, 1975
Contractor: L. Savard, North Bay
Cost: \$2062.50

Magnetometer Survey, Period, March 20 to Apr. 20, 1975
Contractor: Profex Ltd, 350 Bay St. Toronto
Author of report, L.G. Phelan, M.A.S. P. Eng.
Cost 2125.00
Total cost \$4187.50

Date Apr 22, 1975 Signature of Recorded Holder or Agent T. Heale

The Mining Act
Certificate Verifying Report of Work

I, Tom Heale, P. Eng.
431 Crosby Ave Richmond Hill Ont L4C 2R9
(Post Office Address)

hereby certify:

- That I have a personal and intimate knowledge of the facts set forth in the report of work annexed hereto, having performed the work or witnessed some during and/or after its completion.
- That the annexed report is true.

Dated Apr 22 19 75

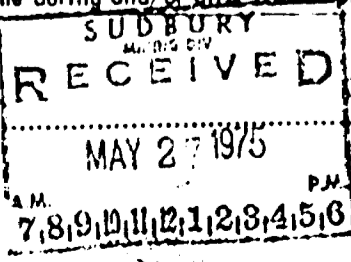

Signature T. Heale

THE PENALTY FOR MAKING A FALSE STATEMENT IN THIS REPORT AND/OR CERTIFICATE IS \$500. OR SIX MONTHS IMPRISONMENT OR BOTH

Schrotes Twp.

Macbeth Twp.

Vogt Twp.

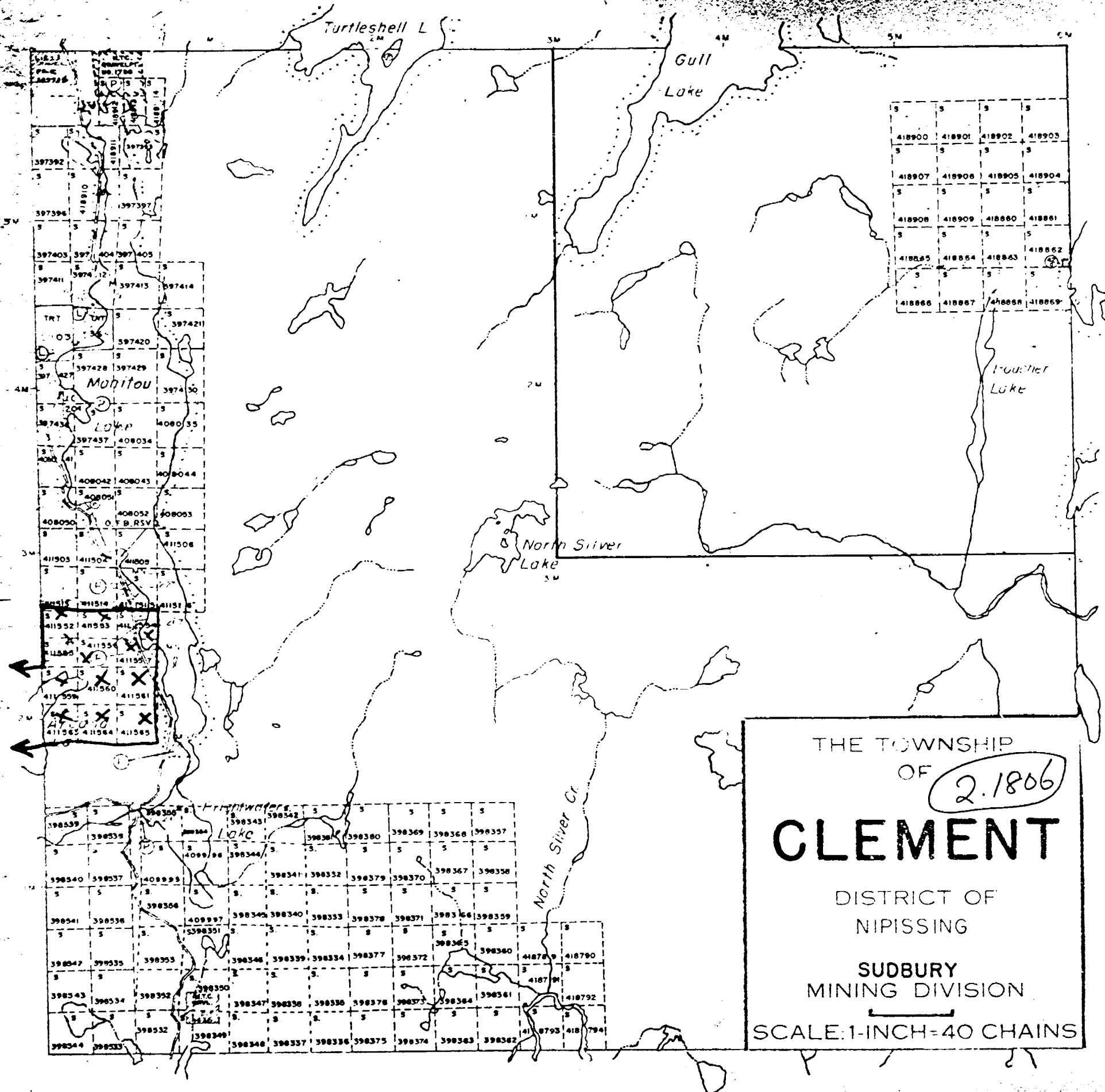

THE TOWNSHIP
 OF 2.1806
CLEMENT
 DISTRICT OF
 NIPISSING
 SUDBURY
 MINING DIVISION
 SCALE: 1-INCH=40 CHAINS

AFTON TWP.

MC CARTHY TWP.

CLEMENT TWP.

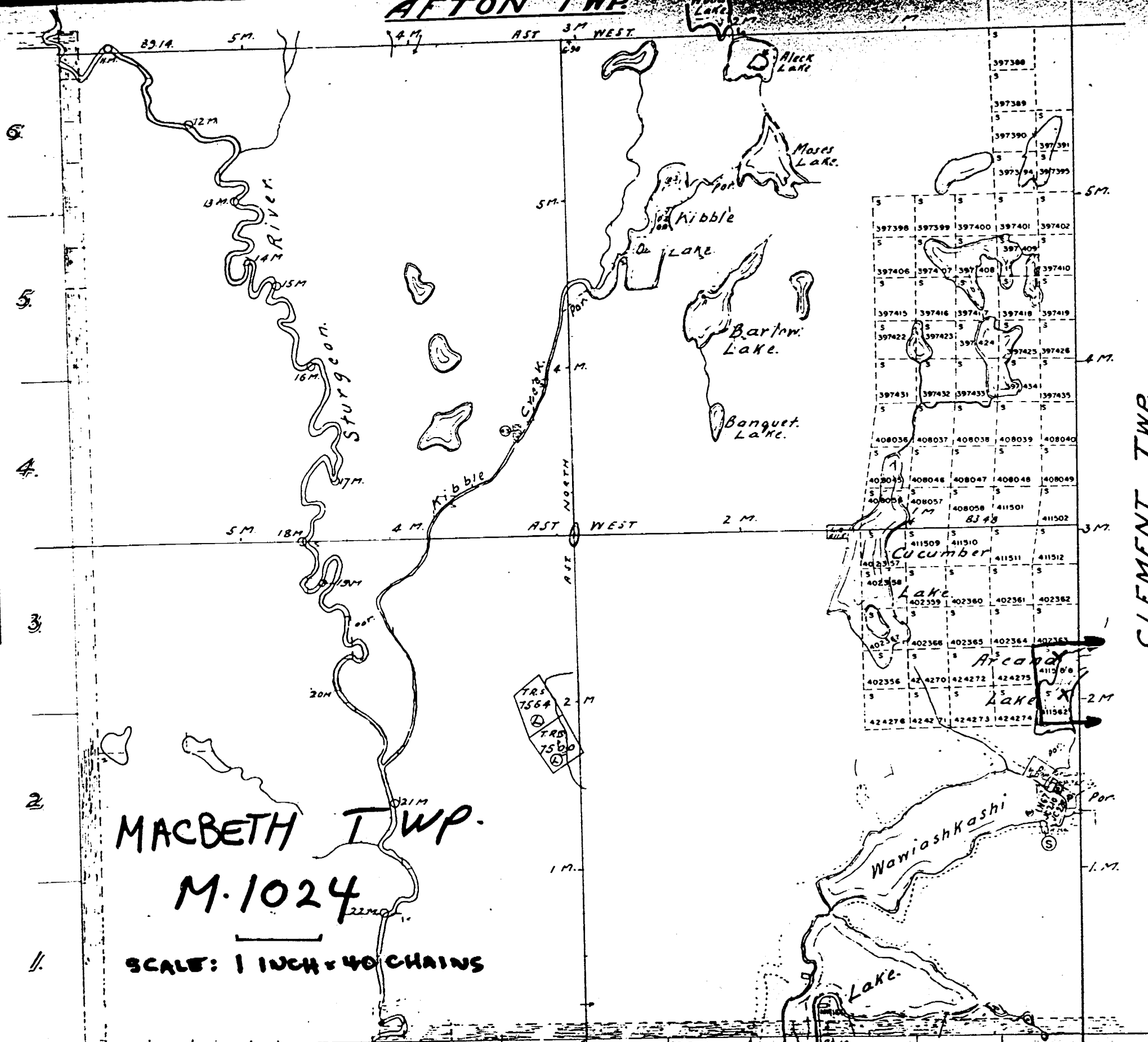

MACBETH TWP.

M. 1024

SCALE: 1 INCH = 40 CHAINS

12.	11.	10.	9.	8.	7.	6.	5.	4.	3.	2.	1.
79.05		82.00		80.65	AST 640 WEST	79.50		84.10			

NOTES:

SEE ACCOMPANYING
MAP(S) IDENTIFIED AS

CLEMENT-0015-B1-*

LOCATED IN THE MAP
CHANNEL IN THE FOLLOWING
SEQUENCE (X)

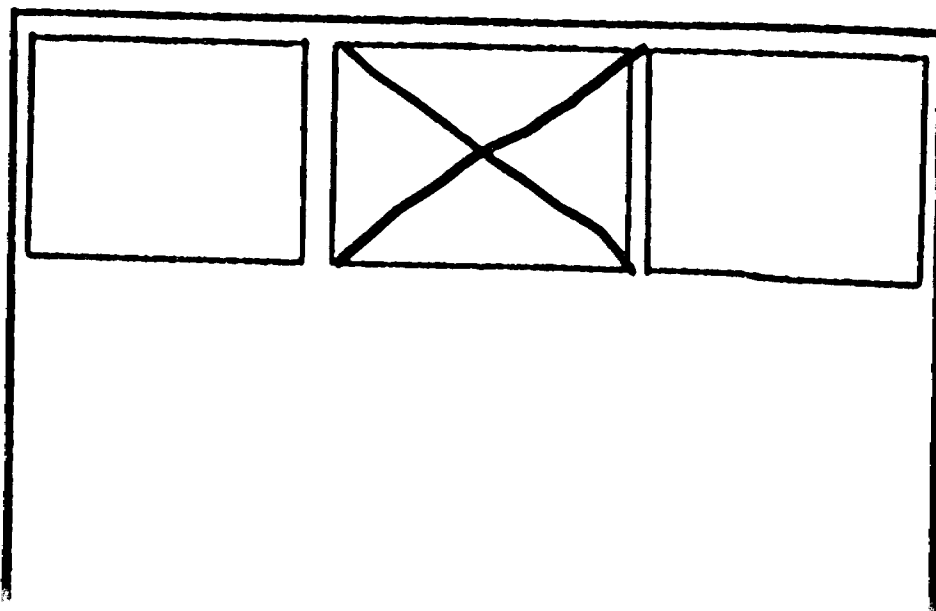

40+00 N

30+00 N

20+00 N

10+00 N

0+00

10+00 S

200

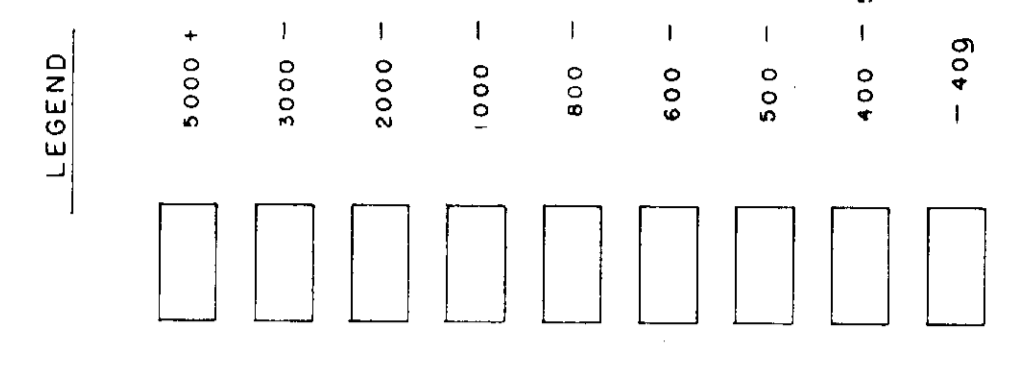
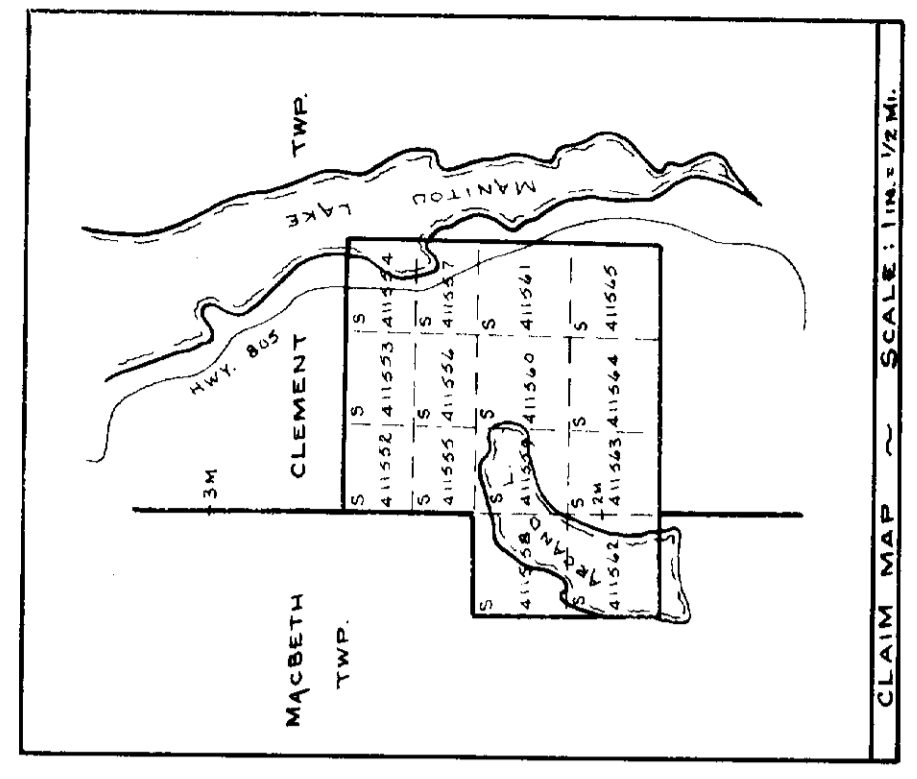
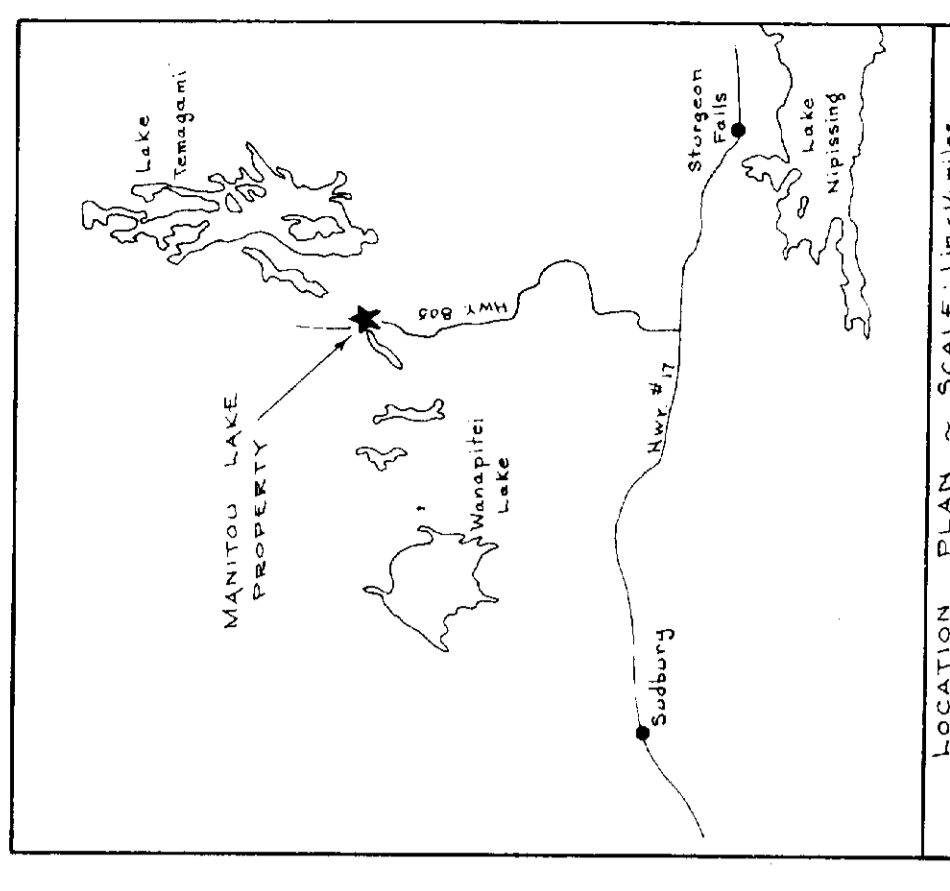
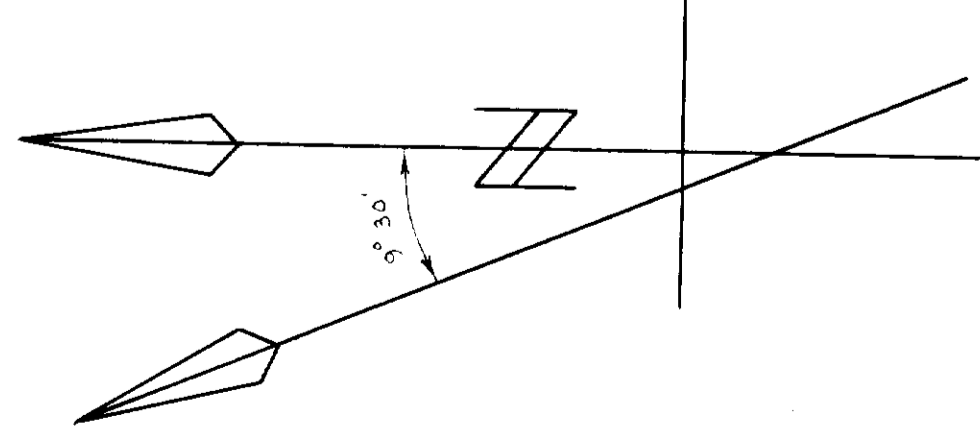

CLEMENT-0015-B1 #1
 MAGNETOMETER SURVEY
 MANITOU LAKE PROPERTY
 FOR
 M. GREENE & ASSOCIATES LTD.

PROJEX LIMITED
 APRIL 1975

