

Salter dup.
M. 1087

#74-101

RECEIVED file S. 377842

NOV 19 1974

A separate form is required for each type of work to be recorded.

THE MINING ACT REPORT OF WORK

To the Recorder of Sudbury Mining Division

I, Thomas Legrand name of Recorded Holder C-31120 Miner's Licence

no. Box 792 Esplanade Est Post Office Address

do hereby report the performance of 96 days of Manual Labour type of work **MANUAL LABOUR**

not before reported to be applied on the following contiguous claims

Claim No.	Days	Claim No.	Days	Claim No.	Days
S. 377842	20				
S. 377843	96.36				
S. 377844	20				
S. 377845	20				



SUDBURY RECEIVED NOV 4 1974

010

7, 8, 9, 10, 11, 12, 13, 15, 16

All the work was performed on Mining Claim (s) S. 377843
(In the case of geological and/or geophysical survey (s) where more than 18 claims are involved attach a schedule)
READ CAREFULLY: THE FOLLOWING INFORMATION IS REQUIRED BY THE MINING RECORDER.

- For Manual Work, Stripping or Opening up of Mines, Sinking Shafts or Other Actual Mining Operations - Names and addresses of the men who performed the work and the dates and hours of their employment.
- For Diamond and other Core Drilling - Footage, No. and angle of holes and diameter of core. Name and address of owner or operator of drill. Dates when drilling was done. Signed core log and sketch in duplicate.
- For Compressed Air or Other Power Driven or Mechanical Equipment - Type of drill or equipment. Names and addresses of men engaged in operating equipment and the dates and hours of their employment.
- For Power Stripping - Type of equipment. Name and address of owner or operator. Amount expended. Dates on which work was done. Proof of actual cost must be submitted within 30 days of recording.
- With each of the above types of work sketches are required to show the location and extent of the work in relation to the nearest claim post. In the case of diamond or other core drilling the sketch must be submitted in duplicate.
- For Geological and Geophysical Survey - The names and addresses of men employed as well as dates. Type of instrument used in the case of geophysical survey. Reports and maps in duplicate must be filed with the Minister within 60 days of recording.
- For Land Survey - the name and address of Ontario Land surveyor.

The Required Information is as Follows: (Attach a list if this space is insufficient)

SUDBURY RECEIVED OCT 25 1974

Date Oct. 24, 1974 Signature of Recorded Holder or Agent Thomas Legrand

The Mining Act Certificate Verifying Report of Work

I, Thomas Legrand
12 Queensway Esplanade Est P.O. Box 792
(Post Office Address)

- hereby certify:
- That I have a personal and intimate knowledge of the facts set forth in the report of work annexed hereto, having performed the work or witnessed same during and/or after its completion.
 - That the annexed report is true.

Dated Oct 24 19 74 Signature Thomas Legrand

THE PENALTY FOR MAKING A FALSE STATEMENT IN THIS REPORT AND/OR CERTIFICATE IS \$500. OR SIX MONTHS IMPRISONMENT OR BOTH

Recd Report Starting Date May 6th, 1974
Thomas Tennant

May 6 7 8 9 10 13 14 15 16 17 20 21 22 23 24 27 28 29 30
 20 days in May 6 hr. day 120 hrs. for 20 days

June 3rd 4 5 6 7 10 11 12 13 14 17 18 19 20 24 25 26 27 28
 19 days in June 6 hr. day 114 hrs. for 19 days ✓

July 8 9 10 11 12 13 15 16 17 18 19 22 23 24 25 26 29 30 31
 18 day in July 6 hr. day 108 hrs for 18 day

Aug 5 6 7 8 9 12 13 14 15 16 19 20 21 22 23 26 27 28 29
 20 day in Aug 6 hr day 120 hrs. for 20 days

Sept 4 5 6 9 10 11 12 13 16 17 18 19 20 23 24 25 26 27 30

19 days Sept 6 hr. day 114 hrs. for 19 days

Work perform by Thomas Tennant Mining Lic. No. C 31120	May	20 days work	
	June	19	-
	July	18	-
	Aug.	20	-
	Sept.	19	-
		<u>96 days work</u>	

All work perform on Total
 Claim No ~~31~~ 377843

Thomas Tennant

Salter Township District of Sudbury Perth

CLAIM No 377842

CLAIM No 377844

Thomas Tennant
Mining Lic No. C31120

20 days work

20 days work
20 DAYS WORK

STARTING DATE MAY 6 - TO SEPT 30/74
Starting date May 6 - to Sept. 30th/74

MANUAL LABOUR

Manual labour CLAIM No 377843

CLAIM No 377845

96 day work

Perform by Thomas Tennant
PERFORM BY THOMAS TENNANT

West

East

PIT #1
ROCK TRENCH
APPROX 2 1/3 DEEP
4' WIDE, APPROX
10' LONG.

PIT #2 - ROCK
TRENCH APPROX
1 FT DEEP
3 WIDE
APPROX 8' LONG.

3.00 ft.

315 ft

Pit #1
Rock trench
approx. 2 1/2 deep 4 ft. wide
approx 10 ft. long

Pit #2
Rock trench
approx 1 ft. deep 3 wide
approx 8 ft. long

Pit #3
approx 3 ft. deep 4 1/2 ft wide
approx 20 ft. long

Pit #4
Rock trench
approx 3 ft. deep
approx 14 ft. long 6 ft wide

Pit #5
approx 400' 8 ft. long 6 wide 3 1/2 deep

Pit #6
approx 420' 11 ft. long
3 ft 7 deep
5 ft wide

Pit #7
approx 440' 14 ft long 3 wide 3 ft 10 deep

PIT #8
approx 460' 4 ft. wide, 12 long 2 1/2 deep
3 FT WIDE.
12 LONG
2 1/2 DEEP

APPROX 3' DEEP
4 1/2' WIDE
APPROX 20' LONG

370 ROCK TRENCH
APPROX 3' DEEP
14' LONG; 6' WIDE

APPROX 8' LONG
3 1/2 DEEP

11 FT LONG
3 FT 7 DEEP
5 FT WIDE

APPROX 14 FT LONG
3 WIDE
3 FT 10 DEEP

20 days work

36 days work
36 DAYS WORK

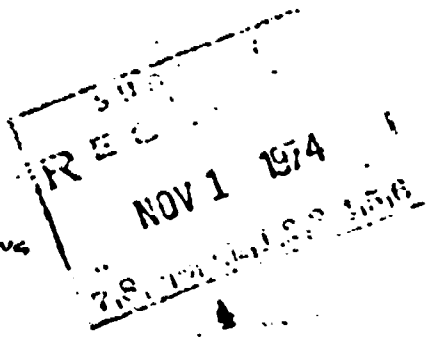

SALTER TWP

76-48

RECEIVED

FILE S. 377843



AUG 31 1976

A separate form is required for each type of work to be recorded.

Ni, Cu

020 REPORT OF WORK

To the Recorder of Salisbury Mining Division
I, Thomas Tennant name of Recorded Holder N.A.C. 31120 Prospector's Licence

do hereby report the performance of 2 min 166 days of drilling with compressed air type of work where
not before reported to be applied on the following contiguous claims DRILLING W/COMPRESSANT AIR DRILL

Claim No.	Days	Claim No.	Days	Claim No.	Days
377842	40				
377843	40				
377844	40				
377845	40				

Geological Branch ODM
ASSESSMENT FILES
RESEARCH OFFICE
AUG 2 1976
RECEIVED

All the work was performed on Mining Claim (s) 377843
(In the case of geological and/or geophysical survey (s) where more than 18 claims are involved attach a schedule)

READ CAREFULLY: THE FOLLOWING INFORMATION IS REQUIRED BY THE MINING RECORDER.

- For Manual Work, Stripping or Opening up of Mines, Sinking Shafts or Other Actual Mining Operations - Names and addresses of the men who performed the work and the dates and hours of their employment.
- For Diamond and other Core Drilling - Footage, No. and angle of holes and diameter of core. Name and address of owner or operator of drill. Dates when drilling was done. Signed core log and sketch in duplicate.
- For Compressed Air or Other Power Driven or Mechanical Equipment
Type of drill or equipment. Names and addresses of men engaged in operating equipment and the dates and hours of their employment.
- For Power Stripping - Type of equipment. Name and address of owner or operator. Amount expended. Dates on which work was done. Proof of actual cost must be submitted within 30 days of recording.
- With each of the above types of work sketches are required to show the location and extent of the work in relation to the nearest claim post. In the case of diamond or other core drilling the sketch must be submitted in duplicate.
- For Geophysical, Geological, Geochemical Surveys and Expenditure Credits - the name of author of report. Covering dates of survey (linecutting & office). Type of instrument used. Total amount of expenditure. Technical reports, maps, expenditure breakdown, receipts must be filed in duplicate with the Minister within 60 days of recording.
- For Land Survey - the name and address of Ontario Land surveyor.

The Required Information is as Follows: (Attach a list if this space is insufficient)

RECEIVED
MINING DIVISION
AUG 10 1976
7:19/10/11/12/13/14/15/16

Date Aug 8th 76 Signature of Recorded Holder or Agent Thomas Tennant

The Mining Act
Certificate Verifying Report of Work

I, Thomas Tennant
Salisbury (Post Office Address)

hereby certify:

- That I have a personal and intimate knowledge of the facts set forth in the report of work annexed hereto, having performed the work or witnessed same during and/or after its completion.
- That the annexed report is true.

Dated Aug 8 19 76 Signature Thomas Tennant
AUG 8/76

THE PENALTY FOR MAKING A FALSE STATEMENT IN THIS REPORT AND/OR CERTIFICATE IS \$500. OR SIX MONTHS IMPRISONMENT OR BOTH

#4 Post.

Salter Township NORTH 1/2 Subdiv

#1 Post.

Claim No. 377843

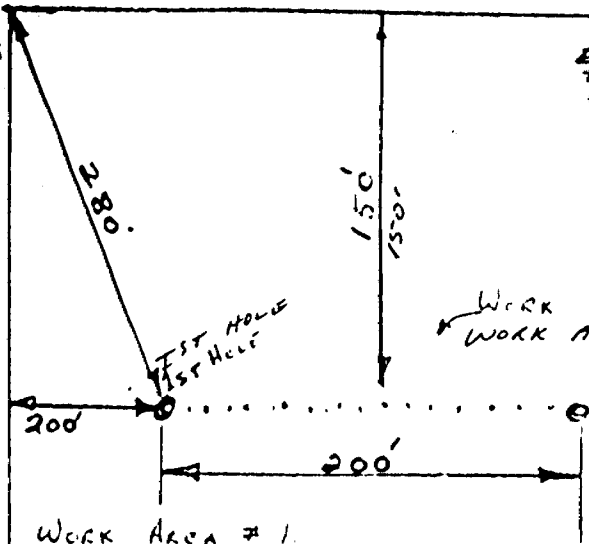

EACH HOLE APPROX 4' DEEP
 & 2' APART (APPROX)
 EACH HOLE APPROX. 4 FEET DEEP
 AND 2 FEET APART (APPROX)
 CLEARING A DISTANCE OF
 SOME 200 FEET IN LENGTH
 COVERING A DISTANCE OF SOME
 200' IN LENGTH.

Work Area #1
 Work Area #1

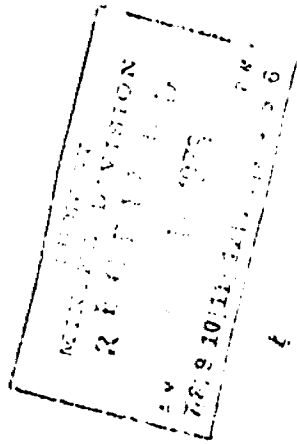

WORK AREA #2
 EACH HOLE IS APPROX 4' DEEP
 & 2' APART CLEARING A DISTANCE
 OF APPROX 100' IN LENGTH.
 1ST HOLE IS APPROX 400' IN
 FROM #2 POST. 400' FROM EAST LINE
 EAST
 350' FROM SOUTH LINE
 APPROX 45-50 HOLES IN THIS AREA.

Work Area #3
 EACH HOLE IS APPROX 4 FEET
 DEEP AND 2 FEET APART
 CLEARING A DISTANCE
 OF APPROX 200 FEET
 IN LENGTH.
 1st Hole is approx 400 feet
 in from #2 post
 400 feet from the east line
 350 feet from the south line
 approx 45-50 holes in this area

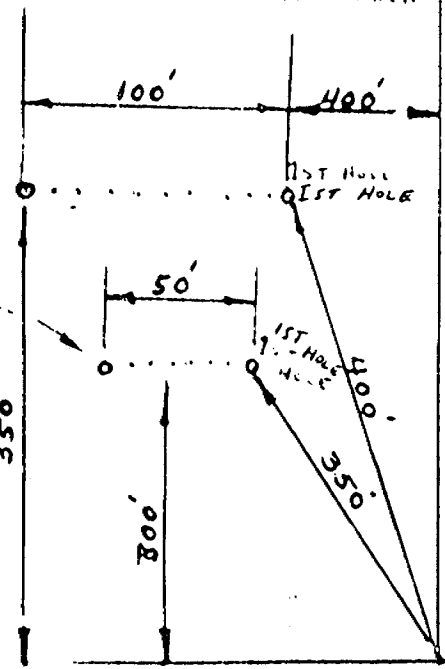

Work Area #1
 1st Drill Hole is approx. 280 feet
 in from #4 post
 200 feet in from the west line
 150 feet in from the north line.
 APPROX 100 DRILL HOLES IN THE 200 FEET
 1st DRILL HOLE IS APPROX. 280' OF CLEARANCE!
 IN FROM #4 POST
 200' IN FROM WEST LINE
 150' IN FROM NORTH LINE
 APPROX 100 DRILL HOLES IN THE 200 FEET OF CLEARANCE!

NOTE! ALL WORK DONE
 by AIR COMPRESSOR DRILL.

SKETCHES ARE NOT DONE
 TO SCALE. HOWEVER
 DISTANCES ARE APPROX.
 ACCURATE.

Work Area #2
 Work Area #2
 WORK AREA #3
 Work Area #3
 EACH HOLE IS APPROX 4 FEET DEEP & 2 FEET APART
 CLEARING A DISTANCE OF SOME 50 FEET
 1st Hole is approx. 350 feet in from #2 post
 400' FEET FROM EAST LINE
 300' FEET FROM SOUTH LINE
 APPROX 25-30 HOLES PER 50' CLEARANCE

#3 Post.

SOUTH

#2 Post.

TENNANT, T.
 Salter Twp
 1974

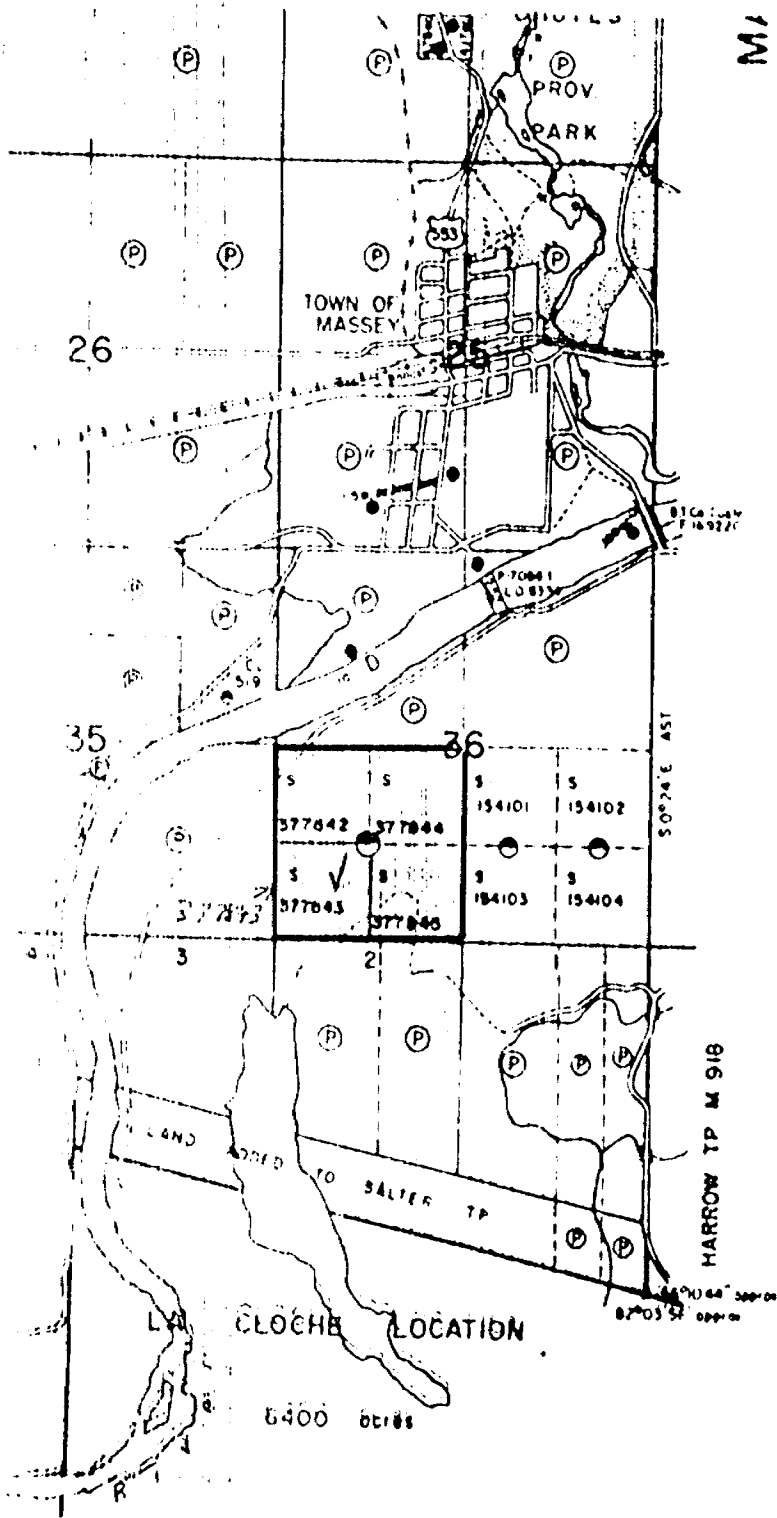

LEGEND

- PATENTED LAND
- PATENTED FOR MINING RIGHTS ONLY
- PATENTED FOR SURFACE RIGHTS ONLY
- LEASE
- LICENSE OF OCCUPATION
- CROWN LAND SALES
- LOCATED LAND
- CANCELLED
- MINING RIGHTS ONLY
- SURFACE RIGHTS ONLY
- HIGHWAY & ROUTE NO.
- ROADS
- TRAILS
- RAILWAYS
- POWER LINES
- MARSH OR MUSKEG
- MINES
- ORIGINAL SHORELINE

used only with summer resort locations or when space

TOWNSHIP OF

SALTER

DISTRICT OF
SUDBURY

SUDBURY
MINING DIVISION

SCALE : 1 INCH = 40 CHAINS (1/2 MILE)

DR DT.	PLAN NO. M.1087
DATE <i>June/72</i>	

MINISTRY OF
 NATURAL RESOURCES
 ONTARIO