

*note: this cut from prospectus dated April 20, 1964.  
Remainder of prospectus is in file SSM-620,  
in Sup. 163 file.*

## GEOLOGIST'S REPORT

ON

CLAIM GROUP OF BRUCE-PRESTO MINES LTD.

BATCHAWANA AREA, ONTARIO

**RECEIVED**  
MAY 12 1964

RESIDENT GEOLOGIST  
SAULT STE. MARIE

SUMMARY

The 5 - claim group of Bruce Presto Mines Ltd. in the Batchawana Area of Ontario is approximately  $3\frac{1}{2}$  miles southwest of the copper ore zone of Tribag Mining Co. Ltd.

The favourable granite-volcanic and gabbro contact on the Tribag property strikes in a southwesterly direction and could pass through, or close to, the claim group of Bruce Presto Mines Ltd.

It is recommended that reconnaissance geological mapping be conducted over the property to determine the geological setting and if the favourable contact crosses the claim group more detailed work would be warranted. This second phase would include line cutting, detailed geological mapping and geophysical surveying. The estimated cost of the first stage is \$800. and the second stage \$2000.

INTRODUCTION

This report is based on examination of Ontario Dept. of Mines report Vol XXV Part 11 (Batchawana Area, District of Algoma by E.S. Moore) and on private reports by Ajax Minerals Ltd. and Pitch Ore Uranium Mines Ltd. of exploration carried out on their properties in the Batchawana Area.

The writer has not visited the area or the property of Bruce-Presto Mines Ltd.

NOT TO BE REMOVED FROM  
THE OFFICE OF THE RESIDENT  
GEOLOGIST, ONT. DEPT. OF MINES  
SAULT STE. MARIE, ONT.

PROPERTY

The claim group consists of 5 unpatented, apparently contiguous, claims numbered SSM-66609 to SSM-66613 inclusive. These claims were staked in July, 1963, by J. Pickering and transferred to Bruce-Presto Mines in September 1963.



LOCATION AND ACCESS

The Batchawana property of Bruce Presto Mines Ltd. is located in Township 28, Range XIII, Sault Ste Marie Mining Division, Ontario.

Access to the property is by way of a dirt road from mileage 47 on highway 17. The distance from the highway is about 10 miles.

PREVIOUS WORK

There is no record of previous work having been carried out on the 5 claims discussed herein.

The iron occurrences in Palmer Twp. and Twp. 28, Range XIII have been known since 1865 but none has been brought to production. Copper mineralization was noted in several localities but until the Tribag discovery there were no known economic deposits.

GEOLOGY

According to Geological Map 35b, Ontario Dept. of Mines, the Bruce-Presto Mines claim group is underlain by the Batchawana Series of sediments and lavas which have been intruded by Mamainse gabbro. The Algonian granite-volcanic contact is shown to cut across the northern extremity of the property although detailed work in the area has indicated that the location of this contact on the map is not exact.

Iron formation is known to occur on patented land adjoining the 5-claim group on the south and the east.

The aeromagnetic map of the region (map 2188G, Mica Bay, Algoma District; Ontario Dept. of Mines) shows a magnetic low passing through the property in a northerly direction. The negative anomaly coincides with a topographic depression and is probably caused by a fault which could be the continuation of one postulated on the Quonto-Ajax property 1 mile to the north.

GEOLOGY (continued)

A large magnetic high to the south east of the property can be attributed to iron formation. On the aeromagnetic map there is an indication that this formation has been offset to the south by the above-mentioned fault.

MINERALIZATION IN THE AREA

The copper mineralization on the Tribag property is reported to be related to breccia zones either along the granite-volcanic contact or in the granite to the north.

On the Quonto-Ajax property minor disseminated chalcopyrite has been found in basic dykes and granite as well as in greenstone.

Sporadic patches of chalcopyrite in basic intrusive breccia were intersected in drill holes on the property of Allied Pitch Ore Uranium Mines 2 miles southeast of the Bruce-Presto Mines property.

CONCLUSIONS AND RECOMMENDATIONS

Wide spread copper mineralization has been found in the vicinity of the claim group of Bruce-Presto Mines Ltd. in the Batchawana area of Ontario. One of these occurrences, that belonging to Tribag Mining Co. Ltd., is being readied for production.

From the available geological literature it appears that the favourable granite-greenstone contact on the Tribag property strikes southwesterly towards the Bruce-Presto claim group and probably passes just to the north of it. Thus, the Bruce-Presto property would be underlain by the volcanic-gabbro formations which are reported to carry minor amounts of copper mineralization usually associated with breccia zones elsewhere in the area.

GEOLOGIST'S REPORT ON CLAIM GROUP OF BRUCE-PRESTO  
MINES LTD. BATCHAWANA AREA, ONTARIO

CONTINUED:

CONCLUSIONS AND RECOMMENDATIONS (continued)

A northerly trending fault appears to cut across the property and could provide breccia zones similar to those carrying copper mineralization on the Tribag property.

The Bruce-Presto Mines Ltd. claim group in the Batchawana Area is well located geologically and warrants further investigation.

In this connection it is recommended that a geological reconnaissance survey be carried out on the 5 claims when the snow has gone. Should it be found that the granite-volcanic contact crosses the property or that there are breccia zones within the group a more comprehensive programme of exploration would be required. This would include line cutting, detailed geological mapping and a magnetometer survey.

A breakdown of the cost is as follows:

Phase I - geological reconnaissance		\$800.
Phase II - line cutting 5 miles @ \$45.	\$ 225.	
- detail geological mapping	1200.	
- magnetometer survey 5 miles @ \$70.	350.	
- contingencies	<u>225.</u>	<u>2000.</u>
Total Expenditure		\$2800.

NOT TO BE REMOVED FROM  
THE OFFICE OF THE RESIDENT  
GEOLOGIST, ONT. DEPT. OF MINES  
SAULT STE. MARIE, ONT.

Respectfully submitted,

L. B. HALLADAY.

TORONTO, Ontario  
February 19, 1964.

**DISTRICT OF ALBERTA**  
**MULTI-STE. MARIE MINING DIVISION.**

Scale: 40 chains to an inch.

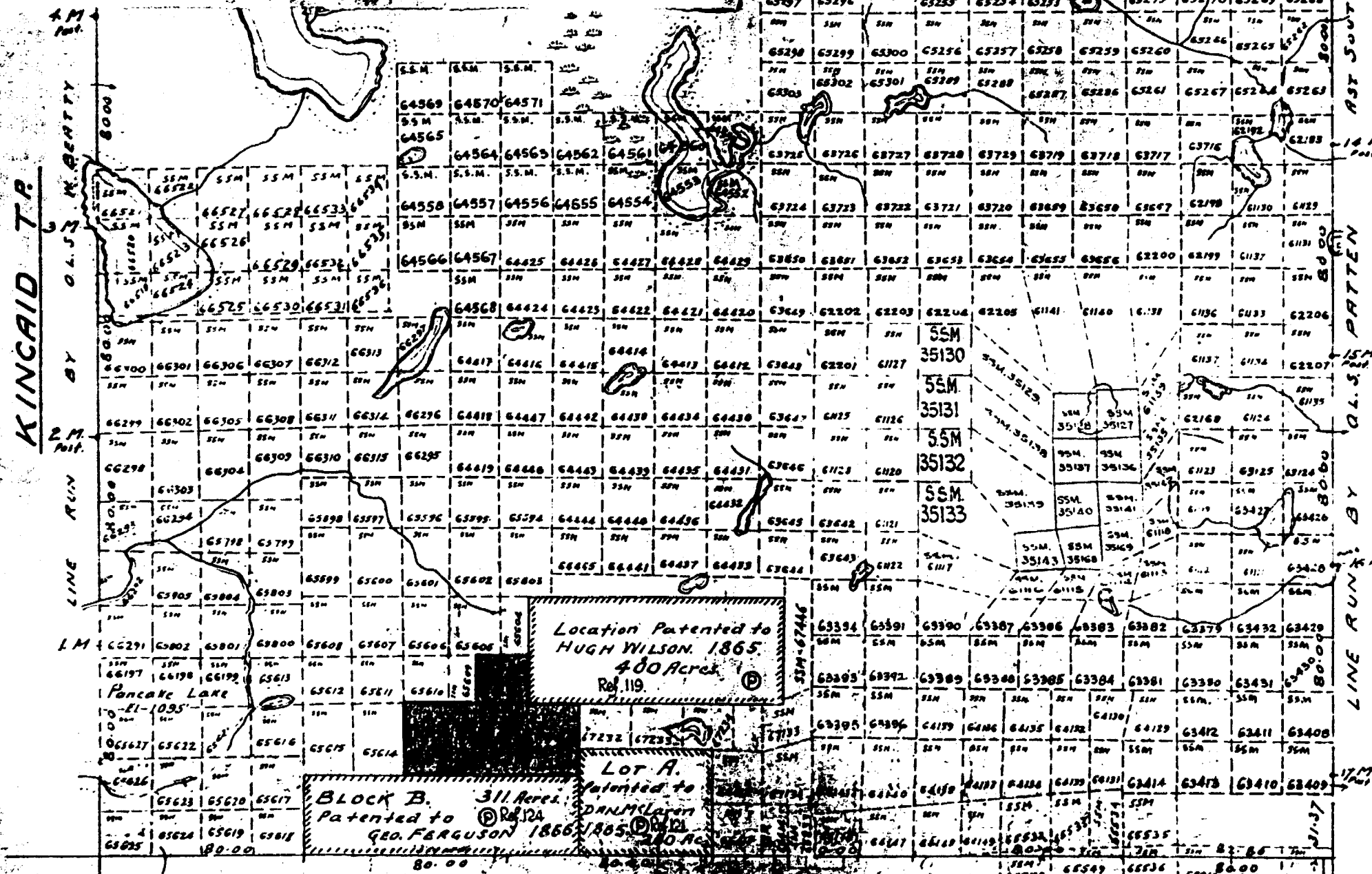

T.R. 27. R. 13.

NOT TO BE REMOVED FROM

100000 reservoirs 400 chains by Dept. of Lands & Mines  
 PALMER T.P.