

DIAMOND DRILLING

AREA: PILOT HARBOUR

REPORT NO: 10

WORK PERFORMED FOR: Oneida (Brass Ring) Resources Ltd.

RECORDED HOLDER: Same as above [xx]
: Other []

<u>Claim No.</u>	<u>Hole No.</u>	<u>Footage</u>	<u>Date</u>	<u>Note</u>
SSM 946953	88-1	100'	Apr/88	(1)
	88-2	106'	Apr/88	(1)
	88-3	162'	Apr/88	(1)
	88-4	128'	Apr/88	(1)
	88-5	201'	Apr/88	(1)
	88-6	101.5'	Apr/88	(1)
	88-7	247'	Apr/88	(1)
	88-8	147'	Apr/88	(1)
	88-9	187'	Apr/88	(1)
	88-10	42'	Apr/88	(1)
	88-11	52'	Apr/88	(1)
	88-12	352'	Apr/88	(1)
SSM 946954	88-13	152'	Apr/88	(1)
SSM 946958	88-14	251'	Apr/88	(1)
SSM 946964	88-18	144'	Apr/88	(1)
	88-19	402'	Apr/88	(1)
SSM 946979	88-20	396'	Apr/88	(1)
	88-21	352'	Apr/88	(1)
SSM 946948	88-22	332'	Apr/88	(1)
	88-23	302'	Apr/88	(1)
	88-16	142'	Apr/88	(1)
	88-17	396'	Apr/88	(1)

22

4694.5'

NOTES: (1) #W8805.109, filed in Dec/88

ONEIDA RESOURCES INC.

Location Grid "F" L 8E, 2 + 98S - 8 + 35E
 Test Peek-A-Boo Quartz (VG) vein.

Property **Maple Lake**

Sheet No. 1 of 1 Hole No. O-88-1

Project No. **N.T.S.**

Core Size:

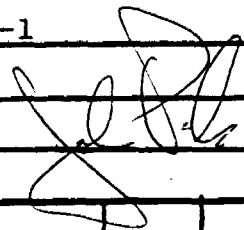

Elev. **-45°** Collared **07 April '88**
 Depth **100 ft.** Bearing **348°** Completed **08 April '88**

Logged by: **Herb Wahl**

ASSAYS

Stage	Rec'y	Rock Type/Alteration	Graphic Log	Mineralization/Structure	% Sulfides	Sample No.	Lt.											
0-10		Casing				04020	10 12	2										
10-18'3"	50%	Silicified Quartz vein zone: oxidized, broken & missing core. From 14'				04021	12 14	2										
		18'3" approx. 50% Rec. minor dism. Py & CPy				04022	14 18	3 4' 3"										
18'3"-25'6"		Mafic Vlc Highly silic. sericitic, minor Py at 45'-46' semi quartz vein zone better Py-Cpy				04023	25 26	1										
25'6"-32'		As above, silicified and quartz vein zones at 52'-53' 1/2" quartz Py 61-63' 1/2" quartz vein parallel to core axis				04024	52 53	1										
		64'6"-65' 6" quartz vein Py 69'-71' 2' quartz vein, clots chlrt & blebs Py Po Cpy & Pbs??				04025	61 63	2										
		82'-85'6" silic. zone, Py angle 35° 85'6"-87.0' 6" quartz vein clots chlrt, blebs Po Cpy				04026	64'6" 65'6"	0'6"										
		82'-85'6" silic. zone, Py angle 35° 85'6"-87.0' 6" quartz vein clots chlrt, blebs Po Cpy				04027	69 71	2'										
		64'6"-65' 6" quartz vein Py 69'-71' 2' quartz vein, clots chlrt & blebs Py Po Cpy & Pbs??				04028	82 85.6	3'6"										
		82'-85'6" silic. zone, Py angle 35° 85'6"-87.0' 6" quartz vein clots chlrt, blebs Po Cpy				04029	85'6" 87	1.5'										
		82'-85'6" silic. zone, Py angle 35° 85'6"-87.0' 6" quartz vein clots chlrt, blebs Po Cpy				04030	92 95	3.0'										
		82'-85'6" silic. zone, Py angle 35° 85'6"-87.0' 6" quartz vein clots chlrt, blebs Po Cpy				04031	95 99.6	4'6"										
92-100		Contact angle 40° Intermediate vlc: Pale grey silic. higher sericite and carb on fractures last 6" is quartz vein with tr. Py Cpy				04032	99'6" 100	0'6"										
		quartz vein with tr. Py Cpy																
		END OF HOLE																
		Note: Hole drilled on N. edge of zone just caught quartz vein																

ONTARIO GEOLOGICAL SURVEY
 ASSESSMENT FILES
 OFFICE
 JUL 26 1988
 RECEIVED

ONEIDA RESOURCES, INC.

Location Grid "F", L8E, 2+98S - 8+35E
 East Down Dip of Peek-A-Boo Vein

Property: Maple Lake

Sheet No. 1 of 1 Hole No. O-88-2

Project No. N.T.S.

Core Size:

Elev. Dip -75° Collared 08 April '88 Logged by: Herb Wahl

Depth 106 ft. Bearing 348° Completed 08 April '88 ASSAYS

Depth	Rec'y	Rock Type/Alteration	Graphic Log	Mineralization/Structure	% Sulfides	Sample No.	Lt.										
1'-2'		Casing															
1'-37'		Mafic Vlc Fine-medium gr., chloritic, variably foliated quartz veins (white w/pink carb, minor Py-Cpy)				04001	19										
		19'9, 2" vein angle 45°				04002	20	1									
		25', 2" vein angle 45°				04003	24	1									
		35', 1/2" vein angle 40°				04004	25	1									
		38'3" - 40'0" quartz - pink carb. section				04005	34	1									
						04006	38	2									
						04007	40	2									
						04008	54	2									
						04009	56	2									
						04010	80	5									
37'-41'		Rhyolite, Very fine gr. siliceous, No. Py				04007	95.5	2.5									
41'-46'		Intermediate volc., strongly foliated (sub shearing from 86' on foliation trends nearly parallel to core axis becoming more micro banded in appearance, with occ. drag folded kink angle 47'-40° angle 76'-20° angle 56'-20° angle 78'-15° at 54'-56' more siliceous, sericitic zone at 90'-95' includes 2"-3" barren white quartz vein sample mainly check splits				04008	97.5	2.5									
						04009	100	2.5									
						04010	102.5	2.5									
							102.5	3.5									
106'		barren white quartz vein sample mainly check splits					106										
		END OF HOLE															

ONTARIO GEOLOGICAL SURVEY
 ASSESSMENT FILES
 OFFICE
 JUL 25 1988
 RECEIVED

ONEIDA RESOURCES INC.
 Location 8 + 415 - 2 + 30S
 East below Peek-A-Boo Trench #1

Property Maple Lake

Sheet No. 1 of 1 Hole No. 0-88-3

Project No. N.T.S.

Core Size:

Elev. _____

Dip -45°

Collared April 9, 1988

Logged by: Herb Wahl

Depth 162 ft.

Bearing 225°

Completed April 10, 1988

ASSAYS

Stage	Rec'y	Rock Type/Alteration	Graphic Log	Mineralization/Structure	% Sulfides	Sample No.	Lt.										
J-3'	6"	Casing															
6"		Mafic Vlc, very highly silicified, 1-10% Py, numerous quartz injections 1/2" 1' thick w/carb. and dism. Py, Tr. Zns. at 43'-44' more distinctive quartz vein with carbonate and blebs Py angle fol. at 62', 45°															
0'-	2'6"	More bleached in appearance, increasing sericite, approx. 1% Py at 65'-96' Intermittant, narrow (1/4") widely spaced pink carb. veins.															
2'6-	62	As above, somewhat more bleached, highly silicified scattered narrow (to 1/4") quartz veins parallel to and X-cutting fol. < 1% Py angle at 100'-50° angle at 122'-50° at 129'-131' pink carb. zone below 100', rock is very 'dry', very hard and fine grained, massive w/nil. sulf.															
62		END OF HOLE															

ONTARIO GEOLOGICAL SURVEY
 ASSESSMENT FILES
 OFFICE
 JUL 26 1988
 RECEIVED

ocation: Oneida in-between cls, Peek-A-Boo showing

ONEIDA RESOURCES INC.

E: showing bl. Az 135°

est under new visible gold showing

Maple Lake

Property

Sheet No. 1 of 1 Hole No. O-88-4

Project No.

N.T.S.

Core Size:

0 + 51 SE

Elev..

Dip

-41°

Collared

April 10, '88

Logged by:

Herb Wahl

0 + 42 SW

Depth

128 ft.

Bearing

45°

Completed

April 11, '88

ASSAYS

Stage	Rec'y	Rock Type/Alteration	Graphic Log	Mineralization/Structure	% Sulfides	Sample No.	Lt.											
-3'		Casing					10											
08'		Silicifite: Very hard, intensely silicified Rx, semi-bleached, quartz pale green chlorite variable areas of low sericite random quartz stringers <2% Py overall as scattered narrow stringers and disms. core fairly massive and fine grained core <'s at 7'-10°, at 25'-30°, at 53'-30°, at 58'-25° at 60'-30°, at 87'-30°, These are angles of fol. which is alternating layers of pale green mica and quartz				04073	12.5	2.5										
						04074	20	2.5										
						04075	22.5	2.5										
						04076	25	2.5										
						04077	27.5	2.5										
						04078	37.5	2.5										
						04079	45	2.5										
						04080	47.5	2.5										
						04081	55	2.5										
						04082	57.5	2.5										
						04083	65	2.5										
						04084	67.5	2.5										
						04085	75	2.5										
						04086	85	2.5										
						04087	87.5	2.5										
						04088	89.5	2.5										
						04089	95	2.5										
108'		More intense bleached and silicified zone lower contact angle 45°				04083	105	2.5										
120'						04084	107.5	2.5										
						04085	108	2.0										
						04086	110	2.0										
120'		More chloritic section				04085	110	2.0										
128'						04086	112	2.0										
						04086	112	2.0										
						04087	114	2.0										
		END OF HOLE				04087	114	2.0										
						04088	116	2.0										
						04088	116	2.0										
						04088	118	2.0										
						04089	118	2.0										
						04089	120	2.0										

ONTARIO GEOLOGICAL SURVEY
ASSESSMENT FILES
OFFICE
JUL 26 1988
RECEIVED

RE: showing Baseline AZ 135°
ONEIDA RESOURCES INC.

Location Oneida In-Between Cls. Peek-A-Boo showing
 deeper Test new v.g. showing drilled from
 same setup as O-88-4

Property **Maple Lake**

Sheet No. 1 of 1 Hole No. O-88-5

Elev. 0 + 51 SE
 0 + 42 SW

Depth 201

Dip 045°
 Bearing -70°

Project No. N.T.S.
 Collared 11 April '88
 Completed 12 April '88

Core Size:
 Logged by: Herb Wahl

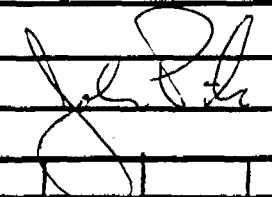

ASSAYS

Stage	Rec'y	Rock Type/Alteration	Graphic Log	Mineralization/Structure	% Sulfides	Sample No.	Lt.										
1-5		Casing				04090	10	2.5									
1-10						04091	20	2.5									
01'		Silicifite: Same as O-88-4				04092	30	2.5									
		at 78.5', 4" quartz vein.				04093	40	2.5									
		barren, glassy, no sulf.				04094	50	2.5									
		contains clots of coarse chlorite w/diss. Py to 2-3%				04095	60	2.5									
						04096	70	2.5									
						04097	75	2.5									
						04098	78.5	0.25									
						04099	spot	2.5									
		at 88.5-94' 4 1/4" quartz vein parallel to core axis				04100	88.5	2.5									
		at 133'-152'6" section w/ quartz veins 1/8" - 2"				04101	90	2.0									
						04102	94.4	1.33									
						04103	96.6	2.17									
		having incipient comb structure. Some pink carb.				04104	105	2.50									
						04105	115	2.50									
						04106	125	2.50									
		at 146', better vein (again subparallel to core axis)				04107	133	2.0									
		with Py in streaks parallel to wall rock				04108	143	1.0									
						04109	145	2.0									
						04110	147	2.0									
01		END OF HOLE				04111	150	2.5									
						04112	162.5	2.5									
						04113	175	2.5									
						04114	185	2.5									
						04115	195	2.5									
						04116	200	1.0									
							201										

ONTARIO GEOLOGICAL SURVEY
 ASSESSMENT FILES
 OFFICE
 JUL 26 1988
 RECEIVED

ONEIDA RESOURCES INC.

1st under Peek-A-Boo Vein
Location 1 + 00SE, 0 + 40SW (RE Showing BL)

Property Maple Lake

Sheet No. 1 of 1 Hole No. O-88-6

Project No. N.T.S.
Collared April 13, 1988

Core Size:
Logged by: Herb Wahl

Elev.:
Depth 101.5 ft.
Dip -41°
Bearing 045°
Completed April 14, 1988

ASSAYS

Depth	Rec'y	Rock Type/Alteration	Graphic Log	Mineralization/Structure	% Sulfides	Sample No.	Lt.								
0-7'		Casing				4117	7								
7-10'		Silicifite: see below (75% Rec, broken surface Rx)				4118	10 5	3.0							
10-16'		Quartz vein, parallel to core axis, est. 1"-3" thick very low Py chloritic flecks				4119	12 0	2.5							
16-21.5'		Silicifite: very fine grain hard, quartz chlrt. rock, odd 1/8"-1/4" pink carb. vein				4120	15 3.0								
		at 43-45 stringer veins 1/16"-1/4" angle 15° (pink carb.)				4121	16 1.0								
		at 44.5, 1/2" quartz vein, blebs Py				4122	17 1.0								
		at 58-60, 1" quartz vein angle 15°, barren				4123	20 2.5	2.5							
		at 74.5-77 More sheared, pale green chloritic section quartz stringers, pink carb. low Py.				4124	22 5	2.5							
		summary: (7'-101.5')				4125	30 2.5								
		silicified zone, scattered variable quartz injections, low to Nil sulphide content high but variable pale green chlorite content same rock type as O-88-4 & 5				4126	32 5	2.5							
101.5'		END OF HOLE				4127	40 2.5								
						4128	42 5	2.5							
						4129	43 2								
						4130	45 2								
						4131	45 2								
						4132	47 2								
						4133	58 2								
						4134	60 2								
						4135	74 5	2.5							
						4136	77 5	2.5							
						4137	82 5	2.5							
						4138	82 5	2.5							
						4139	85 2.5								
						4140	85 2.5								
						4141	87 5	2.5							
						4142	87 5	2.5							
						4143	90 2.5								
						4144	90 2.5								
						4145	92 5	2.5							
						4146	92 5	2.5							
						4147	92 5	2.5							
						4148	92 5	2.5							
						4149	95 2.5								
						4150	95 2.5								
						4151	97 5	2.5							

ONTARIO GEOLOGICAL SURVEY
ASSESSMENT FILES
OFFICE
JUL 26 1988
RECEIVED

Location: 4 + 10NW - 0 + 100NE, RE: showing B.L. Project No.

N.T.S.

Core Size:

Lat.

Elev..

Dip

-41°

Collared

April 15, 1988

Logged by:

Herb Wahl

Herb Wahl

Dep.

Depth

247 ft.

Bearing

225°

Completed

April 16, 1988

ASSAYS

Footage	Rec'y	Rock Type/Alteration	Graphic Log	Mineralization/Structure	% Sulfides	Sample No.	Lt.											
0-9		Casing				4139	12-14	2.0										
9-12		Broken core, similar to 13-20				4140	20-22	2.0										
12-13		Granitic dike/apophysis: chlrt/flsp. hybrid				4141	23-25	2.0										
						4142	28-31	3.0										
						4143	33-37	4.0										
13-59		Silicifite: (fin. gr. quartz chlrt. Rx) very low to Nil Py. Silica varies from mod. to very strong over sections of 2-5 ft. scattered narrow quartz veins to 1" at 20-22 granitic section, gradational contacts at 31', 4" do				4144	38-40.5	2.5										
						4145	42-45.5	3.5										
						4146	52-54	2.0										
						4147	54-56	2.0										
						4148	56-58	2.0										
						4149	59-63	4.0										
						4150	63-65	2.0										
						4151	65-67	2.0										
						4152	67-69	2.0										
						4153	69-72	3.0										
59-82		at 65', angle vague Si banding is 50° Extremely hard and very fine grain section				4154	72-74	2.0										
						4155	74-76	2.0										
						4156	76-78	2.0										
						4157	78-80	2.0										
82-88		As 13-59				4158	80-82	2.0										
88-141		Rhyolite? Hybrid silicifite? color change on dry surface banded, with shades of pale				4159	88-92	4.0										
						4160	102-104	2.0										
						4161	109-112	3.0										
						4162	128-131	2.0										
		green, pink and mauve. Occ. highly silicified zones, mottled w/na. flsps, blotchy to crystalline. Scattered odd pink carb. veins 1/8"				4163	164-167	3.0										
						4164	178-181	3.0										
						4165	206-208	1.5										
						4166	215-217.5	2.5										
		1/4" at 123-124 blotchy flsp. por. band angle 60° 50 B conformable				4167	217-221	3.5										
						4168	225-227.5	2.5										
						4169	227-230	2.5										
141-206.5		Silicified mafic: Odd scattered dism/strngr. Py Cpy at 179-180 1 ft. quartz vein chloritic, barren				4170	230-231	1.0										
						4171	240-241.5	1.0										

ONTARIO GEOLOGICAL SURVEY
ASSESSMENT FILES
OFFICE
JUL 26 1988
RECEIVED

ONEIDA RESOURCES, INC.

Test Peek-A-Boo silicified zone

location 2 + 00NW - 1 + 00NE RE: showing BL

Property: Maple Lake

Sheet No. 1 of 1 Hole No. O-88-8

Project No. N.T.S.

Core Size:

Lat.

Elev..

Dip

-45°

Collared

April 16, 1988

Logged by:

Herb Wahl

Dep.

Depth

147 ft.

Bearing

225°

Completed

April 17, 1988

ASSAYS

Footage	Rec'y	Rock Type/Alteration	Graphic Log	Mineralization/Structure	% Sulfides	Sample No.	Lt.	From	To									
0-10		Casing				4201	2.5	29.5	32.0									
10-27		Broken and rocky surface rock-poor recovery basically same as 27-74				4202	0.5	55	splot									
						4203	3.0	77	80									
						4204	2.5	80	82.5									
						4205	2.5	82.5	85									
27-74		<u>Silicified Mafic Volcanic:</u> fine grain, quartz chlrt. rx scattered narrow pink carb. vns at 29.5-32 contorted				4206	2.5	85	87.5									
						4207	2.5	87.5	90									
						4208	2.5	90	92.5									
						4209	1.5	92.5	94									
74-85		chloritic shear w/quartz injections More chloritic zone (pale green variety)				4210	2.5	97.5	100									
						4211	2.5	100	102.5									
						4212	2.5	102.5	105									
						4213	2.5	105	107.5									
85-97	5	at 77-85 contorted zone, narrow quartz injections diss. strngr. Py <u>Silicified Mafic Volcanic:</u>				4214	1.5	107.5	109									
						4215	2.0	113	115									
						4216	2.0	115	117									
						4217	2.0	117	119									
		quartz veins 2"-3" w/Py in dissem. and stringer form at 90.5-94.0 quartz vein white, glassy, chloritic, No Py Barren looking				4218	2.0	119	122									
						4219	2.0	122	124									
						4220	2.0	124	126									
						4221	2.0	126	128									
97.5-109		<u>Silicifite:</u> stronger silicification, scattered quartz injections w/minor Py				4222	3.0	128	131									
109-113		<u>Silicified Mafic vlc.:</u> solfter				4223	2.0	140	142									
113-131		<u>Silicifite:</u> scattered qtz injections, minor diss and strngr Py																
131-133		<u>Silicified mafic vlc</u>																
133-147		<u>Rhyolite:</u> v.f.g. qtz-scact. Rx pale whitish grey on dry surface angle at 145' (55°)																

ONTARIO GEOLOGICAL SURVEY
ASSESSMENT FILES
OFFICE
JUL 26 1988
RECEIVED

ONEIDA RESOURCES INC.

Undercut 50' silicified zone in 88-3
 Location 0+08 NW - 1+62NE RE: SHOWING BL.

Property **Maple Lake**

Sheet No. 1 of 1 Hole No. 0-88-9

Project No. **N.T.S.**

Core Size:

Herb Wahl

Lat.	Elev..	Dip	-45°	Collared	April 17, '88	Logged by:	Herb Wahl
Dep.	Depth	Bearing	225°	Completed	April 18, '88	ASSAYS	

Footage	Rec'y	Rock Type/Alteration	Graphic Log	Mineralization/Structure	% Sulfides	Sample No.	Lt.	From	To								
0-11		Casing				04224	1.0	121	122								
11-12		Granitic Dike				04225	2.0	122	124								
12-38		Rhyolite: quartz scrct Rx, v. f. g.				04226	2.0	124	126								
						04227	2.0	126	128								
						04228	2.0	128	130								
38-47.5		Mafic Volcanic: chlorite clots give porphyritic appearance vs lighter background				04229	2.0	130	132								
						04230	1.0	132	133								
						04231	2.0	146	148								
						04232	2.0	148	150								
47.5-121		Mafic Volcanic: chloritic schist, scattered random quartz stringers, minor Py				04233	3.0	154	157								
						04234	1.5	158.5	160								
						04235	2.0	160	162								
121-133		Silicification zone: banded quartz-scrct Rx, angle 60° v. f. g. includes intensely silicified zones of mottled mauve, pink, green and gray showing brecciated test and recementing by later quartz variable Py (CPy) to 10%				04236	2.0	162	164								
						04237	2.0	164	166								
						04238	2.0	166	168								
						04239	2.0	168	170								
133-						04240	2.0	170	172								
						04241	2.0	172	174								
						04242	2.0	174	176								
						04243	2.0	176	178								
146		Silicified mafic (silicite) quartz chlrt Rx				04244	2.0	178	180								
						04245	2.0	180	182								
146-150		Sub-quartz vein: intense si micro-faults w/offset re-healed by si, 10% Py minor CPy at 147.5 speck v.g.				04246	2.0	182	184								
						04247	3.0	184	187								
150-158.5		Silicified mafic (silicite) quartz-chlrt Rx															
158.5-161		As 121-133															
161-187		As 121-133 but very hard angle banding at 174 = 45° angle layering at 181 + 60°															

ONTARIO GEOLOGICAL SURVEY
 ASSESSMENT FILES
 OFFICE
 JUL 26 1988
 RECEIVED

END OF HOLE BOTTOMED IN SILICA ALTERATION ZONE

Location 0+48 SE - 0+47 NE

ONEIDA RESOURCES INC.

Property Maple Lake

Sheet No. 1 of 1 U-88-10

Check Depth Extent of Peek-A-Boo Vein
 RE: Showing B.L.

Project No. N.T.S.

Core Size:

[Handwritten Signature]

at. Elev. Dip -41° Collared April 20, 1988

Logged by: Herb Wahl

Dep. Depth 42 ft. Bearing 210° Completed April 20, 1988

ASSAYS

Footage	Rec'y	Rock Type/Alteration	Graphic Log	Mineralization/Structure	% Sulfides	Sample No.	Lt.											
0-7		Casing				4172	7	1.67										
7-8'8"		<u>Silica Rock</u> , 2-3% Py, vuggy				4173	27 28	1.0										
8'8" 27 27- 29		<u>Silicified Mafic Volcanic</u>				4174	28 29	1.0										
		Peek-A-Boo Vein Zone: 1 ft. quartz vein w/py bordered by sub-quartz silicified Rx streaks and disms. of Py, traces CPy whole core for assay																
29-42		<u>Silicified Mafic Volcanic</u> END OF HOLE																

ONTARIO GEOLOGICAL SURVEY
 ASSESSMENT FILES
 OFFICE
 JUL 26 1988
 RECEIVED

ONEIDA RESOURCES INC.

Location 0+48 SE - 0+47 NE RE SHOWING BL.
 Check Depth extent Peek-A-Boo Vein

Property Maple Lake

Sheet No. 1 of 1 Hole No. 0-88-11

Project No. N.T.S.

Core Size:

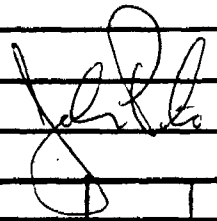

Lat.

Elev.

Dip -70°

Collared April 20, '88

Logged by: Herb Wahl

Dep.

Depth 52 ft.

Bearing 210°

Completed April 20, '88

ASSAYS

Footage	Rec'y	Rock Type/Alteration	Graphic Log	Mineralization/Structure	% Sulfides	Sample No.	Lt.											
0-5		Casing				4175	5 8	3.0										
5-8		Banded Silica Rock (1-2% Py) similar to section in 88-9 angle banding 30°				4176	8 10	2.0										
8-12.5		Quartz-scrct Rx, v.f.g., finely laminated scattered dism. Py (1%) angle contact at 12.5=30°				4177	13 34.5	3.0										
						4178	35 35	0.5										
12.5-33		Silicified Mafic Volcanic			qv vg	4179	36.75 36.75	1.75										
33-34.5		As 8-12.5, not as intensely silicified				4180	37.5	0.75										
34.5-35		Hanging wall of qv, more silicified																
35-36'9"		Peek-A-Boo Qv. Py speck v.g. at lowe end																
36'9"-37'6"		Banded si rx, angle banding = 50°																
37'6"-41		Silicified mafic finely foliated angle 50°																
41-		Lighter colored unit																
42.5-		(andesitic tuff?) blotchy sub-porphyrific texture																
42.5-52		Mafic volcanic, mildly silicified																
		END OF HOLE																

ONTARIO GEOLOGICAL SURVEY
 ASSESSMENT FILES
 OFFICE
 JUL 26 1988
 RECEIVED

Objective: Test Strong Si zone under 88-9
ONEIDA RESOURCES INC.
 Location: 04 10SE, 2+90NE, Re: Showing BL

Property **Oneida S.S.M.**
 Project No. **N.T.S.**
 Collared **21/04/88**
 Completed **23/04/88**

Sheet No. 1 of 2 Hole No. 088-12
 Core Size:
 Logged by: **H. Wahl**

[Handwritten signature]

Lat. _____ Elev. _____
 Dip **-41°**
 Depth **352 Ft.**

Bearing **225°**
 Bore Size: _____

ASSAYS

Footage	Rec'y	Rock Type/Alteration	Graphic Log	Mineralization/Structure	% Sulfides	Sample No.	Lt.											
0-7		Casing				04181	21.5	0.5										
7 - 21.5		Silicified Mafic, Variable Zones Granitic Injection				04182	22	2.0										
21.5-28		Salt and Pepper RX (Quartz-Pale Green Chlrt) 25% dism. Po. Minor Cpy				04183	24	4.0										
28 -		Silicifite				04184	80	2.5										
122		At 52-60 Aphanitic Banding is layers of Quartz, Pale green Mica and variable sericite angle bands 70-80°				04185	96	2.0										
		At 80-82.5 more bleached				04186	98	2.0										
		At 96-100 banded Si Rx similar to 88-9					100											
		At 101.25-107 more bleached				04187	101	25	1.75									
		At 115-117 --- do --- incl.				04188	103	2.0										
122-208		6" Quartz vein at 116.5				04189	105	2.0										
208-		Silicified Mafic				04190	107	5	0.5									
215		Banded Silicifite angle 45°					115	5	0.5									
215-228		Silicified Mafic				04191	116	5	0.5									
228-234		Silicified Mafic				04192	117	1.5										
228-234		Banded Silicifite					118	5										
234-237.67		Silicified Mafic				04193	130	5	1.5									
						04197	205	0.5										
						04194	208	2.0										
						04195	210	2.0										
							212											

ONTARIO GEOLOGICAL SURVEY
 ASSESSMENT FILES
 OFFICE
 JUL 26 1988
 RECEIVED

ONEIDA RESOURCES INC.
 Test shear zone at trench #6
 Location 5+82 SE, 0+65 NE (RE SHOWING BL)

Property: Maple Lake

Sheet No. 1 of 1 Hole No. 0-88-13

Project No. N.T.S.

Core Size:
 Logged by: Herb Wahl

Lat. Elev. Dip -41° Collared April 23, 1988
 Dep. Depth 152 Bearing 225° Completed April 24, 1988

ASSAYS

Handwritten initials: J.P.L.

Footage	Rec'y	Rock Type/Alteration	Graphic Log	Mineralization/Structure	% Sulfides	Sample No.	Lt.											
0-6.5		Casing				4255	75.5	1.5										
6.5-75.5		Silicified Mafic Volcanic (Moderate si)				4256	77	2.0										
75.5-79		scattered qv's to 1", low Py at 12' angle fol. 45°-50° Silic. mafic vlc, biotite bands, incr. Py 2-3%				4257	79	1.0										
79-83.5		Shear Zone Biotite/chlorite 20% Py as stringers to 1/4"				4258	80	2.0										
83.5-152		Mafic volcanic, narrow banded, chloritic scattered qtz injections, variable Hi Si zones at 128', 4" pink (k spar?) qtz carb. vein with garnets				4259	82	1.5										
		at 146-147 intense k spar + Si				4260	83.5	2.0										
		END OF HOLE				4261	109	0.25										
						4262	111	0.25										
						4263	126	1.0										
							128											
							146											
							147											

ONTARIO GEOLOGICAL SURVEY
 ASSESSMENT FILES
 OFFICE
 JUL 26 1988
 RECEIVED

ONEIDA RESOURCES INC.
 Location: 5+82 SE 0+65 NE

Property: Maple Lake

Sheet No. 1 of 3 Hole No. 0-88-14 *John H. H.*

Project No. N.T.S.

Core Size:

Lat. Elev. Dip -65° Collared April 24, '88

Logged by: George Giga

Dep. Depth 251' Bearing 225° Completed April 25, '88

ASSAYS

Footage	Rec'y	Rock Type/Alteration	Graphic Log	Mineralization/Structure	% Sulfides	Sample No.	Lt.											
0-2 2-42.5		Casing and overburden Intermed. volc. grey, f gr., massive, silicified, sheared, chl. ser, garnet bearing, with minor Py																
42.5- 44.5		Highly altered and sheared zone, garnt, chl., biot bearing				4301	42.5 44.5	2										
44.5- 187		Silicified mafic volc. green, f gr., silicified, sheared, carb, chl. ser																
61.5- 65.5		bearing, with minor Py seen as irreg. stringers. Lower contact is 60° to CA Banded silicified mafic volc. similar to 44-187; in addition dissem. biot present seen as bands																
89.5- 94 94-		Banded silicified mafic volc. similar to 61.5to65.5																
95.5		Highly altered and sheared zone, chl., carb. bearing minor Py				4302	94 95.5	1.5										
95.5- 96.5		1' gv, massive, white, chl. carb. bearing with minor Py < 1%, 45° to CA				4303	95.5 96.5	1										

ONTARIO GEOLOGICAL SURVEY
 ASSESSMENT FILES
 OFFICE
 JUL 26 1988
 RECEIVED

Lat. Elev. Dip -70° Collared April 25, '88

Logged by: George Giga *John P. Giga*

Dep. Depth 142' Bearing 245° Completed April 26, '88

ASSAYS

Footage	Rec'y	Rock Type/Alteration	Graphic Log	Mineralization/Structure	% Sulfides	Sample No.	Lt.											
0-2		Casing				4313	37	2										
2-33.7		Silicified mafic volc. gm, massive, f. gr., partially sheared, chl. bearing with minor Py <1% Infreg. irreg. quartz stringers present Lower contact 40° to CA				4314	47 49	2										
						4315	57 59	2										
						4316	66.4 67.7 67.7	1.3										
33.7-66.5		Banded silicified rhyolite grey, massive, f gr., sheared chl, biot, garnet bearing, siliceous with a series of banded biot found throughout section. Lower contact 60° to CA				4317	70.8 76	3.1										
						4318	78 86	2										
						4319	88	2										
						4320	92.5 93.5	1										
66.5-67.7		Highly sheared and altered zone, chl. biot, garnet bearing seen as stringers, lower contact 45° to CA				4321	98.5 100.5	2										
						4322	112 114	2										
67.7-142		Series of banded rhyolite and silicified mafic volc. units				4323	122 124	2										
		END OF HOLE																

ONTARIO GEOLOGICAL SURVEY
ASSESSMENT FILE
OFFICE
JUL 26 1988
RECEIVED

Location 13+40N 21+00E RE: Grid G

Property
Project No. N.T.S.

Core Size:

at. Elev. Dip -41 Collared April 26, '88
 Dep. Depth 396' Bearing 360° Completed April 28, '88

Logged by: George Giga

ASSAYS

Handwritten signature/initials

Depth	Rec'y	Rock Type/Alteration	Graphic Log	Mineralization/Structure	% Sulfides	Sample No.	Lt.											
0-15.2	2	Casing																
15.2-82.2		Mafic Volc: grn, f gr., sheared, chl. mica(mose?) bearing, occasionally appears																
18-82.2		porphyritic with irreg. quartz carb. stringers. Minor Py present <1% broken core																
86.9		Mafic volc. Similar to 15.2-82.2, in addition more sheared, biot and garnet bearing																
84.9-85.9		1' gv white, massive, f gr. chl, carb. bearing seen as stringers with minor Py. <1%																
86.9-115.5		Mafic volc. similar to 15.2-82.2																
115.5-120		Mafic Volc.																
120-286		Similar to 82.2-86.9, In addition contains consider- ably more Py <1 to 20% Mafic Volc. Similar to 15.2-82.2																
286-293.5		Altered zone highly sheared, biot, chl., ser, carb. bearing with minor Py <1%																
293.5-306		Mafic Volc.																
306-372		Similar to 15.2-82.2 Mafic Volc. Similar to 15.2-82.2, but more chloritized, sericitized and carbonaceous. Appears 1 grn																

ONTARIO GEOLOGICAL SURVEY
 ASSESSMENT FILES
 OFFICE
 JUL 26 1993
 RECEIVED

372-396 colored Mafic Volc. Similar to 15.2-82.2, Occas. banded biot present

END OF HOLE

ONEIDA RESOURCES INC.

Property: Maple Lake

Sheet No. 1 of 1 Hole No. 0-88-18

Location 6+00W-15+80N Grid "F"

Project No. N.T.S.

Core Size:

Test "Mag-Offset"

at

Elev..

Dip

-41

Collared

April 29, '88

Logged by:

George Giga

GG

Dep.

Depth

144'

Bearing

225°

Completed

April 30, '88

ASSAYS

Footage	Rec'y	Rock Type/Alteration	Graphic Log	Mineralization/Structure	% Sulfides	Sample No.	Lt.										
0-5		Casing															
5-133.9		Mafic Volc. green, v f gr, massive, silicified, chl., carbonate bearing with minor Py <1% Stringers of quartz carb. frequent the section. Broken core predominate															
133.9- 144		Gabbro grey, fine to med gr, massive equigranular, silicified, chl., ser. bearing magnetic, with minor Py <1% Black and white mottled appearance broken core predominate															
		END OF HOLE															

ONTARIO GEOLOGICAL SURVEY
ASSESSMENT FILES
OFFICE
JUL 26 1988
RECEIVED

ONEIDA RESOURCES INC.
 Location 6+00W-15+80N Grid "F"
 Test 'Mag-Offset'

Property: Maple Lake
 Project No. N.T.S.
 Collared April 30, '88
 Completed May 2, '88

Sheet No. 1 of 1 Hole No. 0-88-19
 Core Size:
 Logged by: George Giga
 ASSAYS

Handwritten signature/initials

Lat. _____ Elev. _____ Dip -55
 Depth 402' Bearing 225°

Footage	Rec'y	Rock Type/Alteration	Graphic Log	Mineralization/Structure	% Sulfides	Sample No.	Lt.											
0-5		Casing																
5-139.5		Mafic volc. green, v fine gr, massive, silicified, chl. bearing with occasional irreg. qtz chl. carb. stringers trenching along foliation plane.																
139.5-394.5		Gabbro grey, fine to med. gr, massive, equigranular, chl. ser bearing, silicified, magnetic, with minor Py <1% Black and white mottled appearance. Lack of stringers or vns., exception highly chloritized and carbonaceous altered zone (320.7-326.2') seen as irreg. stringers																
394.5-402		Mafic Volc. Similar to 5-139.5																
		END OF HOLE																

ONTARIO GEOLOGICAL SURVEY
 ASSESSMENT FILES
 OFFICE
 JUL 26 1988
 RECEIVED

ONEIDA RESOURCES INC.
Location BL 10+42 E

Property: Maple Lake

Sheet No. 1 of 1 Hole No. 0-88-20

Project No. N.T.S.

Core Size:

George Giga

Lat. Elev. Dip -45° Collared May 3, '88

Logged by: George Giga

Dep. Depth 396' Bearing 225° Completed May 6, '88

ASSAYS

Footage	Rec'y	Rock Type/Alteration	Graphic Log	Mineralization/Structure	% Sulfides	Sample No.	Lt.											
0-19		Casing																
19-38		Broken core																
38-53.9		Mafic volc. grn, v. g. gr, massive, sheared, siliceous, chl.																
		biot bearing seen as bending with occasional garnet present sulphides present Py <1%																
53.9-56.9		Granite grey white, med. gr, equi- granular, massive, chl. biot bearing																
56.9-272.5		Mafic volc. with minor intervals of granite similar to 38-53.9 and 53.9-56.9																
189.8-190.1		4" irreg. qv with carb. chl stringers																
194.1-202.9		Porphyritic variety of Mafic volc. but coarser grained (chl. clasts)																
212-215.7		Mafic volc. with clots of garnet																
272.5-284.3		Banded intermed. volc. grey, f. gr, siliceous, biot bearing, massive, foliated																
284.3-396		Mafic volc. Similar to 38-53.9																
		END OF HOLE																

ONTARIO GEOLOGICAL SURVEY
ASSESSMENT FILES
OFFICE
JUL 26 1988
RECEIVED

John F. Giga

Lat. _____ Elev. _____ Dip -45° Collared May 6, 1988

Logged by: George Giga

Dep. _____ Depth 352' Bearing 225° Completed May 8, 1988

ASSAYS

Footage	Rec'y	Rock Type/Alteration	Graphic Log	Mineralization/Structure	% Sulfides	Sample No.	Lt.											
0-10 10-14 24- 352		Casing Broken Core Mafic volc. grey to green, v fine to fine gr, chl, biot bearing, silicified sheared with infreg. quartz chl. stringers found through- out section minor Py present <1%, chl. porphyry found at 24-31.7' and 43.2-47.7'. garnet bearing at 41.8-42.8' 58.8-59.8', 291.8-297.9', and 299.5-301'; feldspar porphyry at 326.7-328.7'																
107.6- 119.5		Silicifite white, grn grey to flesh tone, massive, highly silicified sheared, carbonaceous, biot, chl, garnet bearing with series of narrow bands present, minor Py present <1%																
143.2- 146.7		Silicifite Similar to 107.6-119.5 with 4" massive, white, chl, carb. bearing qv (107.6') with Py found along fracture plane																
178.5- 179.5		Altered zone grn, sheared, highly chloritized zone with two 2" quartz carb. chl. vns present																
198- 199 208- 209 262.5-263.5		4" white, massive, chl, carb, ser bearing qv with Py <1% 1" " " " " " 1 1/2" " " " " "																
352		END OF HOLE																

LAND GEOLOGICAL SURVEY
ASSESSMENT FILES
OFFICE
JUL 26 1988
RECEIVED

Handwritten initials/signature

Lat.	Elev.	Dip	-45°	Collared	May 10, '88
Dep.	Depth	Bearing	225°	Completed	May 11, '88

Logged by: George Giga

ASSAYS

Footage	Rec'y	Rock Type/Alteration	Graphic Log	Mineralization/Structure	% Sulfides	Sample No.	Lt.											
0-5 5-35.6	6	Casing Mafic Volc. grn, f gr, siliceous, carbonaceous, foliated chl. and biot bearing seen as occasional bands. Infreg. irreg. quartz-carb stringers found thru out core. Minor occurrence of Py <1-5%, avg																
35.6- 38.6		< 1%. Foliation range from 60 to 70°, avg. 60° to CA Silicifite Massive, semi bleached, highly silicified, carbonaceous chl, ser. biot bearing with irreg qtz-carb. chl. ser. stringers sulfides present Py <1%																
38.6- 332		Mafic Volc. Similar to 5-35.6																
46.9		2" qv white, massive with minor chl, carb. Py <1%																
114.8		4" qv white, massive with minor chl, carb. Py <1%																
332		END OF HOLE																

ONTARIO GEOLOGICAL SURVEY
ASSESSMENT
OFFICE
JUL 26
RECEIVED

Elev.. Dip 45° Collared May 11, '88

Logged by: George Giga

Depth 302' Bearing 180° Completed May 13, '88

ASSAYS

age	Rec'y	Rock Type/Alteration	Graphic Log	Mineralization/Structure	% Sulfides	Sample No.	Lt.											
-7 -47		Casing Mafic Volc. grn, f.gr, foliated, siliceous carbonaceous chl.																
		and biot bearing. Infreg. irreg. qtz-carb stringers found thru out section. Minor occurrence of Py ranging from <1-10% avg.																
		<1% Foliation 70° to Ca. Also appears 58-109.5', 111.5-119.5', 122-160.7', 161-180.3', 182.9-218',																
7-58		242.8-290', 294-302' Banded Mafic Volc. Similar to 7-47', in																
		addition biot seen as banding. Also appears 109.5-111.5', 119.5-122, 290-294'																
60.7 61		Silicifite massive, semi bleached, highly silicified, carbonaceous ch. ser.																
		bearing with irreg. qtz carb-chl-ser stringers sulfides present Py <1% Also appears 180.3-182.9'																
18- 42.8		Mafic Volc. more sheared and altered porphyritic variety of 7-47' with chl. closts and biot banding Minor occ. of Py <1% Greater abundance																

ONTARIO MINING SURVEY
ASSESSMENT FILES
OFFICE
JUL 26 1988
RECEIVED

Claim # SSM 946948

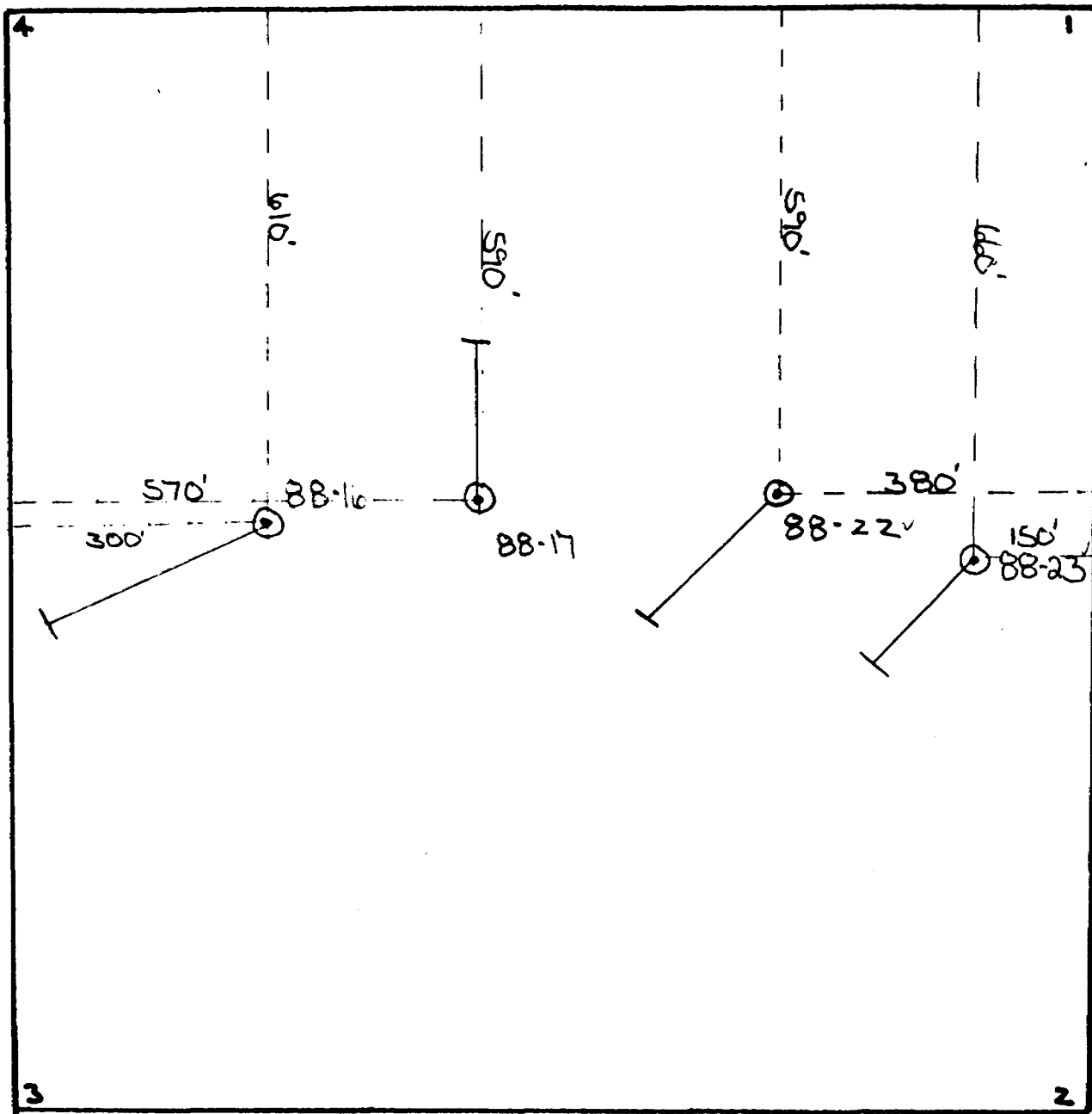

Scale 1"=200'

Claim # 946979

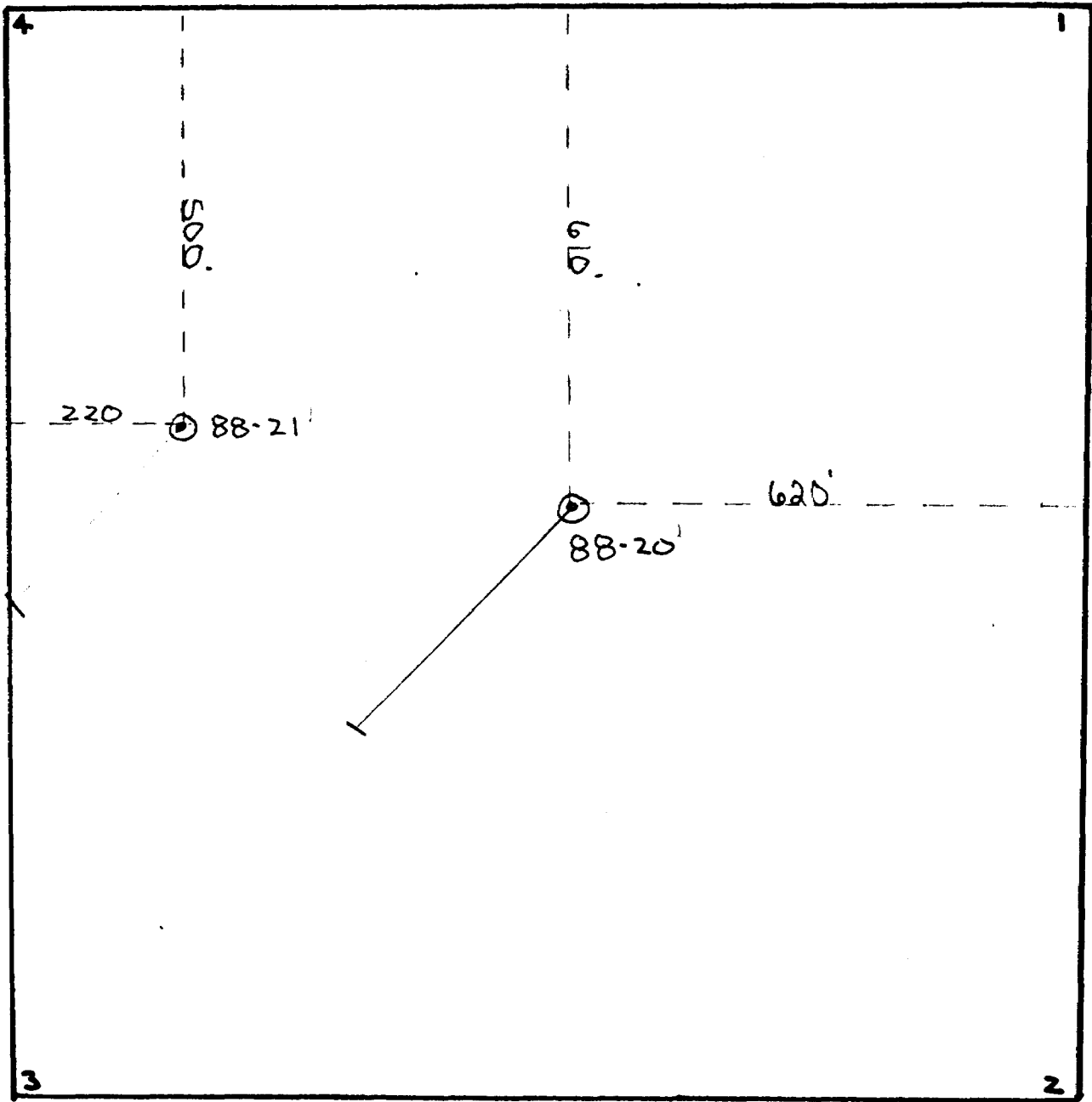

Scale 1"=200'

Claim # SSM 946953

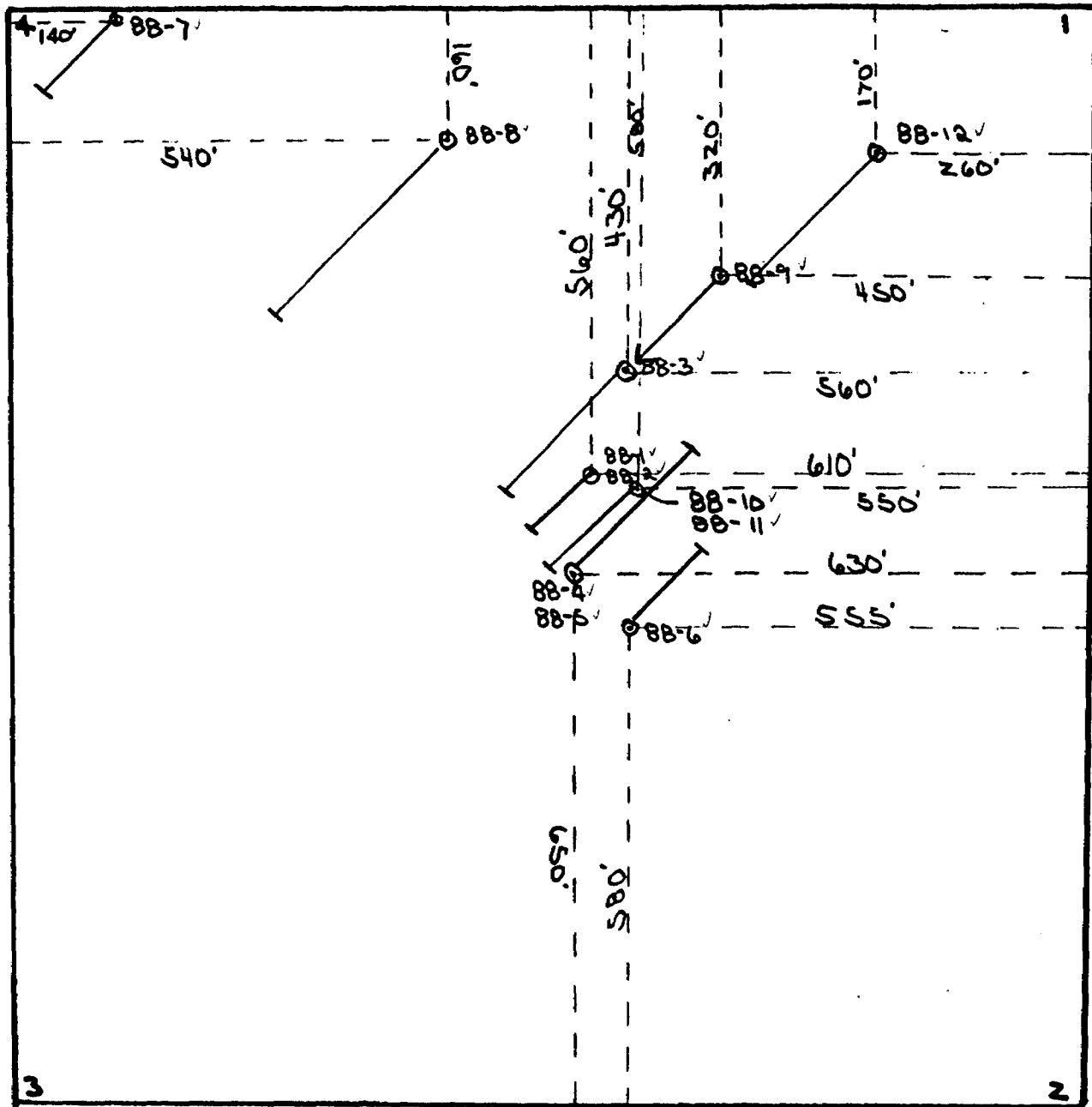

Scale 1"=200'

Claim # 946958

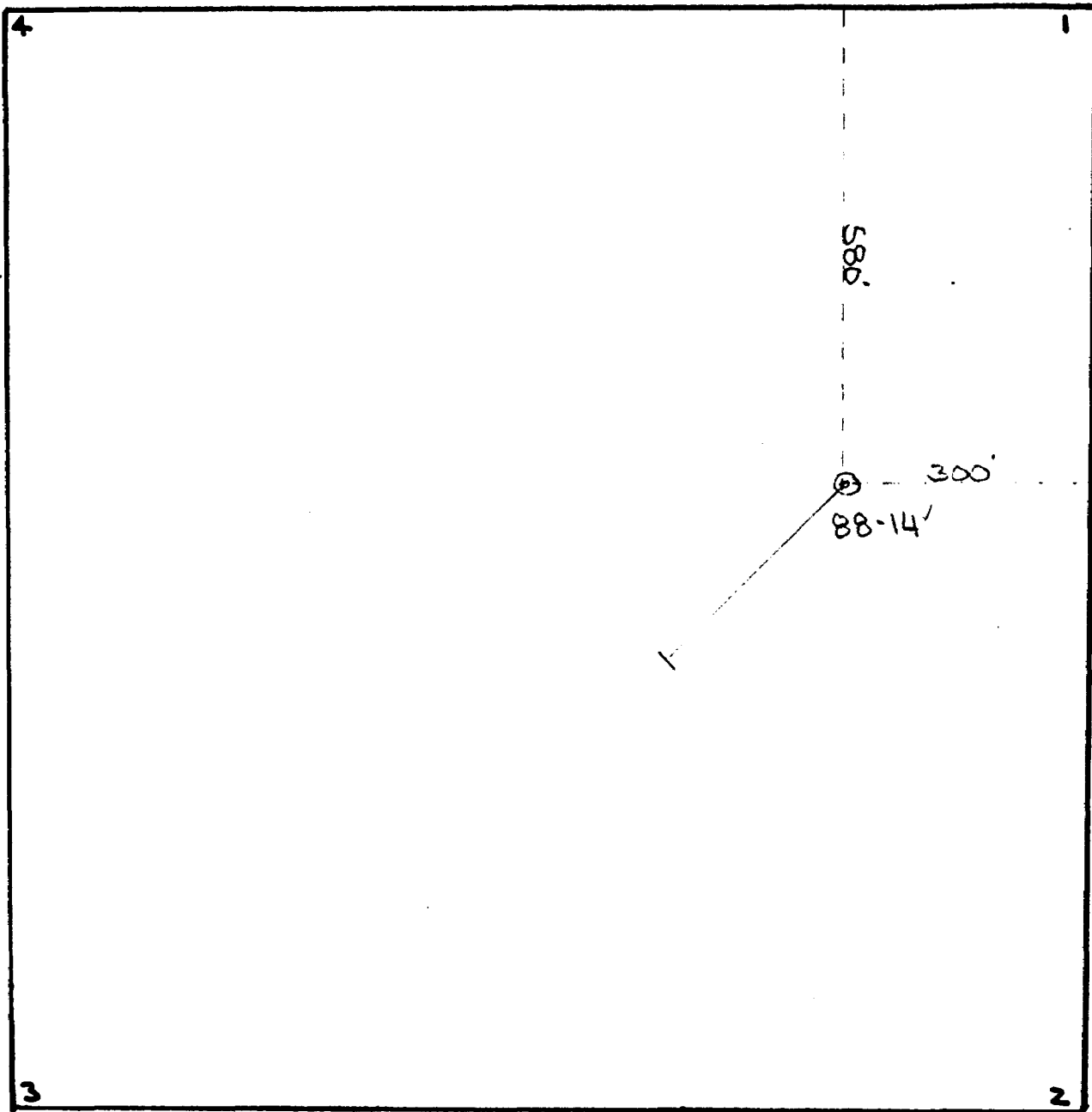

Scale 1"=200'

Claim # 9469.64

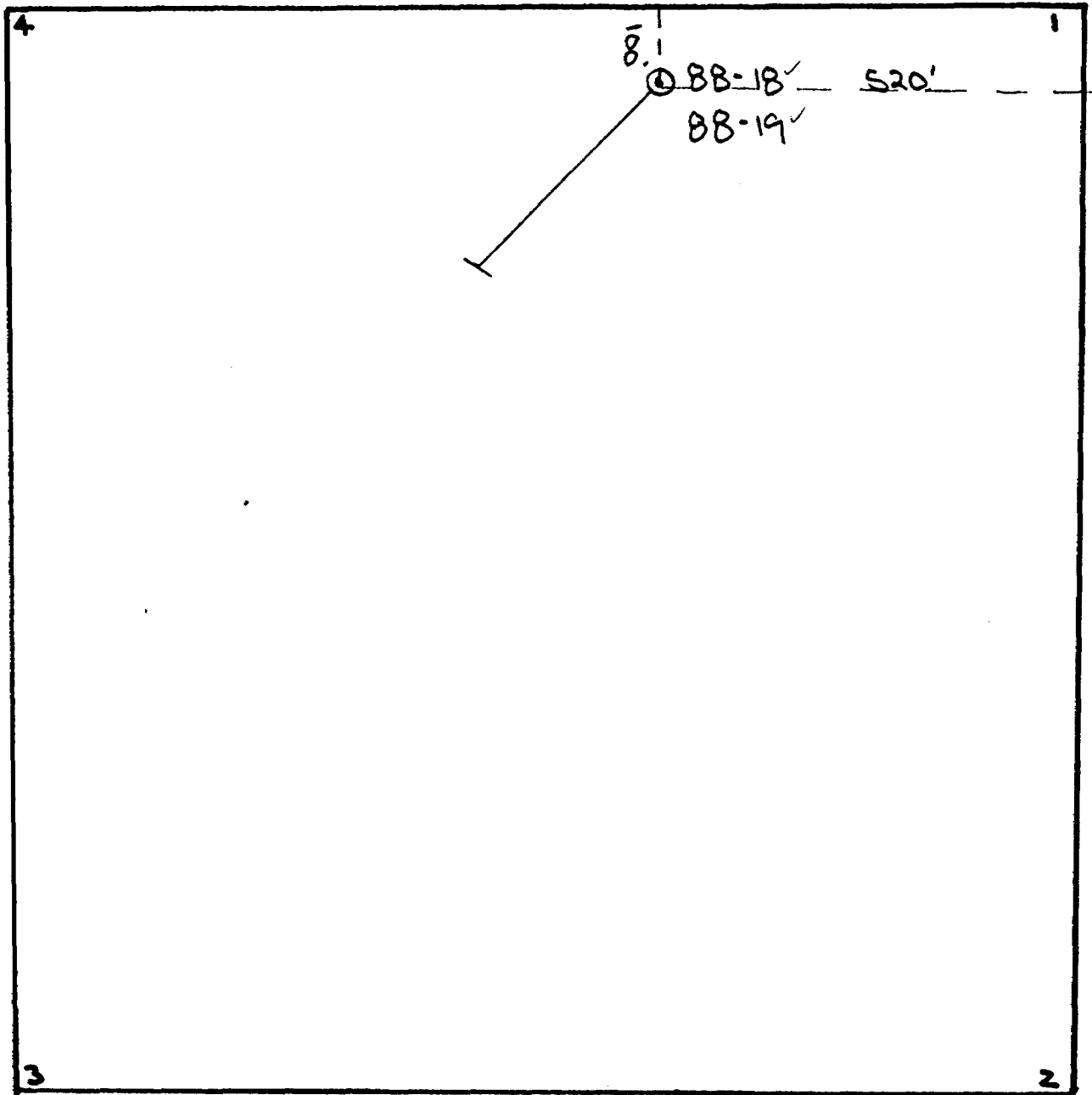

Scale 1"=200'

Claim # SSM 46954

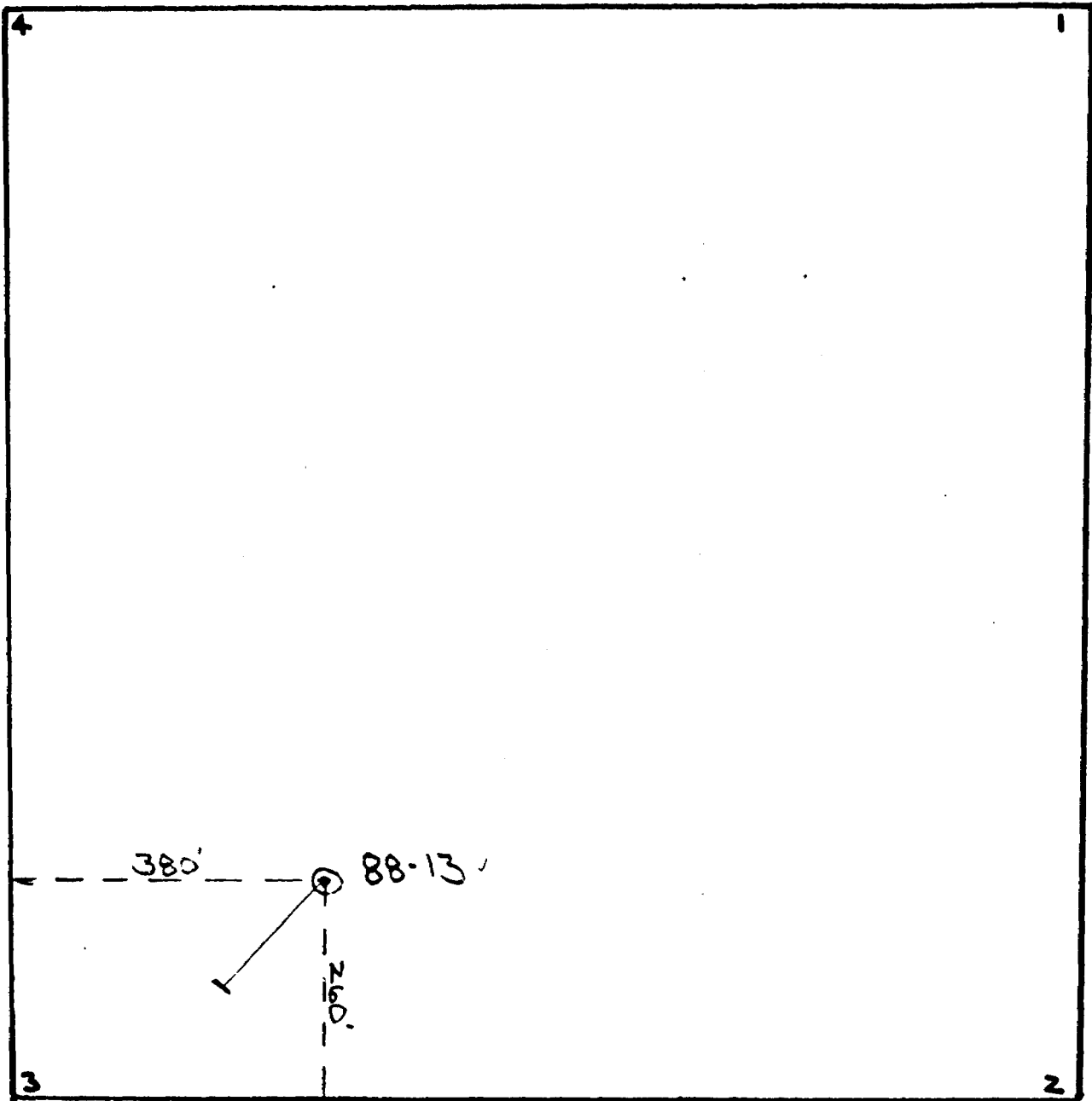

Scale 1"=200'



Name Postal Address of Recorded Holder

ONIEDA (Brass Ring) Resources Ltd. T 5022
188 Perreault Val d'Or Quebec J9P 2H5

Summary of Work Performance and Distribution of Credits

Total Work Days Cr. claimed 4,599	Mining Claim			Mining Claim			Mining Claim		
	Prefix	Number	Work Days Cr.	Prefix	Number	Work Days Cr.	Prefix	Number	Work Days Cr.
for Performance of the following work. (Check one only) <input type="checkbox"/> Manual Work <input type="checkbox"/> Shaft Sinking Drifting or other Lateral Work. <input type="checkbox"/> Compressed Air, other Power driven or mechanical equip. <input type="checkbox"/> Power Stripping <input checked="" type="checkbox"/> Diamond or other Core drilling <input type="checkbox"/> Land Survey	SSM	894395	51.1	SSM	946869	51.1	SSM	946877	51.1
		894394	51.1		946870	51.1		946878	51.1
		894399	51.1		946871	51.1		946879	51.1
		894400	51.1		946872	51.1		946880	51.1
		894401	51.1		946873	51.1		946881	51.1
		894402	51.1		946874	51.1		946882	51.1
		894403	51.1		946875	51.1		946889	51.1
		894404	51.1		946876	51.1		946890	51.1

All the work was performed on Mining Claim(s): SSM 946914⁽⁵⁴⁶⁾ 946958⁽²⁵¹⁾ 946953^(1,155) 946951⁽¹²⁷⁾ 946979⁽⁷⁴⁸⁾ 946948^(1,172)

Required Information eg: type of equipment, Names, Addresses, etc. (See Table Below) G. 2100 + G. 3765 - Wawa

Drilcor Ltd.
17-7449 Home Ave
Tilbury Industrial Park
Delta B.C.
V4G 1C3

Date Start: April 07/88
Latest Hole: May 13/88

Owner: Dangle Frye
Equipment: 1 BBS Flydrill
1 Helicopter Hughes 500D
Core Stored in Bush

4,624 days performed
4,599 days applied
25 days to be banked on SSM 946954

SAULT STEPHEN
RECEIVED
JUL 15 1988
A.M. 7:09 P.M. 4:15

Date of Report: July 3/88
Recorded/Holder or Agent (Signature): [Signature]

Certification Verifying Report of Work

I hereby certify that I have a personal and intimate knowledge of the facts set forth in the Report of Work annexed hereto, having performed the work or witnessed same during and/or after its completion and the annexed report is true.

Name and Postal Address of Person Certifying
John Pike 188 Perreault Val d'Or Quebec J9P 2H5

Date Certified: July 3/88
Certified by (Signature): [Signature]

Table of Information/Attachments Required by the Mining Recorder

Type of Work	Specific Information	Other information (Common to 2 or more types)	Attachments
Manual Work	Nil JUL 15 1988 RECEIVED	Names and addresses of men who performed manual work/operated equipment, together with dates and hours of employment.	Work Sketch: these are required to show the location and extent of work in relation to the nearest claim post.
Shaft Sinking, Drifting or other Lateral Work			
Compressed air, other power driven or mechanical equip.	Type of equipment	ONTARIO GEOLOGICAL SURVEY ASSESSMENT FILES OFFICE JUL 26 1988	Work Sketch (as above) in duplicate
Power Stripping	Type of equipment and amount expended. Note: Proof of actual cost must be submitted within 30 days of recording.		
Diamond or other core drilling	Signed core log showing; footage, diameter of core, number and angles of holes.	Names and addresses of owner or operator together with dates when drilling was done.	Nil
Land Survey	Name and address of Ontario land surveyer.	RECEIVED	



Mining Act

Name and Postal Address of Recorded Holder	Prospector's Licence No.

Summary of Work Performance and Distribution of Credits

Total Work Days Cr. claimed	Mining Claim		Work Days Cr.	Mining Claim		Work Days Cr.	Mining Claim		Work Days Cr.
	Prefix	Number		Prefix	Number		Prefix	Number	
for Performance of the following work. (Check one only) <input type="checkbox"/> Manual Work <input type="checkbox"/> Shaft Sinking Drifting or other Lateral Work. <input type="checkbox"/> Compressed Air, other Power driven or mechanical equip. <input type="checkbox"/> Power Stripping <input type="checkbox"/> Diamond or other Core drilling <input type="checkbox"/> Land Survey	SSM	946891	51.1	SSM	946899	51.1		946918	51.1
		946892	51.1		946900	51.1		946919	51.1
		946893	51.1		946901	51.1		946920	51.1
		946894	51.1		946902	51.1		946921	51.1
		946895	51.1		946903	51.1		946922	51.1
		946896	51.1		946915	51.1		946923	51.1
		946897	51.1		946916	51.1		946924	51.1
		946898	51.1		946917	51.1		946925	51.1

All the work was performed on Mining Claim(s): SSM 946942

Required Information eg: type of equipment, Names, Addresses, etc. (See Table Below)

	Date of Report	Recorded Holder or Agent (Signature)
--	----------------	--------------------------------------

Certification Verifying Report of Work

I hereby certify that I have a personal and intimate knowledge of the facts set forth in the Report of Work annexed hereto, having performed the work or witnessed same during and/or after its completion and the annexed report is true.

Name and Postal Address of Person Certifying

	Date Certified	Certified by (Signature)
--	----------------	--------------------------

Table of Information/Attachments Required by the Mining Recorder

Type of Work	Specific information per type	Other information (Common to 2 or more types)	Attachments
Manual Work	Nil	Names and addresses of men who performed manual work /operated equipment, together with dates and hours of employment.	Work Sketch: these are required to show the location and extent of work in relation to the nearest claim post.
Shaft Sinking, Drifting or other Lateral Work			
Compressed air, other power driven or mechanical equip.	Type of equipment	Names and addresses of owner or operator together with dates when drilling/stripping done.	
Power Stripping	Type of equipment and amount expended. Note: Proof of actual cost must be submitted within 30 days of recording.		
Diamond or other core drilling	Signed core log showing; footage, diameter of core, number and angles of holes.		Work Sketch (as above) in duplicate
Land Survey	Name and address of Ontario land surveyer.	Nil	Nil



Mining Act

Name and Postal Address of Recorded Holder	Prospector's Licence No.

Summary of Work Performance and Distribution of Credits

Total Work Days Cr. claimed	Mining Claim			Work Days Cr.	Mining Claim			Work Days Cr.	
	Prefix	Number	Work Days Cr.		Prefix	Number	Work Days Cr.		
for Performance of the following work. (Check one only) <input type="checkbox"/> Manual Work <input type="checkbox"/> Shaft Sinking Drifting or other Lateral Work. <input type="checkbox"/> Compressed Air, other Power driven or mechanical equip. <input type="checkbox"/> Power Stripping <input type="checkbox"/> Diamond or other Core drilling <input type="checkbox"/> Land Survey	SSM	946926	51.1	SSM	946948	51.1	SSM	946956	51.1
		946927	51.1		946949	51.1		946957	51.1
		946928	51.1		946950	51.1		946958	51.1
		946929	51.1		946951	51.1		946959	51.1
		946930	51.1		946952	51.1		946960	51.1
		946931	51.1		946953	51.1		946961	51.1
		946932	51.1		946954	51.1		946962	51.1
		946947	51.1		946955	51.1		946963	51.1

All the work was performed on Mining Claim(s):

Required Information eg: type of equipment, Names, Addresses, etc. (See Table Below)

	Date of Report	Recorded Holder or Agent (Signature)
--	----------------	--------------------------------------

Certification Verifying Report of Work

I hereby certify that I have a personal and intimate knowledge of the facts set forth in the Report of Work annexed hereto, having performed the work or witnessed same during and/or after its completion and the annexed report is true.

Name and Postal Address of Person Certifying		
	Date Certified	Certified by (Signature)

Table of Information/Attachments Required by the Mining Recorder

Type of Work	Specific information per type	Other information (Common to 2 or more types)	Attachments
Manual Work	Nil	Names and addresses of men who performed manual work/operated equipment, together with dates and hours of employment.	Work Sketch: these are required to show the location and extent of work in relation to the nearest claim post.
Shaft Sinking, Drifting or other Lateral Work			
Compressed air, other power driven or mechanical equip.	Type of equipment		
Power Stripping	Type of equipment and amount expended. Note: Proof of actual cost must be submitted within 30 days of recording.	Names and addresses of owner or operator together with dates when drilling/stripping done.	Work Sketch (as above) in duplicate
Diamond or other core drilling	Signed core log showing; footage, diameter of core, number and angles of holes.		
Land Survey	Name and address of Ontario land surveyor.	Nil	Nil



Name Postal Address of Recorded Holder	Prospector's Licence No.

Summary of Work Performance and Distribution of Credits

Total Work Days Cr. claimed	Mining Claim		Work Days Cr.	Mining Claim		Work Days Cr.	Mining Claim		Work Days Cr.
	Prefix	Number		Prefix	Number		Prefix	Number	
for Performance of the following work. (Check one only) <input type="checkbox"/> Manual Work <input type="checkbox"/> Shaft Sinking Drifting or other Lateral Work. <input type="checkbox"/> Compressed Air, other Power driven or mechanical equip. <input type="checkbox"/> Power Stripping <input type="checkbox"/> Diamond or other Core drilling <input type="checkbox"/> Land Survey	SSM	946964	51.1	SSM	946986	51.1	SSM	946994	51.1
		946979	51.1		946987	51.1		946995	51.1
		946980	51.1		946988	51.1			
		946981	51.1		946989	51.1			
		946982	51.1		946990	51.1			
		946983	51.1		946991	51.1			
		946984	51.1		946992	51.1			
		946985	51.1		946993	51.1			

All the work was performed on Mining Claim(s):

Required Information eg: type of equipment, Names, Addresses, etc. (See Table Below)

Date of Report	Recorded Holder or Agent (Signature)
----------------	--------------------------------------

Certification Verifying Report of Work

I hereby certify that I have a personal and intimate knowledge of the facts set forth in the Report of Work annexed hereto, having performed the work or witnessed same during and/or after its completion and the annexed report is true.

Name and Postal Address of Person Certifying	
Date Certified	Certified by (Signature)

Table of Information/Attachments Required by the Mining Recorder

Type of Work	Specific information per type	Other information (Common to 2 or more types)	Attachments
Manual Work	Nil	Names and addresses of men who performed manual work/operated equipment, together with dates and hours of employment.	Work Sketch: these are required to show the location and extent of work in relation to the nearest claim post.
Shaft Sinking, Drifting or other Lateral Work			
Compressed air, other power driven or mechanical equip.	Type of equipment	Names and addresses of owner or operator together with dates when drilling/stripping done.	
Power Stripping	Type of equipment and amount expended. Note: Proof of actual cost must be submitted within 30 days of recording.		
Diamond or other core drilling	Signed core log showing; footage, diameter of core, number and angles of holes.	Nil	Work Sketch (as above) in duplicate
Land Survey	Name and address of Ontario land surveyer.		Nil

DOCUMENT No. W6805-109

claims work applied to
claims work performed on

LEGEND

	HIGHWAY AND ROUTE NO.
	OTHER ROADS
	TRAILS
	SURVEYED LINES
	LOTS MINING CLAIMS, ETC.
	UNSURVEYED LINES
	PARCEL BOUNDARY
	MINING CLAIMS, ETC.
	RAILWAY AND RIGHT OF WAY
	UTILITY LINES
	NON-PERENNIAL STREAM
	FLOODING OR FLOODING RIGHTS
	SUBDIVISION OR COMPOSITE PLAN
	RESERVATION
	ORIGINAL SHORELINE
	MARSH OR MUSKEG
	MINE
	TRAVERSE MONUMENT

DISPOSITION OF CROWN LANDS

TYPE OF DOCUMENT	SYMBOL
PATENT SURFACE & MINING RIGHTS	
PATENT SURFACE RIGHTS ONLY	
PATENT MINING RIGHTS ONLY	
LEASE SURFACE & MINING RIGHTS	
LEASE SURFACE RIGHTS ONLY	
LEASE MINING RIGHTS ONLY	
LICENCE OF OCCUPATION	
ORDER IN COUNCIL	
RESERVATION	
SALT GRAVEL	

NOTE: MINING RIGHTS IN PARCELS SHOWN IN THIS PLAN ARE SUBJECT TO THE PROVISIONS OF THE MINING ACT AND REGULATIONS THEREUNDER.

AREA: **PILOT HARBOUR**
 M.A.R. ADMINISTRATIVE DISTRICT
 WAWA
 MINING DIVISION
SAULT STE MARIE
 LAND TITLES / REGISTRY DIVISION
 THUNDER BAY

Ministry of Natural Resources and Mines
 Ontario

DATE: JULY 1956

PROJECT: **G-2700**

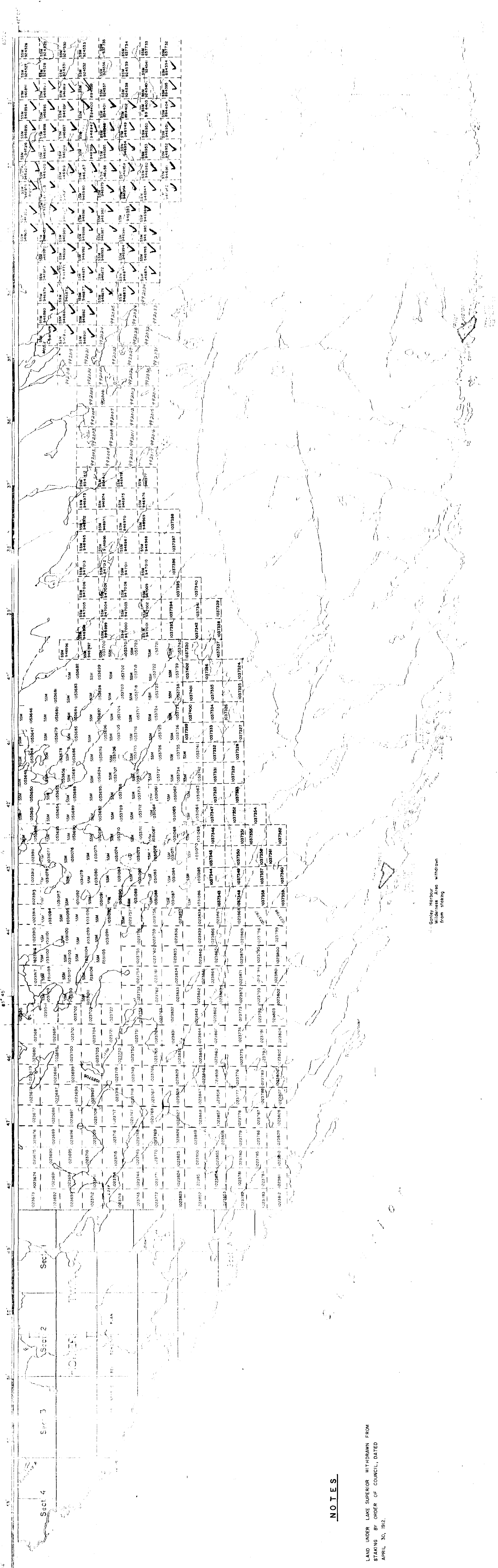

NOTES

LAND UNDER LAKE SUPERIOR WITHDRAWN FROM STAKING BY ORDER OF COUNCIL, DATED APRIL 30, 1912.



REFERENCES

AREAS WITHDRAWN FROM DISPOSITION

M.R.D. - MINING RIGHTS ONLY
 S.R.D. - SURFACE RIGHTS ONLY
 M+S - MINING AND SURFACE RIGHTS

Description	Order No.	Date	Disposition	File

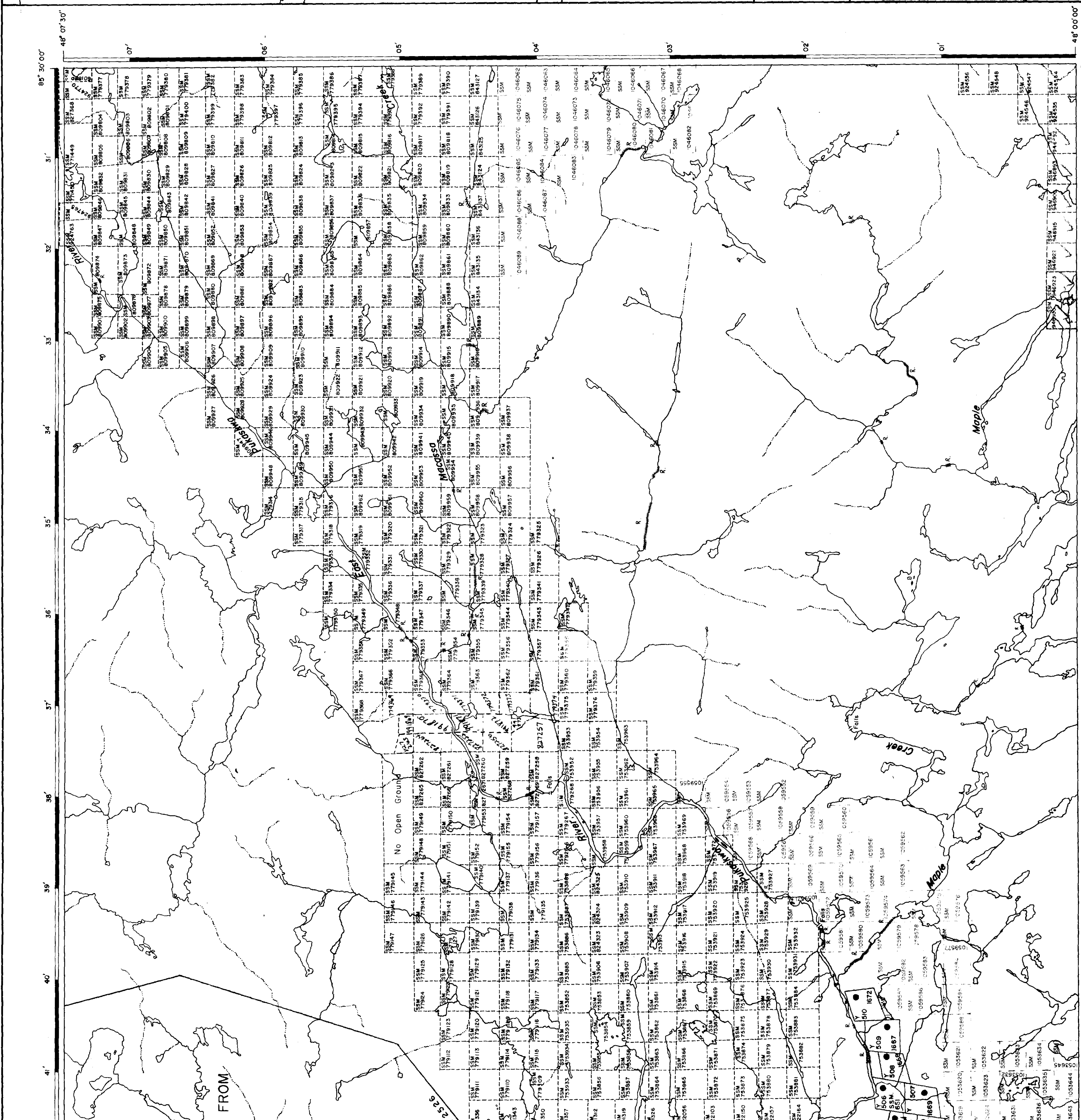
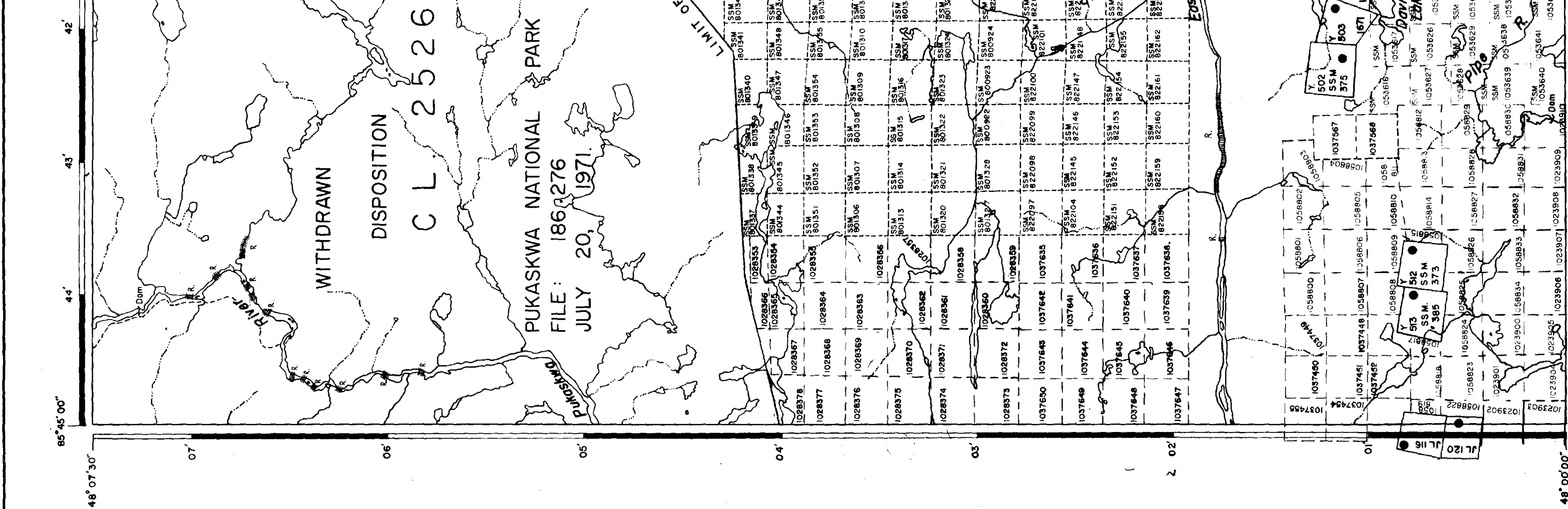

REFERENCES	LEGEND	DISPOSITION OF CROWN LANDS	TYPE OF DOCUMENT	SYMBOL	SCALE	AREA	DAVID LAKE	M.N.R. ADMINISTRATIVE DISTRICT	WAWA	MINING DIVISION	SAULT STE. MARIE	LAND TITLES / REGISTRY DIVISION	THUNDER BAY	Ministry of Natural Resources and Mines	Ministry of Northern Development and Mines	DATE: DECEMBER, 1986	Number	G-3765
-------------------	---------------	-----------------------------------	-------------------------	---------------	--------------	-------------	-------------------	---------------------------------------	-------------	------------------------	-------------------------	--	--------------------	--	---	-----------------------------	---------------	---------------



TRIM TO THIS LINE ALL AROUND

MAR 25