

September 5, 2004

Geosciences Assessment Office,
933 Ramsey Lake Road, 6th Floor,
Sudbury, Ontario
P3E 6B5

Thunderwood Resources Inc
c/o Larry Sostad (Agent)
818 – 470 Granville Street,
Vancouver, BC, V6C 1V5

Attention: Bruce Gates

Re: Assessment work. Pipe Lake Project. Submission No. 2.27560

I arrived into Ontario with Mr. Emil Leimanus April 13, 2004. On April 15th, I made arrangements with Blair Mills of Wilderness Helicopters in Wawa to fly us to the property.

Prospecting:

The prospecting part of this project was carried out by Emil Leimanus and Larry Sostad. We were hampered by heavy snow in some areas. We concentrated on the area around the trenches. The whole area is underlain mainly by granite going to finegrained andesite and dacite. Outcrop are about 10 – 20 % of the area. The bush is relatively thick. There is heavy muskeg and swamps in the ravines and depressions. Abundant iron staining was observed. Dacite with oxidized quartz stringers were observed. No significant showing were found. Three samples were taken and have been submitted to Acme Analytical Laboratories Inc in Vancouver for 31 element ICP analyses. The results should be completed September 15th, 2004 and I will forward them to you.

Trenching:

On April 15th, I contacted Willy Descrochers. Willy and his crew would not be available until April 19th.

We left April 20th and returned April 22nd.

The crew consisted of:

Larry Sostad, Supervisor, Prospector and Blaster (604 904 2432)
Emil Leimanus, Prospector (604 421 6178)

The Mining Essentials and Contracting Crew, Hawk Junction (705 887 2138)

Willy Descrochers, Blaster
Ivan Descrochers, Driller
Leo Roberts, Driller
Kieth Holland, Cook

2.27560

We established 4 trenches and collected 11 rock samples from the trenches.



2 "Cobra" Punjar Drills were used on the project.

The rock samples were submitted for assaying to Acme Analytical Laboratories Ltd, Vancouver, BC. (604 253 3158). The assaying is to be completed by September 15, 2004. At that time we will forward you the results.

I hope this meets all your requirements. If there are any questions please call me at 604 904 2432 or 778 388 1315.

Yours Truly

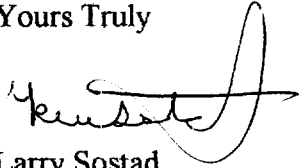
A handwritten signature in black ink, appearing to read "Larry Sostad", with a large, stylized flourish extending from the end of the name.

Larry Sostad
Ontario Prospector's License: 1000690

PIPE LAKE AREA

TRENCHING + PROSPECTING AREA

ASSESSMENT WORK

APRIL 2004



Records' Office of the Ministry of Northern Development and Mines for additional
navigational, survey, or land title determination purposes as the information
accuracy are not guaranteed. Additional information may also be obtained through the
ing Records' Office at the time of downloading from the Ministry of Northern

General Information and Limitations
Contact Information:
Provincial Mining Records' Office
Willet Green Miller Centre 933 Ramsey Lake Road
Sudbury ON P3E 6B5
Home Page: www.mrdm.gov.on.ca/MNDMINESLANDS/miamnpgg.htm

Toll Free
Tel: 1 (888) 415-9845 ext 57
Fax: 1 (877) 670-1444

Map Datum: NAD 83
Projection: UTM (6 degree)
Topographic Data Source: Land Information Ontario
Mining Land Tenure Source: Provincial Mining Records' Office

This map may not show
land including certain
flooding rights, licence
interest from the Crown
that restrict or prohibit
illustrated.

PIPE LAKE AREA

PILOT HARBOUR

PLAN G 2700

PROSPECTING TRAVERSES (APPROXIMATE)

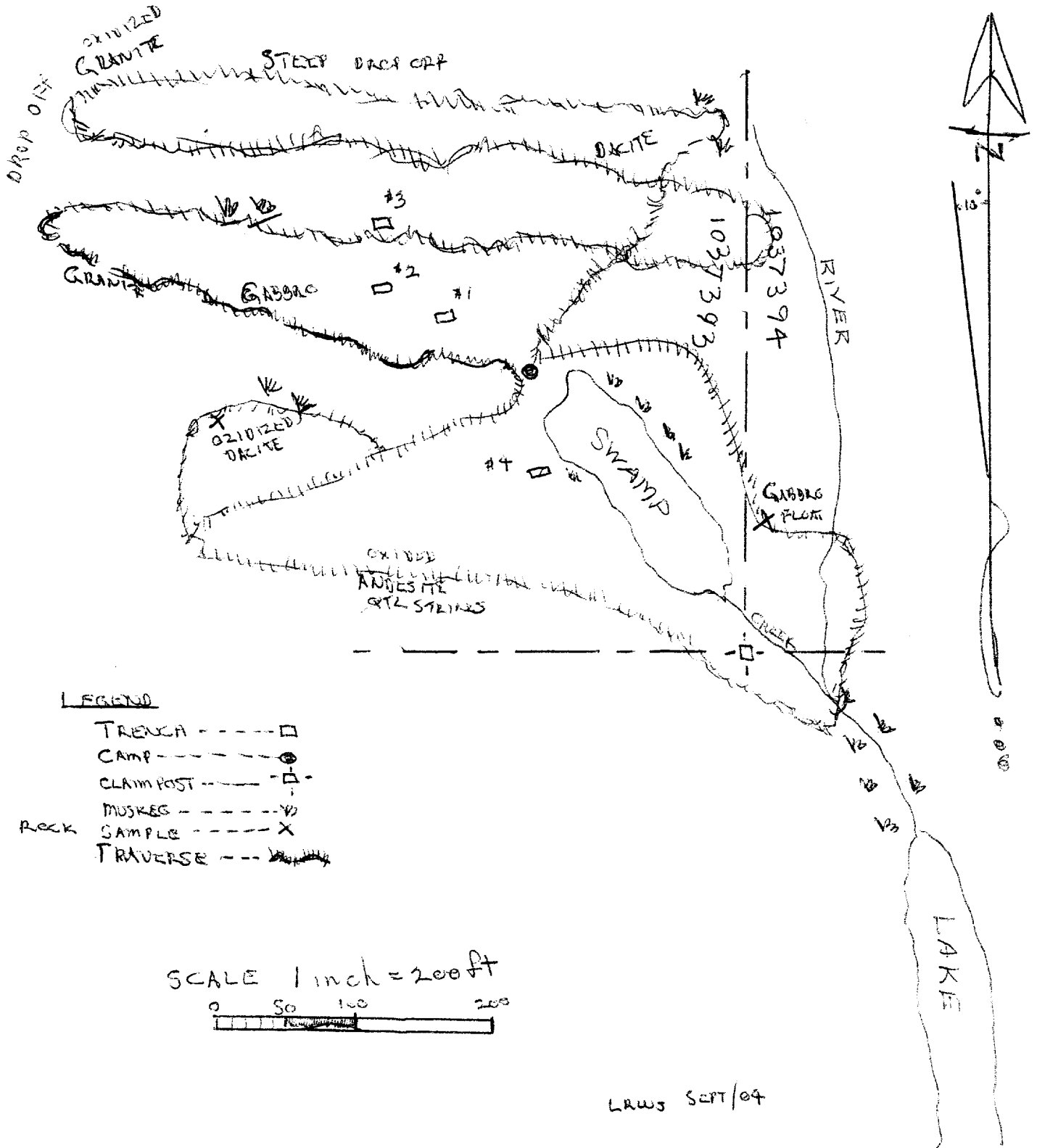

LEGEND

- TRENCH - - - - □
- CAMP - - - - ⊙
- CLAIM POST - - - - ⊠
- MUSKES - - - - v
- ROCK SAMPLE - - - - x
- TRAVERSE - - - - hachures

SCALE 1 inch = 200 ft

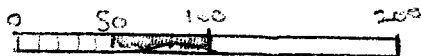

LAWS SEPT/04

TRENCHING PIPE LAKE AREA PILOT HARBOUR

PLAN G 2700

SE $\frac{1}{4}$
CLAIM
N^o 1037393

#3 TRENCH
9m LONG
2m WIDE
1m DEEP

DACITE
IRON OXIDE
FRACTURES
MINOR QTZ VEINING



#2 TRENCH
10m LONG
2m WIDE
1m DEEP

GABBRO

ALTERED
GRANITE

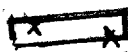

#1 TRENCH
11m LONG
2m WIDE
1m DEEP

DACITE

ALTERED
GRANITE



#4 TRENCH
10m LONG
1m WIDE
1m DEEP

Oxidized
DACITE

GAULTED
QTZ STRINGERS
IN DACITE

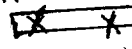

SCALE

1 inch = 50 ft

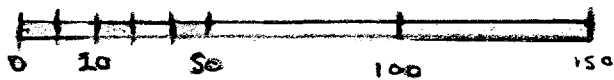

1 inch = 15.02 METRES

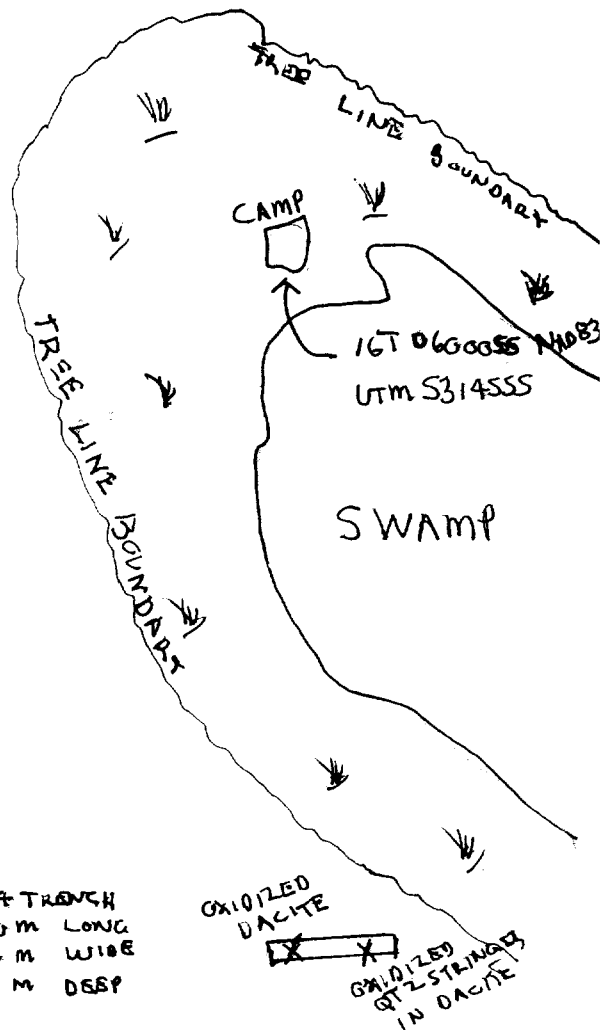

TRENCHING & PROSPECTING

PIPE LAKE AREA

CLAIM NUMBER 1037393

PILOT HARBOR AREA

PLAN G 2700

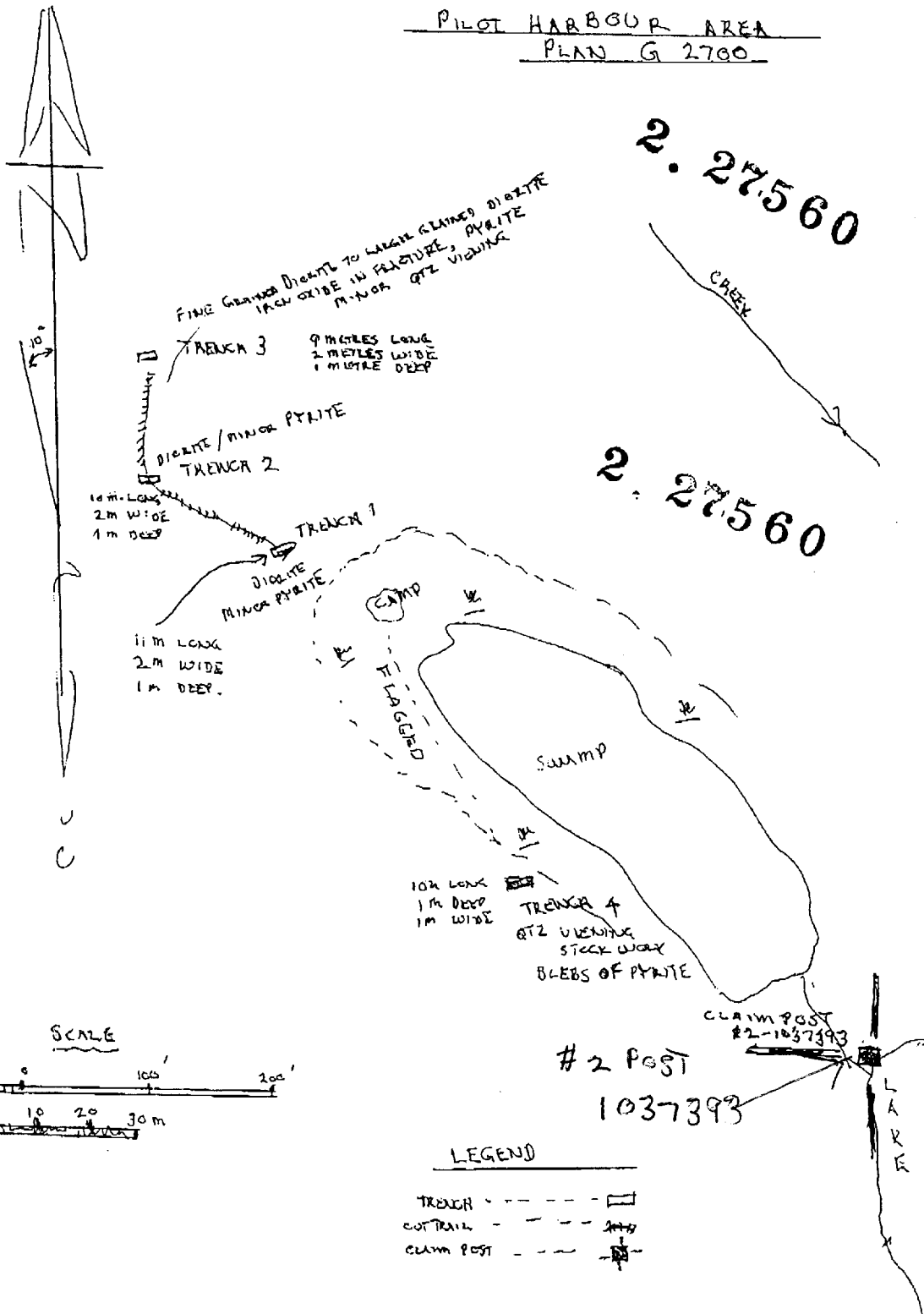

L. HALLS
APR 1/04

 Ontario

Prospector's Licence/
Permis de Prospecteur

LIC 1000690
EXP 15JAN2008

CLN 400795
LARRY R SOSTAD





CHOPPER
COMING IN WITH GEAR

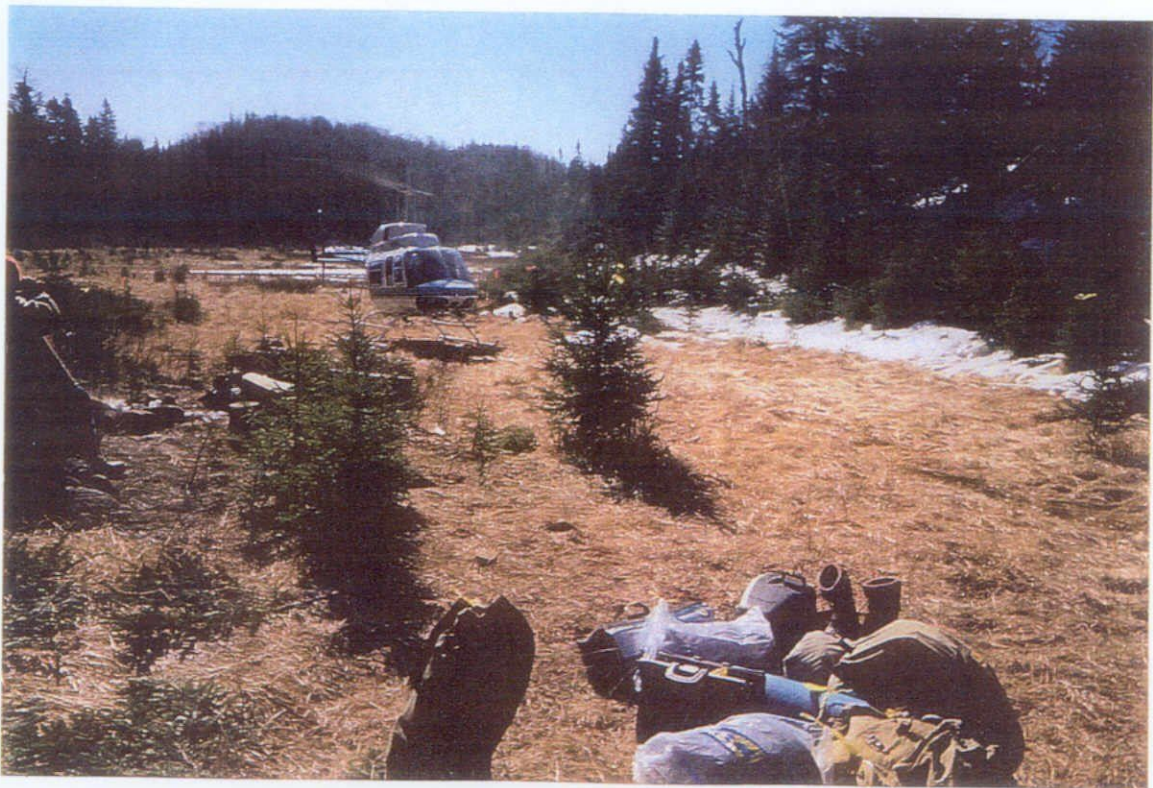

CAMP AREA



CAMP



THE BUSY COOK



E. LEIMANUS
SNOW CONDITIONS



L. SOSTAD
SNOW CONDITIONS



LOOKING NORTH FROM #4 TRENCH
YOU CAN SEE CAMP.



GENERAL AREA VIEW



NR TRENCH 1
= LOOKING AT CAMP



GETTING READY TO DRILL
TRENCH 1



IVAN DRILLING



WILLY DRILLING (SHOWS BOTH DRILLS)



SAMPLING

L. SOSTAD

#2 TRENCH



CHECKING THE ROCK

E. LEIMANUS



L. SOSTAD SAMPLING
TRENCH 3



TRENCH 3

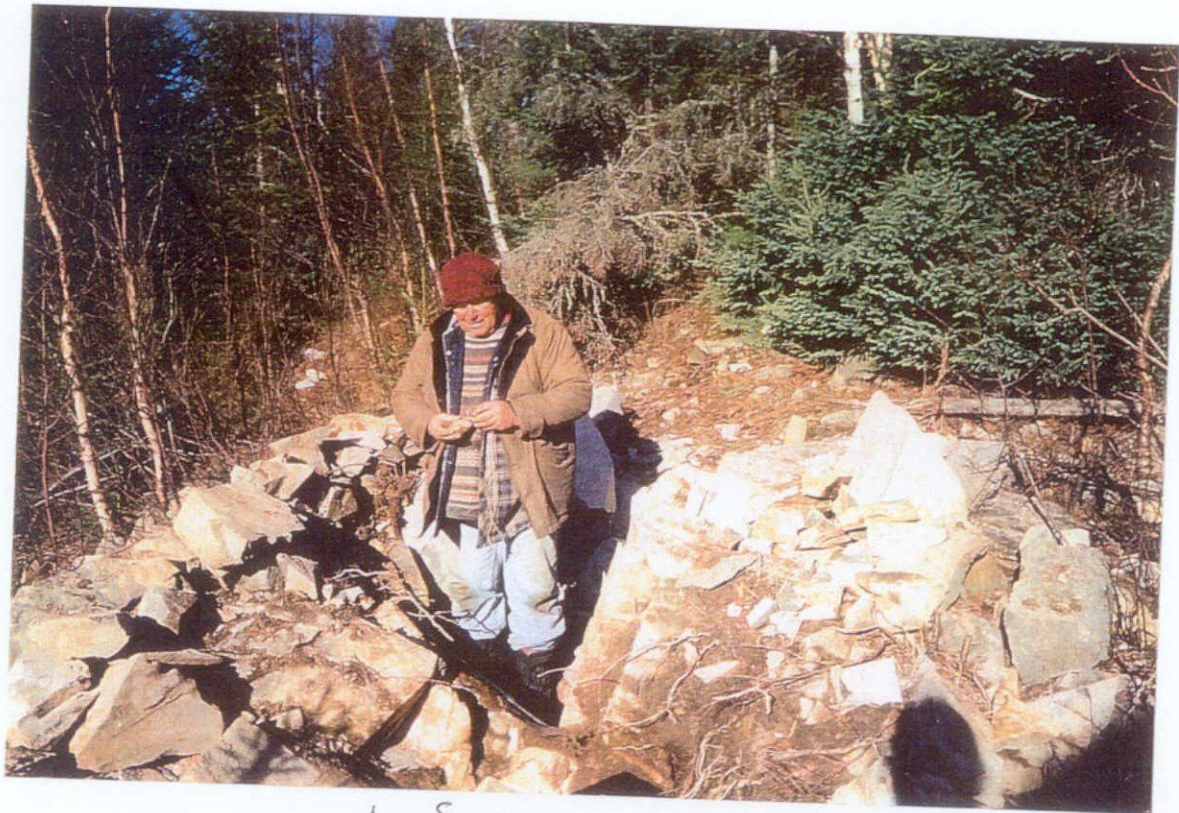

L SOSTAD

#4 TRENCH



WILLY

CLEANING THE TRENCH

April 23/04

WORK ON CLAIM

WORK WAS FROM APR 13/04 to APRIL 22

I had my prospect E. LEIMANIS

I hired "Mining Essentials & Contracting" out of Hazelton
WILLY DESROCHERS

705 559 2138

Willy supplied himself and 3 men to make our crew total six. Willy supplied Drill and blasting equipment I supplied a drill. We trench and prospect the area with a 2 km radius of camp. There was snow and it was covering about 30% of the area. The whole area has pyrite (small blebs) throughout

Access was by Wilderness helicopter from W. W. We sent 2 truck "MICHAEL PIT" 48 K S.W. of HWY 17 on "River Gold" road. A 3 tent cook/camp was used to complete the job.

2, 27560

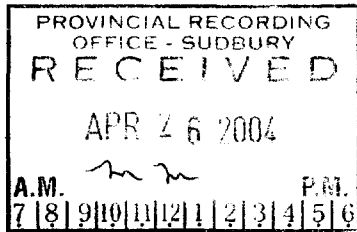

SGD - Larry Sostad
LARRY SOSTAD

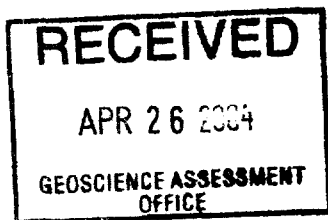

COSTS - PIPE LAKE PROJECT.

ARRIVE ONTARIO - APRIL - 13/04.
 LEAVE ONTARIO APRIL 24/04.
 TOTAL DAYS ONTARIO 12

TRUCK RENTAL 4x4 JEEP @ \$60 x 12 \$ 720
 2500 KM @ .35 \$ 1050

FOOD + ACCOM.
 12 DAYS x 2 @ \$90 \$ 2160

DRILL RENTAL (COBRA) \$ 1000

MANPOWER

L. SOSTAD 12 DAYS @ \$350 \$ 4200
 + 1 DAY MOB. + DEMOB

E. LEIMANIS - 12 DAYS @ \$250 \$ 3000

HELICOPTER (WILDERNESS AIRWAY)

4.4 hrs @ 1370/hr. \$ 6028
 G.S.T. \$ 422

CONTRACTOR - MINING ESSENTIALS + CONTRACTING
 DRILL BLAST + EQUIP.

6 DAYS APR. 16 - 22/04 7000
 GST. 490

TOTAL COST. \$ 26,870

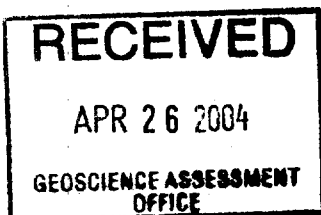

2,27560

TRENCHING & PROSPECTING

PIPE LAKE AREA

CLAIM NUMBER 1037393

PILOT HARBOR AREA

PLAN G 2700

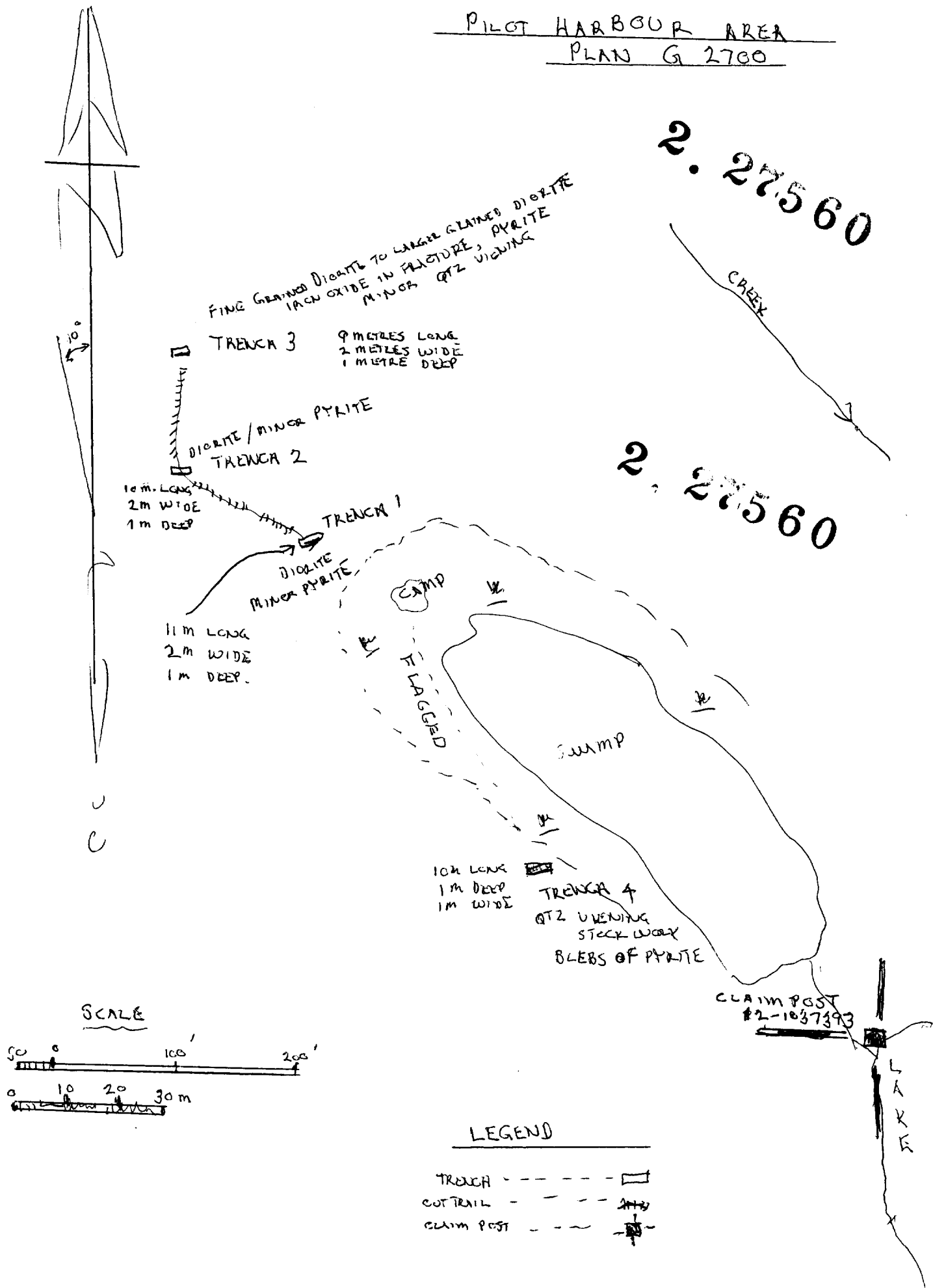

LAWSON
APR/04

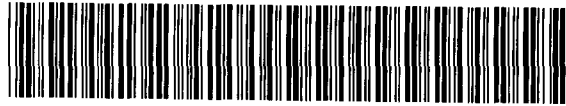

41N13NE2002 2.27560

PILOT HARBOUR

020

September 14 , 2004

Geosciences Assessment Office,
933 Ramsey Lake Road, 6th Floor,
Sudbury, Ontario
P3E 6B5

Thundersword Resources Inc.,
c/o Larry Sostad (Agent),
818 - 470 Granville Street,
Vancouver, B.C. V6C 1V5

Attention: Bruce Gates

Re: Assessment work. Pipe Lake Project Submission No. 2.27560

Enclosed please find both the prospecting and trenching maps generated from our fieldwork. I trust this will cover the assay sample requirements.

Any questions please don't hesitate to call

Yours Truly,

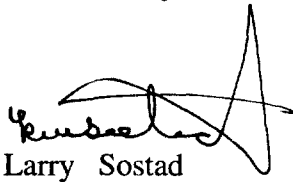
Larry Sostad

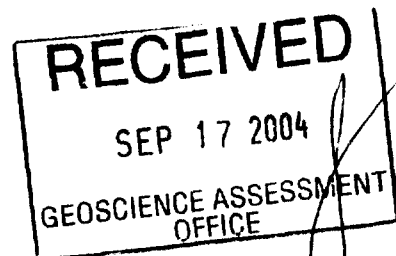

2.27560

PIPE LAKE AREA

PILOT HARBOUR
PLAN G 2700

CERTIFICATE OF ANALYSIS ATTACHED

PROSPECTING TRAVERSES
(APPROXIMATE)

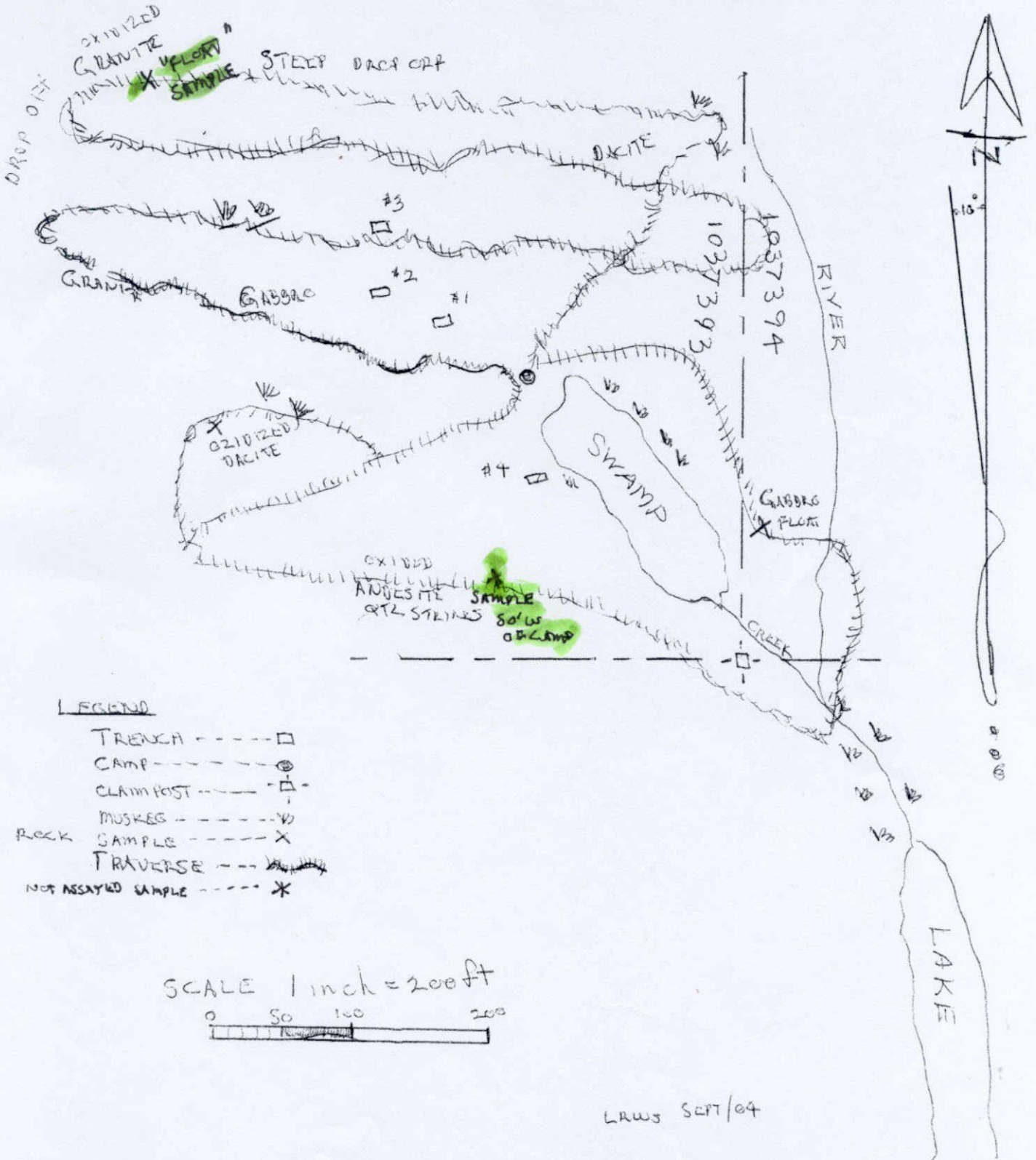

LWWS SEPT/04



GEOCHEMICAL ANALYSIS CERTIFICATE



MAS Capital Inc. File # A404951

1500 - 750 W. Pender St., Vancouver BC Submitted by: Angus J. MacKinnon

P. 1

6046850593

MAR CAPITAL GRPUP

Feb 01 2004 4:40AM

| SAMPLE# | Mo | Cu | Pb | Zn | Ag | Ni | Co | Mn | Fe | As | U | Au | Th | Sr | Cd | Sb | Bi | V | Ca | P | La | Cr | Mg | Ba | Ti | B | Al | Na | K | W | Au** |
|--------------------|-----|-----|-----|-----|-----|-----|-----|-----|------|-----|-----|-----|-----|-----|-----|-----|-----|-----|------|------|-----|-----|------|-----|------|----|------|-----|-----|-----|------|
| | ppm | ppm | ppm | ppm | ppm | ppm | ppm | ppm | % | ppm | ppm | ppm | ppm | ppm | ppm | ppm | ppm | ppm | % | % | ppm | ppm | % | ppm | % | % | % | % | % | ppm | ppb |
| S1 | 1 | 5 | 3 | 3 | <.3 | <1 | <1 | 7 | .04 | <2 | <8 | <2 | <2 | 2 | <.5 | <3 | <3 | <1 | .08 | .001 | <1 | <1 | .01 | 3 | <.01 | <3 | .01 | .32 | .01 | <2 | 3 |
| TRENCH #1A | 1 | 55 | <3 | 56 | .3 | 76 | 13 | 397 | 2.20 | <2 | 8 | <2 | <2 | 9 | <.5 | <3 | <3 | 37 | .70 | .051 | 9 | 131 | 1.50 | 16 | .11 | 4 | 1.41 | .07 | .07 | <2 | 15 |
| TRENCH #1B | <1 | 141 | <3 | 74 | .4 | 91 | 17 | 384 | 2.75 | 2 | <8 | <2 | <2 | 7 | <.5 | <3 | <3 | 48 | .49 | .051 | 9 | 153 | 1.88 | 39 | .14 | <3 | 1.78 | .05 | .17 | <2 | 28 |
| TRENCH #2A | 1 | 12 | <3 | 52 | .3 | 72 | 15 | 340 | 2.26 | <2 | <8 | <2 | <2 | 16 | <.5 | <3 | <3 | 36 | .52 | .073 | 11 | 115 | 1.57 | 7 | .08 | 4 | 1.54 | .05 | .02 | <2 | 5 |
| TRENCH #2B | <1 | 11 | <3 | 47 | .4 | 70 | 14 | 306 | 2.13 | <2 | <8 | <2 | <2 | 14 | <.5 | <3 | <3 | 31 | .44 | .075 | 10 | 116 | 1.48 | 7 | .08 | 5 | 1.44 | .05 | .02 | <2 | 6 |
| TRENCH #3A | 1 | 20 | 3 | 120 | <.3 | 93 | 18 | 472 | 3.01 | 3 | <8 | <2 | <2 | 14 | <.5 | <3 | <3 | 65 | .82 | .078 | 11 | 126 | 2.03 | 24 | .17 | <3 | 1.91 | .07 | .07 | <2 | 3 |
| TRENCH #3B | <1 | 9 | <3 | 83 | .3 | 76 | 15 | 370 | 2.33 | 2 | <8 | <2 | <2 | 14 | <.5 | <3 | <3 | 50 | .95 | .094 | 13 | 104 | 1.65 | 15 | .14 | 3 | 1.55 | .06 | .07 | <2 | 3 |
| TRENCH #3C | 1 | 17 | <3 | 98 | <.3 | 82 | 18 | 431 | 3.18 | 2 | <8 | <2 | <2 | 41 | <.5 | <3 | <3 | 73 | 1.93 | .064 | 10 | 109 | 2.16 | 26 | .18 | <3 | 3.09 | .10 | .13 | <2 | 4 |
| TRENCH #4A | <1 | 42 | 3 | 154 | .3 | 90 | 16 | 812 | 3.22 | <2 | <8 | <2 | 2 | 33 | <.5 | 3 | <3 | 59 | 1.42 | .047 | 9 | 124 | 2.30 | 85 | .15 | <3 | 3.45 | .14 | .49 | 2 | 6 |
| TRENCH #4B | 1 | 10 | 8 | 109 | .4 | 55 | 10 | 798 | 2.28 | 2 | <8 | <2 | 2 | 25 | <.5 | <3 | <3 | 43 | 1.65 | .045 | 10 | 96 | 2.04 | 67 | .12 | 6 | 2.51 | .06 | .36 | 2 | 10 |
| RE TRENCH #4B | 1 | 10 | 11 | 105 | .5 | 54 | 10 | 777 | 2.22 | 3 | <8 | <2 | 2 | 25 | <.5 | 3 | <3 | 42 | 1.62 | .043 | 11 | 98 | 1.99 | 65 | .12 | 9 | 2.45 | .06 | .35 | <2 | <2 |
| 50'-0 WEST OF CAMP | <1 | 15 | 5 | 76 | .4 | 89 | 16 | 443 | 2.68 | 2 | <8 | <2 | 2 | 5 | <.5 | 3 | 3 | 45 | .32 | .047 | 6 | 141 | 1.89 | 15 | .12 | <3 | 1.69 | .04 | .05 | <2 | <2 |
| FLOAT SAMPLE | 1 | 24 | 4 | 63 | .4 | 28 | 10 | 267 | 2.33 | <2 | 8 | <2 | 2 | 11 | <.5 | <3 | 3 | 45 | .35 | .051 | 11 | 29 | 1.05 | 51 | .11 | 4 | 1.03 | .06 | .15 | <2 | <2 |
| STANDARD DS5/AU-R | 13 | 141 | 24 | 135 | .3 | 25 | 12 | 741 | 3.00 | 18 | <8 | <2 | 3 | 45 | 5.3 | 5 | 7 | 58 | .72 | .090 | 11 | 188 | .67 | 137 | .10 | 17 | 2.01 | .04 | .14 | 5 | 500 |

GROUP 10 - 0.50 GM SAMPLE LEACHED WITH 3 ML 2-2-2 HCL-HNO3-H2O AT 95 DEG. C FOR ONE HOUR, DILUTED TO 10 ML, ANALYSED BY ICP-ES.
 (>) CONCENTRATION EXCEEDS UPPER LIMITS. SOME MINERALS MAY BE PARTIALLY ATTACKED. REFRACTORY AND GRAPHITIC SAMPLES CAN LIMIT AU SOLUBILITY.
 ASSAY RECOMMENDED FOR ROCK AND CORE SAMPLES IF CU PB ZN AS > 1%, AG > 30 PPM & AU > 1000 PPB
 - SAMPLE TYPE: ROCK R150 AU** GROUP 3B - 30.00 GM SAMPLE ANALYSIS BY FA/ICP.
 Samples beginning 'RE' are Retuns and 'RRE' are Reject Retuns.

Data N FA _____ DATE RECEIVED: AUG 25 2004 DATE REPORT MAILED: Sept. 9/04



TRENCHING PIPE LAKE AREA

PILOT HARBOUR

SHOWING ASSAY LOCATIONS WITH
ANALYSIS CERTIFICATE INCLUDED

PLAN G 2700

SE 1/4
CLAIM
N^o 1037393

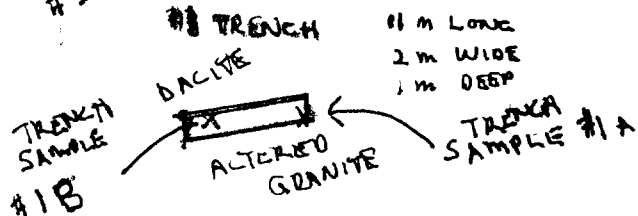
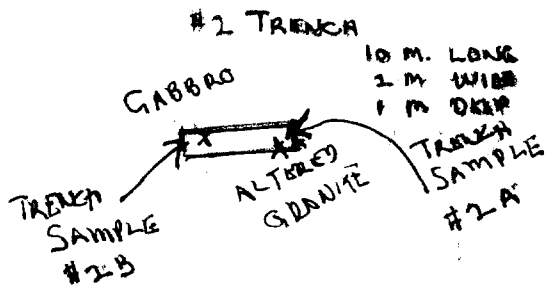
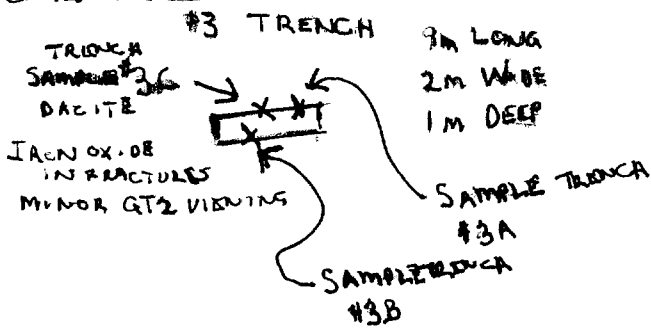

SCALE

1 inch = 50 ft

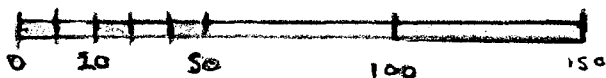

1 inch = 15.02 METRES

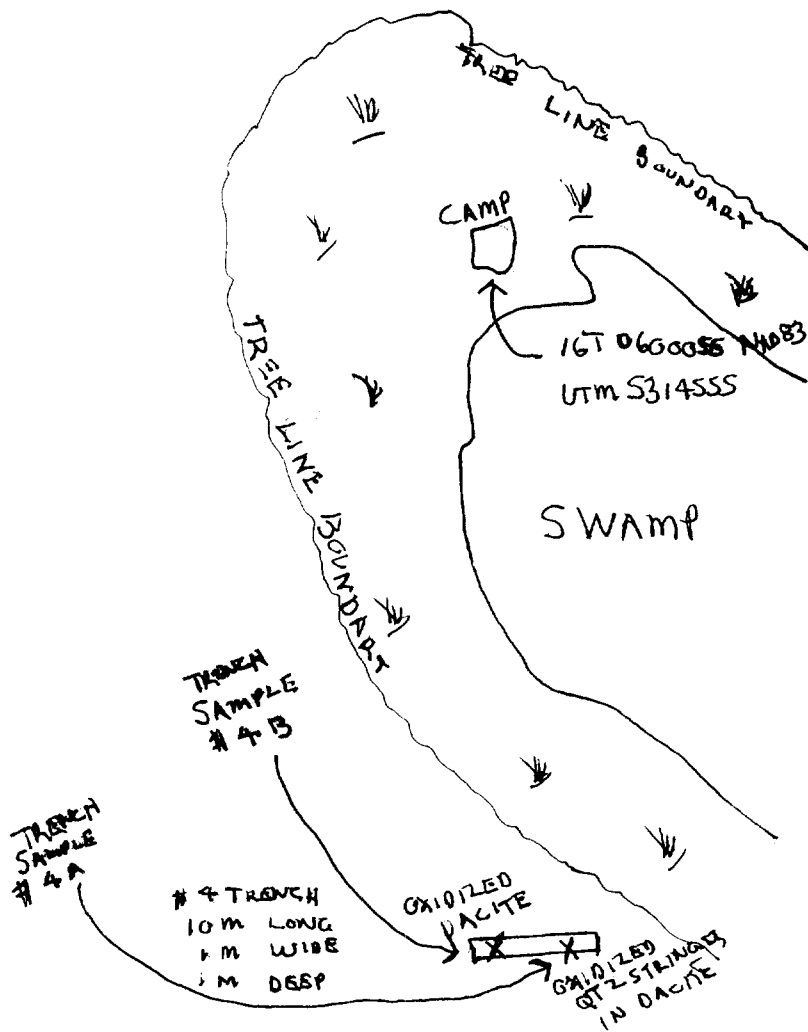
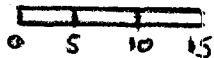



GEOCHEMICAL ANALYSIS CERTIFICATE



MAS Capital Inc. File # A404951

1500 - 750 W. Pender St., Vancouver BC Submitted by: Angus J. MacKinnon

P. 1

6046850593

MAR CAPITAL GRPUP

Feb 01 2004 4:40AM

| SAMPLE# | Mo | Cu | Pb | Zn | Ag | Ni | Co | Mn | Fe | As | U | Au | Th | Sr | Cd | Sb | Bi | V | Ca | P | La | Cr | Mg | Ba | Ti | B | Al | Na | K | W | Au** |
|--------------------|-----|-----|-----|-----|-----|-----|-----|-----|------|-----|-----|-----|-----|-----|-----|-----|-----|-----|------|------|-----|-----|------|-----|------|----|------|-----|-----|-----|------|
| | ppm | ppm | ppm | ppm | ppm | ppm | ppm | ppm | % | ppm | ppm | ppm | ppm | ppm | ppm | ppm | ppm | ppm | % | % | ppm | ppm | % | ppm | % | % | % | % | % | ppm | ppb |
| S1 | 1 | 5 | 3 | 3 | <.3 | <1 | <1 | 7 | .04 | <2 | <8 | <2 | <2 | 2 | <.5 | <3 | <3 | <1 | .08 | .001 | <1 | <1 | .01 | 3 | <.01 | <3 | .01 | .32 | .01 | <2 | 3 |
| TRENCH #1A | 1 | 55 | <3 | 56 | .3 | 76 | 13 | 397 | 2.20 | <2 | 8 | <2 | <2 | 9 | <.5 | <3 | <3 | 37 | .70 | .051 | 9 | 131 | 1.50 | 16 | .11 | 4 | 1.41 | .07 | .07 | <2 | 15 |
| TRENCH #1B | <1 | 141 | <3 | 74 | .4 | 91 | 17 | 384 | 2.75 | 2 | <8 | <2 | <2 | 7 | <.5 | <3 | <3 | 48 | .49 | .051 | 9 | 153 | 1.88 | 39 | .14 | <3 | 1.78 | .05 | .17 | <2 | 28 |
| TRENCH #2A | 1 | 12 | <3 | 52 | .3 | 72 | 15 | 340 | 2.26 | <2 | <8 | <2 | <2 | 16 | <.5 | <3 | <3 | 36 | .52 | .073 | 11 | 115 | 1.57 | 7 | .08 | 4 | 1.54 | .05 | .02 | <2 | 5 |
| TRENCH #2B | <1 | 11 | <3 | 47 | .4 | 70 | 14 | 306 | 2.13 | <2 | <8 | <2 | <2 | 14 | <.5 | <3 | <3 | 31 | .44 | .075 | 10 | 116 | 1.48 | 7 | .08 | 5 | 1.44 | .05 | .02 | <2 | 6 |
| TRENCH #3A | 1 | 20 | 3 | 120 | <.3 | 93 | 18 | 472 | 3.01 | 3 | <8 | <2 | <2 | 14 | <.5 | <3 | <3 | 65 | .82 | .078 | 11 | 126 | 2.03 | 24 | .17 | <3 | 1.91 | .07 | .07 | <2 | 3 |
| TRENCH #3B | <1 | 9 | <3 | 83 | .3 | 76 | 15 | 370 | 2.33 | 2 | <8 | <2 | <2 | 14 | <.5 | <3 | <3 | 50 | .95 | .094 | 13 | 104 | 1.65 | 15 | .14 | 3 | 1.55 | .06 | .07 | <2 | 3 |
| TRENCH #3C | 1 | 17 | <3 | 98 | <.3 | 82 | 18 | 431 | 3.18 | 2 | <8 | <2 | <2 | 41 | <.5 | <3 | <3 | 73 | 1.93 | .064 | 10 | 109 | 2.16 | 26 | .18 | <3 | 3.09 | .10 | .13 | <2 | 4 |
| TRENCH #4A | <1 | 42 | 3 | 154 | .3 | 90 | 16 | 812 | 3.22 | <2 | <8 | <2 | 2 | 33 | <.5 | 3 | <3 | 59 | 1.42 | .047 | 9 | 124 | 2.30 | 85 | .15 | <3 | 3.45 | .14 | .49 | 2 | 6 |
| TRENCH #4B | 1 | 10 | 8 | 109 | .4 | 55 | 10 | 798 | 2.28 | 2 | <8 | <2 | 2 | 25 | <.5 | <3 | <3 | 43 | 1.65 | .045 | 10 | 96 | 2.04 | 67 | .12 | 6 | 2.51 | .06 | .36 | 2 | 10 |
| RE TRENCH #4B | 1 | 10 | 11 | 105 | .5 | 54 | 10 | 777 | 2.22 | 3 | <8 | <2 | 2 | 25 | <.5 | 3 | <3 | 42 | 1.62 | .043 | 11 | 98 | 1.99 | 65 | .12 | 9 | 2.45 | .06 | .35 | <2 | <2 |
| 50'-0 WEST OF CAMP | <1 | 15 | 5 | 76 | .4 | 89 | 16 | 443 | 2.68 | 2 | <8 | <2 | 2 | 5 | <.5 | 3 | 3 | 45 | .32 | .047 | 6 | 141 | 1.89 | 15 | .12 | <3 | 1.69 | .04 | .05 | <2 | <2 |
| FLOAT SAMPLE | 1 | 24 | 4 | 63 | .4 | 28 | 10 | 267 | 2.33 | <2 | 8 | <2 | 2 | 11 | <.5 | <3 | 3 | 45 | .35 | .051 | 11 | 29 | 1.05 | 51 | .11 | 4 | 1.03 | .06 | .15 | <2 | <2 |
| STANDARD DS5/AU-R | 13 | 141 | 24 | 135 | .3 | 25 | 12 | 741 | 3.00 | 18 | <8 | <2 | 3 | 45 | 5.3 | 5 | 7 | 58 | .72 | .090 | 11 | 188 | .67 | 137 | .10 | 17 | 2.01 | .04 | .14 | 5 | 500 |

GROUP 10 - 0.50 GM SAMPLE LEACHED WITH 3 ML 2-2-2 HCL-HNO3-H2O AT 95 DEG. C FOR ONE HOUR, DILUTED TO 10 ML, ANALYSED BY ICP-ES.
 (>) CONCENTRATION EXCEEDS UPPER LIMITS. SOME MINERALS MAY BE PARTIALLY ATTACKED. REFRACTORY AND GRAPHITIC SAMPLES CAN LIMIT AU SOLUBILITY.
 ASSAY RECOMMENDED FOR ROCK AND CORE SAMPLES IF CU PB ZN AS > 1%, AG > 30 PPM & AU > 1000 PPB
 - SAMPLE TYPE: ROCK R150 AU** GROUP 38 - 30.00 GM SAMPLE ANALYSIS BY FA/ICP.
 Samples beginning 'RE' are Reruns and 'RRE' are Reject Reruns.

Data FA

DATE RECEIVED: AUG 25 2004

DATE REPORT MAILED: *Sept. 9/04*

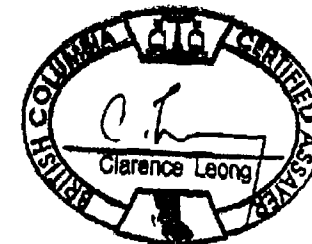

Work Report Summary

Transaction No: W0450.00627

Status: APPROVED

Recording Date: 2004-APR-23

Work Done from: 2004-APR-13

Approval Date: 2004-AUG-21

to: 2004-APR-22

Work Report Details:

| Claim# | Perform | Perform Approve | Applied | Applied Approve | Assign | Assign Approve | Reserve | Reserve Approve | Due Date |
|-------------|----------|-----------------|----------|-----------------|----------|----------------|----------|-----------------|-------------|
| SSM 1037393 | \$26,870 | \$17,651 | \$400 | \$400 | \$16,400 | 16,400 | \$10,070 | \$851 | 2005-APR-24 |
| SSM 1037394 | \$0 | \$0 | \$400 | \$400 | \$0 | 0 | \$0 | \$0 | 2005-APR-24 |
| SSM 1037395 | \$0 | \$0 | \$400 | \$400 | \$0 | 0 | \$0 | \$0 | 2005-APR-24 |
| SSM 1037396 | \$0 | \$0 | \$400 | \$400 | \$0 | 0 | \$0 | \$0 | 2005-APR-24 |
| SSM 1037397 | \$0 | \$0 | \$400 | \$400 | \$0 | 0 | \$0 | \$0 | 2005-APR-24 |
| SSM 1037398 | \$0 | \$0 | \$400 | \$400 | \$0 | 0 | \$0 | \$0 | 2005-APR-24 |
| SSM 1037402 | \$0 | \$0 | \$400 | \$400 | \$0 | 0 | \$0 | \$0 | 2005-APR-24 |
| | \$26,870 | \$17,651 | \$16,800 | \$16,800 | \$16,400 | \$16,400 | \$10,070 | \$851 | |

External Credits: \$0

Reserve:

\$851 Reserve of Work Report#: W0450.00627

 \$851 Total Remaining

Status of claim is based on information currently on record.

Date: 2004-SEP-22

GEOSCIENCE ASSESSMENT OFFICE
933 RAMSEY LAKE ROAD, 6th FLOOR
SUDBURY, ONTARIO
P3E 6B5

THUNDER SWORD RESOURCES INC.
6031 TRANQUILLE PLACE
RICHMOND, BRITISH COLUMBIA
V7C 2T2 CANADA

Tel: (888) 415-9845
Fax: (877) 670-1555

Submission Number: 2.27560
Transaction Number(s): W0450.00627

Dear Sir or Madam

Subject: Approval of Assessment Work

We have approved your Assessment Work Submission with the above noted Transaction Number(s). The attached Work Report Summary indicates the results of the approval.

At the discretion of the Ministry, the assessment work performed on the mining lands noted in this work report may be subject to inspection and/or investigation at any time.

The 45 days outlined in the Notice dated July 7, 2004 have passed. Reported costs exceed the value of information submitted. Geology type wages have been claimed for 12 days of which only 3 are in the field. The ensuing prospecting report consists of 9 lines. The most important information usually associated with a trenching program is the detailed map of the workings. The plan provided showing the trenches at @1.5 cm in length can not be considered detailed. Nothing in the report gives a clue as to the selection for the trench locations or discusses the results of the trenching. Assays costs of \$186 has been estimated and included but as the analyses were performed after the anniversary date of the claims this amount can not be used to meet the April 24, 2004 required amounts.

The TOTAL VALUE of assessment credit that will be allowed, based on the information provided in this submission, is $(\$26,870 \times 65\% = \$17,465) + \$186 = \$17,651$.

If you have any question regarding this correspondence, please contact BRUCE GATES by email at bruce.gates@ndm.gov.on.ca or by phone at (705) 670-5856.

Yours Sincerely,



Ron C. Gashinski
Senior Manager, Mining Lands Section

Cc: Resident Geologist

Thunder Sword Resources Inc.
(Claim Holder)

Larry Ralph Sostad
(Agent)

Assessment File Library

Thunder Sword Resources Inc.
(Assessment Office)

