



41N13SW0014 41N13SW0011D1 MICHIPICOTEN ISLAND

010

Diamond Drilling

Area of MICHIPICOTEN ISLAND

Report N^o 15

Work performed by: Advance Red Lake Gold Mines Ltd.

| Claim N ^o | Hole N ^o | Footage | Date | Note |
|----------------------|---------------------|----------------|------|------|
| SSM 75621 | <u>4</u> | <u>1505.0'</u> | 1966 | |
| | TOTAL: 1 DH | 1505' | | |

Notes:

DIAMOND DRILL RECORD

PROPERTY Advance Michipicoten HOLE NO. 4

SHEET NUMBER 1 SECTION FROM 0 TO 1505 STARTED July 4, 1966
 LATITUDE 12.090 DATUM _____ COMPLETED July 12, 1966
 DEPARTURE 2458.0 BEARING N 10 W mag. ULTIMATE DEPTH 1505
 ELEVATION 100' above L. Superior DIP 45° PROPOSED DEPTH 1500

| DEPTH FEET | FORMATION | SAMPLE NO. | WIDTH OF SAMPLE | GOLD g | SLUDGE GOLD g | Copper % |
|------------|---|------------|-----------------|------------|---------------|----------|
| 0-82 | Casing | | | | | |
| 82-1505 | Conglomerate. Small to medium pebbles | 081 | 5.0 ft | 130-135 | | 0.01 |
| | Matrix fine to coarse grit. Pebbles | 082 | 5.0 | 285-290 | | 0.02 |
| | closely packed, sometimes angular. | 083 | 7.5 | 300-304 | | Trace |
| | Various types of Basalt. Many | 084 | 5.0 | 605-610 | | 0.01 |
| | veinlets calcite and red analcite. Copper | 085 | 5.0 | 800-805 | | 0.01 |
| | in small nug at 65'. Copper stain | 086 | 5.0 | 935-943 | | 0.02 |
| | (malachite) sampled. Many calcite | 087 | 0.5 | 1024-1024½ | | 0.02 |
| | stringers. Considerable analcite | 088 | 5.0 | 1465-1470 | | 0.02 |
| | in matrix, giving reddish color. Variable | 089 | 5.0 | 1470-1495 | | 0.02 |
| | intensity of alteration from none to | 090 | 5.0 | 1475-1480 | | 0.02 |
| | early greenstone facies. Calc-Analcite | 091 | 5.0 | 1495-1500 | | 0.01 |
| | at 329, 396, 467, 497, 503, 524, 584, 601 | | | | | |
| | 626, 695, 730, 820, 915, 945, 959, 1006, 1046 | | | | | |
| | and so on with many veinlets in between | | | | | |
| | Copper stain at 97, 658, 800, 935 to 943, | | | | | |
| | 1024, 1465 to 1470, 1497, 1499, 1500 | | | | | |
| | Matrix often red with analcite | | | | | |
| | alteration | | | | | |

N.M.P. TORONTO-STOCK FORM NO. 901 REV. 12/61

DRILLED BY Canadian Logging Ltd

SIGNED H. J. Robinson

On 756 22
DIAMOND DRILL RECORD

PROPERTY Advance Michipicoten HOLE NO. 4

SHEET NUMBER 1 SECTION FROM 0 TO _____ STARTED July 4 1966

LATITUDE N 12090 DATUM _____ COMPLETED July 12 1966

DEPARTURE N 24580 BEARING N 10 W mag. ULTIMATE DEPTH 1505

ELEVATION 100' above Lake Superior DIP 45°, 70°-53°, 140°-62° PROPOSED DEPTH 1500

| DEPTH FEET | FORMATION | SAMPLE NO. | WIDTH OF SAMPLE | GOLDS | BLUES GOLD | Copper % |
|--|--|------------|-----------------|-----------|------------|----------|
| 0-82 | Coarse | 081 | 5.0 | 120-125 | | 0.01 |
| 12-1505 | Conglomerate. Small to medium pebbles | 082 | 5.0 | 285-290 | | 0.02 |
| | Matrix fine to coarse grit. Pebbles | 083 | 3.5 | 300-304 | | Trace |
| | closely packed, sometimes angular to | 084 | 5.0 | 605-610 | | 0.01 |
| | sub-angular. Various types of Basalt | 085 | 5.0 | 800-805 | | 0.01 |
| | Many inclusions of calcite and analcite | 086 | 5.0 | 935-943 | | 0.02 |
| | Copper in small nug @ 150. Many chryso- | 087 | 0.5 | 1024-1025 | | 0.02 |
| | cella stringers in matrix. Considerable | 088 | 5.0 | 1465-1470 | | 0.02 |
| | analcite gives pale red color. Variable | 089 | 5.0 | 1470-1475 | | 0.02 |
| | metamorphism up to early greenschist | 090 | 5.0 | 1475-1480 | | 0.02 |
| | facies. Calc-Analcite @ 329, 396, 467, 497, | 091 | 5.0 | 1495-1500 | | 0.01 |
| | 523, 524, 524, 601, 626, 695, 730, 850, 915, 94E | | | | | |
| | 1006, 1046 and 30 ea. Copper stain @ 97, | | | | | |
| | 1024, 1465, 1470, 1497, 1499, 1500. All | | | | | |
| | Copper appears to be secondary. | | | | | |
| <p>Only 140' can be applied. Remainder under water of Lake Superior. 2/7</p> | | | | | | |

N.M.P. TORONTO-STOCK FORM NO. 801 REV. 12/61

DRILLED BY Canadian Norwegian

SIGNED H. B. Roberson

LAKE SUPERIOR

HOLE N° 4

Bearing N 10 W Mag
 Dip 45° of 0
 53° of 750
 62° of 1400
 Depth 1505'

CORE STORED
 IN SHACK
 IN CL 75706

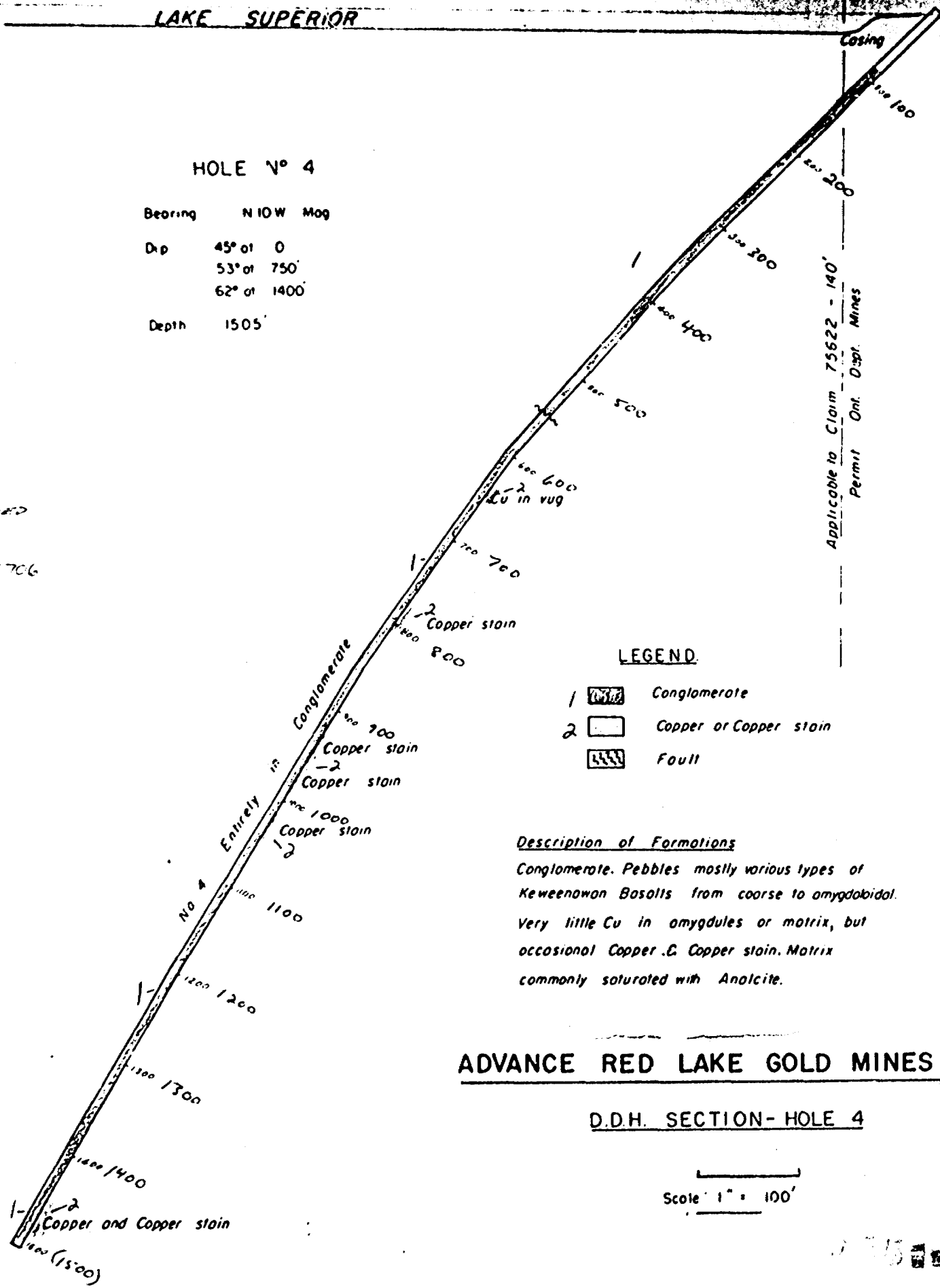

Applicable to Claim 75622 - 140'
 Permit Ont. Dip. Mines

LEGEND.

- 1 [Conglomerate symbol] Conglomerate
- 2 [Copper or Copper stain symbol] Copper or Copper stain
- [Fault symbol] Fault

Description of Formations

Conglomerate. Pebbles mostly various types of Keweenaw Basalts from coarse to amygdaloidal. Very little Cu in amygdules or matrix, but occasional Copper. **C. Copper stain.** Matrix commonly saturated with Analcite.

ADVANCE RED LAKE GOLD MINES LTD.

D.D.H. SECTION - HOLE 4

Scale 1" = 100'

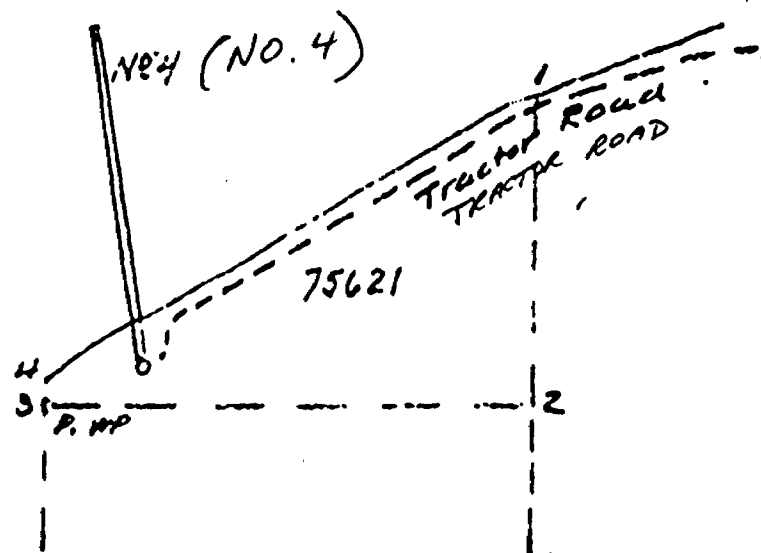

(140 FT ON 75621)
 140 ft on 75621
 1425 ft in LAKE
 see section
 (SEE SECTION)

ADVANCE REDLAKE GM
 ADVANCE RED LAKE GM

HOLE NO. 4 HOLE No. 4
 N10W 1505'

Certificate of Analysis

NO. 7251

to. Advance Red Lake Mines Limited,
347 Bay Street Suite 700,
TORONTO, Ontario.

RECEIVED August 4, 1966

INVOICE NO. 8924

SAMPLE(S) OF split core & rock SUBMITTED TO US SHOW RESULTS AS FOLLOWS.

| <u>Sample No.</u> | <u>% Cu</u> | <u>% Ni</u> |
|-------------------|-------------|-------------|
| 081 | 0.01 | |
| 82 | 0.02 | |
| 83 | Trace | |
| 84 | 0.01 | |
| 85 | 0.01 | Nil |
| 86 | 0.02 | |
| 87 | 0.02 | |
| 88 | 0.02 | |
| 89 | 0.02 | |
| 90 | 0.02 | |
| 91 | 0.01 | |
| 92 | 0.01 | |
| 901 | Trace | |

X-RAY ASSAY LABORATORIES LIMITED

MANAGER



41N13SW0014 41N13SW0011D1 MICHIPICOTEN ISLAND

900

A separate form is required for each type of work to be recorded.

THE MINING ACT REPORT OF WORK

To the Recorder of SAILT STE MARIE Mining Division
ADVANCE RED LAKE GOLD MINES LIMITED A-38202
name of Recorded Holder Miner's Licence
ROOM 700-347 BAY STREET, TORONTO 1, ONTARIO
Post Office Address

do hereby report the performance of 140 days of Diamond Drilling type of work
not before reported to be applied on the following contiguous claims

| Claim No. | Days | Claim No. | Days | Claim No. | Days |
|-----------|------|-----------|------|-----------|------|
| X 75620 | 42 | X 75626 | N11 | X 75631 | N11 |
| X 75621 | 49 | X 75627 | N11 | X 75632 | N11 |
| X 75622 | 49 | X 75628 | N11 | X 75633 | N11 |
| X 75623 | N11 | X 75629 | N11 | X 75634 | N11 |
| ✓ 75646 | N11 | X 75630 | N11 | X 75635 | N11 |

MICHIPICOTEN ISLAND

All the work was performed on Mining Claim (s) 75622 ISLAND
(In the case of geological and/or geophysical survey (s) where more than 18 claims are involved attach a schedule)

READ CAREFULLY: THE FOLLOWING INFORMATION IS REQUIRED BY THE MINING RECORDER.

- For Manual Work, Stripping or Opening up of Mines, Sinking Shafts or Other Actual Mining Operations - Names and addresses of the men who performed the work and the dates and hours of their employment.
- For Diamond and other Core Drilling - Footage, No. and angle of holes and diameter of core. Name and address of owner or operator of drill. Dates when drilling was done. Signed core log and sketch in duplicate.
- For Compressed Air or Other Power Driven or Mechanical Equipment
Type of drill or equipment. Names and addresses of men engaged in operating equipment and the dates and hours of their employment.
- For Power Stripping - Type of equipment. Name and address of owner or operator. Amount expended. Dates on which work was done. Proof of actual cost must be submitted within 30 days of recording.
- With each of the above types of work sketches are required to show the location and extent of the work in relation to the nearest claim post. In the case of diamond or other core drilling the sketch must be submitted in duplicate.
- For Geological and Geophysical Survey - The names and addresses of men employed as well as dates. Type of instrument used in the case of geophysical survey. Reports and maps in duplicate must be filed with the Minister within 60 days of recording.
- For Land Survey - the name and address of Ontario Land surveyor.

The Required Information is as Follows: (Attach a list if this space is insufficient)

NO. 4 - 140 Feet
July 4th to July 12th, 1966
All + 7/8" Core. Hydraulic Drive C.L. Machine

CANADIAN LONGYEAR LIMITED
NORTH BAY, ONTARIO
PETER C. BRENNER, MANAGER

Locational plan on 75584

Date February 15th, 1967

H.S. Robinson
Signature of Recorded Holder or Agent
ADVANCE RED LAKE GOLD MINES LIMITED

The Mining Act
Certificate Verifying Report of Work

HOWARD S. ROBINSON
4800 CHICAGO BEACH DRIVE, CHICAGO, ILLINOIS
(Post Office Address)

S. S. MARIE
MINING DIV.
RECEIVED
FEB 23 1967
AM 7 8 9 10 11 12 P 1 2 3 4 5 6

hereby certify:

- That I have a personal and intimate knowledge of the facts set forth in the report of work annexed here to, having performed the work or witnessed some during and/or after its completion.
- That the annexed report is true.

Dated February 15th, 1967

H.S. Robinson
Signature

S. S. MARIE
MINING DIV.
RECEIVED
MAR 16 1967
AM 7 8 9 10 11 12 P 1 2 3 4 5 6

file on 75622

THE PENALTY FOR MAKING A FALSE STATEMENT IN THIS REPORT AND/OR CERTIFICATE IS \$500. OR SIX MONTHS IMPRISONMENT OR BOTH

CORE SPECIMENS

Specimens from this hole are available for examination at the resident geologist's office, Ontario Department of Mines and Northern Affairs, Sault Ste. Marie.

Company *ADVANCE RED LAKE GOLD MINES LTD.*

Hole no. *4*.....

Depth sampled *0'-1505'*.....

Block no. *E-2-1 TO E-2-2*.....

File no. *ASM. 955*.....

SUMMARY - DIAMOND DRILLING
CANADIAN LONGYEAR - NORTH BAY

NUMBER

DESCRIPTION

NOTES

1 Collar on Claim 75700 ✓
 Bearing - N 10W Mag.
 Dip @ 0 - 55°
 20 58°
 140 60°
 400 62°
 1341 65°
 Length on 75700 - 250'
 Recorded on 75700 500 Days
 Total Depth 1341'

Recorded
 June, 1966

2 Collar on Claim 75700 ✓
 Bearing - N 10W Mag.
 Dip @ 0 - 55°
 Length on 75700 - 139' — *Depth on log 280'*
 Recorded on 75700 278 Days
 Total Depth 139'

Recorded
 June, 1966

3 Collar on Claim 75716 ✓ 75616
 Bearing - N 10W Mag.
 Dip @ 0 - 45°
 385 59°
 1500 59°
 Length on 75716 60'
 Recorded on 75716 60 Days
 Total Depth 1506'

To be recorded
 60 Days

4 Collar on Claim 75622 ✓
 Bearing - N 10W Mag.
 Dip @ 0 - 45°
 750 53°
 1400 52°
 Length on 75622 133-140
 Recorded on 75622 133 Days 141
 Total Depth 1505'

To be recorded
~~133~~ Days
 140

5 Collar on Claim 75711 ✓
 Bearing - N 10W Mag.
 Dip @ 0 - 45°
 375 57°
 Length on 75711 30'
 Recorded on 75711 30 Days
 Total Depth 408'

To be recorded
 30 Days

REGISTRATION
 NOT TO BE REMOVED FROM
 THE OFFICE OF THE RESIDENT
 GEOLOGIST, ONT. DEPT. OF MINES
 SAULT STE. MARIE, ONT.

RECEIVED
 MAR 17 1966
 RESIDENT GEOLOGIST
 SAULT STE. MARIE

1572

SUMMARY - DIAMOND DRILLING
CANADIAN LONGYEAR - NORTH BAY

| <u>NUMBER</u> | <u>DESCRIPTION</u> | <u>NOTES</u> |
|---------------|---|-----------------------------|
| 6A | Collared on Claim 75708 Bearing - N 10W Mag. Dip @ 0 - 40° 215 43° Length on 75708 90' Recorded on 75708 90 Days Total Depth 468' | To be recorded 90 Days |
| 6B | Collared on Claim 75708 Bearing - N 10W Mag. Dip @ 0 - 40° 45 43° 1500 53° Length on 75708 - 113' Recorded on 75708 113 Days Total Depth 1385' | To be recorded 113 Days |
| 7 | Collared on Claim 75704 ✓ Bearing - N 10W Mag. Dip @ 0 - 50° 1000 55° 1500 56° Length on 75704 495' Recorded on 75704 495 Days Total Depth 1505' | To be recorded 495 Days |
| 8 | Collared on Claim 75704 ✓ Bearing - N 10W Mag. Dip @ 0 - 80° 1000 78° 1322 79° Length on 75704 1322' Recorded on 75704 1322 Days Total Depth 1322' | To be recorded 1322 Days |
| 9 | Collared on Claim 75584 ✓ Bearing - N 10W Mag. Dip @ 0 - 65° Length on 75584 - 371' Recorded on 75584 371 Days Total Depth 371' | To be recorded 371 Days |

MSR

SUMMARY OF DRILLING

| <u>WELL</u> | <u>DEPTH</u> | <u>NEAREST CORNER</u> | <u>N. OR S.</u> | <u>E. OR W.</u> | <u>TO BE RECORDED</u> |
|-------------|--------------|-----------------------|-----------------|-----------------|-----------------------|
| 1 | 1341 | 1 - 75700 | - | - | Recorded June, 1966 |
| 2 | 139 | 1 75700 | - | - | Recorded June, 1966 |
| 3 | 1506 | WP-4 75616 | N100 | E135 | 60 Days |
| 4 | 1505 | WP-4 75622 | N100 | E275 | 133 Days |
| 5 | 408 | WP-1 75712 | N690 | E250 | 30 Days |
| 6A | 468 | WP-1 75707 | S75 | N90 | 90 Days |
| 6B | 1385 | WP-1 75707 | S62 | N85 | 43 Days |
| 7 | 1505 | WP-1 75704 | N120 | N125 | 495 Days |
| 8 | 1322 | WP-1 75704 | N120 | N125 | 1322 Days |
| 9 | 371 | No. 4 75584 | S310 | N120 | 371 Days |
| <hr/> | | | | | <hr/> |
| TOTAL | 9,950 | | | | 2,614 DAYS |
| <hr/> | | | | | <hr/> |

H.S.R.

NATIVE COPPER

Native Copper was found as coarse slugs, round grains the size of shot and fine flakes in the Basalts of No. 1, 7 and 8 holes and in cracks in Felsite in No. 7 hole. It seemed to be rather uniformly distributed in an altered section of a wide coarse Gabbro flow in hole No. 1 (Flow 15) in fine flakes and similarly in flows 21 and 22 of hole No. 7, and just below the last Felsite in hole No. 8. Some samples indicate sections of considerable interest and the possibility of locating low-grade Copper ore between hole Nos. 1 and 7. It is thought that vertical holes along the shore would be worth investigating. Some of the results are listed below:-

| <u>HOLE NO:</u> | <u>FROM</u> | <u>TO</u> | <u>WIDTH</u> | <u>% Cu. ASSAY</u> |
|-----------------|-------------|-----------|--------------|------------------------|
| 1 | 600 | 605 | 5.0 | .41 |
| | 605 | 610 | 5.0 | .12 |
| | 610 | 615 | 5.0 | .14 |
| | 615 | 620 | 5.0 | .09 |
| 7 | 691 | 694 | 3.0 | .14 |
| | 705 | 708 | 3.0 | .19 |
| | 710 | 715 | 5.0 | .25 |
| 8 | 830 | 835 | .50 | .20 |
| | 835 | 840 | 5.0 | .53 |
| | 1175 | 1180 | 5.0 | .35 |
| | 1180 | 1185 | 5.0 | .16 |

Assays were made by X-Ray Assay Laboratory, Don Mills, Ontario and in each assay that part of the Copper that would not go through a 200 mesh screen was assayed separately.

Maps (in Duplicate)

Plan 1" - 500' Sheets 1 to 6

Sections 1" - 100' Hole Nos. 3, 4, 5, 6A, 6B, 7 and 8, 9

H. S. Robinson
H. S. ROBINSON,
Member O.A.C.

SUMMARY OF CORE ASSAYS

BY

X-RAY ASSAY LABORATORIES
DON MILLS, ONTARIO

| <u>SOLE NO.</u> | <u>ASSAY NO.</u> | <u>FROM</u> | <u>DEPTH TO</u> | <u>LENGTH FEET</u> | <u>COPPER %</u> |
|-----------------|------------------|-------------|-----------------|--------------------|-----------------|
| 4 | 081 | 130 | 135 | 5.0 | 0.01 |
| | 082 | 285 | 290 | 5.0 | 0.02 |
| | 083 | 300 | 304 | 3.5 | trace |
| | 084 | 605 | 610 | 5.0 | 0.01 |
| | 085 | 800 | 805 | 5.0 | 0.01 |
| | 086 | 938 | 943 | 5.0 | 0.02 |
| | 087 | 1024 | 1025 | 0.50 | 0.02 |
| | 088 | 1465 | 1470 | 5.0 | 0.02 |
| | 089 | 1470 | 1475 | 5.0 | 0.02 |
| | 090 | 1475 | 1480 | 5.0 | 0.02 |
| | 091 | 1495 | 1500 | 5.0 | 0.01 |
| 7 | 094 | 691 | 694 | 3.0 | 0.14 |
| | 095 | 705 | 708 | 3.0 | 0.19 |
| | 096 | 775 | 777 | 2.5 | 0.37 |
| | 106 | 677 | 680 | 3.0 | 0.11 |
| | 105 | 710 | 715 | 5.0 | 0.25 |
| | 104 | " | 850 | 5.0 | 0.06 |
| | 103 | | 855 | 5.0 | 0.04 |
| | 102 | 1275 | 1280 | 5.0 | 0.04 |
| 8 | 098 | 830 | 835 | 5.0 | 0.20 |
| | 099 | 835 | 840 | 5.0 | 0.53 |
| | 101 | 840 | 845 | 5.0 | 0.04 |
| | 107 | at 710 | | 0.1 | 0.67 |
| | 108 | 925 | 926 | 1.0 | 0.02 |
| | 109 | 1122 | 1125 | 3.0 | trace |
| | 110 | 1175 | 1180 | 5.0 | 0.35 |
| | 111 | 1180 | 1185 | 5.0 | 0.16 |

ORIGINAL ASSAY REPORTS ATTACHED

NR

#1 630

#2 175

#3 830

#4 900

#5 240

#6 280

6B 980

7 900

#8 185

9 150

Projected Distances
ON Surface.