



41N14NW0035 2.10498 POINT ISACOR

010

GEOCHEMICAL ASSAYS (ROCK & SOIL)

MISSING LAKE CLAIMS

DOMINION EXPLORERS INC.

1987

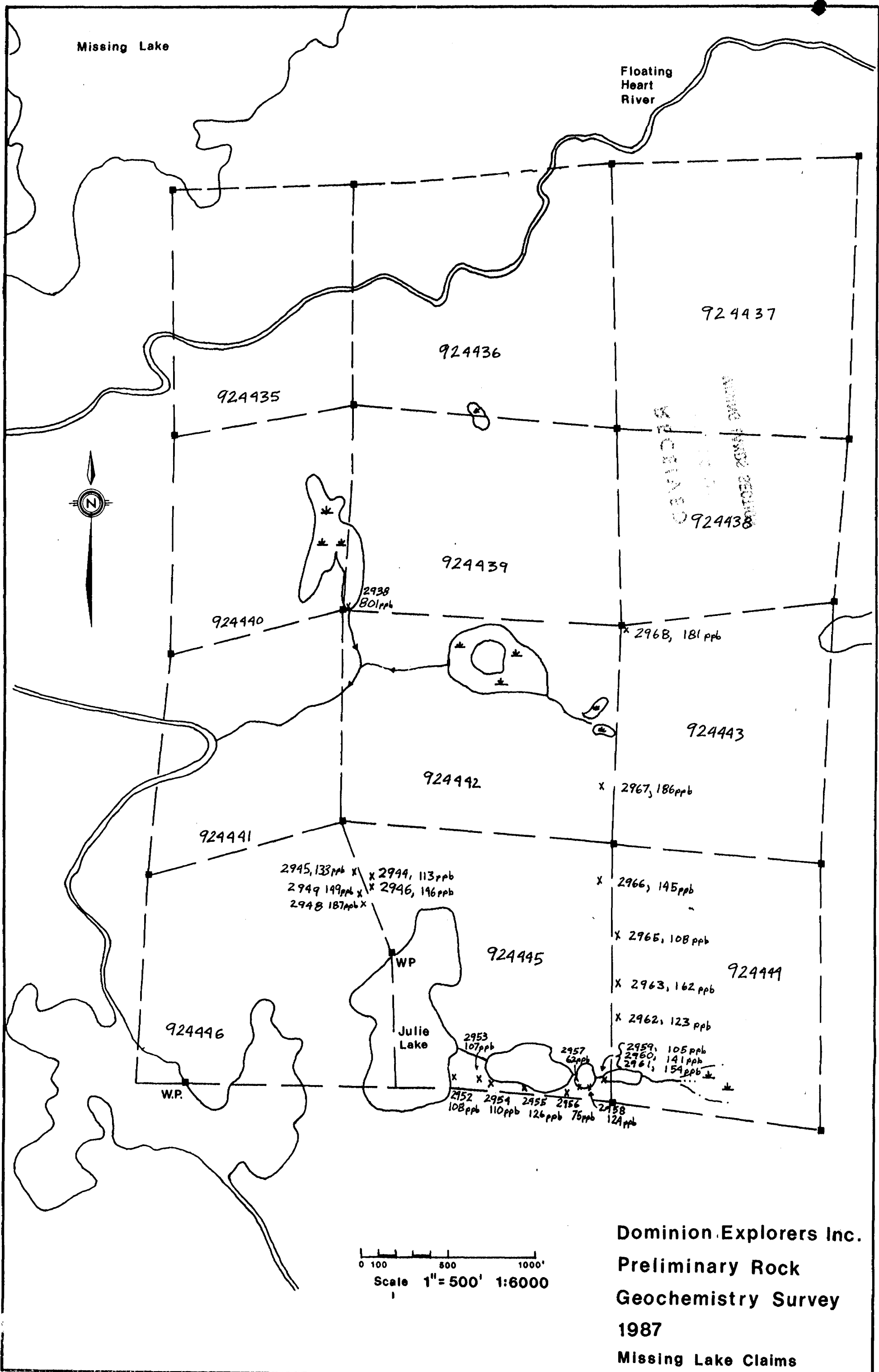

Missing Lake

Floating Heart River



RECEIVED
 MINING AND GEOLOGY
 924438

924437

924436

924435

924439

924440

2938
801ppb

x 2968, 181 ppb

924443

924442

x 2967, 186ppb

924441

2945, 133ppb x
 2949, 149ppb x
 2948, 187ppb x
 x 2944, 113ppb
 x 2946, 196ppb

x 2966, 145ppb

x 2965, 108 ppb

924445

x 2963, 162 ppb

924444

x 2962, 123 ppb

924446

Julie Lake

2953
107ppb

2957
62ppb

2959, 105 ppb
 2960, 141 ppb
 2961, 154 ppb

W.P.

WP

2952, 108ppb
 2954, 110ppb
 2955, 126ppb
 2956, 75ppb
 2958, 124ppb

0 100 500 1000'
 Scale 1" = 500' 1:6000

Dominion Explorers Inc.
 Preliminary Rock
 Geochemistry Survey
 1987
 Missing Lake Claims

Missing Lake

Floating Heart River

Sample Number

Sample Number

Gold Value ppb

924435

924436

924437

924440

924439

924438

924441

924442

924443

924446

924445

924444

Julie Lake

WP

W.P.



0 100 500 1000'
Scale 1" = 500' 1:6000

Sample Number	Gold Value ppb
DRMS - 260	44
259	50
258	46
257	43
256	79
255	77
254	61
253	74
252	25
251	57
DRMS - 250	8
249	63
248	59
247	64
246	56
245	42
244	35
243	21
242	45
241	65
240	57
DRMS - 239	29
238	66
237	58
236	43
235	74
234	55
233	60
232	31
231	60
DRMS - 230	44
229	46
228	87
227	71
226	76
225	30
224	44
223	39
222	57
221	25
DRMS - 220	51
219	64
218	66
217	84
216	78
215	44
214	50
213	50
212	54
DRMS - 210	86
209	60
208	43
207	23
206	44
205	37
204	42
203	-
202	-
DRMS - 200	9
199	22
198	31
197	25
196	19
195	33
194	40
193	11
192	41
191	46
190	40
189	47
188	36
187	37
186	27
DRMS - 185	25
184	21
183	-
182	-
181	11
180	38
DRMS - 179	19
178	25
177	25
176	25
175	-
174	37
173	25
172	25
DRMS - 171	25
170	25
169	25
168	25
167	13
166	17
165	21
164	41
163	47
162	39
161	25
160	25
159	41
158	18
157	25
156	51
DRMS - 153	46

Dominion Explorers Inc.
Preliminary Soil
Survey 1987
Missing Lake Claims

AMENDED REPORT

W.R. #



Ministry of Northern Development and Mining

Report of Work

(Geophysical, Geological, Geochemical and Expenditures)



41N14NW0035 2.10498 POINT ISACOR

900

W8705-147

Mining

Type of Survey(s) **GEOCHEMICAL ASSAYS** Township or Area **POINT ISACOR (MISKATSHIU)**

Claim Holder(s) **DOMINION EXPLORERS INC.** Prospector's License No. **A 35056**

Address **SUITE 916, 111 RICHMOND STREET WEST, TORONTO M5H 2G4**

Survey Company **DOMINION EXPLORERS INC.** Date of Survey (from & to) **1 08 87 3 08 87** Total Miles of line Cut **-**

Name and Address of Author (of Geo-Technical report) **M. K. KEARNEY (AS ABOVE)** **UNIVERSITY GEOLOGICAL SURVEY ASSESSMENT FILES**

Credits Requested per Each Claim in Columns at right

Special Provisions	Geophysical	Days per Claim
For first survey: Enter 40 days. (This includes line cutting)	- Electromagnetic	
	- Magnetometer	
For each additional survey: using the same grid: Enter 20 days (for each)	- Radiometric	
	- Other	
	Geological	
	Geochemical	3.06

Man Days	Geophysical	Days per Claim
Complete reverse side and enter total(s) here	- Electromagnetic	
	- Magnetometer	
	- Radiometric	
	- Other	
	Geological	
	Geochemical	

Airborne Credits	Geophysical	Days per Claim
Note: Special provisions credits do not apply to Airborne Surveys.	Electromagnetic	
	Magnetometer	
	Radiometric	

Mining Claims Traversed (List in numerical sequence)

Prefix	Mining Claim Number	Expend. Days Cr.	Prefix	Mining Claim Number	Expend. Days Cr.
	924435	15.8			
	924436	15.8			
	924437	15.8			
	924438	15.8			
	924439	15.8			
	924440	15.8			
	924441	15.8			
	924442	15.8			
	924443	15.8			
	924444	15.8			
	924445	15.8			
	924446	15.8			

RECEIVED RECEIVED

NOV 09 1987 NOV 02 1987

MINING LANDS SECTION MINING LANDS SECTION

SAULT STE MARIE MINING DIV.
RECEIVED
NOV 4 1987
A.M. 7:18 P.M. 4:53

Expenditures (excludes power stripping)

Type of Work Performed **ASSAY EXPENDITURES**

Performed on Claim(s) **924435 SSM - et al**

Calculation of Expenditure Days Credits

Total Expenditures **\$ 2,851.75** ÷ Total Days Credits **15** = **190.12**

Instructions
Total Days Credits may be apportioned at the claim holder's choice. Enter number of days credits per claim selected in columns at right.

For Office Use Only

Total Days Cr. Recorded **226.3** Date Recorded **Nov. 4/87** Mining Recorder **G. A. Kusylo**

Date Approved or Recorded **24 Dec 87** Branch Director **W. Brown**

Date **Oct. 22/87** Recorded Holder or Agent (Signature) **M. K. Kearney**

Certification Verifying Report of Work for **DOMINION EXPLORERS INC.**

I hereby certify that I have a personal and intimate knowledge of the facts set forth in the Report of Work annexed hereto, having performed the work or witnessed same during and/or after its completion and the annexed report is true.

Name and Postal Address of Person Certifying **DOMINION EXPLORERS INC, 916-111 RICHMOND ST. WEST TORONTO**

Date Certified **Sept. 4/87** Certified by (Signature) **M. Kearney**

REFERENCES

AREAS WITHDRAWN FROM DISPOSITION

- M.R.O. - MINING RIGHTS ONLY
- S.R.O. - SURFACE RIGHTS ONLY
- M.+S. - MINING AND SURFACE RIGHTS

Description	Order No.	Date	Disposition	File
SEC 34D MG ACT	23A/01			169051
GAP RECORD STATION			DEPT. OF NATIONAL REFERENCE	
			WITHDRAWN FROM STAKING	

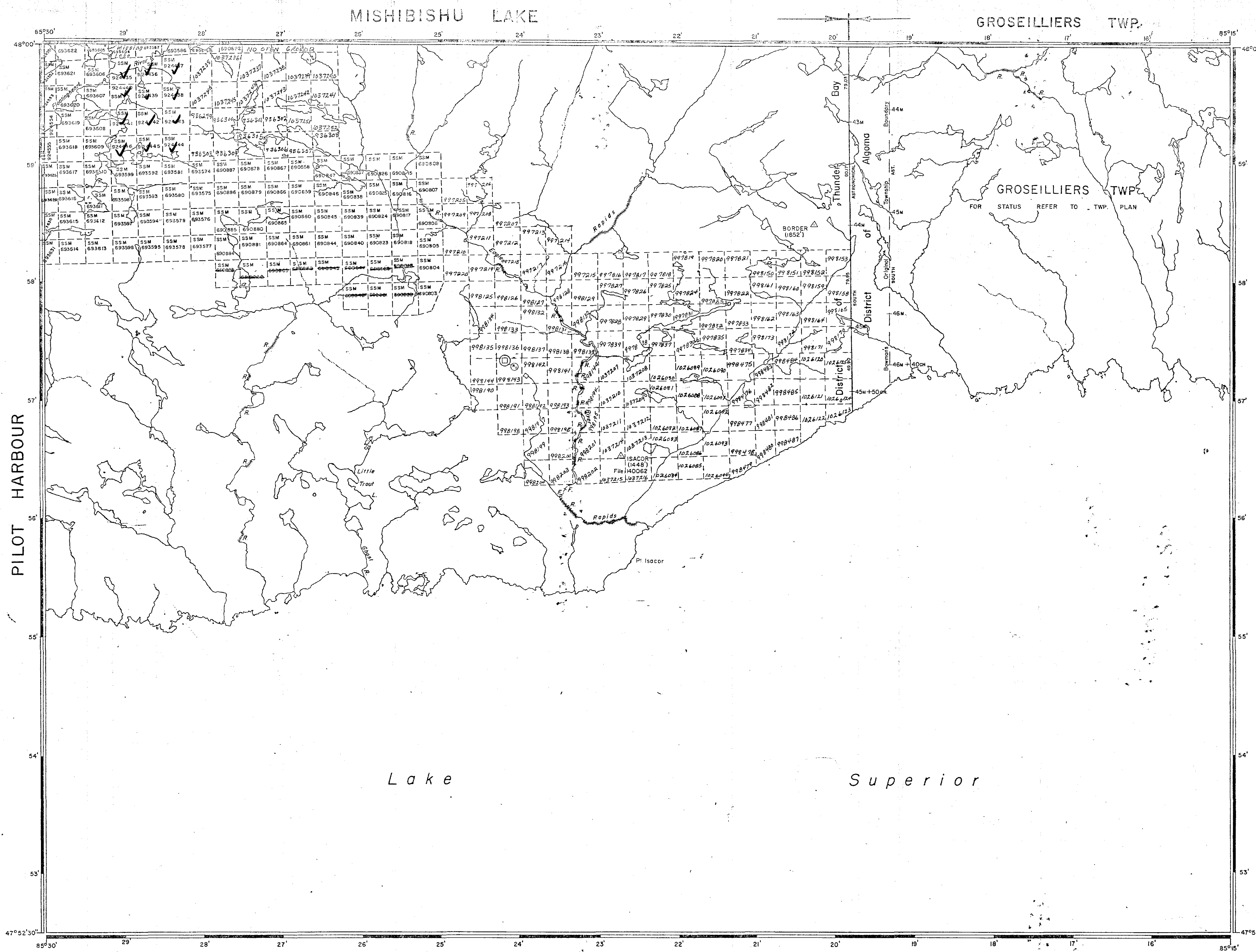

LEGEND

- HIGHWAY AND ROUTE No.
- OTHER ROADS
- TRAILS
- SURVEYED LINES:
 - TOWNSHIPS, BASE LINES, ETC.
 - LOTS, MINING CLAIMS, PARCELS, ETC.
- UNSURVEYED LINES:
 - LOT LINES
 - PARCEL BOUNDARY
 - MINING CLAIMS ETC.
- RAILWAY AND RIGHT OF WAY
- UTILITY LINES
- NON-PERENNIAL STREAM
- FLOODING OR FLOODING RIGHTS
- SUBDIVISION OR COMPOSITE PLAN
- RESERVATIONS
- ORIGINAL SHORELINE
- MARSH OR MUSKEG
- MINES
- TRAVERSE MONUMENT

DISPOSITION OF CROWN LANDS

TYPE OF DOCUMENT	SYMBOL
PATENT, SURFACE & MINING RIGHTS	⊙
" SURFACE RIGHTS ONLY	○
" MINING RIGHTS ONLY	⊙
LEASE, SURFACE & MINING RIGHTS	⊙
" SURFACE RIGHTS ONLY	⊙
" MINING RIGHTS ONLY	⊙
LICENCE OF OCCUPATION	⊙
ORDER-IN-COUNCIL	OC
RESERVATION	⊙
CANCELLED	⊙
SAND & GRAVEL	⊙

NOTE: MINING RIGHTS IN PARCELS PATENTED PRIOR TO MAY 6, 1913, VESTED IN ORIGINAL PATENTEE BY THE PUBLIC LANDS ACT, R.S.O. 1970, CHAP. 380, SEC. 63, SUBSEC. 1.

SCALE: 1 INCH = 40 CHAINS

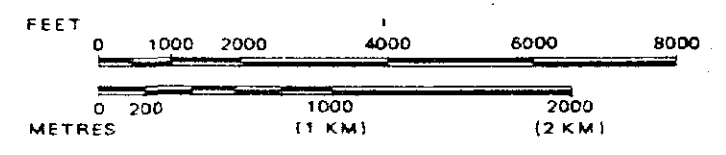

DATE OF ISSUE
DEC 11 1987
SAULT STE. MARIE
MINING RECORDS OFFICE

AREA
POINT ISACOR
M.N.R. ADMINISTRATIVE DISTRICT
WAWA
MINING DIVISION
SAULT STE. MARIE
LAND TITLES / REGISTRY DIVISION
THUNDER BAY

Ministry of Natural Resources Ontario
Ministry of Northern Development and Mines

Date FEBRUARY 1987
Number **G-3778**

