

MCMURRAY-0049 #1

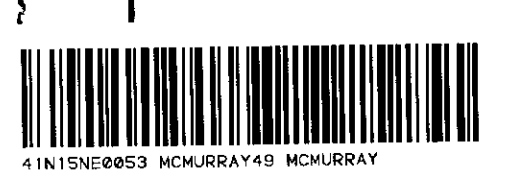



TABLE OF FORMATIONS

LATE PRECAMBRIAN

5 DIABASE

EARLY PRECAMBRIAN (ARCHEAN)

4 META - INTRUSIVE ROCKS

- 4 a Granodiorite, trondhjemite
- 4 b Quartz diorite
- 4 c Intrusive breccia, xenolithic
- 4 d Diorite

3 META-SEDIMENTARY ROCKS

- 3 a Lithic graywacke
- 3 b Pelitic tuff
- 3 c Mafic tuff
- 3 d Gold-bearing rock
- 3 e Sulphide-bearing rock
- 3 f Tuff-chert, cherty breccia
- 3 g Polymictic breccia with granitic clasts
- 3 h Polymictic breccia with volcanic clasts

2 INTERMEDIATE METAVOLCANIC ROCKS

- 2 a Medium-grained flow or sill
- 2 b Feldspar crystal tuff
- 2 c Feldspar crystal-lapilli tuff
- 2 d Fine-grained tuff
- 2 e Feldspar crystal tuff-breccia

1 FELSIC METAVOLCANIC ROCKS

- 1 a Medium-grained flow or sill
- 1 b Quartz crystal tuff
- 1 c Quartz crystal-lapilli tuff
- 1 d Fine-grained tuff
- 1 e Quartz crystal tuff-breccia

SYMBOLS

- Quartz vein (inclined, vertical)
- Schistosity (inclined, vertical)
- Bedding (inclined, vertical, tops)
- Lineation with plunge (c=clast; a=drag fold, m=mineral, q=quartz lens)
- Geological contact
- Metamorphic transition
- Fault
- Shaft with depth in feet (vertical, inclined with plunge)
- Underground workings projected to surface
- Pit and trench
- Mine dump
- Gold occurrence
- Outcrop
- Quartz lens
- Diamond drill hole

DUNRAINE MINES LIMITED
DARWIN PROPERTY - WAWA, ONTARIO

OUTCROP MAP
SCALE
1:2400

0 600
FEET

GEOLOGY BY P.A. STUDEMEISTER Ph.D. 1983.
DRAWN BY G.J. BOISVERT & D.J. GIGNAC
MAY and JUNE, 1983

MCMURRAY-0049 #1

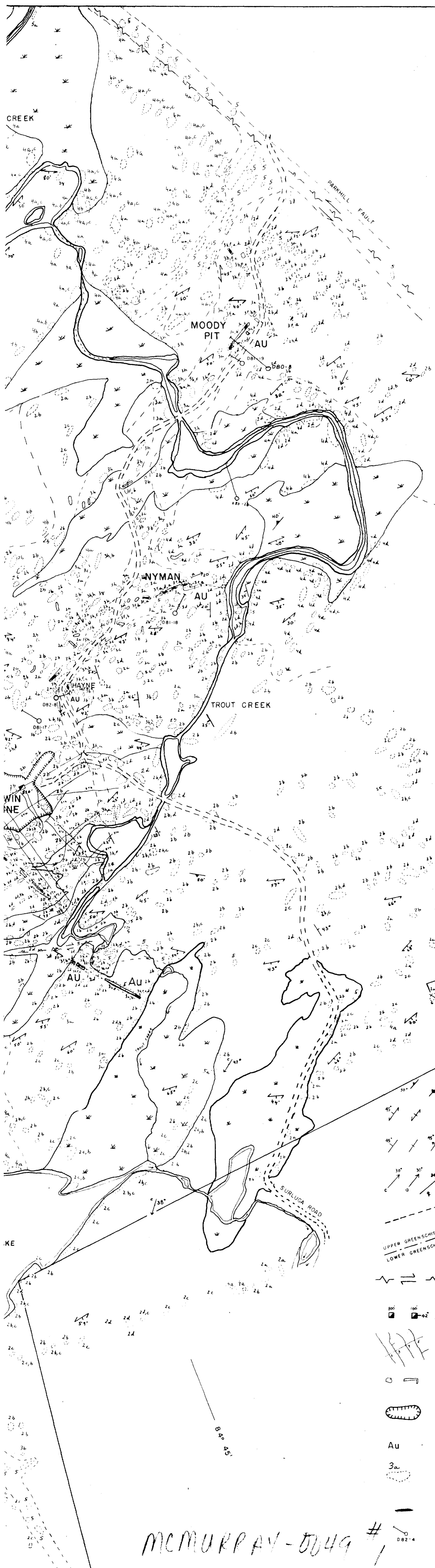

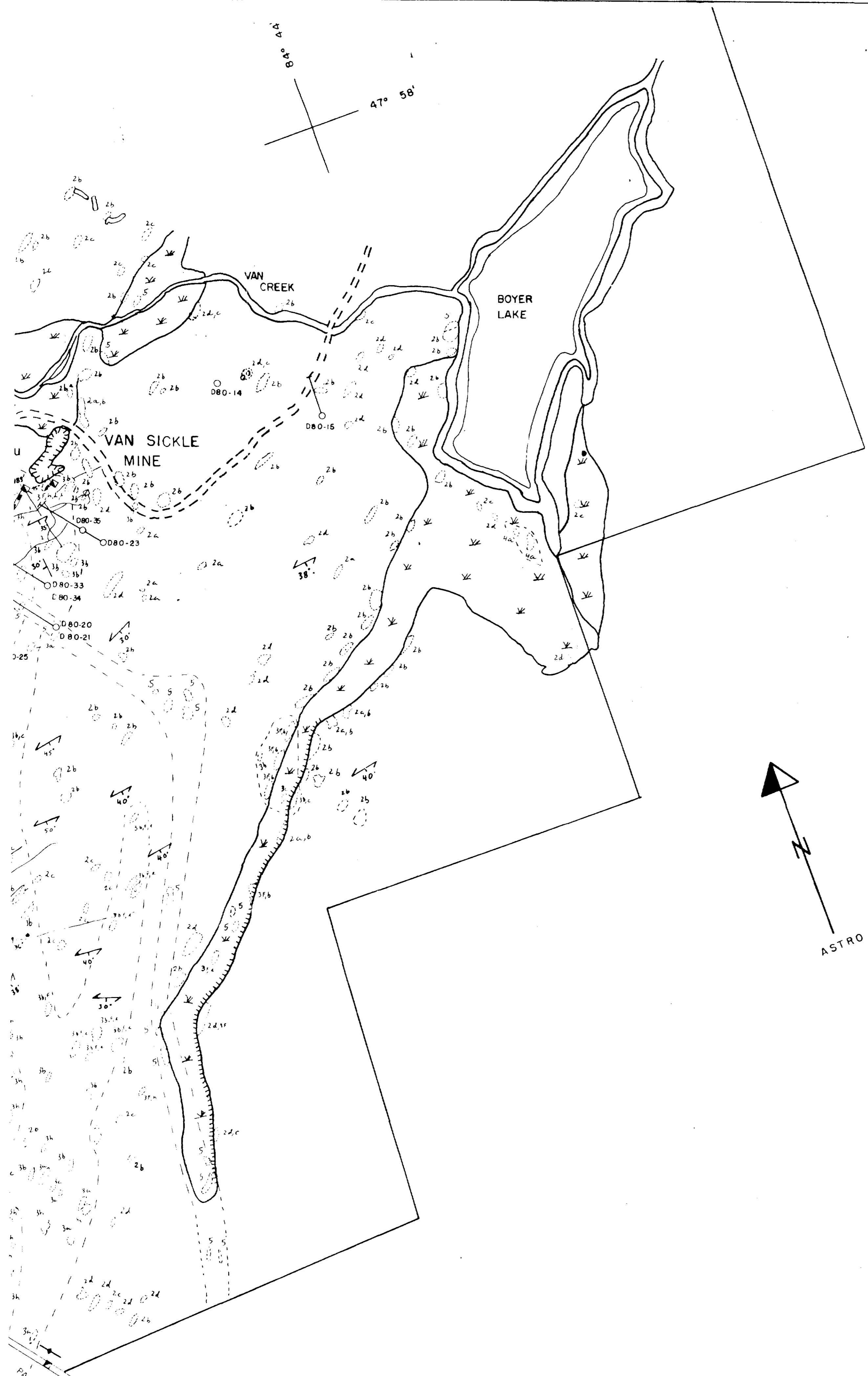

TABLE OF FORMATIONS

LATE PRECAMBRIAN

5 Diabase

EARLY PRECAMBRIAN (ARCHEAN)

4 META-INTRUSIVE ROCKS

- 4 a Granodiorite, trondhjemite
- 4 b Quartz diorite
- 4 c Intrusive breccia, xenolithic
- 4 d Diorite

3 META-SEDIMENTARY ROCKS

- 3 a Lithic graywacke
- 3 b Pelitic tuff
- 3 c Mafic tuff
- 3 d Gold-bearing rock
- 3 e Sulphide-bearing rock
- 3 f Tuff-chert, cherty breccia
- 3 g Polymictic breccia with granitic clasts
- 3 h Polymictic breccia with volcanic clasts

2 INTERMEDIATE METAVOLCANIC ROCKS

- 2 a Medium-grained flow or sill
- 2 b Feldspar crystal tuff
- 2 c Feldspar crystal-lapilli tuff
- 2 d Fine-grained tuff
- 2 e Feldspar crystal tuff-breccia

1 FELSIC METAVOLCANIC ROCKS

- 1 a Medium-grained flow or sill
- 1 b Quartz crystal tuff
- 1 c Quartz crystal-lapilli tuff
- 1 d Fine-grained tuff
- 1 e Quartz crystal tuff-breccia



SYMBOLS

- Quartz vein (inclined, vertical)
- Schistosity (inclined, vertical)
- Bedding (inclined, vertical, tops)
- Lamination with plunge (c=clast; a=fold axis, m=mineral, g=quartz lens)
- Geological contact
- Metamorphic transition (UPPER GREENSCHIST / LOWER GREENSCHIST)
- Fault
- Shaft with depth in feet (vertical, inclined with plunge)
- Underground workings projected to surface
- Pit and trench
- Mine dump
- Au Gold occurrence
- Outcrop
- Quartz lens
- Diamond drill hole (D80-18)

MCMURRAY-6449 #2

DUNRAINE MINES LIMITED
 PARKHILL PROPERTY - WAWA ONTARIO
OUTCROP MAP
 SCALE 1:2400
 0 600 FEET
 GEOLOGY BY P. A. STUDEMEISTER Ph.D.
 DRAWN BY G. J. BOISVERT & D. J. GIGNAC
 MAY and JUNE, 1983