



010

GEOLOGICAL REPORT OF CLAIM SSM 581686

BY DANIEL J. GIGNAC

DUNRAINE MINES LTD.

WAWA, ONTARIO.

Location:

Claim SSM 581686 is situated in McMurray Twp. immediately to the west of claim SSM 3124, approximately 2.5 miles south-east of the town of Wawa in the Algoma District.

The Parkhill Gold Mine is located 600 feet to the east of the number three post of the claim. This wedge shaped claim has an area of 2.98 acres.

Geology:

Five different rock types were observed on this claim. (as per map)

Unit numbers 1 and 4 are felsic volcanics. A distinction exists as unit 4 is a feldspar crystal tuff and unit 1 is a fine grained felsic volcanic tuff.

The felsic volcanic outcrops on this claim are fairly massive as opposed to those found nearer the Parkhill mine which display graded bedding and banding and are probably reworked.

A narrow band of conglomerate (unit 2) occurs three hundred feet north of the number three post.

A granodiorite intrusion (unit 5) occupies the north half of the claim. This intrusion is part of the so-called Jubilee Stock and is a major geologic feature in the township.

Finally, a mafic intrusive rock (unit 6) diabase mostly, is located in two areas on the claim. The most important area

being at the south tip of the wedge.

A wide diabase dyke occupies a fault zone which displaces the Parkhill vein system some 1800 feet to the south. A narrower dyke, 80 to 100 feet to the east, parallels the major one and probably occupies the same zone of weakness as the rocks between the dykes are badly fractured and altered.

Three minor quartz-carbonate veins (E-W striking) are situated in the central portion of the fraction. These veins are narrow and barren and occupy the contact between the granodiorite stock and felsic volcanics. They have little if any economic value.

Submitted May 31, 1982



Daniel J. Gignac

Dunraine Mines Ltd.

P.O. Box 265

WaWa Ontario.

Pos-1k0

2.4844

SSM 3135

SSM 3129

SSM 3124

SSM 3406

SSM 3109

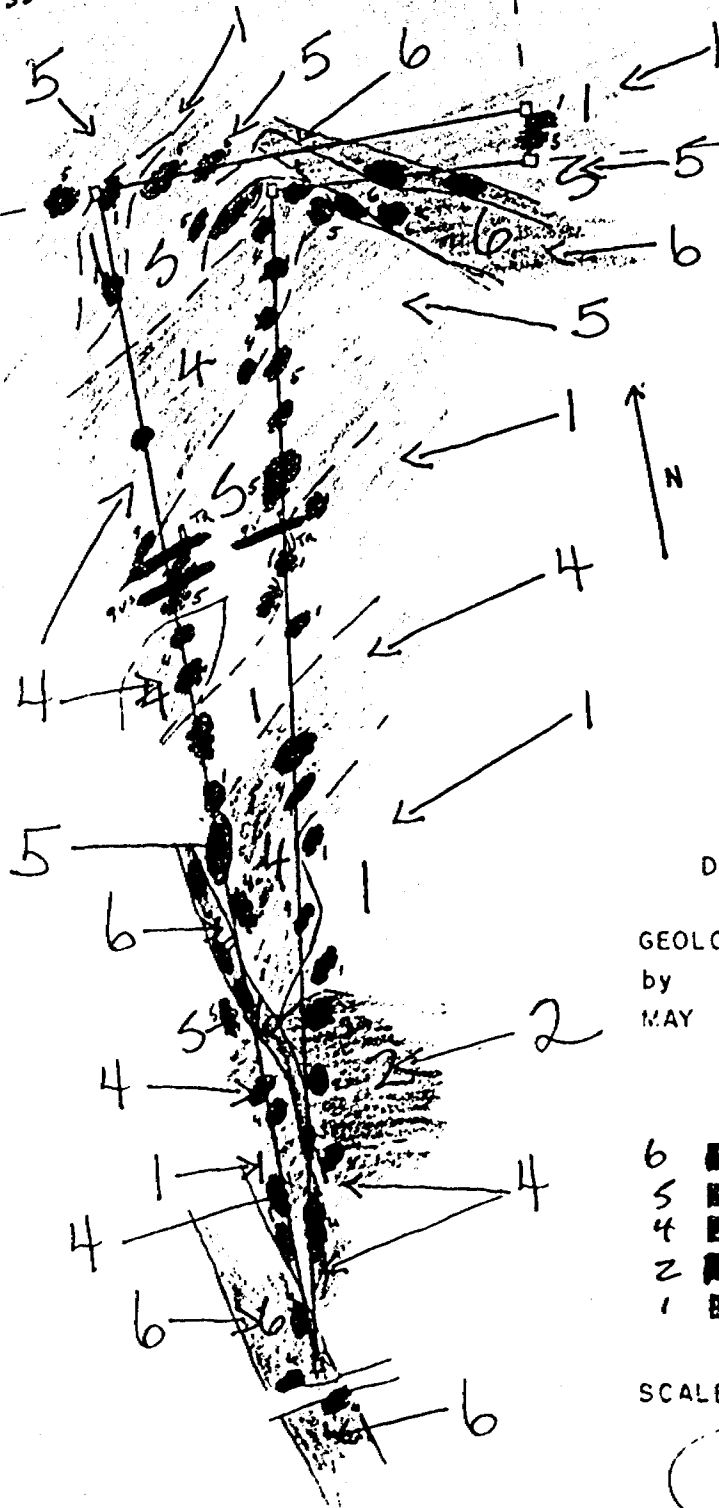

DUNRAINE MINES LIMITED

GEOLOGY OF CLAIM SSM 56656
by DANIEL J. GIGNAC
MAY 18 1982

LEGEND

- 6 DIABASE
- 5 GRANODIORITE
- 4 FELSIC VOLCANICS
- 2 CONGLOMERATE
- 1 METAVOLCANICS

SCALE: ONE INCH TO TWO HUNDRED FEET

Daniel J. Gignac

2.4844

References: Geological Series Preliminary Map P2441
Precambrian Geology of McMurray Township
Wawa Area, Ontario.
by R. P. Sage O.G.S. 1982

2.4844

CERTIFICATE OF QUALIFICATION

for

DANIEL J. GIGNAC

RECEIVED

APR 15 1983

MINING LANDS SECTION

- Graduated, University of Waterloo, Waterloo Ontario, 1980. - Bachelor Degree Environmental Studies, minor Geology. -

- Successfully completed year one of Mining Technology Program at Northern College, Haileybury School of Mines, Haileybury Ontario, 1979.

- Have been employed as Exploration Geologist May to December 1980, May to September 1981 by Dunraine Mines Ltd. Toronto.
September to December 1981, June and July 1982, November 1982 to present by J-Q Resources Inc. Toronto.

signed,

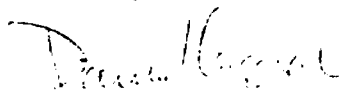

Daniel J. Gignac B.E.S.

Date
1983 08 22

Mining Recorder's Report of
Work No.

Recorded Holder
JOHN S. GRANT

Township or Area
McMURRAY TOWNSHIP

Type of survey and number of Assessment days credit per claim	Mining Claims Assessed
Geophysical Electromagnetic _____ days Magnetometer _____ days Radiometric _____ days Induced polarization _____ days Other _____ days	SSN 581686
Section 77 (19) See "Mining Claims Assessed" column	
Geological _____ 28 _____ days	
Geochemical _____ days	
Man days <input checked="" type="checkbox"/> Airborne <input type="checkbox"/> Special provision <input type="checkbox"/> Ground <input checked="" type="checkbox"/>	
<input type="checkbox"/> Credits have been reduced because of partial coverage of claims. <input checked="" type="checkbox"/> Credits have been reduced because of corrections to work dates and figures of applicant.	

Special credits under section 77 (16) for the following mining claims

No credits have been allowed for the following mining claims

not sufficiently covered by the survey Insufficient technical data filed

The Mining Recorder may reduce the above credits if necessary in order that the total number of approved assessment days recorded on each claim does not exceed the maximum allowed as follows: Geophysical — 80; Geological — 40; Geochemical — 40; Section 77 (19) — 60;
828 (83/6)

1. Type of Survey Geological

2. Township or Area Mc Murray

3. Numbers of Mining Claims Traversed by Survey

SSM - 581684

Reason for credit reduction:

- DDH set up a core logging not part of

Geological Survey

4. Number of Miles

*5. Number of Station

- no proof of linecutting on map or in

*6. Make and type of

report. Possibly considered linecutting

*7. Scale Constant of

& claim staking one in the same.

*8. Frequency Used as

Monday
4 days x 7 = 28 days/claim

July 6/83

Ray

9. Summary of Assessment Credits (details on reverse side)

Total 8 hour Technical Days (Include Consultants, Draughting etc.) 5

Total 8 hour Line-Cutting Days /

Calculation

$$\frac{5}{\text{Technical}} \times 7 = \frac{35}{\text{Line-cutting}} + \frac{1}{\text{Number of claims}} = \frac{36}{\text{Assessment credits per claim}}$$

The dates listed on this form represent working time spent entirely within the limits of the above listed claims Check

If otherwise, please explain - Line cutting - mine area grid at 100 ft

intervals - four North-South lines run through claim - Geological Survey Followed claim land survey lines

Dated: June 30/83

Signed: Dominic Agnace

RECEIVED

- Note: (A) * Complete only if applicable.
 (B) Complete list of names, addresses and dates on July 5 1983.
 (C) Submit separate breakdown for each type of survey.
 (D) Submit in duplicate.

MINING LANDS SECTION

FIELD WORK

<u>Type of Work</u>	<u>Name & Address</u>	<u>Dates Worked</u>	<u>Number of 8 hour days</u>
Geological Survey	D. Gignac Wawa	May/82	1
Diamond Drill location set up + core logging	- D. Gignac Wawa	Nov/82	1

CONSULTANTS

<u>Name & Address</u>	<u>Dates Worked (specify in field or office)</u>	<u>Number of 8 hour days</u>	
H. G. Harper	- Willowdale Ont (office)	May 82	1

DRAUGHTSMAN, TYPING, OTHERS (specify)

<u>Name & Address</u>	<u>Type of Work</u>	<u>Dates Worked</u>	<u>Number of 8 hour days</u>
D. Gignac	draughting	may 82	1
G. Kozar	typing	may 82	1
TOTAL 8 HOUR TECHNICAL DAYS			5

LINE-CUTTING

<u>Name</u>	<u>Address</u>	<u>Dates Worked</u>	<u>Number of 8 hour days</u>
Gaston Grattan	Wawa	May 1980	1
TOTAL 8 HOUR LINE-CUTTING DAYS			1

1. Type of Survey Geological

2. Township or Area Mc Murray

3. Numbers of Mining Claims Traversed by Survey
SSM - 581686

4. Number of Miles of Line Cut 0.6 ^{- claim survey} lines Flown n/a

*5. Number of Stations Established

*6. Make and type of Instrument Used

*7. Scale Constant or Sensitivity

*8. Frequency Used and Power Output

9. Summary of Assessment Credits (details on reverse side)

Total 8 hour Technical Days (Include Consultants, Draughting etc.) 5

Total 8 hour Line-Cutting Days 1

Calculation

$$\frac{5}{\text{Technical}} \times 7 = \frac{35}{\text{Line-cutting}} + \frac{1}{\text{Number of claims}} = \frac{36}{\text{Assessment credits per claim}}$$

The dates listed on this form represent working time spent entirely within the limits of the above listed claims Check
If otherwise, please explain line cutting - mine area grid at 100 ft intervals
- Four North-South lines run through claim - Geological survey
Followed claim land survey lines

Dated: June 30 / 83

Signed: Daniel Lopez

RECEIVED

- Note:
- (A) * Complete only if applicable.
 - (B) Complete list of names, addresses and dates on JUL 5 1983.
 - (C) Submit separate breakdown for each type of survey.
 - (D) Submit in duplicate.

MINING LANDS SECTION

FIELD WORK

<u>Type of Work</u>	<u>Name & Address</u>	<u>Dates Worked</u>	<u>Number of 8 hour days</u>
Geological Survey	- D. Gignac Wawa	May/82	1
Diamond Drill location set up and core logging	- D. Gignac Wawa	Nov/81	1

CONSULTANTS

<u>Name & Address</u>	<u>Dates Worked (specify in field or office)</u>	<u>Number of 8 hour days</u>
H. G. Harper - Willowdale Ont (office)	May/82	1

DRAUGHTSMAN, TYPING, OTHERS (specify)

<u>Name & Address</u>	<u>Type of Work</u>	<u>Dates Worked</u>	<u>Number of 8 hour days</u>
D. Gignac	draughting	May 82	1
Golda Logkaya	typing	May 82	1
TOTAL 8 HOUR TECHNICAL DAYS			<u>5</u>

LINE-CUTTING

<u>Name</u>	<u>Address</u>	<u>Dates Worked</u>	<u>Number of 8 hour days</u>
Barton Cratton	Wawa	May/80	1
REMI DOR			
TOTAL 8 HOUR LINE-CUTTING DAYS			<u>1</u>

Mining Lands Comments

- no qualifications
 - report not signed
 - no key map
 - ~~claim numbers not on map~~ - number is on title on map.
 - map not signed
- This is OK.

To: Geophysics

Comments

Approved

Wish to see again with corrections

Date

Signature

To: Geology - Expenditures

Mr Kustra

Comments

*sign report, map
key map - otherwise OK
if the claim is less than 3 acres - a proportionate credit
should be assigned - 3 days?*

Approved

Wish to see again with corrections

Date

Jan 19/83

Signature

Kustra

To: Geochemistry

Comments

LD

Approved

Wish to see again with corrections

Date

Signature

To: Mining Lands Section, Room 6462, Whitney Block.

(Tel: 5-1380)

1982 06 16

2.4844

Mining Recorder
Ministry of Natural Resources
75 Elgin Street
P.O. Box 669
Sault Ste. Marie, Ontario
P6A 5N2

Dear Madam:

We have received reports and maps for a Geological Survey submitted under Special Provisions (credit for Performance and Coverage) on Mining Claim: SSH 581686 in the Township of McMurray.

This material will be examined and assessed and a statement of assessment work credits will be issued.

Yours very truly,

E.F. Anderson
Director
Land Management Branch

Whitney Block, Room 6450
Queen's Park
Toronto, Ontario
M7A 1W3
Phone: 416/965-1316

J. Skura/amc

cc: John S. Grant
Toronto, Ontario

cc: Dunraine Mines Ltd/Attn: Mr. Daniel Gignac
Wawa, Ontario

1983 03 24

2.4844

Mr. John S. Grant
Suite 2500
390 Bay Street
25th Floor
Toronto, Ontario
M5H 2W7

Dear Sir:

RE: Geological Survey submitted on Mining Claim
SSM 581686 et al in the Township of McMurray

Enclosed are the plans and final page of the report, in duplicate, for the above mentioned survey. In order to complete your submission we require the following:

- a) the final pages and maps must be signed,
- b) a brief resume stating the qualifications of the author of the report for our records
- copy of guidelines enclosed.

For further information, please contact Mr. F.W. Matthews at 416/965-1380.

Yours very truly,

E.F. Anderson
Director
Land Management Branch

Whitney Block, Room 6450
Queen's Park
Toronto, Ontario
M7A 1W3
Phone: 416/965-1380

A. Barr:sc

Encls:

cc: Mining Recorder

D. J. Gignac
Box 265
Unwa. Ontario

RECEIVED	
Land Management Branch	
CIRCULATE	<input checked="" type="checkbox"/>
COMMENTS PLEASE	<input type="checkbox"/>
BY	
APR 15 1983	
E. F. ANDERSON	
J. R. MORTON	
J. C. SMITH	
G. SHERMAN	
J. M. SMALL	
RETURN TO R.6450	

Mr. E. F. Anderson
M. N. R.
Land Management Director
Queen's Park
Toronto, Ontario

April, 11 1983

re: Geological survey of Mining Claim
SSM 581686 Township of McMurray.

Dear Sir:

Enclosed please find the required signed final pages and maps of the report I submitted to your office in May of 1982.

You will also find two signed copies of my qualification certificate.

I apologize for the inconvenience.

Truly,

Daniel Gignac

May 25, 1983

2.4844

John S. Grant
Suite 2500
390 Bay Street
25th Floor
Toronto, Ontario
M5H 2W7

Dear Sirs:

RE: Geological Survey submitted on Mining Claim SSM 581686
in the Township of McMurray

Examination of your Geological Survey Report and Map covering the above Mining Claim in McMurray Township reveals that assessment of your requested credits may not be considered using the Special Provisions method. This is due to the very small size of your claim.

Credits will be allowed, however, under the man-day method provided you complete and return the enclosed man-day breakdown forms.

Yours very truly,

E.F. Anderson
Director
Land Management Branch

Whitney Block, Room 6450
Queen's Park
Toronto, Ontario
M7A 1W3
Phone: 416/965-1380

R. Pichette/mc
Encls:

cc: Mining Recorder
Sault Ste. Marie, Ontario

RECEIVED	
Land Management Branch	
CIRCULATE	<input type="checkbox"/>
COMMENTS PLEASE	<input type="checkbox"/>
BY	
JUL - 5 1983	
E. F. ANDERSON	
J. R. MORTON	
J. C. SMITH	
G. SHERMAN	
J. M. SMITH	
RETURN TO R. 8450	

June 30/83

E. F. Anderson
 Land Management Branch
 M. W. R.
 Toronto.

Dear Sir:

Enclosed, please find (in duplicate) the Assessment Work Breakdown for our claim number SSM 581684 - requested to Mr. J. S. Grant in May of this year.

Hopefully every thing is in order.

Truly

D. J. Gignac
 Durraine Mines
 Wawa Ont.
 P.O. 5-140.

RECEIVED

JUL 5 1983

MINING LANDS SECTION

Sept 12, 83

1983 08 22

Your file:

Our file: 2.4844

Mrs. M.V. St. Jules
Mining Recorder
Ministry of Natural Resources
875 Queen Street East
P.O. Box 669
Sault Ste. Marie, Ontario
P6A 5N2

Dear Madam:

Enclosed are two copies of a Notice of Intent with statements listing a reduced rate of assessment work credits to be allowed for a technical survey. Please forward one copy to the recorded holder of the claims and retain the other. In approximately fifteen days from the above date, a final letter of approval of these credits will be sent to you. On receipt of the approval letter, you may then change the work entries on the claim record sheets.

For further information, if required, please contact Mr. F.W. Matthews at 416/965-1380.

Yours very truly,

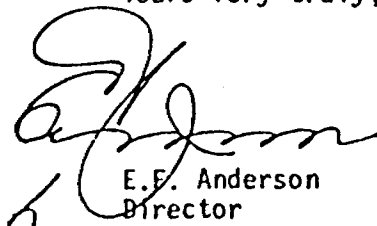

E.F. Anderson
Director
Land Management Branch

Whitney Block, Room 6450
Queen's Park
Toronto, Ontario
M7A 1W3
Phone: 416/965-1316

John
R. Pichette:sc

Encls:

cc: Mr. John S. Grant
Suite 2500
390 Bay Street
25th Floor
Toronto, Ontario
M5H 2W7

Cc: Mr. G.H. Ferguson
845 Mining & Lands Commissioner



Ministry of
Natural
Resources

Ontario

Notice of Intent for Technical Reports

1983 08 22

2.4844

An examination of your survey report indicates that the requirements of The Ontario Mining Act have not been fully met to warrant maximum assessment work credits. This notice is merely a warning that you will not be allowed the number of assessment work days credits that you expected and also that in approximately 15 days from the above date, the mining recorder will be authorized to change the entries on his record sheets to agree with the enclosed statement. Please note that until such time as the recorder actually changes the entry on the record sheet, the status of the claim remains unchanged.

If you are of the opinion that these changes by the mining recorder will jeopardize your claims, you may during the next fifteen days apply to the Mining and Lands Commissioner for an extension of time. Abstracts should be sent with your application.

If the reduced rate of credits does not jeopardize the status of the claims then you need not seek relief from the Mining and Lands Commissioner and this Notice of Intent may be disregarded.

If your survey was submitted and assessed under the "Special Provision-Performance and Coverage" method and you are of the opinion that a re-appraisal under the "Man-days" method would result in the approval of a greater number of days credit per claim, you may, within the said fifteen day period, submit assessment work breakdowns listing the employees names, addresses and the dates and hours they worked. The new work breakdowns should be submitted direct to the Lands Management Branch, Toronto. The report will be re-assessed and a new statement of credits based on actual days worked will be issued.

2.4844

1983 09 23

Mrs. M.V. St. Jules
Mining Recorder
Ministry of Natural Resources
875 Queen Street East
P.O. Box 669
Sault Ste. Marie, Ontario
P6A 5N2

Dear Madam:

RE: Geological Survey on Mining ClaimsSSM 581685
in the Township of McMurray

The Geological Survey assessment work credits as listed with my Notice of Intent dated August 22, 1983 have been approved as of the above date.

Please inform the recorded holder of these mining claims and so indicate on your records.

Yours very truly,

E.F. Anderson
Director
Land Management Branch

Whitney Block, Room 6450
Queen's Park
Toronto, Ontario
M7A 1W3
Phone:(416)965-1380

R. Pichette:mc

Encl.

cc: Mr. John S. Grant
Suite 2500
390 Bay Street
25th Floor
Toronto, Ontario M5H 2W7

cc: Resident Geologist
Sault Ste. Marie, Ontario

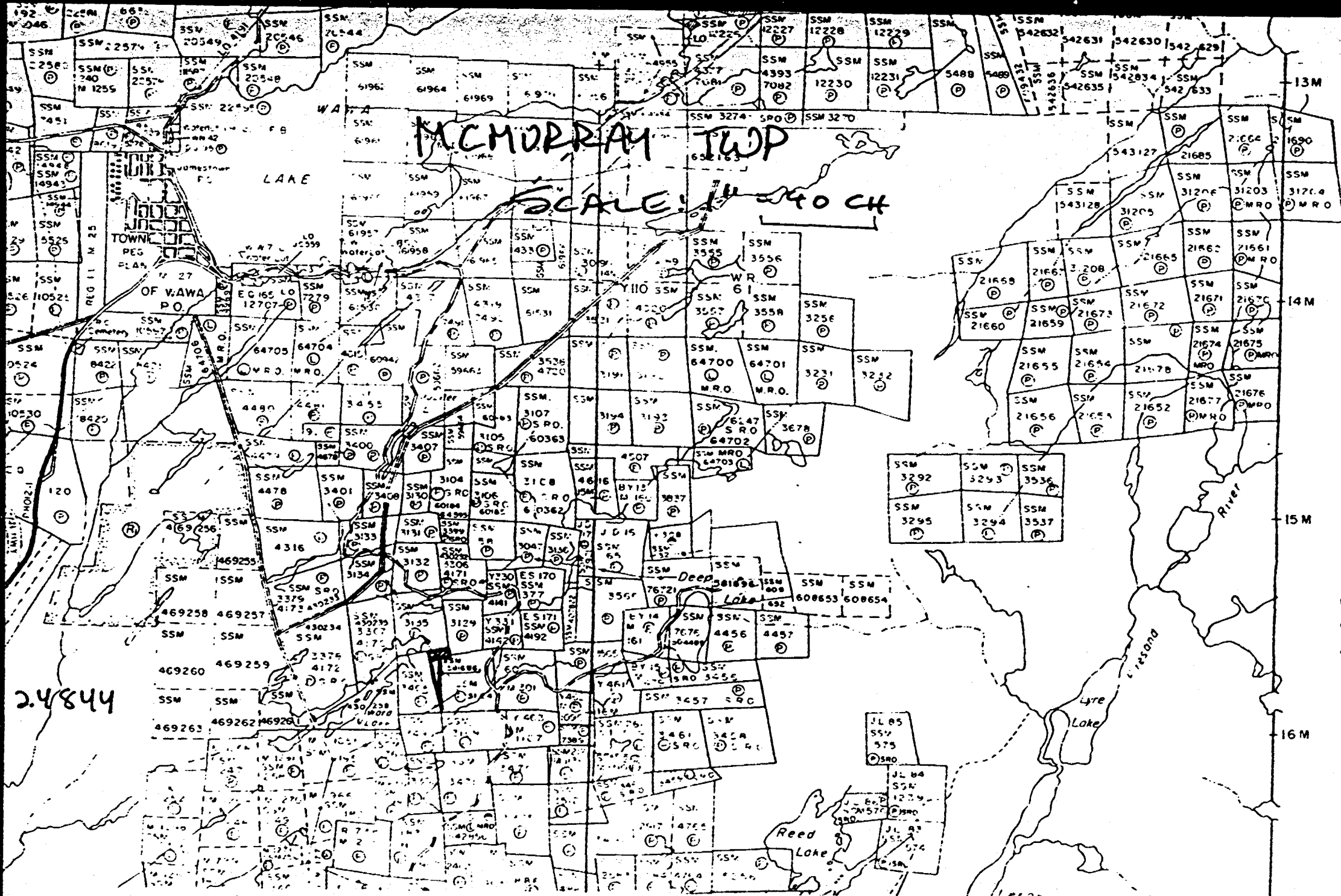

2.4844

McMURRAY TWP
SCALE 1/4 = 40 CH

LASTHEELS TP.
(M. 1534)

SCALE

PATENTED
CROWN L
LEASES
LOCATED
LICENSE
MINING R
SURFACE
ROADS
IMPROVED
KING'S M
RAILWAYS
POWER L
MARSH OF
MINES
CANCELLED
PATENTED

400' SUR
AROUND
THIS TO
CONTROL
THE TO
Refer to
MINING C

ARE PAT
WITHDR
LO 3826
FROM W

SSM 3292	SSM 3293	SSM 3536
SSM 3295	SSM 3294	SSM 3537

JL 85 SSM 575	JL 84 SSM 1234
JL 83 SSM 574	JL 82 SSM 1233