

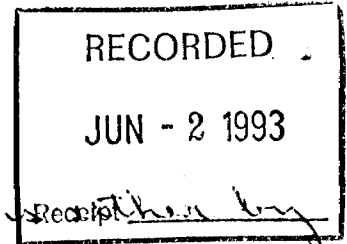

41009NE9160 63.6299 MALLARD

010

Report of Work
on the
Mallard Twp.

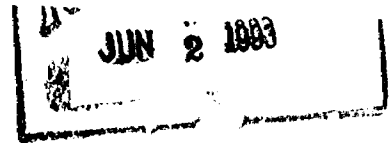

Access to the Mallard gold property is ~~by~~ Receipt here by
Hwy 101 west towards Foleyet & then south on
the Foleyet Timber Road to the E. B. Eddy road
or via Hwy. 144 south past Gogama and then
west on the E. B. Eddy road towards Sultan.
Either way the distance is approx. 240 Km.

The purpose of this extensive stripping
program was to better expose along strike a gold
showing found by George Cross during the
spring of 1991 and subsequent staking by the
partners involved.

The "showing" itself is located on the south
side of the E. B. Eddy road which was made easy
to travel by recent gravelling and repair to the
bridge.

The original showing was found on a poorly
exposed outcrop 10' x 25' approx. $\frac{1}{2}$ mile past the
Opereusway bridge. Values up to 20 opt. Au
were found in a highly altered zone of quartz-
carbonate stringers up to 28 ft. in width.
Best assays were in pods of qtz associated with
pyrite & chalcopyrite. Wallrock is mainly
andesitic metavolcanic rocks typical of the Swayze
belt which is part of the Western Abitibi Greenstone Belt.

June 2/93

Physical Work Report

Mechanical Overburden Stripping

Contract work was performed by Wally Kapel under contract by partners, T. Denomme, D. Moun, G. George Ross & Fred Ross all recipients of O.P.A.P. grants.

Work was performed on 10 hrs day at the rate of \$100.00/hr for the operator & the 225 cat backhoe.

Work Performance Schedule

<u>Date</u>	<u>Crew/Hrs per man</u>	
Sept. 6/91	8	mob. equip & set up camp
" 7/91	10	Strip & cut access road
" 8/91	10	" " Supervision
" 9/91	10	" " "
" 10/91	10	" " "
" 11-13	off	Return to Timmins for fuel, equipment, food.
" 15/91	10 hrs per man	Strip & cut timber, supervision
" 16/91	" " " "	" " " "
" 17-18	Break down	To Town for parts
" 19/91	10 hrs	Strip
" 20/91	10 hrs	strip - cut trees, supervision
" 21/91	10 hrs	" " "
" 22/91	8 hrs	Tear down camp, return to Timmins
	<u>86 hrs per man</u>	

T. C. Denomme

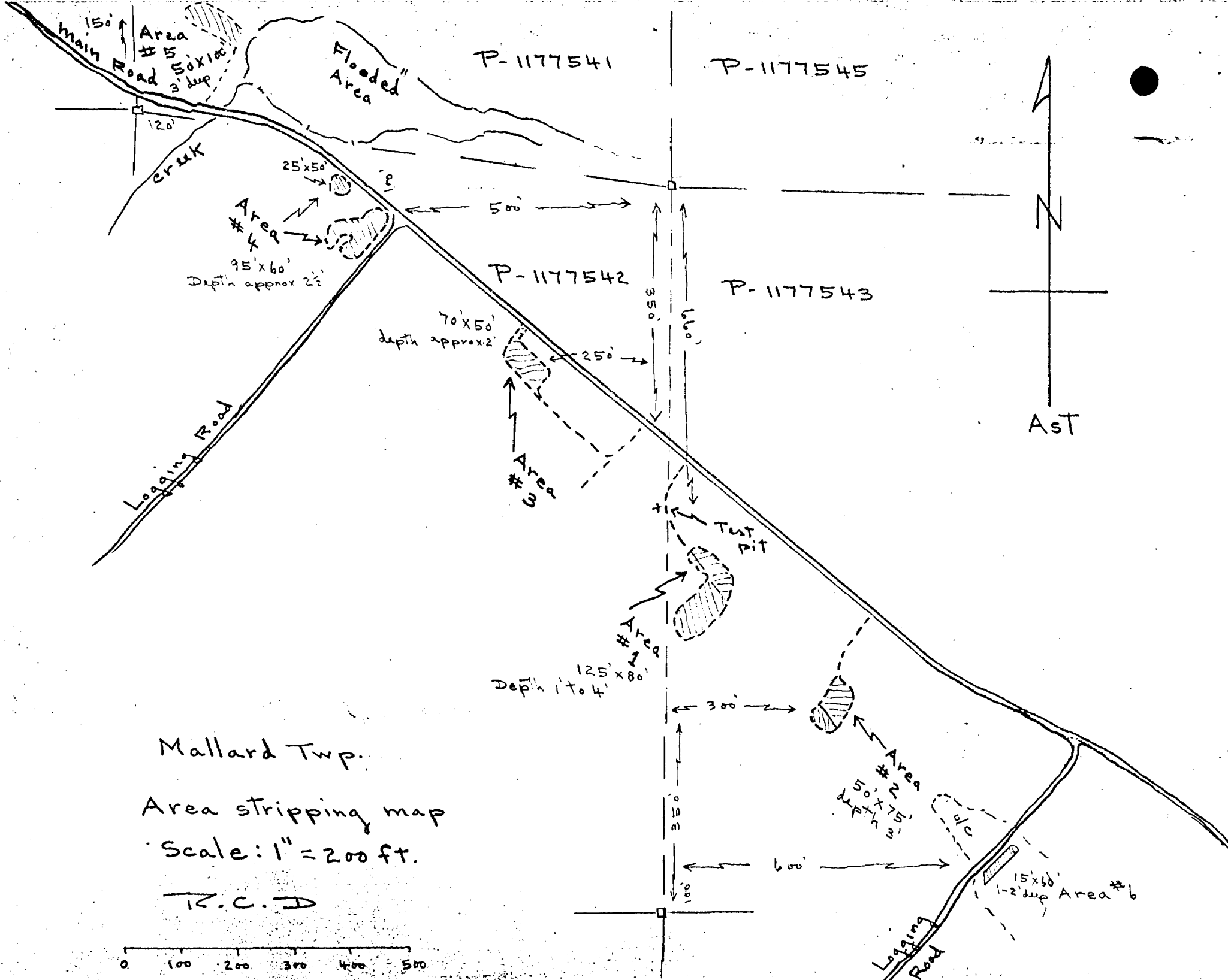

Mallard Twp.

Area stripping map

Scale: 1" = 200 ft.

T.C.D.



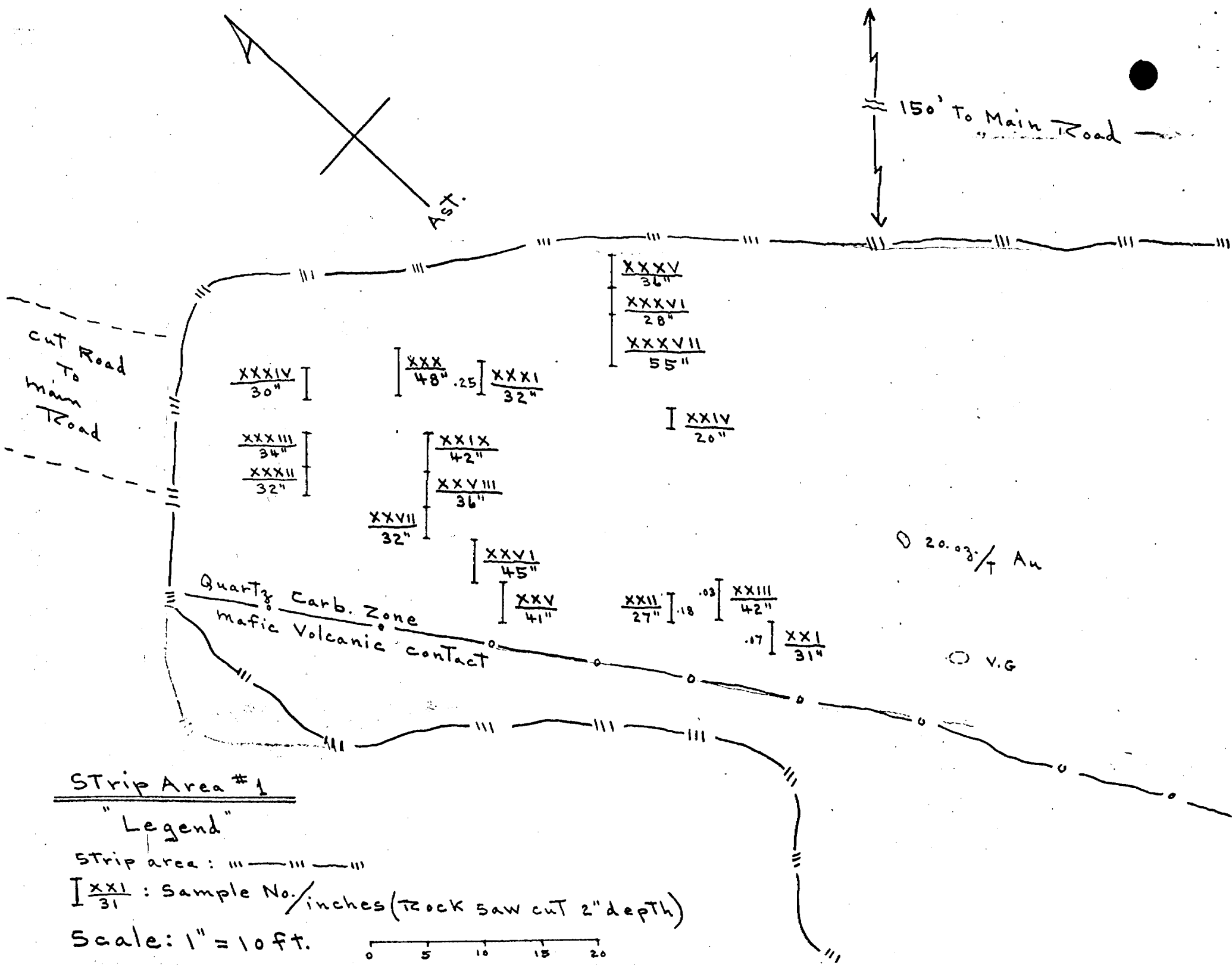

Strip Area #1

"Legend"

Strip area : ||| — ||| — |||

I $\frac{XXI}{31}$: Sample No./inches (rock saw cut 2" depth)

Scale: 1" = 10 ft.

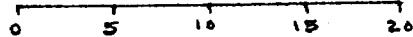

Main Road

North A.S.T.

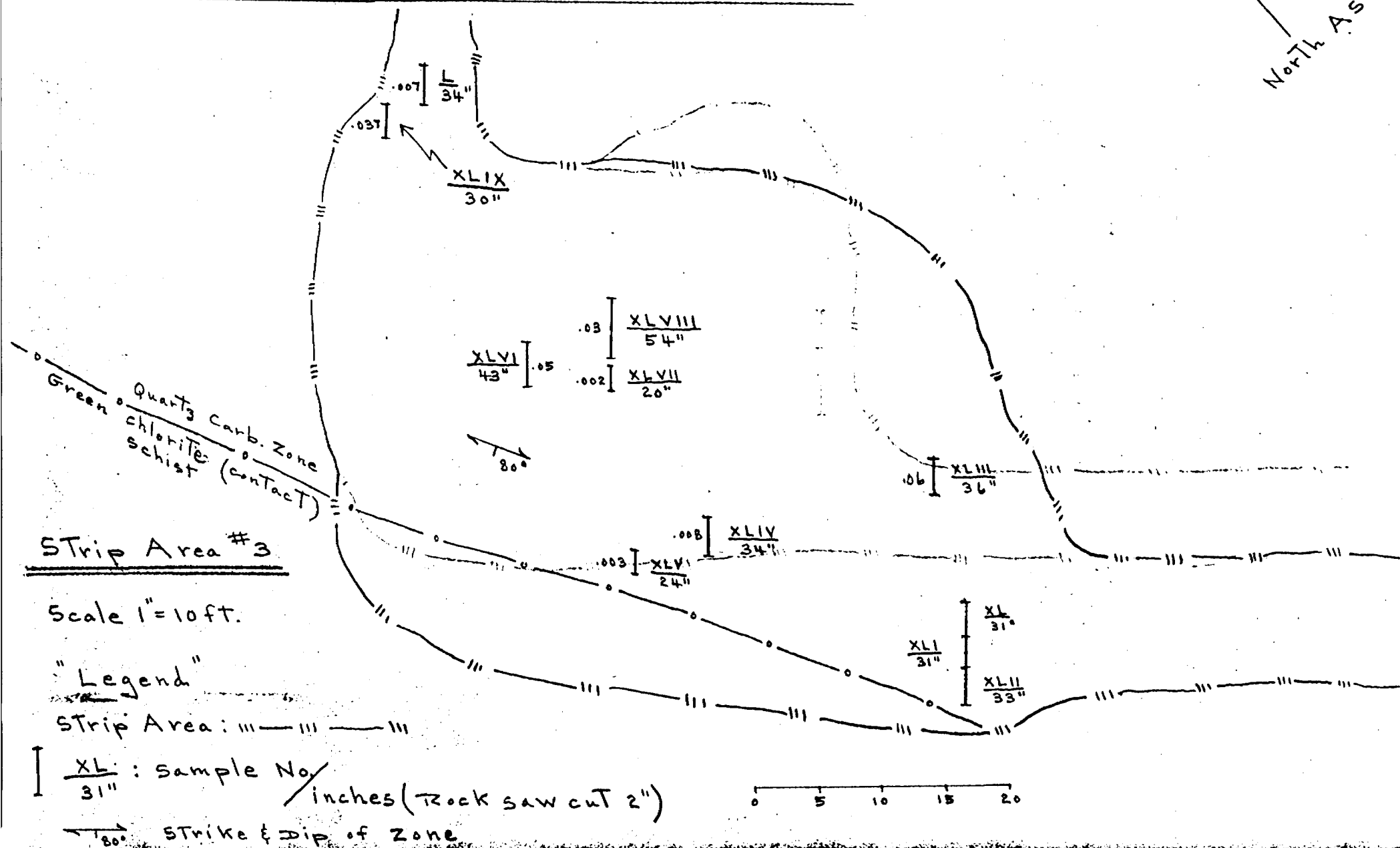

Strip Area #4

1" = 10 ft.

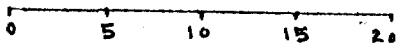

Main Road

A ST.

Pot hole

$\frac{LV I}{48''}$

$\frac{LV}{34''}$

$\frac{LV IV}{30''}$

$\frac{L I}{44''}$

$\frac{L II}{46''}$

$\frac{L III}{52''}$

$\frac{LV II}{12''}$

$\frac{LV III}{12''}$



KAPEL'S BACKHOE SERVICES



(Wally Kapel)
 1400 Norman St.
 TIMMINS, ONTARIO P4N 4B8
 Tel. (705) 267-7208
 Pager (705) 268-2391
 (TRUCKING)



Date Sept 12 19 91

Name ROGER DENOMMEC

Address _____

Hrs.	Description	Amount
	EXCAVATION	
	OF LAND	
	SITE	
	<u>MALLARD TWP</u>	
	Encl. mob- & de-mob	
	Floa	
	TOTAL	<u>4643.00</u>

Customer Signature

237

Thank you!

KAPEL'S BACKHOE SERVICES



(Wally Kapel)
 1400 Norman St.
 TIMMINS, ONTARIO P4N 4B8
 Tel. (705) 267-7208
 Pager (705) 268-2391
 (TRUCKING)



Date Sept. 22 19 91

Name Roger Denomme

Address _____

Hrs.	Description	Amount
	FLOA TO AND	
	FROM MALLARD	
	TWP. (NEAR	
	Ramsay) +	
	EXCAVATION OF	
	LAND SITES	
		<u>3795.40</u>
	G.S.T.	<u>265.67</u>
	TOTAL	<u>4061.07</u>

Customer Signature

322

Thank you!



Report of Work Conducted After Recording Claim

Mining Act

ASSESSMENT FILES
Transaction Number
W9360.00116



41009NE9160 63.6299 MALLARD

900

Personal information collected on this form is obtained under the authority of the Mining Act. This collection should be directed to the Provincial Manager, Mining Lands, Ministry of Northern Development and Mines, Sudbury, Ontario, P3E 6A5, telephone (705) 670-7264.

- Instructions:**
- Please type or print and submit in duplicate.
 - Refer to the Mining Act and Regulations for requirements of filing assessment work or consult the Mining Recorder.
 - A separate copy of this form must be completed for each Work Group.
 - Technical reports and maps must accompany this form in duplicate.
 - A sketch, showing the claims the work is assigned to, must accompany this form.

Recorded Holder(s) Richard Morin		Client No. 172554
Address 133 Shalot Cres., North Bay, Ont		Telephone No. (705) 476-2389
Mining Division Porcupine	Township/Area Mallard	M or G Plan No.
Dates Work Performed From: Sept. 6/91		To: Sept. 22/91

Work Performed (Check One Work Group Only)

Work Group	Type
<input type="checkbox"/> Geotechnical Survey	
<input checked="" type="checkbox"/> Physical Work, Including Drilling	mechanical stripping, cut timber by chain saw.
<input type="checkbox"/> Rehabilitation	
<input type="checkbox"/> Other Authorized Work	
<input type="checkbox"/> Assays	
<input type="checkbox"/> Assignment from Reserve	

ONTARIO GEOLOGICAL SURVEY
GIS-ASSESSMENT FILES
JUL 28 1993
RECEIVED

RECORDED
JUN - 2 1993
Receipt

Total Assessment Work Claimed on the Attached Statement of Costs \$ **9979.00**

Note: The Minister may reject for assessment work credit all or part of the assessment work submitted if the recorded holder cannot verify expenditures claimed in the statement of costs within 30 days of a request for verification.

Persons and Survey Company Who Performed the Work (Give Name and Address of Author of Report)

Name	Address
Kapel's Backhoe Service	1400 Norman St. Timmins, Ont
George Ross	Foleyet, Ont.
Roger Denomme	P.O. Box 1625, Timmins, Ont
Denis Morin	Foleyet, Ont.

(attach a schedule if necessary)

Certification of Beneficial Interest * See Note No. 1 on reverse side

I certify that at the time the work was performed, the claims covered in this work report were recorded in the current holder's name or held under a beneficial interest by the current recorded holder.	Date June 2/93	Recorded Holder or Agent (Signature) R.C. Denomme
--	--------------------------	---

Certification of Work Report

I certify that I have a personal knowledge of the facts set forth in this Work report, having performed the work or witnessed same during and/or after its completion and annexed report is true.		
Name and Address of Person Certifying Roger Denomme, P.O. Box 1625, Timmins, Ont		
Telephone No. 264-1918	Date June 2, 1993	Certified By (Signature) R.C. Denomme

For Office Use Only

Total Value Cr. Recorded \$ 9,979.00	Date Recorded JUNE 2ND / 93	Mining Recorder [Signature]	RECEIVED JUN 2 1993
	Deemed Approval Date AUG. 31 / 93	Date Approved JULY 16 / 93	
	Date Notice for Amendments Sent		

Statement of Costs for Assessment Credit

Transaction No./N° de transaction
W9360.00116

État des coûts aux fins du crédit d'évaluation

Mining Act/Loi sur les mines

Personal information collected on this form is obtained under the authority of the Mining Act. This information will be used to maintain a record and ongoing status of the mining claim(s). Questions about this collection should be directed to the Provincial Manager, Minings Lands, Ministry of Northern Development and Mines, 4th Floor, 159 Cedar Street, Sudbury, Ontario P3E 6A5, telephone (705) 670-7264.

Les renseignements personnels contenus dans la présente formule sont recueillis en vertu de la Loi sur les mines et serviront à tenir à jour un registre des concessions minières. Adresser toute question sur la collecte de ces renseignements au chef provincial des terrains miniers, ministère du Développement du Nord et des Mines, 159, rue Cedar, 4^e étage, Sudbury (Ontario) P3E 6A5, téléphone (705) 670-7264.

1. Direct Costs/Coûts directs

Type	Description	Amount Montant	Totals Total global
Wages Salaires	Labour Main-d'oeuvre	600. ⁰⁰	
	Field Supervision Supervision sur le terrain	900. ⁰⁰	1500. ⁰⁰
Contractor's and Consultant's Fees Droits de l'entrepreneur et de l'expert-conseil	Type		
Supplies Used Fournitures utilisées	Type		
Equipment Rental Location de matériel	Type		
	2.25 Cat	8704. ⁰⁰	
	Backhoe		
Total Direct Costs Total des coûts directs			8704.⁰⁰

2. Indirect Costs/Coûts indirects

** Note: When claiming Rehabilitation work Indirect costs are not allowable as assessment work. Pour le remboursement des travaux de réhabilitation, les coûts indirects ne sont pas admissibles en tant que travaux d'évaluation.

Type	Description	Amount Montant	Totals Total global
Transportation Transport	Type		
	2 Trucks		
	2 Trips 2000 Km X .30¢	600. ⁰⁰	
Sub Total of Indirect Costs Total partiel des coûts indirects			600.⁰⁰
Food and Lodging Nourriture et hébergement	3 men for 9 days 2.7 X 2.5. ⁰⁰	675. ⁰⁰	675. ⁰⁰
Mobilization and Demobilization Mobilisation et démoblisation			
Amount Allowable (not greater than 20% of Direct Costs) Montant admissible (n'excédant pas 20 % des coûts directs)			1275.⁰⁰
Total Value of Assessment Credit (Total of Direct and Allowable Indirect costs) Valeur totale du crédit d'évaluation (Total des coûts directs et indirects admissibles)			9979.⁰⁰

Note: The recorded holder will be required to verify expenditures claimed in this statement of costs within 30 days of a request for verification. If verification is not made, the Minister may reject for assessment work all or part of the assessment work submitted.

Note: Le titulaire enregistré sera tenu de vérifier les dépenses demandées dans le présent état des coûts dans les 30 jours suivant une demande à cet effet. Si la vérification n'est pas effectuée, le ministre peut rejeter tout ou une partie des travaux d'évaluation présentés.

Filing Discounts

1. Work filed within two years of completion is claimed at 100% of the above Total Value of Assessment Credit.
2. Work filed three, four or five years after completion is claimed at 50% of the above Total Value of Assessment Credit. See calculations below:

Total Value of Assessment Credit	Total Assessment Claimed
	× 0.50 =

Remises pour dépôt

1. Les travaux déposés dans les deux ans suivant leur achèvement sont remboursés à 100 % de la valeur totale susmentionnée du crédit d'évaluation.
2. Les travaux déposés trois, quatre ou cinq ans après leur achèvement sont remboursés à 50 % de la valeur totale du crédit d'évaluation susmentionné. Voir les calculs ci-dessous.

Valeur totale du crédit d'évaluation	Évaluation totale demandée
	× 0,50 =

Certification Verifying Statement of Costs

I hereby certify: that the amounts shown are as accurate as possible and these costs were incurred while conducting assessment work on the lands shown on the accompanying Report of Work form.

that as Pentner I am authorized (Recorded Holder, Agent, Position in Company)

to make this certification

Attestation de l'état des coûts

J'atteste par la présente: que les montants indiqués sont le plus exact possible et que ces dépenses ont été engagées pour effectuer les travaux d'évaluation sur les terrains indiqués dans la formule de rapport de travail ci-joint.

Et qu'à titre de _____ je suis autorisé (titulaire enregistré, représentant, poste occupé dans la compagnie)

à faire cette attestation.

Signature: [Signature] Date: JUN 2/93

DISPOSITION OF CROWN LANDS

TYPE OF DOCUMENT	SYMBOL
PATENT, SURFACE & MINING RIGHTS	●
" SURFACE RIGHTS ONLY	○
" MINING RIGHTS ONLY	○
LEASE, SURFACE & MINING RIGHTS	■
" SURFACE RIGHTS ONLY	■
" MINING RIGHTS ONLY	■
LICENCE OF OCCUPATION	▽
ORDER-IN-COUNCIL	○
RESERVATION	○
CANCELLED	○
SAND & GRAVEL	○

NOTE: MINING RIGHTS IN PARCELS PATENTED PRIOR TO MAY 8, 1913, VESTED IN ORIGINAL PATENTEE BY THE PUBLIC LANDS ACT, R.S.O. 1970, CHAP. 380, SEC. 63, SUBSEC. 1.

AREAS WITHDRAWN FROM DISPOSITION

- M.R.O. - MINING RIGHTS ONLY
- S.R.O. - SURFACE RIGHTS ONLY
- M.+S. - MINING AND SURFACE RIGHTS

Description	Order No.	Date	Disposition	File

THIS TWP. IS SUBJECT TO FOREST ACTIVITIES IN 1992/93 - FURTHER INFORMATION AVAILABLE ON FILE.

LAND NOT OPEN FOR STAKING SECTION 31(4) OF TWP. MINING ACT R.S.O. 1990. APPEAL 91-AUG-20.

THIS TWP. IS SUBJECT TO FOREST ACTIVITY IN 1993/94. FURTHER INFORMATION ON FILE.

THE INFORMATION THAT APPEARS ON THIS MAP HAS BEEN COMPILED FROM VARIOUS SOURCES, AND ACCURACY IS NOT GUARANTEED. THOSE WISHING TO STAKE MINING CLAIMS SHOULD CONSULT WITH THE MINING RECORDER, MINISTRY OF NORTHERN DEVELOPMENT AND MINES, FOR ADDITIONAL INFORMATION ON THE STATUS OF THE LANDS SHOWN HEREON.

MARION TWP.

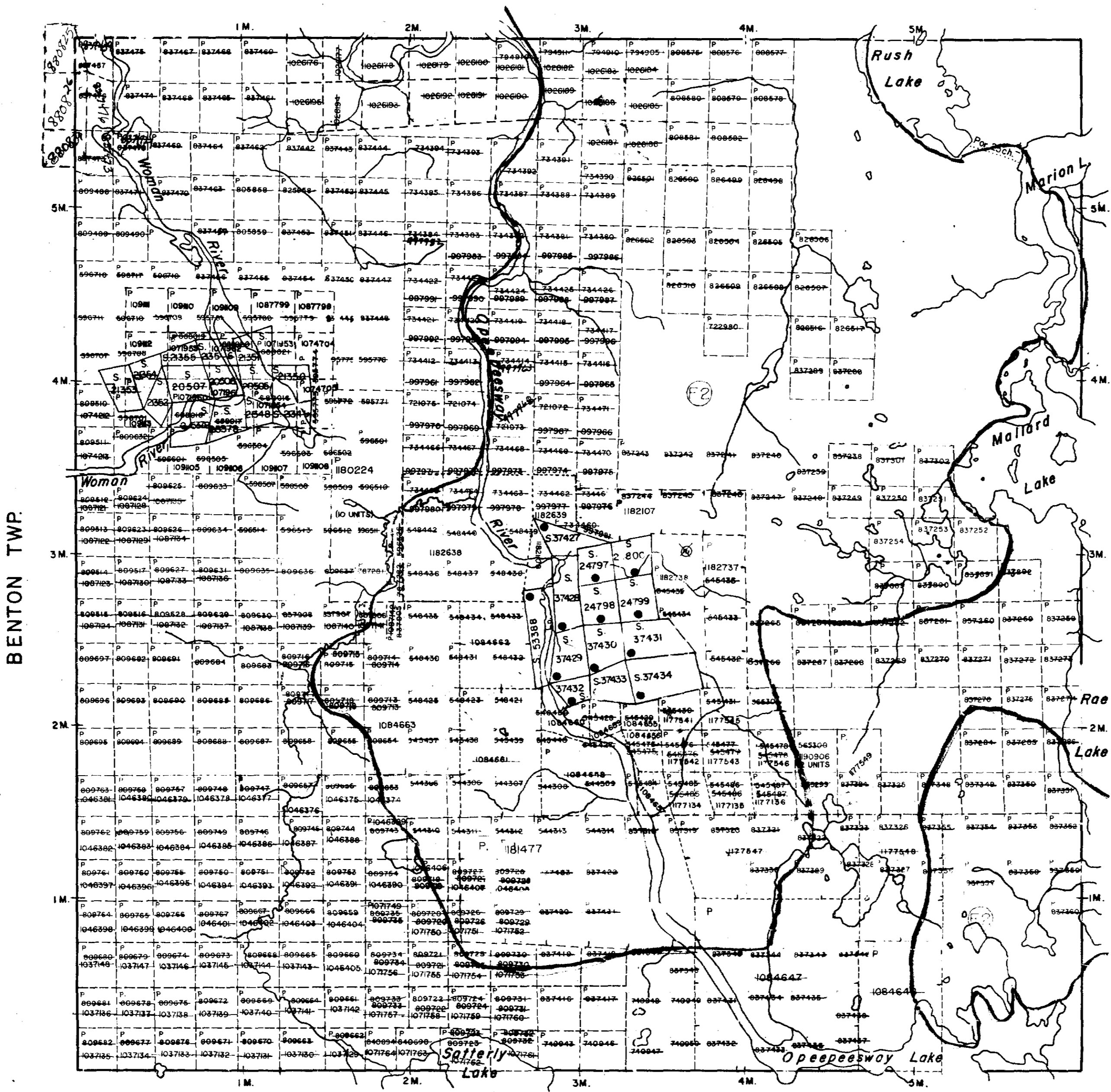

BENTON TWP.

ERIC TWP.

OSWAY TWP.

LEGEND

- HIGHWAY AND ROUTE No.
- OTHER ROADS
- TRAILS
- SURVEYED LINES:
 - TOWNSHIPS, BASE LINES, ETC.
 - LOTS, MINING CLAIMS, PARCELS, ETC.
- UNSURVEYED LINES:
 - LOT LINES
 - PARCEL BOUNDARY
 - MINING CLAIMS ETC.
- RAILWAY AND RIGHT OF WAY
- UTILITY LINES
- NON-PERENNIAL STREAM
- FLOODING OR FLOODING RIGHTS
- SUBDIVISION OR COMPOSITE PLAN
- RESERVATIONS
- ORIGINAL SHORELINE
- MARSH OR MUSKEG
- MINES
- TRAVERSE MONUMENT

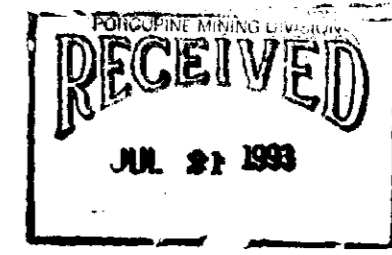

SCALE: 1 INCH = 40 CHAINS

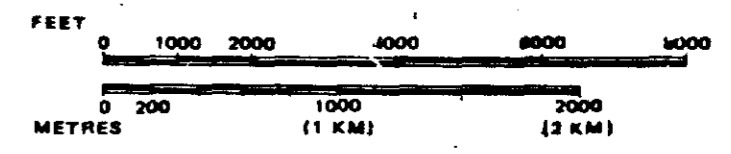

TOWNSHIP OF
MALLARD

DISTRICT OF
SUDBURY

MINING DIVISION

Porcupine



Ministry of Natural Resources
Ministry of Northern Development and Mines

Date JULY 1986

Plan No.

National Topographic Series

G-1171

CK 200 16/86

63.6299

