



010

DIAMOND DRILLING

TOWNSHIP: ESTHER TWP.

REPORT NO: 13

WORK PERFORMED FOR: Martin Lindsay Burton

RECORDED HOLDER: Same as above [xx]
: Other []

<u>Claim No.</u>	<u>Hole No.</u>	<u>Footage</u>	<u>Date</u>	<u>Note</u>
P 648044	87-1	365'	July/87	(1)

NOTES: (1)#191-87, filed in Mar/88

DIAMOND DRILL HOLE 87-1

LOCATION: Claim 648044
970 feet S23°E from NE corner (#4 post) of claim
AZIMUTH: 015° INCLINATION: -45° CORE SIZE: BQ
STORAGE: Grandad Resources at Casey Mountain near New Liskard
HOLE LENGTH: Total hole length 365 feet
CONTRACTOR: N Morissette Canada Inc. DATE: July 10-11, 1987
LOGGED BY: Glenn R. Clark, P.Eng.

DESCRIPTION:

- 0-7 feet Overburden, cased no recovery
- 7-117.7 Meta-volcanics, intermediate to mafic in composition, dark green to green in colour with flow structure indicated by quartz-carbonate patches and stringers
8.2 ft. 1/4 in. pyrrhotite band
21.5-22 section of interflow sediments or sheared flow, some black carbonaceous bands, rusty section at 22", a possible fault.
- 117.7-127 Meta-volcanics, intermediate to felsic in composition, light green to grey, massive, some patches of quartz-carbonate
- 127 - 177 Sediments, inter-flow sediments, grey to black, banded, banding at 85° to 45° to core axis some contorting, fine grained
132-132.5 carbonaceous bands
170-174 black carbonaceous sediments, probably the cause of the VLF-EM anomaly
- 177-365 Meta-volcanics, intermediate to felsic in composition, green, fine grained, massive
242.5-243.1 quartz-carbonate and sericite at 242.5 contact at 25° to core and at 243.1 at 45°
285.5-286.7 quartz-carbonate with rock fragments
327-327.5 quartz vein
347.9-348.4 quartz vein, brecciated with some rock fragments
363.5-364 quartz vein, pinkish colour

365 END OF HOLE

General comment: minor sulphides (pyrite) throughout, quartz-carbonate sections mostly quartz, VLF-EM anomaly due to carbonaceous sediments



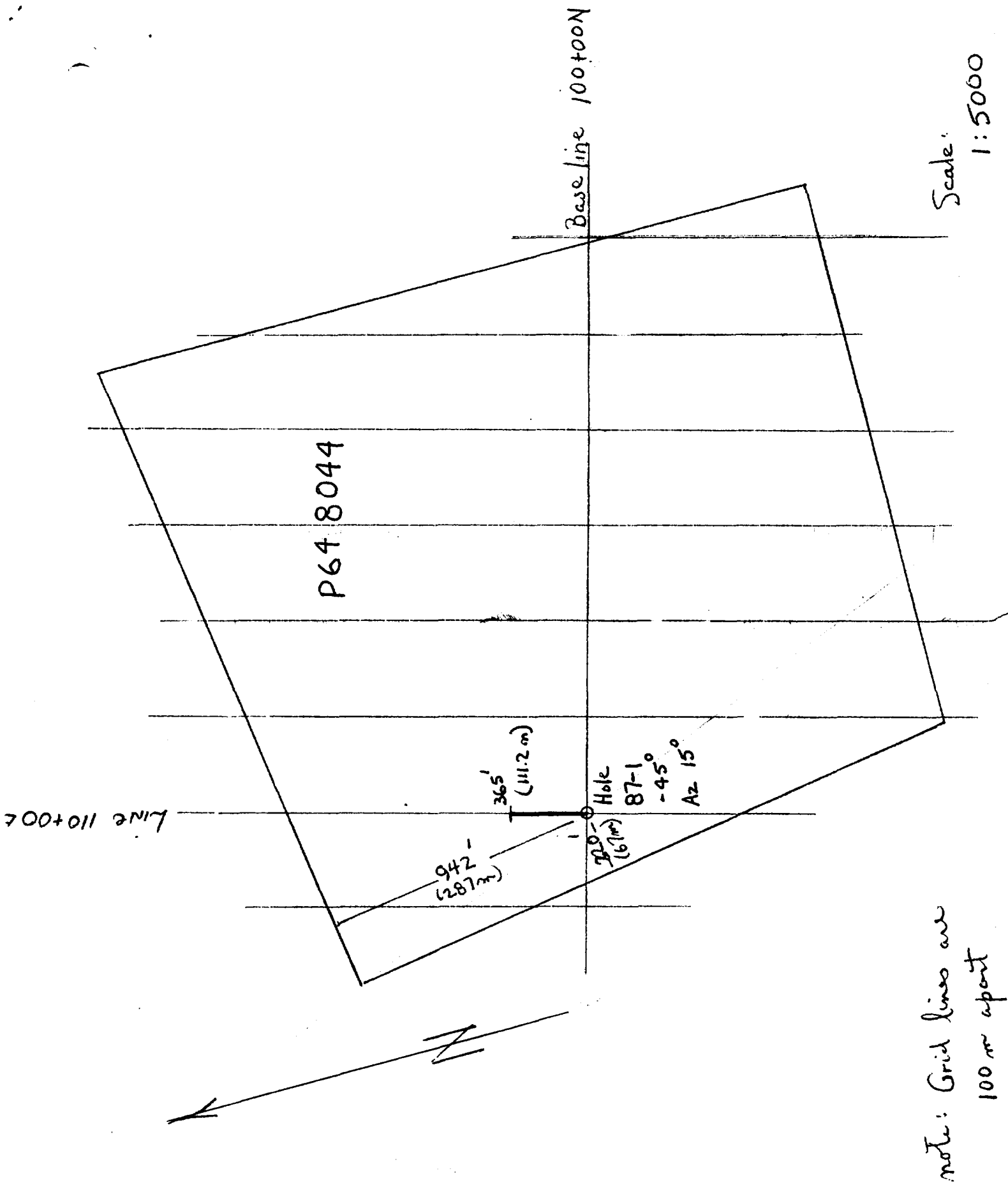

DOCUMENT No.
8706. 197/87
Mining A



41009NW0125 13 ESTHER

900

Name and Postal Address of Recorded Holder

MARTIN LINDSAY BURTON

Prospector's Licence No.

C 22311

352 HOWEY DRIVE, SUDBURY, ONT

P3B 1E8

Summary of Work Performance and Distribution of Credits

Total Work Days Cr. claimed 365	Mining Claim			Work Days Cr.	Mining Claim			Work Days Cr.	Mining Claim		Work Days Cr.
	Prefix	Number	Work Days Cr.		Prefix	Number	Work Days Cr.		Prefix	Number	
for Performance of the following work. (Check one only) <input type="checkbox"/> Manual Work <input type="checkbox"/> Shaft Sinking Drifting or other Lateral Work. <input type="checkbox"/> Compressed Air, other Power driven or mechanical equip. <input type="checkbox"/> Power Stripping <input checked="" type="checkbox"/> Diamond or other Core drilling <input type="checkbox"/> Land Survey	P	648047	100								
		648048	100								
		648049									
		648050									
		629911	60								
		629912	60								
	648044	45									

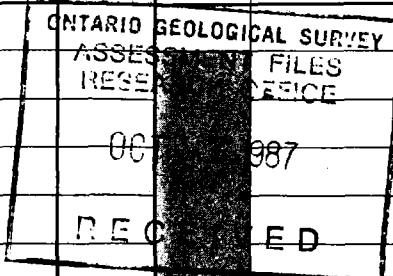

All the work was performed on Mining Claim(s): P 648044

Required Information eg: type of equipment, Names, Addresses, etc. (See Table Below)

Diamond Drilling by
N. Morissette Canada Inc.
Halleyburg, Ont. P0S 1K0
Hole 87-1 drilled July 10 & 11, 1987
Depth 365 feet
Size BQ.
Drill logs by G.R. CLARK

RECORDED
AUG 11 1987

Date of Report: Aug. 7/87
Recorded Holder or Agent (Signature): Glenn R Clark

Certification Verifying Report of Work

I hereby certify that I have a personal and intimate knowledge of the facts set forth in the Report of Work annexed hereto, having performed the work or witnessed same during and/or after its completion and the annexed report is true.

Name and Postal Address of Person Certifying
GLENN R CLARK

RRI, ORONO, ONT. L0B1N10
Date Certified: Aug 7/87
Certified by (Signature): Glenn R Clark

Table of Information/Attachments Required by the Mining Recorder

Type of Work	Specific information per type	Other information (Common to 2 or more types)	Attachments
Manual Work	Nil	Names and addresses of men who performed manual work/operated equipment, together with dates and hours of employment.	Work Sketch: these are required to show the location and extent of work in relation to the nearest claim post.
Shaft Sinking Drifting or other Lateral Work	Type of equipment		
Compressed Air, other power driven or mechanical equip.	Type of equipment and amount expended.		

