



41009SE0018 19 HUFFMAN

Diamond Drill

010

Township of HUFFMAN

Report NO 19

Work performed by: T.J. Gaffney

Claim NO	Hole NO	Footage	Date	Note
S 113861	7	469'	1961	(1)
	8	246'	"	(1)
	11	60'	"	(1)
	12	60'	"	(1)
	13	51'	"	(1)
	14	102'	"	(1)

6/988

1294

Notes:

(1) These holes were drilled from Sept-Dec/61

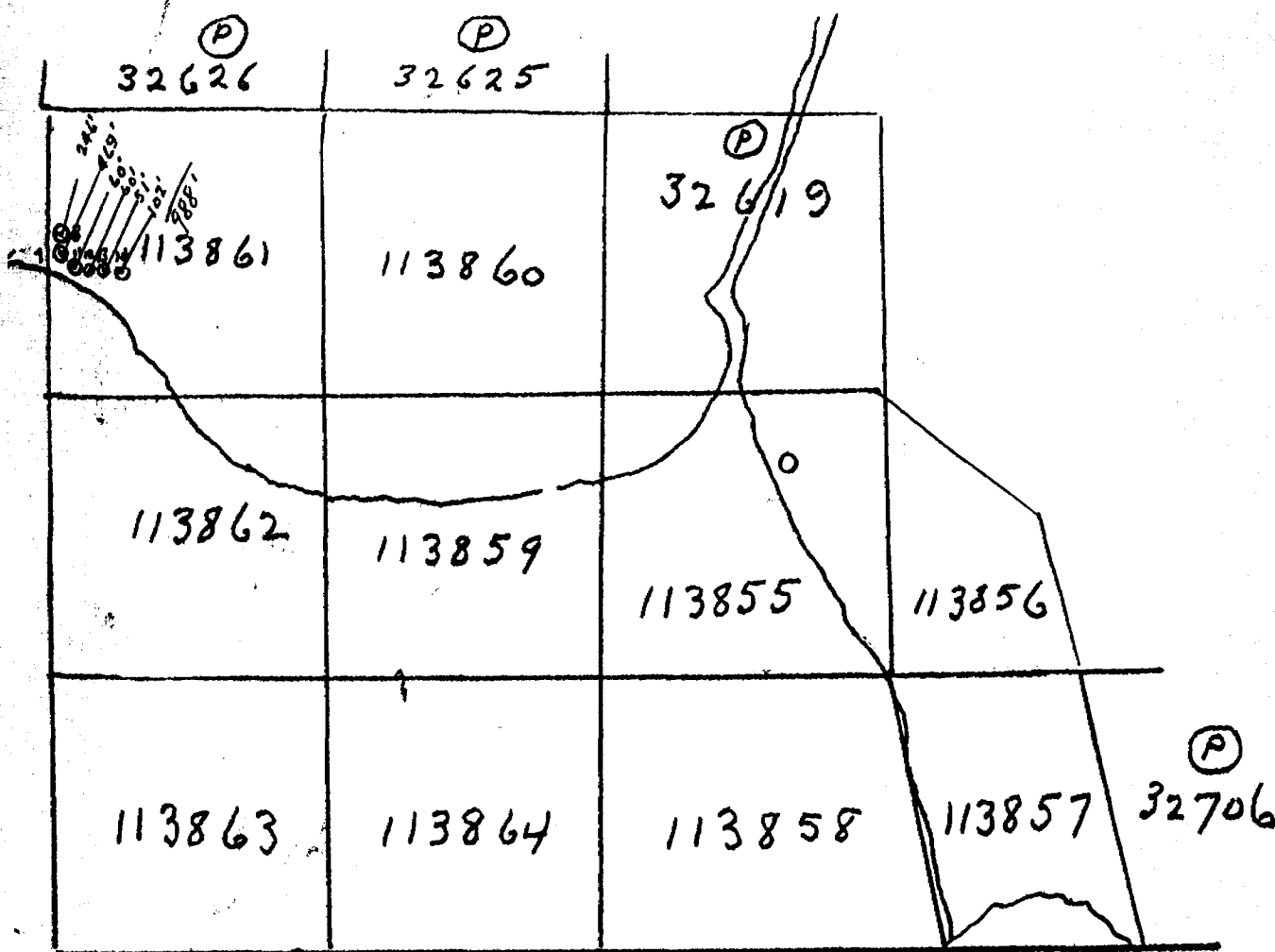

Log of Hole No.7

0 to 41½ altered sediments with some mineralization, 41½ to 51½ Quartz vein, 45 to 51½ assayed .24 oz Gold and .33 silver, The balance of the hole to 469 was altered sediments, with some minerals showing, A sample taken from 235 to 240 assayed .03 Gold

Log of Hole No.8 north of No.7

Altered sediments through-out with some minerals showing, but did not intersect the quartz as in hole No.7, sample taken at 239 to 235 assayed .03 in Gold, Hole ended at 246 feet.

Log of Hole No.11

Altered sediments, quartz vein from 43 to 52 with low gold values (Hole ended at 60 feet.

Log of Hole No.12

Altered sediments with quartz vein from 40 to 50 with assays up to .07 in gold, Hole ended at 60 feet

Log of Hole No.13

Altered sediments, quartz vein from 33 to 43½ with low gold values Hole ended at 51 feet.

Log of Hole No.14

Altered sediments, quartz vein from 70 to 80 no assay taken Hole ended at 102 feet.

4M

OSWAY

*Huffman Tract*

5-2-192

Little

Rice

Lake

3M

112747	112754	112755
112748	112753	112756

S	S	S	
112749	112752	112757	112760
112750	112751	112758	112759

2M

32220	32221	32222	32223	32224	32225	32226
29951	29952	32224	32226	32226	32226	32226
32387	32388	32210	32225	32225	32225	32225
32387	32388	32210	32225	32225	32225	32225
32387	32388	32210	32225	32225	32225	32225

Boundary

Lake

3/5/8

113582	113581	113580	113579			
113589	113583	112422	112421	113578		
113584	113585	112419	112420			
113587	113586	112418	112417			
112405	112406	112407	112409	112411	112413	112415

1M

2M

3M

400' Reserve



41009SE0018 19 HUFFMAN

900

HUFFMAN TWA

**IMPORTANT**

Attach sketch showing location of work in relation to corner posts, and nature and extent thereof.

Form 12 A  
20M-60-2134

**THE MINING ACT**



ONTARIO

**REPORT OF WORK**

To the Recorder of Sudbury Mining Division:  
I, J. J. Gaffney  
118 Denkwater St. Sudbury Ont.  
(Post Office Address)

the recorded holder of mining claim No. 113861 hereby report the performance of 120 days' work not before reported, to be applied to this claim.

\*This mining claim is one of a group of contiguous claims numbered 113855 to 113864

of which I am the recorded holder under Mining License No. 628314 and the work

was performed on mining claim (s) 113861 and is to be applied

in respect of mining claim (s) 113861  
(\*Complete above section only if applicable)

The work is as follows:  
Stripping or opening up mines, sinking shafts or other actual mining operations.

The names and addresses of the men who performed the work and the dates upon which each man worked in its performances are: (If more space is required, attach list).

Diamond or other Core Drilling Total No. of days

Footage drilled 988 No. of holes drilled 6 Angle 45°  
Diameter of core 4/8 Names and addresses of owner and operator of drill

Dates upon which drilling was done Sept. 27/61 to Dec 17/61  
(Core log and Sketch in duplicate by core examiner accompanies this Report.)

Total No. of days 988

Work by Compressed Air or other Power Driven Rock Drill or Mechanical Equipment.

Type of drill Diamond Drill P.S. EXT  
Names and addresses of men engaged in operating drill,

Dates upon which each man worked  
Total No. of days

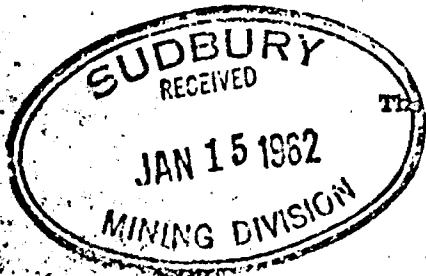

The penalty for making a false statement in this certificate is \$500. or six months imprisonment or both.

**IMPORTANT**

Attach sketch showing location of work in relation to corner posts, and nature and extent thereof.

Form 12 A  
25M-59-360

**THE MINING ACT**



ONTARIO

**REPORT OF WORK**

To the Recorder of ..... **SUDBURY** ..... Mining Division:

I, ..... **T. J. GAFFNEY** .....  
(Name of Applicant)  
..... **Box 272 Sudbury Ont.** .....  
(Post Office Address)

the recorded holder of mining claim No. .... **113861** ..... hereby report the performance of **80** days' work not before reported, to be applied to this claim.

\*This mining claim is one of a group of contiguous claims numbered **113855 to 113864 Incl.**

of which I am the recorded holder under Mining License No. .... **C-23314** ..... and the work

was performed on mining claim(s) ... **113855** ..... and is to be applied

in respect of mining claim(s) ..... **113861** .....  
(\*Complete above section only if applicable)

The work is as follows:

Stripping or opening up mines, sinking shafts or other actual mining operations

The names and addresses of the men who performed the work and the dates upon which each man worked in his performances are: (If more space is required, attach list).

.....  
.....  
.....

Diamond or other Core Drilling

Total No. of days .....

Footage drilled ..... **659** ..... No. of holes drilled ..... **2** ..... Angle **60'**  
Diameter of core ..... **7/8 EXT** ..... Names and addresses of owner and operator of  
drill ..... **M. J. Gaffney Sudbury Ont.** .....  
..... **Albert Johnson Copper Cliff Ont.** .....  
Dates upon which drilling was done ..... **July 13th, to Aug 4th/1961** .....  
(Core log and Sketch in duplicate by core examiner accompanies this Report.)

Total No. of days ... **659** .....

Work by Compressed Air or other Power Driven Rock Drill or Mechanical Equipment.

Type of drill .....  
Names and addresses of men engaged in operating drill .....

Dates upon which each man worked .....  
Total No. of days .....

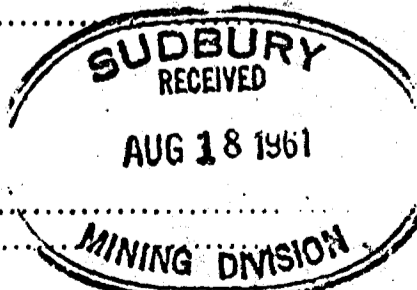

The penalty for making a false statement in this certificate is \$500. or six months imprisonment or both.