



41009SE0031 18 HUFFMAN

010

Diamond Drilling

Township of HUFFMAN

Report NO 18

Work performed by: Best-Ore Gold Mines

Claim NO	Hole NO	Footage	Date	Note
S 40666	3.	225	1942	
	6	317'	"	
	8	275'	"	
S 32544	4	225'	"	
	5.	150'	"	
S 32545	1	200'	"	
	2	175' 67 1567. ₂	"	

Notes: These holes were drilled before 1945.

Huffman trap

5-2-190

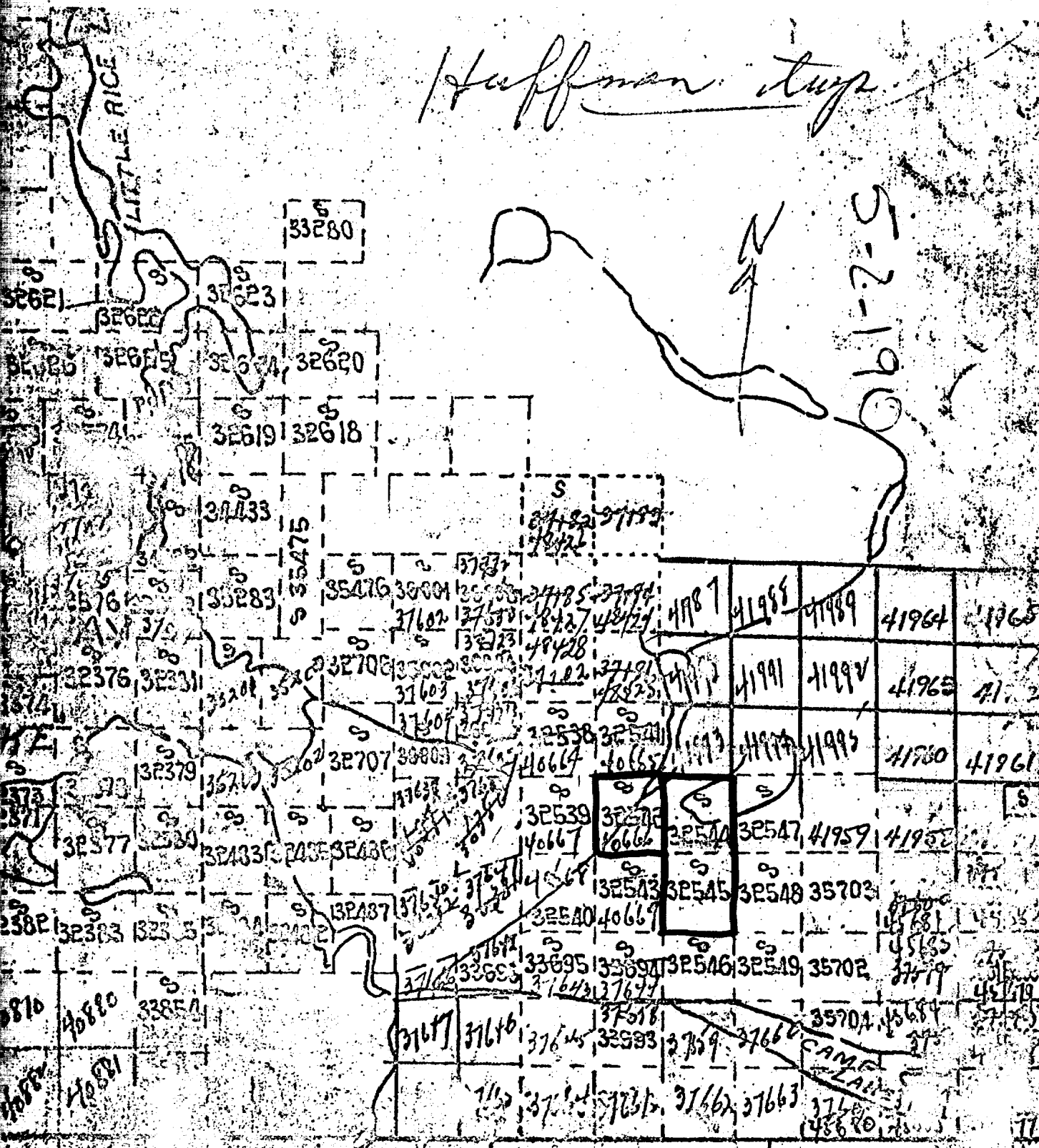

DATE OF ISSUE
MAY 19 1912

DIAMOND DRILL RECORD

Hole No. 3 Sheet No.

Property Best-Ore Gold Mines Ltd.
Location 40666
Latitude
Departure
Bearing S 25° W

Dip 40
Total Footage 225

Elev. Collar
Datum
Date Started
Date Completed
Drilled by
Logged by

Table with columns: Footage (From, To), Formation, Sample Number, Sample Width, Gold Sample, Gold Sludge, Remarks. Rows include: 0-3 Casing, 3-25 Porphyry, 25-50 ' w.n., 50-75 ' , 75-100 ' , 100-125 ' , 125-150 ' , 150-175 Lost core, 175-200 Porphyry, 200-225 ' .

Date of Examination

DIAMOND DRILL RECORD

Hole No. 6 Sheet No. _____

Property Best-Ore Gold Mines Ltd.
 Location 40666
 Latitude _____
 Departure _____
 Bearing S 12° W

Dip

60

 Total Footage 317'

Elev. Collar _____
 Datum _____
 Date Started _____
 Date Completed _____
 Drilled by _____
 Logged by _____

Footage		Formation	Sample Number	Sample Width	Gold Sample	Gold Sludge	Remarks
From	To						
0	3	Casing					
	25	Porphyry					
	50	"					
	75	" W. min.					
	100	"					
	125	"					
	150	"					
	175	"					
	200	"					
	225	"					
	250	"					
	275	"					
	300	"					
	317	" with quartz stringers.					

Date of Examination _____

DIAMOND DRILL RECORD

Hole No. 8

Sheet No.

 Property Best-Ore Gold Mines Ltd.
 Location 40666

Dip 30°

 Latitude
 Departure
 Bearing N

 Elev. Collar
 Datum
 Date Started
 Date Completed
 Drilled by
 Logged by

Total Footage 275'

Footage		Formation	Sample Number	Sample Width	Gold Sample	Gold Sludge	Remarks
From	To						
0	6	Casing					
	25	Min Shear					
	50	Shear Conglomerate					
	75	Grey-pink arkose					
	100	" " " " changing to Porphyry					
	125	Porphyry					
	150	"					
	175	"					
	200	"					
	225	Arkose					
	250	"					
	275	"					

Date of Examination

DIAMOND DRILL RECORD

Hole No. 4 Sheet No. ●

Property Best-Ore Gold Lines Ltd.
 Location Claim 32544

Dip
45°

Elev. Collar _____
 Datum _____
 Date Started _____
 Date Completed _____
 Drilled by _____
 Logged by _____

Latitude _____
 Departure _____
 Bearing S 5° W

Total Footage 225'

Footage		Formation	Sample Number	Sample Width	Gold Sample	Gold Sludge	Remarks
From	To						
0	2	Casing					
	25	Carbonates					
	50	Porphyry Red & Arkose					
	75	" " "					
	100	" " "					
	125	Lost Core, Quartz Porphyry					
	150	" "					
	175	" "					
	200	Sheared, Carbonated Conglomerate					
	225	" " "					
		End of Hole 225'					

Date of Examination _____

DIAMOND DRILL RECORD

Hole No. 5 Sheet No.

Property Best-Ore Gold Mines Ltd.
 Location Claim No. 32544

 Latitude _____
 Departure _____
 Bearing N 20° E

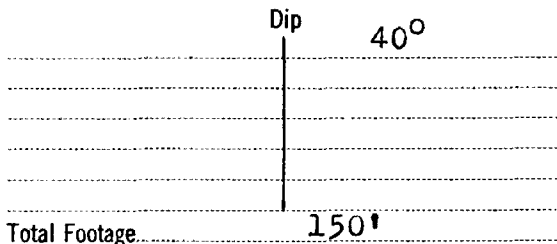

Elev. Collar _____
 Datum _____
 Date Started _____
 Date Completed _____
 Drilled by _____
 Logged by _____

Footage		Formation	Sample Number	Sample Width	Gold Sample	Gold Sludge	Remarks
From	To						
0	6	Casing 6.25 Porphyry					
25	50	Carbonated Seds.					
50	75	" "					
75	100	Grey porphyry changing to carbonates					
	125	Carbonated seds					
	150	" "					

Date of Examination _____

DIAMOND DRILL RECORD

Hole No. 2

Sheet No. _____

Property Best-Ore Gold Mines Ltd.
Location 32545Dip 45Elev. Collar _____
Datum _____
Date Started _____
Date Completed _____
Drilled by _____
Logged by _____Latitude _____
Departure _____
Bearing NTotal Footage 175'

Footage		Formation	Sample Number	Sample Width	Gold Sample	Gold Sludge	Remarks
From	To						
0	5	Casing					
	25	Porphyry to Qtz. Porphyry					
	50	"					
	75	"					
	100	SiO2 "					
	121	Porphyry & Arkose					
	125	" "					
	150	"					
	162	Arkose changing to Diabase					
	175	Diabase					
Hole #2 - 175'							

Date of Examination _____

DIAMOND DRILL RECORD

Hole No. 1

Sheet No. _____

Property Best Ore Gold Mines Ltd.
 Location Claim No. 32545

 Latitude _____
 Departure _____
 Bearing South

Dip 45°

Total Footage 200'

Elev. Collar _____
 Datum _____
 Date Started _____
 Date Completed _____
 Drilled by _____
 Logged by _____

Footage		Formation	Sample Number	Sample Width	Gold Sample	Gold Sludge	Remarks
From	To						
0	5	Casing					
5	25	Arkose to Porphyry					
	50	Porphyry Qtz Stringer					
	75	Porphyry s.n.					
	100	Porphyry & arkose					
	125	SiO ₂ Porphyry					
	150	"					
	175	Arkose					
	200	Arkose & Porphyry					
		End of Hole 200'					

Date of Examination _____