



41010NE0040 33 CUNNINGHAM

010

DIAMOND DRILLING

TOWNSHIP: Cunningham

REPORT No.: 33

WORK PERFORMED BY: M.W. Resources

<u>CLAIM No.</u>	<u>HOLE No.</u>	<u>FOOTAGE</u>	<u>DATE</u>	<u>NOTE</u>
MR 101856	80 - 3	250.0	Sept/80	(1)
	80 - 4	250.0	Sept/80	(1)

NOTES: (1) #344-80

DIAMOND DRILL PROGRAM
M.W. RESOURCES OPTION
CUNNINGHAM TWP., ONTARIO
VENTURE 170
BY
PLACER DEVELOPMENT LIMITED

November 1980
Toronto, Ontario

INTRODUCTION

From September 5, 1980 until September 30, 1980, Placer Development Limited drilled 1250 feet in 4 holes on the M.W. Resources Option in Cunningham Township, Ontario. (Figures 1 & 2). The core is stored at the campsite on Hiram Lake (Claim #S57536).

DRILLING RESULTS

Of the four holes drilled two, MW.80-3 and MW.80-4, are eligible for assessment credits and are described below.

MW.80-3 was collared on line 16S at 15+60W to test an EM.17 anomaly and drilled to a depth of 250 feet. The drill hole intersected a 31.5 foot section of massive pyrrhotite and several quartz veins mineralized with blebs of pyrrhotite. The following assays are from the above intersection.

<u>From</u>	<u>To</u>	<u>Au oz/ton</u>	<u>Ni %</u>	<u>Cu %</u>	<u>Ag oz/ton</u>
79'	82'	Trace	-	0.04	Nil
85.5'	86.5'	Trace	-	Trace	Trace
109'	111'	Trace	0.01	0.01	Trace
126.5'	133'	Trace	0.01	0.06	Nil
178.5'	184'	Trace	0.01	0.07	Nil
184'	190'	Trace	0.01	0.06	Nil
190'	195'	Trace	0.01	0.05	Nil
195'	200'	Trace	0.01	0.03	Nil
200'	205'	Trace	0.02	0.02	Nil
205'	210'	Trace	0.01	0.04	Nil

MW.80-4 was collared on line 16S at 19+50W to test an EM.17 anomaly and drilled to a depth of 250 feet. The drill hole did not intersect a conductor.

contd. ...

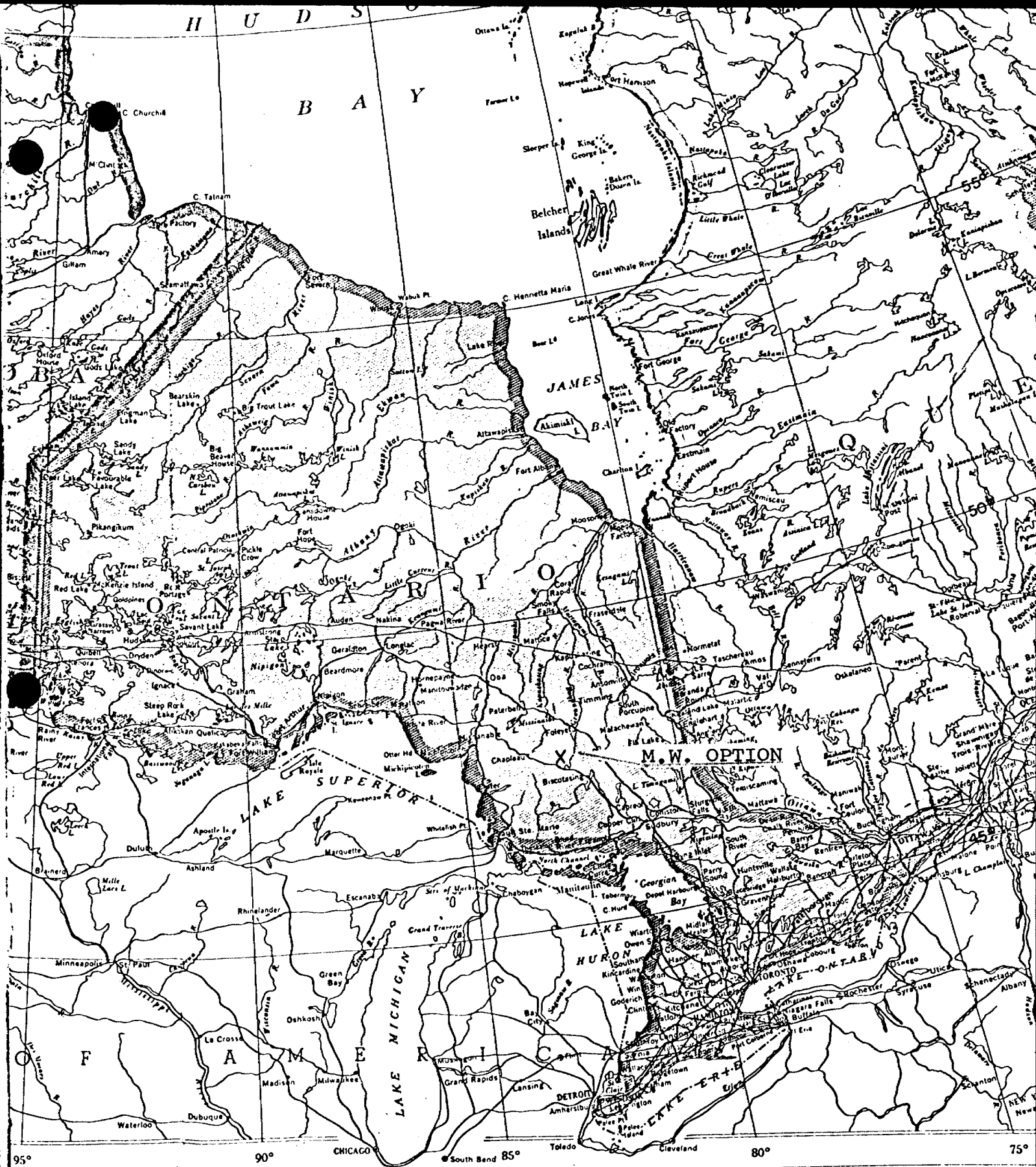
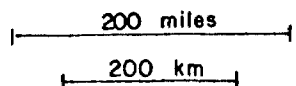
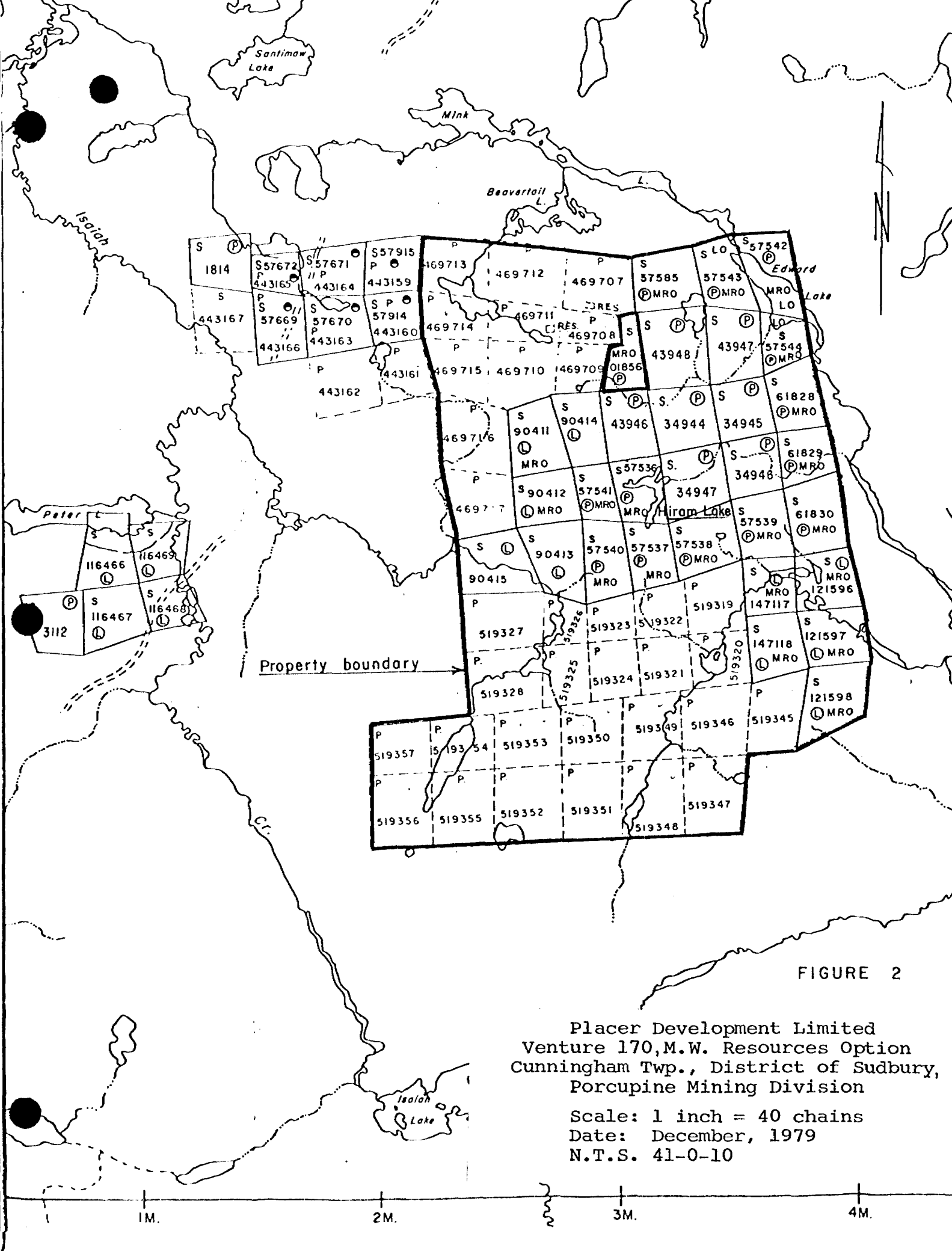

FIGURE 1 GENERAL LOCATION MAP





Placer Development Limited
 Venture 170, M.W. Resources Option
 Cunningham Twp., District of Sudbury,
 Porcupine Mining Division
 Scale: 1 inch = 40 chains
 Date: December, 1979
 N.T.S. 41-0-10

SUMMARY

The drilling program found nothing of economic significance.

Respectfully Submitted,

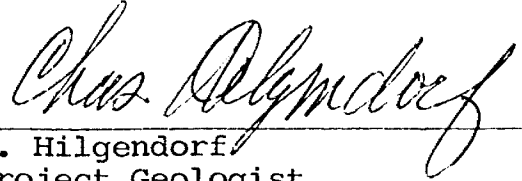

C. Hilgendorf
Project Geologist

CH/of

PROPERTY V.170 M.W. Option
 GRID South Grid
Claim P.519324

PLACER DEVELOPMENT LIMITED
 DIAMOND DRILL LOG

HOLE NO. MW.80-3
 SHEET 1 OF 2

LOCATION Cunningham Twp., Ontario AZIMUTH Grid W DATE COLLARED Sept.22/80 LOGGED BY C.Hilgendorf
 LATITUDE 16+00S CORE SIZE BQ DIP -45° DATE COMPLETED Sept.24/80 DATE Sept.23-24, 1980
 DEPARTURE 15+60W ELEVATION _____ LENGTH 250' DRILLED BY Bradley Bros. Limited

FOOTAGE	DESCRIPTION	Sample footage	Sample number	% Ni	% Cu	% Zn	Au oz./t	Ag oz./t
0-15	Casing.							
15-40	Andesite - medium grey, amygdaloidal, carbonatized, sheared, fine grained with calcite stringers @ 10° & 45° to core. Trace of disseminated pyrite.							
40-77	Andesite - medium grey, blocky, carbonatized with ± 1% calcite stringers @ 10° & 30° to core. Contact gradational with above.							
77-126.5	Andesite - fine grained, medium grey, sheared, carbonatized, amygdaloidal, with calcite stringers @ 50° to core. Contact is sharp at 30° to core.							
	@ 79-82' Quartz vein with ± 2% pyrite.	79-82	1280		0.04		Tr	Nil
	@ 85.5-86.5' Quartz vein with ± 2% pyrite.	85.5-86.5	1281		Tr		Tr	Tr
	Above veins @ 30° to core.							
	@ 109-111' Quartz vein @ 45° to core with ± 0.5% massive pyrite & pyrrhotite.	109-111	1282	0.01	0.01		Tr	Tr

Engineer _____

Footage	DESCRIPTION	Sample	Sample number	% Ni	% Cu	% Zn	Au oz/t	Ag oz./t
126.5-178.5	Andesite - fine grained, light grey, spherulitic, chloritic with shearing @ 50° to core. Up to 1% quartz stringers @ 30° to core. Carbonatized throughout.							
	@ 126.5-133' quartz breccia with trace of pyrite in blebs.	126.5-133	1283	0.01	0.06		Tr	Nil
178.5-190	Siltstone - dense, dark green, graphitic, chloritic, and sheared at 50° to core. Banding and massive pyrrhotite @ 50° to core. Up to 30% pyrrhotite.	178.5-184	1283	0.01	0.07		Tr	Nil
		184-190	1285	0.01	0.06		Tr	Nil
190-210	Andesite - Fine grained, dark grey, chloritic amygdaloidal, brecciated and carbonatized. Up to 1% quartz veins @ 60° to core. ± 20% pyrrhotite in blebs and veins.	190-195	1286	0.01	0.05		Tr	Nil
		195-200	1287	0.01	0.03		Tr	Nil
		200-205	1288	0.02	0.02		Tr	Nil
		205-210	1289	0.01	0.04		Tr	Nil
210-226.5	Andesite - fine grained, medium grained, chloritic, carbonatized with ± 1% quartz veins @ 30° & 60° to core. Trace of pyrrhotite.							
226.5-250	Andesite - fine grained, dark grey, amygdaloidal, brecciated, chloritic and carbonatized. ± 1% quartz veins @ 30° & 60° to core. ± 1% pyrite in blebs.							
250	END OF HOLE. Acid Test @ 250' 45°							

Chas. K. [Signature]

PROPERTY V.170 M.W. Option
 GRID South Grid
Claim P.519325

PLACER DEVELOPMENT LIMITED
 DIAMOND DRILL LOG

HOLE NO. MW.80-4
 SHEET 1 OF 1

LOCATION Cunningham Twp., Ontario AZIMUTH Grid W DATE COLLARED Sept.24/80 LOGGED BY C.Hilgendorf
 LATITUDE 16+00S CORE SIZE BQ DIP -45° DATE COMPLETED Sept.25/80 DATE Sept.26, 1980
 DEPARTURE 19+50W ELEVATION _____ LENGTH 250' DRILLED BY Bradley Bros. Limited

FOOTAGE	DESCRIPTION	Sample footage	Sample number	% Ni	% Cu	% Zn			
0-11	Casing.								
11-250	Andesite - fine grained, medium grey, chloritic, carbonatized, blocky with quartz and carbonate stringers throughout at 30° & 45° to core.								
	@ 134.5-146' mauve silicified section with a trace of pyrite in crystals.								
	@ 129.5' 1' quartz vein with fine pyrite seams.								
250'	END OF HOLE.								
	Acid Test @ 250' 45°								

C.H. Hilgendorf

X-RAY ASSAY LABORATORIES LIMITED

1885 LESLIE STREET, DON MILLS, ONTARIO M3B 3J4

PHONE 416-445-5755

TELEX 06-986947

CERTIFICATE OF ANALYSIS

TO: PLACER DEVELOPMENT,
SUITE 2600, 401 BAY ST.,
P.O. BOX-66
TORONTO, ONTARIO.
M5H 2Y4

REPORT 8649

REF. FILE 5214-12

14 S. CORES SUBMITTED ON 29-SEP-80

WERE ANALYSED AS FOLLOWS:

	UNITS	METHOD	DETECTION LIMIT
AU	OZ/TON	FA	0.010
NI	%	XRF	0.010
CU	%	XRF	0.010
ZN	%	XRF	0.010
AG	OZ/TON	FA	0.200

DATE 14-OCT-80

X-RAY ASSAY LABORATORIES LIMITED

CERTIFIED BY

J.H. OPDEBEECK

SAMPLE AU OZ/TON NI % CU % ZN % AG OZ/TON

SAMPLE	AU OZ/TON	NI %	CU %	ZN %	AG OZ/TON
1280	TRACE	--	0.04	--	NIL
1281	TRACE	--	TRACE	--	TRACE
1282	TRACE	0.01	0.01	--	TRACE
1283	TRACE	0.01	0.06	--	NIL
1284	TRACE	0.01	0.07	--	NIL
1285	TRACE	0.01	0.06	--	NIL
1286	TRACE	0.01	0.05	--	NIL
1287	TRACE	0.01	0.03	--	NIL
1288	TRACE	0.02	0.02	--	NIL
1289	TRACE	0.01	0.04	--	NIL

FEET ← Grid West
 L. 16+00 S 21 W 20 W DDH MW80-4 16S, 19+50W 19 W 18 W P 519325 EM-17 P 519324 anomaly 17 W DDH MW80-3 16 W 16S, 15+60W 15 W FEET

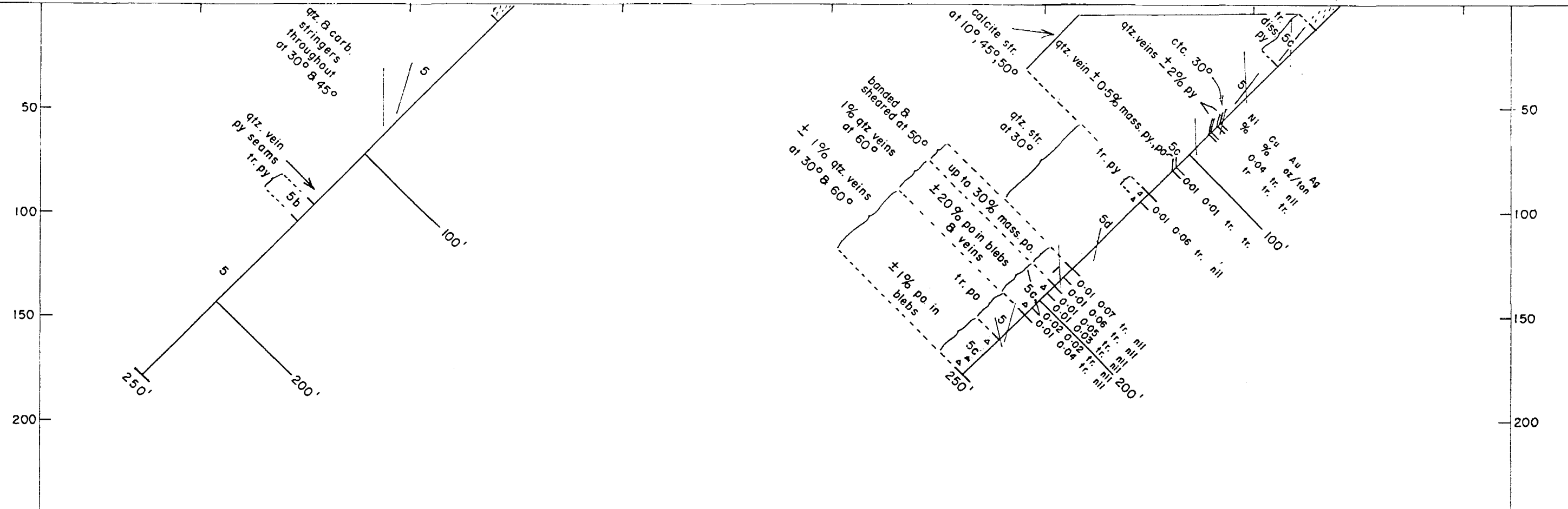

LEGEND (order does not indicate age)

- 5 Andesite
 - b) silicified
 - c) amygdaloidal
 - d) spherulitic
- 1 Siltstone
- Overburden
- △ △ △ Brecciated

DRAWN J.G.W.	SCALE 1" = 50'	PLACER DEVELOPMENT LIMITED	SECTION 16+00S looking grid north
TRACED	DATE Nov. 1980	M.W. RESOURCES OPTION	SOUTH GRID (West of B.L. 1)
APPROVED		Cunningham Twp., Ontario	FILE NO. NTS 41-0-10 V 170 Dwg. No. 170-22

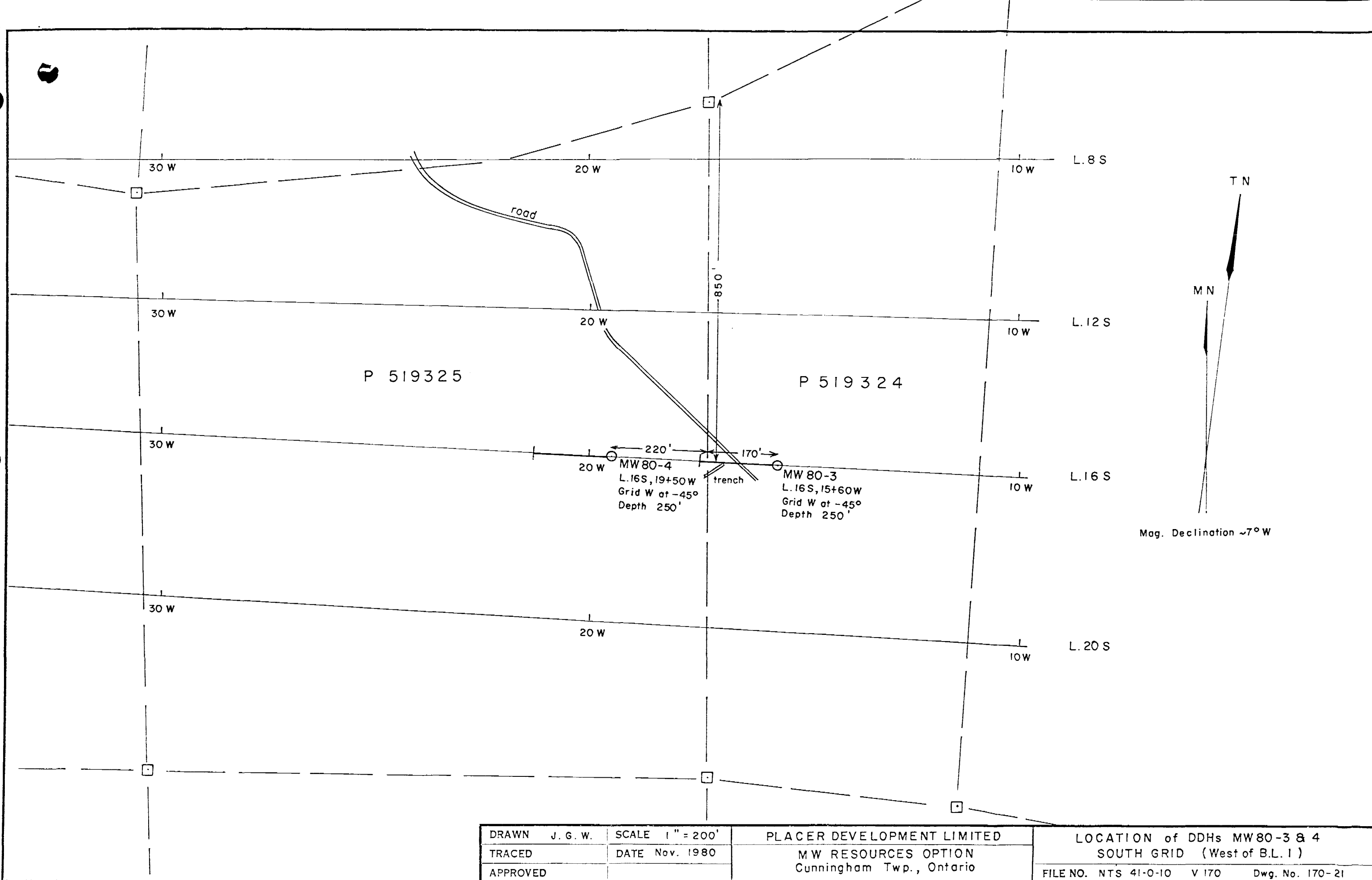

P 519325

P 519324

MW 80-4
L. 16 S, 19+50 W
Grid W at -45°
Depth 250'

MW 80-3
L. 16 S, 15+60 W
Grid W at -45°
Depth 250'

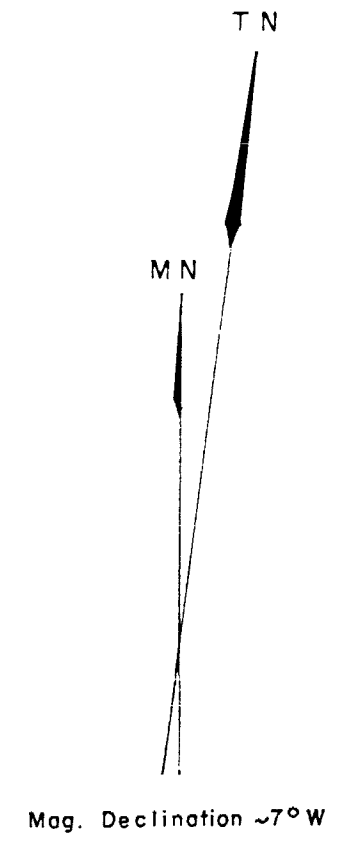

DRAWN J. G. W.	SCALE 1" = 200'	PLACER DEVELOPMENT LIMITED	LOCATION of DDHs MW 80-3 & 4
TRACED	DATE Nov. 1980		
APPROVED		Cunningham Twp., Ontario	FILE NO. NTS 41-0-10 V 170 Dwg. No. 170-21