



41010NE0074 10 CUNNINGHAM

010

Diamond Drilling

Township of CUNNINGHAM

Report No. 10

Work performed by: J.E. Derragh & Maneast Uranium

Claim No	Core No	Depth	Date	Notes
S 57672	1	259'	July/52	
	2	251'	July/52	
	3	240'	July/52	
	4	250'	July/52	
S 57671	5	423'	July/52	
	M.S.1	400'	Jan/56	
S 57670	M.S.2	150'	Feb/56	
S 57669	M.S.3	400'	Mar/56	

73

Notes:

STATE OF MONTANA
 COUNTY OF TOWNSEND
 SODDUM MOUNTAIN MINES

REPORT OF THE
 CLAIMS AND - S-576669, 41-90
 S-576670

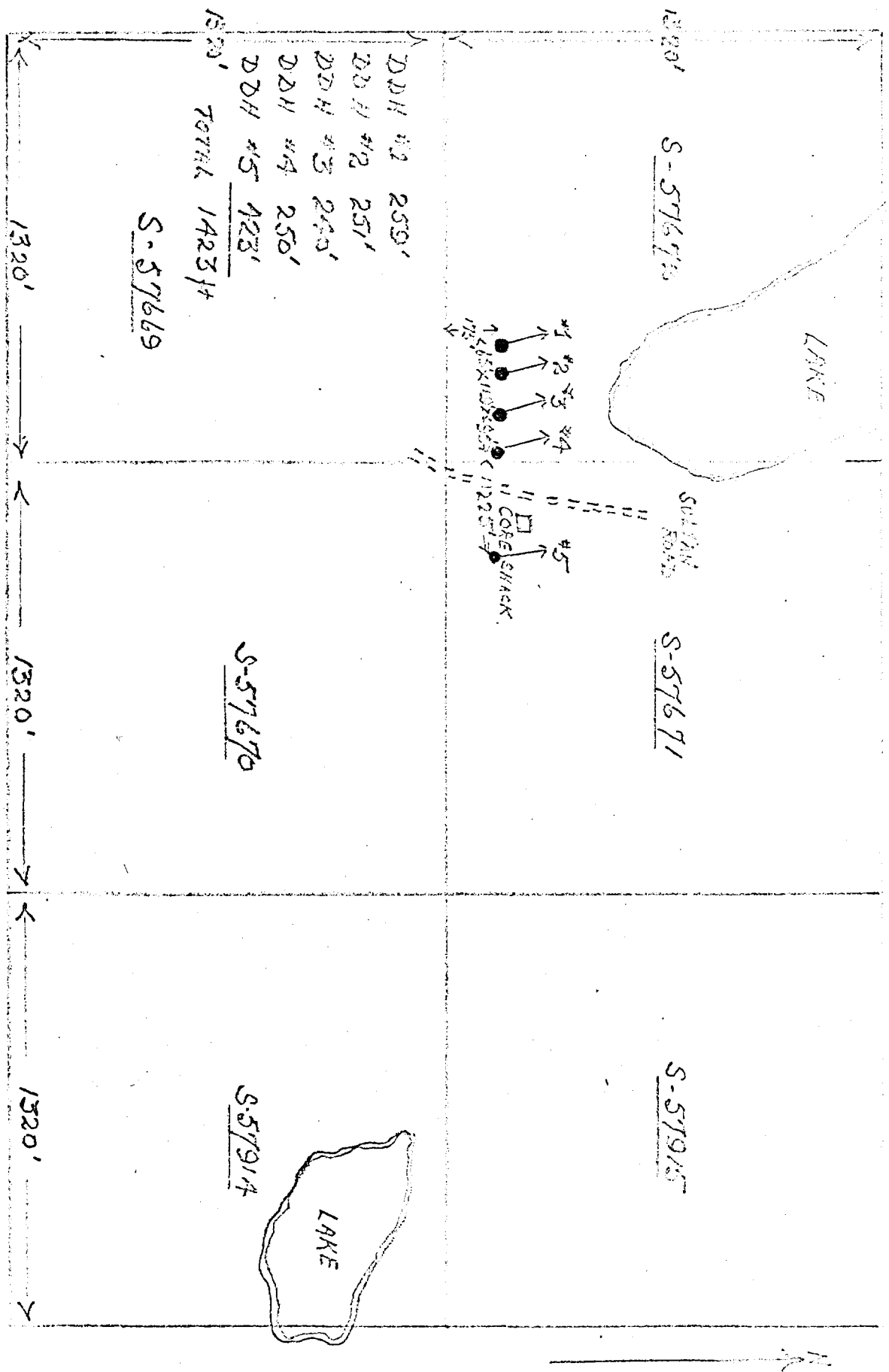

Scale 1 in = 490 ft

28 October, 1968

PROPERTY ST. DEBRAUGH - CUNNINGHAM TWP. SH.

CORNER No. 5-57669-72192
S 57914, 15

DIAMOND DRILL RECORD

HOLE NUMBER 1

SHEET NUMBER 1

SECTION FROM _____ TO _____

LOCATION: LAT _____ DEP _____

ELEVATION OF COLLAR _____

DATUM _____

DIRECTION AT START: BEARING N 30° W DIP 75°

STARTED 7 JULY 1952

COMPLETED } _____

ULTIMATE DEPTH 259'

PROPOSED DEPTH _____

DEPTH FEET	FORMATION	SAMPLE NO.	WIDTH OF SAMPLE	GOLD \$	SLUDGE GOLD \$
0-6	CASING				
6-56	POPHYRIC ORE-BODITE - MASSIVE				
56-196.5	IRON FORMATION. BANDS ASSOCIATED in places contains small amount pyrite or calcite.				
196.5-259	Associated Iron formation with many small dykes. Some alteration in short sections.				
	End of hole 259'				

PROPERTY J. E. DERAGUGH - CUNNINGHAM TOWNSHIP

CLAIMS Nos. 5-57669-72 170
5-57941 15

DIAMOND DRILL RECORD

HOLE NUMBER 2
 SHEET NUMBER 1
 SECTION FROM _____ TO _____

LOCATION: LAT. _____ DEP. _____
 ELEVATION OF COLLAR _____
 DATUM _____
 DIRECTION AT START: BEARING N 30° W DIP 45
 STARTED 2 JULY 1952
 COMPLETED 1
 ULTIMATE DEPTH 251 ft
 PROPOSED DEPTH _____

DEPTH FEET	FORMATION	SAMPLE NO.	WIDTH OF SAMPLE	GOLD \$	SLUDGE GOLD \$
0-12	CASINGS				
12-52	Indesite or fine grained phase of diorite, contains a few rounded Qtz inclusions and very small Feld. Pheno-crysts.				
52-62	Field Por Silicified, dk gray, fairly massive				
62-187	Iron formation - sheared & fractured and containing Qtz, Calcareate & Siderite				
187-215	Iron formation - less brecciated				
215-218	17 1/2 Perphyry, highly carbonated.				
218-251	Iron formation - all banded with high percentage silates				
END OF HOLE 251 Ft					

PROPERTY OF DEERQUEN - SUNNINGHAM TOWNSHIP
 CLAIMS Nos. S-57669-72 ac.
 S-57914 & 15

DIAMOND DRILL RECORD

HOLE NUMBER 3
 SHEET NUMBER 1
 SECTION FROM _____ TO _____

LOCATION: LAT _____ DEP _____
 ELEVATION OF COLLAR _____
 DATUM _____
 DIRECTION AT START: BEARING N 30° W DIP 45°

STARTED 5 JULY 1952
 COMPLETED 5
 ULTIMATE DEPTH 240 Yd
 PROPOSED DEPTH _____

DEPTH FEET	FORMATION	SAMPLE NO.	WIDTH OF SAMPLE	GOLD \$	SLUDGE GOLD \$
0-12	CRASSING				
12-20	Greenstone - probably basalt				
20-56	Tuffaceous Periphyry. Massive. See Qtz eyes				
56-62	Dioritic inclusion - fine grained. Well mgn.				
62-95.6	Field spar. Periphyry - as above.				
95.6-110	Greenstone highly altered speckled with carboates. Quite mineralogical.				
110-182.7	Field spar. Periphyry - as above.				
182.7-199.4	Tuff formation. Banded & brecciated. Ab. chert slates. Fair well mgn.				
199.4-201.7	Field Spar. - as above.				
201.7-207.6	Chert - good sphaerite.				
207.6-222.3	Field Spar.				
222.3-224.1	Chert W. mgn.				
224.1-225	Field Spar.				
225-231	Fine grained siliceous contact rock.				
231-233	Chert. Well mgn.				
233-238	Altered Periphyry. Scattered phos. concretions				
238-240	Chert. Fair sphaerite.				

END OF HOLE 240 Yd.

PROPERTY J.E. BERRAUGH - CUNNINGHAM TOWNSHIP
 CLAIMS Nos. S-57769-78 in S-57914-15 **DIAMOND DRILL RECORD**

HOLE NUMBER 4
 SHEET NUMBER 1
 SECTION FROM _____ TO _____

LOCATION: LAT _____ DEP _____
 ELEVATION OF COLLAR _____
 DATUM _____
 DIRECTION AT START: BEARING N 30° W DIP 45°

STARTED } JULY 1952
 COMPLETED }
 ULTIMATE DEPTH 250 ft
 PROPOSED DEPTH _____

DEPTH FEET	FORMATION	SAMPLE NO.	WIDTH OF SAMPLE	GOLD \$	SLUDGE GOLD \$
0-7	Casing				
7-31.3	Silicious Breccia slates, andesite about 50 ft				
31.3-60	Highly silicious Breccia slates, argillite, cherty, etc. 28 ft				
60-98	Silicious Breccia Res. 38 ft				
98-127.2	Highly silicious Breccia Filled 29 ft				
127.2-220	Gr. Feld. Por. slatted Pyrite.				
220-223.1	Breccia - slates andesite.				
223.1-240	Gr. Feld. Por.				
240-250	Silicious slates & Breccia well 10 ft				
END OF HOLE 250 ft					

551771-72

HOLE NUMBER

5

SHEET NUMBER

1

SECTION FROM TO

PROPERTY J.E. DERRRUGH - SUNNINGHAM TOWNSHIP
S-57969-72 175
S-57914 115

DIAMOND DRILL RECORD

LOCATION: LAT.....

STARTED } JULY, 1952

ELEVATION OF COLLAR DEP.....

COMPLETED }

DATUM.....

ULTIMATE DEPTH 423 ft

DIRECTION AT START: BEARING.....

PROPOSED DEPTH

450

DEPTH FEET	FORMATION	SAMPLE NO.	WIDTH OF SAMPLE	GOLD \$	SLUDGE GOLD \$
0-6	Casing				
6-37.5	Qtz Breccia with chert & slates s.m.				
37.5-105.6	Iron Formation - slates				
105.6-113.6	Highly siliceous Breccia - Qtz & chert.				
113.6-117.6	Same Same way.				
117.6-131	Highly altered siliceous slates & quartzite				
131-141.9	Qtz Feld Porphyry s.m.				
141.9-327	Highly altered siliceous slates & quartzite chert & Qtz. containing many brecciated zones				
327-423	siliceous nodules grading to more basic material of dioritic texture.				
END OF HOLE 423'					

DRILLED BY CONTINENTAL DIAMOND DRILLING NORANDA SIGNED

PLAN OF DIAMOND DRILLING
1956

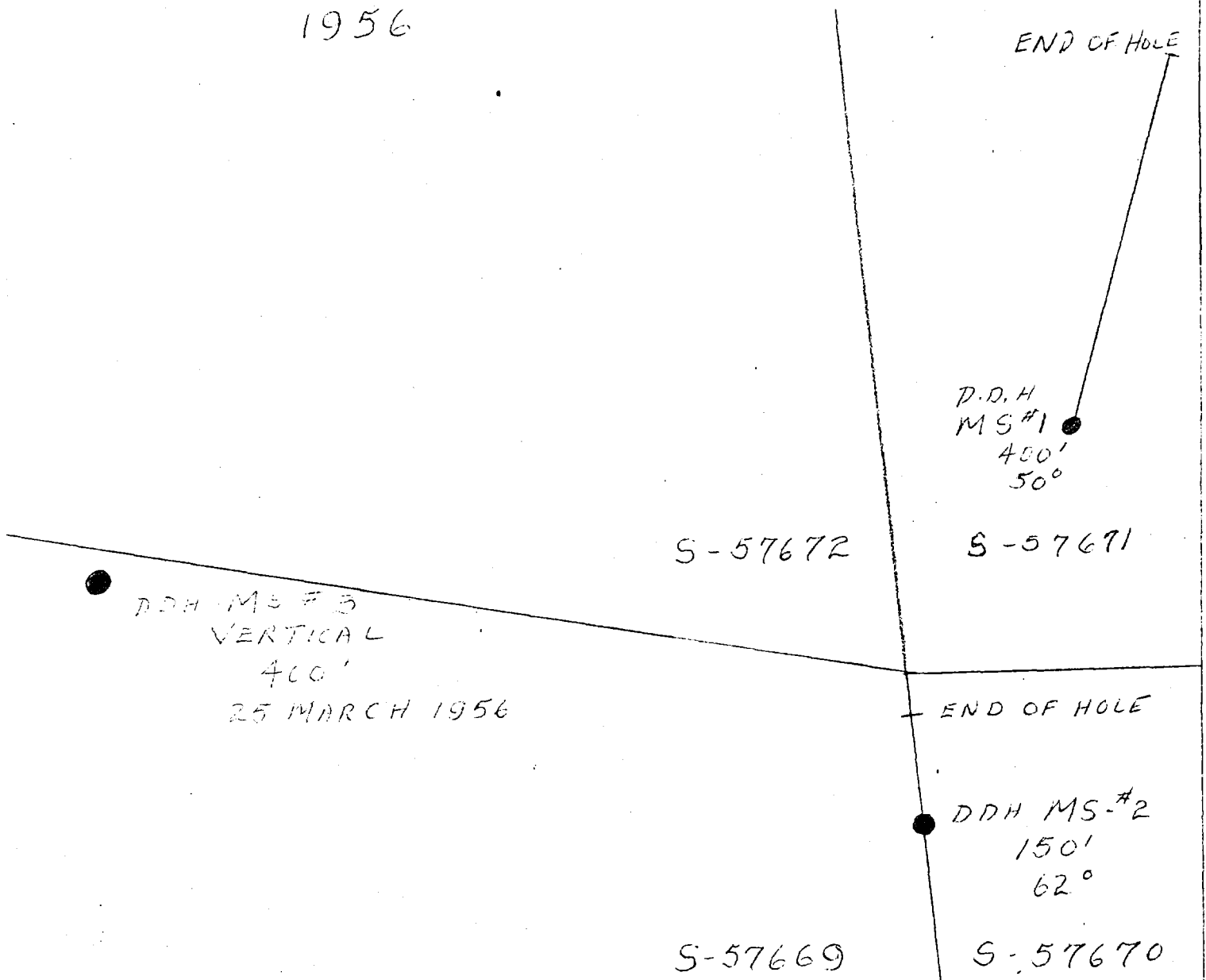

MANEAST URANIUM MINES LTD
CUNNINGHAM TWP

SCALE 1 IN = 100 FT

S.L. Macdonald

DIAMOND DRILL RECORD

PROPERTY Hancrest Uranium Mines Ltd. (Claim No. S-576771) HOLE No. M.S.I

SHEET NUMBER 1 SECTION FROM 0 TO 400 ft. STARTED Jan. 25th, 1956

LATITUDE..... DATUM Map Attached COMPLETED Feb. 23rd, 1956

DEPARTURE..... BEARING N 20° E ULTIMATE DEPTH.....

ELEVATION..... DIP 50° PROPOSED DEPTH.....

DEPTH FEET	FORMATION	SAMPLE NO.	FROM	TO	WIDTH	ASSAY VALUES		
						CU	PB	ZN
0-5'6"	Casing							
5'6"-100	I.F. Brecciated Banded sections some pyrrhotite							
100-125	I.F. 120-125 Porphyritic 106'6" - 110'6" a little ZN, PB & CU.							
125-133	Grey Porphyry No mineral							
133-200	I.F. a little pyrrhotite							
200-225	I.F. Bands of Dactite & Fine graded Diorite							
225-275	Dabase grading fine to coarse a little pyrite							
275-285'6"	Andesite 282 - 284 Graphitic							
285'6" -	308 Breccia min. pyrr.							
308-318	Vein form Qtz. pyrr. cu.	3601	308	311	3'	0.03		
318-350	Quartz Diorite	3602	311	314	3'	0.03		
350-359'7"	Greywacke pyrr.	3603	314	317	3'	0.03		
359'7" -	365 Dactite Graphite Pyrr.	3604	359'6"	362'6"	3'			

NORTHERN MINER FORM 505 REV./54
 DRILLED BY J. L. Pilon Limited, Box 90, Ferris, Ont. SIGNED W. J. MacKinnon

DIAMOND DRILL RECORD

PROPERTY Maneast Uranium Mines Ltd. (Claim No. S-57669) HOLE No. M.S.3

SHEET NUMBER 1 SECTION FROM 0 TO 400 ft. STARTED March 5, 1956

LATITUDE _____ DATUM _____ Map attached COMPLETED _____

DEPARTURE _____ BEARING _____ ULTIMATE DEPTH _____

ELEVATION _____ DIP _____ PROPOSED DEPTH _____

DEPTH FEET	FORMATION	SAMPLE NO.	FROM	TO	WIDTH	ASSAY VALUES			
0-8	Casing								
8-115	Diolite porphyritic								
115-125	I.F. a little pyrr.								
125-150	I.F. pb. cu. zn. Pyrr. Graphitic	3606	125	130	5'				
150-175	Cherty quartz zn. cu. pb. pyrr.	3607	130	135	5'				
175-225	I.F. Cherty Pyrr.	3608	135	140	5'				
225-275	I.F. sections Basalt porphyritic	3609	140	145	5'				
275-311	I.F. Pyrr. Cu. Graphite 275 - 280 Basalt	3610	145	150	5'				
311-328	Grey porphyry	3611	150	155	5'				
328-375	I.F. Cherty Pyrr.	3612	285	290	5'				
		3614	290	294	4'				
		3613	307'6"	310'9"	3'3"				
375-400	I.F. Banded Min. zn. Cu. Pb. Iron pyrite - andesite diorite								

NORTHERN MINER FORM 503 REV/54
 DRILLED BY J.L. Pilon Limited Box 90, Ferris, Ont.

SIGNED S.L. MacGraith

DIAMOND DRILL RECORD

PROPERTY Kanastot Uranium Corporation Ltd. HOLE No. MS-3

SHEET NUMBER 1 SECTION FROM 400 TO 747 STARTED March 26, 1956.

LATITUDE Map Attached DATUM Map Attached COMPLETED April 10, 1956

DEPARTURE Bearing BEARING Vertical ULTIMATE DEPTH 747 feet

ELEVATION DIP PROPOSED DEPTH

DEPTH FEET	FORMATION	SAMPLE NO.	FROM	TO	WIDTH	ASSAY VALUES					
400 - 450	Iron Formation Banded, Zn, Pb. and Cu. visible. 445 - 450 graphitic shear										
450 - 500	Diabase - fine grained 450 - 463 feet W. Min - Pyrrhotite small content Zn. Pb. & Cu.										
500 - 550	Diabase - narrow graphitic slips										
550 - 747	Diabase END OF HOLE										

NORTHERN MINER FORM 505 REV/54
DRILLED BY L. J. Pilon Ltd., Harris, Ontario. SIGNED S. A. W. G. G. G.