



41010NE0075 11 CUNNINGHAM

010

Diamond Drilling

Township of CUNNINGHAM

Report 11

Work performed by: Page-Harley Mines

Claim No	Hour		Date	Note
S 61030	19	365.5'	July/53	
	20	316.0'	July/53	
	21	276.0'	July/53	
	22	316.0'	July/53	
	23	295.0'	Aug/53	
	24	384.0'	Aug/53	
	25	175.0'	Aug/53	
S 62785	26	463.0'	Aug/53	
S 61132	27	386.0'	Aug/53	

Page 11

Notes:

DIAMOND DRILL RECORD, HOLE NO. 79

PROPERTY OF THE NORTHERN MINES LTD

75' CROWN

SHEET NUMBER

1 of 3

SECTION FROM

TO

STARTED

July 10/50

LATITUDE

DATUM

COMPLETED

July 20/50

DEPARTURE

BEARING

ULTIMATE DEPTH

2000'

ELEVATION

DIP 46°

PROPOSED DEPTH

DEPTH	FORMATION	SAMPLE NO.	FROM	TO	CORE WIDTH	GOLD	VALUES						
							AT	AT	AT	AT			
0-16	casing				1.000								
16-354	greywacke or dike (?) some not weathered & rusty												
	grey-green, contains semi-fossils	1428	354	404	5.0								
	fragments of cherty material with	1429	404	444	4.0								
	small veinlets of Zn. also some Pb	1430	444	465	2.1								
	with carbonate	1431	465	517	3.2								
354-635	Chert blue-grey, brecciated	1432	517	55	3.3								
	some small fractures with carb @	1433	55	58	3.0								
	45° to core well min with Zn and Fe	1434	58	63.5	5.5								
	Pb especially along breccia fragments	1435	63.5	67.7	4.2								
	in matrix. Some py. & pyrsh.	1436	67.7	72.7	5.0								
635-809	I.F. chert well brecciated	1437	72.7	77.7	5.0								
	and also tiny fractures with ^{good} zinc	1438	77.7	82.9	5.2								
	carbonate. Fair Zn some py.												

NORTHERN MINER FORM 505

Drilled by: Muckler core; 67.2-67.5, 6.5'; 71-72, 10';
15-18.8, 0.5'; 79.3-81, 1.1'

SIGNED

DIAMOND DRILL RECORD, HOLE NO. 19

PROPERTY

SHEET NUMBER 2 of 3 SECTION FROM _____ TO _____ STARTED _____
 LATITUDE _____ DATUM _____ COMPLETED _____
 DEPARTURE _____ BEARING _____ ULTIMATE DEPTH _____
 ELEVATION _____ DIP _____ PROPOSED DEPTH _____

DEPTH FEET	FORMATION	SAMPLE NO.	FROM	TO	WIDTH	GOLD VALUES			
						AT	AT	AT	AT
329-00	T.F. softer & carbonated, some shales but predominantly chert. Very little pyrite.								
30-2005	T.F. chert, blue grey much more pyrobitite & pyrite structure but not too well delineated. very little to no zinc mineralization. The rock has some carbonate fragments of chert with the pyrobitite occurring on head up to 3 ft. There are also fragments completely replaced by pyrite. Negative. Drill test for nickel, 187-189 more chloritoid, 207-208 chert with the fragments completely replaced by pyrobitite, none with pyrite. negative test for nickel								
2005-2006	T.F. mostly chert conspicuous disseminating pyrobitite and shales. Another irregular fracture.								
2006-2008	Pyrobitite about 65% with pyrite and a little pyrite. Some fragments negative test for nickel.								
2008-2013	same as 2005-2006. Some fine pyrite in chert. Drill test around 207, 212-214								

DIAMOND DRILL RECORD, HOLE NO. 19

PROPERTY _____

SHEET NUMBER 3 of 3 SECTION FROM _____ TO _____ STARTED _____
 LATITUDE _____ DATUM _____ COMPLETED _____
 DEPARTURE _____ BEARING _____ ULTIMATE DEPTH 365.5'
 ELEVATION _____ DIP _____ PROPOSED DEPTH _____

DEPTH FEET	FORMATION	SAMPLE NO.	FROM	TO	WIDTH	GOLD	VALUES			
							AT	AT	AT	AT
343-346	<i>T.F. The same but later fracturing has brought in some zinc and galena with carboniferous.</i>									
346-356	<i>T.F. chert blue and m. sh. appearance and well fractured.</i>									
356-5	<i>End of hole.</i>									
<i>One stored at camp site on elev. 5-576.22</i>										

DRILLED BY Carbocut A. S.

SIGNED [Signature]

DIAMOND DRILL RECORD, HOLE NO. 20

PROPERTY PAGE-HARLEY MINES

SHEET NUMBER 1 of 3 SECTION FROM _____ TO _____ STARTED July 23
 LATITUDE _____ DATUM _____ COMPLETED July 26
 DEPARTURE _____ BEARING _____ ULTIMATE DEPTH 316'
 ELEVATION _____ DIP 45° PROPOSED DEPTH _____

DEPTH FEET	FORMATION	SAMPLE NO.	FROM	TO	CORE WIDTH	VALUES			
						GOLD	AT	AT	AT
0-10.5	casing				1/2 in.				
10.5-27	Agglomerate with semiangular isclated pieces of chert in a medium grained matrix. Some pyrobitite replacement in the matrix.								
27-30	Lighter gray porphyritic silice, soft, massive. 225-230 coarse pyrobitite in chert fracture zone.								
30-42	Same as 10.5-27								
42-75	Lighter gray porphyritic matrix with some graphitic schistosity along core.								
75-90	Chert inclusions becoming more numerous, more than green matrix. Matrix slightly porphyritic. Some pyrobitite in chert inlets. Red chert inlets.								
90-100	Lighter gray, massive, brecciated.								

DIAMOND DRILL RECORD, HOLE NO. 20

PROPERTY

SHEET NUMBER 2 of 3 SECTION FROM _____ TO _____ STARTED _____
 LATITUDE _____ DATUM _____ COMPLETED _____
 DEPARTURE _____ BEARING _____ ULTIMATE DEPTH _____
 ELEVATION _____ DIP _____ PROPOSED DEPTH _____

DEPTH FEET	FORMATION	SAMPLE NO.	FROM	TO	CORE WIDTH	VALUES			
						GOLD	AT	AT	AT
100-139	1. cont'd carbonates filling fractures, calc. mott. ss.		100	106.4	6.1	0.68	3.72	0.19	
	very good iron Zn, Cu, Pb. some soft chert	1439	100	106.4	6.1	0.68	3.72	0.19	
	Similar to 1439 but not so well min.	1440	106.4	108.9	2.5	0.15	0.74	TR	
	Thin chert, somewhat dirty, some calc. ore	1441	108.9	113.2	4.3	0.37	1.74	0.04	
	Chert barren less Zn more pyritic	1442	113.2	118.2	5.0	0.07	nil		
	Chert barren good Zn	1443	118.2	122.4	4.2	0.32	0.99		
	Chert barren more pyritic	1444	122.4	129.1	6.7	TR	1.41		
	Good chert some soft pyritic chert	1445	129.1	134.1	5.0	0.16	0.87		
	Thin chert chert more pyritic	1446	134.1	139.1	5.0	0.10	0.50	0.03	
141-142	Chert barren iron Zn, Cu, Pb. some soft chert								
143-144	Chert barren iron Zn, Cu, Pb. some soft chert								
145-146	Chert barren iron Zn, Cu, Pb. some soft chert								

U.S. GEOLOGICAL SURVEY FORM 505

DEVELOPED BY _____

SIGNED _____

DIAMOND DRILL RECORD, HOLE NO. 20

PROPERTY

SHEET NUMBER 3 of 3 SECTION FROM _____ TO _____ STARTED _____
 LATITUDE _____ DATUM _____ COMPLETED _____
 DEPARTURE _____ BEARING _____ ULTIMATE DEPTH 316'
 ELEVATION _____ DIP _____ PROPOSED DEPTH _____

DEPTH FEET	FORMATION	SAMPLE NO.	FROM	TO	WIDTH	VALUES			
						GOLD AT	AT	AT	AT
225-245	Same as 1341-1323								
245-285	Softer dark grey like material, excellent texture yellow uniform, was cut contact at 45° to core 10' core cut at 250' end 255'. This grade is soft graphitic schist with occasional inclusions of blackish material with some pyrite along later fractures.								
285-295	Yellowish porphyry, specimen recovered at 35° to core, red line with iron and the surface similar to graphite in later direction.								
295-316	Chert appearance, greenish is a fine grained chert, some some pyrite in replacement.								

Core stored at camp site on Oct 15 - 1929

J. H. [unclear]

[Signature]

DIAMOND DRILL RECORD, HOLE NO. 21

PROPERTY PAGE-HARLEY MINES

B GROUP

SHEET NUMBER 1 of 3

SECTION FROM _____ TO _____

STARTED July 28

LATITUDE _____

DATUM _____

COMPLETED July 30

DEPARTURE _____

BEARING _____

ULTIMATE DEPTH 276'

ELEVATION _____

DIP 50°

PROPOSED DEPTH _____

DEPTH FEET	FORMATION	SAMPLE NO.	FROM	TO	CORE WIDTH	VALUES			
						GOLD	AT	AT	AT
0-5	clay								
5-15	Chert agglomerate & Breccia with druse & rusty facies 15' carb In this report core was almost 5' c long Pb in place and in ground study done.	1147	50	115	65				
15-27	Chert breccia and agglomerate, some chert pebbles, good pyrite @ 26'								
27-32	Dark brown mudstone & grey sandstone								
32-35	Dark silty mudstone & shaly sandstone								
35-40	Chert layers & breccia, some pyrite @ 36', some iron pyrite @ 38'								
40-45	Dark silty mudstone & shaly sandstone								
45-50	Dark silty mudstone & shaly sandstone								

DIAMOND DRILL RECORD, HOLE NO. 21 79

PROPERTY _____

SHEET NUMBER 2 of 3

SECTION FROM _____ TO _____

STARTED _____

LATITUDE _____

DATUM _____

COMPLETED _____

DEPARTURE _____

BEARING _____

ULTIMATE DEPTH _____

ELEVATION _____

DIP _____

PROPOSED DEPTH _____

DEPTH FEET	FORMATION	SAMPLE NO.	FROM	TO	CORE WIDTH (INCH)	GOLD VALUES			
						AT	AT	AT	AT
144-144.5	Basic dike, soft med grain med grey massive								
144.5-149.5	Chert agglomerate, good pyrite.								
149.5-251.5	ORE FORMATION, chert agglomerate well exposed, some chert, some carbonate, filling fractures carrying Zn Pb								
	10 min. Zn & some Pb	1448	149.5	105.5	5.0		0.68		2.65
	same but quite so well min.	1449	105.5	121	5.5		0.19		0.94
	Chert, not so well bed, some Zn	1450	121	263.0	12.8		0.10		4.1
	same better Zn	1451	263.0	212	8.2		0.25		0.60
	Basic dike, core black, some Pb	1452	212	215.1	3.1		0.03		4.1
	same where they were chert Zn	1453	215.1	220.7	5.6		0.33		1.54
	same Zn & Pb	1454	220.7	220.7	0.1		0.10		0.00
	same with Zn & Pb	1455	220.7	240.0	19.3		0.00		0.00
	Pyrite, Zn, Pb, some massive	1456	240.0	240	0.0		0.00		0.00
	Chert	1457	240	240	0.0		0.00		0.00

DIAMOND DRILL RECORD, HOLE NO. 31-20

PROPERTY

SHEET NUMBER 3 of 3 SECTION FROM _____ TO _____ STARTED _____
 LATITUDE _____ DATUM _____ COMPLETED _____
 DEPARTURE _____ BEARING _____ ULTIMATE DEPTH 276'
 ELEVATION _____ DIP _____ PROPOSED DEPTH _____

DEPTH FEET	FORMATION	SAMPLE NO.	FROM	TO	CORE WIDTH	VALUES									
						GOLD	AT	GOLD	AT	GOLD	AT	GOLD	AT		
172.5-247.5	Cont'd. Chert replacement, well min with pyrite, some lim.	1458	245	2515		nil		nil							
2515-276	Chert replacement rounded fragments in 266. 6" of good size of pyrite. 266.5-267.5 soft basic drift.														

Core stored at camp site on claim 5-11-1910

DRILLED BY W. H. ...

SIGNED W. H. ...

DIAMOND DRILL RECORD, HOLE NO. 22

PROPERTY PAGE-HABLEY MINES
B GROUP

SHEET NUMBER 1 of 3 SECTION FROM _____ TO _____ STARTED July 31/58
 LATITUDE _____ DATUM _____ COMPLETED Aug 7
 DEPARTURE _____ BEARING _____ ULTIMATE DEPTH 316'
 ELEVATION _____ DIP 50° PROPOSED DEPTH _____

DEPTH FEET	FORMATION	SAMPLE NO.	FROM	TO	CORR. WIDTH	VALUES			
						GOLD	AT	AT	AT
0-5	casing				length	AT	AT	AT	AT
5-15	Probably chert, conglomerate abundant, at min with pyrite some chert, many surfaces seams filled with rust	1459	5	11.5	6.5	TR.	nil	oro	
15-30	St. to some chert inclusions schistosity at 45° to some some massive pyrite								
30-45	Grey waste, scattered masses there is some resemblance of to bluish grey chert inclusions some thin graphitic planes at 45° to some some massive chert inclusions in chert at 45° to some some								

NORTHERN MINING FORM 100

PREPARED BY: _____

SIGNED: _____

DIAMOND DRILL RECORD, HOLE NO. 22

PROPERTY

SHEET NUMBER R of 3 SECTION FROM _____ TO _____ STARTED _____
 LATITUDE _____ DATUM _____ COMPLETED _____
 DEPARTURE _____ BEARING _____ ULTIMATE DEPTH _____
 ELEVATION _____ DIP _____ PROPOSED DEPTH _____

DEPTH FEET	FORMATION	SAMPLE NO.	FROM	TO	CORR. WIDTH	GOLD VALUES			
						AT $\frac{1}{16}$ "	AT $\frac{1}{32}$ "	AT $\frac{1}{64}$ "	AT _____
72-77 1/2	30% pyrochloite, some fair pyrite replacement								
78-125	Chert Breccia, abundant pyrochloite, some fine pyrite								
	Brilliant white fine grained Zn	1460	1245	120	55	0.17	0.57	0.09	
	Massive brown Brn, good Pb N.R. of 1/4". Some Cu	1461	120	1365	55				
125-200	Chert agglomerate, typical pyrochloite in matrix. 150.5-160.5								
	abundant with good size								
200-215	Chert in situ, brown chert	1462	205	205	45				
	Chert in situ, in the same	1463	205	210	50				
	Chert	1464	210	215	50				
215-220	Massive chert, abundant pyrite								

DRILLED BY _____

SIGNED _____

DIAMOND DRILL RECORD, HOLE NO. 22

PROPERTY _____

SHEET NUMBER 3 of 3 SECTION FROM _____ TO _____ STARTED _____

LATITUDE _____ DATUM _____ COMPLETED _____

DEPARTURE _____ BEARING _____ ULTIMATE DEPTH 316

ELEVATION _____ DIP _____ PROPOSED DEPTH _____

DEPTH FEET	FORMATION	SAMPLE NO.	FROM	TO	CORRECTION	GOLD	VALUES						
							AT	AT	AT	AT			
223-245	chert well fractured, m. n. with pyrite, some epidote												
224.5-241	Chert breccia, finer phase with carbonate nodules filling	1467	224.5	230	5.6								
	considerable fine disseminated	1468	230	235	5.0								
		1469	235	240.8	5.3								
241-	blue chert some kn	1460	241	251	4.0								
253	bluish chert, no buttons in places, shaly surfaces, some fine kn. 1470												
	become, chert nodules, considerable pyrite 1471												
263-1463	typical chert nodules, some pyrite, some chert nodules, some chert nodules												

Core stored at camp site in cloth bags

DIAMOND DRILL RECORD FORM 100

DRILLED BY _____

SIGNED _____

DIAMOND DRILL RECORD, HOLE NO. 23

PROPERTY FRYE-HARLEY MINES

SHEET NUMBER 1 of 1 SECTION FROM _____ TO _____ STARTED Aug 6
 LATITUDE _____ DATUM _____ COMPLETED Aug 8
 DEPARTURE _____ BEARING _____ ULTIMATE DEPTH 295'
 ELEVATION _____ DIP 50° PROPOSED DEPTH _____

DEPTH FEET	FORMATION	SAMPLE NO.	FROM	TO	CER. WIDTH	VALUES			
						GOLD	AT	AT	AT
0-8	Casing								
5-50	Slates with narrow bands of chert in intervals								
50-100	Greywacke & chert conglomeration - same narrow bands of chert								
100-105	Highly siliceous chert bedded								
	Coar. Zn & Pb	1469	104	108	4.0				
	Fine Zn & Pb	1470	108	113	5.0				
	Med. med. Zn & Pb	1471	113	135	5.5				
135-144	Soft brown shale, micaceous lime pebbles								
144-145	Chert conglomerate with lime pebbles, as above								
	Coar. med. siliceous chert								

BOULET PAT. 1,041,114 U.S. PAT. OFF.

DRILLED BY: W. J. ...

SIGNED: ...

DIAMOND DRILL RECORD, HOLE NO. 24

PROPERTY FRASER-HOBLEY MINES LTD

'B' GROUP

SHEET NUMBER 1 of 3

SECTION FROM _____ TO _____

STARTED Aug 10 / 53

LATITUDE _____

DATUM _____

COMPLETED _____

DEPARTURE _____

BEARING _____

ULTIMATE DEPTH _____

ELEVATION _____

DIP 50°

PROPOSED DEPTH _____

DEPTH FEET	FORMATION	SAMPLE NO.	FROM	TO	CORR WIDTH	VALUES				
						GOLD	AT	AT	AT	AT
0-5	Casing									
5-45	Chert agglomerate, rusty for the first few feet from 46 to 54. The core is not very well fractured generally. Some tiny veins of Fe to 70-73	1472	50	53.5	38					
45-74	Some more carbonaceous pyrite etc, some pyrite. 2 core ground to 70.5 to 71.5	1473	76	71.5	55					
74-100	More chert in narrow bands some Fe to 100.5	1474	88.5	93	75					
100-121	Chert some irregularly with pyrite and pyrochlore. It is a fine grained chert with some pyrite and pyrochlore. It is a fine grained chert with some pyrite and pyrochlore.									

DIAMOND DRILL RECORD, HOLE NO. 24

PROPERTY _____

SHEET NUMBER P of 3 SECTION FROM _____ TO _____ STARTED _____
 LATITUDE _____ DATUM _____ COMPLETED _____
 DEPARTURE _____ BEARING _____ ULTIMATE DEPTH _____
 ELEVATION _____ DIP _____ PROPOSED DEPTH _____

DEPTH FEET	FORMATION	SAMPLE NO.	FROM	TO	WIDTH	VALUES			
						GOLD AT	AT	AT	AT
226-2275	metamorphic phase some calcite and qtz.								
2275-2675	Chert with lens fragments and a more uniform section of the greenish in color. Sometimes are filled with tiny qtz and calcite shivers. Very little pyrite or pyroterite. No trace of mica. Bedding can be seen at times with occasional narrow bands of grey sandstone at 230' in some places when present at 66°								
2675-295	Microchert, slightly silty with many small bands of pyrite. Shaly chert at 295' to core.								
295-310	Microchert, silty, well fractured and somewhat shaly. Some pyroterite, 1/2" of fine mica. Bedding in well seen. Some shaly chert at 305-308. Soft pyroterite. Some mica. Some shaly chert at 310.								
310-315	Microchert, silty, well fractured and somewhat shaly. Some pyroterite, 1/2" of fine mica. Bedding in well seen. Some shaly chert at 305-308. Soft pyroterite. Some mica. Some shaly chert at 310.								

DRILLED BY _____

SIGNED _____

DIAMOND DRILL RECORD, HOLE NO. 24

PROPERTY _____

SHEET NUMBER 3 of 3 SECTION FROM _____ TO _____ STARTED _____

LATITUDE _____ DATUM _____ COMPLETED _____

DEPARTURE _____ BEARING _____ ULTIMATE DEPTH _____

ELEVATION _____ DIP _____ PROPOSED DEPTH _____

DEPTH FEET	FORMATION	SAMPLE NO.	FROM	TO	WIDTH	VALUES			
						GOLD	AT	AT	AT
257-258	30% cor'd pebbles in a greenish matrix of calcite and pyrite.								
259-264	Massive, fine-grained, speckled with small white phenocrysts.								
<p>Cone stored at camp site on claim S-54-72.</p>									

LOGSHEET NUMBER 1004-505

DRILLED BY Will A. ...

SIGNED [Signature]

DIAMOND DRILL RECORD, HOLE NO. 25

PROPERTY PAGE-HARLEY MINES LTD

'B' Group

SHEET NUMBER 1 of 1

SECTION FROM _____ TO _____

STARTED Aug 17

LATITUDE _____

DATUM _____

COMPLETED Aug 19

DEPARTURE _____

BEARING _____

ULTIMATE DEPTH 175'

ELEVATION _____

DIP 53°

PROPOSED DEPTH _____

DEPTH FEET	FORMATION	SAMPLE NO.	FROM	TO	WIDTH	VALUES			
						GOLD AT	AT	AT	AT
0-5'	Casing								
5-70.5	Chert, agglomerate, core is relatively unfractured, pyroclastic in nature. Core at 61 and 66 in fault planes. Very siliceous with some fine grained pyroclastic from 53-56.								
70.5-83	Black fine grained silty quartz schistose at 60° to east, some pyroclastic core at 83'								
83-91	Chert, black, well fractured, additional siliceous at 86' with some fine structures. Core black, 1-2' core lost, core at 87'. Some siliceous at 89-91' in an outer fine pyroclastic zone.								
91-100	Black pyrophyllous massive, contact at 89° to east, slightly siliceous in places.								
100-110	Chert with scattered chert fragments, but very siliceous in places. Unfractured, fine grained, some pyroclastic in nature.								
110-120	Chert with bands of agglomerate silty pyroclastic.								
120-175	Chert with bands of agglomerate silty pyroclastic.								

NORTHERLY QUARTER SECTION

EDITED BY _____

SIGNED _____

175' but not used Core lost at contact siliceous at 87'

DIAMOND DRILL RECORD, HOLE NO. 26

PROPERTY PAGE-HARLEY MINES LTD

SHEET NUMBER 1 of 2 SECTION FROM _____ TO _____ STARTED Aug 21/53
 LATITUDE _____ DATUM _____ COMPLETED May 26/53
 DEPARTURE _____ BEARING _____ ULTIMATE DEPTH 463
 ELEVATION _____ DIP 50° PROPOSED DEPTH _____

DEPTH FEET	FORMATION	SAMPLE NO.	FROM	TO	WIDTH	VALUES			
						GOLD AT	AT	AT	AT
0-6	Casing								
6-76	Andesite, med gray schistose. @ 75° to core, in zone tiny qtz veins, some disseminated pyrite. 83-85 core very blocky.								
76-100	Andesite, more altered than above and better developed pyrite mineralization. Some chert at 86.5, 88.								
100-117	Andesite, lighter gray, well altered. Fractured with tiny qtz stringers								
117-119	Altered greenstone, carbonated, 2 1/2' in with pyrite and with some especially good chert. Sharp contact at 115° some 117-118.								
119-120	Altered porphyry, altered and with light gray								
120-130	A hybrid zone of porphyry and calcite. Light gray calcite and chert. 130-140 pyrite and chert.								
130-140	Altered porphyry with quartz mineralization and some chert. 140-145 chert. Some light gray calcite.								
140-141	Chert, red green quartz, and calcite.								
141-142	Chert, thin, with some quartz. Very much altered.								

DIAMOND DRILL RECORD, HOLE NO. 26

PROPERTY

SHEET NUMBER B of B SECTION FROM _____ TO _____ STARTED _____
 LATITUDE _____ DATUM _____ COMPLETED _____
 DEPARTURE _____ BEARING _____ ULTIMATE DEPTH _____
 ELEVATION _____ DIP _____ PROPOSED DEPTH _____

DEPTH FEET	FORMATION	SAMPLE NO.	FROM	TO	WIDTH	VALUES			
						GOLD AT	AT	AT	AT
271-370	Greenstone schistose and altered. Considerable pyrite, especially around 277, 282, 291, 300, 301, 334-335. Tubular 334-346.								
370-379	Chert, argillaceous, chert pebbles in argillaceous matrix.								
379-380 1/2	Chert, well fractured at 35° to 40° dip, with pyrite, some iron and pyrite at 368.								
389-409	Dk. bl. sh. grey speckled with light grey pyrite. Massive spots of yellowish brown iron ore at 394, 395.								
409-414	Greenish sh. chert, bluish argill. thin grain. Sh. chert with light fractures, some pyrite.								
414-420	Argillaceous sh. some white sh. pyrite at 414, 415.								
420-421	White sh. chert, massive, some pyrite, some iron ore. Sh. chert with light fractures.								

AMERICAN BUREAU OF MINE

DRILLED BY

W. C. D. D. D.

SIGNED

W. C. D. D. D.

DIAMOND DRILL RECORD, HOLE NO. 27

PROPERTY PAGE-HARLEY MINES LTD

SHEET NUMBER 1 of 2 SECTION FROM _____ TO _____ STARTED Aug 27/53
 LATITUDE N 3476.2 DATUM _____ COMPLETED 3/7/54
 DEPARTURE E 0065.3 BEARING N 48° E ULTIMATE DEPTH _____
 ELEVATION 5098.3 DIP 45° PROPOSED DEPTH _____

DEPTH FEET	FORMATION	SAMPLE NO.	FROM	TO	WIDTH	GOLD VALUES			
						AT	AT	AT	AT
0-5	Casing								
5-31	Iron formation brecciated cherts with cementing carbonate. many spots of Co. & Zn throughout as well as much pyrite etc.								
31-51 1/2	I. F. intersecting bands of slates, cherts, pyrite etc, some of it interstratified iron brecciated as above, a few spots of Zn.								
51 1/2-60	Chert breccia with fine iron ore 32-54 1/2								
60-105	Slates shaly, slightly graphitic, some Mn. Zn also some iron ore breccia with carbonate filling.								
105-140	Same as 31-54 1/2								
140-172	Chert breccia with a bright green matrix, a lot of iron ore, graphitic chert some at 155.								
172-175	Slates in blocks of pyrite always rusty.								
175-178	Chert breccia some no min.								
178-180	Chert breccia and gang pyrite, pyrite								
180-185	Intersecting bands of chert, iron ore, pyrite								

DIAMOND DRILL RECORD, HOLE NO. 27

PROPERTY

SHEET NUMBER R of R SECTION FROM _____ TO _____ STARTED _____
 LATITUDE _____ DATUM _____ COMPLETED _____
 DEPARTURE _____ BEARING _____ ULTIMATE DEPTH _____
 ELEVATION _____ DIP _____ PROPOSED DEPTH _____

DEPTH FEET	FORMATION	SAMPLE NO.	FROM	TO	WIDTH	VALUES			
						GOLD AT	AT	AT	AT
174 1/2 - 200	cont'd. specks of Cu. & pyrite especially along the seams are planes of the slates which are often graphitic with some fine								
200 - 206	Slate & ground care, graphitic & finely brecciated. Some fine Pb & Zn 10' were lost								
206 - 206	shale? light grey speckled with a dark grey sh. no of banding. some dissem. pyrite in the matrix. 10' of 6" of buff gr. at 303. more shaly & brecciated, calc. at 304 307. 317 1/2 - 320 care, no care drilled experiment. 321 - 330 lost care or care, 334 1/2 - 335 1/2 lost care or care. then became progressively more shaly & calc. with some mica. 336 - 340 340 - 340 shaly. at 340 to 340. 340 - 340 shaly & calc. 340 - 340 shaly & calc. Care started at sample site on elev. 5-287 1/2								

A PLAN OF
A & B GROUPS
PAGE-HARLEY MINES
 CUNNINGHAM TOWNSHIP
 ONTARIO

SCALE: 1" = 200'

1953

Report # 11
 Cunningham Map

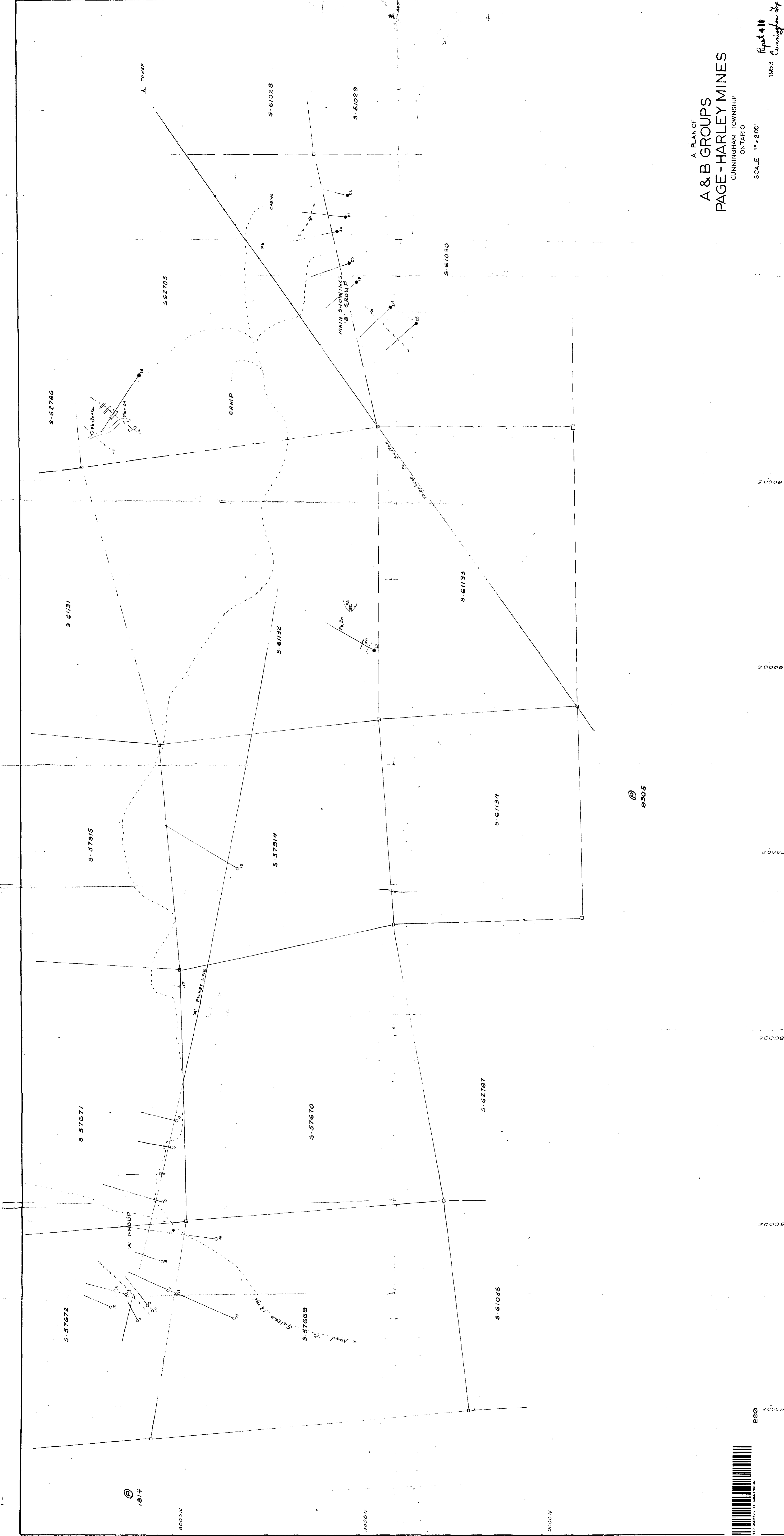

MINES 11 CUNNINGHAM

200

70000

50000

70000

70000

70000

70000

9305

1614

50000

40000

30000