



41010NE0084 19 CUNNINGHAM

010

MINING

Township of CUNNINGHAM

Report 19

work performed by, Sunshy Mines

Claim No	Section	Area	Date	Notes
S 115366	SH-64-1	235'	July/64	
S 115365	SH-64-2	282'	July/64	
S 115358	SH-64-3	362'	July/64	
S 115345	SH-64-4	362'	July/64	
	SH-64-5	253'	July/64	

Notes:

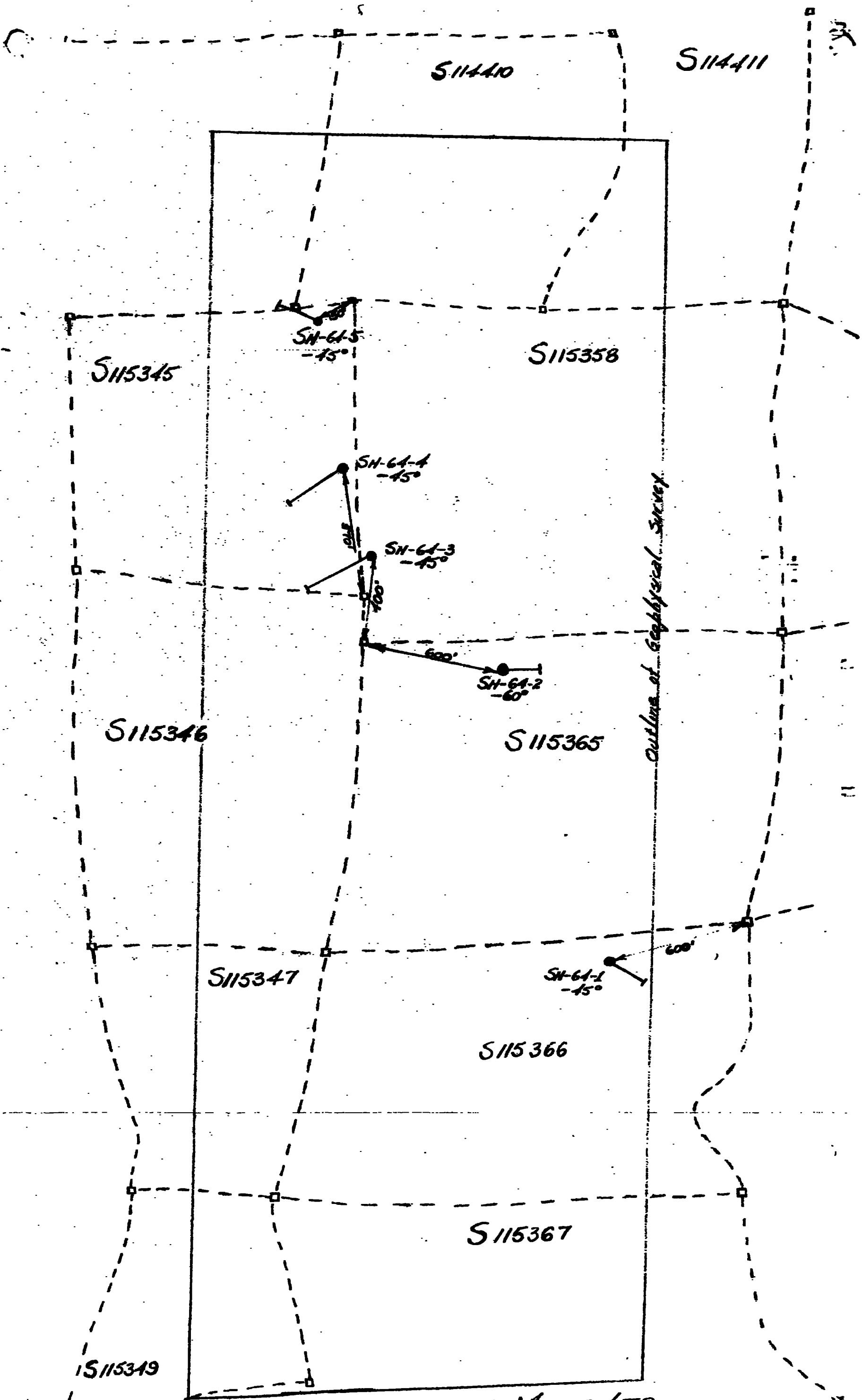

SHUNSBY MINES LTD.
 CUNNINGHAM TWP.
 Scale 1" = 400'

SHIVERS THICK LOGS

Hole No. Sh-64-1 Dig -15' Location - N 22 S
 Property: Shivers Mines: (Lippon Colton) Cunningham Inv. Date - July 6/64
 Location: 26+80S; 4790 Grid "A" Elev. - Not Surveyed

Depth	Description of Core	Sample No.	Sample Depth	Width	% Cu	% Zn	% Ni	% Pb
99.2	Chlorite schistose rock; schistosity sub-parallel to core. Sulfides lean and disseminated.	5109A	100-103	3	0.03	0.18	72	Nil/Nil/Nil Ag, Ag
103.1	Carbonaceous slate with chert clert. Massive Sulfides Pyrite Pyrrhotite, Cpy.							
104.7	Chlorite schist with lean disseminated Pyrite.							
106.7	Carbonaceous slate with chert Bx. Massive Sulfides Pyrrhotite, Pyrite, Cpy (Tr.)							
112	Brecciated Andesite much chloritized & shows K&C type Brecciation Occasional chert fragments Lean mineralization mostly Pyrite, Pyrrhotite							
235	Grey to Green "Porphyry" Fine to med. grained & Chloritized. Occasionally weakly schistose thin streaks CO ₂ Occasional Pyrite Stringers. This rock appears to be a lava and shows vesicularity on Occasion possibly an Andesite							

SHERBY THMS LIMITED

Hole No. Sh-64-1 Dip -45°

Strike - N 22 S

Property: Shunshy Mines: (Whipon Option) Comstock Prop.

Date - July 1/64

Location: 36+00S; 8+75E Grid "A"

Flow. - Not surveyed

Depth	Description of Core	Sample No.	Sample Depth	Width	Cu	Zn	Pb	Ag
225	End of Hole							

Drilled by Continental Diamond Drilling
West at 225' Corrected 4'
Casing Salvaged
Started June 28.
Completed " 29.

Logged by: C.T. Pasfale
Approved: Herman H. Urcel P. ENG.
Herman H. Urcel

9+00E

Over burden

Brecciated Carbonaceous Slate

Diorite

Chert Breccia

Chlorite

Brecciated Carbonaceous Slate-Chert

Chlorite

Chert Breccia

Brecciated Andesite

Diorite

End of Hole

SHUNSBY MINES LIMITED

DDH-SH-64-1

COLLAR- 36+80S-8+75 E

SECTION - E - 32°S

SCALE - 1" = 40'

SERIES 2 INGS LIT TEND

Hole No. Sh-64-2 Dip -60° Strike - East
 Property: Shinsky Mines: (Highway Station) Cunningham Twp. Date - July 8/64
 Location: 27S; 3450E Grid "A" Elev. - Not Surveyed

Depth	Description of Core	Sample No.	Sample Depth	Width	Cu	Zn	Pb	Mn	Au	Ag
93.56	Fine grained Andesite doleritic (30" square Pyrite)									
94.3	Bx. of Black shale & clotted massive Sulphides, Pyrrhotite, Pyrite, Qz.									
122.0	Blue to Green Andesite, Very slight breccia (bx) CO ₃ Stringers. Poor irregular cohesivity	7411A	122.9'-138.6'	5.7'						
138.7	Black crystalline shale with siliceous bands. Massive Sulphides, Pyrite, Pyrrhotite, Qz.									
140.8	Fine grained andesite									
143.9	Black shale with silica bands massive Sulphides, Pyrrhotite, Pyrite, Qz.									
155	Medium grained Andesite									
146.1	Carbonaceous shale & silica Bx. with flocs Pyrrhotite									
202	Fine to medium grained Andesite with minor stringers CO ₃ Occasionally softens with, no consistent direction									

Te. Nil

STANDARD TEST LOG

Well No. 21-64-2 Dip -60°

Strike - East

Property: Spindly Mines: (Hydron Option) Cunningham Wp.

Date - July 1/64

Location: 21S; 34T0E 11th 11W

Now - Not Salvaged

Depth	Description of Core	Sample no.	Sample Depth	Feet	in	ft	in	ft	in
-------	---------------------	------------	--------------	------	----	----	----	----	----

212 11W of Hole

AX Core
Drilled by Continental Diamond Drill Inc.
Fest at 270' Connected to
Casing Salvaged
Started July 1.
Completed " 2.

Logged by: C.F. Pasfalo

Approved: FORMAN H. HESOL P. INC.

Norman D. Wood

4+00E

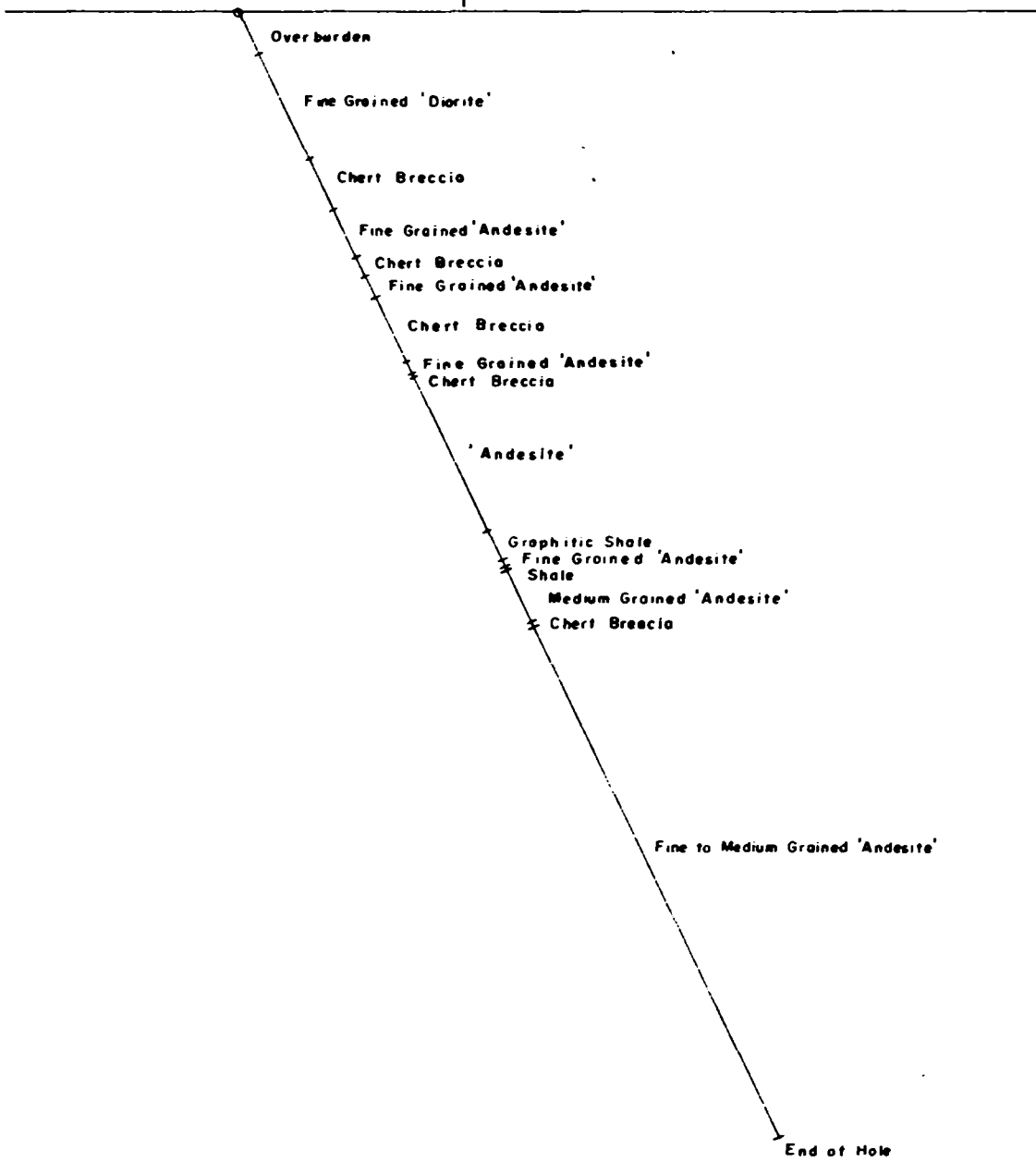

SHUNSBY MINES LIMITED

DDH-SH-64-2

COLLAR-24+00S-3+50E

SECTION - E

SCALE - 1" = 40'

SHREVE & THOMAS LIMITED

Hole No. S-54-3 Dip -45°

Strike - N 30 S

Property: Shansby Mines: (Million Option) Cunningham Prop.

Date - July 8/54

Location: 19+00S; 3+00E Grid "A"

Blow - Not Surveyed

Depth	Description of Core	Sample No.	Sample Depth	Width	Cu	Zn	Pb	Mn	Au	Ag
-------	---------------------	------------	--------------	-------	----	----	----	----	----	----

362 End of Hole

AT Core
Drilled by Core-located Diamond Drilling
Tests 350' Core-located 1/4"
Casting collected
Started July 7.
Completed " 5.

Logged by: G.T. Pascheta

Approved: Norman H. Fred P. Ing.

Norman H. Fred

→ WEST

3+00W

Overburden

Medium Grained Andesite

Fine Grained Andesite

Medium Grained Andesite

Fine Grained Andesite

Medium Grained Andesite

Fine Grained Andesite

Medium Grained Andesite

Fine Grained Andesite

Medium Grained Andesite

End of Hole

SHUNSBY MINES LIMITED

DDH-SH-64-3

COLLAR-19+00S-3+00W

SECTION- W-30°S

SCALE-1"=40'

SHERBORN LITHOLOG

Hole No. SH-44-4 Dip -15°

Strike - N 34 S

Property: Shamsby Mines: (Hudson Cotton) Cambridge Wp.

Date - July 10/61.

Location: 15+00S; 3+00W Grid "A"

Dev. - Not Surveyed

Depth	Description of Core	Sample No.	Sample Depth	Width
-------	---------------------	------------	--------------	-------

0 Collar

5 Casing

101.6 Medium grained Andesite Occasional Stringer CO₂ with Tr. Pyrite minor fracturing c. 1/10 foot

102 Fine grained Andesite (X. with CO₂ filling

362 Medium grained Andesite. Very slightly fractured
6" str. CO₂ c. 214.5) minor faults
336-338.5 - Striped out fragments reflecting plastic behaviour
i.e. convolute structure.

362 End of Hole

AX Core
Drilled by Continental Diamond Drilling
Test c. 340' Corrected 44'
Casing Salvaged
Started July 7.
Completed " 8.

Logged by: C.T. Paschala
Approved: Norman F. Ussel F. ENG
Norman F. Ussel

→ WEST

4+00W

Overburden

Medium Grained 'Andesite'

Fine Grained 'Andesite'

Medium Grained 'Andesite'

End of Hole

SHUNSBY MINES LIMITED

DDH-SH-64-4

COLLAR-15+00S-3+82W

SECTION-W-34°S

SCALE-1"=40'

SURVEY & TEST LOG

Hole No. SH-64-5 Dip -45°

Strike - N 22 W

Property: Shunby Mines: (Harrison Gulch) Cunningham Twp.

Date - July 12/64

Location: S+300; 5+000 Grid "A"

Dev. - Not Surveyed

Depth	Description of Core	Sample No.	Sample Depth	Notes
0	Collar			
37	Casing			
253	Medium grained Andesite very slightly fractured with occasional CO ₂ v. pits. Stringers. Riflor Bx. 1. 31.5 over 1m Minor Pyrite & 166.5 over 6m (4m Qz.) 220-228 Pyrite			
293	End of Hole			

Suspect massive Sulphides @ 37-39'
massive Pyrite: probable boulder

AX Core
Drilled by Continental Diamond Drilling
Test @ 250' corrected 42
Casing salvaged
Started July 9.
Completed "10.

Logged by: C.T. Pasicka

Approved: Norman H. Ursel F.S.M.S.

Norman H. Ursel

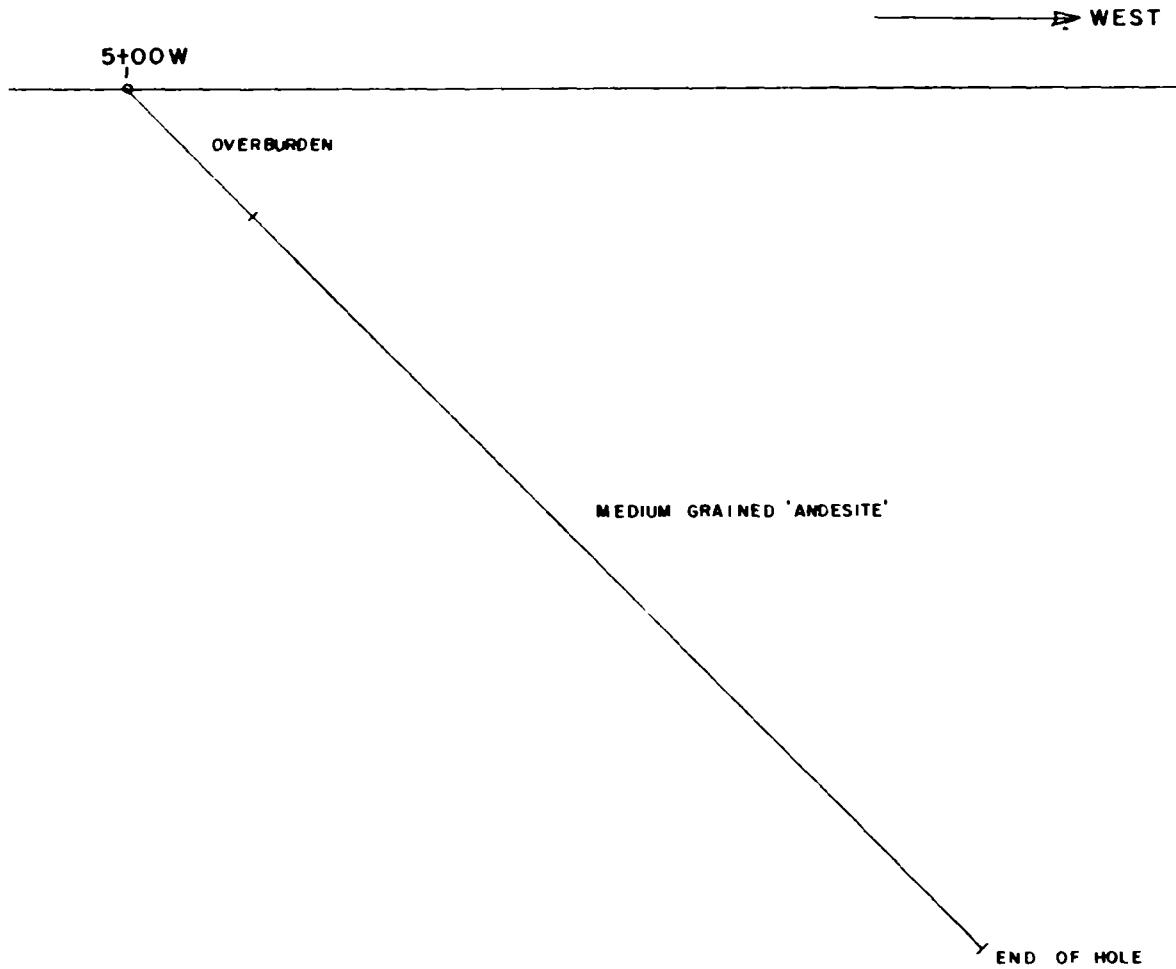

SHUNSBY MINES LIMITED

DDH SH-64-5

COLLAR - 8+00S - 5+00W

SECTION - W - 22° N

SCALE - 1" = 40'