



41014SE0052 63.1791 MCNAUGHT

010

REPORT ON
GEOPHYSICAL SURVEY
18-CLAIM GROUP PROPERTY
MULTI-MINERALS LIMITED,
MCNAUGHT TOWNSHIP, ONT.

Multi-Minerals Limited,
Suite 911,
25 Adelaide Street West,
Toronto, 1, Ontario.

Gentlemen:

This report describes the results of a Magnetometer Survey conducted by Geo-Technical Development Co. Limited on part of your 18-claim group property on Cachege Lake, McNaught Township in the Chapleau Area, Ontario. The line cutting was completed during the period from August 14th., to August 21st., incl., 1964 and the survey was carried out from August 17th., to August 21st., incl., 1964. The results and interpretation are mapped on Plan No. 1, accompanying this report.

CONCLUSIONS AND RECOMMENDATIONS

No outcrops were seen. The area is covered completely with sand and rounded granite gneiss boulder overburden.

The magnetometer survey shows that the country rock of the surrounding area is composed of granite gneiss with the central part of the mapped area having been intruded and altered by acid type rocks. This is indicated by anomalies of higher content of disseminated magnetite. Five main magnetic anomaly zones have been located and these anomalies have been marked "A", "B", "C", "D" and "E" on Plan No. 1 in order of importance.

Previous drilling work on the Multi-Minerals Limited main property at about a mile and a half to the east has

proven that large zones containing the phosphate mineral apatite is closely associated with both massive and disseminated titaniferous magnetite and niobium. The niobium is radioactive, but a combined scintillometer survey with the magnetometer results of the area surveyed is not recommended to find apatite zones due to overburden, stray boulders and lack of outcrops. The five anomalous zones mentioned above contain disseminated magnetite and point to a good target to discover associated apatite with the drill. Six test holes have been recommended and particulars are in the "Recommended Diamond Drilling Schedule" appended to this report. The drilling of Holes 2, 3 and 4 depends on good results of Hole 1. Holes 5 and 6 are to test separate zones.

PROPERTY, LOCATION AND ACCESS

The property consists of a block of 18 mining claims located in the central part of McNaught Township, District of Sudbury, Ontario. The area is approximately 720 acres. The claim numbers are listed below:-

18 claims - 120577 to 120594 inclusive.

The survey was done on 11 claims numbered below:-

4 claims - 120577 to 120580 incl.
 3 claims - 120583 to 120585 incl.
 2 claims - 120588 and 120589
2 claims - 120592 and 120593

11 claims

Access was made from White River Air Service, Chapleau, Ontario. The plane landed on the eastern part of Cachege

Lake. Camp was made on a point on the lake due to sand bars and submerged rocks near the eastern shore.

GEOLOGY

No outcrops have been found. The area is blanketed with sand and granite gneiss boulder overburden. One boulder had a narrow pegmatite dyke intrusion with coarse feldspar crystals.

Airborne Magnetic Map 2232G, shows that the magnetic anomaly on the Multi-Minerals Limited main property is connected to the anomaly on the area surveyed. This could suggest side eruption of the same volcano and possibly similar deep seated intrusive rocks into granite gneiss country rock.

Magnetic background readings from intensities of 204 to 700 gammas have been inferred as granite gneiss country rock. Five anomalous zones have been located and marked Anomalies "A", "B", "C", "D" and "E" with magnetic "highs" of 1,815, 1,531, 1,400, 1,350 and 1,289 gammas respectively. These anomalies are caused by higher content of disseminated magnetite than in the country rock and is the result of deep seated intrusive volcanic activity. In view of the fact that the phosphate mineral apatite has been found associated with disseminated magnetite, it warrants that these anomalous zones be test drilled.

GEOPHYSICAL SURVEY INSTRUMENTS AND METHOD

Base-check method was used for the magnetometer survey

with a Base Control Station established on the base line and three Control Stations on the same base line at 800 foot intervals. A Sharpe Model A-2 magnetometer with vertical intensity and sensitivity of 18.2 gammas per scale division was used. This instrument was supplemented by an Arvela vertical intensity magnetometer. The survey was supervised by the writer.

SURVEY DATA

The line cutting, chaining and magnetometer survey were carried out by Geo-Technical Development Co. Limited during the period from August 14th., to August 21st., incl., 1964. A base line was cut north-south for turning picket lines at every 400 foot intervals. Readings were taken at every 100 foot intervals on the base line and picket lines.

The total mileage including base line is 6.1 miles cut and chained.

The mileage of the magnetometer survey is 6.1 miles and 326 observations were made.

The number of eight-hour man-days required to complete the survey was as follows:

	<u>8-Hour Man-days</u>	<u>Attributable to Assessment work</u>
Line cutting and chaining	32 x 4	128
Operating magnetometer survey	7 x 4	28

W0506-20577



41014SE0052 63.1791 MCNAUGHT

900

A separate form is required for each type of work to be recorded.

THE MINING ACT REPORT OF WORK

To the Recorder of SUDBURY Mining Division

I, Multi-Minerals Limited A 26172 name of Recorded Holder Miner's Licence

911 - 25 Adelaide Street West, Toronto 1, Ontario Post Office Address

do hereby report the performance of 123 days of Geophysical type of work

not before reported to be applied on the following contiguous claims

Table with 6 columns: Claim No., Days, Claim No., Days, Claim No., Days. Rows include S120577 (11.18), S120578, S120579, S120580, S120583, S120584 and S120585 (11.18), S120588, S120589, S120592, S120593.

All the work was performed on Mining Claim (s) Listed above (In the case of geological and/or geophysical survey (s) where more than 18 claims are involved attach a schedule)

READ CAREFULLY: THE FOLLOWING INFORMATION IS REQUIRED BY THE MINING RECORDER.

- For Manual Work, Stripping or Opening up of Mines, Sinking Shafts or Other Actual Mining Operations - Names and addresses of the men who performed the work and the dates and hours of their employment.
For Diamond and other Core Drilling - Footage, No. and angle of holes and diameter of core. Name and address of owner or operator of drill. Dates when drilling was done. Signed core log and sketch in duplicate.
For Compressed Air or Other Power Driven or Mechanical Equipment Type of drill or equipment. Names and addresses of men engaged in operating equipment and the dates and hours of their employment.
For Power Stripping - Type of equipment. Name and address of owner or operator. Amount expended. Dates on which work was done. Proof of actual cost must be submitted within 30 days of recording.
With each of the above types of work sketches are required to show the location and extent of the work in relation to the nearest claim post. In the case of diamond or other core drilling the sketch must be submitted in duplicate.
For Geological and Geophysical Survey - The names and addresses of men employed as well as dates. Type of instrument used in the case of geophysical survey. Reports and maps in duplicate must be filed with the Minister within 60 days of recording.
For Land Survey - the name and address of Ontario Land surveyor.

The Required Information is as Follows: (Attach a list if this space is insufficient)

Date November 11, 1965

Signature of Recorded Holder or Agent H. A. PEARSON REGISTERED PROFESSIONAL ENGINEER PROVINCE OF ONTARIO

The Mining Act Certificate Verifying Report of Work

I, H.A. Pearson 911 - 25 Adelaide Street West, Toronto 1, Ontario (Post Office Address)

hereby certify:

- 1. That I have a personal and intimate knowledge of the facts set forth in the report of work annexed hereto, having performed the work or witnessed same during and/or after its completion.
2. That the annexed report is true.

Dated November 11, 1965

Signature H. A. PEARSON REGISTERED PROFESSIONAL ENGINEER PROVINCE OF ONTARIO

THE PENALTY FOR MAKING A FALSE STATEMENT IN THIS REPORT AND/OR CERTIFICATE IS \$500. OR SIX MONTHS IMPRISONMENT OR BOTH

SUITE 911
25 ADELAIDE STREET WEST
TORONTO 1, CANADA

23

Mr. R.V. Scott,
Director, Mining Lands Branch,
Ontario Department of Mines,
Parliament Buildings,
TORONTO 2,
Ont.

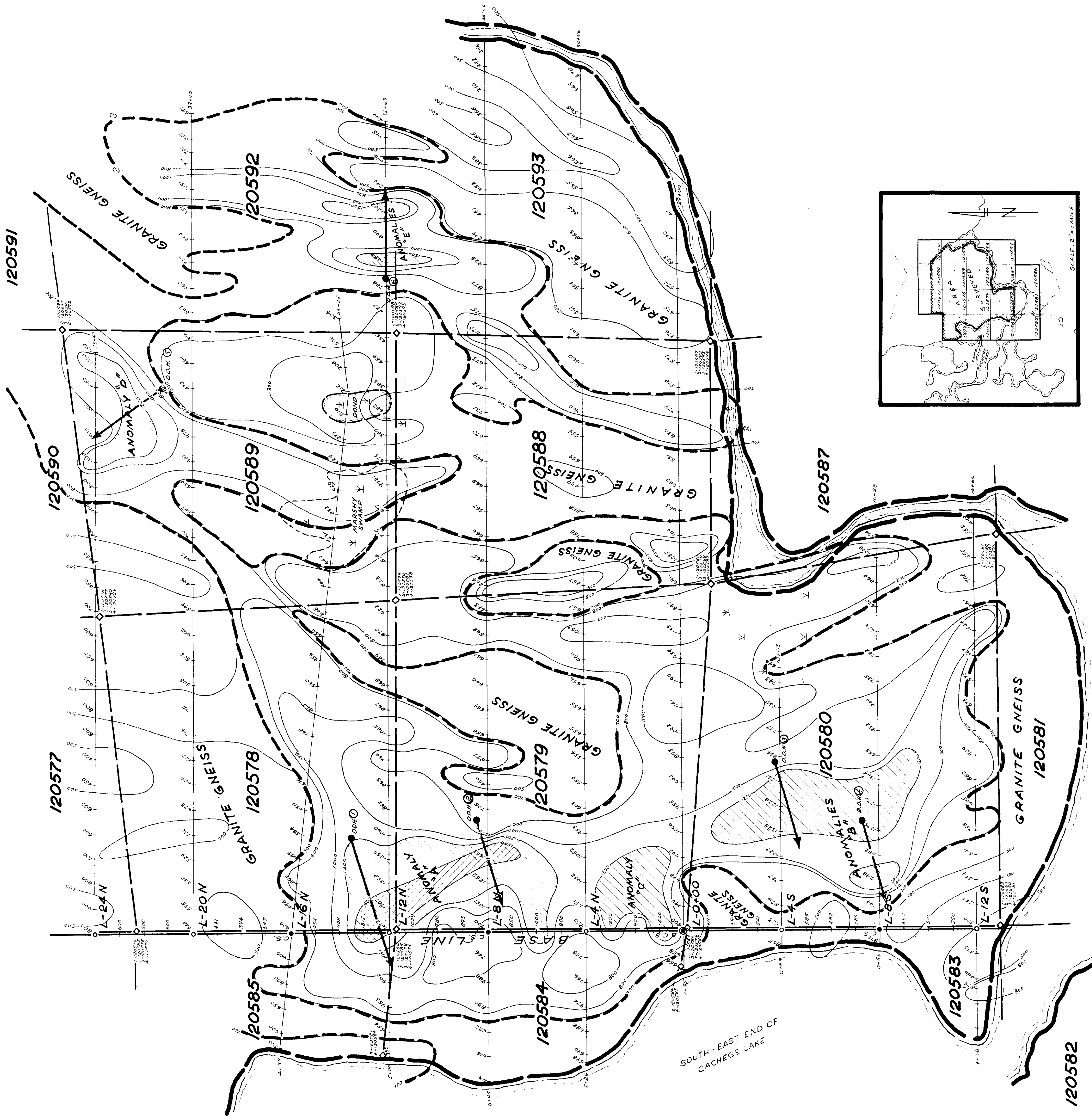
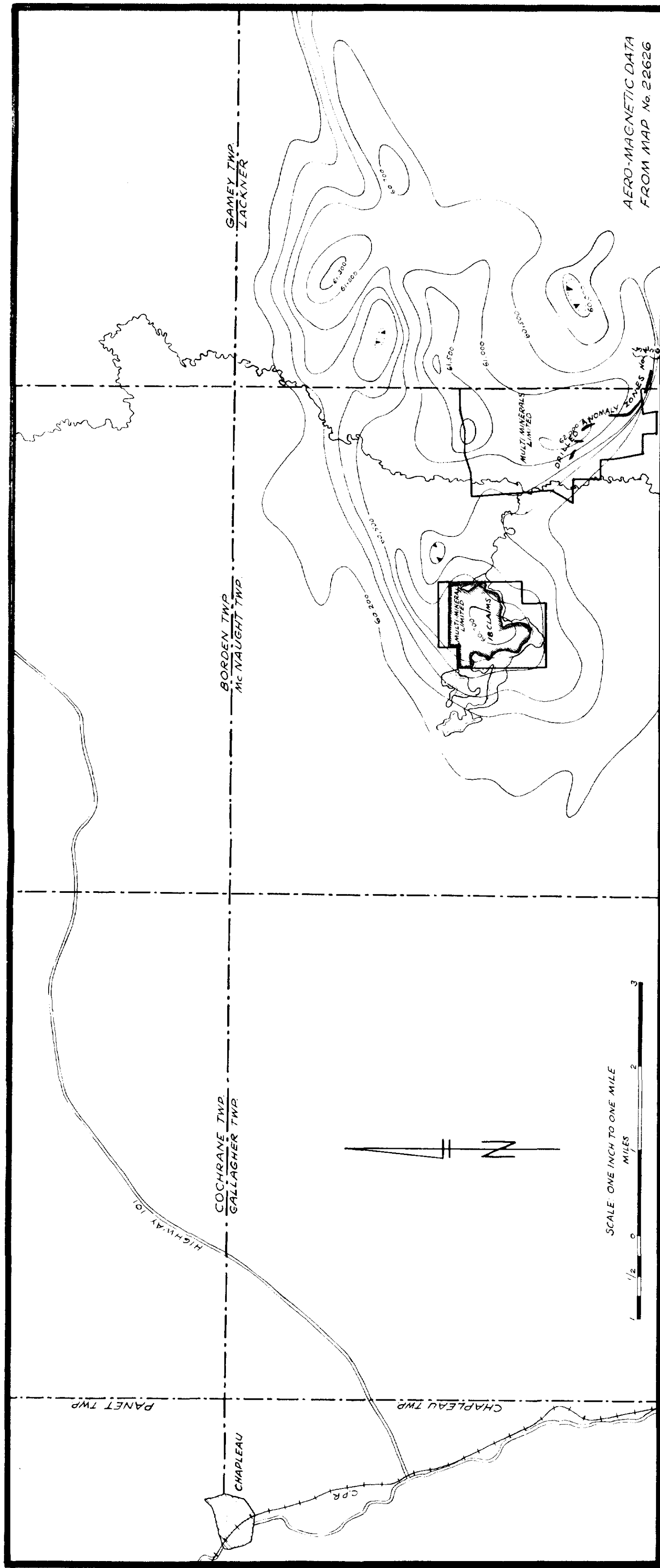

LEGEND

- LINES CUT AND CHAINED.
- MAGNETIC READINGS OBSERVED.
- MAGNETIC CONTOUR.
- MAGNETIC BASE CONTROL STATION.
- AND MAGNETIC CONTROL STATION.
- LOCATION OF CLAIM POST.
- SWAMP.
- RECOMMENDED DRILL HOLE.
- GEOLOGICAL CONTACTS INFERRED FROM MAGNETIC DATA.

0	500	GAMMA
500	700	
700	800	
800	1,000	
1,000	1,200	
1,200	1,500	
1,500	UP	

MAGNETIC SURVEY DATA ON PART OF 18-CLAIM GROUP

MULTI - MINERALS LIMITED

ISO-DYNAMIC CONTOURS OF MAGNETIC INTENSITIES
AND GEOLOGICAL INTERPRETATION

MC NAUGHT TWP.
DISTRICT OF SUDBURY
ONTARIO

GEOPHYSICAL SURVEY BY:

GEO-TECHNICAL DEVELOPMENT CO. LTD.

PLAN NO.-1 SCALE: 1" = 200'

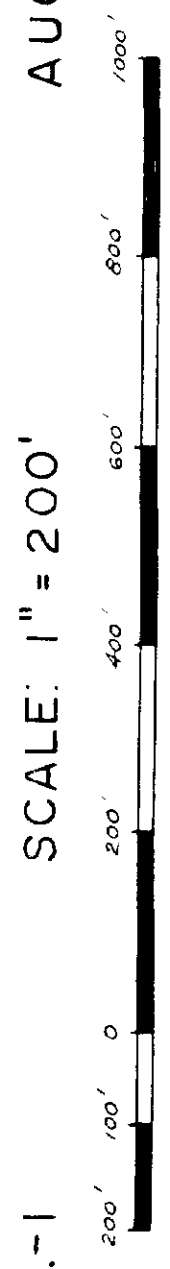

AUG. 1964.