



BELL - WHITE ANA

P.O. BOX 187.
POJ 1KO

HAILE



410155E0002 2.12644 ROLLO

010

Certificate of Analysis

NO. 0259

DATE: March 10, 1989

SAMPLE(S) OF: Core (27)

RECEIVED: March 1989

SAMPLE(S) FROM:

Kian A. Jensen

Sample #	Oz. Gold
26951	Trace
52	Trace
53	Trace
54	Trace
26955	Trace
56	Trace
57	Trace
58	Trace
59	Trace
26960	0.002*
61	0.048
62	Trace
63	Trace
64	Trace
26965	Trace
66	Trace
67	0.002*
68	Trace
69	Trace
26970	Trace
71	Trace
72	0.014
73	Trace
74	Trace
26975	Trace
76	0.002*
26977	Trace

* Estimated

IN ACCORDANCE WITH LONG ESTABLISHED NORTH AMERICAN CUSTOM UNLESS IT IS SPECIFICALLY STATED OTHERWISE GOLD AND SILVER VALUES REPORTED ON THESE SHEETS HAVE NOT BEEN ADJUSTED TO COMPENSATE FOR LOSSES AND GAINS INHERENT IN THE FIRE ASSAY PROCESS

BELL-WHITE ANALYTICAL LABORATORIES LTD.

Per 



BELL-WHITE ANALYTICAL LABORATORIES LTD.

P.O. Box 187, 374 Browning St., Halleybury, Ontario P0J 1K0
(705) 672-3107

INVOICE

NO: 33943

DATE: 03-10-89

PAGE: 1 of 1

SOLD TO: Kian Jensen Exploration
P.O. Box 37
South Porcupine, Ontario
P0N 1H0

SHIP TO: Same

QTY	QUANTITY	UNIT	DESCRIPTION	UNIT PRICE	AMOUNT
27	27	1	Au	8.500	229.50
27	27	1	Sample Preparation	2.500	67.50
TERMS: Net 30 Days					297.00

*Paid
March 30/89
#1576
KJ*

KIAN A. JENSEN
HOLLINGER BUILDING, SUITE 11
TIMMINS, ONTARIO

0576

March 30 1989

PAY TO THE ORDER OF *Bell White Analytical Lab Ltd.*

\$ 297.00

Two Hundred and Ninety Seven

DOLLARS
100

RE *Invoice 33943 - Project 89-02*

KIAN A. JENSEN

PER *Kian Jensen*

CANADA TRUSTCO MORTGAGE COMPANY
194 THIRD AVE.
TIMMINS, ONTARIO

⑈000576⑈

⑆11462⑆509⑆

503941⑆2⑈

⑈0000029700⑈

80382-002
THE BANK OF NOVA SCOTIA
HALLEYBURY, ONTARIO
80382-002

DEPOSIT TO THE CREDIT OF
Bell-White Analytical
Laboratories Ltd.

00576⑆04/07/89⑆038

8 AP 89 07 5

SCOTIABANK
DATA CENTRE
TORONTO

AP 89 07

CANADA TRUST
CLEANING CENTRE
TORONTO, ONTARIO

⑆5012075⑆

⑆80550872



DOCUM
W 89



410155E0002 2.12644 ROLLO

8906.351 Mining /

Type of Survey(s) **ASSAYS OF DRILL CORE 2.1204** Township or Area **ROLLO TWP**

Claim Holder(s) **HANSON LAKE RESOURCES LIMITED** Prospector's Licence No. **T-1640**

Address **P.O. BOX 41, STATION A, ISLINGTON, ONTARIO M9A 4X1**

Survey Company **KIAN A. JENSEN** Date of Survey (from & to) **10 02 89 | 25 02 89** Total Miles of line Cut

Name and Address of Author (of Geo-Technical report) **KIAN A. JENSEN, P.O. BOX 37, SOUTH PORCUPINE, ONTARIO P0N 1H0**

Credits Requested per Each Claim in Columns at right Mining Claims Traversed (List in numerical sequence)

Special Provisions	Geophysical	Days per Claim
For first survey: Enter 40 days. (This includes line cutting)	- Electromagnetic	
	- Magnetometer	
For each additional survey: using the same grid: Enter 20 days (for each)	- Radiometric	
	- Other	
	Geological	
	Geochemical	
Man Days	Geophysical	Days per Claim
Complete reverse side and enter total(s) here	- Electromagnetic	
	- Magnetometer	
	- Radiometric	
	- Other	
	Geological	
	Geochemical	
Airborne Credits	Geophysical	Days per Claim
Note: Special provisions credits do not apply to Airborne Surveys.	- Electromagnetic	
	- Magnetometer	
	- Radiometric	

Mining Claim Prefix	Mining Claim Number	Expend. Days Cr.	Mining Claim Prefix	Mining Claim Number	Expend. Days Cr.
P	672457	8			

ONTARIO GEOLOGICAL SURVEY
ASSESSMENT FILES
OFFICE

S-P 07 1989

RECEIVED

RECEIVED RECORDED

JUL 25 1989

MINING LANDS SECTION

PORCUPINE MINING DIVISION

RECEIVED

JUL 25 1989

@11:00am L7

Expenditures (excludes power stripping)

Type of Work Performed **ASSAYS**

Performed on Claim(s) **P-672440 and P-672430**

Calculation of Expenditure Days Credits

Total Expenditures **\$ 292.00** ÷ Total Days Credits **15** = **19.8**

Instructions
Total Days Credits may be apportioned at the claim holder's choice. Enter number of days credits per claim selected in columns at right.

Date **July 6/89** Recorded Holder or Agent (Signature) *Kian Jensen*

For Office Use Only

Total Days Cr. Recorded **8** Date Recorded **JULY 25 1989** Mining Recorder *[Signature]*

Date Approved **July 25 1989** Date Recorded **JULY 25 1989** *[Signature]*

Certification Verifying Report of Work
I hereby certify that I have a personal and intimate knowledge of the facts set forth in the Report of Work annexed hereto, having performed the work or witnessed same during and/or after its completion and the annexed report is true.

Name and Postal Address of Person Certifying **KIAN A. JENSEN P.O. BOX 37, SOUTH PORCUPINE ONTARIO P0N 1H0**

Date Certified **July 6/89** Certified by (Signature) *Kian Jensen*

AREAS WITHDRAWN FROM DISPOSITION

- M.R.O. - MINING RIGHTS ONLY
- S.R.O. - SURFACE RIGHTS ONLY
- M.+S. - MINING AND SURFACE RIGHTS

Location	Order No.	Date	Disposition	File

... FOR EXPLORATORY
 ... OCCUPATION... LAND NOT OPEN
 TO STAKING 23/01/87

Biggs Twp.

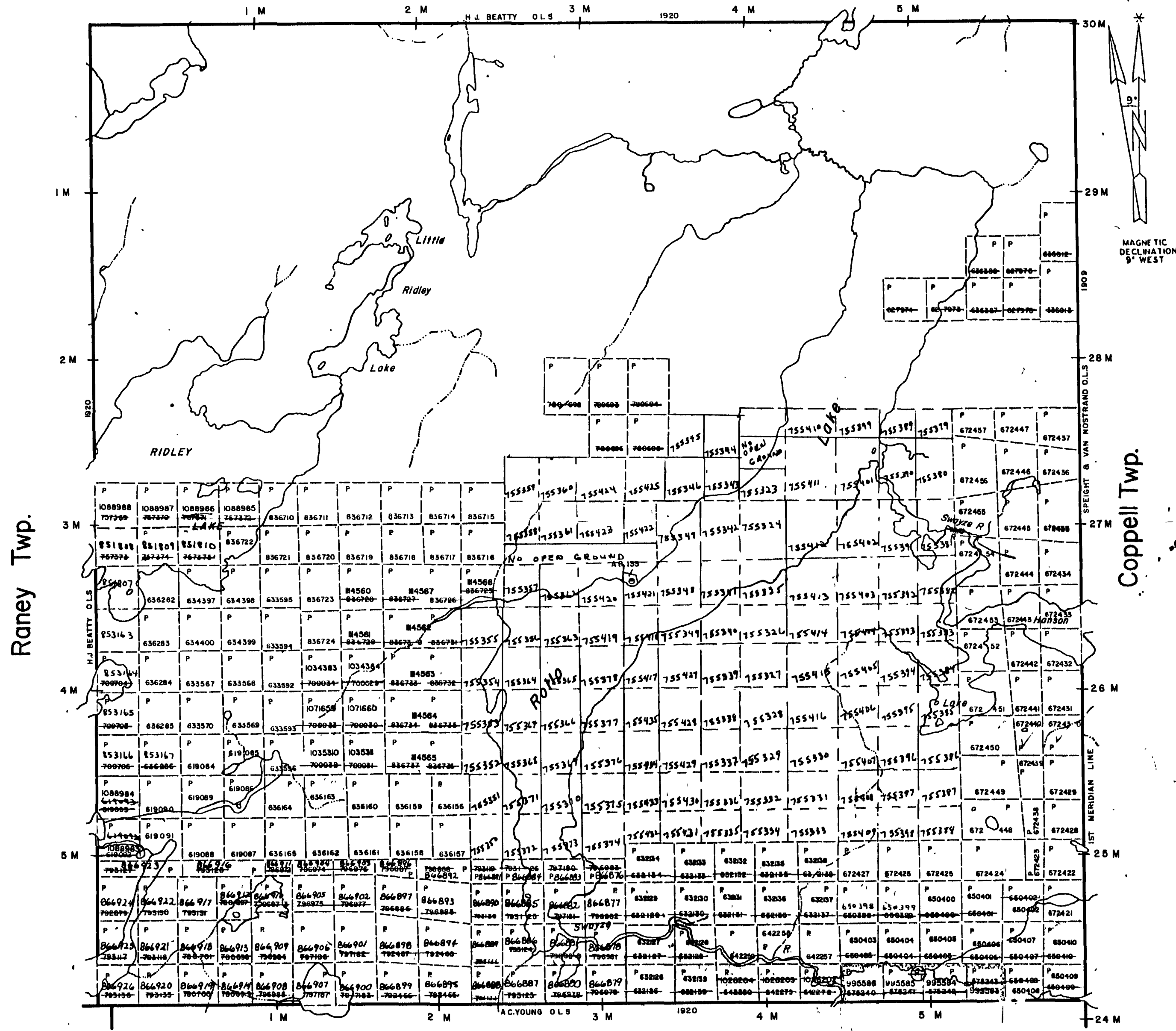

LEGEND

HIGHWAY AND ROUTE No.	
OTHER ROADS	
TRAILS	
SURVEYED LINES:	
TOWNSHIPS, BASE LINES, ETC.	
LOTS, MINING CLAIMS, PARCELS, ETC.	
UNSURVEYED LINES:	
LOT LINES	
PARCEL BOUNDARY	
MINING CLAIMS ETC.	
RAILWAY AND RIGHT OF WAY	
UTILITY LINES	
NON-PERENNIAL STREAM	
FLOODING OR FLOODING RIGHTS	
SUBDIVISION OR COMPOSITE PLAN	
RESERVATIONS	
ORIGINAL SHORELINE	
MARSH OR MUSKEG	
MINES	
TRAVERSE MONUMENT	

DISPOSITION OF CROWN LANDS

TYPE OF DOCUMENT	SYMBOL
PATENT, SURFACE & MINING RIGHTS	●
" SURFACE RIGHTS ONLY	○
" MINING RIGHTS ONLY	○
LEASE, SURFACE & MINING RIGHTS	■
" SURFACE RIGHTS ONLY	□
" MINING RIGHTS ONLY	□
LICENCE OF OCCUPATION	▼
ORDER-IN-COUNCIL	OC
RESERVATION	⊙
CANCELLED	⊗
SAND & GRAVEL	⊙

NOTE: MINING RIGHTS IN PARCELS PATENTED PRIOR TO MAY 8, 1913, VESTED IN ORIGINAL PATENTEE BY THE PUBLIC LANDS ACT, R.S.O. 1970, CHAP. 380, SEC 83, SUBSEC 1.

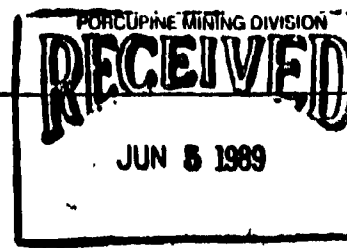
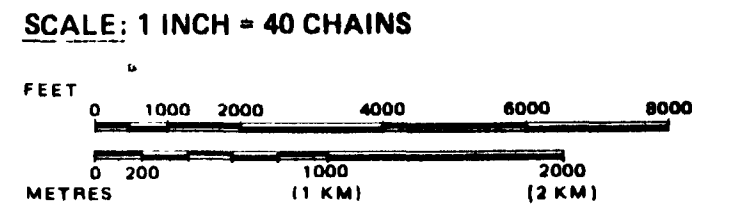

TOWNSHIP
ROLLO
 M.N.R. ADMINISTRATIVE DISTRICT
CHAPLEAU
 MINING DIVISION
PORCUPINE
 LAND TITLES / REGISTRY DIVISION
SUDBURY

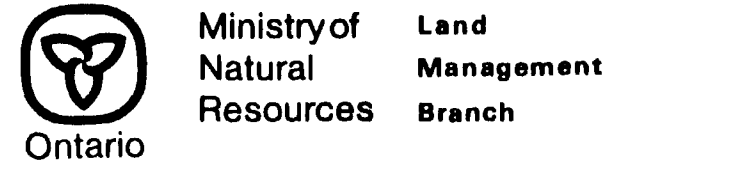

Date MARCH, 1985
 Number **G-3246**

