

41015SE0026 W9560.00244 DORE

010

Report

Mortimer Gold Property
Dore township, Claim:1189640

Porcupine Mining Division
South Swayze Gold Area Ontario.
District of Sudbury

March 1992
Timmins, Ontario.

Charles Mortimer; Prospector



41015SE0026 W9560.00244 DORE

010C

Table of Contents

Introduction
Location-Access
Property Description
Topography
Previous Exploration
Previous Exploration on Kenty Mine
General Geology
Geophysics
Conclusions
Recommendations
List of Equipment
Costs and Estimates
List of Figures
Abstracts
Location Map
Claim Map
Property Location Map
Existing Trench Location Map
Partial Copy of ODM Report
Partial Copy of Kenneth Guy Report
Partial Copy of Kian A. Jenson Report
Copy of Assays
Trench Location Maps with Assays

Introduction

Claim #1189640, Dore Township.

The purpose of this report is to review information on past exploration and recommendations by engineers and geologists for further work.

Some notes on main shearing or fault "Coppore A 91" and mineralized major structure on Mortimer property designated "Coppore B 91".

Location-Access

The property lies in the northwest corner of Dore Township, in the District of Sudbury, Porcupine Mining Division in the South Swayze Gold area.

The property lies about 120 miles northwest of Sudbury, Ontario and about 90 miles southwest of Timmins, Ontario.

Access is via Provincial Highway 101, west from Timmins 55 miles to the Foleyet timber road. South on the Foleyet timber road, 35 miles to the property. The Foleyet timber road is an all weather road. This main logging road runs along the south boundary of claim #1189640. A winter logging road suitable for a 4 wheel drive truck runs from the main logging road northwest to the central area of claim #1189640.

Property Description

Claim #1189640 covers the area of the former Annie Kenty property. The area covered is 6/16 HA units or approximately 240 acres.

The most recent exploration company was Swayze Resources. This company has held the property since 1980. The claims were allowed to come open for staking by Swayze Resources. Charles Mortimer, Prospector, has re-staked the area covering previous claim #'s 575247 to 575252.

Topography

The property rises above the surrounding area with several low rolling hills to the north and south. The main mineralized central area is somewhat flat with a high, marshy plateau.

Most of the property is covered by overburden. There are some low scattered rock outcrop. The property has been logged with in the last four years. Some logging was done on the north part of the property fifteen to twenty years ago.

Previous Exploration

Gold was discovered at the location of the Kenty Mine in 1931. Claim #1189640 covers the area adjacent to the Kenty Mine to the east in Dore Township.

The property has been known as the Miner Kenty, Annie Kenty and recently from 1980 to 1991 as Swayze Resources.

Swayze Resources has completed considerable exploration work, and the company geologist recommended further work.

The work completed is as follows; line cutting, geological, geophysical, geochemical, airborne geophysics, trenching and sampling. Further work recommended by Swayze Resources geologists was bulk sampling, further trenching plus stripping and diamond drilling.

The trenching by Swayze Resources uncovered gold running as high as 13.95 ounces per ton in two areas, designated Area #1 and Area #2. The high assays are from Area #1.

The company geologist, Kian A. Jenson, in his report to Swayze Resources, states that the area #2 has potential for an open pit mine.

Previous Exploration on Kenty Mine

Gold is found on the Kenty Mine property in coarse grained erratic pods and veins. Historic gold grades from government sources are reported to exceed 100 ounces per ton.

Some high grade ore at the surface ran much higher than 100 ounces per ton.

General Geology

The Mortimer property, Claim #1189640, lies in the east west trending Swayze greenstone belt. The rocks are all Precambrian in age, consisting of felsic to mafic volcanic rocks. Felsic volcanic rocks occupy the northern part of Dore township. The most prominent unit on the property trend east west across the central part of the property.

Table of Formation:

Precambrian

- a. Massive basalt
- b. Intermediate tuff
- c. Maffic tuff
- d. Andesite

Felsic Metavolcanic Rock

- a. Massive Rhyolite
- b. Tuff
- c. Breccia
- d. Feldspar porphrey

Intermediate to Maffic Metavolcanic:

This is the main lithological unit on the property; this is subdivided into basalt and andesite. The andesite on the property outcrops within the east west striking mineralized zone on the area of the claim. The Basalt outcrops to the north of the Andesite. The basalt is massive chloritic, medium grained and magnetic. The Andesite is highly silicified, light green and grey in colour, and fine grained.

The quartz carbonate veins occur mainly within the andesite. An area designated "Coppore B 91" striking west south west within the andesite is highly mineralized. Some stripping has been done on the east boundary of Claim #1189640 on this zone in the late fall of 1991. The stripping has exposed quartz carbonate veining with pods of quartz, silicification and much pyrite.

The andesite has been highly carbonated. This area has not been sampled.

The veins uncovered on the property are striking mainly north south. On the Kenty mine property a second set of veins strike east west as well as the north south veins. Trenching will determine if these conditions exist on the Mortimer property.

There is a fault or a major shear zone striking northwest, southeast along the eastern boundary of the property. This zone will be referred to as "Coppore A 91". There is some evidence that "Coppore A91" continues on to the southeast into Dore. A fault on the ODM geology map of Dore township shows up as a linement with "Coppore A 91". There is a linement or faulting on down southeast into Garnet township.

"Coppore A 91" parallels the Wakami river fault which lies approximately 3 miles to the west in Swayze township. Most of "Coppore A 91" lies under overburden.

There is a continuous mineralized zone several hundred feet wide striking west south west from this fault or shear zone. This westerly striking zone is referred to as "Coppore B 91". "Coppore B 91" appears to strike towards the areas designated as area 1 and area 2 on Swayze Resources mapping.

"Coppore A 91" could be the source of mineralization westwards on into the Kenty mine. North east of "Coppore A 91" a five hundred foot drill hole encountered anomalous gold values throughout.

One surface sample returned an assay of 6 ounces per ton. This hole drilled by Dome Exploration would be within 1000 feet of "Coppore A 91"

Several small veins have been discovered cutting into the wall rocks at a low angle from "Coppore A 91". These veins contain chalcopyrite, galena, tourmaline, pyrrotite and pyrite.

Large blocks of float which appear to be a silicified andesite are piled up on the south western side of "Coppore A 91" Chalcopyrite may be seen along with pyrrotite and pyrite. A test with dymethyl glyoximie powder shows there is some nickel present.

Intermediate to Maffic Metavolcanics: continued

There are large blocks of andesite float with pyrite piled up on the south edge of "Coppore B 91". This float contains approximately 10 % pyrite. This float location is near the east boundary of claim #1189640.

There is an airborne E.M. anomaly coincidental with "Coppore A 91" and "Coppore B 91".

A winter logging road bulldozed through the centre of "Coppore B 91" from the east boundary of Claim #1189640 almost to the west boundary of claim # 1189640 has exposed several blocks of mineralized float.

This float is carbonated andesite with pyrite, quartz veining and pods of quartz and silicified throughout this zone which may be seen all along the road has not been sampled.

This road has been bulldozed within the last four years or since all the work was done by Swayze Resources.

Geophysics

Airborne Radiometric

Airborne Magnetometer and E. M.

Geophysical for gold exploration

There were no high geophysical anomalies on the property. There are however, several low geophysical anomalies on and near the zone "Coppore B 91"

Conclusions

The area covered by claim #1189640 is geologically favourable in regard to the exploration and development of economic deposits of gold.

Exploration work completed indicates the possibility of deposits of two types.

"A" high-grade ore in excess of 100 ounces per ton such as the Kenty mine has produced O.D. M.

"B" low grade open pit Kiam A. Jenson.

Further exploration should consist of work recommended by Swayze Resources' geologists.

ie. Trenching, stripping, bulk samples further overall sampling and diamond drilling.

Recommendation

Most of the area of interest which is "Coppore B 91" is covered by overburden. This area appears to be a high plateau with shallow wet areas within.

From observation made since the timber was cut on "Coppore B 91" up to 50 % has less than 10 feet of overburden.

Trenching - A trenching program on a checkerboard grid eg. trenches north and south and east and west is recommended.

Stripping - Stripping should be started in the #1 area of Swayze Resources and continued to the south. All areas where mineralization is encountered should be stripped. Four large stripped areas running north and south to completely expose "Coppore B 91"

Sampling - Follow up of stripping and trenching plus bulk samples totalling up to 475 tons from "Coppore B 91" #1 bulk sample should be from the #2 area as designated by Swayze Resources geologist Kiam A. Jenson.

Diamond Drilling - Four 500 foot holes with a north south bearing across "Coppore B 91"

Line cutting - A grid with a north south base line and east west picket lines should be cut on the property.

This grid should be cut at the same time as the trenching, stripping, sampling and drilling are carried out.

Iron bars or pickets to be placed in drill holes at selected locations instead of wood pickets.

These durable pickets would be helpful in correlating the previous exploration work and the further work in progress.

Cost estimates 1992 April to October

Equipment floating to property

Hydraulic Shovel, D6 Bulldozer, J.D. Backhoe	\$3,600.00	complete	3600.00
Line cutting 6 miles @ \$450.00 per mile	\$2,700.00	4 miles complete	1800.00
Trenching and stripping hydraulic shovel 800 hours @ 450.00 90 per hour	\$48,000.00 \$72,000.00	600 hrs complete	48,000.00
Stripping D6 Bulldozer 600 hours @ \$60.00	\$36,000.00	2 hrs complete	150.00
Stripping loading backhoe J.D. Backhoe 200 hours @ \$50.00 per hour	\$10,000.00	complete	10,000.00
Dump Truck Tandem 200 hours @ \$30.00	\$6,000.00	100 hrs complete	3,000.00
Compressor 250 C.F.M. with drill and steel 5 months rental @ \$800.00 per month	\$4,000.00	complete	4,000.00
Gasoline plugger with drill steel 5 months @ \$300.00 per month	\$1,500.00	complete	1500.00
Labour 2 men 1000 hours @ \$12.00	24,000.00 24,000.00	complete	24,000.00
High pressure 1750 P.S.I. fire pump 5 months @ \$300.00 per month	\$1,500.00	complete	1500.00
100 assays @ \$15.00	\$1,500.00	complete	1500.00
475 ton bulk sampling all costs \$100.00 per ton	\$47,500.00		
Fuel for Gasoline plugger, Compressor	\$1,000.00	complete	1000.00
Explosives	\$1,000.00	complete	1000.00
Diamond drilling 2000 feet including all costs @ \$18.00 per foot	625 FT \$36,000.00	complete	11250.00
	\$207,000.00		
TOTAL	\$224,300.00		\$112,300
	248,300.00		

Ch. Williams



41015SE0026 W9560 00244 DORE

020

C. M. Artemis
Dore Twp Ont
April 17 1955

Mining Claims
1189648, 1154401
1154402, 1154404
AND 1154405.

Report -

C. H. Mortimer -
Box 136
Turonan Ont
PA92C9 -

During May, June and July 1993
stripping, trenching, drilling, blasting and
manual labour, pick shovel and
working with fire pump was carried
out on the above mentioned claims.
These claims are in the N.W.
corner of Dore Twp. Paragon
Mining Division.

The area is predominantly andesite
and basalt. The central area of
the claims is characterized by an
intrusive felsic complex. The perimeter
of the intrusion at the contact with
the andesite and basalt is intensely
altered. The evident fracture has
fracture at 90° to the strike of
the central intrusion.

2/
These fractures are narrow
in most cases not exceeding 10 cm
in width. Free gold may be
seen in these narrow veins.

The contact area of the felsite
and andesite basalt across a
wide zone has values of up to
2 grams per ton in gold as well
as silver and copper.

During the summer of 1994
625 ft of PXT diamond drilling
was carried out at the boundary line
of 1189648 and 1159407 near road side.
This location is shown on main
index map.

This drilling was in 2 holes
from same collar location.
Hole # 1/1994 was drilled to NE
409 ft. This hole was mineralized
for entire length. At this date
the drill core is out for logging
and assays. However a section
from 106 ft to 131 ft was
assayed for ~~gold~~ gold copper silver.
The footage from 100 to 105 ft:
assayed 1.2 % copper .5 gram gold
1.5 grams silver.

A sample from 301' to 306" assayed
1.98 grams gold 1.5 grams silver.
More samples will be taken from
the core.

3/ D.D. 2/1994 was drilled
S.W. for 216 ft. A few ft of
core down to 50 ft show chert
The rest of the core is barren looking
quartz, veining and feldspar porphyry.

An index map with a scale
of 1 cm = 25 metres is included
with this report. This map shows
the location of trenching, striping
drilling and rock blasted pits.
Reamed drill holes are shown

A series of maps with a scale
of 1 cm = 5 metres are
included with this report.
These maps are from # 7
to # 12.

Numbers 1, 2, and 3 are from
previous work and are in
assessment files.

Ch. Morten

Claim 1189640, 1154401, 1154402
1154404 AND 1154405 DORE TWP.
MAY, JUNE, JULY 1993 -
C-MORTIMER.

- 1/ Greases 1509.99
- 2/ Gas, Oil Grease Propane 566.15

\$ 2075.14

C. Mortimer Box 136 Timmins Ont
P4N7C9

A. Lovvold. Foleyet Ont.

A. Toner. Timmins Ont.

L. Schell Bala Ont.

Chain 1189640, 1154401, 1154402
1154409 AND 1154405 DONE TWP.
MAY, JUNE, JULY 1993.

C. MARTIMER.

Water Pump. Bugji. Stratton Fire Pump

Used 14 days MAY, JUNE, JULY 1993.

14 days @ \$50 =

\$700.00

Anselmi Plugger Atlea Cape Cobra

used 15 days MAY, JUNE, JULY 1993

15 days @ \$50 =

\$750.00

\$1450.00

C. MARTIMER. BOX 136 TIMMINS NT
BOX 136 PANTOY.

A. LOVARD FOLEY ET ANT.

A. JOWER TIMMINS ANT

L. SCHILL BALA ANT.

Y

CLAIM 1189640, 1154401, 1154402.
1154404 AND 1154405. DORE TWT.

MAY, JUNE, JULY 1993. C. MORTIMER.
MANUAL LABOUR. PICK. SHOVEL. DRILL. BLAST
RUN WATER PUMP.

DATE	LABOUR	LABOUR	LABOUR
MAY 0/93	C. MORTIMER	L. SCHELL	
MAY 5/93	✓		
MAY 6/93	✓		
MAY 7/93	✓		
MAY 8/93	✓		
MAY 9/93	✓		
MAY 10/93	✓		
MAY 11/93	✓		
MAY 12/93	✓		
MAY 13/93	✓		
MAY 15/93	✓		
MAY 16/93	✓		
MAY 17/93	✓		
MAY 18/93	✓	MAY 18/93 ✓	
MAY 19/93	✓	MAY 19/93 ✓	
MAY 20/93	✓	MAY 20/93 ✓	
MAY 21/93	✓	MAY 21/93 ✓	
MAY 22/93	✓	MAY 22/93 ✓	
MAY 23/93	✓	MAY 23/93 ✓	
MAY 24/93	✓	MAY 24/93 ✓	
MAY 25/93	✓	MAY 25/93 ✓	
MAY 26/93	✓	MAY 26/93 ✓	
MAY 27/93	✓	MAY 27/93 ✓	
MAY 28/93	✓	MAY 28/93 ✓	
MAY 29/93	✓	MAY 29/93 ✓	
MAY 30/93	✓		
MAY 31/93	✓		

22

7

DAYS 29

2 / CLAIM 1189640, 1154901, 1154902
 1154904 AND 1154905 DORE TWP

MAY, JUNE JULY 1993 - C. MERTIMER
 MANUAL LABOUR. PICK. SHOVEL DRILL. BLAST
 RUN WATER PUMP.

DATE	LABOUR C. MORTIMER	LABOUR L. SCHELL	LABOUR
JUNE 2/93	✓	✓	
JUNE 3/93	✓	✓	
JUNE 4/93	✓	✓	
JUNE 11/93	✓	✓	
JUNE 12/93	✓	✓	
JUNE 13/93	✓	✓	
JUNE 14/93	✓	✓	
JUNE 15/93	✓	✓	
JUNE 16/93	✓	✓	
JUNE 17/93	✓	✓	
JUNE 18/93	✓	✓	
JUNE 19/93	✓	✓	
JUNE 20/93	✓	✓	
JUNE 21/93	✓		
JUNE 22/93	✓		
JUNE 23/93	✓		
JUNE 28/93	✓		
JUNE 29/93	✓		
JUNE 30/93	✓		
	19	13	DAYS 32

3 / CLAIM 1189690 . 1154701 ; 1154702
 1154704 AND 1154705 DORE TWP.

MAY, JUNE, JULY, 1993 C. MORTIMER.
 MANUAL LABOUR PICK SNOVEL, DRILL, BLAST
 RUN. WATER PUMP.

DATE	LABOUR C. MORTIMER	LABOUR L. SCHELL	LABOUR A. TONER
JULY 1/93	✓		✓
JULY 2/93	✓		✓
JULY 3/93	✓		✓
JULY 9/93	✓		
JULY 17/93	✓		
JULY 15/93	✓		
JULY 19/93	✓	✓	
JULY 20/93	✓	✓	
JULY 21/93	✓	✓	
JULY 22/93	✓	✓	
JULY 23/93	✓	✓	
JULY 24/93	✓	✓	
<hr/>			
	12	6	3

PAGE 2 21
 PAGE 1 32
 29

TOTAL 82 MAN DAYS @ \$100.00 PER DAY = \$8200.00

C. MORTIMER BOX 136 TIMMINS ONT P4V 7C9
 L. SCHELL BALIA ONT.
 A. TONER TIMMINS ONT.

CLAIM 1189640, 1154401, 1154902
1154404 AND 1154905 DCRK TWP.
MAY, JUNE - JULY 1993. C. MARTINER.

TIME	SHEET.	JSU.	EXCAVATOR
DATE.	OPERATOR.	HRS.	
MAY 4/93	A. LOVOLD	5	
MAY 5/93	A. LOVOLD	8	
MAY 6/93	A. LOVOLD	8	
MAY 7/93	A. LOVOLD	5	
MAY 8/93	A. LOVOLD	5	
MAY 9/93	A. LOVOLD	8	
MAY 10/93	A. LOVOLD	6	
MAY 11/93	A. LOVOLD	8	
MAY 12/93	A. LOVOLD	7	
MAY 13/93	A. LOVOLD	10	
MAY 15/93	A. LOVOLD	7	
MAY 16/93	A. LOVOLD	8	
MAY 17/93	A. LOVOLD	8	
MAY 18/93	A. LOVOLD	10	
MAY 19/93	A. LOVOLD	12	
MAY 20/93	A. LOVOLD	8	
MAY 21/93	A. LOVOLD	9	
MAY 27/93	A. LOVOLD	7	
MAY 28/93	A. LOVOLD	9	
MAY 29/93	A. LOVOLD	10	
MAY 30/93	A. LOVOLD	8	
MAY 31/93	A. LOVOLD	9	
		<u>175</u> HRS	

A. LOVOLD FOLEY ET GNT.

2 CLAIM 1189690, 1154401, 1154402
1154404 AND 1154405. DORE TWP.

MAY, JUNE JULY 1993 D. MORTIMER.

TIME	SHEET	J-S W.	EXCAVATOR
DATE	OPERATOR		HRS
JUNE 2 / 93	L. LOVOLA		7
JUNE 3 / 93	L. LOVOLA		10
JUNE 4 / 93	L. LOVOLA		9
JUNE 11 / 93	L. LOVOLA		8
JUNE 12 / 93	L. LOVOLA		9
JUNE 13 / 93	L. LOVOLA		10
JUNE 14 / 93	L. LOVOLA		7
JUNE 15 / 93	L. LOVOLA		10
JUNE 16 / 93	L. LOVOLA		9
JUNE 17 / 93	L. LOVOLA		8
JUNE 18 / 93	L. LOVOLA		10
JUNE 19 / 93	L. LOVOLA		7
JUNE 20 / 93	L. LOVOLA		8
JUNE 21 / 93	L. LOVOLA		9
JUNE 22 / 93	L. LOVOLA		11
JUNE 23 / 93	L. LOVOLA		8
JUNE 28 / 93	L. LOVOLA		10
JUNE 29 / 93	L. LOVOLA		12
JUNE 30 / 93	L. LOVOLA		8
			<u>170</u> HRS

L. LOVOLA FOLEY ET CNT.

3

CLAIM 1189690. 1189401. 1159402
1154404 AND 1154405 DORE TWP.

MAY, JUNE, JULY 1993 C. MORTIMER.

TIME SHEET JSW EXCAVATOR.

DATE	OPERATOR	HRS.
JULY 1/93	A. LOVOLD	8
JULY 2/93	A. LOVOLD	8
JULY 3/93	A. LOVOLD	8
JULY 9/93	A. LOVOLD	9
JULY 14/93	A. LOVOLD	10
JULY 15/93	A. LOVOLD	12
JULY 19/93	A. LOVOLD	10
JULY 20/93	A. LOVOLD	8
JULY 21/93	A. LOVOLD	7
JULY 22/93	A. LOVOLD	8
JULY 23/93	A. LOVOLD	10
JULY 24/93	A. LOVOLD	12
		<hr/>
		110 NRS
Page 2		170
Page 1		175
		<hr/>
		455 NRS

455 NRS @ \$85 = 38675.00

A. LOVOLD FOLEY ET AL



Report of Work Conducted After Recording Claim

Mining Act

Transaction Number
W9560,00244

Personal information collected on this form is obtained under the authority of the Access to Information Act. This collection should be directed to the Provincial Manager, Mining, Sudbury, Ontario, P3E 6A5, telephone (705) 670-7264.

Street,

Instructions:

- Please type or print and submit in duplicate.
- Refer to the Mining Act and Regulations.



41015SE0026 W9560.00244 DORE

900

lining

- A separate copy of this form must be completed for each Work Group.
- Technical reports and maps must accompany this form in duplicate.
- A sketch, showing the claims the work is assigned to, must accompany this form.

Recorded Holder(s) CHARLES H. MORTIMER		Client No. 172 990
Address Box 136 TIMMINS CNT. P4N2C9		Telephone No.
Mining Division PORCUPINE	Township/Area DORE	M or G Plan No.
Dates Work Performed From: MAY 4/93		To: JULY 24/93

Work Performed (Check One Work Group Only)

Work Group	Type
Geotechnical Survey	
Physical Work, Including Drilling	MANUAL LABOUR. PICK. SHOVEL TRENCHING, STRIPPING DRILLING BLASTING WATER PUMP.
Rehabilitation	
Other Authorized Work	
Assays	
Assignment from Reserve	

RECORDED
MAY 4 1995
Receipt _____

Total Assessment Work Claimed on the Attached Statement of Costs \$ **50,400.00**

Note: The Minister may reject for assessment work credit all or part of the assessment work submitted if the recorded holder cannot verify expenditures claimed in the statement of costs within 30 days of a request for verification.

Persons and Survey Company Who Performed the Work (Give Name and Address of Author of Report)

Name	Address
C. MORTIMER	Box 136 TIMMINS CNT. P4N2C9.
A. LOVOLD	FOLEY CT. ONT.
L. SCHEL	BALA CNT.
A. TONER	TIMMINS CNT.

(attach a schedule if necessary)

Certification of Beneficial Interest * See Note No. 1 on reverse side

I certify that at the time the work was performed, the claims covered in this work report were recorded in the current holder's name or held under a beneficial interest by the current recorded holder.	Date April 17/95	Recorded Holder or Agent (Signature) CH. Mortimer
--	----------------------------	---

Certification of Work Report

I certify that I have a personal knowledge of the facts set forth in this Work report, having performed the work or witnessed same during and/or after its completion and annexed report is true.

Name and Address of Person Certifying CHARLES H. MORTIMER Box 136 TIMMINS CNT P4N2C9		
Telephone No.	Date April 17/95	Certified By (Signature) CH Mortimer

For Office Use Only

50,400.	Total Value Cr. Recorded	Date Recorded	Mining Recorder	<div style="border: 2px solid black; padding: 10px; width: fit-content; margin: auto;"> <p style="font-size: 2em; margin: 0;">RECEIVED</p> <p style="margin: 0;">MAY 4 1995</p> <p style="margin: 0;">2.30</p> <p style="margin: 0;">PORCUPINE MINING DIVISION</p> </div>
	Deemed Approval Date AUG. 2/95	Date Approved JULY 27/95		
	Date Notice for Amendments Sent			

Work Report Number for Applying Reserve	Claim Number (see Note 2)	Number of Claim Units
	1189648	6
	1154411	1
	1154412	1
	1154413 <i>Option</i>	
	1154417	1
	1154406	1
	1154407	1
	1154408	1
	1154409	1
	1154410	1
	1154411	1
	1154412	1
	1154413	1
	1154414	1
	1154415	1
	1154416	1
Total Number of Claims		

Value of Assessment Work Done on the Claim	Value Applied to this Claim
258800.00 <i>Option</i>	
52000.00 <i>Option</i>	
2600.00 <i>Option</i>	
88000.00 <i>Option</i>	
88000.00 <i>Option</i>	
88000.00 <i>Option</i>	
	4000.
	4000
	4000
	4000
	4000
	4000
	4000
	4000
	4000
	4000
	4000
	4000
Total Value Work Done	504000.00

Value Assigned from this Claim	Reserve: Work to be Claimed at a Future Date
4800.00	20400.00
	5200.00
	2600.00
	8800.00 <i>Option</i>
	8700.00
	8700.00
Total Assigned From	45600.00

Credits you are claiming in this report may be cut back. In order to minimize the adverse effects of such deletions, please indicate from which claims you wish to prioritize the deletion of credits. Please mark (✓) one of the following:

- 1. Credits are to be cut back starting with the claim listed last, working backwards.
- 2. Credits are to be cut back equally over all claims contained in this report of work.
- 3. Credits are to be cut back as prioritized on the attached appendix.

In the event that you have not specified your choice of priority, option one will be implemented.

Note 1: Examples of beneficial interest are unrecorded transfers, option agreements, memorandum of agreements, etc., with respect to the mining claims.

Note 2: If work has been performed on patented or leased land, please complete the following:

I certify that the recorded holder had a beneficial interest in the patented or leased land at the time the work was performed.	Signature	Date
---	-----------	------

Nombre de rapport sur les travaux exécutés pour l'affectation de la réserve	Nombre de claim	Nombre d'unités
	11549417	1
Nombre total de claim		17
		adulte

Valeur des travaux d'évaluation exécutés sur ce claim	Valeur affectée à ce claim
	400000
Valeur totale des travaux exécutés	4800000

Valeur transférée de ce claim	Réserve : travaux à réclamer à une date ultérieure
Total transféré	Réserve totale

Les crédits que vous réclamez dans le présent rapport peuvent être réduits. Afin de diminuer les conséquences défavorables de telles réductions, veuillez indiquer l'ordre dans lequel vous désirez qu'elles soient appliquées à vos claims. Veuillez cocher (✓) l'une des options suivantes :

- 1. Les crédits doivent être réduits en commençant par le dernier claim sur la liste.
- 2. Les crédits doivent être réduits également entre tous les claims figurant dans le présent rapport.
- 3. Les crédits doivent être réduits selon l'ordre donné en annexe.

Si vous n'avez pas choisi d'option, la première sera appliquée.

Note 1 : Exemples d'intérêts bénéficiaires : cessions non enregistrées, ententes sur des options, protocoles d'entente, etc. relatifs aux claims.

Note 2 : Si des travaux ont été exécutés sur un terrain faisant l'objet de lettres patentes ou d'un bail, veuillez remplir ce qui suit:

Je certifie que le titulaire enregistré possédait un intérêt bénéficiaire sur le terrain faisant l'objet de lettres patentes ou d'un bail, au moment où les travaux ont été exécutés.	Signature	
	Date	



Ministry of
Northern Development
and Mines

Ministère du
Développement du Nord
et des mines

**Statement of Costs
for Assessment Credit**

**État des coûts aux fins
du crédit d'évaluation**

Transaction No./N° de transaction
W9560.00244

Mining Act/Loi sur les mines

Personal information collected on this form is obtained under the authority of the Mining Act. This information will be used to maintain a record and ongoing status of the mining claim(s). Questions about this collection should be directed to the Provincial Manager, Minings Lands, Ministry of Northern Development and Mines, 4th Floor, 159 Cedar Street, Sudbury, Ontario P3E 6A5, telephone (705) 670-7264.

Les renseignements personnels contenus dans la présente formule sont recueillis en vertu de la Loi sur les mines et serviront à tenir à jour un registre des concessions minières. Adresser toute question sur la collecte de ces renseignements au chef provincial des terrains miniers, ministère du Développement du Nord et des Mines, 159, rue Cedar, 4^e étage, Sudbury (Ontario) P3E 6A5, téléphone (705) 670-7264.

1. Direct Costs/Coûts directs

Type	Description	Amount Montant	Totals Total global
Wages Salaires	Labour 82 DAYS Main-d'oeuvre	100 PER DAY	
	Field Supervision Supervision sur le terrain		8,110.00
Contractor's and Consultant's Fees Droits de l'entrepreneur et de l'expert- conseil	Type JOB EXCAVATE		
			28,110.00
Supplies Used Fournitures utilisées	Type GAS OIL, GRASS	566.15	
		566.15	566.15
Equipment Rental Location de matériel	Type ATLAS COPCO PUMPS	750.00	
	BRIGGS STRATTON PIKE PUMP.	700.00	
		1,450.00	1,450.00
Total Direct Costs Total des coûts directs			10,826.15

2. Indirect Costs/Coûts indirects

** Note: When claiming Rehabilitation work indirect costs are not allowable as assessment work.
Pour le remboursement des travaux de réhabilitation, les coûts indirects ne sont pas admissibles en tant que travaux d'évaluation.

Type	Description	Amount Montant	Totals Total global
Transportation Transport	Type		
Food and Lodging Nourriture et hébergement	GROCERIES	150.00	150.00
Mobilization and Demobilization Mobilisation et démobilisation			
Sub Total of Indirect Costs Total partiel des coûts indirects			150.00
Amount Allowable (not greater than 20% of Direct Costs) Montant admissible (n'excédant pas 20 % des coûts directs)			2,165.23
Total Value of Assessment Credit (Total of Direct and Allowable indirect costs)			13,000.00
Value total du crédit d'évaluation (Total des coûts directs et indirects admissibles)			13,000.00

Note: The recorded holder will be required to verify expenditures claimed in this statement of costs within 30 days of a request for verification. If verification is not made, the Minister may reject for assessment work all or part of the assessment work submitted.

Note : Le titulaire enregistré sera tenu de vérifier les dépenses demandées dans le présent état des coûts dans les 30 jours suivant une demande à cet effet. Si la vérification n'est pas effectuée, le ministre peut rejeter tout ou une partie des travaux d'évaluation présentés.

Filing Discounts

1. Work filed within two years of completion is claimed at 100% of the above Total Value of Assessment Credit.
2. Work filed three, four or five years after completion is claimed at 50% of the above Total Value of Assessment Credit. See calculations below:

Total Value of Assessment Credit	Total Assessment Claimed
	x 0.50 =

Remises pour dépôt

1. Les travaux déposés dans les deux ans suivant leur achèvement sont remboursés à 100 % de la valeur totale susmentionnée du crédit d'évaluation.
2. Les travaux déposés trois, quatre ou cinq ans après leur achèvement sont remboursés à 50 % de la valeur totale du crédit d'évaluation susmentionné. Voir les calculs ci-dessous.

Value total du crédit d'évaluation	Évaluation totale demandée
	x 0.50

Certification Verifying Statement of Costs

I hereby certify:
that the amounts shown are as accurate as possible and these costs were incurred while conducting assessment work on the lands shown on the accompanying Report of Work form.

that as _____ I am authorized
(Recorded Holder, Agent, Position in Company)

to make this certification

Attestation de l'état des coûts

J'atteste par la présente :
que les montants indiqués sont le plus exact possible et que ces dépenses ont été engagées pour effectuer les travaux d'évaluation sur les terrains indiqués dans la formule de rapport de travail ci-joint.

Et qu'à titre de _____ je suis autorisé
(titulaire enregistré, représentant, poste occupé dans la compagnie)

à faire cette attestation.

Signature C. H. Mortimer Date April 17/95

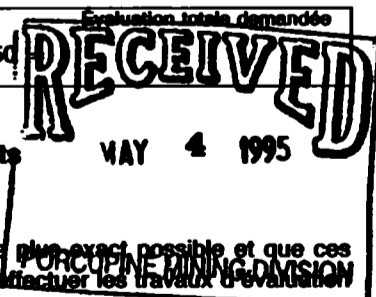

NOTES

400 surface rights reservation along the shores of all lakes and rivers

TRANCH, PSTRIP
PMAN

COPPELL TP

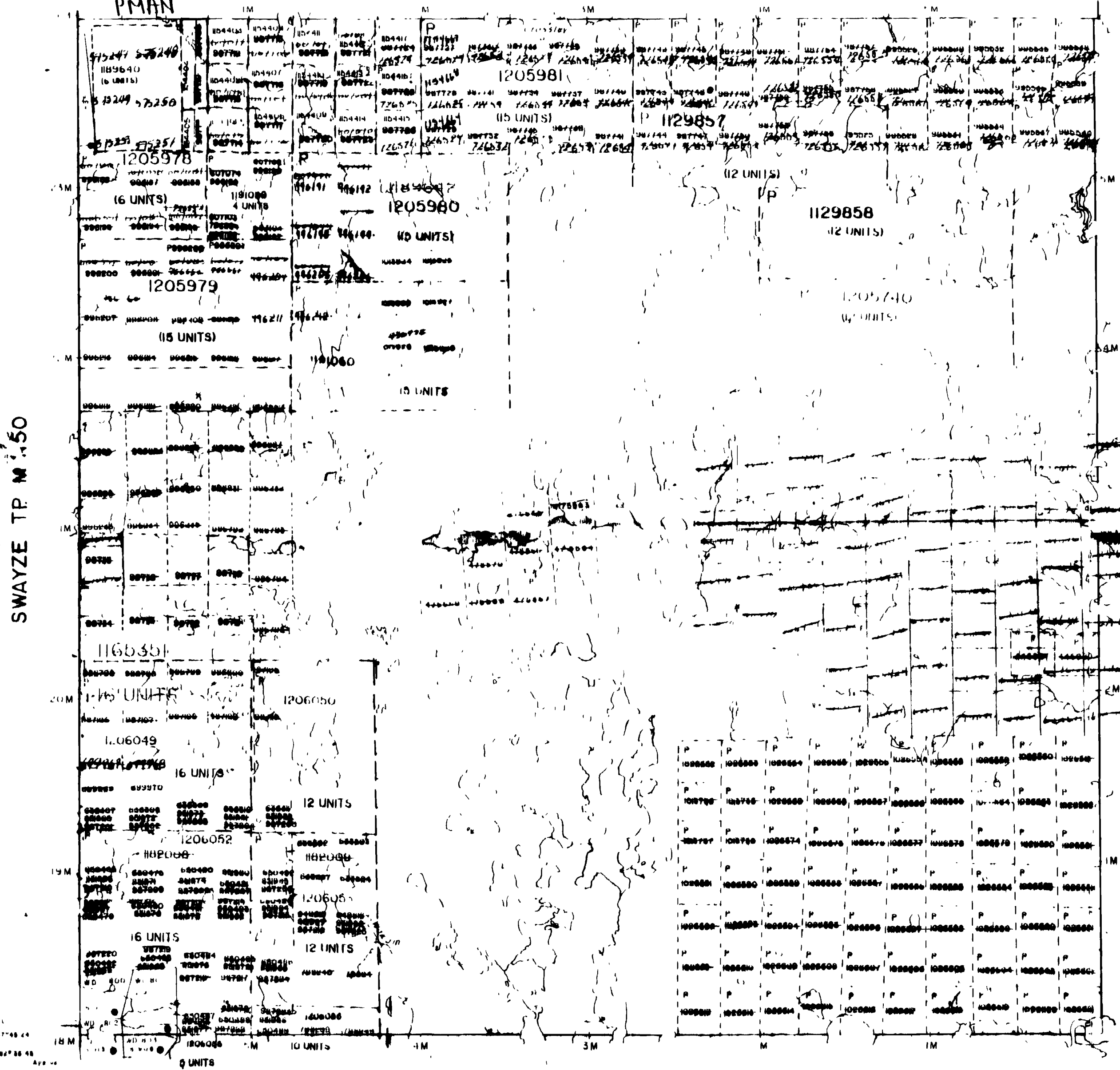

SWAYZE TP. M. 925

HEENAN TP. M. 925

GARNET TP. M. 829

THE INFORMATION THAT APPEARS ON THIS MAP HAS BEEN COMPILED FROM VARIOUS SOURCES, AND ACCURACY IS NOT GUARANTEED. THOSE WISHING TO STAKE MINING CLAIMS SHOULD CONSULT WITH THE MINING RECORDER, MINISTRY OF NORTHERN DEVELOPMENT AND MINES, FOR ADDITIONAL INFORMATION ON THE STATUS OF THE LANDS SHOWN HEREON.

LEGEND

- ROADWAY AND RIGHT OF WAY
- UTILITY LINES
- THALES
- UNSURVEYED LINES
- TOWNSHIP, RANGE LINES, ETC.
- LOT'S, MINING CLAIMS, PARCELS, ETC.
- UNSURVEYED LINE
- LOT LINES
- PARCEL BOUNDARY
- MINING CLAIM, ETC.
- RAILWAY AND RIGHT OF WAY
- UTILITY LINE
- IRON PERENNIAL STREAM
- FLOODING OR FLOODING RIGHT
- SUBDIVISION
- ORIGINAL SURVEY LINE
- MARSH OR MUSKIE
- MINES

NOTES

DISPOSITION OF CROWN LANDS

- | TYPE OF DOCUMENT | SYMBOL |
|-------------------------------|--------|
| PAIRED SURFACE MINING RIGHTS | ● |
| UNPAIRED SURFACE RIGHTS | ○ |
| LEASE SURFACE & MINING RIGHTS | ■ |
| UNPAIRED SURFACE RIGHTS ONLY | □ |
| MINING RIGHTS ONLY | ▨ |
| ABSENCE OF DECLARATION | ◇ |
| CROWN LAND SALE | ◇ |
| ORDER IN COUNCIL | ◇ |
| RESERVATION | ◇ |
| LABELED | ◇ |
| LAND USE PERMIT | ◇ |

Received Jan 7/80

SCALE 1 INCH = 40 CHAINS

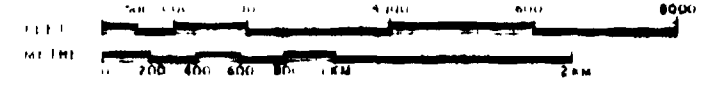

ACRES	HECTARES
40	16

TOWNSHIP

DORE

DISTRICT

SUDBURY

MINING DIVISION

PORCUPINE



Ministry of Natural Resources

Ontario Surveys and Mapping Branch

Date: 4/11/80

Print No.

Whitby, Ont.

Quebec, P.Q., Toronto

6-1108



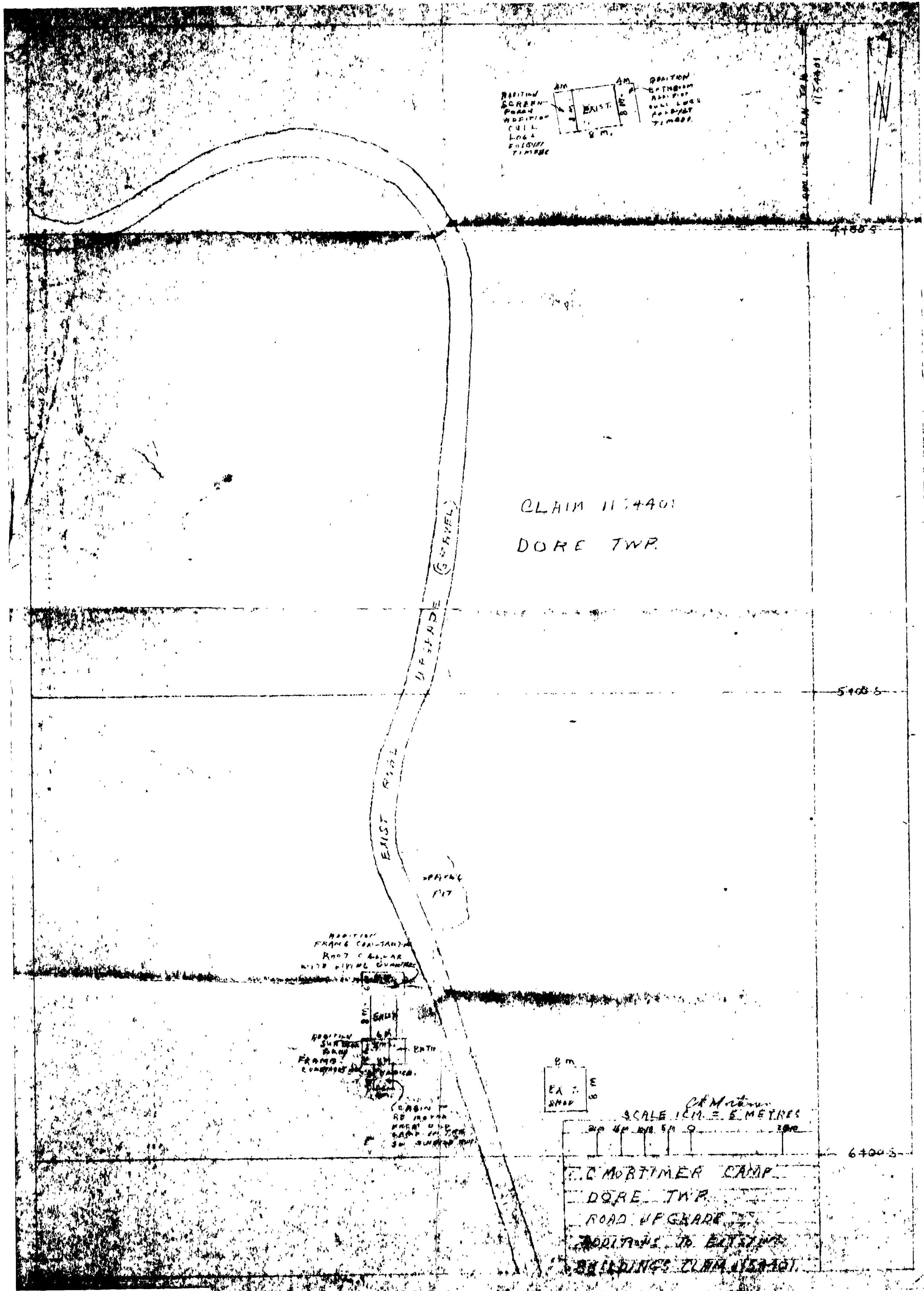

POSITION
SCREEN
POSITION
WELL
LOG
ENTRANCE
TIMBER

4M
8M

EXIST. RAIL

POSITION
CAMP
WELL
LOG
ENTRANCE
TIMBER

CLAIM 115401
DORE TWP.

ROOFING
FRAME COAL-TANK
ROOF COLLAR
WIDE DIVING QUARTER

ROOFING
SURFACE
FRAMES
LUMBER

CABIN
ROOFING SURFACE
FRAMES
LUMBER
ENTR

8m
E
W

SCALE 1 CM. = 5 METRES

E.C. MORTIMER CAMP
DORE TWP.
ROAD UPGRADE
ROADS TO EASTERN
BUILDINGS CLAIM 115401



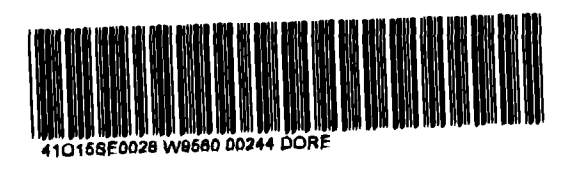
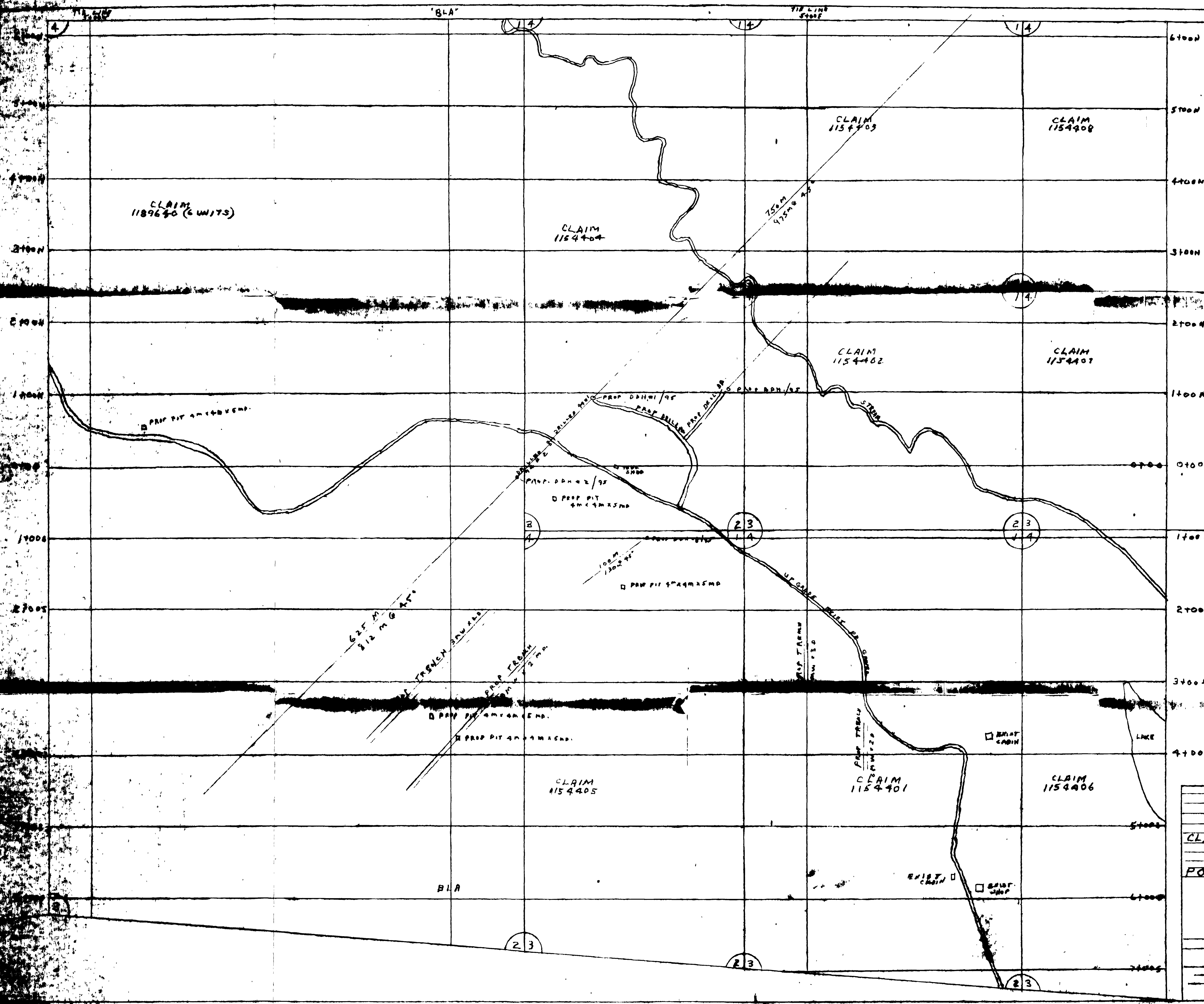

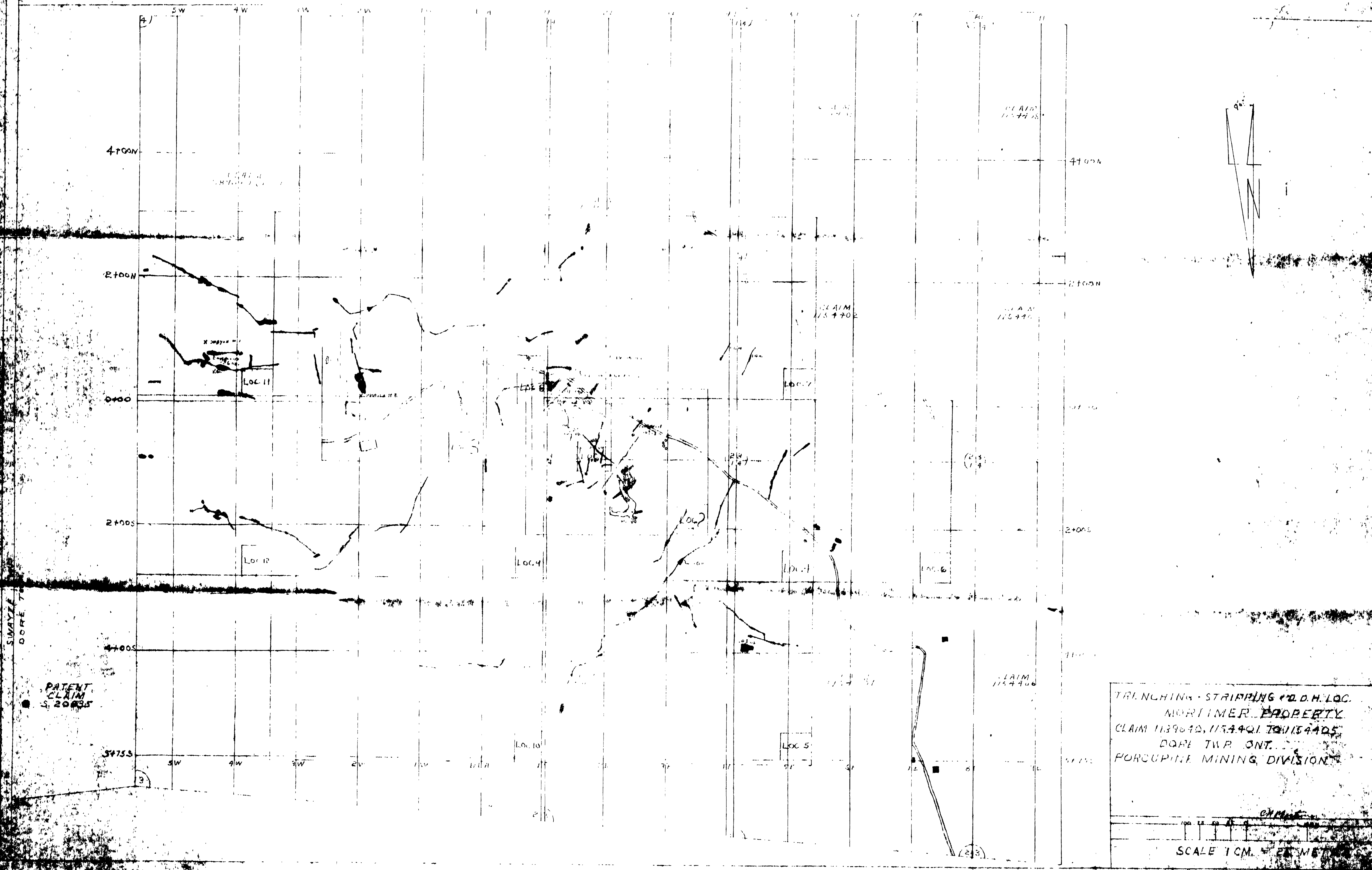

TRINCHING - STRIPPING P.D.H. LOC.
 MORTIMER PROPERTY
 CLAIM 1139640, 1154401 TO 1154405
 DORE TWP. ONT.
 PORCUPINE MINING DIVISION

SCALE 1 CM. = 25 METERS



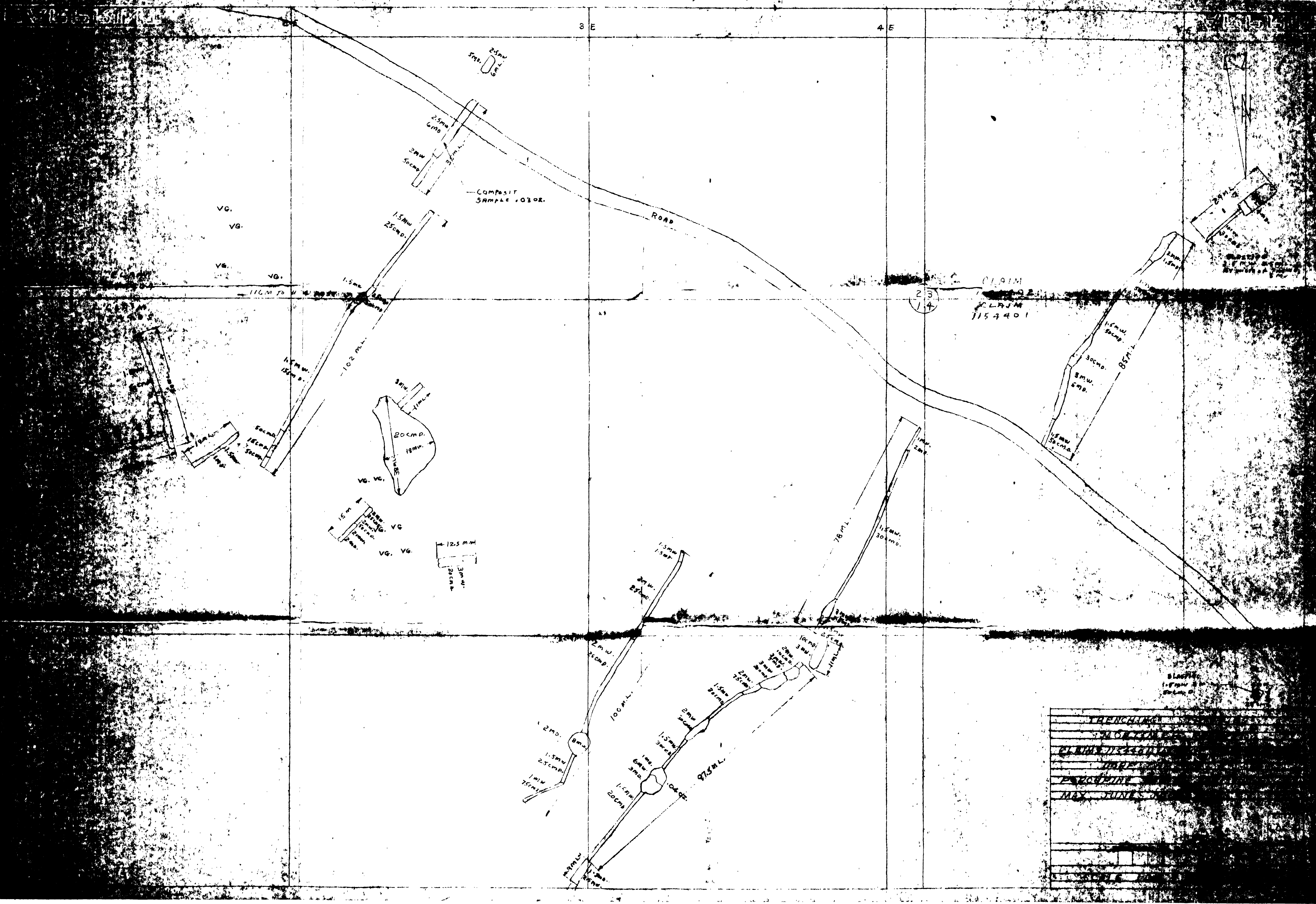

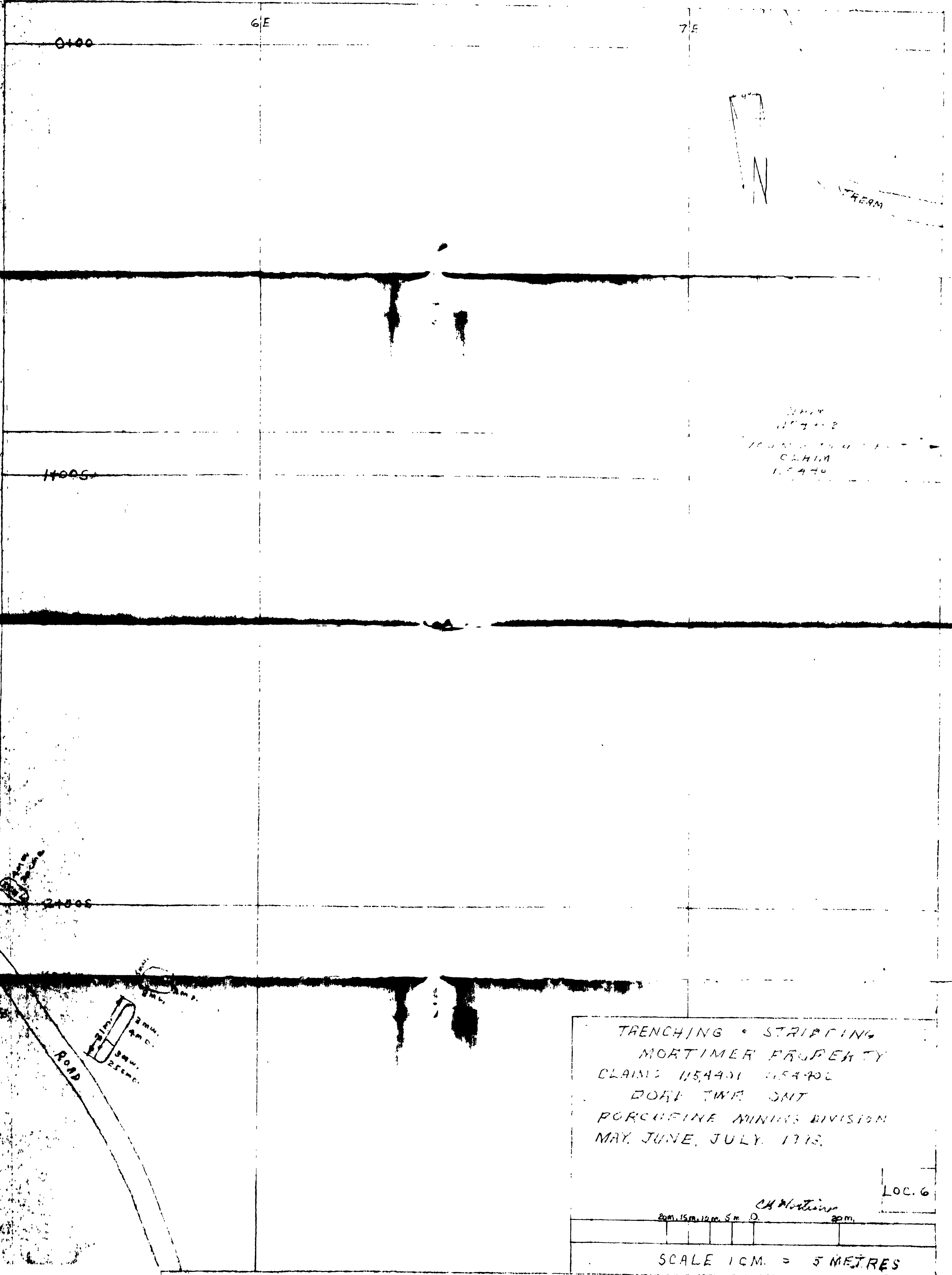

0+00

6E

7E

1+005

2+005

ROAD

STREAM

115441
115442
115443
115444
115445
115446
115447
115448
115449
115450

TRENCHING • STRIPPING
MORTIMER PROPERTY
CLAIMS 115441 115450
DORÉ TWP. QNT
PORCUPINE MINING DIVISION
MAY, JUNE, JULY, 1973.

LOC. 6

20m, 15m, 10m, 5m, 0, 5m, 10m, 15m, 20m

SCALE 1 CM. = 5 METRES



410188E0028 W880 00244 DORE

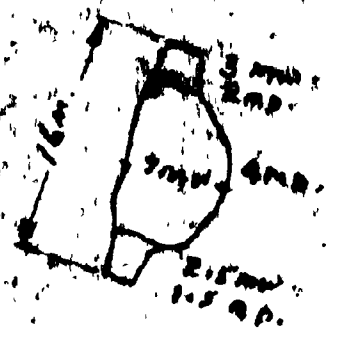

6.00

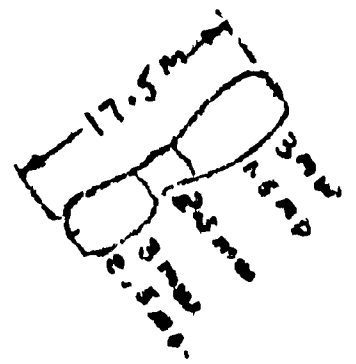

17.50

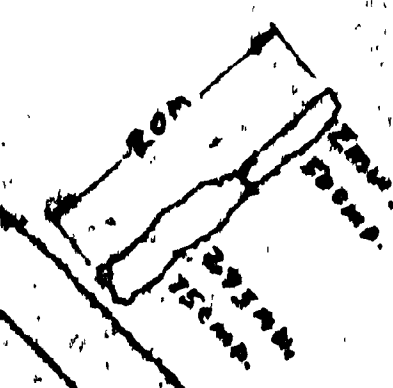

3 E

4 E

5 E

CLAIM 1154404

CLAIM 1154403

CLAIM 1154402

STREAM

15m. W. 4. Post

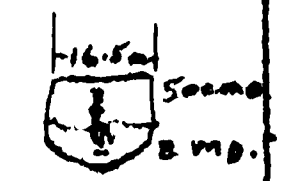
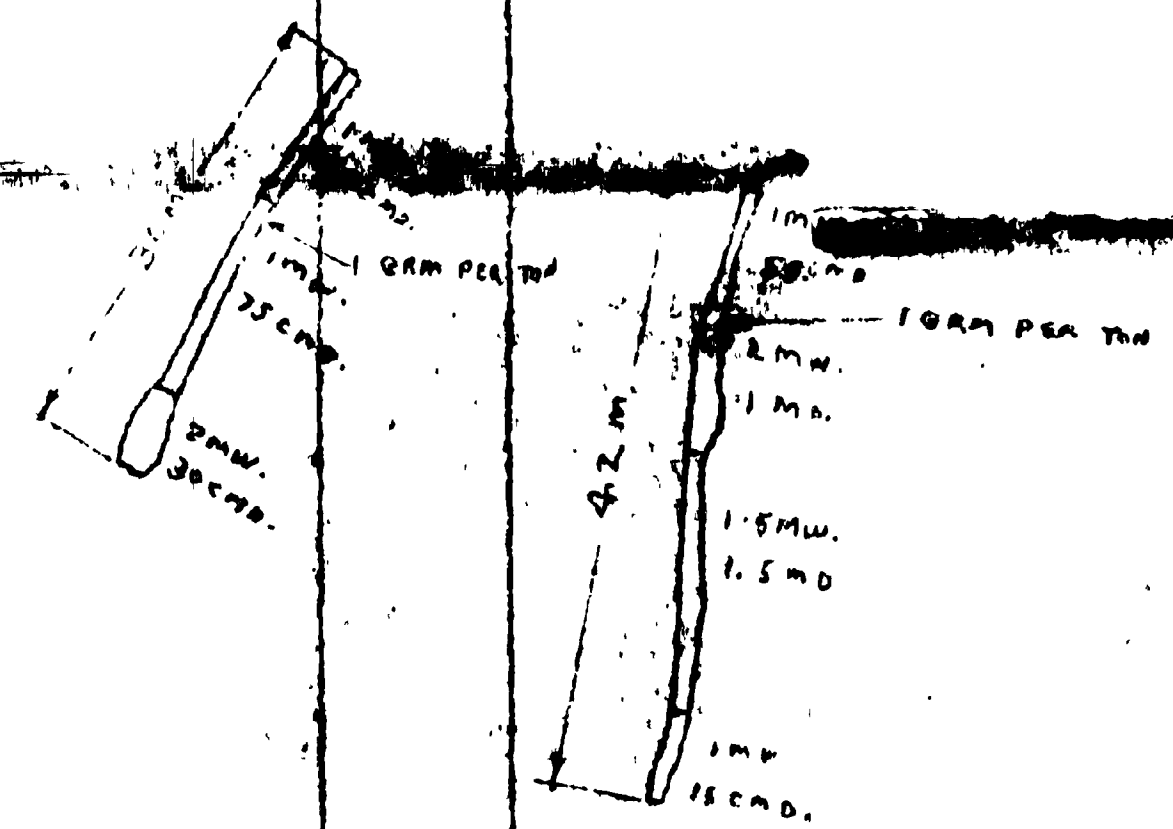

TRENCHING & SHIPPING
MORTIMER PROPERTY
CLAIMS 1154402, 1154403, 1154404
D.O.R.E. TWP. ONE
POCUPINE MINING DIVISION
MAY, JUNE, JULY 1993
LOC. 7
SCALE 1cm = 1 METRE



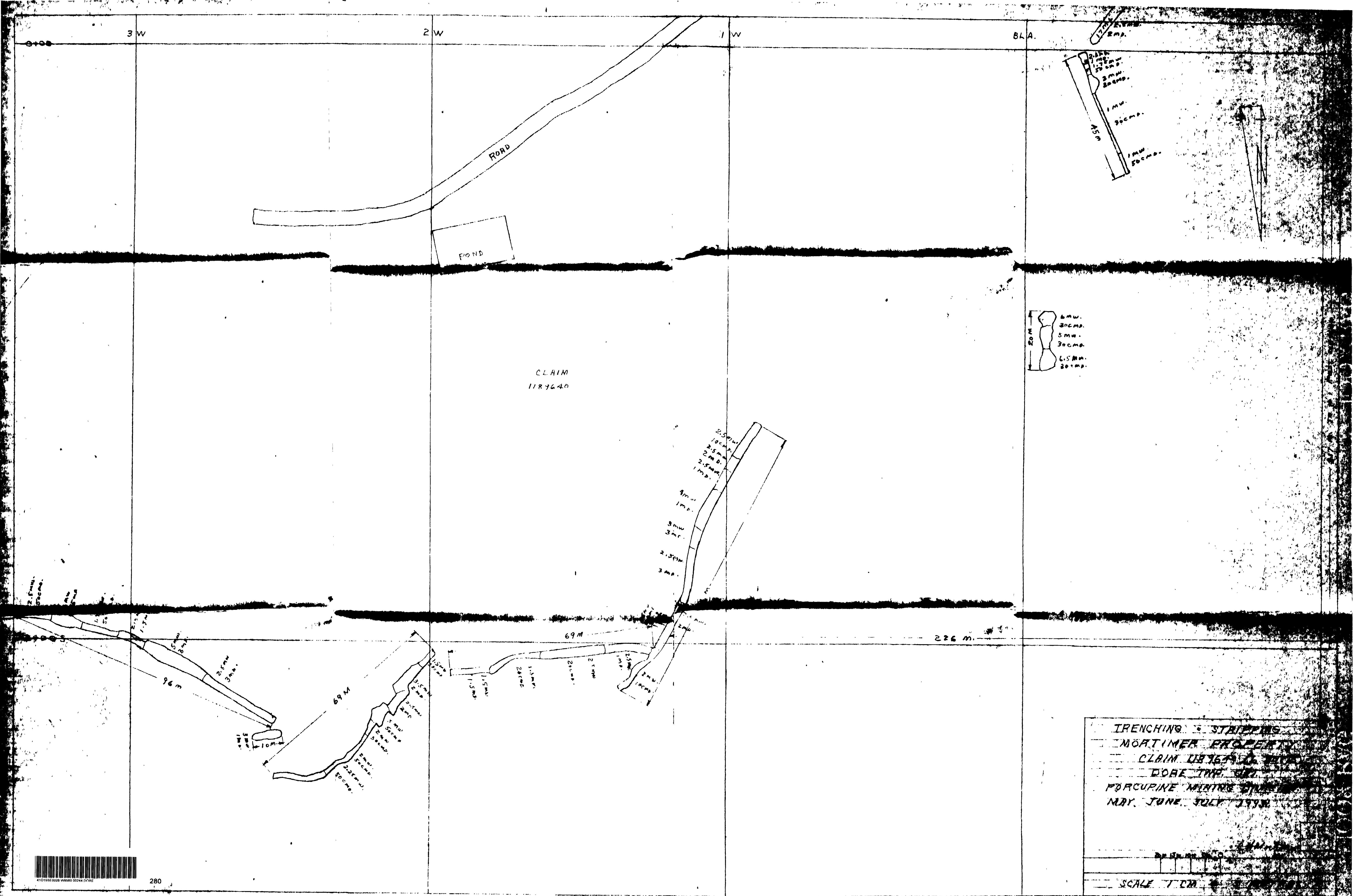

CLAIM
1187640

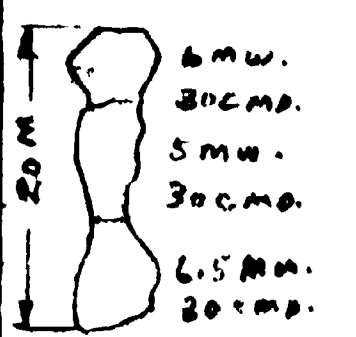

TRENCHING & STRIPPING
MORTIMER PROPERTY
CLAIM 1187640
DOE TRAIL
PORCUPINE MOUNTAIN DISTRICT
MAY, JUNE, JULY 1998

SCALE 1:10000



CLAIM
1189640

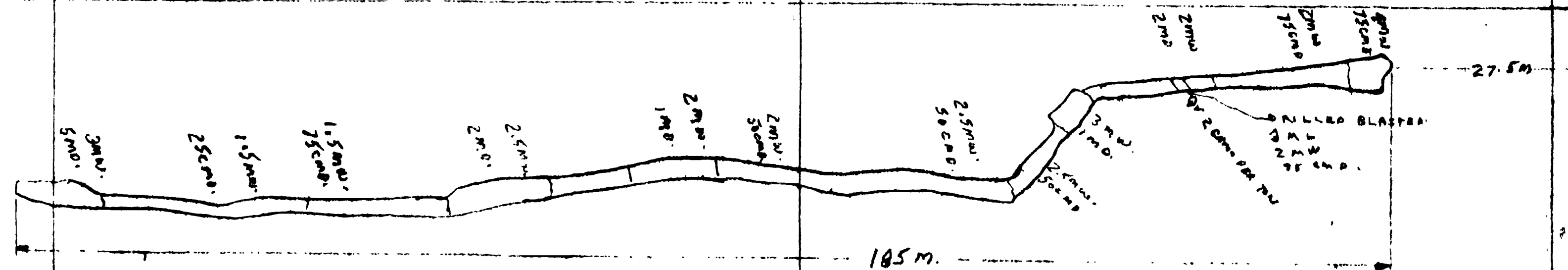

TRENCHING & STRIPPING
MORTIMER PROPERTY
CLAIM 1189640 (6 UNITS)
DORE TWP. ONT.
PORCUPINE MINING DIVISION
MAY, JUNE, JULY, 1993.

LOC. 10

SCALE 1 CM = 2 METERS

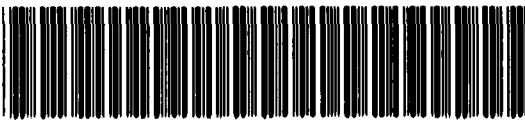

3 W 2 W 1 W B L A I E

CLAIM
1189640

TRENCHING & STRIPPING
MORTIMER PROPERTY
CLAIM 1189640 (6 UNITS)
DORE TWP. ONT.
PORCUPINE MINING DIVISION
MAY JUNE JULY 1993

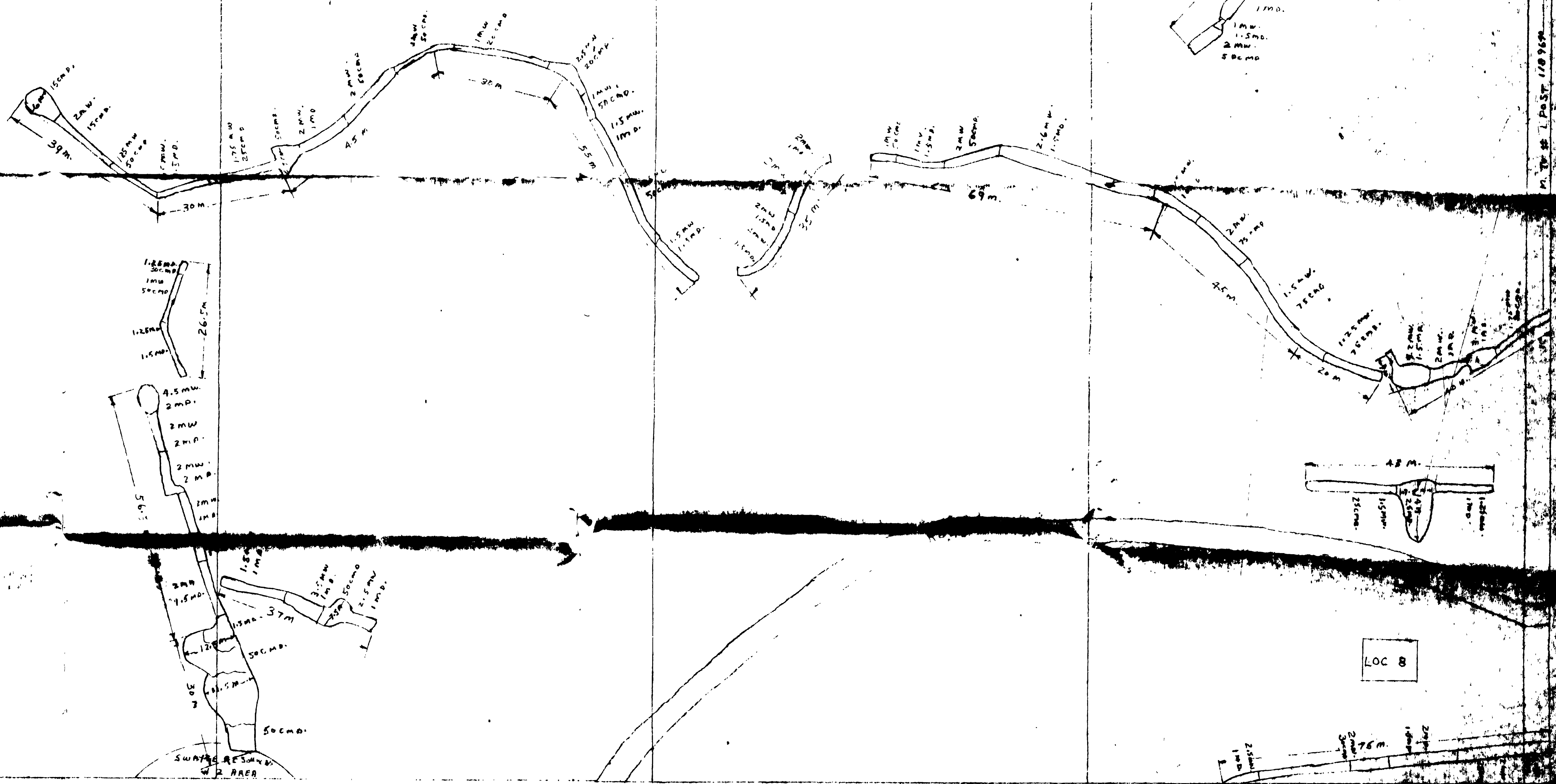
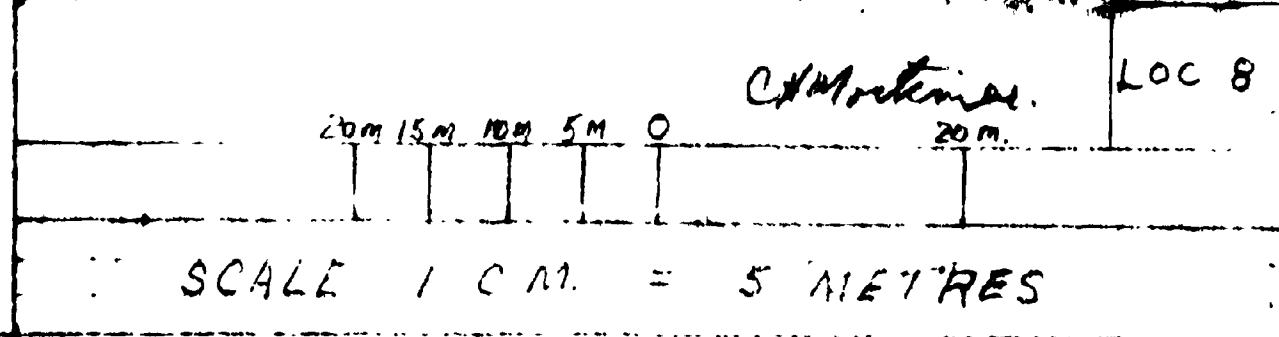

M. T. 88 1. Post 170 764

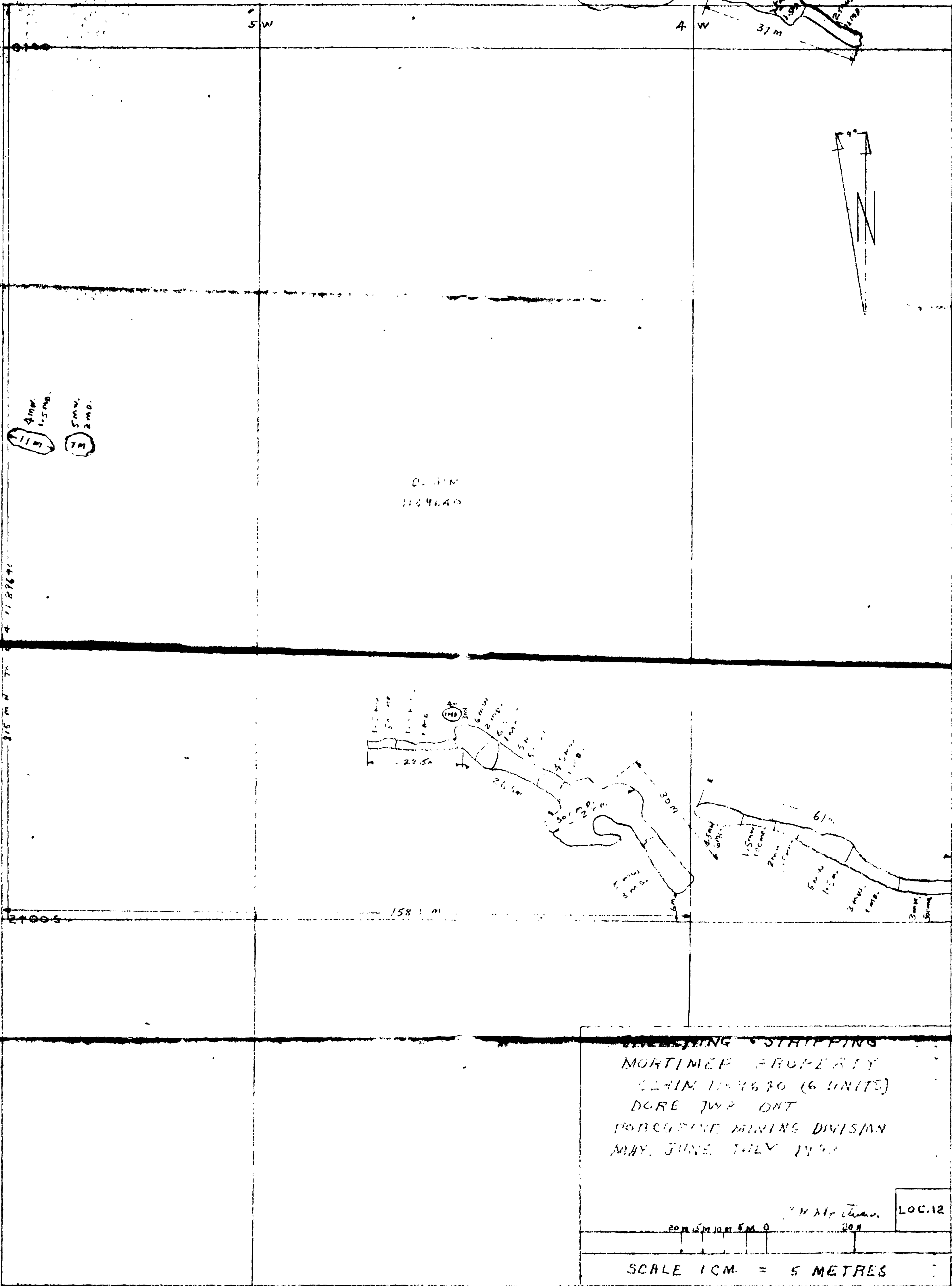

TRENCHING & STRIPPING
 MORTIMER PROPERTY
 CLAIM 1189640 (6 UNITS)
 DORE TWP. ONT.
 PORCUPINE MINING DIVISION
 MAY, JUNE, JULY 1993.

LOC 11

SCALE 1 CM = 5 METRES

