

Gene



41015SE0079 2.7205 SWATZE

010

Geological Report
on the

Yarwood Lake Property

Cunningham & Swayze Townships
Porcupine Mining Division
Ontario

for

Ingamar Explorations Limited

by

Don Hillier, B.SC.

August 1984

RECEIVED
OCT 11 1984
MINING DIVISION



41015SE0079 2.7205 SWAYZE

010C

TABLE OF CONTENTS

| | <u>PAGE NUMBER</u> |
|---------------------------------|--------------------|
| Introduction | 1 |
| Location and Access | 2 |
| Property Ownership | 2 |
| Topography and Vegetation | 3 |
| Survey Procedure | 4 |
| Previous Work | 5, 6, 7 & 8 |
| General Geology | 9 & 10 |
| Property Geology | 11 & 12 |
| Conclusions and Recommendations | 13 |
| References | 14 |
| Certificate | 15 |

List of Figures

Figure 1 Location Sketch
Figure 2 Claim Sketch

List of Tables

Table 1 Table of Formations
Map 1 Geological Survey Map

Appendix A
Claim Abstracts

I N T R O D U C T I O N

The Yarwood Lake Property of Ingamar Explorations Limited consists of fourteen (14) contiguous unpatented, 40 acre (approx.) mining claims. Thirteen are located in Cunningham Township and one claim is located in Swayze Township, District of Sudbury, Porcupine Mining Division, Northeastern Ontario.

A geological survey was carried out during the month of August, 1984 and the property was found to be underlain by intermediate to mafic metavolcanics, chemical metasediments, mafic intrusive rocks and iron formation. A zone of massive pyrite-magnetite was found to occur on claim #765705. This area and other mineralized outcrops were sampled and all samples will be assayed for gold content. A follow-up program consisting of electromagnetic and magnetic surveys and some trenching is recommended.

LOCATION AND ACCESS

The property is located in northeastern Ontario at latitude 47° 45' and longitude 82° 37' or approximately 75 miles southwest of Timmins, Ontario. (see fig. 1). Yarwood Lake is located on the northeastern portion of the property.

The property is accessible via float plane leased at Ivanhoe Lake located 30 miles north-northeast of the property.

PROPERTY OWNERSHIP

The property described in this report consists of 14 contiguous, unpatented, 40 acre (approx.) mining claims located in Cunningham & Swayze Twps. Porcupine Mining Division, Ontario; and are described as follows:

| <u>Claim No.</u> | <u>Staker</u> | <u>Date Recorded</u> |
|------------------|---------------|----------------------|
| P 724418 | R. Roy | July 6, 1983 |
| 724419 | R. Roy | July 6, 1983 |
| 724420 | R. Roy | July 6, 1983 |
| 724421 | R. Roy | July 6, 1983 |
| 724422 | R. Roy | July 6, 1983 |
| 724423 | R. Roy | July 6, 1983 |
| 765676 | R. Roy | July 6, 1983 |
| 765677 | R. Roy | July 6, 1983 |
| 765678 | R. Roy | July 6, 1983 |
| 765679 | R. Roy | July 6, 1983 |
| 765680 | R. Roy | July 6, 1983 |
| 765703 | R. Roy | July 6, 1983 |
| 765704 | R. Roy | July 6, 1983 |
| 765705 | R. Roy | July 6, 1983 |

These claims are currently held in good standing by
Ingamar Explorations Limited.

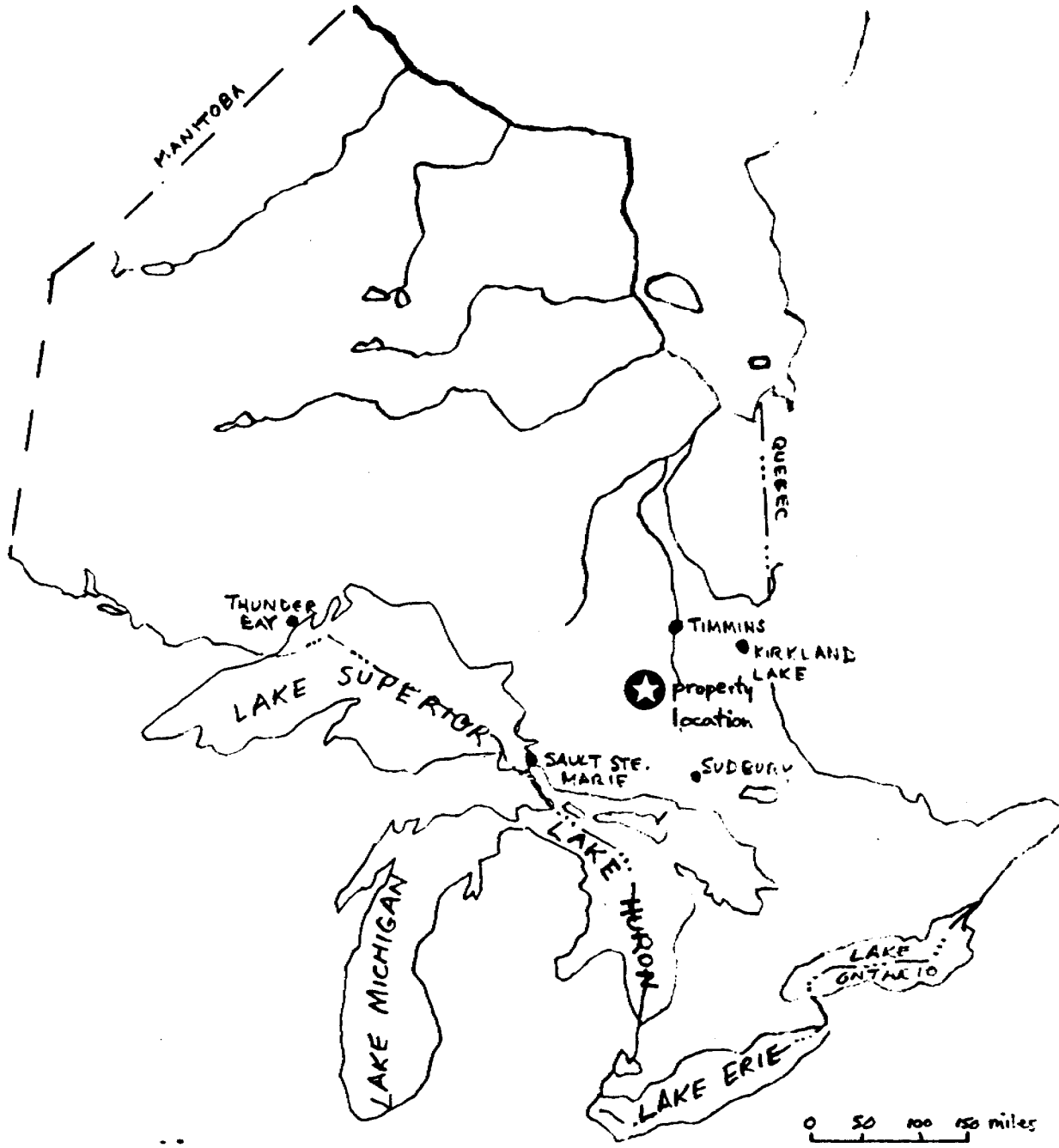

FIG. 1 LOCATION SKETCH

Swayze Twp

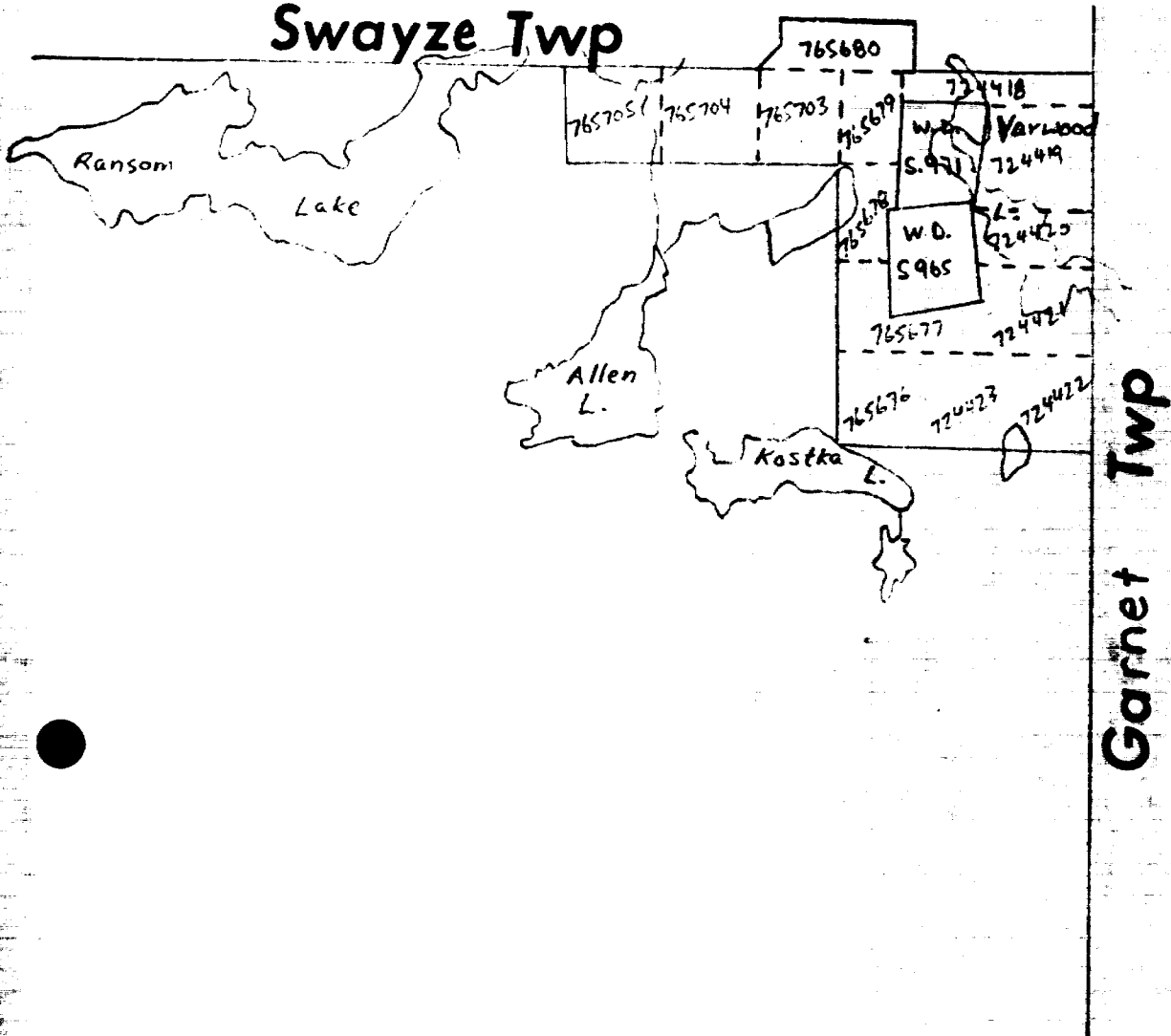

FIG. 2 CLAIM SKETCH

TOPOGRAPHY AND VEGETATION

The main physiographical feature on the property is Yarwood Lake located on the eastern side of the property. Kotska Lake borders the southern part of the property and an unnamed lake covers the western half of claim #765678. Most outcrop is confined to the edge of Yarwood Lake and the edges of hills scattered throughout the property. There are numerous swamps and muskegs but none of any great extent.

Jackpine, white birch, black spruce, balsam fir, poplar and alder are the principal tree mixture covering the property.

SURVEY PROCEDURE

A total of 13.7 miles of line was blazed, chained and picketed, mileage is as follows:

| | |
|----------------------|------|
| Base lines/tie lines | 2.1 |
| Picket lines | 11.6 |

Picket lines were turned off at 90 degrees to the east-west baseline and tielines at 400 foot intervals and cut to the property boundary. Stations at 100 foot intervals were established along the picket lines.

The property was geologically mapped using the established picket lines. Interline traversing was done by the pace and compass method. Results of the survey were plotted on a map to the scale of one inch equals 200 feet.

Work Done By

Linecutting - S. Mortson, Timmins, Ontario
- D. Hillier, Timmins, Ontario

Geological Survey - D. Hillier, Timmins, Ontario

P R E V I O U S W O R K

Previous work on the Yarwood Lake property consists of a geological and magnetometer survey conducted in 1956 by Simard and Knight for Aumacho River Mines Limited (file #T2047). These surveys covered all of the present property except for claims #765605 and #765604. Old trenches and a pit (8' x 6' x 5') have been excavated on claim #765705 but no record of this work has been filed for assessment credit.

The earliest exploration activity in the area was originally aroused by the presence of iron in chert and prospecting for iron was carried out in the period 1904-1907 by the Ridout Mining Company. Development in the area ceased after the iron content was found to be too low for economic mining at that time.

In 1927 galena and sphalerite veins were found in chert and exploration for base-metal deposits intensified.

A gold property consisting of 12 claims in the Allen Lake area was acquired by Swayze-Huycke Gold Mines Limited in 1933. Work on this property consisted of diamond drilling in 1933 and in 1934 shaft sinking began. By September of that year a complete mining plant had been installed and a two compartment shaft had reached a depth of 150 feet with a level at 125 feet. About 30 feet of drifting and 98 feet of cross-cutting was completed.

Due to the lack of extensions of promising surface gold values operations were suspended. In 1939 the property was sold to Olive Gold Mines Limited and was restaked in 1961 by Flint Rock Mines Limited.

The majority of exploration and development work in Cunningham Township has occurred on the property of Consolidated Shunsby Mines Limited located in the central part of the township.

P R E V I O U S W O R K (C O N T ')

Chalcopyrite and sphalerite were found in claim 534947 in the summer of 1955 and 20 claims were optioned to Shunsby Gold Mines Limited; in 1967 this name was changed to Consolidated Shunsby Mines Limited. In 1975 the company was renamed MW Resources Limited. Geological mapping, stripping and trenching, and diamond drilling of 74 holes totalling 20,336 feet was carried out during the period 1955-1957. Further exploration work consisting of a geological survey and 9 diamond drill holes totalling 3,605 feet was carried out in 1960-1961 by Nipiron Mines Limited, under an option agreement with Shunsby. An additional 15 claims were staked and transferred to Shunsby. In June and July of 1961, nine more holes totalling 4,110 feet were diamond drilled along with a limited amount of magnetic and electromagnetic surveying. An additional 14,279 feet of diamond drilling was completed in 1965 with financing provided by the F.R. Soubin Prospecting Syndicate. During the period October 1968-February 1969 an additional 9,091 feet of diamond drilling was completed with funds totalling \$100,000 raised through a public underwriting of Consolidated Shunsby Mines Limited. A total of 51,417 feet of diamond drilling had been completed on the property at this time, and as of August 1971 the property consisted of 20 patented claims, one licence of occupation over 23.32 acres, 10 leased claims, and 11 ordinary claims, all in one block. In 1974 Grandora Explorations Limited acquired an option on the Consolidated Shunsby property and added an additional 22 claims. By January 1975 at least 2,871 feet of diamond drilling had been completed by Grandora. In 1978 an additional five drill holes totalling 1,237 feet were completed by M.W. Resources Limited in the Beavertial Lake area.

As of May 1975 Grandora Exploration Limited has an indicated 1,000,000 tons amenable to open pit mining and 500,000 tons to underground methods grading 1.2 percent copper and 1.28 percent zinc.

P R E V I O U S W O R K (C O N T ')

Additional diamond drilling in Cunningham Township by operators other than M.W. Resources Limited are listed below.

| <u>Year</u> | <u>Company</u> | <u>Claim</u> | <u>Number of DDH</u> | <u>Total Length (ft.)</u> |
|---------------|--|--|-----------------------------|--|
| 1923- 1929 | Ridout Cunningham Mines Limited | S57672 | ? | ? |
| 1952 | JE Derrough & Maneast Uranium Corp. Ltd. | S47671 S57672 | 1 4 | 423 1000 |
| 1953 | Page Harley Mines | S61030 S61132 S62785 | 7 1 1 | 2127 386 463 |
| 1954 | The American Metal Co. | S62655 S62505 S62503 S58597 | 1 2 1 1 | 203 850 386 559 |
| 1956 | J.E. Derraugh & Maneast Uranium Corp. Ltd. J.M. MacIntosh Mid-North Engineering Ltd. Maneast Uranium Corp. Ltd. | S57671 S57670 S57669 S76342 S90807 S61137 | 1 1 1 13 8 3 | 400 150 400 554 360 519 |
| 1959 | Rio Tinto Canadian Exp. Ltd. | S110814 | 2 | 817 |
| 1961 | The Anconda Company (Canada) Limited | S110481 | 1 | 227 |
| 1966 | The International Nickel Co. of Canada Ltd. | S131033 | 1 | 153 |
| 1971 | Dome Explor. (Canada) Ltd. | S292429 | 1 | 351 |
| 1973 | Dome Explor. (Canada) Ltd. | S292435 | 3 | 522 |
| 1975 | Cordilleran Engineering Ltd. | P422500 | 1 | 241 |

PREVIOUS WORK (CONT')

| <u>Year</u> | <u>Company</u> | <u>Claim</u> | <u>Number of DDH</u> | <u>Total Length (ft.)</u> |
|-------------|-------------------|--------------|----------------------|---------------------------|
| 1977 | Granges Explor. | P450703 | 1 | 180 |
| | AB (March) | P442947 | 1 | 208 |
| | Canadian Division | | | |

Siragusa, (1980)

GENERAL GEOLOGY

Cunningham & Swayze Townships lie within the Swayze Greenstone Belt, a part of the Archean mafic to intermediate, foliated metavolcanic rock sequence forming the Superior Province.

The Swayze volcanic complex consists of an east-west trending belt of metavolcanics and clastic metasediments.

The northern half of Cunningham Township is predominated by metamorphosed volcanic flows interpreted a high-magnesium tholeiitic basalt. The metavolcanics are locally pillowed, vesicular or amygdaloidal and rarely variolitic. Metamorphism rarely exceeds greenschist rank and primary features such as selvage margins of pillows may be found. Thin layers of dacitic crystal tuff occur in the upper section of the (assumedly) north-facing metavolcanic series.

During the development of the basaltic series cycles of chemical and clastic sedimentation occurred and resulted in the depositon of chert, iron formation, and epiclastic rocks in the middle and upper section of the series.

Closely associated (spatially) with the main chert units are relatively small bodies of feldspar porphyry.

Bands of epiclastic metasediments trending east-northeast, northeast and west are interbedded with the metavolcanics in the upper and central sections of the basaltic sequence.

Mafic intrusive rocks in bodies of irregular shape and variable size are spatially associated with the metavolcanics. These rocks vary in composition from diorite to gabbro.

GENERAL GEOLOGY (CONT')

Discrete intrusions of peridotite occur in southern Cunningham Township.

A small pluton of massive porphyritic quartz monzonite underlies parts of western and southwestern Cunningham Township.

Lamprophyre dikes rarely occur and cut the metavolcanics or gabbro at a few localities. The youngest rocks in the area are diabase dikes which cut the quartz monzonite. Siragusa, (1980).

PROPERTY GEOLOGY

The Yarwood Lake property is underlain by metamorphosed volcanic flows, which are probably high-magnesium tholeiitic basalts, chemical metasediments and mafic intrusive rocks of gabbroic composition.

The dark green metavolcanics are fine-grained and generally massive in character, although on the northeastern portion of the property they have been foliated. Pillowed, vesicular metavolcanics occur locally and primary features, notably selvage margins of pillows can be seen. The pillows tend to have irregular outlines making top determinations impossible. Several outcrops of porphyritic, massive metavolcanics were encountered in various locations on the property. Plagioclase phenocrysts were generally small, averaging an eighth of an inch in size. During field mapping it was practically impossible to trace these horizons across the property. However, it appears that they are flows rather than of intrusive origin. Altered and bleached metavolcanics occur in two areas of L20W-BL0 and L9W-16N. These rocks have been bleached to a lighter green in color and may be andesitic in composition. The metavolcanics contain minor disseminated pyrite and pyrrhotite with some zones containing from 2-4 percent. The metavolcanics weather grey to dark green.

Various cycles of chemical sedimentation have resulted in the deposition of chert iron formations. The chert units are laminated and occasionally medium-bedded. The chert is generally black in color, but grey, green and light brown chert was also seen.

The majority of the chert units were interbedded with iron rich (20-60 percent magnetite) layers. Small percentages (1-2 percent) of sulphide mineralization were seen in all of the chert units. Massive pyrite mineralization occurs in a chert iron formation trending northeast from L72W-IN to L682-5N. This zone appears to be approximately 50 feet

PROPERTY GEOLOGY (CONT')

wide. The actual extent of this massive sulphide zone could not be determined due to overburden cover. Previous work consisting of two trenches and a pit were seen at L72W-IN. Another trench had been excavated at L68W-5N. Chert outcrops weather black and are occasionally gossanous.

A gabbroic intrusive was found on the southeastern portion of the property. The gabbro is medium-grained and consists of basic plagioclase, hornblende and pyroxene. Negligible sulphide mineralization was seen in this rock type. Weathered surfaces are rough and have a distinct speckled, 'dioritic' appearance.

Barren quartz veins and stringers occur at random on the property. A mineralized quartz vein 1/2 to 1 foot wide, containing 2 percent pyrite mineralization was found at L68W-5N. The length of this vein could not be determined due to overburden cover.

There were no prominent structural features observed from the geological mapping of the property.

The disparity of widths of the iron formations suggests local flexuring or folding within the horizons.

CONCLUSIONS AND RECOMMENDATIONS

The bodies of iron formation are too low in iron content to be of value for iron. They consist primarily of chert with little magnetite. The existence of a zone of massive sulphide on claims 765704 and 765705 indicates that a possible base metal deposit may occur on the western portion of the property. The possibility of a gold-sulphide association suggests that further work is recommended.

Without resorting to extreme expenses to investigate the property, a minimal work program should include:

1. Further stripping and trenching on the quartz vein located at L68W-5N.
2. Lines spaced at 200 foot intervals should be cut on claims 765704 and 765705.
3. A magnetometer survey should be conducted over the entire property using the existing grid. This would delineate contacts and reveal the extent of the iron formations.
4. An electromagnetic survey should be conducted over the entire property using the existing grid and the grid cut on claims 765704 and 765705. Any tabular sulphide bodies should be delineated by this method.

Further exploratory work could be formulated based on the results of the above mentioned surveys.

R E F E R E N C E S

Siragusa, G.M.
1980, Cunningham Township Area, District of Sudbury, Ontario,
Geological Survey Prelim. Map P2339 Geological Ser., Scale
1:15840 or 1 inch to 1/4 mile. Geology 1978.

Thurston, P.C., Siragusa, G.M., and Sage, R.P.
1977, Geology of the Chapleau Area, Districts of Algoma,
Sudbury, and Cochrane; Ontario Div. Mines, G.R. 157,
293p. Accompanied by Maps 2351 and 2352, Scale 1:250,000,
and Map 2221, Scale 1 inch to 4 miles (1:253,440).

C E R T I F I C A T I O N

I, Don Hillier, B.Sc., of Timmins, Ontario, certify that:

1. I am a graduate of the University of British Columbia, Vancouver, B.C., with a B.Sc. degree in Geology obtained in 1981.
2. I have been practicing my profession in Canada since graduation.
3. I have no direct or indirect interest in the properties or securities of Ingamar Exploration Ltd. nor do I expect to receive any.

Dated at Timmins, Ontario
this 4th day of September, 1984.



DON HILLIER, B.Sc.

CENOZOIC

PLEISTOCENE AND RECENT

Till, sand, boulders, clay

UNCONFORMITY

MESOZOIC

?LATE JURASSIC TO EARLY CRETACEOUS

Lamprophyre dikes

INTRUSIVE CONTACT

PRECAMBRIAN

LATE PRECAMBRIAN

MAFIC TO INTERMEDIATE INTRUSIVE ROCKS¹Hornblende syenite, syenodiorite
and diorite, hornblende
monzonite, porphyritic
hornblende diorite, quartz
diorite, and gabbro, mafic
hornfelsCARBONATITE-ALKALIC COMPLEXES¹Alkalic syenite, pulaskite,
brecciated alkalic syenite,
fenitized rocks, massive mafic
nepheline syenite (malignite),
massive to foliated nepheline
syenite, sovite (calcite-rich
igneous rocks), magnetite-
apatite rock, urtites,
ijolites, melteigites
(nepheline-pyroxene rocks)

INTRUSIVE CONTACT

EARLY TO MIDDLE PRECAMBRIAN

MAFIC INTRUSIVE ROCKS

Diabase, quartz diabase,
granophyre

INTRUSIVE CONTACT

EARLY PRECAMBRIAN

SHAWMERE ANORTHOSITE COMPLEX

Anorthosite to gabbroic anorth-
osite, anorthositic gabbro
and gabbro, brecciated
anorthositic to gabbroic rocks,
gneissic to flaser-textured
tonalite and monzonite

INTRUSIVE CONTACT

KAPUSKASING STRUCTURAL ZONE ROCKS

Metamorphosed mafic to intermediate intrusive rocks, melanocratic granulite, pelitic and psammitic granulites, meta-sedimentary and metavolcanic gneiss (upper amphibolite facies), arkosic metasediments

FAULT CONTACT

FELSIC IGNEOUS AND METAMORPHIC ROCKS

Felsic Intrusive and Hybrid Rocks

Massive to gneissic, biotite and hornblende trondhjemite, granodiorite, quartz monzonite, and minor quartz diorite, syenitic rocks, pegmatite, aplite, augen gneiss, granodiorite to diorite (in part hybrid rocks), porphyritic 'granitic' rocks

INTRUSIVE OR GRADATIONAL CONTACT

Migmatitic Rocks

Migmatite with metavolcanic paleosome of quartz-feldspar-hornblende gneiss, migmatite with metasedimentary paleosome of biotite-quartz-feldspar gneiss

INTRUSIVE CONTACT

MAFIC TO ULTRAMAFIC INTRUSIVE ROCKS

Diorite, gabbro, ultramafic rocks and their serpentinized equivalents

INTRUSIVE CONTACT

METASEDIMENTS²

Greywacke, arkose, quartzite, conglomerate, argillaceous fine grained metasediments, biotite-quartz-feldspar schist and gneiss, migmatized metasediments, iron formation

METAVOLCANICS²

Felsic to Intermediate Metavolcanics

Rhyolite to dacite flows and fragmental rocks, tuff, lapilli-tuff, agglomerate, breccia, porphyritic flows, quartz-feldspar porphyry, iron formation

Mafic to Intermediate Metavolcanics

Basalt to andesite flows and porphyritic flows, pillow lava, mafic pyroclastic rocks, layered amphibolite, diorite, gabbro, migmatized mafic metavolcanics, iron formation

Notes

- 1 Relative ages unknown, radiometric ages equivalent; these units appear to be spatially associated with the Kapuskasing Structural Zone.
- 2 Age relationships among mafic metavolcanics, felsic metavolcanics and metasediments are variable.

Reference

from O.D.M. Geoscience Report 157, 1977.

AUDIT NUMBER

0251



Ministry of Natural Resources

Mining Claim

The Mining Act

CLAIM NO P-724418

| | | | |
|--|-------------------------------|-------------------------------|---------------------------------------|
| RECORDED IN THE NAME OF Rejean Roy | LICENCE NO. M-21130 | RECEIPT NO. H263377 | DATE RECORDED July 6, 1983. |
|--|-------------------------------|-------------------------------|---------------------------------------|

| | |
|---|---|
| ADDRESS C.P. 672, Barraute, Quebec. | DATE AND TIME OF STAKING June 17, 1983 at 8:00 A.M. |
|---|---|

| | | | | |
|--|-----------------|---------------|---------|--|
| ASSESSMENT WORK CREDITS ASSIGNED TO OTHER CLAIMS | OFFICE USE ONLY | DATE RECORDED | BALANCE | DESCRIPTION OF CLAIM CUNNINGHAM TOWNSHIP |
| | | | | RESERVATIONS — 400 FOOT SURFACE RIGHTS RESERVATION AROUND ALL LAKES AND RIVERS SAND AND GRAVEL RESERVED. PEAT RESERVED. Including Land Under Water |

FILE NO 724418

| DATE | DAYS WORK | | RECEIPT NO. |
|------------|-----------|---|------------------|
| Apr. 11/84 | | Transfer all interest to Ingamar Explorations Limited, T-836. | (#201/84) 381083 |
| July 13/84 | 40 | Geological. | (W.R.#292/84) |

This Abstract is a copy of the entries in the Record Book and is not to be considered as assurance of the validity of the claim.

SEP 24 1984

 Mining Recorder
 PORCUPINE MINING DIVISION

AUDIT NUMBER

300252



Ministry of Natural Resources

Mining Claim

The Mining Act

CLAIM NO.

P-724419

| | | | |
|---------------------------------------|------------------------|------------------------|--------------------------------|
| RECORDED IN THE NAME OF Rejean Roy | LICENCE NO. M-21130 | RECEIPT NO. H263377 | DATE RECORDED July 6, 1983. |
|---------------------------------------|------------------------|------------------------|--------------------------------|

| | |
|--|--|
| ADDRESS C.P. 672, Barraute, Quebec. | DATE AND TIME OF STAKING June 17, 1983 at 10:00 A.M. |
|--|--|

| ASSESSMENT WORK CREDITS ASSIGNED TO OTHER CLAIMS | OFFICE USE ONLY | DAYS RECORDED | BALANCE | DESCRIPTION OF CLAIM |
|--|-----------------|---------------|---------|----------------------|
| | | | | |

FILE NO.

724418

| DATE | DATE WORK | | RECEIPT NO. |
|------------|-----------|---|------------------|
| Apr. 11/84 | / | Transfer all interest to Ingamar Explorations Limited, T-836. | (#201/84) 381083 |
| July 13/84 | 40 | Geological | (W.R.#292/84) |

This Abstract is a copy of the entries in the Record Book and is not to be considered as assurance of the validity of the claim.

SEP 4 1984

Ministry of Natural Resources
PORCUPINE MINING DIVISION

AUDIT NUMBER

0253



Ministry of
Natural
Resources

Mining Claim

The Mining Act

CLAIM NO.

P-724420

| | | | |
|--|-------------------------------|-------------------------------|---------------------------------------|
| RECORDED IN THE NAME OF Rejean Roy | LICENCE NO. M-21130 | RECEIPT NO. H263377 | DATE RECORDED July 6, 1983. |
|--|-------------------------------|-------------------------------|---------------------------------------|

| | |
|---|---|
| ADDRESS C.P. 672, Barraute, Quebec. | DATE AND TIME OF STARTING June 17, 1983 at 12:00 Noon |
|---|---|

| ASSESSMENT WORK CREDITS ASSIGNED TO OTHER CLAIMS | OFFICE USE ONLY | DATE RECORDED | BALANCE | DESCRIPTION OF CLAIM |
|---|-----------------|------------------|---------|----------------------|
| | | | | |

FILE NO
724418

| DATE | DAYS WORK | | RECEIPT NO. |
|-------------------|--------------|---|-------------------------|
| Apr. 11/84 | - | Transfer all interest to Ingamar Explorations Limited, \$-836. | (#201/84) 381083 |
| July 13/84 | 40 | Geological. | (W.R.#292/84) |

This Abstract is a copy of the entries in the Record Book and is not to be considered as assurance of the validity of the claim.

EPD 4 1984
Chandler
Mining Records
PORCUPINE MINING DIVISION

AUDIT NUMBER

30254



Ministry of Natural Resources

Mining Claim

The Mining Act

CLAIM NO

P-724421

RECORDED IN THE NAME OF

Rejean Roy

LICENCE NO.

M-21130

RECEIPT NO.

H263377

DATE RECORDED

July 6, 1983.

ADDRESS

C.P. 672, Barraute, Quebec.

DATE AND TIME OF STAKING

June 17, 1983
at 2:00 P.M.

ASSESSMENT WORK CREDITS
ASSIGNED TO OTHER CLAIMS

OFFICE USE ONLY

DATE RECORDED

BALANCE

DESCRIPTION OF CLAIM

CUNNINGHAM TOWNSHIP

RESERVATIONS - 400 FOOT SURFACE RIGHTS RESERVATION AROUND ALL LAKES AND RIVERS
SAND AND GRAVEL RESERVED. PEAT RESERVED.

Including Land Under Water

FILE NO

724418

DATE

DAYS WORK

RECEIPT NO.

Apr. 11/84

/

Transfer all interest to Ingamar Explorations

Limited, T-836.

(#201/84)

381083

July 13/84

40

Geological.

(W.R.#292/84)

This Abstract is a copy of the entries in the
Record Book and is not to be considered as
assurance of the validity of the claim.

SEP 04 1984

PORCUPINE MINING DIVISION

AUDIT NUMBER

90255



Ministry of Natural Resources

Mining Claim

The Mining Act

CLAIM NO

P-724422

| | | | |
|--|------------------------|---|--------------------------------|
| RECORDED IN THE NAME OF Rejean Roy | LICENCE NO. M-21130 | RECEIPT NO. H263377 | DATE RECORDED July 6, 1983. |
| ADDRESS C.P. 672, Barraute, Quebec. | | DATE AND TIME OF STAKING June 17, 1983 at 4:00 P.M. | |

| | | | | |
|--|-----------------|---------------|---------|---|
| ASSESSMENT WORK CREDITS ASSIGNED TO OTHER CLAIMS | OFFICE USE ONLY | DAYS RECORDED | BALANCE | DESCRIPTION OF CLAIM |
| | | | | <p>CUNNINGHAM TOWNSHIP</p> <p>RESERVATIONS — 400 FOOT SURFACE RIGHTS RESERVATION AROUND ALL LAKES AND RIVERS SAND AND GRAVEL RESERVED. PEAT RESERVED.</p> <p>Including Land Under Water</p> |
| | | | | FILE NO. 724418 |

| DATE | DAYS WORK | | RECEIPT NO. |
|------------|-----------|---|------------------|
| Apr. 11/84 | | Transfer all interest to Ingamar Explorations Limited, #-836. | (#201/84) 381083 |
| July 13/84 | 40 | Geological | (W.R.#292/84) |

This Abstract is a copy of the entries in the Record Book and is not to be considered as assurance of the validity of the claim.

ADD 0 4 1984

[Signature]
Mining Recorder
PORCUPINE MINING DIVISION

AUDIT NUMBER

390256



Ministry of Natural Resources

Mining Claim

The Mining Act

CLAIM NO

P-724423 -

| | | | |
|--|-------------------------------|-------------------------------|---------------------------------------|
| RECORDED IN THE NAME OF Rejean Roy | LICENCE NO. M-21130 | RECEIPT NO. H263377 | DATE RECORDED July 6, 1983. |
|--|-------------------------------|-------------------------------|---------------------------------------|

| | |
|---|---|
| ADDRESS C.P. 672, Barraute, Quebec. | DATE AND TIME OF STAKING June 18, 1983 at 8:00 A.M. |
|---|---|

| OFFICE USE ONLY | DAYS RECORDED | BALANCE | DESCRIPTION OF CLAIM |
|--|---------------|---------|--|
| ASSESSMENT WORK CREDITS ASSIGNED TO OTHER CLAIMS | | | CUNNINGHAM TOWNSHIP |
| | | | RESERVATIONS — 400 FOOT SURFACE RIGHTS RESERVATION AROUND ALL LAKES AND RIVERS BAND AND GRAVEL RESERVED. PEAT RESERVED. Including Land Under Water |

FILE NO

724418

| DATE | DAYS WORK | | RECEIPT NO. |
|------------|-----------|---|-------------|
| Apr. 11/84 | | Transfer all interest to Ingamar Explorations Limited, T-836. (#201/84) | 381083 |
| July 13/84 | 40 | Geological. (W.R.#292/84) | |

This Abstract is a copy of the entries in the Record Book and is not to be considered as assurance of the validity of the claim.

SEP 04 1984

PORCUPINE MINING DIVISION

AUDIT NUMBER

300258



Ministry of
Natural
Resources

Mining Claim

The Mining Act

CLAIM NO.
P-765677 -

| | | | |
|---|-------------------------------|-------------------------------|--|
| RECORDED IN THE NAME OF Rejean Roy | LICENCE NO. M-21130 | RECEIPT NO. W263377 | DATE RECORDED July 6, 1983. |
| ADDRESS C.P. 672, Barraute, Quebec. | | | DATE AND TIME OF STAKING June 18, 1983 at 12:00 Noon |

| | | | | | |
|---|-----------------|------------------|---------|---|---------------------------|
| ASSESSMENT WORK CREDITS ASSIGNED TO OTHER CLAIMS | OFFICE USE ONLY | DAYS RECORDED | BALANCE | DESCRIPTION OF CLAIM CUNNINGHAM TOWNSHIP RESERVATIONS — 400 FOOT SURFACE RIGHTS RESERVATION AROUND ALL LAKES AND RIVERS. SAND AND GRAVEL RESERVED. PEAT RESERVED. | FILE NO. 724418 |
| | | | | | |

| DATE | DAYS WORK | | RECEIPT NO. |
|------------|--------------|---|-------------|
| Apr. 11/84 | ✓ | Transfer all interest to Ingamar Explorations Limited, T-836. (#201/84) | 381083 |
| July 13/84 | 40 | Geological... (W.R.#292/84) | |
| | | | |
| | | | |
| | | | |
| | | | |
| | | | |
| | | | |
| | | | |
| | | | |
| | | | |
| | | | |
| | | | |
| | | | |
| | | | |
| | | | |
| | | | |
| | | | |
| | | | |
| | | | |
| | | | |
| | | | |
| | | | |

This Abstract is a copy of the entries in the Record Book and is not to be considered as assurance of the validity of the claim.
 SEP 4 1984
Charles
 Mining Recorder
PORCUPINE MINING DIVISION

AUDIT NUMBER

0259



Ministry of
Natural
Resources

Mining Claim

The Mining Act

CLAIM NO
P-765678 -

| | | | |
|---------------------------------------|------------------------|------------------------|--------------------------------|
| RECORDED IN THE NAME OF Rejean Roy | LICENCE NO. M-21130 | RECEIPT NO. H263377 | DATE RECORDED July 6, 1983. |
|---------------------------------------|------------------------|------------------------|--------------------------------|

| | |
|--|---|
| ADDRESS C.P. 672, Barraute, Quebec. | DATE AND TIME OF STAKING June 18, 1983 at 2:00 p.m. |
|--|---|

| OFFICE USE ONLY | | DAYS RECORDED | BALANCE | DESCRIPTION OF CLAIM |
|---|--|---------------|---------|---|
| ASSESSMENT WORK CREDITS ASSIGNED TO OTHER CLAIMS | | | | CUNNINGHAM TOWNSHIP |
| | | | | RESERVATIONS — 400 FOOT SURFACE RIGHTS RESERVATION AROUND ALL LAKES AND RIVERS. SAND AND GRAVEL RESERVED. PEAT RESERVED. Including Land Under Water |

FILE NO
724418

| DATE | DAYS WORK | | RECEIPT NO. |
|------------|-----------|--|-------------|
| Apr. 11/84 | | Transfer all interest to Ingamar Explorations Limited, #-836. (#201/84) | 381083 |
| July 13/84 | 40 | Geological. (W.R.#292/84) | |

This Abstract is a copy of the entries in the Record Book and is not to be considered as assurance of the validity of the claim.

SEP 04 1984

PORCUPINE MINING DIVISION

AUDIT NUMBER
30260



Mining Claim
The Mining Act

CLAIM NO.
P-765679 -

| | | | |
|---|---|-------------------------------|---------------------------------------|
| RECORDED IN THE NAME OF Rejean Roy | LICENCE NO. M-21130 | RECEIPT NO. H263377 | DATE RECORDED July 6, 1983. |
| ADDRESS C.P. 672, Barraute, Quebec. | DATE AND TIME OF STAKING June 18, 1983 at 4:00 P.M. | | |

| | | | | |
|--|-----------------|---------------|---------|---|
| ASSESSMENT WORK CREDITS ASSIGNED TO OTHER CLAIMS | OFFICE USE ONLY | DAYS RECORDED | BALANCE | DESCRIPTION OF CLAIM CUNNINGHAM TOWNSHIP RESERVATIONS — 400 FOOT SURFACE RIGHTS RESERVATION AROUND ALL LAKES AND RIVERS SAND AND GRAVEL RESERVED. PEAT RESERVED. |
| | | | | FILE NO. 724418 |

| DATE | DAYS WORK | DESCRIPTION | RECEIPT NO. |
|------------|-----------|---|-------------|
| Apr. 11/84 | ' | Transfer all interest to Ingamar Explorations Limited, T-836. (#201/84) | 381083 |
| July 13/84 | 40- | Geological. (W.R.#292/84) | |

This Abstract is a copy of the entries in the Record Book and is not to be considered as assurance of the validity of the claim.

SEP 4 1984
[Signature]
Mining Recorder
PORCUPINE MINING DIVISION

AUDIT NUMBER
 80261



Ministry of
 Natural
 Resources

Mining Claim

The Mining Act

CLAIM NO.
 P-765703

| | | | |
|---|-------------------------------|--|---------------------------------------|
| RECORDED IN THE NAME OF Rejean Roy | LICENCE NO. M-21130 | RECEIPT NO. H263377 | DATE RECORDED July 6, 1983. |
| ADDRESS C.P. 672, Barraute, Quebec. | | DATE AND TIME OF STAKING June 19, 1983 at 10:00 A.M. | |

| ASSESSMENT WORK CREDITS ASSIGNED TO OTHER CLAIMS | OFFICE USE ONLY | DAYS RECORDED | BALANCE | DESCRIPTION OF CLAIM |
|---|-----------------|------------------|---------|--|
| | | | | CUNNINGHAM TOWNSHIP <small>RESERVATIONS — 400 FOOT SURFACE RIGHTS RESERVATION AROUND ALL LAKES AND RIVERS. SAND AND GRAVEL RESERVED. PEAT RESERVED.</small> |
| | | | | FILE NO 724418 |

| DATE | DAYS WORK | | RECEIPT NO. |
|--|--------------|--|-------------|
| Apr. 11/84 | / | Transfer all interest to Ingamar Explorations Limited, T-836. (#201/84) | 381083 |
| July 13/84 | 40 | Geological. (W.R.#292/84) | |
| This Abstract is a copy of the entries in the Record Book and is not to be considered as assurance of the validity of the claim. SEP 04 1984 <i>(Signature)</i> Mining Recorder PORCUPINE MINING DIVISION | | | |

AMOUNT NUMBER
390263



Ministry of
 Natural
 Resources

Mining Claim

The Mining Act

CLAIM NO.
P-765705

RECORDED IN THE NAME OF **Rejean Roy** LICENCE NO. **M-21130** RECEIPT NO. **H263377** DATE RECORDED **July 6, 1983**

ADDRESS **C.P. 672, Barraute, Quebec.** DATE AND TIME OF STAKING **June 19, 1983 at 2:00 P.M.**

| ASSESSMENT WORK CREDITS ASSIGNED TO OTHER CLAIMS | OFFICE USE ONLY | DAYS RECORDED | BALANCE | DESCRIPTION OF CLAIM |
|---|-----------------|------------------|---------|----------------------|
| | | | | |

| DATE | DAYS WORK | | RECEIPT NO. |
|-------------------|--------------|--|------------------------|
| Apr. 11/84 | 1 | Transfer all interest to Ingamar Explorations Limited, T-836. | (#201/84) 38108 |
| July 13/84 | 40 | Geological | (W.R.#292/84) |

This Abstract is a copy of the entries in the Record Book and is not to be considered as assurance of the validity of the claim.

[Signature]
 Mining Recorder
PORCUPINE MINING DIVISION



410155E0079 2.7205 SWAYZE

900

Mining Lands Section

File No 2.7205

Control Sheet

TYPE OF SURVEY

- GEOPHYSICAL
- GEOLOGICAL
- GEOCHEMICAL
- EXPENDITURE

MINING LANDS COMMENTS:

gd. L.D.

S. Hunt
Signature of Assessor

84-10-12
Date

1984 11 08

Your File: 292-84
Our File: 2.7205

Mining Recorder
Ministry of Natural Resources
60 Wilson Avenue
Timmins, Ontario
P4N 2S7

Dear Sir:

RE: Notice of Intent dated October 22, 1984.
Geological Survey on Mining Claims P 724418
et al in Cunningham and Swayze Townships.

The assessment work credits, as listed with the
above-mentioned Notice of Intent, have been approved
as of the above date.

Please inform the recorded holder of these mining
claims and so indicate on your records.

Yours sincerely,

S.E. Yundt
Director
Land Management Branch

Whitney Block, Room 6643
Queen's Park
Toronto, Ontario
M7A 1W3
Phone:(416)965-6918

S. Hurst:sc

cc: Ingamar Explorations Ltd
Cedar Hill
Connaught, Ontario
P0N 1A0

cc: Mr. G.H. Ferguson
Mining & Lands Commissioner
Toronto, Ontario

cc: Resident Geologist
Timmins, Ontario

**Technical Assessment
 Work Credits**

File
 2.7205

Date
 1984 10 22

Mining Recorder's Report of
 Work No. 292-84

Recorded Holder
 INGAMAR EXPLORATIONS LTD

Township or Area
 CUNNINGHAM AND SWAYZE TOWNSHIPS

| Type of survey and number of Assessment days credit per claim | Mining Claims Assessed |
|--|--|
| Geophysical Electromagnetic _____ days Magnetometer _____ days Radiometric _____ days Induced polarization _____ days Other _____ days Section 77 (19) See "Mining Claims Assessed" column Geological _____ 40 _____ days Geochemical _____ days Man days <input type="checkbox"/> Airborne <input type="checkbox"/> Special provision <input checked="" type="checkbox"/> Ground <input checked="" type="checkbox"/> <input type="checkbox"/> Credits have been reduced because of partial coverage of claims. <input type="checkbox"/> Credits have been reduced because of corrections to work dates and figures of applicant. | P 724422-23 765676-77-79-80 765703-04-05 |

Special credits under section 77 (16) for the following mining claims

| | |
|--|--------------------------------------|
| <u>30 DAYS CREDIT</u> P 724418-19 765678 | <u>20 DAYS CREDIT</u> P 724420-21 |
|--|--------------------------------------|

No credits have been allowed for the following mining claims

not sufficiently covered by the survey
 insufficient technical data filed

The Mining Recorder may reduce the above credits if necessary in order that the total number of approved assessment days recorded on each claim does not exceed the maximum allowed as follows: Geophysical — 80; Geological — 40; Geochemical — 40; Section 77 (19)—60:



Nov 6/84

1984 10 22

Your File: 292-84
Our File: 2.7205

Mining Recorder
Ministry of Natural Resources
60 Wilson Avenue
Timmins, Ontario
P4N 2S7

Dear Sir:

Enclosed are two copies of a Notice of Intent with statements listing a reduced rate of assessment work credits to be allowed for a technical survey. Please forward one copy to the recorded holder of the claims and retain the other. In approximately fifteen days from the above date, a final letter of approval of these credits will be sent to you. On receipt of the approval letter, you may then change the work entries on the claim record sheets.

For further information, if required, please contact Mr. R.J. Pichette at 416/965-4888.

Yours sincerely,

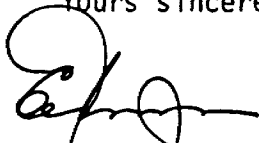
S.E. Yundt
Director
Land Management Branch

Whitney Block, Room 6643
Queen's Park
Toronto, Ontario
M7A 1W3

R2 S. Hurst:mc

Encls.

cc: Ingamar Explorations Ltd
Cedar Hill
Connaught, Ontario
PON 1A0

cc: Mr. G.H. Ferguson
Mining & Lands Commissioner
Toronto, Ontario



Ministry of
Natural
Resources

Ontario

Notice of Intent
for Technical Reports

1984 10 22

2.7205/292-84

An examination of your survey report indicates that the requirements of The Ontario Mining Act have not been fully met to warrant maximum assessment work credits. This notice is merely a warning that you will not be allowed the number of assessment work days credits that you expected and also that in approximately 15 days from the above date, the mining recorder will be authorized to change the entries on his record sheets to agree with the enclosed statement. Please note that until such time as the recorder actually changes the entry on the record sheet, the status of the claim remains unchanged.

If you are of the opinion that these changes by the mining recorder will jeopardize your claims, you may during the next fifteen days apply to the Mining and Lands Commissioner for an extension of time. Abstracts should be sent with your application.

If the reduced rate of credits does not jeopardize the status of the claims then you need not seek relief from the Mining and Lands Commissioner and this Notice of Intent may be disregarded.

If your survey was submitted and assessed under the "Special Provision-Performance and Coverage" method and you are of the opinion that a re-appraisal under the "Man-days" method would result in the approval of a greater number of days credit per claim, you may, within the said fifteen day period, submit assessment work breakdowns listing the employees names, addresses and the dates and hours they worked. The new work breakdowns should be submitted direct to the Land Management Branch, Toronto. The report will be re-assessed and a new statement of credits based on actual days worked will be issued.

W.K. #292184

Mining Act 27205

Instructions: - Please type or print. - If number of mining claims traversed exceeds space on this form, attach a list. Note: - Only days credits calculated in the "Expenditures" section may be entered in the "Expend. Days Cr." columns. - Do not use shaded areas below.

Sept 11/84

Type of Survey(s): **GEOLOGY + LINECUTTING**

Claim Holder(s): **INGAMAR EXPLORATIONS LIMITED**

Address: **LEBAR HILL CONNAUGHT ONT PONI A 0**

Survey Company: **INGAMAR EXPLORATIONS LIMITED**

Name and Address of Author (of Geo-Technical report): **KEVIN F. H. 322 HARTST TIMMINS ONT**

Date of Survey (from & to): **06. 84. 05 07 84.**

Total Miles of line Cut: **14 MILES**

Inspector: **CUNNINGHAM & SWAYZE**

Projector: **T B 36**

| Special Provisions | Geophysical | Days per Claim |
|---|-------------------|----------------|
| For first survey: Enter 40 days. (This includes line cutting) | - Electromagnetic | |
| | - Magnetometer | |
| | - Radiometric | |
| For each additional survey: using the same grid: Enter 20 days (for each) | - Other | |
| | Geological | 40 |
| | Geochemical | |

| Man Days | Geophysical | Days per Claim |
|---|-------------------|----------------|
| Complete reverse side and enter total(s) here | - Electromagnetic | |
| | - Magnetometer | |
| | - Radiometric | |
| | - Other | |
| | Geological | |
| | Geochemical | |

| Airborne Credits | Geophysical | Days per Claim |
|--|-------------------|----------------|
| Note: Special provisions credits do not apply to Airborne Surveys. | - Electromagnetic | |
| | - Magnetometer | |
| | - Radiometric | |

| Mining Claims Traversed (List in numerical sequence) | | | Mining Claims Traversed (List in numerical sequence) | | |
|--|--------|------------------|--|--------|------------------|
| Prefix | Number | Expend. Days Cr. | Prefix | Number | Expend. Days Cr. |
| P | 724418 | | | | |
| | 724419 | | | | |
| | 724420 | | | | |
| | 724421 | | | | |
| | 724422 | | | | |
| | 724423 | | | | |
| | 765676 | | | | |
| | 765677 | | | | |
| | 765678 | | | | |
| | 765679 | | | | |
| | 765680 | | | | |
| | 765703 | | | | |
| | 765704 | | | | |
| | 765705 | | | | |

RECEIVED
JUL 30 1984
MINING LANDS SECTION

RECORDED
JUL 13 1984
Receipt No. **JD**

RECEIVED
JUL 13 1984
A.M. 7:18 P.M. 11:12 1:23 4:56

Total number of mining claims covered by this report of work. **14**

Expenditures (excludes power stripping)

Type of Work Performed:

Performed on Claim(s):

Calculation of Expenditure Days Credits

Total Expenditures \$ ÷ 15 = Total Days Credits

Instructions: Total Days Credits may be apportioned at the claim holder's choice. Enter number of days credits per claim selected in columns at right.

For Office Use Only

| | | |
|-------------------------|---------------------------|-----------------|
| Total Days Cr. Recorded | Date Recorded | Mining Recorder |
| 560 | July 13, 1984 | <i>Stanley</i> |
| | Date Approved as Recorded | Branch Director |
| | See Revised Statement | <i>Stanley</i> |

Date: **July 12/84**

Recorded by or Agent (Signature): *Hubbard*

Certification Verifying Report of Work

I hereby certify that I have a personal and intimate knowledge of the facts set forth in the Report of Work annexed hereto, having performed the work or witnessed same during and/or after its completion and the annexed report is true.

Name and Postal Address of Person Certifying: **MARIE HUBBARD CEDAR HILL CONNAUGHT ONT PONI A 0**

Date Certified: **JULY 12, 1984**

Certified by (Signature): *Hubbard*

October 9, 1984

File: 2.7205

Ingamar Explorations Ltd
Cedar Hill
Connaught, Ontario
PUN 1A0

Dear Sir:

RE: Geological Survey submitted on
Mining Claims P 724418 et al
in Cunningham and Swayze Townships

With reference to the above-described submission,
our letter of October 1, 1984 incorrectly acknowledged
receipt of reports and maps. The reports only have
been received. Please submit the appropriate maps,
in duplicate, quoting file 2.7205.

For further information, please contact Susan Hurst
at (416)965-4888.

Yours sincerely,

S.E. Yundt
Director
Land Management Branch

Whitney Block, Room 6643
Queen's Park
Toronto, Ontario
M7A 1W3
Phone: (416)965-4888

S. Hurst:mc

cc: Mining Recorder
Timmins, Ontario



INGAMAR EXPLORATIONS LIMITED

CEDAR HILL CONNAUGHT, ONTARIO P0N 1A0
TEL. (705) 433-3551 or (705) 264-3100
TELEX 067-81502

October 3, 1984

Mr. Fred Matthews, Director
Ministry of Natural Resources
Land Management Branch
Whiney Block, Room 6450
Queen's Park
TORONTO, Ontario
M7A 1W3

RECEIVED
OCT 11 1984
MINERAL RESOURCES SECTION

SUBJECT: YARWOOD LAKE PROPERTY - 14 claims
P724418 et al

Enclosed herewith are two copies of the Geological Report, also copies of the maps and two copies of the Work Report on the above property. Since forwarding to your office we noted that there was an error on the first Geological Report that was sent to you on September 28, 1984.

Sorry for any inconvenience this error may have caused. Thank you for your consideration.

Sincerely,
INGAMAR EXPLORATIONS LIMITED

Irma Hibbard, Vice President
IH/ab
Enc.

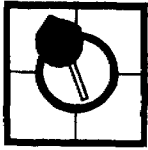

INGAMAR EXPLORATIONS LIMITED

September 10, 1984
CEDAR HILL CONNAUGHT, ONTARIO P0N 1A0
TEL. (705) 433-3551 or (705) 264-3100
TELEX 067-81502

Mr. Fred Matthews, Director
Ministry of Natural Resources
Land Management Branch
Whitney Block, Room 6450
Queen's Park
Toronto, Ontario
M7A 1W3

SUBJECT: YARWOOD LAKE PROPERTY - 13 claims
P-724418 et al.

Dear Sir:

Enclosed are two copies of the Geological Report on the above property. Also enclosed are two copies of the work report. We have not included the maps as we are waiting to receive them from the printers and expect to forward them in a day or two.

Thank you.

Sincerely,
INGAMAR EXPLORATIONS LIMITED

Irma Hibbard
Irma Hibbard, Vice-President
Enc.
IH/ab

*Known in this
Report AKB*

*Received
September 10 1984*

1984 10 01

Your File: 292
Our File: 2.7205

Mining Recorder
Ministry of Natural Resources
60 Wilson Avenue
Timmins, Ontario
P4N 2S7

Dear Sir:

We received reports and maps on September 20, 1984 for a Geological Survey submitted under Special Provisions (credit for Performance and Coverage) on Mining Claims P 724418 et al in the Townships of Cunningham and Swayze.

This material will be examined and assessed and a statement of assessment work credits will be issued.

Yours sincerely,

S.E. Yundt
Director
Land Management Branch

Whitney Block, Room 6643
Queen's Park
Toronto, Ontario
M7A 1W3
Phone: (416)965-6918

A.Barr:sc

cc: Ingamar Explorations Limited
Cedar Hill
Connaught, Ontario
P0N 1A0
Attn: Maurice Hibbard

144

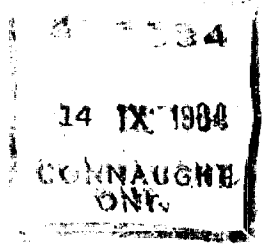
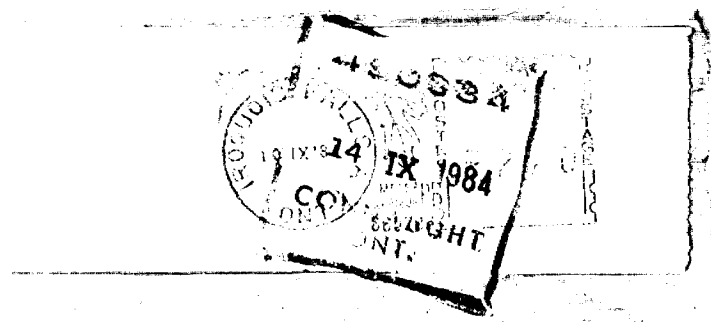
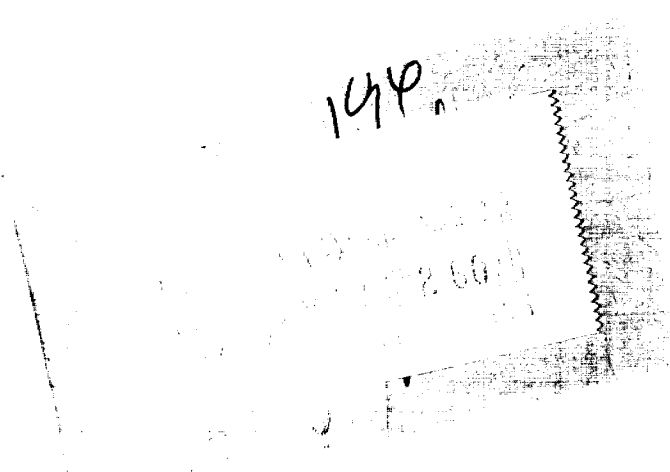

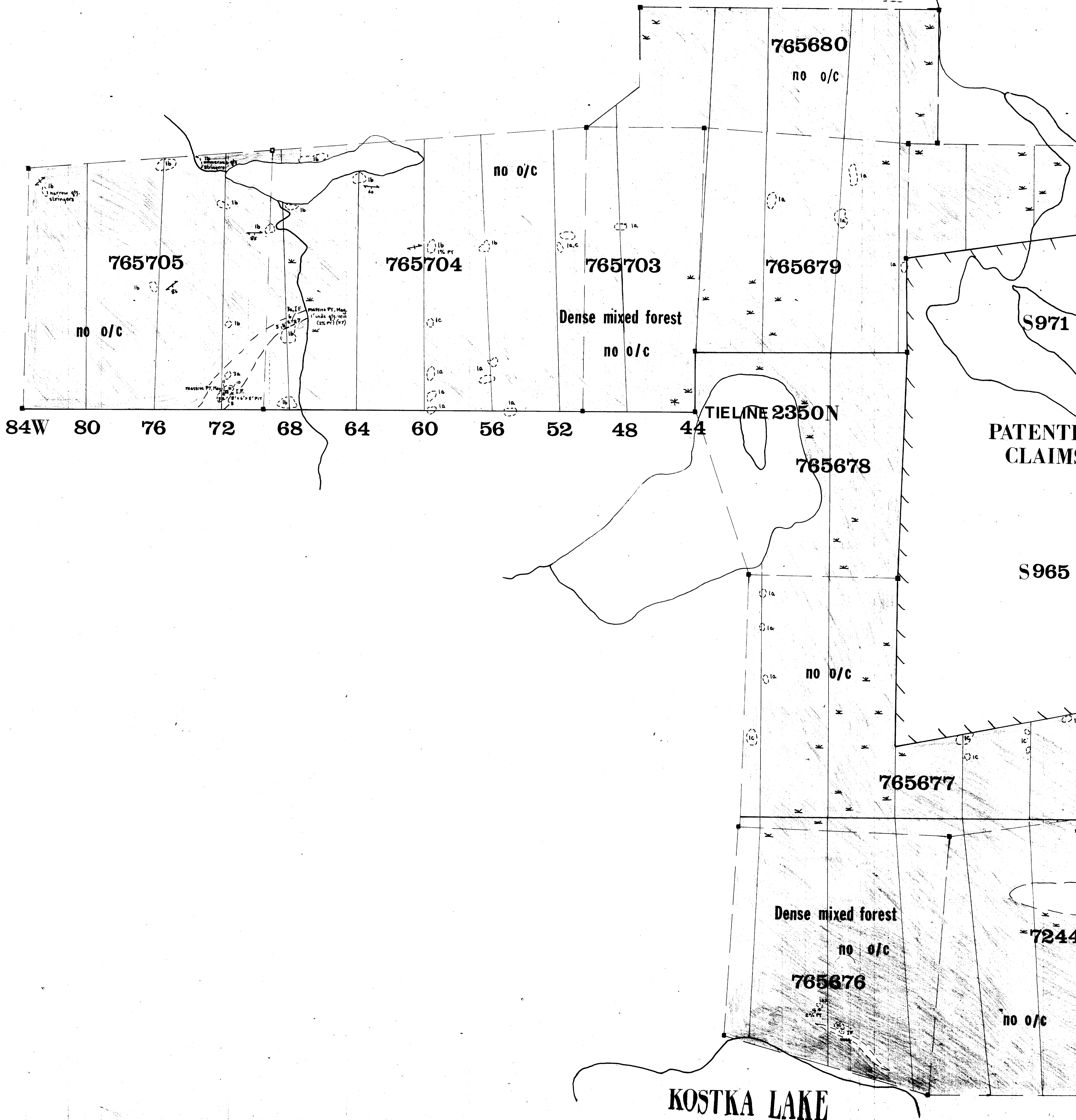

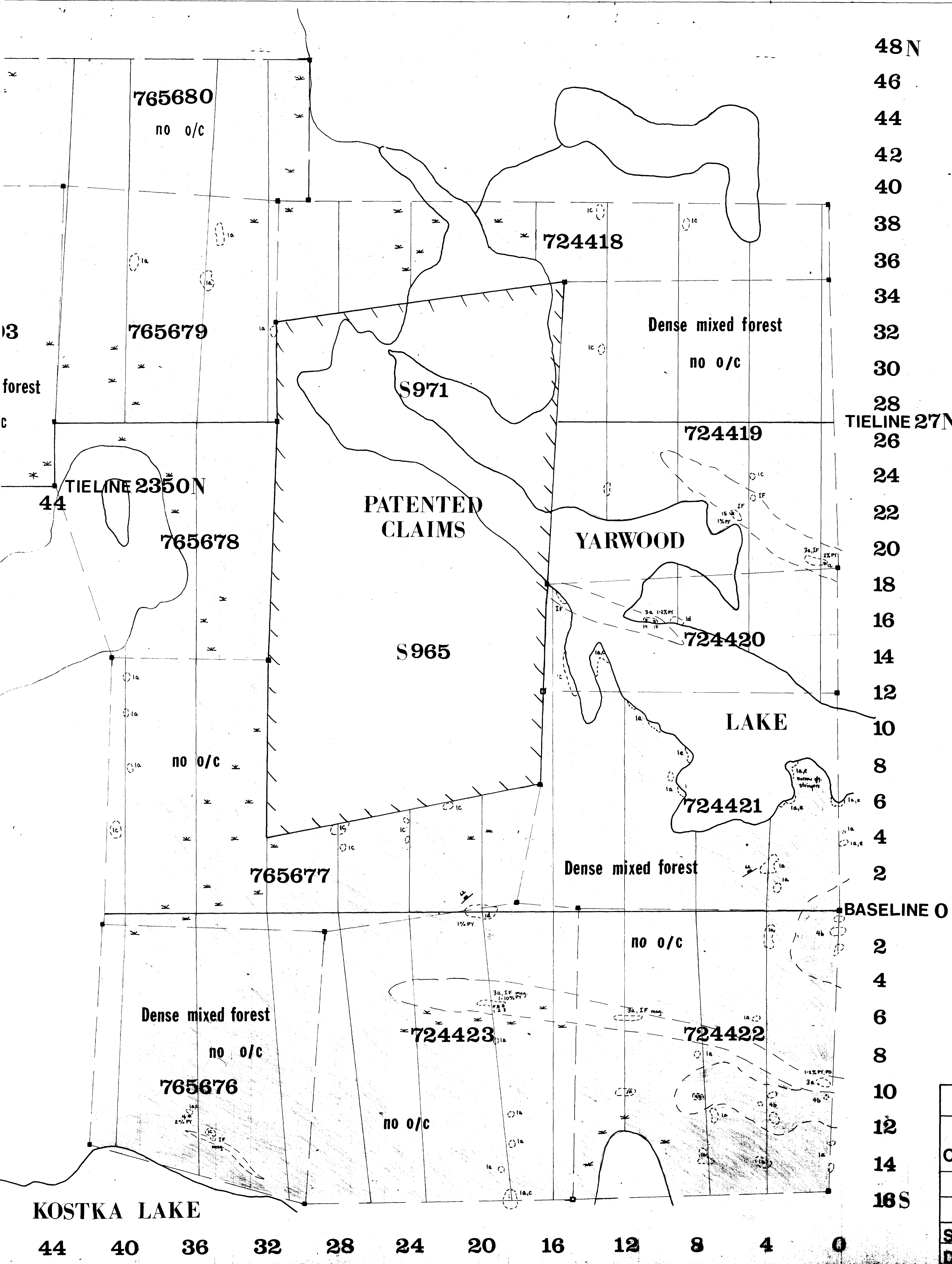

48N
46
44
42
40
38
36
34
32
30
28
TIE LINE 27N
26
24
22
20
18
16
14
12
10
8
6
4
2
BASELINE 0
2
4
6
8
10
12
14
16S

LEGEND

- EARLY PRECAMBRIAN (ARCHEAN)
- METAMORPHOSED MAFIC INTRUSIVE ROCKS
 - 4a Gabbro
- METASEDIMENTS
 - Chemical Metasediments
 - 3a Black orange grey chert
 - Iron Formation
 - IF Magnetite-rich laminae or beds interbedded with 3a
- METAVOLCANICS
 - Mafic to Intermediate
 - 1a Massive
 - 1b Foliated
 - 1c Porphyritic
 - 1d Altered and bleached
 - 1e Pillowed

SYMBOLS

- Area of bedrock outcrop
- Geological boundary
- Foliation (inclined, vertical)
- Jointing (inclined)
- no o/c No outcrop encountered
- Swamp, muskeg
- Located claim post
- Unlocated claim post
- Pyrite
- Pyrrhotite
- Magnetite
- *b Sample location, number

Don Miller

| | |
|--|---------------|
| INGAMAR EXPLORATIONS | |
| YARWOOD LAKE PROPERTY CUNNINGHAM & SWAYZE TOWNSHIPS | |
| GEOLOGY 27205 | |
| Scale: 1"=200' | Project: 84-6 |
| Drawn: D. Miller | Date: Aug. 84 |

KOSTKA LAKE

44 40 36 32 28 24 20 16 12 8 4 0