



41015SW0003 2.10574 RANEY

010

BRIEF REPORT  
on the  
Lithogeochemical Sampling Program  
on the Raney Lake Property  
for  
GOLDROCK RESOURCES INC.  
by  
Robert K. Abernethy, B.A.Sc.  
November, 1987

**RECEIVED**

NOV 25 1987

**MINING LANDS SECTION**

Fifty-nine rock samples were collected on the Raney Lake Property by geologists Tom Guoth and Mark Henrich between October 15 and October 18, 1987. The sampling program was conducted to confirm gold values and delineate enriched zones in the two known gold showings (Darke, 1986), and to test other alteration zones originally outlined by Cairn and Coster (1984). Samples were sent to Chemex Labs Ltd. of Mississauga Ontario for analysis. Analyses included fire assay with an atomic absorption finish on 20 grams of sample for gold and a 32 element geochemical package involving a nitric-aqua regia digestion followed by ICP element detection.

Twelve samples were taken from the zone denoted by Cairn and Coster as Area 1 (L5+00W, L3+00N) and eleven samples were taken from the zone denoted as Area 2 (L7+00W, L1+50N). All but two samples taken from Area 1 returned highly anomalous gold values including one sample which contained 3280 ppb Au and another which contained 1150 ppb Au. All samples taken from Area 2 returned anomalous gold values including one sample which contained greater than the 10,000 ppb Au detection limit and another sample contained 1225 ppb. Samples enriched in gold also tended to show minor, erratic enrichment in lead, molybdenum and arsenic.

All other samples contained background Au values and no noteworthy enrichment in trace elements except for sample 119128

which contained greater than 10.000 ppm (1%) zinc.

The laboratory report and sample location map are included in the appendix of this report.

Respectfully submitted

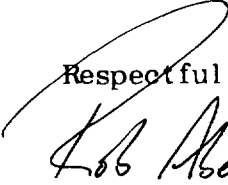

*Robert K. Abernethy*

Robert K. Abernethy, B.A.Sc.

REFERENCES

CAIRA. N. and COSTER. I.  
1984

Geology Reports (2): J-Dex Property.  
Raney Township, Ontario. Accompanied  
by Geol. maps.

DARKE. KENNETH H.  
1986

Preliminary Exploration Report on the  
J-Dex Raney Gold Property Raney  
Township, Ontario. Swayze Gold Area  
for Goldrock Resources Inc. and Glen  
Auden Resources Limited.

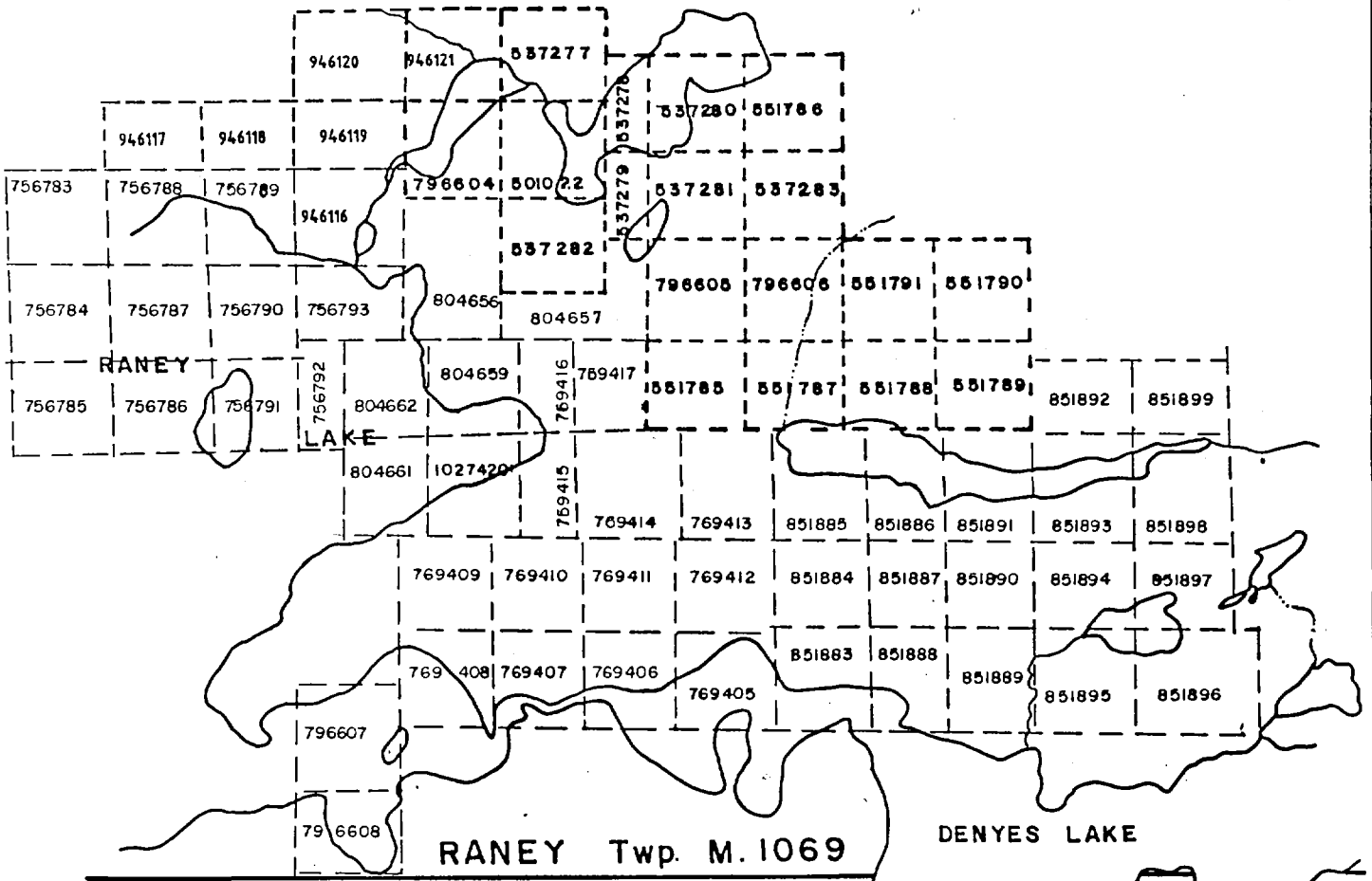

RANEY Twp. M. 1069

DENYES Twp. M. 758

DENYES LAKE

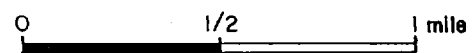

REVISIONS	KENNETH H. DARKE Consultants Limited		
	for	J-DEX RANEY	
	Title	CLAIM INDEX MAP	
	Date	June 1986	Scale: 1" = 1/2 mi. N.T.S.:
	Drawn:	C.G.	Approved:
			File:

FIG. 2

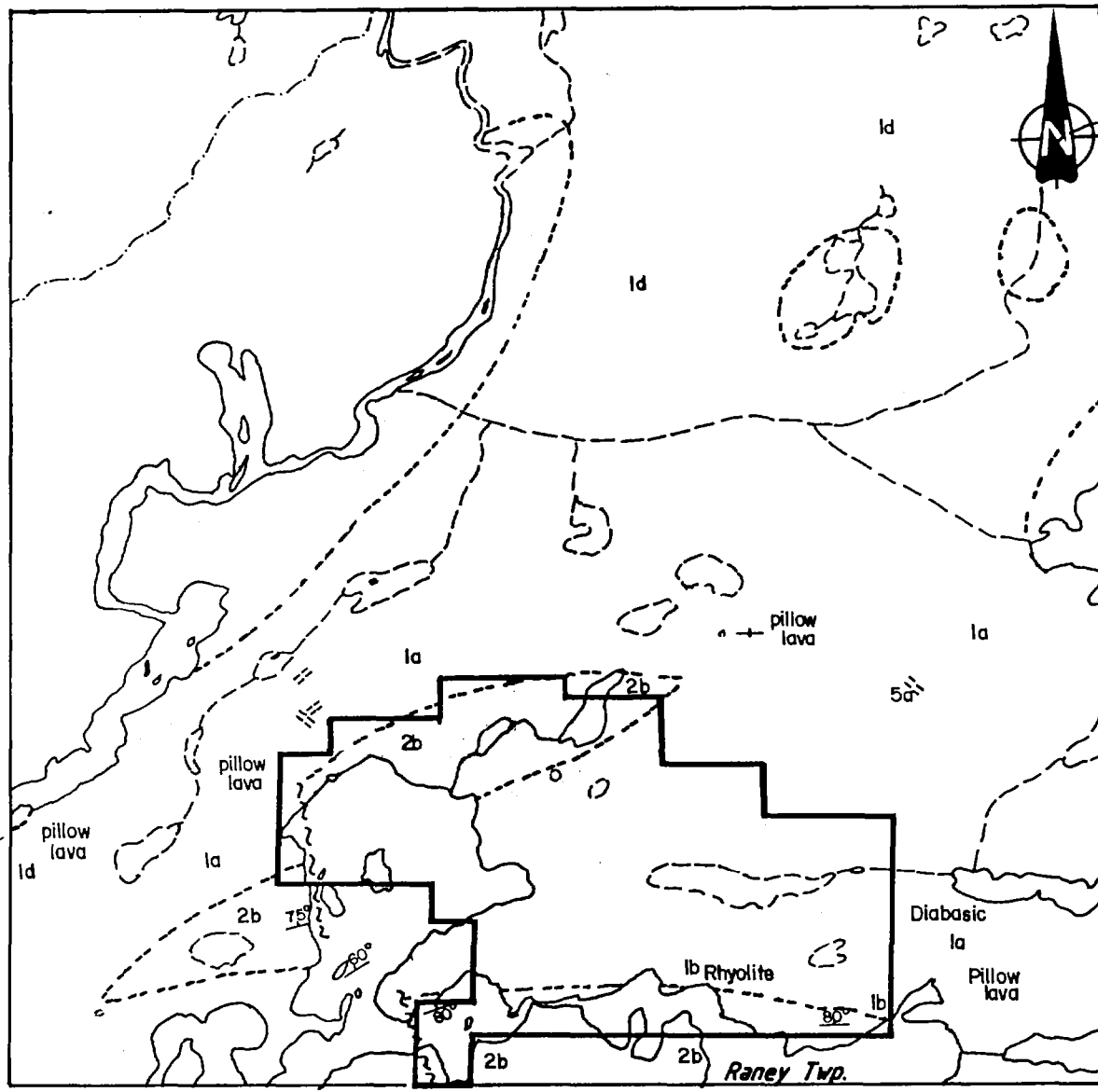

**LEGEND**

- 5a Quartz diabase, Olivine Diabase
- 2b Greywacke, quartzite, slate
- 1d Hornblende and chlorite schists
- 1b Rhyolite, dacite
- 1a Acid to basic lavas including basalt, andesite, gabbro, diabase

REVISIONS	KENNETH H. DARKE Consultants Limited	
	for J-DEX RANEY	
	Title	FIG. 3
	REGIONAL GEOLOGY MAP	
	From Map No. 43b	H.C. RICKABY in Vol. XLIII, Part 3
	Date JUNE 1986	Scale: 1"=1 mile N.T.S.
	Drawn: C.G.	Approved: File

A P P E N D I X



# Chemex Labs Ltd.

Analytical Chemists • Geochemists • Registered Assayers  
450 MATHESON BLVD., E., UNIT 54, MISSISSAUGA,  
ONTARIO, CANADA L4Z-1R5  
PHONE (416) 890-0310

JIDDLETON, ILLINOIS EXHIBITATION SERVICE  
136 CEDAR ST. SOUTH  
TIMMINS, ONT.  
P4N 7W8  
Project: M-69  
Comments: ATTN: HAROLD BENT

Page No. 1-A  
Total Pages: 2  
Date: 9-NOV-87  
Invoice #: I-8725103  
P.O. #

## CERTIFICATE OF ANALYSIS A8725103

SAMPLE DESCRIPTION	PREP CODE	Au ppb FA+AA	Al %	Ag ppm	As ppm	Ba ppm	Bc ppm	Bi ppm	Ca %	Cd ppm	Co ppm	Cr ppm	Cu ppm	Fe %	Ga ppm	Hg ppm	K %	La ppm	Mg %	Mn ppm
A22301	248 238	< 5	0.43	< 0.2	< 5	60	< 0.5	< 2	0.75	< 0.5	7	1	5	1.71	< 10	< 1	0.06	10	0.25	317
A22302	248 238	10	0.28	< 0.2	10	30	< 0.5	< 2	0.27	< 0.5	10	1	4	1.71	< 10	< 1	0.05	10	0.05	527
A22303	248 238	< 5	0.36	< 0.2	5	40	0.5	< 2	0.21	< 0.5	10	< 1	12	1.88	< 10	< 1	0.08	10	0.03	511
A22304	248 238	< 5	1.21	< 0.2	< 5	20	< 0.5	< 2	0.19	< 0.5	7	2	28	2.52	< 10	< 1	0.09	10	0.37	329
A22305	248 238	< 5	1.88	< 0.2	5	10	< 0.5	< 2	4.84	< 0.5	40	< 1	40	8.39	< 10	< 1	0.02	< 10	1.20	2890
A22306	248 238	< 5	2.57	0.2	25	60	0.5	2	1.61	< 0.5	27	4	38	5.44	< 10	< 1	0.21	< 10	0.80	1065
A22307	248 238	< 5	2.25	< 0.2	30	10	1.5	< 2	4.24	< 0.5	27	< 1	3	7.34	< 10	< 1	0.03	< 10	1.66	1710
A22308	248 238	< 5	1.04	< 0.2	< 5	50	< 0.5	< 2	1.13	< 0.5	10	14	8	1.91	< 10	1	0.14	10	0.68	283
A22309	248 238	10	0.84	< 0.2	< 5	50	0.5	< 2	2.18	< 0.5	10	8	1	1.84	< 10	< 1	0.17	< 10	0.72	302
A22310	248 238	115	0.54	< 0.2	< 5	60	0.5	< 2	2.29	< 0.5	8	2	2	1.54	< 10	< 1	0.16	< 10	0.71	296
A22311	248 238	>10000	0.24	2.0	5	20	< 0.5	< 2	1.27	< 0.5	3	3	20	0.36	< 10	< 1	0.08	< 10	0.12	95
A22312	248 238	60	0.62	< 0.2	< 5	50	< 0.5	< 2	2.11	< 0.5	7	3	1	1.50	< 10	< 1	0.16	< 10	0.88	287
A22313	248 238	140	0.56	< 0.2	5	60	< 0.5	< 2	0.13	< 0.5	8	3	2	1.61	< 10	< 1	0.13	< 10	0.10	242
A22314	248 238	5	0.59	< 0.2	< 5	30	< 0.5	< 2	3.76	< 0.5	7	5	1	1.46	< 10	1	0.13	< 10	0.73	325
A22315	248 238	25	0.76	< 0.2	< 5	70	< 0.5	< 2	2.09	< 0.5	8	4	2	1.60	< 10	< 1	0.25	< 10	0.87	274
A22316	248 238	1225	0.33	2.2	< 5	40	< 0.5	2	1.94	0.5	4	1	7	0.99	< 10	< 1	0.13	< 10	0.39	172
A22317	248 238	45	0.79	< 0.2	< 5	60	< 0.5	< 2	1.77	< 0.5	8	9	1	1.50	< 10	< 1	0.20	< 10	0.80	249
A22318	248 238	35	0.89	< 0.2	< 5	80	< 0.5	< 2	1.45	< 0.5	7	7	2	1.52	< 10	< 1	0.15	< 10	0.66	375
A22319	248 238	25	1.42	< 0.2	< 5	70	0.5	< 2	1.03	< 0.5	11	14	14	1.86	< 10	< 1	0.16	< 10	0.75	321
A22320	248 238	< 5	0.89	< 0.2	< 5	60	< 0.5	< 2	1.24	< 0.5	8	7	1	1.58	< 10	< 1	0.11	< 10	0.76	234
A22321	248 238	3280	0.77	1.8	20	30	< 0.5	< 2	3.75	< 0.5	8	10	7	1.74	< 10	< 1	0.10	< 10	0.65	409
A22322	248 238	385	0.94	< 0.2	10	130	< 0.5	< 2	1.67	< 0.5	5	< 1	4	1.71	< 10	< 1	0.42	< 10	0.52	221
A22323	248 238	625	1.18	< 0.2	< 5	10	< 0.5	< 2	3.19	< 0.5	10	14	12	2.08	< 10	< 1	0.05	< 10	0.99	378
A22324	248 238	200	1.07	< 0.2	< 5	70	< 0.5	< 2	2.17	< 0.5	9	4	7	1.76	< 10	< 1	0.23	< 10	0.71	285
A22325	248 238	80	1.72	< 0.2	10	70	< 0.5	< 2	1.32	< 0.5	17	19	28	3.31	< 10	< 1	0.23	< 10	1.09	409
A22326	248 238	< 5	1.46	< 0.2	< 5	60	< 0.5	< 2	1.36	< 0.5	11	12	15	2.33	< 10	< 1	0.23	< 10	0.84	418
A22327	248 238	500	0.18	0.6	< 5	< 10	< 0.5	< 2	2.79	< 0.5	< 1	2	3	0.35	< 10	< 1	0.01	< 10	0.13	197
A22328	248 238	115	0.26	< 0.2	< 5	10	< 0.5	< 2	4.18	< 0.5	< 1	2	2	0.38	< 10	< 1	0.05	< 10	0.16	284
A22329	248 238	30	1.02	< 0.2	5	30	< 0.5	< 2	6.82	< 0.5	7	6	15	1.48	< 10	< 1	0.15	< 10	0.65	466
A22330	248 238	1150	1.98	0.2	5	70	< 0.5	< 2	1.75	< 0.5	18	21	34	3.21	< 10	< 1	0.29	< 10	1.21	381
A22331	248 238	160	2.01	< 0.2	10	50	< 0.5	< 2	2.05	< 0.5	10	18	24	3.38	< 10	< 1	0.23	< 10	1.33	421
A22332	248 238	< 5	0.41	0.2	< 5	10	< 0.5	< 2	1.48	< 0.5	< 1	14	4	0.59	< 10	< 1	0.02	< 10	0.22	185
A22333	248 238	< 5	0.15	< 0.2	< 5	10	< 0.5	< 2	2.31	< 0.5	< 1	2	5	0.67	< 10	< 1	0.01	< 10	0.09	741
A22334	248 238	5	5.11	0.2	75	30	< 0.5	< 2	2.25	< 0.5	42	180	145	11.90	< 10	< 1	0.02	< 10	2.97	1425
A22335	248 238	10	4.14	< 0.2	15	10	< 0.5	< 2	5.46	< 0.5	35	165	114	6.16	< 10	< 1	0.01	< 10	2.92	914
A22336	248 238	5	4.18	< 0.2	15	20	< 0.5	< 2	4.21	< 0.5	41	161	121	8.74	< 10	< 1	0.01	< 10	3.30	1495
A22337	248 238	< 5	4.90	< 0.2	< 5	10	< 0.5	< 2	2.86	< 0.5	44	61	100	8.48	< 10	< 1	< 0.01	< 10	3.56	1240
A22338	248 238	< 5	3.93	0.2	15	< 10	< 0.5	< 2	3.52	< 0.5	40	198	106	7.12	< 10	< 1	< 0.01	< 10	2.75	1265
A22339	248 238	< 5	5.16	< 0.2	< 5	50	< 0.5	< 2	2.38	< 0.5	45	174	122	9.44	< 10	< 1	0.05	< 10	2.79	2050
A22340	248 238	< 5	2.79	< 0.2	25	20	< 0.5	< 2	4.99	< 0.5	34	118	98	6.69	< 10	< 1	0.07	< 10	2.73	1075

CERTIFICATION :





**Chemex Labs Ltd.**  
Analytical Chemists • Geochemists • Registered Assayers  
450 MATHESON BLVD, E., UNIT 54, MISSISSAUGA,  
ONTARIO, CANADA L4Z-1R5  
PHONE (416) 890-0310

**ADD IN, EX WTC ERVI**  
136 CEDAR ST. SOUTH  
TIMMINS, ON  
P4N 7W8  
Project: M-69  
Comments: ATTN: HAROLD BENT

**Page: 2**  
Date: 9-NOV-87  
Invoice #: I-8725103  
P.O. #

**CERTIFICATE OF ANALYSIS A8725103**

SAMPLE DESCRIPTION	PREP CODE	Mb ppm	Na %	Ni ppm	P ppm	Pb ppm	Sb ppm	Se ppm	Sr ppm	Ti %	Tl ppm	U ppm	V ppm	W ppm	Zn ppm
A22301	248 238	< 1	0.06	14	370	< 2	< 5	< 10	29	< 0.01	< 10	< 10	3	< 5	64
A22302	248 238	< 1	0.05	10	400	< 2	< 5	< 10	16	< 0.01	< 10	< 10	3	< 5	76
A22303	248 238	< 1	0.06	18	440	< 2	< 5	< 10	21	< 0.01	< 10	< 10	2	< 5	115
A22304	248 238	< 1	0.05	12	280	< 2	< 5	< 10	17	< 0.01	< 10	< 10	8	< 5	69
A22305	248 238	< 1	0.03	8	470	6	5	< 10	84	< 0.01	< 10	< 10	99	< 5	126
A22306	248 238	< 1	0.02	57	840	< 2	< 5	< 10	26	0.58	< 10	< 10	63	< 5	115
A22307	248 238	< 1	0.02	4	530	< 2	< 5	< 10	89	< 0.01	< 10	< 10	102	< 5	92
A22308	248 238	< 1	0.05	23	450	< 2	< 5	< 10	41	< 0.01	< 10	< 10	11	< 5	60
A22309	248 238	< 1	0.04	21	450	< 2	< 5	< 10	96	< 0.01	< 10	< 10	6	< 5	55
A22310	248 238	< 1	0.03	18	440	< 2	< 5	< 10	94	< 0.01	< 10	< 10	3	< 5	42
A22311	248 238	< 1	0.02	10	150	6	< 5	< 10	51	< 0.01	< 10	< 10	1	< 5	11
A22312	248 238	< 1	0.04	15	430	< 2	< 5	< 10	110	< 0.01	< 10	< 10	5	< 5	43
A22313	248 238	< 1	0.03	20	470	< 2	< 5	< 10	13	< 0.01	< 10	< 10	6	< 5	33
A22314	248 238	< 1	0.03	19	400	< 2	< 5	< 10	181	< 0.01	< 10	< 10	6	< 5	40
A22315	248 238	< 1	0.04	21	460	< 2	< 5	< 10	126	< 0.01	< 10	< 10	6	< 5	38
A22316	248 238	< 1	0.02	11	180	178	< 5	< 10	121	< 0.01	< 10	< 10	2	< 5	268
A22317	248 238	< 1	0.05	17	370	< 2	< 5	< 10	96	< 0.01	< 10	< 10	6	< 5	52
A22318	248 238	< 1	0.08	17	400	< 2	< 5	< 10	64	< 0.01	< 10	< 10	7	< 5	45
A22319	248 238	< 1	0.09	27	470	< 2	< 5	< 10	70	< 0.01	< 10	< 10	10	< 5	63
A22320	248 238	< 1	0.07	18	370	< 2	< 5	< 10	68	< 0.01	< 10	< 10	7	< 5	41
A22321	248 238	34	0.03	16	310	4	< 5	< 10	315	< 0.01	< 10	< 10	10	< 5	23
A22322	248 238	65	0.02	8	460	< 2	< 5	< 10	126	< 0.01	< 10	< 10	9	< 5	35
A22323	248 238	1	0.04	15	340	2	< 5	< 10	278	< 0.01	< 10	< 10	24	< 5	43
A22324	248 238	< 1	0.02	16	390	< 2	< 5	< 10	170	< 0.01	< 10	< 10	9	< 5	56
A22325	248 238	< 1	0.02	31	630	2	< 5	< 10	112	< 0.01	< 10	< 10	23	< 5	82
A22326	248 238	< 1	0.04	23	490	< 2	< 5	< 10	86	< 0.01	< 10	< 10	19	< 5	51
A22327	248 238	13	0.01	4	70	344	< 5	< 10	224	< 0.01	< 10	< 10	1	< 5	26
A22328	248 238	< 1	0.01	5	130	42	< 5	< 10	346	< 0.01	< 10	< 10	2	< 5	18
A22329	248 238	< 1	0.03	12	350	22	< 5	< 10	492	< 0.01	< 10	< 10	12	< 5	46
A22330	248 238	< 1	0.03	32	630	4	< 5	< 10	126	< 0.01	< 10	< 10	28	< 5	81
A22331	248 238	< 1	0.03	29	580	< 2	< 5	< 10	137	< 0.01	< 10	< 10	25	< 5	93
A22332	248 238	< 1	0.02	25	190	6	< 5	< 10	80	< 0.01	< 10	< 10	4	< 5	14
A22333	248 238	< 1	0.01	4	120	< 2	< 5	< 10	46	< 0.01	< 10	< 10	6	< 5	9
A22334	248 238	< 1	0.03	82	260	< 2	5	< 10	17	< 0.01	< 10	< 10	247	< 5	162
A22335	248 238	< 1	0.04	92	250	< 2	5	< 10	104	< 0.01	< 10	< 10	172	< 5	97
A22336	248 238	< 1	0.04	76	260	< 2	< 5	< 10	23	< 0.01	< 10	< 10	192	< 5	99
A22337	248 238	< 1	0.01	66	290	< 2	5	< 10	37	0.01	< 10	< 10	293	< 5	97
A22338	248 238	< 1	0.01	100	230	2	< 5	< 10	25	0.46	< 10	< 10	203	< 5	75
A22339	248 238	< 1	0.01	99	270	< 2	< 5	< 10	13	< 0.01	< 10	< 10	166	< 5	113
A22340	248 238	< 1	0.03	72	230	< 2	< 5	< 10	19	< 0.01	< 10	< 10	103	< 5	88

CERTIFICATION : *[Signature]*



**Chemex Labs Ltd.**  
Analytical Chemists • Geochemists • Registered Assayers  
450 MATHESON BLVD., E., UNIT 54, MISSISSAUGA,  
ONTARIO, CANADA L4Z-1R5

PHONE (416) 890-0310

To: MIDDLETON, R.S. EXPLORATION SERVICES

136 CEDAR ST. SOUTH  
TIMMINS, ON  
P4N 7W8

Project: M-69  
Comments: ATTN: HAROLD BENT

\*\*Page No.: 2-A  
Tot. Pages: 2  
Date: 9-NOV-87  
Invoice #: I-8725103  
P.O. #:

**CERTIFICATE OF ANALYSIS A8725103**

SAMPLE DESCRIPTION	PREP CODE	Au ppb Pt+AA	Al %	Ag ppm	As ppm	Ba ppm	Bc ppm	Bi ppm	Ca %	Cd ppm	Co ppm	Cr ppm	Cu ppm	Fe %	Ga ppm	Hg ppm	K %	La ppm	Mg %	Mn ppm
A22341	248 238	< 5	2.60	0.2	40	10	< 0.5	< 2	6.19	< 0.5	45	141	97	6.61	< 10	1	0.02	< 10	3.86	1245
A22342	248 238	< 5	2.33	0.2	5	60	< 0.5	< 2	2.03	< 0.5	49	23	124	4.75	< 10	< 1	0.11	< 10	1.46	579
A22343	248 238	< 5	2.47	0.2	< 5	50	< 0.5	< 2	1.72	< 0.5	48	28	126	5.03	< 10	< 1	0.10	< 10	1.56	594
A22344	248 238	< 5	2.33	0.2	10	100	< 0.5	< 2	1.87	< 0.5	41	< 1	63	4.59	< 10	1	0.13	< 10	1.56	666
A22345	248 238	< 5	2.31	0.2	< 5	50	< 0.5	< 2	2.37	< 0.5	41	< 1	52	4.70	< 10	< 1	0.06	< 10	1.43	721
A22347	248 238	< 5	3.37	0.2	10	10	< 0.5	< 2	2.17	< 0.5	46	< 1	55	6.38	< 10	< 1	< 0.01	< 10	2.39	987
A22348	248 238	< 5	2.75	0.2	< 5	20	< 0.5	< 2	1.48	< 0.5	35	25	46	5.39	< 10	< 1	< 0.01	< 10	1.73	1035
A22349	248 238	< 5	2.06	0.2	< 5	20	< 0.5	< 2	1.64	< 0.5	34	22	54	4.27	< 10	< 1	0.01	< 10	1.18	714
A22350	248 238	< 5	2.51	0.2	< 5	10	< 0.5	< 2	1.35	< 0.5	37	14	96	5.51	< 10	< 1	0.01	< 10	1.46	1170
119126	248 238	< 5	2.57	0.2	10	10	< 0.5	< 2	0.35	< 0.5	12	28	67	7.83	< 10	< 1	0.05	< 10	2.52	638
119127	248 238	< 5	2.35	0.2	15	< 10	< 0.5	< 2	1.05	< 0.5	37	27	86	5.21	< 10	< 1	0.01	< 10	1.88	766
119128	248 238	< 5	0.82	0.2	10	30	< 0.5	< 2	0.14	32.0	16	3	95	9.88	< 10	< 1	0.12	10	0.54	326
119129	248 238	< 5	0.31	0.2	5	< 10	< 0.5	< 2	5.58	< 0.5	24	< 1	128	6.04	< 10	< 1	0.01	< 10	0.28	689
119130	248 238	< 5	2.41	0.2	5	20	< 0.5	< 2	1.68	< 0.5	39	14	87	5.32	< 10	< 1	0.01	< 10	1.41	1145
119131	248 238	< 5	2.41	0.2	< 5	20	< 0.5	< 2	1.13	< 0.5	33	23	61	5.11	< 10	1	0.01	< 10	1.54	939
119132	248 238	< 5	2.32	0.2	< 5	20	< 0.5	< 2	1.17	< 0.5	38	20	64	4.99	< 10	1	0.01	< 10	1.55	843
119133	248 238	< 5	3.01	0.2	15	10	< 0.5	< 2	2.41	< 0.5	34	14	92	5.82	< 10	< 1	< 0.01	< 10	1.65	1320
119134	248 238	< 5	0.34	0.6	< 5	< 10	< 0.5	< 2	8.74	< 0.5	7	< 1	142	5.73	< 10	< 1	< 0.01	< 10	0.29	975
119135	248 238	< 5	1.69	0.2	< 5	10	< 0.5	< 2	0.61	< 0.5	26	24	60	6.19	< 10	< 1	0.04	< 10	1.64	552

CERTIFICATION: *[Signature]*



**chemex Labs Ltd.**  
 Analytical Chemists • Geochemists • Registered Assayers  
 450 MATTHESON BLVD. E., UNIT 54, MISSISSAUGA,  
 ONTARIO, CANADA L4Z-1R5  
 PHONE (416) 890-0310

136 CEDAR ST. SOUTH  
 TIMMINS, ON  
 P4N 7W8

Project: MF-69  
 Comments: ATTN: HAROLD BENT

**CERTIFICATE OF ANALYSIS A8725103**

\*\* No. 10  
 Tot. Pages: 2  
 Date: 9-NOV-87  
 Invoice #: I-8725103  
 P.O. #

SAMPLE DESCRIPTION	PREP CODE	Mo ppm	Na %	Ni ppm	P ppm	Pb ppm	Sb ppm	Se ppm	Sr ppm	Ti %	Tl ppm	U ppm	V ppm	W ppm	Zn ppm
A22341	248 238	< 1	0.09	164	240	< 2	< 5	< 10	34	< 0.01	< 10	< 10	103	5	68
A22342	248 238	< 1	0.03	48	500	< 2	< 5	< 10	13	0.64	< 10	< 10	217	< 5	99
A22343	248 238	< 1	0.04	46	530	< 2	< 5	< 10	12	0.72	< 10	< 10	258	< 5	120
A22344	248 238	< 1	0.02	25	620	< 2	< 5	< 10	11	0.57	< 10	< 10	200	< 5	151
A22345	248 238	< 1	0.03	18	700	2	< 5	< 10	13	0.57	< 10	< 10	229	< 5	129
A22347	248 238	< 1	0.02	28	560	< 2	< 5	< 10	21	0.69	< 10	< 10	408	< 5	129
A22348	248 238	< 1	0.03	36	470	< 2	< 5	< 10	14	0.76	< 10	< 10	215	< 5	89
A22349	248 238	< 1	0.03	38	440	< 2	< 5	< 10	26	0.70	< 10	< 10	187	< 5	74
A22350	248 238	< 1	0.03	37	400	< 2	< 5	< 10	12	0.73	< 10	< 10	237	< 5	79
119126	248 238	< 1	0.03	10	490	< 2	< 5	< 10	7	0.34	< 10	< 10	314	< 5	85
119127	248 238	< 1	0.04	39	420	< 2	5	< 10	9	0.69	< 10	< 10	273	< 5	86
119128	248 238	< 1	0.02	41	250	< 2	< 5	< 10	3	< 0.01	< 10	< 10	32	< 5	> 10000
119129	248 238	< 1	0.01	22	110	< 2	5	< 10	85	0.02	< 10	< 10	23	< 5	286
119130	248 238	< 1	0.02	36	390	< 2	< 5	< 10	14	0.63	< 10	< 10	226	< 5	115
119131	248 238	< 1	0.03	33	460	< 2	< 5	< 10	14	0.72	< 10	< 10	218	< 5	77
119132	248 238	< 1	0.03	36	400	2	< 5	< 10	23	0.68	< 10	< 10	206	< 5	100
119133	248 238	< 1	0.02	32	370	< 2	< 5	< 10	31	0.63	< 10	< 10	259	< 5	94
119134	248 238	< 1	< 0.01	26	100	4	< 5	< 10	129	0.01	< 10	< 10	21	< 5	26
119135	248 238	< 1	0.04	26	410	< 2	< 5	< 10	7	0.20	< 10	< 10	187	< 5	49

CERTIFICATION :

*[Handwritten signature]*



# Chemex Labs Ltd.

Analytical Chemists \* Geochemists \* Registered Assayers  
212 BROOKSBANK AVE., NORTH VANCOUVER,  
BRITISH COLUMBIA, CANADA V7J-2C1

PHONE (604) 984-0221

MID [TO] [S. I] [FOR] [DN] [VIC] [\*\*]

136 CEDAR ST. SOUTH  
TIMMINS, ON  
P4N 7W8

\* INVOICE NUMBER 18725103 \*

### BILLING INFORMATION

Date : 9-NOV-87  
Project : M-69  
P.O. # :  
Account : FSD

Billing : For analysis performed on  
Certificate A8725103

Terms : Net payment in 30 Days  
1.5% per month (18% per annum)  
charged on overdue accounts.

Please remit payments to:

CHEMEX LABS LTD.  
212 Brooksbank Ave.,  
North Vancouver, B.C.  
Canada V7J-2C1

CHEMEX CODE	ANALYSIS DESCRIPTION	SAMPLES ANALYZED	UNIT PRICE	AMOUNT
982	Au ppb			
921	AI			
922	Ag			
923	As			
924	Ba			
925	Bc			
926	Bi			
927	Ca			
928	Cd			
929	Co			
930	Cr			
931	Cu			
932	Fe			
933	Ga			
934	Hg			
935	K			
936	La			
937	Mg			
938	Mn			
939	Mo			
940	Na			
941	Ni			
942	P			
943	Pb			
944	Sb			
945	Se			
946	Sr			
947	Ti			
948	Tl			
949	U			
950	V			
	W			
	Zn	59	14.50	855.50
Sample preparation and other charges :				
248	Rock prep - Zr rings	59	3.50	206.50
238	ICP aqua-regia digestion	59	0.00	0.00
Total Cost \$				1062.00
TOTAL PAYABLE \$				1062.00

*Approved S.C.D. Nadeau*



Ministry of  
Northern Development  
and Mines



41015SW0003 2.10574 RANEY

900

Ontario

Ministère du  
Développement du Nord  
et des Mines

February 5, 1988

Your File: 320/87  
Our file: 2.10574

Mining Recorder  
Ministry of Northern Development and Mines  
60 Wilson Avenue  
Timmins, Ontario  
P4N 2S7

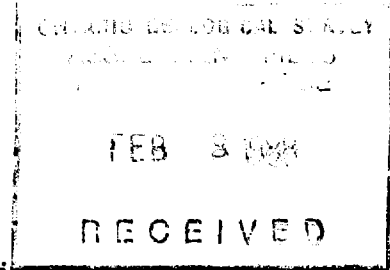

Dear Sir:

RE: Notice of Intent dated January 21, 1988  
Data for Assaying submitted on Mining Claims  
P 769409 et al in the Township of Raney

The assessment work credits, as listed with the above-mentioned Notice of Intent, have been approved as of the above date.

Please inform the recorded holder of these mining claims and so indicate on your records.

Yours sincerely,

W.R. Cowan, Manager  
Mining Lands Section  
Mines and Minerals Division

Whitney Block, Room 6610  
Queen's Park  
Toronto, Ontario  
M7A 1W3

Telephone: (416) 965-4888

SH:p1  
Enclosure: Technical Assessment Work Credits

cc: Mr. G.H. Ferguson  
Mining & Lands Commissioner  
Toronto, Ontario

Resident Geologist  
Timmins, Ontario

Goldrock Resources Inc.  
P.O. Box 1637  
Timmins, Ontario  
P4N 7W8



Ontario

File 2.10574

Date January 21, 1988

Mining Recorder's Report of Work No. 320/87

Recorded Holder Goldrock Resources Inc.

Township ~~XXXX~~ Raney Township

Type of survey and number of Assessment days credit per claim	Mining Claims Assessed
<b>Geophysical</b> Electromagnetic _____ days Magnetometer _____ days Radiometric _____ days Induced polarization _____ days Other _____ days  Section 77 (19) See "Mining Claims Assessed" column  <b>Geological</b> _____ days  <b>Geochemical</b> _____ days  Man days <input type="checkbox"/> Airborne <input type="checkbox"/>  Special provision <input type="checkbox"/> Ground <input type="checkbox"/>  <input type="checkbox"/> Credits have been reduced because of partial coverage of claims. <input type="checkbox"/> Credits have been reduced because of corrections to work dates and figures of applicant.	<p>\$1,062.00 SPENT ON ASSAYING SAMPLES TAKEN FROM MINING CLAIMS:</p> <p>P 501022            537282            769404-06-09            804656-57</p> <p>70.8 days credit allowed which may be grouped in accordance with Section 76(6) of the Mining Act R.S.O. 1980</p>

Special credits under section 77 (16) for the following mining claims

No credits have been allowed for the following mining claims

not sufficiently covered by the survey       insufficient technical data filed

Assay costs only are an allowable expense under Section 77(19).

The Mining Recorder may reduce the above credits if necessary in order that the total number of approved assessment days recorded on each claim does not exceed the maximum allowed as follows: Geophysical - 80; Geological - 40; Geochemical - 40; Section 77(19) - 60.



Ministry of Northern Development and Mines

Report of Work  
(Geophysical, Geological, Geochemical and Expenditures)

- Instructions: - Please type or print.  
- If number of mining claims traversed exceeds space on this form, attach a list.  
Note: - Only days credits calculated in the "Expenditures" section may be entered in the "Expend. Days Cr." columns.  
- Do not use shaded areas below.

#320/87  
Mining Act 2.10574

Type of Survey(s) <b>LITHOGEOCHEMICAL SURVEY</b>	Township or Area <b>RANEY TWP</b>
Claim Holder(s) <b>GOLDROCK RESOURCES INC.</b>	Prospector's Licence No. <b>T-4715</b>
Address <b>P.O. Box 1637, TIMMINS, ONTARIO, P4N 7W8</b>	
Survey Company <b>ROBERT S. MIDDLETON EXPLORATION SERVICES INC.</b>	Date of Survey (from & to) Day Mo. Yr. <b>14 10 87</b> Day Mo. Yr. <b>18 10 87</b>
Total Miles of line Cut <b>NONE</b>	
Name and Address of Author (of Geo-Technical report) <b>ROBERT ABERNETHY, 136 CEDAR SOUTH, TIMMINS, ON. P4N 7W8</b>	

Credits Requested per Each Claim in Columns at right

Special Provisions	Geophysical	Days per Claim
For first survey: Enter 40 days (This includes line setting)	- Electromagnetic Magnetometer	
For each additional survey: using the same grid: Enter 20 days (for each)	- Radiometric Geological Geochemical	

Man Days

Complete reverse side and enter total(s) here	Geophysical	Days per Claim
	- Electromagnetic Magnetometer	
	- Radiometric Geological Geochemical	

Airborne Credits

Note: Special provisions credits do not apply to Airborne Surveys.	Geophysical	Days per Claim
	- Electromagnetic Magnetometer	
	- Radiometric Geological Geochemical	

Mining Claims Traversed (List in numerical sequence)

Prefix	Mining Claim Number	Expend. Days Cr.
P	769409	20
	769412	20
	769416	29.3
	851888	5
	851894	5
	851895	5
	851897	5
	804656	18.3
	804657	18.3
	804659	29.3
	905890	20
	905891	20
	905892	20
	905893	20
	905894	20
	905895	20
	905896	20
	1027420	10

Expenditures (excludes power stripping)

Type of Work Performed  
**LITHOGEOCHEMICAL SURVEY (ASSAYING)**

Performed on Claim(s) **769409, 769406, 501022, 796604, 537282 & 804656, 804657**

Calculation of Expenditure Days Credits

Total Expenditures **\$ 4,594.16** ÷ Total Days Credits **15** = **306.3**

Instructions  
Total Days Credits may be apportioned at the claim holder's choice. Enter number of days credits per claim selected in columns at right.

**RECORDED**  
**NOV 19 1987**

Total number of mining claims covered by this report of work. **18**

For Office Use Only

Total Days Cr. Recorded <b>305.2</b>	Date Recorded <b>Nov. 19/87</b>	Mining Recorder <i>[Signature]</i>
Date Approved <b>Nov. 18/87</b>	Date Recorded	Branch Director

Date **Nov. 18/87** Recorder Holder or Agent (Signature) *[Signature]*

Certification Verifying Report of Work

I hereby certify that I have a personal and intimate knowledge of the facts set forth in the Report of Work annexed hereto, having performed the work or witnessed same during and/or after its completion and the annexed report is true.

Name and Postal Address of Person Certifying  
**ROBERT ABERNETHY, % RSMES, 136 CEDAR SOUTH, TIMMINS, ON. P4N 7W8**

Date Certified **Nov 18 / 1987** Certified by (Signature) *[Signature]*

AREAS WITHDRAWN FROM DISPOSITION

- M.R.O. - MINING RIGHTS ONLY
- S.R.O. - SURFACE RIGHTS ONLY
- M.+S. - MINING AND SURFACE RIGHTS

Description Order No. Date Disposition File

*SMA  
SA+MA withdrawn from status  
NAK 8/86 cancelled*

HELLYER TWP.

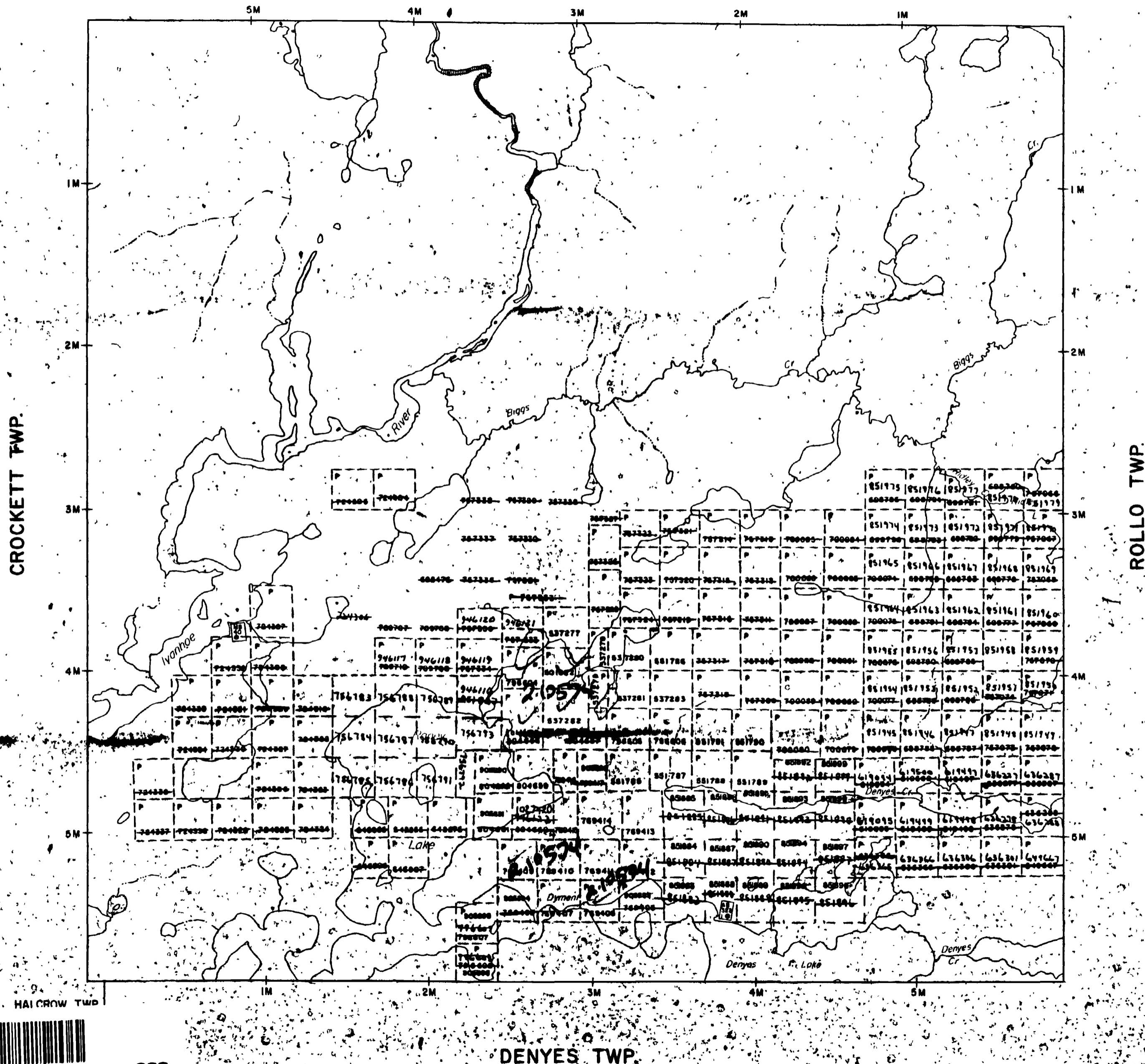

LEGEND

- HIGHWAY AND ROUTE No.
- OTHER ROADS
- TRAILS
- SURVEYED LINES
- TOWNSHIPS, BASE LINES, ETC.
- LOTS, MINING CLAIMS, PARCELS, ETC.
- UNSURVEYED LINES:
- LOT LINES
- PARCEL BOUNDARY
- MINING CLAIMS ETC.
- RAILWAY AND RIGHT OF WAY
- UTILITY LINES
- NON-PERENNIAL STREAM
- FLOODING OR FLOODING RIGHTS
- SUBDIVISION OR COMPOSITE PLAN
- RESERVATIONS
- ORIGINAL SHORELINE
- MARSH OR MUSKEG
- MINES
- TRAVERSE MONUMENT

DISPOSITION OF CROWN LANDS

TYPE OF DOCUMENT	SYMBOL
PATENT, SURFACE & MINING RIGHTS	●
" SURFACE RIGHTS ONLY	○
" MINING RIGHTS ONLY	◐
LEASE, SURFACE & MINING RIGHTS	■
" SURFACE RIGHTS ONLY	□
" MINING RIGHTS ONLY	◑
LICENCE OF OCCUPATION	▼
ORDER-IN-COUNCIL	OC
RESERVATION	⊙
CANCELLED	⊖
SAND & GRAVEL	⊕

NOTE: MINING RIGHTS IN PARCELS PATENTED PRIOR TO MAY 6, 1913, VESTED IN ORIGINAL PATENTEE BY THE PUBLIC LANDS ACT, R.S.O. 1970, CHAP. 300, SEC. 63, SUBSEC 1.

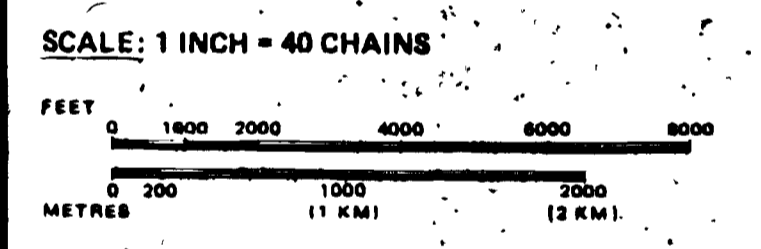

TOWNSHIP

# RANEY

M.N.R. ADMINISTRATIVE DISTRICT

## CHAPLEAU

MINING DIVISION

## PORCUPINE

LAND TITLES / REGISTRY DIVISION

## SUDBURY

OCT 28 1987

Ontario Ministry of Natural Resources Land Management Branch

Date MARCH, 1985 Number G-3245

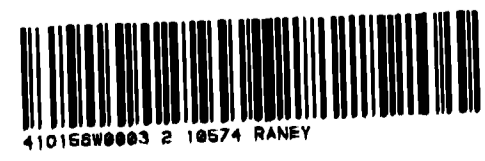



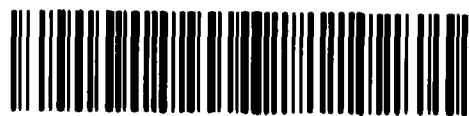
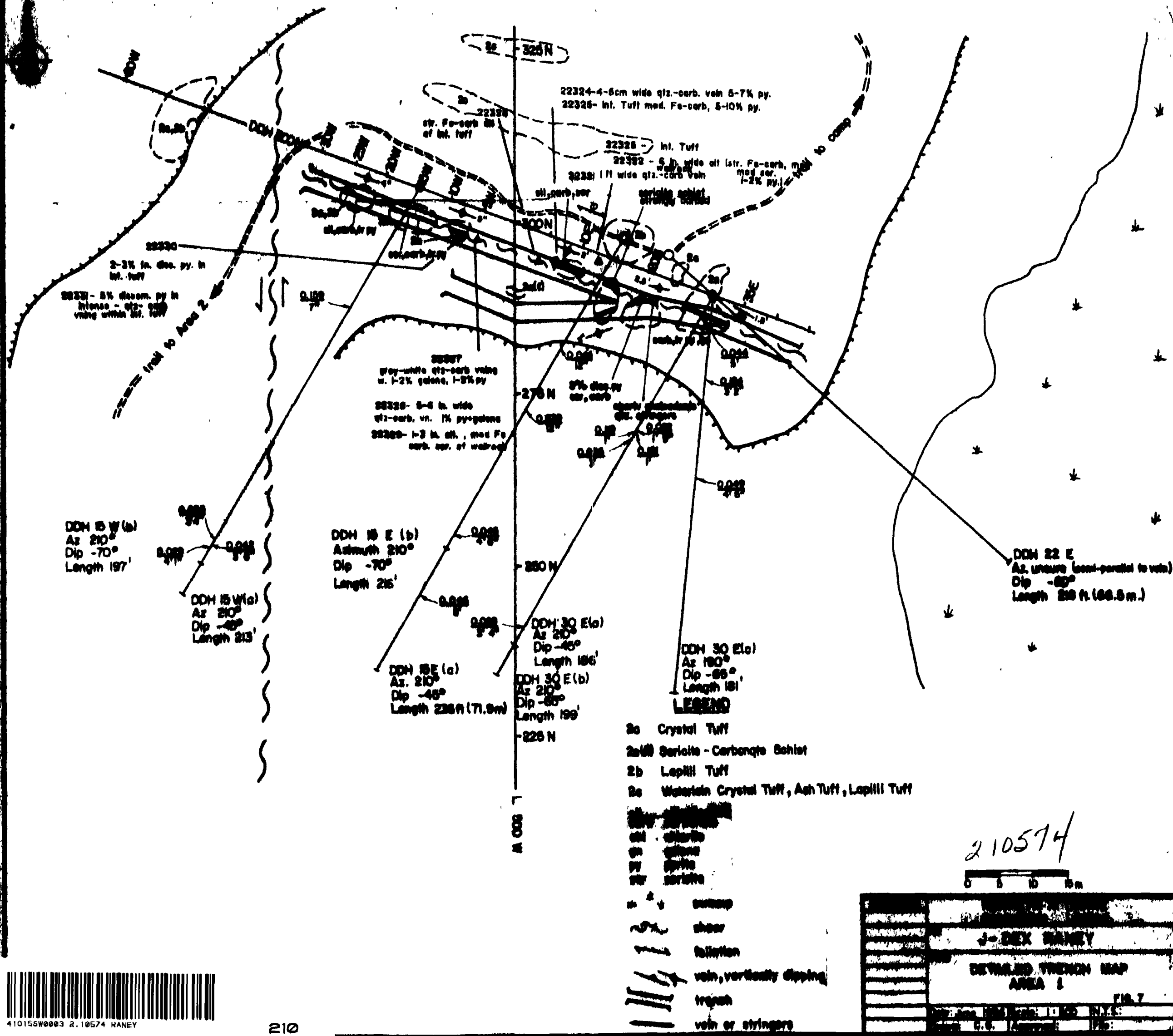

410156W0003 2.10574 RANEY

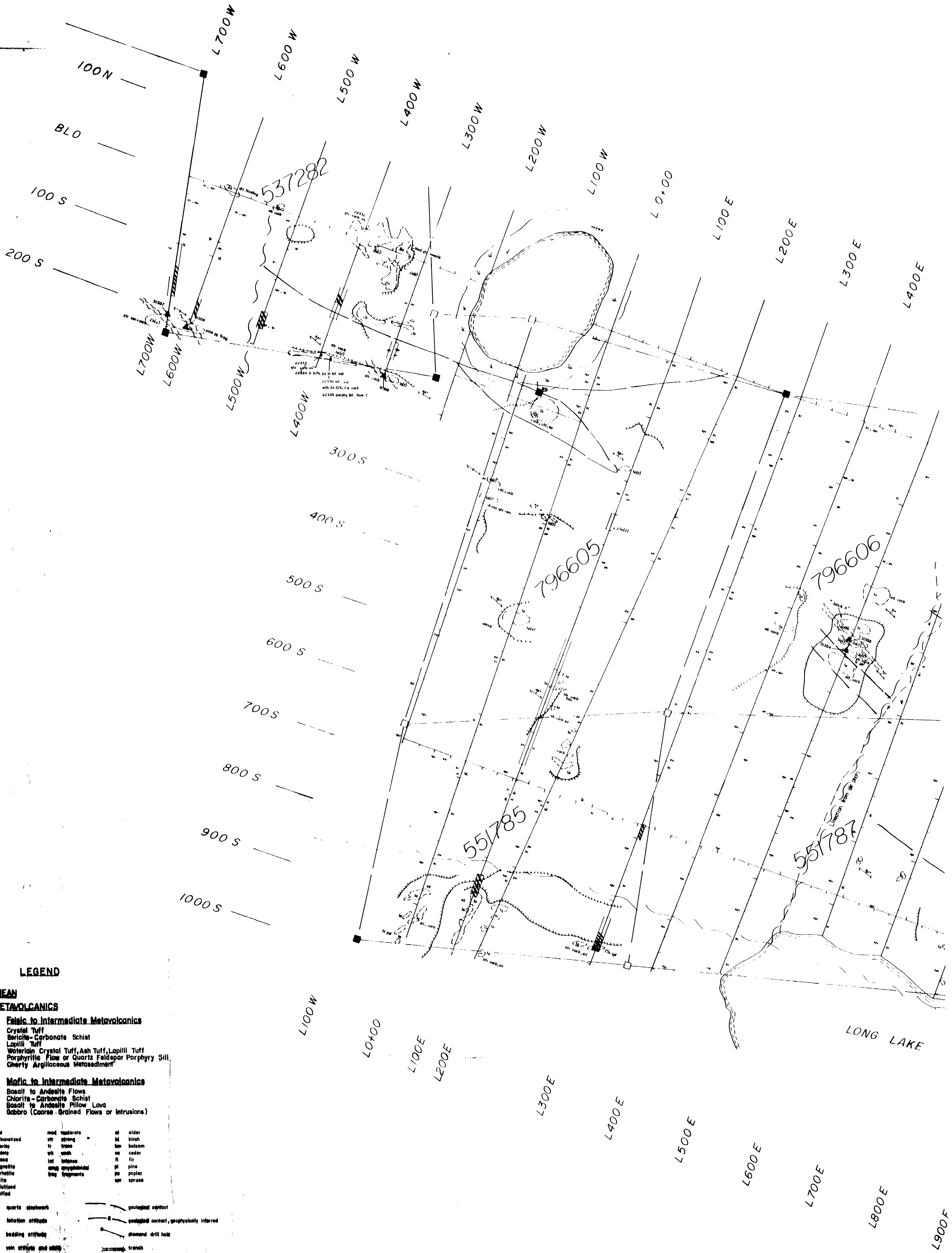

**LEGEND**

**ARCHEAN**

**METAVOLCANICS**

**Felsic to Intermediate Metavolcanics**

- 2a Crystal Tuff
- 2a(f) Sericite-Carbonate Schist
- 2b Lapilli Tuff
- 2c Waterlain Crystal Tuff, Ash Tuff, Lapilli Tuff
- 2d Porphyritic Flow or Quartz Feldspar Porphyry Sill
- 2e Cherty Argillaceous Metasediment

**Mafic to Intermediate Metavolcanics**

- 1a Basalt to Andesite Flows
- 1a(f) Chlorite-Carbonate Schist
- 1b Basalt to Andesite Pillow Lava
- 1c Gabbro (Coarse Grained Flows or Intrusions)

- |                 |                  |           |
|-----------------|------------------|-----------|
| au gold         | mod moderate     | al alder  |
| carb carbonized | str strong       | bl birch  |
| ch chert        | tr trace         | ba balsam |
| ep epidote      | wk weak          | ca cedar  |
| gn garnet       | int intense      | fr fir    |
| mg magnetite    | ang amygdaloidal | pl pine   |
| py pyrite       | frag fragments   | pp poplar |
| pr pyrrhotite   |                  | sp spruce |
| st silicified   |                  |           |

- |                       |  |
|-----------------------|--|
| quartz stockwork      | geological contact                         |
| bedding attitude      | geological contact, geophysically inferred |
| vain strike and width | diamond drill hole                         |
| cutting               | trench                                     |
| step of fault         | ▲ sample number and location               |
| step of fault         | ■ site part, location known                |
| step of fault         | □ site part, location assumed              |
| step of fault         | ○ site part, location uncertain            |



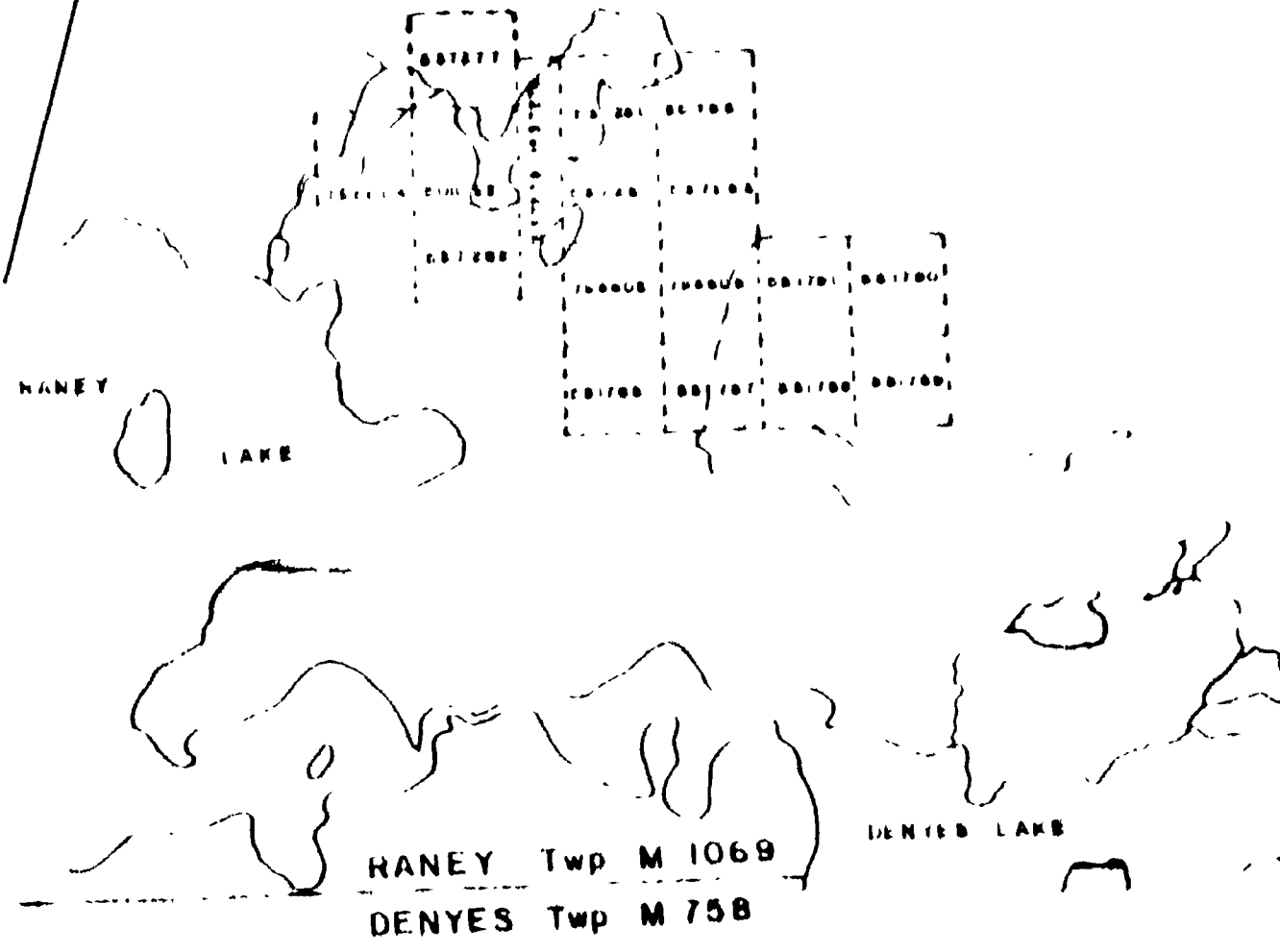

**SOUTH SHEET**

REVISIONS	<b>ROBERT S. MIDDLETON EXPLORATION SERVICES INC.</b>
	J-28X
	MINING EXPLORATION LTD
	<b>GEOLOGY</b>



**LEGEND**

**ARCHEAN**

**METAVOLCANICS**

**Felsic to Intermediate Metavolcanics**

- 2a Crystal Tuff
- 2a(f) Sericite-Carbonate Schist
- 2b Lapilli Tuff
- 2c Waterlain Crystal Tuff, Ash Tuff, Lapilli Tuff
- 2d Porphyritic Flow or Quartz Feldspar Porphyry Sill
- 2e Cherty Argillaceous Metasediment

**Mafic to Intermediate Metavolcanics**

- 1a Basalt to Andesite Flows
- 1a(f) Chlorite-Carbonate Schist
- 1b Basalt to Andesite Pillow Lava
- 1c Gabbro (Coarse Grained Flows or Intrusions)

- Au gold
- carb carbonized
- chl chlorite
- ep epidote
- gn galena
- mt magnetite
- py pyrite
- ser sericitized
- sil silicified
- mod moderate
- str strong
- wk weak
- al alder
- bl birch
- bm balsam
- ce cedar
- fi fir
- pi pine
- pa poplar
- spr spruce

- quartz stockwork
- foliation attitude
- bedding attitude
- vein attitude and width
- outcrop
- edge of ridge
- fault, showing direction of slip
- shear zone
- geological contact
- geological contact, geophysically inferred
- diamond drill hole
- trench
- ▲ 1:2500 sample number and location
- claim post, location known
- claim post, location assumed
- witness post indicating direction to true post location



LAKE

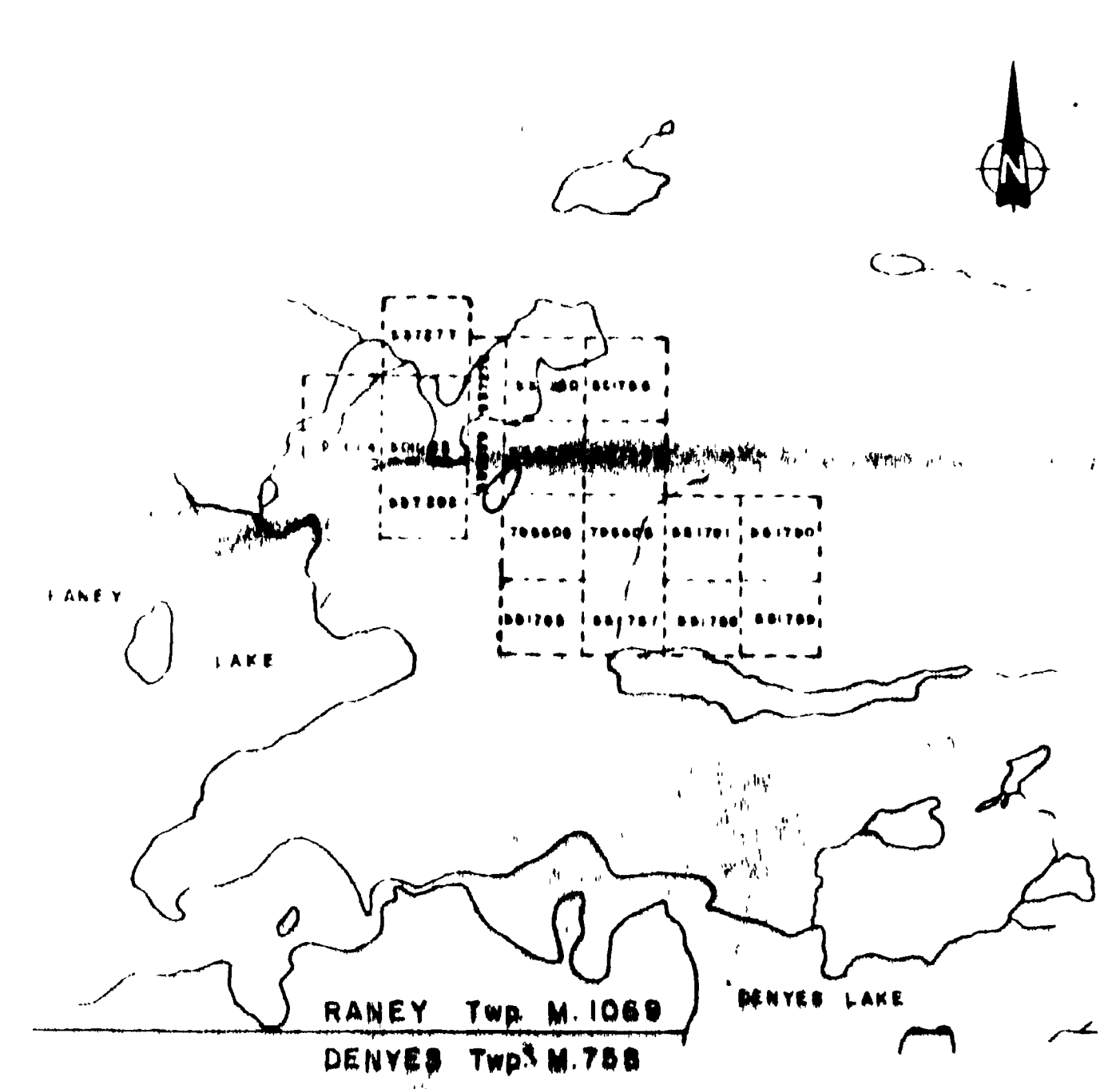
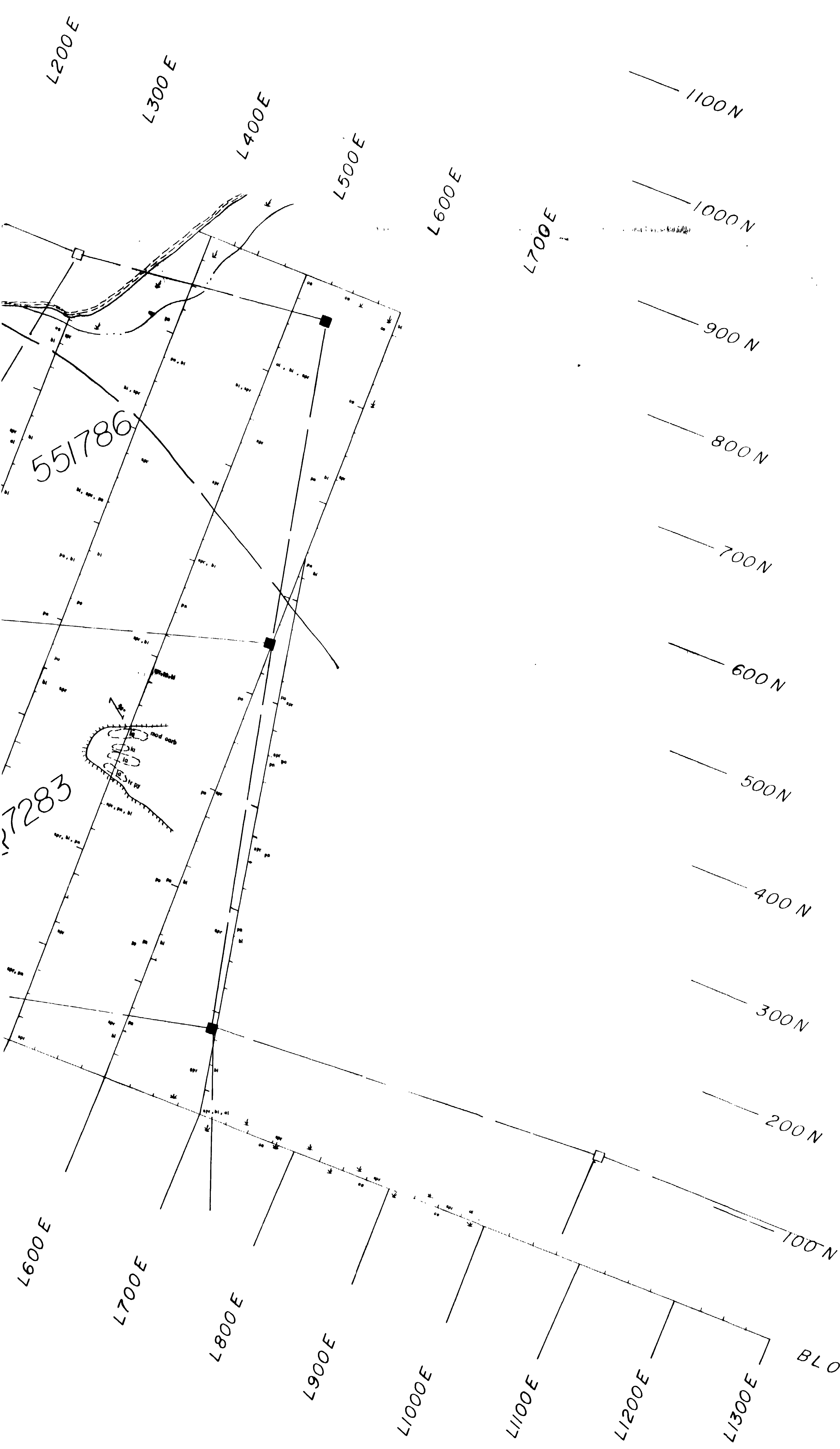

**NORTH SHEET**

REVISIONS	ROBERT S. MIDDLETON EXPLORATION SERVICES INC.
	J-DEX
	MINING EXPLORATION LTD
	GEOLOGY
	Fig. 5
	Dec/86 1:50,000 N.T.S.: 41 O/NE
	No. 29

2105/14



**LEGEND**

**ARCHEAN**

**Mafic Intrusive Rocks**

- 9 Diabase
- Invasive Contact

**METAVOLCANICS**

**Felsic to Intermediate Metavolcanics**

- 2a Crystal Tuff and Rhyolitic Ash
- 2a(f) Quartz Sericite-Carbonate Schist
- 2b Waterlain Crystal Tuff, Ash Tuff, Lapilli Tuff
- 2c Porphyritic Flow or Feldspar Porphyry Sill
- 2d Cherty Argillaceous Metasediment

**Mafic to Intermediate Metavolcanics**

- 1a Basalt to Andesite Flows (Massive, fine-grained)
- 1a(f) Chlorite-Carbonate Schist
- 1b Basalt to Andesite Pillow Lava Flow
- 1c Gabbro, Tholeiitic Flow (Coarse Grained Flows)
- 1c(f) Chlorite Carbonate Schist

- |      |            |     |          |     |        |
|------|------------|-----|----------|-----|--------|
| Ab   | basalt     | mod | moderate | ol  | older  |
| carb | carbonized | str | strong   | bl  | black  |
| chl  | chlorite   | tr  | trace    | ca  | cedar  |
| mag  | magnetite  | wt  | weak     | pn  | pine   |
| py   | pyrite     |     |          | pp  | poplar |
| ser  | sericized  |     |          | spr | spruce |
| sil  | silicified |     |          |     |        |

- quartz stockwork
- injection attitude
- bedding attitude
- vein attitude and width
- outcrop
- edge of ridge
- fault, showing direction of slip
- shear zone
- geological contact
- diamond drill hole
- trench
- sample number and location
- chain post, location known
- chain post, location assumed
- chain post indicating direction to true post location



*John C. ...*

<b>ROBERT S. MIDDLETON EXPLORATION SERVICES INC.</b>		
J-DEX (B) (21 claims)		
GEOLOGY (NORTH SHEET)		
Date: NOV. 1984	Scale: 1:2000	N.T.S.
Drawn: C6	Approved:	File: M-69

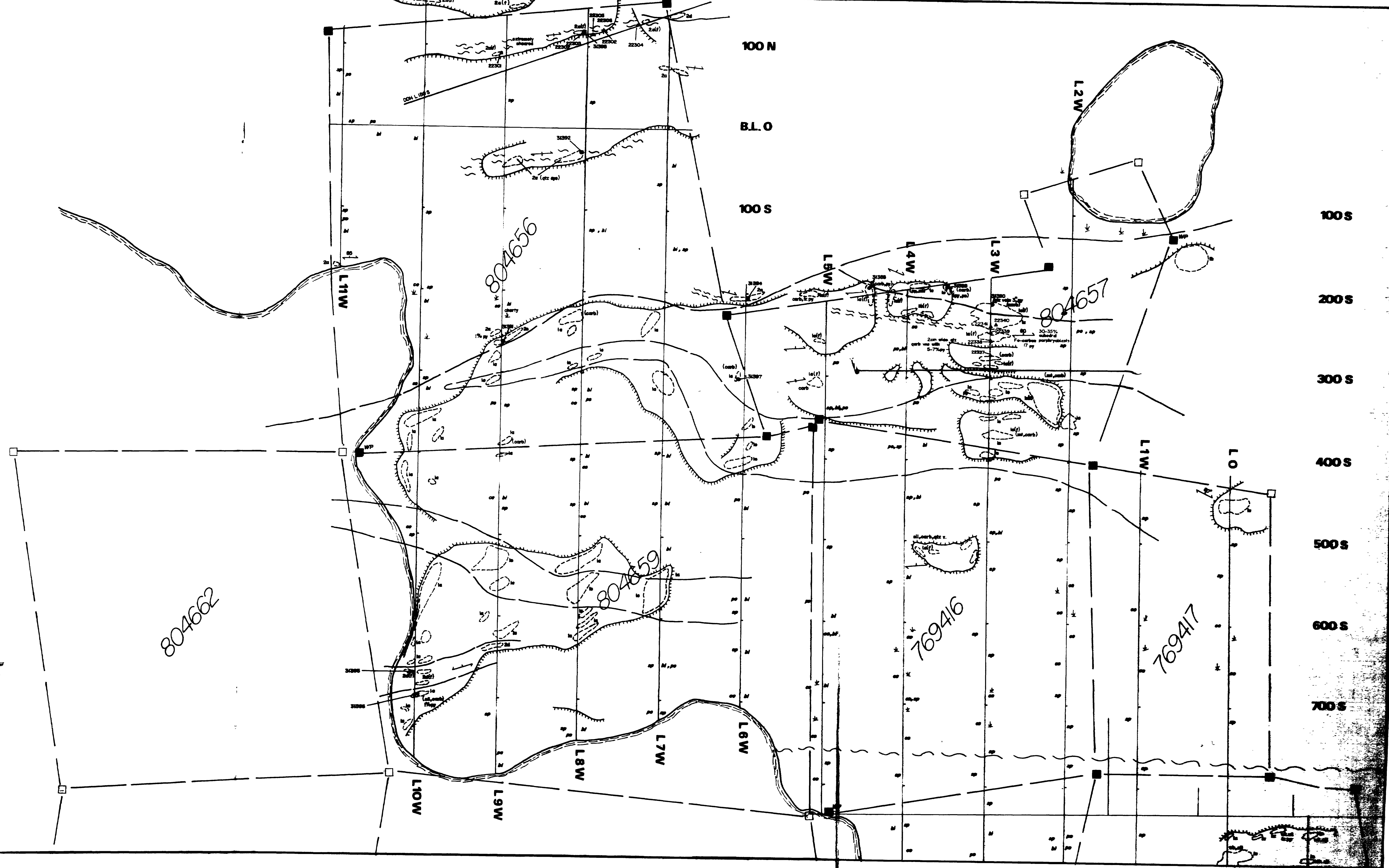

Raney Lake

804661

804660

769415

769409

769410

769407

769408

796607

796608

Raney Lake

LEGEND

ARCHEAN

Mafic intrusives

- 9 Diabase

METAVOLCANICS

Felsic to Inte

- 2a Crystal Tuff and
- 2a(f) Quartz Sericite-
- 2c Waterlain Cryst
- 2d Porphyritic Flo
- 2e Cherty Argillac

Mafic to Inte

- la Basalt to Ande
- la(f) Chlorite - Carbo
- lb Basalt to Ande
- le Gabbro, Tholeiitic
- le(f) Chlorite Carbonc

- ΔΔΔ breccia
- carb carbonized
- chl chlorite
- mt magnetite
- pe pyrrhotite
- py pyrite
- ser sericitized
- sil silicified
- mod r
- str s
- tr t
- wk w

- # quartz stockwork
- sp foliation attitude
- sb bedding attitude
- v vein attitude and w
- o outcrop
- ~ edge of ridge
- fault, showing direct
- shear zone

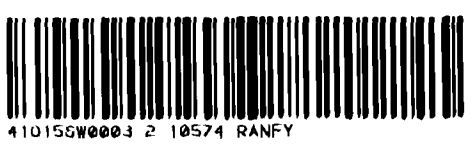

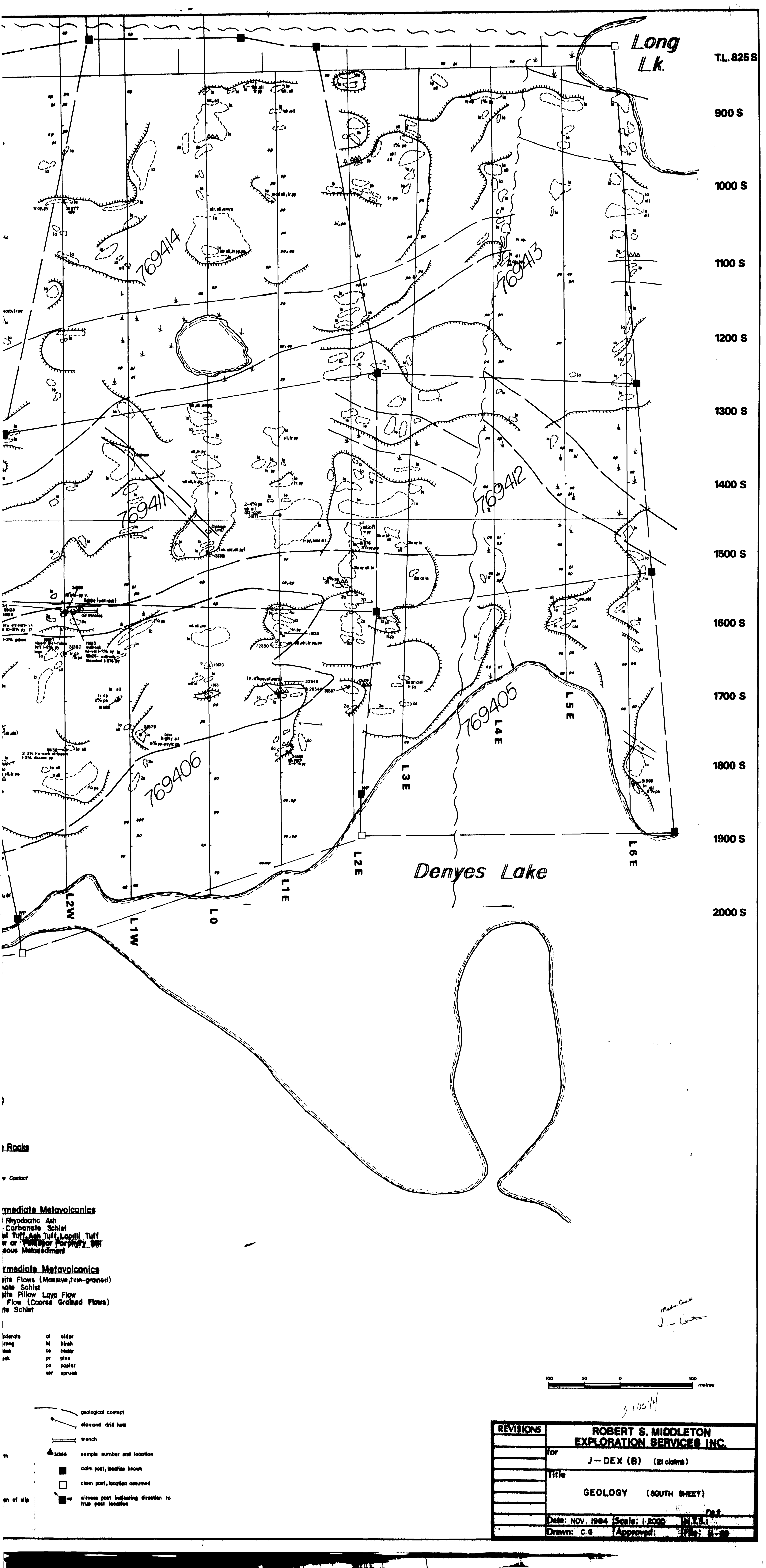

Rocks

Contact

Intermediate Metavolcanics

- Hydrothermal Ash
- Carbonate Schist
- Ash Tuff, Ash Tuff, Lapilli Tuff
- or Porphyry
- Metasediment

Intermediate Metavolcanics

- Lava Flows (Massive, fine-grained)
- Schist
- Pillow Lava Flow
- Flow (Coarse Grained Flows)
- Schist

- al alder
- bl birch
- ca cedar
- pr pine
- po poplar
- spr spruce

- geological contact
- diamond drill hole
- trench
- sample number and location
- claim post, location known
- claim post, location assumed
- witness post indicating direction to true post location

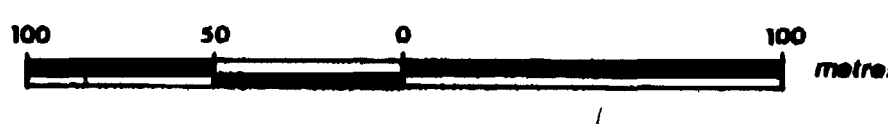

REVISIONS	ROBERT S. MIDDLETON EXPLORATION SERVICES INC.	
	J-DEX (B) (21 claims)	
	GEOLOGY (SOUTH SHEET)	
Date: NOV. 1984	Scale: 1:2000	N.T.L.
Drawn: C.G.	Approved:	File: H-89

*Robert Middleton  
J. G. Coates*

210574