

41015SW0037 2.16341 HALCROW

010

MAGNETOMETER SURVEY
ON THE
HALCROW CREEK PROPERTY
HALCROW TOWNSHIP
PORCUPINE MINING DISTRICT, ONTARIO

2.16341

by

William R. Troup

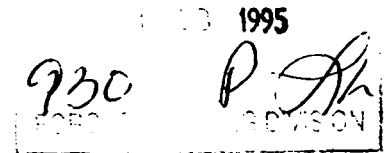
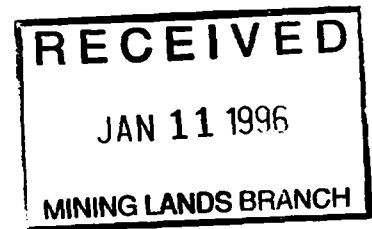

Alcanex Ltd.

Mississauga, Ontario

May 8, 1995

SUMMARY

A program of line cutting and ground geophysics was completed on the Halcrow Creek Property during the period September 20 and November 15, 1995.

The four known gold zones on the property all have a strong magnetic correlation.

The south gold zone occurs over a conformable linear magnetic high that can be traced along strike for over 800 meters (2600 feet).

The north gold zone occurs over the west extension of a broad magnetic low that extends off the grid to the east, a distance of more than 1000 meters. A limited, reconnaissance V.L.F survey was completed on pace and compass lines, in 1993, and a broad conductive horizon was delineated coincident with the western 400 meters of this magnetic low. The survey did not cover the eastern half of the grid.

The two central gold zones occur on the north and south flanks of a circular magnetic high that measures some 400 meters in diameter.

On the Halcrow Creek Property, gold typically occurs with disseminated pyrite in zones of sheared volcanics and/or quartz-feldspar-porphyry intrusive. This type of mineralization should respond well to detection by I.P. survey.

A two phase exploration program is proposed to evaluate the economic potential of the Halcrow Creek Property.

In phase 1, I.P. surveying is proposed over all areas of known gold mineralization. V.L.F surveying is recommended over the entire grid. Prospecting and detailed mapping is recommended to tie all known mineralized zones in with the recently established grid. Geochemical sampling should be attempted over geophysical anomalies of interest which occur in overburden covered areas.

A phase 2 program of diamond drilling (1200 meters) is anticipated to provide an initial test of deserving gold targets.



410155W0037 2.16341 HALCROW

010C

TABLE OF CONTENTS

	Page
I INTRODUCTION	1
II LOCATION & ACCESS.....	1
III PROPERTY.....	1.
IV PREVIOUS WORK.....	4
V GEOLOGY.....	5
VI 1994 MAGNETOMETER SURVEY.....	6
VII FUTURE RECOMMENDATIONS	6
VIII REFERENCES.....	7
APPENDIX 1. STATEMENT OF COSTS	
APPENDIX 2 GEOLOGISTS CERTIFICATE	
APPENDIX 3 MAGNETIC MAP - 1994 SURVEY	

LIST OF FIGURES

Figure 1. Property Location Map.....	2
Figure 2. Claims.....	3
Figure 3. Magnetic Map - This Survey	A-3

I. INTRODUCTION

During the period Oct. 1 to Nov. 15, 1994, Timmins North Exploration Ltd. completed a program of line cutting and Ground magnetic surveying on the Halcrow Creek property.

The area has been subjected to sporadic exploration over a period of more than 50 years, and identified as highly prospective for gold.

The current program was directed at an area encompassing four known gold zones. Twenty-six kilometers of grid were established and surveyed by proton magnetometer in an effort to delineate the extent of the known mineralized zones.

II. LOCATION & ACCESS

The property is located in Halcrow Township, approximately 90 miles west of Timmins, and within the Porcupine Mining District. The center of the property is at Lat: 47 50'N, and 82 57'W (Figure 1). in NTS quadrangle 41/O,15.

A system of logging roads extends southwest from highway 101, from a point 40 kilometers west of the town of Foleyet, for 28 km's to the northwest corner of the claim group.

The Ivanhoe River crosses the northwest corner of the property, immediately south of the end of the access road. Locally, the river narrows to approximately 3 meters and is less than 1 meter in depth, and can be crossed on a series of fallen logs.

III. PROPERTY

The property consists of 7 claims totaling approximately 1,240 acres. The recorded owner of the claims is Alcanex Ltd., 1365 Clarkson Rd. N., Mississauga, Ont., L5J-2W6.

CLAIM #	SIZE	RECORDING DATE
1150962	16(40 acre) Units	Oct. 23, 1991
1150965	2(40 acre) Units	Oct. 23, 1991
1150966	1(40 acre) Unit	Oct. 25, 1991
1150967	1(40 acre) Unit	Oct. 25, 1991
1150968	2(40 acre) Units	Oct. 25, 1991
1150969	1(40 acre) Unit	Oct. 25, 1991
1205434	8(40 acre) Units	Oct. 17, 1994 ?

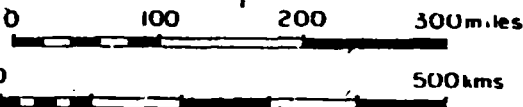
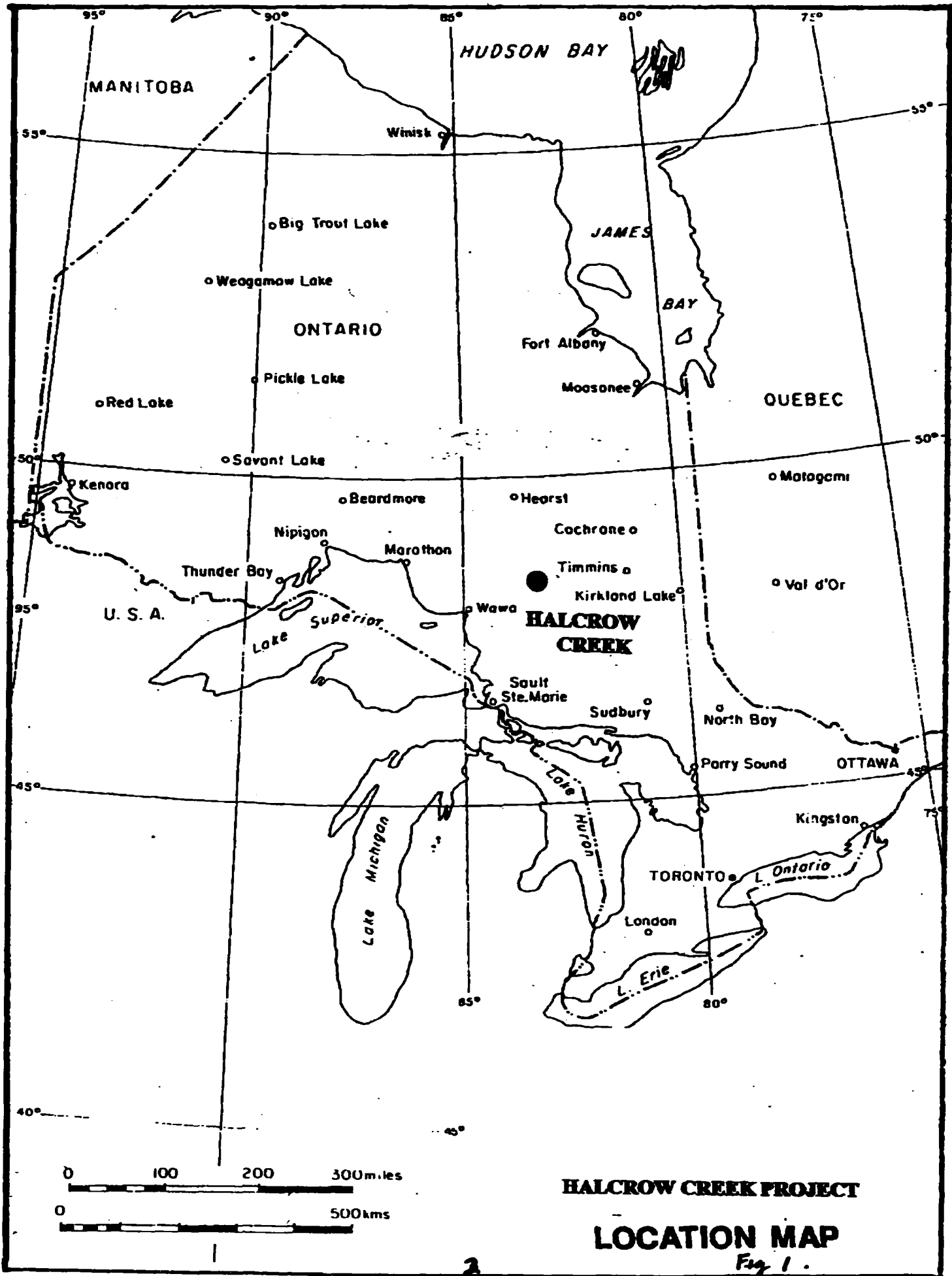

HALCROW CREEK PROJECT

LOCATION MAP

Fig. 1.



3

(1175914) = Claims Held by Other Parties

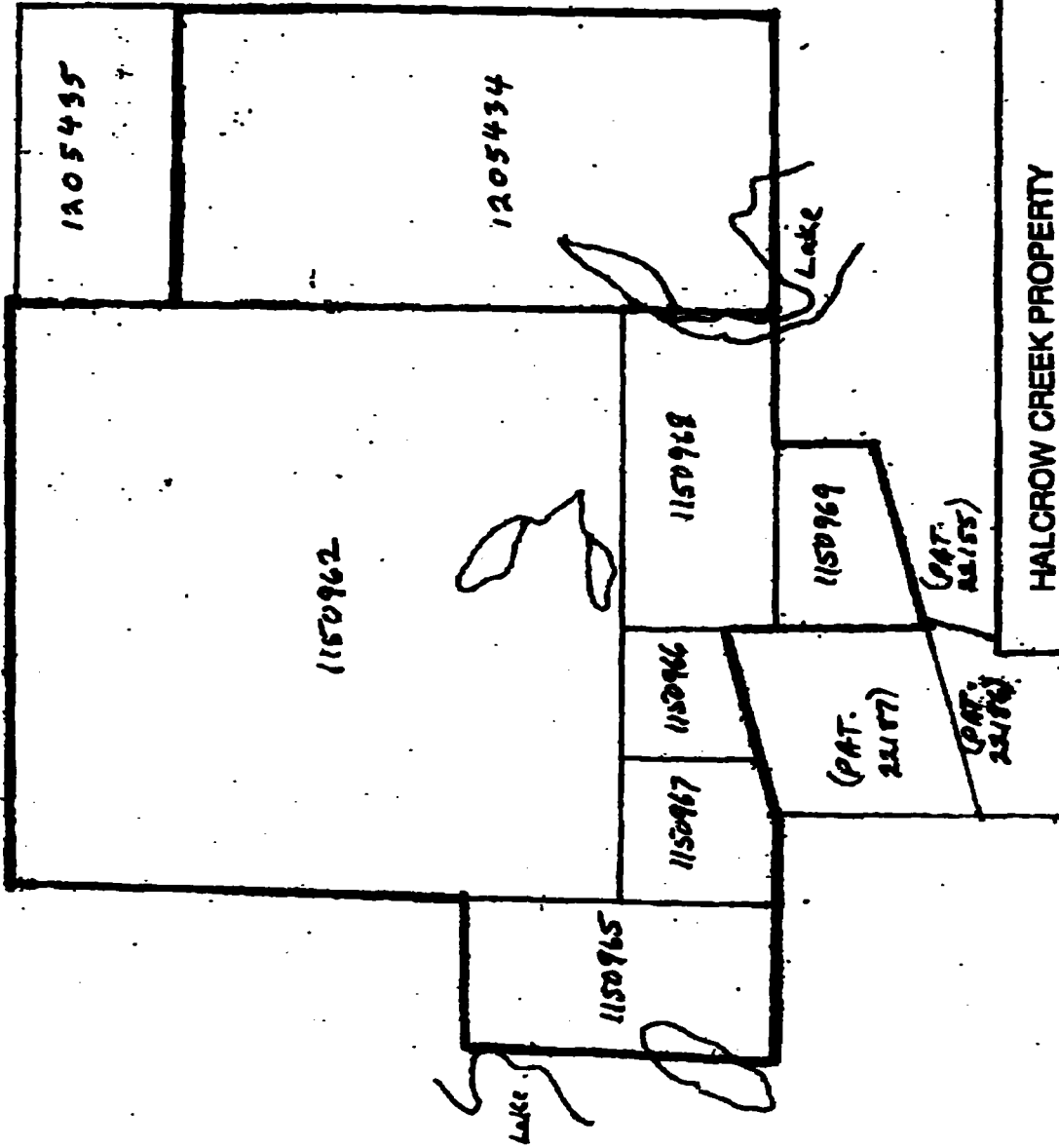

HALCROW CREEK PROPERTY

SCALE

1:20,000

DRAWN BY

W. Johnson

REVISED BY

H. Turner / 02/5/06

CLAIMS

DATE

DEC. 15/92

TARGET EXPLORATION SERVICES LTD.

DRAWING NUMBER

FIG. 2

Topography in the area is gently rolling with maximum relief of about 50 meters. The high ground on the property is covered mainly by a mixed forest of poplar, white spruce, white birch, balsam, fir, jack pine and alders. White cedar and black ash are present in lower areas. Much of the area between highway 101 and the north boundary of the property has been clear-cut in recent years.

IV. PREVIOUS WORK

The area has received intermittent waves of exploration since the initial discovery of gold at Timmins in the early 1900's.

The patented claims located immediately south of the Halcrow Creek property, and formally held by Halcrow-Swayze Mines Ltd., received considerable exploration in the period 1932-1934. A shaft was sunk to a depth of 371 feet. The company estimated a reserve of 127,000 tons with a grade of 0.11 oz/ton on one vein to the 354 foot level.

W. Hammerstrom and W.J. Koski prospected the area in the mid 1940's and identified 5 areas favorable for hosting gold mineralization. They apparently located one showing north of the small pond near the south boundary of the Halcrow Creek claim block which returned .12 oz/ton Au. (see Karvinen (1980)). This is presumed to be the showing located in the south central part of our claim block. A mineralized boulder from south of the property which assayed 3.65 oz/ton Au was suggested to have a possible source from beneath the pond mentioned previously. In consideration of the direction of glacial transport, the source could be south of the Halcrow Property, or any one of the four known zones on the property.

Parts of the current property were staked in the 1950's and 1960's.

In 1977 Granges explorations drilled one hole on an airborne electromagnetic anomaly located in the southeastern part of the current property. The hole intersected 10-30% pyrite over a few feet in tuff and argillite. the target was base metal massive sulphides. No gold analyses were recorded.

In 1980, W. Karvinen prospected and mapped the area for Gossan Resources. No detailed surveys or drilling was initiated.

In 1984, Regal Petroleum carried out geological mapping and prospecting over the current area of interest as part of a larger area evaluation. They completed airborne magnetic, electromagnetic and VLF surveys over the area. Several areas of geochemically anomalous gold values were identified and detail follow-up was recommended over the central part of the property.

In 1990 & 1991 W. Troup and B Otton prospected the area and located four distinct zones of anomalous gold mineralization. An initial block of 6 claims was staked in the area.

In 1992, Lorac Properties optioned the claim block and completed reconnaissance geological mapping over approximately 1/2 of the property. Three of the four known gold zones were examined and hand stripped and sampled. In all instances anomalous gold values were confirmed and a follow-up program of geophysics and drilling was planned but never completed. The property was returned to Troup & Otton when Lorac was unsuccessful in financing a 1993 exploration program.

In the current 1994 program, Alcanex Ltd. established 26 kilometers of grid over the property and completed a proton magnetometer survey.

V. GEOLOGY

Va) General Geology

The survey area is located within and near the western extremity of the Swayze Greenstone Belt, which in turn represents the western extension of the larger Abitibi Greenstone Belt of the Canadian Precambrian Shield. The area is underlain by an east-west trending sequence of mafic volcanics and associated sediments interrupted locally by mafic and felsic intrusives.

Vb) Property Geology

The property is underlain in part by andesite flows, tuffs and associated sediments, intruded locally by felsic intrusive dykes and/or sills. The northern and western extremities of the property are underlain by granodiorite. Pyritic argillite and quartz-magnetite iron formation occur in two areas near the southern margin of the property.

Most of the rock formations are at least weakly foliated. In places this foliation becomes strong and pervasive and locally grades into schistosity or shearing. Pyrite and occasional quartz veining are typically present in areas of shearing.

Four gold enriched shear zones have been identified on the property. In all instances, gold occurs with disseminated pyrite in amounts of up to 10 percent.

At the south zone, gold occurs with disseminated to massive pyrite, in a unit of conformably sheared interflow sediment. The three north zones all occur near the contacts between mafic volcanics and granitic and/or quartz-porphyry intrusives.

VI 1994 MAGNETOMETER SURVEY

In November 1994, Timmins North Exploration Services cut 25 kilometers of grid on the Halcrow Creek property and completed a total field magnetic survey on all newly established grid. Survey logistics, instrument specifications and survey results are presented in appendix 3 of this report.

The magnetic survey outlined a number of magnetic features for future evaluation.

The most southerly of the four known gold zones (Zone 1) on the property occurs on the axis of a conformable linear magnetic high with a strike length of over 300 meters.

The next gold zone to the north (Zone 2) occurs on the south flank of a strong magnetic high and near the west end of a linear magnetic low that extends for over 500 meters to the west.

The two north zones (Zones 3&4) occur on the north flank of the magnetic high that is associated with zone 2. A government airborne E.M survey indicates a linear VLF anomaly in the area of zones 3&4 that extends eastward across the property for over 800 meters.

Two additional linear magnetic highs occur between Zones 1&2 and warrant investigation by prospecting and/or geochemical and geophysical sampling.

VII FUTURE RECOMMENDATIONS

Ground magnetic surveying reveals that the known gold zones on the property occur proximal to linear magnetic highs or lows. Previously sampling on the property has shown that gold mineralization commonly occurs in pyritic shears located on or proximal to the contacts between granitic intrusives and host volcanics.

It is recommended that an I.P. geophysical survey be initiated over the area encompassing the known gold zones. All coincident I.P & Magnetic anomalies should be examined along their length by prospecting, geochemical sampling and/or diamond drilling.

VIII REFERENCES

Donovan, J.F, 1968; Geology of Halcrow-Ridout Lakes Area; Ont. Dept. of Mines, Geol. Rept. 63.

Johnson, W. L. 1993; Geological Mapping, Trenching and Sampling on the Halcrow Creek Property, Halcrow Township, Porcupine Mining District, Ontario; Target Exploration Services Ltd. (available in assessment files)

Karvinen, W.O. 1980; Report on the Gossan Resources Property, Halcrow Township, district of Sudbury, Ontario.; unpub. report (available in assessment files)

Ontario Geological Survey, 1982; Airborne Electromagnetic Survey Swayze Area, (Input Survey).

Troup, W.R. and Otton, B. 1991; Swayze Project - OPAP Grant #91-611 (Report on OPAP Project).

**APPENDIX 1
STATEMENT OF COSTS**

1. Field Program (Line Cutting & Magnetic Survey)

a. Contract

Timmins North Exploration

Linecutting & Ground Magnetic Survey.....\$7,725.00

(27 line km's @ \$ 286.00/line km.

b. In House

3 days Supervision of project start up - W. Troup.....\$ 1,605.00

(\$500.00/day + 7% G.S.T.)

Sub Total.....\$ 9,330.00

2. Mob-Demob W. Troup

Travel by truck to & from property.....\$ 300.00

1000 km's x \$0.30/km)

Accommodation & food for 3 days @ \$50/day.....\$ 150.00

Sub Total.....\$ 450.00

Project Total.....\$ 9,780.00

* The 1994 work program was completed in the time period September 20'th to November 15'th 1994.

* W. Troup mobilized to the property on Sept. 19'th, 1994 to show contractor access, tie in points, etc., left area on Sept. 22, 1994.

CERTIFICATE OF QUALIFICATIONS

I, William R. Troup, of Mississauga, Ontario, hereby certify and declare the following:

1. I am a Consulting Geologist and President of Alcanex Ltd., a service company providing geological services and project management to the mineral exploration industry.
2. I graduated from the University of Waterloo with an Msc. degree in Geology in 1975.
3. I have been practising my profession for the past 24 years.
4. I am a fellow in the Geological Association of Canada.
5. I personally planned and supervised the Halcrow Creek project completed in the fall of 1994.
6. The opinions expressed in this report are based on my own observations and on my review of public geological reports on the area.



William R. Troup, Msc.
F.G.A.C.

Mississauga, Ontario
May 8, 1995

**Report of Work Conducted
 After Recording Claim**

Transaction Number
 W9560.00412

Mining Act

Personal information collected on this form is obtained under the authority of the Mining Act. This collection should be directed to the Provincial Manager, Mining Lands, Sudbury, Ontario, P3E 6A5, telephone (705) 670-7264.

- Instructions:**
- Please type or print and submit in duplicate.
 - Refer to the Mining Act and Regulations for Recorder.
 - A separate copy of this form must be completed for each Work Group.
 - Technical reports and maps must accompany this form in duplicate.
 - A sketch, showing the claims the work is assigned to, must accompany this form.



900

Recorded Holder(s) ALCANEX LTD		Client No. 101-512
Address 1365 CLARKSON RD. N., MISSISSAUGA, ONTARIO L5J 2W4		Telephone No. (905) 823-2881
Mining Division PORCUPINE	Township/Area HALCROW TWP	M or G Plan No. 6-889
Dates Work Performed From: SEPT 19 1994		To: NOV 30 1994

Work Performed (Check One Work Group Only)

Work Group	Type
<input checked="" type="checkbox"/> Geotechnical Survey	V LINE CUTTING & MAGNETOMETER SURVEY
<input type="checkbox"/> Physical Work, including Drilling	
<input type="checkbox"/> Rehabilitation	
<input type="checkbox"/> Other Authorized Work	
<input type="checkbox"/> Assays	
<input type="checkbox"/> Assignment from Reserve	

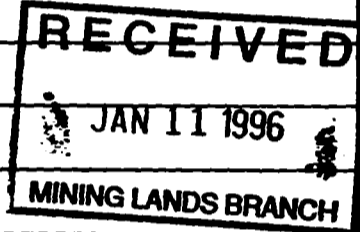

Total Assessment Work Claimed on the Attached Statement of Costs \$ **9,420⁰⁰**

Note: The Minister may reject for assessment work credit all or part of the assessment work submitted if the recorded holder cannot verify expenditures claimed in the statement of costs within 30 days of a request for verification.

Persons and Survey Company Who Performed the Work (Give Name and Address of Author of Report)

Name	Address
TIMMIN'S NORTH EXPL'N	TIMMIN'S ONT.
W. TROUP (ALCANEX LTD)	1365 CLARKSON RD. N. MISSISSAUGA ONT

(attach a schedule if necessary)

Certification of Beneficial Interest * See Note No. 1 on reverse side

I certify that at the time the work was performed, the claims covered in this work report were recorded in the current holder's name or held under a beneficial interest by the current recorded holder.	Date	Recorded Holder or Agent (Signature)
--	------	--------------------------------------

Certification of Work Report

I certify that I have a personal knowledge of the facts set forth in this Work report, having performed the work or witnessed same during and/or after its completion and annexed report is true.

Name and Address of Person Certifying William R Troup / 1365 CLARKSON RD. N., MISSISSAUGA, ONT	Date OCT 11 1995	Certified By (Signature) William R Troup
--	----------------------------	--

or Office Use Only

Total Value Cr. Recorded \$9,420	Date Recorded	Mining Recorder Undated Gary White	Received Stamp RECEIVED JCT 13 1995 930 PDR
	Deemed Approval Date JAN. 11, 1996	Date Approved	
Date Notice for Amendments Sent			

Work Report Number for Applying Reserve	Claim Number (see Note 2)	Number of Claim Units
U	1150962	16
24	1150965	2
33	1150967	1
3	1150966	1
2	1150968	2
	1150969	1
	1205434	8
Total Number of Claims		7

Total Value Work Done	Total Value Work Applied	Value of Assessment Work Done on this Claim	Value Applied to the Claim
		\$ 7,290 ⁰⁰	\$ 426 ⁰⁰
		\$ 500 ⁰⁰	\$ 500 ⁰⁰
		700 ⁰⁰	400 ⁰⁰
		320 ⁰⁰	400 ⁰⁰
		310 ⁰⁰	500 ⁰⁰
			400 ⁰⁰
			400 ⁰⁰
			320 ⁰⁰
Total Value Work Done	Total Value Work Applied		
\$ 9,420 ⁰⁰	\$ 6,426 ⁰⁰		

RECEIVED
 JAN 11 1996
 MINING LANDS BRANCH

Total Assigned From	Total Reserve	Value Assigned from this Claim	Reserve Work to be Claimed at a Future Date
		3890 ⁰⁰	2994 ⁰⁰
Total Assigned From	Total Reserve		
4190 ⁰⁰	2994 ⁰⁰		

Credits you are claiming in this report may be cut back. In order to minimize the adverse effects of such deletions, please indicate from which claims you wish to prioritize the deletion of credits. Please mark (✓) one of the following:

- Credits are to be cut back starting with the claim listed last, working backwards.
- Credits are to be cut back equally over all claims contained in this report of work.
- Credits are to be cut back as prioritized on the attached appendix.

In the event that you have not specified your choice of priority, option one will be implemented.

Note 1: Examples of beneficial interest are unrecorded transfers, option agreements, memorandum of agreements, etc., with respect to the mining claims.

Note 2: If work has been performed on patented or leased land, please complete the following:

I certify that the recorded holder had a beneficial interest in the patented or leased land at the time the work was performed.

Signature: *William R. Trumb* Date: *Oct 12/ 95*

Statement of Costs for Assessment Credit

État des coûts aux fins du crédit d'évaluation

Mining Act/Loi sur les mines

Transaction No./N° de transaction

W9560.004/2

20100

Personal information collected on this form is obtained under the authority of the Mining Act. This information will be used to maintain a record and ongoing status of the mining claim(s). Questions about this collection should be directed to the Provincial Manager, Minings Lands, Ministry of Northern Development and Mines, 4th Floor, 159 Cedar Street, Sudbury, Ontario P3E 6A5, telephone (705) 670-7284.

Les renseignements personnels contenus dans la présente formule sont recueillis en vertu de la Loi sur les mines et serviront à tenir à jour un registre des concessions minières. Adresser toute question sur la collecte de ces renseignements au chef provincial des terrains miniers, ministère du Développement du Nord et des Mines, 159, rue Cedar, 4^e étage, Sudbury (Ontario) P3E 6A5, téléphone (705) 670-7284.

1. Direct Costs/Coûts directs

Type	Description	Amount Montant	Totals Total global
Wages Salaires	Labour Main-d'oeuvre		
	Field Supervision Supervision sur le terrain		
Contractor's and Consultant's Fees Droits de l'entrepreneur et de l'expert-conseil	Type		
	Timmins W/L.C.H. Mag	7,725 ⁰⁰	
	ALCANEY SUPERVISOR	1,605 ⁰⁰	
			9,330 ⁰⁰
Supplies Used Fournitures utilisées	Type		
Equipment Rental Location de matériel	Type		
Total Direct Costs Total des coûts directs			9,330 ⁰⁰

2. Indirect Costs/Coûts indirects

Note: When claiming Rehabilitation work Indirect costs are not allowable as assessment work. Pour le remboursement des travaux de réhabilitation, les coûts indirects ne sont pas admissibles en tant que travaux d'évaluation.

Type	Description	Amount Montant	Totals Total global
Transportation Transport	Type		
	TRUCK	300 ⁰⁰	
			300 ⁰⁰
Food and Lodging Nourriture et hébergement	Type		
	W. JK 008 / 3 Days	150 ⁰⁰	
			150 ⁰⁰
Sub Total of Indirect Costs Total partiel des coûts indirects			450 ⁰⁰
Amount Allowable (not greater than 20% of Direct Costs) Montant admissible (n'excédant pas 20 % des coûts directs)			90 ⁰⁰
Total Value of Assessment Credit (Total of Direct and Allowable indirect costs) Valeur totale du crédit d'évaluation (Total des coûts directs et indirects admissibles)			9,420 ⁰⁰

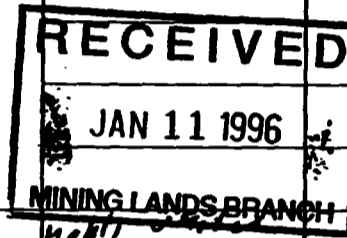

Note: The recorded holder will be required to verify expenditures claimed in this statement of costs within 30 days of a request for verification. If verification is not made, the Minister may reject for assessment work all or part of the assessment work submitted.

Note: Le titulaire enregistré sera tenu de vérifier les dépenses demandées dans le présent état des coûts dans les 30 jours suivant une demande à cet effet. Si la vérification n'est pas effectuée, le ministre peut rejeter tout ou une partie des travaux d'évaluation présentés.

Filing Discounts

- Work filed within two years of completion is claimed at 100% of the above Total Value of Assessment Credit.
- Work filed three, four or five years after completion is claimed at 50% of the above Total Value of Assessment Credit. See calculations below:

Total Value of Assessment Credit	Total Assessment Claimed
	x 0.50 =

Remises pour dépôt

- Les travaux déposés dans les deux ans suivant leur achèvement sont remboursés à 100 % de la valeur totale susmentionnée du crédit d'évaluation.
- Les travaux déposés trois, quatre ou cinq ans après leur achèvement sont remboursés à 50 % de la valeur totale du crédit d'évaluation susmentionné. Voir les calculs ci-dessous.

Valeur totale du crédit d'évaluation	Évaluation totale demandée
	x 0.50 =

Certification Verifying Statement of Costs

I hereby certify: that the amounts shown are as accurate as possible and these costs were incurred while conducting assessment work on the lands shown on the accompanying Report of Work form.

That as Recorded Holder I am authorized (Recorded Holder, Agent, Position in Company)

to make this certification

Attestation de l'état des coûts

J'atteste par la présente: que les montants indiqués sont le plus exact possible et que ces dépenses ont été engagées pour effectuer les travaux d'évaluation sur les terrains indiqués dans la formule de rapport de travail ci-joint.

Et qu'à titre de Recorded Holder je suis autorisé (titulaire enregistré, représentant, poste occupé dans la compagnie)

à faire cette attestation.

Signature: [Signature] Date: at 11/45

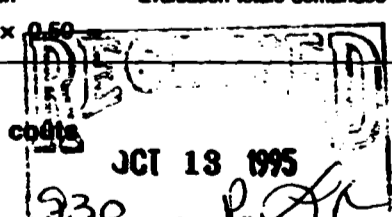

Ministry of
Northern Development
and Mines

Ministère du
Développement du Nord
et des Mines

Geoscience Approvals Office
933 Ramsey Lake Road
6th Floor
Sudbury, Ontario
P3E 6B5

Telephone: (705) 670-5853
Fax: (705) 670-5863

Our File: 2.16341
Transaction #: W9560.00412

January 15, 1996

Mining Recorder
Ministry of Northern Development & Mines
60 Wilson Avenue, 1st Floor
Timmins, Ontario
P4N 2S7

Dear Sir:

**RE: APPROVAL OF ASSESSMENT WORK SUBMITTED ON MINING CLAIMS
P.1150962 ET AL IN HALCROW TOWNSHIP**

A Notice of Deficiency was not issued on this Report of Work prior to the 90 day deemed approval date and as outlined in subsection 6(5) of the Mining Act Regulations this Report of Work is deemed approved as of JANUARY 11, 1995.

If you require further information please contact Lucille Jerome at (705) 670-5858.

Yours sincerely,
ORIGINAL SIGNED BY:



Ron C. Gashinski
Senior Manager, Mining Lands Section
Mining and Land Management Branch
Mines and Minerals Division

 LJ/jl

cc: Resident Geologist
Timmins, Ontario

 Assessment Files Office
Sudbury, Ontario

HALCROW TWP

Lackner Twp.

Crockett Twp.

Denyes Twp.

Tooms Twp.

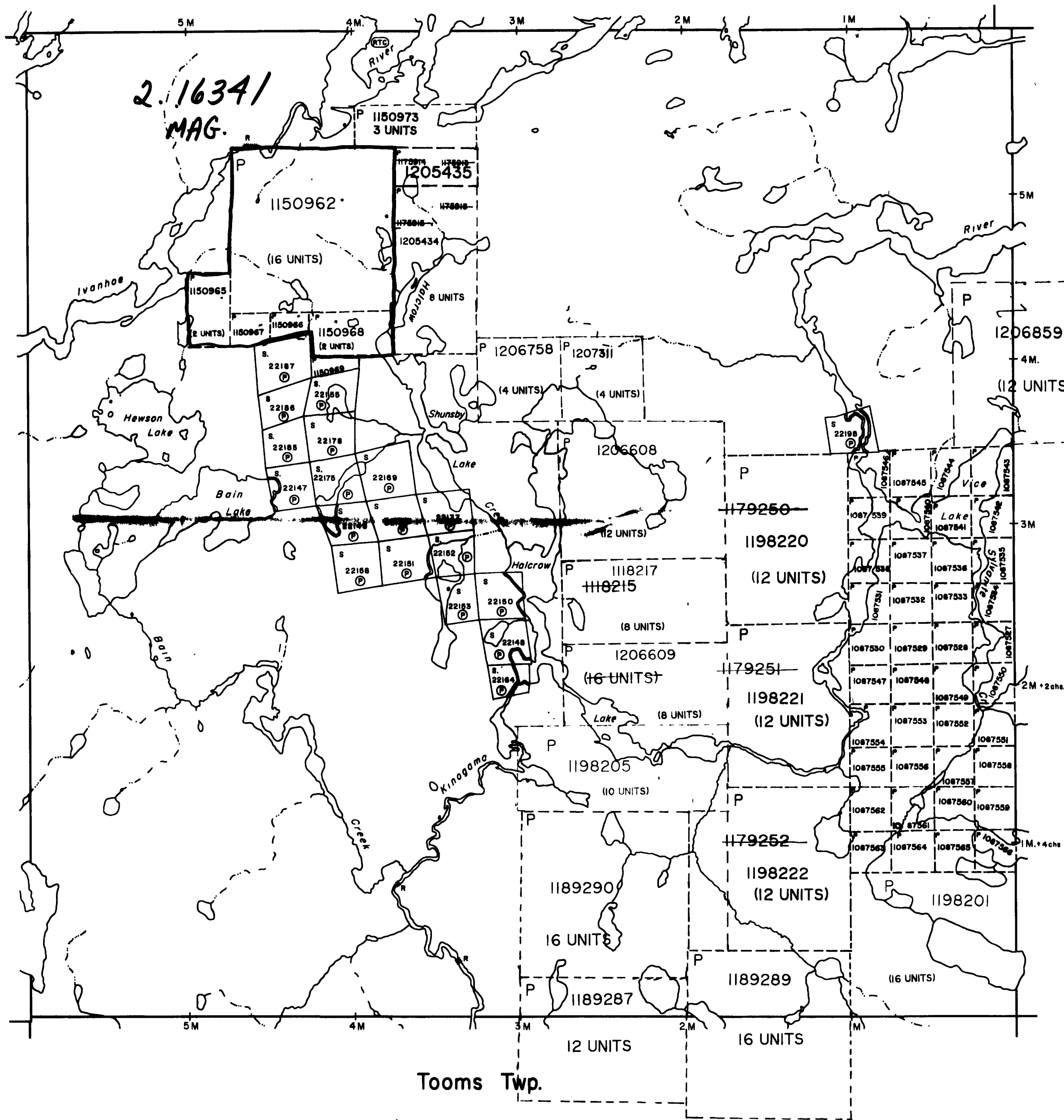

THE INFORMATION THAT APPEARS ON THIS MAP HAS BEEN COMPILED FROM VARIOUS SOURCES, AND ACCURACY IS NOT GUARANTEED. THOSE WISHING TO STAKE MINING CLAIMS SHOULD CONSULT WITH THE MINING RECORDER, MINISTRY OF

FORCUPINE 1135 DWG 100

LEGEND

- PATENTED LAND (P)
- CROWN LAND SALE (C.S)
- LEASES (L)
- LOCATED LAND (Loc.)
- LICENSE OF OCCUPATION (L.O.)
- MINING RIGHTS ONLY (M.R.O)
- SURFACE RIGHTS ONLY (S.R.O.)
- ROADS
- IMPROVED ROADS
- KING'S HIGHWAYS
- RAILWAYS
- POWER LINES
- MARSH OR MUSKEG
- MINES
- CANCELLED (C)
- (RTD) REMOTE TOURIST CAMP

SCALE 1 INCH = 40 CHAINS

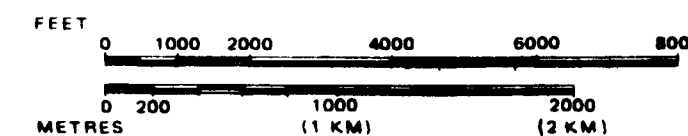

TOWNSHIP

HALCROW

RECEIVED
JAN 11 1996
MINING LANDS BRANCH

M.N.R ADMINISTRATIVE DISTRICT
CHAPLEAU
MINING DIVISION
PORCUPINE
LAND TITLES / REGISTRY DIVISION
SUBSURY



Ministry of Natural Resources

Ministry of Northern Development and Mines

Date MAY, 1992

Number

ACTIVATED JULY 14, 1992 BY D.C.

CHECKED BY G.W.

G-1135



410158W0037 2 16341 HALCROW

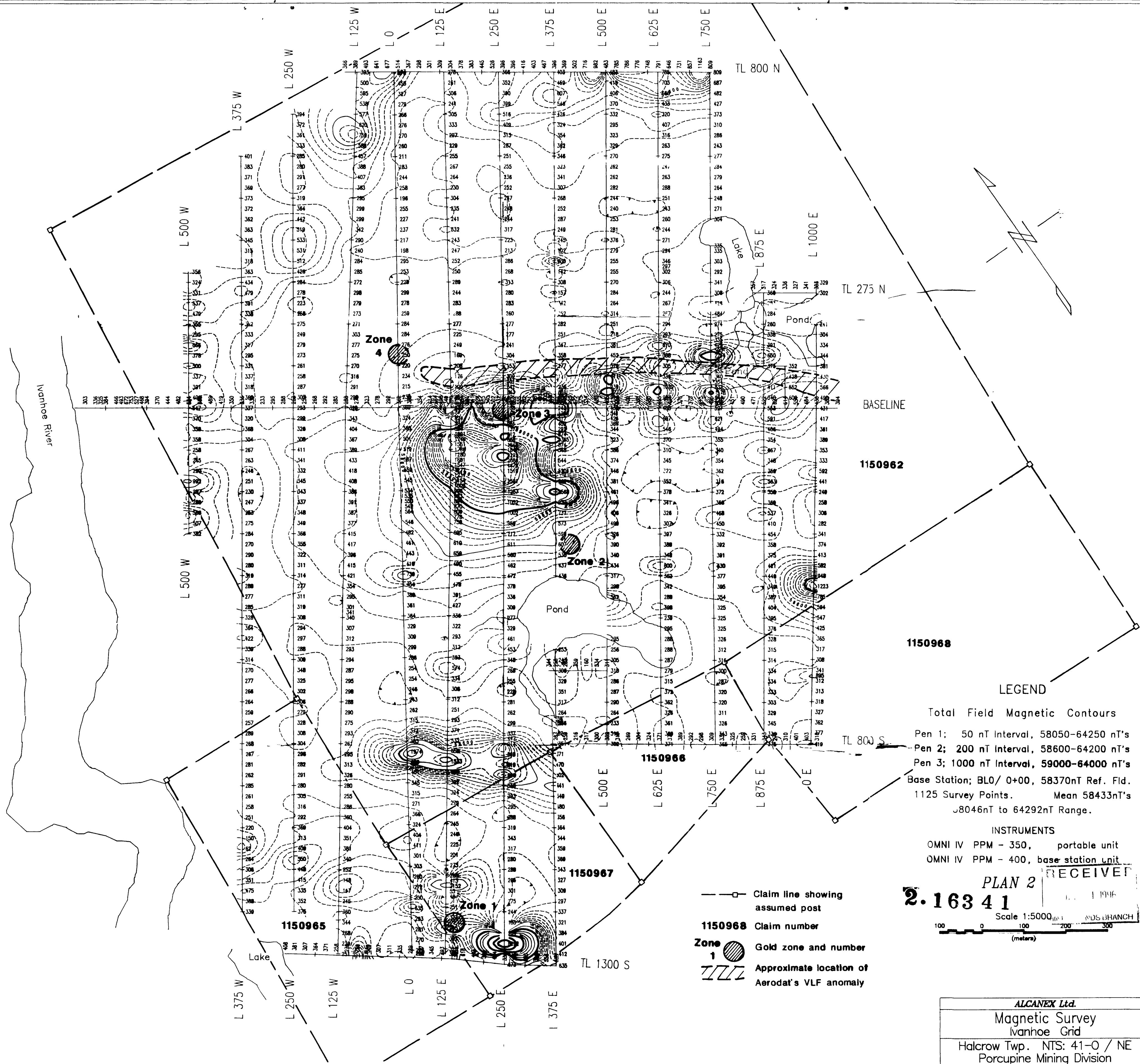

BASELINE

1150962

1150968

1150966

1150967

1150965

LEGEND

Total Field Magnetic Contours
 Pen 1; 50 nT Interval, 58050-64250 nT's
 Pen 2; 200 nT Interval, 58600-64200 nT's
 Pen 3; 1000 nT Interval, 59000-64000 nT's
 Base Station; BL0/ 0+00, 58370nT Ref. Fid.
 1125 Survey Points. Mean 58433nT's
 8046nT to 64292nT Range.

INSTRUMENTS
 OMNI IV PPM - 350, portable unit
 OMNI IV PPM - 400, base station unit

PLAN 2
2.16341
 Scale 1:5000
 (meters)

- Claim line showing assumed post
- 1150968** Claim number
- Gold zone and number
- Approximate location of Aerodat's VLF anomaly

ALCANEX Ltd.
 Magnetic Survey
 Ivanhoe Grid
 Halcrow Twp. NTS: 41-0 / NE
 Porcupine Mining Division
 M. C. Exploration Services Inc. Nov. 1994.

W A Troop

