



410155W9085 2.14953 DENYES

010

DENYES TWP.

EXPLORATION WORK REPORT ON:

- a) Prospecting,
- b) Hand stripping & sampling,
- c) Geology & Chip sampling,
- d) Plugger drill hole & dust sampling.

for

J.K.FILO & D.V.JONES

RECEIVED

MAR 25 1993

MINING LANDS BRANCH

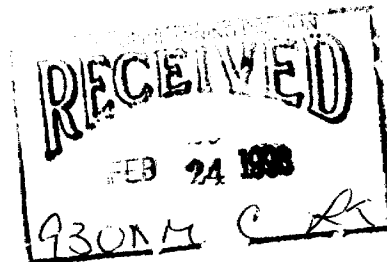

Feb. 18/93

by: J.K. FILO, H.BSc, P.GEO(BC)

2.14953



410155W9085 2.14953 DENYES

TABLE OF CONTENTS

	Page
Title page	i
Table of contents	ii
Introduction	1
Property, Location & Access	1
Property History	1
General Geology	4
Discussion of Present Exploration Work	6
Prospecting	6
Hand Stripping	6
Grid Establishment	7
Geology & Chip Sampling	7
Plugger Drilling & Dust Sampling	8
Conclusions & Recommendations	14
Bibliography	15
Appendix S2 : Sample Description	17
: Assays	19
Field Work Summary	23
Certification	24

LIST OF FIGURES

S1-1	Location of property	2
S2-1	Claim map	3
S2-3	Sylvanite/Erie Cdn trench & assay	5
S2-4	Area A : sample locations	10
S2-5	Area A : Geology	11
S2-6	Area B : sample locations	12
S2-7	Area B : Geology	13
S2-2	Grid map, areas of work, other sample locations	25

INTRODUCTION

During the 1992 field season Messrs. Jones and Filo carried out prospecting work on a 6 claim block in the northeast sector of Denyes Township.

Work on the property consisted mainly of prospecting, some geological mapping; and plugger dust, grab and chip sampling in the vicinity of the main mineralized gold occurrences. The work was carried out in order to take advantage of new exposure from recent stripping by previous owners Glen Auden Resources who did very minimal sampling.

Details of the prospecting work and sampling are presented within the following sections of this report.

PROPERTY, LOCATION AND ACCESS

The Denyes Prospect consists of six contiguous mining claims with the NW sector of Denyes Township (Fig. #S1-1 and #S2-1) numbered 1175907 to 1175912 inclusive. Access to the prospect may be attained by travelling west on Highway 101 from Timmins and accessing a network of new logging roads into Raney Township, just north of Denyes Lake. From this point access is available via trails and canoe through Denyes Lake and a hook-shaped lake labelled B on Fig. #S2-1. Alternatively, float plane access is available to Lake B from Ivanhoe Lake near Folyet, Ontario.

PROPERTY HISTORY

This occurrence was originally worked in the 1930's by Erie Canadian and Sylvanite Mines. The original name for the prospect is the Sylvanite occurrence. Erie Canadian and Sylvanite did a substantial amount of work on the main showing area including trenching and channel sampling. This work is documented in assessment File T-2072. This assessment file shows two chip sampled mineralized zones and the values quoted on these zones are 3.30/7.1 feet wide for 60.5 feet of strike length and 5.80/3.4 feet wide for 119.5' of strike length. This author believes numbers 3.30 and 5.80 to represent values in dollars for 1935 (map date) or \$35.16 gold in 1935 or .093 and .165 oz/ton Au. Some drilling was also carried out on this

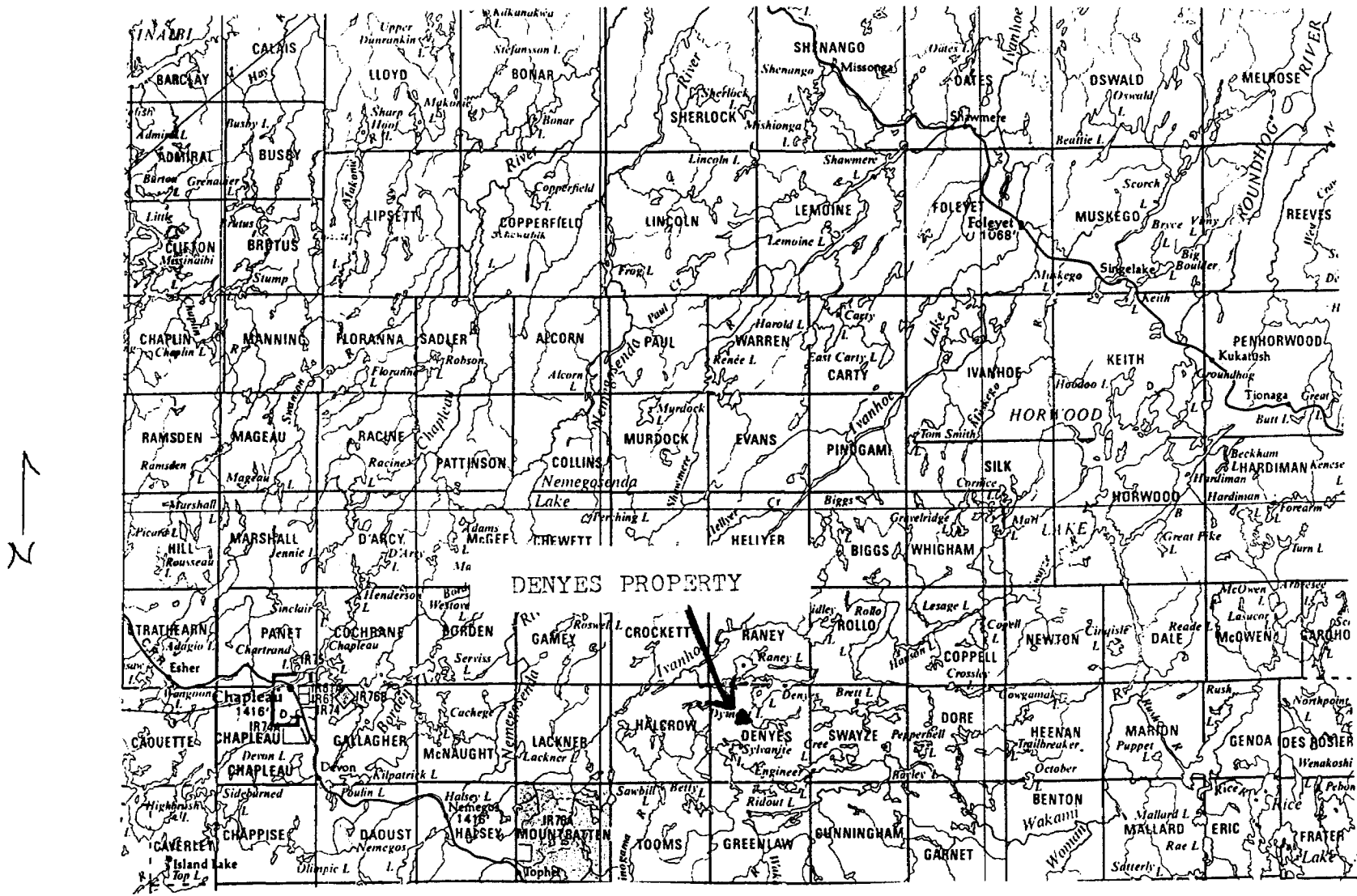

FIGURE : S1-1 Location of Denyes Twp. property
(Scale 1:600,000)

occurrence but no logs or assays are available, the author saw some of these old drill collars holes #3 and #5 shown in Fig. #S2-3.

Little work was carried out on this occurrence after the 1930's. Two major mining companies and one junior company worked it to a limited extent since 1930's. Falconbridge in 1974 mapped and sampled the prospect (Assays File T - 2068). Their results were not as promising as the Erie Canadian/Sylvanite sampling. The best result was 0.22 oz/ton over an 8.5 foot width and a strike length of 16 feet. With these results Falconbridge dropped the prospect. John Mansville, the next owner, carried out geophysical surveys including magnetics, VLF-EM and a radiometric survey over the entire prospect. They also mapped the property and did some limited sampling. John Mansville's best reported value from preliminary sampling was 0.202/ton Au over a 5 foot width.

Glen Auden from 1987-1989 did extensive stripping around the main showing as well as preliminary geophysics over the entire property. Glen Auden also mapped the main showings and carried out limited sampling. Their geologists and geophysicists recommended an induced polarization survey over the prospect.

It should be noted that in Glen Auden's assessment file (T-3036) report values quoted from Erie Canadian and Sylvanite are reported in oz/ton, and nowhere on any of the old maps does it designate values as oz/ton. This substantially elevates the values for this prospect and it is this author's belief that the numbers on old maps are in dollars and cents at \$35.16 gold typical of the period.

GENERAL GEOLOGY

The property was mapped by John Mansville in 1982 (assessment file T-2538). The extreme eastern portion of the present day claims (1175907 and 1175908) are the only claims to contain limited out crop. It is evident from Mansville's mapping that the property is underlain by a sequence of intercalated felsic and mafic volcanics as well as sediments. These units appear to have been intruded by a pink quartz feldspar porphyry unit which in some instances

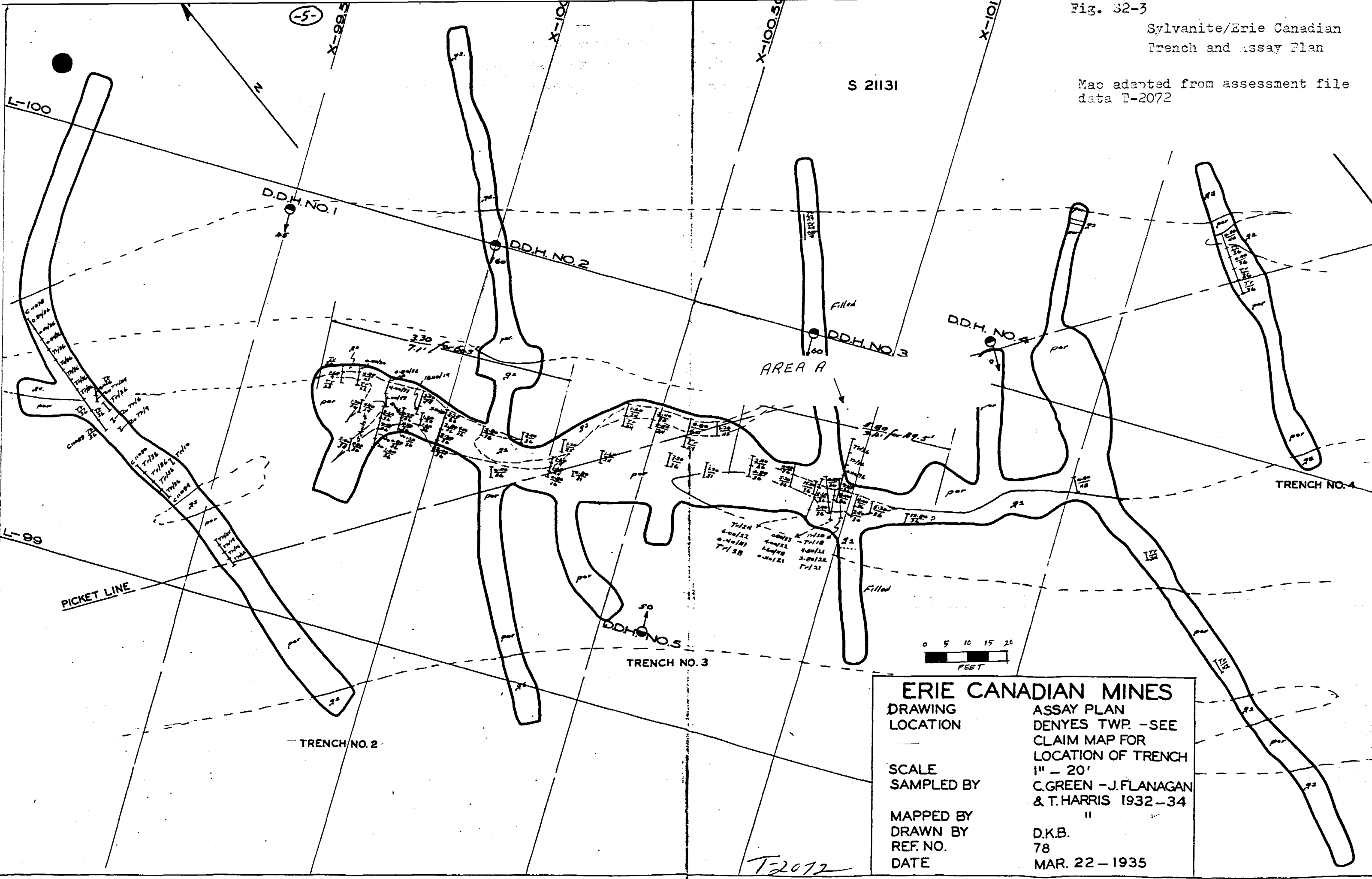

ERIE CANADIAN MINES
 DRAWING LOCATION ASSAY PLAN
 DENYES TWP. - SEE CLAIM MAP FOR LOCATION OF TRENCH
 SCALE 1" = 20'
 SAMPLED BY C. GREEN - J. FLANAGAN & T. HARRIS 1932-34
 MAPPED BY " "
 DRAWN BY D.K.B.
 REF. NO. 78
 DATE MAR. 22 - 1935

T-2072

is sheared and sericitized. Gold mineralization appears to be associated with quartz veining and sulphide on the contact of a major feldspar porphyry unit and volcanics.

A more detailed account of the subject property geology is presented by Falconbridge and John Mansville in assessment files T-2068 and T-2651 respectively. Reference may be made to these files for further information.

DISCUSSION OF PRESENT EXPLORATION PROGRAM

The exploration work performed for this report consisted of:

- a) Prospecting (Phase I and II)
- b) Hand stripping
- c) Grid establishment
- d) Geology & Chip sampling
- e) Plugger drill hole and dust sampling.

Prospecting (phase I):

As a preliminary reconnaissance of the old gold showings, the outcrop area that had previously been bulldozer stripped by Glen Auden Resources (Fig. S2-2) was prospected and sampled. Grab samples D-1 to D-16 were subsequently assayed with some extremely favourable results obtained. The better samples included assay values ranging from 363 ppb to 29005 ppb. ^{for gold} Appendix S-2 gives a more detailed description of each sample along with related assay reports.

All sample sites were marked with paint and later their locations were tied-in to the new grid lines that were established (Figs S2-2, S2-4, and S2-6).

Hand Stripping:

Prior to further work, areas A and B (see Fig S2-2) were hand cleaned and stripped of any debris and vegetation that had accumulated since the previous bulldozer work. Several pools of water that had formed on the stripped outcrop were used as a water source for "bucket" washing of the newly cleaned sites, after the heavier debris was removed with shovels.

Grid Establishment:

With fairly encouraging values from the preliminary sampling it was decided that a more extensive exploration program was warranted around areas A and B. Consequently a control grid was established by turning two new lines from the old Glen Auden grid (Fig. S2-2).

For area A a new line was turned at 120° , off of line 5 west at 125 south. This new line 125 S was chained with stations marked by paint at every two metre interval, within area A, and extended further west to map in samples D-1 and D-2, and also eastwards to tie into line 435 W.

Similarly, for area B, a new line was turned at 030° , off of BLO at station 435 west. This line 435 W was chained with two metre interval stations through area B, and was then extended south to allow mapping samples D-9 to D-12.

Geology & Chip Sampling:

Using the new grid lines as a mapping reference, both areas A and B were geologically mapped in detail. Area A consisted of a main quartz feldspar porphyry unit and sheared mafic volcanic unit. Sulphides existed principally along the contact, however numerous quartz veinlets and stringers were noted within the porphyry unit proximal to the main vein. The quartz stringers and veinlets were not sulphide bearing (Fig. S2-5).

Area B consisted mainly of a very contorted, sheared feldspar porphyry unit with a wide quartz vein running along its south western contact with a moderately foliated mafic volcanic unit (Fig. S2-7).

Although area B did not yield any encouraging assay values from the initial prospecting, promising visual structure and quartz veining suggested that something may have been overlooked. Consequently, chip sampling was performed along line 435 W, inbetween 0+18 south and 1+30 south (Fig S2-6). Samples D-18 to D-23 were collected where each sample consisted of chips collected over a two metre line length (ie. sample D-23 was from 0+18 S to 0+20 S).

Unfortunately, all assay values returned low gold values (refer to Appendix S2).

Plugger Drilling and Dust Sampling:

In an attempt to confirm the high gold assays that were obtained in phase I of the prospecting, and also to possibly delineate and expand the known mineralized zone, a plugger dust sampling program was undertaken.

An Atlas Copco Cobra (BBM47L) plugger with 3/4 inch drill steels, was used to drill .5 metre deep holes that were spaced approximately one metre apart. Thirty-four holes were drilled in area A with their locations being measured in to the new grid line 125 S (Fig. S2-4). A large inverted funnel was placed over each hole during drilling, with the drill steel being placed through the centre of the funnel. This allowed the drilling dust and chips to accumulate under the funnel which would then be periodically collected as a sample for that hole. All dust was collected from the beginning of each hole down to the bottom of the hole and bagged as one sample.

All holes were drilled within the quartz-feldspar porphyry and the main quartz vein that originally was thought to be the mineralized zone. As shown in Figure S2-4, and Appendix S2, the assays for the drill holes turned out to be quite low, ranging from nil to 1.11 grams per tonne. This situation was somewhat puzzling considering that original grab samples suggested good gold values in this area. Initially it was suspected that there may have been problems with the sampling technique but extreme care was taken when sampling was done.

Prospecting (phase II):

In order to try and resolve the discrepancy between the original high assays from grab samples and the low plugger drill sample assays, a second round of prospecting and sampling was performed. Area A was sampled in more detail and this consisted of taking a sample of vein material with sulphides; vein material with no sulphides; quartz vein material with sulphides; and some altered quartz feldspar wall rock(samples D-27 to D-29 inclusive).

A sample of volcanic wall rock with some quartz and 10% pyrite (fly rock from pit) was also taken (D-30). Every sample with pyrite contained at least anomalous gold, with values ranging from 0.05 oz/ton to 1.5 oz/ton Au. Sample D-28 with quartz and no pyrite had extremely low values. The area in which there are high gold values appears to be isolated within a narrow pyrite rich zone with quartz on the contact between the porphyry body and volcanics. This zone is on average 30 cm in width where exposed at surface.

From all of the sampling data to date in areaA, it is evident that quartz veining within the porphyry or volcanics and /or quartz veins along the contact without sulphides do not carry significant gold values.

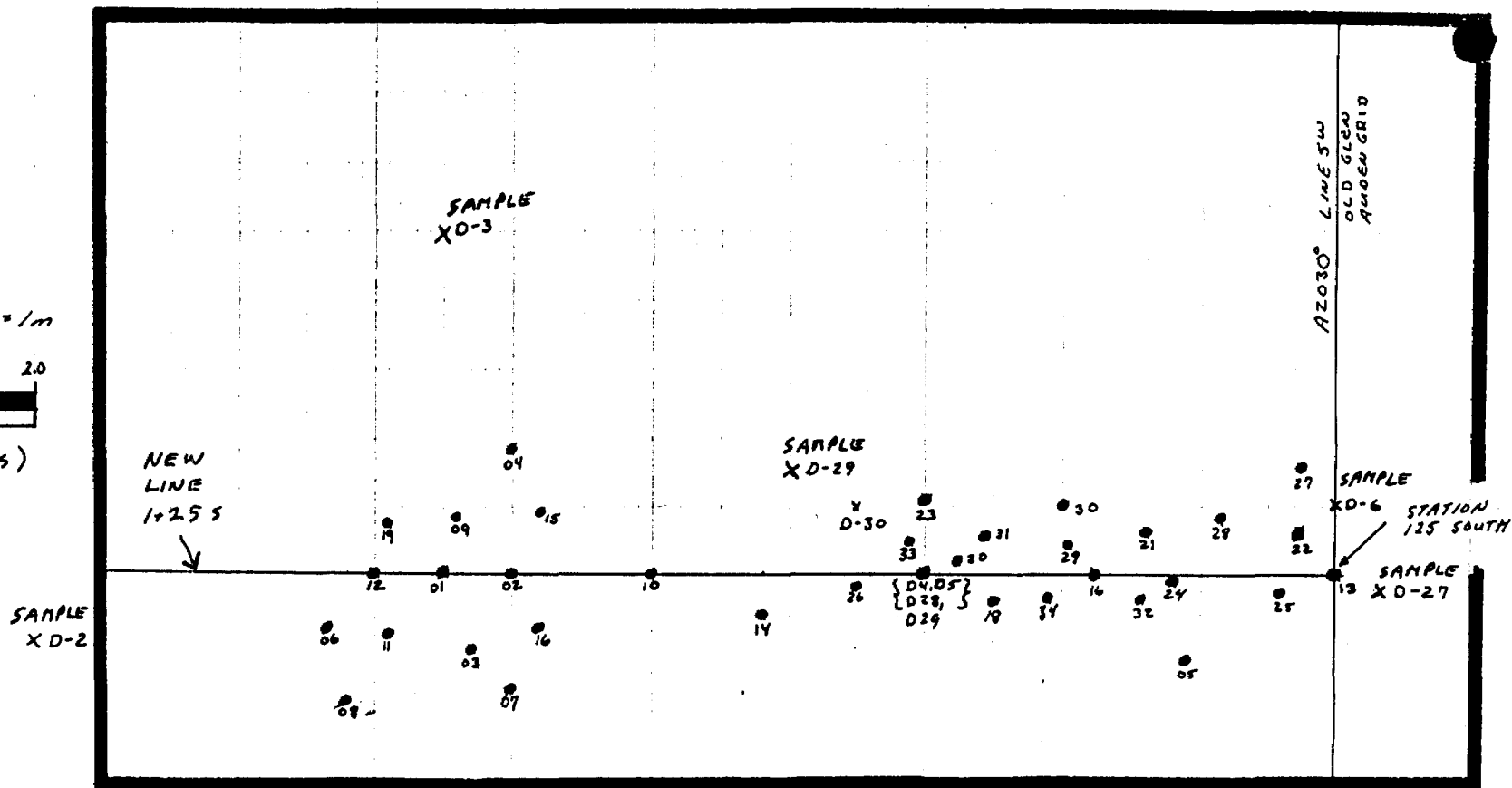
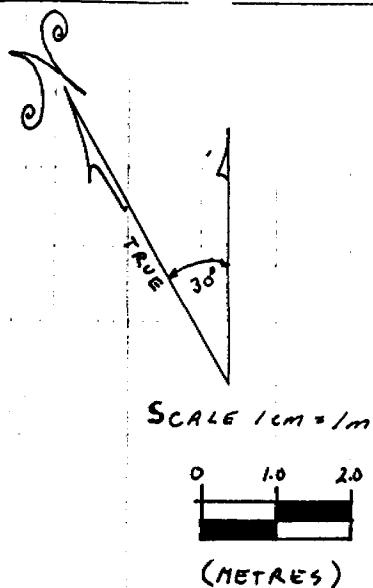

LEGEND

- PLUGGER DUST HOLE SAMPLE LOCATION (HILES = 0.5 METRE DEPTH)
- X D-2 - GRAB SAMPLE LOCATION

X NOTE

ALL SAMPLES SHOULD BE PREFIXED WITH 2247 i.e 224701, 224702 ETC. TO CORRESPOND WITH ASSAY SHEET IN APPENDIX (ORIGINAL)

SAMPLE VALUES

PLUGGER DUST SAMPLES IN GRAMS PER METRIC TONNE / 0.5m						GRAB IN -PPB	
01	0.01	13	NIL	25	0.50	02	NIL
02	0.01	14	0.05	26	0.03	03	13166
03	NIL	15	NIL	27	0.01	04	28800
04	0.13	16	0.07	28	0.05	05	480
05	0.01	17	0.04	29	0.11	06	165
06	NIL	18	0.84	30	0.28	07	1782
07	0.03	19	0.01	31	1.11	08	29
08	NIL	20	0.29	32	0.14	09	51,921
09	0.01	21	0.04	33	0.36	10	1822
10	NIL	22	NIL	34	0.82		
11	0.01	23	0.68				
12	0.07	24	0.12				

AREA "A": ENLARGED VIEW OF INSET SHOWN ON FIGURE S2-2.

FIG # S2-4

DETAILED SAMPLE LOCATION MAP FOR AREA A DENYES PROSPECT

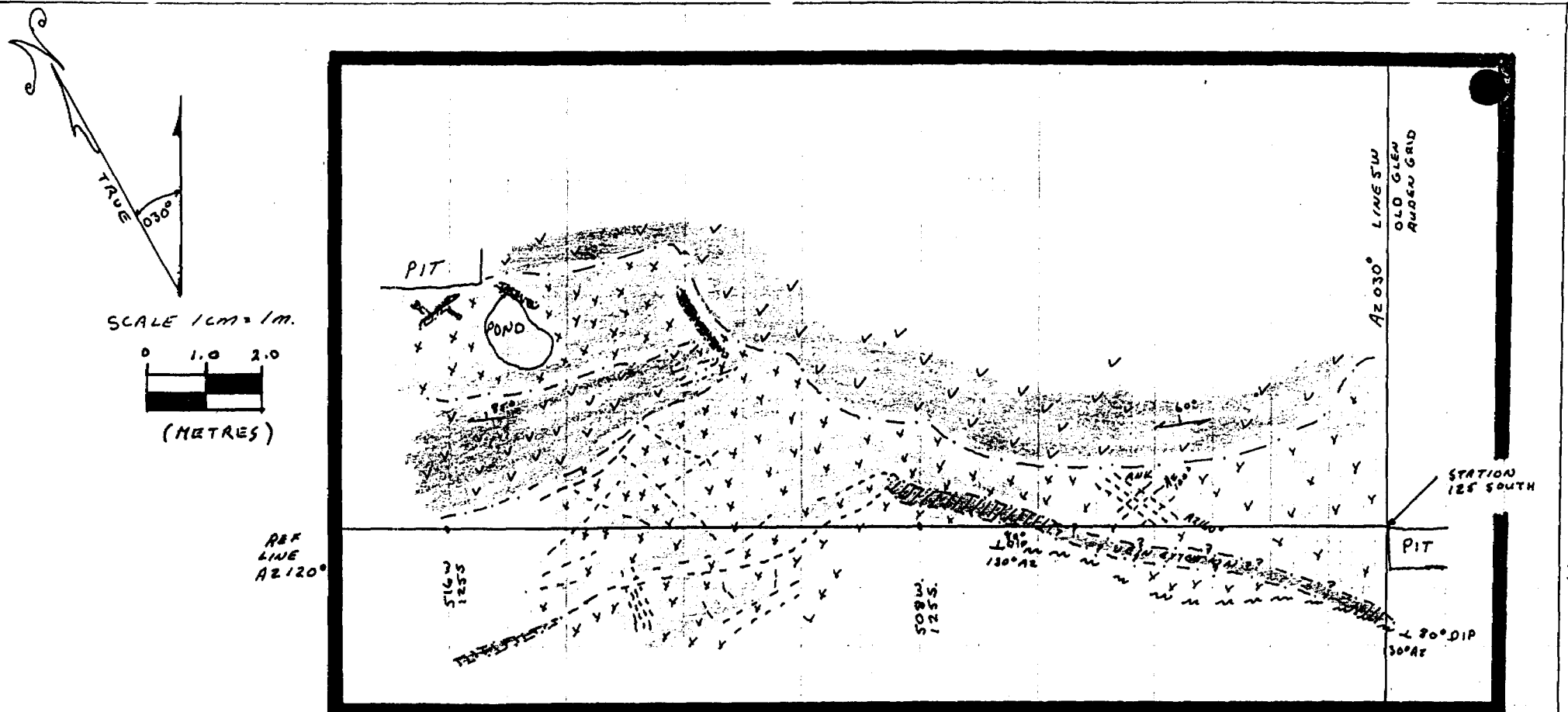

SCALE 1 CM = 1 M.

0 1.0 2.0



(METRES)

ABF
LINE
AZ 120°

516 W
125 S

508 W
125 S

130° AZ

PIT

70° DIP
30° AZ

STATION
125 SOUTH

LEGEND

PORPHYRY

- x - QUARTZ-FELDSPAR PORPHYRY
- stippled - MAFIC VOLCANIC (SHEARED)
- dashed - QUARTZ VEIN
- - STRINGER QUARTZ VEIN LET
- wavy - MINOR FAULT
- + - DIP & STRIKE OF CONTACT
- ↖ - DIP & STRIKE OF SHEAR
- ANK - ANKERITE

AREA "A"

ENLARGED VIEW
OF INSET SHOWN
ON FIGURE S2-2

FIG. # S2-5

GEOLOGICAL SKETCH MAP
FOR AREA A
DENYES PROSPECT

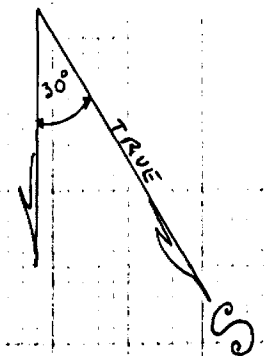

SCALE 1cm = 1m.

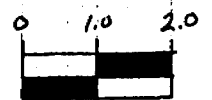

(METRES)

DETAILED SAMPLE LOCATION
MAP FOR DENYES TWP
AREA B

FIG 52-6

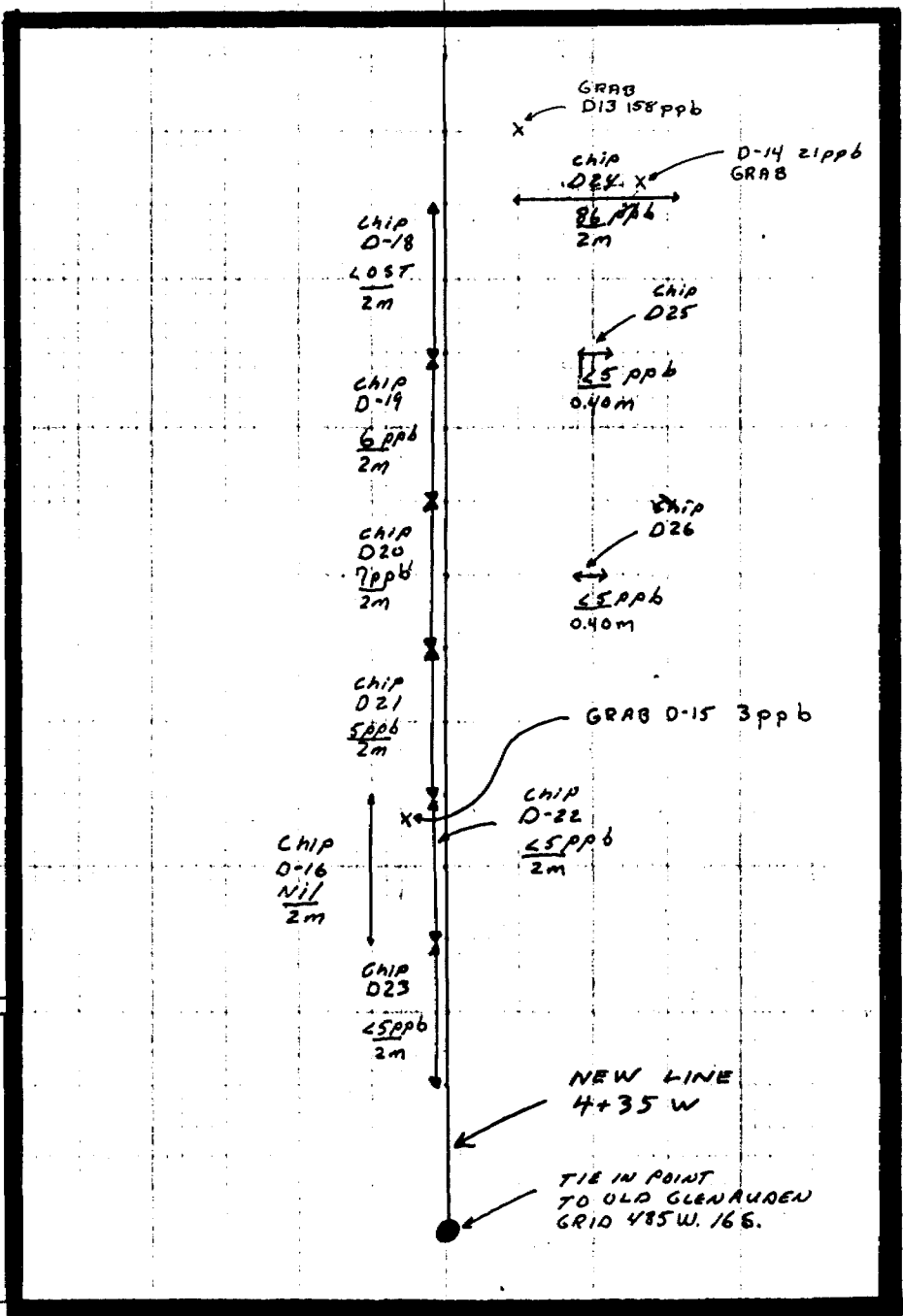

AREA "B"
ENLARGED
VIEW OF
INSET SHOWN
ON FIGURE
52-2

325

305

285

265

245

225

205

185

165

335
325
315
305
295
285
275
265
255
245
235
225
215
205
195
185
175
165

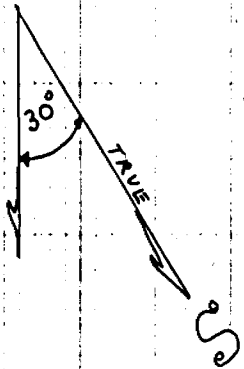

SCALE 1cm = 1m.

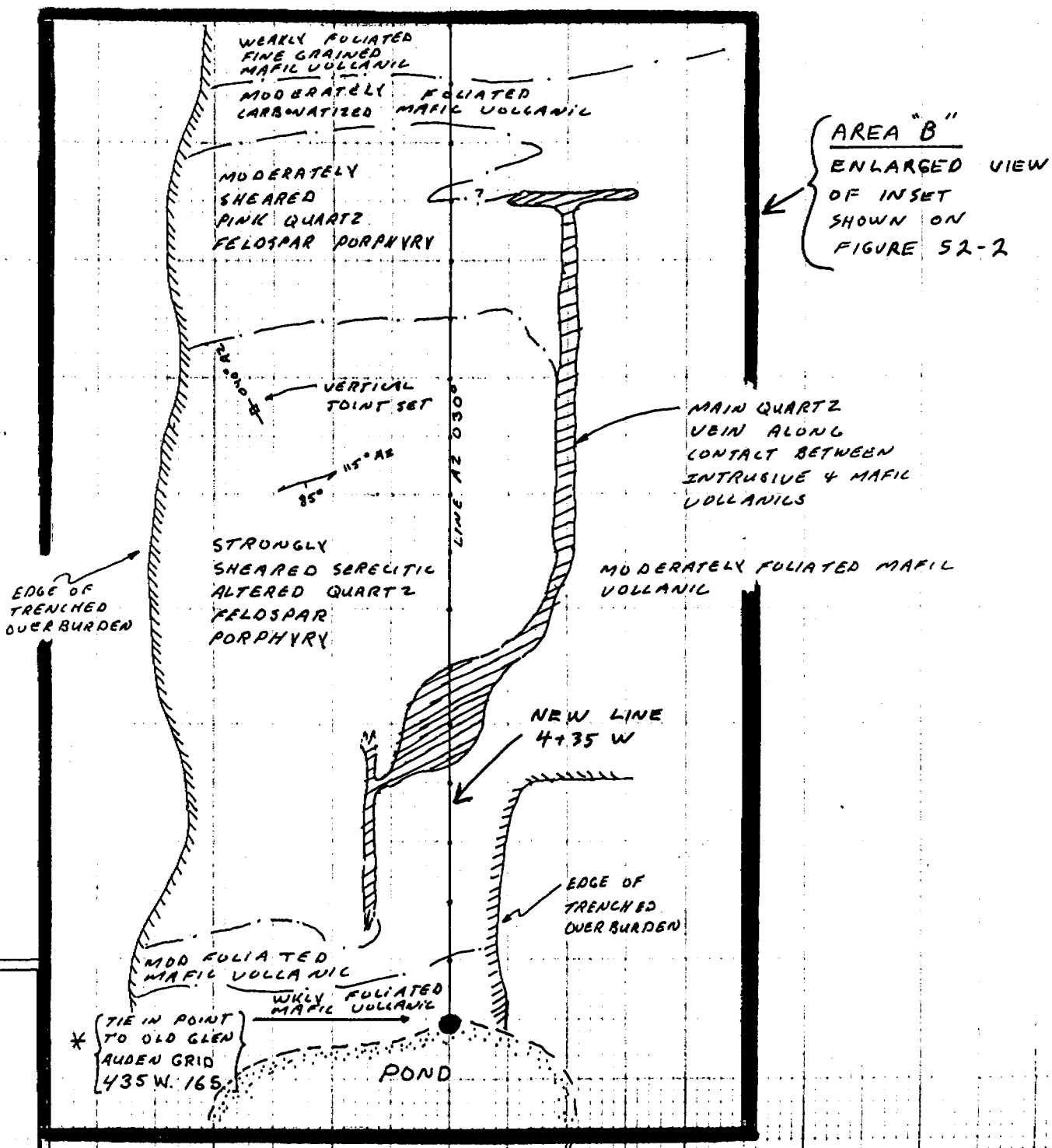
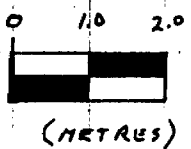

FIG 52-7
GEOLOGY SKETCH MAP
AREA B DENVER TWP
PROSPECT

-13-

CONCLUSIONS AND RECOMMENDATIONS

It is apparent that gold values on the Denyes project are related to narrow sulphide rich quartz bearing shear zones proximal to the contact of feldspar porphyry bodies and sheared mafic volcanics. The original Sylvanite/Erie Canadian zones appear to be too narrow to be of economic significance. However, the fact that there is high grade gold associated within pyritic rich zones bodes well for further exploration; it is possible that similar systems which may be larger may exist on the property. Further, it is obvious that little work has been done to explore for such systems outside the main showing area. These pyritic quartz shears are likely targets for conventional geophysics such as VLF-EM and/or Induced polarization.

This author recommends the following program to further evaluate this property:

- i) rehabilitate the old grid and carry out geophysical surveys including induced polarization and VLF-EM. A gamma ray spectrometer survey should also be considered. These surveys would help locate potential sulphide bearing zones proximal to feldspar-porphyry bodies.
- ii) upon completion of these surveys targets could be prioritized for mechanized stripping and sampling as there is winter road access for heavy equipment.
- iii) further work including diamond drilling would be contingent on the results of the first portion of the program.

Respectfully submitted,

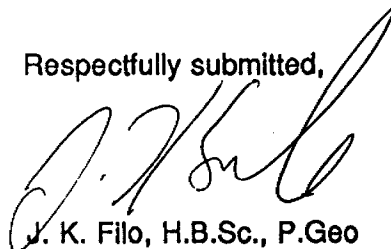

J. K. Filo, H.B.Sc., P.Geo

BIBLIOGRAPHY FOR DENYES PROPERTY

Abernathy, R.K., 1987, Report on the Property of Glen Auden Resources Limited, Denyes Township, Porcupine Mine Division, District of Cochrane

Donovan, J.E., 1968, Geology of the Halcrow Rideout Area, District of Sudbury, Ontario; Ontario Department of Mines Geological Report 63, 43p. Accompanied by Maps 2120 & 2121, Scale 1" = ½ mile

Erie Canadian, 1932-1940, Sketch Maps of Trenches and Assay Plan (Assessment File T-2072)

Evelegh, F. J., 1982, Report on Geophysical Surveys, Sylvanite Group of Claims, Denyes Township, Porcupine Mining Division, Province of Ontario, Johns Manville Canada Inc. (Assessment File T-2538)

Evelegh, F. J., 1985, Report on Geological and Radiometric Surveys, Sylvanite Group of Claims, Denyes Township, Porcupine Mining Division, Province of Ontario, Johns Manville Canada Inc. (Assessment File T-2656)

Kelly, J. A., P.Eng., 1973, Geological Report on Claims S355237-242 Inclusive, Denyes Township, Porcupine Mining Division, Ontario, Falconbridge Nickel Mines Limited (Assessment File T-2068)

APPENDIX S2

SAMPLE DESCRIPTION

AND

ASSAYS

SAMPLE DESCRIPTION

- D - 1
(Grab) • quartz veinlets (stringers) in quartz feldspar porphyry pink, minor fine cubic pyrite in wall rock and veinlets
- D - 2
(Grab) • quartz feldspar porphyry (pink) minor pyrite 1-2%
- D - 3
(Grab) • quartz carbonate zone with shear, cubic coarse pyrite and fine disseminated pyrite (15-20%) quartz content 20-25% approximately
- D - 4
(Grab) • contact zone between porphyry and sheared volcanic, quartz carbonate with 15-20% pyrite (10% quartz content)
- D - 5
(Grab) • bull white quartz adjacent contact of quartz / carbonate zone, main vein present on showing
- D - 6
(Grab) • altered sericite quartz-feldspar porphyry with fine sulphide and quartz veining, sulphide content 2-4%
- D - 7
(Grab) • quartz carbonate, some grey black volcanic within a shear, 10-15% cubic pyrite, minor quartz
- D - 8
(Grab) • quartz vein on contact of feldspar porphyry and sheared volcanic
- D - 9
(Grab) • quartz carbonate, fine pyrite 10-15% (possible fly rock from trenching)
- D - 10
(Grab) • contact between sheared porphyry and volcanic minor quartz and sulphide
- D - 11
(Grab) • sericitic quartz - feldspar porphyry and volcanic, some quartz stringers and sulphide content 4-5%
- D - 12
(Grab) • quartz vein on contact of porphyry and sheared volcanic
- D - 13
(Grab) • quartz carbonate vein minor sulphide, sample on contact between sheared volcanic and extremely sheared altered sericitic feldspar porphyry
- D - 14
(Grab) • quartz vein in sheared altered quartz feldspar sericitic porphyry host
- D - 15
(Grab) • chip sample of sheared feldspar porphyry, sericitic, no significant sulphide
- D - 16
(Grab) • chip sample of sheared feldspar porphyry, sericitic, no significant sulphide
- D - 17 • no such sample

- D - 18 (Chip) • sheared sericitic, carbonated quartz feldspar porphyry (sent for assay but lost)
- D - 19 (Chip) • as in D - 18
- D - 20 (Chip) • as in D - 18
- D - 21 (Chip) • as in D - 18
- D - 22 (Chip) • sheared sericitic carbonated quartz feldspar porphyry with veining 60% quartz, 40% quartz-feldspar porphyry
- D - 23 (Chip) • as in D - 18
- D - 24 (Chip) • quartz vein chip, no significant sulphide noted
- D - 25 (Chip) • as in D - 24
- D - 26 (Chip) • as in D - 24
- D - 27 (Grab) • 90% quartz vein material with 5-10% sub-hedral pyrite
- D - 28 (Grab) • quartz vein, with a speck of pyrite almost 100% quartz
- D - 29 (Grab) • quartz vein 3-4% sub-hedral pyrite, some altered minor quartz feldspar porphyry wall rock in vein as well
- D - 30 (Grab) • silicified grey volcanic with some quartz and fine sulphide, 10% disseminated pyrite, minor chalcopyrite, possible fly rock not from proposed location may be a few meters away

NOTES

- i) chip samples within seen on map
- ii) samples 225701 - 224734 are dust samples, lithology for these samples is shown in sketches in figures (S2-4,5)



Established 1928

Swastika Laboratories

A Division of Assayers Corporation Ltd.

Assaying - Consulting - Representation

Page 1 of 2

2W-0878-PA1

Assay Certificate

Company: **K. FILO**
Project:
Attn:

Date: **AUG-21-92**
Copy 1. 535 BARTLEMAN, TIMMINS P4N 4X2
2. FAX 235-2474

We hereby certify the following Assay of 34 PULP samples submitted AUG-14-92 by .

Sample Number	Au g/tonne	Au check g/tonne
224701	0.01	
224702	0.01	
224703	Nil	
224704	0.13	0.12
224705	0.01	
224706	Nil	
224707	0.03	
224708	Nil	
224709	0.01	
224710	Nil	
224711	0.01	
224712	0.07	
224713	Nil	
224714	0.05	
224715	Nil	
224716	0.07	
224717	0.04	
224718	0.84	0.96
224719	0.01	
224720	0.29	
224721	0.04	
224722	Nil	
224723	0.68	0.89
224724	0.12	
224725	0.50	
224726	0.03	
224727	0.01	
224728	0.05	
224729	0.11	
224730	0.28	

Certified by Donna Gardner



Established 1928

- 20 -
Swastika Laboratories

A Division of Assayers Corporation Ltd.

Assaying - Consulting - Representation

Page 2 of 2

Assay Certificate

2W-0878-PA1

Company: **K. FILO**

Date: **AUG-21-92**

Project:

Copy 1. 535 BARTLEMAN, TIMMINS P4N 4X2

Attn:

2. FAX 235-2474

We hereby certify the following Assay of 34 PULP samples submitted AUG-14-92 by .

Sample Number	Au g/tonne	Au check g/tonne
224731	1.13	1.11
224732	0.14	
224733	0.30	
224734	0.82	0.82

Certified by Donna Gardner



Established 1928

Swastika Laboratories

A Division of Assayers Corporation Ltd.

Assaying - Consulting - Representation

*Dewkes
TWP*

Geochemical Analysis Certificate

2W-0516-RG1

Company: **K. FILO**

Date: MAY-29-92

Project:

Attn:

We hereby certify the following Geochemical Analysis of 16 ROCK samples submitted MAY-27-92 by .

Sample Number	Au PPB	Au check PPB
D1	843	
D2	Nil	
D3	13166	13508
D4	28800	29005
D5	480	209
D6	165	
D7	5143	5897
D8	363	
D9	230	
D10	761	
D11	4224	4565
D12	31	
D13	158	
D14	21	
D15	3	
D16	Nil	

Certified by *Donna Gardner*

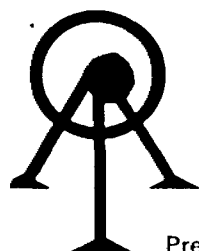

ACCURASSAY LABORATORIES

A DIVISION OF BARRINGER LABORATORIES LIMITED, REXDALE, ONTARIO
BOX 426
KIRKLAND LAKE, ONTARIO, CANADA P2N 3J1
TEL.: (705) 567-3361

President: Dr. GEORGE DUNCAN, M.Sc., Ph. D., C. Chem (Ont.), C. Chem (U.K.), M.C.I.C., M.R.S.C., A.R.C.S.T.

46108

Certificate of Analysis

Page: 1

Filo, Mr. J.K.
535 Bartleman St.
Timmins, Ontario
P4N 4X2

October 2

92

Work Order # : 920356
Project :

Accurassay	SAMPLE NUMBERS Customer	Gold ppb	Gold Oz/T	
260178	D-19	6	<0.001	
260179	D-20	7	<0.001	
260180	D-21	5	<0.001	
260181	D-22	<5	<0.001	
260182	D-23	<5	<0.001	
260183	D-24	86	0.002	
260184	D-25	<5	<0.001	
260185	D-26	<5	<0.001	
260186	D-27	1782	0.052	
260187	D-28	29	0.001	
260187	D-28	54	0.002	Check
260188	D-29	51921	1.511	
260189	D-30	1822	0.053	
260189	D-30	2010	0.058	Check

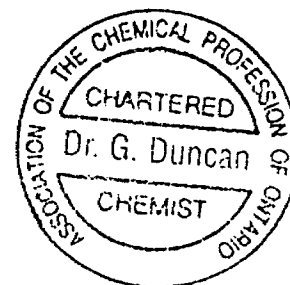

Per: Dr. G. Duncan

ORIGINAL

FIELD WORK SUMMARY

Type of Work	Dates field work performed (1992)	Notes **
PROSPECTING	May 22 (Jones & Filo) Sept 27 (Jones & Filo)	
GEOLOGY	July 21 (Filo) July 29 (Jones & Filo) Sept 29 (Filo)	- supervised by Filo
PHYSICAL WORK		
a) Hand Strip	July 22 (Jones & Filo)	2 man-days @ \$150/man-day
b) Plugger Drill & Dust Sample	July 25 to 28 (Jones & Filo) Aug 6 to 8 (Jones & Filo)	14 man-days @ \$150/man-day
c) Mob - Demob	July 23, Sept 28 (Jones & Filo)	4 man-days @ \$150/man-day

** All field work was performed by both :

1) J. Kevin Filo
535 Bartleman St.
Timmins, Ont.
P4N 4X2
Lic. # M25052

and

2) David V. Jones
Box 1513
South Porcupine, Ont.
P0N 1H0
Lic. # M21190

J. K. Filo
.....

D. V. Jones
.....

CERTIFICATE

I, J.K.Filo of 535 Bartlemen St., Timmins, Ontario, do hereby certify that:

- 1) I personally worked on all phases of the exploration program in this report.
- 2) I am the author of this exploration work report and I have reviewed all pertinent assessment file data, geological reports and pertinent information pertaining to this prospect and adjoining areas prior to writing this report.
- 3) I hold an Honours Bachelor of Science degree in geology from Laurentian University, Sudbury, Ont. (1980) and I am a member of the Association of Professional Engineers and Geoscientists of British Columbia.
- 4) I have been practising my profession as an exploration and mine geologist for just over 12 years.
- 5) I hold some interest in all of the property mentioned in this report.



J.K.Filo, HBSce., P.Geo(BC)



020

Report on
 PROSPECTING TRAVERSES
 in
 HALCROW TP.
 for
 D.V. JONES & J.K. FILO

RECEIVED

MAR 25 1993

MINING LANDS BRANCH

Jan. 23/93

RECEIVED
 FEB 24 1993
 930 c [Signature]

2.14953

by: J.K.Gilo, H.BSc,P.GEO (B.C.)
 Quant-2.7466

INTRODUCTION

During the field season of 1992, Messrs. D. Jones & K. Filo investigated reported gold mineralization on their Halcrow Prospect within the Swayze Greenstone Belt.

This prospecting was initiated to examine previous work in the field first hand and substantiate reported values. An account of the findings from this work and recommendations are documented within the following portions of this text.

PROPERTY, LOCATION AND ACCESS

The prospects consists of 4 contiguous claims numbered 1175913 to 1175916 inclusive in the extreme north central portion of Halcrow Township (Fig. #S1-1&2). Access to the property is attained by heading west of Timmins on Highway 101. A network of new logging roads into the Swayze Belt from Highway 101 allows access to a long lake "A" (Fig. #S1-~~3~~²) between the two to three mile posts on the Halcrow/Crockett Township boundary. From this lake it is a short walk or canoe trip to the subject property. Alternatively a float plane can be taken from Ivanhoe Lake near Folyet and one may utilize Lake A for float plane access.

PROPERTY HISTORY

This prospect was originally known as the Lyell-Beldman occurrence and this showing was worked since the 1930's. Donovan (O.G.S. Report 63) has a description of the main occurrence by a previous Government Geologist Rickaby in 1934. This excerpt is as follows:

...The principal showings occur...about one mile north of the north end of Shunsby lake. The country rock consists of sediments, including conglomerate of the Swayze series, which have been intruded by large dikes or bosses of reddish syenite porphyry, and later by narrow dikes of mica lamprophyre. The porphyry body in which the showings occur has a width of at least 800 feet from north to south; its length cannot be determined owing to overburden. A series of trenches over a length of 200 feet shows a fracture zone in the porphyry striking approximately east and west. The fractures have been filled with quartz in the form of narrow veinlets, and the porphyry has been replaced by moderate amounts of pyrite and arsenopyrite.

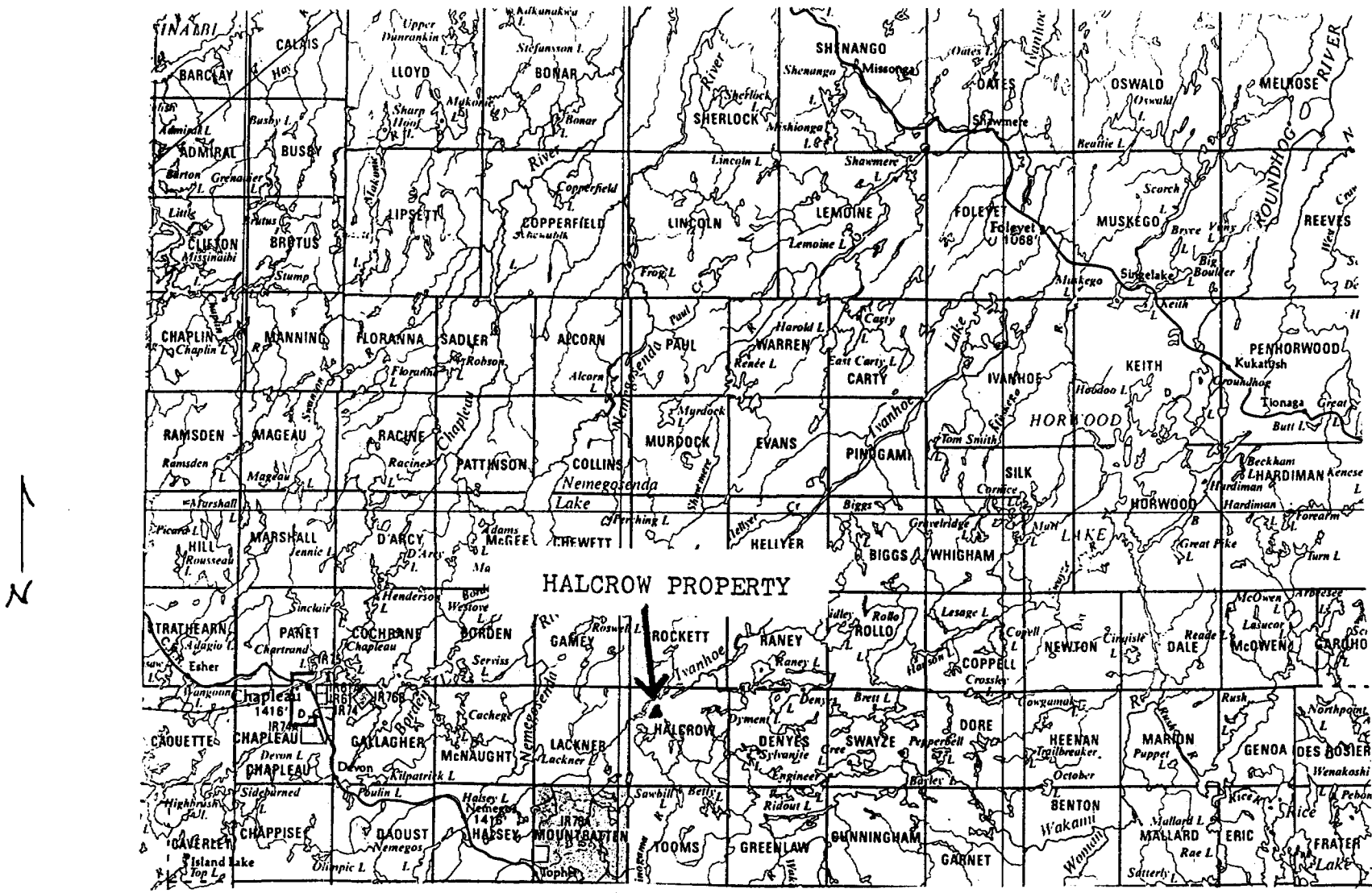

FIGURE : S1-1 Location of Halcrow property
 (Scale 1:600,000)

One hundred feet north another fracture zone with a northeast strike shows a similar condition but with more quartz and heavier mineralization over widths up to 3 feet or more. The linear extent of this fracture has not been determined.

The oxidized material from these two zones pans gold very freely, and some fine native gold was noted in one place. Selected grab samples from these showings are reported to give high values in gold. Two chip samples taken across 18 inches and 24 inches in the north pit have 0.03 ounces per ton in gold. The owners plan further extensive surface work on this property in the near future.

After the 1930's there is relatively little documented work. In 1966 Dalhousie Oil and Gas put a few holes into this prospect with an x-ray drill; holes ranged in length from 35' - 100' and the total program was 400'. Sulpetro in 1981 researched the Dalhousie work further and found that no significant values were obtained in the drilling. However, Sulpetro did some re-sampling of the pits and attained a gold value of 4.35 grams/tonne Au. (Assessment File # 2472). Sulpetro also carried out a VLF-EM survey, HL-EM survey and a magnetometer survey. The geophysicists felt there was some correlation with the geophysics and mineralized zones. But, due to the disseminated nature of the mineralization an induced polarization (I.P.) survey was recommended to help define the best areas to drill in the vicinity of the main showing and evaluate other areas of interest. This I.P. work was never carried out and the project was dropped for no apparent reason.

GENERAL GEOLOGY

There is relatively a small amount of exposure on this prospect. Government geology maps (Map 2120, Fig. #S1-3) and assessment file maps (Sulpetro) suggest the property is underlain by east-west striking mafic volcanics, sediments and felsic volcanics. This suite of volcanics is intruded by reddish quartz feldspar porphyry and grey feldspar porphyry. During the course of prospecting this author personally examined the porphyry units and confirmed the presence of sediments (conglomerate) reported by Rickaby (1934) and Donovan (O.G.S. Map 2120, Fig. #S1-3). The sediments were sheared and shear orientations ranged from 040°Az to

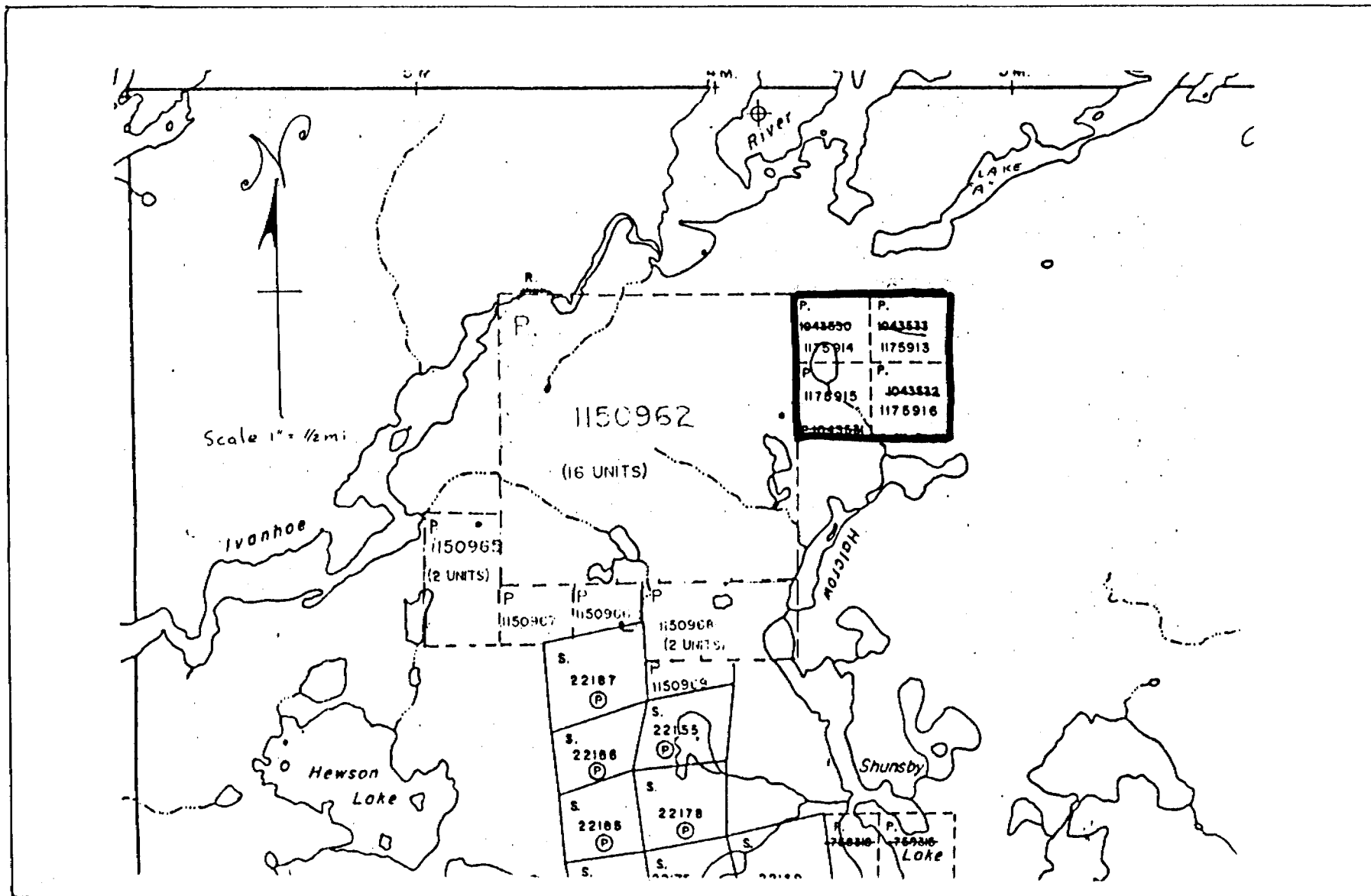

Fig. S1-2

Claim Location Map for
Halcrow Prospect

070° Az.

This structural deformation is probably related to the Kapuskasing High which exists a short distance from this prospect (Reference OGS Map 2221). It is quite likely that substantial deformation occurred on this prospect, this may not be readily evident due to limited exposure. Such deformation is usually spatially associated with gold deposits. A more detailed account of the geology on this prospect is given by Beecham (1981) and this may be referred to in Assessment File T-2471.

DISCUSSION OF PROSPECTING WORK

Upon location of the trenches on this prospect a preliminary examination of the trenches was made and representative sampling carried out. The majority of time was spent on the main occurrence (Fig. #S1-4) where Sulpetro obtained a gold value of 4.35 grams/tonne Au. Substantial trenching was carried out by previous owners at this location. These pits and trenches were roughly 2-4 m in depth and in many instances there was substantial caving. Considerable time was spent selecting representative samples from these pits and trenches by sorting through the old muck piles as well as digging sluff material from the walls.

The values obtained from sampling on this property including the main showing area were very poor; the more anomalous values ranged from 0.01 oz/ton to 0.042 oz/ton Au. Other values were significantly less. None of the values were as high as the 4.35 grams/tonne Au obtained from Sulpetro. Mineralization, namely fine disseminated sulphide usually 2% pyrite, was noted and some narrow quartz stringers were seen as well. The mineralization in the pit areas is local and not pervasive. Results to date suggest there is some association between the gold and sulphide.

The lack of more significant assays and pervasive mineralization in the main showing area and the low values in a quartz vein in the sediments prompted prospecting efforts to be curtailed on this claim block.

CONCLUSIONS AND RECOMMENDATIONS

Prospecting efforts on the Halcrow Prospect showed that gold values on the main zone were anomalous at best and did not attain values comparable to Sulpetro's 4.35 grams/tonnes Au. Mineralization (pyrite) appears to be very sporadic and when it is present it is usually found to be fine and disseminated. Limited sampling carried out by the prospectors suggest there may be some correlation between gold mineralization and pyrite.

In light of the fact there is anomalous gold located within a rather large porphyritic intrusive system there is the possibility that a deposit may exist along strike or at depth proximal to the main showing or in association with the geophysical targets obtained by Sulpetro. In light of the fact that this area is now reasonably accessible by road, a possible further evaluation of the main zone and Sulpetro targets could be done via mechanized stripping instead of I.P. as recommended by Sulpetro. This would allow for better sampling and a "hands on" evaluation of the Sulpetro targets. Further work on this project would be contingent upon the results of this preliminary program.

Respectfully submitted,

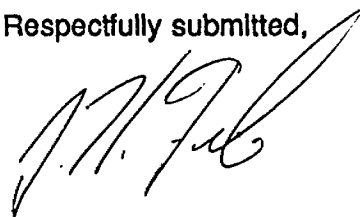

J. K. Filo, P. Geo.

BIBLIOGRAPHY FOR HALCROW PROPERTY

Beecham A.W. (Sulpetro)

1981: Geological Mapping, Halcrow Township Claims, Project 3383.1, Claims P565751 - P565754, P565775 and P565779 Porcupine Mining Division Ontario; Assessment File T - 2471

Donovan J.E.

1968: Geology of the Halcrow - Rideout area, District of Sudbury; Ontario Department of Mines, Geological Report 63, 43p. Accompanied by Maps 2120 and 2121, Scale 1" = ½ mile

Dalhousie Oil and Gas

1966: Diamond Drill Logs, Assessment File T - 2103

Lai K. (Sulpetro)

1981: Horizontal Loop electromagnetic, VLF and Magnemeter Surveys, Project 3381.1 Claims P565751 to P565754, P565775 and P565779, Porcupine Mining Division, Assessment File T-2472

Ontario Geological Survey

Chapleau-Folyet Geological Compilation Map 2221 Scale 1:250,000

APPENDIX S -1

SAMPLE DESCRIPTION

AND

ASSAY RESULTS

SAMPLE DESCRIPTION

- H - 1
(Grab) • 95% quartz and altered wallrock along vein salvage, no significant sulphide noted
- H - 2
(Grab) • Quartz vein with no significant sulphide
- H - 3
(Grab) • fine to medium grained quartz - feldspar porphyry pink to red in colour with 1-2% fine pyrite
- H - 4
(Grab) • 49% quartz and 49% quartz - feldspar porphyry, phenocrysts not as pronounced, quartz appears as quartz eyes. 2% sub-hedral pyrite in sample
- H - 5
(Grab) • pinkish grey quartz - feldspar porphyry, minor pyrite and chalcopyrite 1-2% combined
- H - 6
(Grab) • pinkish - grey quartz feldspar porphyry, minor disseminated pyrite 1-2%
- H - 7
(Grab) • fine to medium grained quartz feldspar porphyry, mainly grey in colour with a slight tinge of pink, rare speck of pyrite
- H - 8
(Grab) • grey and pink quartz - feldspar porphyry with 3% fine pyrite disseminated throughout it
- H - 9
(Grab) • good quartz feldspar porphyry pink in colour, rare speck of pyrite noted, some limonite on fractures
- H - 10
(Grab) • grey medium grained - feldspar porphyry, no significant sulphide noted, very minor quartz stringer



ACCURASSAY LABORATORIES
 A DIVISION OF BARRINGER LABORATORIES LIMITED, REXDALE, ONTARIO
 BOX 426
 KIRKLAND LAKE, ONTARIO, CANADA P2N 3J1
 TEL.: (705) 567-3361

President: Dr. GEORGE DUNCAN, M.Sc., Ph. D., C. Chem (Ont.), C. Chem (U.K.), M.C.I.C., M.R.S.C., A.R.C.S.T

45439

Certificate of Analysis

Page: 1

D. V. Jones
 P.O. Box 1513
 SOUTH PORCUPINE, Ontario
 PON 1H0

June 24

Work Order # : 920203
 Project :

Accurassay	SAMPLE NUMBERS	Customer	Copper ppm	Nickel ppm
	255755	H-1	25	
	255756	H-2	13	
	255757	H-3	38	
	255758	H-4	26	
	255759	H-5	170	
	255760	H-6	13	
	255761	H-7	97	
	255762	H-8	23	
	255763	H-9	28	
	255764	H-10	10	

*HALLOW TWP
 PROJECT*



ACCUR
A DIVISION OF BAF

KIRKLANI

President: Dr. GEORGE DUNC,

AY LABORATORIES

LABORATORIES LIMITED, REXDALE, ONTARIO

BOX 426

ONTARIO, CANADA P2N 3J1

TEL: (705) 567-3361

Ph. D., C. Chem (Ont.), C. Chem (U.K.), M.C.I.C., M.R.S.C., A.R.C.S.T.

45434

Certificate of Analysis

Page: 1

D.V. Jones
P.O. Box 1513
SOUTH PORCUPINE, Ontario
PON 1H0

June 24

Work Order # : 920203
Project :

SAMPLE NUMBERS			Gold	Gold
Accurassay	Customer		ppb	Oz/T
255755	H-1		<5	<0.001
255756	H-2		10	<0.001
55757	H-3		486	0.014
255758	H-4		170	0.005
255759	H-5		344	0.010
255760	H-6		1455	0.042
255761	H-7		78	0.002
255762	H-8		30	0.001
255763	H-9		19	0.001
255764	H-10		31	0.001
255764	H-10		32	0.001

// ACCURASSAY
PROJECT

~Check

CERTIFICATE

I, J.K.Filo of 535 Bartleman St., Timmins, Ontario, do hereby certify that:

- 1) I personally worked on all phases of the exploration program in this report.
- 2) I am the author of this exploration work report and I have reviewed all pertinent assessment file data, geological reports and pertinent information pertaining to this prospect and adjoining areas prior to writing this report.
- 3) I hold an Honours Bachelor of Science degree in geology from Laurentian University, Sudbury, Ont. (1980) and I am a member of the Association of Professional Engineers and Geoscientists of British Columbia.
- 4) I have been practising my profession as an exploration and mine geologist for just over 12 years.
- 5) I hold some interest in all of the property mentioned in this report.

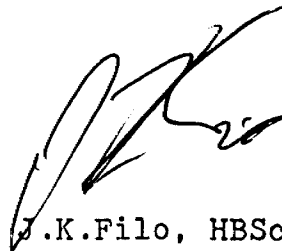

J.K.Filo, HBSce., P.Geo(BC)

APPENDIX, LITHOLOGY DESCRIPTION

(A) Quartz Feldspar Porphyry

- Matrix supported unit, matrix consists principally of quartz and possibly some feldspar. Sub-hedral to anhedral crystals (3-4 mm) plagioclase feldspar are present within matrix. On the fresh surface, unit is grey/white in color; on fresh surface, brown Fe carbonate is sometimes present.

(B) Sericite Altered Quartz Feldspar Porphyry

- Sericitic alteration on this prospect in the vicinity of the area mapped is generally associated with the feldspar porphyry. Basically, the description is as above in (A). However, in some instances, the feldspar minerals within the porphyry are altered to sericite. They develop a more micaceous appearance and a distinct apple green color. Generally, alteration is pervasive and when it occurs, it dominates the entire unit such that most of the rock becomes sericitic and distinctly green in color.

(C) Mafic Volcanics

- The mafic volcanics are probably altered basalts that have been metamorphosed and exhibit a distinct banding on surface as a result of metamorphism. They are grey/black in color on the weathered surface and primary volcanic features, if there were any, are not evident. On the fresh surface, the unit is very fine-grained and grey/black in color. A few white lathes are evident within unit. The unit is likely made up of plagioclase feldspar and ferro-magnesium minerals, i.e., pyroxenes.

(D) Ankerite Alteration

- This is a brown Fe carbonate found to be associated with veins of quartz within the volcanics or porphyry unit. It is present within the porphyry or volcanic wall rocks and adjacent veins in some instances. The ankerite itself is brown to light brown in color and is generally very fine-grained and soft.

Report of Work Conducted After Recording Claim

Mining Act

M.L.
Transaction Number
W 9360.00027



41015SW9085 2.14953 DENYES

900

Personal information collected on this form is obtained under the authority of the Mi (this collection should be directed to the Provincial Manager, Mining Lands, Mini Sudbury, Ontario, P3E 6A5, telephone (705) 670-7264.

- Instructions:
- Please type or print and submit in duplicate.
 - Refer to the Mining Act and Regulations for requirements of filing assessment work or consult the Mining Recorder.
 - A separate copy of this form must be completed for each Work Group.
 - Technical reports and maps must accompany this form in duplicate.
 - A sketch, showing the claims the work is assigned to, must accompany this form.

Recorded Holder(s) <i>DAVID V. JONES</i>	Client No. <i>149 868</i>
Address <i>BOX 1513 SOUTH PORCUPINE ONTARIO</i>	Telephone No. <i>(705) 235-2474</i>
Mining Division <i>PORCUPINE</i>	Township/Area <i>HALCROW TWP.</i>
	M or G Plan No. <i>M 906</i>
Dates Work Performed From: <i>MAY 19/92</i>	To: <i>JUNE 19/92</i>

Work Performed (Check One Work Group Only)

RECEIVED

Work Group	Type
Geotechnical Survey	<i>MAR 25 1993</i>
Physical Work, including Drilling	<i>PROSPECTING MINING LANDS BRANCH</i>
Rehabilitation	
Other Authorized Work	
Assays	
Assignment from Reserve	

Total Assessment Work Claimed on the Attached Statement of Costs \$ *1200*

Note: The Minister may reject for assessment work credit all or part of the assessment work submitted if the recorded holder cannot verify expenditures claimed in the statement of costs within 30 days of a request for verification.

Persons and Survey Company Who Performed the Work (Give Name and Address of Author of Report)

Name	Address
<i>D. JONES</i>	<i>BOX 1513 SOUTH PORCUPINE ONTARIO</i>
<i>J. K. FILO (AUTHOR)</i>	<i>535 BARTLEMAN ST. TITMINS P4N 4X2</i>

(attach a schedule if necessary)

Certification of Beneficial Interest * See Note No. 1 on reverse side

I certify that at the time the work was performed, the claims covered in this work report were recorded in the current holder's name or held under a beneficial interest by the current recorded holder.	Date <i>JAN 23/93</i>	Recorded Holder or Agent (Signature) <i>[Signature]</i>
--	--------------------------	--

Certification of Work Report

I certify that I have a personal knowledge of the facts set forth in this Work report, having performed the work or witnessed same during and/or after its completion and annexed report is true.		
Name and Address of Person Certifying <i>J. KEVIN FILO, 535 BARTLEMAN ST., TITMINS P4N 4X2</i>		
Telephone No. <i>(705) 268-9045</i>	Date <i>FEB 23/93</i>	Certified By (Signature) <i>[Signature]</i>

For Office Use Only

Total Value Cr. Recorded <i>\$1,200.</i>	Date Recorded <i>FEB. 24/93</i>	Mining Recorder <i>[Signature]</i>	Received Stamp <i>RECEIVED</i>
	Deemed Approval Date <i>MAY 25/93</i>	Date Approved	
	Date Notice for Amendments Sent		

Statement of Costs for Assessment Credit

Transaction No./N° de transaction
W9360.00027

État des coûts aux fins du crédit d'évaluation

2.14958

Mining Act/Loi sur les mines

Personal information collected on this form is obtained under the authority of the Mining Act. This information will be used to maintain a record and ongoing status of the mining claim(s). Questions about this collection should be directed to the Provincial Manager, Minings Lands, Ministry of Northern Development and Mines, 4th Floor, 159 Cedar Street, Sudbury, Ontario P3E 6A5, telephone (705) 870-7264.

Les renseignements personnels contenus dans la présente formule sont recueillis en vertu de la Loi sur les mines et serviront à tenir à jour un registre des concessions minières. Adresser toute question sur la collecte de ces renseignements au chef provincial des terrains miniers, ministère du Développement du Nord et des Mines, 159, rue Cedar, 4^e étage, Sudbury (Ontario) P3E 6A5, téléphone (705) 870-7264.

1. Direct Costs/Coûts directs

Type	Description	Amount Montant	Totals Total global
Wages Salaires	Labour Main-d'oeuvre		
	Field Supervision Supervision sur le terrain		
Contractor's and Consultant's Fees Droits de l'entrepreneur et de l'expert- conseil	Type 8 DAYS @ \$150/DAY	1200	1200
Supplies Used Fournitures utilisées	Type		
Equipment Rental Location de matériel	Type RECEIVED MAR 25 1993		
MINING LANDS BRANCH Total Direct Costs Total des coûts directs			1200

2. Indirect Costs/Coûts indirects

** Note: When claiming Rehabilitation work indirect costs are not allowable as assessment work. Pour le remboursement des travaux de réhabilitation, les coûts indirects ne sont pas admissibles en tant que travaux d'évaluation.

Type	Description	Amount Montant	Totals Total global
Transportation Transport	Type		
Food and Lodging Nourriture et hébergement			
Mobilization and Demobilization Mobilisation et démobilisation			
Sub Total of Indirect Costs Total partiel des coûts indirects			N/A
Amount Allowable (not greater than 20% of Direct Costs) Montant admissible (n'excédant pas 20 % des coûts directs)			N/A
Total Value of Assessment Credit (Total of Direct and Allowable Indirect costs)			1200
Valeur totale du crédit d'évaluation (Total des coûts directs et indirects admissibles)			

Note: The recorded holder will be required to verify expenditures claimed in this statement of costs within 30 days of a request for verification. If verification is not made, the Minister may reject for assessment work all or part of the assessment work submitted.

Note : Le titulaire enregistré sera tenu de vérifier les dépenses demandées dans le présent état des coûts dans les 30 jours suivant une demande à cet effet. Si la vérification n'est pas effectuée, le ministre peut rejeter tout ou une partie des travaux d'évaluation présentés.

Filing Discounts

- Work filed within two years of completion is claimed at 100% of the above Total Value of Assessment Credit.
- Work filed three, four or five years after completion is claimed at 50% of the above Total Value of Assessment Credit. See calculations below:

Total Value of Assessment Credit	Total Assessment Claimed
	x 0.50 =

Remises pour dépôt

- Les travaux déposés dans les deux ans suivant leur achèvement sont remboursés à 100 % de la valeur totale susmentionnée du crédit d'évaluation.
- Les travaux déposés trois, quatre ou cinq ans après leur achèvement sont remboursés à 50 % de la valeur totale du crédit d'évaluation susmentionné. Voir les calculs ci-dessous.

Valeur totale du crédit d'évaluation	Evaluation totale demandée
	x 0,50 =

Certification Verifying Statement of Costs

I hereby certify: that the amounts shown are as accurate as possible and these costs were incurred while conducting assessment work on the lands shown on the accompanying Report of Work form.

that as RECORDED HOLDER. I am authorized
(Recorded Holder, Agent, Position in Company)

to make this certification

Attestation de l'état des coûts

J'atteste par la présente : que les montants indiqués sont le plus exact possible et que ces dépenses ont été engagées pour effectuer les travaux d'évaluation sur les terrains indiqués dans la formule de rapport de travail ci-joint.

Et qu'à titre de _____ je suis autorisé
(titulaire enregistré, représentant, poste occupé dans la compagnie)

à faire cette attestation.

Signature 	Date JAN 23/93
---	-------------------

Report of Work Conducted After Recording Claim

Mining Act

M.L.
Transaction Number
W9360.00028

Personal information collected on this form is obtained under the authority of the Mining Act. This information will be used for correspondence. Questions about its collection should be directed to the Provincial Manager, Mining Lands, Ministry of Northern Development and Mines, Fourth Floor, 159 Cedar Street, Sudbury, Ontario, P3E 6A5, telephone (705) 670-7264.

2.14953

- Instructions:
- Please type or print and submit in duplicate.
 - Refer to the Mining Act and Regulations for requirements of filing assessment work or consult the Mining Recorder.
 - A separate copy of this form must be completed for each Work Group.
 - Technical reports and maps must accompany this form in duplicate.
 - A sketch, showing the claims the work is assigned to, must accompany this form.

Recorded Holder(s) <i>DAVID V. JONES</i>	Client No. <i>149 868</i>
Address <i>BOX 1513 SOUTH PORCUPINE PONIHO</i>	Telephone No. <i>(705) 235-2474</i>
Mining Division <i>PORCUPINE</i>	Township/Area <i>HALCROW TWP</i>
	M or G Plan No. <i>17906</i>
Dates Work Performed From: <i>MAY 19/92</i>	To: <i>JUNE 19/92</i>

Work Performed (Check One Work Group Only)

Work Group	Type
Geotechnical Survey	
Physical Work, including Drilling	
Rehabilitation	
Other Authorized Work	
Assays	<i>ASSAY FEES</i>
Assignment from Reserve	

Total Assessment Work Claimed on the Attached Statement of Costs \$ *289*

Note: The Minister may reject for assessment work credit all or part of the assessment work submitted if the recorded holder cannot verify expenditures claimed in the statement of costs within 30 days of a request for verification.

Persons and Survey Company Who Performed the Work (Give Name and Address of Author of Report)

Name	Address
<i>D. JONES</i>	<i>BOX 1513 SOUTH PORCUPINE PONIHO</i>
<i>J. K. FILO (AUTHOR)</i>	<i>535 BARTLEMAN ST, TIMMINS P4N 4X2</i>

(attach a schedule if necessary)

MINING LANDS BRANCH

RECORDED
MAR 25 1993

FEB 24 1993

Certification of Beneficial Interest * See Note No. 1 on reverse side

I certify that at the time the work was performed, the claims covered in this work report were recorded in the current holder's name or held under a beneficial interest by the current recorded holder.	Date <i>JAN 23/93</i>	Recorded Holder or Agent (Signature) <i>[Signature]</i>
--	--------------------------	--

Certification of Work Report

I certify that I have a personal knowledge of the facts set forth in this Work report, having performed the work or witnessed same during and/or after its completion and annexed report is true.		
Name and Address of Person Certifying <i>J. KEVIN FILO, 535 BARTLEMAN ST, TIMMINS P4N 4X2</i>		
Telephone No. <i>(705) 268-9045</i>	Date <i>FEB 23/93</i>	Certified By (Signature) <i>[Signature]</i>

For Office Use Only

Total Value Cr. Recorded <i>4289</i>	Date Recorded <i>FEB. 24/93</i>	Mining Recorder <i>[Signature]</i>	RECEIVED FEB 24 1993 <i>[Signature]</i>
	Deemed Approval Date <i>MAY 25/93</i>	Date Approved	
	Date Notice for Amendments Sent		

Statement of Costs for Assessment Credit

État des coûts aux fins du crédit d'évaluation

Mining Act/Loi sur les mines

Transaction No./N° de transaction

W9360.00028

2,149.53

Personal information collected on this form is obtained under the authority of the Mining Act. This information will be used to maintain a record and ongoing status of the mining claim(s). Questions about this collection should be directed to the Provincial Manager, Minings Lands, Ministry of Northern Development and Mines, 4th Floor, 159 Cedar Street, Sudbury, Ontario P3E 6A5, telephone (705) 670-7264.

Les renseignements personnels contenus dans la présente formule sont recueillis en vertu de la Loi sur les mines et serviront à tenir à jour un registre des concessions minières. Adresser toute question sur la collecte de ces renseignements au chef provincial des terrains miniers, ministère du Développement du Nord et des Mines, 159, rue Cedar, 4^e étage, Sudbury (Ontario) P3E 6A5, téléphone (705) 670-7264.

1. Direct Costs/Coûts directs

Type	Description	Amount Montant	Totals Total global
Wages Salaires	Labour Main-d'oeuvre		
	Field Supervision Supervision sur le terrain		
Contractor's and Consultant's Fees Droits de l'entrepreneur et de l'expert-conseil	Type		
Supplies Used Fournitures utilisées	Type		
	ASSAYS	289.17	
			289.17
Equipment Rental Location de matériel	Type		
Total Direct Costs Total des coûts directs			289

2. Indirect Costs/Coûts indirects

** Note: When claiming Rehabilitation work Indirect costs are not allowable as assessment work. Pour le remboursement des travaux de réhabilitation, les coûts indirects ne sont pas admissibles en tant que travaux d'évaluation.

Type	Description	Amount Montant	Totals Total global
Transportation Transport	Type		
Food and Lodging Nourriture et hébergement			
Mobilization and Demobilization Mobilisation et démoblisation			

Sub Total of Indirect Costs Total partiel des coûts indirects

N/A

Amount Allowable (not greater than 20% of Direct Costs) Montant admissible (n'excédant pas 20 % des coûts directs)

N/A

Total Value of Assessment Credit (Total of Direct and Allowable Indirect costs) Valeur totale du crédit d'évaluation (Total des coûts directs et indirects admissibles)

289

Note: The recorded holder will be required to verify expenditures claimed in this statement of costs within 30 days of a request for verification. If verification is not made, the Minister may reject for assessment work all or part of the assessment work submitted.

Note : Le titulaire enregistré sera tenu de vérifier les dépenses demandées dans le présent état des coûts dans les 30 jours suivant une demande à cet effet. Si la vérification n'est pas effectuée, le ministre peut rejeter tout ou une partie des travaux d'évaluation présentés.

Filing Discounts

- Work filed within two years of completion is claimed at 100% of the above Total Value of Assessment Credit.
- Work filed three, four or five years after completion is claimed at 50% of the above Total Value of Assessment Credit. See calculations below:

Total Value of Assessment Credit	Total Assessment Claimed
x 0.50 =	

RECEIVED

MAR 25 1993

Remises pour dépôt

- Les travaux déposés dans les deux ans suivant leur achèvement sont remboursés à 100 % de la valeur totale susmentionnée du crédit d'évaluation.
- Les travaux déposés trois, quatre ou cinq ans après leur achèvement sont remboursés à 50 % de la valeur totale du crédit d'évaluation susmentionné. Voir les calculs ci-dessous.

Valeur totale du crédit d'évaluation	Évaluation totale demandée
x 0,50 =	

Certification Verifying Statement of Costs / MINING LANDS BRANCH / Attestation de l'état des coûts

I hereby certify: that the amounts shown are as accurate as possible and these costs were incurred while conducting assessment work on the lands shown on the accompanying Report of Work form.

that as RECORDED HOLDER I am authorized (Recorded Holder, Agent, Position in Company)

to make this certification

J'atteste par la présente : que les montants indiqués sont le plus exact possible et que ces dépenses ont été engagées pour effectuer les travaux d'évaluation sur les terrains indiqués dans la formule de rapport de travail ci-joint.

Et qu'à titre de _____ je suis autorisé (titulaire enregistré, représentant, poste occupé dans la compagnie)

à faire cette attestation.

Signature [Signature] Date JUN 23/93

Report of Work Conducted After Recording Claim

Mining Act

Transaction Number

W/9360.00029

Personal information collected on this form is obtained under the authority of the Mining Act. This information will be used for correspondence. Questions about its collection should be directed to the Provincial Manager, Mining Lands, Ministry of Northern Development and Mines, Fourth Floor, 159 Cedar Street, Sudbury, Ontario, P3E 6A5, telephone (705) 670-7264.

- Instructions:
- Please type or print and submit in duplicate.
 - Refer to the Mining Act and Regulations for requirements of filing assessment work or consult the Mining Recorder.
 - A separate copy of this form must be completed for each Work Group.
 - Technical reports and maps must accompany this form in duplicate.
 - A sketch, showing the claims the work is assigned to, must accompany this form.

2.14953

Recorded Holder(s) <i>DAVID V. JONES</i>	Client No. <i>149 868</i>
Address <i>BOX 1513 SOUTH PORCUPINE PONIHO</i>	Telephone No. <i>(705) 235-2474</i>
Mining Division <i>PORCUPINE</i>	Township/Area <i>DENVES TWP.</i>
	M or G Plan No. <i>M-758</i>
Dates Work Performed From: <i>AUG 21/92</i> To: <i>OCT. 2/92</i>	

Work Performed (Check One Work Group Only)

Work Group	Type
Geotechnical Survey	
Physical Work, including Drilling	
Rehabilitation	
Other Authorized Work	
Assays	<i>ASSAY COSTS.</i>
Assignment from Reserve	

Total Assessment Work Claimed on the Attached Statement of Costs \$ 905.42

Note: The Minister may reject for assessment work credit all or part of the assessment work submitted if the recorded holder cannot verify expenditures claimed in the statement of costs within 30 days of a request for verification.

Persons and Survey Company Who Performed the Work (Give Name and Address of Author of Report)

Name	Address
<i>D. JONES</i>	<i>BOX 1513 SOUTH PORCUPINE PONIHO</i>
<i>J. K. FILO (AUTHOR)</i>	<i>535 BARTLEMAN ST. TIMMINS P4N 4X2</i>

RECEIVED
MAR 25 1993
RECORDED
FEB 24 1993
Receipt

(attach a schedule if necessary)

MINING LANDS BRANCH

Certification of Beneficial Interest * See Note No. 1 on reverse side

I certify that at the time the work was performed, the claims covered in this work report were recorded in the current holder's name or held under a beneficial interest by the current recorded holder.	Date <i>JAN 23/93</i>	Recorded Holder or Agent (Signature) <i>D. Jones</i>
--	--------------------------	---

Certification of Work Report

I certify that I have a personal knowledge of the facts set forth in this Work report, having performed the work or witnessed same during and/or after its completion and annexed report is true.		
Name and Address of Person Certifying <i>J. KEVIN FILO, 535 BARTLEMAN ST., TIMMINS P4N 4X2</i>		
Telephone No. <i>(705) 288-9045</i>	Date <i>FEB 23/93</i>	Certified By (Signature) <i>J. K. Filo</i>

For Office Use Only

Total Value Cr. Recorded <i>\$905.</i>	Date Recorded <i>FEB. 24 1993</i>	Mining Recorder <i>White</i>	Received Stamp RECEIVED FEB 24 1993
	Deemed Approval Date <i>MAY 25 1993</i>	Date Approved	
	Date Notice for Amendments Sent		

**Statement of Costs
for Assessment Credit**

Transaction No./N° de transaction

W9360.00029

**État des coûts aux fins
du crédit d'évaluation**

Mining Act/Loi sur les mines

2.14950

Personal information collected on this form is obtained under the authority of the Mining Act. This information will be used to maintain a record and ongoing status of the mining claim(s). Questions about this collection should be directed to the Provincial Manager, Minings Lands, Ministry of Northern Development and Mines, 4th Floor, 159 Cedar Street, Sudbury, Ontario P3E 6A5, telephone (705) 670-7264.

Les renseignements personnels contenus dans la présente formule sont recueillis en vertu de la Loi sur les mines et serviront à tenir à jour un registre des concessions minières. Adresser toute question sur la collecte de ces renseignements au chef provincial des terrains miniers, ministère du Développement du Nord et des Mines, 159, rue Cedar, 4^e étage, Sudbury (Ontario) P3E 6A5, téléphone (705) 670-7264.

1. Direct Costs/Coûts directs

Type	Description	Amount Montant	Totals Total global
Wages Salaires	Labour Main-d'oeuvre		
	Field Supervision Supervision sur le terrain		
Contractor's and Consultant's Fees Droits de l'entrepreneur et de l'expert- conseil	Type		
Supplies Used Fournitures utilisées	Type ASSAYS	868.92	
			868.92
Equipment Rental Location de matériel	Type		
Total Direct Costs Total des coûts directs			868.92

2. Indirect Costs/Coûts indirects

** Note: When claiming Rehabilitation work Indirect costs are not allowable as assessment work.
Pour le remboursement des travaux de réhabilitation, les coûts indirects ne sont pas admissibles en tant que travaux d'évaluation.

Type	Description	Amount Montant	Totals Total global
Transportation Transport	Type COURIER	36.50	
			36.50
Food and Lodging Nourriture et hébergement			
Mobilization and Demobilization Mobilisation et démobilisation			
Sub Total of Indirect Costs Total partiel des coûts indirects			36.50
Amount Allowable (not greater than 20% of Direct Costs) Montant admissible (n'excédant pas 20 % des coûts directs)			173.78
Total Value of Assessment Credit (Total of Direct and Allowable indirect costs)			905.42

Note: The recorded holder will be required to verify expenditures claimed in this statement of costs within 30 days of a request for verification. If verification is not made, the Minister may reject for assessment work all or part of the assessment work submitted. **MAR 25 1993**

Note: Le titulaire enregistré sera tenu de vérifier les dépenses demandées dans le présent état des coûts dans les 30 jours suivant une demande à cet effet. Si la vérification n'est pas effectuée, le ministre peut rejeter tout ou une partie des travaux d'évaluation présentés.

Filing Discounts

MINING LANDS BRANCH

Remises pour dépôt

- Work filed within two years of completion is claimed at 100% of the above Total Value of Assessment Credit.
- Work filed three, four or five years after completion is claimed at 50% of the above Total Value of Assessment Credit. See calculations below:

- Les travaux déposés dans les deux ans suivant leur achèvement sont remboursés à 100 % de la valeur totale susmentionnée du crédit d'évaluation.
- Les travaux déposés trois, quatre ou cinq ans après leur achèvement sont remboursés à 50 % de la valeur totale du crédit d'évaluation susmentionné. Voir les calculs ci-dessous.

Total Value of Assessment Credit	Total Assessment Claimed
	× 0.50 =

Valeur totale du crédit d'évaluation	Evaluation totale demandée
	× 0,50 =

Certification Verifying Statement of Costs

I hereby certify:
that the amounts shown are as accurate as possible and these costs were incurred while conducting assessment work on the lands shown on the accompanying Report of Work form.

that as RECORDED HOLDER I am authorized
(Recorded Holder, Agent, Position in Company)

to make this certification

Attestation de l'état des coûts

J'atteste par la présente :
que les montants indiqués sont le plus exact possible et que ces dépenses ont été engagées pour effectuer les travaux d'évaluation sur les terrains indiqués dans la formule de rapport de travail ci-joint.

Et qu'à titre de _____ je suis autorisé
(titulaire enregistré, représentant, poste occupé dans la compagnie)

à faire cette attestation.

Signature <i>[Signature]</i>	Date JAN 23/93
---------------------------------	-------------------

Report of Work Conducted After Recording Claim

Mining Act

M.L.
Transaction Number
W/9360.00030

Personal information collected on this form is obtained under the authority of the Mining Act. This information will be used for correspondence. Questions about this collection should be directed to the Provincial Manager, Mining Lands, Ministry of Northern Development and Mines, Fourth Floor, 159 Cedar Street, Toronto, Ontario, P3E 6A5, telephone (705) 670-7264.

2.14953

- Instructions:**
- Please type or print and submit in duplicate.
 - Refer to the Mining Act and Regulations for requirements of filing assessment work or consult the Mining Recorder.
 - A separate copy of this form must be completed for each Work Group.
 - Technical reports and maps must accompany this form in duplicate.
 - A sketch, showing the claims the work is assigned to, must accompany this form.

Recorded Holder(s) <i>DAVID V. JONES</i>	Client No. <i>149 868</i>
Address <i>Box 1513 South Porcupine Ontario</i>	Telephone No. <i>(705) 235-2474</i>
Mining Division <i>PORCUPINE</i>	Township/Area <i>DENVES TWP</i>
Dates Work Performed From: <i>MAY 22/92</i>	To: <i>SEPT. 27/92</i>
	M or G Plan No. <i>M 758</i>

Work Performed (Check One Work Group Only)

Work Group	Type
Geotechnical Survey	
Physical Work, Including Drilling	<i>PROSPECTING</i>
Rehabilitation	
Other Authorized Work	
Assays	
Assignment from Reserve	

Total Assessment Work Claimed on the Attached Statement of Costs \$ *600*

Note: The Minister may reject for assessment work credit all or part of the assessment work submitted if the recorded holder cannot verify expenditures claimed in the statement of costs within 30 days of a request for verification.

Persons and Survey Company Who Performed the Work (Give Name and Address of Author of Report)

Name	Address
<i>D. JONES</i>	<i>Box 1513 South Porcupine Ontario</i>
<i>J. K. FILE (AUTHOR)</i>	<i>535 BARTLEMAN ST. THURONS P4N 4X2</i>

RECEIVED
MAR 25 1993
MINING LANDS BRANCH
RECORDED
FEB 24 1993
Receipt

(attach a schedule if necessary)

Certification of Beneficial Interest * See Note No. 1 on reverse side

I certify that at the time the work was performed, the claims covered in this work report were recorded in the current holder's name or held under a beneficial interest by the current recorded holder.	Date <i>JAN 23/93</i>	Recorded Holder or Agent (Signature) <i>D. Jones</i>
--	--------------------------	---

Certification of Work Report

I certify that I have a personal knowledge of the facts set forth in this Work report, having performed the work or witnessed same during and/or after its completion and annexed report is true.

Name and Address of Person Certifying <i>J. KEVIN FILE, 535 BARTLEMAN ST., THURONS P4N 4X2</i>		
Telephone No. <i>(705) 268-9045</i>	Date <i>FEB 23/93</i>	Certified By (Signature) <i>[Signature]</i>

For Office Use Only

Total Value Cr. Recorded <i>\$600</i>	Date Recorded <i>FEB. 24/93</i>	Mining Recorder <i>[Signature]</i>	Received Stamp RECORDED FEB 24 1993 <i>[Initials]</i>
	Deemed Approval Date <i>MAY 25/93</i>	Date Approved	
	Date Notice for Amendments Sent		



Ministry of
Northern Development
and Mines

Ministère du
Développement du Nord
et des mines

**Statement of Costs
for Assessment Credit**

**État des coûts aux fins
du crédit d'évaluation**

Mining Act/Loi sur les mines

Transaction No./N° de transaction

W9360.00030

2.14958

Personal information collected on this form is obtained under the authority of the Mining Act. This information will be used to maintain a record and ongoing status of the mining claim(s). Questions about this collection should be directed to the Provincial Manager, Mining Lands, Ministry of Northern Development and Mines, 4th Floor, 159 Cedar Street, Sudbury, Ontario P3E 6A5, telephone (705) 670-7264.

Les renseignements personnels contenus dans la présente formule sont recueillis en vertu de la Loi sur les mines et serviront à tenir à jour un registre des concessions minières. Adresser toute question sur la collecte de ces renseignements au chef provincial des terrains miniers, ministère du Développement du Nord et des Mines, 159, rue Cedar, 4^e étage, Sudbury (Ontario) P3E 6A5, téléphone (705) 670-7264.

1. Direct Costs/Coûts directs

Type	Description	Amount Montant	Totals Total global
Wages Salaires	Labour 4 DAYS Main-d'oeuvre	\$600	
	Field Supervision Supervision sur le terrain		\$600
Contractor's and Consultant's Fees Droits de l'entrepreneur et de l'expert- conseil	Type		
Supplies Used Fournitures utilisées	Type		
Equipment Rental Location de matériel	Type		
Total Direct Costs Total des coûts directs		\$600.00	

2. Indirect Costs/Coûts indirects

** Note: When claiming Rehabilitation work Indirect costs are not allowable as assessment work. Pour le remboursement des travaux de réhabilitation, les coûts indirects ne sont pas admissibles en tant que travaux d'évaluation.

Type	Description	Amount Montant	Totals Total global
Transportation Transport	Type		
Food and Lodging Nourriture et hébergement			
Mobilization and Demobilization Mobilisation et démobilisation			
Sub Total of Indirect Costs Total partiel des coûts indirects			
Amount Allowable (not greater than 20% of Direct Costs) Montant admissible (n'excédant pas 20 % des coûts directs)			
Total Value of Assessment Credit (Total of Direct and Allowable indirect costs)		Valeur totale du crédit d'évaluation (Total des coûts directs et indirects admissibles)	

Note: The recorded holder will be required to verify expenditures claimed in this statement of costs within 30 days of a request for verification. If verification is not made, the Minister may reject for assessment work all or part of the assessment work submitted.

Note: Le titulaire enregistré sera tenu de vérifier les dépenses demandées dans le présent état des coûts dans les 30 jours suivant une demande à cet effet. Si la vérification n'est pas effectuée, le ministre peut rejeter tout ou une partie des travaux d'évaluation présentés.

MAR 25 1993

Filing Discounts

1. Work filed within two years of completion is claimed at 100% of the above Total Value of Assessment Credit.
2. Work filed three, four or five years after completion is claimed at 50% of the above Total Value of Assessment Credit. See calculations below:

Total Value of Assessment Credit	Total Assessment Claimed
	× 0.50 =

Remises pour dépôt

1. Les travaux déposés dans les deux ans suivant leur achèvement sont remboursés à 100 % de la valeur totale susmentionnée du crédit d'évaluation.
2. Les travaux déposés trois, quatre ou cinq ans après leur achèvement sont remboursés à 50 % de la valeur totale du crédit d'évaluation susmentionné. Voir les calculs ci-dessous.

Valeur totale du crédit d'évaluation	Evaluation totale demandée
	× 0,50 =

Certification Verifying Statement of Costs

I hereby certify: that the amounts shown are as accurate as possible and these costs were incurred while conducting assessment work on the lands shown on the accompanying Report of Work form.

that J. F. [Signature] RECORDED HOLDER I am authorized (Recorded Holder, Agent, Position in Company)

to make this certification

Attestation de l'état des coûts

J'atteste par la présente: que les montants indiqués sont le plus exact possible et que ces dépenses ont été engagées pour effectuer les travaux d'évaluation sur les terrains indiqués dans la formule de rapport de travail ci-joint.

Et qu'à titre de _____ je suis autorisé (titulaire enregistré, représentant, poste occupé dans la compagnie)

à faire cette attestation.

Signature [Signature] Date JAN 23/93

Report of Work Conducted After Recording Claim
Mining Act

M.L.
Transaction Number
W9360.00032

Personal information collected on this form is obtained under the authority of the Mining Act. This information will be used for correspondence. Questions about this collection should be directed to the Provincial Manager, Mining Lands, Ministry of Northern Development and Mines, Fourth Floor, 159 Cedar Street, Sudbury, Ontario, P3E 6A5, telephone (705) 670-7264.

2.14953

- Instructions:
- Please type or print and submit in duplicate.
 - Refer to the Mining Act and Regulations for requirements of filing assessment work or consult the Mining Recorder.
 - A separate copy of this form must be completed for each Work Group.
 - Technical reports and maps must accompany this form in duplicate.
 - A sketch, showing the claims the work is assigned to, must accompany this form.

Recorded Holder(s) <i>DAVID V. JONES</i>	Client No. <i>149 868</i>
Address <i>BOX 1513 SOUTH PORCUPINE PONIHO</i>	Telephone No. <i>(705) 235-2474</i>
Mining Division <i>PORCUPINE</i>	Township/Area <i>DENYES TWP.</i>
M or G Plan No. <i>M-758</i>	
Dates Work Performed From: <i>JULY 21/92</i> To: <i>OCT. 5/92</i>	

Work Performed (Check One Work Group Only)

Work Group	Type
Geotechnical Survey	<i>GEOLOGY + ENV GRID ESTABLISHMENT</i>
Physical Work, Including Drilling	
Rehabilitation	
Other Authorized Work	
Assays	
Assignment from Reserve	

Total Assessment Work Claimed on the Attached Statement of Costs \$ *1454.88*

Note: The Minister may reject for assessment work credit all or part of the assessment work submitted if the recorded holder cannot verify expenditures claimed in the statement of costs within 30 days of a request for verification.

Persons and Survey Company Who Performed the Work (Give Name and Address of Author of Report)

Name	Address
<i>D. JONES</i>	<i>BOX 1513 SOUTH PORCUPINE PONIHO</i>
<i>J. K. FILO (AUTHOR)</i>	<i>535 BARTLEMAN ST. TUNNINGS P4N 4X2</i>

(attach a schedule if necessary) MINING LANDS BRANCH

Certification of Beneficial Interest * See Note No. 1 on reverse side

I certify that at the time the work was performed, the claims covered in this work report were recorded in the current holder's name or held under a beneficial interest by the current recorded holder.	Date <i>JAN 23/93</i>	Recorded Holder or Agent (Signature) <i>D. Jones</i>
--	--------------------------	---

Certification of Work Report

I certify that I have a personal knowledge of the facts set forth in this Work report, having performed the work or witnessed same during and/or after its completion and annexed report is true.

Name and Address of Person Certifying
J. KEVIN FILO, 535 BARTLEMAN ST., TUNNINGS P4N 4X2

Telephone No. *(705) 268-9045* Date: *Feb 23/93* Certified By (Signature) *[Signature]*

For Office Use Only

<i>\$1,455</i>	Total Value Or. Recorded	Date Recorded <i>FEB. 24/93</i>	Mining Recorder <i>[Signature]</i>	RECEIVED FEB 24 1993 930 C. J. C.
	Deemed Approval Date <i>MAY 25/93</i>	Date Approved		
	Date Notice for Amendments Sent			

Statement of Costs
for Assessment Credit

État des coûts aux fins
du crédit d'évaluation

Mining Act/Loi sur les mines

Transaction No./N° de transaction

W9360.00032

2,14953

Personal information collected on this form is obtained under the authority of the Mining Act. This information will be used to maintain a record and ongoing status of the mining claim(s). Questions about this collection should be directed to the Provincial Manager, Minings Lands, Ministry of Northern Development and Mines, 4th Floor, 159 Cedar Street, Sudbury, Ontario P3E 6A5, telephone (705) 670-7264.

Les renseignements personnels contenus dans la présente formule sont recueillis en vertu de la Loi sur les mines et serviront à tenir à jour un registre des concessions minières. Adresser toute question sur la collecte de ces renseignements au chef provincial des terrains miniers, ministère du Développement du Nord et des Mines, 159, rue Cedar, 4^e étage, Sudbury (Ontario) P3E 6A5, téléphone (705) 670-7264.

1. Direct Costs/Coûts directs

Type	Description	Amount Montant	Totals Total global
Wages Salaires	Labour Main-d'oeuvre		
	Field Supervision Supervision sur le terrain		
Contractor's and Consultant's Fees Droits de l'entrepreneur et de l'expert- conseil	Type GEOLOGY SURVEY	\$ 1050	
	ESTABLISH GRID	150	1200.00
Supplies Used Fournitures utilisées	Type PAINT	\$ 12.40	
			12.40
Equipment Rental Location de matériel	Type		
Total Direct Costs Total des coûts directs			1212.40

2. Indirect Costs/Coûts indirects

** Note: When claiming Rehabilitation work Indirect costs are not allowable as assessment work. Pour le remboursement des travaux de réhabilitation, les coûts indirects ne sont pas admissibles en tant que travaux d'évaluation.

Type	Description	Amount Montant	Totals Total global
Transportation Transport	Type AIR (FIX-WING)	241.20	
Food and Lodging Nourriture et hébergement	GROCERIES	48.00	
Mobilization and Demobilization Mobilisation et démobilisation			
Sub Total of Indirect Costs Total partiel des coûts indirects			289.20
Amount Allowable (not greater than 20% of Direct Costs) Montant admissible (n'excedant pas 20 % des coûts directs)			242.48
Total Value of Assessment Credit (Total of Direct and Allowable indirect costs)			1454.88
Valeur totale du crédit d'évaluation (Total des coûts directs et indirects admissibles)			

RECEIVED

Note: The recorded holder will be required to verify expenditures claimed in this statement of costs within 30 days of a request for verification. If verification is not made, the Minister may reject for assessment work all or part of the assessment work submitted.

Note: Le titulaire enregistré sera tenu de vérifier les dépenses demandées dans le présent état des coûts dans les 30 jours suivant une demande à cet effet. Si la vérification n'est pas effectuée, le ministre peut rejeter tout ou une partie des travaux d'évaluation présentés.

MINING LANDS BRANCH

Filing Discounts

1. Work filed within two years of completion is claimed at 100% of the above Total Value of Assessment Credit.
2. Work filed three, four or five years after completion is claimed at 50% of the above Total Value of Assessment Credit. See calculations below:

Total Value of Assessment Credit	Total Assessment Claimed
	× 0.50 =

Remises pour dépôt

1. Les travaux déposés dans les deux ans suivant leur achèvement sont remboursés à 100 % de la valeur totale susmentionnée du crédit d'évaluation.
2. Les travaux déposés trois, quatre ou cinq ans après leur achèvement sont remboursés à 50 % de la valeur totale du crédit d'évaluation susmentionné. Voir les calculs ci-dessous.

Valeur totale du crédit d'évaluation	Evaluation totale demandée
	× 0,50 =

Certification Verifying Statement of Costs

I hereby certify:
that the amounts shown are as accurate as possible and these costs were incurred while conducting assessment work on the lands shown on the accompanying Report of Work form.

that as [Signature] RECORDED HOLDER I am authorized
(Recorded Holder, Agent, Position in Company)

to make this certification

Attestation de l'état des coûts

J'atteste par la présente :
que les montants indiqués sont le plus exact possible et que ces dépenses ont été engagées pour effectuer les travaux d'évaluation sur les terrains indiqués dans la formule de rapport de travail ci-joint.

Et qu'à titre de _____ je suis autorisé
(titulaire enregistré, représentant, poste occupé dans la compagnie)

à faire cette attestation.

Signature [Signature] Date JAN 23/93



Ministry of
Northern Development
and Mines

Ministère du
Développement du Nord
et des Mines

Geoscience Approvals Section
Mining and Land
Management Branch
Willet Green Miller Centre
933 Ramsey Lake Road
6th Floor
Sudbury, Ontario
P3E 6B5

Telephone: (705) 670-5853
Fax: (705) 670-5863

Our File: 2.14953
Transaction #: W9360.00027
W9360.00028
W9360.00029
W9360.00030
W9360.00032

JULY 13, 1993

Mining Recorder
Ministry of Northern Development
and Mines
60 Wilson Avenue
1st Floor
Timmins, Ontario
P4N 2S7

Dear Sir:

**RE: APPROVAL OF ASSESSMENT WORK ON MINING CLAIMS P 1175909 ET. AL.
IN DENYES AND HALCROW TOWNSHIP.**

The Assessment Credits for GEOLOGY, section 12 of the Mining Act Regulations, as listed on Report of Work W9360.00032, have been Approved as of JULY 5, 1993.

The Assessment Credits for PROSPECTING, section 9 of the Mining Act Regulations, as listed on Reports of Work W9360.00027 and W9360.00030, have been approved as of MAY 21, 1993.

The Assessment Credits for ASSAYS, section 17 of the Mining Act Regulations, as list on Reports of Work W9360.00028 and W9360.00029, have been approved as of MAY 21, 1993.

.../2

July 13, 1993
Mining Recorder - Timmins

Please indicate this approval on the claim record sheets.

If you have any questions please call Clive Stephenson at
(705) 670-5856.

Yours sincerely,



D
Ron C. Gashinski
Senior Manager, Mining and Land
Management Branch
Mines and Minerals Division

CM
CDS/jl

Enclosures:

cc: Assessment Files Office
Toronto, Ontario

Resident Geologist
Timmins, Ontario

Raney Twp. - M.1069

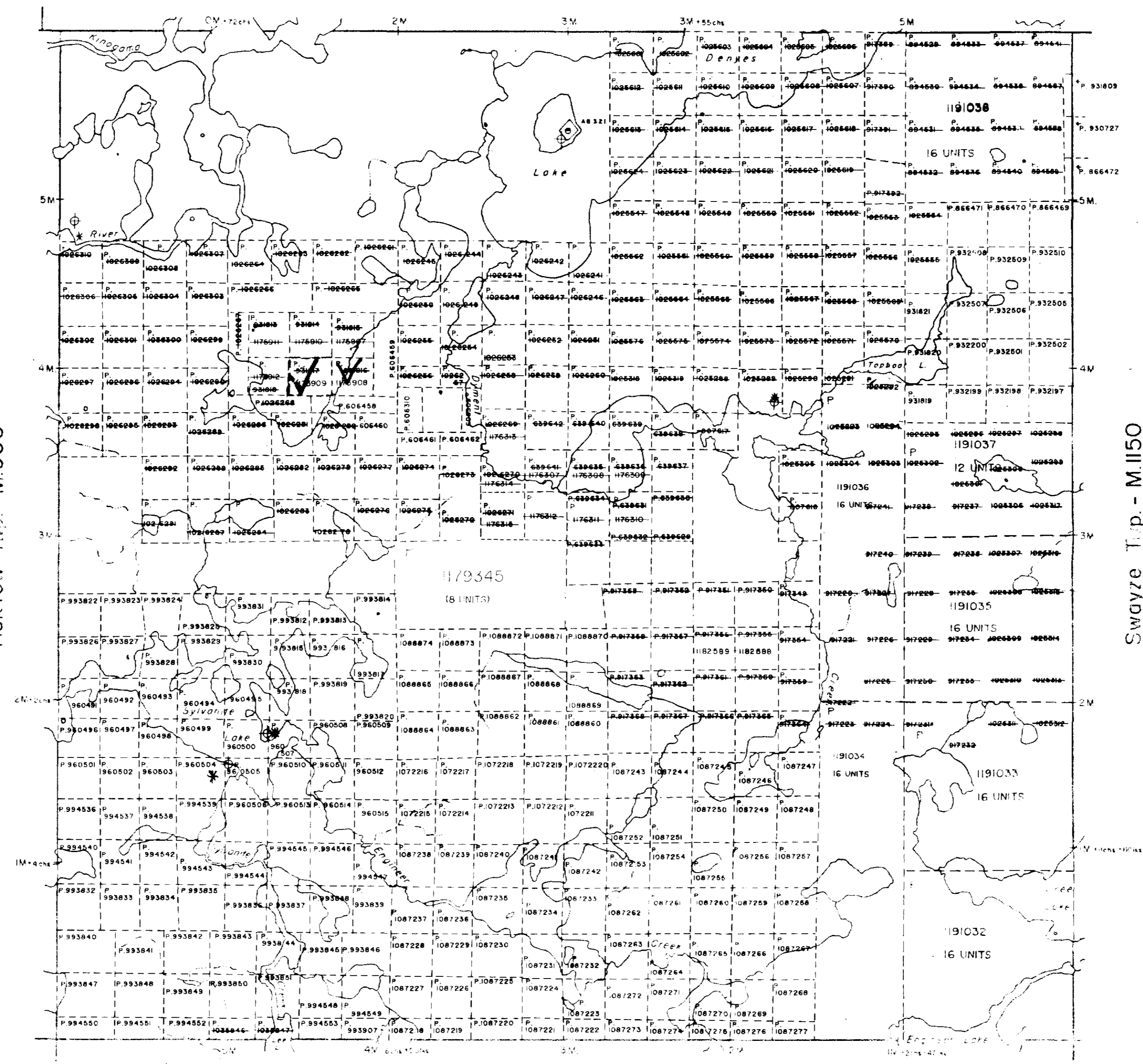

Halkrow Twp. - M.906

Swayze Twp. - M.1150

Greenlaw Twp. - M.895

THE INFORMATION THAT APPEARS ON THIS MAP HAS BEEN COMPILED FROM VARIOUS SOURCES AND ACCURACY IS NOT GUARANTEED THOSE WISHING TO STAKE MINING CLAIMS SHOULD CONSULT WITH THE MINING RECORDER, MINISTRY OF NORTHERN DEVELOPMENT AND MINES, FOR ADDITIONAL INFORMATION ON THE STATUS OF THE LANDS SHOWN HEREON.

THE TOWNSHIP OF DENYES

DENYES

DISTRICT OF SUDBURY

PORCUPINE MINING DIVISION

SCALE: 1-INCH = 40 CHAINS

LEGEND

PATENTED LAND	⊙
CROWN LAND SALE	C.S.
LEASES	⊕
LOCATED LAND	Loc.
LICENSE OF OCCUPATION	L.O.
MINING RIGHTS ONLY	M.R.O.
SURFACE RIGHTS ONLY	S.R.O.
ROADS	—
IMPROVED ROADS	—
KING'S HIGHWAYS	—
RAILWAYS	—
POWER LINES	—
MARSH OR MUSKEG	—
MINES	⊙
CANCELLED	X
PATENTED FOR S.R.O.	⊙

NOTES

600' surface rights reserved on along the shores of all lakes and rivers.

* L.U.P.
⊕ REMOTE TOURIST CAMPS

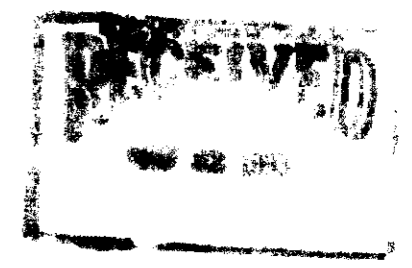

SERVICE OCT. 31/89 CHECKED BY R. BAILEY

PLAN NO. 11708

ONTARIO
MINISTRY OF NATURAL RESOURCES
SURVEYS AND MAPPING BRANCH



4101559385 2,14953 DENYES

HALCROW TWP

HALCROW TWP

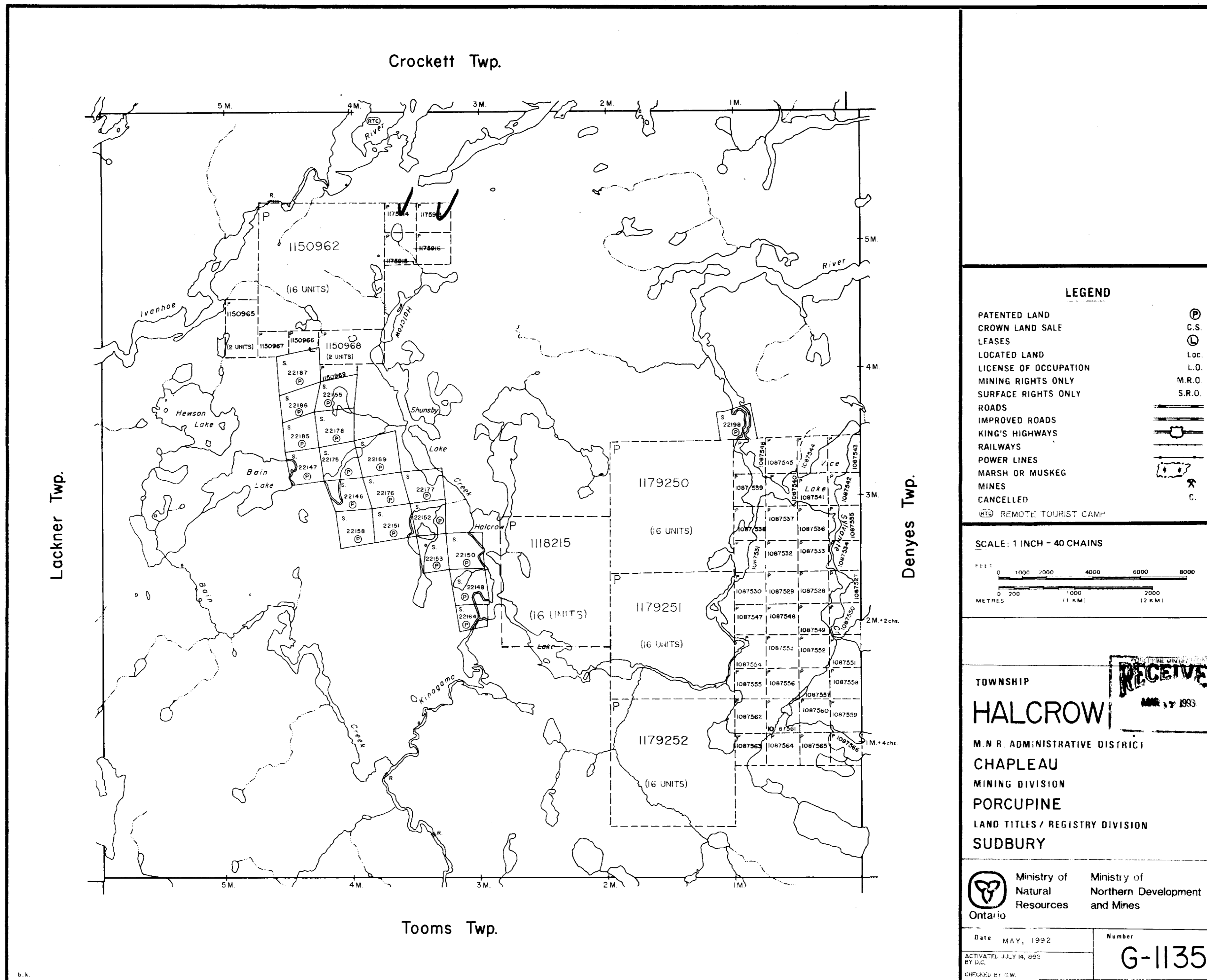

LEGEND

- PATENTED LAND (P)
- CROWN LAND SALE (C.S.)
- LEASES (L)
- LOCATED LAND (Loc.)
- LICENSE OF OCCUPATION (L.O.)
- MINING RIGHTS ONLY (M.R.O.)
- SURFACE RIGHTS ONLY (S.R.O.)
- ROADS
- IMPROVED ROADS
- KING'S HIGHWAYS
- RAILWAYS
- POWER LINES
- MARSH OR MUSKEG
- MINES
- CANCELLED (C.)
- (RT) REMOTE TOURIST CAMP

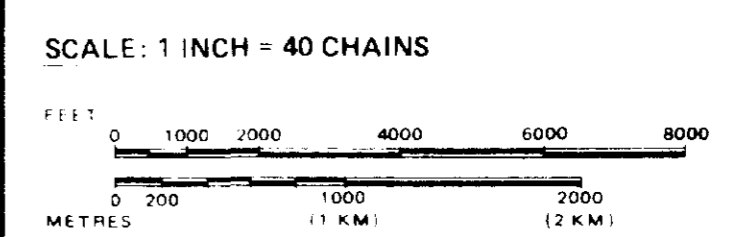

TOWNSHIP
HALCROW
 M.N.R. ADMINISTRATIVE DISTRICT
 CHAPLEAU
 MINING DIVISION
 PORCUPINE
 LAND TITLES / REGISTRY DIVISION
 SUDBURY

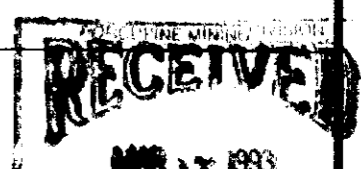

Ministry of Natural Resources Ontario
 Ministry of Northern Development and Mines

Date MAY, 1992
 ACTIVATED JULY 14, 1992 BY D.C.
 CHECKED BY G.W.
 Number
G-1135

THE INFORMATION THAT APPEARS ON THIS MAP HAS BEEN COMPILED FROM VARIOUS SOURCES AND ACCURACY IS NOT GUARANTEED. THOSE WISHING TO STAKE MINING CLAIMS SHOULD CONSULT WITH THE MINING DIVISION, MINISTRY OF



FIG # S2-2 DENYES PROSPECT

GRID MAP, AREAS OF DETAILED WORK & OTHER SAMPLE LOCATIONS

D-9 X - SAMPLE LOCATION

AREA A, B - AREAS WITH DETAILED WORK & SAMPLING

□, ■ - UNLOCATED, LOCATED POST

--- AREA OF STRIPPED OUTCROP (PAGIUS BULLDOZER WORK - GLEN HOBEN RESOURCES)

* NOTE: DATA TAKEN FROM FIELD (K.S. FILE # D. JONES) & VERIFICATION OF OLD GRID ORIENTATION FROM ASSOCIATED FILES

DATE: SEPT. 4 1972
DRAWN: D. JONES & J.R. FILED

2. 14958

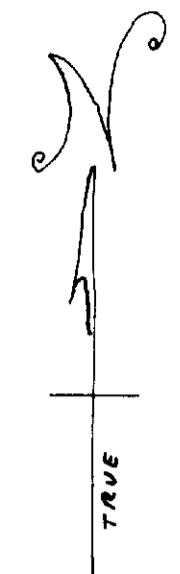

SCALE 1:2500

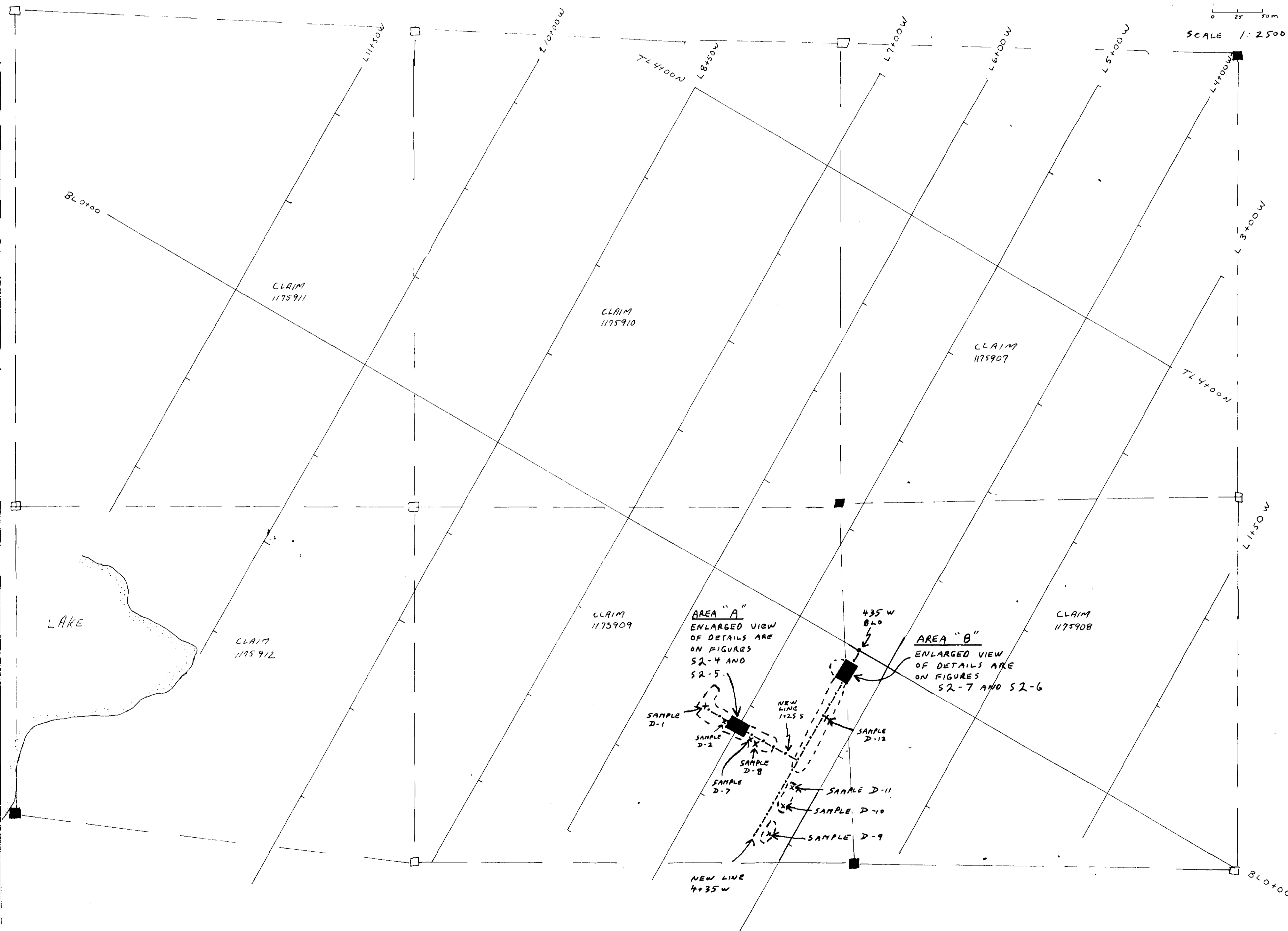

4101559085 2. 14953 DENYES

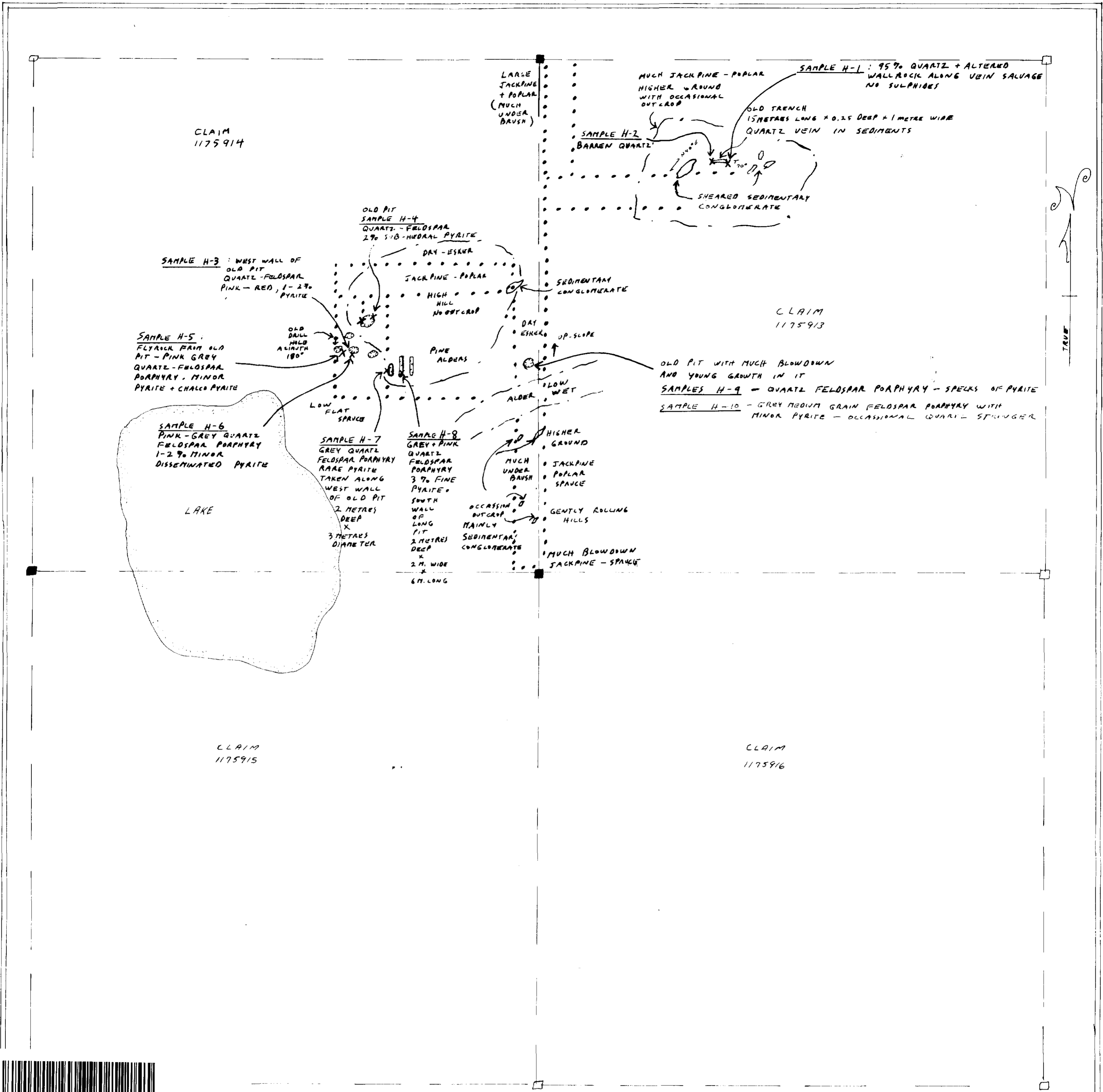

230

<p>FIGURE # S1-4</p> <p>PROSPECTING TRAVERSES</p> <p>2.14953</p> <p>HAL CROW PROPERTY</p>		<p>■, □ CLAIM POST (LOCATED, ESTIMATED)</p> <p>— CLAIM LINE</p> <p>..... PROSPECTING TRAVERSE (COMPASSED)</p> <p>⊙ OLD PITS OR TRENCHES</p> <p>--- BOUNDARY OF MAJOR FOREST CHANGE OR TOPOGRAPHIC TRANSITION.</p>	<p>0 25 50 75 100</p> <p>(METRES)</p>
<p>DATE: JUNE 19/92</p> <p>SCALE: 1:2500</p>	<p>DRAWN: D. JONES</p> <p>FIELD WORK: J.R. FILO + D. JONES</p>		
<p>WORK PERFORMED: MAY 19/92 (2 MEN PER DAY)</p> <p>MAY 29/92</p> <p>JUNE 14/92</p> <p>JUNE 19/92</p>		<p>J.R. FILO (M25052)</p> <p>D.V. JONES (M21190)</p>	