



41015SW9210 2.15026 RANEY

010

W9360.00094

RANEY TWP.

SALO

RECEIVED
MAY 20 1993
MINING LANDS BRANCH

2.15026

RECEIVED
"C"
MAY 3 1993
@ 1:30 pm Sal.





TABLE OF CONTENTS

Page 1	Raney Township Property Number One	
	Introduction	
	General Geology	
Page 2	Findings; Area 1	
	Findings; Area 2	
Page 3	Raney Township Number Two	
	Location	
	Work	
	General Geology	
Figure 3;1	Raney Township Number One Property Map	page 4
Figure 3;2	General Geology	page 5
Figure 3;3	Raney Township Claim 1176524	page 6
Figure 3;4	Detail Geological Mapping-Area 1	page 7
Figure 3;5	Detail Geological Mapping Area 2	page 8
	Appendum	
	a-Table of Contents	
	B-Statement of Author	
	C-History	
	D-References	
	E-Letter to R. Gashinski	

● Introduction:

The proposed program for Raney Twp. No. 1 was to be a line cut grid with magnetometer, VLF EM 1b surveys and geological mapping.

A work permit was applied for through the Ministry of Natural Resources in Chapleau. Although the work permit was granted it has conditions which prohibit line cutting within 120 meters of Raney Lake and any activity within 200 meters of the Osprey Nest {located approximately center of the claim block}. It also prohibited vehicular access from any existing road.

These conditions left little to access means, except to fly or walk. Supplies for 2 people for 10 days were backpacked into Raney Lake from the McChesney Lumber Road that goes through Raney and Rollo Townships. At Biggs Creek a compass traverse was made for 4.5km to Raney Lake. Due to the distance and terrain, the geophysical equipment was not taken in. see Fig. 3-1 and 3-2

Using the remains of an existing line grid put into place in 1984- two areas were mapped geologically by Joe-Anne Salo and Claire Hebert.

Geological mapping was performed from July 11-17th 1991. The property consists of four contiguous unpatented mining claims located between Raney Lake and Duck Lake.

GENERAL GEOLOGY:

The property is underlain by metavolcanic and metasedimentary rocks of the Swayze-Deloro belt. The metavolcanic sequence includes andesitic to basaltic flows, pillowed flows, felsic to intermediate porphyritic and pyroclastic rocks, thin locally banded cherty interflow metasediments and gabbroic flows. The majority of the outcropping is in the felsic to intermediate pyroclastics with two faults running North South displacing a quartz-feldspar porphyry.

see Fig.3-3

FININGS:

AREA 1:

Previous trenching in this area has exposed an auriferous quartz vein. The quartz carbonate vein has been extensively trenched for a length of 75 meters parallel to the strike at an angle of 110° .

The white quartz carbonate vein is of the pinch and swell type, hosted in a dacitic tuff. The vein varies in width from 3 cm to 90 cm. Mineralization was visible in a silicified zone with brown carbonate stringers. These minerals include: free gold, galena, pyrite, pyrrhotite and chalcopyrite.

see Fig. 3-4

AREA 2:

This area is also a previous trench which has exposed an auriferous quartz vein. This vein was trenched for 35 meters. The white quartz carbonate vein is hosted in a sheared, altered feldspar porphyry. Visible galena and pyrite was seen.

Similar to area 1, this area is of the pinch and swell type. Fine tourmaline seams occur within this vein.

see Fig. 3-5

IT IS PLANNED FOR AUGUST OF 1992, TO GET PERMISSION TO BRUSH OUT THE OLD LINE GRID, RE-CHAIN AND SURVEY. IF FINANCING WILL ALLOW AND A MINISTRY PERSONNEL WILL ACCOMPANY, A TRAIL IS PLANNED TO ACCESS THE PROPERTY FOR THE PURPOSED OF DRILLING WITH A BBS 1.

RANEY TOWNSHIP NUMBER TWO

● Located in the Swayze Greenstone Belt of Northeastern Ontario, in Raney Township, Porcupine Mining Division, this property consists of one unpatented mining claim staked in February of 1991. This claim is located one half mile north of the north west shore of Raney Lake.

Access was via the McChesney Lumber road through Rollo and Raney Townships. This road can be reached from the Foleyet Timber Road out of Foleyet. The McChesney Lumber Road crosses Biggs Creek in Raney Township. From this point supplies and gear were backpacked into Raney Lake. While working on the Raney number one property a two day side trip north to Raney Two was made. Work permit 220 does not permit vehicular access from any existing road.

see Fig.4-1 and 4-2

Work:

A large area of exposed outcrop runs NE-SW along the SE shore of the pond located on the claim. This was geologically mapped by Joe-Anne Salo and Claire Hebert in July 1991.

General Geology:

The claim is underlain by felsic igneous rocks and intermediate and mafic metavolcanics with zones of felsic to intermediate tuffs and agglomerates.

The following are the rock types found on the claim.

BASALT to ANDESITE FLOWS:

Zones of green carbonate alteration was observed in the basaltic flows. Small discontinuous quartz veins in the metavolcanics with visible blebs and cubes of pyrite.

PORPHYRTITIC FLOWS:

Appears as a discrete intrusion within the mafic metavolcanics. White feldspar phenocrysts were seen surrounded by a dark fine grained matrix.

FELSIC to INTERMEDIATE METAVOLCANICS:

The felsic to intermediate metavolcanics were found in several locations. It is light grey-green to tan coloured and fine grained. Only minor carbonate and disseminated pyrite was noted.

see Fig.4-3

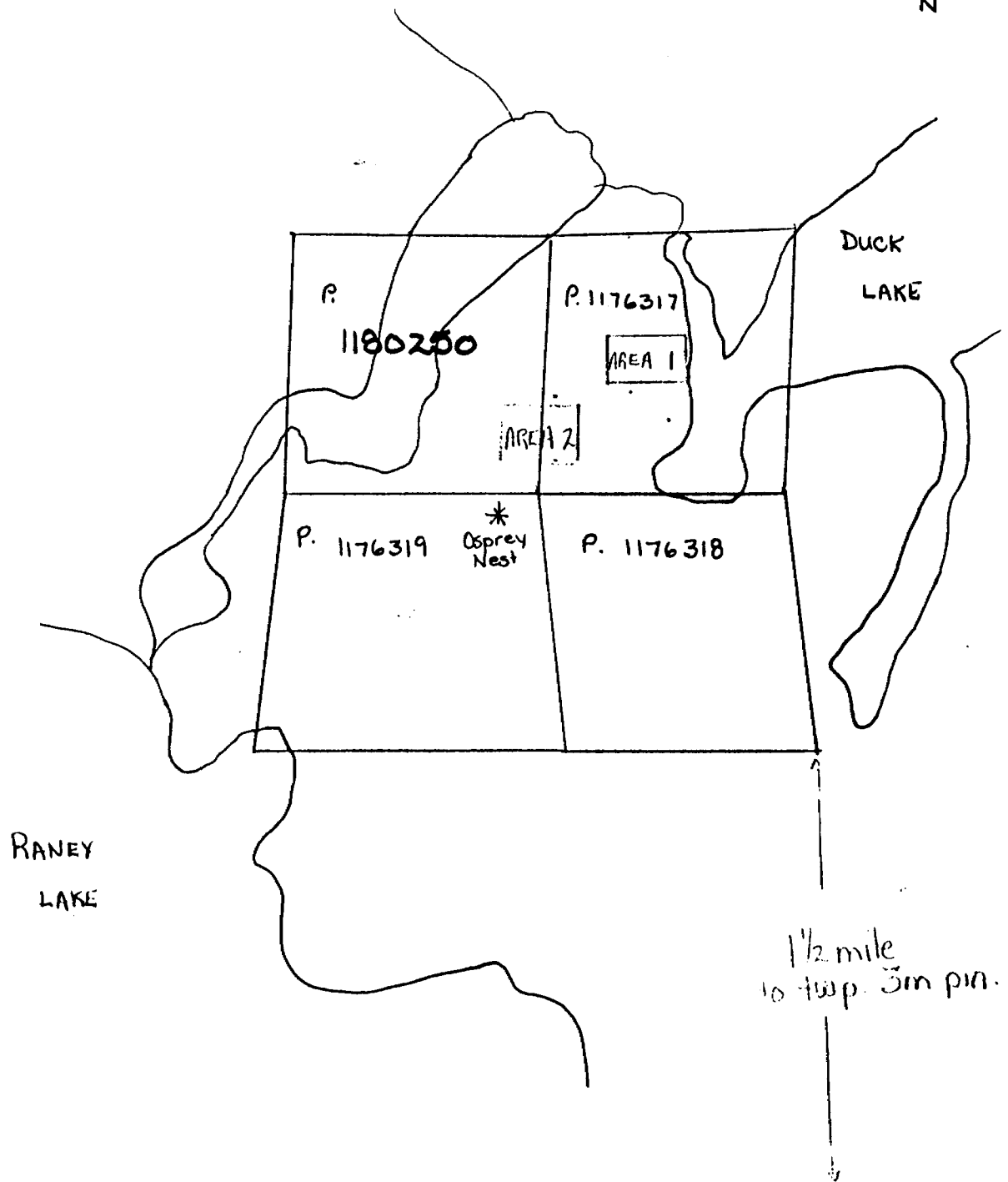

RANEY
LAKE

DUCK
LAKE

RANEY TOWNSHIP NUMBER ONE



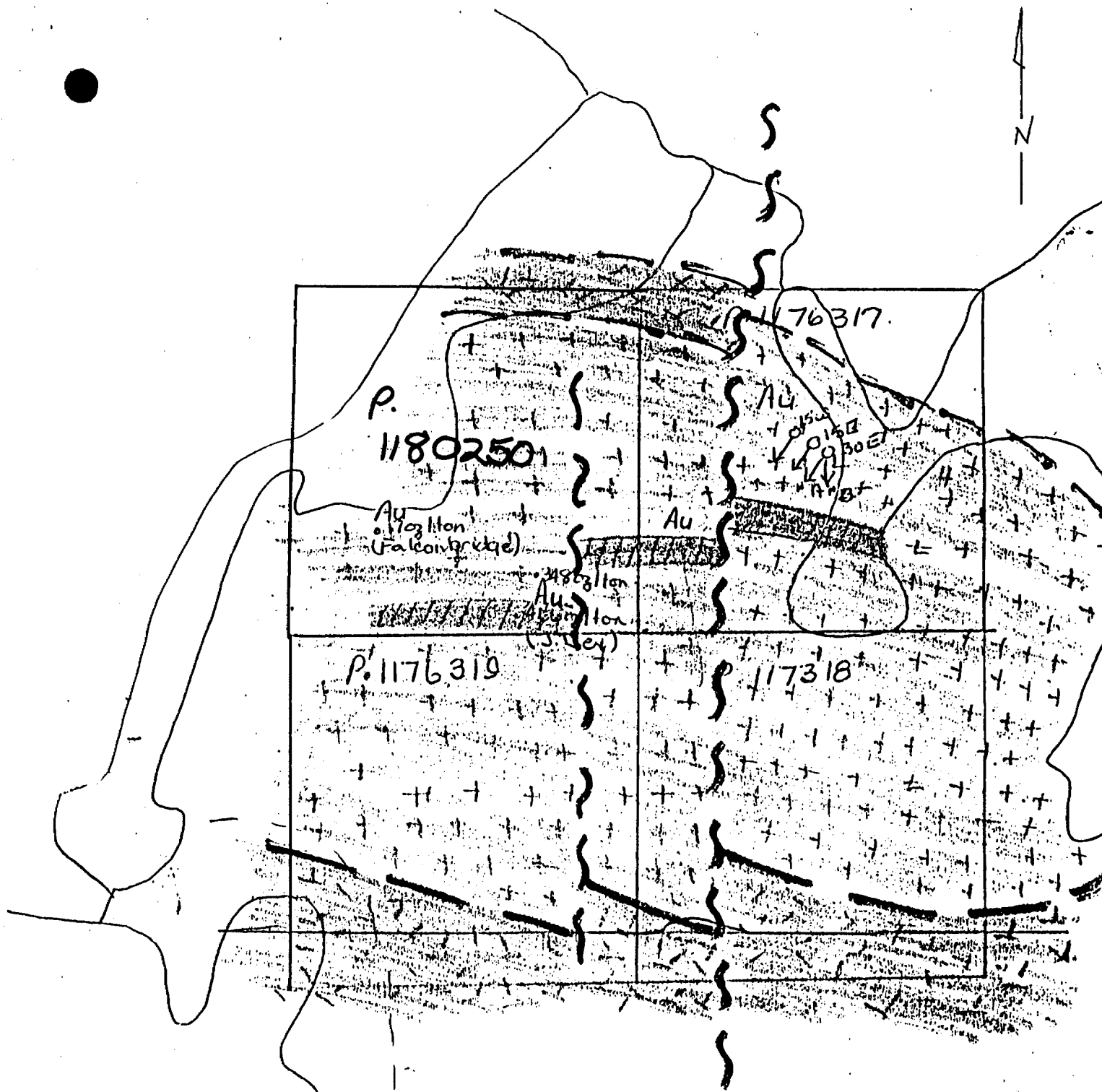
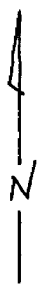

0 100m 200m

1cm = 100 meters
Figure 3-7.



RANEY
LAKE

Au- gold occurrence
⊕ Drill Hole

-  Fault or lineation
-  Porphyritic Flow
or
Quartz-Feldspar Porphyry
-  Felsic to Intermediate Pyroclastics
-  Gabbroic Flows or Intrusions

SALO PROPERTY
RANEY TOWNSHIP

MARCH 1991
Figure 3-3.

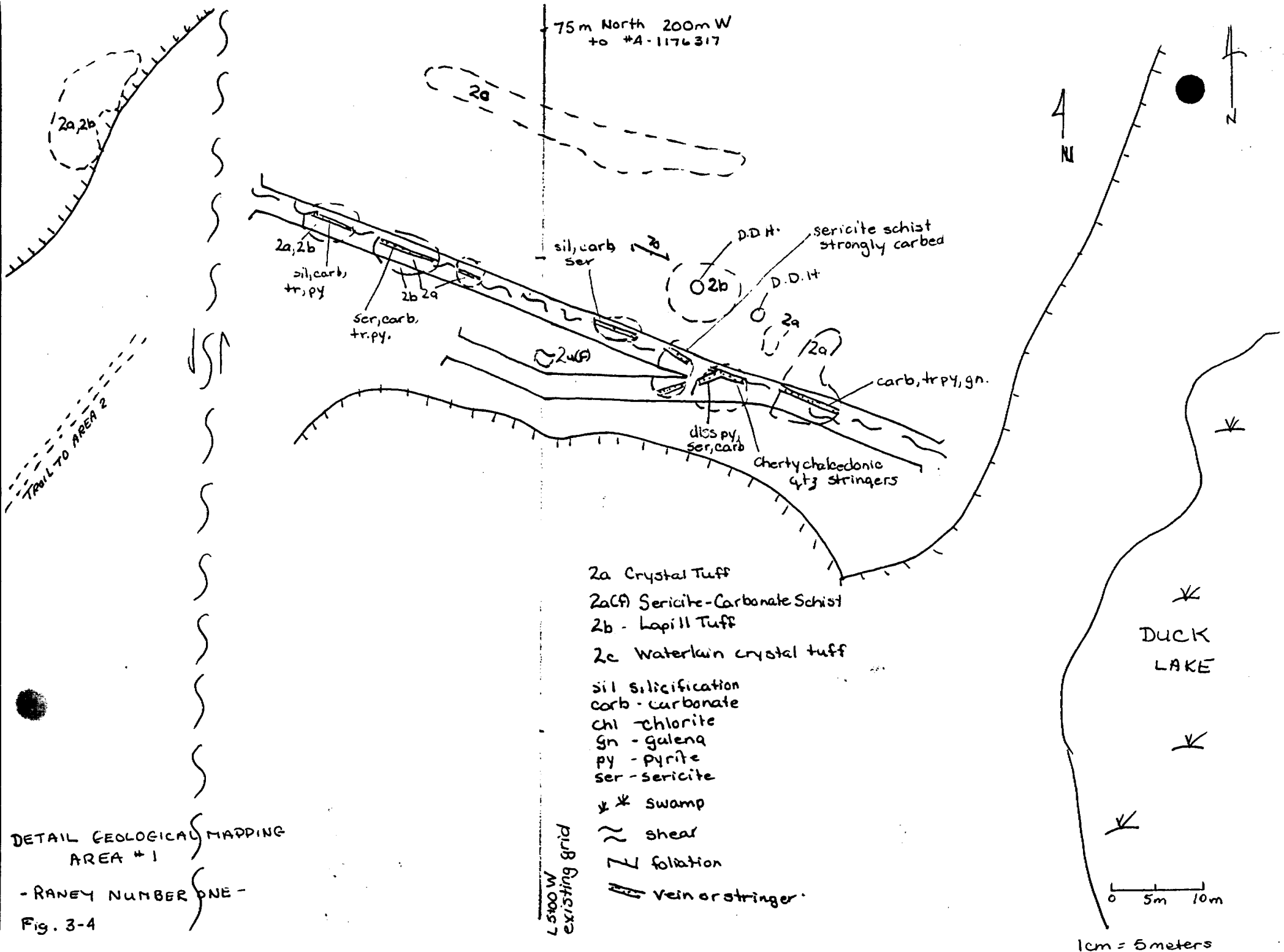

RANEY TOWNSHIP
 -Claim P. 1176524

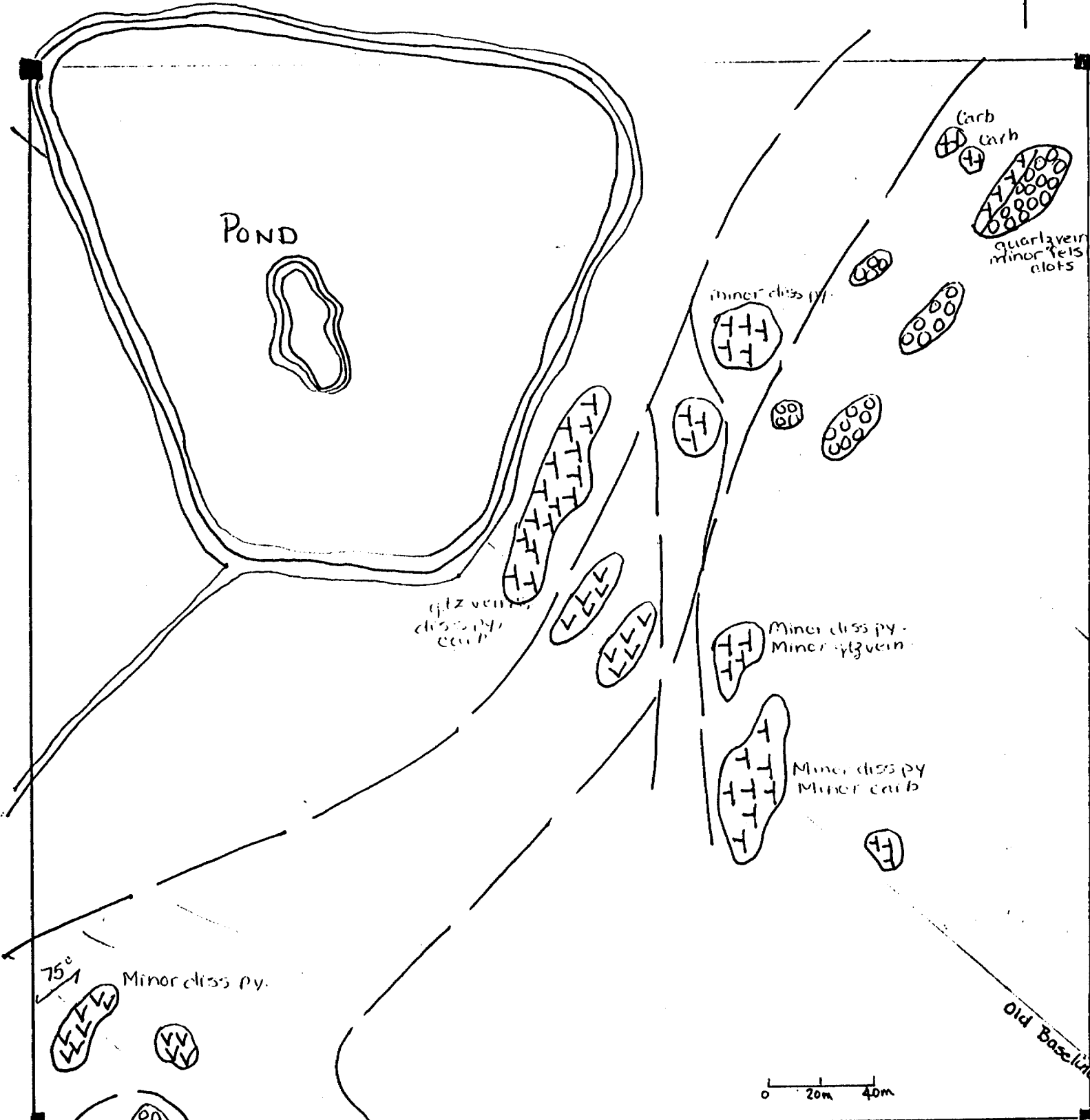

- Basaltic Flows
- Porphyritic Flows
- Felsic to Intermediate Volcanics
- Geological Contact
- Outcrop
- Dioritic Intrusives
- Mafic to Intermediate metavolcanics
- Claim post
5cm = 100 meters

72% py in sheared 2d with
intense quartz-siderite
flooding stringers avg.
2" wide along shear
(Falcon bridge assay
Au-17g/ton over 7ft)

TO AREA #1
200m South of
#4-P.1176317

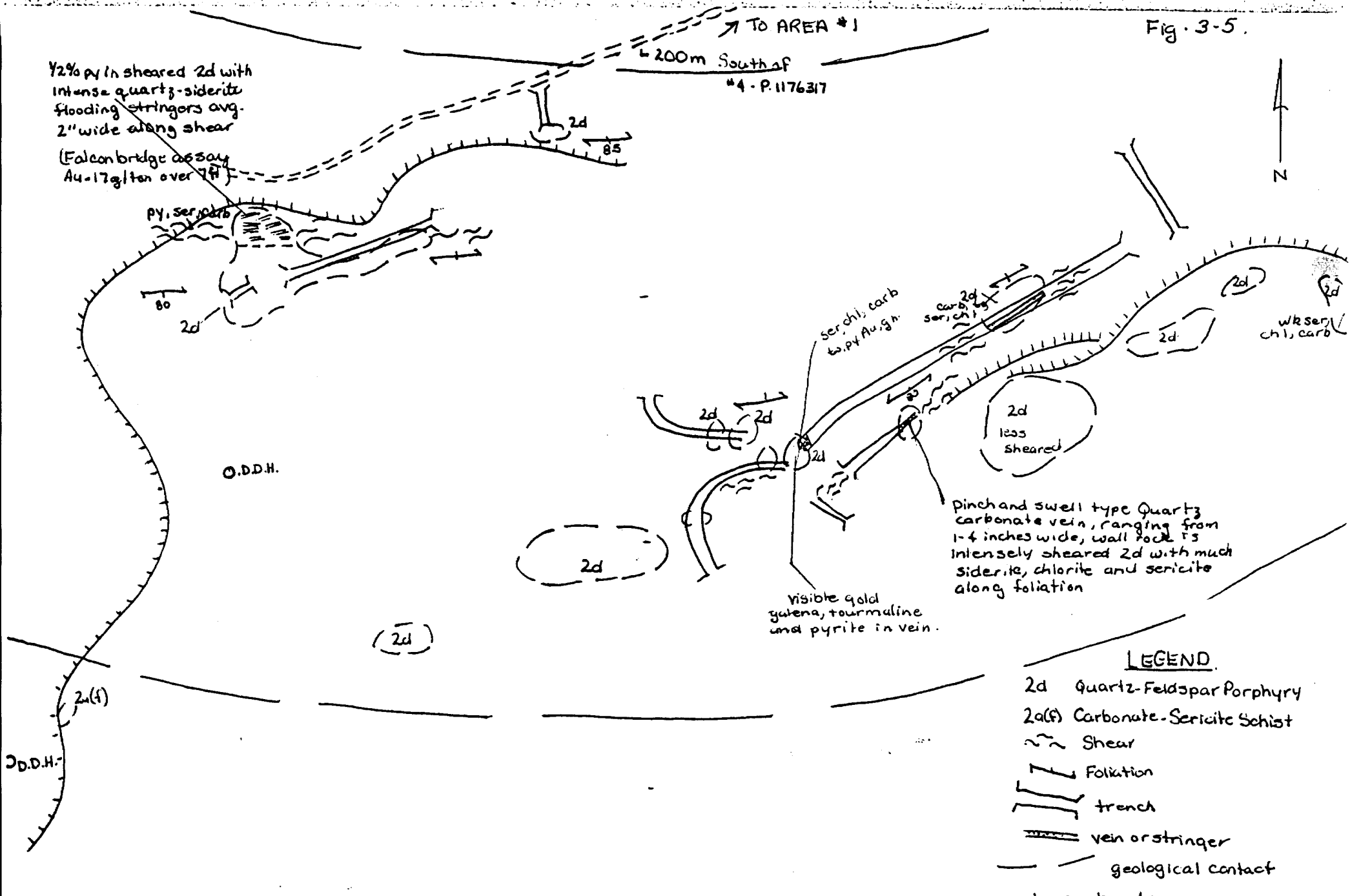

Pinch and swell type Quartz
carbonate vein, ranging from
1-4 inches wide, wall rock is
intensely sheared 2d with much
siderite, chlorite and sericite
along foliation

Visible gold
galena, tourmaline
and pyrite in vein.

LEGEND.

- 2d Quartz-Feldspar Porphyry
- 2d(s) Carbonate-Sericite Schist
- ~ Shear
- Foliation
- trench
- vein or stringer
- geological contact

- carb - carbonate
- chl - chlorite
- gn - galena
- py - pyrite
- ser - Sericite
- to - Tourmaline
- Au - gold

0 5m 10m

1cm = 5 meters

DETAIL GEOLOGICAL MAPPING

AREA 2.

- RANBY TOWNSHIP NUMBER ONE -

17100W
existing grid
- elevation line

APPENDUM C

PREVIOUS WORK HISTORY

The Raney Township Property has seen work sporadically since 1932. The first recorded showing was Throme-Guaser Gold Showing and was report by Furse in 1932 and again by Rickaby in 1935.

In 1972 the property was held by Claw Lake Molybdenite Mines Ltd.,. who performed aeromagnetics and ground geophysics.

In 1982 O.G.S. performed aeromagnetic surveys and electromagnetic surveys. J-Dex Mining then held claims in the area, performing VLF and magnetrometer surveys.

The same company performed diamond drilling with a winkie drill in 1983 and 1984.

Due to the access of this property no heavy equipment work has been performed.

STATEMENT

I Joe-Anne Salo, do hereby state that I have no personal interest in this property and will receive no monies or gratuities regarding such.

I did personally attend the property in July of 1991. The original report was written by me in January 1992. Work was filed with the Mining Recorders office in Timmins in May of 1993. The Appendix to this report was filed September 13 1993.

Joe-Anne G Salo

REFERENCES

- File T-2631 Dore Explorations Ltd.,-Raney Township
"Geological Report of the Raney Township Property
Swayze Gold Belt, Porcupine Mining Division, Ontario"
-D. Hillier and R.S. Middleton 1983
- File T-2157 Candore Exploration Ltd.,
"Report on Airborne Magnetometer Survey on claim groups
Opeepeesway Lake Area, Sudbury District, Ontario."
-H. Bergmann 1972
- File T-2180 J-Dex Exploration Ltd.,-Raney Township
"Geological Report of the 21 Claim Raney Township Property"
Diamond Drill Reports- D.O. Baker
-N. Cairra and I. Coster 1985



This permit is issued under the authority and provisions of the following indicated Provincial Acts and their regulations, and is subject to the limitations and provisions thereof and is also subject to the terms and conditions herein.

- Forest Fires Prevention Act
- Lakes and Rivers Improvement Act
- Public Lands Act as amended

Note: The issuance of this permit does not relieve the applicant from the responsibility of acquiring any other agency, board, government, etc., approval as may be required nor does it relieve the permittee from the requirements of any legislation.

This Permit is Issued to:

Name of Permittee Joe - Anne Salo
Post Office Address RR #1
Connaught, Ontario P0N 1A0

To conduct an operation from the 15 day of July, 1991 to and including the 30 day of December, 1991 on the following work permit area:
Raney Township as shown on map submitted by you.

as per your application dated: June 12, 1991

For the purpose of: Mineral Exploration - Line Cutting

Subject to the following conditions:

1. The Permittee shall keep this permit or a true copy thereof on the work permit area.
2. The person in charge of the operation conducted under this permit shall produce and show this permit or the true copy kept on the work permit area to any officer whenever requested by the officer.
3. Other conditions as listed on the reverse side of this permit as well as those contained in Work Permit Conditions attached.

Place of Issue Chapleau	Date July 10, 1991	Signature of Issuing Officer <i>[Handwritten Signature]</i>
----------------------------	-----------------------	--



Work Permit Conditions

WORK PERMIT NO. 222

The permittee must operate according to the Forest Fires Prevention Act.

The permittee must operate according to the Ministry of Natural Resources guidelines for modifying forest operations in response to fire danger.

Deleterious substances as defined in the Canada Fisheries Act are not to be deposited or allowed to enter any waterbody or watercourse as a result of activities by the permittee.

The permittee is responsible to maintain the site in a safe condition.
The permittee assumes liability for the safety of the work area during and after operations.

All merchantable timber cut or destroyed in the course of the permittee's operation must be:

under the authority of a District Cutting License to be obtained before operations commence.

All merchantable timber must be cut and piled prior to bulldozing.

No debris or trees shall be placed or allowed to be placed in any lake, river, stream, or creek.

Upon completion of the work, the permittee will remove all construction materials, equipment and refuse from the site. The disposal of all waste material must be undertaken in accordance with applicable legislation.

The permittee must ensure that mining claim markings that may be located on the permit area are not damaged or altered.

Information regarding staked claims may be obtained from the Mining Records office at:
60 Wilson Ave., Timmins, Ont. P4N 2S7

A 200 m NO activity zone must be maintained around existing Osprey nest at north end of Raney Lake from April 15 to September 1.

No vehicular access shall be created to the work permit area from any currently existing roads.

No grid lines within 120 metres of Raney Lake (a tourism lake).

This permit is issued under the authority and provisions of the following indicated Provincial Acts and their regulations, and is subject to the limitations and provisions thereof and is also subject to the terms and conditions herein.

- Forest Fires Prevention Act
- Lakes and Rivers Improvement Act
- Public Lands Act as amended

Note: The issuance of this permit does not relieve the applicant from the responsibility of acquiring any other agency, board, government, etc., approval as may be required nor does it relieve the permittee from the requirements of any legislation.

This Permit is Issued to:

Name of Permittee Joe - Anne Salo
Post Office Address RR #1
Connaught, Ontario P0N 1A0

To conduct an operation from the 15 day of July, 19 91 to and including the 30 day of December, 19 91 on the following work permit area:

Raney Township as shown on map submitted by you.

as per your application dated: June 12, 1991

For the purpose of: Mineral Exploration - Line Cutting

*30
7/10/91
Comptroller (Dis. Services) H.G.*

Subject to the following conditions:

1. The Permittee shall keep this permit or a true copy thereof on the work permit area.
2. The person in charge of the operation conducted under this permit shall produce and show this permit or the true copy kept on the work permit area to any officer whenever requested by the officer.
3. Other conditions as listed on the reverse side of this permit as well as those contained in Work Permit Conditions attached.

Place of Issue Chapleau	Date July 10, 1991	Signature of Issuing Officer <i>[Signature]</i>
----------------------------	-----------------------	--



Work Permit Conditions

WORK PERMIT NO. 220

The permittee must operate according to the Forest Fires Prevention Act.

The permittee must operate according to the Ministry of Natural Resources guidelines for modifying forest operations in response to fire danger.

Deleterious substances as defined in the Canada Fisheries Act are not to be deposited or allowed to enter any waterbody or watercourse as a result of activities by the permittee.

The permittee is responsible to maintain the site in a safe condition. The permittee assumes liability for the safety of the work area during and after operations.

All merchantable timber cut or destroyed in the course of the permittee's operation must be:

under the authority of a District Cutting License to be obtained before operations commence.

All merchantable timber must be cut and piled prior to bulldozing.

No debris or trees shall be placed or allowed to be placed in any lake, river, stream, or creek.

Upon completion of the work, the permittee will remove all construction materials, equipment and refuse from the site. The disposal of all waste material must be undertaken in accordance with applicable legislation.

The permittee must ensure that mining claim markings that may be located on the permit area are not damaged or altered.

Information regarding staked claims may be obtained from the Mining Records office at:
60 Wilson Ave., Timmins, Ont. P4N 2S7

No vehicular access shall be created to the work permit area from Ivanhoe River or any other currently existing roads.



41015SW9210 2.15026 RANEY

900

Ministry of
Northern Development
and Mines

Ministère du
Développement du Nord
et des Mines

Geoscience Approvals Section
933 Ramsey Lake Road
6th Floor
Sudbury, Ontario
P3E 6B5

Telephone: (705) 670-5853
Fax: (705) 670-5863

September 21, 1993

Our File: 2.15026
Transaction #: W9360.00094

Mining Recorder
Ministry of Northern
Development and Mines
60 Wilson Avenue
1st Floor
Timmins, Ontario
P4N 2S7

Dear Sir/Madam:

**Subject: APPROVAL OF ASSESSMENT WORK CREDITS ON MINING CLAIM
P1180250 IN RANEY TOWNSHIP**

The assessment work credits for Geology, Section 12, of the Mining Act Regulations, have been approved as outlined on the attached Assessment Work Credit Form.

The approval date is September 13, 1993.

As mentioned in the Notice of Deficiency dated July 30, 1993, work was performed on four claims and not one as the report of work indicates. The work has therefore been reduced to one-quarter to reflect this change.

If you have any questions regarding this correspondence, please contact Lucille Jerome at (705) 670-5855.

Yours sincerely,

Ron C. Gashinski
Senior Manager, Mining Lands Section
Mining and Land Management Branch
Mines and Minerals Division

LJ/dm

cc: Resident Geologist
Timmins, Ontario

Assessment Files Library ✓
Toronto, Ontario

ASSESSMENT WORK CREDIT FORM

FILE NUMBER: 2.15026
DATE: September 13, 1993
RECORDER'S REPORT NUMBER: W9360.00094

RECORDED HOLDER: Larry J. Salo CLIENT NUMBER: 191085

TOWNSHIP OR AREA: Raney Township

CLAIM	VALUE OF WORK DONE ON THIS CLAIM	VALUE APPLIED TO THIS CLAIM	VALUE ASSIGNED FROM THIS CLAIM	RESERVE
P1180250	860	860	0	0

Report of Work Conducted After Recording Claim

Mining Act

MNLB LANDS
Transaction Number
W9360.00094

Personal information collected on this form is obtained under the authority of the Mining Act. This information will be used for correspondence. Questions about this collection should be directed to the Provincial Manager, Mining Lands, Ministry of Northern Development and Mines, Fourth Floor, 159 Cedar Street, Sudbury, Ontario, P3E 8A5, telephone (705) 670-7264.

2.15020

- Instructions:
- Please type or print and submit in duplicate.
 - Refer to the Mining Act and Regulations for requirements of filing assessment work or consult the Mining Recorder.
 - A separate copy of this form must be completed for each Work Group.
 - Technical reports and maps must accompany this form in duplicate.
 - A sketch, showing the claims the work is assigned to, must accompany this form.

Recorded Holder(s) <i>Harry J Salo</i>	Client No. <i>191085</i>
Address <i>General Delivery Connaught</i>	Telephone No. <i>705-363-2108</i>
Mining Division <i>Roscupine</i>	Township/Area <i>Raney Sup</i>
M or G Plan No. <i>6-3245</i>	
Dates Work Performed From: <i>July 11/91</i>	To: <i>July 20/91</i>

Work Performed (Check One Work Group Only)

Work Group	Type
<input type="checkbox"/> Geotechnical Survey	
<input checked="" type="checkbox"/> Physical Work, including Drilling	<i>geological</i>
<input type="checkbox"/> Rehabilitation	
<input type="checkbox"/> Other Authorized Work	
<input type="checkbox"/> Assays	
<input type="checkbox"/> Assignment from Reserve	

RECEIVED
MAY 20 1993
MINING LANDS BRANCH

RECORDED
MAY - 3 1993
Receipt

Total Assessment Work Claimed on the Attached Statement of Costs \$ *3437.*

Note: The Minister may reject for assessment work credit all or part of the assessment work submitted if the recorded holder cannot verify expenditures claimed in the statement of costs within 30 days of a request for verification.

Persons and Survey Company Who Performed the Work (Give Name and Address of Author of Report)

Name	Address
<i>Joe Anne Salo</i>	<i>General Delivery Connaught Ont</i>
<i>Claire Helbert</i>	<i>General Delivery Connaught Ont</i>

(attach a schedule if necessary)

Certification of Beneficial Interest * See Note No. 1 on reverse side

I certify that at the time the work was performed, the claims covered in this work report were recorded in the current holder's name or held under a beneficial interest by the current recorded holder.	Date <i>May 2/93</i>	Recorded Holder or Agent (Signature) <i>J Salo</i>
--	-------------------------	---

Certification of Work Report

I certify that I have a personal knowledge of the facts set forth in this Work report, having performed the work or witnessed same during and/or after its completion and annexed report is true.

Name and Address of Person Certifying <i>Joe Anne J Salo</i>		
Telephone No. <i>705-363-2108</i>	Date <i>May 2, 1993</i>	Certified By (Signature) <i>J Salo</i>

For Office Use Only

Total Value Cr. Recorded <i>\$3437.</i>	Date Recorded <i>MAY 30/93</i>	Mining Recorder <i>White</i>	Received Stamp <i>1993</i>
	Deemed Approval Date <i>AUG. 30/93</i>	Date Approved	
	Date Notice for Amendments Sent		

@ 1:30pm



Ministry of Northern Development and Mines

Ministère du Développement du Nord et des mines

Statement of Costs for Assessment Credit

État des coûts aux fins du crédit d'évaluation

Mining Act/Loi sur les mines

Transaction No./N° de transaction
W9360.0094

2. 15026

Personal information collected on this form is obtained under the authority of the Mining Act. This information will be used to maintain a record and ongoing status of the mining claim(s). Questions about this collection should be directed to the Provincial Manager, Minings Lands, Ministry of Northern Development and Mines, 4th Floor, 159 Cedar Street, Sudbury, Ontario P3E 6A5, telephone (705) 670-7264.

Les renseignements personnels contenus dans la présente formule sont recueillis en vertu de la Loi sur les mines et serviront à tenir à jour un registre des concessions minières. Adresser toute question sur la collecte de ces renseignements au chef provincial des terrains miniers, ministère du Développement du Nord et des Mines, 159, rue Cedar, 4^e étage, Sudbury (Ontario) P3E 6A5, téléphone (705) 670-7264.

1. Direct Costs/Coûts directs

Type	Description	Amount Montant	Totals Total global
Wages Salaires	Labour Main-d'oeuvre	3000	
	Field Supervision Supervision sur le terrain		3000
Contractor's and Consultant's Fees Droits de l'entrepreneur et de l'expert-conseil	Type		
Supplies Used Fournitures utilisées	Type		
Equipment Rental Location de matériel	Type		
	Receipt		
Total Direct Costs Total des coûts directs			3000

2. Indirect Costs/Coûts indirects

** Note: When claiming Rehabilitation work Indirect costs are not allowable as assessment work. Pour le remboursement des travaux de réhabilitation, les coûts indirects ne sont pas admissibles en tant que travaux d'évaluation.

Type	Description	Amount Montant	Totals Total global
Transportation Transport	Type		
	Road (800km)	240	
Food and Lodging Nourriture et hébergement			
	groceries	197.25	
Mobilization and Demobilization Mobilisation et démoblisation			
Sub Total of Indirect Costs Total partiel des coûts indirects			240
Amount Allowable (not greater than 20% of Direct Costs) Montant admissible (n'excedant pas 20 % des coûts directs)			48
Total Value of Assessment Credit (Total of Direct and Allowable indirect costs) Valeur totale du crédit d'évaluation (Total des coûts directs et indirects admissibles)			3048

Note: The recorded holder will be required to verify expenditures claimed in this statement of costs within 30 days of a request for verification. If verification is not made, the Minister may reject for assessment work all or part of the assessment work submitted.

Note : Le titulaire enregistré sera tenu de vérifier les dépenses demandées dans le présent état des coûts dans les 30 jours suivant une demande à cet effet. Si la vérification n'est pas effectuée, le ministre peut rejeter tout ou une partie des travaux d'évaluation présentés.

Filing Discounts

- Work filed within two years of completion is claimed at 100% of the above Total Value of Assessment Credit.
- Work filed three, four or five years after completion is claimed at 50% of the above Total Value of Assessment Credit. See calculations below:

Total Value of Assessment Credit	Total Assessment Claimed
	× 0.50 =

Remises pour dépôt

- Les travaux déposés dans les deux ans suivant leur achèvement sont remboursés à 100 % de la valeur totale susmentionnée du crédit d'évaluation.
- Les travaux déposés trois, quatre ou cinq ans après leur achèvement sont remboursés à 50 % de la valeur totale du crédit d'évaluation susmentionné. Voir les calculs ci-dessous.

Valeur totale du crédit d'évaluation	Evaluation totale demandée
	× 0,50 =

Certification Verifying Statement of Costs

I hereby certify: that the amounts shown are as accurate as possible and these costs were incurred while conducting assessment work on the lands shown on the accompanying Report of Work form.

that as Agent I am authorized (Recorded Holder, Agent, Position in Company)

to make this certification

Attestation de l'état des coûts

J'atteste par la présente : que les montants indiqués sont le plus exact possible et que ces dépenses ont été engagées pour effectuer les travaux d'évaluation sur les terrains indiqués dans la formule de rapport de travail ci-joint.

Et qu'à titre de _____ je suis autorisé (titulaire enregistré, représentant, poste occupé dans la compagnie)

à faire cette attestation.

Signature J. Salo Date 05/03/93

REFERENCES

AREAS WITHDRAWN FROM DISPOSITION

- M.R.O. - MINING RIGHTS ONLY
- S.R.O. - SURFACE RIGHTS ONLY
- M.+S. - MINING AND SURFACE RIGHTS

Description	Order No.	Date	Disposition	File
<p>Ⓣ THIS TWP. IS SUBJECT TO FOREST ACTIVITY IN 1993/94. FURTHER INFORMATION ON FILE.</p>				

Ⓣ THIS TWP. IS SUBJECT TO FOREST ACTIVITY IN 1993/94. FURTHER INFORMATION ON FILE.

CROCKETT TWP.

HELLYER TWP.

HALCROW TWP.

DENYES TWP.

MAGNETIC DECLINATION 9° WEST

ROLLO TWP.

LEGEND

- HIGHWAY AND ROUTE No.
- OTHER ROADS
- TRAILS
- SURVEYED LINES:
 - TOWNSHIPS, BASE LINES, ETC.
 - LOTS, MINING CLAIMS, PARCELS, ETC.
- UNSURVEYED LINES:
 - LOT LINES
 - PARCEL BOUNDARY
 - MINING CLAIMS ETC.
- RAILWAY AND RIGHT OF WAY
- UTILITY LINES
- NON-PERENNIAL STREAM
- FLOODING OR FLOODING RIGHTS
- SUBDIVISION OR COMPOSITE PLAN
- RESERVATIONS
- ORIGINAL SHORELINE
- MARSH OR MUSKEG
- MINES
- TRAVERSE MONUMENT

DISPOSITION OF CROWN LANDS

TYPE OF DOCUMENT	SYMBOL
PATENT, SURFACE & MINING RIGHTS	●
" SURFACE RIGHTS ONLY	○
" MINING RIGHTS ONLY	○
LEASE, SURFACE & MINING RIGHTS	■
" SURFACE RIGHTS ONLY	■
" MINING RIGHTS ONLY	■
LICENCE OF OCCUPATION	◀
ORDER-IN-COUNCIL	OC
RESERVATION	Ⓞ
CANCELLED	Ⓢ
SAND & GRAVEL	Ⓢ
REMOTE TOURIST CAMP	Ⓢ

NOTE: MINING RIGHTS IN PARCELS PATENTED PRIOR TO MAY 6, 1912, VESTED IN ORIGINAL PATENTEE BY THE PUBLIC LANDS ACT, R.S.O. 1970, CHAP. 380, SEC. 63, SUBSEC. 1.

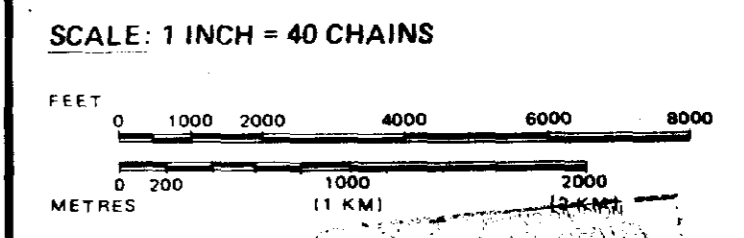

TOWNSHIP
RANEY 2, 150 26
 M.N.R. ADMINISTRATIVE DISTRICT
CHAPLEAU RECEIVED
 MINING DIVISION
PORCUPINE MAY 20 1993
 LAND TITLES / REGISTRY DIVISION
SUDBURY

Ministry of Land Management
 Natural Resources Branch
 Ontario

Date MARCH, 1985 Number
 ACTIVATED JUNE 30, 1992 BY D.C. **G-3245**

THE INFORMATION THAT APPEARS ON THIS MAP HAS BEEN COMPILED FROM VARIOUS SOURCES, AND ACCURACY IS NOT GUARANTEED. THOSE WISHING TO STAKE MINING CLAIMS SHOULD CONSULT WITH THE MINING RECORDER, MINISTRY OF NORTHERN DEVELOPMENT AND MINES, FOR ADDITIONAL INFORMATION ON THE STATUS OF THE



410155#9210 2.15026 RANEY

C-3542

RANEY TWP

C-3542