



41016SE0026 11 GENOA

010

Diamond Drilling

Township of GENOA

Report N^o 11

Work performed by: Central Sudbury Lead-Zinc Mines Ltd.

Claim N ^o	Hole N ^o	Footage	Date	Note
S 51074	N-2	307.0'	Aug/48	
	N-3	296.0'	Aug-Sept/48	
S 51073	N-1	250.0'	Aug/48	
	N-4	265.0'	Sept/48	
	N-5	290.0'	Sept/48	

500H 1408'

Notes:

DIAMOND DRILL RECORD

LOCATION: LAT. 358' South of #4 Post & 34' East
 DEP. S 51073
 ELEVATION OF COLLAR
 DATUM
 DIRECTION AT START: BEARING N 2 Degrees E
 DIP N 50 Degrees

STARTED August 12, 1948
 COMPLETED August 17, 1948
 ULTIMATE DEPTH
 PROPOSED DEPTH

DEPTH FEET	FORMATION	SAMPLE No.	WIDTH OF SAMPLE	GOLD \$	SLUDGE GOLD \$
0-6	Casing				
6-11	Grey feldspar porphyry				
11-14	Volcanics				
14-28	Highly altered volcanics intruded by quartz, porphyry and granite stringers.				
28-30	Iron formation Massive	112	28-5 to 29.5	1 ft.	
	pyrrhotite, quartz & sphalerite				
30-77	Highly altered and sheared volcanics intruded by granite and porphyry dikes 1 ft. wide				
77-83.5	Acid complex - sheared granite phase				
83.5-97	Vein zone banded quartz & volcanics, considerable pyrrhotite highly garnetiferous, high temp alteration some sphalerite & chalc.				
97-105	Grey feldspar porphyry mineralized				
105-116.5	Sheared & Altered porphyry				
116.5-146.5	Highly altered acid volcanics garnetiferous, pyrrhotite				

PROPERTY CENTRAL SUDBURY LEAD-ZINC MINES LIMITED

HOLE NUMBER N1

SHEET NUMBER 2

SECTION FROM 146.5 TO 250

DIAMOND DRILL RECORD

LOCATION: LAT. 358' South of #4 Post & 34' East
 DEP. Claim S-51073

STARTED August 12, 1948

ELEVATION OF COLLAR

COMPLETED August 17, 1948

DATUM

ULTIMATE DEPTH

DIRECTION AT START: BEARING N 20 Degrees E
 DIP N 50 Degrees

PROPOSED DEPTH

DEPTH FEET	FORMATION	SAMPLE NO.	WIDTH OF SAMPLE	GOLD \$	SLUDGE GOLD \$
146.5-147.5	Lamprophyre				
147.5-152	Highly altered silicious volcanics				
152-166.5	Vein Zone - Banded quartz & volcanics sheared veinlets of sphalerite galena & graphite	113	152.5 - 153.5	1 ft.	
	2½ feet granite containing ZN & PB	114	154.5 to 158.3	3½ ft.	
	Lost Core	115	158 to 159.3	1.3 ft.	
153.5-154.5	Basic Greenstone (some zinc)	116	162.3 to 166.2	3.9 ft.	
166.5-191	Vein zone banded altered volcanics stringers of sphalerite and galena some quartzite	117	159.3 to 162.3	3 ft.	
191-201		118	191.5 to 194.5	3 ft.	
		119	194.5 to 197	2.5 ft.	
		120	197 to 200.5	3.5 ft.	
201-212	Altered volcanics (some zinc)				
212-232	Basic Greenstone				
232-246	Feldspar porphyry				
246-250	Basic Greenstone				

DRILLED BY

SIGNED R. Russell Clark

SKETCH

Showing location Diamond Drill Hole No. N 1

CENTRAL SUDBURY LEAD-ZINC MINES LIMITED

L A K E

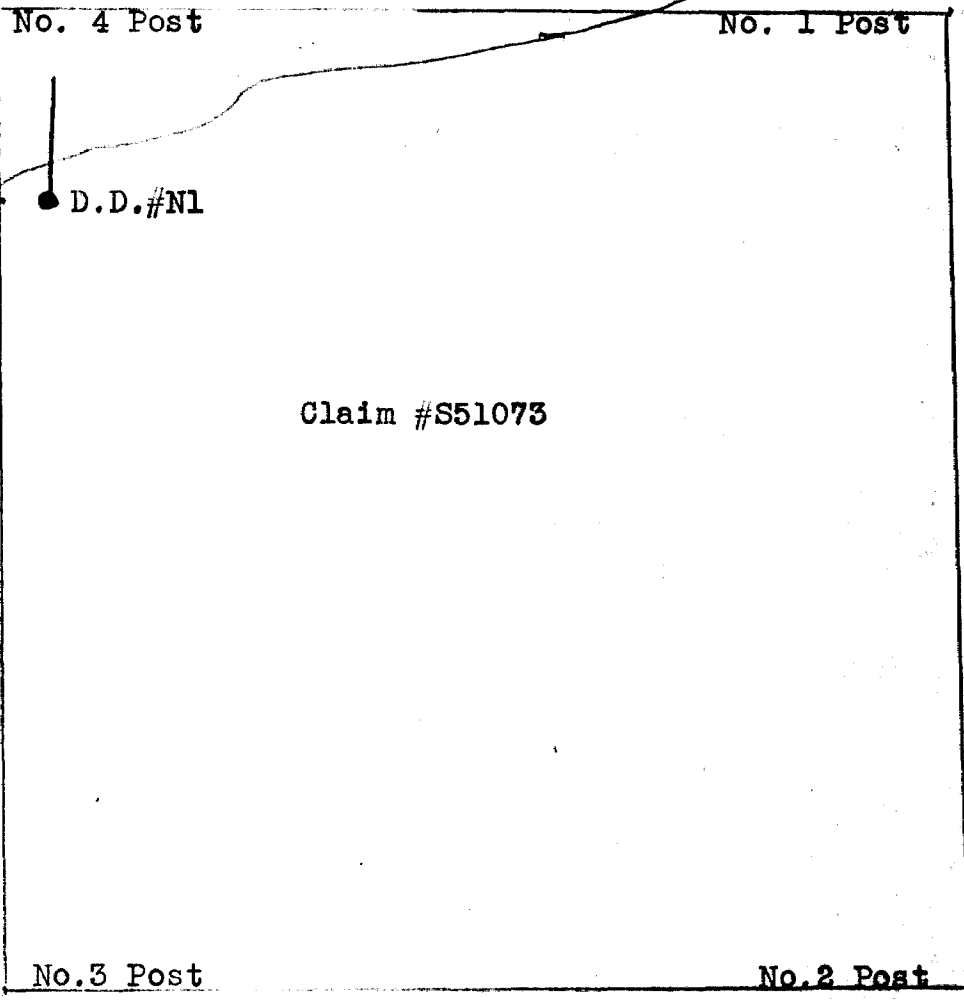

PROPERTY CENTRAL SUDBURY LEAD-ZINC MINES LIMITED

HOLE NUMBER N2

SHEET NUMBER 1

SECTION FROM 0 TO 97.5

DIAMOND DRILL RECORD

LOCATION: LAT. 50' West of Hole N 1
 DEP.
 ELEVATION OF COLLAR
 DATUM
 DIRECTION AT START: BEARING Due North
 DIP 50 Degrees

STARTED August 20, 1948
 COMPLETED August 29, 1948
 ULTIMATE DEPTH 307
 PROPOSED DEPTH

DEPTH FEET	FORMATION	SAMPLE NO.	WIDTH OF SAMPLE	GOLD \$	SLUDGE GOLD \$
0-7	Casing				
7-7.6	Feldspar porphyry				
7.6-7.9	Lamprophyre				
7.9-9.6	Feldspar porphyry				
9.6-49.5	Altered volcanics & garnet gneiss intruded by qtz. & granite stringers Much pyrrhotite from 30-32 Zinc at 31 & 49 ft.				
49.5-56	Light green tuff. (Epidote crystals?)				
56-58	Highly altered volcanics				
58-65	Acid Complex				
65-68	Highly altered volcanics, Min.				
68-74.5	Sheared Min. qtz. porphyry some zinc at 70 & 72 ft.				
74.5-87	VEIN ZONE Banded silica and garnetiferrous volcanics. Some sphalerite, chalcopyrite & pyrrhotite				
87-90	Feldspar porphyry				
90-97.5	Highly altered volcanics - garnet gneiss				

NORTHERN MINER PRESS LIMITED, TORONTO-STOCK FORM No. 501 REV. 9/44

DRILLED BY

SIGNED R. Russell Clark

DIAMOND DRILL RECORD

LOCATION: LAT. 50' West of Hole N. 1
 DEP.
 ELEVATION OF COLLAR
 DATUM
 DIRECTION AT START: BEARING Due North
 DIP 50 Degrees

STARTED August 20, 1948
 COMPLETED August 29, 1948
 ULTIMATE DEPTH 307
 PROPOSED DEPTH

DEPTH FEET	FORMATION	SAMPLE NO.	WIDTH OF SAMPLE	GOLD \$	SLUDGE GOLD \$
97.5-104	Feldspar porphyry. Specks of sphalerite & galena throughout				
104-115	Garnet gneiss, min.				
115-123	Altered Siliceous Volcanics some zinc.				
123-166	Altered Basic volcanics - specks of sphalerite and galena to 150 feet.				
166-167	Lamprophyre				
167-173	Altered basic volcanics				
173-177.5	Feldspar porphyry				
177.5-231	Altered basic volcanic, some zinc from				
195-203					
231-243	Feldspar Porphyry				
243-269	Altered volcanics				
269-277	VEIN ZONE Highly sheared & oxidized Brown & green oxides. Much pyrrhotite. Some galena & Sphalerite Green oxide possibly smithsonite	0121	269 - 275		
277-281	Altered volcanics				
281-282	Feldspar porphyry				

SKETCH

Showing location Diamond Drill Hole No. N 2

CENTRAL SUDBURY LEAD-ZINC MINES LIMITED

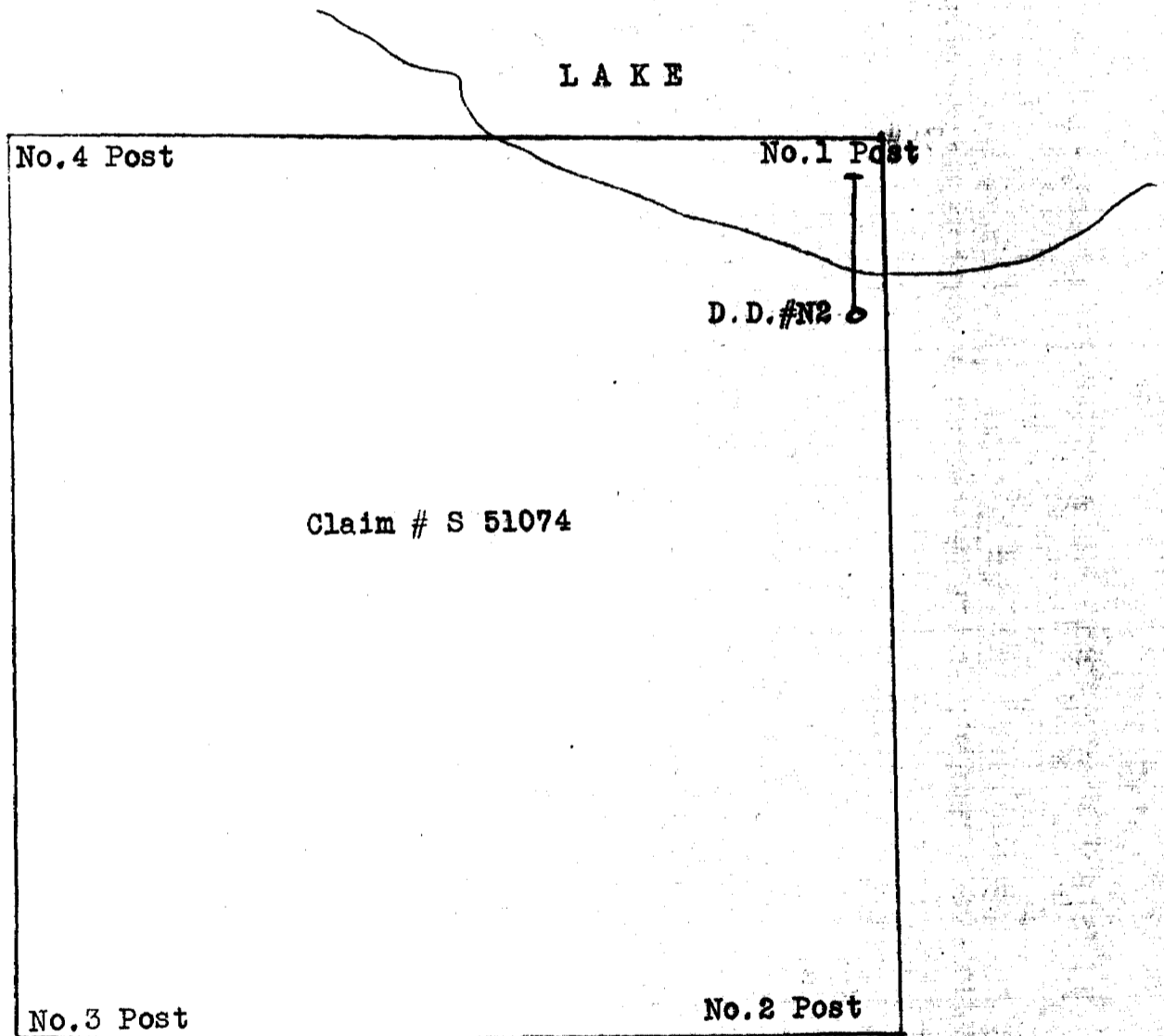

PROPERTY CENTRAL SUDBURY LEAD-ZINC MINES LIMITED

HOLE NUMBER N3

SHEET NUMBER 1

SECTION FROM 0 TO 127

DIAMOND DRILL RECORD

LOCATION: LAT. 45° South of 2
 DEP.

STARTED August 30, 1948

ELEVATION OF COLLAR

COMPLETED September 7, 1948

DATUM

ULTIMATE DEPTH 296

DIRECTION AT START: BEARING Due North
 DIP 45 Degrees

PROPOSED DEPTH

DEPTH FEET	FORMATION	SAMPLE No.	WIDTH OF SAMPLE	GOLD \$	SLUDGE GOLD \$
0-10	Casing				
10-28	Lamprophyre dike, coarse grained in middle, some enclosed altered granite		0129 -	10 to 12	
28-33	Garnet Gneiss				
33-35	Lamprophyre				
35-48.5	Altered volcanics, banded chalco, pyrrhotite specks of zinc.				
48.5-74.5	Sheared, altered volcanics and garnet gneiss, pyrrhotite & chalco, zinc at 50-51.5				
74.5-76	Feldspar porphyry				
76-84.5	Acid complex				
84.5-86.5	Feldspar porphyry				
86.5-91.5	Altered volcanics				
91.5-94	Feldspar porphyry				
94-105.5	Altered volcanics (green oxides at 97)				
105.5-109.8	Vein Zone	0122	105.5 to 107		
	Well mineralized schist & quartz, considerable chalco, pyrrhotite & garnets	0123	108 to 109.8		
109.8-115.5	Altered volcanics (brown Mica) 114.8 to 115.6	0124 (test sample)	114.8 to 115.6		
115.5-116.5	Lost Core				
116.5-127	Acid Complex				

NORTHERN MINER PRESS LIMITED, TORONTO—STOCK FORM NO. 501 REV. 9/44

DRILLED BY

SIGNED R. Russell Clark

5-7-248

DIAMOND DRILL RECORD

LOCATION: LAT. 45° South of 2
 DEP.
 ELEVATION OF COLLAR
 DATUM
 DIRECTION AT START: BEARING Due North
 DIP 45 Degrees

STARTED August 30, 1948
 COMPLETED September 7, 1948
 ULTIMATE DEPTH 296
 PROPOSED DEPTH

DEPTH FEET	FORMATION	SAMPLE No.	WIDTH OF SAMPLE	GOLD \$	SLUDGE GOLD \$
127-165.5	Basic Greenstone				
165.5-167.5	Altered volcanics				
167.5-168.5	Granite				
168.5-172	Altered volcanics				
172-174.2	Acid complex Zinc at 172 & 174				
174.2-182	Altered volcanics				
182-189	Feldspar porphyry				
189-195	Lost Core				
195-196	Feldspar porphyry				
196-205.5	Altered volcanics				
205.5-209	Garnet Gneiss				
209-222	Basic volcanics				
222-222.5	Quartz vein (Barren)				
222.5-225	Feldspar Porphyry				
225-228	Altered volcanics				
228-235.5	Garnet Gneiss & Basic Greenstone				
235.5-244	Altered volcanics				
244-257	Garnet Gneiss				
257-270	Altered volcanics				
270-283.5	Basic Greenstone				
283.5-296	Porphyry				
	END OF HOLE				

SKETCH

Showing location Diamond Drill Hole No. N 5

CENTRAL SUDBURY LEAD-ZINC MINES LIMITED

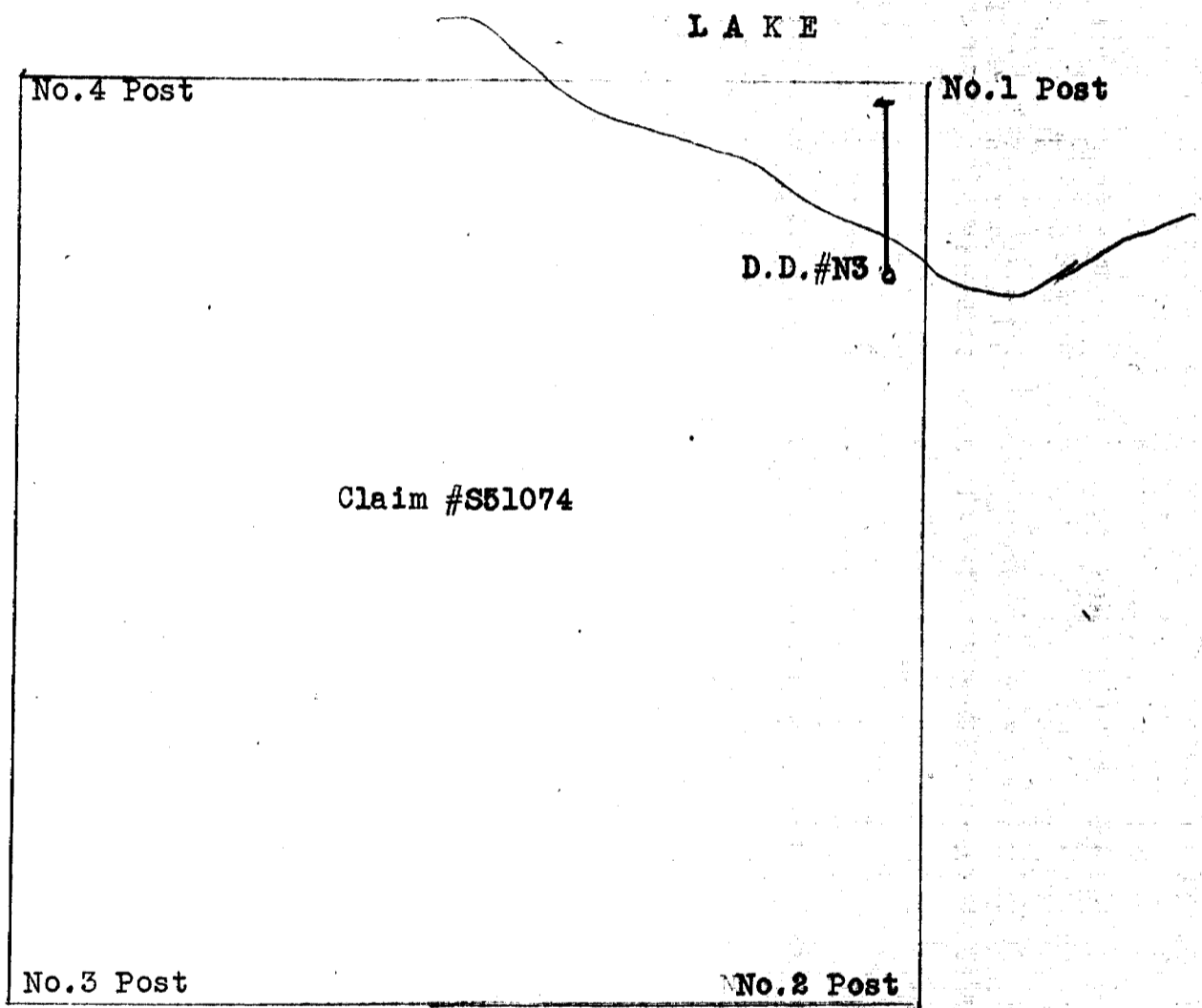

DIAMOND DRILL RECORD

LOCATION: LAT. 50° East of N-1
 DEP.
 ELEVATION OF COLLAR
 DATUM
 DIRECTION AT START: BEARING Due North
 DIP 50 Degrees

STARTED
 COMPLETED September 19, 1948
 ULTIMATE DEPTH 265
 PROPOSED DEPTH

DEPTH FEET	FORMATION	SAMPLE No.	WIDTH OF SAMPLE	GOLD \$	SLUDGE GOLD \$
0-9.2	Casing				
9.2-14	Granite Porphyry				
14-14.5	Quartz Porphyry				
14.5-17.5	Granite Porphyry				
17.5-18	Quartz Porphyry				
18-26	Basic Greenstone quartz stringers				
26-87	Garnet Gneiss, some chalco & pyrrhotite seams of pyrrhotite at 31 quartz stringers from 54 to 87	130	48 to 50 ft.	test for fine grained lead	
87-102	Banded quartz & altered volcanics considerable pyrrhotite some chalco				
102-107	Garnet gneiss (translucent real mineral in places)				
107-108.5	Lost core				
108.5-112	Garnet gneiss				
112-113.5	Quartz Porphyry (altered)				
113.5-124.5	Garnet Gneiss				
124-5-126	Quartz porphyry				
126-131.3	Altered Volcanics				
131.3-132	Lamprophyre				

DIAMOND DRILL RECORD

LOCATION: LAT.....
 DEP.....
 ELEVATION OF COLLAR.....
 DATUM.....
 DIRECTION AT START: BEARING.....
 DIP.....

STARTED.....
 COMPLETED.....
 ULTIMATE DEPTH.....
 PROPOSED DEPTH.....

DEPTH FEET	FORMATION	SAMPLE No.	WIDTH OF SAMPLE	GOLD \$	SLUDGE GOLD \$
132-135.5	Altered volcanics zinc at 135.1				
135.5-138.5	Lost Core				
138.5-151	Garnet Gneiss Red Mineral from 147 to 149				
151-154.5	Acid Altered volcanics				
154.5-158	Garnet Gneiss chalcocite at 158				
158-158.5	Altered basic greenstone				
158.5-160.5	Garnet Gneiss				
160.5-162.5	Banded volcanics & quartz pyrrhotite & Chalcocite				
162.5-191.5	Garnet gneiss, zinc in specks and narrow stringers from 176 to 191.5	136	184.8 to 188		
191.5-205	Basic greenstone highly altered	131	191.1 to 193		
	Lead & Zinc	132	193 to 196		
205-206.2	Lost Core	133	196 to 199		
206.2-211.5	Banded volcanics pyrrhotite	134	199 to 202		
211.5-212.2	Lost Core	135	202 to 205		
212.5-246	Basic greenstone				
246-263	Quartz porphyry				
263-265	Basic Greenstone				
	END OF HOLE				

SKETCH

Showing location Diamond Drill Hole No. N 4

CENTRAL SUDBURY LEAD-ZINC MINES LIMITED

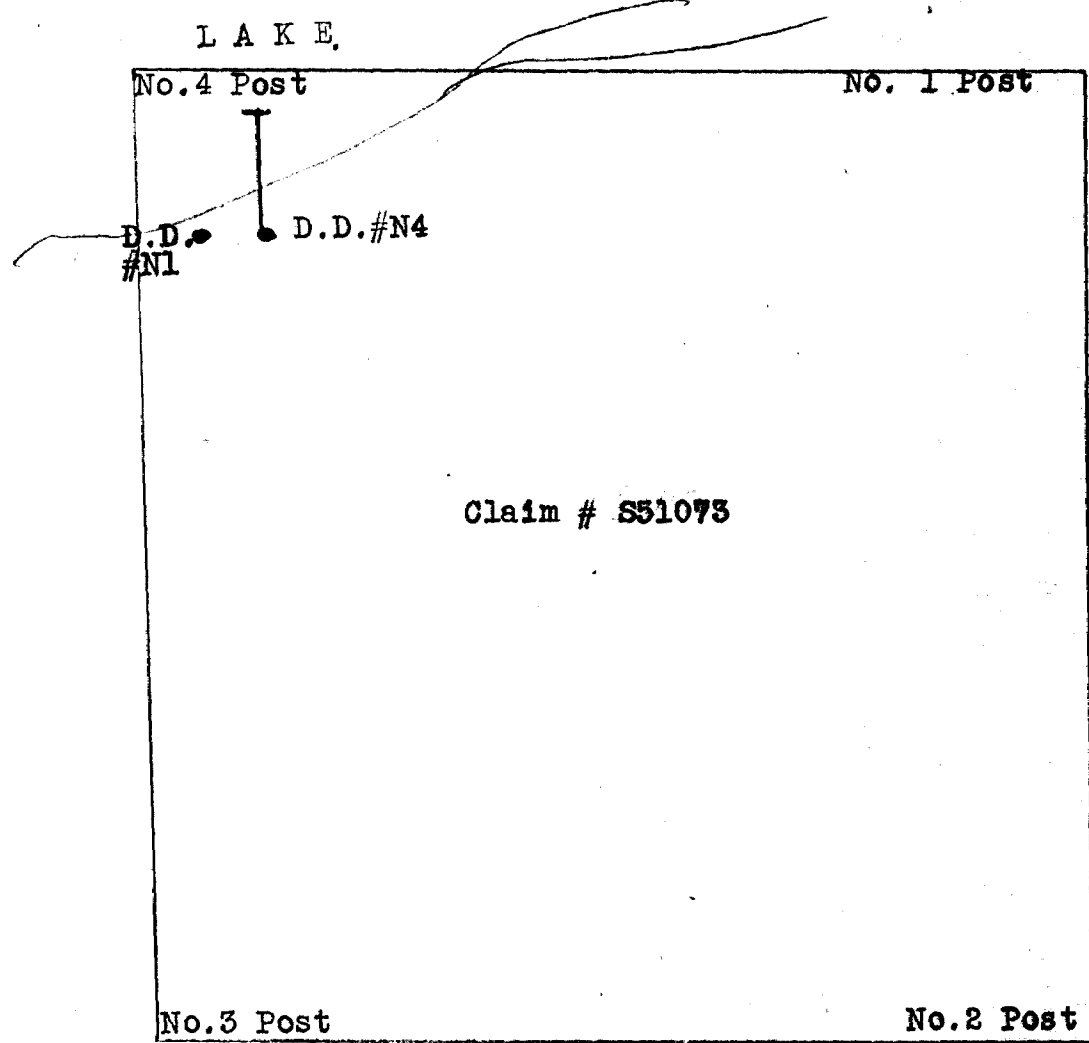

DIAMOND DRILL RECORD

LOCATION: LAT. 100° due East of N-1
 DEP.

STARTED September 20, 1948

ELEVATION OF COLLAR

COMPLETED September 27, 1948

DATUM

ULTIMATE DEPTH

DIRECTION AT START: BEARING Due North
 DIP 50 Degrees

PROPOSED DEPTH

DEPTH FEET	FORMATION	SAMPLE NO.	WIDTH OF SAMPLE	GOLD \$	SLUDGE GOLD \$
0-9	Casing				
9-14.5	Quartz Porphyry				
14.5-42	Granite Porphyry				
42-48.5	Altered volcanics				
48.5-84.5	Granite Porphyry				
84.5-91	Banded-Volcanics & Quartz				
91-106.2	Garnet Gneiss				
106.2-107.5	Lamprophyre				
107.5-110	Gneiss				
110-115	Altered quartz porphyry				
115-130	Garnet Gneiss, stringer Course Granite 118 to 120				
130-132.5	Altered quartz porphyry				
132.5-175	Garnet gneiss pyrrhotite at 162 Chalco 174				
175-178	Banded quartz & Volcanics fine seams of zinc				
178-207	Garnet Gneiss fractured from 202				
	Considerable pyrrhotite				
	Vien Zone				
207-208	Green schist (soft) fine grained pyrrhotite & magnetite	143	207 to 208	.03 PB	.0924
208-210	Lost core (ground sludge very black than very green)				

PROPERTY CENTRAL SUDBURY LEAD-ZINC MINES LIMITED

HOLE NUMBER N5

SHEET NUMBER 2

DIAMOND DRILL RECORD

SECTION FROM 210 TO 265

LOCATION: LAT.....
DEP.....

STARTED.....

ELEVATION OF COLLAR.....

COMPLETED.....

DATUM.....

ULTIMATE DEPTH.....

DIRECTION AT START: BEARING.....
DIP.....

PROPOSED DEPTH.....

DEPTH FEET	FORMATION	SAMPLE No.	WIDTH OF SAMPLE	GOLD \$	SLUDGE GOLD \$		
210-210.5	Quartz & Schist some lead & zinc						
210-211.5	Altered quartz porphyry seam of lead & zinc						
211.5-212	Schist & quartz some lead & zinc						
212-214	Lost Core			.58 PB	1.56		
214-216	Banded quartz considerable lead & zinc		144	214 to 216	2 ft.		
216-217.5	Lost Core						
217.5-218.5	Banded quartz considerable lead & zinc		145	217.5 to 218.5	1 ft.		
218.5-219.8	Lost Core						
219.5-221	Banded quartz some lead & zinc		146	219.8 to 221	1.2 ft.		
221-221.6	Lost Core						
221.6-223.5	Volcanic Schist						
223.5-224.3	Granite some zinc						
224.3-225	Basic greenstone						
225-234.9	Quartz porphyry seams & specks of zinc						
234.9 to 242.7	Altered volcanics with narrow dikes of granite & porphyry specks of zinc especially in the dikes						
242.7-254	Garent gneiss considerable zinc in places		147	242.7 to 243.7	1 ft.		
254-265	Banded volcanic, quartz stringers & narrow porphyry dikes lead & zinc in seams good sized crystal (This hole is still in the vein zone at 260) The rest of the log will be forwarded						

DRILLED BY.....

SIGNED.....

SKETCH

Showing location Diamond Drill Hole No. N 3

CENTRAL SUDBURY LEAD-ZINC MINES LIMITED

L A K E

