



41O16SW0014 2 16465 HEENAN

010

A REPORT ON A
GEOLOGICAL AND MAGNETOMETER SURVEY

HEENAN TOWNSHIP, ONT.

N.T.S. 41-0/16

2.16465

by: Raymond L. Lashbrook
January 1996

*Qual. #
2.3075*

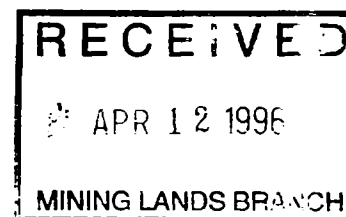



41016SW0014 2 16465 HEENAN

010C

CONTENTS

	PAGE
INTRODUCTION	1
PROPERTY	1
LOCATION AND ACCESS	1
PREVIOUS WORK	1
LOCATION MAP	1B
GENERAL GEOLOGY	2
LINECUTTING	2
MAGNETOMETER SURVEY	2,3
GEOLOGY	3
MINERALIZATION	4
CONCLUSION	4
RECOMMENDATIONS	5
APPENDIX	

ASSAY SHEET	
CERTIFICATE OF QUALIFICATIONS	
BACK POCKET	

1 MAGNETOMETER MAP, 1 GEOLOGY MAP	

INTRODUCTION

Between September 10 - 18th, 1995, Angus MacDonnell and Ray Lashbrook conducted an exploration program over their Heenan Township property.

This work included linecutting, geology and a magnetometer survey.

This work was successful in locating 2 new gold showings.

This report covers the results of the program and gives a recommendation for additional work.

PROPERTY

The property is located in the Township of Heenan and is comprised of one 6 unit claim #1195018 registered in the name of Angus MacDonnell Lic. #C28645, Client No. 162063.

LOCATION AND ACCESS

The property is located in the southeast quarter of Heenan Township, N.T.S. 41/0-16, approximately 110 kilometers southwest of Timmins, Ont. Access is gained by good logging roads south from Hwy. 101 near Foleyet on the Dore Road or west from Hwy. 144 south of Gogama on the Sultan Industrial Road. Much of Heenan Twp. has been clear-cut which provides excellent access to the claims via the logging roads.

PREVIOUS WORK

No sign of previous work was noted on the claims during this program. All previous work that has been filed for assessment can be viewed at the regional geological office of the O.G.S. in Timmins, Ont. The reader is also referred to the O.G.S. Report #0038 by A.M. Goodwin et al, "Geology of Heenan and Marion Townships and the Northern Part of Genoa Township", 1965.

GENERAL GEOLOGY

Regionally the property is located within the Swayze Volcanic Complex of the Abitibi Subprovince, which is the largest assemblage of Archean metavolcanics and metasediments in the Canadian Shield. The Swayze belt is east-trending and is 25 kilometers wide at the eastern edge and 74 kilometers long. It is terminated against the Kapuskasing Structural Zone by a north-south trending fault.

The general geology of the property consists of a footwall felsic volcanic complex overlain by a thick iron formation/sedimentary complex which is in turn overlain by a mafic volcanic hangingwall sequence. Intruding the above units are a series of quartz-feldspar porphyry dikes, tholeiitic feeder dikes, syenitic dikes, lamprophyres and diabase dykes.

1995 PROGRAM

Linecutting

The baseline was established from the west boundary of the claim group approximately 300 meters north of the #3 post of the claim and run at an azimuth of 050 degrees. Crosslines were established every 100 meters and in places 50 meters. Stations were established every 25 meters along the lines. A total of 5.3.kilometers of grid was completed.

MAGNETOMETER SURVEY

The magnetometer survey was conducted using an EG & G Geometric Proton Magnetometer. A base station was set up at B.L. 0+00E

at a reading of 58,865 gammas. All readings were then corrected to this value. A total of 174 readings were taken.

The magnetometer survey located several anomalies generally trending in a easterly to northeasterly direction. All anomalies are approximately 300 - 400 gammas above background. It is probable that they are all caused by disseminated magnetite within mafic flows or interflow tuffs. Sulfide mineralization could be associated with these units.

GEOLOGY

The grid is underlain mainly by a series of massive to pillowed tholeiitic mafic volcanics. These rocks are fine to medium grained and are dark green to grey-green to black in colour. The flows generally weather a medium to dark green colour however in some the weathering was a dark reddish-brown and quite deep, possibly caused from carbonatization or them being mafic to ultramafic in composition. The pillowed flows had in places a flow top breccia. The breccia fragments were in part cherty or rhyolitic, white and up to 3-4 mm in diameter. Most fragments were quite angular.

In places (L1E, 1+90S) quartz-epidote veins and veinlets cut the rock generally in a 290 - 320 degree direction.

On L4E at 0+25S quartz filled gas cavities were found up to 2.5 x 12 cms. in size. In other places quartz was noted in the pillow selvages.

Felsic dykes intrude the mafic volcanic sequence. These dykes are, were found, from a meter to several meters in width. They are a quartz-feldspar porphyry, generally pinkish to greyish pink in colour. The mafic minerals are usually less than 10% and being 1- 2 mm in size. Minor specks of pyrite were noted in places.

Mineralization

Mineralization was found in 2 locations on the property.

Just east of L'0' at 0+30S a quartz carbonate vein was found. The vein was up to 6 cm thick within a shear zone of undetermined width.

Alteration and pyrite mineralization of several cms. are along the contacts of the vein. Pyrite mineralization is ~40% for 2 cms. along the vein plus massive pyrite veins to 1 cm. within the vein. The shearing carries disseminated pyrite of 1-2%. Shearing is ~275 degree direction.

A grab sample consisting of the vein and sheared material assayed 0.14 oz/ton Au (4778 ppb's).

The other zone of mineralization was located at 4+80E, 0+15S along the edge of the outcrop and a low wet area. Here the mineralization consists of 10% disseminated pyrite in a carbonate altered ultramafic volcanic. The rock is a light greenish colour and weathers a dark brown. Quartz veinlets to 5 mm crisscross the zone. The zone probably strike is in a 305 degree direction.

A grab sample returned a value of 1019 ppb gold (0.03 oz/ton Au).

CONCLUSION

The above program was successful in locating 2 new gold zones.

The first located on L'0' is within an easterly trending magnetic anomaly.

More work will have to be carried out at this location.

The second zone located near L5E lies within a magnetic low area which possibly reflects a much larger alteration zone than can be seen from the presently exposed surface. More work will also be required here.

RECOMMENDATIONS

The following program is recommended for this property

- i) The areas around the mineralized zones should be mechanically stripped, trenched and assayed.
- ii) The gridding should be extended to cover the whole of the property along with the magnetometer and vlf surveys.
- iii) The property should be completely mapped and prospected.
- iv) An I.P. survey should be conducted over the mineralized zones and over any vlf conductors located during the survey.
- v) At least 6 diamond drill holes should be drilled to investigate the mineralized zones and any new targets found by the above program. This will require approximately 900 meters of drilling.



Established 1928

Swastika Laboratories

A Division of TSL/Assayers Inc.

Assaying - Consulting - Representation

Geochemical Analysis Certificate

5W-3901-RG1

Company: **LASHEX LTD**

Date: OCT-12-95

Project:

Ann: **R. Lashbrook**

We hereby certify the following Geochemical Analysis of 2 Rock samples submitted OCT-06-95 by .

Sample Number	Au PPB	Au Check PPB
15517	1005	1032
15518	4738	4817

Certified by

P.O. Box 10, Swastika, Ontario P0K 1T0
Telephone (705) 642-3244 FAX (705) 642-3300

CERTIFICATE

I, RAYMOND LASHBROOK do hereby declare that

- (a) I have a 50% interest in this property.
- (b) I graduated from Haileybury School of Mines in 1969 and I have been practising my profession ever since.
- (c) I reside at 973 Pinecreek Road, R.R.#1, Callander, Ontario, POH 1H0.



Raymond L. Lashbrook
January 1996



Personal information collected on this form is obtained under the authority of the Mining Act. This information will be used for correspondence. Questions about this collection should be directed to the Provincial Manager, Mining Lands, Ministry of Northern Development and Mines, Fourth Floor, 159 Cedar Street, Sudbury, Ontario, P3E 6A5, telephone (705) 670-7284.

- Instructions:
- Please type or print and submit in duplicate.
 - Refer to the Mining Act and Regulations for required forms.
 - A separate copy of this form must be complete.
 - Technical reports and maps must accompany this form.
 - A sketch, showing the claims the work is assigned to, must be submitted.

2.16465



41016SW0014 2 16465 HEENAN

900

Recorded Holder(s) ANGUS MACDONNELL		Client No. 162063
Address TILDEN LAKE, ONT. POH 2KO.		Telephone No. 705-892-2415
Mining Division PORCUPINE	Township/Area HEENAN TOWNSHIP	M or G Plan No.
Dates Work Performed From: Sept 10th 1995 JAN 14th 1996		To: Sept 18th 1995 JAN 17, 1996 LFIELD OFFICE

Work Performed (Check One Work Group Only)

Work Group	Type
<input checked="" type="checkbox"/> Geotechnical Survey	MAGNETOMETER, GEOLOGY
<input type="checkbox"/> Physical Work, Including Drilling	
<input type="checkbox"/> Rehabilitation	
<input type="checkbox"/> Other Authorized Work	
<input checked="" type="checkbox"/> Assays	SECTION 18 ONLY
<input type="checkbox"/> Assignment from Reserve	

RECEIVED
APR 12 1996
MINING LANDS BRANCH

Total Assessment Work Claimed on the Attached Statement of Costs \$ 4153

Note: The Minister may reject for assessment work credit all or part of the assessment work submitted if the recorded holder cannot verify expenditures claimed in the statement of costs within 30 days of a request for verification.

Persons and Survey Company Who Performed the Work (Give Name and Address of Author of Report)

Name	Address
ANGUS MACDONNELL	TILDEN LAKE, ON.
RAYMOND LASHBROOK	973 PINECREEK RD, CALLANDER, ON <small>POH 1H0</small>

(attach a schedule if necessary)

Certification of Beneficial Interest * See Note No. 1 on reverse side

I certify that at the time the work was performed, the claims covered in this work report were recorded in the current holder's name or held under a beneficial interest by the current recorded holder.	Date Jan 30/96	Recorded Holder or Agent (Signature) Ray Lashbrook
--	--------------------------	--

Certification of Work Report

I certify that I have a personal knowledge of the facts set forth in this Work report, having performed the work or witnessed same during and/or after its completion and annexed report is true.		
Name and Address of Person Certifying RAYMOND LASHBROOK, 973 PINECREEK RD, CALLANDER <small>POH 1H0</small>		
Telephone No. 705-752-3242	Date Jan 30/96	Certified By (Signature) Ray Lashbrook

For Office Use Only

Total Value Cr. Recorded 4153	Date Recorded	Mining Recorder [Signature]	<div style="border: 1px solid black; padding: 5px;"> <p>RECEIVED FEB 2 1996 1100 P JK PORCUPINE MINING DIVISION</p> </div>
	Deemed Approval Date MAY 2/96	Date Approved	
	Date Notice for Amendments Sent		



Mining Act/Loi sur les mines

Personal information collected on this form is obtained under the authority of the Mining Act. This information will be used to maintain a record and ongoing status of the mining claim(s). Questions about this collection should be directed to the Provincial Manager, Minings Lands, Ministry of Northern Development and Mines, 4th Floor, 159 Cedar Street, Sudbury, Ontario P3E 6A5, telephone (705) 670-7264.

Les renseignements personnels contenus dans la présente formule sont recueillis en vertu de la Loi sur les mines et serviront à tenir à jour un registre des concessions minières. Adresser toute question sur la collecte de ces renseignements au chef provincial des terrains miniers, ministère du Développement du Nord et des Mines, 159, rue Cedar, 4^e étage, Sudbury (Ontario) P3E 6A5, téléphone (705) 670-7264.

1. Direct Costs/Coûts directs

Type	Description	Amount Montant	Totals Total global
Wages Salaires	Labour/MAIN - 3 days Main-d'oeuvre	360	
	Field Supervision Supervision sur le terrain		360
Contractor's and Consultant's Fees Droits de l'entrepreneur et de l'expert- conseil	Type 5, 3 km x 250/km LINE CUTTING	1325	
	2.5 km x 100/km MAG SURVEY	450	
	3 days x \$25/day GEOLOGY	750	3275
Supplies Used Fournitures utilisées	Type DRAFTING REPORT 3 days x 250/day	750	
Equipment Rental Location de matériel	Type		
Total Direct Costs Total des coûts directs			3635

2. Indirect Costs/Coûts indirects

** Note: When claiming Rehabilitation work Indirect costs are not allowable as assessment work.
Pour le remboursement des travaux de réhabilitation, les coûts indirects ne sont pas admissibles en tant que travaux d'évaluation.

Type	Description	Amount Montant	Totals Total global
Transportation Transport	Type TRUCK 800km @ 0.31/km	258	
Sub Total of Indirect Costs Total partiel des coûts indirects			258
Food and Lodging Nourriture et hébergement	FOOD 20 MAN DAYS @ \$15/day		300
Mobilization and Demobilization Mobilisation et démobilisation			
Sub Total of Indirect Costs Total partiel des coûts indirects			558
Amount Allowable (not greater than 20% of Direct Costs) Montant admissible (n'excedant pas 20 % des coûts directs)			727
Total Value of Assessment Credit (Total of Direct and Allowable indirect costs)			4193

Note: The recorded holder will be required to verify expenditures claimed in this statement of costs within 30 days of a request for verification. If verification is not made, the Minister may reject for assessment work all or part of the assessment work submitted.

Note : Le titulaire enregistré sera tenu de vérifier les dépenses demandées dans le présent état des coûts dans les 30 jours suivant une demande à cet effet. Si la vérification n'est pas effectuée, le ministre peut rejeter tout ou une partie des travaux d'évaluation présentés.

Filing Discounts

1. Work filed within two years of completion is claimed at 100% of the above Total Value of Assessment Credit.
2. Work filed three, four or five years after completion is claimed at 50% of the above Total Value of Assessment Credit. See calculations below:

Total Value of Assessment Credit	Total Assessment Claimed
	x 0.50 =

Remises pour dépôt

1. Les travaux déposés dans les deux ans suivant leur achèvement sont remboursés à 100 % de la valeur totale susmentionnée du crédit d'évaluation.
2. Les travaux déposés trois, quatre ou cinq ans après leur achèvement sont remboursés à 50 % de la valeur totale du crédit d'évaluation susmentionné. Voir les calculs ci-dessous.

Valeur totale du crédit d'évaluation	Évaluation totale demandée
	x 0.50 =

Certification Verifying Statement of Costs

hereby certify:
that the amounts shown are as accurate as possible and these costs were incurred while conducting assessment work on the lands shown on the accompanying Report of Work form.

that as Agent I am authorized
(Recorded Holder, Agent, Position in Company)

to make this certification

Attestation de l'état des coûts

J'atteste par la présente :
que les montants indiqués sont le plus exact possible et que ces dépenses ont été engagées pour effectuer les travaux d'évaluation sur les terrains indiqués dans la formule de rapport de travail ci-joint.

Et qu'à titre de _____ je suis autorisé
(titulaire enregistré, représentant, poste occupé dans la compagnie)

à faire cette attestation.

Ministry of
Northern Development
and Mines

Ministère du
Développement du Nord
et des Mines

Geoscience Approvals Office
933 Ramsey Lake Road
6th Floor
Sudbury, Ontario
P3E 6B5

Telephone: (705) 670-5853
Fax: (705) 670-5863

AMENDED
July 2, 1996

Our File: 2.16465
Transaction #: W9660.00060

Mining Recorder
Ministry of Northern Development & Mines
60 Wilson Ave.
Timmins, Ontario
P4N 2S7

Dear Mr. White:

**SUBJECT: APPROVAL OF ASSESSMENT WORK CREDIT ON MINING LAND, CLAIM(S)
1195018 (ET AL.) IN HEENAN TOWNSHIP (AREA)**

Assessment work credit has been approved as outlined on the Declaration of Assessment Work Form accompanying this submission. The credit has been approved under Sections 12,14, Geology, Geophysics(MAG) of the Assessment Work Regulation.

The approval date is April 23, 1996. Please indicate this approval on the claim record.

If you have any questions regarding this correspondence, please contact Bruce Gates at (705) 670-5856.

Yours sincerely,
ORIGINAL SIGNED BY:

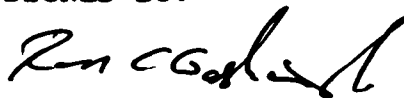

Ron C. Gashinski
Senior Manager, Mining Lands Section
Mines and Minerals Division

BIG/cc

cc: Resident Geologist
Timmins, Ontario

✓ Assessment Files Library
Sudbury, Ontario

Ministry of
Northern Development
and Mines

Ministère du
Développement du Nord
et des Mines

Geoscience Assessment Office
933 Ramsey Lake Road
6th Floor
Sudbury, Ontario
P3E 6B5

Telephone: (705) 670-5853
Fax: (705) 670-5863

April 26, 1996

Our File: 2.16465
Transaction #: W9660.00060

Mining Recorder
Ministry of Northern Development & Mines
60 Wilson Ave.
Timmins, Ontario
P4N 2S7

Dear Mr. White:

**SUBJECT: APPROVAL OF ASSESSMENT WORK CREDIT ON MINING LAND, CLAIM(S)
1195018 (ET AL.) IN HEENAN TOWNSHIP (AREA)**

Assessment work credit has been approved as outlined on the Declaration of Assessment Work Form accompanying this submission. The credit has been approved under Sections 12,14, Geology, Geophysics (MAG) of the Assessment Work Regulation.

The approval date is April 23, 1995. Please indicate this approval on the claim record.

If you have any questions regarding this correspondence, please contact Bruce Gates at (705) 670-5856.

Yours sincerely,
ORIGINAL SIGNED BY:



Ron C. Gashinski
Senior Manager, Mining Lands Section
Mines and Minerals Division

BIG BIG/jl
Enclosure:

cc: Resident Geologist
Timmins, Ontario

✓ Assessment Files Library
Sudbury, Ontario

NEWTON TWP.

THE TOWNSHIP
OF
HEENAN

2.16465

DISTRICT RECEIVED
SUDBURY APR 12 1996
PORCUPINE MINING DIVISION
MINING LANDS BRANCH

SCALE: 1-INCH = 40 CHAINS

LEGEND

PATENTED LAND	Ⓟ
CROWN LAND SALE	C.S.
LEASES	Ⓛ
LOCATED LAND	Loc.
LICENSE OF OCCUPATION	L.O.
MINING RIGHTS ONLY	M.R.D.
SURFACE RIGHTS ONLY	S.R.O.
ROADS	—
IMPROVED ROADS	—
KING'S HIGHWAYS	—
RAILWAYS	—
POWER LINES	—
MARSH OR MUSKEG	—
MINES	ⓧ
CANCELLED	c.

NOTES

- 400' Surface rights reservation around the shores of all lakes and rivers
 - Ⓜ MINING AND SURFACE RIGHTS WITHDRAWN FROM STAKING UNDER SECTION 38 OF THE MINING ACT R.S.O. 1980 ORDER NO. W30786 DATED 86-MAY-21
 - Ⓜ MINING AND SURFACE RIGHTS WITHDRAWN FROM STAKING UNDER SECTION 38 OF THE MINING ACT R.S.O. 1980 ORDER NO. W4187 (LOCAL FILE NRW 5187) DATED 87-FEB-03
 - THIS TWP IS SUBJECT TO FOREST ACTIVITIES IN 1956-1980. FURTHER INFORMATION AVAILABLE ON FILE
 - Ⓜ SURFACE AND MINING RIGHTS RE-OPENED TO PROSPECTING, STAKING OUT, SALE OR LEASE UNDER SECTION 35 OF THE MINING ACT R.S.O. 1980 EFFECTIVE 92-MAY-05 AT 7:00 AM E.S.T. ORDER NO. O.P.4192 HER DATED 92-APR-15
 - Ⓜ THIS TWP IS SUBJECT TO FOREST ACTIVITIES IN 1995/96. FURTHER INFORMATION AVAILABLE ON FILE
- THE INFORMATION THAT APPEARS ON THIS MAP HAS BEEN COMPILED FROM VARIOUS SOURCES, AND ACCURACY IS NOT GUARANTEED. THOSE WISHING TO STAKE MINING CLAIMS SHOULD CONSULT WITH THE MINING RECORDER, MINISTRY OF NORTHERN DEVELOPMENT AND MINES, FOR ADDITIONAL INFORMATION ON THE STATUS OF THE LANDS SHOWN HEREON

CHECKED BY D. CHOLETTE
IN SERVICE OCT. 24/89

PLAN NO. **G-1139**

**ONTARIO
DEPARTMENT OF MINES
AND NORTHERN AFFAIRS**

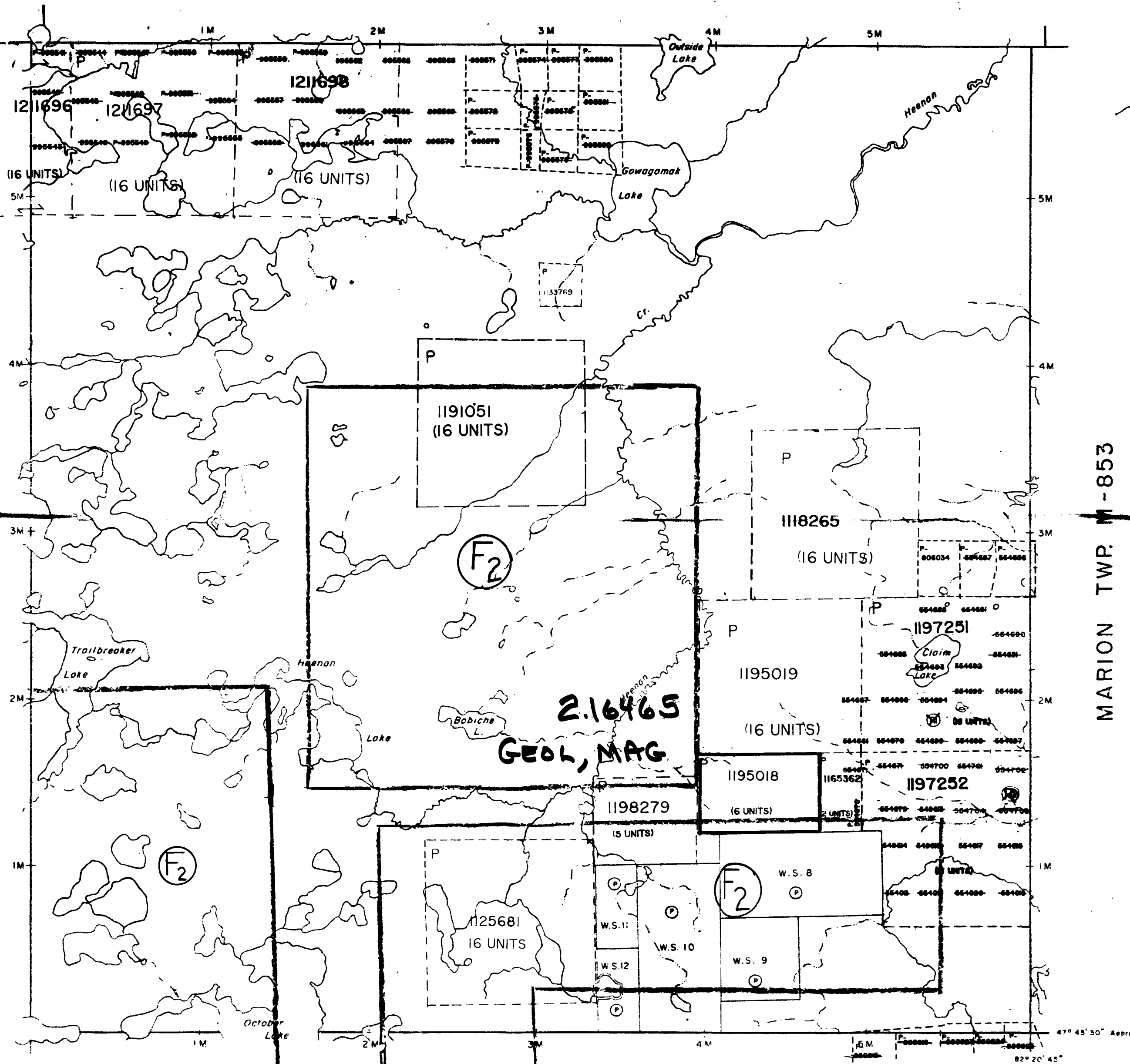

HEENAN TWP

DORE TWP. M-763

MARION TWP. M-853

BENTON TWP. M-659



4101SSW0014 2.16465 HEENAN
200
W-252

HEENAN TWP

W-252

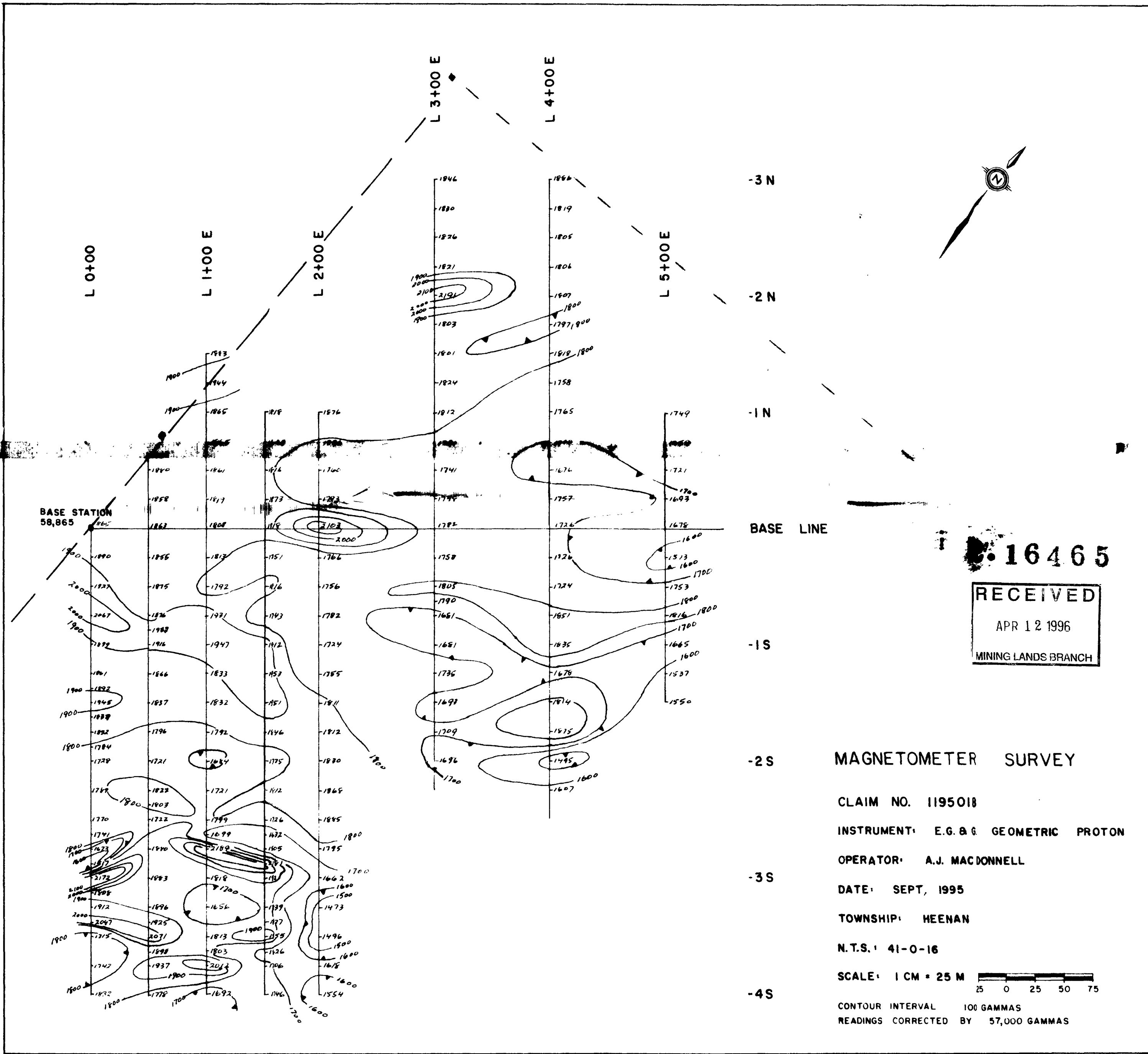

16465
 RECEIVED
 APR 12 1996
 MINING LANDS BRANCH

MAGNETOMETER SURVEY
 CLAIM NO. 1195018
 INSTRUMENT: E.G. & G. GEOMETRIC PROTON
 OPERATOR: A.J. MACDONNELL
 DATE: SEPT, 1995
 TOWNSHIP: HEENAN
 N.T.S.: 41-0-16
 SCALE: 1 CM = 25 M
 CONTOUR INTERVAL 100 GAMMAS
 READINGS CORRECTED BY 57,000 GAMMAS



41016SW0014 2.16465 HEENAN

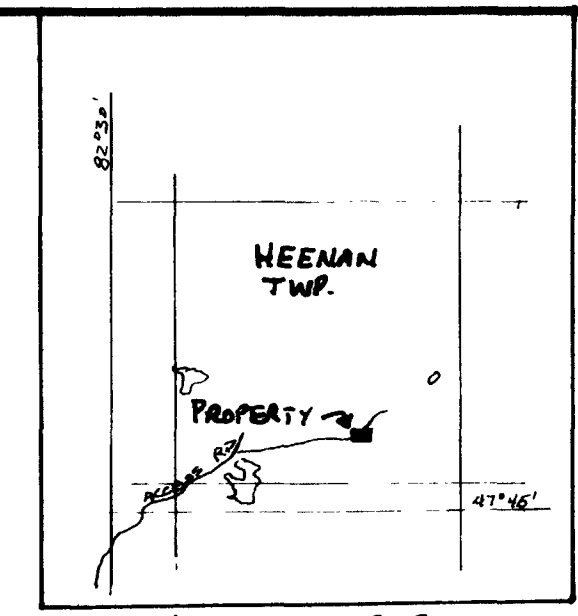
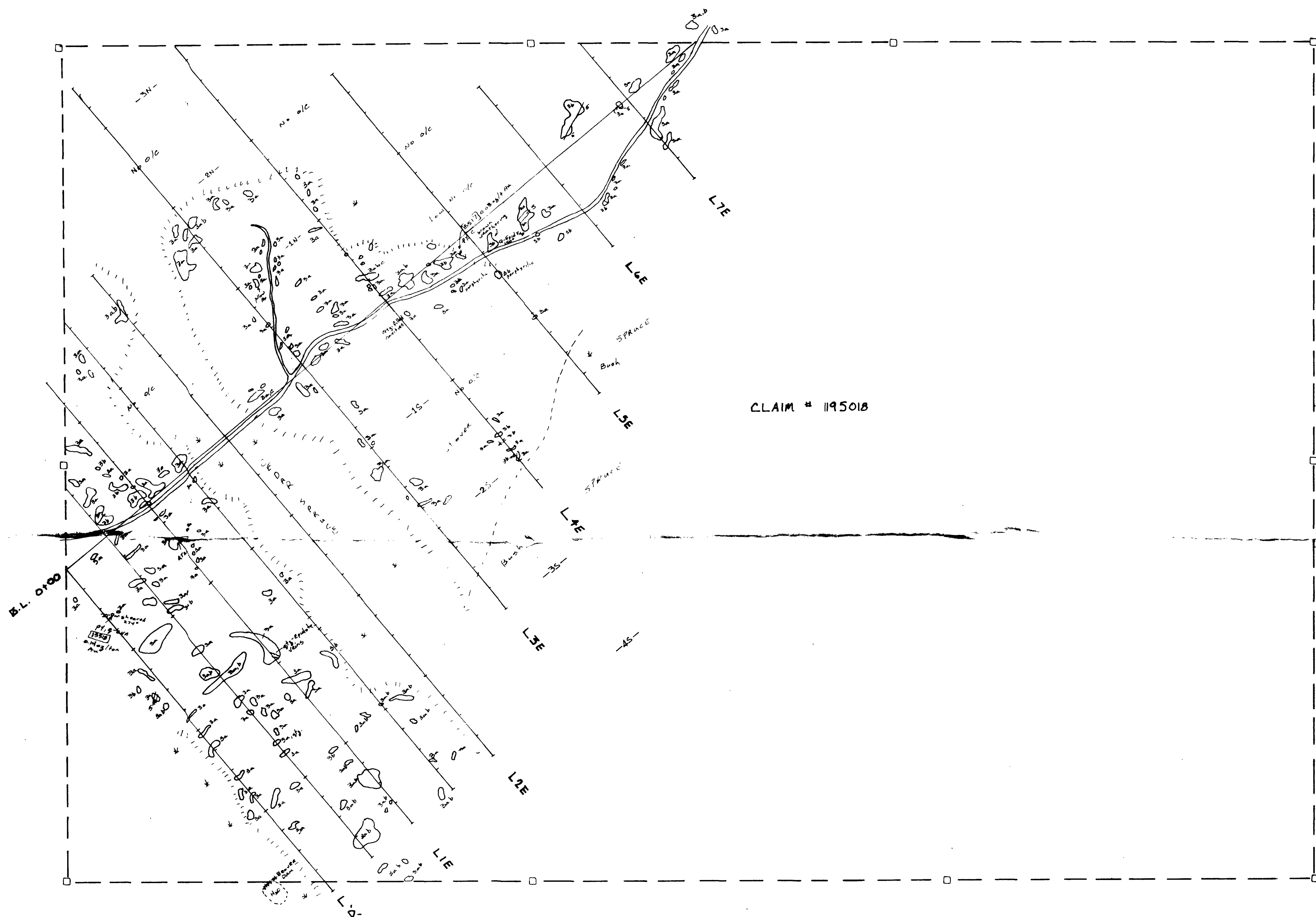

CLAIM # 1195018

LEGEND

- 5- FELSIC DYKES
- 4- THOLEIITIC DYKES
- 3- MAFIC VOLCANICS
 - a - pillowed
 - b - massive
 - c - tuffaceous
- 2- IRON FORMATION
- 1- FELSIC VOLCANICS

py - pyrite
 qv - quartz vein
 Epid - epidote
 c - carbonate

RECEIVED
 APR 12 1996
 MINING LANDS BRANCH

2.16465



220

MACDONNELL PROPERTY
 GEOLOGY MAP
 HEENAN TOWNSHIP

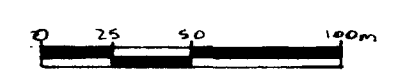

DATE: JAN 1992 DRAWN BY: RAY LASH, PEX
 SCALE: 1:2500