



41016SW0054 14 HEENAN

010

Diamond Drilling

Township of HEENAN

Report NO 14

Work performed by: Gulf Minerals Limited

Claim NO	Hole NO	Footage	Date	Note
P 451768	HNW-1	508.0'	Oct/76	(1)

Zn/Cu

Notes:

(1) #120-77

NEWTON TWP.

#120-77

Heenan Twp.
Gulf Mine

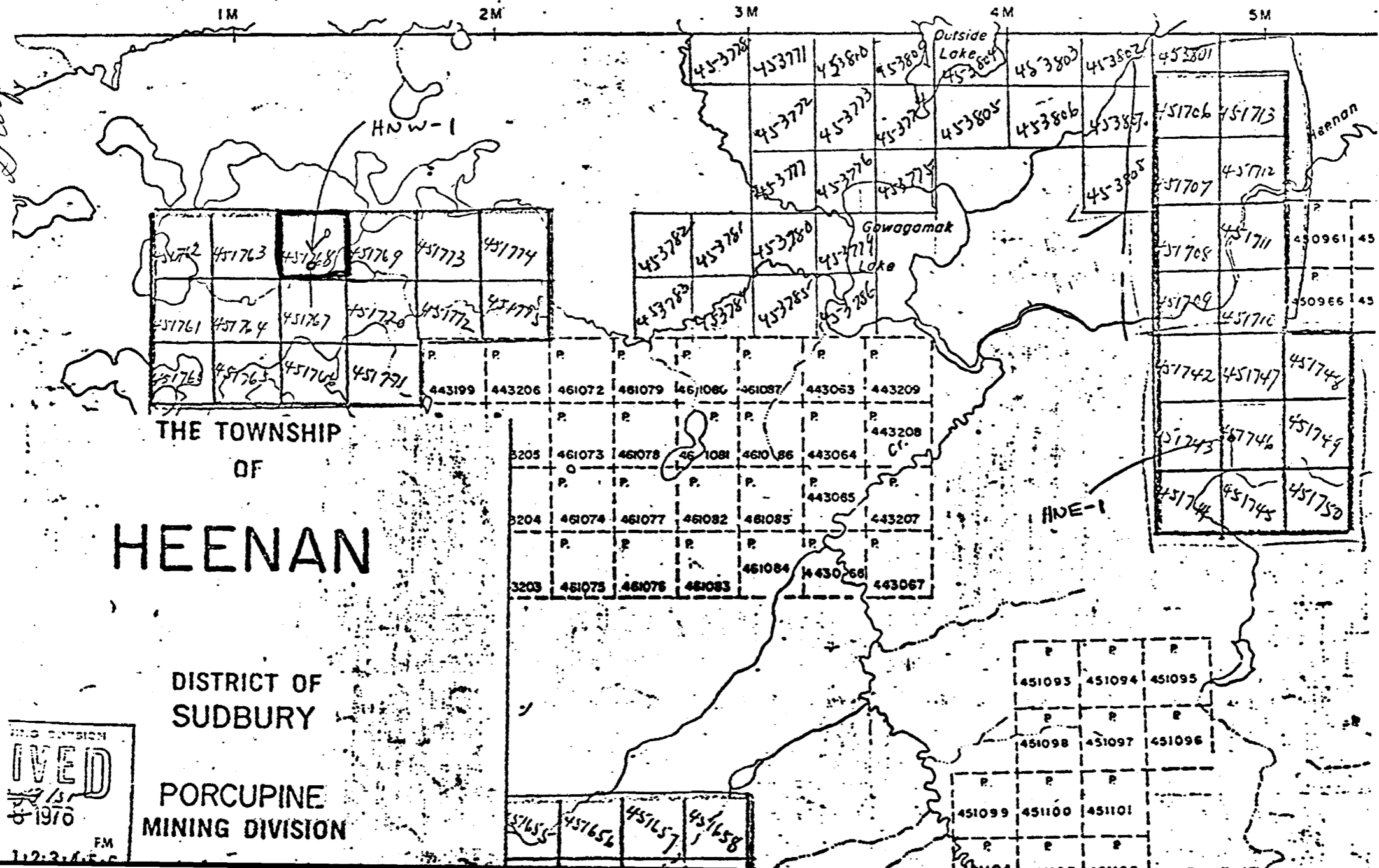

MINING DIVISION
IVED
1970
FM
112-3-4-5-6

Gulf Minerals Canada Limited

REPORT OF ASSESSMENT WORK

D.D.H. LOCATION SKETCH

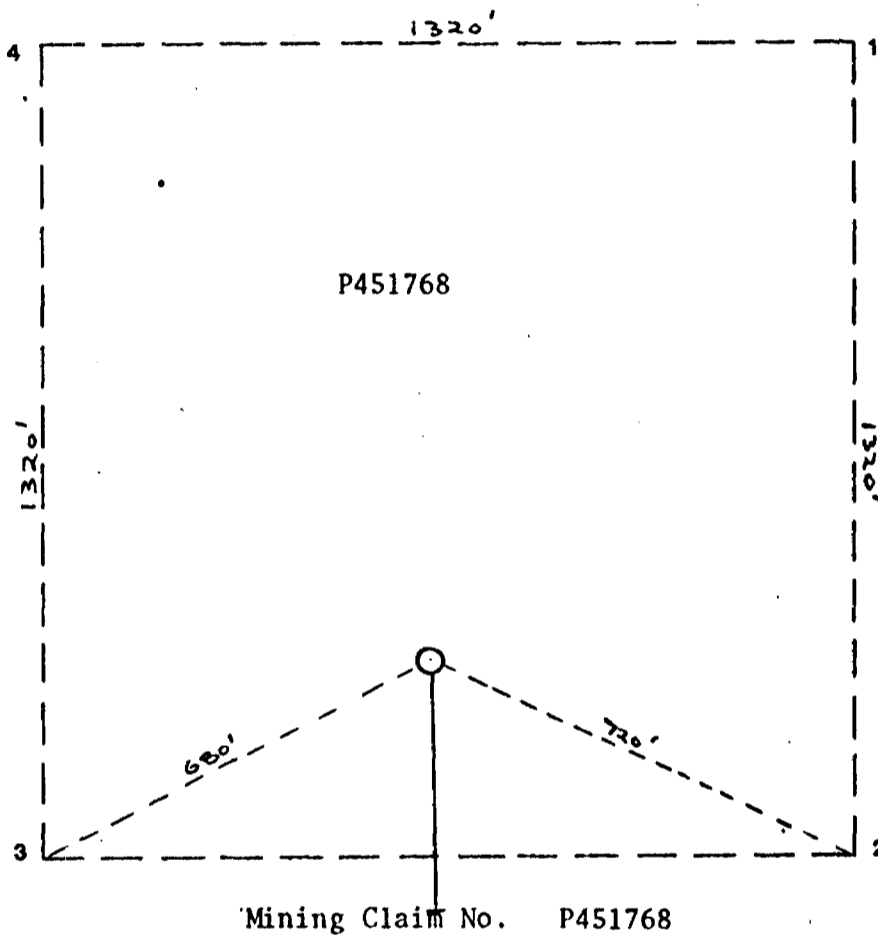

Hole No. or Name: HNW-1

Province: Ontario

Location: Heenan Township





Gulf Minerals Canada Limited
DIAMOND DRILL RECORD

D.D.H. NO. HNW - 1
SHEET 1 OF 3

PROPERTY Ileenan North West-Swayze
LATITUDE 6 + 00N
LONGITUDE 0 + 00
ELEVATION _____

BEARING - TRUE 180°
DIP Collar -50, 118'-46°, 300'-43°, 500'-39°30'
FINAL DEPTH 503'
CORE SIZE AQ

DATE STARTED October 12, 1976
DATE COMPLETED October 15, 1976
DRILLED BY Morissette
LOGGED BY T.H. Carpenter

DATE: October 22, 1976 SIGNED T. H. Carpenter

DEPTH FEET	F'TAGE CORED	F'TAGE REC'D	FORMATION	DESCRIPTION	DEPTH	BED'G & FOLIA	REMARKS SAMPLES ETC.
0 - 118			Overburden				
118 - 155.5	37.5	37.5	Rhyolite	Gray to black fine grained rock. Moderately banded. Weakly fractured with fracture planes frequently coated with graphite. The section contains numerous calcite stringers at irregular angles to the core axis. These stringers seldom measure more than 1/10" in thickness. 134' - Pyrite bleb.			
155.5 - 190.5	35	31	Graphite	Black hard, fine grained moderately fractured rock with the fractures ranging from 60° - 90° to the core axis. The section has a discordant lower contact. Contains frequent blebs and veinlets of pyrite, which makes up 3 - 5% of the rock. 161 - 165 - Ground Core. 170.5 - 172 - Medium gray basaltic rock with finely disseminated pyrite. 185.5 - 186 - Rhyolite. Light gray slightly porphyritic rock. Contains minor sulphides. Weakly foliated. 186 - 190.5 - Contains frequent calcite stringers at irregular angles to core axis.		Zn Cu 155.5-161 0.6 0.08 165 -167 0.5 0.1 170 -172 0.1 .02 167 -170.5 0.4 0.07 172 -175 1.0 0.2 175 -180 1 0.2 180 -185.5 1 0.2 183.5-185 0.1 - 186 -190.5 .07 -	
190.5 - 199	8.5	8.5	Rhyolite	As above from 185.5 - 186'. Section contains minor pyrite chlorite and epidote. 198.6 - 199 - Broken core.			
199 - 205.5	6.5	6.5	Graphite	As above from 155.5 - 190.5.			199 -202 0.9 0.2 202.0-205.0 0.9 0.2
205.5 - 210	4.5	4.5	Rhyolite	Similar to section from 190.5 - 199. 205 - 208.5-Predominantly broken core. 208.5 -210 -Massive darker gray and contains up to 5% disseminated sulphides.			

DIAMOND DRILL RECORD--CONTINUATION SHEET

D.D.H. NO. INW - 1
 SHEET 2 OF 3

DEPTH FEET	F'TAGE CORED	F'TAGE REC'D	FORMATION	DESCRIPTION	DEPTH	BED'G & FOLIA	REMARKS SAMPLES ETC.
210 - 245	35	35	Rhyolite	Gray black to black fine grained rock. Massive to weakly fractured. Contains regular and convoluted foliations. Graphite appears along most fractures. The section contains finely disseminated and occasional blebs of pyrite. 210 -211 - Calcite stringers. Some brecciation at 210.2. 221 -222 - Pyrite blebs. 230 -232.4) Gray coarser grained rock 235 -235.4) 236.5-277.5- Shear zone with calcite healed breccia.			Zn Cu 242.0-243.0 .08 .01
245 - 282	37	37	Rhyolite	The core appears to be slightly coarser grained than the previous section, has more regular banding and is predominantly medium to dark gray in colour. To 256' the core is lightly peppered with pyrite. Locally calcite stringers occur parallel to the banding. The rock is weakly calcareous. 264.2 - Calcite healed breccia. 280.4-281.2- Calcite veins.	250	55°	
282 - 341	59	59	Dacite - Rhyolite	Black, fine grained, massive, cut by an occasional calcite vein at angles ranging from 45 - 60° to the core axis. Weakly banded. Contains minor disseminated pyrite. Calcareous - reacts well with acid. 302 -309 - Grayish rock. 311 -318.5- Contains numerous pyrite blebs averaging 2mm in size disseminated through the core. 318.5 - Minor breccia. 324.5-330 - Black rock containing intervals of gray calcic core and blebs to 2 - 3 mm of gray calcic material (possible filled vesicles).			
341 - 371	30	30	Dacite - Rhyolite	Approximate contact based on calcite content. From 341' the core is well banded and made up of black fine grained material and inter-banded gray calcareous material. The core is massive and contains an occasional calcite stringer.	363	65°	
371 - 402.5	31.5	31.5	Graphite	As above from 155.5.0 190.5'. The rock is black, fine grained, massive to moderately faulted and contains blebs and stringers of sulphides. 384.7-387 - Light gray slightly porphyritic dacite to rhyolite. Massive with minor sulphides. 396.8-402 - Broken core. Probable shear zone.			Zn Cu 371 - 376 0.7 0.1 376 - 381 0.8 0.2 381 - 384.7 0.8 0.2 390 - 393 0.5 0.1 387 - 390 0.6 0.1 393 - 398 0.5 0.1 398 - 402 0.09