



DIAMOND DRILLING

Township: Benton

Report No: 17

WORK PERFORMED FOR: WEACO Resources Ltd.

RECORDED HOLDER: SAME AS ABOVE [X]

: OTHER []

<u>CLAIM NO.</u>	<u>HOLE NO.</u>	<u>FOOTAGE</u>	<u>DATE</u>	<u>NOTE</u>
P 880829	W-86-1	501.5'	Oct/86	(1) (2)
P 880823	W-86-2	567'	Oct/86	(1) (2)
P 880826	W-86-3	444'	Oct-Nov/86	(1) (2)

NOTES: (1) #402-86 (filed in May/87)

(2) DRILL HOLE SECTIONS AND LOCATION PLAN, HOLES W-86-1 TO W-86-3, SUBMITTED UNDER OMEP REPORT # OM86-5-P-114 - added to file March/89.



41016SW0071 17 BENTON

020

REPORT
ON
PHASE III EXPLORATION RESULTS
DIAMOND DRILLING
SWAYZE PROJECT, ONTARIO
WEACO RESOURCES LTD.

November 16, 1986
Toronto, Ontario

E. A. Gallo, F.G.A.C.
Gallo Exploration Services inc.

INTRODUCTION

WEACO RESOURCES LIMITED owns 225 mining claims in 5 separate groups in the Swayze Area of Ontario.

A 3-hole drill program was recently completed on 1 of the 5 claim groups, termed the North Benton Property.

This report discusses the technical results of this drill program. Details regarding the preliminary exploration work which led to this drill program are outlined in the author's Report of January 30, 1986, and therefore are not repeated here.

TAI



41016SW0071 17 BENTON

020C

	Page
INTRODUCTION	i.
LOCATION AND ACCESS	1.
CLAIMS DATA	1.
DAIMOND DRILLING RESULTS	2.
Hole W-86-1	2.
Hole W-86-2	2.
Hole W-86-3	4.
SUMMARY	4.
CONCLUSIONS	4.

LIST OF TABLES

I	SUMMARY OF DIAMOND DRILLING RESULTS	5.
---	-------------------------------------	----

LIST OF FIGURES

1.	PLAN SHOWING HOLE LOCATIONS	Page 3.
2.	PLAN AND SECTION OF HOLE W-86-1	Pocket 1
3.	PLAN AND SECTION OF HOLE W-86-2	Pocket 1
4.	PLAN AND SECTION OF HOLE W-86-3	Pocket 1

LIST OF APPENDICES

I DETAILED LOGS OF HOLES W-86-1, W-86-2, and W-86-3.

II ASSAY CERTIFICATES:

Timmins Analytical Services; A-249-86, and
A-269-86.

Assayers (Ontario) Ltd.; GA-39/5545

PHASE III EXPLORATION RESULTS

DIAMOND DRILLING

SWAYZE PROJECT, ONTARIO

WEACO RESOURCES LIMITED

LOCATION AND ACCESS

The Location and Access are given in the author's Report of January 30, 1986.

CLAIMS DATA

The Claims Data for 4 of the 5 WEACO properties, namely the South Benton, North Mallard, Central Mallard, and South Mallard properties are as given in the author's Report of January 30, 1986.

The 3 holes were drilled on the North Benton property (see Fig 1). This property originally consisted of 42 claims. Irregularities in the staking of these claims were discovered while preliminary exploration work was being conducted on them. The claims were therefore cancelled, and new claims were staked. The results of the preliminary exploration work suggested that a portion of the property was not worth re-staking. Accordingly, only 24 new claims were staked, covering the geologically favourable formations that were identified.

The 24 new claims comprising the North Benton property are numbered P 880808 - P 880831, inclusive. They presently come due on July 28, 1987, however the 3 holes will be submitted for assessment credits, and if approved, the due date will become July 28, 1989.

DIAMOND DRILLING RESULTS

The 3 holes are numbered W-86-1, -2, and -3. They total 1,512 feet (460.9 meters). They were drilled to explain separate conductive zones with associated anomalous magnetics and anomalous geochemical values in geologically interesting areas.

Hole W-86-1: This hole was collared at station 11+50 S on Line 24 W, and was drilled at a dip of 45° along an azimuth of 025° (Grid North). The hole was completed at a depth of 501.5 feet (152.9 meters). The purpose of this hole was to probe Max Min II HLEM Conductor B with a coincident strong dipolar magnetic anomaly in cherty iron formation and altered felsic pyroclastics on strike from a weak gold geochemical anomaly (340 ppb, or 0.01 oz/ton). The hole intersected banded cherty iron formation, granodiorite, and rhyolite crystal tuff. The iron formation contains up to 20% magnetite, pyrrhotite, and pyrite, and traces of chalcopyrite. The tuff contains up to 2% pyrite and traces of chalcopyrite. The best assay returned 280 ppb gold, or 0.01 oz/ton, across a core length of 3.0' (0.9 meter) at a depth of 421.5' (128.5 meters). The anomalous geophysical and geochemical readings are adequately explained in the hole.

Appendix I has a detailed log of Hole W-86-1. Appendix II has the assay certificates. Figure 2 is a Plan and Section of the hole.

Hole W-86-2: This hole was collared at station 8+30 N on Line 32 W, and was drilled at a dip of 45° along an azimuth of 025° (Grid North). The hole was completed at a depth of 567' (172.8 meters). This hole was drilled to probe Max Min II HLEM Conductor C with a coincident strong dipolar magnetic anomaly in altered felsic tuffs adjacent to a weak gold geochemical anomaly (538 ppb, or 0.02 oz/ton). The hole intersected basalt, chert, rhyolite breccia, and massive rhyolite. The basalt contains magnetite stringers and up to 10% pyrite. The chert contains bands of massive pyrite and minor graphite. The rhyolite breccia and massive rhyolite contain up to 1% pyrite. The best assay returned 3,040 ppb gold, or 0.09 oz/ton, across a core length of 5.5' (1.7 meter) at a depth of 429.5' (130.9 meters). The anomalous geophysical and geochemical readings are adequately explained in the hole.

Appendix I has a detailed log of Hole W-86-2. Appendix II has the assay certificates. Figure 3 is a Plan and Section of the hole.

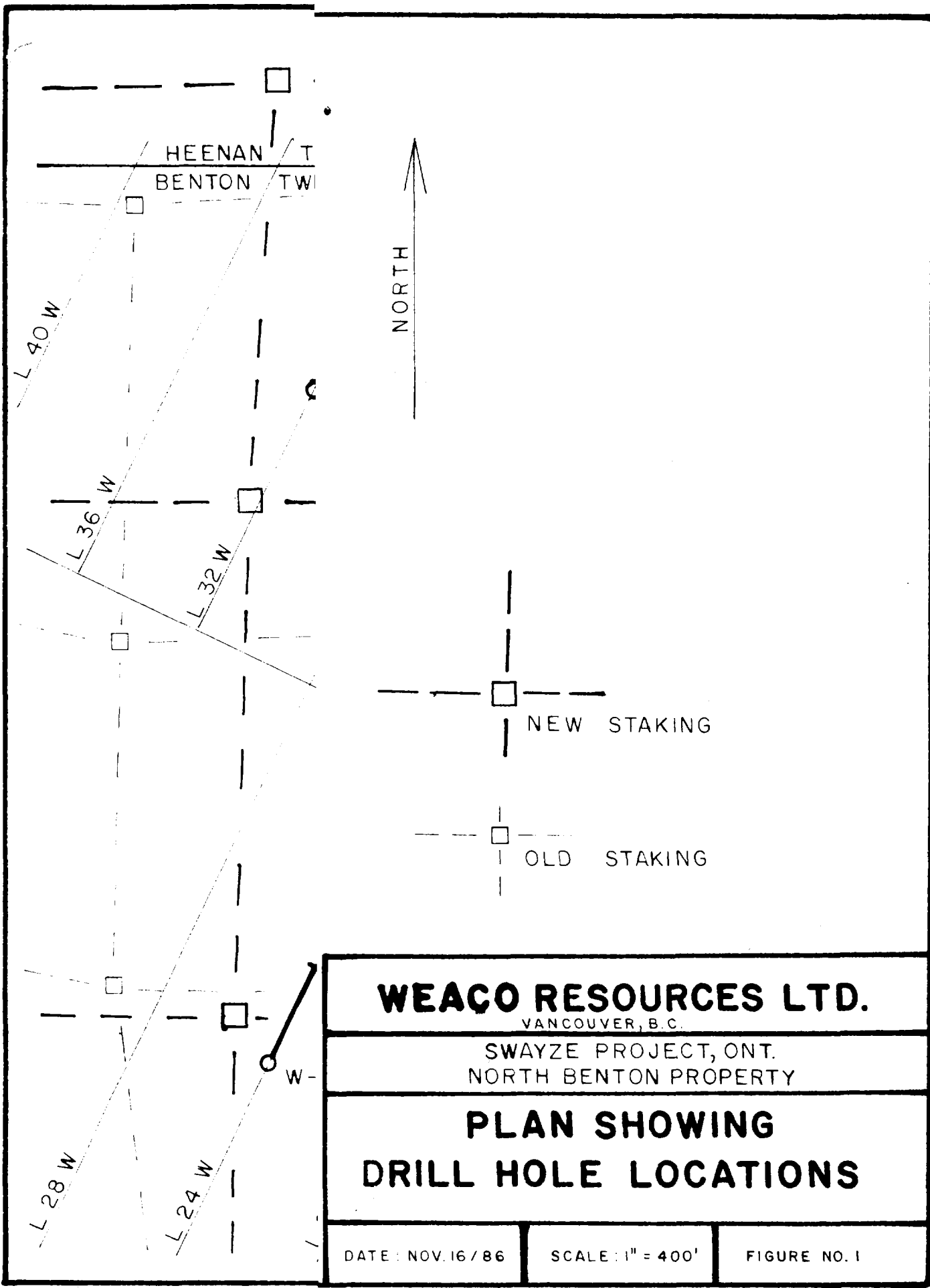

WEACO RESOURCES LTD.
VANCOUVER, B.C.

SWAYZE PROJECT, ONT.
NORTH BENTON PROPERTY

**PLAN SHOWING
DRILL HOLE LOCATIONS**

DATE: NOV. 16 / 86

SCALE: 1" = 400'

FIGURE NO. 1

Hole W-86-3: This hole was collared at station 8+75 N on Line 12 W, and was drilled at a dip of 45° along an azimuth of 025° (Grid North). The hole was completed at a depth of 444' (135.3 meters). This hole was drilled to probe Max Min II HLEM Conductor D with a coincident weak magnetic anomaly in the sheared, altered contact area of mafic and felsic volcanics. The hole intersected basalt, chert, rhyolite tuffs and breccia, and massive pyritic sulphides. The basalt contains traces of magnetite and pyrite. The chert carries sections of massive pyritic sulphides. The rhyolite tuffs and breccia contain minor quantities of magnetite and pyrite. The best assay returned 990 ppb gold, or 0.03 oz/ton, across a core length of 1.3' (0.4 meter) at a depth of 85' (25.9 meters). The anomalous geophysical readings are adequately explained in the hole.

Appendix I has a detailed log of Hole W-86-3. Appendix II has the assay certificates. Figure 4 is a Plan and Section of the hole.

SUMMARY

The diamond drilling program consisted of 3 holes for a total of 1,512 feet (460.9 meters). Each hole was drilled into separate conductive zones with coincident anomalous magnetics. Two of the 3 conductors also display geochemically anomalous gold values. All of the anomalous geophysical and geochemical conditions are adequately explained.

Table I summarizes the diamond drilling results.

CONCLUSIONS

The 3 Max Min II HLEM conductors have been explained by the presence of pyrite, pyrrhotite, and minor graphite. The anomalous magnetic readings have been explained by the presence of magnetite and pyrrhotite. Values as high as 3,040 ppb gold (0.09 oz/ton) were obtained, which explains the anomalous geochemical conditions.

The banded cherty iron formation units identified on the property indicate that exhalative volcanic geological processes were active at the time these rocks were deposited. Such processes are considered very favourable by many geologists because they are sometimes associated with precious (and base)

TABLE I

SUMMARY OF DIAMOND DRILLING RESULTS

NORTH BENTON PROPERTY, SWAYZE PROJECT, ONTARIO

	W-86-1	W-86-2	W-86-3
Collar coordinates	11+50 S, Line 24 W	8+30 N, Line 32 W	8+75 N, Line 12 W
Azimuth	025°	025°	025°
Dip	45°	45°	45°
Depth of Hole	501.5'	567'	444'
Overburden thickness	5'	3'	35'
Purpose of Hole	EM Conductor B with coincident strong dipolar Mag on strike from geochemically anomalous Au values.	EM Conductor C with coincident strong dipolar Mag adjacent to geochemically anomalous Au values.	EM Conductor D with coincident Mag anomaly.
Lithologies	Banded cherty iron formation, granodiorite, rhyolite crystal tuff.	Basalt, chert, rhyolite breccia, rhyolite.	Basalt, chert, rhyolite tuffs and breccia, massive pyritic sulphides.
Mineralization	Up to 20% Mag, Po, PY, Tr Cp.	Mag stringers, massive PY, minor graph.	Bands of massive PY, minor Mag.
Best Assays	0.01 oz Au/ton across 3.0'	0.09 oz Au/ton across 5.5'	0.03 oz Au/ton across 1.3'
Comments	Anomalous geophysical and geochemical conditions explained. Geologic environment is interesting.	Anomalous geophysical and geochemical conditions explained. Geologic environment is interesting.	Anomalous geophysical conditions explained. Geologic environment is interesting.

metals deposits. Examples of this in Canada are the Pickle Lake and Contwoyto Lake iron formations. The former hosts the Central Patricia, Pickle Crow, Dome's Donna Lake, and St. Joe's new gold deposits. The latter hosts the Echo Bay gold deposit. In all of these deposits, a subsequent major structural event appears to have remobilized and concentrated the gold mineralization in the iron formations to a size and grade that is presently economic. Those portions of the iron formation which escaped the structural activity retain only background, chemically-anomalous quantities of gold.

No evidence of any subsequent major structural activity was found in the course of the exploration work on the North Benton property. This does not necessarily mean that none is present, especially considering the lack of outcrop in many parts of the property. However, without a specific target area to concentrate further efforts, one would need unlimited funds to systematically explore all the known exhalite horizons on the property. This is not feasible, consequently additional work is not justified at this time.



November 16, 1986
Toronto, Ontario

E. A. Gallo, F.G.A.C.

APPENDIX I

DETAILED LOGS OF HOLES W-86-1, W-86-2, and W-86-3

APPENDIX II

ASSAY CERTIFICATES:

Timmins Analytical Services; A-249-86, and A-269-86

Assayers (Ontario) Ltd.; GA-39/5545

timmins

Analytical Services

P.O. Box 842
McIntyre Road
Schumacher, Ontario
Canada P0N 1G0
Phone 705-264-5111

CERTIFICATE OF ANALYSIS

Samples of: Rock

Date: October 27, 1986

No.: A - 249 - 86

Samples from: 9199

Received: October 22, 1986

Lab number	Shipper number	PPB FAAuAA				
	001	150				
	002	160				
	003	140				
	004	130				
	005	<100				
	006	140				
	007	120				
	008	180				
	009	190				
	010	230				
	011	130				
	012	220				
	013	280				
	014	140				
	015	140				
	016	<100				
	017	<100				
	018	<100				
	019	120				
	020	390				
	021	190				
	022	<100				
	023	200				
	024	190				
	025	670				
	026	300				
	027	840				
	028	140				
	029	230				

timmins

Analytical Services
P.O. Box 842
McIntyre Road
Schumacher, Ontario
Canada P0N 1G0
Phone 705-264-5111

CERTIFICATE OF ANALYSIS

Samples of: Core

Date: November 13, 1986

No.: A - 269 - 86

Samples from: 9199

Received: November 7, 1986

Lab number	Shipper number	PPB		%	Cu		
		FA	Au AA				
	030		180		-		
	031		520		-		
	032		3040		-		
	033		< 100		-		
	034		440		-		
	035		140		-		
	036		160		-		
	037		320		-		
	038		170		-		
	039		470		-		
	040		530		-		
	041		260		-		
	042		280		-		
	043		110		-		
	044		600		-		
	045		990		-		
	046		100		-		
	047		430		-		
	048		150		-		
	049		350		-		
	050		200		-		
	25801		200		-		
	25802		600		-		
	25803		250		-		
	005		-		.028		
	009		-		<.010		
	010		-		<.010		

Per: 



ASSAYERS (ONTARIO) LIMITED

33 CHAUNCEY AVENUE TORONTO, ONTARIO M8Z 2Z2 · TELEPHONE (416) 239-3527

Certificate of Analysis

Certificate No. GA-39/5545 Date: November 11, 1986

Received Nov. 7/86 1 Samples of Drill Core

Submitted by Gallo Exploration Services Inc. Att'n: Mr. F. A. Gallo

Sample No. 25804

Au ppb 398

ASSAYERS (ONTARIO) LIMITED

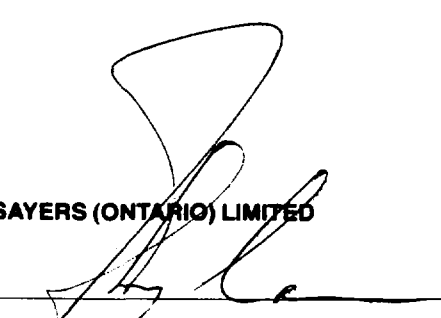
Per 

J. van Engelen Mgr.

ANALYTICAL CHEMISTS · ASSAYING · CONSULTING · ORE DRESSING · REPRESENTATION

W.R. # 402/8

BENTON, HEENAN MALLARD TWPS. Instructions - Supply required data on a separate form for each

The Mi



41016SW0071 17 BENTON

900

Name and Postal Address of Recorded Holder
WEACO RESOURCES LTD.
 Suite 805, 475 Howe Street, Vancouver, B.C. V6C 2B3

Summary of Work Performance and Distribution of Credits

Total Work Days Cr. claimed 1,512	Mining Claim			Mining Claim			Mining Claim		
	Prefix	Number	Work Days Cr.	Prefix	Number	Work Days Cr.	Prefix	Number	Work Days Cr.
for Performance of the following work. (Check one only) <input type="checkbox"/> Manual Work <input type="checkbox"/> Shaft Sinking Drifting or other Lateral Work. <input type="checkbox"/> Compressed Air, other Power driven or mechanical equip. <input type="checkbox"/> Power Stripping <input checked="" type="checkbox"/> Diamond or other Core drilling <input type="checkbox"/> Land Survey	P	880808	60	P	880816	92	P	880824	60
		880809	60		880817	60		880825	60
		880810	60		880818	60		880826	60
		880811	60		880819	60		880827	60
		880812	60		880820	60		880828	60
		880813	60		880821	60		880829	60
		880814	60		880822	60		880830	60
		880815	60		880823	100		880831	60

All the work was performed on Mining Claim(s) P 880823, P 880826, and P 880829

Required Information eg: type of equipment, Names, Addresses, etc. (See Table Below)

See attached report and Maps.

RECORDED

DEC 23 1986

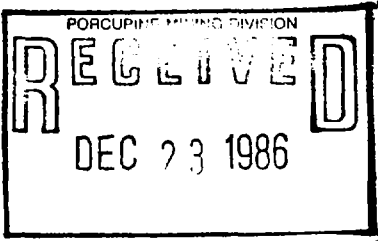

Work performed Oct. 7 - Nov. 1 / 86 incl.

Date of Report Nov. 16, 1986	Recorded Holder or Agent (Signature) <i>E. A. Gallo</i>
---------------------------------	--

Certification Verifying Report of Work

E. A. Gallo

I hereby certify that I have a personal and intimate knowledge of the facts set forth in the Report of Work annexed hereto, having performed the work or witnessed same during and/or after its completion and the annexed report is true.

Name and Postal Address of Person Certifying
E. A. Gallo 148 Allanhurst Drive

Islington, Ontario M9A 4K7

Date Certified Dec. 17, 1986	Certified by (Signature) <i>E. A. Gallo</i>
---------------------------------	--

Table of Information/Attachments Required by the Mining Recorder

Type of Work	Specific information per type	Other information (Common to 2 or more types)	Attachments
Manual Work	Nil	Names and addresses of men who performed manual work / operated equipment, together with dates and hours of employment.	Work Sketch: these are required to show the location and extent of work in relation to the nearest claim post.
Shaft Sinking, Drifting or other Lateral Work			
Compressed air, other power driven or mechanical equip.	Type of equipment	Names and addresses of owner or operator together with dates when drilling/stripping	
Power Stripping	Type of equipment and amount expended. Note: Proof of actual cost must be submitted within 30 days of recording.		

Benton Twp.

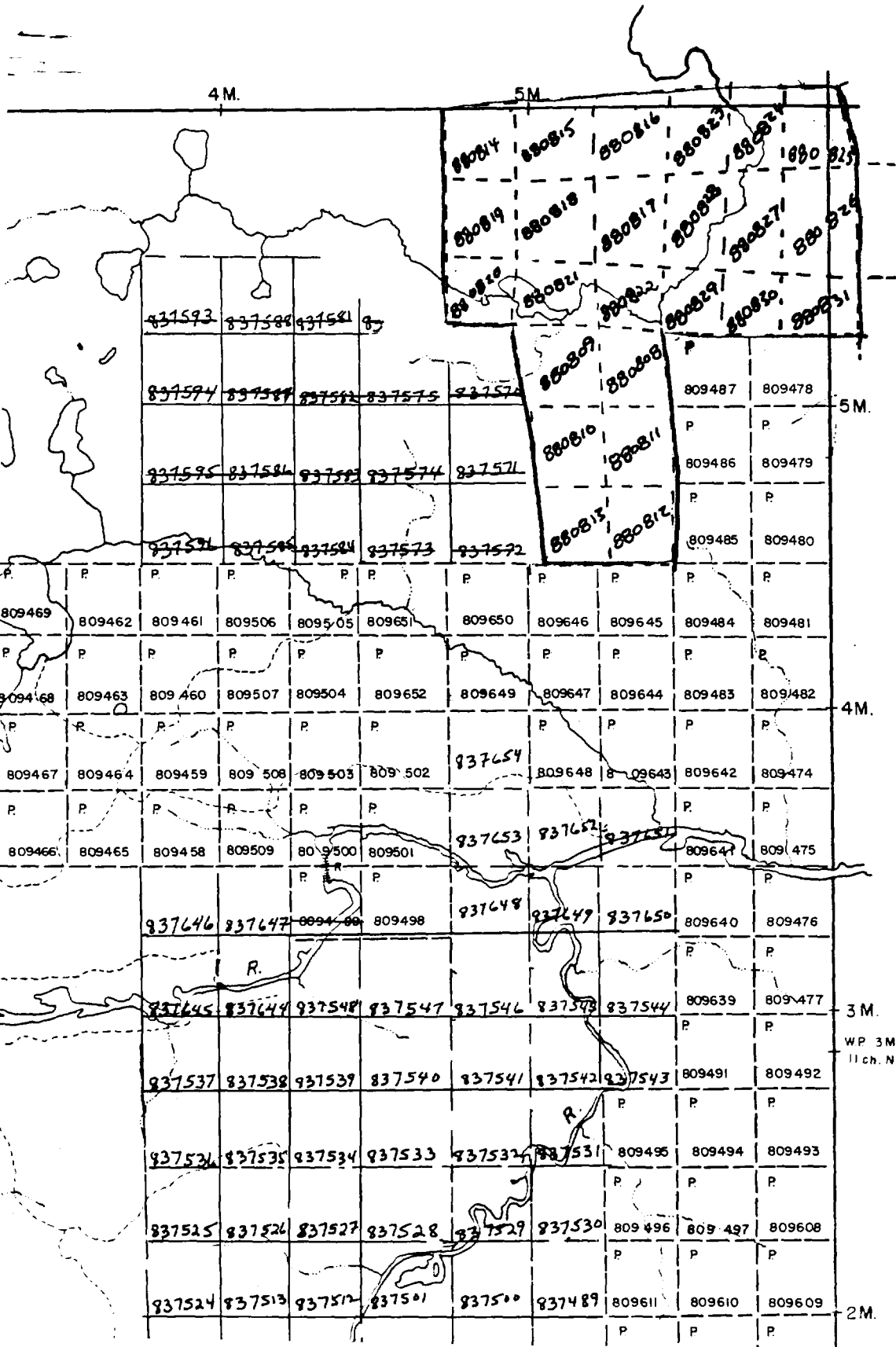

HIGHWAY A.
 OTHER ROA
 TRAILS
 SURVEYED
 TOWNSHIP
 LOTS, MIN
 UNSURVEYED
 LOT LINE
 PARCEL B
 MINING C
 RAILWAY A.
 UTILITY LIN
 NON-PEREN
 FLOODING
 SUBDIVISIO
 RESERVATIO
 ORIGINAL S
 MARSH OR
 MINES
 TRAVERSE

DISPO

TYPE OF D

PATENT, SU
 " , SU
 " , MI
 LEASE, SUP
 " , SUP
 " , MIN
 LICENCE C
 ORDER-IN-
 RESERVAT
 CANCELLE
 SAND & GR

NOTE: MINIP
 1913
 LAND

SCALE :

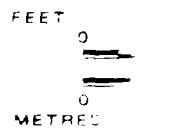

MALLARD TP.

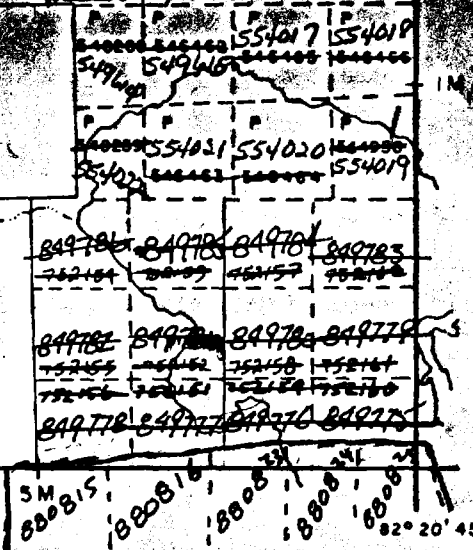
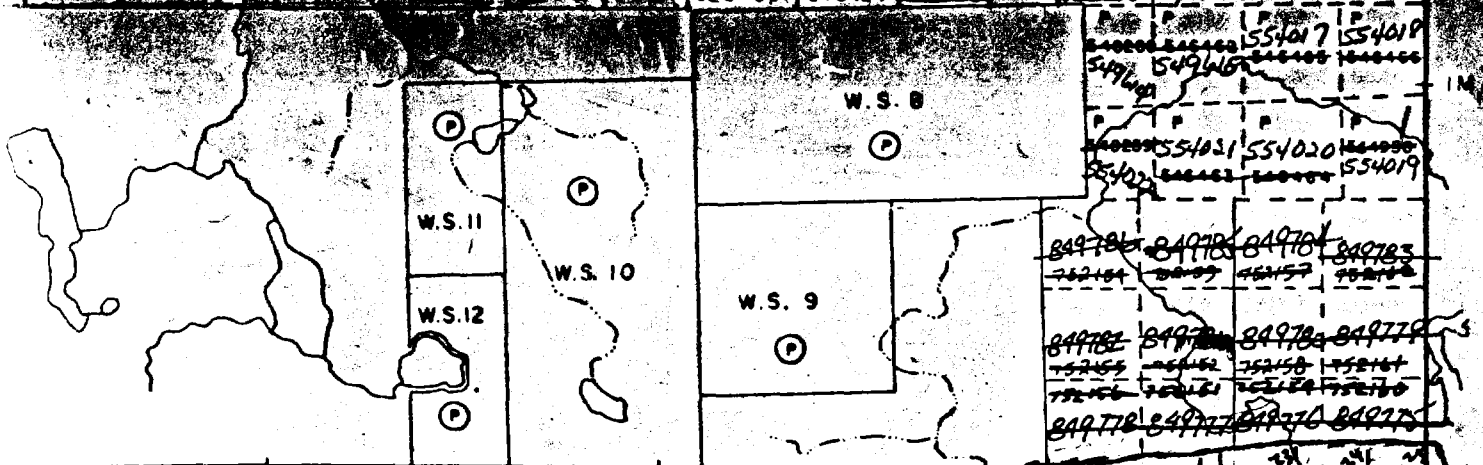
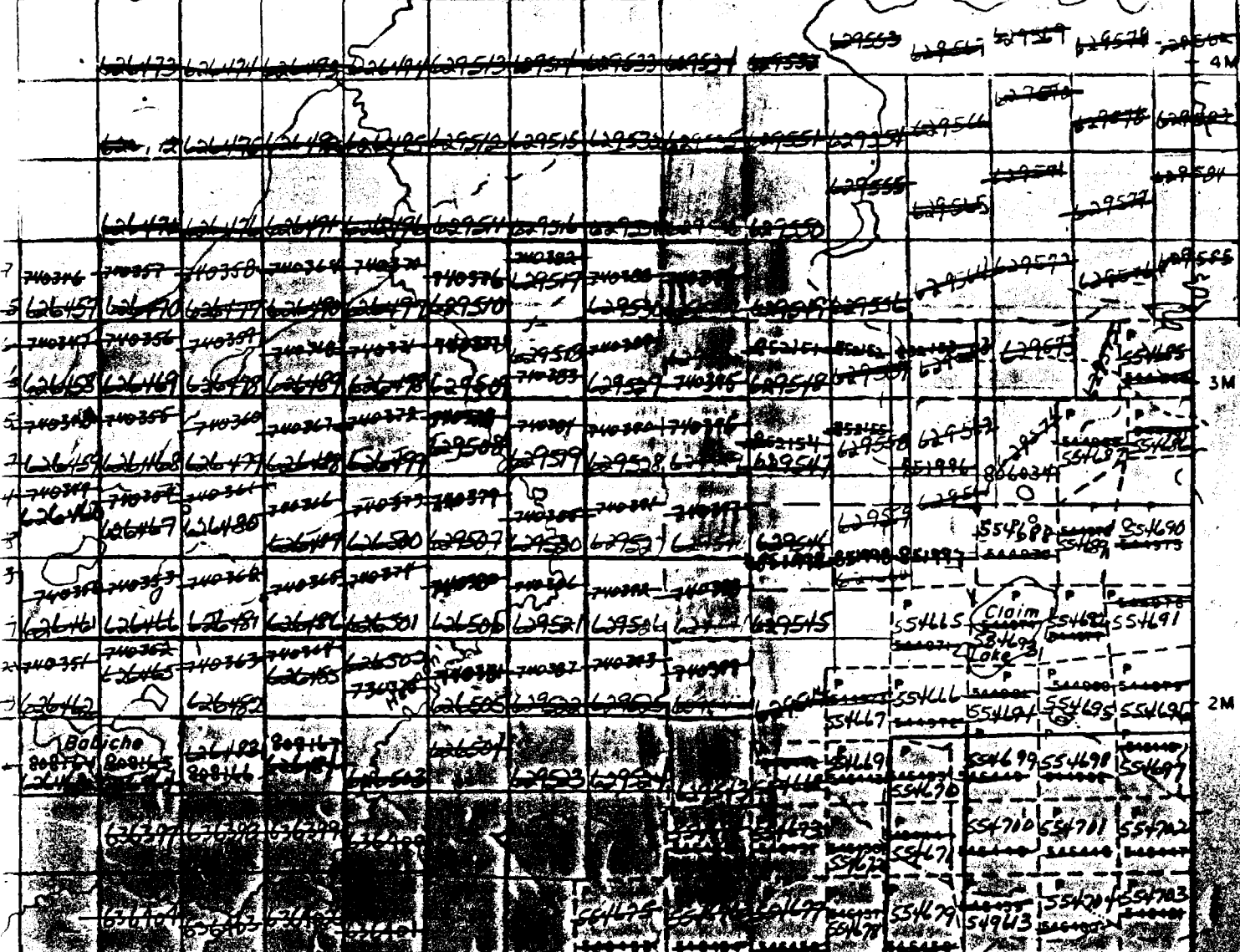

BENTON TWP. M - 659

Wheeler Twp.

3M 800815 800816 800817 800818 800819 47° 45' 82° 20' 45"

DIAMOND DRILL RECORD

WEACO RESOURCES LIMITED
SWAYZE PROJECT, ONT.

NAME OF PROPERTY North Benton Property

HOLE NO. W-86-2

SHEET NO. 10 OF 10

FOOTAGE FROM FEET TO	DESCRIPTION	SAMPLE			ASSAYS	
		NO.	% SULPHIDES	FOOTAGE FROM TO TOTAL	Au oz./ton	Au ppb
526.8 (cont'd)	RHYOLITE (cont'd) 553.0: ¼" thick calcite stringer at 20° to core axis. 558.8: 1/8" thick calcite stringer along core. 560.0: Character Sample. 561.0-564.5: 1/8" thick calcite stringer along core. 562.0-564.0: 1% disseminated pyrite in the calcite stringer. 565.0: Contact at 30° to core axis. RHYOLITE BRECCIA. Slightly sericitized. Numerous hairline fractures at 40° to core axis. Trace to 1% disseminated pyrite. Light grey colour. END OF HOLE. NOTE: Core stored in 30 covered boxes on footings 40' grid north of collar. DRILLED BY: Herbert Funk Diamond Drilling Limited, Wawa, Ontario					
565.0		039	1%	562.0 564.0 2.0	0.014	470
567.0						



DIAMOND DRILL RECORD

WEACO RESOURCES LIMITED
SWAYZE PROJECT, ONT.

NAME OF PROPERTY North Benton Property

HOLE NO. W-86-2 SHEET NO. 8 OF 10

FOOTAGE FROM FEET	TO	DESCRIPTION	SAMPLE			ASSAYS							
			NO.	% SULPH IDES	FROM FOOTAGE	TO FOOTAGE	TOTAL	Au oz/ ton	Au ppb	0.1 TON	0.2 TON		
454.5	467.5	BASALT (cont'd)											
(cont'd)		467.0: ¼" thick calcite stringer at 35° to core axis. 467.5: Minor disseminated pyrite along lamina at 30° to core axis.											
467.5	502.5	RHYOLITE BRECCIA. Fragments up to 3", elongated at 40° to core axis. Light grey colour. Trace to 1% pyrite. 467.5-472.5: 1% pyrite. 474.0: Several chlorite-lined fractures at 45° to core axis. 475.3: Trace pyrite. 476.0: Trace pyrite. 483.5: Character Sample. 484.0: Several fractures at 60°-80° to core axis. 491.0-502.5: Sericitized. Trace pyrite. Locally vuggy. Intensely shattered at 50° to core axis. 499.0: Irregular quartz stringer at 10° to core axis, with minor euhedral pyrite. 502.5: Contact at 40° to core axis.	033	Tr	467.5	472.5	5.0	0.003	100				
502.5	503.3	BASALT. Foliated. Dark greenish-grey colour. Frequent calcite stringers at 0°-40° to core axis.											
503.3	505.0	RHYOLITE BRECCIA. Fragments to 3". Light grey colour. Sericitized. Trace pyrite. Vuggy. Intensely shattered at 50° to core axis. 505.0: Contact at 80° to core axis.											
505.0	516.5	BASALT. Aphanitic. Dark green colour. Locally carbonatized. Strongly magnetic. Up to 1% disseminated euhedral pyrite. Foliated at 20°-30° to core axis. 505.0-505.8: Strongly carbonatized. Magnetic. 1% disseminated pyrite. Foliated at 20° to core axis.	034	1%	505.0	505.8	0.8	0.012	440				

DIAMOND DRILL RECORD

WEACO RESOURCES LIMITED
SWAYZE PROJECT, ONT.

NAME OF PROPERTY North Benton Property

HOLE NO. W-86-2 SHEET NO. 7 OF 10

FOOTAGE FROM FEET TO	DESCRIPTION	SAMPLE				ASSAYS				
		NO.	% SULPH IDES	FROM	FOOTAGE TO	TOTAL	Au oz/ton	Au ppb	0.1 TON	0.2 TON
311.0 (cont'd)	RHYOLITE BRECCIA (cont'd)									
454.5	408.0: Character Sample. 408.5: 1/16" thick fracture at 50° to core axis. 411.0-412.0: 1% finely disseminated euhedral pyrite. 412.0-413.0: Sericitized, strongly fractured at 50° to core axis. 415.0-419.0: Dark grey colour. Fractured, with traces of pyrite and specularite along the fractures, at 0°-50° to core axis. 417.0-417.5: Lost Core. 419.0-424.5: Light grey colour. Fractured, at 0°-50° to core axis. Traces of euhedral pyrite along fractures. 424.5-435.0: Dark grey colour. Finely disseminated magnetite in threads and stringers at 50° to core axis. 1% disseminated pyrite. 435.0-454.5: Varicoloured fragments; dark greenish-grey or pink coloured, aligned at 50° to core axis. 444.0-450.0: Strongly magnetic. Minor magnetite, trace pyrite. 445.5: 3/4" thick magnetite band at 50° to core axis. 453.3-454.5: Intensely fractured at 40° to core axis.	030	1%	411.0	412.0	1.0	0.005	180		
454.5	454.5: BASALT. Aphanitic, carbonatized, foliated at 50° to core axis. Dark greenish-grey colour. 455.5: 1/2" patch of calcite. 456.0-458.0: Brecciated, highly carbonatized. 457.8: Pyrite stringer along foliation at 40° to core axis. 460.0: 1/16" thick calcite stringer at 30° to core axis 461.5: Pyrite stringer at 50° to core axis. 464.0: Calcite stringers at 10°-50° to core axis. 465.0: Alternating light green and dark green laminations up to 2" thick at 30° to core axis.	031 032	1% 1%	424.5 429.5	429.5 435.0	5.0 5.5	0.015 0.089	520 3040		

DIAMOND DRILL RECORD

WEACO RESOURCES LIMITED
SWAYZE PROJECT, ONT.

NAME OF PROPERTY North Benton Property
HOLE NO. W-86-2 SHEET NO. 6 OF 10

LANGRIDGES - TORONTO - 366-1168

FOOTAGE FROM FEET TO	DESCRIPTION	SAMPLE			ASSAYS					
		NO.	% SULPHIDES	FROM	TO	TOTAL	Au OZ/ TON	Au ppb	0.1 TON	0.1 TON
311.0 (cont'd)	RHYOLITE BRECCIA (cont'd)									
	331.8: Vuggy quartz stringer along core.									
	332.0-342.5: Strongly magnetic.	028	1%	332.0	337.0	5.0	0.004	140		
	338.0: Character Sample.	029	1%	337.0	342.5	5.5	0.007	230		
	342.5-345.0: Bleached, sericitized. Banding at 40° to core axis.									
	347.0: Matrix of chlorite-magnetite. Interstices up to 1/8" thick. Banding at 40° to core axis. Character Sample.									
	349.0: Magnetite patch.									
	350.0: Pyrite stringer at 40° to core axis.									
	352.0-363.0: Matrix of magnetite and locally of fine euhedral pyrite.									
	358.0-362.0: Several fractures at 70° to core axis.									
	363.0-390.3: Matrix contains fine euhedral pyrite.									
	364.0: 1/8" thick calcite-sericite-chlorite stringer along core.									
	365.0: Fracture lined with calcite and chlorite.									
	367.0: 1/4" thick calcite stringer at 10° to core axis.									
	368.0: Trace pyrite.									
	369.0: Carbonatized.									
	370.0: Trace pyrite.									
	371.0: Trace pyrite.									
	373.0-374.0: Strongly fractured at 45° to core axis.									
	375.0: Trace pyrite.									
	376.0: Trace pyrite.									
	379.3: Patch of calcite.									
	379.3-384.0: Cherty, sericitized.									
	382.0: Character Sample.									
	385.0-400.0: Traces of pyrite.									
	393.0: Chlorite-lined fracture at 10° to core axis.									
	400.0-403.5: Shattered.									
	403.5-412.0: Cherty fragments, local traces of magnetite and pyrite. Banding at 50° to core axis.									

DIAMOND DRILL RECORD

WEACO RESOURCES LIMITED
SWAYZE PROJECT, ONT.

NAME OF PROPERTY North Benton Property

HOLE NO. W-86-2

SHEET NO. 4 OF 10

FOOTAGE FROM FEET	TO	DESCRIPTION	NO.	% SULPH IDES	SAMPLE			ASSAYS				
					FROM	FOOTAGE TO	TOTAL	Au OZ/ Tonn	Au ppb	OZ. TON	OZ. TON	
5.0	286.0	BASALT (cont'd)	019	Tr	230.0	233.8	3.8	0.003	120			
(cont'd)		230.0-233.8: Bleached and silicified. Light grey colour. Locally brecciated, with dark grey quartz fragments up to 1". Trace disseminated pyrite. Frequent dark grey quartz threads, at 70°-85° to core axis. Several ¼" thick white quartz stringers at 50°-70° to core axis.										
		233.8-235.3: Bleached, silicified, and carbonatized. Locally brecciated. Frequent quartz threads and stringers.										
		239.0: Several quartz-calcite patches up to 1", aligned at 50° to core axis.										
		248.5-249.0: Amygduloidal.										
		250.0: Few calcite threads at 50° to core axis.										
		253.0: Calcite-filled amygdules up to ¼" in diameter.										
		357.5: ¼" thick calcite stringer at 50° to core axis.										
		259.5: 1½" patch of calcite.										
		263.0-268.5: Calcite-filled amygdules aligned at 50° to core axis.										
		271.5: 1/8" thick calcite stringer, irregular at 90° to core axis.										
		273.0: Character sample. Amygduloidal.										
		273.0-286.0: Carbonatized, several chlorite-lined fractures at 50° to core axis.										
286.0	311.0	CHERT. White to smokey grey colour. Numerous hairline fractures filled with quartz, pyrite, and chlorite, at 30°-50° to core axis. Local sections of massive and semi-massive pyrite. Locally tuffaceous.	020	20%	286.0	288.0	2.0	0.011	390			
		286.0-288.0: Felsic tuff with 20% fine euhedral pyrite.	021	30%	288.0	289.0	1.0	0.006	190			
		288.0-289.0: Felsic tuff with 30% pyrite.										
		289.0: Character sample.										
		289.0-292.3: Pyritic chert, 20% pyrite.	022	20%	289.0	292.3	3.3	0.003	<100			

DIAMOND DRILL RECORD

WEACO RESOURCES LIMITED
SWAYZE PROJECT, ONT.

NAME OF PROPERTY North Benton Property

HOLE NO. W-86-2

SHEET NO. 2 OF 10

LANGRIDGES - TORONTO - 366-1168

FOOTAGE FROM FEET TO	DESCRIPTION	NO.	% SULPH IDES	SAMPLE			ASSAYS						
				FROM	TO	TOTAL	Au oz/ ton	Au ppb	oz./TON	oz. TON			
5.0 (cont'd)	286.0 BASALT (cont'd)												
	76.0-78.0: 1% Pyrite in stringers at 50°-70° to core axis, and in a small patch with calcite.	014	1%	76.0	78.0	2.0	0.004	140					
	80.0-81.5: Magnetite-calcite stringers with trace pyrite at 0°-20° to core axis.												
	82.8: Strongly carbonatized, disseminated magnetite.												
	82.8-111.3: Minor disseminated magnetite, locally up to 3%.												
	96.0: Several calcite stringers.												
	98.5-100.0: Several calcite-magnetite stringers.												
	100.0-102.5: Patches of magnetite-pyrite, 1" thick quartz-calcite stringer at 60° to core axis.	015	1%	100.0	102.5	2.5	0.004	140					
	102.5-105.0: Calcite-magnetite stringers up to 3/8" thick at 0°-20° to core axis.												
	107.0: Blobs and stringers of calcite-pyrite at 40° to core axis.												
	108.0-109.0: 10% pyrite disseminated in irregular 3" patch.	016	10%	108.0	109.0	1.0	0.003	<100					
	110.0-111.0: Abundant calcite stringers.												
	111.3-140.0: Numerous calcite stringers up to 1/2" thick, calcite-filled amygdules elongated parallel to foliation at 30° to core axis. Minor chlorite.												
	Occasional chlorite-lined fractures at 40° to core axis.												
	136.5-137.5: 3/8" thick calcite vein with trace pyrite along core.	017	Tr	136.5	137.5	1.0	0.003	<100					
	147.0-151.5: 3-1/8" thick calcite veins at 40° and 50° to core axis.												
	155.0: 1/8" diameter calcite-filled amygdules aligned at 30° to core axis.												
	156.0-160.0: Amygduloidal, with calcite stringers at 35° to core axis, and chlorite-lined fractures at 40° to core axis.												
	171.0: 1/4" thick calcite stringer with trace pyrite at 35° to core axis.												

DIAMOND DRILL RECORD

WEACO RESOURCES LIMITED
SWAYZE PROJECT, ONT.

NAME OF PROPERTY North Benton Property
 HOLE NO. W-86-2 LENGTH 567.0'
 LOCATION Benton Twp., Ont. Claim # P 880823
 Station 8+30 N DEPARTURE Line 32 W
 LATITUDE "0" AZIMUTH 025° DIP 45°
 ELEVATION _____
 STARTED Oct. 16, 1986 FINISHED Oct. 26, 1986

FOOTAGE	DIP	Corrected Dip	FOOTAGE	DIP	AZIMUTH
567.0'	45°	37°			

Acid Tests

HOLE NO. W-86-2 SHEET NO. 1 OF 10
 REMARKS Drilled to test
Conductor C with Direct Mag. cor-
relation in an area of altered
felsic tufts near a Diorite
intrusive & a Geochemical anomaly.
 Logged by Sandor Surmacz

FOOTAGE

FROM FEET TO

0.0 5.0
5.0 286.0

DESCRIPTION

Casing,
 BASALT. Aphanitic, altered. Dark green. Foliated at 40°-60° to core axis. Locally amygduloidal. Amygdules filled with calcite, elongated parallel to foliation. Locally abundant irregular calcite stringers up to ¼" thick. Traces of euhedral pyrite. Occasional bands of magnetite up to ¼" thick, with calcite and finely disseminated euhedral pyrite.
 5.0-20.0: Broken core. Foliated at 0°-40° to core axis.
 29.0: Few calcite-pyrite stringers at 70° to core axis.
 34.0: Strongly carbonatized.
 36.0: Broken core. Few calcite stringers at 40°-60° to core axis.
 38.8: Calcite-filled amygdules elongated at 40° to core axis.
 38.8-63.0: Strongly carbonatized.
 69.3: ¼" thick calcite-magnetite stringer at 35° to core axis.
 69.3-111.3: Strongly magnetic.
 72.0: Magnetite-pyrite stringer along core.
 73.0: Broken core. Limonitic fractures at 60° and 130° to core axis.
 73.0-74.0: Fractured, 1/8" thick calcite-magnetite stringer at 0°-60° to core axis.
 74.5: Magnetite-calcite-pyrite stringer at 0°-40° to core axis.
 75.3: 3/8" thick magnetite-pyrite stringer at 75° to core axis.

SAMPLE

NO. SUI PH. FROM TO TOTAL

A S S A Y S

Au OZ/TON Au ppb OZ/TON OZ/TON

DIAMOND DRILL RECORD

WEACO RESOURCES LIMITED
SWAYZE PROJECT, ONT.

Acid Tests

NAME OF PROPERTY North Benton Property
 HOLE NO. W-86-3 LENGTH 444.0'
 LOCATION Benton Twp., Ont. Claim # P 880826
 LATITUDE Station 8+75 N DEPARTURE Line 12 W
 ELEVATION "0" AZIMUTH 025° DIP 45°
 STARTED October 27/86 FINISHED November 1, 1986

FOOTAGE	DIP	Corrected Dip	FOOTAGE	DIP	AZIMUTH
444.0'	46°	38°			

HOLE NO. W-86-3 SHEET NO. 1 OF 8
 REMARKS Drilled to test
Conductor D with Direct Mag.
correlation in an area of altered
felsic & mafic metavolcanics
nearby diorite intrusive.
Sandor Surmacz

FOOTAGE FROM	FOOTAGE TO	DESCRIPTION	SAMPLE				ASSAYS						
			NO.	% SOLIDS	FROM	TO	Au oz/ton	Au ppb	oz/ton	oz/ton			
0.0	50.0	Casing.											
50.0	73.5	BASALT. Aphanitic, foliated at 40° to core axis. Dark grey colour. Carbonatized, chloritized, locally limonitic. 52.5: 1/8" thick calcite stringer at 45° to core axis. 53.0: Several calcite stringers at 45° to core axis. 55.0: Several calcite stringers at 45° to core axis. 60.0: Several 1/4" thick calcite stringers at 45° to core axis. 65.0-67.0: Fractured along foliation. 67.0-68.0: Limonitic laminae. 69.8: 1" thick limonitic band at 40° to core axis. 70.0-73.5: Intensely fractured along foliation. 71.0-72.0: Limonitic laminae at 40° and 10° to core axis. 73.5: Contact at 30° to core axis.											
73.5	77.0	CHERT. Grey, locally black colour. Pyritic. 30° to core axis. 73.5-74.0: 90% pyrite. 74.0-75.5: 50% pyrite. 75.0: Character Sample. 75.5-77.0: 30% pyrite. Limonitic bands up to 1/4" thick at 30° to core axis. 77.0: Contact at 30° to core axis.	040	90%	73.5	74.0	0.5	0.015	530				
			041	50%	74.0	75.5	1.5	0.008	260				
			042	30%	75.5	77.0	1.5	0.008	280				

DIAMOND DRILL RECORD

WEACO RESOURCES LIMITED

SWAYZE PROJECT, ONT.

NAME OF PROPERTY North Benton Property

HOLE NO. W-86-3

SHEET NO. 3 OF 8

LANGRIDGES - TORONTO - 366-1168

FOOTAGE FROM TO	DESCRIPTION	SAMPLE				ASSAYS				
		NO.	% SULPH IDES	FROM	FOOTAGE TO	TOTAL	Au oz/ ton	Au ppb	02./TON	02./TON
94.0 (cont'd)	163.3 RHYOLITE BRECCIA (cont'd)									
	119.3-119.5: Massive pyrite.									
	119.5-139.5: Pink coloured fragments. Traces pyrite.									
	131.0: Chlorite-lined fracture.									
	139.5-163.3: Dark grey coloured fragments. Sections of up to 60% pyrite.									
	144.0-149.0: 2% finely disseminated pyrite.	050	2%	144.0	149.0	5.0	0.006	200		
	149.0-151.5: 10% pyrite in patches and stringers, 35° to core axis.	25801	10%	149.0	151.5	2.5	0.006	200		
	149.5: Character Sample.									
	151.5-153.0: 60% pyrite, 30° to core axis.	25802	60%	151.5	153.0	1.5	0.017	600		
	151.5: Character Sample.									
	153.0-153.8: 10% pyrite in patches and stringers.	25803	10%	153.0	153.8	0.8	0.007	250		
	155.0: Trace pyrite.									
	157.0: Core Broken. Chlorite-lined fractures.									
	163.3: Contact at 20° to core axis.									
163.3	176.5 BASALT. Chloritized, foliated at 30° to core axis. Aphanitic. Carbonatized. Dark grey colour.									
	166.3: Calcite stringer at 40° to core axis.									
	166.8: Chlorite-lined fracture at 30° to core axis.									
	169.8: Amygduloidal, filled with quartz.									
	171.0: 1/8" thick quartz-calcite stringer at 60° to core axis.									
	172.3: Several quartz-calcite stringers at 60° to core axis.									
	174.0-175.0: Fractured and broken, 30° to core axis.									
	176.5: Contact at 80° to core axis.									
176.5	348.5 RHYOLITE BRECCIA. Pink coloured fragments up to 6". Elongated at 50° to core axis. Matrix consists of chlorite, sericite, and magnetite. Fractured. Trace of finely disseminated euhedral pyrite. Locally carbonatized.									

Problem Page

The original page in this document had a problem when scanned and as a result was unable to convert to Portable Document Format (PDF).

We apologize for the inconvenience.

Problème de conversion de page

Un problème est survenu au moment de balayer la page originale dans ce document. La page n'a donc pu être convertie en format PDF.

Nous regrettons tout inconvénient occasionné par ce problème.

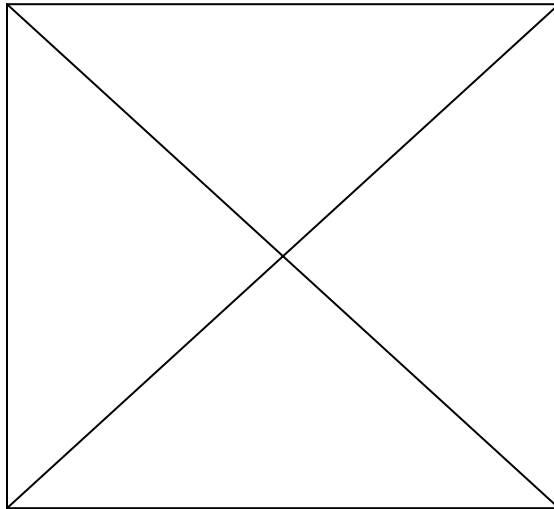

DIAMOND DRILL RECORD

WEACO RESOURCES LIMITED
SWAYZE PROJECT, ONT.

NAME OF PROPERTY North Benton Property

HOLE NO. W-86-3

SHEET NO. 6 OF 8

LANGRIDGES - TORONTO - 366-1168

FOOTAGE FROM FEET TO	DESCRIPTION	SAMPLE			ASSAYS				
		NO.	% SULPH IDES	FROM FOOTAGE TO	TOTAL	Au oz/ ton	Au ppb	0.1 TON	0.2 TON
176.5 (cont'd)	RHYOLITE BRECCIA (cont'd)								
348.5	308.0: Broken Core. Fractured, lined with chlorite and pyrite. 309.0-316.0: Traces of pyrite, chlorite. 317.0: Calcite patches and stringers at 40° to core axis. 318.0-348.5: Dark coloured, chloritic matrix. Trace pyrite, locally magnetic. 319.0-320.0: 1% euhedral pyrite, chloritic. 321.0-327.0: Traces pyrite. 335.0: ½" thick chlorite band with disseminated magnetite, at 80° to core axis. 348.0: Magnetic, trace euhedral pyrite. 348.5: Contact at 50° to core axis.	25804	1%	319.0	320.0	1.0	0.012	398	
348.5	373.0 BASALT. Aphanitic, foliated at 45° to core axis. Dark greenish-black colour. Chloritized. Locally brecciated, carbonatized. Locally magnetic. Trace euhedral pyrite. 348.5: Trace euhedral pyrite. 349.0-354.0: Brecciated at 50° to core axis. 353.5: Trace pyrite, 50° to core axis. 354.0: 1/16" thick calcite vein at 40° to core axis, with trace pyrite. 357.5: Trace pyrite. 358.0: Several calcite stringers at 10° to core axis, minor magnetite. 359.0-373.0: Magnetic. 359.0-362.0: Several calcite stringers up to ½", at 10°-35° to core axis. 364.0-365.0: Strongly carbonatized. Network of calcite stringers. 366.3: 1/16" thick calcite stringer at 60° to core axis. 367.0-369.0: Network of calcite stringers.								

DIAMOND DRILL RECORD

WEACO RESOURCES LIMITED

SWAYZE PROJECT, ONT

NAME OF PROPERTY North Benton Property

HOLE NO. W-86-3 SHEET NO. 7 OF 8

LANGRIDGES - TORONTO - 366-1168

FOOTAGE FROM MEET TO	DESCRIPTION	SAMPLE			ASSAYS			
		NO.	% SULPHIDES	FOOTAGE FROM TO TOTAL	Au oz/ton	Au ppb	02.70M	02.70M
348.5 373.0 (cont'd)	BASALT (cont'd)							
	370.0: Fracture, lined with calcite, at 10° to core axis.							
	371.0-373.0: Network of calcite stringers.							
	373.0: Contact at 60° to core axis.							
373.0 425.0	RHYOLITE BRECCIA. Fragments generally pink but locally light grey coloured, up to 3". Matrix consists of chlorite and sericite. Strongly fractured, generally at 50° to core axis. Strongly carbonatized. Trace euhedral pyrite.							
	373.0: ¼" thick calcite stringer at 80° to core axis, with trace pyrite.							
	374.0: Network of hairline fractures, filled with calcite. Trace pyrite.							
	378.0: Fracture at 35° to core axis.							
	381.0: Patch of calcite with trace euhedral pyrite.							
	383.0-407.8: Chloritized. Light grey coloured fragments.							
	384.0: Trace pyrite.							
	386.0: 3/8" thick calcite stringer at 45° to core axis.							
	387.5: ¼" thick pyrite band.							
	389.0: Trace pyrite.							
	390.8: 3/8" thick calcite stringer at 70° to core axis.							
	396.0: Trace pyrite.							
	407.8-410.0: Pink coloured fragments.							
	410.0-425.0: Chloritized. Light grey coloured fragments.							
	425.0: Contact at 60° to core axis.							
425.0 444.0	BASALT. Aphanitic, chloritic, carbonatized, foliated at 40° to core axis. Dark greenish-grey colour. Locally magnetic. Trace euhedral pyrite.							
	435.0: Magnetic.							

DIAMOND DRILL RECORD

WEACO RESOURCES LIMITED
SWAYZE PROJECT, ONT.

NAME OF PROPERTY North Benton Property

HOLE NO. W-86-3

SHEET NO. 8 OF 8

FOOTAGE FROM FEET TO	DESCRIPTION	NO.	% SUPPH IDES	SAMPLE			ASSAYS						
				FROM	TO	TOTAL	Au oz/ ton	Au ppb	0.7 TON	0.7 TON			
425.0 444.0 (cont'd)	BASALT (cont'd)												
	436.0: ¼" thick calcite stringer at 40° to core axis.												
	438.5-440.0: Several 1/16" thick calcite stringers at 45° to core axis.												
	442.0: Trace pyrite.												
	443.5: Several 1/8" thick calcite stringers at 60° to core axis, trace pyrite.												
	444.0: Trace pyrite.												
444.0	END OF HOLE												
	NOTE: Core stored in 21 covered boxes on footings 40' SE of collar.												
	DRILLED BY: Herbert Funk Diamond Drilling Limited, Wawa, Ontario												



DIAMOND DRILL RECORD

WEACO RESOURCES LIMITED
SWAYZE PROJECT, ONT.

Acid Tests

NAME OF PROPERTY North Benton Property
 HOLE NO. W-86-1 LENGTH 501.5'
 LOCATION Benton Twp., Ont., Claim #P 880829
 STATION 11+50 S DEPARTURE Line 24 W
 ELEVATION "0" AZIMUTH 025° DIP 45°
 STARTED Oct. 7, 1986 FINISHED Oct. 14, 1986

FOOTAGE	DIP	Corrected Dip	FOOTAGE	DIP	AZIMUTH
501.5'	48°	40°			

HOLE NO. W-86-1 SHEET NO. 1 OF 5
 REMARKS To test Conductor B with direct Mag. correlation & Geochem. Anomaly in area of Cherty I.F. and Felsic Tufts near 2 Granitic Plugs
 Logged by Sandor Surmacz

FROM DEPTH	TO	DESCRIPTION	SAMPLE				ASSAYS								
			NO.	% SULPHIDES	FROM	TO	TOTAL	Au OZ/ TON	Au ppb	oz/TON	oz/TON	Cu %			
0.0	10.0	Casing.													
10.0	149.5	BANDED CHERTY IRON FORMATION. Aphanitic. Rhythmic layers of smokey, dark grey chert with red jasper, up to 6" thick. Bedding at 20°-25° to core axis. Local concentrations of up to 20% of magnetite, pyrrhotite, and fine pyrite along laminae. Trace chalcopyrite locally.	001	2%	12.5	13.5	1.0	0.004	150						
		12.5-13.5: Broken core. Limonitic fractures at 130° to core axis. 2% finely disseminated pyrite along laminae at 20° to core axis.													
		15.0-17.5: Lost core.													
		17.5-18.8: Broken core. Limonitic. 1% finely disseminated pyrite along laminae at 130° to core axis.	002	1%	17.5	18.8	1.3	0.005	160						
		20.0-21.5: Dark grey beds up to 1' thick at 20° to core axis, with 1% finely disseminated pyrite. Local concentrations of pyrite in beds up to ½" thick.	003	1%	20.0	21.5	1.5	0.004	140						
		24.5-25.5: Vuggy, with limonitic fractures at 130° to core axis. Locally bleached. Trace pyrite locally.	004	Tr	24.5	25.5	1.0	0.004	130						
		26.5-32.0: Red jasper bands up to 2" thick. Bedding at 25° to core axis.													
		39.5: Character Sample.													
		46.3: Limonitic fracture at 160° to core axis.													
		53.0: Minor magnetite lamina.													
		54.0: Minor magnetite lamina.													
		62.0: Red jasper bands at 20° to core axis.	005	Tr	63.5	64.0	0.5	0.003	<100						0.03
		63.5-64.0: Red jasper bands at 20° to core axis. Minor chalcopyrite in stringers at 160° to core axis.													

DIAMOND DRILL RECORD

WEACO RESOURCES LIMITED

SWAYZE PROJECT, ONT.

NAME OF PROPERTY North Benton Property

HOLE NO. W-86-1

SHEET NO. 2 OF 5

LANGRIDGES - TORONTO - 366-1168

FORM 2

FOOTAGE FROM FEET TO	DESCRIPTION	NO.	% SULPH. IDES	SAMPLE			ASSAYS							
				FROM	FOOTAGE TO	TOTAL	Au oz/ ton	Au ppb	0.7 TON	0.2 TON				
10.0 (cont'd)	149.5 Banded Cherry Iron Formation (cont'd)													
	64.0-67.0: Red jasper bands at 20° to core axis.													
	68.0-82.5: Red jasper bands at 20°-30° to core axis, intersected by network of very fine white quartz veinlets.													
	71.0: Fractures at 130° to core axis.													
	76.0: Fracture with ½" offset.													
	82.5-149.5: Strongly magnetic, with greenish-grey chert beds up to 1' thick, alternating at 20°-30° to core axis. Laminae of finely disseminated pyrite up to 1/8" thick interbedded with magnetite. Minor pyrite as veinlets or fracture coatings at 130° to core axis.													
	85.8: ¼" thick lamina of pyrite at 20° to core axis.													
	86.0: Fracture with ½" offset of magnetite lamina.													
	88.0: ¼" thick lamina of pyrite in a 3" thick lamina of magnetite at 20° to core axis.													
	88.5: Fracture network at 140° to core axis.													
	89.0: Fracture at 165° to core axis, with pyrite and magnetite.													
	94.0-95.0: Broken core.													
	99.0: Fracture at 160° to core axis in a magnetic lamina.													
	102.8: 1" thick lamina of magnetite at 30° to core axis, with 1/8" thick lamina of pyrite.													
	104.8-106.5: Magnetite laminae at 25° to core axis, with 1% pyrite in laminae up to 1/8" thick.	006	1%	104.8	106.5	1.7	0.004	140						
	105.8: Fracture at 150° to core axis.													
	107.8-109.3: Magnetite laminae with finely disseminated pyrite, and pyrite laminae, at 30° to core axis.													
	110.8: Fracture at 140° to core axis.													
	112.3-114.5: Magnetite beds up to 9" thick at 30° to core axis, with 2% pyrite in laminae up to ½" thick, and in network of pyrite veinlets.	007	2%	112.3	114.5	1.2	0.003	120						

DIAMOND DRILL RECORD

WEACO RESOURCES LIMITED
SWAYZE PROJECT, ONT.

NAME OF PROPERTY North Benton Property
HOLE NO. W-86-1 SHEET NO. 3 OF 5

FOOTAGE FROM FEET	TO	DESCRIPTION	NO.	% SULPH IDES	SAMPLE			ASSAYS				
					FROM	FOOTAGE TO	TOTAL	Au oz/ ton	Au ppb	0.2 TON	0.2 TON	
10.0	149.5	BANDED CHERTY IRON FORMATION (cont'd)	008	1%	127.0	131.8	4.8	0.005	180			
(cont'd)		Magnetite bands @ 115.5, 116.5, 117.0, 117.3, 118.5, 119.0, 119.5, 121.3, 125.0, 125.8, and 126.3. 127.0-131.8: Magnetite interbedded with greenish chert laminae up to ¼" thick at 40° to core axis, and 1% pyrite in laminae up to 1/8" thick and in network of pyrite veinlets. 128.5: Fracture at 120° to core axis. 131.0: Brecciated quartz for 3" at 90° to core axis. 134.0: Magnetite band 9" thick with finely disseminated pyrite laminae at 50° to core axis. 149.3: Pyrite lamina at 20° to core axis. 149.5: Contact at 50° to core axis.										
149.5	288.5	GRANODIORITE. Fine to medium grained, massive, pale grey. Fresh, slightly magnetic. Finer grained at both contacts. Fractures @ 150.5: 140° to core axis, 151.0: 130° to core axis, 153.0: 150° to core axis, 154.0: 120° to core axis, 166.0: 120° to core axis, 167.0: 140° to core axis. Random fracturing continues to 186.0' where core is broken. 226.3: Calcite and chlorite-lined fracture at 145° to core axis. 240.8: Calcite and chlorite-lined fracture at 155° to core axis. 288.5: Contact at 50° to core axis.										
288.5	338.5	BANDED CHERTY IRON FORMATION. Rhythmic layers of light grey chert and blackish magnetite averaging 3" in thickness at 40° to core axis. Local interbedded pyrrhotite laminae up to ¼" thick, Occasional hairline fractures and networks with up to 2% pyrite and pyrrhotite, and trace chalcopyrite. Locally graphitic.										

DIAMOND DRILL RECORD

WEACO RESOURCES LIMITED
SWAYZE PROJECT, ONT.

NAME OF PROPERTY

North Benton Property

HOLE NO. W-86-1

SHEET NO. 4 OF 5

FOOTAGE FROM FEET TO	DESCRIPTION	SAMPLE			ASSAYS				
		NO.	% SULPHIDES	FOOTAGE FROM TO TOTAL	Au OZ/ TON	Au ppb	02. TON	02. TON	Cu %
288.5 (cont'd)	BANDED CHERTY IRON FORMATION (cont'd)								
	288.5-300.0: 2% pyrite and pyrrhotite, trace chalcopyrite.	009	2%	288.5 300.0 11.5	0.006	190			<0.01
	288.5: Character Sample.								
	289.0: Character Sample.								
	308.5: Trace chalcopyrite.								
	314.5: 1/8" thick calcite veinlet at 140° to core axis.								
	318.0: Character Sample.								
	330.0+338.5: 2% pyrite and pyrrhotite, Tr chalcopyrite.	010	2%	330.0 338.5 8.5	0.007	230			<0.01
	330.8: 1/4" thick calcite veinlet at 140° to core axis.								
	338.5: contact at 50° to core axis.								
338.5	RHYOLITE CRYSTAL TUFF. Laminated at 50° to core axis. Slightly sericitized, more so for 20' near contact. Fractured with chlorite linings. Small quartz phenocrysts, trace of finely disseminated euhedral pyrite, mainly along laminae. Trace chalcopyrite locally. Occasional calcite blebs and veinlets along laminae.								
	341.5: Calcite veinlet at 50° to core axis.								
	342.5: 1/8" thick pyrite lamina.								
	343.0: 1/8" thick pyrite lamina.								
	343.5: Minor chalcopyrite smeared on lamina.								
	370.0-372.5: Few grains of pyrite.	011	Tr	370.0 372.5 2.5	0.004	130			
	377.0-377.5: Lost core.								
	403.8-405.5: Occasional quartz-calcite stringers.								
	406.0-407.0: Brecciated, with quartz and calcite. Filling the matrix as stringers up to 1/8" thick.	012	Tr	406.0 407.0 1.0	0.006	230			
	Vuggy, Minor pyrite.								
	421.5-424.5: Brecciated, with quartz and calcite filling the matrix as stringers up to 1/4" thick. Vuggy, 2% disseminated pyrite. Specular hematite lines some of the quartz stringers.	013	2%	421.5 424.5 3.0	0.008	280			
	425.5: Several quartz stringers up to 1/4" thick at 50° to core axis.								

DIAMOND DRILL RECORD

WEACO RESOURCES LIMITED
SWAYZE PROJECT, ONT.

NAME OF PROPERTY North Benton Property

HOLE NO. W-86-1 SHEET NO. 5 OF 5

LANGRIDGES - TORONTO - 366-1168

FOOTAGE FROM FEET TO	DESCRIPTION	SAMPLE			ASSAYS			
		NO.	% SULPHIDES	FOOTAGE FROM TO TOTAL	Au oz/ton	Au ppb	0.2 TON	0.2 TON
338.5 (cont'd)	501.5 RHYOLITE CRYSTAL TUFF (cont'd)							
	427.0: 1/2" thick quartz stringer at 30° to core axis.							
	429.5: Chlorite-lined fractures at 170° and 120° to core axis.							
	446.0: 1/4" thick quartz-calcite stringer at 60° to core axis.							
	468.0-471.0: Bleached.							
	473.0: 1/2" thick quartz-calcite stringer at 45° to core axis.							
	483.0: 1/4" thick seam of sericite at 45° to core axis.							
	490.0: 1/8" thick quartz-calcite stringer along core.							
	491.0: Few euhedral pyrite crystals.							
	493.5: 1/2" thick quartz-calcite stringer with chlorite at 50° to core axis.							
	495.3: Trace chalcopyrite as smears along laminae at 50° to core axis.							
	496.0: 1/8" thick quartz-calcite-chlorite stringer at 60° to core axis.							
	498.0: 1/8" thick quartz-calcite-chlorite stringer with trace pyrite along laminae at 50° to core axis.							
	499.0: 1/8" thick quartz-calcite-chlorite stringer with trace pyrite along laminae at 50° to core axis.							
501.5	END OF HOLE.							

NOTE: Core stored in 26 covered boxes on footings 50' west of collar.

DRILLED BY: Herbert Funk Diamond Drilling Limited,
Wawa, Ontario

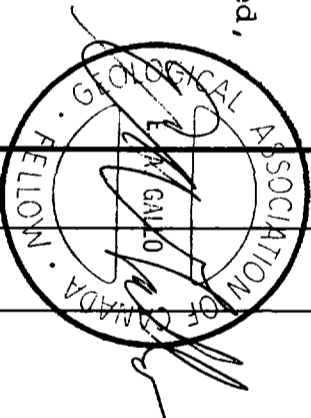

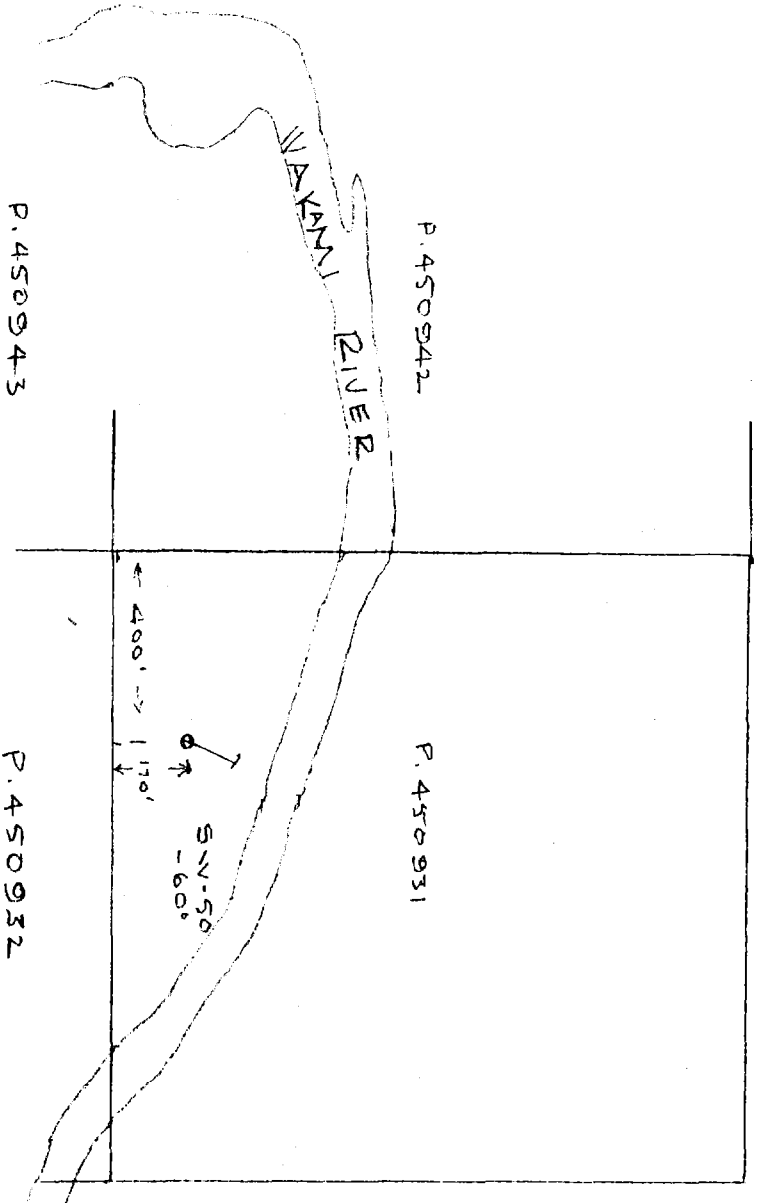

BENTON TWP.

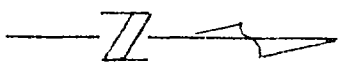

PORCUPINE MINING DIVISION
RECEIVED
 AUG 29 1978
 AM 7:39:12 PM 7:34:56

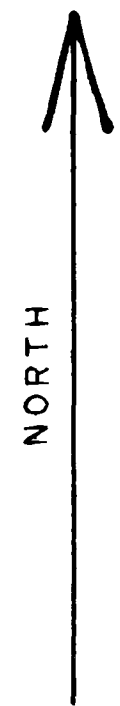

PLAN
SCALE : 1" = 400'

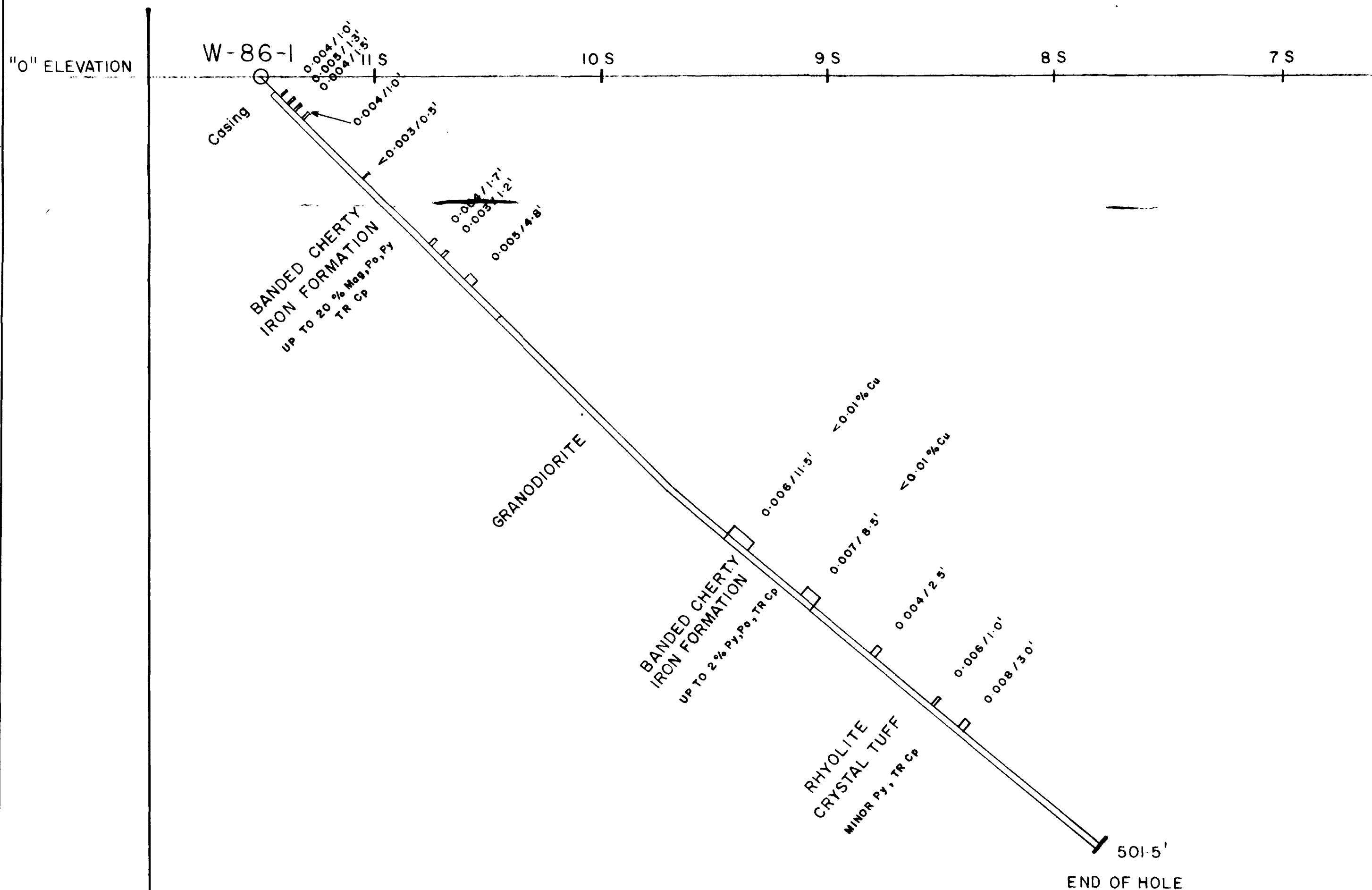
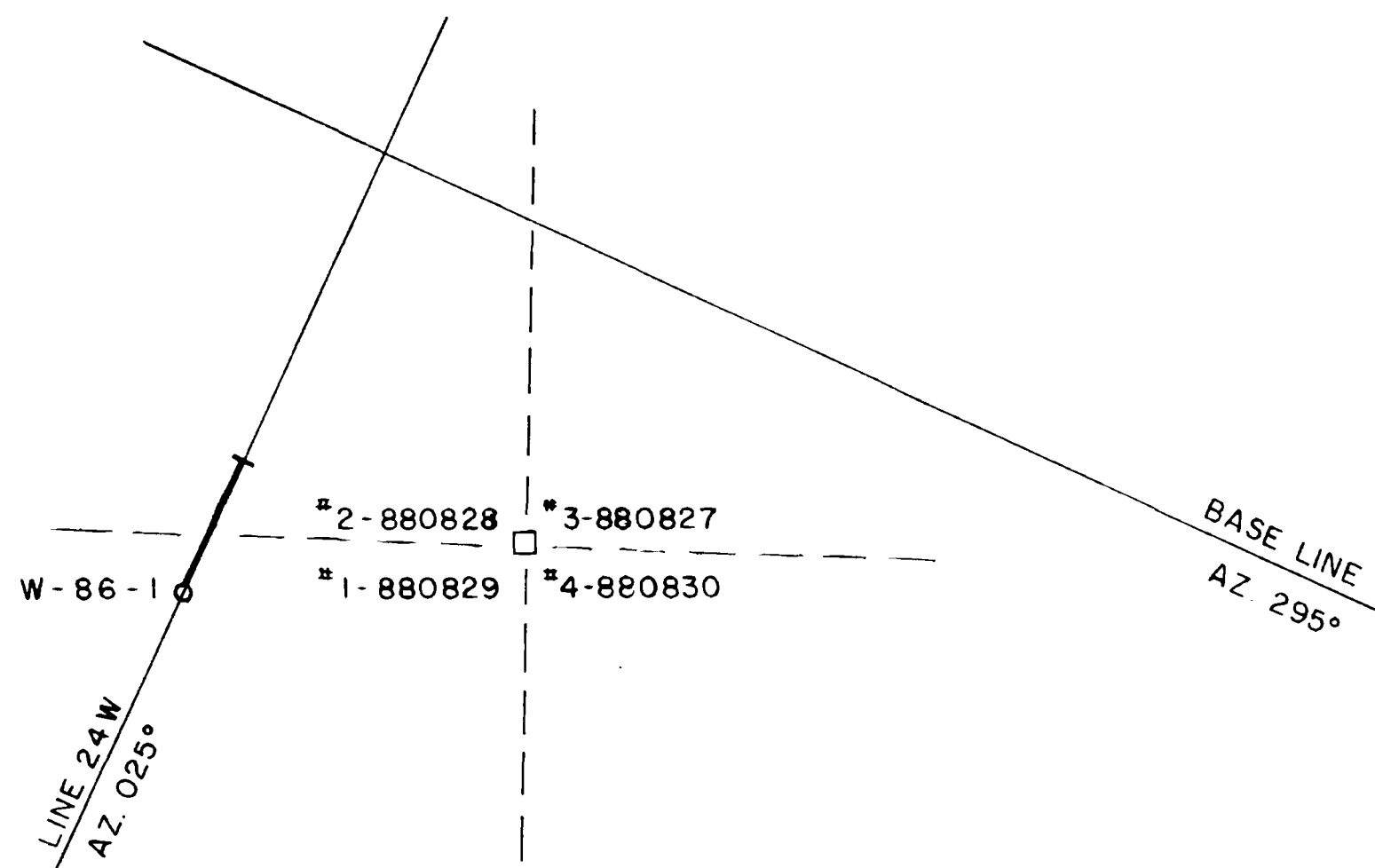

SECTION ALONG LINE 24W

SCALE : 1" = 40'

ASSAY VALUES IN OZ. Au/Ton

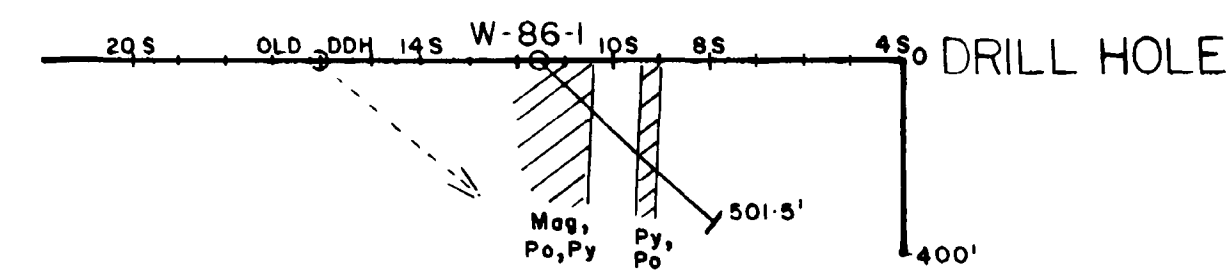
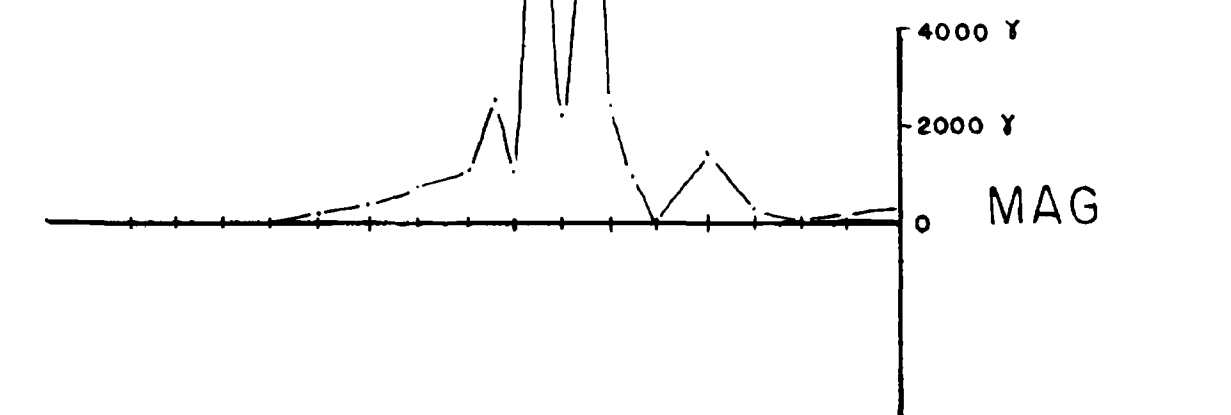
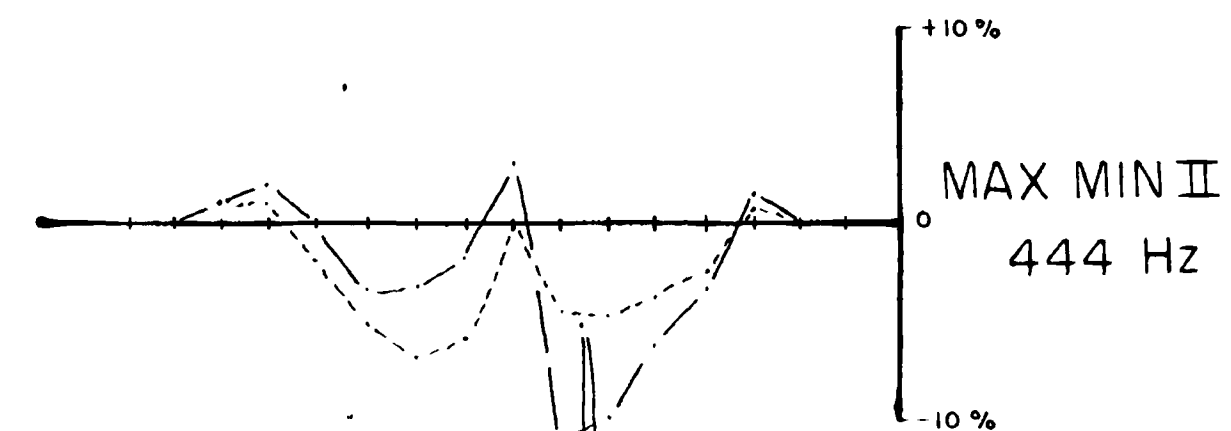
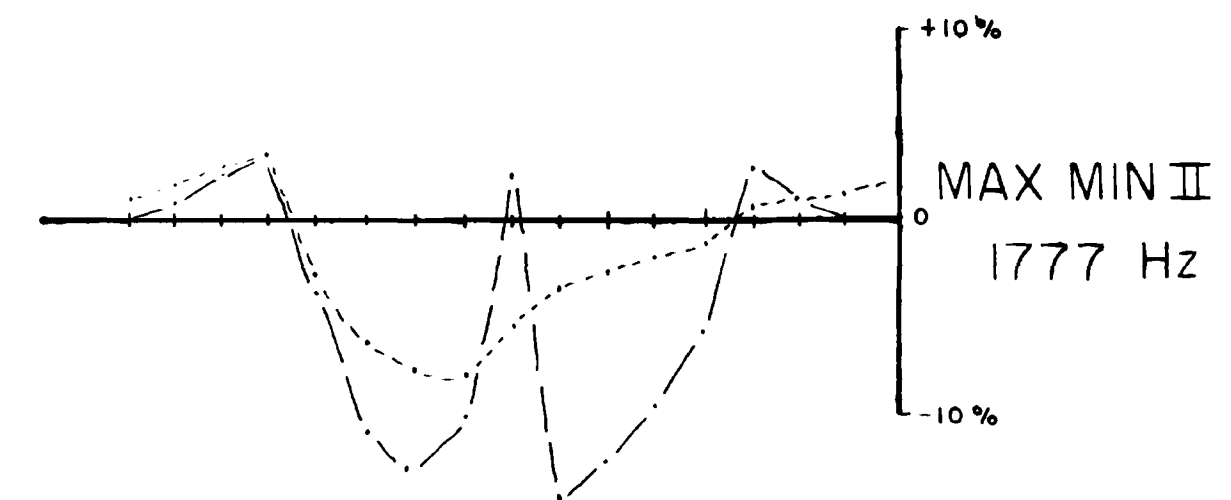
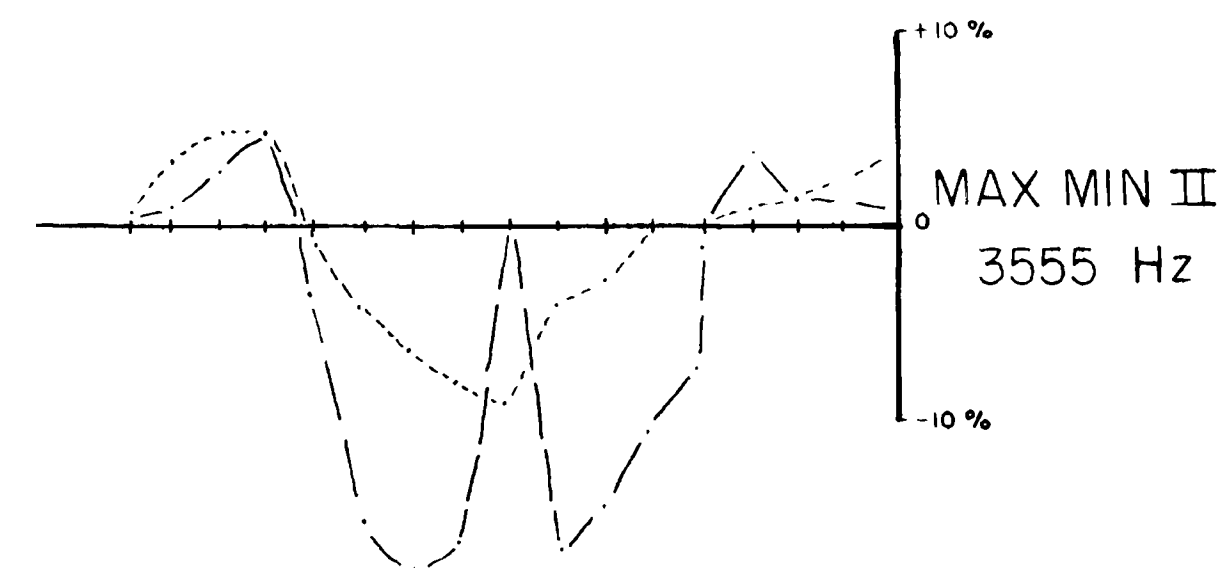

SECTION ALONG LINE 24W

SCALE : 1" = 400'

WEACO RESOURCES LTD.
VANCOUVER, B.C.

SWAYZE PROJECT, ONT.
NORTH BENTON PROPERTY

HOLE W-86-1

DATE: NOV. 16, 1986

DRAWN BY: E.A.G.

MAP NO. 2

Benton DDR 17



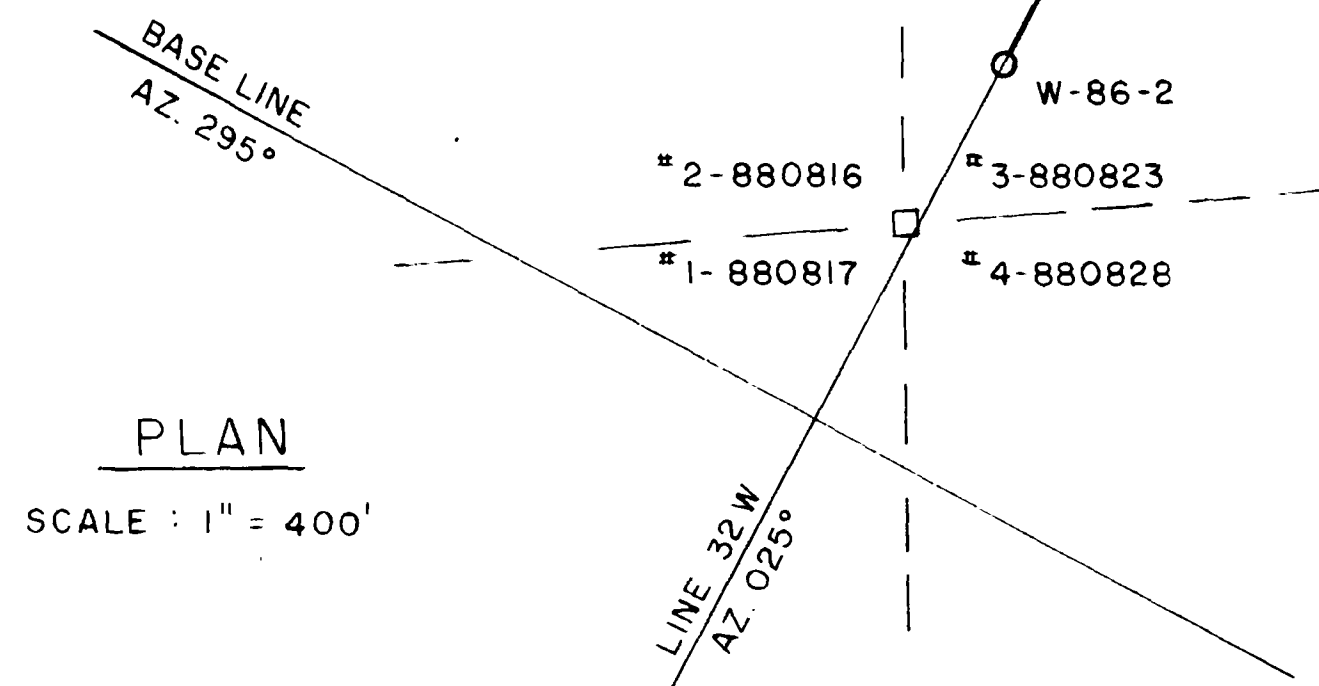
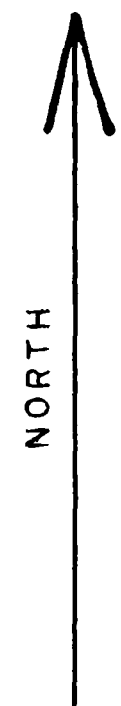

PLAN
SCALE: 1" = 400'

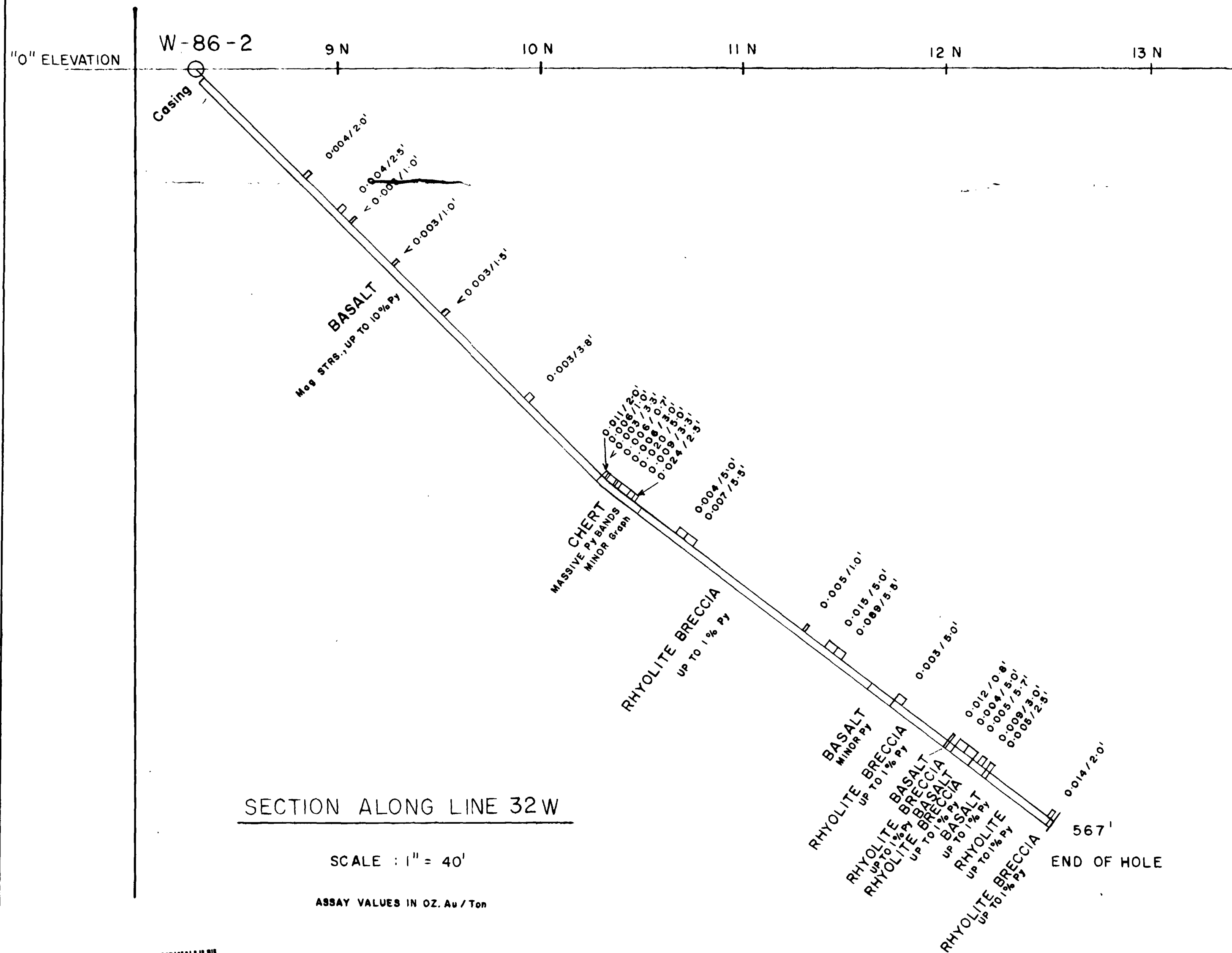

SECTION ALONG LINE 32 W

SCALE: 1" = 40'

ASSAY VALUES IN OZ. Au / Ton

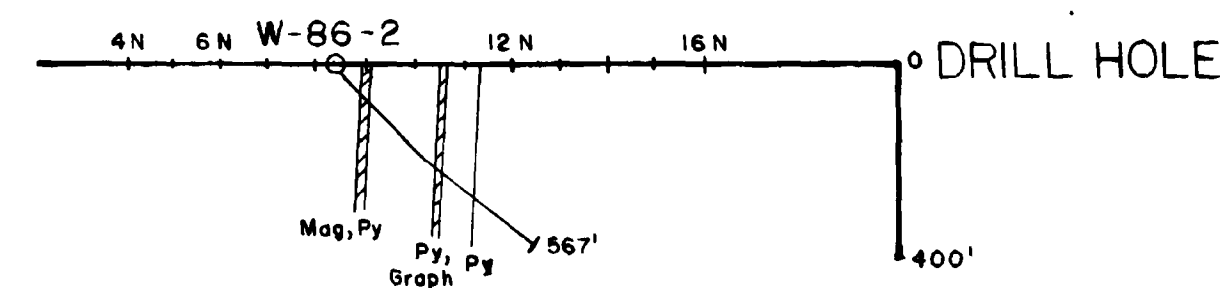
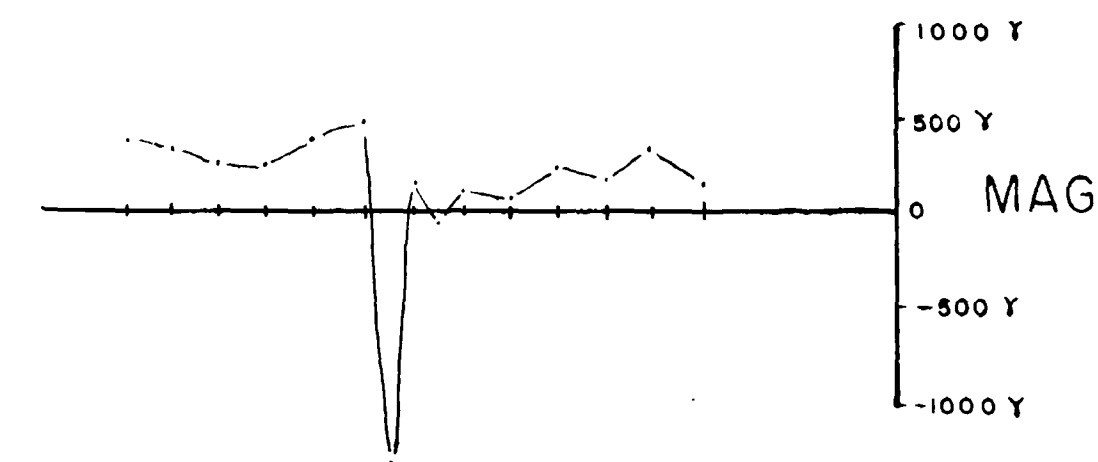
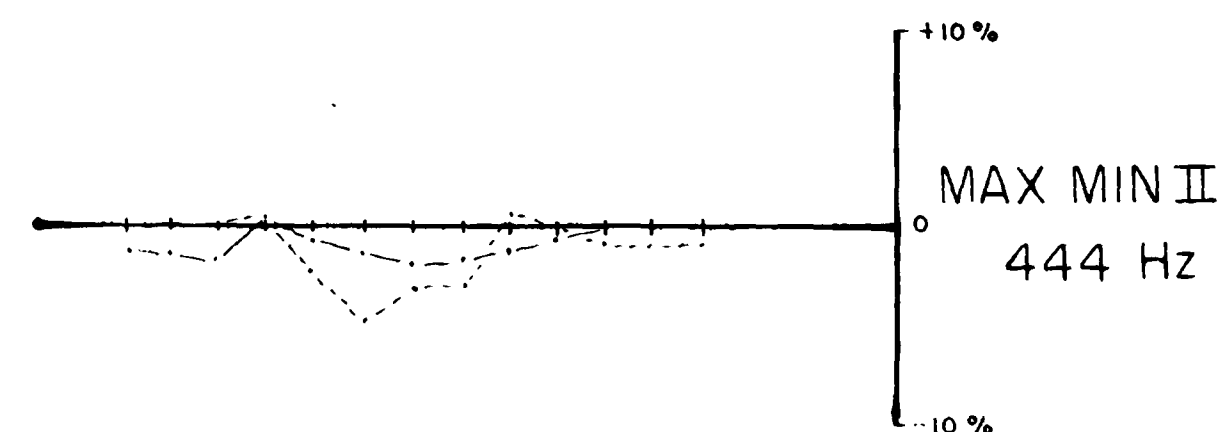
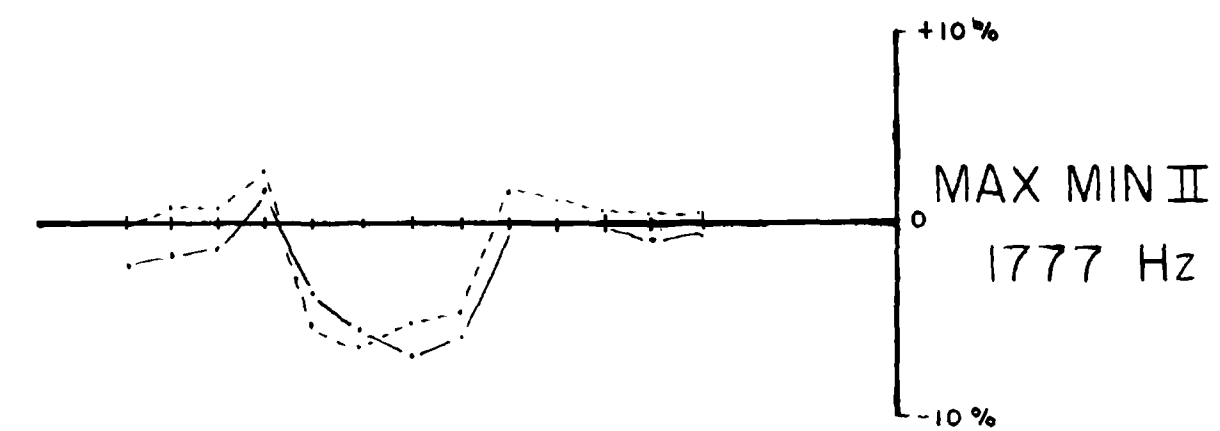
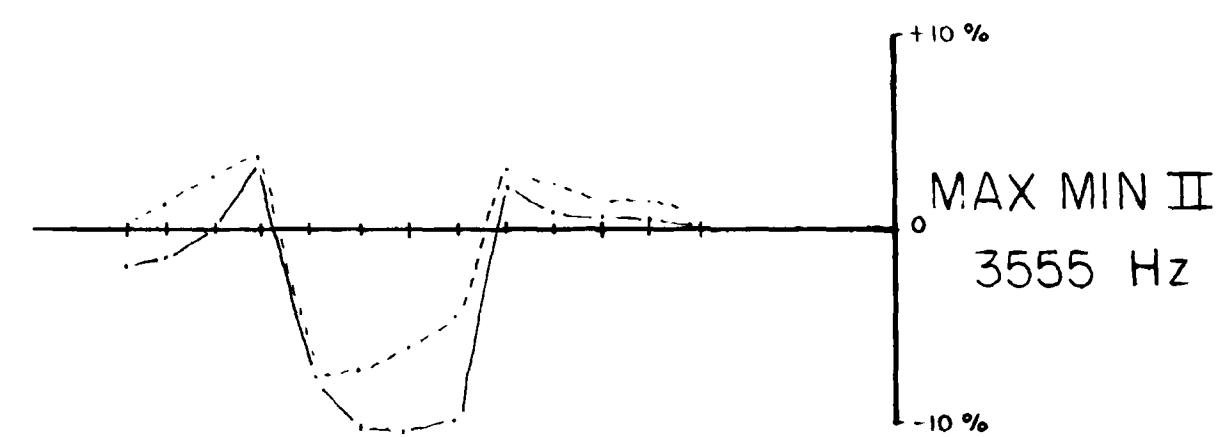

SECTION ALONG LINE 32 W

SCALE: 1" = 400'

WEACO RESOURCES LTD.
VANCOUVER, B.C.

SWAYZE PROJECT, ONT.
NORTH BENTON PROPERTY

HOLE W-86-2

DATE: NOV. 16, 1986

DRAWN BY: E.A.G.

MAP NO. 3



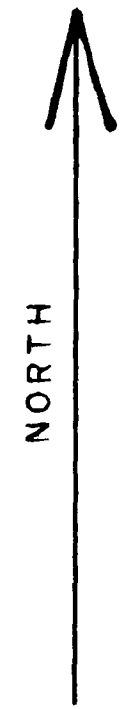

PLAN
SCALE : 1" = 400'

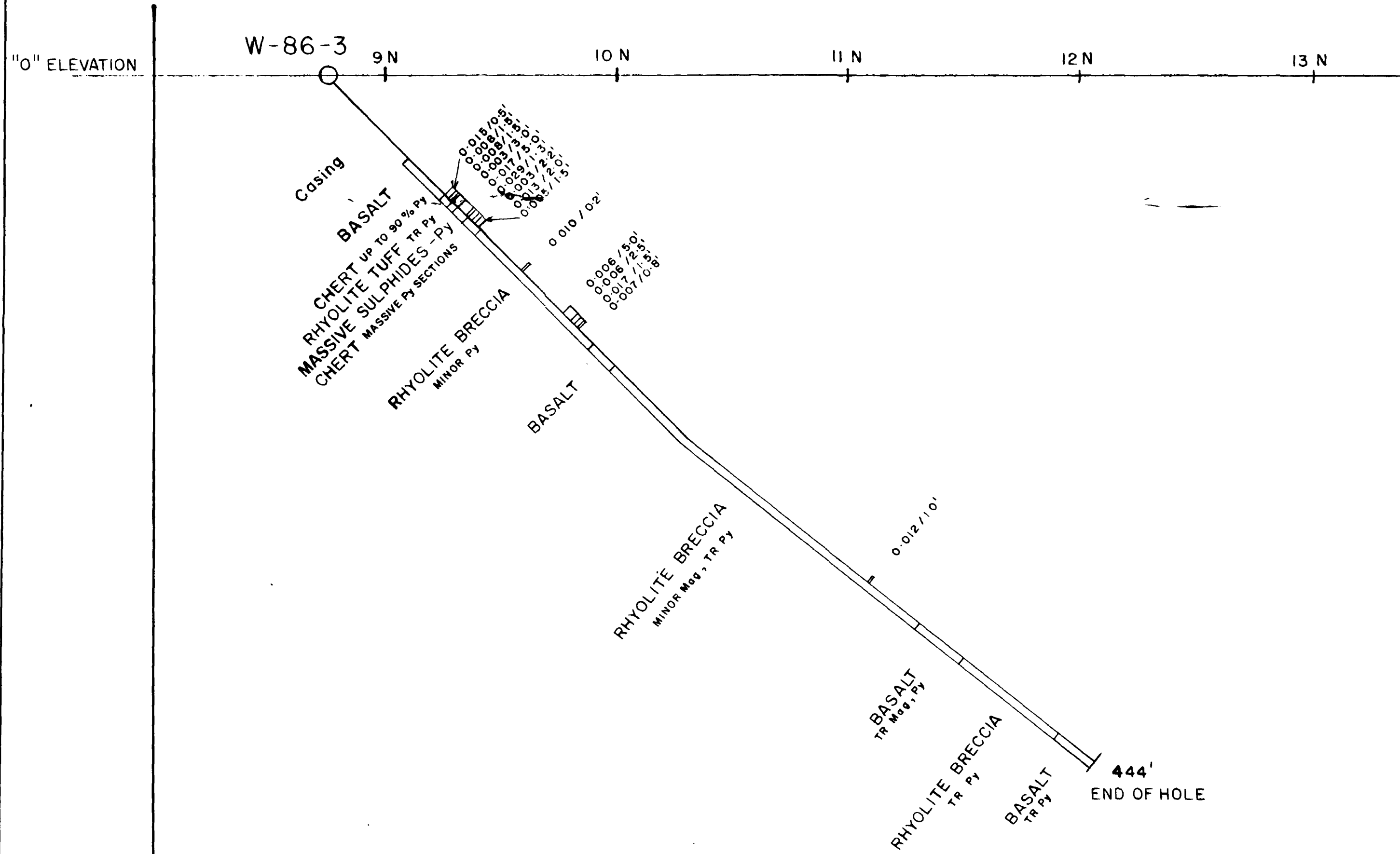
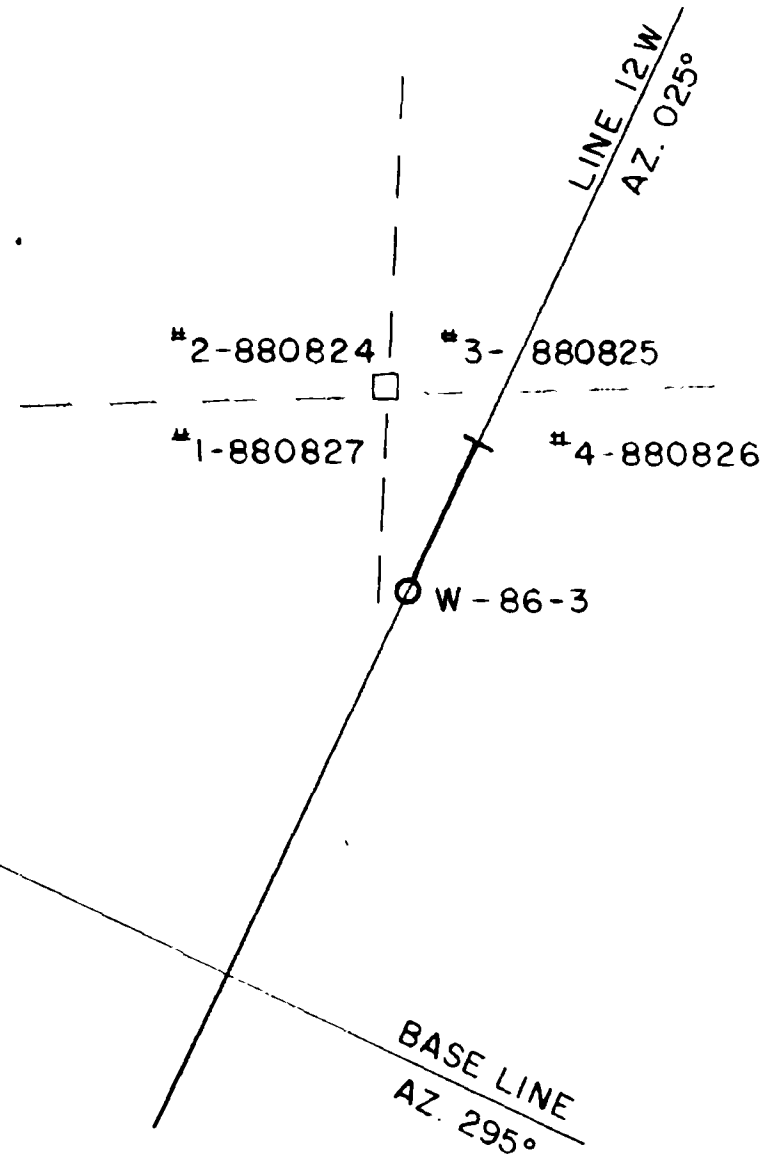

SECTION ALONG LINE 12 W

SCALE : 1" = 40'

ASSAY VALUES IN OZ. Au / Ton

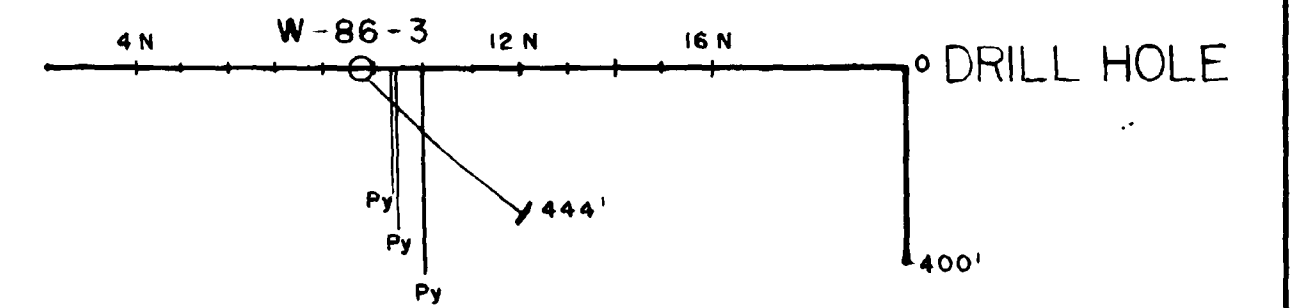
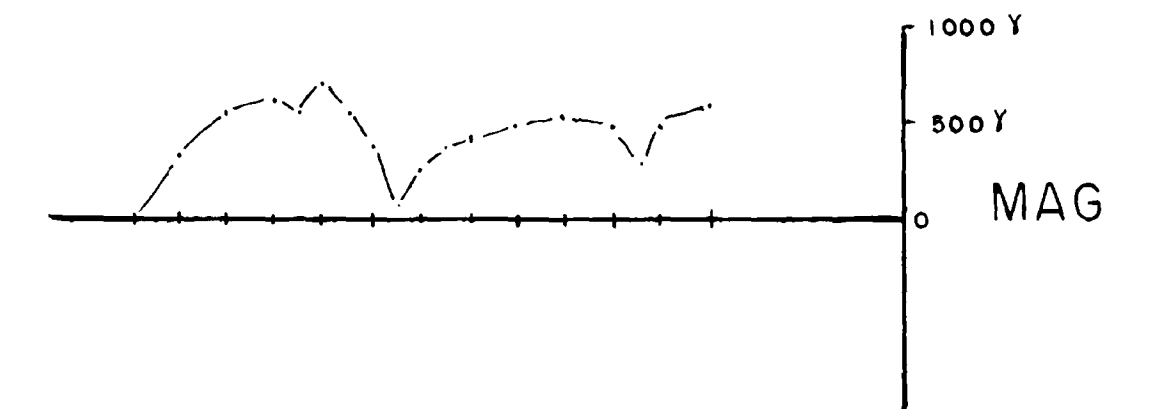
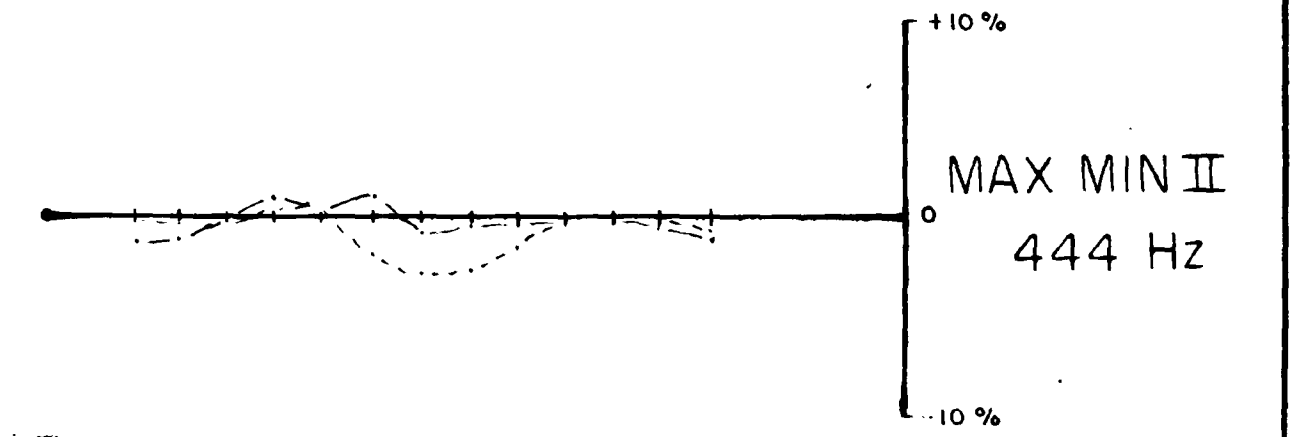
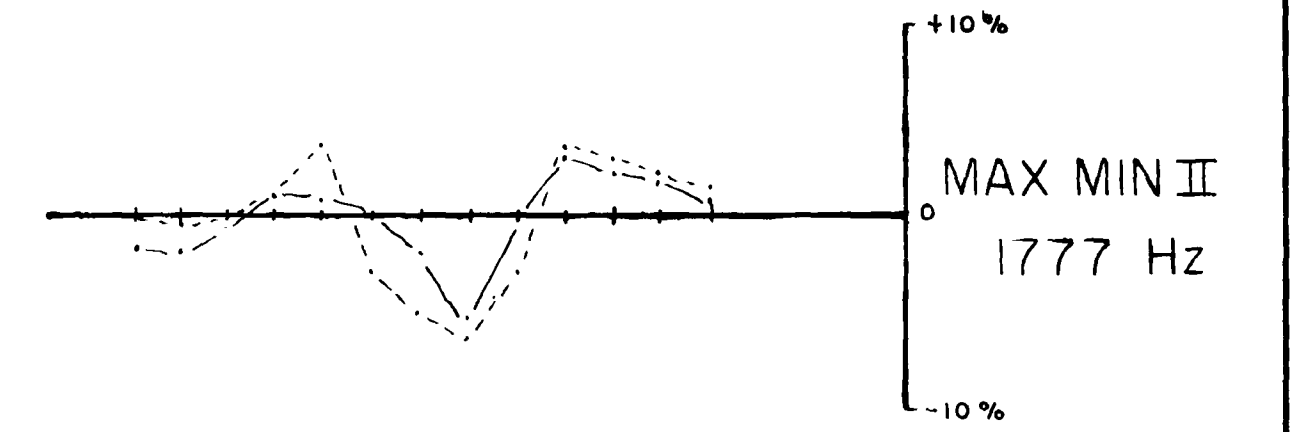
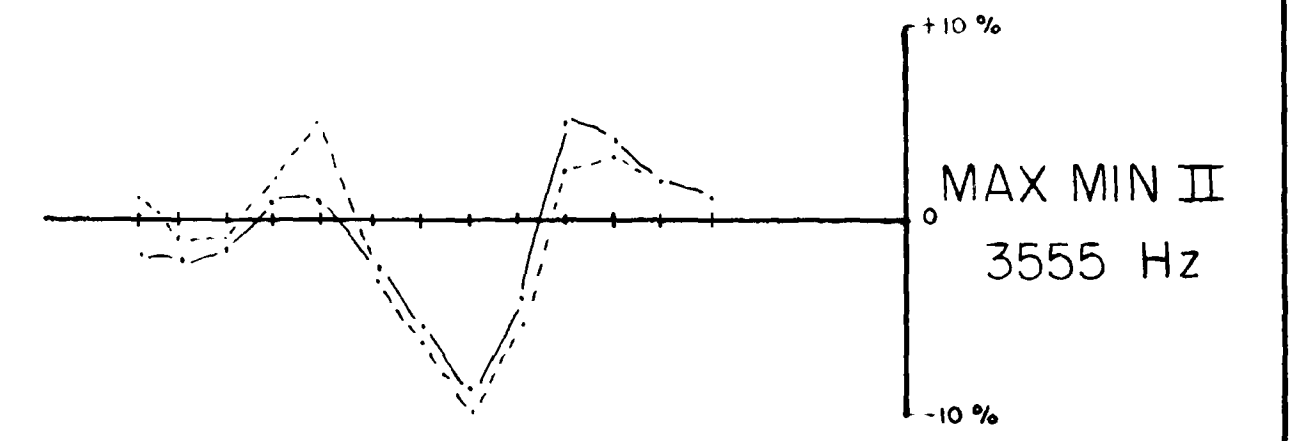

SECTION ALONG LINE 12 W

SCALE : 1" = 400'

WEACO RESOURCES LTD. VANCOUVER, B.C.		
SWAYZE PROJECT, ONT. NORTH BENTON PROPERTY		
HOLE W-86-3		
DATE: NOV. 16, 1986	DRAWN BY: E.A.G.	MAP NO. 4

