



Diamond Drilling

010

Township OF BELFAST

Report No: 11

Work performed by: Obabika Mines Limited

Claim No	Hole No	Footage	Date	Note
T 36547	1	73.0'	Oct/56	
	2	95.0'	Oct/56	
	3	33.0'	Oct/56	
	4	26.0'	Oct/56	
	5	53.0'	Oct/56	
	6	201.0'	Oct/56	
	7	177.0'	Oct/56	
	8	177.0'	Oct/56	
	9	173.0'	Nov/56	
	10	209.0'	Nov/56	
	11	500.0'	Nov/56	
	14	440.0'	Dec/56	
	12	213.0'	Nov/56	
	13	201.0'	Dec/56	
	15	210.0'	Dec/56	
	16	151.0'	Jan/57	

Notes:

Total. 16 DH 2932.0'

DIAMOND DRILL HOLES

OBABIKA MINES LTD

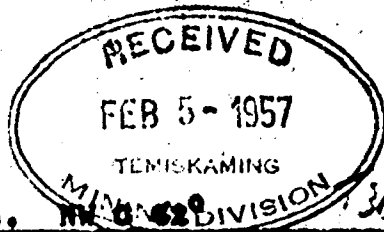

DDH #1 - 7/8" core - N.3650', E.385' more or less. NW @ 52° 36527

FROM	TO	DESCRIPTION
0.0	2.5	GREYWACKE - fine-grained, dark gray, massive.
2.5	7.5	QUARTZITE - fine-grained, pale buff, local bedding @ 35-45
7.5	49.0	GREYWACKE - fine-grained, dark gray, massive, 8" quartz-breccia at 17.5'.
49.0	54.0	QUARTZITE - fine-grained, pale buff, more or less massive, small stringers pink carbonate.
54.0	73.0	GREYWACKE - fine-grained, dark gray, massive to more or less broken up, locally small stringers of pink carbonate. Mostly lost core from 68.0'.
73.0		END OF HOLE

::

DDH #2 - X-ray core - N.2168, E.530. SE @ 55° 36533

0.0	25.0	QUARTZ-VEIN - white quartz, with short sections buff to more or less pink carbonate, locally a little chalcocopyrite.
25.0	62.0	QUARTZ DIABASE - medium to coarse grained, massive.
62.0	72.0	QUARTZ DIABASE - fine-grained, more or less altered, bleaching, sericite and carbonate.
72.0	95.0	QUARTZ DIABASE - mostly medium-grained, massive and unaltered.
95.0		END OF HOLE

::

DDH #3 - 7/8" core - N.2168, E.530. SE @ 45° 36533

0.0	21.0	QUARTZ VEIN - white quartz with short sections buff to pink carbonate, more or less oxidation - 8.0' lost core
21.0	33.0	QUARTZ DIABASE - quite acidio, medium to coarse grained, massive.
33.0		END OF HOLE.

::

DDH #4 - 7/8" core - N. 2160, E. 590. - Vertical 36533

0.0	26.0	Said to be all quartz vein with sections of buff to pink carbonate. (only 1' core received).
26.0		END OF HOLE

::

DDH #5 - 7/8" core - N. 2160, E. 660 - Vertical 36546

0.0	50.0	Mostly chloritic, slightly sheared, diabase with short sections medium to coarse grained altered diabase.
50.0	53.0	QUARTZ VEIN
53.0		END OF HOLE - (hole abandoned).

::

OBABIKA MINES LTD.

DDH #6 - 2000' N, 770' E. Dip Vertical

Start - Oct. 24/56
End - Oct. 29/56

FROM	TO	DESCRIPTION	3556
0.0	10.0	CASING	
10.0	30.0	QUARTZ DIABASE, coarse-grained, massive, unaltered.	
30.0	56.3	QUARTZ DIABASE - more or less sheared (sliced) and altered, with numerous tiny irregular quartz, quartz carbonate and pink carbonates, mostly at around 60° - 70° to core axis, about 70° quartz (gray) from 46.7 to 50.5'	
56.3	85.3	<u>VEIN</u> : some pink carbonate at start changing to white to dark gray quartz at 57.5' with short irregular sections light brown carbonate and few inches red-stained carb.	
85.3	97.6	QUARTZ DIABASE - more or less fine-grained, altered, slightly sheared (squeezed), about 15% quartz and quartz carbonate stringers, some deep red quartz with thin specular hematite in slips at 90' to 90.3'.	
76.6	201.0	QUARTZ DIABASE - coarse-grained, massive, unaltered, contains short sections more or less fine-grained.	
201.0		END OF HOLE.	
<p><u>Note</u>: Core recovery as measured between blocks seems quite good, some evidence of grinding in core barrel, here and there in veins and between 90' to 93'.</p>			

::

DDH #7 - 2100' N, 770' E. Dip Vertical

Start - Oct. 30/56
End - Oct. 31/56

0.0	8.0	CASING	
8.0	25.0	QUARTZ DIABASE - coarse-grained, massive, unaltered, 6" quartz-chlorite-carbonate at 45° at 12.0'.	
25.0	73.7	QUARTZ DIABASE - more or less sheared (squeezed) and altered with numerous small quartz and quartz-carbonate stringers at 50-60° - 2.0' quartz-carbonate at 38.0' to 40.0' more massive fine grained diabase from 40.0' to 50.0' and 60' to 66'. 1.8' white quartz-carbonate at 45 at 51.7' to 53.5'.	
73.7	93.7	<u>VEIN</u> : white to gray quartz - about 10% white to pink carbonate locally some deep red quartz (or carbonate).	
93.7	177.0	QUARTZ DIABASE - slightly sheared (squeezed) at 70° to 95°, thence coarse grained, massive, unaltered, some short more or less fine-grained sections.	
177.0		END OF HOLE.	

::

ORABIKA MINES LTD.

DDH #8 - 2200' N., 770' E. Dip vertical

Start - Oct. 31/56
End - Nov. 2/56

2206

FROM	TO	DESCRIPTION
0.0	15.0	CASING
15.0	92.8	QUARTZ DIABASE - mostly coarse-grained, with some short fine-grained sections, slightly sheared (squeezed) at 70° with tiny irregular quartz stringers from 40' to 55' - 1.5' quartz-carbonate at 70° at 47', 2.1' quartz-carbonate at 64.2', 2.7' white quartz-carbonate at 70', diabase fine-grained, altered, squeezed at 70° more or less from 80' to 92.8' with white pink few small quartz stringers.
92.8	107.0	<u>VEIN:</u> white to gray quartz with white, pink and brown carbonate (8%).
107.0	177.0	QUARTZ DIABASE - fine-grained, slightly sheared and altered to 107.5', thence mostly coarse-grained, massive, unaltered, with some short fine-grained sections.
177.0		END OF HOLE.

::

DDH #9 - 2300' N., 770' E. Dip Vertical

Start - Nov. 3/56
End - Nov. 4/56

2206

0.0	7.0	CASING
7.0	91.8	QUARTZ DIABASE - coarse to medium-grained, massive, unaltered, slightly sheared (squeezed) at 70° - 80° from 140' to 24.0' - 1" quartz-carbonate, pink carbonate at 18.8', massive, unaltered from 24.0' to 44.0' thence slightly sheared (squeezed) at 70-80° to 53.0', 6" white quartz-carbonate at 47.5', a grain of chalcopyrite in massive diabase at 57.4', coarse massive diabase with short fine-grained sections to 74.0', thence slightly sheared at 70° with tiny quartz stringers - 12" gray quartz at 76.8'.
91.8	123.5	<u>VEIN:</u> at 70° - 90% white to dark gray quartz, 2.0' ground core at 100' to 105', 10% white carbonate, numerous tiny fractures with red hematite from 120' to 123.5'.
123.5	173.0	QUARTZ DIABASE - slightly sheared at 60 - 70° and altered, about 15% gray quartz-carbonate stringers to 130', thence mostly coarse-grained, massive, unaltered.
173.0		END OF HOLE.

::

OBABIKA MINES LTD.

DDH. #10 - 2400' N., 770' E. Dip Vertical

Start Nov. 5/56
End Nov. 9/56

Yes

FROM	TO	DESCRIPTION
0.0	10.0	CASING.
10.0	13.8	VEIN: More or less irregular, more or less parallel to core, 50% white quartz, 10% buff carbonate, 40% diabase
13.8	28.0	QUARTZ DIABASE - slightly sheared (squeezed) at 60° and altered with numerous tiny quartz stringers.
28.0	35.2	VEIN: 80% white quartz, 3% carbonate, 17% diabase.
35.2	45.0	QUARTZ DIABASE - slightly sheared (squeezed) at 35-45° and altered, fairly numerous tiny quartz and pink carbonate stringers.
45.0	108.5	QUARTZ DIABASE - more or less fine grained, massive to 55' thence coarse-grained, massive, unaltered, slightly sheared (squeezed) at 70° and altered from 89' to 95' with tiny quartz stringers - 6" quartz carbonate 91.2', 4" at 93.9', massive, unaltered, coarse-grained from 95' to 108.5'.
108.5	115.5	QUARTZ DIABASE - slightly sheared (squeezed) at 60° with irregular quartz stringers.
115.5	139.5	VEIN: 95% white to gray quartz, 5% carbonate.
139.5	209.0	QUARTZ DIABASE - slightly sheared at 70° to 141' - 1.0' lost core 138 to 141', 1' lost core 141 to 143' - from 141' mostly coarse-grained, massive, unaltered; fine-grained, altered with tiny carbonate stringers more or less parallel to core from 181 to 184'.
209.0		END OF HOLE.

:::::::::::::::::::CS:::::::

365

DDH. #11 - 2000' N., 842' E. Az N50°W, dip collar -55°
at 500' - 53°

Start - Nov. 11/56
End - Nov. 22/56

0.0	7.0	CASING.
7.0	8.0	VEIN: 90% quartz - 10% diabase.
8.0	132.0	QUARTZ DIABASE - mostly coarse-grained, massive, unaltered core more or less broken up and blocky. 1.5' lost core 10.0' to 12.0', 0.6' lost core 150' to 17.0'. 4" quartz at 128.7' - squeezed at 70° with small quartz carbonate stringers from 129'.
132.0	153.0	VEIN: mostly all gray to white quartz with short sections squeezed diabase.
153.0	500 (?)	QUARTZ DIABASE - 2.5' lost core 153 to 157', squeezed diabase with quartz-carbonate stringers to 157' thence medium to coarse-grained quartz diabase, all massive, unaltered, short sections fine-grained - 2" quartz-carbonate 186' - 1" carbonate 40° at 193', 1" carbonate 40° at 216' - 3" quartz-carbonate at 40° at 243.3', short fine-grained and very coarse-grained sections, 1" quartz-carbonate at 35° at 461.2'.
500.0 (?)		END OF HOLE.

:::::::::::::::::::

DDH #12

Sample No. 2001 - trace gold, nil copper
" " 2002 - trace gold, .01% copper

OBABIKA MINES LTD.

DDH #14 - 3600' N. 429' E. Az. N36° W. Dip - collar - 50° Start Dec. 6/56
 End Dec. 10/56

FROM	TO	DESCRIPTION
0.0	6.5	CASING
6.5	12.0	GREYWACKE - fine-grained, dark gray, massive.
12.0	17.8	ARKOSE (Quartzite) - fine-grained, pale gray, massive.
17.8	85.7	GREYWACKE - fine-grained, dark gray, massive. Core more or less broken up at 70° from 78' locally with some small irregular quartz-carbonate stringers. 1.8' lost core 83.9 to 85.7.
85.7	104.5	VEIN: 99% white quartz, 1% pink carbonate.
104.5	168.7	GREYWACKE - slightly broken up, few small stringers of pink carbonate to 107', thence fine-grained, dark gray, massive. Several (1'-2') beds of pale arkosic quartzite at 50°, 8" quartz at 60° at 168' to 168.7' beyond which carbonate.
168.7	440.0'	QUARTZ DIABASE - more or less squeezed (sheared) at 60° with tiny irregular quartz-carbonate stringers to 172' thence fine-grained, grading at 175 into medium to coarse-grained (more or less) massive, unaltered. 8" quartz-carbonate at 35° at 191.5. Quite fine-grained from 212.5' to 226.5' with some coarse-grained inclusions, fairly sharp contacts at 50°, some fine-grained sections from 275'. Squeezed (sheared) at 50° with tiny quartz-carbonate stringers from 275' to 278'. 2" Quartz at 70° at 310', several tiny quartz-carbonate stringers at 60° at 316.5' to 317.5' - 1" quartz-carbonate at 60° at 420'.
440.0		END OF HOLE

Lost hole due to cave - no cement.

::

DDH #12 - 2800' N, 900' E. Vertical Start - Nov. 25/56
 End - Nov. 29/56

0.0	0.0	CASING
0.0	155.0	QUARTZ DIABASE - coarse to medium-grained, massive, unaltered, with short fine-grained sections with more or less sharply gradational contacts. Core more or less highly broken up (squeezed at 70°) with tiny quartz-carbonate stringers from 51' to 65' - 2" lost core at 51' to 54', 2.0 at 56' to 60', broken up at 76' to 77', more or less broken up at 70° at 138' to 142' with small quartz stringers, more or less squeezed at 70° at 153' to 155'.
155.0	168.0	VEIN: mostly gray to white quartz, about 5% carbonate and altered diabase.
168.0	168.9 2.9 2001	VRIN: 5% chloritic inclusion, 2% carbonate - a little pyrite.
168.9	183.7	VEIN: gray to white quartz - 3% carbonate.
183.7	202.0	QUARTZ DIABASE - more or less altered, locally squeezed at 70° with small irregular quartz-carbonate stringers
202.0	204.5 2.5 2002	60% irregular white quartz and pink carbonate, 40% chloritic diabase. 1/4" grain chalcopyrite in 1" quartz carbonate at 204.5'.

12/25/56

OBABIKA MINES LTD.

Hole #12 cont'd.

FROM	TO	DESCRIPTION
804.5	813.0	QUARTZ DIABASE - squeezed at 70° to 208', thence coarse-grained, massive, unaltered.
813.0		END OF HOLE. Lost core barrel, bit, etc. in hole - abandoned.

::

DDH #13 - 3200' N., 862' E. Vertical Start Dec. 1/56 36547
 End Dec. 4/56

0.0	10.0	CASING.
10.0	97.2	QUARTZ DIABASE - coarse to medium grained, with some short fine-grained sections, massive, unaltered. 3" quartz-carbonate at 70° at 60', 9" carbonate 68', 1" at 78'. Diabase more or less squeezed at 70° (broken up) from 93' to 97.2' with small quartz-carbonate stringers.
97.2	120.3	VEIN: 70% white quartz, 20% buff carbonate (about 80% of section from 105' to 109'), 10% chloritic diabase.
120.3	201.0	QUARTZ DIABASE - more or less squeezed at 70° and altered to 122' with small quartz-carbonate stringers thence mostly more or less coarse-grained, massive, unaltered.
201.0		END OF HOLE.

::

DDH #15 - 2000' N., 950' E. Vertical Start - Dec. 14/56 31226
 End - Dec. 16/56

0.0	5.0	CASING
5.0	131.0	QUARTZ DIABASE - mostly medium grained, massive, unaltered, more or less broken up from 60' to 65' - 1" quartz-carbonate at 86', core more or less broken up (slightly squeezed at 60°) from 117.5' with 20% irregular quartz-pink carbonate stringers.
131.0	157.0	VEIN: 75% gray quartz - 20% pink and white carbonate 5% chloritic diabase.
157.0	164.0	QUARTZ DIABASE - (squeezed at 70°) more or less broken up 15% irregular quartz carbonate stringers.
164.0	177.0	VEIN: (20% core lost) 60% white to gray quartz, 10% pink carbonate, 30% broken up diabase.
177.0	210.0	QUARTZ DIABASE - medium to coarse-grained, massive, unaltered.
210.0		END OF HOLE.

::

OBABIKA MINES LIMITED

DDH #16 - 1771'N. 900'E. Dip - vertical

Start - Jan. 6, 1957
End - Jan. 8, 1957

From	To	Description
0.0	12.0	Casing
12.0	115.0	quartz diabase - mostly medium-grained, massive, unaltered; 12' very coarse-grained, epidotic, 28.0'; red iron oxide on joints from 85' to 88'; about 50% irregular white quartz with pink carbonate and red iron oxide from 107.5' to 115.0'.
115.0	148.7	<u>Vein</u> - 80% white to dark gray quartz, 15% buff carbonate, 5% slightly sheared and altered (chloritic) diabase, locally seams of pink carbonate and of red iron oxide.
148.7	151.0	quartz diabase - fine-grained, slightly sheared (?) ~ 50° to core axis, 20% irregular quartz stringers with some buff carbonate and red iron oxide.
151.0		END OF HOLE

26516

.....

D. Drilling done 1956
Cl. 36546

OBABIKA MINES

Log by L. J. Cunningham

Hole No. 6 - vertical

0 - 11 - Ca sing

11 - 28 Diabase, coarse to medium grain

28 - 48 Sheared diabase - 30 degree/core

48 - 93 Qtz. carb. - zone

partially leached - diabase inclusions

no chalco visible

93 - 101 Sheared db

101 - 200 diabase, generally coarse- some fine grain sections

Hole No. 7 - 100 ft N. 40 E of No. 6-vertical

0 - 9' - Casing

9-- 23 - Diabase - med. to f.g.

23 - 38 - Sheared diabase

much qtz.carb. in minor irregular fractures, approx.

normal T/core, no mineral.

38 - 41 - Qtz. carb Breccia

41 - 70 - Sheared diabase with 2' Qtz. at 52-54

70 - 94 - Qtz. carb. zone, no mineral.

sheared inclusions showing hematite 60 deg/core

94 - 177 - Diabase- coarse to med. gr.

End of Hole.

I a

OBABIKA MINES

Hole No. 8 - 100ft. N.40E of #7. Vertical.

0 - 15 - Casing

15 - 59 - Diabase, coarse - some f.g.sections - several
narrow Qtz.-carb. sections

59 - 92 - Sheared db - 45 deg/core
contains much carb. in shearing with Qtz. carb.
as follows: 65-67; 70-73.

92 - 106 - Qtz. carb. zone - Barren - some brick
red feldspar

106 - 179 - Med. gr. diabase

Hole No. 9 - 100 ft. N 40 E of No. 8. Vertical.

0 - 7 - Casing

7 - 44 Diabase - ,F.G. to med.

44 - 52 - Sheared diabase, normal to core, whitish grey

52 - 72 - Diabase- f.g. to med.

72 - 90 - Sheared db. grey white some Qtz. inclusions

90 - 123 - Qtz. carb. zones of which bottom 10' blue qtz. no mineral.

123 - 130 - Sheared - 60/core - some qtz.

130 - 173 - db- f.g. to med.

End of Hole.

Tr

OBABIKA MINES

Hole No. 10 - 100 ft. N-40-E of No. 9

0 - 10 - Ca sing

10 - 45 - Sheared db - 60 deg./core

Qtz. carb. inclusion as follows: 10-14; 27-36;

45 - 89 - db. Med. to f.g.

89 - 96 - Sheared db - 2 sections - 6" each of Qtz. carb.

96 - 109 - db. med. gr.

109 - 115 - Sheared db. - 60 deg./core

115 - 139 - Qtz.-carb. zone- with little carb

and both sections of Qtz. blue.

139 - 153 - db. med. to coarse.

Hole continuing to 300 feet.

N(AST)

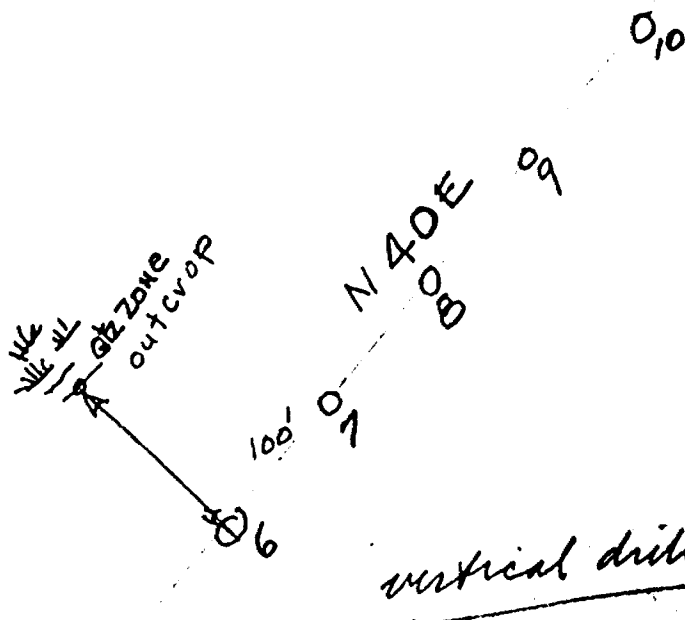

19

OBABIKA MINES, Ltd.

Belfast Township

D. Range

SUMMARY OF DRILLING

Claim No.	Hole No.	Core Size	Location		Bearing	Dip	Length
			North	East			
T-36546	5	EX	2160	660		Vert	53
"	6	AX	2000	770		Vert	201
"	7	AX	2100	770		Vert	177
"	8	AX	2200	770		Vert	177
"	9	AX	2300	770		Vert	173
"	10	AX	2400	770		Vert	209
"	11	AX	2600	842	N56°W	-55°	500
"	12	AX	2800	900		Vert	213
"	15	AX	2000	950		Vert	210
"	16	AX	1771	900		Vert	151
							<u>2064'</u>
T-36547	1	EX	3650	385	N56°W	-62°	73
"	13	AX	3200	862		Vert	201
"	14	AX	3600	429	N56°W	-50°	440
							<u>714'</u>
T-36533	2	X-RAY	2168	530	856°E	-55°	95
							= 47 (for assessment purposes)
"	3	EX	2168	530	856°E	-45°	33
"	4	EX	2160	590		Vert	26
							<u>106'</u>
							<u>2884'</u>

ASSESSMENT WORK

Rec'd from Mining Recorder

Harley Gury

Date Feb. 7/57 W.J.

Resident Geologist



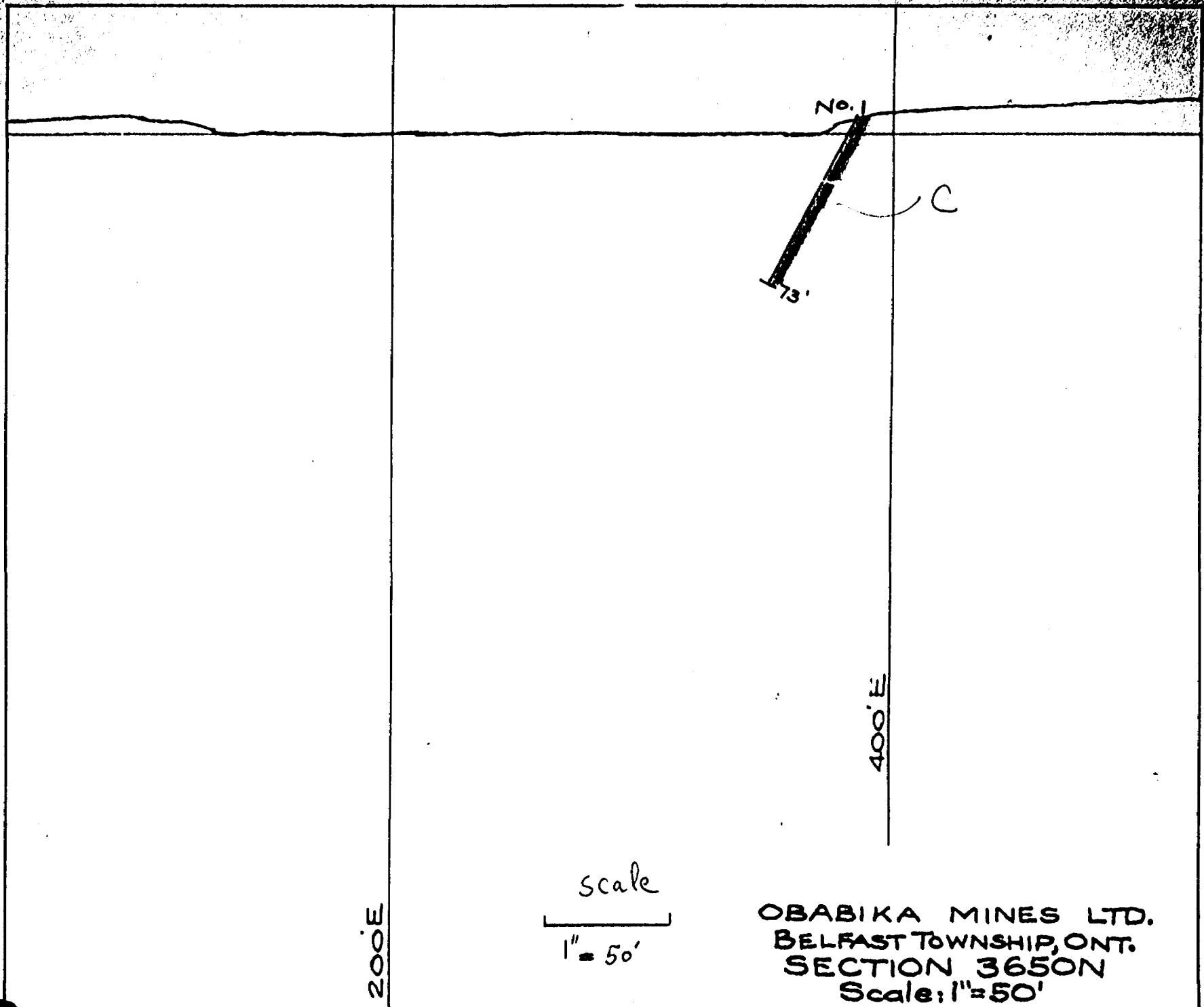

200'E

400'E

No. 1

73'

C

scale
1" = 50'

OBABIKA MINES LTD.
BELFAST TOWNSHIP, ONT.
SECTION 3650N
Scale: 1" = 50'

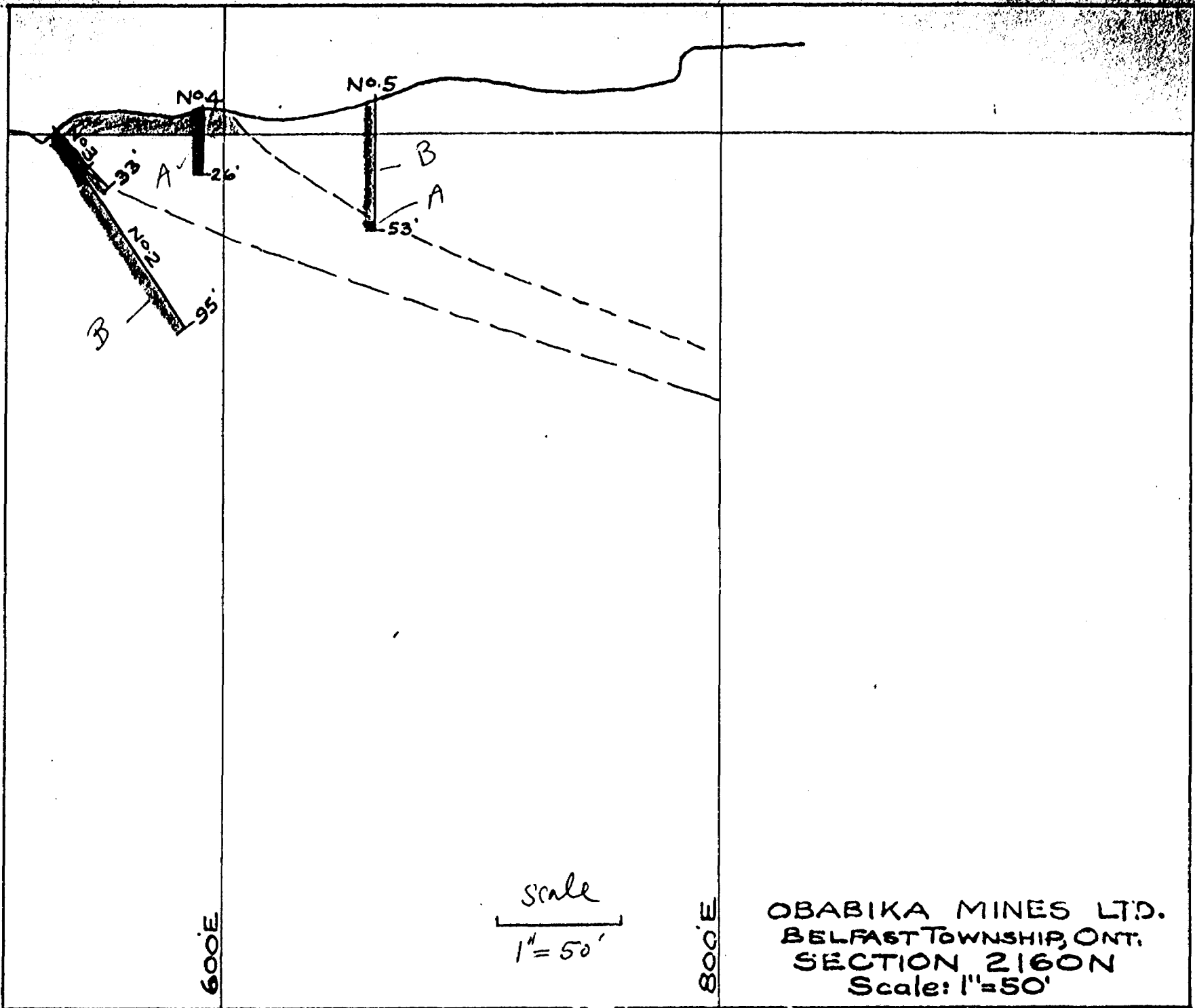

600'E



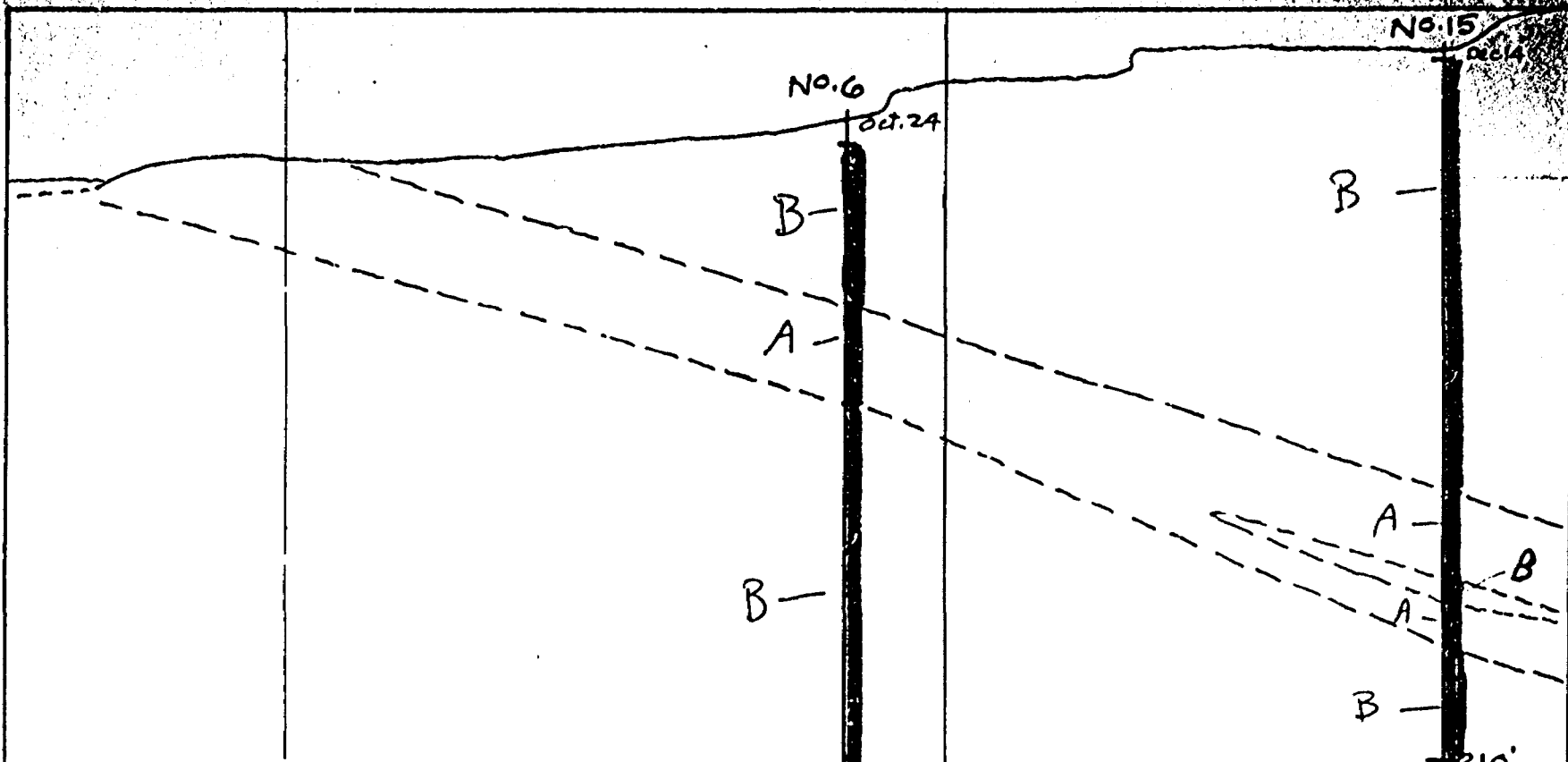

800'E

Scale
1" = 50'

OBABIKA MINES LTD.
BELFAST TOWNSHIP, ONT.
SECTION 2160N
Scale: 1" = 50'



LEGEND

- A  vein material, mostly quartz
KEWEENAWAN
- B  Nipissing quartz diabase
HURONIAN
- C  Cobalt Series, greywacke,
arkose, conglomerate
-  shearing & fracturing

600 E

Scale
1" = 50'

800 W

OBABIKA MINES LTD.
BELFAST TOWNSHIP, ONT.
SECTION 2000N
Scale: 1" = 50'