

Amendment.

2.18907

## Work Report

Claim # 1223134  
 Belfast Twp, Nip. District  
 Client # 101082

12 Sept. 1996 - exploratory work, sampler  
 assayed - claim staked and recorded.

07 June 1997 - quartz vein striggled  
 and explored. Checked trenches  
 where exploratory work done in  
 1930s

05 July 1997 - work on cleaning old  
 trenches, clean vein and follow.

03 Sep. 1998 - drilling + blasting in vein  
 area, clean + collect sampler for assay

Expenses incurred for meals and  
 travel expenses for vehicle, boat +  
 motor

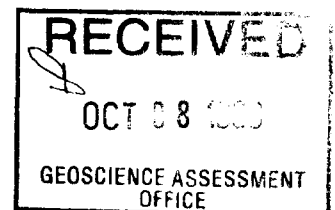

41P01SE2001 2.18907 BELFAST

010

# Work Report

Claim # 1223134  
Belfast Twp, Nip. District  
Client # 101082

Sept. 1996 - exploratory work, sampler assayed - claim staked and recorded.

June 1997 - quartz vein stripped and explored. Checked trenches where exploratory work done in 1930s

July 1997 - work on cleaning old trenches, clean vein and follow.

Sept. 1998 - drilling + blasting in vein area, clean + collect sampler for assay

Expenses incurred for meals and travel expenses for vehicle, boat + motor

2.18907



Le Roche Twp.

scale  
1-5000

Twp. Line

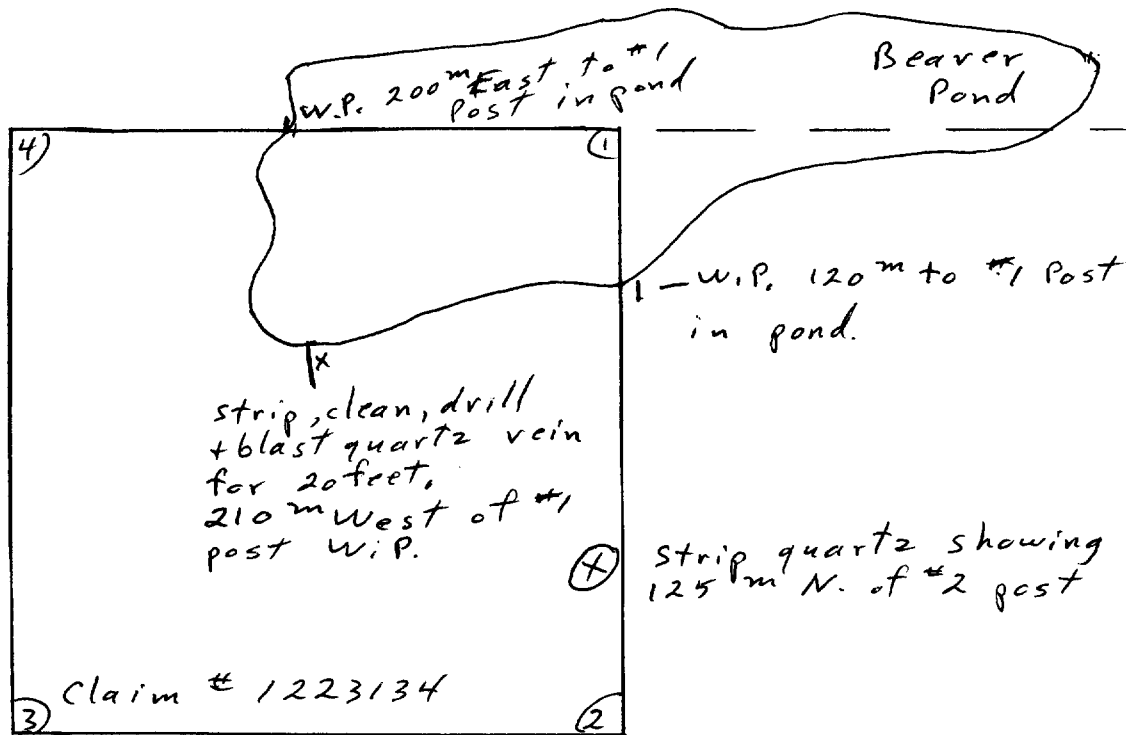

Belfast Twp

Nipissing District.



Established 1928

# Swastika Laboratories

A Division of TSL/Assayers Inc.

Assaying - Consulting - Representation

2.18907

8W-2667-RA1

## Assay Certificate

Company: **R. COMSTOCK**

Date: SEP-15-98

Project:

Att: R. Comstock

We hereby certify the following Assay of 1 Rock samples submitted SEP-09-98 by .

Sample Number	Au oz/ton	Multi Element
No #	0.022	Results to follow

One assay ton portion used.

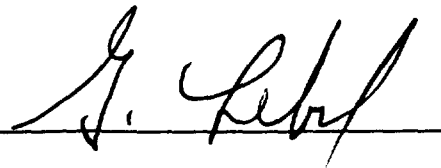
Certified by 

**L. COMSTOCK**

Attention: R. Comstock

1 Cameron Ave., Middletown, CT 06457  
 PHONE (705) 642-3244 FAX (705) 642-3300

**MULTI-ELEMENT ICP ANALYSIS**  
 Aqua Regia Digestion

Sample Number	Ag ppm	Al %	As ppm	Ba ppm	Be ppm	Bi ppm	Ca %	Cd ppm	Co ppm	Cr ppm	Cu ppm	Fe %	K %	Mg %	Mn ppm	Mo ppm	Na %	Ni ppm	P ppm	Pb ppm	Sb ppm	Sc ppm	Sn ppm	Sr ppm	Ti %	V ppm	W ppm	Y ppm	Zn ppm	Zr ppm
No #	40.2	0.36	20	10	<0.5	175	4.43	22	21	416	2940	2.16	0.02	1.80	555	4	0.02	92	90	4874	5	1	<10	16	0.01	14	<10	2	2179	2

2.18902

A 5 gm sample is digested with 10 ml 3:1 HCl/HNO3 at 95C for 2 hours and diluted to 25ml with D.I.H2O.

Signed: 

ZONE 17

119 74 801270

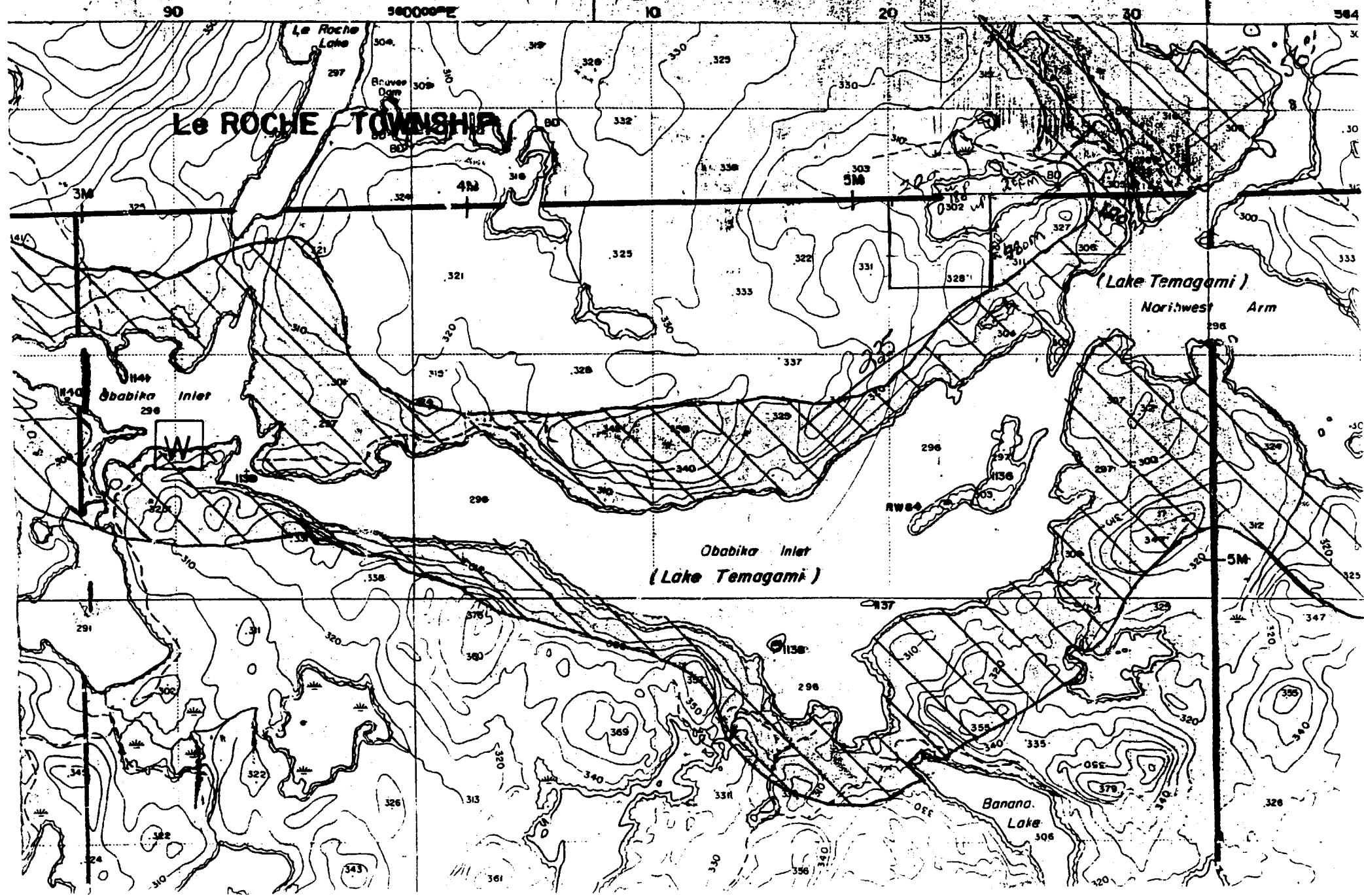

2.18902

Scale 1-5000

LeRoche Twp.

Twp. Line

Belfast Twp.  
Nipissing District

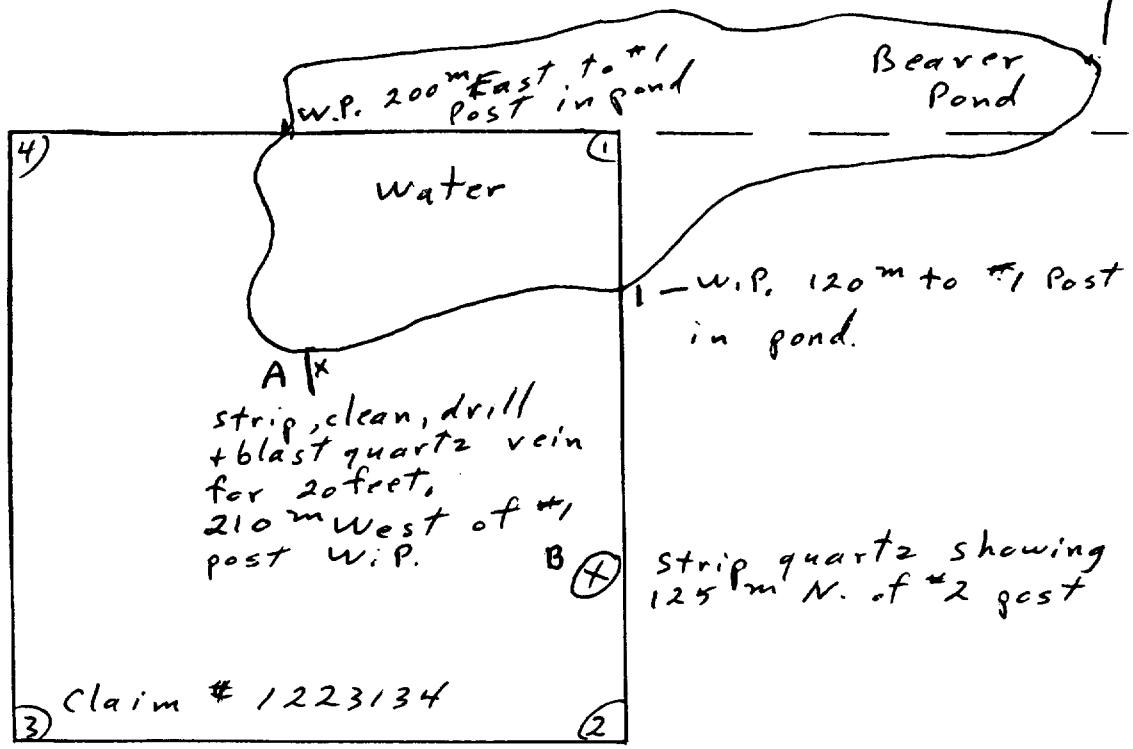

A - enlarged

B - enlarged

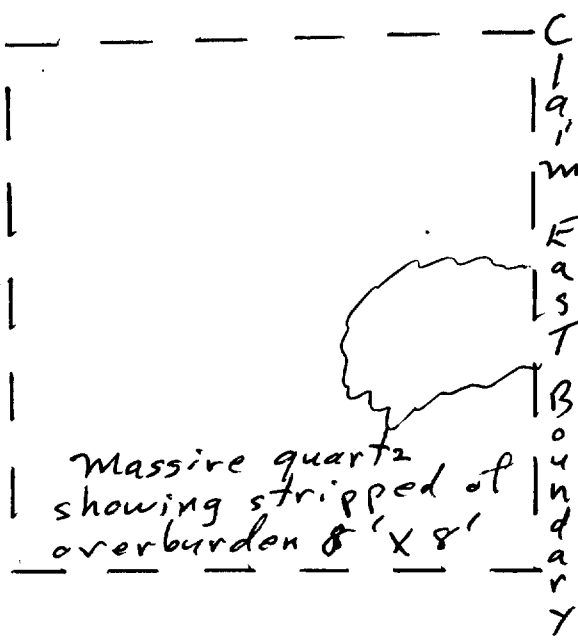
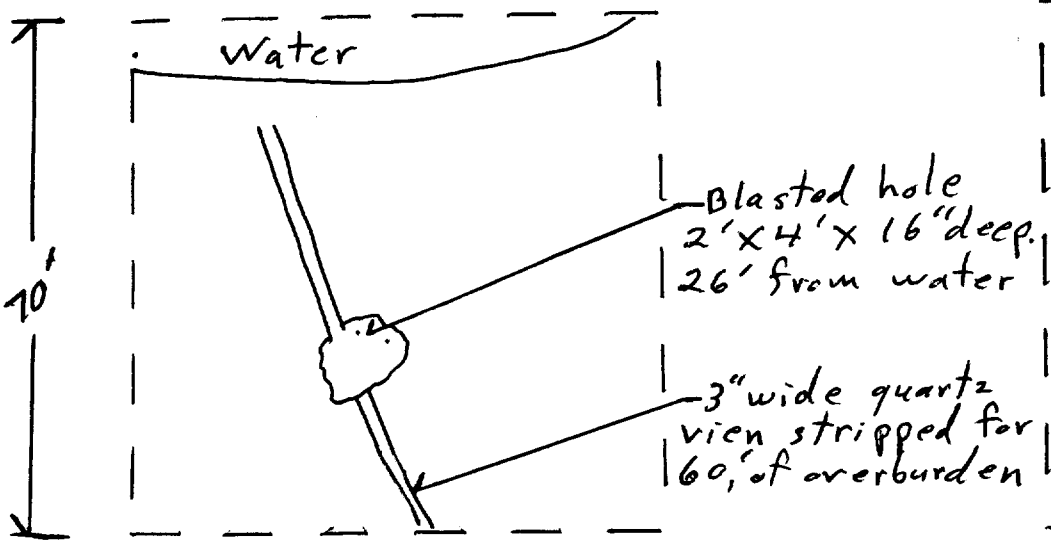

Sample from hole assayed.  
Results (attached) indicates  
mineralization of site.

**RECEIVED**

DEC 18 1993

11.65

GEOSCIENCE ASSESSMENT  
OFFICE



Ministry of Northern Development and Mines

**Declaration of Assessment Work Performed on Mining Land**

Mining Act, Subsection 85(2) and 86(3), R.S.O. 1990

Transaction Number (office use) <b>WAB90-00560</b>
Assessment File Research Imaging

copy of subsections 85(2) and 86(3) of the Mining Act. Under section 8 of the Act to review the assessment work and correspond with the mining land holder. Mining Recorder, Ministry of Northern Development and Mines, 6th Floor.



41P01SE2001 2.18907 BELFAST

900

before recording a claim, use form 0240.

*Amendment*

**2.18907**

**1. Recorded holder(s) (Attach a list if necessary)**

Name <b>A.W. ADAIR</b>	Client Number <b>C 37234 101082</b>
Address <b>Box 225</b>	Telephone Number <b>705-569-3319</b>
<b>Temagami, Ont. P0H2H0</b>	Fax Number
Name	Client Number
Address	Telephone Number
	Fax Number

**2. Type of work performed: Check (✓) and report on only ONE of the following groups for this declaration.**

Geotechnical: prospecting, surveys, assays and work under section 18 (regs)     Physical: drilling, stripping, trenching and associated assays     Rehabilitation

Work Type <b>Striping, trenching assay</b>	Office Use
	Commodity
	Total \$ Value of Work Claimed: <b>863</b>
Dates Work Performed From <b>12 May 97</b> To <b>03 Sep 98</b>	NTS Reference
Global Positioning System Data (if available)	Mining Division <b>Sudbury</b>
Township/Area <b>Belfast Twp.</b>	Resident Geologist District <b>Sudbury</b>
M or G-Plan Number <b>G 3408</b>	

Please remember to: - obtain a work permit from the Ministry of Natural Resources as required;  
- provide proper notice to surface rights holders before starting work;  
- complete and attach a Statement of Costs, form 0212;  
- provide a map showing contiguous mining lands that are linked for assigning work;  
- include two copies of your technical report.

**3. Person or companies who prepared the technical report (Attach a list if necessary)**

Name	Telephone Number
Address	Fax Number
Name	Telephone Number
Address	Fax Number
Name	Telephone Number
Address	Fax Number

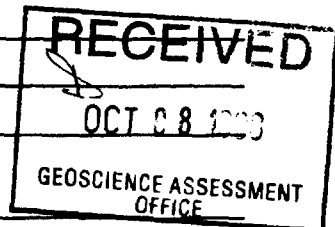

**4. Certification by Recorded Holder or Agent**

I, **A. W. ADAIR** (Print Name), do hereby certify that I have personal knowledge of the facts set forth in this Declaration of Assessment Work having caused the work to be performed or witnessed the same during or after its completion and, to the best of my knowledge, the annexed report is true.

Signature of Recorded Holder or Agent <i>[Signature]</i>	Date <b>Oct 1/98</b>
Agent's Address <b>Box 225, Temagami</b>	Telephone Number <b>705-569-3319</b>
	Fax Number

OCT 08 '98 10:01

*Declaration of Assessment Work*

PAGE: 02

Address

Fax Number

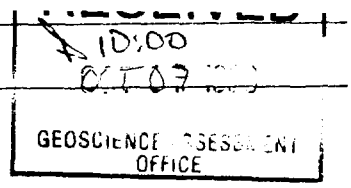

**4. Certification by Recorded Holder or Agent**

I, **A. W. ADAIR** (Print Name), do hereby certify that I have personal knowledge of the facts set forth in this Declaration of Assessment Work having caused the work to be performed or witnessed the same during or after its completion and, to the best of my knowledge, the annexed report is true.

Signature of Recorded Holder or Agent <i>[Signature]</i>	Date <b>Oct 1/98</b>
Agent's Address <b>Box 225, Temagami</b>	Telephone Number <b>705-569-3319</b>
	Fax Number



5. Work to be recorded and distributed. Work can only be assigned to claims that are contiguous (adjoining) to the mining land where work was performed, at the time work was performed. A map showing the contiguous link must accompany this form.

W9870.00560

Mining Claim Number. Or if work was done on other eligible mining land, show in this column the location number indicated on the claim map.	Number of Claim Units. For other mining land, list hectares.	Value of work performed on this claim or other mining land.	Value of work applied to this claim.	Value of work assigned to other mining claims.	Bank. Value of work to be distributed at a future date.
eg TB 7827	16 ha	\$26,825	N/A	\$24,000	\$2,825
eg 1234567	12	0	\$24,000	0	0
eg 1234568	2	\$8,892	\$4,000	0	\$4,892
1 1223134	1	863.00	400	0	463.00
2					
3					
4					
5					
6					
7					
8					
9					
10					
11					
12					
13					
14					
15					
Column Totals					

I, A. Wayne ADAIR (Print Full Name), do hereby certify that the above work credits are eligible under subsection 7 (1) of the Assessment Work Regulation 6/96 for assignment to contiguous claims or for application to the claim where the work was done.

Signature of Recorded Holder or Agent Authorized in Writing: [Signature] Date: 01 Oct 98

6. Instructions for cutting back credits that are not approved.

Some of the credits claimed in this declaration may be cut back. Please check (✓) in the boxes below to show how you wish to prioritize the deletion of credits:

- 1. Credits are to be cut back from the Bank first, followed by option 2 or 3 or 4 as indicated.
- 2. Credits are to be cut back starting with the claims listed last, working backwards; or
- 3. Credits are to be cut back equally over all claims listed in this declaration; or
- 4. Credits are to be cut back as prioritized on the attached appendix or as follows (describe):

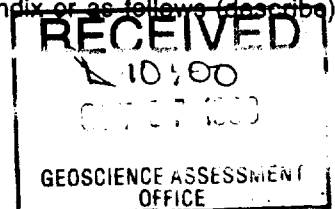

Note: If you have not indicated how your credits are to be deleted, credits will be cut back from the Bank first, followed by option number 2 if necessary.

For Office Use Only

Received Stamp	Deemed Approved Date	Date Notification Sent
	Date Approved	Total Value of Credit Approved
Approved for Recording by Mining Recorder (Signature)		

Personal information collected on this form is obtained under the authority of subsection 6(1) of the Assessment Work Regulation 6/96. Under section 6 of the Mining Act, the information is a public record. This information will be used to review the assessment work and correspond with the mining land holder. Questions about this collection should be directed to the Chief Mining Recorder, Ministry of Northern Development and Mines, 6th Floor, 933 Ramsey Lake Road, Sudbury, Ontario, P3E 6B5.

2.18907

Work Type	Units of Work <small>Depending on the type of work, list the number of hours/days worked, metres of drilling, kilometres of grid line, number of samples, etc.</small>	Cost Per Unit of work	Total Cost
Trenching	5 days	\$150.00 per day	\$750.00
Drill and blast			
Assay			\$42.00 <del>42.00</del>
<b>Associated Costs (e.g. supplies, mobilization and demobilization).</b>			
<b>Transportation Costs</b>			\$37.00
<b>Food and Lodging Costs</b>			\$34.00
<b>Total Value of Assessment Work</b>			<b>863.00</b>

**Calculations of Filing Discounts:**

- 1. Work filed within two years of performance is claimed at 100% of the above Total Value of Assessment Work.
- 2. If work is filed after two years and up to five years after performance, it can only be claimed at 50% of the Total Value of Assessment Work. If this situation applies to your claims, use the calculation below:

TOTAL VALUE OF ASSESSMENT WORK  $\times$  0.50 = Total \$ value of worked claimed.

**Note:**

- Work older than 5 years is not eligible for credit.
- A recorded holder may be required to verify expenditures claimed in this statement of costs within 45 days of a request for verification and/or correction/clarification. If verification and/or correction/clarification is not provided the Minister may reject all or part of the assessment work submitted.

RECEIVED  
10:00  
OCT 27 1998  
GEOSCIENCE ASSESSMENT OFFICE

**Certification verifying costs:**

I, A. Wayne ADAIR (please print full name), do hereby certify, that the amounts shown are as accurate as may reasonably be determined and the costs were incurred while conducting assessment work on the lands indicated on the accompanying Declaration of Work form as Recorded holder (recorded holder, agent, or state company position with signing authority) I am authorized to make this certification.

Signature: A. Wayner Date: 01 Oct 98

Geoscience Assessment Office  
933 Ramsey Lake Road  
6th Floor  
Sudbury, Ontario  
P3E 6B5

Telephone: (888) 415-9846  
Fax: (877) 670-1555

December 22, 1998

ALAN WAYNE ADAIR  
BOX 225  
TEMAGAMI, ONTARIO  
P0H-2H0

Visit our website at:  
[www.gov.on.ca/MNDM/MINES/LANDS/mlsmnpge.htm](http://www.gov.on.ca/MNDM/MINES/LANDS/mlsmnpge.htm)

Dear Sir or Madam:

**Submission Number:** 2.18907

**Status**

**Subject: Transaction Number(s):** W9870.00560 Approval After Notice

---

We have reviewed your Assessment Work submission with the above noted Transaction Number(s). The attached summary page(s) indicate the results of the review. **WE RECOMMEND YOU READ THIS SUMMARY FOR THE DETAILS PERTAINING TO YOUR ASSESSMENT WORK.**

If the status for a transaction is a 45 Day Notice, the summary will outline the reasons for the notice, and any steps you can take to remedy deficiencies. The 90-day deemed approval provision, subsection 6(7) of the Assessment Work Regulation, will no longer be in effect for assessment work which has received a 45 Day Notice. Allowable changes to your credit distribution can be made by contacting the Geoscience Assessment Office within this 45 Day period, otherwise assessment credit will be cut back and distributed as outlined in Section #6 of the Declaration of Assessment work form.

Please note any revisions must be submitted in **DUPLICATE** to the Geoscience Assessment Office, by the response date on the summary.

If you have any questions regarding this correspondence, please contact Steve Beneteau by e-mail at [steven.beneteau@ndm.gov.on.ca](mailto:steven.beneteau@ndm.gov.on.ca) or by telephone at (705) 670-5855.

Yours sincerely,



ORIGINAL SIGNED BY  
Blair Kite  
Supervisor, Geoscience Assessment Office  
Mining Lands Section

# Work Report Assessment Results

---

**Submission Number:** 2.18907

**Date Correspondence Sent:** December 22, 1998

**Assessor:** Steve Beneteau

---

<b>Transaction Number</b>	<b>First Claim Number</b>	<b>Township(s) / Area(s)</b>	<b>Status</b>	<b>Approval Date</b>
W9870.00560	1223134	BELFAST	Approval After Notice	December 20, 1998

**Section:**

10 Physical PSTRIP  
10 Physical PTRNCH

All deficiencies associated with this submission have been corrected. Accordingly, assessment work credit has been approved as outlined on the Report of Work form accompanying this submission.

**Correspondence to:**

Resident Geologist  
Sudbury, ON

**Recorded Holder(s) and/or Agent(s):**

ALAN WAYNE ADAIR  
TEMAGAMI, ONTARIO

Assessment Files Library  
Sudbury, ON

---

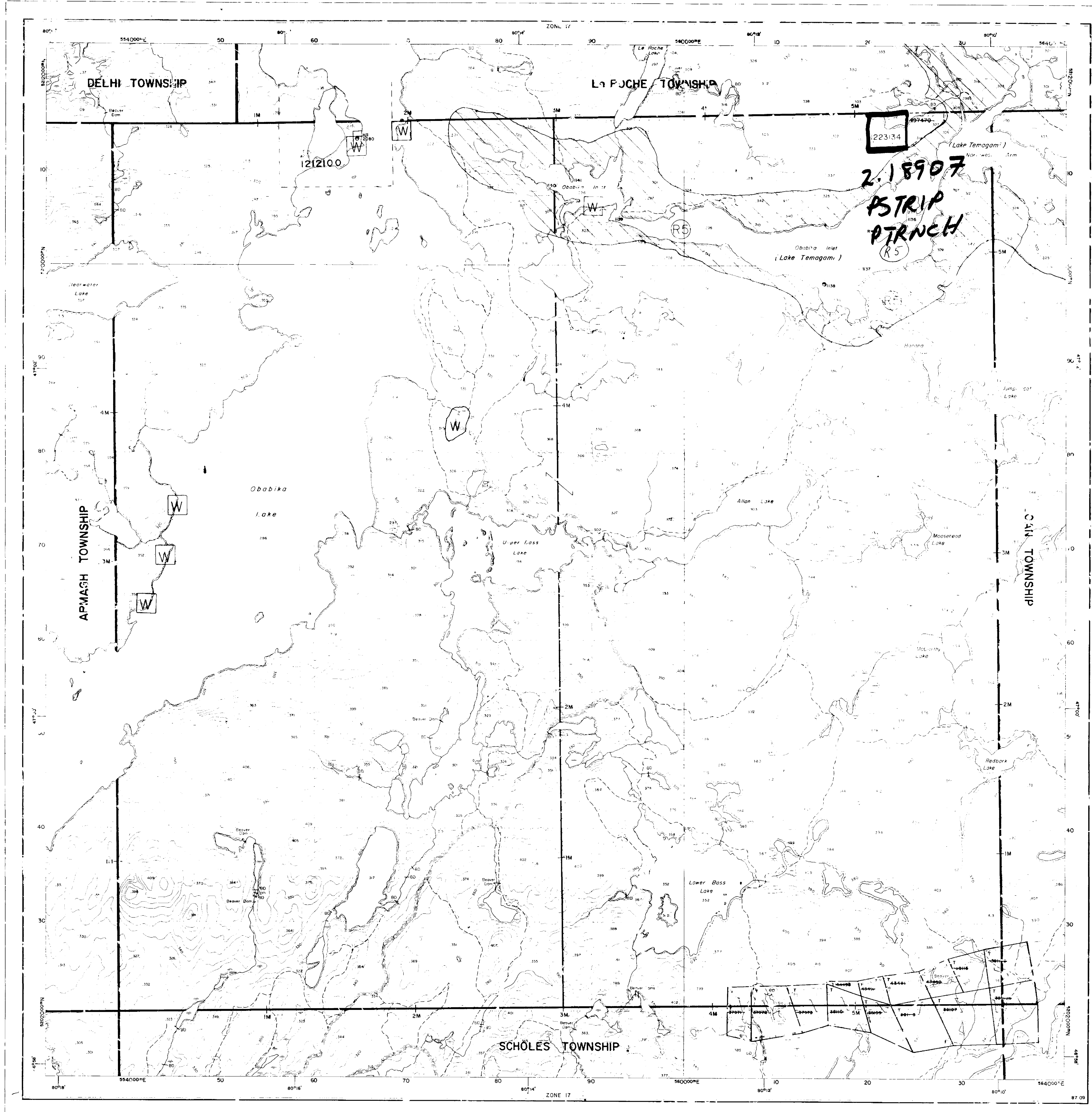

**INDEX TO LAND DISPOSITION**

PLAN  
 G-3408  
 TOWNSHIP  
**BELFAST**

DATE OF ISSUE  
 DEC 24 1988  
 PROVINCIAL RECORDING  
 OFFICE - SUDBURY

M.N.R. ADMINISTRATIVE DISTRICT  
**TEMAGAMI**  
 MINING DIVISION  
 SUDBURY  
 LAND TITLES/REGISTRY DIVISION  
 NIPISSING

THE INFORMATION THAT APPEARS ON THIS MAP HAS BEEN COMPILED FROM VARIOUS SOURCES AND ACCURACY IS NOT GUARANTEED. THOSE WISHING TO STAKE MINING CLAIMS SHOULD CONSULT WITH THE MINING RECORDER, MINISTRY OF NORTHERN DEVELOPMENT AND MINES, FOR ADDITIONAL INFORMATION ON THE STATUS OF THE LANDS SHOWN HEREON.

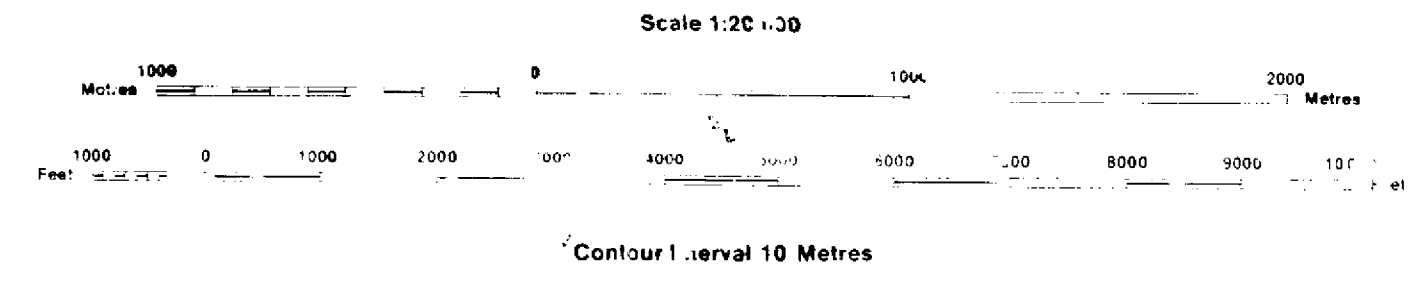

**AREAS WITHDRAWN FROM DISPOSITION**

MRO - Mining Rights Only  
 SRO - Surface Rights Only  
 M+S - Mining and Surface Rights

**SYMBOLS**

Boundary	.....	.....
Township, Median, Baseline	.....	.....
Flood allowance surveyed	.....	.....
Lot concession surveyed	.....	.....
Private survey	.....	.....
Right-of-way	.....	.....
Railway	.....	.....
Road	.....	.....
Highway	.....	.....
County road	.....	.....
Trail	.....	.....
Shovel signal	.....	.....
Transmission line	.....	.....
Wooded area	.....	.....

Description	Order No.	Date	Disposition	File
SEC 35/80	W-5-42/88	21/07/88	M+S	18515
SEC 36/80	W-5-42/88	21/07/88	M+S	18516

**DISPOSITION OF CROWN LANDS**

Patent	.....
Surface & Mining Rights	.....
Surface Rights Only	.....
Mining Rights Only	.....
Lease	.....
Surface & Mining Rights	.....
Surface Rights Only	.....
Mining Rights Only	.....
License of Occupation	.....
Order-in-Council	.....
License	.....
Reservation	.....
Sand & Gravel	.....

**NOTE**

ISLANDS IN LAKE TEMAGAMI ARE OPEN FOR STAKING UNDER THE MINING ACT

JUNE 1984 OPENING ONTARIO GAZETTE VOL. 127-20 MAY 14 1984 PAGE 1557

**NOTICE**

Pursuant to Section 25 of the Mining Act, R.S.O. 1990, the MINING AND SURFACE RIGHTS of the area shown as SKYLINE RESERVE and the land covered by the waters of LAKE TEMAGAMI as indicated on this map will be RE-OPENED TO PROSPECTING AND STAKING ON OCTOBER 27, 1988 at 9:00 a.m. This Order comes into effect on October 27, 1988 at 9:00 a.m. Eastern Standard Time, which is equivalent to 9:00 a.m. local time. These lands will be subject to Ontario Regulation 274/88 made under the Mining Act. ALL CLAIM STAKING ACTIVITIES IN THIS AREA are subject to this new regulation. MAJOR AMENDMENTS TO NORMAL STAKING PRACTICES HAVE BEEN IMPLEMENTED FOR THIS AREA. Consult and understand these amendments prior to carrying out any staking in this designated area. For further information please contact the Provincial Recorders Office at 1-888-415-0844.

**PLEASE NOTE: THE ISLANDS IN LAKE TEMAGAMI ARE WITHDRAWN AND WILL NOT BE OPEN TO PROSPECTING AND STAKING.**

**WORK PERMITS FOR MINERAL EXPLORATION ACTIVITIES**

Effective 15 September 1988

The area shown as SKYLINE RESERVE and the land covered by the waters of LAKE TEMAGAMI on this map will be subject to Ontario Regulation 274/88 made under the Public Lands Act. Depending on the type and timing of your exploration work you may require a Work Permit. For further information please contact the Provincial Recorders Office at 1-888-415-0844 or Jim Ireland, Regional Manager at (705) 255-1412.

The disposition of land shown on this map is subject to the provisions of the Mining Act, R.S.O. 1990, and the Public Lands Act, R.S.O. 1990.

Map base and land disposition drafted by Surveyors and Geographers, Provincial Ministry of Northern Development and Mines.