

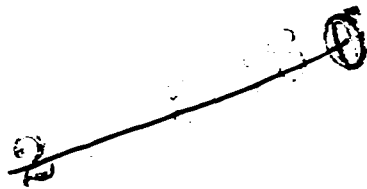

41P02SW0001 2.15280 GRIGG

010

REPORT OF ASSESSMENT WORK  
CARRIES OUT ON  
CLAIM S1179252  
GRIGG TOWNSHIP  
SUDBURY MINING DIVISION



~~BU~~  
~~CO~~

10/19/93

GRIGG TOWNSHIP

JUNE 1992

WORK PERFORMED ON 4 UNIT CLAIM S 1179252 AS FOLLOWS:

THREE MEN WITH CHAIN SAWS, PICKS, SHOVELS AND A 450 JD LOADER BACK HOE WORKED FOR 4 DAYS STRIPPING, TRENCHING AND MAKING TRAILS TO REMOVE SAMPLES WEIGHING AS MUCH AS 200 LBS. EACH.

FOUR AREAS WERE STRIPPED AND TRENCHED WITH A HAMMER DRILL BEING USED TO BLAST OUT SAMPLES OF MARBLE. APPROXIMATELY 1000 LBS. OF STONE WAS REMOVED FROM ALL TRENCHES. TWO DISTINCT COLOURS WERE OUTLINED AND WARRENTS FUTURE WORK.

-----

AUGUST 31 TO SEPTEMBER 25, 1993

THE WORK PERFORMED IN AUGUST AND SEPTEMBER OF 1993 IS AS FOLLOWS:

THE OBJECTIVE DURING THIS WORK PERIOD WAS TO ESTABLISH A WORK AREA WHERE FUTURE QUARRY WORK WILL CONTINUE.

APPROXIMATELY 2 ACRES WAS CLEARED WITH THE REMOVAL OF 3000 TONS OF GRAVEL OVERBURDEN. THIS WAS A LARGE UNDERTAKING AS IT REQUIRED AN 850 JD BULLDOZER AND A 690 JD EXCAVATOR.

IT TOOK ABOUT THREE WEEKS TO ACCOMPLISH THIS WORK AND 75 TONS OF MARBLE BLOCKS WERE REMOVED.

A FACE APPROXIMATELY 150 WIDE WAS EXPOSED WITH 4 COLOURS OF MARBLE BEING OUTLINED.

PERMITTING TO A QUARRY WILL BE DONE IN 1994.

CLAIM NO.

S 1179252

④ ①

8' x 60'  
STRIPPING + TRENCH

LINE POST 400M S # 1

8' x 20'  
TRENCH

TRENCH  
8' x 10'

TRENCH  
8' x 30'

L.P. 800M S # 1

CLEARING  
AREA  
300' x 300'  
STRIPPED

L.P. 1200 S # 1

ACCESS RD.

GRAVEL  
PIT.

③ ②

GRIGG TWP.

WANAPITEI RIVER

LOGGING ROAD

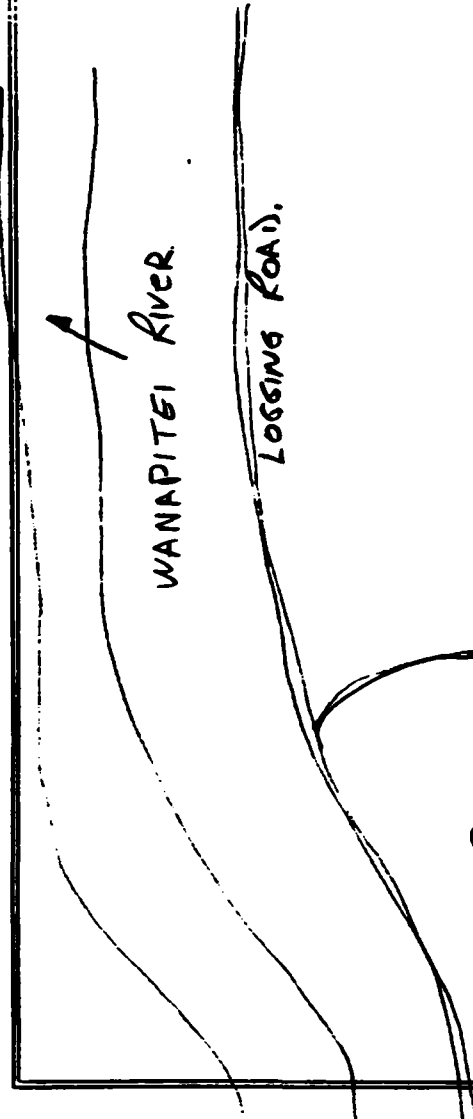

EQUIPMENT USAGE REPORT

JARVIS RESOURCES LTD. - GRIGG TWP. (HARBLE)

Note: GST extra

<u>DATES USED</u>	<u>TYPE</u>	<u>RATE</u>	<u>HOURS</u>	<u>OPERATOR</u>	<u>HOURS</u>	<u>RATE</u>
June 1-7/92	450 JD Bulldozer	40.00/hr	25		25	15.00/hr.
June 8-21/92	" "	40.00/hr	4		4	15.00/hr.
Aug. 31-Sept 11/93	850 JD Bulldozer	100.00/hr	34		34	17.00/hr.
Sept 12-25/93	" "	80.00/hr	38		38	30.00/hr.
Sept. 15-24/93	690 JD Excavator	65.00/hr	44		44	17.00/hr
Aug 29 - Sept 25/93	Austin Westvra Crane	4 1/1 x 1000.00/month			18.5	22.50/hr
Aug 29 - Sept 25/93	Petter Pump	4/11 x 400.00/month				
June 1-7/92	Pluggew	50.00/week	1 wk.		25	15.00/hr
June 8-21/92	"	50.00/week	1 wk.		8	15.00/hr

# Report of Work Conducted After Recording Claim

Transaction Number W 9370.00085

Mining Act

Information collected on this form is obtained under the authority of the Mining Act. Collection should be directed to the Provincial Manager, Mining Laboratory, Ontario, P3E 6A5, telephone (705) 670-7264.

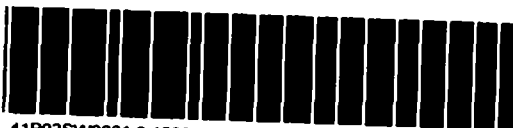

your best,

- Instructions:**
- Please type or print and submit in duplicate.
  - Refer to the Mining Act and Regulations Recorder.
  - A separate copy of this form must be completed for each Work Group.
  - Technical reports and maps must accompany this form in duplicate.
  - A sketch, showing the claims the work is assigned to, must accompany this form.

900

19

2.15200

Recorded Holder(s) <b>JARVIS RESOURCES LTD.</b>		Client No. <b>148720</b>
Address <b>106 FIELDING ROAD, LIVELY, ONTARIO, POM2E0</b>		Telephone No. <b>(705) 682-0649</b>
Mining Division <b>SUDBURY</b>	Township/Area <b>GRIGG TWP.</b>	M or G Plan No. <b>G-4053</b>
Dates Work Performed From: <b>June 1/92</b>		To: <b>September 15/93</b>

**Work Performed (Check One Work Group Only)**

Work Group	Type
<input checked="" type="checkbox"/> Geotechnical Survey	ONTARIO GEOLOGICAL SURVEY GIS-ASSESSMENT FILES
<input checked="" type="checkbox"/> Physical Work, including Drilling	Stripping, trenching, Drilling, Blasting, Sample-Block Removal
<input type="checkbox"/> Rehabilitation	
<input checked="" type="checkbox"/> Other Authorized Work	Bulk Sampling SECTION 18 ONLY
<input type="checkbox"/> Assays	
<input type="checkbox"/> Assignment from Reserve	

Total Assessment Work Claimed on the Attached Statement of Costs \$ 21,898.99

Note: The Minister may reject for assessment work credit all or part of the assessment work submitted if the recorded holder cannot verify expenditures claimed in the statement of costs within 30 days of a request for verification.

**Persons and Survey Company Who Performed the Work (Give Name and Address of Author of Report)**

Name	Address
<b>Erava Mines Ltd.</b>	<b>106 Fielding Road, Lively, Ontario, POM 2E0</b>

RECEIVED  
DEC 22 1993  
MINING

RECORDED  
OCT 20 1993

**Certification of Beneficial Interest \* See Note No. 1 on reverse side**

I certify that at the time the work was performed, the claims covered in this work report were recorded in the current holder's name or held under a beneficial interest by the current recorded holder.

Date: **Oct. 19/93** Recorded Holder or Agent (Signature): *J. G. Funk*

**Certification of Work Report**

I certify that I have a personal knowledge of the facts set forth in this Work report, having performed the work or witnessed same during and/or after its completion and annexed report is true.

Name and Address of Person Certifying: **Joanne A. Funk, c/o 106 Fielding Road, Lively, Ontario POM 2E0**

Telephone No. (705)682-2606 Date: **October 19, 1993** Certified By (Signature): *Joanne A. Funk*

**For Office Use Only**

Total Value Cr. Recorded <i>Applied \$1,000 Revised \$13,899</i>	Date Recorded <b>Oct. 22/93</b>	Mining Recorder <i>[Signature]</i>	Received Stamp <b>RECEIVED</b>
	Deemed Approval Date <b>Jan. 18/94</b>	Date Approved <i>[Signature]</i>	
Date Notice for Amendments Sent			

9/16/94





Ministry of  
Northern Development  
and Mines

Minis. du  
Développement du Nord  
et des mines

Statement of Costs  
for Assessment Credit

État des coûts aux fins  
du crédit d'évaluation

Mining Act/Loi sur les mines

Transaction No./N° de transaction

W4370-00055

Personal information collected on this form is obtained under the authority of the Mining Act. This information will be used to maintain a record and ongoing status of the mining claim(s). Questions about this collection should be directed to the Provincial Manager, Minings Lands, Ministry of Northern Development and Mines, 4th Floor, 159 Cedar Street, Sudbury, Ontario P3E 6A5, telephone (705) 670-7264.

Les renseignements personnels contenus dans la présente formule sont recueillis en vertu de la Loi sur les mines et serviront à tenir à jour un registre des concessions minières. Adresser toute question sur la collecte de ces renseignements au chef provincial des terrains miniers, ministère du Développement du Nord et des Mines, 159, rue Cedar, 4<sup>e</sup> étage, Sudbury (Ontario) P3E 6A5, téléphone (705) 670-7264.

1. Direct Costs/Coûts directs

Type	Description	Amount Montant	Totals Total global
Wages Salaires	Labour Main-d'oeuvre	6,759.47	
	Field Supervision Supervision sur le terrain		6,759.47
Contractor's and Consultant's Fees Droits de l'entrepreneur et de l'expert- conseil	Type		
Supplies Used Fournitures utilisées	Type Plugger Steel	53.50	
			53.50
Equipment Rental Location de matériel	Type 450 JD Bulldozer	1,241.20	
	850 JD "	6,890.00	
	690 E Excavator	3,060.20	
	Austin Western Crane	387.09	
	Petter Pump	155.63	
	Plugger	107.00	11,843.92
Total Direct Costs Total des coûts directs			18,656.89

2. Indirect Costs/Coûts indirects

\*\* Note: When claiming Rehabilitation work Indirect costs are not allowable as assessment work.  
Pour le remboursement des travaux de réhabilitation, les coûts indirects ne sont pas admissibles en tant que travaux d'évaluation.

Type	Description	Amount Montant	Totals Total global
Transportation Transport	Type Personnel, Service & Supplies	1,198.40	
	Sample - Blocks	888.10	
			2,086.50
Food and Lodging Nourriture et hébergement		0	0
Mobilization and Demobilization Mobilisation et démobilisation	Mob. & Demob. Equipment	1,155.60	1,155.60
Sub Total of Indirect Costs Total partiel des coûts indirects			3,242.10
Amount Allowable (not greater than 20% of Direct Costs) Montant admissible (n'excédant pas 20 % des coûts directs)			3,242.10
Total Value of Assessment Credit (Total of Direct and Allowable Indirect costs)			21,898.99
Valeur totale du crédit d'évaluation (Total des coûts directs et indirects admissibles)			

Note: The recorded holder will be required to verify expenditures claimed in this statement of costs within 30 days of a request for verification. If verification is not made, the Minister may reject for assessment work all or part of the assessment work submitted.

Note: Le titulaire enregistré sera tenu de vérifier les dépenses demandées dans le présent état des coûts dans les 30 jours suivant une demande à cet effet. Si la vérification n'est pas effectuée, le ministre peut rejeter tout ou une partie des travaux d'évaluation présentés.

Filing Discounts

1. Work filed within two years of completion is claimed at 100% of the above Total Value of Assessment Credit.
2. Work filed three, four or five years after completion is claimed at 50% of the above Total Value of Assessment Credit. See calculations below:

Total Value of Assessment Credit	Total Assessment Claimed
	x 0.50 =

Remises pour dépôt

1. Les travaux déposés dans les deux ans suivant leur achèvement sont remboursés à 100 % de la valeur totale susmentionnée du crédit d'évaluation.
2. Les travaux déposés trois, quatre ou cinq ans après leur achèvement sont remboursés à 50 % de la valeur totale du crédit d'évaluation susmentionné. Voir les calculs ci-dessous.

Valeur totale du crédit d'évaluation	Évaluation totale demandée
	x 0,50 =

Certification Verifying Statement of Costs

I hereby certify:  
that the amounts shown are as accurate as possible and these costs were incurred while conducting assessment work on the lands shown on the accompanying Report of Work form.

that as Joanne A. Funk I am authorized  
(Recorded Holder, Agent, Position in Company)

to make this certification

Attestation de l'état des coûts

J'atteste par la présente :  
que les montants indiqués sont le plus exact possible et que ces dépenses ont été engagées pour effectuer les travaux d'évaluation sur les terrains indiqués dans la formule de rapport de travail ci-joint.

Et qu'à titre de \_\_\_\_\_ je suis autorisé  
(titulaire enregistré, représentant, poste occupé dans la compagnie)

à faire cette attestation.

Signature <u>Joanne A. Funk</u>	Date Oct. 19/93
------------------------------------	--------------------



Ontario

63.6354

Ministry of  
Northern Development  
and Mines

Ministère du  
Développement du Nord  
et des Mines

Mining Recorder's Office  
Willet Green Miller Centre  
933 Ramsey Lake Road  
3rd Floor (B)  
Sudbury, ON  
P3E 6B5

Telephone: (705) 670-5742  
Fax: (705) 670-5681

January 19, 1994

Jarvis Resources Ltd.,  
106 Fielding Road  
Lively, ON POM 2E0

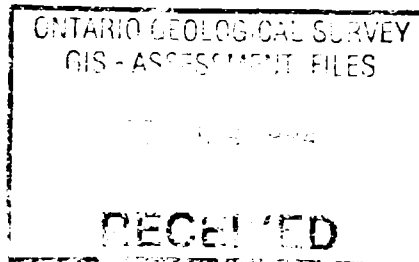

Dear Sir/Madam:

**RE: APPROVAL OF ASSESSMENT WORK SUBMITTED FOR PHYSICAL WORK FOR  
REMOVAL OF A BULK SAMPLE ON MINING CLAIM S.1179252 IN GRIGG  
TOWNSHIP**

A Notice of Deficiency was not issued on this Report of Work prior to the 90 day deemed approval date and as outlined in subsection 6(5) of the Mining Act Regulations this Report of Work is deemed approved as of January 18, 1994.

If you require further information please contact our office at the number above.

Yours truly,

  
Roy Denomme  
Mining Recorder  
Sudbury Mining Division

/mh

Encls.



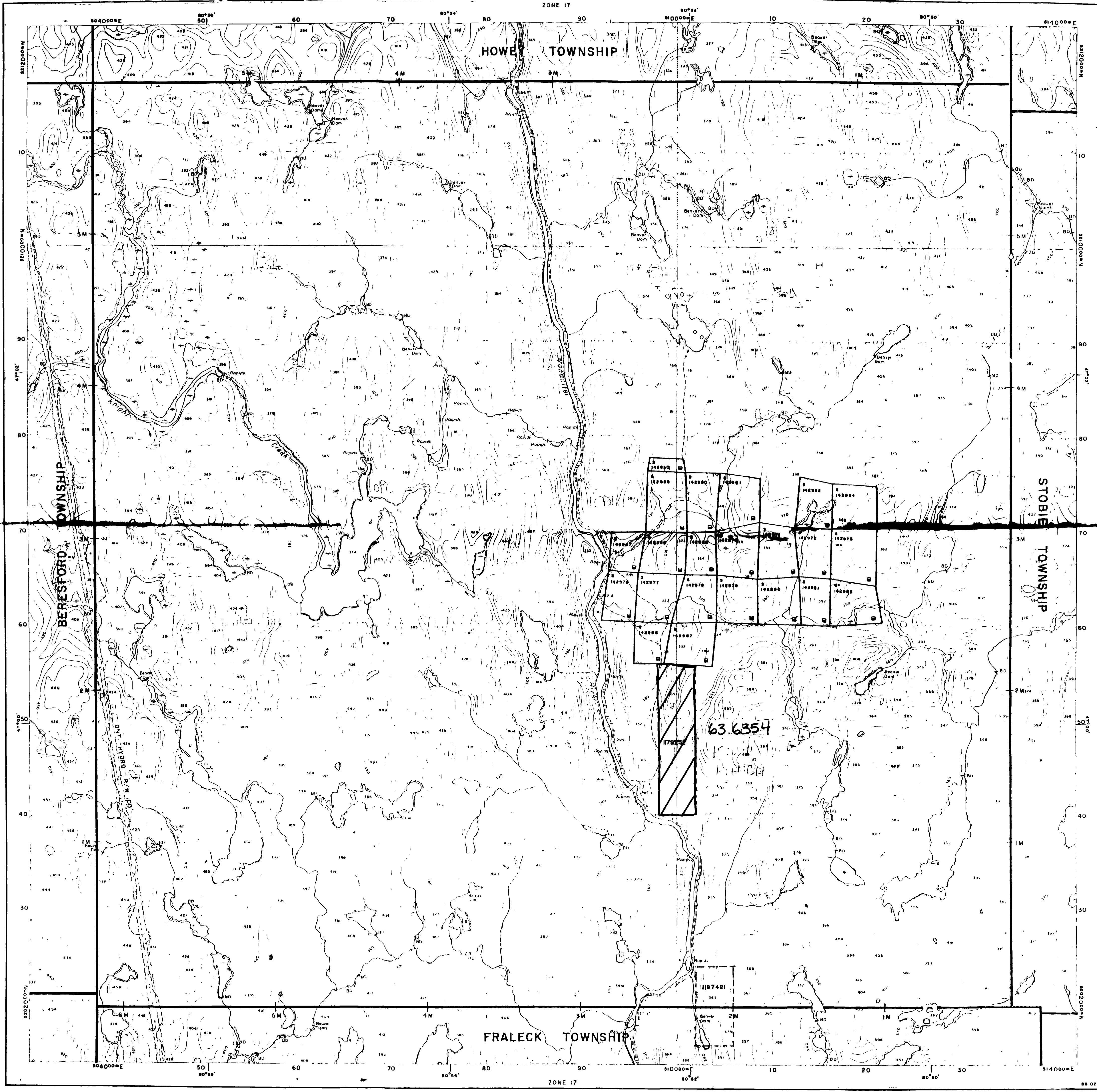

**INDEX TO LAND DISPOSITION**

PLAN  
G-4053  
TOWNSHIP  
**GRIGG**

M.N.R. ADMINISTRATIVE DISTRICT  
**SUBURY**  
MINING DIVISION  
**SUBURY**  
LAND TITLES/REGISTRY DIVISION  
**SUBURY**

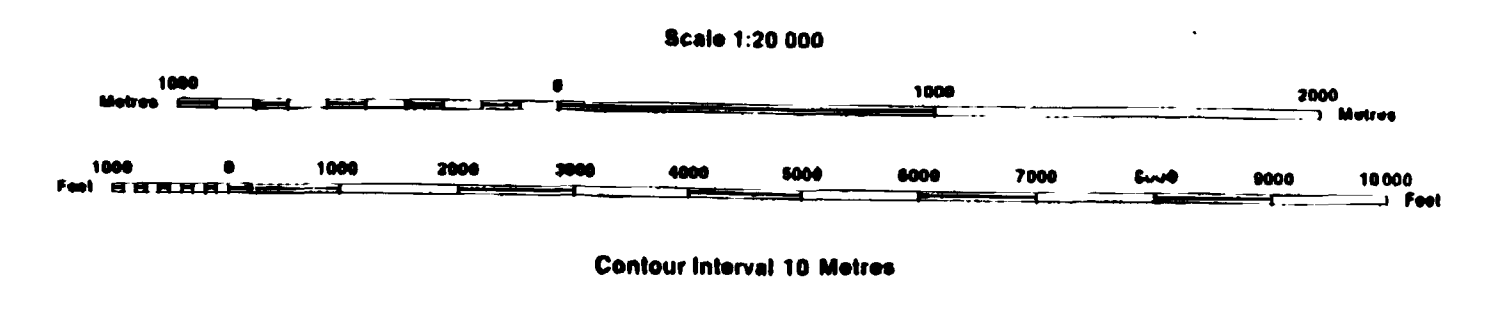

**AREAS WITHDRAWN FROM DISPOSITION**  
MRO - Mining Rights Only  
SRO - Surface Rights Only  
M + S - Mining and Surface Rights

**SYMBOLS**

Description	Order No	Date	Disposition	File
Boundary				
Township, Meridian, Baseline				
Road allowance; surveyed				
shoreline				
Loi/Concession, surveyed				
unsurveyed				
Parcel, surveyed				
unsurveyed				
Right-of-way; road				
utility				
Reservation				
Cliff, Pt, Pile				
Contour				
Interpolated				
Approximate				
Depression				
Control point (horizontal)				
Flooded land				
Mine head frame				
Pipeline (above ground)				
Railway; single track				
double track				
abandoned				
Road, highway, county, township				
access				
trail, bush				
Shoreline (original)				
Transmission line				
Wooded area				

SUBURY  
MINING RECORDS OFFICE

**DISPOSITION OF CROWN LANDS**

Patent	
Surface & Mining Rights	●
Surface Rights Only	○
Mining Rights Only	◐
Lease	
Surface & Mining Rights	■
Surface Rights Only	□
Mining Rights Only	◑
Licence of Occupation	▼
Order-in-Council	OC
Cancelled	○
Reservation	◎
Sand & Gravel	⊙

THE INFORMATION THAT APPEARS ON THIS MAP HAS BEEN COMPILED FROM VARIOUS SOURCES AND ACCURACY IS NOT GUARANTEED. THOSE WISHING TO STAKE MINING CLAIMS SHOULD CONSULT WITH THE MINING RECORDER, MINISTRY OF NORTHERN DEVELOPMENT AND MINES, FOR ADDITIONAL INFORMATION ON THE STATUS OF THE LANDS SHOWN HEREON.

G-4053

GRIGG

G-4053