

1.

Dec. 7 195



41P06NE0018 W9580-00791 NORTH WILLIAMS

010

Work Skc

result of excavating North Williams T.W.P.  
Proterozoic

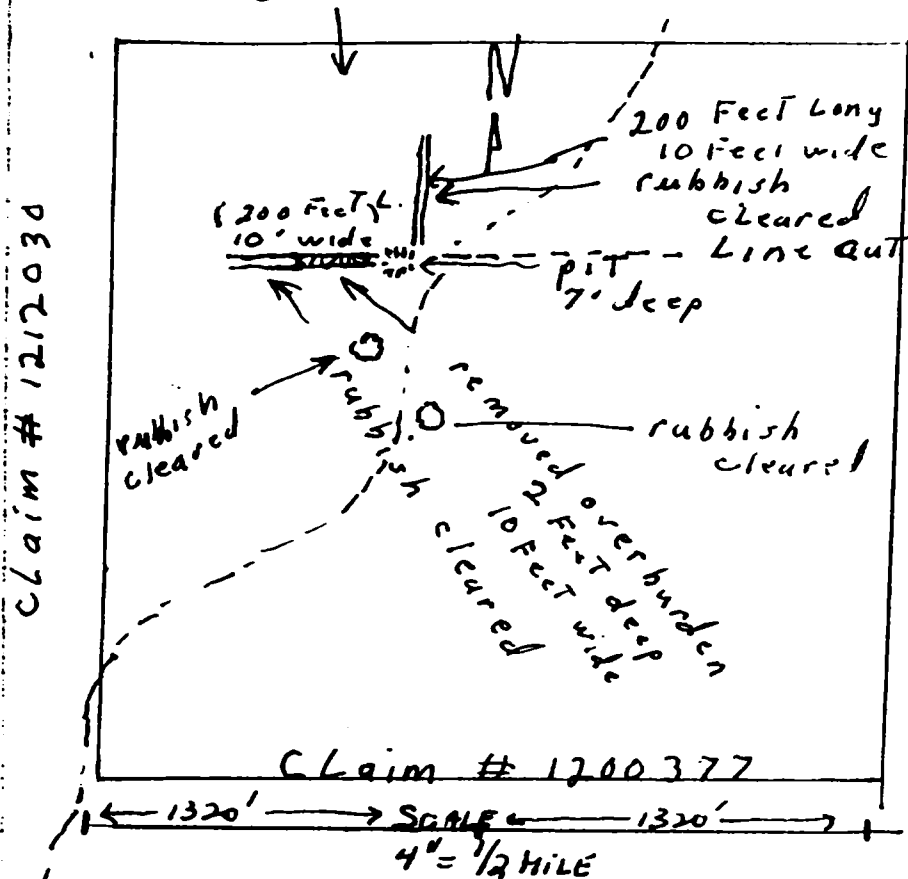
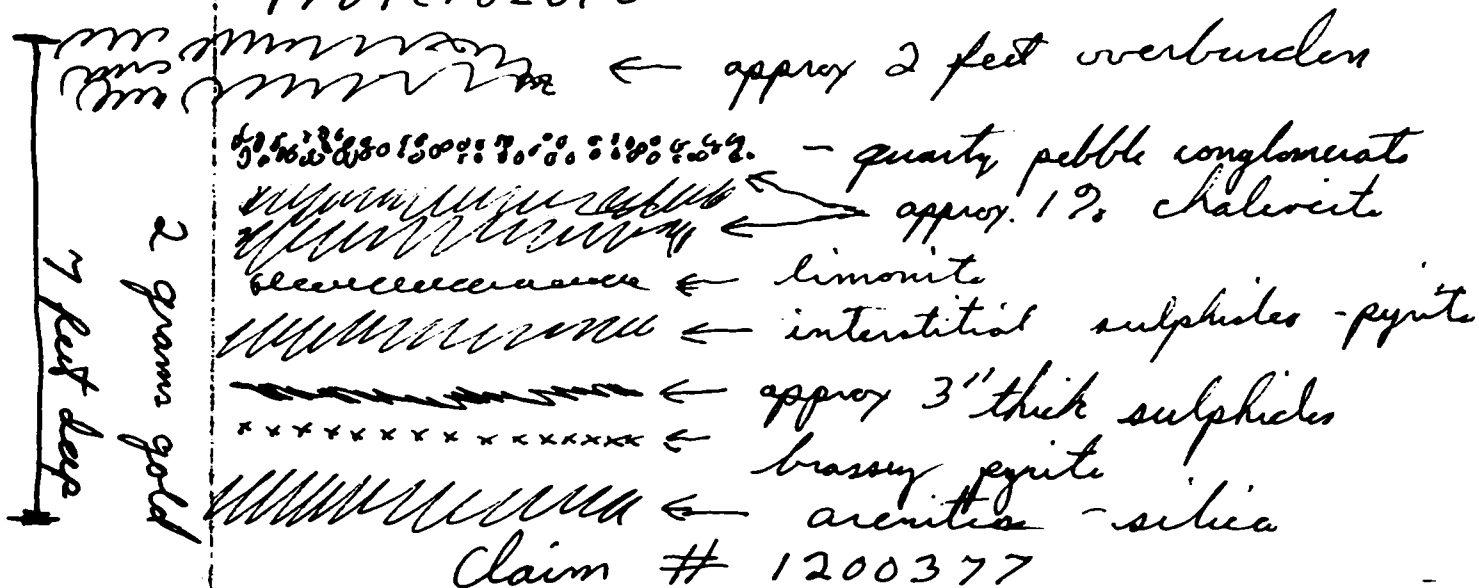

Scale 4" = 1/4 Mi.

Total area  
of claim  
scub Black  
spruce  
and brush

A. La Cret

2.

Dec. 7 195

North Williams T.W.P.

Work Sketch Claim # 1223244  
16 claim group

purpose of work  
Locate copper  
silver mineralization

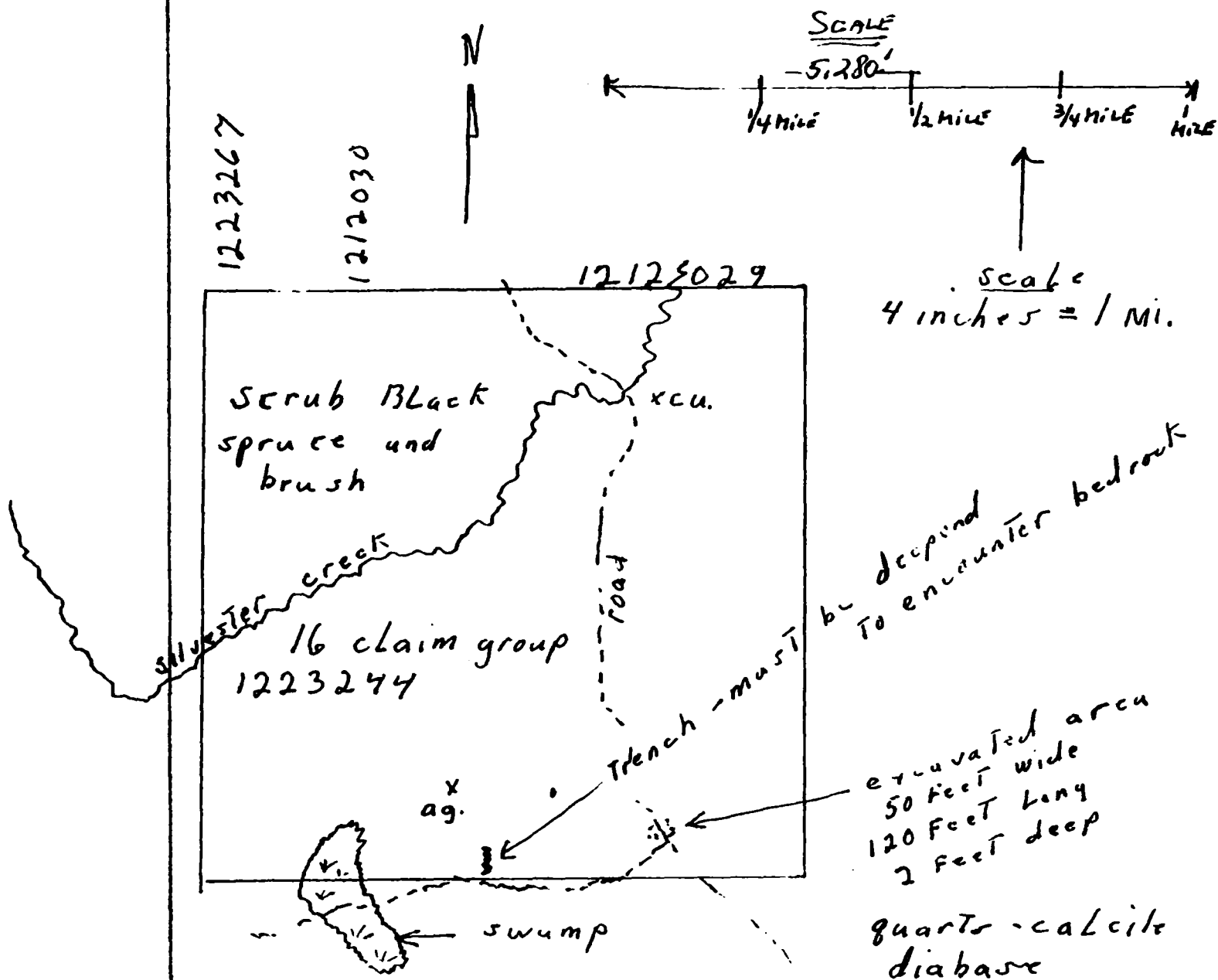

P. LaCue

3.

Dec. 71 96

### Mechanical Stripping

TD-9 bulldozer	- \$55 per hr.	
1850 compressor	- \$55 per hr.	
Aug. 12 195 TD-9	6 hrs.	
Aug. 12 195 1850 compressor drill	6 hrs.	
Aug. 28 195 TD-9	8 hrs.	worked on claim # 1200377
Aug. 29 195 TD-9	8 hrs.	
Aug. 30 195 TD-9	8 hrs.	
Aug. 31 195 TD-9	4 hrs.	
" " " 1850 compressor	4 hrs.	
Sept. 1 195 TD-9	8 hrs.	worked on claim # 1223244
Sept. 2 195 TD-9	8 hrs.	
Sept. 3 195 TD-9	8 hrs.	
Sept. 5 195 TD-9	8 hrs.	

76 hrs.

Floating machine to and from job site 550<sup>00</sup>

NO Labour only machine Time

Total 4,180  
550  
\$4,730

A. Salas



# Report of Work Conducted After Recording Claim

## Mining Act

Transaction Number  
W 9580 • 00791

Personal information collected on this form is obtained under the authority of the Mining Act. This information will be used for correspondence. Questions concerning this collection should be directed to the Provincial Manager, Mining Lands, Mir Sudbury, Ontario, P3E 6A5, telephone (705) 670-7264.

- Instructions:**
- Please type or print and submit in duplicate.
  - Refer to the Mining Act and Regulations for Recorder.
  - A separate copy of this form must be completed for each Work Group.
  - Technical reports and maps must accompany this form in duplicate.
  - A sketch, showing the claims the work is assigned to, must accompany this form.



41P06NE0018 W9580-00791 NORTH WILLIAMS

900

Recorded Holder(s) <i>Anchie LaCante</i>	Client No.
Address <i>C/O General Delivery Gowganda Ont P0G1G0</i>	Telephone No. <i>624-2300</i>
Mining Division <i>Larder Lake</i>	Township/Area <i>North Williams</i>
Dates Work Performed From: <i>Aug 12/95</i> to <i>Sept 5/95</i>	M or G Plan No. <i>G-3694</i>

**Work Performed (Check One Work Group Only)**

Work Group	Type
Geotechnical Survey	
Physical Work, Including Drilling	<i>Mechanical stripping</i>
Rehabilitation	
Other Authorized Work	
Assays	
Assignment from Reserve	

Total Assessment Work Claimed on the Attached Statement of Costs \$ *4,730.00*

**Note:** The Minister may reject for assessment work credit all or part of the assessment work submitted if the recorded holder cannot verify expenditures claimed in the statement of costs within 30 days of a request for verification.

**Persons and Survey Company Who Performed the Work (Give Name and Address of Author of Report)**

Name	Address
<i>Anchie LaCante</i>	<i>C/O General Delivery Ont P0G1G0</i>

(attach a schedule if necessary)

**Certification of Beneficial Interest \* See Note No. 1 on reverse side**

I certify that at the time the work was performed, the claims covered in this work report were recorded in the current holder's name or held under a beneficial interest by the current recorded holder.	Date <i>Dec 6/95</i>	Recorded Holder or Agent (Signature) <i>A. LaCante</i>
--	-------------------------	---

**Certification of Work Report**

I certify that I have a personal knowledge of the facts set forth in this Work report, having performed the work or witnessed same during and/or after its completion and annexed report is true.		
Name and Address of Person Certifying <i>Anchie LaCante</i>		
Telephone No. <i>705-624-2187</i>	Date <i>Dec 7/95</i>	Certified By (Signature) <i>A. LaCante</i>

**For Office Use Only**

Total Value Cr. Recorded <i>\$4730.</i>	Date Recorded <i>Dec 12/95</i>	Mining Recorder <i>[Signature]</i>	Received Stamp MINING DIVISION <b>DEC 12 1995</b>
	Deemed Approval Date <i>Mar 11/96</i>	Date Approved <i>May 13/96</i>	
	Date Notice for Amendments Sent <i>Deemed Approved</i>		

Work Report Number for Reserve	Claim Number (see Note 2)	Number of Claim Units	Value of Assessment of Work Done on this Claim	Value Applied to this Claim	Value Assigned from this Claim	Work to be Claimed at a Future Date
	1223244	16	3,170 <del>4,730.00</del> 0.5000 1.5000 <del>25.000</del>	4,730.00	1560.00	
	1200377	1				
Total Number of Claims			Total Value Work Done	Total Value Work Applied	Total Assigned From	Total Reserve
17			\$4,730.00	4,730.00	1560.00	

Credits you are claiming in this report may be cut back. In order to minimize the adverse effects of such deletions, please indicate from which claims you wish to prioritize the deletion of credits. Please mark (✓) one of the following:

- Credits are to be cut back starting with the claim listed last, working backwards.
- Credits are to be cut back equally over all claims contained in this report of work.
- Credits are to be cut back as prioritized on the attached appendix. *to be applied only to claim # 1223244*

In the event that you have not specified your choice of priority, option one will be implemented.

Note 1: Examples of beneficial interest are unrecorded transfers, option agreements, memorandum of agreements, etc., with respect to the mining claims.

Note 2: If work has been performed on patented or leased land, please complete the following:

I certify that the recorded holder had a beneficial interest in the patented or leased land at the time the work was performed.	Signature <i>x [Signature]</i>	Date DEC 7/95
---	-----------------------------------	------------------



Ministry of  
Northern Development  
and Mines

Ministère du  
Développement du Nord  
et des mines

**Statement of Costs  
for Assessment Credit**

**État des coûts aux fins  
du crédit d'évaluation**

**Mining Act/Loi sur les mines**

Transaction No./N° de transaction  
113520001110  
U9580-0077

Personal information collected on this form is obtained under the authority of the Mining Act. This information will be used to maintain a record and ongoing status of the mining claim(s). Questions about this collection should be directed to the Provincial Manager, Minings Lands, Ministry of Northern Development and Mines, 4th Floor, 159 Cedar Street, Sudbury, Ontario P3E 6A5, telephone (705) 670-7264.

Les renseignements personnels contenus dans la présente formule sont recueillis en vertu de la Loi sur les mines et serviront à tenir à jour un registre des concessions minières. Adresser toute question sur la collecte de ces renseignements au chef provincial des terrains miniers, ministère du Développement du Nord et des Mines, 159, rue Cedar, 4<sup>e</sup> étage, Sudbury (Ontario) P3E 6A5, téléphone (705) 670-7264.

**1. Direct Costs/Coûts directs**

Type	Description	Amount Montant	Totals Total global
Wages Salaires	Labour Main-d'oeuvre		
	Field Supervision Supervision sur le terrain		
Contractor's and Consultant's Fees Droits de l'entrepreneur et de l'expert- conseil	Type		
Supplies Used Fournitures utilisées	Type		
Equipment Rental Location de matériel	Type D.9 Bulldozer	\$3,630.00	
	185Q Compressor	\$550.00	
<b>Total Direct Costs Total des coûts directs</b>			<b>\$4,180.00</b>

**2. Indirect Costs/Coûts indirects**

\*\* Note: When claiming Rehabilitation work Indirect costs are not allowable as assessment work.  
Pour le remboursement des travaux de réhabilitation, les coûts indirects ne sont pas admissibles en tant que travaux d'évaluation.

Type	Description	Amount Montant	Totals Total global
Transportation Transport	Type		
Food and Lodging Nourriture et hébergement			
Mobilization and Demobilization Mobilisation et démobilisation	float Bulldozer		\$550.00
<b>Sub Total of Indirect Costs Total partiel des coûts indirects</b>			<b>\$550.00</b>
Amount Allowable (not greater than 20% of Direct Costs) Montant admissible (n'excédant pas 20 % des coûts directs)			
<b>Total Value of Assessment Credit (Total of Direct and Allowable indirect costs)</b>			<b>\$4,730.00</b>
Valeur totale du crédit d'évaluation (Total des coûts directs et indirects admissibles)			

Note: The recorded holder will be required to verify expenditures claimed in this statement of costs within 30 days of a request for verification. If verification is not made, the Minister may reject for assessment work all or part of the assessment work submitted.

Note: Le titulaire enregistré sera tenu de vérifier les dépenses demandées dans le présent état des coûts dans les 30 jours suivant une demande à cet effet. Si la vérification n'est pas effectuée, le ministre peut rejeter tout ou une partie des travaux d'évaluation présentés.

**Filing Discounts**

1. Work filed within two years of completion is claimed at 100% of the above Total Value of Assessment Credit.
2. Work filed three, four or five years after completion is claimed at 50% of the above Total Value of Assessment Credit. See calculations below:

Total Value of Assessment Credit	Total Assessment Claimed
	x 0.50 =

**Remises pour dépôt**

1. Les travaux déposés dans les deux ans suivant leur achèvement sont remboursés à 100 % de la valeur totale susmentionnée du crédit d'évaluation.
2. Les travaux déposés trois, quatre ou cinq ans après leur achèvement sont remboursés à 50 % de la valeur totale du crédit d'évaluation susmentionné. Voir les calculs ci-dessous.

Valeur totale du crédit d'évaluation	Évaluation totale demandée
	x 0.50 =

**Certification Verifying Statement of Costs**

I hereby certify:  
That the amounts shown are as accurate as possible and these costs were incurred while conducting assessment work on the lands shown on the accompanying Report of Work form.

That as Recorded Holder I am authorized  
(Recorded Holder, Agent, Position in Company)

To make this certification

**Attestation de l'état des coûts**

J'atteste par la présente :  
que les montants indiqués sont le plus exact possible et que ces dépenses ont été engagées pour effectuer les travaux d'évaluation sur les terrains indiqués dans la formule de rapport de travail ci-joint.

Et qu'à titre de \_\_\_\_\_ je suis autorisé  
(titulaire enregistré, représentant, poste occupé dans la compagnie)

à faire cette attestation.

Signature [Signature] Date Dec 7/95

Ministry of  
Northern Development  
and Mines

Ministère du  
Développement du Nord  
et des Mines

Recording Office  
4 Government Road East  
KIRKLAND LAKE, Ontario  
P2N 1A2

Our File: W9580.00791

May 13, 1996

Mr. Archie LaCarte  
General Delivery  
Gowganda, Ontario  
P0J 1J0

Dear Sir

SUBJECT: Report of Work #W9580.00791  
Power stripping  
L 1223244 et al, North Williams Township

The above mentioned report of work was filed in this office December 12, 1995. According to subsection 6(7) of the assessment work regulations under The Mining Act, eligible assessment work shall be deemed to be approved for credit if this Ministry does not identify a deficiency within 90 days of filing.

The 90 day period has expired and therefore the work submitted in your report is to be considered automatically approved and recorded as you had indicated on the reverse side of your report of work form (attached).

If you have any questions please call us.

Yours truly

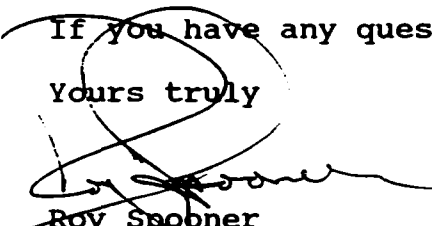
  
Roy Spobner  
Mining Recorder  
Larder Lake Mining Division  
Telephone (7050 567-9241)

RS/lp

encl.

c.c.: Resident Geologist, Cobalt  
Assessment File Office



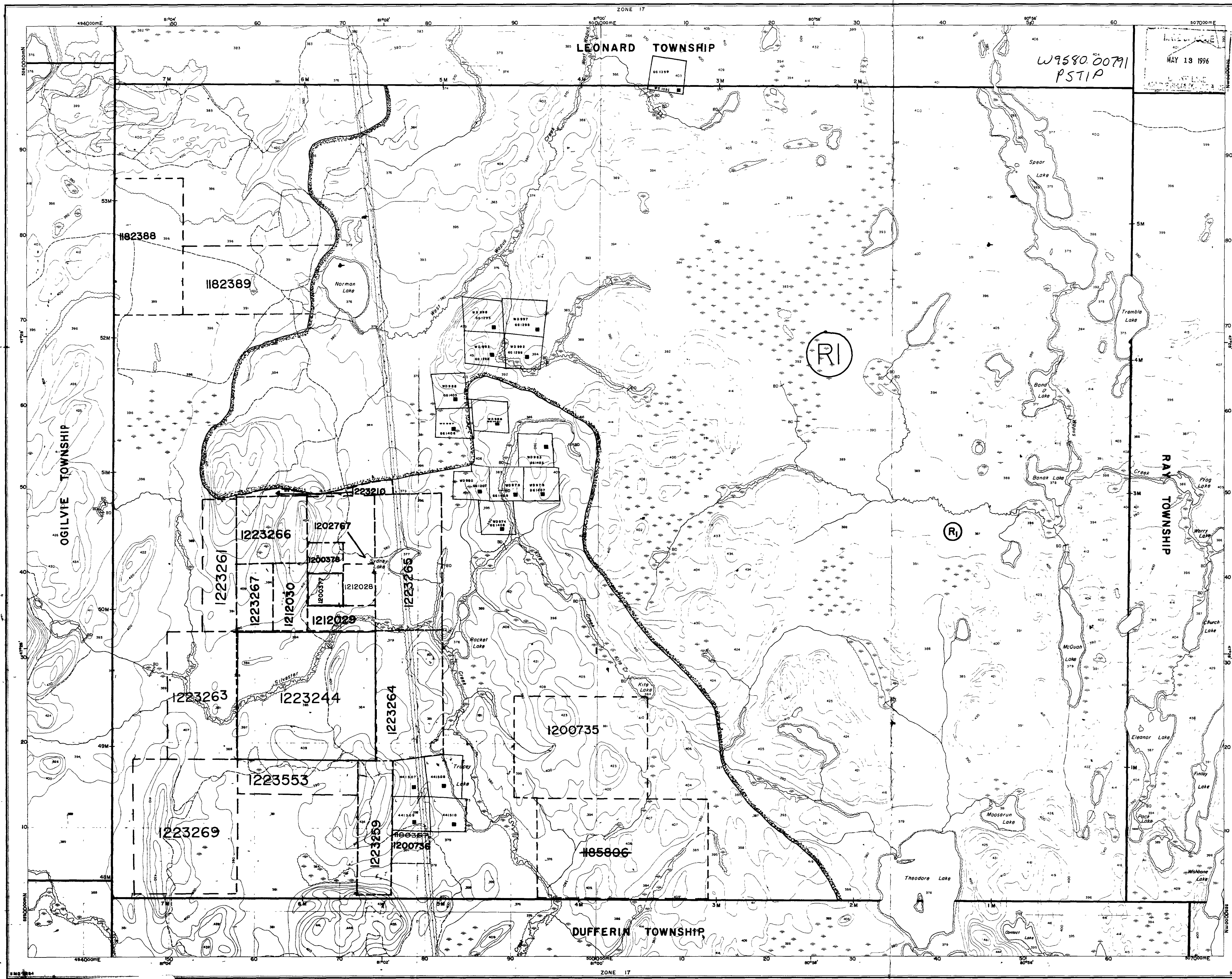

**INDEX TO LAND DISPOSITION**

PLAN  
G-3694  
TOWNSHIP

**NORTH WILLIAMS**

M.N.R. ADMINISTRATIVE DISTRICT  
**KIRKLAND LAKE**  
MINING DIVISION  
**LARDER LAKE**  
LAND TITLES/REGISTRY DIVISION  
**TIMISKAMING**

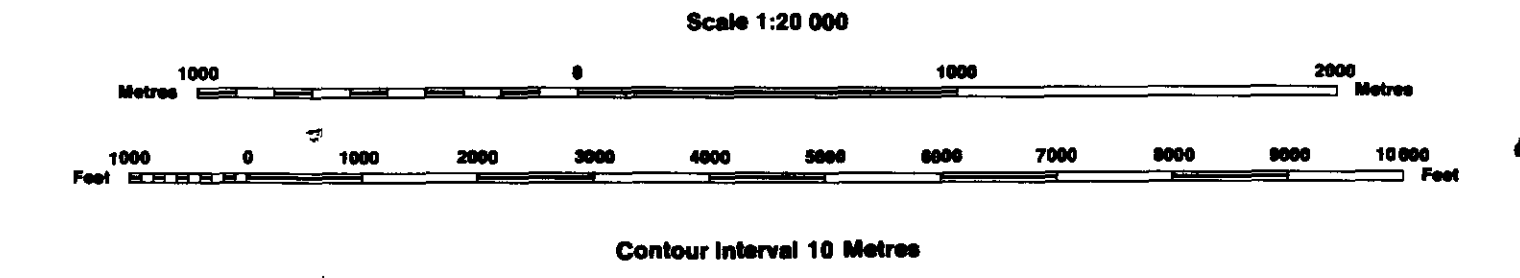

**AREAS WITHDRAWN FROM DISPOSITION**

MRO - Mining Rights Only  
SRO - Surface Rights Only  
M + S - Mining and Surface Rights

Description	Order No.	Date	Disposition	File
SEC.34/90	NRW 12/82	3/4/90	S & M.	

\*Part of Order NRW 12/82 RE-OPENED by order  
O.M.L.04-90 NER effective April 3, 1990 at 7:00 AM E.S.T.

**SYMBOLS**

- Boundary
- Township, Meridian, Baseline
- Road allowance, surveyed
- shoreline
- Lot/Concession; surveyed
- unsurveyed
- Parcel, surveyed
- unsurveyed
- Right-of-way, road
- railway
- utility
- Reservation
- City, Pt. File
- Contour
- Interpolated
- Approximate
- Depression
- Control point (horizontal)
- Flooded land
- Mine head frame
- Pipeline (above ground)
- Railway, single track
- double track
- abandoned
- Road, highway, county, township
- access
- trail, bush
- Shoreline (original)
- Transmission line
- Wooded area

**DISPOSITION OF CROWN LANDS**

- Patent
- Surface & Mining Rights
- Surface Rights Only
- Mining Rights Only
- Lease
- Surface & Mining Rights
- Surface Rights Only
- Mining Rights Only
- Licence of Occupation
- Order-in-Council
- Cancelled
- Reservation
- Sand & Gravel

THIS MAP SHOWS THE APPROXIMATE LOCATION OF THE BOUNDARIES OF THE AREA WHICH IS THE SUBJECT OF CURRENT LITIGATION. THE EXACT LOCATION WILL BE SHOWN FOLLOWING CONFIRMATION BY THE PARTIES TO THE ACTION.

RECEIVED FEB. 22/95  
CIRCULATED AUG. 19, 1992 B.R.B.

THE INFORMATION THAT APPEARS ON THIS MAP HAS BEEN COMPILED FROM VARIOUS SOURCES AND ACCURACY IS NOT GUARANTEED. THOSE WISHING TO STAKE MINING CLAIMS SHOULD CONSULT WITH THE MINING RECORDER, MINISTRY OF NORTHERN DEVELOPMENT AND MINES, FOR ADDITIONAL INFORMATION ON THE STATUS OF THE LANDS SHOWN HEREON.

Map base and land disposition drafting by Surveys and Mapping Branch, Ministry of Natural Resources.

The disposition of land, location of lot fabric and parcel boundaries on this index was compiled for administrative purposes only.

