

ASSESSMENT WORK REPORT

2. 165 34

PROSPECTING & TRENCHING

ON

ROY ANNETT CLAIM NO. 1200736

NORTH WILLIAMS TOWNSHIP

Roy Annett of Shining Tree, Ontario is the recorded owner of the single unit claim 1200736 in North Williams Township. Access to the claim is along the HEPC road to near the south boundary of the township. The HEPC line crosses the eastern side of the claim.

Extender Minerals, a barite mining firm based in Matachewan, Ontario owns the adjoining leased claims to the north and east, and during the 1992 - 1993 season took a bulk sample of barite ore from their property.

During the period October 2 to 14, 1995 Annett made several trips to his claim and thoroughly prospected the outcrop area. A series of east-west striking barite veins were discovered which Annett stripped and trenched using shovel and grubhoes. The veins are massive white barite veins varying in width from 1" to 5" and were traced intermittently for some 500 feet across the claim. Host rock appears to be a reddish granophyritic diabase, much the same as that hosting the Extender veins. Strike is east-west, again similar to Extender's.

A sketch map of Annett's work and stripping areas is attached hereto.

Roy Annett

41P09NE023 2 18534 NORTH WILLIAMS

010

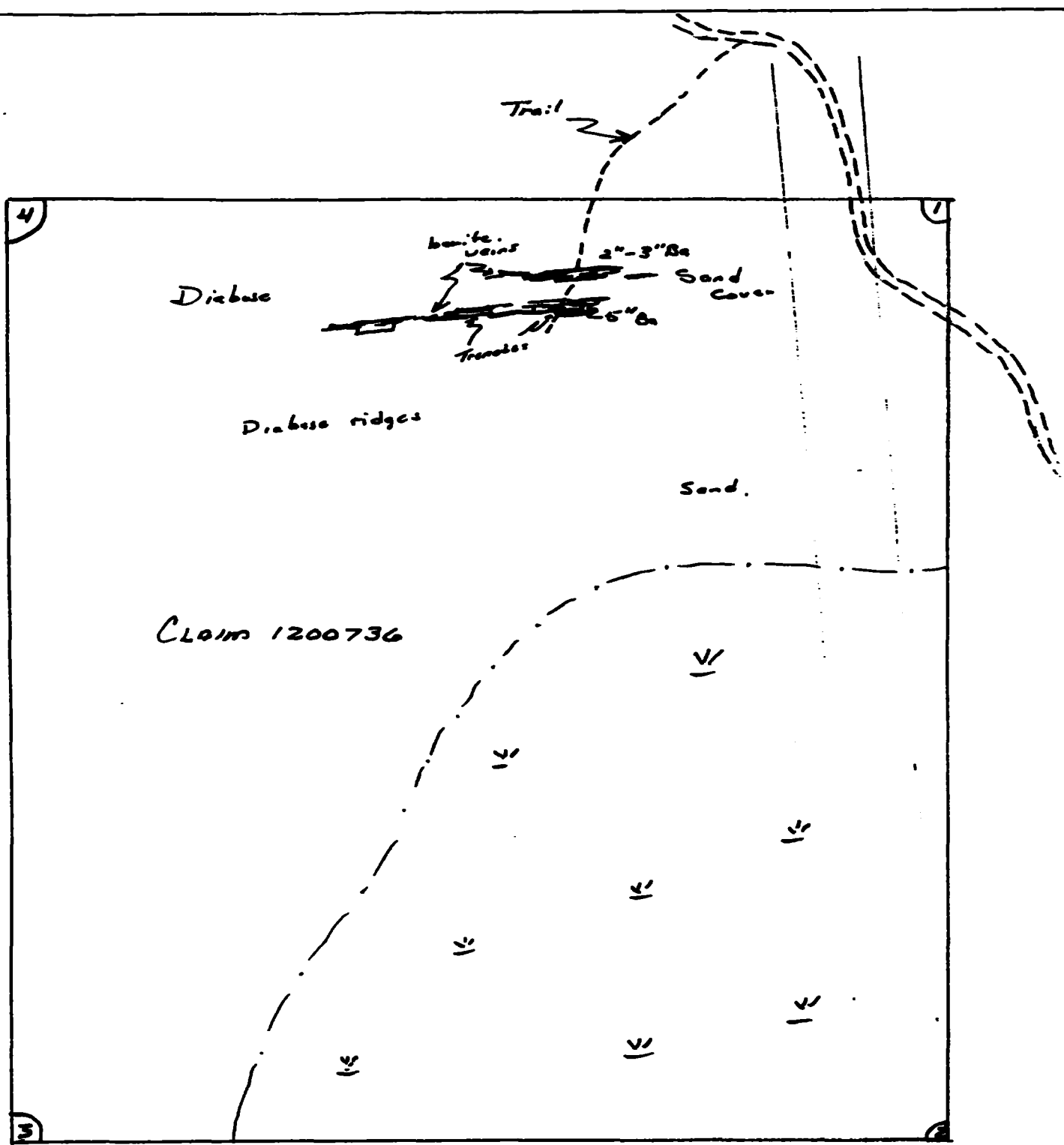

Roy Annett Property  
 Barite Shows  
 North Williams Twp  
 1" = 200'  
 11/1/96 R.A.

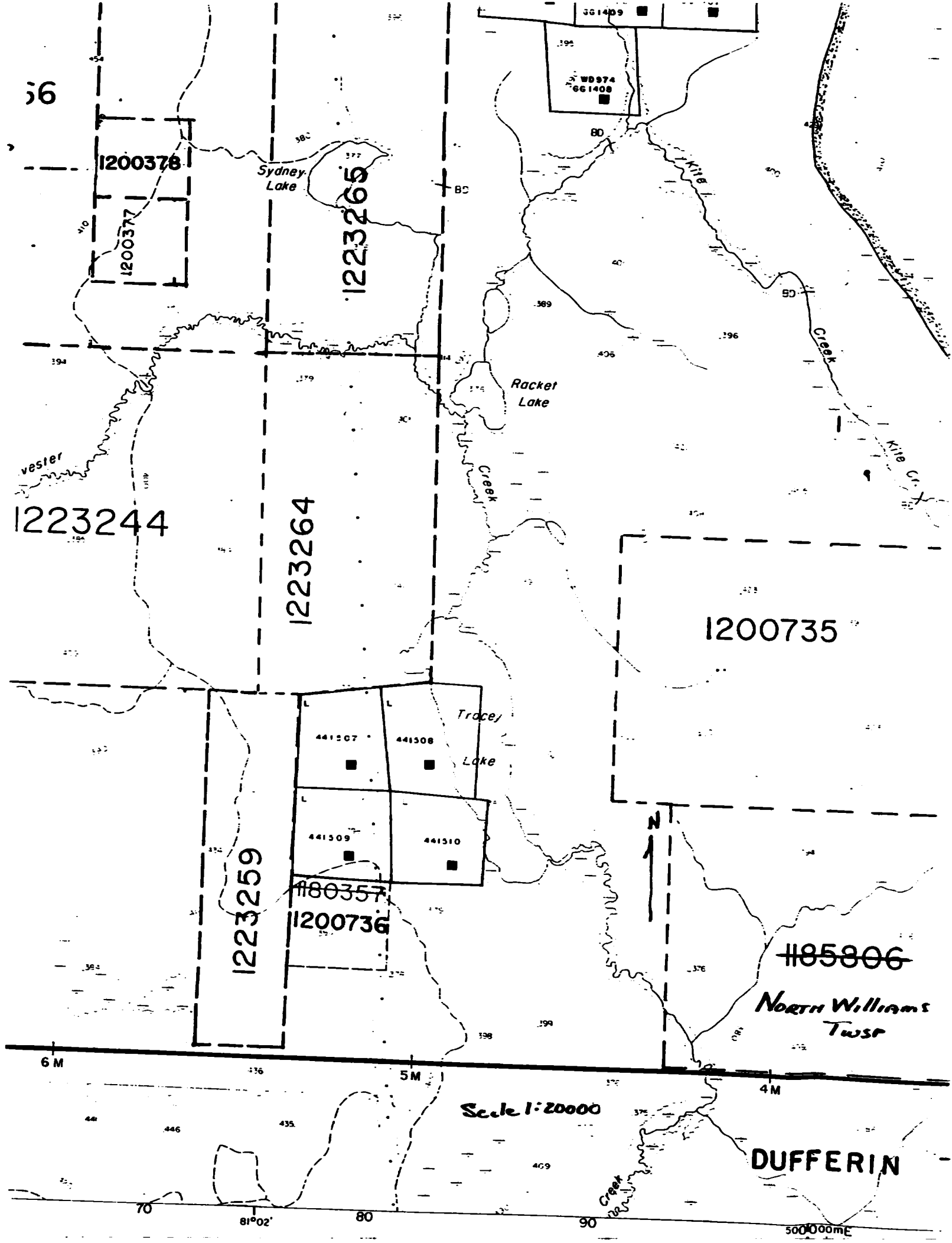

Scale 1:20000

DUFFERIN

NORTH Williams  
Twp

56

1223244

1200378

1200377

1223265

1223264

1200735

1223259

1180357  
1200736

1185806

6 M

5 M

4 M

70

81°02'

80

90

500000mE



**Report of Work Conducted  
After Recording Claim**

**Mining Act**

Transaction Number  
**DOCUMENT No.**  
9680-6637

Personal information collected on this form is obtained under the authority of the Mining Act. This information will be used for correspondence. Questions about this collection should be directed to the Provincial Manager, Mining Lands, Ministry of Northern Development and Mines, Fourth Floor, 159 Cedar Street, Sudbury, Ontario, P3E 6A5, telephone (705) 670-7264.

- Instructions:**
- Please type or print and submit in duplicate.
  - Refer to the Mining Act and Regulations for requirements of filing assessment work or consult the Mining Recorder.
  - A separate copy of this form must be completed.
  - Technical reports and maps must accompany it.
  - A sketch, showing the claims the work is assigned to, must be attached.

**2.16534**



41P06NE0023 2.16534 NORTH WILLIAMS

900

Recorded Holder(s) <b>ROY ANNETT</b>		Client No. <b>102630</b>
Address <b>SHINING TREE ONTARIO P0M 2X0</b>		Telephone No. <b>705-263-2054</b>
Mining Division <b>LARDER LAKE</b>	Township/Area <b>NORTH WILLIAMS</b>	M or G Plan No. <b>63694</b>
Dates Work Performed From: <b>OCTOBER 2/95</b>		To: <b>OCTOBER 14, 1995</b>

**Work Performed (Check One Work Group Only)**

Work Group	Type
<input checked="" type="checkbox"/> Geotechnical Survey	
<input checked="" type="checkbox"/> Physical Work, Including Drilling	<b>PROSPECTING, Teaching, Striping</b>
<input type="checkbox"/> Rehabilitation	
<input type="checkbox"/> Other Authorized Work	
<input type="checkbox"/> Assays	
<input type="checkbox"/> Assignment from Reserve	



Total Assessment Work Claimed on the Attached Statement of Costs \$ **754**

**Note:** The Minister may reject for assessment work credit all or part of the assessment work submitted if the recorded holder cannot verify expenditures claimed in the statement of costs within 30 days of a request for verification.

**Persons and Survey Company Who Performed the Work (Give Name and Address of Author of Report)**

Name	Address
<b>ROY ANNETT</b>	<b>SHINING TREE ONT. P0M 2X0</b>

attach a schedule if necessary)

**Verification of Beneficial Interest \* See Note No. 1 on reverse side**

I certify that at the time the work was performed, the claims covered in this work report were recorded in the current holder's name or held under a beneficial interest by the current recorded holder.	Date <b>MAY 8/96</b>	Recorded Holder or Agent (Signature) <b>Roy Annett</b>
----------------------------------------------------------------------------------------------------------------------------------------------------------------------------------------------------------	-------------------------	-----------------------------------------------------------

**Verification of Work Report**

I certify that I have a personal knowledge of the facts set forth in this Work report, having performed the work or witnessed same during and/or after its completion and annexed report is true.

Name and Address of Person Certifying <b>ROY ANNETT SHINING TREE ONT P0M 2X0</b>		
Telephone No. <b>705-263-2054</b>	Date <b>MAY 8/96</b>	Certified By (Signature) <b>Roy Annett</b>

**For Office Use Only**

Total Value Cr. Recorded <b>754</b>	Date Recorded <b>96 May 13</b>	Mining Recorder <b>[Signature]</b>	Received Stamp <b>RECEIVED LARDER LAKE MINING DIVISION MAY 13 1996</b>
	Deemed Approval Date <b>Aug 11</b>	Date Approved <b>[Signature]</b>	
	Date Notice for Amendments Sent		





Statement of Costs  
for Assessment Credit

État des coûts aux fins  
du crédit d'évaluation

Mining Act/Loi sur les mines

Transaction No./N° de transaction

Personal information collected on this form is obtained under the authority of the Mining Act. This information will be used to maintain a record and ongoing status of the mining claim(s). Questions about this collection should be directed to the Provincial Manager, Minings Lands, Ministry of Northern Development and Mines, 4th Floor, 159 Cedar Street, Sudbury, Ontario P3E 6A5, telephone (705) 670-7264.

Les renseignements personnels contenus dans la présente formule sont recueillis en vertu de la Loi sur les mines et serviront à tenir à jour un registre des concessions minières. Adresser toute question sur la collecte de ces renseignements au chef provincial des terrains miniers, ministère du Développement du Nord et des Mines, 159, rue Cedar, 4<sup>e</sup> étage, Sudbury (Ontario) P3E 6A5, téléphone (705) 670-7264.

1. Direct Costs/Coûts directs

Type	Description	Amount Montant	Totals Total global
Wages Salaires	Labour Main-d'oeuvre	800	800
	Field Supervision Supervision sur le terrain		
Contractor's and Consultant's Fees Droits de l'entrepreneur et de l'expert- conseil	Type		
Supplies Used Fournitures utilisées	Type		
Equipment Rental Location de matériel	Type		
<b>Total Direct Costs Total des coûts directs</b>			<b>800</b>

2. Indirect Costs/Coûts indirects

\*\* Note: When claiming Rehabilitation work Indirect costs are not allowable as assessment work.  
Pour le remboursement des travaux de réhabilitation, les coûts indirects ne sont pas admissibles en tant que travaux d'évaluation.

Type	Description	Amount Montant	Totals Total global
Transportation Transport	Type		
	4x4 TRUCK - 12km @ 0.30	153.6	
			152.60
Food and Lodging Nourriture et hébergement			
Mobilization and Demobilization Mobilisation et démobilisation			
<b>Sub Total of Indirect Costs Total partiel des coûts indirects</b>			<b>153.60</b>
Amount Allowable (not greater than 20% of Direct Costs) Montant admissible (n'excedant pas 20 % des coûts directs)			153.60
<b>Total Value of Assessment Credit (Total of Direct and Allowable indirect costs)</b>			<b>954.00</b>
<b>Valueur totale du crédit d'évaluation (Total des coûts directs et indirects admissibles)</b>			

Note: The recorded holder will be required to verify expenditures claimed in this statement of costs within 30 days of a request for verification. If verification is not made, the Minister may reject for assessment work all or part of the assessment work submitted.

Note : Le titulaire enregistré sera tenu de vérifier les dépenses demandées dans le présent état des coûts dans les 30 jours suivant une demande à cet effet. Si la vérification n'est pas effectuée, le ministre peut rejeter tout ou une partie des travaux d'évaluation présentés.

Filing Discounts

1. Work filed within two years of completion is claimed at 100% of the above Total Value of Assessment Credit.
2. Work filed three, four or five years after completion is claimed at 50% of the above Total Value of Assessment Credit. See calculations below:

Total Value of Assessment Credit	Total Assessment Claimed
	x 0.50 =

Remises pour dépôt

1. Les travaux déposés dans les deux ans suivant leur achèvement sont remboursés à 100 % de la valeur totale susmentionnée du crédit d'évaluation.
2. Les travaux déposés trois, quatre ou cinq ans après leur achèvement sont remboursés à 50 % de la valeur totale du crédit d'évaluation susmentionné. Voir les calculs ci-dessous.

Valueur totale du crédit d'évaluation	Évaluation totale demandée
	x 0,50 =

Certification Verifying Statement of Costs

I hereby certify:  
that the amounts shown are as accurate as possible and these costs were incurred while conducting assessment work on the lands shown on the accompanying Report of Work form.

that as Recorded Holder I am authorized  
(Recorded Holder, Agent, Position in Company)

to make this certification

Attestation de l'état des coûts

J'atteste par la présente :  
que les montants indiqués sont le plus exact possible et que ces dépenses ont été engagées pour effectuer les travaux d'évaluation sur les terrains indiqués dans la formule de rapport de travail ci-joint.

Et qu'à titre de \_\_\_\_\_ je suis autorisé  
(titulaire enregistré, représentant, poste occupé dans la compagnie)

à faire cette attestation.

Signature <u>Ray Bennett</u>	Date <u>MAY 8, 1986</u>
---------------------------------	----------------------------



Ministry of  
Northern Development  
and Mines

Ministère du  
Développement du Nord  
et des Mines

Geoscience Assessment Office  
933 Ramsey Lake Road  
6th Floor  
Sudbury, Ontario  
P3E 6B5

Telephone: (705) 670-5853  
Fax: (705) 670-5863

August 2, 1996

Our File: 2.16534  
Transaction #: W9680.00227

Mining Recorder  
Ministry of Northern Development & Mines  
4 Government Road East  
Kirkland Lake, Ontario  
P2N 1A2

Dear Mr. Spooner:

**SUBJECT: APPROVAL OF ASSESSMENT WORK CREDIT ON MINING LAND, CLAIM(S)  
1200736 (ET AL.) IN N. WILLIAMS TOWNSHIP (AREA)**

Assessment work credit has been approved as outlined on the Declaration of Assessment Work Form accompanying this submission. The credit has been approved under Section 9, Prospecting (PROSP) of the Assessment Work Regulation.

**The approval date is August 2, 1996.** Please indicate this approval on the claim record.

If you have any questions regarding this correspondence, please contact Bruce Gates at (705) 670-5856.

Yours sincerely,  
ORIGINAL SIGNED BY:

A handwritten signature in black ink, appearing to read "Ron C. Gashinski".

Ron C. Gashinski  
Senior Manager, Mining Lands Section  
Mines and Minerals Division

*BOE* BIG/jf

cc: Resident Geologist  
Cobalt, Ontario



Assessment Files Library  
Sudbury, Ontario

Ministry of Natural Resources Ontario  
Ministry of Northern Development and Mines

**INDEX TO LAND DISPOSITION**

PLAN  
**G-3694**  
TOWNSHIP  
**NORTH WILLIAMS**

M.N.R. ADMINISTRATIVE DISTRICT  
**KIRKLAND LAKE**  
MINING DIVISION  
**LARDER LAKE**  
LAND TITLES/REGISTRY DIVISION  
**TIMISKAMING**

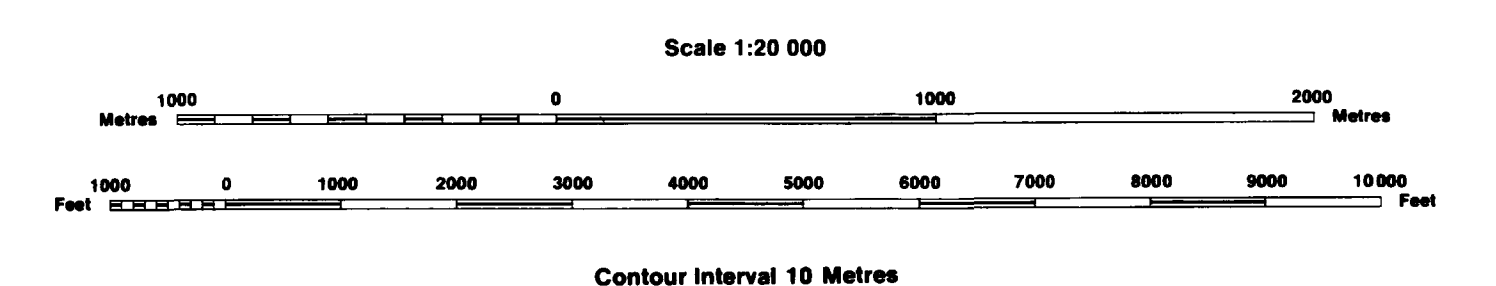

DATE OF ISSUE  
**MAY 13 1996**  
LARDER LAKE  
MINING DIVISION

**AREAS WITHDRAWN FROM DISPOSITION**

MRO - Mining Rights Only  
SRO - Surface Rights Only  
M+S - Mining and Surface Rights

Description	Order No.	Date	Disposition	File
SEC. 26/90	NRW 12/82	3/4/90	S.R.W.	

\*Part of Order NRW 12/82 RE-OPENED by order O-M.C.-90 NER effective April 3, 1990 at 7:00 AM E.S.T.

**SYMBOLS**

Boundary	
Township, Meridian, Baseline	—
Road allowance; surveyed	—
shoreline	—
Lot/Concession; surveyed	—
unsurveyed	—
Parcel; surveyed	—
unsurveyed	—
Right-of-way; road	—
railway	—
utility	—
Reservation	—
Cliff, Pit, Pile	—
Contour	—
Interpolated	—
Approximate	—
Depression	—
Control point (horizontal)	—
Flooded land	—
Mine head frame	—
Pipeline (above ground)	—
Railway; single track	—
double track	—
abandoned	—
Road; highway, county, township	—
access	—
trail, bush	—
Shoreline (original)	—
Transmission line	—
Wooded area	—

**DISPOSITION OF CROWN LANDS**

Patent	
Surface & Mining Rights	●
Surface Rights Only	○
Mining Rights Only	○
Lease	
Surface & Mining Rights	■
Surface Rights Only	□
Mining Rights Only	□
Licence of Occupation	▼
Order-in-Council	OC
Cancelled	○
Reservation	○
Sand & Gravel	○

"THIS MAP SHOWS THE APPROXIMATE LOCATION OF THE BOUNDARIES OF THE AREA WHICH IS THE SUBJECT OF CURRENT LITIGATION. THE EXACT LOCATION WILL BE SHOWN FOLLOWING CONFIRMATION BY THE PARTIES TO THE ACTION."

RECEIVED FEB. 22/95  
CIRCULATED AUG. 19, 1992 B.R.B.

THE INFORMATION THAT APPEARS ON THIS MAP HAS BEEN COMPILED FROM VARIOUS SOURCES AND ACCURACY IS NOT GUARANTEED. THOSE WISHING TO STAKE MINING CLAIMS SHOULD CONSULT WITH THE MINING RECORDER, MINISTRY OF NORTHERN DEVELOPMENT AND MINES, FOR ADDITIONAL INFORMATION ON THE STATUS OF THE LANDS SHOWN HEREON

Map base and land disposition drafting by Surveys and Mapping Branch, Ministry of Natural Resources. The disposition of land, location of lot fabric and parcel boundaries on this index was compiled for administrative purposes only.

