

WORK PREFORMED  
ARCHIE LACARTE

Claim #1223269  
North Williams twp...Landen Lake  
Assessment Filings.....

2.17183

Work Log

Mechanical stripping and trenching  
: Insley Hydraulic Backhoe..yard 3/4 bucket..with operator....\$85.00hr  
: TD9 Bull Dozer with operator....at .....\$55,00hr

July 17/96.....TD9 Bull Dozer move to site &  
excavation south end of claimgroup...8hrs  
at 55.00 hr \$440.00

Prospectors Comments: mobilization- \$400.00  
: encountered sandstone.

July 18/96.....Excavating with Bulldozer  
for test holes.....8hrs  
\$440.00

Prospectors Comments:  
: sandstone..very little pebble conglomerate

July 19/96.....T.D.9 Bulldozer  
moved machine to North End  
of Claim Group .....8hrs  
\$440.00

Prospectors Comments:  
Hematite staining in sand

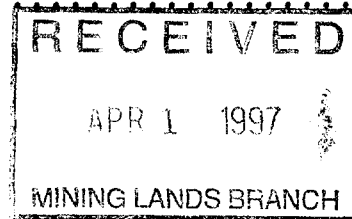

CLAIM NUMBER 1223261  
July 20/96.....Bulldozer  
excavating outcrop.....8hrs  
\$440.00

Prospectors Comments:  
: sandstone no mineral

July 21/96 .....Bulldozer Westside  
Excavating.....8hrs  
\$440.00

Prospectors Comments:  
: located sandstone  
: 50% increase in hematite staining

July 22/96.....Bulldozer  
moved machine back to South end  
of claim group.....8hrs  
\$440.00

Prospectors Comments:  
: Excavating on a North-South Ridge  
: very minor copper showing



WORK PREFORMED  
ARCHIE LACARTE

CLAIM # 1223269  
North Williams twp....Landen Lake  
Assessment Filings...

Work Log continued

July 23/96 .....Bulldozer  
Trenching..PIT.SITES.....8hrs  
Prospectors Comments: \$440.00

:Quartz pebble conglomerate & sandstone

July 28/96.....Bulldozer  
Trenching of 4 pits.....8hrs  
\$440.00

July 29/96.....Bulldozer  
Trenching..PIT.SITES.....8hrs  
\$440.00

Prospectors Comments:

:located main quartz pebble conglomerate bed.

: ON going work SCHEDULED FOR 1997 - SUMMER/FALL

Total Work Reported this filing.....\$4,360.00

includes \$400.00 mobilization to site.

all work to be accredited to claim #1223244

a 16claim group unit.

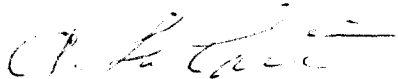

Archie Lacarte

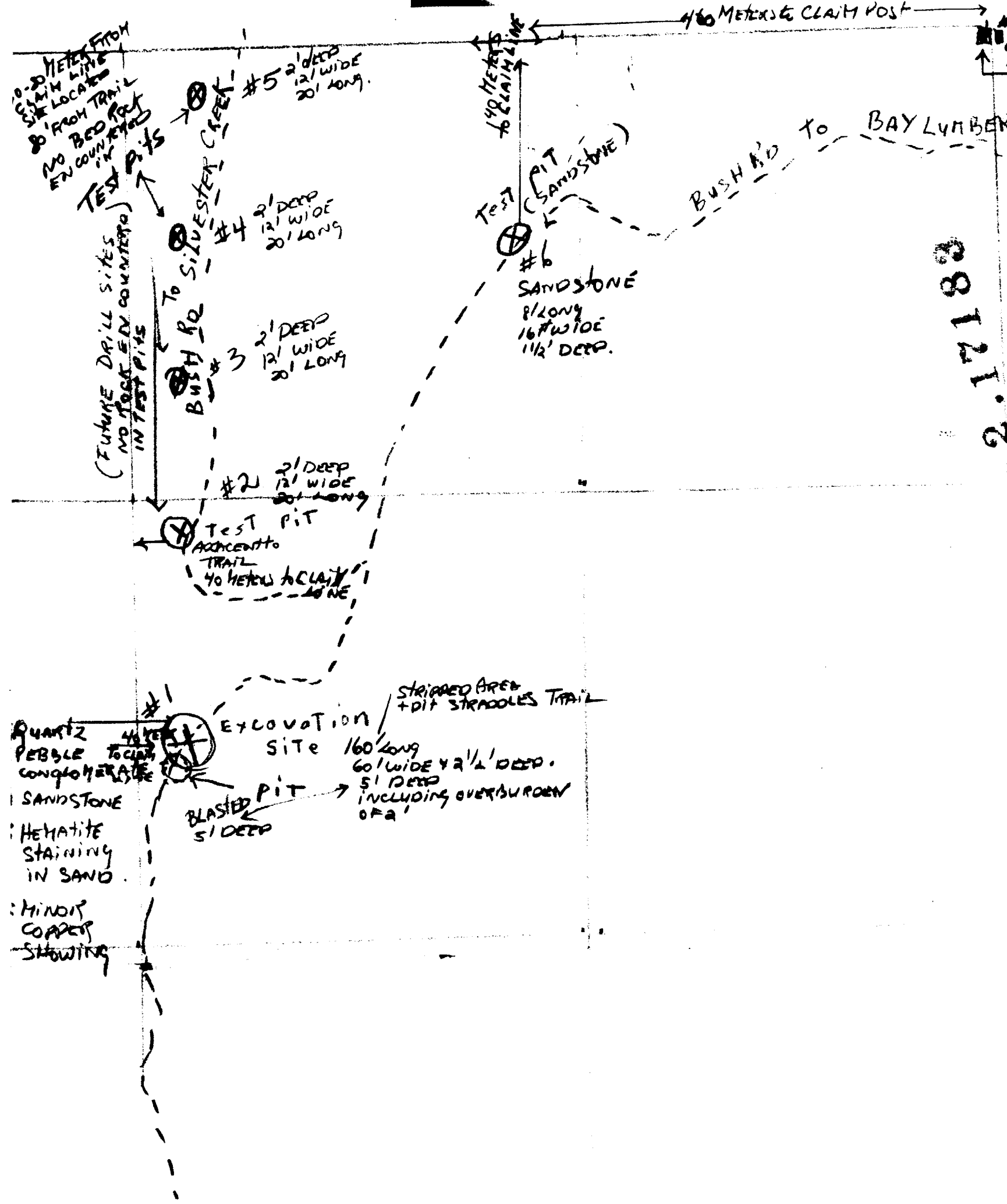

#1 POST ALSO #3 POST FOR CLAIM # 1223269 CLAIM # 1223244

CLAIM # 1223269  
12 UNITS

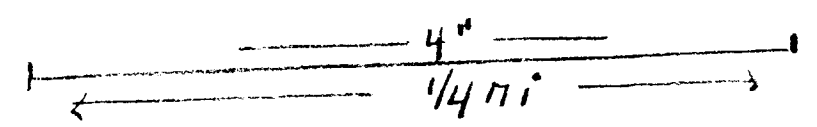

RECEIVED WORTH WILLIAMS TWP.  
APR 1 1997 - ONGOING WITH 1997 WORK PROGRAMS. WILL INCLUDE SOIL SAMPLING + ASSAYS.  
MINING LANDS BRANCH

[ASTRONOMIC BEARING.]

DUPLICATE COPY

Total area scrub Black spruce and balsam

RESUBMITTED JULY 3/97

*A. L. Curt*

Claim # 1223261  
4 UNITS

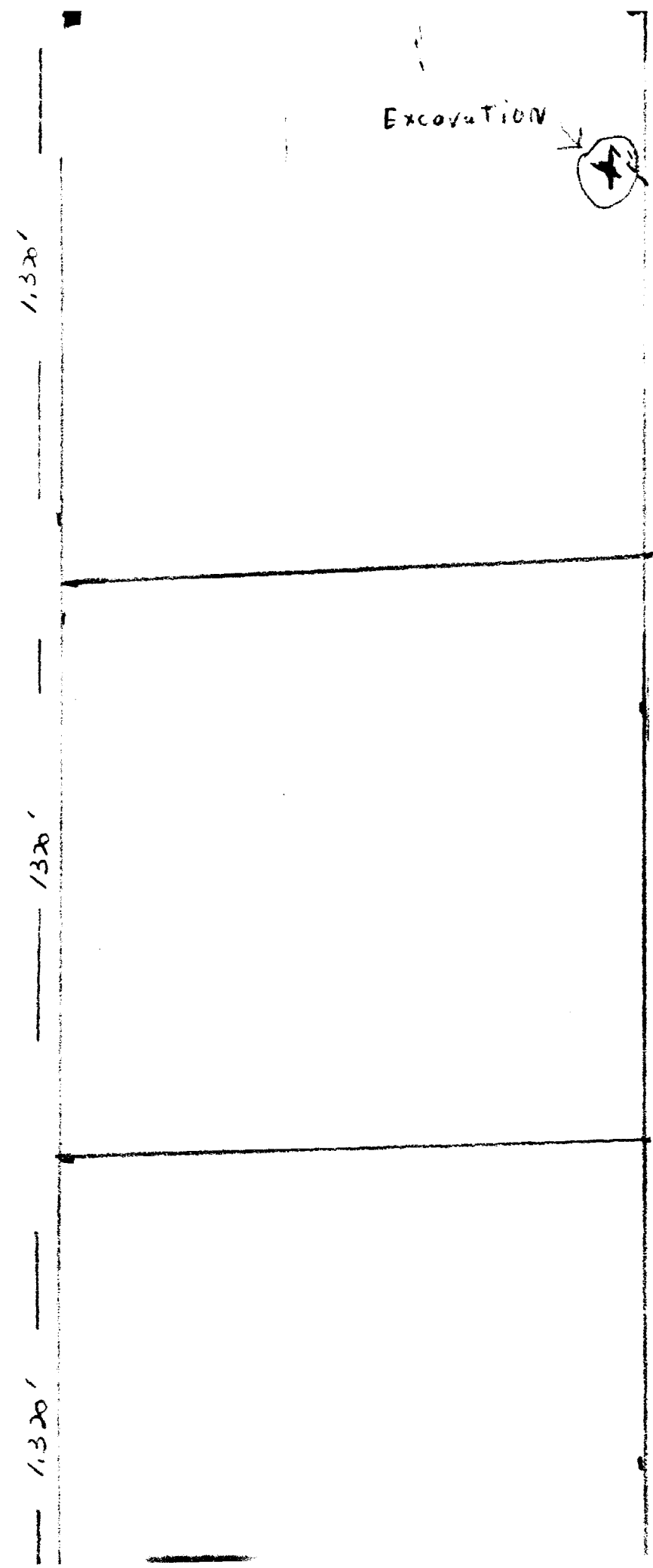

CLAIM # 1223261  
4 UNITS

SCALE

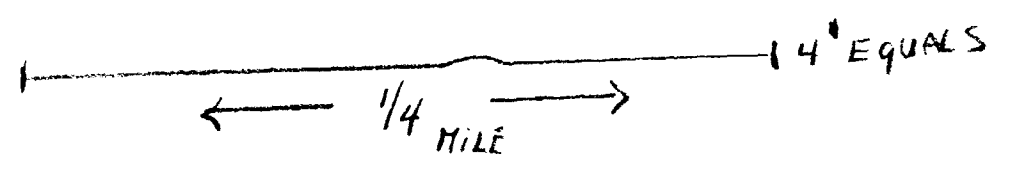

NORTH WILLIAMS TWP.

2.17183

DUPLICATE  
COPY

RECEIVED
APR 1 1997
MINING LANDS BRANCH

Total area  
scrub Black spruce  
and balsam



### Declaration of Assessment Work Performed on Mining Land

Mining Act, Subsection 65(2) and 66(3), R.S.O. 1990

Transaction Number (office use) <b>W 9780.00202</b>
Assessment Files Research Imaging

Personal Inform Mining Act, the Questions about 933 Ramsey La



?) and 66(3) of the Mining Act. Under section 8 of the ment work and correspond with the mining land holder. y of Northern Development and Mines, 6th Floor,

900

**2.17183**

**Instructions:** - For work performed on Crown Lands before recording a claim, use form 0240.  
- Please type or print in ink.

**1. Recorded holder(s) (Attach a list if necessary)**

Name <i>Anchie LaCante</i>	Client Number <i>155166</i>
Address <i>C/O General Delivery Gowganda Ont. P09 1G0</i>	Telephone Number <i>705-624-2496</i>
	Fax Number
Name	Client Number
Address	Telephone Number
	Fax Number

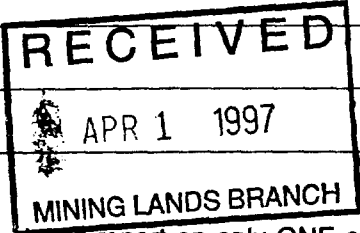

**2. Type of work performed:** Check ( ) and report on only ONE of the following groups for this declaration.

Geotechnical: prospecting, surveys, assays and work under section 18 (regs)      Physical: drilling, stripping, trenching and associated assays      Rehabilitation

Work Type <i>Mechanical stripping and excavating</i>	Office Use
	Commodity
	Total \$ Value of Work Claimed <i>4360</i>
Dates Work Performed From <i>17 07 96</i> To <i>29 07 96</i>	NTS Reference
Global Positioning System Data (if available)	Mining Division <i>Lander Lake</i>
Township/Area <i>North Williams twp</i>	Resident Geologist District <i>Cobalt</i>
M or G-Plan Number <i>G 3694</i>	

Please remember to: - obtain a work permit from the Ministry of Natural Resources as required;  
- provide proper notice to surface rights holders before starting work;  
- complete and attach a Statement of Costs, form 0212;  
- provide a map showing contiguous mining lands that are linked for assigning work;  
- include two copies of your technical report.

**3. Person or companies who prepared the technical report (Attach a list if necessary)**

Name <i>Anchie LaCante as above</i>	Telephone Number
Address	Fax Number
Name	Telephone Number
Address	Fax Number
Name	Telephone Number
Address	Fax Number

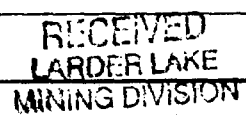

*MAR 24 1997 10:04 L.*

**4. Certification by Recorded Holder or Agent**

I, *Anchie LaCante* (Print Name), do hereby certify that I have personal knowledge of the facts set forth in this Declaration of Assessment Work having caused the work to be performed or witnessed the same during or after its completion and, to the best of my knowledge, the annexed report is true.

Signature of Recorded Holder or Agent <i>[Signature]</i>	Date <i>March 19/97</i>
Agent's Address <i>General Delivery Gowganda Ont</i>	Telephone Number <i>624-2496</i>
	Fax Number

5. Work to be recorded and distributed. Work can only be assigned to claims that are contiguous (adjoining) the mining land where work was performed, at the time work was performed. A map showing the contiguous link must accompany this form.

Mining Claim Number. Or if work was done on other eligible mining land, show in this column the location number indicated on the claim map.	Number of Claim Units. For other mining land, list hectares.	Value of work performed on this claim or other mining land.	Value of work applied to this claim.	Value of work assigned to other mining claims.	Bank. Value of work to be distributed at a future date.
eg TB 7827	16 ha	\$26,825	N/A	2.17 \$24,000	3 \$2,825
eg 1234567	12	0	\$24,000	0	0
eg 1234568	2	\$8,892	\$4,000	0	\$4,892
1 1223269	12	\$3,040.00	000	\$3,040.00	
2 1223261	4	\$1,320.00	000	\$1,320.00	
3 1223244	16	000	\$4360.00		
4					
5					
6					
7					
8					
9					
10					
11					
12					
13					
14					
15					
<b>Column Totals</b>		\$4,360.00	\$4,360.00	\$4,360.00	

**RECEIVED**  
 APR 1 1997  
 MINING LANDS BRANCH

I, Anctie LaCante (Print Full Name), do hereby certify that the above work credits are eligible under subsection 7 (1) of the Assessment Work Regulation 6/96 for assignment to contiguous claims or for application to the claim where the work was done.

Signature of Recorded Holder or Agent Authorized in Writing: [Signature] Date: March 19/97

**6. Instructions for cutting back credits that are not approved.**

Some of the credits claimed in this declaration may be cut back. Please check (✓) in the boxes below to show how you wish to prioritize the deletion of credits:

- 1. Credits are to be cut back from the Bank first, followed by option 2 or 3 or 4 as indicated.
- 2. Credits are to be cut back starting with the claims listed last, working backwards; or
- 3. Credits are to be cut back equally over all claims listed in this declaration; or
- 4. Credits are to be cut back as prioritized on the attached appendix or as follows (describe):

Note: If you have not indicated how your credits are to be deleted, credits will be cut back from the Bank first, followed by option number 2 if necessary.

**For Office Use Only**

Received Stamp RECEIVED MINING LANDS BRANCH MAR 24 1997 10:04Z	Deemed Approved Date <u>97 March 22</u>	Date Notification Sent
	Date Approved <u>[Signature]</u>	Total Value of Credit Approved <u>4360</u>
Approved for Recording by Mining Recorder (Signature) <u>[Signature]</u>		

Personal information collected on this form is obtained under the authority of subsection 8(1) of the Assessment Work Regulation 6/96. Under section 8 of the Mining Act, the information is a public record. This information will be used to review the assessment work and correspond with the mining land holder. Questions about this collection should be directed to the Chief Mining Recorder, Ministry of Northern Development and Mines, 6th Floor, 933 Ramsey Lake Road, Sudbury, Ontario, P3E 6B5.

2.17183

Work Type	Units of Work <small>Depending on the type of work, list the number of hours/days worked, metres of drifting, kilometres of grid line, number of samples, etc.</small>	Cost Per Unit	Total Cost
Mechanical stripping & excavating TD 9 Bulldozer		55.00 hr. with operator x 72 hrs	\$3,960.00
Associated Costs (e.g. supplies, mobilization and demobilization). Move bulldozer to site			\$400.00
Transportation Costs			
Food and Lodging Costs			
<b>Total Value of Assessment Work</b>			<b>\$4,360.00</b>

RECEIVED  
APR 1 1997  
MINING LANDS BRANCH

Calculations of Filing Discounts:

1. Work filed within two years of performance is claimed at 100% of the above Total Value of Assessment Work.
2. If work is filed after two years and up to five years after performance, it can only be claimed at 50% of the Total Value of Assessment Work. If this situation applies to your claims, use the calculation below:

TOTAL VALUE OF ASSESSMENT WORK  $\times 0.50 =$  Total \$ value of worked claimed.

Note:

- Work older than 5 years is not eligible for credit.
- A recorded holder may be required to verify expenditures claimed in this statement of costs within 45 days of a request for verification and/or correction/clarification. If verification and/or correction/clarification is not made, the Minister may reject all or part of the assessment work submitted.

Certification verifying costs:

I, Archie LaCante (please print full name), do hereby certify, that the amounts shown are as accurate as may reasonably be determined and the costs were incurred while conducting assessment work on the lands indicated on the accompanying Declaration of Work form as Recorded Holder I am authorized (recorded holder, agent, or state company position with signing authority) to make this certification.

Signature: Archie LaCante Date: March 19/97

Ministry of  
Northern Development  
and Mines

Ministère du  
Développement du Nord  
et des Mines



Geoscience Assessment Office  
933 Ramsey Lake Road  
6th Floor  
Sudbury, Ontario  
P3E 6B5

July 8, 1997

Roy Spooner  
Mining Recorder  
4 Government Road East  
Kirkland Lake, ON  
P2N 1A2

Telephone: (705) 670-5853  
Fax: (705) 670-5863

Dear Sir or Madam:

Submission Number: 2.17183

**Status**

**Subject: Transaction Number(s):** W9780.00202 Approval After Notice

---

We have reviewed your Assessment Work submission with the above noted Transaction Number(s). The attached summary page(s) indicate the results of the review. WE RECOMMEND YOU READ THIS SUMMARY FOR THE DETAILS PERTAINING TO YOUR ASSESSMENT WORK.

If the status for a transaction is a 45 Day Notice, the summary will outline the reasons for the notice, and any steps you can take to remedy deficiencies. The 90-day deemed approval provision, subsection 6(7) of the Assessment Work Regulation, will no longer be in effect for assessment work which has received a 45 Day Notice.

Please note any revisions must be submitted in DUPLICATE to the Geoscience Assessment Office, by the response date on the summary.

NOTE: This correspondence may affect the status of your mining lands. Please contact the Mining Recorder to determine the available options and the status of your claims.

If you have any questions regarding this correspondence, please contact Lucille Jerome by e-mail at [jerome\\_l@torv05.ndm.gov.on.ca](mailto:jerome_l@torv05.ndm.gov.on.ca) or by telephone at (705) 670-5858.

Yours sincerely,

A handwritten signature in black ink, appearing to read "Ron C. Gashinski".

ORIGINAL SIGNED BY  
Ron C. Gashinski  
Senior Manager, Mining Lands Section  
Mines and Minerals Division



## Work Report Assessment Results

---

**Submission Number:** 2.17183

**Date Correspondence Sent:** July 08, 1997

**Assessor:** Lucille Jerome

---

<b>Transaction Number</b>	<b>First Claim Number</b>	<b>Township(s) / Area(s)</b>	<b>Status</b>	<b>Approval Date</b>
W9780.00202	1223269	NORTH WILLIAMS	Approval After Notice	July 08, 1997

**Section:**

10 Physical PSTRIIP

**Correspondence to:**

Mining Recorder  
Kirkland Lake, ON

Resident Geologist  
Cobalt, ON

Assessment Files Library  
Sudbury, ON

**Recorded Holder(s) and/or Agent(s):**

ARCHIE ALBANY LACARTE  
GOWGANDA, Ontario

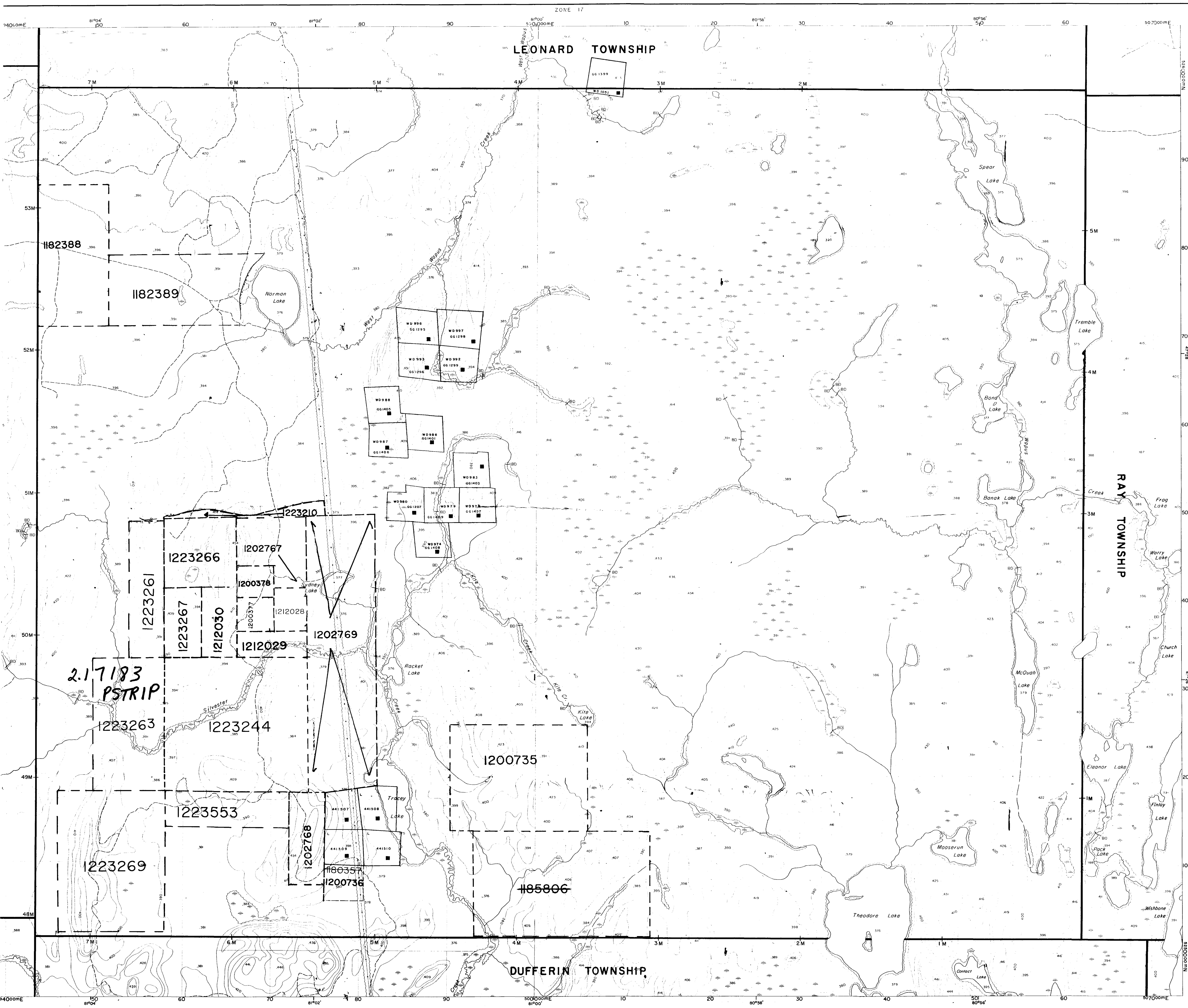

**INDEX TO LAND DISPOSITION**

**PLAN**  
 G-3694  
**TOWNSHIP**  
 NORTH WILLIAMS

**M.N.R. ADMINISTRATIVE DISTRICT**  
 KIRKLAND LAKE  
**MINING DIVISION**  
 LARDER LAKE  
**LAND TITLES/REGISTRY DIVISION**  
 TIMISKAMING

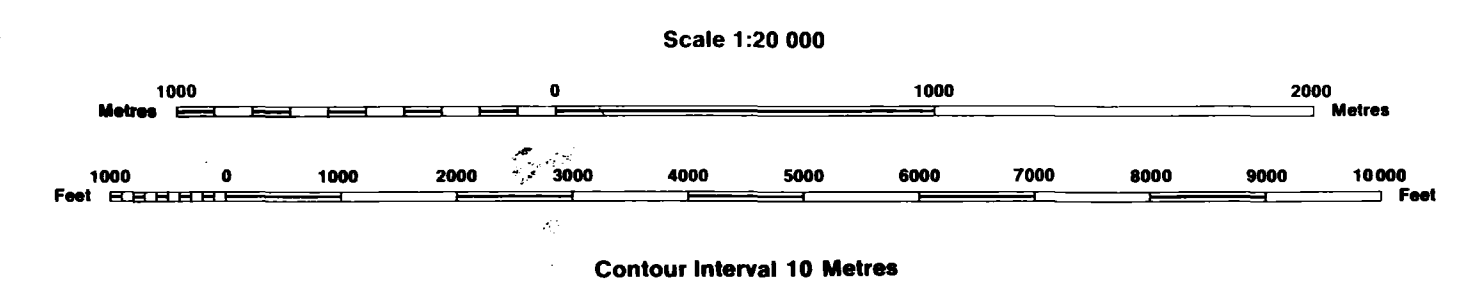

**SYMBOLS**

- Boundary
- Township, Meridian, Baseline
- Road allowance; surveyed
- shoreline
- Lot/Concession; surveyed
- unsurveyed
- Parcel; surveyed
- unsurveyed
- Right-of-way; road
- railway
- utility
- Reservation
- Cliff, Pit, Pile
- Contour
- Interpolated
- Approximate
- Depression
- Control point (horizontal)
- Flooded land
- Mine head frame
- Pipeline (above ground)
- Railway; single track
- double track
- abandoned
- Road; highway, county, township
- access
- trail, bush
- Shoreline (original)
- Transmission line
- Wooded area

**AREAS WITHDRAWN FROM DISPOSITION**

- MRO - Mining Rights Only
- SRO - Surface Rights Only
- M + S - Mining and Surface Rights

Description	Order No.	Date	Disposition	File
-------------	-----------	------	-------------	------

**DISPOSITION OF CROWN LANDS**

- Patent
- Surface & Mining Rights
- Surface Rights Only
- Mining Rights Only
- Lease
- Surface & Mining Rights
- Surface Rights Only
- Mining Rights Only
- Licence of Occupation
- Order-in-Council
- Cancelled
- Reservation
- Sand & Gravel

THIS MAP SHOWS THE APPROXIMATE LOCATION OF THE BOUNDARIES OF THE AREA WHICH IS THE SUBJECT OF CURRENT LITIGATION. THE EXACT LOCATION WILL BE SHOWN FOLLOWING CONFIRMATION BY THE PARTIES TO THE ACTION.

RECORDED SEPT. 19, 1996  
 ARCHIVED FEB. 22/95  
 CIRCULATED AUG. 19, 1992 B.R.B.

**2.17183**

THE INFORMATION APPEARS ON THIS HAS BEEN COM FROM VARIOUS SOI AND ACCURACY IS GUARANTEED. T WISHING TO STAKE ING CLAIMS SHOULD SULT WITH THE A RECORDER, MINIST NORTHERN DEV. ENT AND MINES. F. DITIONAL INFORM ON THE STATUS O LANDS SHOWN HER

#4 POST

#1 Post

CLAIM # 1223269  
12 UNITS

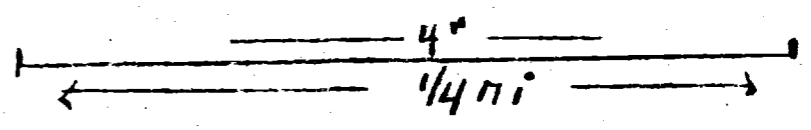

NORTH WILLIAMS TWP



TEST PIT  
(FUTURE DRILL SITES  
NO TEST & IN DOWNHOLE  
IN TEST PITS)

TO SILVESTER CREEK  
BUSHAD

TEST PIT  
(SANDSTONE)

BUSHAD TO BAY LUMBER RD

TEST PIT

88121.8

Total area  
scrub Black spruce  
and balsam

QUARTZ  
PEBBLE  
CONGLOMERATE

EXCAVATION  
SITE  
BLASTED PIT

RECEIVED  
APR 1 1997  
MINING LANDS BRANCH



210

#3 POST

#2 Post

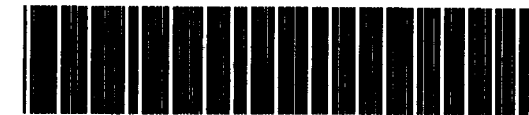

claim # 1223261  
4 UNITS

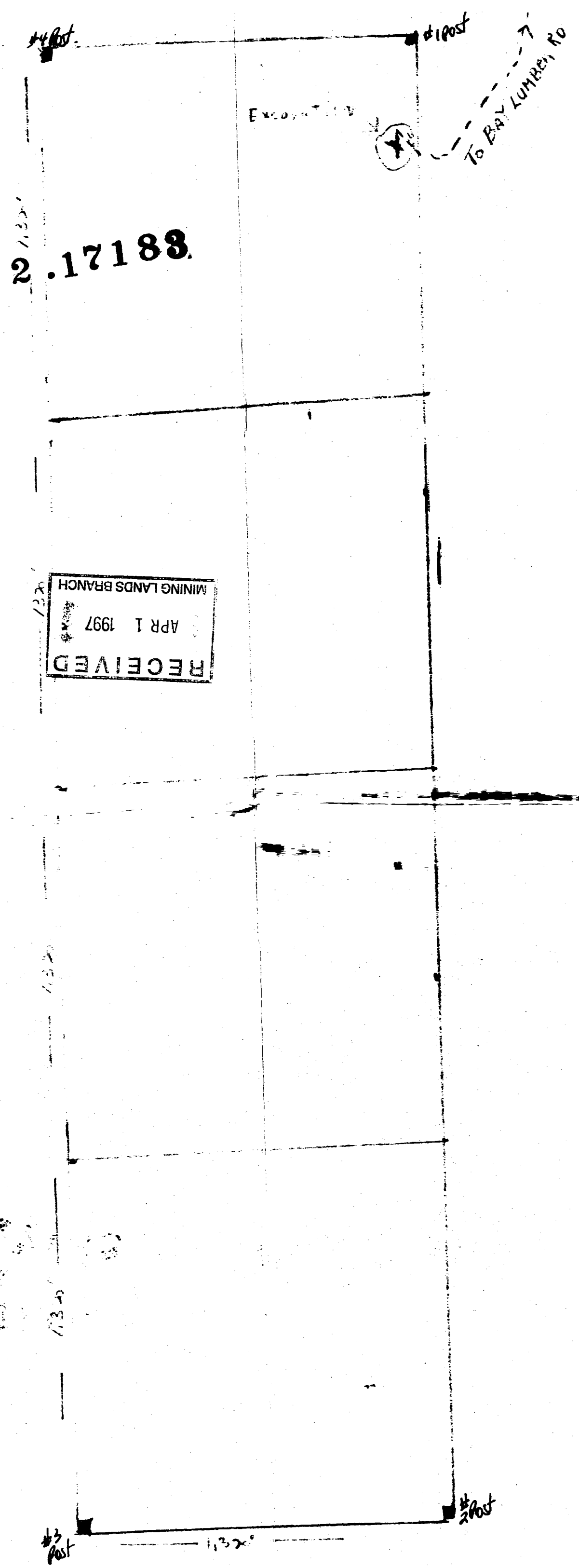

CLAIM # 1223261  
4 UNITS

SCALE

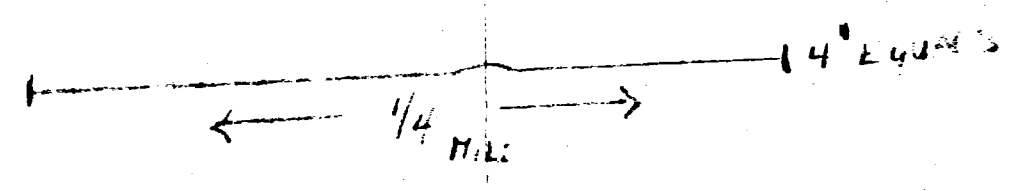

NORTH WILLIAMS TWP

Total area  
scrub Black spruce  
and balsam