



41P06NE2012 2.20503 SHEARD

010

ASSESSMENT WORK REPORT

REPORT ON TRENCHING, WASHING, MAPPING

AND

SAMPLING PROGRAM

ON

CLAIM NO. 1185494

SHEARD TOWNSHIP, LARDER LAKE MINING DIVISION

SHINING TREE AREA

NTS 41-P-06

August 15, 2000

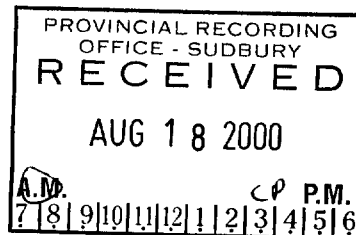

***J.L. Tindale
Geologist***

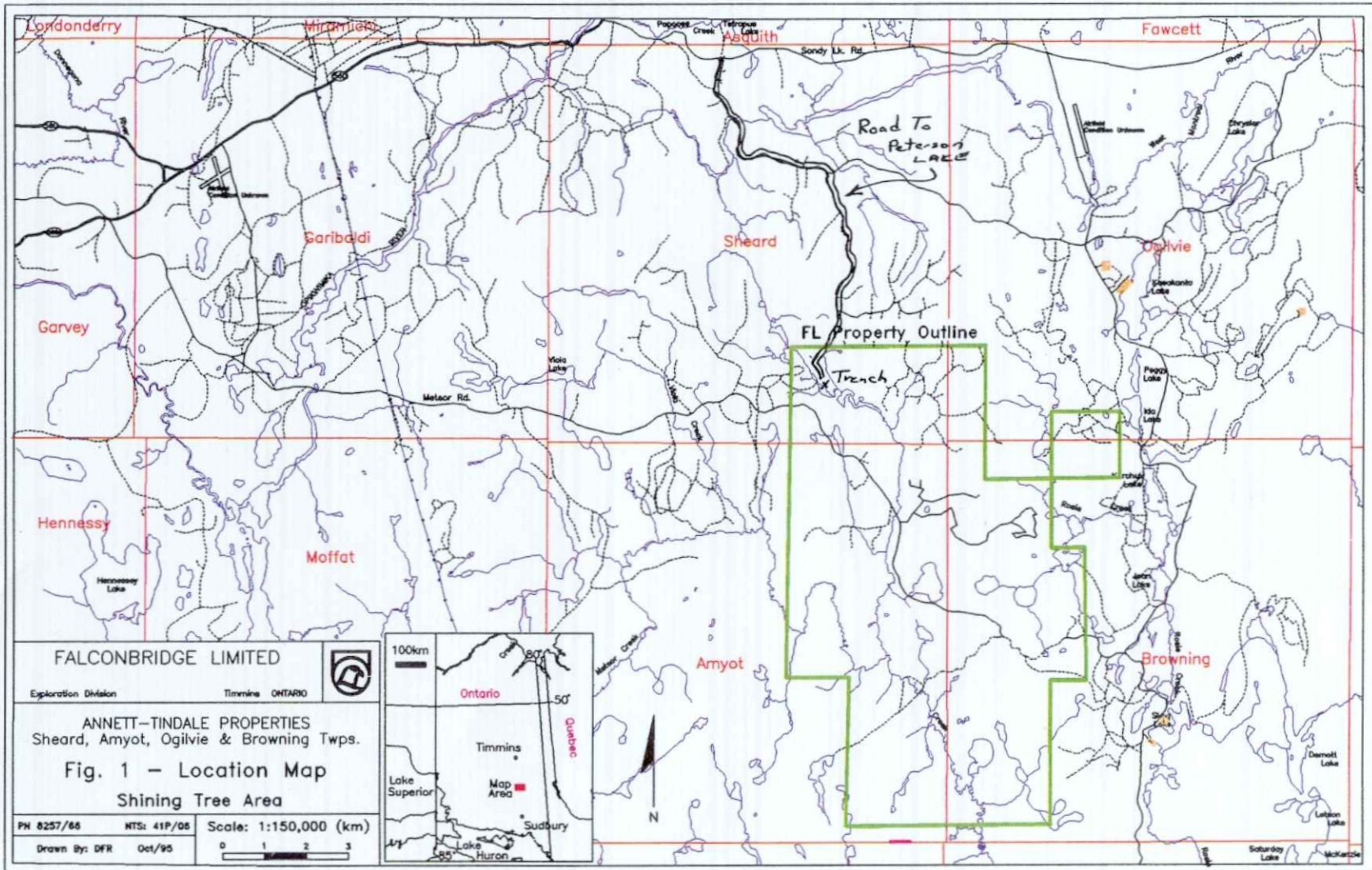

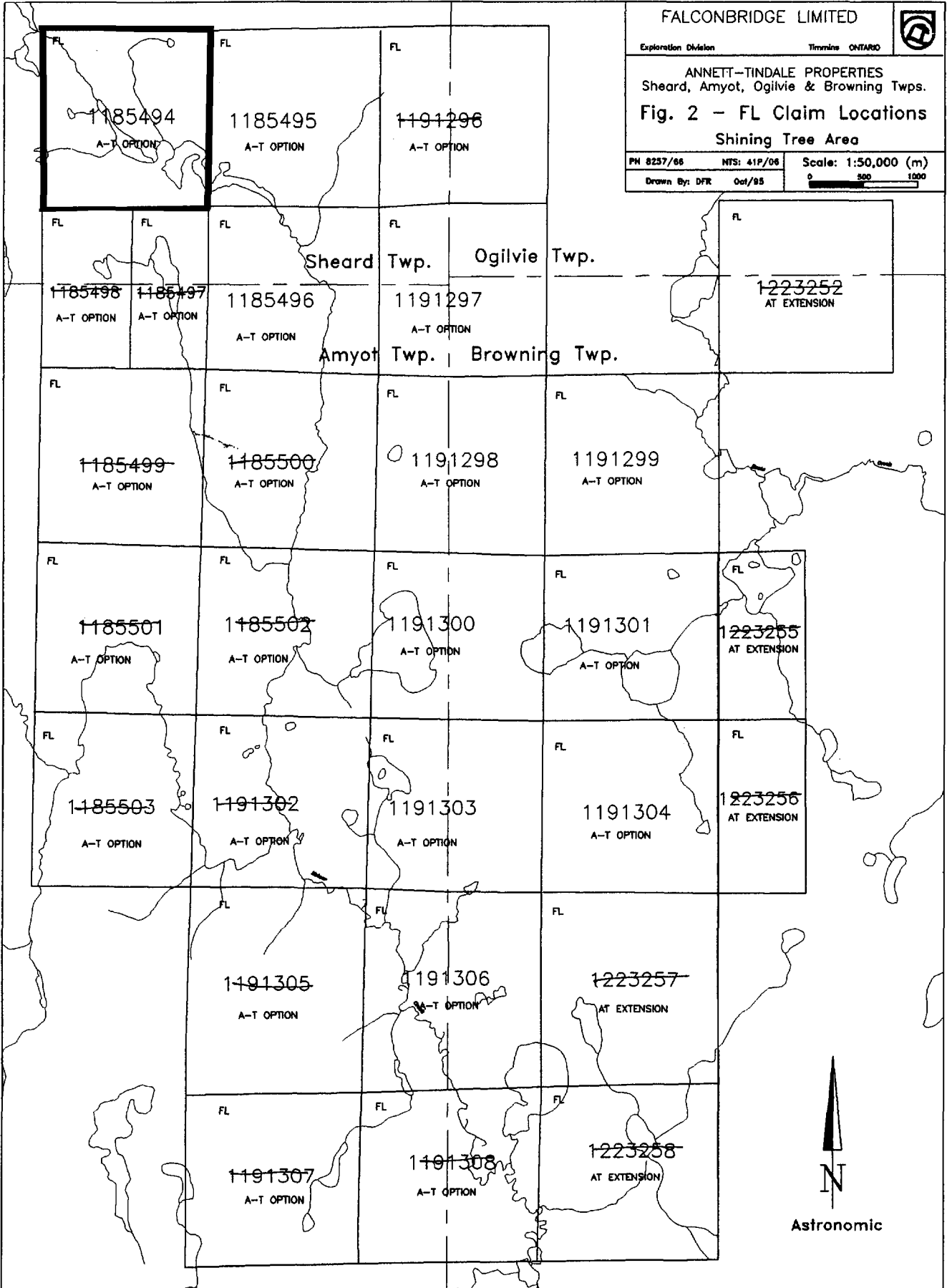

INTRODUCTION

The Peterson Lake showing in Sheard Township was discovered by prospector Roy Annett in the early 1990's and led to a staking flurry in the area which ultimately covered much of Browning, Amyot and Ogilvie Townships. Follow-up airborne and ground geophysical surveys, principally by Falconbridge in 1995 and 1996, focused attention onto strong anomalous responses in Browning and Amyot Townships. Drilling confirmed the presence of massive to semi-massive base metal sulphides though in sub-economic grades. During this activity the original Peterson Lake showing received little follow-up work principally due to the lack of a geophysical response over the showing.

The 2000 trenching program was designed to cross cut the host formation and freshen up the showing in the hopes of interesting a mining group in drilling the prospect. The following describes the work carried out.

LOCATION AND ACCESS

The property is located in the southeastern corner of Sheard Township and is accessible from the village of Shining Tree via Hwy. 560, 8 km west to the Sandy Lake Road and thence 3 km easterly to a forestry access road which meanders southerly to within 100 metres of the showing on Peterson Lake, a total distance from Shining Tree of 23.4 km. Figure 1 attached depicts the location of the road network.

CLAIM HOLDINGS

The writer is the registered owner of eleven contiguous claim blocks which includes the subject area of work.

<u>CLAIM NO.</u>	<u>TOWNSHIP</u>	<u>UNITS</u>	<u>RECORD DATE</u>
1185494	Sheard	16	August 21, 1992
1185495	"	16	September 16, 1992
1185496	"	16	November 9, 1992
1191297	Ogilvie	16	November 9, 1992
1191298	Browning	16	November 9, 1992
1191299	"	16	November 9, 1992
1191300	"	16	November 9, 1992
1191301	"	16	November 9, 1992
1191303	"	16	November 9, 1992
1191304	"	16	November 9, 1992
1191306	"	16	November 9, 1992

Figure 2 depicts the current property holdings.

Ontario Ministry of Northern Development and Mines
Mines and Minerals Division

M-1107 - SHEARD - LARDER LAKE Division



Zoom Tools

help



Zoom Level

GO

Adjacent Map

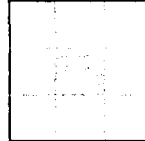

help

Order Hard Copy Map help

Download Full Scale image help

Order Form

Download

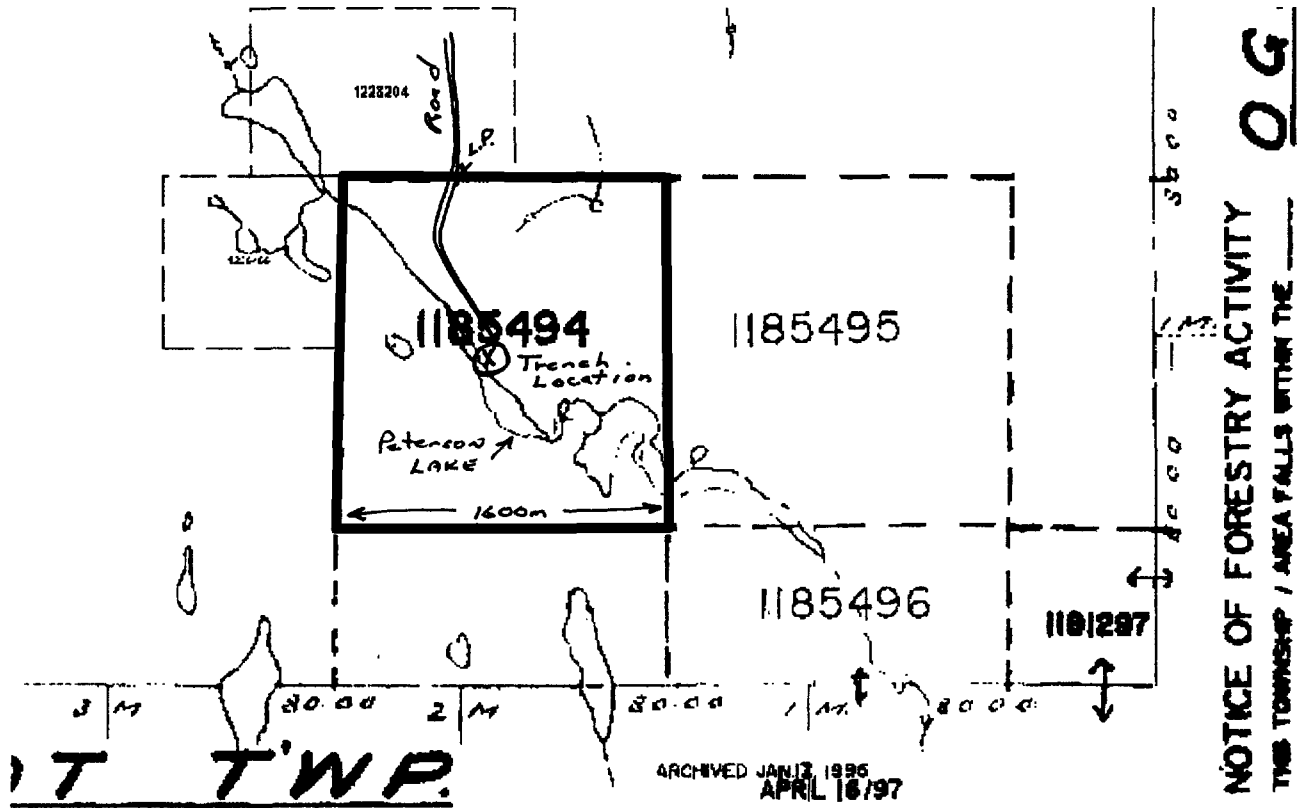

IT TWP.

10. Driveway streets

LOCATION MAP
& Claim MAP SHEARD
TOWNSHIP.

Back | Main Menu | Mining Lands

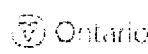

This site maintained by the Government of Ontario
Comments and feedback to: steve.beneteau@ndm.gov.on.ca

© Copyright 1998 Queen's Printer for Ontario

This information is provided as a public service, but we cannot guarantee that the information is current or accurate. Readers should verify the information before acting on it.

SAMPLE RESULTS

SAMPLE Nos.	ASSAY VALUES			Au gm/t	Ag gm/t
	Cu %	Pb %	Zn %		
#1 444	0.28	5.12	0.19	0.01	2.6
#2 445	1.32	2.03	1.33	0.04	9.5
#3 446	0.13	0.25	0.39	0.02	3.2
#4 447	0.43	0.66	0.24	0.01	3.6
#5 448	0.01	0.02	0.01	0.08	1.2
#6 449	0.005	0.04	0.02	0.01	0.8

CLAIM # 1185494

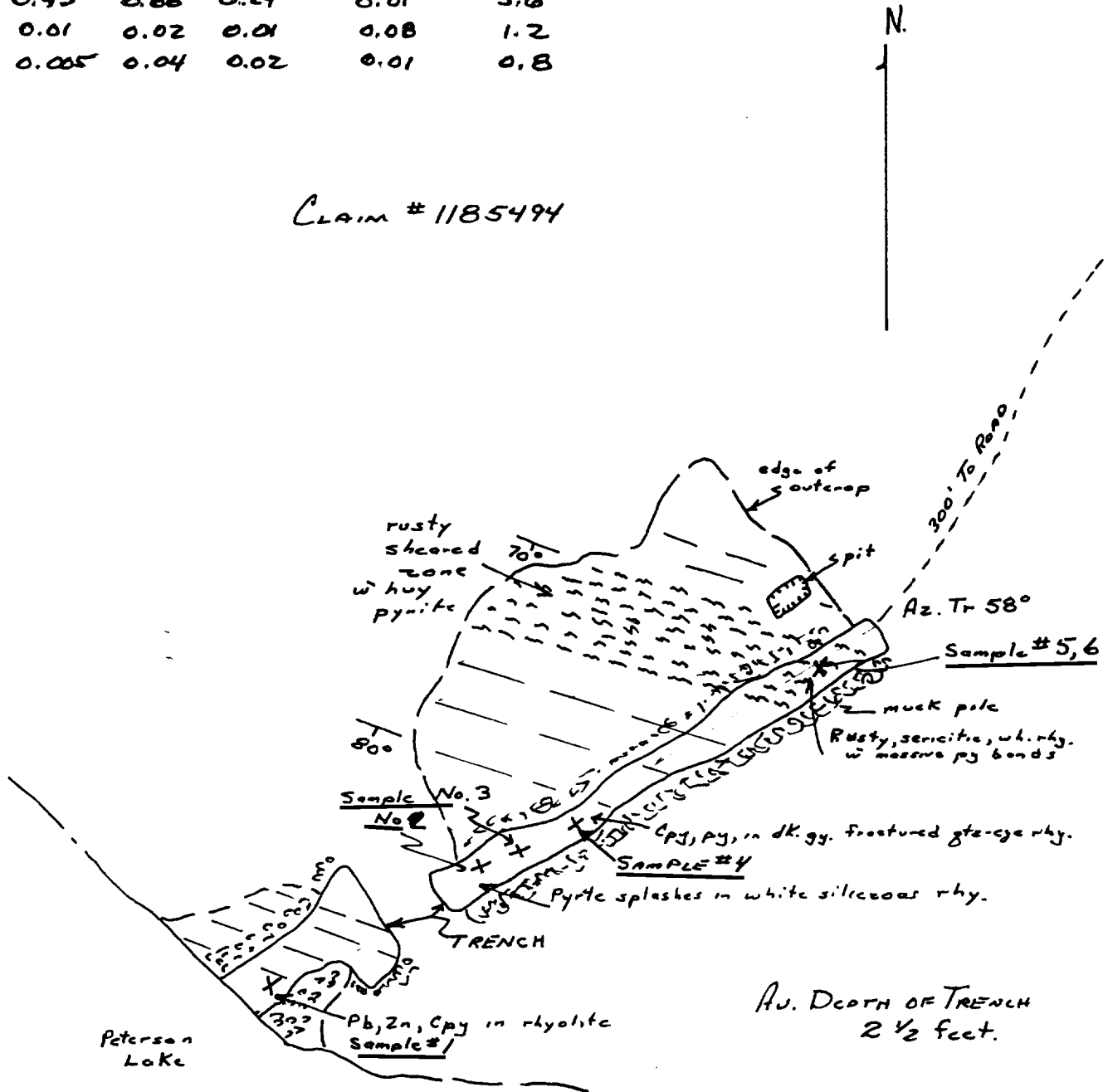

AU. DEPTH OF TRENCH
2 1/2 feet.

PETERSON LAKE SHOWING
Plan of TRENCH & STRIPPING
Claim No. 1185494
SHEARD TOWNSHIP
Scale 1" = 20'
Figure 3

GENERAL GEOLOGY

The claim holdings cover a portion of a small (11 x 8 km) isolated outlier of the Abitibi Greenstone belt bounded on the north and west by granitic rocks and overlain by Huronian Supergroup sediments along the eastern margin. The greenstone terrain consists of a predominantly calc-alkaline suite of felsic to intermediate flows and fragmentals with minor intercalated mafic volcanics. The stratigraphy is cut by fine grained mafic to gabbroic and diabase dykes.

THE 2000 TRENCHING PROGRAM

During late June and early July, 2000 Roy Annett of Shining Tree, Larry Salo and Trevor Dowe of Connaught, Ontario moved into the property a compressor and plugger and proceeded to drill approximately 48, 4 foot holes across the strike of a band of white weathering, sericitic quartz-eye rhyolite. The original showing at the northern shore of Peterson Lake was the starting point and the trench was blasted across the strike at an azimuth of 58° for a distance of approximately 90 feet. The trench was mucked out and washed down utilizing a Wajax high pressure pump. Adjacent outcrop to the trench were also washed. On July 29, 2000 the writer mapped and sampled the trench. Six samples were sent for assay to Swastika Laboratories in Swastika, Ontario. Roy Annett is a prospector and a partner with the writer in the property. Larry Salo is a contractor.

The trench is depicted in Figure 3 attached. White weathering grey to dark grey quartz-eye rhyolite is exposed in the trench for approximately 70 feet starting at the water edge of Peterson Lake. The rhyolite is fractured into parallel bands which strike at 276° Az and dip to the southwest at approximately 80°. The rhyolite is quite-siliceous and blocky. Randomly oriented quartz-carbonate veinlets are prolific along fracture planes often carrying sulphide mineralization.

At the lake shore fracturing and veining is most intense accompanied by copious amounts of galena and lesser amounts of sphalerite and chalcopyrite as stringer sulphide-like occurrences. Pyrite is ubiquitous as dissemination and massive streaks with the base metal values. Away from the lake shore showing the quantity of Pb-Zn lessens though chalcopyrite as disseminations and streaks appear to increase across the interval. Pyrite as coarse cubes and fine disseminations also increases with distance from the lake shore.

From 70ft. to 85ft. along the trench from the lakeshore an intensely sheared zone of white chalky rhyolite occurs accompanied by bands up to three inches wide of massive coarsely crystalline pyrite. These pyrite bands appear to have been injected along fracture planes parallel to the schistosity and from assay data enclosed are relatively barren of economic sulphides. Blue quartz-eyes are preserved in this highly sheared band so it is obviously the same rock type to that previously described at the lakeshore.

Figure 3 attached is a plan of the trench with geology and sample locations. Appendix A is a detailed sample description to which the assay certificate is appended.

CONCLUSIONS AND RECOMMENDATIONS

The trench exposes stringer and disseminated base metal sulphides hosted by altered quartz-eye rhyolite. While no economic grades of base metal mineralization was revealed, the setting is conducive to hosting VMS-style deposits.

A single diamond drill hole is proposed to test the mineralized interval exposed in the trench from a setup southwest of the trench on the western shore of Peterson Lake. This would be a winter drilling program.

Respectfully submitted

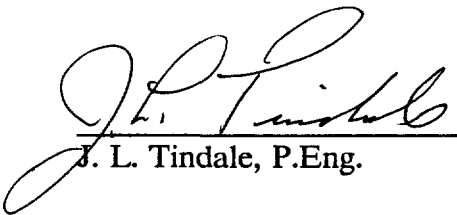

J. L. Tindale, P.Eng.

APPENDIX A

SAMPLE LOG

PETERSON LAKE - SHEARD TOWNSHIP, JULY 29, 2000

- No. 1 **Sample #444** Selected grab @ 0+00 on tape line. Med. grained, blue qtz-eye rhyolite; qtz-eyes stretched parallel to foliation; siliceous, brick red incl. of aplite-like material; brecciated in part; galena along hairline fractures and as splashes and inclusions; chalcopyrite as fine diss. and as splashes; pyrite as inclusions and replacements.
Assay for: Cu, Pb, Zn, Au, Ag, 30 element.
- No. 2 **Sample #445** Selected grab @ 0+31 on tape line. Sheared f.g. to med.gr. qtz-eye rhyolite; qtz-eyes white and blue, not stretched; white calcite infilling along fracture planes and as replacements along bedding (?) planes; Hvy. pyrite as massive inclusions and infills along fracture planes; trace of galena.
Assay for: Cu, Pb, Zn, Au, Ag, 30 element.
- No. 3 **Sample #446** Selected grab @ 0+38 on tape line. Sheared f.g. to med.gr. grey qtz-eye tuff, rhyolite; qtz-eyes white and brilliant blue; some large (± 1 ") inclusions white qtz; pyrite semi-massive as streaks and blebs; minor galena smears on fracture planes.
Assay for: Cu, Pb, Zn, Au, Ag, whole rock; 30 element.
- No. 4 **Sample #447** Selected grab @ 0+46 on tape line. Grey, siliceous f.g. qtz-eye rhyolite tuff; streaks of pyrite and chalcopyrite along fracture planes and as veinlets; galena along fractures and hairline veinlets.
Assay for Cu, Pb, Zn, Au, Ag, 30 element.
- No. 5 **Sample #448** Selected grab @ 0+76 on tape line. White to pinkish sheared qtz-eye rhyolite; Altered from grey due to intense shearing; banded w massive med.grd. pyrite along and parallel to bedding plane shears.
Assay for: Cu, Pb, Zn, Au, Ag, whole rock; 30 element.
- No. 6 **Sample #449** Selected grab @ 0+76 on tape line. Similar to 448 but fresher, blue qtz-eyes; less massive py, cubic.
Assay for: Cu Pb, Zn, Au, Ag, whole rock; 30 element.



Established 1928

Swastika Laboratories Ltd

Assaying - Consulting - Representation

Assay Certificate

0W-2447-RA1

Company: **J. TINDALE**
Project: Peterson Lake
Attn: J. Tindale

Date: AUG-09-00

We hereby certify the following Assay of 5 Rock samples submitted JUL-31-00 by .

Sample Number	Au g/tonne	Au Check g/tonne	Ag g/tonne	Cu %	Pb %	Zn %	Multi Element	WRA
444	0.01	-	3.6	0.282	5.12	0.197	Results to follow	Results to follow
445	0.04	-	9.5	1.32	2.03	1.33		
446	0.02	-	3.2	0.134	0.247	0.397		
447	0.01	-	3.6	0.425	0.659	0.244		
448	0.08	0.08	1.2	0.006	0.015	0.007		
449	0.01	-	0.8	0.005	0.037	0.020		

One assay ton portion used.

Certified by Denis Chantre

1 Cameron Ave., P.O. Box 10, Swastika, Ontario P0K 1T0
Telephone (705) 642-3244 Fax (705) 642-3300

P. 02

J. TINDALE
Attention: J. Tindale
Project: Peterson Lake
Sample: Rock

Swastika Laboratories Ltd.
1 Cameron Ave., Swastika, Ontario, P0K 1T0
Tel: (705) 642-3244 Fax: (705) 642-3300

Report No : 0W2447 RL
Date : Aug-21-00

ICP Whole Rock Assay
Lithium Metaborate Fusion

8957

368

1 416

M. D. COULTER & ASSOCIATES

OCT-12-00 09:21 AM

Sample Number	SiO ₂ %	Al ₂ O ₃ %	Fe ₂ O ₃ %	CaO %	MgO %	Na ₂ O %	TiO ₂ %	K ₂ O %	MnO %	P ₂ O ₅ %	LOI %	Ba ppm	Sr ppm	Zr ppm	Sc ppm	Y ppm	Be ppm	Co ppm	Cr ppm	Cu ppm	Ni ppm	V ppm	Zn ppm	Rb %	Nb ppm	Total %
446	56.03	8.29	19.89	0.37	0.96	3.81	0.18	0.22	0.04	0.05	9.36	<10	50	140	4	20	<5	25	705	1170	<5	60	2065	0.01	<10	99.63
448	40.51	4.14	34.41	0.08	0.22	0.78	0.10	1.16	0.01	0.05	10.22	100	20	110	1	5	<5	55	600	45	<5	70	<5	0.02	<10	99.79
449	70.88	12.16	6.12	0.77	0.48	4.80	0.25	1.18	0.02	0.05	2.90	420	90	190	3	30	5	15	835	45	<5	35	65	0.01	<10	99.80

Up to 100 ppm Cr contamination due to sample grinding.

Sample is fused with Lithium metaborate and dissolved in dilute HNO₃.

DATE 00

1 416 700 0000

DATE 10 103 00.01

Transaction Number (office use) W0080.00315
Assessment Files Research Imaging N0080 01006



41P06NE2012 2.20503 SHEARD

900

y of subsections 65(2) and 66(3) of the Mining Act. Under section 8 of the to review the assessment work and correspond with the mining land holder. ng Recorder, Ministry of Northern Development and Mines, 9th Floor,

PROVINCIAL RECORDING OFFICE - SUDBURY	
RECEIVED	
AUG 18 2000	
C.P.M.	
7	8
9	10
11	12
1	2
3	4
5	6

Instructions: - For work performed on Crown Lands before recording a claim, use form 0212
- Please type or print in ink.

1. Recorded holder(s) (Attach a list if necessary)

Name <u>JOHN L. TINDALE</u>	Client Number <u>202125</u>
Address <u>907-110 ERSKINE AVE</u>	Telephone Number <u>416 481 5781</u>
<u>TORONTO ONTARIO M4P1Y4</u>	Fax Number <u>416 481 5781</u>
Name	Client Number
Address	Telephone Number
	Fax Number

2. Type of work performed: Check (✓) and report on only ONE of the following groups for this declaration.

Geotechnical: prospecting, surveys, assays and work under section 18 (regs) Physical: drilling, stripping, trenching and associated assays Rehabilitation

Work Type <u>TRENCHING, WASHING, ASSAYING, SAMPLING, MAPPING TRENCH</u>	Office Use
	Commodity
	Total \$ Value of Work Claimed <u>8511</u>
Dates Work Performed From <u>24</u> Day <u>6</u> Month <u>00</u> Year To <u>29</u> Day <u>7</u> Month <u>00</u> Year	NTS Reference
Global Positioning System Data (if available)	Mining Division <u>harder lake</u>
Township/Area <u>SHEARD</u>	Resident Geologist District <u>Kirkland Lake</u>
M or G-Plan Number <u>M 1107</u>	

Please remember to: - obtain a work permit from the Ministry of Natural Resources as required;
- provide proper notice to surface rights holders before starting work;
- complete and attach a Statement of Costs, form 0212;
- provide a map showing contiguous mining lands that are linked for assigning work;
- include two copies of your technical report.

3. Person or companies who prepared the technical report (Attach a list if necessary)

Name <u>JOHN L. TINDALE</u>	Telephone Number <u>416 481 5781</u>
Address <u>907-110 ERSKINE AVE TORONTO ON M4P1Y4</u>	Fax Number <u>416 481 5781</u>
Name	Telephone Number
Address	Fax Number
Name	Telephone Number
Address	Fax Number

RECEIVED
AUG 18 2000 12:00 PM
GEOSCIENCE ASSESSMENT OFFICE

4. Certification by Recorded Holder or Agent

I, JOHN L. TINDALE (Print Name), do hereby certify that I have personal knowledge of the facts set forth in this Declaration of Assessment Work having caused the work to be performed or witnessed the same during or after its completion and, to the best of my knowledge, the annexed report is true.

Signature of Recorded Holder or Agent <u>J. L. Tindale</u>	Date <u>AUGUST 17, 2000</u>
Agent's Address	Telephone Number
	Fax Number

5. **Work to be recorded and distributed.** Work can only be assigned to claims that are contiguous (adjoining) to the mining land where work was performed, at the time work was performed. A map showing the contiguous link must accompany this form.

Mining Claim Number. Or if work was done on other eligible mining land, show in this column the location number indicated on the claim map.	Number of Claim Units. For other mining land, list hectares.	Value of work performed on this claim or other mining land.	Value of work applied to this claim.	Value of work assigned to other mining claims.	Bank. Value of work to be distributed at a future date.
eg TB 7827	16 ha	\$26,825	N/A	\$24,000	\$2,825
eg 1234567	12	0	\$24,000	0	0
eg 1234568	2	\$8,892	\$4,000	0	\$4,892
1 1185494	16	8511	6400		2111
2					
3					
4					
5					
6					
7					
8					
9					
10					
11					
12					
13					
14					
15					
Column Totals		8511	6400		2111

2. 20503

I, JOHN L. TINDALE, do hereby certify that the above work credits are eligible under subsection 7 (1) of the Assessment Work Regulation 6/96 for assignment to contiguous claims or for application to the claim where the work was done.

Signature of Recorded Holder or Agent Authorized in Writing

Date

J. L. Tindale

AUGUST 17, 2000

6. **Instructions for cutting back credits that are not approved.**

Some of the credits claimed in this declaration may be cut back. Please check (✓) in the boxes below to show how you wish to prioritize the deletion of credits:

- 1. Credits are to be cut back from the Bank first, followed by option 2 or 3 or 4 as indicated.
- 2. Credits are to be cut back starting with the claims listed last, working backwards; or
- 3. Credits are to be cut back equally over all claims listed in this declaration; or
- 4. Credits are to be cut back as prioritized on the attached appendix or as follows (describe):

Note: If you have not indicated how your credits are to be deleted, credits will be cut back from the Bank first, followed by option number 2 if necessary.

For Office Use Only

Received Stamp

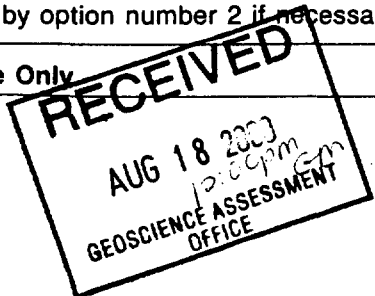

Deemed Approved Date	Date Notification Sent
Date Approved	Total Value of Credit Approved
Approved for Recording by Mining Recorder (Signature)	

Personal information collected on this form is obtained under the authority of subsection 6(1) of the Assessment Work Regulation 6/96. Under section 8 of the Mining Act, the information is a public record. This information will be used to review the assessment work and correspond with the mining land holder. Questions about this collection should be directed to the Chief Mining Recorder, Ministry of Northern Development and Mines, 6th Floor, 933 Ramsey Lake Road, Sudbury, Ontario, P3E 6B5.

Work Type	Units of Work Depending on the type of work, list the number of hours/days worked, metres of drilling, kilometres of grid line, number of samples, etc.	Cost Per Unit of work	Total Cost
2. 20503 Plugging, compressor, washing, blasting dynamite, fuse etc	6 days (INVOICE Attached)	1033	6200.00
Roy ANNETT Supervision and Labour	7 days	200	1400.00
JOHN TINDALE (MAP: sample)	1 day	100	100.00
Associated Costs (e.g. supplies, mobilization and demobilization).			
ASSAYS (receipt)			321.97
WAXAX Pump Rental	2 days	50	100.00
Fuel for Waxax			20.00
TYPING REPORT	3 hours	28	84.00
Photocopies			20.00
Transportation Costs			
Roy ANNETT (7 round trips)	336 Km	0.30/Km	100.80
JOHN TINDALE (1 trip to P.O.)	548 Km	0.30/Km	164.40
Food and Lodging Costs			
Total Value of Assessment Work			\$8511

Calculations of Filing Discounts:

1. Work filed within two years of performance is claimed at 100% of the above Total Value of Assessment Work.
2. If work is filed after two years and up to five years after performance, it can only be claimed at 50% of the Total Value of Assessment Work. If this situation applies to your claims, use the calculation below:

TOTAL VALUE OF ASSESSMENT WORK $\times 0.50 =$ Total \$ value of worked claimed.

Note:

- Work older than 5 years is not eligible for credit.
- A recorded holder may be required to verify expenditures claimed in this statement of costs within 45 days of a request for verification and/or correction/clarification. If verification and/or correction/clarification is not made, the Minister may reject all or part of the assessment work submitted.

Certification verifying costs:

I, JOHN L. TINDALE (please print full name), do hereby certify, that the amounts shown are as accurate as may reasonably be determined and the costs were incurred while conducting assessment work on the lands indicated on the accompanying Declaration of Work done as recorded holder, agent, or state company position with signing authority) I am authorized to make this certification.

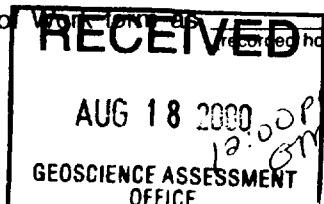

Signature: J. L. Tindale Date: August 17, 2000

Geoscience Assessment Office
933 Ramsey Lake Road
6th Floor
Sudbury, Ontario
P3E 6B5

Telephone: (888) 415-9845

Fax: (877) 670-1555

October 12, 2000

JOHN LAWRENCE TINDALE
907-110 ERSKINE AVE.
TORONTO, Ontario
M4P-1Y4

Visit our website at:
www.gov.on.ca/MNDM/MINES/LANDS/mlsmnpge.htm

Dear Sir or Madam:

Submission Number: 2.20503

Status

Subject: Transaction Number(s): W0080.00315 Approval After Notice

We have reviewed your Assessment Work submission with the above noted Transaction Number(s). The attached summary page(s) indicate the results of the review. **WE RECOMMEND YOU READ THIS SUMMARY FOR THE DETAILS PERTAINING TO YOUR ASSESSMENT WORK.**

If the status for a transaction is a 45 Day Notice, the summary will outline the reasons for the notice, and any steps you can take to remedy deficiencies. The 90-day deemed approval provision, subsection 6(7) of the Assessment Work Regulation, will no longer be in effect for assessment work which has received a 45 Day Notice. Allowable changes to your credit distribution can be made by contacting the Geoscience Assessment Office within this 45 Day period, otherwise assessment credit will be cut back and distributed as outlined in Section #6 of the Declaration of Assessment work form.

Please note any revisions must be submitted in DUPLICATE to the Geoscience Assessment Office, by the response date on the summary.

If you have any questions regarding this correspondence, please contact LUCILLE JEROME by e-mail at lucille.jerome@ndm.gov.on.ca or by telephone at (705) 670-5858.

Yours sincerely,



ORIGINAL SIGNED BY
Steve B. Beneteau
Acting Supervisor, Geoscience Assessment Office
Mining Lands Section

Work Report Assessment Results

Submission Number: 2.20503

Date Correspondence Sent: October 12, 2000

Assessor: LUCILLE JEROME

Transaction Number	First Claim Number	Township(s) / Area(s)	Status	Approval Date
W0080.00315	1185494	SHEARD	Approval After Notice	October 12, 2000

Section:

10 Physical PTRNCH

The revisions outlined in the Notice dated October 5, 2000 have been corrected. Accordingly, assessment work credit has been approved as outlined on the Declaration of Assessment Work Form accompanying this submission.

Correspondence to:

Resident Geologist
Kirkland Lake, ON

Recorded Holder(s) and/or Agent(s):

JOHN LAWRENCE TINDALE
TORONTO, Ontario

Assessment Files Library
Sudbury, ON

MINISTRY OF NATURAL RESOURCES
SURVEYS AND MAPPING BRANCH

PLAN OF SHEARD TWP. LARDER LAKE MINING DIVISION. DISTRICT OF SUDBURY.

#11

THE INFORMATION THAT APPEARS ON THIS MAP HAS BEEN COMPILED FROM VARIOUS SOURCES, AND ACCURACY IS NOT GUARANTEED. THOSE WISHING TO STAKE MINING CLAIMS SHOULD CONSULT WITH THE MINING RECORDER, MINISTRY OF NORTHERN DEVELOPMENT AND MINES, FOR ADDITIONAL INFORMATION ON THE STATUS OF THE LANDS SHOWN HEREON.

Scale 40 chains to an inch.

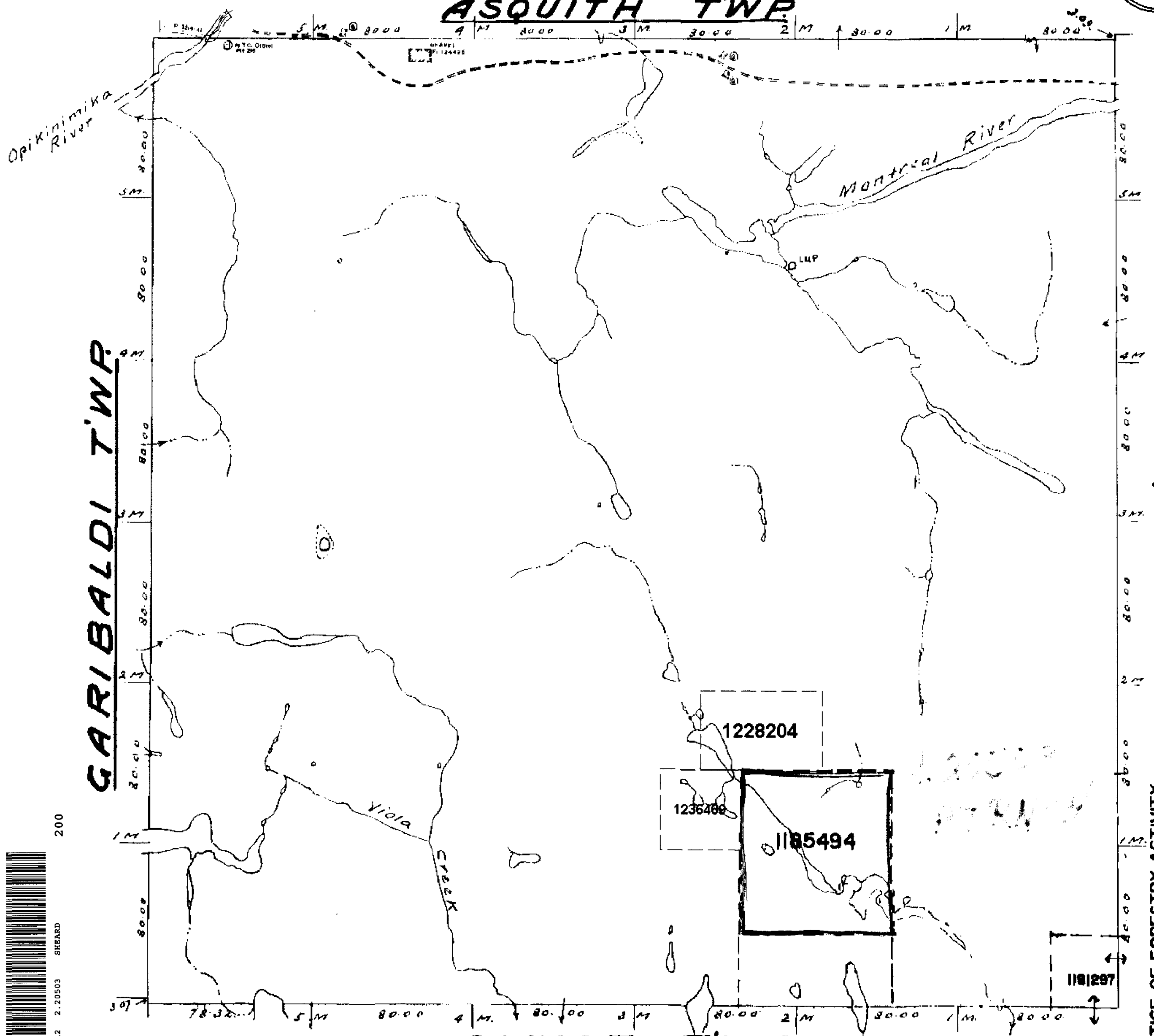
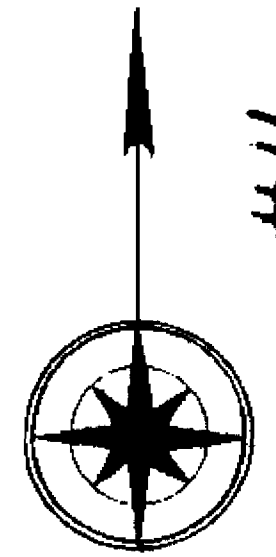

GARIBALDI TWP.

OGILVIE TWP.

AMYOT TWP.

Notes

Railways shown as ... Non-perennial streams as ...

NOTICE OF FORESTRY ACTIVITY
THIS TOWNSHIP / AREA FALLS WITHIN THE
FORESTRY MANAGEMENT UNIT
AND MAY BE SUBJECT TO FORESTRY OPERATIONS
THE MFR UNIT FORESTER FOR THIS AREA CAN BE
CONTACTED AT: P.O. BOX 229
LOW AVERE
SODASIA, ONT.
FROM MFO
705-884-2000

ARCHIVED JAN 18 1996
APRIL 16/97

