



41P06SE0021 2.8420 HODGETTS

010

ASSESSMENT WORK REPORT ON

AN

EIGHT CLAIM BLOCK

HODGETTS TWP ONTARIO

FOR

RANEX MINERALS INC. OF

ST. CATHERINES ONTARIO

SEPTEMBER 1985

RECEIVED

SEP 06 1985

MINING LANDS SECTION

P.A.R. Brown



P.A.R. BROWN, B.Sc., A.R.S.M.
Consulting Mining Geologist
R.R. 1, Corbeil, Ontario POH 1K0
705-752-1123

*Qual. in
2.82*



TABLE OF CONTENTS

PAGE NO.

SUMMARY..... 1

INTRODUCTION..... 2

PROPERTY LOCATION AND ACCESS..... 3

PROPERTY OWNERSHIP..... 4

TOPOGRAPHY TREE COVER AND OVERBURDEN..... 5

GENERAL GEOLOGY AND ECONOMIC GEOLOGY..... 6

OVERBURDEN SAMPLER..... 7

PERSONAL OBSERVATIONS..... 8

SAMPLING AND COSTS..... 9

RECOMMENDATIONS..... 10

REFERENCES..... 11

CERTIFICATION..... 12

APPENDIX....

DRILL LOGS... SECTIONS... LOCATIONS.....

FIG 1 1in to ^{400ft}~~1/2~~ mile drillhole loc. map

FIG 2 1in to 1/2 mile claim map

FIG 3 1in to 8miles surficial map

FIG 4 1in to 4miles placer trend

SUMMARY

Gold bearing palaeoplacers and glacial outwash deposits lie in the area along the Vermillion River Fault. Gold has been found and testing has been carried out on gravels in the Meteor Lake Area in Beulah twp just to the west of the claims held by Ranex Minerals Inc.

It is hoped that testing of the outwash deposits on the Ranex claims will locate a viable placer gold deposit.

The company's address is;

Ranex Minerals Inc.
P.O Box 2362
Station B
St. Catherines Ontario
L2M 7M7
Ph. 416 934-4152
Miner's Licence # T1599

The eight claims concerned in this report have not been previously evaluated as a source of placer gold.

INTRODUCTION

A large block of claims has been staked covering mainly glacial outwash deposits in Beulah, Hodgetts, Marshay Twps.

It is hoped to sample these deposits using an overburden vibra sampler to get samples from depth.

Evaluation of content will be a winter project requiring gravity concentration techniques prior to assaying because of the difficulty in obtaining reliable assays on low grade placer material.

Gold from panning has been noted in the area since the 1800,s although no records of any significant evaluation can be found.

The undersigned was asked to evaluate the overburden sampler and generally guide the future exploration on the claims block.

PROPERTY LOCATION & ACCESS

The eight claims in the report are part of a larger block but it has been decided to drop the remaining ten claims because of little potential for placer type deposits.

The claims are located in the northeast part of Hodgetts Twp, Ontario and lie on and to the south of the Raven Creek drainage system which strikes northeasterly.

Access is by bush road south from highway #560 at a point 28 miles east of highway #144. 24 miles south of #560 one turns west for about $8\frac{1}{2}$ miles then one can use an ARGO road one mile northeast to the southeast corner of the eight claim block.

PROPERTY OWNERSHIP

I have not checked the abstracts of these **eight claims** but have been told that they belong to Ranex Minerals of St. Catherines and are in good standing.

TOPOGRAPHY, TREE COVER, OVERBURDEN

Elevations up to 200' maximum can be expected from the river to the diabase peaks, but generally moderate relief & even sand plains are more common.

Vegetation is dense second growth mainly poplar & spruce. Some jackpine on sand plains.

Overburden ranges up to 100 feet in my estimation from seeing the sand ridges along the river. The material varies from fine sand to coarse gravel.

GENERAL GEOLOGY

The claims block lies in an area where Gowganda Conglomerate lies on the metamorphic felsic basement rocks. The contact tends NE diagonally across the Township with metavolcanics at the contact and a large intrusive sill of Nipissing diabase lying along this plane of weakness.

Outcrops in the claims area are scarce as the whole area is overlain by glacial outwash deposits of sand and gravel.

Immediately to the west is the Esker complex of the Meteor Lake area in Marshay and Beulah Twps with a large end moraine deposit just to the north.

These sand and gravel deposits lie along and to the east of the Vermillion River Fault which controls the path of the Vermillion River and its associated placers.

ECONOMIC GEOLOGY

The objective of Ranex Minerals is to evaluate glacial deposits and hopefully find a placer type deposit on its claims. Gold has been reported just to the west in the same sand and gravel units. Evaluation of these deposits is under way using an overburden sampling unit.

RANEX VIBRASONIC DRILL RIG.

EQUIPMENT DESCRIPTION:

Specially headed five foot sections of pipe with 1.81" ID core are vibrated into the ground with a modified Oztec 7 horsepower Gas Vibrator with Remington case and housing. The vibrator head has modifications for flexible shaft drive and for 80 rod connections which are assembled with 3 foot pipe wrenches. The vibrating unit is attached to a custom-built mobile tower assembly using a series of pulleys to raise and lower the pipe sections. The electric winch is powered by two 12 volt rechargeable batteries. A gas generator is used to recharge batteries as needed.

All component parts are designed for easy transportation to sites via all-terrain vehicle, while the 10'- 12' high tower is fitted with three wheels for transport.

Maximum Depth Drilled to Date 80 feet (16 pipes) and the rig has the capacity to drill between 100 to 200 feet.

PERSONAL OBSERVATIONS

While on the property for several days during July I watched the unit work. Penetration was rapid unless boulders were encountered at which time it was best to move over about a foot and repeat the hole.

The vibra head is connected to a rod and started via a flex drive to a gas motor. Immediately penetration begins and the rod is down in seconds. This rod is pulled and the sample vibrated out again in seconds. Pulling the rods is made easy by the 4 ton electric winch utilising the steel tower which is wheel mounted and towed by ARGO (ATV) to set ups.

Additional rods can be added and I witnessed a maximum of 20 foot penetration and four 5 foot sand samples being taken in about 30 minutes.

Moving & set up times take about one hour if conditions are suitable.

When samples are wet a simple system for bleeding off excess water is utilised and this permits extraction of the sample.

Most time is used up moving and setting up. Actual drilling time is minimal due to the rapid penetration achieved by the unit.

Two men are required to operate the equipment.

Mr. Jo Herberer was logging the samples and was doing a fine job, noting size of particle, type of overburden, percentage of black sand. He is also reliable and conscientious in tying the hole locations in to the claims posts.

Samples are properly labelled and stored in heavy plastic bags suitably marked with hole number, location and footage.

Sampling

Six vibrasonic holes were put down for a total of 48 feet. Maximum depth penetrated was 12 feet. This was obtained with great difficulty due to the large number of boulders encountered. Twelve samples were taken altogether.

All the holes were drilled on claim #817303.

Initial observation of the samples indicates that little potential exists in this area. However detailed investigation of the samples may prove this incorrect.

Costs

June 25 - July 10, 1985 (15 days)

TRIP 85 - 3

CLAIM GROUP : HODGETTS TOWNSHIP

- L. 817291
- 817292
- 817300
- 817301
- 817302
- L. 817303
- 817304
- 817305

15 days drilling - 48' total - access to sites difficult

EXPENSE REPORT

Drill Holes 26 - 31 Hodgetts

Fuel on site	\$ 257.10
Supplies and provisions	496.35
Labour (3 men x 15 days)	3,217.83
Drill rental (15 x \$49.75)	746.25
Typing and Mapping services	75.00
SUBTOTAL	\$ 4,792.53
On-site supervision/logging	\$1500.00
Geologist - Report	500.00
TOTAL	<u>\$ 6792.53</u>

RECOMMENDATIONS

Due to the low grade of placer deposits evaluation is difficult.

One way to obtain reliable results is to reduce samples using a gravity concentrator. Assay the concentrate making sure the weights before and after are noted and calculating back to get the heads.

By making a concentrate we are increasing the chances of the assayer obtaining the small pieces of gold in original sample. For an assay only a teaspoon of material is taken and the chances of obtaining a flake of gold are very slim for example in 1 cu. yard. However, if that yard is reduced to about 5lbs of heavies then more chance is likely that we will get the gold particle in the assay sample. More importantly a repeat sample will correlate.

I have about 10 years experience in mill tailings assaying and have used this technique of preconcentration with great success. Repeat assays of straight tailings give results which can vary by 200 or 300 % but by concentrating and assaying this material the results fall within a 5 to 10% variation which is acceptable.

REFERENCES

Assesment files were searched for the claims area and little if any useful work has been done concerning the placer potential. Gold is reported in OGS circular 17 1978 page 182.

The work reported by Vermillion Placers is disputed and is totally unreliable.

CERTIFICATION

The undersigned is a graduate of the Royal School of Mines London England and a fellow of the Geological Association of Canada and a member of the Canadian Institute of Mining and Metallurgy. I am familiar with all phases of exploration including placer evaluation having practiced my profession since 1966. I am familiar with the sampling unit having watched it operate and drill several holes. I also witnessed the samples being retrieved and bagged.

I have no financial interests directly or indirectly in the claims nor do I expect to receive any.

I was not present while this drill program was being carried out but I am familiar with the unit, and will be associated with the evaluation of the samples.



P.A.R. Brown B.Sc., A.R.S.M.

RANEX MINERALS INC.

85

PAGE: 1 of 1

VIBRASONIC DRILL HOLE # 26

STARTED: _____

TOWNSHIP: Hodgetts

LATITUDE: 6' north of post #3

COMPLETED: _____

CLAIM NUMBER: 817303

DEPARTURE: 5' east of post #3

LOGGED BY: Joseph Haberer

ANGLE: 90° Verticle

FROM	TO	REMARKS	SAMPLE NUMBER	SAMPLE LENGTH	RESULTS
0'0"	0'6"	TOP SOIL top soil brown in colour, very fine texture	H2601	4'	
0'6"	4'0"	CLAY AND SAND clay light brown to grey in colour 400-500 mesh size, 2% black sand mixed with it probable origin andesite			
	4'0"	END OF HOLE			

RANEX MINERALS INC.

TOWNSHIP: HODGETTS

DRILL HOLE NUMBER: 26

CLAIM NUMBER: _____

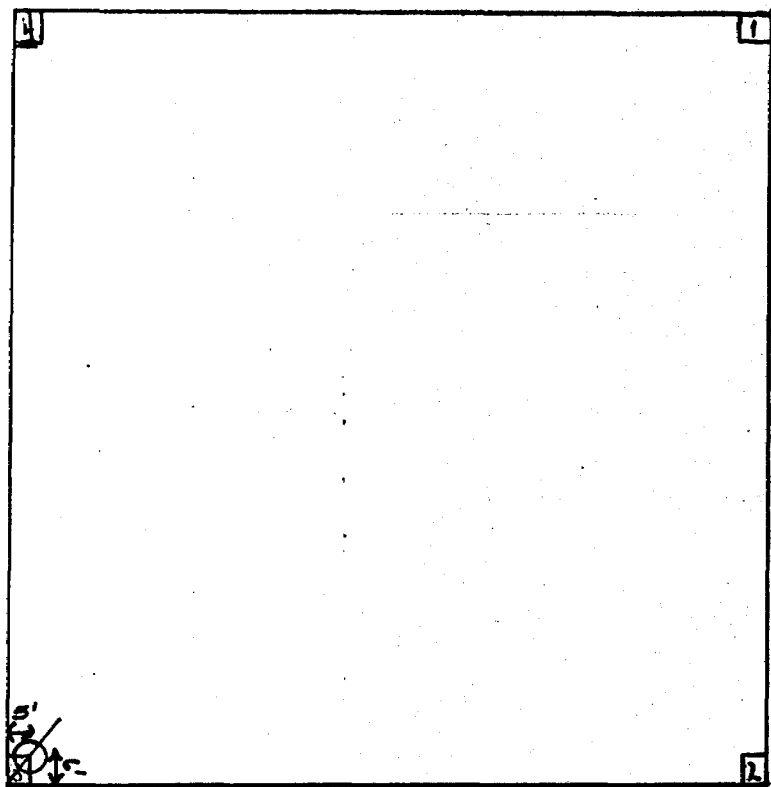

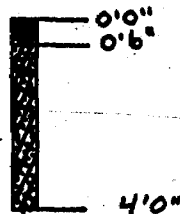

LEGEND:

 TOP SOIL
SAND & CLAY

RANEX MINERALS INC.

VIBRASONIC HOLE # 26 TOWNSHIP: HODGETTS

1 inch = 4 FEET.

RANEX MINERALS INC.

85

PAGE: 1 of 1

VIBRASONIC DRILL HOLE # 27

STARTED: _____

TOWNSHIP: Hodgetts

LATITUDE: 272'0" north of post #3

COMPLETED: _____

CLAIM NUMBER: 817303

DEPARTURE: 46'6" east of post #3

LOGGED BY: Joseph Haberer

ANGLE: 90° Verticle

FROM	TO	REMARKS	SAMPLE NUMBER	SAMPLE LENGTH	RESULTS
0'0"	0'7"	TOP SOIL	H2701	5'	
0'7"	2'0"	SILICA SAND AND CLAY silica sand mixed with 5% clay, yellow to light brown in colour			
2'0"	5'0"	CLAY light coloured clay			
5'0"	10'0"	SILICA SAND, SAND AND CLAY silica sand from 20-80 mesh size, 5% black sand some 1% red colour Feldspatic	H2702	5'	
10'0"	12'0"	SILICA SAND, SAND AND CLAY silica sand 20-80 mesh size 2% clay , 2% black sand, hit bedrock	H2703	2'	
	12'0"	HIT BEDROCK END OF HOLE			

RANEX MINERALS INC.

TOWNSHIP: HODGETTS

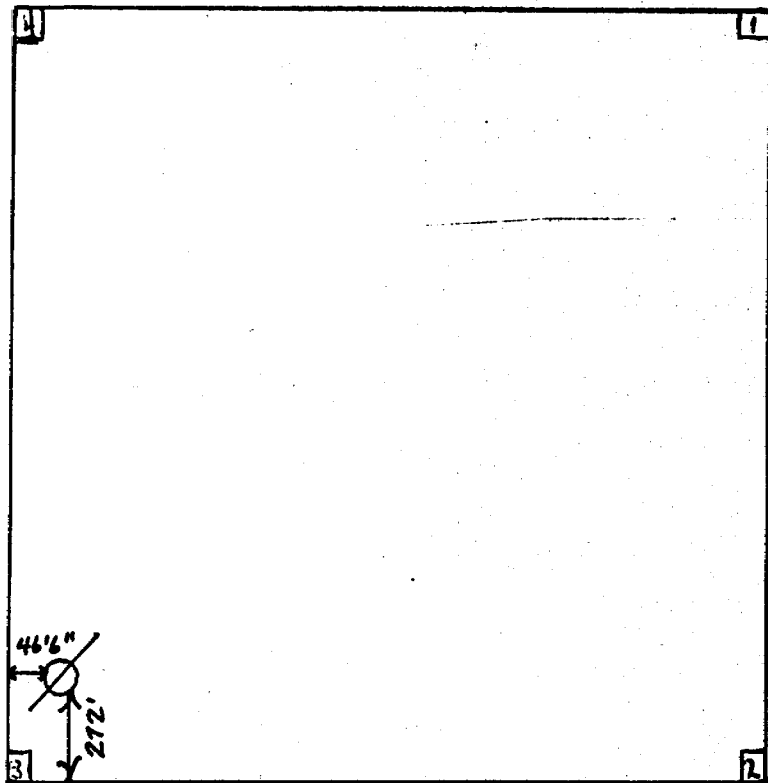

DRILL HOLE NUMBER: 21

CLAIM NUMBER: 817303

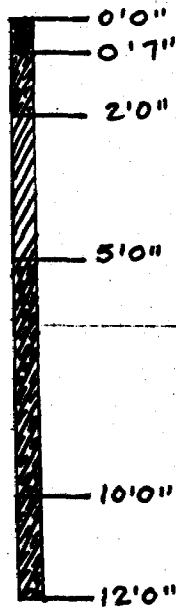



LEGEND:

-  TOP SOIL
-  SILICA SAND, SAND & CLAY
-  CLAY

RANEX MINERALS INC.

VIBRASONIC HOLE # 27 TOWNSHIP: HODGETTS

1 inch = 4 FEET.

RANEX MINERALS INC.

85

PAGE: 1 of 1

VIBRASONIC DRILL HOLE # 28

STARTED: _____

TOWNSHIP: Hodgetts

LATITUDE: 341' north of post

COMPLETED: _____

CLAIM NUMBER: 817303

DEPARTURE: 495' east of post

LOGGED BY: Joseph Haberer

ANGLE: 90° Verticle

FROM	TO	REMARKS	SAMPLE NUMBER	SAMPLE LENGTH	RESULTS
0'0"	0'10"	TOP SOIL	H2801	5'	
0'10"	2'0"	CLAY light brown clay very fine texture 500-600 mesh size			
2'0"	5'0"	SILICA SAND AND SAND grey silica sand from 10-80 mesh size 2% black sand 2% red sand probable origin slate			
5'0"	10'0"	SILICA SAND, AND SAND: grey silica sand mixed with 5% red slate 2% black sand	H2802	5'	
10'0"	12'0"	SILICA SAND AND CLAY. light coloured grey silica sand with 80% clay 500-600 mesh size, 2% black sand probable andesite origin	H2803	2'	
	12'0"	END OF HOLE.			

RANEX MINERALS INC.

TOWNSHIP: HODGETTS

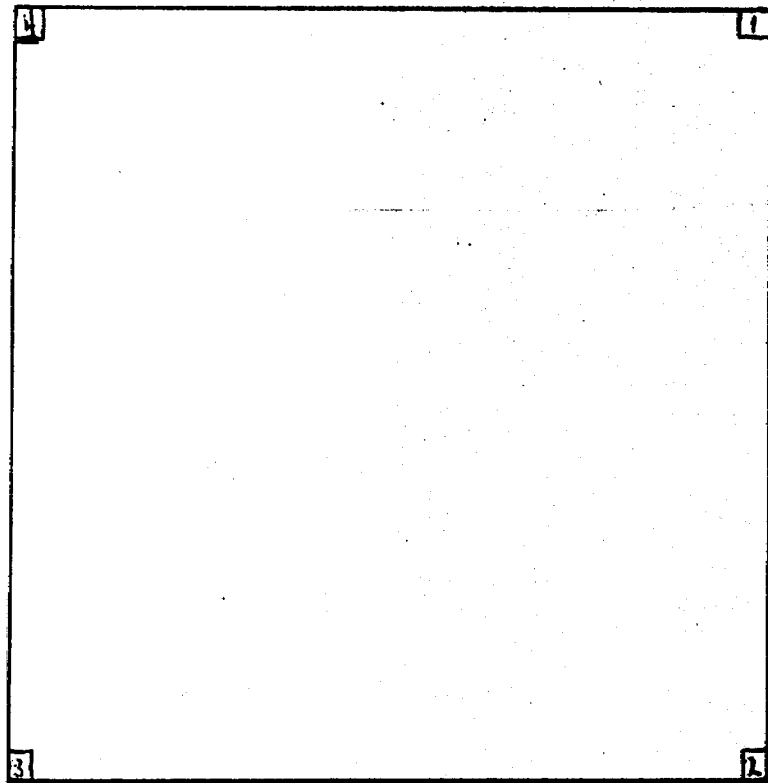

DRILL HOLE NUMBER: 28

CLAIM NUMBER: 817303

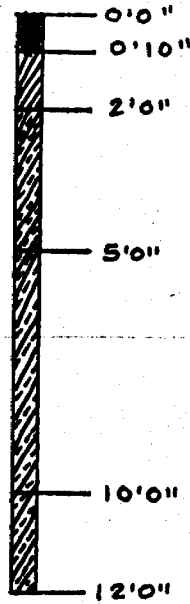



LEGEND:

-  TOP SOIL
-  CLAY
-  SILICA SAND, SAND, & CLAY

RANEX MINERALS INC.

VIBRASONIC HOLE # 28 TOWNSHIP: HODGETTS

1 inch = 4 FEET.

RANEX MINERALS INC.

85

PAGE: 1 of 1

VIBRASONIC DRILL HOLE # 29

STARTED: _____

TOWNSHIP: Hodgetts

LATITUDE: 566' north of post #2

COMPLETED: _____

CLAIM NUMBER: 817303

DEPARTURE: 16' west of post #2

LOGGED BY: Joseph Haberer

ANGLE: 90° Verticle

FROM	TO	REMARKS	SAMPLE NUMBER	SAMPLE LENGTH	RESULTS
0'0"	0'6"	TOP SOIL dark brown top soil mixed with decomposed vegetation	H2901	5'6"	
2'0"	5'6"	SANDY SILT, SILICA AND GRAVEL sandy silt 60-70% silica, up to ½" gravel mixed with it up to 2%. Hit boulder			
	5'6"	HIT BOULDER. END OF HOLE			

RANEX MINERALS INC.

TOWNSHIP: HODGETTS

DRILL HOLE NUMBER: 29

CLAIM NUMBER: 81303

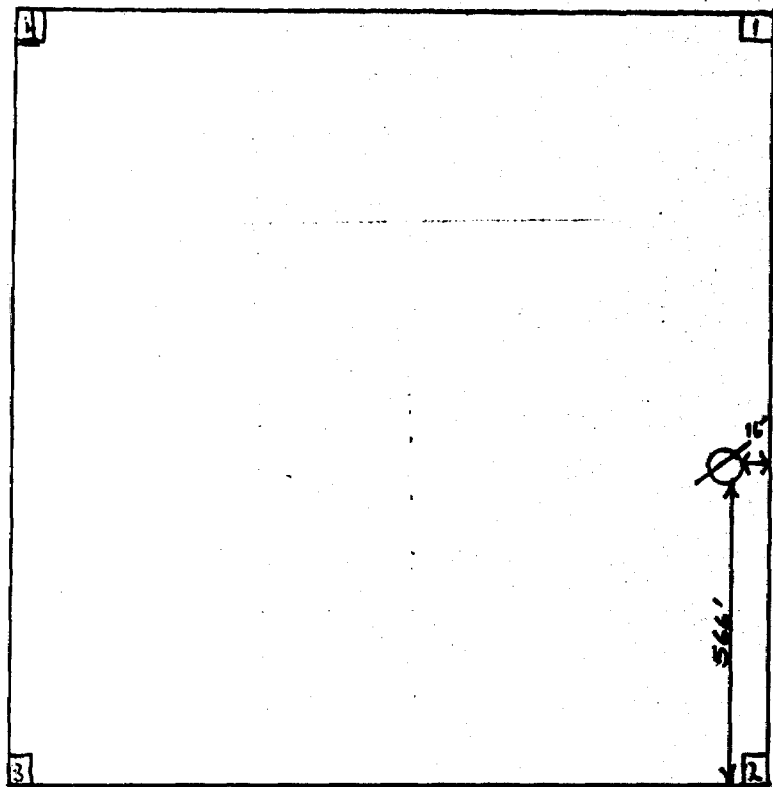

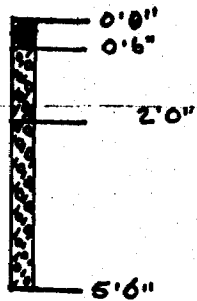

LEGEND:



TOP SOIL

SANDY SILT, SILICA & GRAVEL

RANEX MINERALS INC.

VIBRASONIC HOLE # 29 TOWNSHIP: HODGETT

1 inch = 4 FEET.

RANEX MINERALS INC.

85-2

PAGE: 1 of 1

VIBRASONIC DRILL HOLE # 30

STARTED: _____

TOWNSHIP: Hodgetts

LATITUDE: 566' north of post #2

COMPLETED: _____

CLAIM NUMBER: 817303

DEPARTURE: 15' west of post #2

LOGGED BY: Joseph Haberer

ANGLE: 90° Verticle

FROM	TO	REMARKS	SAMPLE NUMBER	SAMPLE LENGTH	RESULTS
0'0"	0'6"	TOP SOIL dark brown top soil mixed with decomposed vegetation	H3001	5'	
0'6"	2'0"	CLAY yellow to brown clay very fine texture 600 mesh size			
2'0"	5'0"	SANDY SILT AND GRAVEL sandy silt 60-70% silica 2%, up to ½" gravel			
5'0"	10'0"	GRAVEL, SAND, SANDY SILT, CLAY ½" - ½" stones, sandy silt 60%, silica sand to very fine texture, yellow clay mixed with it up to 5% black sand content	H3002	5'	
10'0"	11'6"	SANDY SILT, SLATE AND SAND sandy silt to 1½" slate rock mixed with it. 40% silica sand content, 5% black sand content.	H3003	1'6"	
	11'6"	END OF HOLE			

RANEX MINERALS INC.

TOWNSHIP: HODGETTS



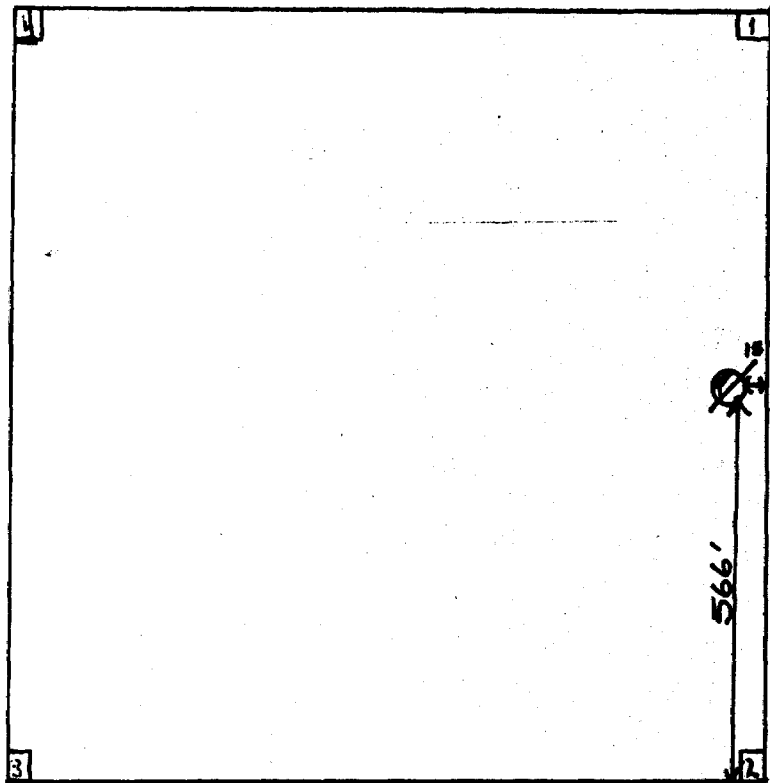

DRILL HOLE NUMBER: 30

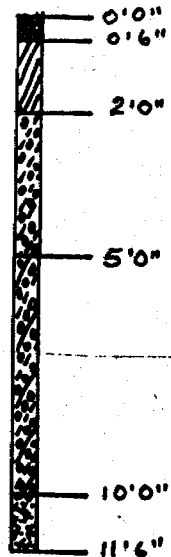
CLAIM NUMBER: 817303





LEGEND:

-  TOP SOIL
-  CLAY
-  GRAVEL, SAND, SANDY SILT, CLAY
-  SANDY SILT & GRAVEL
-  SANDY SILT, SLATE, & SAND

RANEX MINERALS INC.

VIBRASONIC HOLE # _____ 30 _____ TOWNSHIP: HODGETTS

1 inch = 4 FEET.

RANEX MINERALS INC.

85

PAGE: 1 of 1

VIBRASONIC DRILL HOLE # 31

TOWNSHIP: Hodgetts

LATITUDE: 558' north of post #2

CLAIM NUMBER: 817303

DEPARTURE: 306' W

ANGLE: 90° Verticle

STARTED: _____

COMPLETED: _____

LOGGED BY: Joseph Haberer

FROM	TO	REMARKS	SAMPLE NUMBER	SAMPLE LENGTH	RESULTS
0'0"	0'2"	TOP SOIL, SAND AND CLAY :top soil, sand mixed with light brown clay 10% silica sand, 90% clay	H3101	3'	
0'2"	3'0"	SILICA SAND, AND CLAY light brown clay very light brown to yellow in colour, 5% silica sand, clay 500-600 mesh size. Hit bedrock			
	3'0"	HIT BEDROCK. END OF HOLE			

RANEX MINERALS INC.

TOWNSHIP: HODGETTS

DRILL HOLE NUMBER: 31

CLAIM NUMBER: 817303

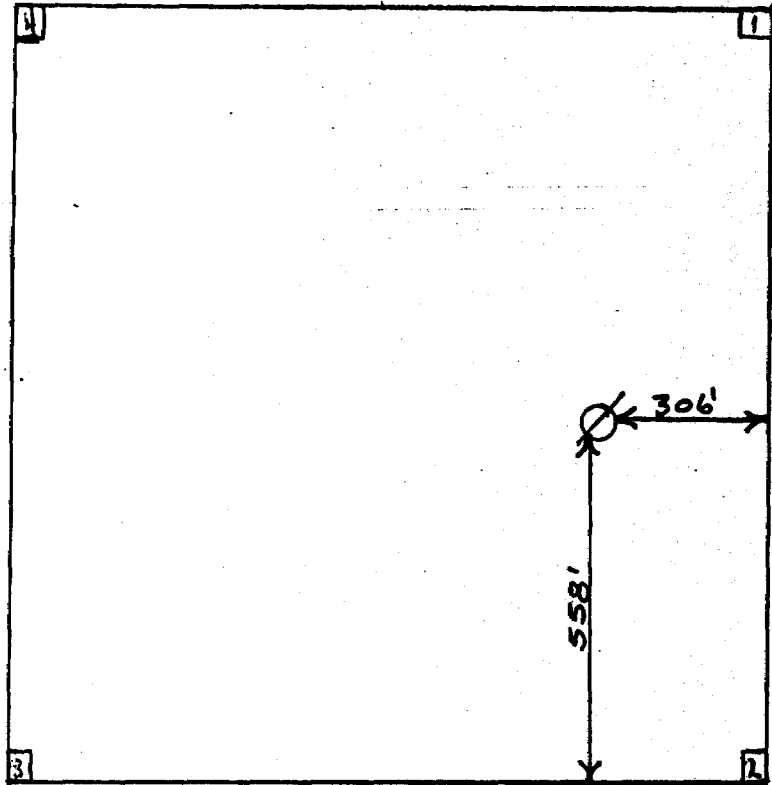

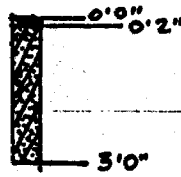

LEGEND:



RANEX MINERALS INC.

VIBRASONIC HOLE # 31 TOWNSHIP: HODGETTS

1 inch = 4 FEET.

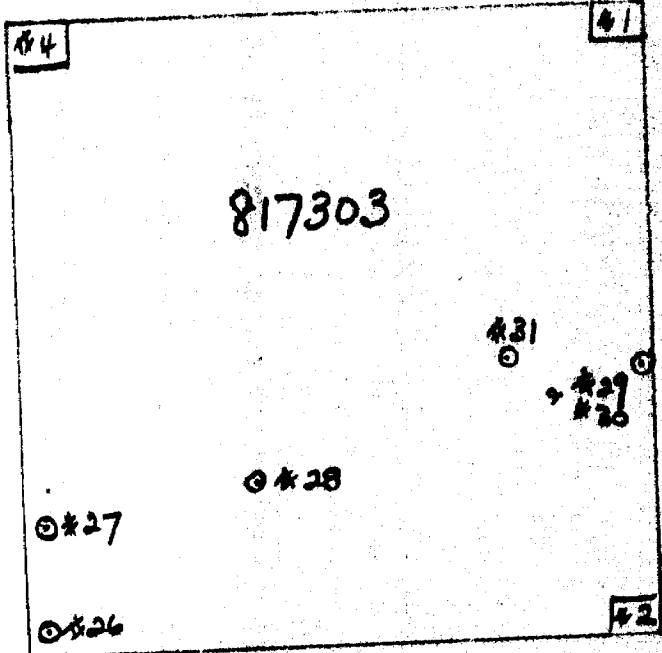

DRILLHOLE LOC^N MAP
SCALE 1" = 400 FT

FIG 1

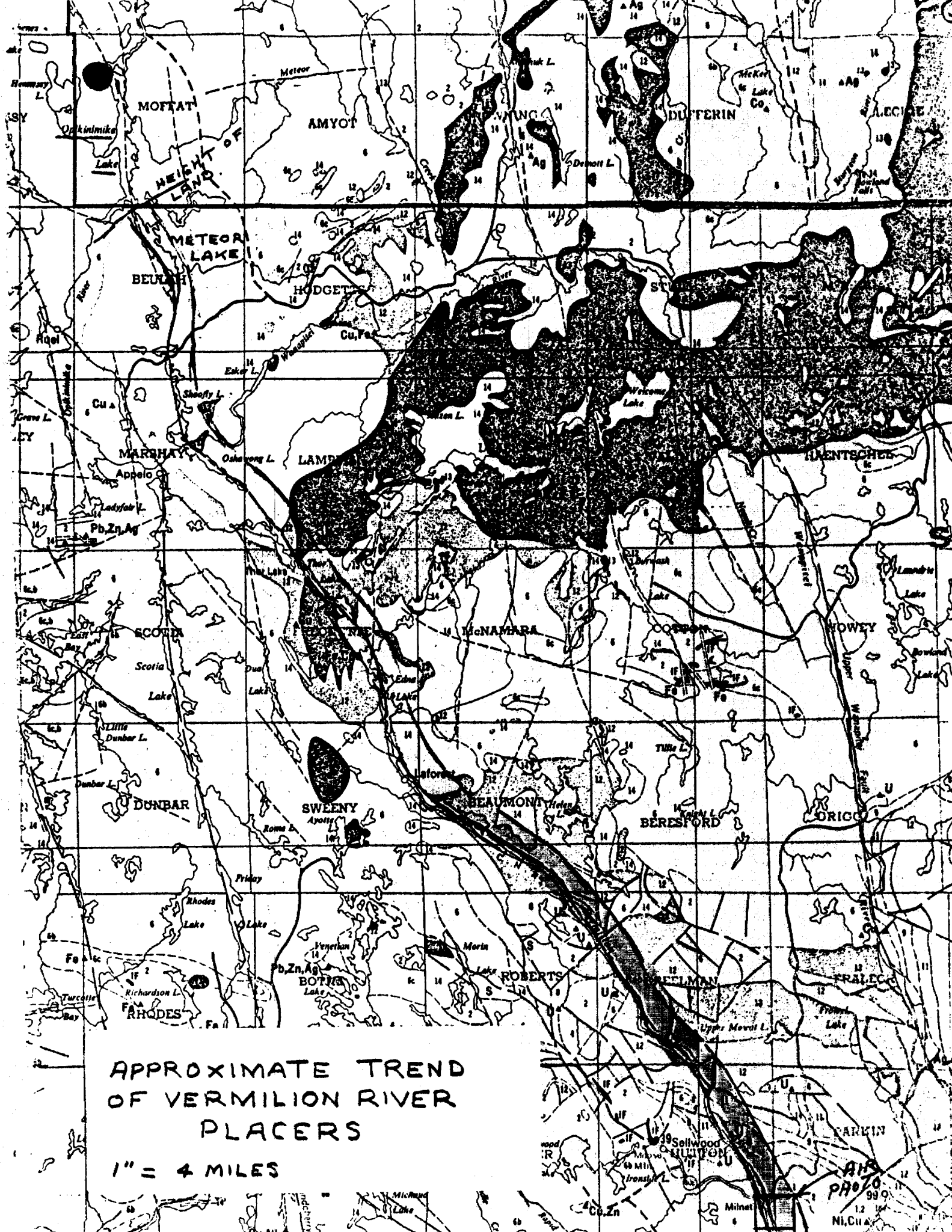

APPROXIMATE TREND
OF VERMILION RIVER
PLACERS

1" = 4 MILES

AHS
PHOTO
990
12
Ni, Cu

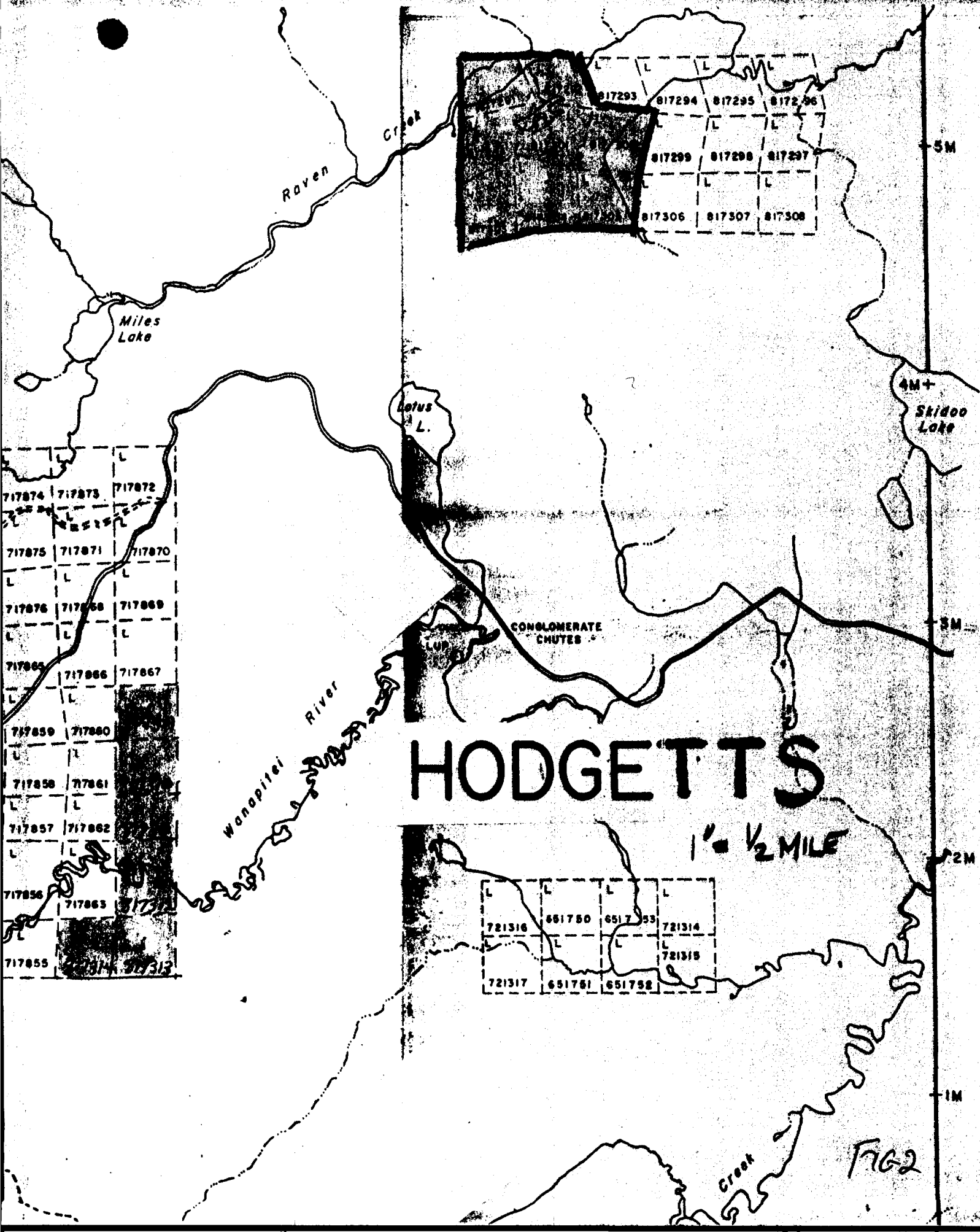

Raven
Creek

Miles
Lake

Lotus
L.

4M+
Skidoo
Lake

CONGLOMERATE
CHUTES

Wanapitei
River

HODGETTS

1/2 MILE

Creek

1762

817293	817294	817295	817296
817299	817298	817297	
817306	817307	817308	

717874	717873	717872
717875	717871	717870
717876	717868	717869
717865	717866	717867
717859	717860	
717858	717861	
717857	717862	
717856	717863	717864
717855	717864	717863

721316	651750	651753	721314
			721315
721317	651751	651752	

5M
4M+
5M
2M
1M

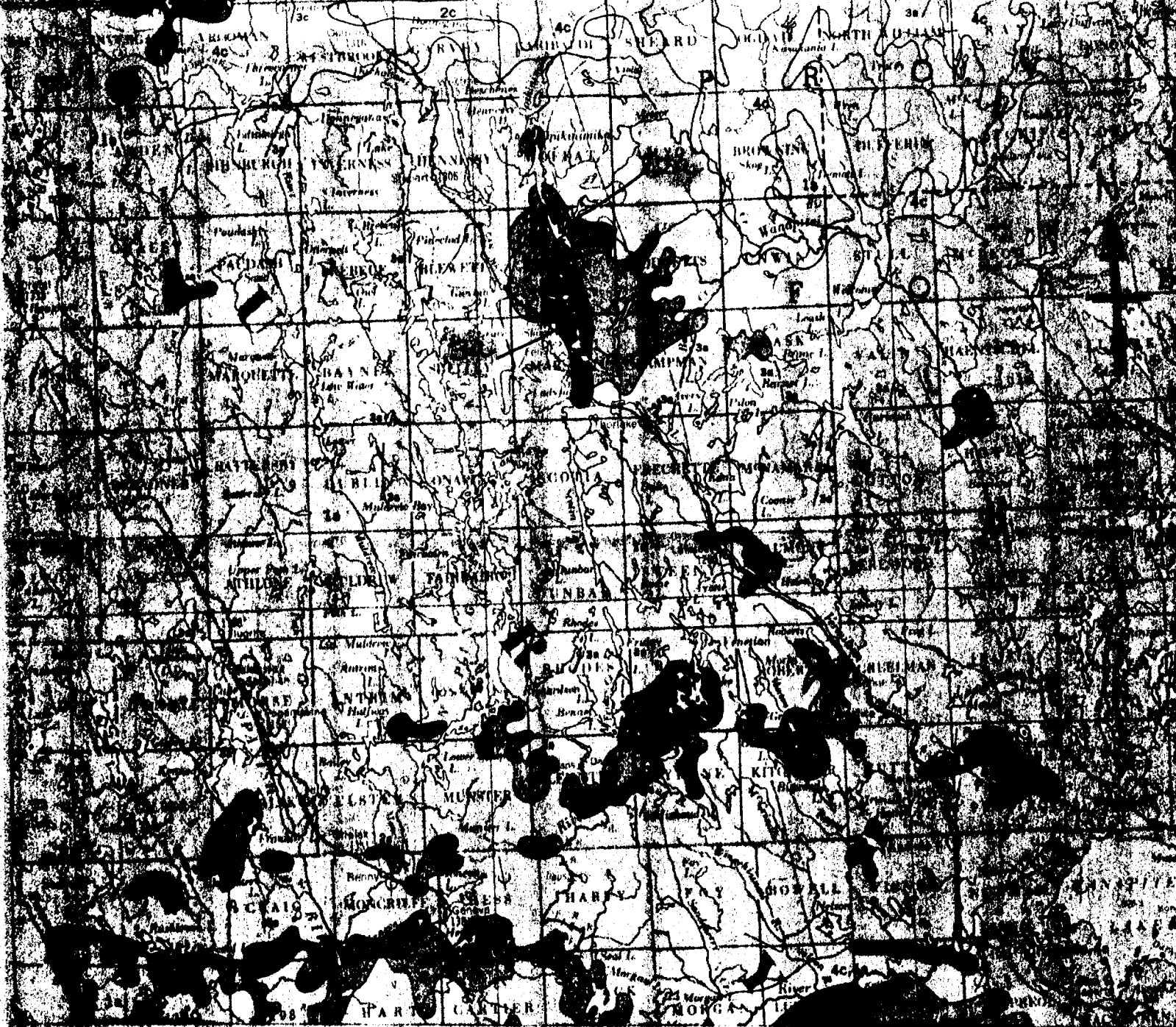

MAP OF THE PROVINCE OF ONTARIO AND QUEBEC

Map 8465

ALGOMA, SUDBURY, TIMISKAMING AND NIPISSING

SURFICIAL GEOLOGY

- ESKER COMPLEX
- END MORAINES
- OUTWASH SANDS

Scale: $\frac{1}{506,880}$ or 8 miles to 1 inch

January 10, 1986

File: 2.8420

Ranex Minerals Inc
P.O. Box 2362
Station B
St. Catharines, Ontario
L2M 7M7

Attention: D. Ranchuk

Dear Sir:

This will confirm that we in fact did approve 452 days
credit for assessment work recorded on Mining Claim L 817303.

Any query as to the amount of credit recorded on the record
sheets should be directed to the Mining Recorder in Kirkland
Lake, Ontario.

Yours sincerely,

S.E. Yundt
Director
Land Management Branch

Whitney Block, Room 6643
Queen's Park
Toronto, Ontario
M7A 1W3
Phone:(416)965-4888

DK/mc

cc: Mining Recorder
Kirkland Lake, Ontario
Files #250 & 325

2,8420

RANEX MINERALS INC.

P.O. BOX 2362, STATION B, ST. CATHARINES, ONT.
L2M 7M7 (416) 934-4152

appd 85-12-18

January 3, 1986

S.E.Yundt
Director Land Management Branch
Whitney Block, Room 6643
Queen's Park
Toronto, Ontario
M7A 1W3

RECEIVED
JAN 07 1986
MINING LANDS SECTION

RECEIVED	
LAND MANAGEMENT BRANCH	
JAN 7 1986	
PREPARE REPLY	<input type="checkbox"/>
COMMENTS PLEASE BY	<input type="checkbox"/>
S. E. YUNDT	
J. R. MORTON	
J. C. SMITH	
W. P. BROOK	
M. J. HOGAN	
D. W. SCOTT	
S. KEER	
Return To: R.66-13	

Dear Mr. Yundt

RE: Your file 2,8420 re Notice of Intent.

Please note that the revisions deleting report of work #250 and replacing it with #325 are in accordance with our records. The original number of expenditure days credits certified by Phil Brown are 56.5 man/days each on claims L.817291, 817292, 817300 -817305 inclusive for a total of 452 man/days.

Please confirm if this is the final figure to be recorded on these claims.

Yours truly

D. Ranchuk
for Ranex Minerals Inc.

DR:ca



Recorded Holder
RANEX MINERALS INC

Township or Area
HODGETTS TOWNSHIP

Type of survey and number of Assessment days credit per claim	Mining Claims Assessed
Geophysical Electromagnetic _____ days Magnetometer _____ days Radiometric _____ days Induced polarization _____ days Other _____ days Section 77 (19) See "Mining Claims Assessed" column Geological _____ days Geochemical _____ days Man days <input type="checkbox"/> Airborne <input type="checkbox"/> Special provision <input type="checkbox"/> Ground <input type="checkbox"/> <input type="checkbox"/> Credits have been reduced because of partial coverage of claims. <input type="checkbox"/> Credits have been reduced because of corrections to work dates and figures of applicant.	<p>\$6,792.53 SPENT ON VIBRASONIC DRILLING AND ASSAYING SAMPLES TAKEN FROM MINING CLAIM:</p> <p>L 817303</p> <p>452 DAYS CREDIT ALLOWED WHICH MAY BE GROUPED IN ACCORDANCE WITH SECTION 76(6) OF THE MINING ACT R.S.O. 1980.</p>

Special credits under section 77 (16) for the following mining claims

No credits have been allowed for the following mining claims

not sufficiently covered by the survey insufficient technical data filed

NO CREDITS ALLOWED FOR REPORT OF WORK OF ³²⁵#250 AS THIS IS A DUPLICATION OF CREDITS REQUESTED ON REPORT OF WORK ²⁵⁰#325.

The Mining Recorder may reduce the above credits if necessary in order that the total number of approved assessment days recorded on each claim does not exceed the maximum allowed as follows: Geophysical - 80; Geological - 40; Geochemical - 40; Section 77(19) - 60.

1985 12 18

Your File: 250, 325
Our File: 2.8420

Mining Recorder
Ministry of Northern Development and Mines
4 Government Road East
Kirkland Lake, Ontario
P2N 1A2

Dear Sir:

RE: Notice of Intent dated October 28, 1985
Assaying submitted under Section 77(19)
of the Mining Act RSO 1980, on Mining
Claims L 817303, et al, in Hodgetts
Township

The assessment work credits, as listed with the
above-mentioned Notice of Intent, have been approved
as of the above date.

Please inform the recorded holder of these mining
claims and so indicate on your records.

Yours sincerely,

S.E. Yundt
Director
Land Management Branch

Whitney Block, Room 6643
Queen's Park
Toronto, Ontario
M7A 1W3
Phone:(416)965-4888

SH/mc

cc: Ranex Minerals Inc
P.O. Box 2362, Station B
St. Catharines, Ontario
L2M 7M7

Resident Geologist
Kirkland Lake, Ontario

Encl.

P.A.R. Brown
R.R.#1
Corbell, Ontario
POH 1K)

Mr. G.H. Ferguson
Mining & Lands Commissioner



Ministry of
Natural
Resources

Nov. 12/85

1985 10 28

Your Files: 250, 325
Our File: 2.8420

Mining Recorder
Ministry of Northern Affairs and Mines
4 Government Road East
Kirkland Lake, Ontario
P2N 1A2

Dear Sir:

Enclosed are two copies of a Notice of Intent with statements listing a reduced rate of assessment work credits to be allowed for a technical survey. Please forward one copy to the recorded holder of the claims and retain the other. In approximately fifteen days from the above date, a final letter of approval of these credits will be sent to you. On receipt of the approval letter, you may then change the work entries on the claim record sheets.

For further information, if required, please contact Mr. R.J. Pichette at 416/965-4888.

Yours sincerely,

S.E. Yundt
Director
Land Management Branch

Whitney Block, Room 6643
Queen's Park
Toronto, Ontario
M7A 1W3

RJ SH/mc

Encls.

cc: Ranex Minerals Inc.
P.O. Box 2362, Station B
St. Catharines, Ontario
L2M 7M7

P.A.R. Brown
R.R.#1
Corbeil, Ontario
POH 1K0

Mr. G.H. Ferguson
Mining & Lands Commissioner
Toronto, Ontario



Ministry of
Natural
Resources

Ontario

Notice of Intent
for Technical Reports

1985 10 28

2.8420/250,325

An examination of your survey report indicates that the requirements of The Ontario Mining Act have not been fully met to warrant maximum assessment work credits. This notice is merely a warning that you will not be allowed the number of assessment work days credits that you expected and also that in approximately 15 days from the above date, the mining recorder will be authorized to change the entries on his record sheets to agree with the enclosed statement. Please note that until such time as the recorder actually changes the entry on the record sheet, the status of the claim remains unchanged.

If you are of the opinion that these changes by the mining recorder will jeopardize your claims, you may during the next fifteen days apply to the Mining and Lands Commissioner for an extension of time. Abstracts should be sent with your application.

If the reduced rate of credits does not jeopardize the status of the claims then you need not seek relief from the Mining and Lands Commissioner and this Notice of Intent may be disregarded.

If your survey was submitted and assessed under the "Special Provision-Performance and Coverage" method and you are of the opinion that a re-appraisal under the "Man-days" method would result in the approval of a greater number of days credit per claim, you may, within the said fifteen day period, submit assessment work breakdowns listing the employees names, addresses and the dates and hours they worked. The new work breakdowns should be submitted direct to the Land Management Branch, Toronto. The report will be re-assessed and a new statement of credits based on actual days worked will be issued.



Ministry of
Natural
Resources
Ontario

Report of Work
(Geophysical, Geological,
Geochemical and Expenditures)

2.8420

Instructions: - Please type or print.
- If number of mining claims traversed exceeds space on this form, attach a list.
Note: - Only days credits calculated in the "Expenditures" section may be entered in the "Expend. Days Cr." columns.
- Do not use shaded areas below.

85-3
#325

Cpeli L 817291 Mining Act

Type of Survey(s): OVERBURDEN DRILLING - Vibrasonic	Township or Area: HODGETTS TOWNSHIP
Claim Holder(s): RANEX MINERALS INC.	Prospector's Licence No.: T.1599
Address: P.O. Box 2362, Station B, St. Catharines, Ont. L2M 7M7	
Survey Company: Ranex Minerals Inc.	Date of Survey (from & to): 25 06 85 to 09 07 85 Day Mo. Yr. Day Mo. Yr.
Name and Address of Author (of Geo-Technical report): P.A.R. Brown, R.R. # 1, Corbeil, Ontario, POH 1K0	

Credits Requested per Each Claim in Columns at right

Special Provisions	Geophysical	Days per Claim
For first survey: Enter 40 days. (This includes line cutting)	- Electromagnetic	
	- Magnetometer	
For each additional survey: using the same grid: Enter 20 days (for each)	- Radiometric	
	- Other	
	Geological	
	Geochemical	
Man Days	Geophysical	Days per Claim
Complete reverse side and enter total(s) here	- Electromagnetic	
	- Magnetometer	
	- Radiometric	
	- Other	
	Geological	
	Geochemical	
Airborne Credits	Geophysical	Days per Claim
Note: Special provisions credits do not apply to Airborne Surveys.	- Electromagnetic	
	- Magnetometer	
	- Radiometric	

Mining Claims Traversed (List in numerical sequence)

Prefix	Mining Claim Number	Expend. Days Cr.	Prefix	Mining Claim Number	Expend. Days Cr.
L	817291	5640			
	817292	5640			
	817300	5640			
	817301	5640			
	817302	5640			
	817303	5640			
	817304	5640			
	817305	5640			

RECEIVED
SEP 9 1985
MINING LANDS SECTION

LAND REPT
REPT
SEP 10 1985
AM

Expenditures (excludes power stripping)

Type of Work Performed: *Sec 77-19*
Overburden drilling-vibrasonic

Performed on Claim(s):
L. 817303

Calculation of Expenditure Days Credits

Total Expenditures	÷	Total Days Credits	=	
\$ 6792.53	÷	15	=	452

Instructions
Total Days Credits may be apportioned at the claim holder's choice. Enter number of days credits per claim selected in columns at right.

Total number of mining claims covered by this report of work. **8**

Date: **July 10, 1985**

Recorded Holder or Agent (Signature): *[Signature]*

For Office Use Only

Total Days Cr. Recorded: **320**

Date Recorded: **SEP 9 1985**

Date Approved as Recorded: *See Reversed Statement*

Mining Recorder Acting: *[Signature]*

Branch Director: *[Signature]*

Certification Verifying Report of Work

I hereby certify that I have a personal and intimate knowledge of the facts set forth in the Report of Work annexed hereto, having performed the work or witnessed same during and/or after its completion and the annexed report is true.

Name and Postal Address of Person Certifying:
P.A.R. Brown, R.R. # 1, Corbeil, Ontario. POH 1K0

Date Certified: **5 Sept**

Certifier's Signature: *P.A.R. Brown*



Ministry of
Natural
Resources

R Lands Management
Report of Work

(Geophysical, Geological,
Geochemical and Expenditures)

File 817291

2.8420
The Mining Act

Instructions: - Please type or print.
- If number of mining claims traversed exceeds space on this form, attach a list.
Note: - Only days credits calculated in the "Expenditures" section may be entered in the "Expend. Days Cr." columns.
- Do not use shaded areas below.

#250 Aug 3rd

Type of Survey(s) OVERBURDEN DRILLING - Vibrasonic	Township or Area HODGETTS TOWNSHIP
Claim Holder(s) RANEX MINERALS INC.	Prospector's Licence No. T.1599
Address Box 2362, Station B, St. Catharines, Ontario L2M 7M7	
Survey Company Ranex Minerals Inc.	Date of Survey (from & to) 25 06 85 09 07 85 Day Mo. Yr. Day Mo. Yr.
Name and Address of Author (of Geo-Technical report) Joseph Haberer, 68-186 Cushman Road, St. Catharines, Ontario. L2M 6Z2	

Credits Requested per Each Claim in Columns at right

Special Provisions	Geophysical	Days per Claim
For first survey: Enter 40 days. (This includes line cutting)	- Electromagnetic	
	- Magnetometer	
For each additional survey: using the same grid: Enter 20 days (for each)	- Radiometric	
	- Other	
	Geological	
	Geochemical	

Man Days	Geophysical	Days per Claim
Complete reverse side and enter total(s) here	- Electromagnetic	
	- Magnetometer	
	- Radiometric	
	- Other	
	Geological	
	Geochemical	

Airborne Credits	Geophysical	Days per Claim
Note: Special provisions credits do not apply to Airborne Surveys.	Electromagnetic	
	Magnetometer	
	Radiometric	

Mining Claims Traversed (List in numerical sequence)

Mining Claims Traversed (List in numerical sequence)			Mining Claims Traversed (List in numerical sequence)		
Prefix	Mining Claim Number	Expend. Days Cr.	Prefix	Mining Claim Number	Expend. Days Cr.
L.	817291	20			
	817292	20			
	817300	20			
	817301	20			
	817302	20			
	817303	20			
	817304	20			
	817305	20			
	817309	20			
	817310	20			
	817311	20			
	817312	20			
	817313	20			
	817314	20			
	817315	23.73			

RECEIVED
JUL 23 1985
MINING LANDS SECTION

LARDER LAKE
MINING DIV.
RECEIVED
JUL 11 1985
AM 7 18 19 10 11 12 1 1 2 3 4 5 16 PM

Expenditures (excludes power stripping)

Type of Work Performed *Sec. 77(19)*
Overburden drilling-vibrasonic

Performed on Claim(s)
L.817303

Calculation of Expenditure Days Credits

Total Expenditures	Total Days Credits
\$ 4,556.00	303.73

Instructions
Total Days Credits may be apportioned at the claim holder's choice. Enter number of days credits per claim selected in columns at right.

Date **July 10, 1985**

Recorded Holder or Agent (Signature)

Total number of mining claims covered by this report of work. **15**

For Office Use Only

Total Days Cr. Recorded	Date Recorded	Mining Recorder
	JUL 11 1985	
Date Approved as Recorded	Branch Director	
<i>See Reversed</i>	<i>Statement</i>	

Certification Verifying Report of Work

I hereby certify that I have a personal and intimate knowledge of the facts set forth in the Report of Work annexed hereto, having performed the work or witnessed same during and/or after its completion and the annexed report is true.

Name and Postal Address of Person Certifying
Joseph Haberer, Unit 68- 186 Cushman Road, St. Catharines, Ont. L2M 6Z2

Date Certified **July 10, 1985**

Certified by (Signature)

RANEX MINERALS INC.

P.O. BOX 2362, STATION B, ST. CATHARINES, ONT.

L2M 7M7

(416) 934-4152

September 9, 1985

Mr. R. Pichette
Land Management Branch
Whitney Block Room 6610
Queen's Park
TORONTO, Ontario
M7A1W3

RECEIVED
SEP 11 1985
MINERAL SECTION
✓

RECEIVED
SEP 11 1985
MINERAL SECTION

Dear Mr. Pichette:

Please find enclosed:

1. A letter concerning the Reports of Work that Joseph Haberer delivered to you on September 6, 1985.
2. The affidavits regarding expenditures of the reports of work.

And, last but certainly NOT least, our many thanks for your help and your patience in getting these reports straightened out.

Yours very truly



DR:ca

D. Ranchuk
(for Ranex Minerals Inc.)

RANEX MINERALS INC.
P.O. BOX 2362, STATION B, ST. CATHARINES, ONT.
L2M 7M7 (416) 934-4152

September 9, 1985

Mr. G.J. Koleszar
Mining Recorder's Office
Ministry of Natural Resources
4 Government Road East
KIRKLAND LAKE, Ontario
P2N 3L1

Dear Mr. Koleszar:

There are a number of items enclosed so I will simply list them in order of occurrence.

1. In the report of work for Hodgetts Township (copy enclosed) filed August 23, 1985 by Mr. Phil Brown, we have been informed of two things: first an extension is needed (copy enclosed) and in reviewing the claim numbers on the form we noticed that claim L. 817318 was inadvertently deleted. Could we please have this claim number added on, bringing the total number of claims to 12 and the expenditure day credits to 38.16 days per claim?

2. The report of work for Hodgetts Township covering claims L. 717885 to 717907 (23 claims) is a re-submitted report on the claims in Hodgetts Township now under dispute. The original report of work bears file number 109 claim number L. 717873 to L. 717907 with total days credits of 571.37. I believe the file number at Land Management is 2.7938. We have re-submitted this report deleting some of the drilling done and covered only 23 of the claims as suggested by Mr. Phil Brown, geologist. Enclosed is a copy of what you should have already received from Mr. Brown with the new figures, claim numbers etc.. Could we please have this new report of work placed on record in place of the original.

Also please note, that proof of expenditures has been sent to Mr. Pichette's office.

Thank you for your assistance in these matters

Yours truly

D. Ranchuk

DR;ca

✓ c.c. Ray Pichette
Land Management Branch

28420

REGISTERED

August 30, 1985

Report of Work #250

Ranex Minerals Inc
7 King Street
Box 2247, Station "B"
St. Catharines, Ontario
L2M 6P6

Dear Sirs:

RE: Overburden Drilling submitted on
Mining Claims L 817291, et al,
in Hodgetts Township

I have not received the reports and maps (in duplicate)
for the Overburden Drilling program on the above-mentioned
claims.

As the assessment "Report of Work" was recorded by the
Mining Recorder on July 11, 1985 the 60 day period
allowed by Section 77 of the Mining Act for the submission
of the technical reports and maps to this office will
expire on September 9, 1985.

If the material is not submitted to this office by September 9,
1985, I will have no alternative but to instruct the Mining
Recorder to delete the work credits from the claim record
sheets.

For further information, please contact Mr. Arthur Barr
at (416)965-4888.

Yours sincerely,

S.E. Yundt
Director
Land Management Branch

Whitney Block, Room 6643
Queen's Park
Toronto, Ontario
M7A 1W3
Phone:(416)965-4888

D. Kinvig:mc

cc: Joseph Haberer
68 - 186 Cushman Road
St. Catharines, Ontario
L2M 6Z2

cc: Ranex Minerals Inc
Box 2362, Station "B"
St. Catharines, Ontario
L2M 7M7

cc: Mining Recorder, Kirkland Lake, Ontario

RANEX MINERALS INC.

P.O. BOX 2362, STATION B, ST. CATHARINES, ONT.

L2M 7M7

(416) 934-4152

I, ROBERT V. MORI, being a director of Ranex Minerals Inc. and having knowledge of the financial matters and operations of this company:

MAKE OATH AND SWEAR that the monies listed on the enclosed expense report have been expended as designated. Receipt copies are available upon request.

SWORN BEFORE ME at the City of
St. Catharines, in the Regional
Municipality of Niagara, this 20th
day of September, 1985.

Commissioners
Oath and Stamp

A Commissioner, etc.

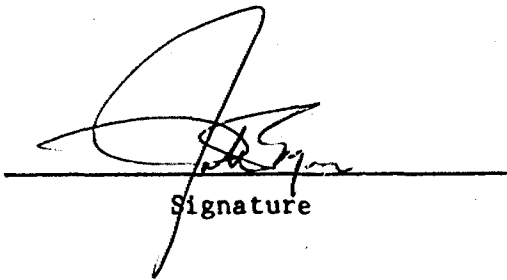
Signature

RANEX MINERALS INC.

P.O. BOX 2363, STATION B, ST. CATHARINES, ONT.

L2M 7M7

(416) 934-4152

June 25 - July 10, 1985 (15 days)

TRIP 85 - 3

CLAIM GROUP : HODGETTS TOWNSHIP

L. 817291	L. 817303	L. 817311
817292	817304	187312
817300	817305	817313
817301	817309	817314
817302	817310	817315

15 days drilling - 48' total - access to sites difficult

EXPENSE REPORT

Drill Holes 26 - 31 Hodgetts

Fuel on site	\$ 257.10
Supplies and provisions	496.35
Labour (3 men x 15 days)	3,217.83
Drill rental (15 x \$49.75)	746.25
Typing and Mapping services	<u>75.00</u>
SUBTOTAL	\$ 4,792.53
On Site Supervision/Logging	1,500.00
Geologist	<u>500.00</u>
TOTAL	<u>\$ 6,792 .53</u>

1985 09 17

File: 2.8420

Mining Recorder
Ministry of Natural Resources
4 Government Road East
Kirkland Lake, Ontario
P2N 1A2

Dear Sir:

We received Data for Overburden Drilling on September 6, 1985 submitted under Section 77(19) of the Mining Act R.S.O. 1980 for Mining Claims L 817291, et al, in Hodgetts Township.

This material will be examined and assessed and a statement of assessment work credits will be issued.

We do not have a copy of the report of work which is normally filed with your office prior to the submission of this technical data. Please forward a copy as soon as possible.

Yours sincerely,

S.E. Yundt
Director
Land Management Branch

Whitney Block, Room 6643
Queen's Park
Toronto, Ontario
M7A 1W3
Phone:(416)965-4888

A. Barr:mc

cc: Ranex Minerals Inc.,
P.O. Box 2362, Station "B"
St. Catharines, Ontario
L2M 7M7



Ministry of
Natural
Resources

Report of Work
(Geophysical, Geological,
Geochemical and Expenditures)

Instructions: - Please type or print.
- If number of mining claims traversed exceeds space on this form, attach a list.
Note: - Only days credits calculated in the "Expenditures" section may be entered in the "Expend. Days Cr." columns.
- Do not use shaded areas below.

Mining Act

Type of Survey(s) OVERBURDEN DRILLING - Vibrasonic	Township or area HODGETTS TOWNSHIP
Claim Holder(s) RANEX MINERALS INC.	Inspector's Licence No. T.1599
Address P.O. Box 2362, Station B, St. Catharines, Ont. L2M 7M7	
Survey Company Ranex Minerals Inc.	Date of Survey (from & to) 25 06 85 09 07 85
Name and Address of Author (of Geo-Technical report) P.A.R. Brown, R.R. # 1, Corbeil, Ontario, POH 1K0	Total Miles of line Cut

Credits Requested per Each Claim in Columns at right

Mining Claims Traversed (List in numerical sequence)

Special Provisions	Geophysical	Days per Claim	Mining Claim			Mining Claim		
			Pegs	Number	Expend. Days Cr.	Pegs	Number	Expend. Days Cr.
For first survey: Enter 40 days. (This includes line cutting)	- Electromagnetic		L	817291	56			
	- Magnetometer			817292				
	- Radiometric			817300				
For each additional survey: using the same grid: Enter 20 days (for each)	- Other			817301				
	Geological			817302				
	Geochemical			817303				
Man Days	Geophysical	Days per Claim		817304				
Complete reverse side and enter total(s) here	- Electromagnetic			817305				
	- Magnetometer							
	- Radiometric							
	- Other							
	Geological							
	Geochemical							
Airborne Credits		Days per Claim						
Note: Special provisions credits do not apply to Airborne Surveys.	- Electromagnetic							
	- Magnetometer							
	- Radiometric							

Expenditures (excludes power stripping)

Type of Work Performed
Overburden drilling-vibrasonic

Performed on Claim(s)
L. 817303

Calculation of Expenditure Days Credits

Total Expenditures	÷	Total Days Credits	=	
\$6792.53		15		452

Instructions
Total Days Credits may be apportioned at the claim holder's choice. Enter number of days credits per claim selected in columns at right.

[Handwritten signature]

Total number of mining claims covered by this report of work.

8

For Office Use Only			
Total Days Cr. Recorded	Date Recorded	Mining Recorder	
	Date Approved as Recorded	Branch Director	

Date
July 10, 1985

Recorded/Holder or Agent (Signature)
[Signature]

Certification Verifying Report of Work

I hereby certify that I have a personal and intimate knowledge of the facts set forth in the Report of Work annexed hereto, having performed the work or witnessed same during and/or after its completion and the annexed report is true.

Name and Postal Address of Person Certifying
P.A.R. Brown, R.R. # 1, Corbeil, Ontario. POH 1K0

Date Certified
5 Sept

Certified by (Signature)
[Signature]