



41P09NE0058 10 BRYCE

010

Diamond Drilling

Township of Bryce

Report NO: 10

Work performed by: G. A. Decaire

Claim NO	Hole NO	Footage	Date	Note	
T 50989	1	334.9'	Aug/62		
	2	344'	Sept/62		
	3	259.5'	Sept/62		
	4	400'	Sept/62		
	5	320.8'	Oct/62		
	9	145'	May/64		
	10	138'	May/64		
	11	198'	May/64		
	12	248'	May/64		
	T 51727	6	238.3'	Nov/62	
			<u>121.7'</u>	Apr/64	
			<u>360'</u>		
7		363'	May/64		
8		361'	May/64		
20		303'	July/67		
21		411'	July/67		
22		186.5'	Sept/67		
T 53151	"A"	141'	May/65	(1)	
T 50967	21	201'	May/65		
	22	205'	June/65		
	23	201'	July/65		
	24	240'	July/65		
	25	238'	July/65		
	26	242'	July/65		
	27	129'	July/65		

Notes:

(1) P. Libby is the lessee of T 53151

G. Deane
come on property. ex 150989
DIAMOND DRILL RECORD

Hole No. **1** Sheet No. **1**
 Property **Libby Claims**
 Drilled by **G. Deane**
 Date Begun **Aug. 31, 1962**
 Date Finished **Sept. 5, 1962**
 Contractor's Footage

Co-ordinates Collar
 Lat. Dept.
 Elev. Collar
 Bearing **S. 43° W.**
 Angle **45°**
 Working Place **T. 50889**

Total Depth **334.9'**
 Ft. of Core Recovered **001.25**
 % Recovery
 Size Bit Used
 Size Core
RECEIVED
001.25.1962
MINING DIVISION

Depth Feet	Formation	Sample No.	Width	Ozs. Au.	Ozs. Ag.	% Cu.	% Ni.	% Zn.
0.0	<u>CASING.</u>							
15.3								
15.3	<u>KEWATIN GREENSTONE -</u>							
50.0	<u>ANDESITE - mostly carbonate</u>							
	<u>schists with shearing @ 45°</u>							
	<u>to core. Green to brown</u>							
	<u>(oxidized) mottled rock, may</u>							
	<u>be some tuff</u>							
	<u>46.0' - 47.0' - broken core</u>							
	<u>with some qu. No mineral.</u>							
50.0	<u>51.0' - 2" qu. in agglomerate</u>							
114.0	<u>65.1' - 5" qu. " "</u>							
	<u>68.5 - 71.5' qu. & schist with</u>							
	<u>light pyrite in agglomerate</u>	51	3.0"					
	<u>99.6 - 102.0 pyritized car-</u>							
	<u>bonate schist</u>	52	2.4"					
134.0	<u>Carbonated Shear possibly</u>							
180.0	<u>tuff - light coloured mottled</u>							
	<u>rock. 144.5' - 5" pyritized</u>							
	<u>shear.</u>							
186.0	<u>AGGLOMERATE & TUFF.</u>							
230.0	<u>Sheared @ 45° to core.</u>							
	<u>Few narrow quartz stringers</u>							
	<u>@ long angles to core.</u>							
	<u>225.4 - 225.8' - qu. vein</u>							
	<u>with much pyrite.</u>							
	<u>SAMPLE</u>	53	4"					
230.0	<u>ANDESITE.</u>							
258.0	<u>Light shear with small quartz</u>							
	<u>veins - long angles to core.</u>							
258.0	<u>DIABASE DYKE (or diorite)</u>							
291.0	<u>Contact @ 45° to core</u>							
	<u>Fine grained green rock with</u>							
	<u>qu. and calcite veins. No</u>							
	<u>Mineral.</u>							

DIAMOND DRILL RECORD

Hole No. **2** Sheet No. **1**
 Property **Libby Claims**
 Drilled by **G. DeCaire**
 Date Begun **Sept. 7, 1962**
 Date Finished **Sept. 15, 1962**
 Contractor's Footage

Co-ordinates Collar
 Lat. Dept.
 Elev. Collar
 Bearing **S. 45° W.**
 Angle **- 35°**
 Working Place **Claim T. 50989**

Total Depth **344.0'**
 Ft. of Core Recovered
 % Recovery
 Size Bit Used
 Size Core **AXX.**

Depth Feet	Formation	Sample No.	Width	Ozs. Au.	Ozs. Ag.	% Cu.	% Ni.	% Zn.
0.0 1.0	<u>CASING.</u>							
1.0 44.0	<u>AGGLOMERATE (KSEWATIN)</u> Highly carbonated and sheared rock with disseminated pyrite.							
	<u>SAMPLES:</u>							
	1.0 - 6.0' pyritized and carbonated shear	54	5.0'					
	6.0 - 11.0	55	5.0'					
	11.0 - 16.0'	56	5.0'					
	16.0 - 21.0'	57	5.0'					
	21.0 - 26.0'	58	5.0'					
	26.0 - 31.0'	59	5.0'					
	31.0 - 34.0	60	3.0'					
	34.0 - 39.0	61	5.0'					
44.0 54.5	<u>TUFF</u> - white silicified rock with clear fragments.							
54.5 107.0	<u>AGGLOMERATE</u> with fragments up to 2". Some altered & pyritized sections. Sheared @ 45° to core							
	57.5 - 60.5' light pyrite	62	3.0'					
	79.0 - 84.0' scattered pyrite in rusty agglomerate	63	5.0'					
	92.4 - 97.4' - scattered pyrite in dark agglomerate	64	5.0'					
107.0 150.6	<u>TUFF</u> white silicified rock as above. Few dark chlorite streaks and short vein sections.							
	132.0 - 132.4 - quartz & chlorite with heavy pyrite	65	5"					
150.6 156.0	<u>AGGLOMERATE</u> as above							

DIAMOND DRILL RECORD

Hole No. 2	Sheet No. 3	Co-ordinates Collar	Total Depth.....
Property Libby Claims.		Lat..... Dept.....	Ft. of Core Recovered.....
Drilled by.....		Elev. Collar.....	% Recovery.....
Date Begun.....		Bearing.....	Size Bit Used.....
Date Finished.....		Angle.....	Size Core.....
Contractor's Footage.....		Working Place.....	

Depth Feet	Formation	Sample No.	Width	Ozs. Au.	Ozs. Ag.	% Cu.	% Ni.	% Zn.
150.6	151.5 - 155.5' - pyritized agglomerate	66	4.0'					
156.0								
156.0	TUFF. as above.							
174.6								
174.6	AGGLOMERATE as above with scattered pyrite and few narrow quartz veins. Sheared @ 30° to core.							
195.0								
	SAMPLES. 176.5 - 180.0'	67	3.5'					
	180.0 - 185.0	68	5.0'					
	185.0 - 190.0	69	5.0'					
	190.0' - 194.5'	70	4.5'					
195.0	TUFF as above, few small blebs of pyrite							
206.0								
206.0	AGGLOMERATE as above							
232.0								
	6" barren quartz @ 215'.							
	210.5 - 215.0' - pyritized	71	4.5'					
	227.6 - 231.6' - pyritized	72	4.0'					
232.0	TUFF - as above							
259.6								
259.6	AGGLOMERATE & TUFF							
296.0								
	Scattered vein matter at various angles to core							
	271.6 - 277.0'	73	6.0'					
296.0	AGGLOMERATE - dark chloritized rock with many fragments - no sulphides.							
311.4								
311.4	ANDESITE green massive rock with small quartz veins @ various angles & light shear @ 30°							
344.0								
	HOLE END - 344.0'							

NOTE: Forty-five split core samples were taken from drill holes Nos. 1 to 5 and left in safe keeping with G. Decaire Oct. 18, 1962.

Log By *E. L. MacVeigh*
for E. L. MacVEIGH

DIAMOND DRILL RECORD

Hole No. **1** Sheet No. **1**
 Property **Libby Claims**
 Drilled by **G. Deoaire**
 Date Begun **Sept. 17, 1962**
 Date Finished **Sept. 25, 1962**
 Contractor's Footage

Co-ordinates Collar
 Lat. Dept.
 Elev. Collar **8,450 W.**
 Bearing **- 35°**
 Angle
 Working Place **Claim T. 50989.**

Total Depth **259.5'**
 Ft. of Core Recovered
 % Recovery
 Size Bit Used
 Size Core **AXT.**

Depth Feet	Formation	Sample No.	Width	Ozs. Au.	Ozs. Ag.	% Cu.	% Ni.	% Zn.
0.0	<u>CASING</u>							
5.5'								
5.5'	<u>AGGLOMERATE CASING</u>							
147.3'	Mottled dark rock with numerous fragments up to 2". Sheared @ 45° to core. Few scattered narrow quartz veins. Pyritized sections sampled							
	5.5 - 0.5' rusty agglomerate	74	4.0'					
	47.0 - 49.6' pyritized agglomerate	75	2.6'					
	59.0 - 62.8' pyritized quartz and sheared agglomerate	76	3.8'					
	88.3 - 90.5' pyritized agglomerate	77	2.2'					
	98.8 - 100.3' rust zone	78	1.5'					
	134.6 - 137.0' -pyritized agglomerate	79	2.4'					
147.3	<u>TUFF (Rhyolite) white silicified rock</u>							
173.0	167.0 - 170.2' - quartz vein barren.	80	3.2'					
173.0	<u>AGGLOMERATE & TUFF.</u>							
225.0	Few narrow quartz veins							
	191.5 - 194.0' pyritized agglomerate with 1" qu. vein	81	2.5'					
225.0	<u>AGGLOMERATE - few quartz veins up to 6"</u>							
259.5	236.0 - 240.4' 6" quartz with pyritized agglomerate	82	4.4'					
	241.6 - 245.4 pyritized agglomerate	83	3.8'					

DIAMOND DRILL RECORD

Hole No. 4 Sheet No. 1 Co-ordinates Collar
 Property Libby Claims. Lat. Dept.
 Drilled by G. Decaire Elev. Collar
 Date Begun Sept. 26, 1962 Bearing S. 45° W.
 Date Finished Oct. 5, 1962 Angle 7.35
 Contractor's Footage Working Place Claim T. 50589 Total Depth 400.0'
 Ft. of Core Recovered
 % Recovery
 Size Bit Used
 Size Core ATT.

Depth Feet	Formation	Sample No.	Width	Ozs. Au.	Ozs. Ag.	% Cu.	% Ni.	% Zn.
0/0 4.0	<u>CASING.</u>							
4.0 70.0	<u>ANDESITE</u> dark green massive, fine grained rock with numerous small quartz stringers & various angles to core, all barren.							
70.0 84.5	<u>LAMPROPHYRE DYKE</u> Dark red rock with light green spots of altered hornblende. Contacts indistinct.							
84.5 98.0	<u>ANDESITE</u> as above.							
98.0 225.0	<u>AGGLOMERATE & TUFF</u> With numerous small quartz veins @ various angles to core.							
225.0 227.5	<u>LAMPROPHYRE DYKE.</u> Fresh dark rock with indistinct contacts.							
227.5 400.0	<u>AGGLOMERATE & TUFF</u> as above. 238.5 - 239.2 quartz vein with sparse pyrite 250.5 - 252.0 quartz vein with sparse pyrite 305' - 308' - quartz vein, no mineral 384.0 - 387.5 lm. veinlets and sheared agglomerate pyritized.	85 86 87	0.7' 1.5' 3.5'					
	<u>HOLE END - 400.0'</u>							
	<u>NOTE:</u> Forty-five split core samples were taken from Drill Holes Nos. 1 to 5, and left in safe keeping with G. Decaire Oct. 18, 1962.							

Log By

for E. L. MacVEIGH

DIAMOND DRILL RECORD

Hole No. **5** Sheet No. **1** Co-ordinates Collar Total Depth **320.8'**
 Property **Libby Property** Lat. Dept.
 Drilled by **G. Decaire** Elev. Collar Ft. of Core Recovered
 Date Begun **Oct. 9, 1962** Bearing **S. 50° W.** % Recovery
 Date Finished **Oct. 18, 1962** Angle **35°** Size Bit Used
 Contractor's Footage Working Place **Claim T. 50889** Size Core **AXT.**

Depth Feet	Formation	Sample No.	Width	Ozs. Au.	Ozs. Ag.	% Cu.	% Ni.	% Zn.
0.0 4.5'	CASING.							
4.5 146.0	ANDESITE (Keowatin) Dark green massive rock with numerous small barren quartz veins @ various angles to core. Sheared @ 60° to core. 27.0 - 28.5' quartz & schist with light pyrite	88	2.5'					
	121.5 - 123.5 rusty qu. and shear	89	2.0'					
	132.0 - 135.0 rusty qu. & shear	90	3.0'					
146.0 320.8	AGGLOMERATE & TUFF. Green mottled rock with light shearing @ 60° to core. 150.2 - 151.2' pyritized quartz & schist, light pyrite	91	1.0'					
	179.3 - 180.5 - qu. & schist with sulphide blebs	92	1.2'					
	278.0 - 280.0 - qu. & shear light pyrite	93	2.0'					
	305.0 - 306.5 pyritized qu. & shear	94	1.5'					
	308.8 - 309.8' qu. vein with 1" of rust	95	1.0'					
	HOLE END - 320.8'							
	NOTE: Forty-five split core samples were taken from Drill Holes Nos. 1 to 5, and left in safe keeping with G. Decaire Oct. 18, 1962.							

Log By *E. L. MacVeigh*
for E. L. MacVEIGH

Location of Hole #6 - #2 feet plus 530' W. on line plus 75' N.

DIAMOND DRILL RECORD

Hole No. **6** Sheet No. **1** Co-ordinates Collar
 Property **Libby Claims** Lat. Dept.
 Drilled by **C. A. Deering** Elev. Collar
 Date Begun **Nov. 15, 1962** Bearing **S73° W.**
 Date Finished **Nov. 30, 1962** Angle **-45°**
 Contractor's Footage Working Place **Claim T. 51927** Total Depth **235.3'**
 Ft. of Core Recovered
 % Recovery
 Size Bit Used
 Size Core **ATF.**

Depth Feet	Formation	Sample No.	Width	Ozs. Au.	Ozs. Ag.	% Cu.	% Ni.	% Zn.
0.0	<u>CASING.</u>							
2.5								
2.5	<u>AGGLOMERATE</u>							
50.0	Amphibolitic rock with irregular fragments. Sheared at 30° to core. Few narrow quartz veins (1/8") @ 60° to core. Light pyritization from 24.0' - 25.0'							
	42.5 - 44.0 - pyritized agglomerate with quartz.	96	1.5'					
50.0	<u>AGGLOMERATE</u> , as above with numerous small barren quartz veins.							
76.0	61.3 - 64.0 pyrite seams in agglomerate with quartz. 1/8" massive pyrite	97	0.7'					
75.5	<u>AGGLOMERATE</u> . Densely packed elastic with dark angular fragments up to 2". (NOTE: This could be a horizon marker)							
109.0	75.5 - 76.5 quartz vein at contact of coarse and fine agglomerate	98	1.0'					
	# 82.0' core leached & broken for 1'							
	# 94.0 rusty seam with light pyrite							
109.0	<u>AGGLOMERATE</u> . coarse fragmental							
122.5	as at START of hole							
	# 116.5 - 1" foldover vein @ 60° to core.							

Log By. *E. L. MacVeigh*
 for E. L. MacVEIGH

DIAMOND DRILL RECORD

Hole No.	Sheet No. 2	Co-ordinates Collar	Total Depth..... 228.3
Property..... Libby Claims		Lat..... Dept.....	Ft. of Core Recovered.....
Drilled by..... C. Decaire		Elev. Collar.....	% Recovery.....
Date Begun.....		Bearing.....	Size Bit Used.....
Date Finished.....		Angle.....	Size Core..... AXT.
Contractor's Footage.....		Working Place.....	

Depth Feet	Formation	Sample No.	Width	Ozs. Au.	Ozs. Ag.	% Cu.	% Ni.	% Zn.
122.5 127.0	QUARTZ-VEIN. 50% Quartz and 50% agglomerate with some chlorite schist. Sparre except for small patches of pyrite.	99	3.0"					
127.0 127.5	AGGLOMERATE * as above							
127.5 138.0'	LAMPROPHYRE Medium to fine grained fresh rock with white feldspar phenocrysts. Contacts * 60° to core some small irregular quartz veinlets.							
138.0 146.0	AGGLOMERATE as above							
146.0 153.5	LAMPROPHYRE DYKE with dark hornblende crystals.							
153.5 228.3	AGGLOMERATE - as above Many small quartz stringers 168.6 - 173.0 quartz veinlets in agglomerate Sparre pyrite. 182.5 - 183.8 pyritized agglomerate	100 101	3.4" 1.5"					
	HOLE END - 228.3'							

Log By *E. L. MacVeigh*
for E. L. MacVEIGH

For Filmy

Collar Loc #2 Post of T. 51727 530' W. on line plus 75' N.

DIAMOND DRILL RECORD

Ext. **1** Sheet No. **1**
 Hole No. **Phil Libby**
 Property **W. Cochrane**
 Drilled by **W. Cochrane**
 Date Begun **Apr. 20, 1964**
 Date Finished **May 1, 1964**
 Contractor's Footage **122.0'**

Co-ordinates Collar
 Lat. Dept.
 Elev. Collar **S. 73° W.**
 Bearing **- 35°**
 Angle
 Working Place **Claim T. 51727**

Total Depth... **238.3 to 360.0'**
 Ft. of Core Recovered... **122.0'**
 % Recovery
 Size Bit Used
 Size Core... **AXT.**

Depth Feet	Formation	Sample No.	Width	Ozs. Au.	Ozs. Ag.	% Cu.	% Ni.	% Zn.
	NOTE: Drilling of first 238.3' carried out Nov. 15 to Nov. 30 1962. Hole deepened Apr. 20 - May 1st, 1964.							
238.3 300.0	AGGLOMERATE. Coarse fragmental in keratin volcanics. Green altered and carbonatized rock lightly sheared @ 70° to core. Few barren quartz stringers up to 1".							
	259.5 - 260.5 - pyritized and silicified lava	26	1.5'					
	289.1 - 292.0 lightly pyritized lava.	27	3.0'					
300.0 329.0	AGGLOMERATE - altered chloritized and carbonatized green rock with barren quartz veins at various angles to core.							
329.0 360.0	AGGLOMERATE as above with few narrow quartz veins @ low angles to core.							
	@ 351.2' - 1" quartz with heavy pyrite	28	0.1'					
	HOLE END - 360.0'							

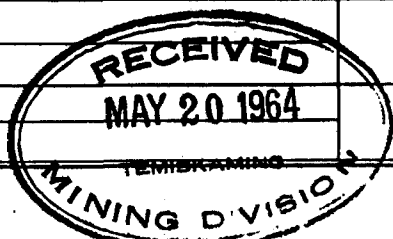

Log By... *[Signature]*
 for E. L. MacVEIGH

WORK FILING COPY

Collar Location: #2 Post of T.51727 plus 530W. on line plus 75' N.
DIAMOND DRILL RECORD same as Hole #6.

Hole No. **7** Sheet No. **1** Co-ordinates Collar
 Property **Libby Claims** Lat. Dept.
 Drilled by Elev. Collar
 Date Begun **May 1st, 1964** Bearing **S73° W.**
 Date Finished **May 10, 1964** Angle **-45°**
 Contractor's Footage Working Place **Claim T.51727** Total Depth **363.0'**
 Ft. of Core Recovered
 % Recovery
 Size Bit Used
 Size Core **AXT.**

Depth Feet	Formation	Sample No.	Width	Ozs. Au.	Ozs. Ag.	% Cu.	% Ni.	% Zn.
0.0	<u>CASING:</u>							
3.0								
3.0	<u>AGGLOMERATE</u> Keowatin volcanic							
77.0	rock showing irregular dark and light fragments in green matrix. Light shearing @ 45° to core and small 1/2" barren quartz veins up to 1" wide @ various angles to core. Sparse pyrite streaks.							
	@ 44.5 - 45.0 - quartz in narrow shear zone with pyrite	29	0.5'					
77.0	<u>AGGLOMERATE</u> - even grained white							
109.0	fragments approximately 1/2" - 3/4" in size. Resembles grit. Ground mass dark green sheared at 45° to core.							
	@ 100.4 - 103.0 - Fine agglomerate pyritized and sheared with small quartz veins	30	2.6'					
	@ 102.5 - 104.0 - pyritized agglomerate	31	1.5'					
109.0	<u>AGGLOMERATE</u>							
180.0	Fragments up to 3" with barren white quartz stringers and patches.							
	@ 126' - 127' shear zone with quartz veins							
	@ 152.8' - 155.0' qu. in shear	32	2.2'					
	@ 158.3 - 159.3' qu. in shear	33	1.0'					
	@ 167.4 - 168.4' rust zone							
	@ 178.0 - 2" qu. vein barren							

Log By..... for E. L. MacVEIGH

DIAMOND DRILL RECORD

Hole No. 7	Sheet No. 2	Co-ordinates Collar	Total Depth 363.0'
Property Phil Libby	Lat.	Dept.	Ft. of Core Recovered.
Drilled by	Elev. Collar	Bearing	% Recovery
Date Begun	Angle	Working Place Claim T. 51727	Size Bit Used
Date Finished	Contractor's Footage		Size Core

Depth Feet	Formation	Sample No.	Width	Ozs. Au.	Ozs. Ag.	% Cu.	% Ni.	% Zn.
180.0 205.6	AGGLOMERATE: Very little vein quartz.							
205.6 280.0'	AGGLOMERATE with numerous barren quartz veins.							
	@ 205.5 - 207.3' - quartz vein at 90° to core with fine pyrite	34	0.7'					
	@ 228.8 - 230.0' quartz & sheared greenstone - little pyrite	35	1.2'					
281.0 303.5	DIORITE Medium grained, green chloritized rock showing shearing at 45° to core. Vein in contact at 300'. Sharp contact at 281.0' at 60° to core. Rock shows several small quartz veins mostly at 60° to core and one large vein - mostly barren white quartz.							
	@ 291.0 - 293.7' white quartz vein in diorite, Very little mineral.							
	@ 285.0' - 289.2' - sheared diorite with scattered pyrite and pyrite streaks - few qu. veinlets	36	4.2'					
303.5 311.6	ANDESITE - may be part of agglomerate but no fragments visible. Black hornblende streaks in light green rock.							
311.6 314.6	DIORITE, As above. Short dyke section with pyrite & chalcopyrite and qu. veinlets @ 311.6 - 314.6'	37	3.0'					

Log By.....
for E. L. MacVEIGH

COLLAR LOCATION: No.2 Post L.51727 Plus 700' N.80° W.

DIAMOND DRILL RECORD

Hole No. **8** Sheet No. **1** Co-ordinates Collar
 Property **Libby Claims** Lat. Dept. Total Depth **361.0'**
 Drilled by **Libby** Elev. Collar Ft. of Core Recovered
 Date Begun **May 1, 1964** Bearing **S. 77° W.** % Recovery
 Date Finished **May 15, 1964** Angle **-45°** Size Bit Used
 Contractor's Footage Working Place **Claim L.51727** Size Core **AXT.**

Depth Feet	Formation	Sample No.	Width	Ozs. Au.	Ozs. Ag.	% Cu.	% Ni.	% Zn.
0.0/ 74.0'	CASING - 10 Ft. ANDESITE & AGGLOMERATE Gray, medium grained rock with numerous irregular quartz veins -barren, Light shearing in short sections. @ 68.3 - 69.7 - sheared section with light pyrite	151	1.5'					
74.0/ 135.0'	AGGLOMERATE: light colored rock mottled with chlorite spots. Scattered pyrite grains. Barren quartz veins at various angles to core. Light shearing at 45° to core.							
135.07 177.0'	AGGLOMERATE: hard massive, gray rock with small barren quartz veins. (Andesite) Sparse pyrite in short sections. @ 166.0' - 168.0' barren quartz in sheared agglomerate. No sulphides.							
177.0/ 215.7'	AGGLOMERATE & TUFF. Tuff sections show dark vesicular chlorite spots. Few barren quartz veins. @ 213.5 - 214.5' pyritized agglomerate near dike.							
	SAMPLE -	152	1.0'					
215.7'/ 217.0	BASIC DIKE: Probably lamprophyre. Fair pyrite mineralization.							
	SAMPLE 215.7' - 217.0	153	1.3'					
217.0/ 270.5	AGGLOMERATE: Light colored grit and fragmental.							

Log By.....
for E. L. MacVEIGH

CLAIM T. 50989

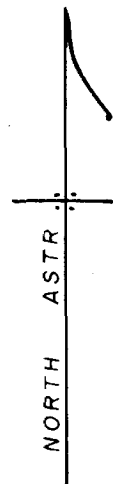
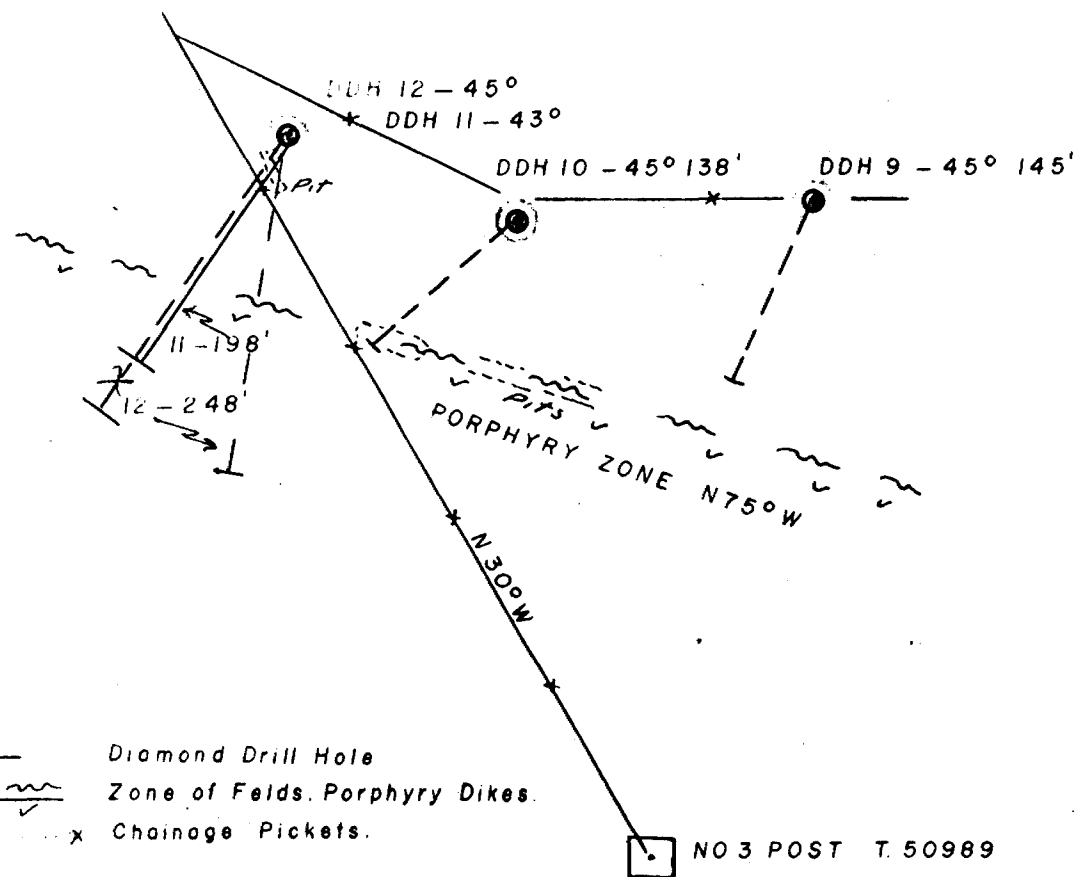

SCALE 1" = 200'

○ --- Diamond Drill Hole
--- Zone of Felds. Porphyry Dikes.
x --- Chainage Pickets.

NO 3 POST T. 50989

LIBBY MINING CLAIMS
BRYCE TWP., ONT.

E. L. MacVeigh B.A., M.S.
E.L. MACVEIGH 21/VIII/64

COLLAR LOCATION: No. 3 Post L. 50989 plus 430' N. 24° E.

DIAMOND DRILL RECORD

Hole No. 9 Sheet No. 1
 Property Libby Claims
 Drilled by Libby
 Date Begun May 1, 1964
 Date Finished May 30, 1964
 Contractor's Footage

Co-ordinates Collar
 Lat. Dept.
 Elev. Collar
 Bearing S. 25° W.
 Angle -45°
 Working Place Claim 50989

Total Depth 1450'
 Ft. of Core Recovered
 % Recovery
 Size Bit Used
 Size Core AXT.

Depth Feet	Formation	Sample No.	Width	Ozs. Au.	Ozs. Ag.	% Cu.	% Ni.	% Zn.
00.0' / 48.0'	<u>ANDESITE: amygdaloidal lava with amygdules filled with calcite & quartz. Rusty seams & numerous sheared slips @ 45° to core. Few quartz-calcite veins. @ 8' to 10.0' pyritized andesite. @ 13.0 - 13.5' 1" pyritized vein & wall rock</u>							
	<u>SAMPLE</u>	157	2.0'					
	<u>SAMPLE</u>	158	0.5'					
48.0' / 55.8'	<u>FELDSPAR PORPHYRY: Hard red rock with white feldspar phenocrysts. Contact @ 45° to core 52.5 - 54.5 - andesite</u>							
55.8' / 61.5'	<u>ANDESITE as above</u>							
61.5' / 78.3'	<u>ANDESITE highly silicified light colored rock. Amygdaloidal fillings Green chlorite or mica Light pyritization @ 61.5 - 65.0</u>	159	3.5'					
	<u>65.0 - 70.0</u>	160	5.0'					
	<u>70.0 - 75.0</u>	161	5.0'					
	<u>76.0 - 78.0 quartz and shear</u>	162	2.3'					
	<u>SAMPLE</u>							
78.3' / 85.5'	<u>FELDSPAR PORPHYRY - as above</u>							
85.5' / 97.0'	<u>AMYGDALOIDAL LAVA - sheared with light pyrite</u>							
	<u>85.5 - 88.5</u>	163	3.0'					
	<u>91.0 - 95.0</u>	164	4.0'					

Log By.....
 for E. L. MacVEIGH

COLLAR LOCATION: No. 3 Post L. 50989 Plus 370' N.04° E.

DIAMOND DRILL RECORD

Hole No. 10 Sheet No. 1 Co-ordinates Collar
 Property Libby Claims Lat. Dept. Total Depth 138.0'
 Drilled by Libby Elev. Collar Ft. of Core Recovered
 Date Begun May 1-1964 Bearing S. 50° W. % Recovery
 Date Finished May 31-1964 Angle -45° Size Bit Used
 Contractor's Footage Working Place Claim 50989 Size Core AXT.

Depth Feet	Formation	Sample No.	Width	Ozs. Au.	Ozs. Ag.	% Cu.	% Ni.	% Zn.
0.0/ 11.0'	ANDESITE Amygdaloidal lava with chlorite spots							
	@ 5.0' - 11.0' quartz-carbonate vein material in andesite with light pyritization							
	SAMPLE	166	6.0'					
	@ 11.0' - 12.9' contact zone with quartz and pyrite.							
	SAMPLE	167	1.9'					
12.9/ 24.5	FELDSPAR PORPHYRY - brown to buff colored rock with quartz stockwork.							
	@ 23.3 - 24.5' quartz and pyrite.							
	SAMPLE	168	1.2'					
24.5/ 100.0'	KEEWATIN hard, dense grained rock (tuff ?) reddish in color. Light shear and quartz-carbonate veinlets. Considerable pyrite and some chalcopyrite							
	@ 25.0 - 30.0' SAMPLE	169	5.0'					
	30.0 - 35.0' SAMPLE	170	5.0'					
	35.0 - 40.0' SAMPLE	171	5.0'					
	40.0 - 45.0' SAMPLE	172	5.0'					
	50.0 - 55.0' SAMPLE	173	5.0'					
	55.0 - 60.0' SAMPLE	174	5.0'					
	60.0 - 65.0' SAMPLE	175	5.0'					
	69.0' - 74.0' SAMPLE	176	5.0'					
	78.0' - 80.0' SAMPLE	177	2.0'					
	94.0 - 95.0' SAMPLE	178	1.0'					
100.0' / 138.0	FELDSPAR PORPHYRY White feldspar phenocrysts in brown ground mass with quartz stockwork. Scattered pyrite cubes							

Log By
 for E. L. MacVEIGH

COLLAR LOCATION: NO. 3 Post L.50989 plus 430' -N 13° W.

DIAMOND DRILL RECORD

Hole No. 11 Sheet No. 1 Co-ordinates Collar
 Property Libby Claims Lat. Dept.
 Drilled by Libby Elev. Collar
 Date Begun May 1, 1964 Bearing S. 35° W.
 Date Finished May 31, 1964 Angle -43°
 Contractor's Footage Working Place Claim L.50989 Total Depth 198.0'
 Ft. of Core Recovered
 % Recovery
 Size Bit Used
 Size Core AXT.

Depth Feet	Formation	Sample No.	Width	Ozs. Au.	Ozs. Ag.	% Cu.	% Ni.	% Zn.
0.0/ 51.0'	<u>AGGLOMERATE</u> altered and sheared and brecciated, multi-colored rock. Fragments up to 6". No sulphides @ 48.0 - 49.0' coarse feldspar porphyry. Contacts @ 45° to core. (Breccia piece (?))							
51.0/ 113.3'	<u>KEEWATIN VOLCANIC</u> Andesite or tuff. Gray dense grained rock with light shearing Flow or tuff. No sharp contact with agglomerate. Barren quartz veinlets, mostly @ 45° to core. Few quartz sections with light pyrite.							
113.3/ 133.5'	<u>FELDSPAR PORPHYRY</u> with stock-work of quartz. Scattered pyrite, mostly cubes. @ 113.3 - 115.0' <u>SAMPLE</u>	185	1.7'					
	115.0 - 120.0	186	5.0					
	120.0 - 125.0	187	5.0					
	130.0 - 133.5'	188	3.5'					
133.5/ 144.0'	<u>KEEWATIN</u> 137.5 - 138.5 quartz & schist. <u>SAMPLE</u>	189	1.0'					
144.0/ 158.0	<u>FELDSPAR PORPHYRY</u> @ 145.0 - 148.0' -quartz & pyrite. <u>SAMPLE</u> Some Keewatin short sections.	190	3.0'					
158.0/ 198.0'	<u>AGGLOMERATE</u> as above Fragments to 2". Altered and silicified. HOLE END - 198.0'							

Log By E. L. MacVeigh
 for E. L. MacVEIGH

COLLAR LOCATION: NO.3 Post L. 50989 Plus 430' -N13° W.

DIAMOND DRILL RECORD

Hole No. 12 Sheet No. 1 Co-ordinates Collar
 Property Libby Claims Lat. Dept.
 Drilled by Libby Elev. Collar
 Date Begun May 1, 1964 Bearing S.10° W.
 Date Finished May 31, 1964 Angle -45°
 Contractor's Footage Working Place Claim L. 50989 Total Depth 248.0'
 Ft. of Core Recovered
 % Recovery
 Size Bit Used
 Size Core AXT.

Depth Feet	Formation	Sample No.	Width	Ozs. Au.	Ozs. Ag.	% Cu.	% Ni.	% Zn.
0.0/ 105.5'	<u>AGGLOMERATE, multi-colored, altered rock.</u>							
	<u>Light shearing @ 45° to core</u>							
	<u>Few rusty zones.</u>							
	<u>@ 23.5 - 23.9' -quartz-carbonate vein with chalcopyrite and sphalerite</u>							
	<u>SAMPLE</u>	191	0.4'					
	<u>Few tuff bands, Feldspar porphyry pebbles (?)</u>							
	<u>Breccia Zone (?)</u>							
	<u>@ 80.5'-82.5' Qu. veins with pyrite</u>							
	<u>SAMPLE</u>	192	2.0'					
105.5/ 126.0'	<u>FELDSPAR PORPHYRY with bands of altered agglomerate</u>							
	<u>@ 106.5 - 110.0 -pyritized-Sample</u>	193	3.5'					
	<u>@ 110.0 - 115.0 " "</u>	194	5.0'					
126.0/ 150.0'	<u>AGGLOMERATE as above</u>							
150.0/ 174.0	<u>KEEWATIN spotted chlorite alteration. Light colored rock with some shearing.</u>							
	<u>@ 170.0 - 171.0' Quartz shear & pyrite</u>							
	<u>SAMPLE</u>	195	1.0'					
174.0/ 176.0	<u>FELDSPAR PORPHYRY</u>							
176.0/ 248.0'	<u>AGGLOMERATE: Light colored silicified fragments to 6".</u>							
	<u>HOLE END - 248.0'</u>							

Log By... *E. L. MacVeigh*
 for E. L. MacVEIGH

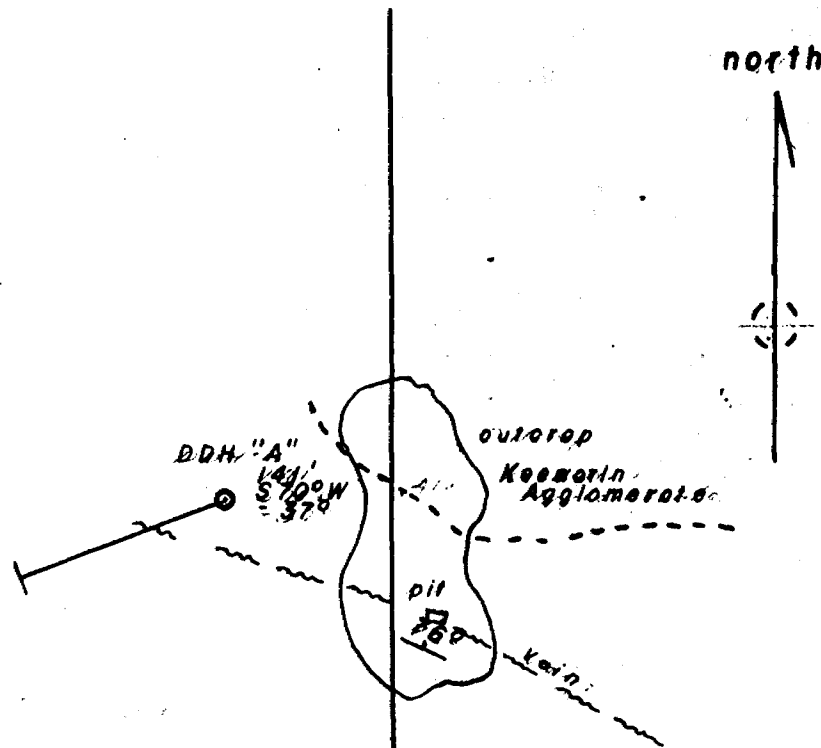

CLAIM T.53151
 NE 1/4, N1/2, Lot 10.

ASSESSMENT FILING
BRYCE TWP., ONTARIO

scale 1" = 100'

No. 2 Post
 T. 53151

Sept. 9, 1965
 E.L. MacVeigh B.A., M.S.

E. MacVeigh

DIAMOND DRILL RECORD

Hole No. Sheet No. **1.**
 Property **Libby Property.**
 Drilled by **P. Libby**
 Date Begun **May 15, 1965.**
 Date Finished **May 20, 1965.**
 Contractor's Footage

Co-ordinates Collar
 Lat. Dep.
 Elev. Collar
 Bearing **S. 70° W.**
 Angle **-37°**
 Working Place **Claim T. 53151**

Total Depth **141.0'**
 Ft. of Core Recovered
 % Recovery
 Size Bit Used
 Size Core **AXT.**

Depth Feet	Formation	Sample No.	Width	Ag	Co	AU.	\$.
0.0' / 8.0'	CASING:						
8.0' / 36.0'	VOLCANIC AGGLOMERATE. Kœwatin, Gray to green rock with fragments to 5". Few narrow quartz stringers to 1/2". No sulphides.						
36.0' / 122.5'	ANDESITE; green rock with dark chloritic spots and white quartz veins. @ 65' - 4" quartz vein.						
122.5' / 129.4'	VEIN MATERIAL: Quartz, carb. veins and pyrite in andesite. SAMPLES:						
	122.5 - 125.5'	1901	3.0'				
	128.0 - 129.4'	1904	1.4'				
129.4' / 141.0'	ANDESITE: as above HOLE END - 141',						

Log by *E. L. MacVeigh*
 For - **E. L. MacVeigh**

BRUCE TWP

DIAMOND DRILL RECORD

Hole No. **1** Sheet No. **1**
 Property **Libby Claims**
 Drilled by **(J. Libby for D. Deoate)**
 Date Begun **May 29, 1965**
 Date Finished **June 5, 1965**
 Contractor's Footage

Co-ordinates Collar
 Lat. Dep.
 Elev. Collar
 Bearing **S. 40° W.**
 Angle **-36°**
 Working Place **Claims T. 50967.**

Total Depth **201.0'**
 Ft. of Core Recovered
 % Recovery
 Size Bit Used
 Size Core **AXT.**

Depth Feet	Formation	Sample No.	Width	Ag	Co	AU.	\$
0.0' / 2.0'	<u>CASING</u>						
2.0' / 68.0'	<u>AMYGDALOIDAL LAVA</u> Andesite with numerous well rounded amygdules, quartz filled. Few barren quartz veins @ 30° to core. No sulphides.						
68.0' / 70.0'	<u>LAMPROPHYRE DIKE:</u> Dark brown, biotite rock. Contacts @ 90° to core.						
70.0' / 143.0	<u>AMYGDALOIDAL LAVA.</u> As above.						
143.0' / 201.0'	<u>AGGLOMERATE:</u> Varicolored rock with some fragments amygdaloidal. Sheared sections at 70° to core.						
	147.0' - 149.4' sheared agglomerate with pyrite. <u>SAMPLE</u>	1907	2.4'				
	154.8' - 157.6' - sheared agglom. with pyrite. <u>SAMPLE</u>	1908	2.8'				
	161.5' - 163.5' - quartz carbonate vein and pyritized agglomerate <u>SAMPLE</u>	1909	2.0'				
	<u>HOLE END - 201.0'.</u>						

Log by *[Signature]*
 For **E. L. MacVeigh**

DIAMOND DRILL RECORD

Hole No. **22** Sheet No. **1**
 Property **Libby Claims**
 Drilled by **(Libby for G. Decaire.)**
 Date Begun **June 10, 1965**
 Date Finished **June 20, 1965**
 Contractor's Footage

Co-ordinates Collar
 Lat. Dep.
 Elev. Collar
 Bearing **S. 23° W.**
 Angle **-37°**
 Working Place **Claim T. 50967**

Total Depth **205.0'**
 Ft. of Core Recovered
 % Recovery
 Size Bit Used
 Size Core **AXT.**

Depth Feet	Formation	Sample No.	Width	Ag	Co	Au.	\$
0.0' / 1.5'	CASING:						
1.5' / 96.8'	VOLCANIC AGGLOMERATE -gray-green rock with well defined fragments up to 4". Few irregular quartz veins-barren. Some rusty, oxidized slips. 1" quartz-carbonate vein @ 63.0'.						
96.8' / 99.8'	QUARTZ-FELDSPAR VEIN 50% white feldspar with irregular quartz and fair pyrite mineralization.						
	SAMPLE 96.8' - 99.8'	1903	3.0'				
	90.8-91.8'	1904	1.0'				
99.8' / 138.2'	VOLCANIC AGGLOMERATE As above. Brown alteration spots of sericite (?) @ 119' - rusty core - fault. 130.4' - 133.0' - pyritized agglomerate						
	134.5' - 138.4' - quartz-carbonate vein in agglomerate	1905	2.6'				
		1906	3.9'				
138.2' / 167.0'	VOLCANIC AGGLOMERATE As above.						
167.0' / 170.5'	Lamprophyre DIKE Contacts @ 60° to core. Gray rock with biotite.						
170.5' / 205.0'	VOLCANIC AGGLOMERATE Few barren quartz veins up to 3"						
	HOLE END - 205.0'						

Log by *Marking*

DIAMOND DRILL RECORD

Hole No. 2	Sheet No. 1	Co-ordinates Collar	Total Depth 240/0'
Property Libby Claims		Lat. Dep.	Ft. of Core Recovered
Drilled by - G. Decaire (Libby for-)		Elev. Collar	% Recovery
Date Begun July 6, 1965.		Bearing S. 60° W.	Size Bit Used
Date Finished July 10, 1965.		Angle -37°	Size Core AXT.
Contractor's Footage		Working Place Claim T. 50967	

Depth Feet	Formation	Sample No.	Width	Ag	Co	Aug.	\$
0/0'	<u>CASING:</u>						
3.5'							
3.5'/9.0'	<u>AMYGDALOIDAL LAVA:</u> Gray-green lava with well rounded amygdules.						
	7.5 - 9.0' pyritized lava with 3" quartz,	1951	1.5'				
9.0'/25.0'	<u>ANDESITE:</u> Massive green lava with narrow barren quartz veins.						
25.0'/39.6'	<u>AMYGDALOIDAL LAVA</u> as above						
39.6'/53.5'	<u>PORPHYRY DIKE:</u> Dense grained sheared rock with small white feldspar phenocrysts. Few barren quartz veins.						
53.5'/61.5'	<u>FLOW BRECCIA:</u> gray-green fragments.						
61.5'/100.0'	<u>DIORITE DIKE:</u> Medium grained, green sheared rock with black hornblende crystals. Contact @ 70° to core.						
	79.0' - 84.0' pyritized diorite	1952	5.0'				
	84.0' - 89.0' pyritized diorite	1953	5.0'				
	89.0' - 91.0' pyritized diorite	1954	2.0'				
100.0'/140.0'	<u>VOLCANIC AGGLOMERATE</u> white fragments in a gray ground mass.						
140.0'/163.0'	<u>DIORITE:</u> Fine grained dark rock						
	142' - 144' - quartz vein with chlorite - barren.						
163.0'/218.0'	<u>ANDESITE</u> - massive lava with chlorite spots. Bleached and altered from 192' to 218'.						

Manning

DIAMOND DRILL RECORD

Hole No. **5** Sheet No. **1**
 Property **Libby Claims for**
 Drilled by **G. Libby**
 Date Begun **July 12, 1965**
 Date Finished **July 16, 1965**
 Contractor's Footage

Co-ordinates Collar
 Lat. Dep.
 Elev. Collar
 Bearing **S 60° W**
 Angle **-60°**
 Working Place **Claim T. 50967**

Total Depth **238.0'**
 Ft. of Core Recovered
 % Recovery
 Size Bit Used
 Size Core **AXT.**

Depth Feet	Formation	Sample No.	Width	Ag	Co	Au.	\$
0.0' / 3.5'	CASING:						
3.5' / 82.5'	AMYGDALOIDAL LAVA Green, massive rock with well rounded amygdules. Numerous barren quartz veins mostly at 30° to core.						
82.5' / 147.0'	AGGLOMERATE - medium grained green rock with small clastic fragments. 104.5 - 106.5' pyritized agglomerate 120.5' - 122.0' pyritized agglomerate	1911 1912	2.0' 2.0'				
147.0' / 206.0'	FLOW BRECCIA - large fragments and flow structure top.						
206.0' / 225.0'	DIKE: Fine grained dark gray rock with irregular quartz veins.						
225.0' / 238.0'	AGGLOMERATE - sheared, mottled rock with irregular fragments. SAMPLES: 191.0-192.3' - pyritized breccia and quartz 205.0 - 205.5' - heavy pyrite in schist, 1" quartz	1913 1914	1.3' 0.5'				
	HOLE END - 238.0'						

Log by *G. Libby*

DIAMOND DRILL RECORD

Hole No. Sheet No. **1.**.....
 Property **Libby Claims**
 Drilled by **G. Decaire**
 Date Begun **July 20, 1965**
 Date Finished **July 25, 1965**
 Contractor's Footage

Co-ordinates Collar
 Lat. Dep.
 Elev. Collar
 Bearing **S. 60° W.**
 Angle **-35°**
 Working Place **Claim T. 50967.**

Total Depth **242.0'**
 Ft. of Core Recovered
 % Recovery
 Size Bit Used
 Size Core **AXT.**

Depth Feet	Formation	Sample No.	Width	Ag	Co	Aug.	\$
0.0' / 3.0'	<u>CASING</u>						
3.0' / 28.0'	<u>ANDESITE</u> ; flow breccia, few barren quartz veins.						
28.0' / 87.5'	<u>AMYGDALOIDAL LAVA</u> and flow breccia with barren quartz veins.						
87.5' / 94.0'	<u>FELDSPAR PORPHYRY DIKE</u> 92.5' - 93.5' - pyritized dike	1915	1.0'				
94.0' / 97.8'	<u>AGGLOMERATE</u>						
97.8' / 100.0'	<u>FELDSPAR PORPHYRY DIKE</u> 97.8 - 100.00' pyritized with quartz.	1916	2.2				
100.0' / 174.0'	<u>AMYGDALOIDAL LAVA</u> Andesite with rounded, quartz filled amygdules.						
174.0' / 238.0'	<u>AGGLOMERATE</u> - highly chloritized and sheared green rock. Much even grained clastic material 226.0 - 227.5' Lamprophyre dike 230.5' - 232.0' - pyritized agglomerate.	1917	1.5'				
238.0' / 242.0'	<u>TUFF</u> : banded, fine grained green rock.						
	<u>HOLE END - 242.0'</u>						

Log by *[Signature]*

T 5 1 7 2 7

1704, 1711, Lot 8, Con. 3

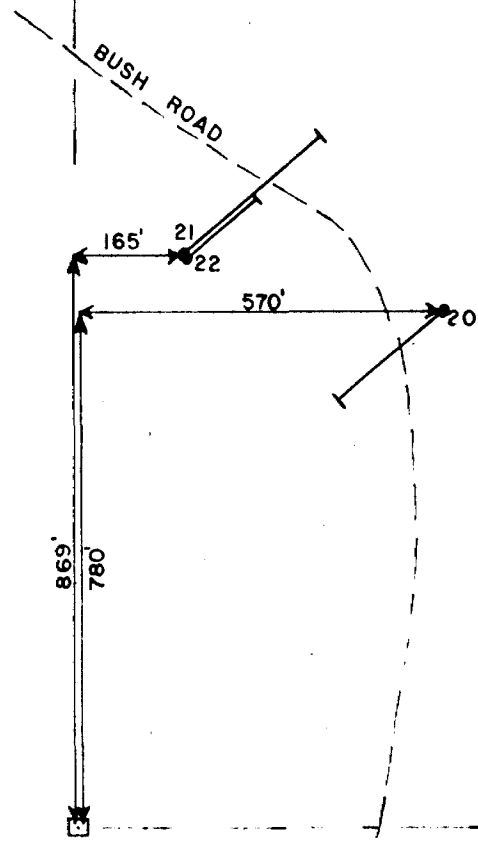

NO. 3 POST
T-51727

LOCATION SKETCH

D.D.H'S 20, 21, 22

G. A. DECAIRE

BRYCE TWP., ONT.

SCALE: 1" = 300'

J. G. Willars
J. G. WILLARS SEPT. 29, 1967.

DIAMOND DRILL LOG

D. D. HOLE NO. 20

PROPERTY G.A. DECAIRE Bryce Twp., Ont.

PAGE 1

LOCATION Claim T 51727 NE¹/₂, S¹/₂, Lot 8, Con. 3

COLLAR: LAT. 780' North of #3 of T 51727

DEP. 579' East of #3 post of T 51727

ELEV. Surface

BEARING S 50° W

DIP -41.5°

DEPTH OF HOLE 303'

STARTED July 11, 1967.

COMPLETED July 21, 1967.

DRILLED BY G.A. Decaire

Core Size AXT

FROM	TO	DESCRIPTION	SAMPLE NO.	CORE FT.
0	10	CASING		
10	23.5	INTERMEDIATE LAVA Light green and greyish, soft, schistic lava flow with banding at 70° to the core axis. Intruded by white quartz-carbonate stringers. Rock contains sparse pyrite specks.		
23.5	45	AGGLOMERATE Irregular sized volcanic bombs in fine grained volcanic ash. Light brown and dark grey colours. Contains scattered pyrite. At 45' 1" shear with carbonate filling.		
45	147	INTERMEDIATE LAVA Banding at 70° to the core axis. Grades intermittenly from coarse grained to fine grained. From 55' - 57' is brecciated and quartz filled FAULT. From 57' - 60' is well fractured. SAMPLES : At 60' - 65' 2% pyrite and at 63' - chalcopyrite Rusted wall rock along fracture. At 90.5' - 92.5' Pyrite specks lying along the banding at 60° to the core axis. From 92' - 100' Brown coloured lava. (alteration) From 127.5' - 127.6' quartz-carbonate with 30% pyrite. Rock contains a few fine grained agglomerate sections and also short sections of amygdaloidal lava.	4133 4134	5.0 2.0
147	170.5	INTERMEDIATE LAVA Light brown or bleached. Fine grained rock containing dark chlorite specks.		
170.5	177.5	DIORITE DIKE Dark green matrix with white feldspar. Medium grained, partly fractured rock with fine grained contacts. Juiced with carbonate stringers. 2 - 5% pyritized. SAMPLES : At 170' - 174' As above At 174' - 178' As above	4135 4136	4.0 4.0
177.5	287.5	AGGLOMERATE Light green to light brown fine grained ash with volcanic bombs. Sparse quartz-carbonate stringers. Scattered seams and patches of pyrite. SAMPLE : At 277' - 279' Quartz-carbonate shear at 60° to the core axis. Sparse pyrite in wall rock. Shear 277.58 - 278.58.	4137	2.0

SIGNED

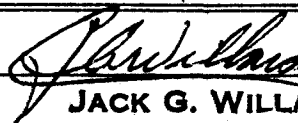

JACK G. WILLARS B.A.Sc., P. ENG.

DIAMOND DRILL LOG

D. D. HOLE NO. 20

PROPERTY G.A. DECAIRE Bryce Twp., Ont.

PAGE 2

FROM	TO	DESCRIPTION	SAMPLE NO.	CORE FT.
287.5	303	<p>AGGLOMERATE Dark green fine grained matrix containing fine grained volcanic bombs up to $\frac{1}{2}$" size.</p>		
	303	END OF HOLE.		

SIGNED

Jack G. Willars

JACK G. WILLARS B.A.Sc., P. ENG.

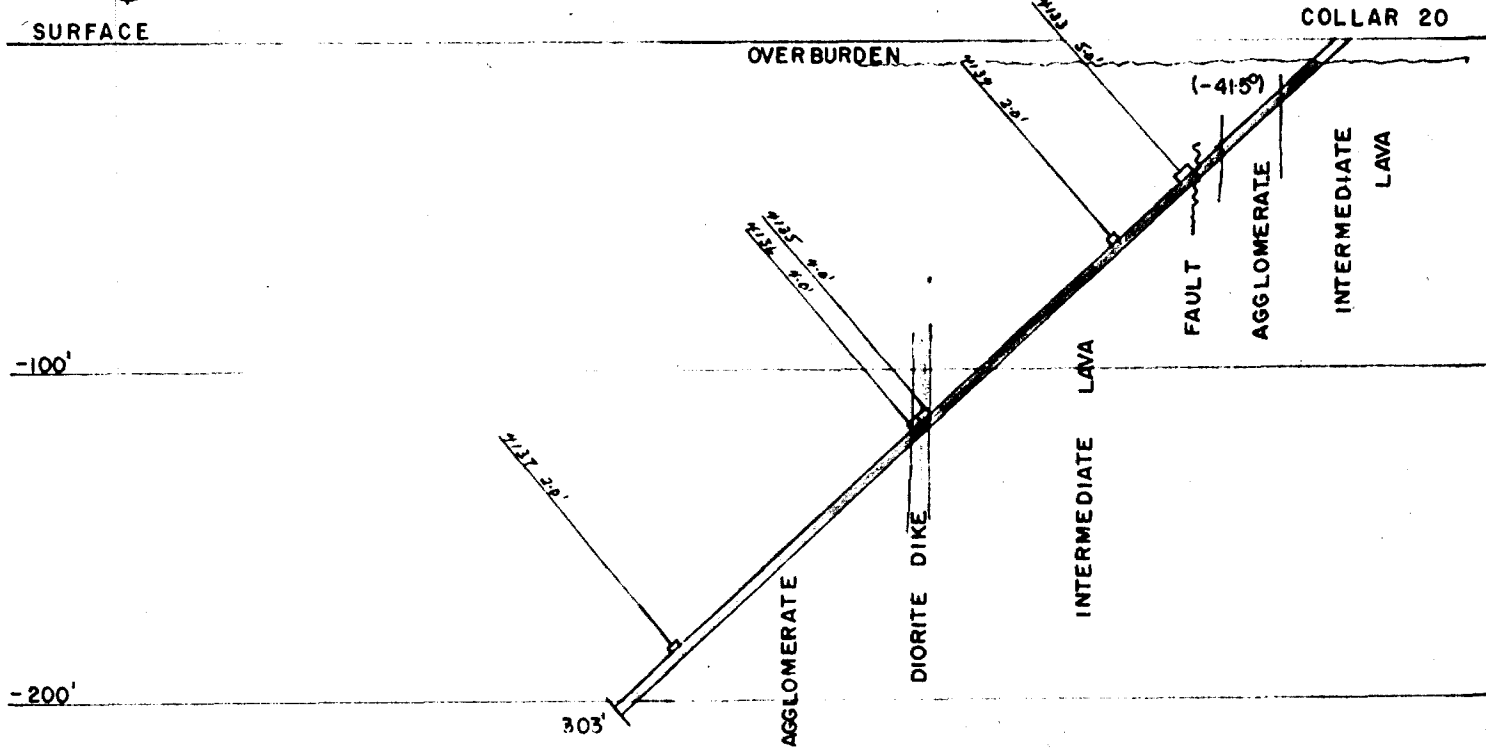
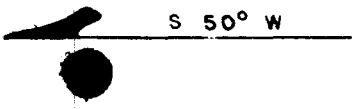

PROFILE SECTION
 (LOOKING NORTHWEST)
 D.D.H. 20
 G. A. DECAIRE
 BRYCE TWP., ONT.
 SCALE: 1" = 60'

J.G. Willars
 J.G. WILLARS SEPT. 29, 1967.

DIAMOND DRILL LOG

D. D. HOLE NO. 21

PROPERTY G.A. DECAIRE Bryce Twp., Ont.

PAGE 1

LOCATION Claim T 51727 NE $\frac{1}{4}$, S $\frac{1}{2}$, Lot 8, Con. 3

COLLAR: LAT. 869' north of post #3 of T 51727

DEP. 165' east of post #3 of T 51727

ELEV. Surface

BEARING N 50° E

DIP -10°

DEPTH OF HOLE 411'

STARTED July 22, 1967.

COMPLETED Sept. 11, 1967

DRILLED BY G.A. Decaire

Core Size AXT

FROM	TO	DESCRIPTION	SAMPLE NO.	CORE FT.
0	8.5	CASING		
8.5	42	AGGLOMERATE Medium grained to fine grained matrix, medium green colour, with irregular sized volcanic bombs of angular shape up to 2" size. Banding roughly at 45° to the core axis. From 48'-48.5' is rusty, vuggy and quartz filled fracture.		
42	55	DIORITE DIKE Fine to medium grained, light green rock with very, fine, grained chilled contacts at 35° to the core axis. From 48'-48.5' is rusty, vuggy and quartz filled fracture.		
55	133	AGGLOMERATE As above at 85' - 42'. White carbonate-quartz stringers at irregular angles to the core axis. From 123'-125' contains 2% pyrite. Rusty quartz and fracturing at bottom contact.		
133	148	AMYGDALOIDAL LAVA Dark green matrix containing white feldspar amygdules, fractured and in part filled with vuggy quartz-carbonate stringers.		
148	286	AGGLOMERATE As above but darker green colour. At 177' 1.5" quartz-carbonate stringers in shear at 60° to the core axis. Contains scattered patches of sparse pyrite. From 225'-250' bleached sections. From 238'-239', and at 247.5' and 248', vuggy quartz shears that are rusted. At 261' 4" fractured and filled with white quartz.		
286	313	AMYGDALOIDAL LAVA Hard, medium grained, fine grained matrix containing white feldspar amygdules. From 300'-304' coarse grained section coloured dark grey. SAMPLE : At 301'-303.5' Pyrite in the rock and at 301.4' quartz-carbonate stringers with pyrite and chalcopyrite.	4138	2.5
313	322	AGGLOMERATE SAMPLE : At 322.5'-324' At 323' is 2" quartz with pyrite and chalcopyrite. Also pyrite and chalcopyrite scattered throughout the rock.	4139	1.5

SIGNED



JACK G. WILLARS B.A.Sc., P. ENG.

DIAMOND DRILL LOG

D. D. HOLE NO. 21PROPERTY G.A. DECAIRE Bryce Twp., Ont.PAGE 2

FROM	TO	DESCRIPTION	SAMPLE NO.	CORE FT.
322	339	AMYGDALOIDAL LAVA Very fine grained and fine grained amygdaloidal lava - well fractured in irregular and many directions and filled with quartz-carbonate . SAMPLE : At 337.58-338.5' pyrite in rock and at 338' is 2" quartz containing pyrite.	4140	1.0
339	352	AGGLOMERATE Well fractured and with quartz-carbonate seams in the fracturing.		
352	371	QUARTZ VEIN Quartz predominantly with some carbonate and the scarce speck of pyrite and chalcopyrite.		
371	392	AGGLOMERATE As above at 339'-352'.		
392	409	AMYGDALOIDAL LAVA Sparse carbonate stringers at irregular attitudes. SAMPLE : At 400'-403' Medium amount of pyrite.	4141	3.0
409	411	FAULT Very rotten, light brown and white, soft rock with pyrite at the upper contact. The hole was stopped here because the capacity limit of the drill was reached at this point.		
	411	END OF HOLE.		

SIGNED



JACK G. WILLARS B.A.Sc., P. ENG.

DIAMOND DRILL LOG

D. D. HOLE NO. 22

PROPERTY G.A. DECAIRE Bryce Twp., Ont.

PAGE 1

LOCATION Claim T 51727 NE $\frac{1}{4}$, S $\frac{1}{2}$, Lot 8, Con. 3
 COLLAR: LAT. 869' north of post #3 of T 51727
 DEP. 165' east of post #3 of T 51727
 ELEV. Surface
 BEARING N 50° E
 DIP -51°

DEPTH OF HOLE 186.5'
 STARTED Sept. 10, 1967
 COMPLETED Sept. 15, 1967
 DRILLED BY G.A. Decaire
 Core Size AXT

FROM	TO	DESCRIPTION	SAMPLE NO.	CORE FT.
0	4	CASING		
4	56	AGGLOMERATE Volcanic bombs up to 2" size in fine grained, light to dark green coloured rock containing sparse white quartz-carbonate stringers.		
56	79	DIORITE DIKE Very fine grained chilled contacts at 30° to the core axis- fine grained white feldspar mottles in a green matrix. - fractured and 10% filled with quartz-carbonate stringers in three different stages - quartz first, then carbonate and then quartz again.		
79	161	AGGLOMERATE As above. At 114' brown carbonate in 4" schisty shear at 35° to the core axis. SAMPLE : At 145.1'-146.5' 1" quartz-carbonate with 30% pyrite and 5% chalcopyrite at 145.6'.	4142	1.5
161	185	AMYGDALOIDAL LAVA Yellow-green at the contact area to green, soft, medium grained, chloritized, schisty amygdaloidal lava. SAMPLE : At 183.5'-185.3' From 184'-184.5' is fractured and contains quartz-carbonate filling and pyrite. Fine pyrite occurs throughout the rock.	4143	1.8
185	186.5	AGGLOMERATE As above.		
	186.5	END OF HOLE.		

SIGNED

Jack G. Willars

JACK G. WILLARS B.A.Sc., P. ENG.

N 50° E

COLLARS

SURFACE

22
(-51°)

21 (-40°)

OVERBURDEN

AGGLOMERATE

DIORITE
DIKE

AGGLOMERATE

AMYGDALOIDAL
LAVA

71°42' 15'

71°43' 18'

AGGLOMERATE

AMYGDALOIDAL
LAVA

AMYGDALOIDAL
LAVA

QUARTZ
VEIN

AMYGDALOIDAL
LAVA

FAULT

411'

AGGLOMERATE

-100'

-200'

-300'

PROFILE SECTION
(LOOKING NORTHWEST)

D.D.H.'S 21 & 22

G. A. DECAIRE

BRYCE TWP., ONT.

SCALE: 1" = 60'

J. G. WILLARS SEPT. 29, 1967.

BY
CHKD. BY

DATE
DATE

SUBJECT

SHEET NO.
JOB NO.

OF

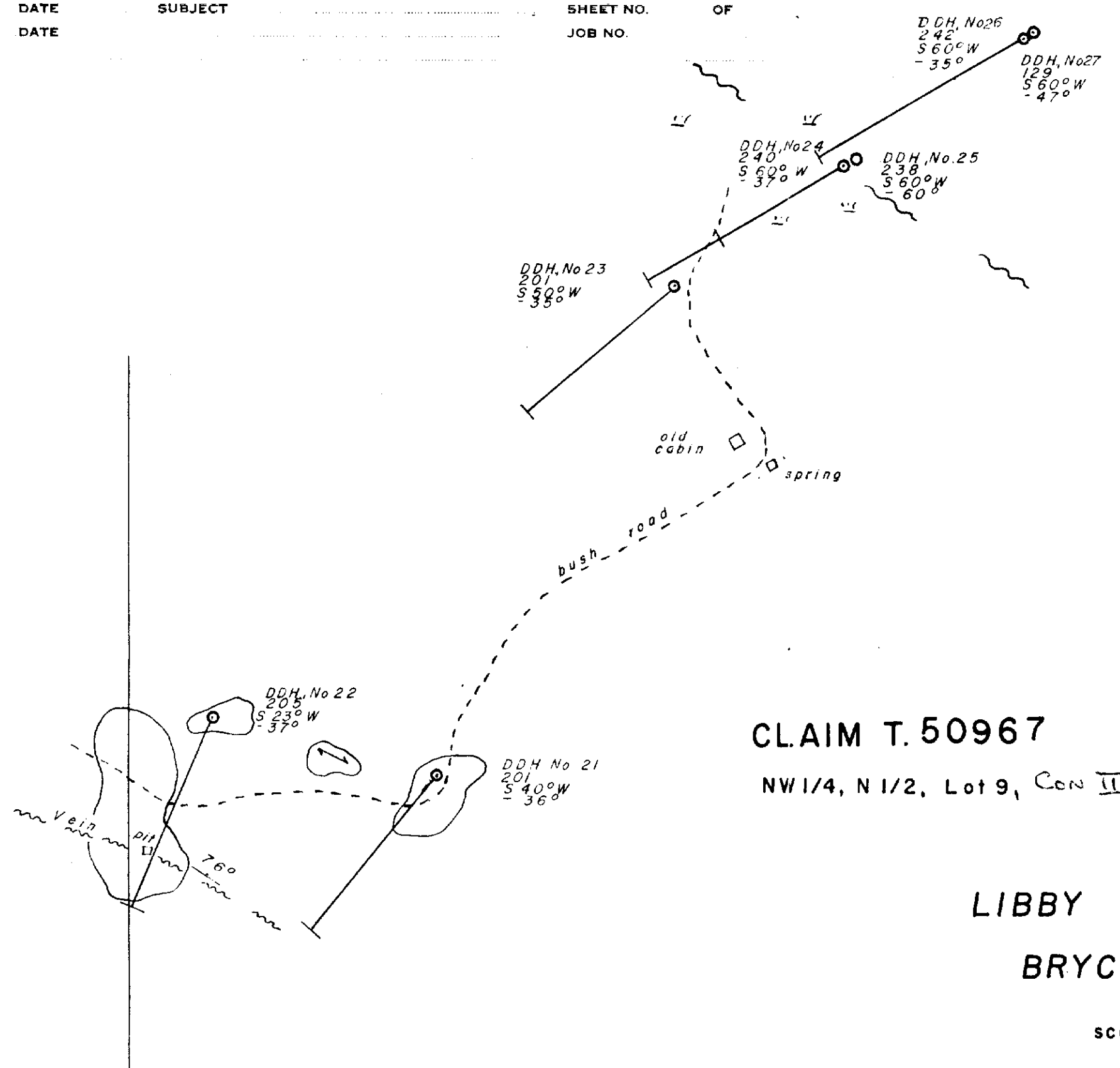

200

No. 3 Post T. 50967

E. L. MacVeigh

Sept 9, 1965 E. L. MacVeigh
B. A. M. S.

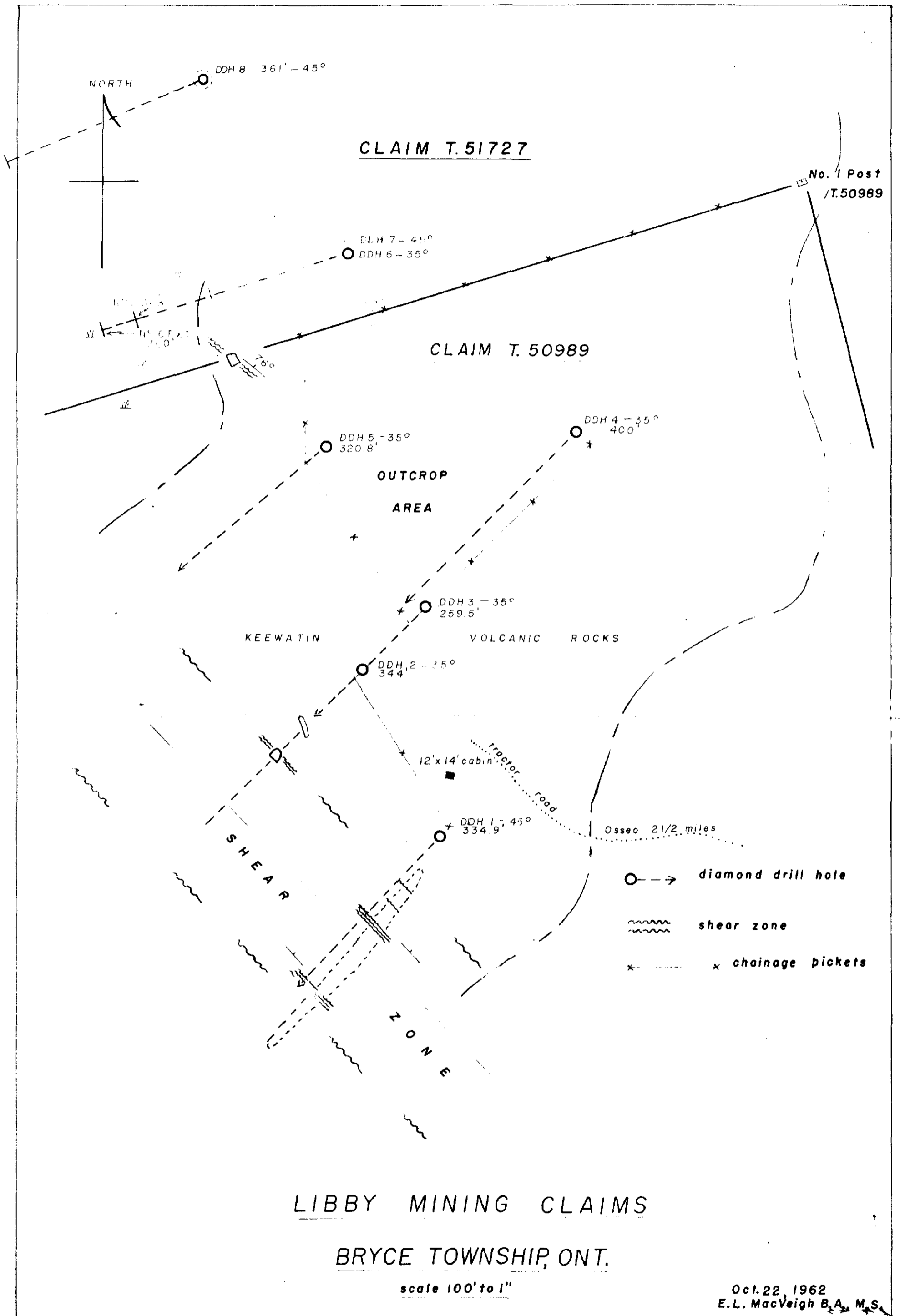

LIBBY MINING CLAIMS

BRYCE TOWNSHIP, ONT.

scale 100' to 1"

Oct. 22, 1962
E.L. MacVeigh B.A., M.S.

UPDATED MAY 12, 1964



41P09NE0058 10 BRYCE