



41P09NW0021 W9680.00519 JAMES

## **PINKERTON PROJECT**

### **OLD BEACON MINE PROPERTY**

This property consists of a block of nine claims located in James Township Lot 3 & 4 Con. I & II Claim # 1223212.

Access to the property is by an old road that is located about four kilometres <sup>W 25 E</sup> south of Elk Lake off the Cooke Lake Road. The road exits on the south side and is now travelable by four-wheel drive vehicles to the old mine site.

All stripping and trenching done on this project was done in the area east of the old shaft located in the northwest quarter of the north half of Lot 3 Con. I.

#### **Geology**

The area is in a Nipissing Diabase dike thought to be about 350 feet deep. The area around the trench is mainly fine to medium grained diabase with quartz and calcite veining.

The Claims were prospected in November 1994. North of the pit area we found many old trenches and pits all mainly filled in with decayed foliage etc. At the base of a piece of high ground we found the remains of an old log camp of three to four buildings.

The remains of what appears to be the wash house with old metal tub and trough was looked at closely. We found a number of old bottles and containers, all American, so I would think that this could be the original Beacon Mine Camp of 1909 - 1913.

We chose to work in the area east of the shaft around a trench that was worked on in 1963-64 by the Salimino Mine Co. This was done so because of Report 62 pages 36 & 37.

Stripping was done in 1995 using a Bantam 200 tracked excavator. 160 metres of stripping was done at a width of about 2.5 metres to the south and east and west on the south side of the old trench. The attached photo's show contacts uncovered and the old trench tht was also cleaned out.

In 1996, wshing, hand stripping and drilling and blasting was done to examine the vein in the old pit and open the new showings.

The vein in the bottom of the old pit is about 10" wide and is carrying silver and cobalt.

The vein in the pit extension is about 3" wide mainly calcite with some quartz showing traces of chalcopryrite and a fair amount of cobalt bloom.

The vein to the south of the trench about 1.5 metres is running parallel to the main vein is about 1/2" wide wih rusty quartz minor hematite and chalcopryrite.

The attached photos show some of the new trenching and also some of the old.



Established 1928

# Swastika Laboratories

A Division of TSL/Assayers Inc.

Assaying - Consulting - Representation

## Assay Certificate

4W-2975-RA1

Company: **G. PINKERTON**

Date: NOV-22-94

Project: *ANDERSON MINE*

Attn: G. Pinkerton

We hereby certify the following Assay of 3 Rock samples submitted NOV-17-94 by .

Sample Number	Ag oz	Co %
J1	810.37	7.99
J2	217.00	0.46
J3	2.05	0.23

Certified by *Denis Charte*

P.O. Box 10, Swastika, Ontario P0K 1T0  
Telephone (705) 642-3244 FAX (705) 642-3300

JAMES TWP.

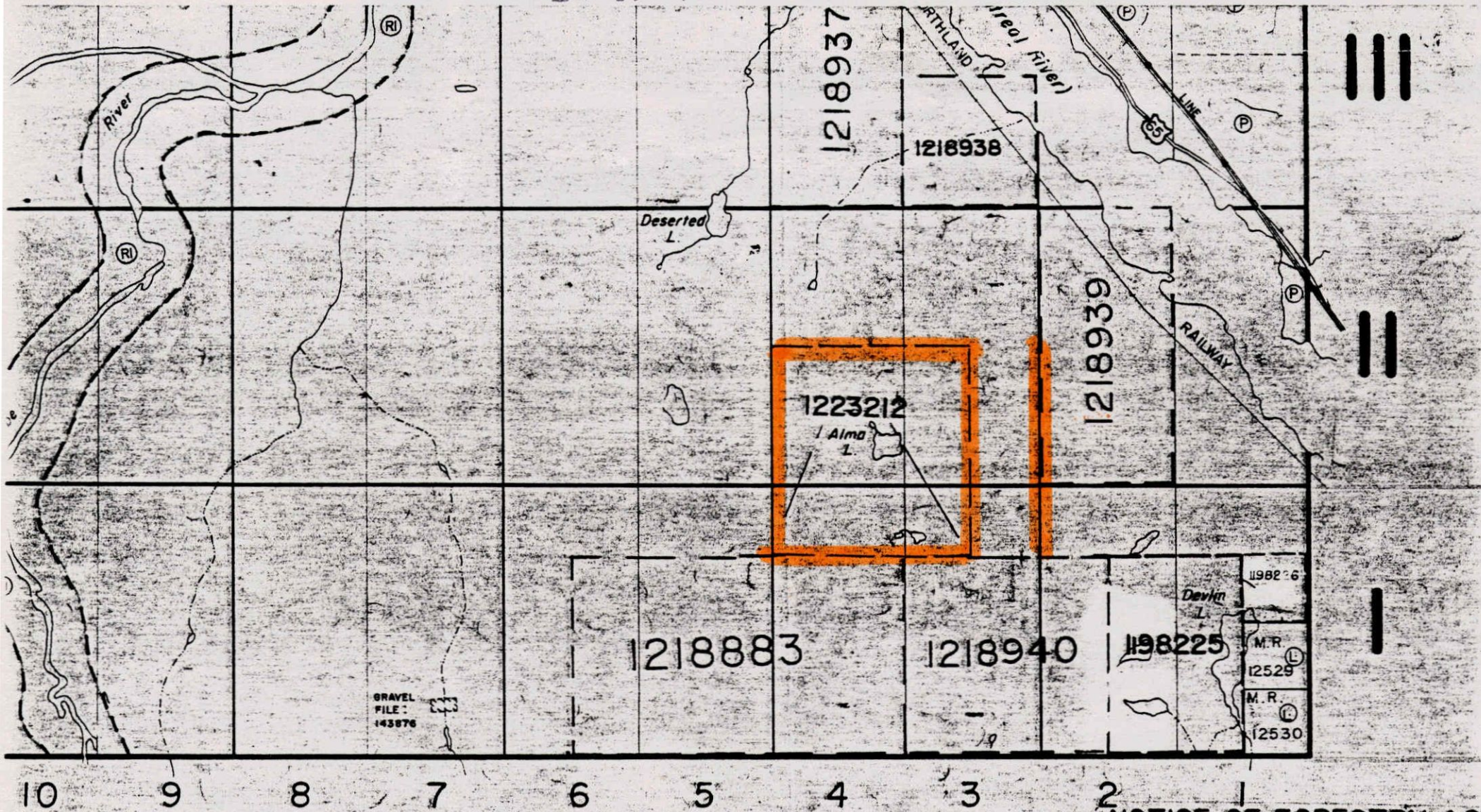

# Willet Tp. M.258

Part of order W-L-01/92 NER REOPENED by order O-ONT-06/92 NER/CR effective March 16 1992 at 4:15 pm E.S.T.

Part of order W-L-01/92 NER REOPENED by order O-ONT-07/92 NER/CR dated March 23 1992 at 8:45 am E.S.T. This Order comes into effect at 7:00 AM E.S.T. on JUNE 1 1992.

## NOTICE OF FORESTRY ACT

THIS TOWNSHIP / AREA FALLS WITHIN THE ELK LAKE MANAGEMENT UNIT

LAND MAY BE SUBJECT TO FORESTRY OPERATIONS UNDER THE MNR UNIT FORESTER FOR THIS AREA CONTACTED AT: P.O. BOX 129

SWASTIKA, ONT.  
POK ITO  
705-642-3222

WAS TO LOOK LAKE RD.

OLD BEACON SHAFT 80M W FROM P.T.

EXCAVATOR TRAIL MADE TO AREA TO BE STRIPPED.

OLD ROAD

Bush.

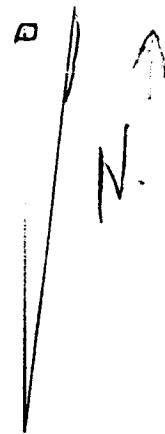

PHOTOS 1-2

BLASTED

OLD TRENCH APPROX 12" TO 18" WIDE - 24" DEEP.

OLD TRENCH

OLD TRENCH - CHEANED OUT - SAMPLED. PHOTO #3

BLAST PHOTO #4

BLAST

PHOTO'S

STRIPPED

Bush.

Bush.

STRIPPED AREA. PHOTO #6

SWAMP

G POWICERSON - OLD BEACON MINE SAKIMINO PROPERTY

1 CM = 5 M.



CRACK



# PINKERTON PROJECT

1994

OCT 30

RAY  
GARFIELD

PINKERTON } PROSPECTING  
                  } OLD MUCK PIKES SHAFT AREA.  
                  } & PITS & TRENCHES. SW AREA CLAIM GROUP.

NOV 1

GARFIELD. PINKERTON

} PUMP OUT PIT  
          } 12 X 25 APPROX.  
          } PROSPECT  
          } TAKE SAMPLES & CLEAN UP.

NOV 5

RAY  
GARFIELD

PINKERTON } PROSPECTING N.E. AREA. OF CLAIM GROUP  
                  } & CAMP AREA. TAKE SAMPLES.

NOV 6

RAY  
GARFIELD

PINKERTON } PROSPECT N.E. & N.W.  
                  } PORTION OF CLAIM GROUP. SAMPLES.  
                  } CHECK FOR BEST ROUTE FOR EXCAVATOR.

1995.

JUNE 23.

GARFIELD  
RAY  
PINKERTON

MECHANICAL STRIPPING  
MOVE HOE ONTO PROPERTY  
CLEAN OUT OLD PIT.

DAVE MULLIN.

CONTRACTOR W/ EXCAVATOR.

JUNE 24

MECHANICAL STRIPPING  
HAND STRIPPING & WASHING.

1996.

AUGUST 31

RAY & GARFIELD

STRIPPING & WASHING.

SEPT 1

RAY & GARFIELD

DRILL & BLAST TAKE  
CLEAN UP. SAMPLES

④ OLD PIT WEST END BEFORE BLAST.



← 3

WEST END AFTER BLAST WASHED & CLEANED UP.  
CLEAR CALCITE VEIN. 2" TO 3" WIDE.  
RUSTY SPOTS W/ FINE PHALTES & CHALCOPYRITES  
& COBALT BLOOM AFTER BLAST.

⑤



← 3

3 WASHING & CLEANING OUT NARROW TRENCH WEST OF PIT

W  
←



CONTACT AREA. APPROX 1.5' S OF OLD PIT.  
RISKY FOR BLASTING  
VEIN APPROX 1/8" WIDE W/ RUSTY QUARTZ. MINOR HEMATITE  
& CHALCOPYRITE.



N.  
↑

5 ~~ON~~ EAST END OF CONTACT AFTER BLAST  
VEIN  $\frac{1}{2}$ " WIDE NO VISUAL MINERALIZATION.



1" E.

6 STRIPPED AREA SOUTH OF OLD TRENCH -



5  
↑



# Report of Work Conducted After Recording Claim

Transaction Number  
**W9680.00519**

## Mining Act

Personal information collected on this form is obtained under the authority of the Mining Act. This information will be used for correspondence. Questions about this collection should be directed to the Provincial Manager, Mining Lands, Ministry of Northern Development and Mines, Fourth Floor, 159 Cedar Street, Sudbury, Ontario, P3E 6A5, telephone (705) 670-7264.

- Instructions:**
- Please type or print and submit it
  - Refer to the Mining Act and Regu Recorder.
  - A separate copy of this form must
  - Technical reports and maps must
  - A sketch, showing the claims the



1e Mining

900

Recorded Holder(s) <b>GARFIELD DONALD PINKERTON</b>		Client No. <b>182588</b>
Address <b>RR#2 ENGLEHART ONT. P051H0</b>		Telephone No. <b>705-544-2797</b>
Mining Division <b>LANDER LAKE</b>	Township/Area <b>JAMES TWP.</b>	M or G Plan No. <b>M 225</b>
Dates Work Performed From: <b>NOV 1 1994</b>	To: <b>SEPT 15 1996</b>	

**Work Performed (Check One Work Group Only)**

Work Group	Type
<input type="checkbox"/> Geotechnical Survey	
<input checked="" type="checkbox"/> Physical Work, Including Drilling	<b>HAND STRIPPING WASHING { PLUGGER } DRILLING } BLASTING</b>
<input type="checkbox"/> Rehabilitation	
<input type="checkbox"/> Other Authorized Work	<b>MECHANICAL TRACKED STRIPPING EXCAVATOR</b>
<input type="checkbox"/> Assays	<b>GRAB &amp; CHIP SAMPLES</b>
<input type="checkbox"/> Assignment from Reserve	

Total Assessment Work Claimed on the Attached Statement of Costs \$ **4,092.00<sup>806</sup>**

**Note:** The Minister may reject for assessment work credit all or part of the assessment work submitted if the recorded holder cannot verify expenditures claimed in the statement of costs within 30 days of a request for verification.

**Persons and Survey Company Who Performed the Work (Give Name and Address of Author of Report)**

Name	Address
<b>GARFIELD PINKERTON</b> <sup>Author</sup>	<b>RR#2 ENGLEHART ONT P051H0 (REPORT)</b>
<b>RAY PINKERTON</b>	<b>RR#2 ENGLEHART ONT P051H0 HELPER</b>
<b>DAVE MULLIN</b>	<b>249 5<sup>TH</sup> ST ELIC LAKE ONT P051G0 (BACK HOE CONTRACTOR)</b>

(attach a schedule if necessary)

**Certification of Beneficial Interest \* See Note No. 1 on reverse side**

I certify that at the time the work was performed, the claims covered in this work report were recorded in the current holder's name or held under a beneficial interest by the current recorded holder.	Date <b>28 SEPT 96</b>	Recorded Holder or Agent (Signature) <i>Garfield D Pinkerton</i>
--	---------------------------	---

**Certification of Work Report**

I certify that I have a personal knowledge of the facts set forth in this Work report, having performed the work or witnessed same during and/or after its completion and annexed report is true.		
Name and Address of Person Certifying <b>GARFIELD D PINKERTON</b>		
Telephone No. <b>705-544-2797</b>	Date <b>28 SEPT 96</b>	Certified By (Signature) <i>Garfield D Pinkerton</i>

**For Office Use Only**

Total Value Cr. Recorded <b>3600</b>	Date Recorded <b>Oct 28/96</b>	Mining Recorder <i>[Signature]</i>	Received Stamp <b>NOV 10 1996</b>
<b>Res 487</b>	Deemed Approval Date <b>Jan. 27/97</b>	Date Approved <b>27 Jan 93</b>	
	Date Notice for Amendments Sent		





Ministry of  
Northern Development  
and Mines

Ministère du  
Développement du Nord  
et des mines

**Statement of Costs  
for Assessment Credit**

**État des coûts aux fins  
du crédit d'évaluation**

**Mining Act/Loi sur les mines**

Transaction No./N° de transaction

Personal information collected on this form is obtained under the authority of the Mining Act. This information will be used to maintain a record and ongoing status of the mining claim(s). Questions about this collection should be directed to the Provincial Manager, Minings Lands, Ministry of Northern Development and Mines, 4th Floor, 159 Cedar Street, Sudbury, Ontario P3E 6A5, telephone (705) 670-7264.

Les renseignements personnels contenus dans la présente formule sont recueillis en vertu de la Loi sur les mines et serviront à tenir à jour un registre des concessions minières. Adresser toute question sur la collecte de ces renseignements au chef provincial des terrains miniers, ministère du Développement du Nord et des Mines, 159, rue Cedar, 4<sup>e</sup> étage, Sudbury (Ontario) P3E 6A5, téléphone (705) 670-7264.

**1. Direct Costs/Coûts directs**

Type	Description	Amount Montant	Totals Total global
Wages Salaires 125.00 Per DAY.	Labour Main-d'œuvre 1125.00	1125.00	1125.00
	Field Supervision Supervision sur le terrain		1125.00
Contractor's and Consultant's Fees Droits de l'entrepreneur et de l'expert- conseil	Type ASSAY		3700
			3700
Supplies Used Fournitures utilisées	Type GAS FUEL OIL MISC. TAPS PAINT	3500 2100	
			5600
Equipment Rental Location de matériel	Type 5 HP. WATER PUMP YAMAHA 4X4 TRACTOR EXCAVATOR W/O.P.	PER DAY 30.00 PER DAY 100.00 PER HR 85.00	60.00 200.00 1105.00
<b>Total Direct Costs</b>			<b>2583.00</b>
<b>Total des coûts directs</b>			<b>2583.00</b>

**2. Indirect Costs/Coûts indirects**

\*\* Note: When claiming Rehabilitation work Indirect costs are not allowable as assessment work.  
Pour le remboursement des travaux de réhabilitation, les coûts indirects ne sont pas admissibles en tant que travaux d'évaluation.

Type	Description	Amount Montant	Totals Total global
Transportation Transport	Type 476 KM TOY FROM 503 JIVE 30 KM		132.80
Food and Lodging Nourriture et hébergement	MEALS & LUNCHES		88.00
Mobilization and Demobilization Mobilisation et démobilisation	TRUCK EXCAVATOR TOY FROM COSSILE LAKE RD	210.00	210.00
<b>Sub Total of Indirect Costs</b>			<b>430.80</b>
<b>Total partiel des coûts indirects</b>			<b>430.80</b>
Amount Allowable (not greater than 20% of Direct Costs) Montant admissible (n'excédant pas 20 % des coûts directs)			
Total Value of Assessment Credit (Total of Direct and Allowable indirect costs)			<b>3,014.00</b>
Valeur totale du crédit d'évaluation (Total des coûts directs et indirects admissibles)			<b>3,014.00</b>

Note: The recorded holder will be required to verify expenditures claimed in this statement of costs within 30 days of a request for verification. If verification is not made, the Minister may reject for assessment work all or part of the assessment work submitted.

Note : Le titulaire enregistré sera tenu de vérifier les dépenses demandées dans le présent état des coûts dans les 30 jours suivant une demande à cet effet. Si la vérification n'est pas effectuée, le ministre peut rejeter tout ou une partie des travaux d'évaluation présentés.

**Filing Discounts**

1. Work filed within two years of completion is claimed at 100% of the above Total Value of Assessment Credit.
2. Work filed three, four or five years after completion is claimed at 50% of the above Total Value of Assessment Credit. See calculations below:

Total Value of Assessment Credit	Total Assessment Claimed
	x 0.50 =

**Remises pour dépôt**

1. Les travaux déposés dans les deux ans suivant leur achèvement sont remboursés à 100 % de la valeur totale susmentionnée du crédit d'évaluation.
2. Les travaux déposés trois, quatre ou cinq ans après leur achèvement sont remboursés à 50 % de la valeur totale du crédit d'évaluation susmentionné. Voir les calculs ci-dessous.

Valeur totale du crédit d'évaluation	Évaluation totale demandée
	x 0,50 =

**Certification Verifying Statement of Costs**

I hereby certify:  
that the amounts shown are as accurate as possible and these costs were incurred while conducting assessment work on the lands shown on the accompanying Report of Work form.

that as RECORDED HOLDER I am authorized  
(Recorded Holder, Agent, Position in Company)

to make this certification

**Attestation de l'état des coûts**

J'atteste par la présente :  
que les montants indiqués sont le plus exact possible et que ces dépenses ont été engagées pour effectuer les travaux d'évaluation sur les terrains indiqués dans la formule de rapport de travail ci-joint.

Et qu'à titre de \_\_\_\_\_ je suis autorisé  
(titulaire enregistré, représentant, poste occupé dans la compagnie)

à faire cette attestation.

Signature Lafield P... Date

Personal information collected on this form is obtained under the authority of subsection 6(1) of the Assessment Work Regulation 6/96. Under section 8 of the Mining Act, the information is a public record. This information will be used to review the assessment work and correspond with the mining land holder. Questions about this collection should be directed to the Chief Mining Recorder, Ministry of Northern Development and Mines, 6th Floor, 933 Ramsey Lake Road, Sudbury, Ontario, P3E 6B5.

Work Type	Units of Work <small>Depending on the type of work, list the number of hours/days worked, metres of drilling, kilometres of grid line, number of samples, etc.</small>	Cost Per Unit	Total Cost
HAND CRIPPING & WASHING DRILL	2 MEN 10 HRS. PER DAY	25.00	250.00
BLAST MUCKING	5. 2FT HOLES. 16 (2 MEN) 7 4FT HOLES. SAMPLES <sup>10 HRS</sup>	25.00	250.00
<b>Associated Costs (e.g. supplies, mobilization and demobilization).</b>			
PLUGGER RENTAL	1 DAY	50.00	50.00
PUMP RENTAL	1 DAY	30.00	30.00
4X4 RENTAL	1 DAY	100.00	100.00
POWDER FUNG.		188.00	188.00
FUEL		31.00	31.00
<b>Transportation Costs</b>			
PICK UP	20 @ 15M 340 KM.	30 KM	102.00
<b>Food and Lodging Costs</b>			
			22.00
<b>Total Value of Assessment Work</b>			<b>1073.00</b>

Calculations of Filing Discounts:

1. Work filed within two years of performance is claimed at 100% of the above Total Value of Assessment Work.
2. If work is filed after two years and up to five years after performance, it can only be claimed at 50% of the Total Value of Assessment Work. If this situation applies to your claims, use the calculation below:

TOTAL VALUE OF ASSESSMENT WORK x 0.50 = Total \$ value of worked claimed.

Note:

- Work older than 5 years is not eligible for credit.
- A recorded holder may be required to verify expenditures claimed in this statement of costs within 45 days of a request for verification and/or correction/clarification. If verification and/or correction/clarification is not made, the Minister may reject all or part of the assessment work submitted.

Certification verifying costs:

I, GARFIELD DONALD PINIKERT (please print full name) do hereby certify, that the amounts shown are as accurate as may reasonably be determined and the costs were incurred while conducting assessment work on the lands indicated on the accompanying Declaration of Work form as RECORDED HOLDER. I am authorized (recorded holder, agent, or state company position with signing authority) to make this certification.

Signature: Garfield Pinikert Date: 28 Sept 96

W552

PT 25MAL

W552

RESIDENT GEOLOGIST  
IN COBALT

W 6649  
p. 101 p. 102 p. 103

Farr Tp. M.219

Smyth Tp. M.248

200

NOTES

(A) - PLANNED DISPOSITION FOR LOCAL MUNICIPAL SUBDIVISION IN 1993

Mickle Tp. M.234

Tudhope Tp. M.252

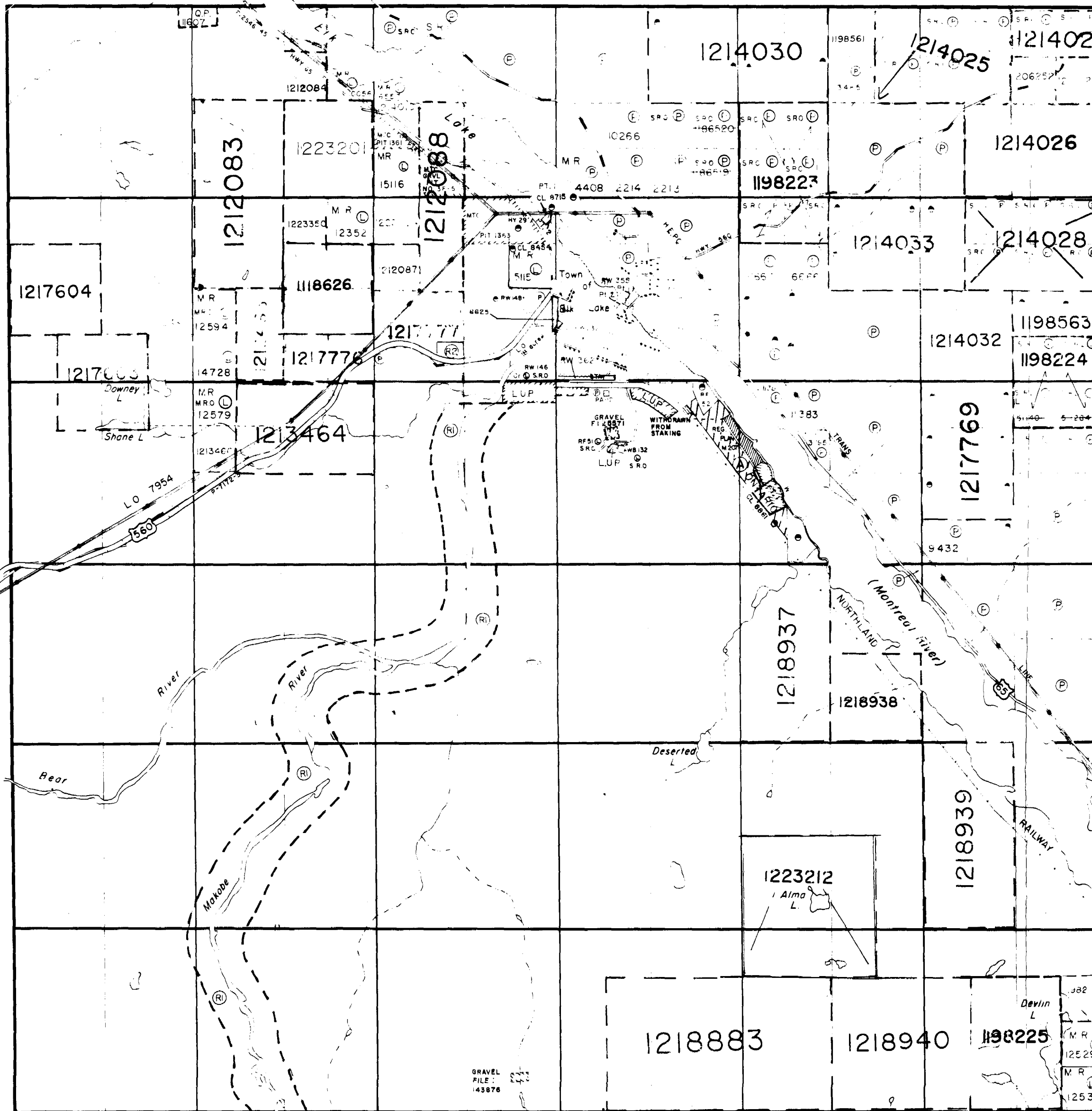

VI  
V  
IV  
III  
II  
I



THE TOWNSHIP OF

JAMES

DISTRICT OF TIMISKAMING

LARDER LAKE MINING DIVISION

SCALE: 1-INCH=40 CHAINS

LEGEND

PATENTED LAND	Ⓟ
CROWN LAND SALE	C.S.
LEASES	Ⓛ
LOCATED LAND	Loc.
LICENSE OF OCCUPATION	L.O.
MINING RIGHTS ONLY	M.R.O.
SURFACE RIGHTS ONLY	S.R.O.
ROADS	—
IMPROVED ROADS	—
KING'S HIGHWAYS	—
RAILWAYS	—
POWER LINES	—
MARSH OR MUSKEG	—
MINES	—
CANCELLED	Ⓞ
PATENTED S.R.O.	Ⓞ

NOTES

400' surface rights reservation along the shores of all lake and rivers.

~~Township closed to staking effective May 8, 1978, Sec. 38(f) of The Mining Act.~~

(R) Surface and Mining Rights on all Crown Land in this township withdrawn from prospecting, staking out, sale or lease Section 36 R.S.O. 1980, The Mining Act, Order NRW 14 / 82 effective October 21, 1982 at 1:42 pm.

\*\*\* Part of order NRW 14/82 RE-OPENED by order O-MLO1-90 NER effective April 3, 1990 at 7:00 AM E.S.T.

\*\*\* REMAINDER OF MINING AND SURFACE RIGHTS IN JAMES TOWNSHIP WITHDRAWN BY ORDER NRW 14/82, EXCEPTING THOSE LANDS WITHDRAWN BY ORDERS WO 5/83, NRW 106/84 AND W-L-01/92 NER, ARE REOPENED BY ORDER O-L-01/92 NER EFFECTIVE JANUARY 7, 1992 AT 9:00 AM E.S.T.

(R) SURFACE AND MINING RIGHTS WITHDRAWN FROM STAKING, SECTION 36/53 ORDER NO. WO-5-83

(R) SURFACE RIGHTS WITHDRAWN FROM STAKING SECTION 36/80 ORDER NRW 106/84

(R) SURFACE AND MINING RIGHTS WITHDRAWN FROM STAKING, SECTION 35 OF THE MINING ACT RSO 1990 ORDER NO. W-L-01/92 NER.

PLAN NO. M.225

ONTARIO  
MINISTRY OF NATURAL RESOURCES

SURVEYS AND MAPPING BRANCH

Willet Tp. M.258

Part of order W-L-01/92 NER REOPENED by order O-ONT-06/92 NER/CR effective March 16 1992 at 4:15 pm E.S.T.

Part of order W-L-01/92 NER REOPENED by order O-ONT-07/92 NER/CR dated March 23 1992 at 8:45 am E.S.T. This Order comes into effect at 7:00 AM E.S.T. on JUNE 1, 1992.

NOTICE OF FORESTRY ACTIVITY

THIS TOWNSHIP / AREA FALLS WITHIN THE ELK LAKE MANAGEMENT UNIT AND MAY BE SUBJECT TO FORESTRY OPERATIONS. THE MNR UNIT FORESTER FOR THIS AREA CAN BE CONTACTED AT: P.O. BOX 129 SWASTIKA, ONT. POK ITO 705-642-3222

COPY OF THIS MYLAR ARCHIVED ON JAN. 03/92

COPY OF THIS MYLAR ARCHIVED JUNE 1, 1992  
ARCHIVED OCT 19, 1994  
ARCHIVED DECEMBER 30, 1996