



41P09NW2005 2.19316 TUDHOPE

010

O.P.A.P.
98 - 172

REPORT

on the

BEAVER POND PROJECT

for

Garfield Pinkerton, Prospector

in

James and Tudhope Townships
Elk Lake, Ontario

Latitude 47° 44': Longitude 80° 17'

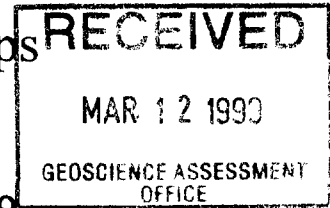
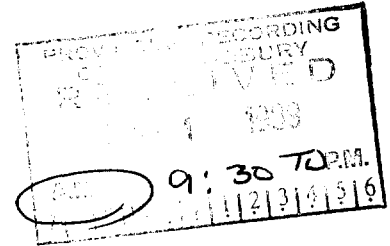

Prepared by: Gino Chitaroni B. Sc. Geology
Date: January 26, 1999

Cobalt, Ontario
Blackstone Development Inc.

2.19316

THE BEAVER POND PROJECT

**James and Tudhope Townships
Elk Lake, Ontario
N.T.S. Map 41 P/NE #9**

Introduction

Through an Ontario Prospector's Assistance Program (OPAP) grant in 1998, a prospecting and stripping/trenching program was undertaken to explore a vein system on claims 1222054 and 1225024. A large old trench was cleaned and stripped trending north-south and east; this work was completed, in order, to explore and sample numerous calcite/quartz veins and joint fractures that extended out from the original veins and pits.

Location

Access to the Beaver Pond Property is via an old logging road 3.3 km south of Elk Lake, off of Highway 65. A gravel road trends off of Highway 65 east for 2.7 km into the work site.

Access

The property is located near the town of Elk Lake, Ontario: Latitude 47 degrees: 44 minutes and Longitude: 80 degrees 17 minutes or N.T.S. Map 41 P/NE #9 situated in the District of Timiskaming. (See Key Map and attached Claim Maps)

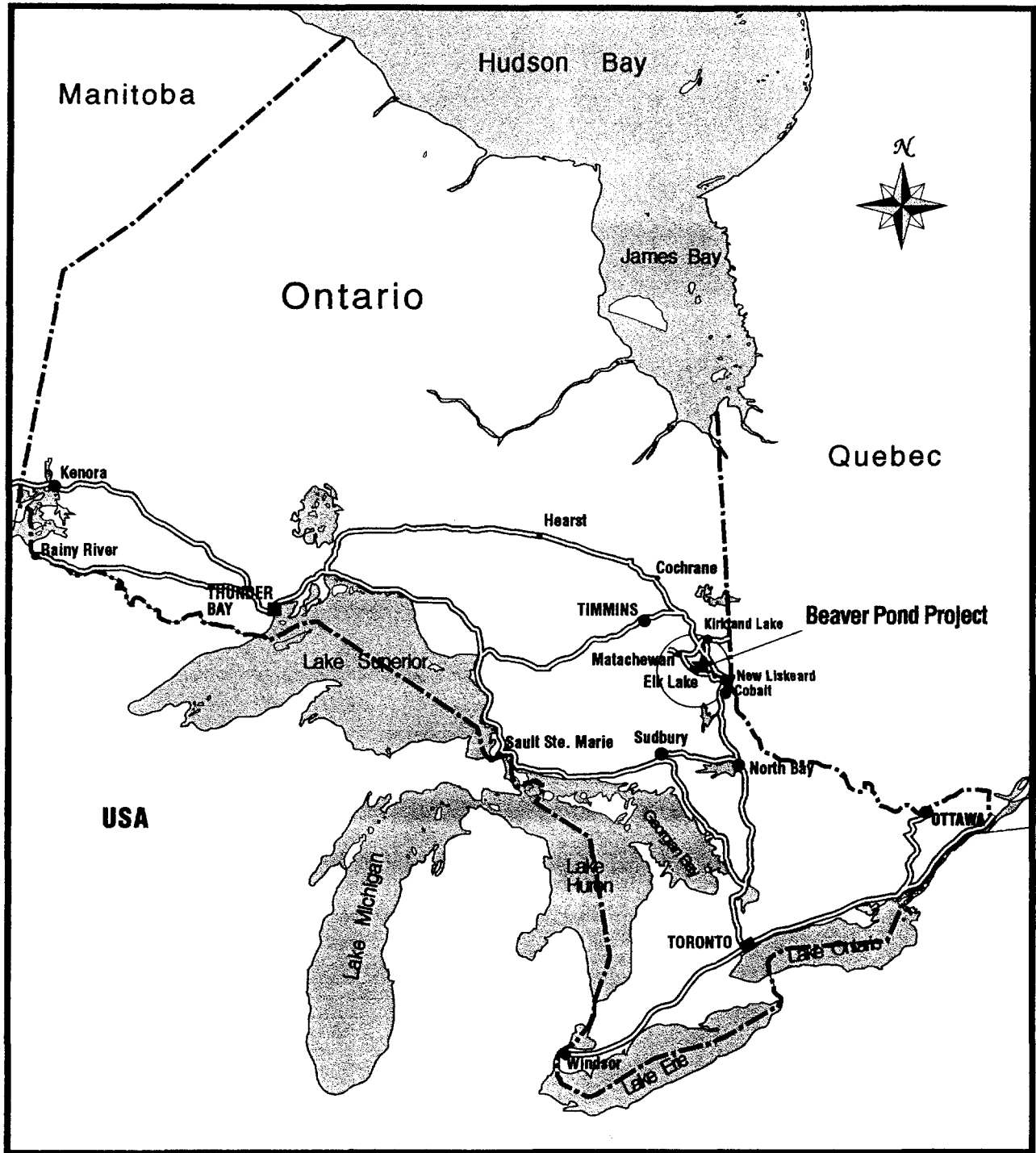

© Digital map file copyright of Blackstone Development Inc., 1998



BLACKSTONE
Development Inc.
50 Silver Street, P.O. Box 699
Cobalt, Ontario, Canada P0J 1C0
Tel. (705) 679-8500
Fax. (705) 679-5519
email: blackstm@nt.net
website: www.blackstn.com

Garfield Pinkerton/ J Kate Explorations Inc.

Beaver Pond Project
(Formerly MIN-ORE Property)
James / Tudhope Townships
Elk Lake, Ontario

Key Map

Scale: see bar scale

Drawn by: P.J. MacArthur

Checked by: G. Chkaroni

Date: January 1998

Property

The Beaver Pond Project property is as follows:

James Township: Claim # 1222054

Tudhope Township: Claim # 1225024 and #1221958

The claims are recorded in the Larder Lake Division under the auspices of the Provincial Mining Recorder, Ontario Ministry of Northern Development and Mines (MNDM).

Please refer to attached claims.

Property Geology

The majority of the property is covered by the Nipissing Diabase Sill rock-type which is thought to be 400-500 feet thick with Gowganda formation sediments typically Cobalt Conglomerate rocks underlying the Sill. There are outcrops of Cobalt Conglomerate found on Claim # 1221958.

Geology of the Beaver Pond Project claims and the Elk Lake area is best described in the following government reports and maps:

A.

Ontario Department of Mines: Geological Report 62 "Geology of the Elk Lake Area" by B.E. Mackean (1968); including Map 2151 Mickle and James Townships, Timiskaming District, Ontario. Scale 1 Inch to ½ Mile.

B.

Ontario Ministry of Northern Development and Mines:
Ontario Geological Survey Report 250: "Geology of the Hill Lake Area" District of Timiskaming (1986); including Map 2501 Hill Lake Area District of Timiskaming, Scale 1 : 31,680 of 1 Inch to ½ Mile.

Property History

The land situated under the Beaver Pond claims were first staked in 1907 and since that time intermittent exploration and minor mine development work has been carried out.

Elk Lake Silver Mines explored this area and discovered silver, cobalt and nickel from trenching and pitting.

Mother Lode Mining held the the property around 1953-54; see Report #62 "Geology of the Elk Lake Area for reference to the company.

In 1957. R.H. McManus completed some exploration work, reference Report #62.

In 1959, Min Ore reported a diamond drill hole on this property intersecting a vein containing 7.5 feet of massive chalcopyrite (copper) but no assays were found. This can be referenced in OGS Report 250, page 75 & 76.

In 1975, S.G. Welsh filed assessment work on the property. Power stripping (caterpillar bulldozer) and manual labour was indicated as work completed on the property; reference: Cobalt Assessment Files.

Since 1975, no work has been conducted on the property chiefly, due to the fact, that the Temagami Indian Land Caution froze, halted all mineral exploration in the Elk Lake area. Portions of land under the influence of the the The Temagami Indian Land Caution were lifted over a period of 6 years but the Beaver Pond Property became intact for staking in September 1996.

The Beaver Pond Project area was acquired by Garfield Pinkerton/J-Kate Exploration in 1997.

1998 OPAP Exploration Program

Field exploration work was carried out on this claim block from May 23, 1998 to November 14th 1998.

Stripping/Trenching and Sampling:

Overburden stripping, trenching and sampling was undertaken on claims 1222054 & 1225024 trending along and in the “main” old trench north-south and east. The location of the trench is approximately 100m north of a line post situated on the township line between Tudhope and James Townships.

For detailed information on the field exploration program, please refer to the “Prospecting and Geology Plan #1” and the “Sample Location Plan #2” .

The old trench area was cleaned out and the overburden covering the surrounding (enclosing) Nipissing Diabase rock outcrop was removed and washed clean to expose the joint fractures and the calcite-quartz veins.

All veins discovered or re-discovered were found to contain Copper: chalcopyrite, malachite (copper) staining and some bornite; but also some Cobalt mineralization was present chiefly in the form of “Cobalt Bloom or staining” erythrite and some smaltite. The host vein “gangue” material was chiefly calcite with subordinate amounts of quartz (typical of the Elk Lake area and the Cobalt Mining Camp).

The main vein “old” trench area appears to locally control the mineralization in this area; however, cylindrical joints within the Nipissing Diabase Sill (gabbroic rock) and splay veinlets off of the main vein system almost all appear to contain copper and cobalt mineralization. In these subordinate systems the veins will range from 1/8” to 1” in width. The main vein averages 12-15 centimeters (4-6 inches) in width.

Overburden Stripping: 285 metres total strike length from 2-30 metres in

LEGEND

- — SHAFT
- — PIT
- — TRENCH
- — SWAMPY AREA
- — ROCK OUTCROP
- — PATENT CLAIM
- - - - - PROSPECTING LINES OF TRAVERSE

LOT 1

LOT 12

LOT 11

LOT 10

COBALT CONGLOMERATE

JAMES TWP.
TUDHOPE TWP.

ASTRONOMIC

1217890

1217891

NIPissing
DIABASE

1221958

1221955

1222054

1223024

BEAVER
POND

CONCESSION 5
CONCESSION 4

To Hwy 65
OLD BUSH ROAD

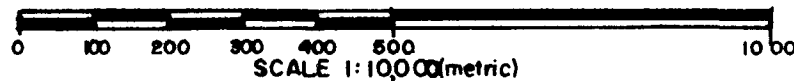

CLIENT:
Garfield Pinkerton / J-Kate Explorations Inc.

PROJECT:
BEAVER POND PROJECT
(FORMERLY MIN-ORE PROPERTY)
PROSPECTING & GEOLOGY PLAN 1



BLACKSTONE DEVELOPMENT INCORPORATED
P.O. BOX 699, 50 Silver St., Cobalt Ont., POJ 1C0
TEL. (705) 679-5500 FAX. (705) 679-5519
EMAIL: blackstn@aol.com WEB SITE: www.blackstn.com

DATE: JAN. 15, 1999

DRAWN: R. LINDSAY

OP.A.P. No 98-172

CHECKED: G. CHITARONI

LEGEND

- JK109 - SAMPLE LOCATION & N°
- - PIT
- ▬ - TRENCH
- ⊖ - ROCK OUTCROP
- - VEIN

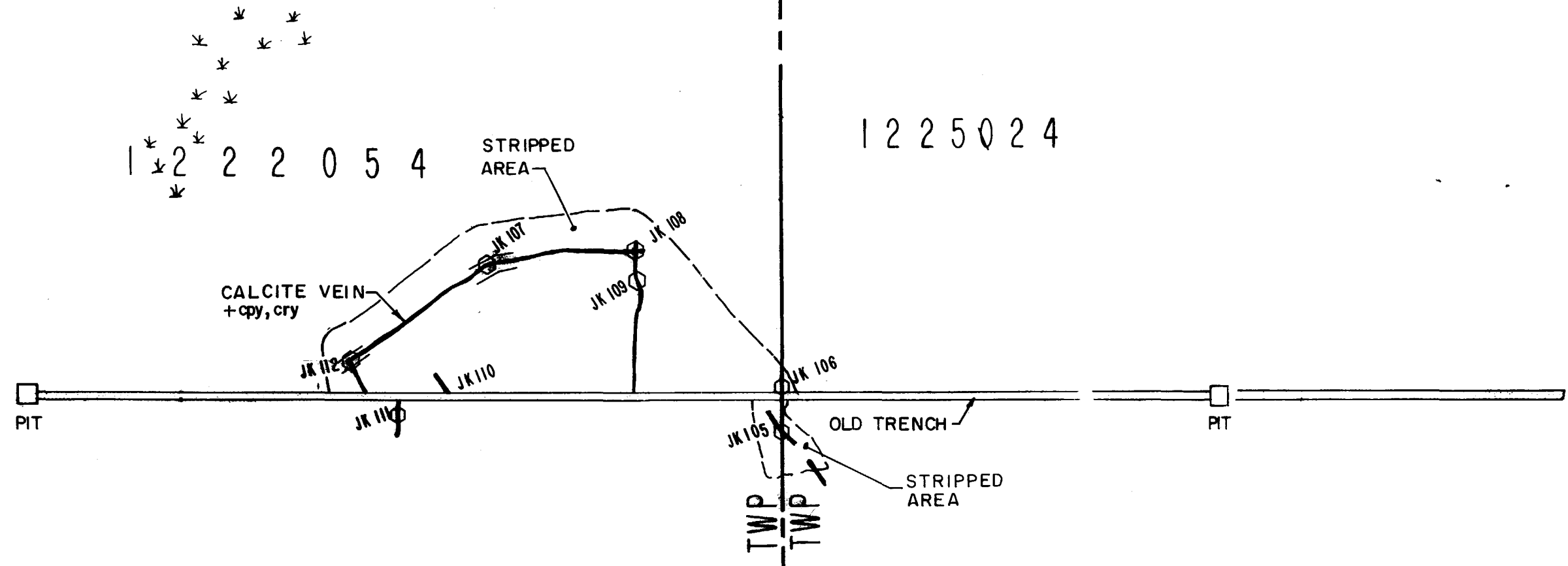
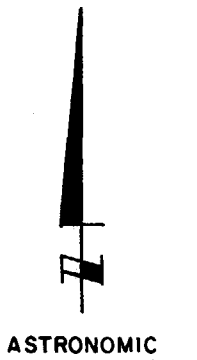

1225024

SAMPLE N°	Ag (oz/ton)	Co %	Cu %	Ni %
JK 105	4.65	0.69	31.81	0.032
JK 106	4.19	2.05	20.67	0.340
JK 107	3.45	1.24	29.32	0.120
JK 108	2.39	0.51	5.43	0.068
JK 109	0.63	0.367	10.60	0.051
JK 110	2.18	2.15	9.47	0.171
JK 111	6.83	0.58	7.98	0.061
JK 112	1.65	0.82	17.84	0.079

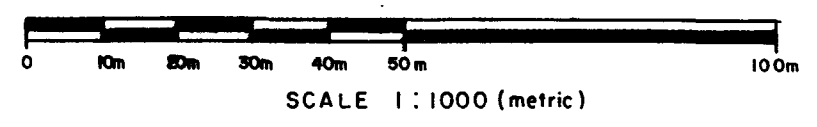

CLIENT: **Garfield Pinkerton / J-Kate Explorations Inc.**

PROJECT: **BEAVER POND PROJECT**
(FORMERLY MIN-ORE PROPERTY)
SAMPLE LOCATION PLAN 2

 **BLACKSTONE DEVELOPMENT INCORPORATED**
P.O. BOX 699, 50 Silver St., Cobalt Ont., POJ 1C0
TEL. (705) 679-5500 FAX. (705) 679-5519
EMAIL: blackstn@tel.net WEB SITE: www.blackstn.com

DATE: JAN. 18, 1999 DRAWN: R. LINDSAY
O P A P No 98 - 172 CHECKED: G. CHITARONI

width and up 1-2 metres in thickness.

Equipment Used: 1 excavator, 2 water pumps, Plugger, shovels etcetera.

Rock trenching: 8 rock trenches averaging 1/3 metres to 1/2 metres width were blasted along the strike length of the vein(s); 10 blast holes total; note, a slash was also blasted off rock face.

Sampling/Assaying:

Eight selected grab/chip samples were taken from the blasted rock material --- See the sample location map, sample description chart and assay certificates provided.

Results

Results from these assays returned high grade Copper values, best being 31.81% Cu; more modest values of Cobalt and Silver were also recorded with best values as follows respectively: 2.15% Co and 6.83 oz/ton Ag.

Nickel values were generally found to be low; while “nil” Gold values were reported.

Recommendations

A geophysical grid should cut with 100m line spaces by 25 metre stations; however, over the localized stripped area the grid should be tightened to lines every 25 metres and stations every 1 metre apart.

It is recommended that the Stripped area be grid-mapped geologically in detail.

Further power stripping and blast trenching should continue, in order, to enlarge the mineralized area and to examine new untouched areas on the property.

Once this is completed a detailed (IP) Induced Polarization (electromagnetic survey) Program is recommended to examine the depth and lateral extent of the Copper-Silver-Cobalt system.

Follow-up Diamond Drilling will be dependent on the results of the IP survey, geological mapping program and the power stripping/blast trenching work.

Respectfully Submitted,

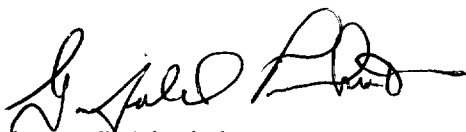
A handwritten signature in black ink, appearing to read 'G. Pinkerton', with a long horizontal flourish extending to the right.

Garfield Pinkerton
Prospector

Elk Lake, Ontario
January 26, 1999.

Statement of Facts

I, Gino Chitaroni, Geologist, F6874, Fellow of the Geological Association of Canada personally visited and briefly examined the Beaver Pond Property in Elk Lake, Ontario on December 4th 1998 for Mr. Garfield Pinkerton/J-Kate Explorations Inc..

I am a qualified Geologist with a B.Sc. Geology from Lake Superior State University; and have been practising Geologist for 10 years.

I am resident of the Township of Coleman, Cobalt, Ontario.

I am the President of Blackstone Development Inc. with corporate offices located on 50 Silver Street, Cobalt, Ontario.

I do not hold an interest in the property nor expect to.

The Beaver Pond OPAP report was initially prepared by Mr. Garfield Pinkerton and completed by Gino Chitaroni and Blackstone Development Inc. of Cobalt, Ontario.

Dated this day January 26, 1996 at Cobalt, Ontario.

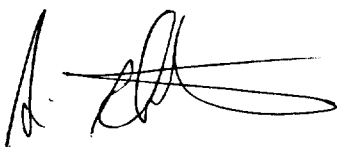

Gino Chitaroni
B.Sc. Geology

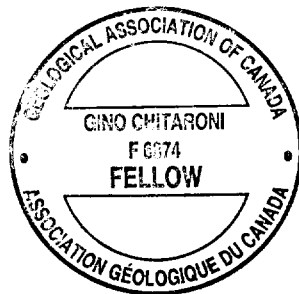

Beaver Pond Project

OPAP 98 - 172

James/Tudhope Townships Elk Lake, Ontario

Sample #	Sample Description
JK105	5 to 7 cm Vein Quartz/Carbonate 20% Chalco, 5-10% Bornite Malachite, Minor Hematite
JK106	8 to 12 cm Vein Carb. 10-15% Chalco Minor Bornite, Cobalt Stain, + Grey Material 10% Gangue
JK107	6 to 8 cm Vein Highly Oxidized 25-30% Chalco, 5% Hematite,, Heavy Malachite Staining
JK108	2cm Stringer. Pyrite Chalcopryrite, Hematite, Cobalt Stain.
JK109	6 to 8 cm Vein Grey Quartz/Carb., 8 to 10% Chalcopryrite, Minor Hematite
JK110	8 to 12 cm Carb Vein. Cobalt Stain, Minor Chalcopryrite Hematite.
JK111	3 to 5 cm Quartz/Carb Vein. Minor Bornite 5% Chalcopryrite
JK112	5 to 7 cm Quartz Vein. 3-5% Chalco Bornite 2% Hematite
* All selected chip samples	

Sampled by: Garfield Pinkerton, Prospector, and Associates

Date: Jan. 26, 1999



Swastika Laboratories

A Division of TSL/Assayers Inc.

Assaying - Consulting - Representation

Established 1928

Assay Certificate

8W-2998-RA1

Company: **J KATE EXPLORATION'S INC**

Date: OCT-13-98

Project:

Attn: G. Pinkerton

We hereby certify the following Assay of 8 Rock samples submitted OCT-05-98 by .

Sample Number	Au oz/ton	Au Check oz/ton	Ag oz/ton	Co %	Cu %	Ni %
JK 105	Nil	-	4.65	0.69	31.81	0.032
JK 106	Nil	-	4.19	2.05	20.67	0.340
JK 107	Nil	Nil	3.45	1.24	29.32	0.120
JK 108	Nil	-	2.39	0.51	5.43	0.068
JK 109	Nil	-	0.63	0.367	10.60	0.051
JK 110	Nil	-	2.18	2.15	9.47	0.171
JK 111	Nil	-	6.83	0.58	7.98	0.061
JK 112	Nil	Nil	1.65	0.82	17.84	0.079

Certified by Denis Charles

W9980 00197

SEC 10 EQUIP USED 19.09.98.
MECH. 490 E. J.D. TRACKED EXCAVATOR.
10 HRS AT 65.00 PER HR. THIS INCLUDES OP. WAGES AND
TRAVEL TIME TOTAL 695.50 GST INCL.

SEC 9. 23 24 MAY 98. PROSPECTING ON 1222054 THIS OLD
TRENCH WAS FULL OF DEBRIS & BROKEN MUCK & WATER IN
LOWER PORTIONS OF TRENCH. SMALL PORTIONS OF URIN WERE
VISIBLE ON HANGING WALL. JUST COBALT BLOOD VISIBLE.
SEE ATT. MAP FOR DETAILS K21894 *Geoffrey P. Rand*

25 26 27 MAY 98. PROSPECTING ON 1225024
THE SHIRT ON THIS CLAIM IS CAPED 8' X 8' SINCE IN
MISSING DIABASE. THE SIZE OF THE WASTE DUMP
WOULD INDICATE A DEPTH OF MAYBE 60' TO 80' FT.
THE MUCK PILE WAS LOOKED OVER EXTENSIVELY FOR
URIN MATERIAL. NO POSITIVE URIN WIDTH COULD BE ESTABLISHED
BUT COBALT BLOOD & CHANCO PYRITE WERE FOUND
IN SMALL ROCK FRAGMENTS THROUGHOUT THE AREAS
SAMPLED. URIN MATERIAL FOUND WAS QUARTZ &
SOME GREYISH BLUE QUARTZ CARBONATE.
PREG. SLS SAMPLES ASSAYED DID CONTAIN MINOR GOLD. 2049
g/ton. Au. & Ag. Cu. Co.
SEE ATT. MAP FOR OTHER DETAILS

K21894 *Geoffrey P. Rand*



41P09NW2005 2.19316 TUDHOPE

020

CLAIM # 1221958.

05/98 198
28 29201 02/06 PROSPECTING WAS DONE ON THE NORTH PORTION
OF THIS CLAIM. ACCESS IS VIA AN OLD LOGGING ROAD THAT
EXITS OFF HWY 560 THAT WAS & IS USED TO ACCESS THE
NORTHERN SILVER FOX PROPERTY IN LOT 11 & LOT 12 CON VI
TADPORE TWP. MOST OF THIS BLOCK OF CLAIMS HAVE BEEN
LOGGED IN WHAT APPEARS TO BE THE LAST 10 TO 12 YRS
& REFORESTED. GROWTH OF GROUND POPULAR & BRUSH ALONG WITH
THE RESEEDED JACK PINE MAKE VISABILITY VERY LIMITED
THE TERRAIN IS LOW ROLLING WITH SMALL TO MEDIUM
BOULDER'S PROTRUDING FROM AN UNKNOWN TIMBER
THE OLD PIT IN THE NORTH EAST PORTION SHOWS CLAY &
SMALL BOULDER'S THIS COULD HAVE BEEN DUG FOR USE AS
FILL FOR THE ROAD.

THE OUTCROP OF DIABASE IN THE SOUTH WEST
PORTION OF THE CLAIM IS HEAVILY TREED WITH JACK PINE
THE SMALL PORTION OF VISABLE DIABASE IS MEDIUM
TO HEAVY GRAINED OVER BURDEN DEPTH OVER CLAIM
IS UNKNOWN AS MUCH STRIPPING WAS NOT UNDERTAKEN.

K21894 Sufield Park —

03-04-06/98

PROSPECTING WAS DONE ON CLAIM 121891
THE NORTH PORTION OF THE CLAIM IS MATURE FOREST
MAINLY JACK PINE. HILT GROWING. WITH SOME LOW
MARSHY AREA'S

THE SOUTH PORTION IS GENTLE ROLLING TYPE GROUND
W SOME CONGLOMERATE BOLDER'S PROTRUDING THROUGH THE
OVER BURDEN. AREA HAS BEEN HARVESTED & RE FORESTATION
HAS BEEN DONE.

K21894 Sufield Park —

SEE ATTACHED MAP #4

CLAIM 1222054.

5-6-11-12-OF 06/98 PROSPECTING DONE ON THESE DATES WAS DONE IN DETAIL. AS THIS WAS THE SITE TO BE STRIPPED & CLEAN OUT OLD TRENCHES A TRAIL WAS CUT FROM THE OLD ROAD N. ON THE TWP LINE.

DURING THE WORK THE OLD D.D. CASINGS WERE FOUND FROM PREV WORK BY MIN OLS OGS REPORT 250 #32 SOME SMALL STRAINERS OF QUARTZ & QUARTZ CARB FOUND AREA THEN PREPARED FOR POWER STRIPPING.

K21894 *Infidel P. Hart*

Received from OCT 30 1998.
Recu de CANTFIELD PINKERTON
THIRTEEN HUNDRED — 100 Dollars
FOR WORK ON JAMES & TUDHOPE CLAIMS.
\$1300.00 Raymond Pinkerton No.

Received from Sept 24 1998
Recu de CANTFIELD PINKERTON
Four Hundred — 100 Dollars
Plugger drilling
James & Tudhope
\$400.00 Mike Rooney No.
Richard Holt

ONE DAY PLUGGER WORK DONE ON CLAIM 1222054
& 1225024. \$200.00

LEROY ROBINSON
GENERAL CONTRACTING LTD.
 R.R.# 2 New Liskeard ON POJ 1PO
 Tel: (705) 647-4646 / Fax: (705) 647-4646

STATEMENT

DATE
9/23/98

BILL TO
J KATE Exploration's Inc. P.O.Box 100 Elk Lake, ON POJ 1GO

P.O. NO.	TERMS
	Net 30

DATE	ITEM	DESCRIPTION	HOURS	RATE	CHARGES
9/19/98	490E BACKHOE TRAVELLING	Excavating GST Registration Number: #R136530987	8.5 1.5	65.00 65.00	552.50T 97.50T
			0024		
SERVICE CHARGE OF 2% ON OVERDUE ACCOUNT				GST	45.50
				TOTAL	\$695.50

Transaction Number (office use)
W9980 00197
Assessment Files Research Imaging



41P09NW2005 2.19316 TUDHOPE 900

Subsection 65(2) and 66(3) of the Mining Act. Under section 8 of the Mining Act, assessment work and correspond with the mining land holder. Questions about this form should be directed to the Ministry of Northern Development and Mines, 3rd Floor, 933 Ramsey Lake Road, Sudbury, Ontario.

Instructions: - For work performed on Crown Lands before recording a claim, use form 0240.
- Please type or print in ink.

Recorded holder(s) (Attach a list if necessary)

Company Name IKATE EXPLORATIONS INC.	Client Number 303112
Address PO BOX 100 ELK LAKE ONT P0J 1G0	Telephone Number 705-678-2165
	Fax Number
Company Name	Client Number
Address	Telephone Number
	Fax Number

Type of work performed: Check (✓) and report on only ONE of the following groups for this declaration.

Geotechnical: prospecting, surveys, assays and work under section 18 (regs)

Physical: drilling stripping, trenching and associated assays

Rehabilitation

Work Type PROSPECTING	Office Use
STRIP & TRENCHING	Commodity
	Total \$ Value of Work Claimed 10,726
Work Period: From 23 05 98 To 28 09 98	NTS Reference
Global Positioning System Data (if available)	Mining Division Larder Lake
Township/Area JAMES TUDHOPE	Resident Geologist
M or G-Plan Number M285 G3721	District Kirkland Lake

- Please remember to:
- obtain a work permit from the Ministry of Natural Resources as required;
 - provide proper notice to surface rights holders before starting work;
 - complete and attach a Statement of Costs, form 0212;
 - provide a map showing contiguous mining lands that are linked for assigning work;
 - include two copies of your technical report.

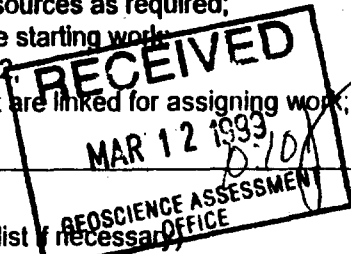

Person or companies who prepared the technical report (Attach a list if necessary)

Name CARFIELD D PINKERTON	Telephone Number 705-678-2165
Address PO BOX 100 ELK LAKE ONT P0J 1G0	Fax Number
Name BLACKSTONE SAU.	Telephone Number 705-679-5500
Address PO BOX 699 COBALT ONT P0J 1E0	Fax Number
Name	Telephone Number
Address	Fax Number

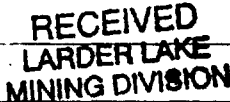

Certification by Recorded Holder or Agent

CARFIELD DONALD PINKERTON (Print Name) do hereby certify that I have personal knowledge of the facts set forth in this Declaration of Assessment Work having caused the work to be performed or witnessed the same during or after its completion and, to the best of my knowledge, the annexed report is true.

MAR 11/99 1:15 PM

Nature of Recorded Holder or Agent PRES. IKATE EXP.	Date 11 Mar 99
Agent's Address PO BOX 100 ELK LAKE ONT P0J 1G0	Telephone Number 705-678-2165
	Fax Number

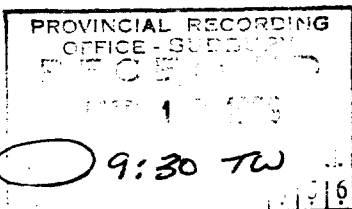

Deemed on June 10/99

2 19316

...and where work was performed, at the time work was performed. A map showing the contiguous link must accompany this for

W9980-00197

Mining Claim Number. Or if work was done on other eligible mining land, show in this column the location number indicated on the claim map.	Number of Claim Units. For other mining land, list hectares.	Value of work performed on this claim or other mining land.	Value of work applied to this claim.	Value of work assigned to other mining claims.	Bank Value of work to be distributed at a future date
eg TB 7827	16 ha	\$26,825	N/A	\$24,000	\$2,825
eg 1234567	12	0	\$24,000	0	0
eg 1234568	2	\$ 8,892	\$ 4,000	0	\$4,892
1 1222054	4	4,000.00	1600	800.00	2,600.00
2 1225024	2	4,320.00	800	3200.00	326.00
3 1221958	5	1,600.00	2000.00	0	
4 1217891	3	800.00	1200	0	
5 1217890	4	0	1600.00	0	
6 1221955	4	0	1600.00	0	
7					
8					
9					
10					
11					
12					
13					
14					
15					
Column Totals		10,720.00	8,800.00	4,000.00	1,926.00

I, GARFIELD DONALD PINKERTON, do hereby certify that the above work credits are eligible under subsection 7 (1) of the Assessment Work Regulation 6/96 for assignment to contiguous claims or for application to the claim where the work was done.

Signature of Recorded Holder or Agent Authorized in Writing: Garfield D Pinkerton PRESIDENT
STATE EXPL INC. Date: 11 Mar 99

6. Instruction for cutting back credits that are not approved.

Some of the credits claimed in this declaration may be cut back. Please check (✓) in the boxes below to show how you wish to prioritize the deletion of credits:

- 1. Credits are to be cut back from the Bank first, followed by option 2 or 3 or 4 as indicated.
- 2. Credits are to be cut back starting with the claims listed last, working backwards; or
- 3. Credits are to be cut back equally over all claims listed in this declaration; or
- 4. Credits are to be cut back as prioritized on the attached appendix or as follows (describe):

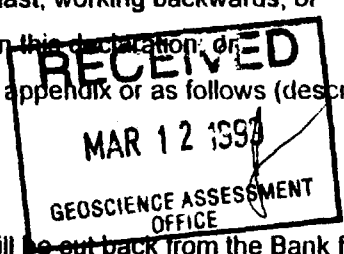

Note: If you have not indicated how your credits are to be deleted, credits will be cut back from the Bank first, followed by option number 2 if necessary.

For Office Use Only

Received Stamp	Deemed Approved Date	Date Notification Sent
	Date Approved	Total Value of Credit Approved
	Approved for Recording by Mining Recorder (Signature)	

RECEIVED
LARDER LAKE
MINING DIVISION

MAR 11/99
1.15

W9980.00197

Personal information collected on this form is obtained under the authority of subsection 6 (1) of the Assessment Work Regulation 6/96. Under section 8 of the Mining Act, this information is a public record. This information will be used to review the assessment work and correspond with the mining land holder. Questions about this collection should be directed to a Provincial Mining Recorder, Ministry of Northern Development and Mines, 3rd Floor, 933 Ramsey Lake Road, Sudbury, Ontario, P3E 6B5.

Work Type	Units of work Depending on the type of work, list the number of hours/day worked, metres of drilling, kilometres of grid line, number of samples, etc.	Cost Per Unit of work	Total Cost
PROSPECTING	16 SAMPLES @ 3	130.00	2,080.00 ✓
HAND STRIPPING	15	130.00	1,950.00 ✓
CLEANING			
PUMPING & WASHING	9	130.00	1,170.00 ✓
DRAIN & BLAST CLEAN.	2	130.00	260.00 ✓
PICK UP POWDER	1		
REPORT ETC.	3	130	390.00 ✓
CONSULTING MAPS ETC. BLACKSTONE DEVELOPMENT. Associated Costs (e.g. supplies, mobilization and demobilization).			1,230.00 ✓
EXCAVATOR. TRACKED W/O.P.		1 DAY	695.00 ✓
PLUGGER W/O.P.		200.00 PER DAY	400.00 ✓
PUMP RENTAL. W/HOSE			385.00 ✓
4 WHEELER W/T.R.			400.00 ✓
HELPER		100.00	1,300.00 ✓
Transportation Costs			
	1498 KM ⁵	.309	449.40 ✓
Food and Lodging Costs			
	MEALS		760.00 ✓

RECEIVED
LARDER LAKE
MINING DIVISION

MAR 11/99
1:15 PM

Total Value of Assessment Work

10,725.90

RECEIVED
MAR 12 1999
10:10 AM
OFFICE

Calculations of Filing Discounts:

Work filed within two years of performance is claimed at 100% of the above Total Value of Assessment Work. If work is filed after two years and up to five years after performance, it can only be claimed at 50% of the Total Value of Assessment Work. If this situation applies to your claims, use the calculation below:

TOTAL VALUE OF ASSESSMENT WORK x 0.50 = Total \$ value of worked claimed.

Note: Work older than 5 years is not eligible for credit.

A recorded holder may be required to verify expenditures claimed in this statement of costs within 45 days of a request for verification and/or correction/clarification. If verification and/or correction/clarification is not made, the Minister may reject all part of the assessment work submitted.

Verification verifying costs:

PAULINA ANN PERKINS do hereby certify, that the amounts shown are as accurate as may reasonably (please print full name) determined and the costs were incurred while conducting assessment work on the lands indicated on the accompanying

Declaration of Work form as JKATA EXPLORES INC. I am authorized to make this certification. (recorded holder, agent, or state company position with signing authority)

PRESIDENT

Signature: [Signature] Date: 11 Mar 99

Geoscience Assessment Office
933 Ramsey Lake Road
6th Floor
Sudbury, Ontario
P3E 6B5

Telephone: (888) 415-9846
Fax: (877) 670-1555

August 12, 1999

JKATE EXPLORATIONS INC.
P.O. BOX 100
341 MUNROE CRESCENT
ELK LAKE, ON
P0J-1G0

Visit our website at:
www.gov.on.ca/MNDM/MINES/LANDS/mlsmnpge.htm

Dear Sir or Madam:

Submission Number: 2.19316

Status

Subject: Transaction Number(s): W9980.00197 Approval After Notice

We have reviewed your Assessment Work submission with the above noted Transaction Number(s). The attached summary page(s) indicate the results of the review. WE RECOMMEND YOU READ THIS SUMMARY FOR THE DETAILS PERTAINING TO YOUR ASSESSMENT WORK.

If the status for a transaction is a 45 Day Notice, the summary will outline the reasons for the notice, and any steps you can take to remedy deficiencies. The 90-day deemed approval provision, subsection 6(7) of the Assessment Work Regulation, will no longer be in effect for assessment work which has received a 45 Day Notice. Allowable changes to your credit distribution can be made by contacting the Geoscience Assessment Office within this 45 Day period, otherwise assessment credit will be cut back and distributed as outlined in Section #6 of the Declaration of Assessment work form.

Please note any revisions must be submitted in DUPLICATE to the Geoscience Assessment Office, by the response date on the summary.

If you have any questions regarding this correspondence, please contact Lucille Jerome by e-mail at lucille.jerome@ndm.gov.on.ca or by telephone at (705) 670-5858.

Yours sincerely,



ORIGINAL SIGNED BY
Blair Kite
Supervisor, Geoscience Assessment Office
Mining Lands Section

Work Report Assessment Results

Submission Number: 2.19316

Date Correspondence Sent: August 12, 1999

Assessor: Lucille Jérôme

Transaction Number	First Claim Number	Township(s) / Area(s)	Status	Approval Date
W9980.00197	1222054	JAMES, TUDHOPE	Approval After Notice	July 27, 1999

Section:

9 Prospecting PROSP

10 Physical PSTRIP

10 Physical PTRNCH

The revisions outlined in the Notice dated June 10, 1999, have been corrected. Accordingly, assessment work credit has been approved as outlined on the Declaration of Assessment Work Form accompanying this submission.

Correspondence to:

Resident Geologist

Kirkland Lake, ON

Recorded Holder(s) and/or Agent(s):

JKATE EXPLORATIONS INC.

ELK LAKE, ON

Assessment Files Library

Sudbury, ON

INDEX TO LAND DISPOSITION

PLAN G - 3724
 TOWNSHIP TUDHOPE

DATE OF ISSUE MAR 0 8 1999
 PROVINCIAL RECORDING OFFICE - SUDBURY

M.N.R. ADMINISTRATIVE DISTRICT KIRKLAND LAKE
 MINING DIVISION LARDER LAKE
 LAND TITLES/REGISTRY DIVISION TIMISKAMING

RECEIVED
 MAR 12 1999
 OFFICE

Scale 1:20,000

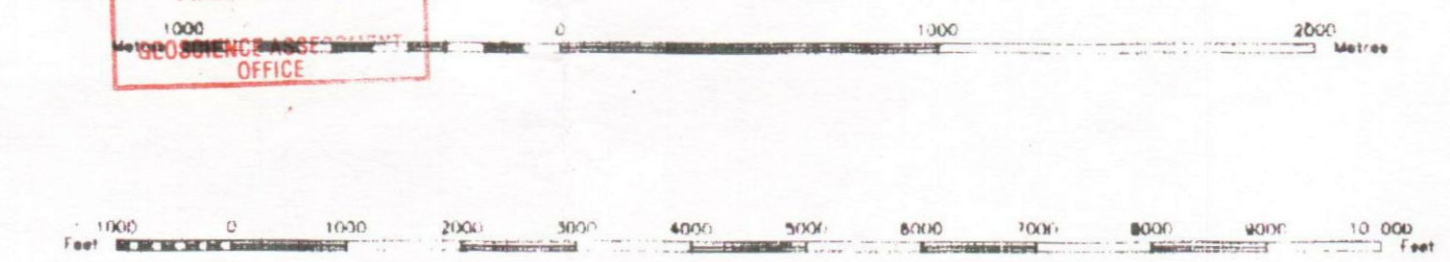

2.19316

AREAS WITHDRAWN FROM DISPOSITION
 MRO - Mining Rights Only
 SRO - Surface Rights Only
 M+S - Mining and Surface Rights

SYMBOLS

Boundary	
Administrative District	---
Township, Meridian, Baseline	---
Road allowance, surveyed	---
shoreline	---
Lot/Concession, surveyed	---
unsurveyed	---
Parcel, surveyed	---
unsurveyed	---
Right-of-way, road	---
railway	---
utility	---
Reservation	---
Cliff, Pit, Pile	---
Contour	---
Interpolated	---
Approximate	---
Depression	---
Control point (horizontal)	---
Fence	---
Flooded land	---
Mine shaft	---
Pipeline (above ground)	---
Railway, single track	---
double track	---
abandoned	---
River/Stream/Creek	---
Intermittent	---
Road, highway, county, township	---
access	---
trail, bush	---
Shoreline (original)	---
Transmission line	---
Wooded area	---

400' surface rights reservation along the shores of all lakes and rivers.

DISPOSITION OF CROWN LANDS

Potential	
Surface & Mining Rights	●
Surface Rights Only	○
Mining Rights Only	◐
Lease	
Surface & Mining Rights	■
Surface Rights Only	□
Mining Rights Only	◻
License of Occupation	▼
Order-in-Council	○
Cancelled	○
Reservation	○
Sand & Gravel	○
Land Use permit	○

THE INFORMATION THAT APPEARS ON THIS MAP HAS BEEN COMPILED FROM VARIOUS SOURCES AND ACCURACY IS NOT GUARANTEED. THOSE WISHING TO STAKE MINING CLAIMS SHOULD CONSULT WITH THE MINING RECORDER, MINISTRY OF NORTHERN DEVELOPMENT AND MINES FOR ADDITIONAL INFORMATION ON THE STATUS OF THE LANDS SHOWN HEREIN.

ARCHIVED SEPT. 19, 1996

CIRCULATED AUGUST 19, 1996

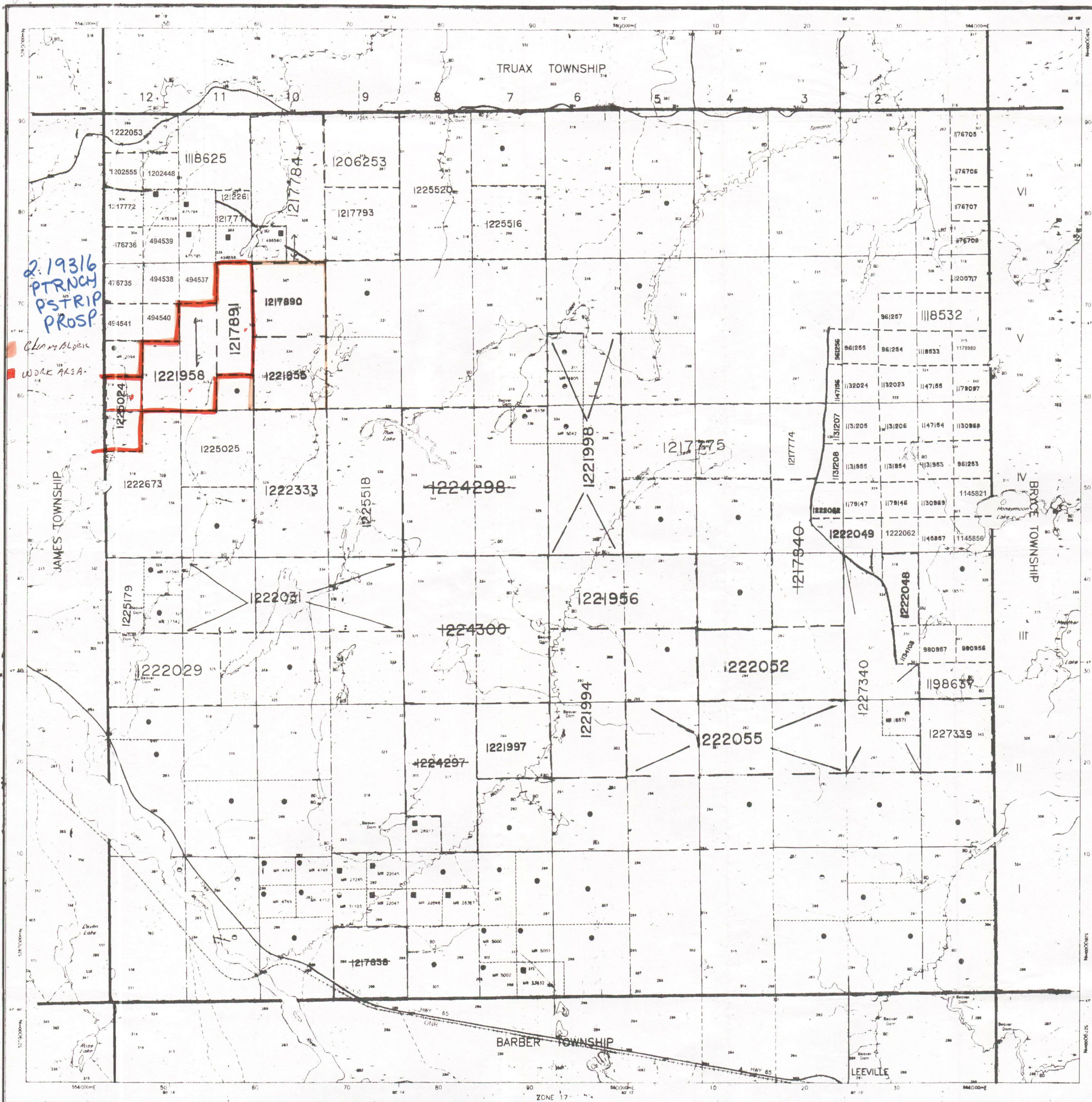

RESIDENT GEOLOGIST
IN COBALT

2.19316

W552

JAMES PT. 25M

W552

NOTES
A - PLANNED DISPOSITION FOR A MUNICIPAL SUBDIVISION IN 1993

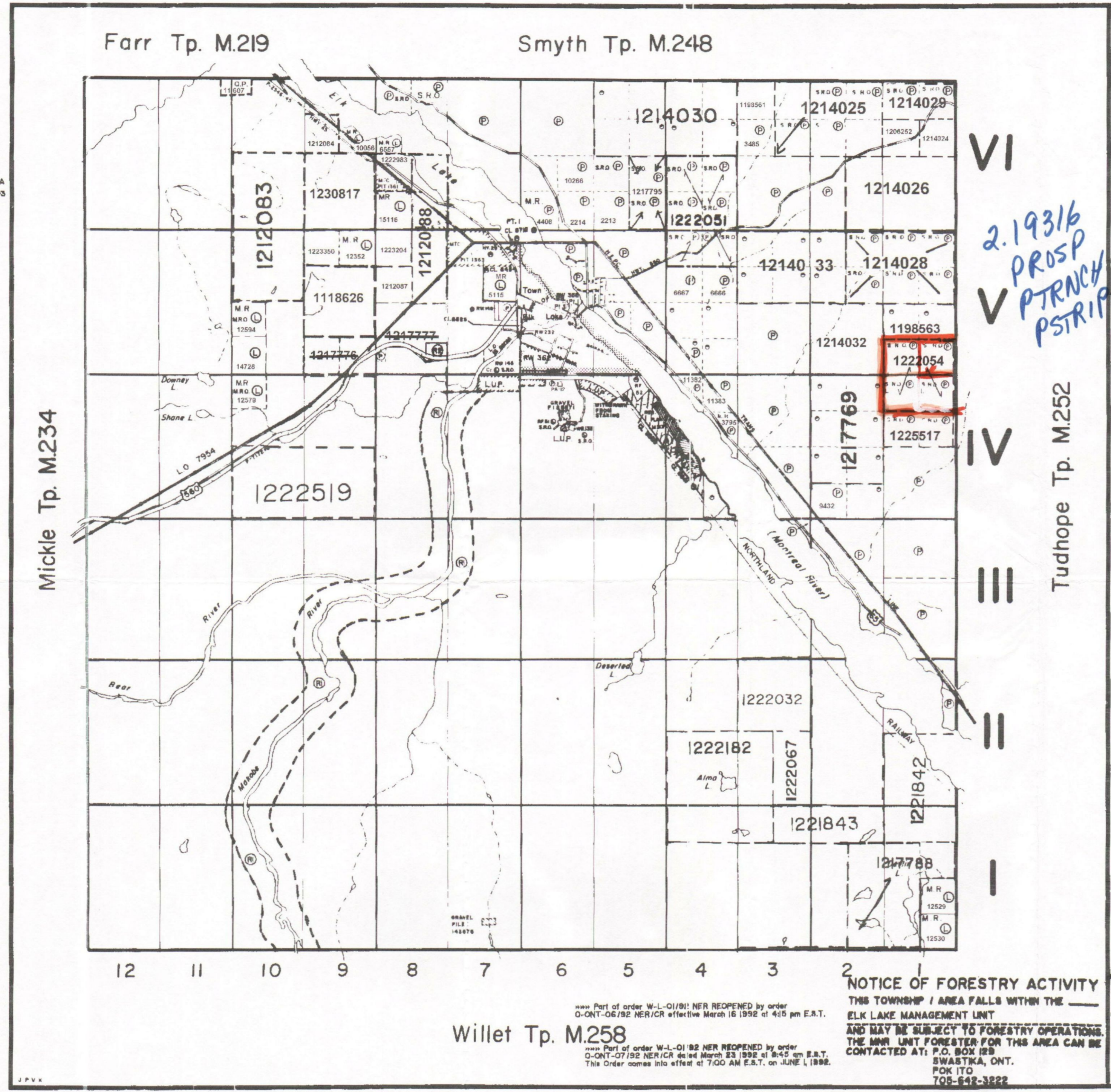

VI
2.19316
PROSP
PTRNCH
PSTRIP

IV
Tudhope Tp. M.252

III
II
I

THE TOWNSHIP
DATE OF ISSUE
OF
MAR 08 1999
PROVINCIAL RECORDING
OFFICE - SUDBURY
JAMES
DISTRICT OF
TIMISKAMING
LARDER LAKE
MINING DIVISION
SCALE: 1-INCH=40 CHAINS

LEGEND

PATENTED LAND	Ⓟ
CROWN LAND SALE	C.S.
LEASES	L
LOCATED LAND	Loc.
LICENSE OF OCCUPATION	L.O.
MINING RIGHTS ONLY	M.R.O.
SURFACE RIGHTS ONLY	S.R.O.
ROADS	—
IMPROVED ROADS	—
KING'S HIGHWAYS	—
RAILWAYS	—
POWER LINES	—
MARSH OR MUSKED	—
MINES	Ⓜ
CANCELLED	Ⓞ
PATENTED S.R.O.	Ⓞ

NOTES
400' surface rights reservation along the shores of all lake and rivers.

*** Part of order NWL 14/82 RE-OPENED by order
O-15-01-90 NER effective April 3, 1990 at 7:00 AM E.S.T.

*** REMAINDER OF MINING AND SURFACE RIGHTS IN JAMES TOWNSHIP WITHDRAWN BY ORDER NRW 14/82, EXCEPTING THOSE LANDS WITHDRAWN BY ORDERS WO 5/83, NRW 106/84 AND W-L-01/92 NER ARE REOPENED BY ORDER O-L-01/82 NER EFFECTIVE JANUARY 7, 1992 AT 9:00 AM E.S.T.

Ⓜ SURFACE AND MINING RIGHTS WITHDRAWN FROM STAKING, SECTION 36/80 ORDER NO. WO-5/83

Ⓜ SURFACE RIGHTS WITHDRAWN FROM STAKING SECTION 36/80 ORDER NRW 106/84

Ⓜ SURFACE AND MINING RIGHTS WITHDRAWN FROM STAKING, SECTION 35 OF THE MINING ACT RSO 1990 ORDER NO. W-L-01/92 NER.

THE INFORMATION THAT APPEARS ON THIS MAP HAS BEEN COMPILED FROM VARIOUS SOURCES AND ACCURACY IS NOT GUARANTEED. THOSE WISHING TO STAKE MINING CLAIMS SHOULD CONSULT WITH THE MINING RECORDER, MINISTRY OF NORTHERN DEVELOPMENT AND MINES, FOR ADDITIONAL INFORMATION ON THE STATUS OF THE LANDS SHOWN HEREON.

NOTICE OF FORESTRY ACTIVITY
THIS TOWNSHIP / AREA FALLS WITHIN THE
ELK LAKE MANAGEMENT UNIT
AND MAY BE SUBJECT TO FORESTRY OPERATIONS.
THE MNR UNIT FORESTER FOR THIS AREA CAN BE CONTACTED AT: P.O. BOX 129
SWASTKA, ONT.
POK ITO
705-642-3822

*** Part of order W-L-01/91: NER REOPENED by order
O-ONT-06/92 NER/CR effective March 16 1992 at 4:15 pm E.S.T.

*** Part of order W-L-01/82 NER REOPENED by order
O-ONT-07/92 NER/CR dated March 23 1992 at 9:45 am E.S.T.
This Order comes into effect at 7:00 AM E.S.T. on JUNE 1, 1992.

Willet Tp. M.258

PLAN NO. - M.225
ONTARIO #3
MINISTRY OF NATURAL RESOURCES
SURVEYS AND MAPPING BRANCH

COPY OF THIS MYLAR ARCHIVED ON JAN. 03/92
COPY OF THIS MYLAR ARCHIVED JUNE 1, 1992
ARCHIVED OCT. 28, 1994
ARCHIVED DECEMBER 30, 1996



41P09NW2005 2.19316 TUDHOPE

220

SURVEYED
TWP
LINE

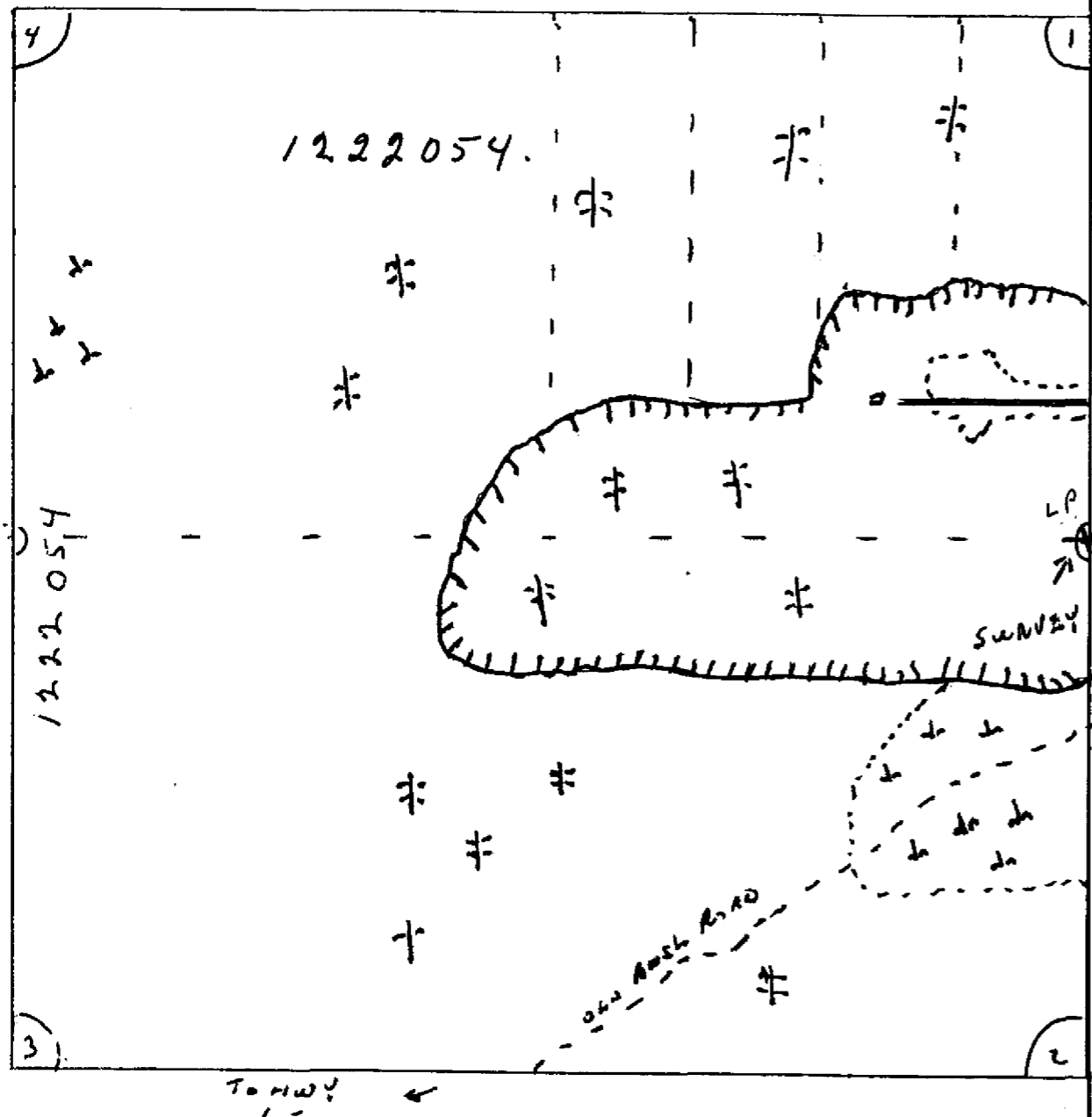

- TRENCH
- ROCK OUTCROP
- SWAMP AREA
- SHAFT
- P.T.
- MED. TO DENSE FOREST
- CUT OVER AREA
- MUCK PILE
- STRIPPED AREA

WEST PORTION OF 1222054 IS LOW SWAMPY
GROUND TIMBER MAINLY BLACK SPRUCE
WITH THICK UNDER GROWTH.
THE OUTCROP IS ^{COVERED} MAINLY MATURE TIMBER
POPKAN & BIRCH
THE OVER BURDEN ON THE AREA STRIPPED IS
APPROX .5 TO 2 M THICK THEN DIPS TO THICK-
NESS UNKNOWN.
OUTCROP IS FINE TO MED GRAINED DIABASE.

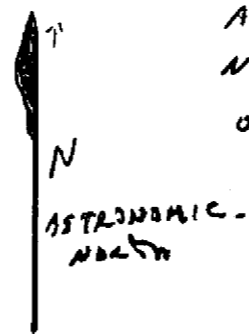

TO HWY
65 ←

Surveyed
LINE

MAP #2

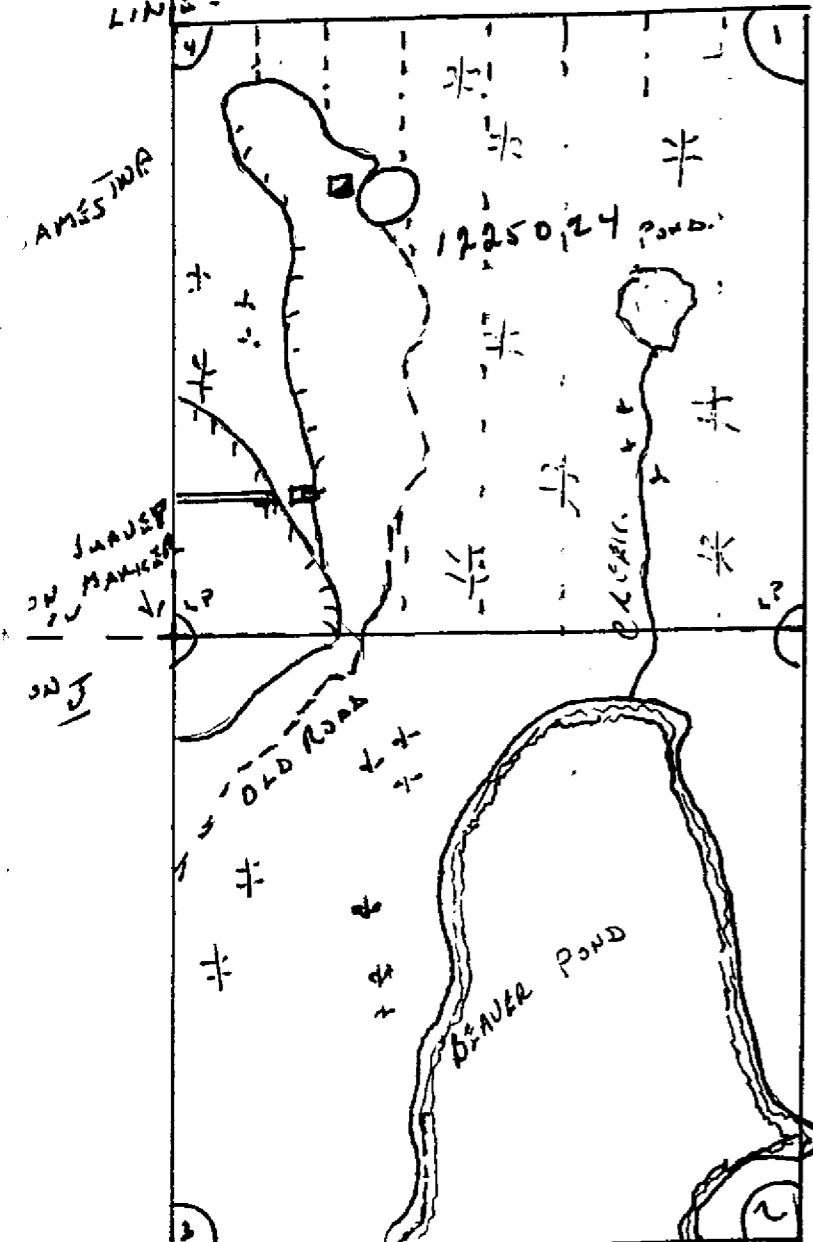

- == TRENCH
- ~~~ ROCK OUTCROP
- ~~~ SWAMP
- SHAFT
- PIT
- * MATURE FOREST
- ▣ CUT OVER AREA
- MUCK PILE
- LINES OF TRAVERSE

LINES OF TRAVERSE South To North
AND NORTH TO South ALTERNATE. APPROX 100 M.
A PART NE QUARTER OF CLAIM 1225024 IS VERY
HEAVILY WOODED SPRUCE & JACK PINE, UNDERBUSH
IS THICK.

OVER BURDEN IN THE AREA STRIPPED WAS FROM 30 CM
TO APPROX 1.5 M. THICK. OUTER BOUNDARY OF OUTCROP
DIPPED VERY SHARP TO DEPTH UNKNOWN OF OVERBURDEN
OVER BURDEN WAS CLAY & SMALL BOWLDERS MAINLY
GRANITIC. WITH A LITE CAP OF MOSS.

THE OUT CROPS IN THE AREA ARE FINE TO MEDIUM GRAINED NAPHS.
DIABASE. W VERY FINE FRACTURES IN THE CYLINDRICAL FORMATION
STRIPPED PIT ON THE EAST OF TRENCH WAS DUG AT THE BASE OF ROCK
FACE APPROX 20 FT HIGH OVER BURDEN IN THIS AREA WAS VERY FINE
SAND. WOULD APPEAR TO BE AN OLD SAND PIT.

41P09W02005 2.19316 TUDHOPE



230

ST 1

TUDHOPE TWP.

- A. LINES OF TRAVERSE NORTH & SOUTH.
- B. OLD ROADS ARE NOT PASSABLE FOR VEHICLE TRAVEL. MUST HAVE BEEN REFORCED.

- == TRENCH.
- ⊞ ROCK OUT C&P
- ⊞ SWAMP AREA.
- ⊞ SHARP PIT
- ⊞ OLD TO DENSE FOREST
- ⊞ CUT OVER AREA.
-) MUCK PITS

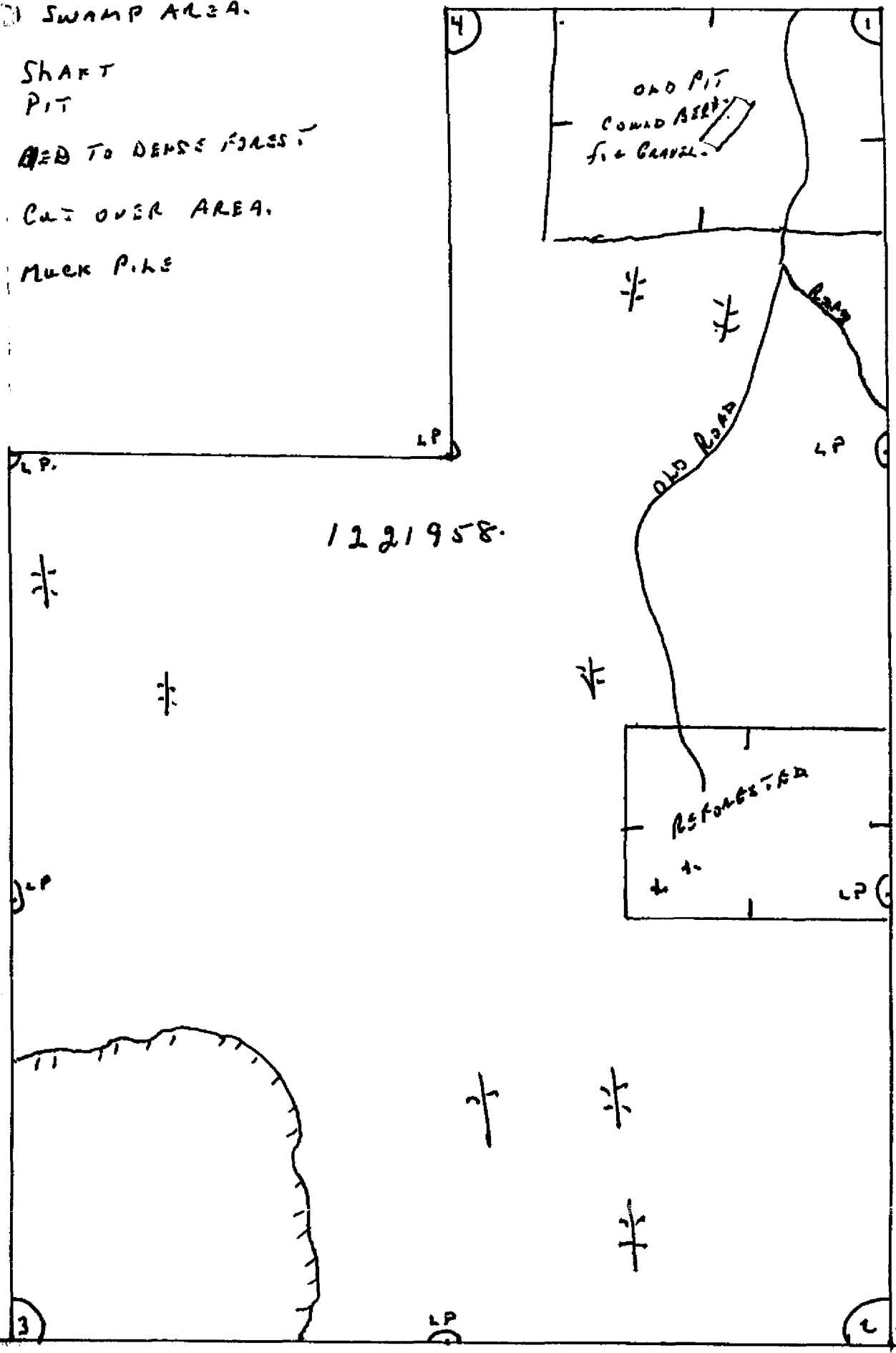

↑
2
ASTRONOMIC NORTH

CON V
CON IV





1:5000



MAP # 4.

TOWNSHIP 27 N. LOT 11 EAST 1/4.

SURVEYED LINE - CONT. VI

- == TRENCH.
-  ROCK OUT CROP
-  SWAMP AREA.
- SHAFT
- PIT
- ⌘ MED TO DENSE FOREST.
-  CUT OVER AREA.
- MUCK PILE

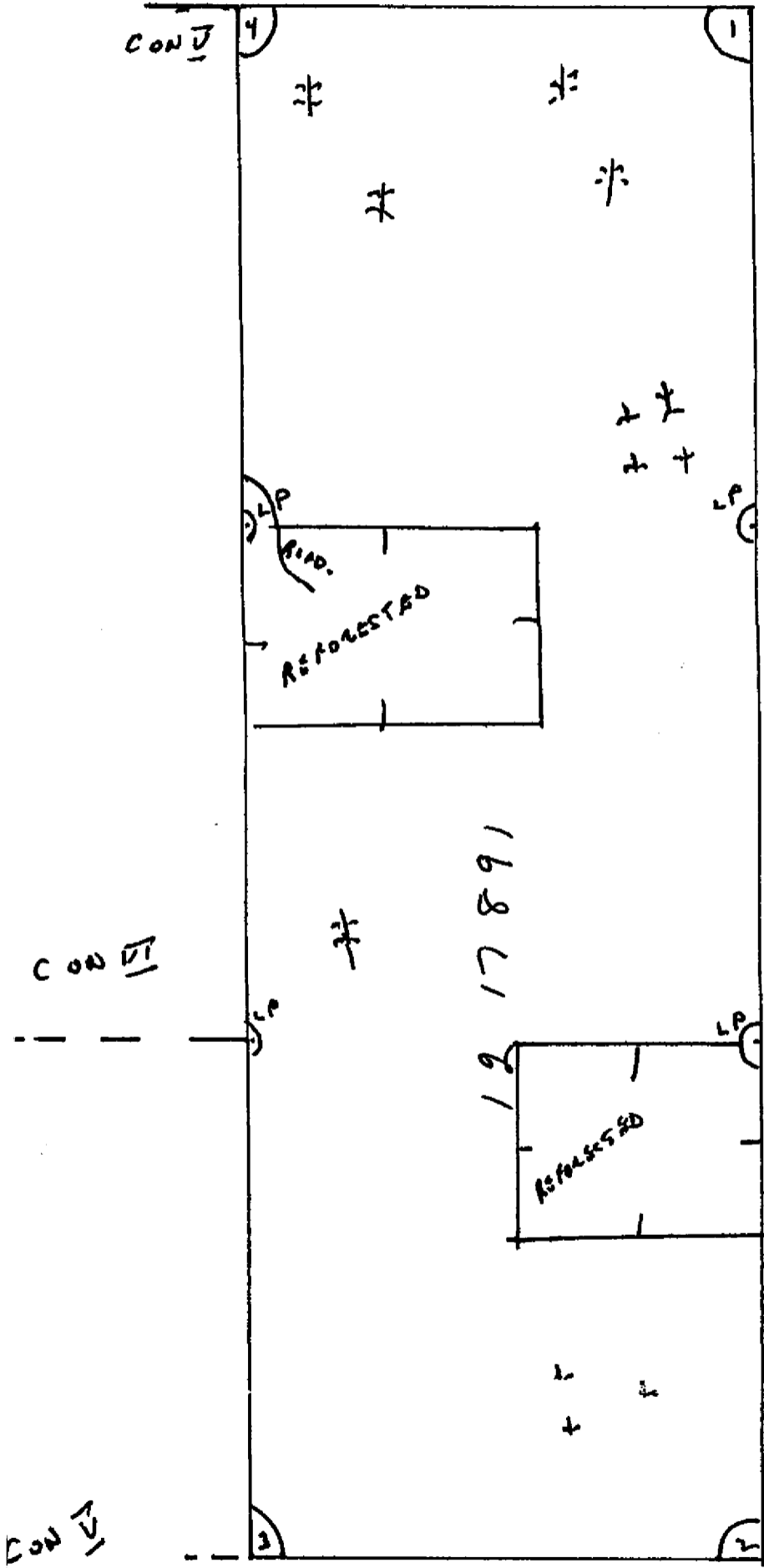

1: 5,000 METRIC.

