

2.22505

GEOLOGICAL REPORT

ON

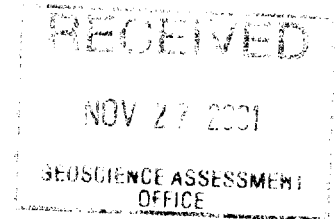

LACARTE PROPERTY

JAMES TOWNSHIP

DISTRICT OF LARDER LAKE, ONTARIO

BY
E.M.BAŠA

November 16, 2001



41P09NW2006 2.22505 JAMES

010

TABLE OF CONTENTS

Table of Contents.....	2
Summary.....	3
Property Description and Access.....	3
Past Work.....	6
Regional Geology.....	6
Local Geology	
Lithologies.....	7
Structure.....	7
Mineralization.....	7
Assay results.....	8
Recommendations.....	8
References.....	9
Statement of Qualifications.....	10
Assay certificates.....	Appendix I

LIST OF FIGURES

Figure 1	Property Location Map.....	4
Figure 2	Claim Location Map.....	5
Figure 3	Geology of Property.....	back pocket

SUMMARY

A mapping program was completed for Roy E. LaCarte, on the Roy LaCarte, Roger LaCarte and Jason Bond property in October 2001. The ground was recorded in March and May of 2001 and transferred to Roy LaCarte in August, 2001. The entire area had previously been explored in the early 1900's. An irregular web of old trenches was still visible. Many of these were followed before stripping began. A stripping program uncovered approximately 2700 m² of outcrop. A total of eight areas were stripped and washed. Depths of overburden varied from less than 0.5m to about 3.0m. Two holes were dug for water collection to use for washing, as there was little water available. The exposed rocks were washed and prospected and sampled across fracture zones, particularly around the pits. Three pits from the original trenching were located cleaned and examined. Several fracture zones or veins were evident in the pits. Samples were assayed for gold/silver. Two days were spent in the field mapping the geology and structure.

PROPERTY DESCRIPTION AND ACCESS

The property lies roughly 2 km SSE of the town of Elk Lake which is approximately 70 km west of New Liskeard and approximately 50 km SSW of Kirkland Lake (Figure 1). Road access to the property is good via an abandoned Ontario Northland Railway bed, now a road, southeast from Elk Lake then up the hill on an old logging road to the property. The claim holders have constructed a rough road into the claim workings.

The property consists of 2 claims (Figure 2). Claim 1242985 is a 4-unit claim comprising the S $\frac{1}{2}$ of Lot 4 Con III. Claim 1242984 is a 2-unit claim comprising the W $\frac{1}{2}$ of the S $\frac{1}{2}$ of Lot 3 Con III. The work area on claim 1242984 is covered with approximately 0 to 1m of overburden consisting of boulder clay and clay. The author visited only the outcrop exposed by stripping.

LACARTE PROPERTY

JAMES TOWNSHIP

WORK LOCATION

Location of trench # 1

this trench is located approx. 120 metres east and 125 metres south from #4 post of claim #1242984. The remainder of work area can be found by following the excavator trail.

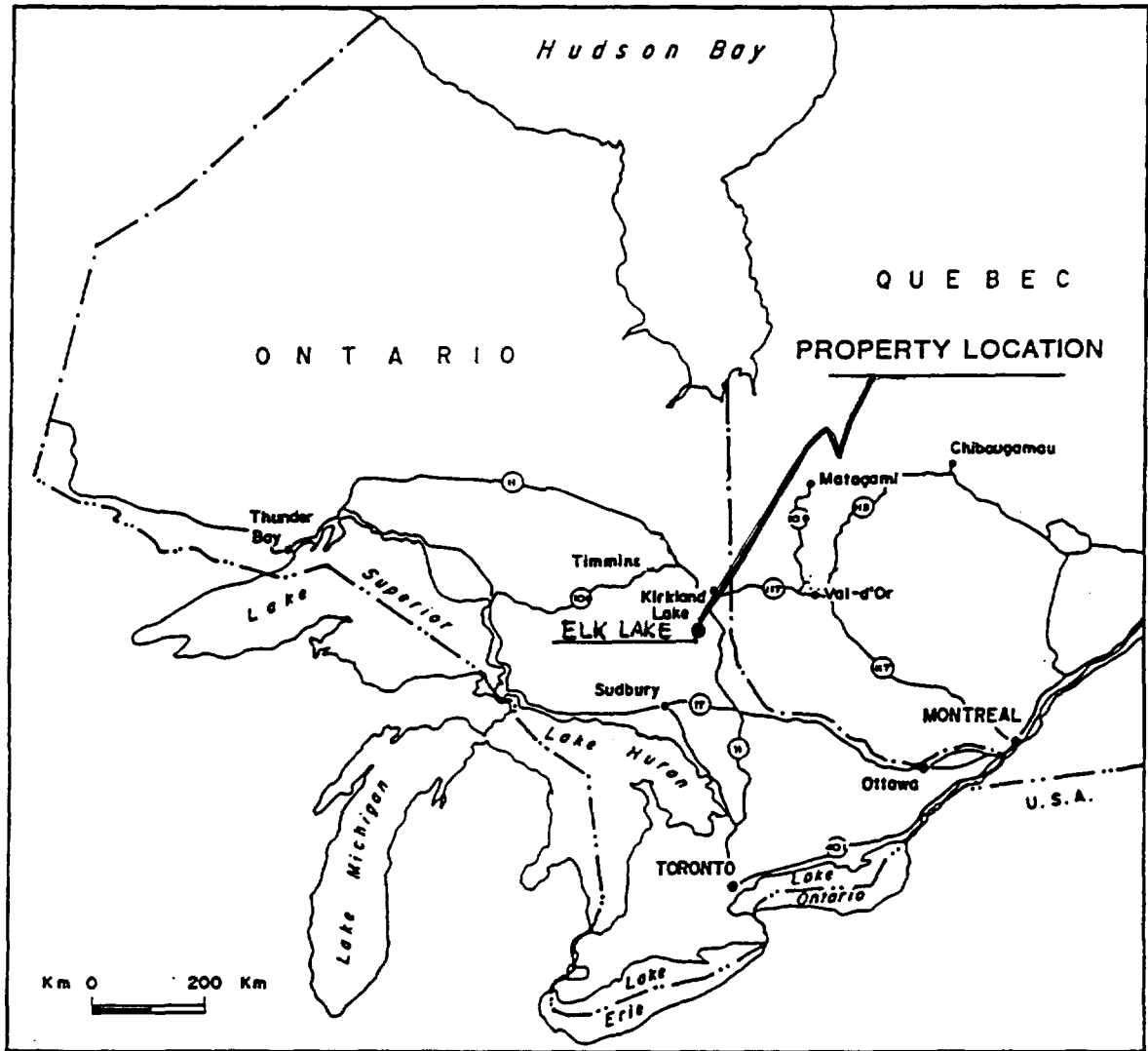
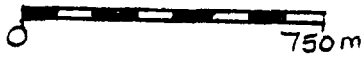



Figure 1



CLAIM LOCATION MAP
JAMES TWP.



LEGEND

- rail bed/road
-  work location

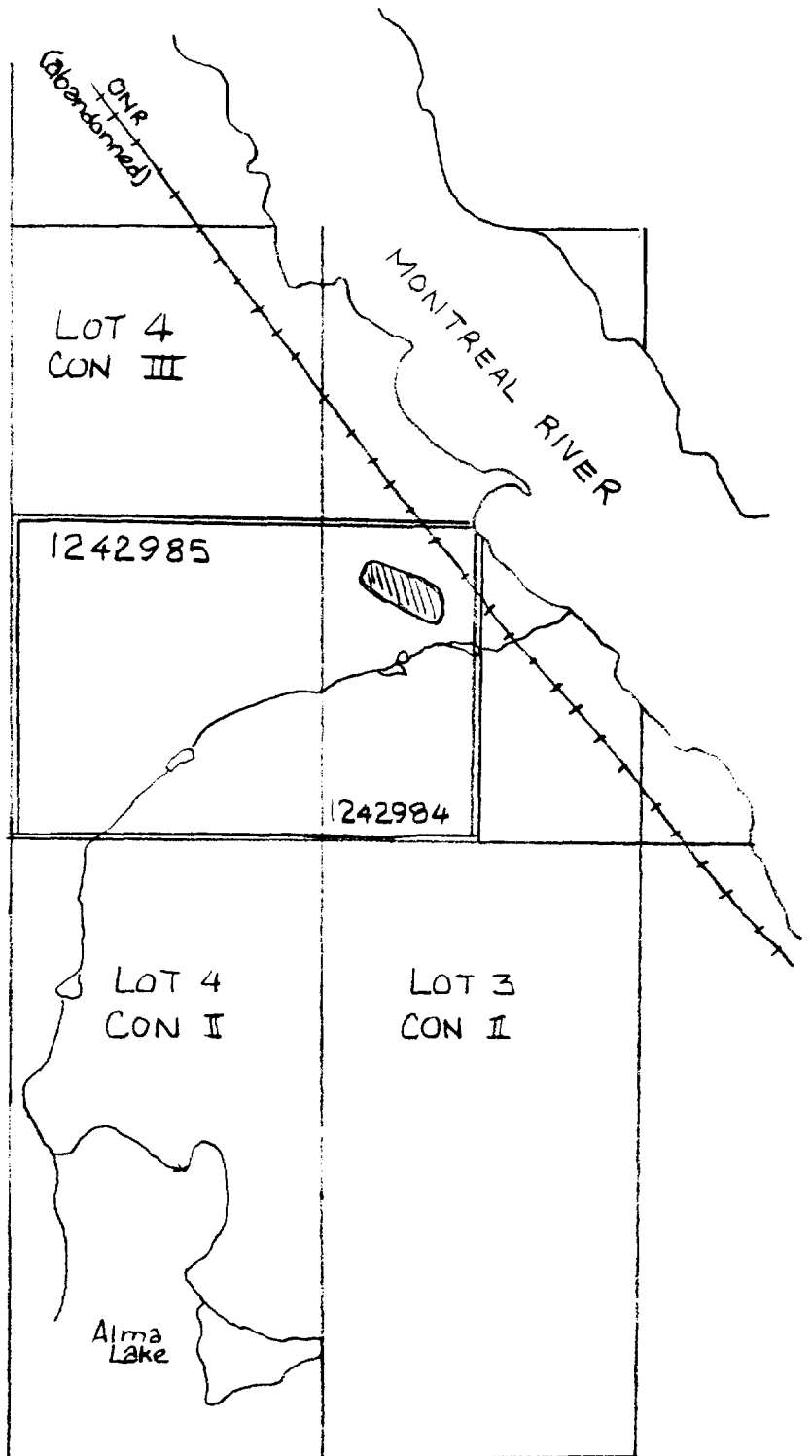

Figure 2. Claim Location Map

PAST WORK

The former McKenzie and Master Stein Cobalt Mining Company Limited properties form the east half of claim 1242985 (4 units). The southern of these was the McKenzie property. It was developed between 1908 and 1910. Two shafts were sunk to 30 and 60 feet, the former with a long open cut and trench (Mackean, 1968). There were a number of veins on the property, not all developed. The main shaft was sunk on a 1" calcite vein trending N40°W, dipping 65°NE. The trench and secondary shaft were on a 1 ½" calcite vein approximately 40 feet to the south, striking N 30°W and dipping 75°NE. An aplite vein parallels this second vein. Limited work was done from these workings. No production is mentioned (Mackean, 1968).

The NE unit in claim 1242985 is the former Master Stein Cobalt Mining Company Limited property. The company was active only from 1907 to 1912. All that is mentioned in Mackean, (1968), is a 20 foot deep pit on a vertical, 10" calcite vein striking N55°E. This is at the base of a south-facing diabase escarpment, which extends roughly eastwards onto claim 1242984.

Information supplied to me by the current property owner, apparently copied from assessment files in the Resident Geologist Office (looks to be from R.Thomson's time from the notations - paper not dated), mentions the Derry Silver-Cobalt property as covering the eastern half of claim 1242985 and the north half of claim 1242984.

The area of claim 1242984, where the current work was done, is riddled with old trenches. They are obviously hand trenched and are assumed to be from the early 1900's. The trenches were irregular and apparently followed fractures as the pits we located were at, or near, trench intersections. This is likely an indication that the grade of silver was richer at fracture junctions (particularly common in the Cobalt camp in diabase-hosted veins).

Work done this summer involved building a rough road from the existing logging road approximately 225m in length from which all the trenching was done. An area of approximately 2700m² was stripped - most of this was washed.

REGIONAL GEOLOGY

James Township lies within the Southern structural province near the boundary with the Superior province. James Township was last mapped in 1963, by the Ontario Department of Mines, along with Mickle, Chown, Willet, Roadhouse and Lawson Townships to form a three-map report area, released as Geology of the Elk Lake Area; Geological Report 62 in 1968. Mickle and James Township Area Map 2151.

James Township is near the northern margin of the Cobalt sedimentary basin and borders the Round Lake granite batholith to the north. The sedimentary rocks here belong to the Middle Precambrian age Cobalt Group of the Huronian Supergroup. Nipissing gabbro is also present throughout the township dipping below the Huronian sediments. The diabase is interpreted (Mackean, 1968) to be a complex intrusion intruded along feeder dikes into sill-like structures

rather than simply a sill. The claim group lies within the diabase in the southeastern portion of the township. The area is covered by substantial and varying amounts of Quaternary glacial sand and gravel deposits. There have not been any volcanic rocks mapped here previously due to the overburden cover although the geological report mentions large volcanic inclusion within the granite in areas.

Structurally, there are several main lineaments, most are not continuous over more than 5 or 6 lots. The Montreal River trends southeast immediately east of the claim group. Several of the lineaments approach the river with an east-southeast trend but do not appear to reach the river. Two small lineaments (approximately 2 lots in length) cross the claim group, trend east-northeast to northeast again approaching but not reaching the Montreal River.

LOCAL GEOLOGY

Lithologies

Only one rock type was mapped on the property. Medium-grained Nipissing diabase covers the area where the stripping was completed. The diabase is fairly uniformly medium grained, dark green and generally strongly fractured. Pink aplite veins are mapped in several places in the stripped area. There are near vertical aplite veins as well as very shallow aplite veinlets generally associated with epidote. These appear to be shallow-dipping fractures as opposed to veins

Structure

The predominant structure over this stripped area of the claims consists of circular jointing common to the Nipissing gabbro. The 'diameter' and concentration of jointing varies considerably over the property and sometimes within an outcrop. There is also a lot of cross-jointing. Two sets of parallel fractures were mapped (Trench 1 and 2 - Figure 3) trending near north-south. These show only epidote mineralization and one is associated with a discontinuous aplite dike. Several veins were seen. They were generally discontinuous and irregular - often following jointing.

Mineralization

Mineralization is limited to fracture zones. Chalcopyrite was the predominant mineral seen both in fractures and the vein in Pit 1. Some specular hematite was noted in Pits 1 and 3. Silver was seen in stripped zone 5 at the northeastern end of a small blast area. The silver noted was in a fracture zone but not on a fracture surface. Hand lens inspection of broken samples revealed minor amounts of silver. As noted above, epidote was evident and quite strong in places - generally on shallow-dipping fractures, but strongest when associated with steep aplite veins. Some fractures were quartz-filled and locally calcite was present. The exception was in the vein through Pit 1, which is a quartz-calcite vein zone. The vein in Pit 3 is a 1cm calcite vein adjacent to a 1 cm shear and associated with a 3cm aplite vein. Although no mineralization was noted, bleaching was obvious and extended, locally, to approximately 30 cm from the vein set. A sample was taken across the zone and tested for silver and gold.

ASSAY RESULTS

Assay results are seen in Appendix 1. Samples 3-7 were taken in various sites around Pit 1 by Jason Bond and were assayed for gold and silver. Several had platinum and palladium assays performed but the results have not been received. The highest value of silver was 65.5 g/t and the highest value for gold was 2.04 g/t. The only other two samples taken were in Trench 5 where minor silver was visible near a blasted area and at the edge of Pit 3 where the vein had a shear component and was associated with a strong aplite vein. These both returned minimal values of both metals.

RECOMMENDATIONS

These workings are close to the diabase escarpment mentioned on the Master Stein property write up in Mackean (1968). It may prove fruitful to prospect along the base of the escarpment, keeping in mind the possible extensions of fractures identified by the current stripping. Also, a number of workings exist on both the McKenzie and Master Stein properties within this claim group. Sampling and prospecting these areas would be helpful as groundwork for providing promising areas to follow up with further work.

REFERENCES

Mackean, B.E. 1968. Geology of the Elk Lake Area. Ontario Department of Mines Geological Report 62. 62p.

Mackean, B.E. 1968. Mickle and James Townships Map 2151; Ontario Department of Mines. Scale 1" = 1/2 mile.

Pyke, D.R., Ayres, A.D., and Innes D.G. 1971. Timmins-Kirkland Lake Geological Compilation Series Map 2205; Ontario Geological Survey. Scale 1"= 4 miles.

Photocopies from various assessment files referring to the Master Stein Cobalt Mining Company Limited and the McKenzie Mining Company.

STATEMENT OF QUALIFICATIONS

I, Elaine Basa, of the town of Haileybury, in the Province of Ontario hereby certify as follows concerning my report on the LaCarte property in James Township, dated November 16, 2001:

1. I graduated from Carleton University in 1985 with a degree of Bachelor of Science, Honours Geology
2. I have worked continuously in the mining industry for the past 16 years
3. The attached report is a product of:
 - a) data provided to me by Roy LaCarte
 - b) maps identified in the reference section of this report
 - c) property visits and mapping conducted on those visits
4. I do not have any direct or indirect interest in the property described.

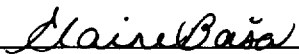
Elaine Basa

Dated in Haileybury, Ontario, on November 16, 2001

APPENDIX I

Assay Certificates



Established 1928

Swastika Laboratories Ltd

Assaying - Consulting - Representation

Assay Certificate

1W-2084-RA1

Company: **JASON BOND**

Date: SEP-24-01

Project:

Attn: J. Bond

We hereby certify the following Assay of 5 Rock samples submitted SEP-10-01 by .

Sample Number	Au g/tonne	Au Check g/tonne	Ag g/tonne
#1 S-3	0.06	-	0.1
#2 S-4	3.62	3.50	24.8
#3 S-5	0.03	-	63.3
#4 S-6	2.04	-	65.5
#5 S-7	0.01	-	4.9

Certified by Ronald D. Remon.



Established 1928

Swastika Laboratories Ltd

Assaying - Consulting - Representation

Assay Certificate

1W-2415-RA1

Company: **ROY LACARTE**
Project:
Attn: R. Lacarte

Date: OCT-25-01

We hereby certify the following Assay of 2 Rock samples submitted OCT-22-01 by .

Sample Number		Au g/tonne	Au Check g/tonne	Ag g/tonne
Sample 01-10-12-01	S-1	0.01	-	0.1
Pit #3 01-10-19-02	S-2	0.01	0.01	2.2

Certified by _____

1 Cameron Ave., P.O. Box 10, Swastika, Ontario P0K 1T0
Telephone (705) 642-3244 Fax (705) 642-3300



Established 1928

Swastika Laboratories Ltd

Assaying - Consulting - Representation

Assay Certificate

1W-2415-RA1

Company: **ROY LACARTE**

Date: OCT-25-01

Project:

Attn: R. Lacarte

We hereby certify the following Assay of 2 Rock samples submitted OCT-22-01 by .

Sample Number	Au g/tonne	Au Check g/tonne	Ag g/tonne
Sample 01-10-12-01	0.01	-	0.1
Pit #3 01-10-19-02	0.01	0.01	2.2

Certified by _____

Date: 2002-FEB-06

GEOSCIENCE ASSESSMENT OFFICE
933 RAMSEY LAKE ROAD, 6th FLOOR
SUDBURY, ONTARIO
P3E 6B5

ROY EARL LACARTE
BOX 431
LOT 4 CON 5 DACK TWP.
ENGLEHART, ONTARIO
P0J 1H0 CANADA

Tel: (888) 415-9845
Fax: (877) 670-1555

Submission Number: 2.22505
Transaction Number(s): W0180.31169

Dear Sir or Madam

Subject: Approval of Assessment Work

We have approved your Assessment Work Submission with the above noted Transaction Number(s). The attached Work Report Summary indicates the results of the approval.

At the discretion of the Ministry, the assessment work performed on the mining lands noted in this work report may be subject to inspection and/or investigation at any time.

If you have any question regarding this correspondence, please contact STEVEN BENETEAU by email at steve.beneteau@ndm.gov.on.ca or by phone at (705) 670-5855.

Yours Sincerely,



Ron Gashinski
Senior Manager, Mining Lands Section

Cc: Resident Geologist

Roy Earl Lacarte
(Claim Holder)

Assessment File Library

Roy Earl Lacarte
(Assessment Office)

LACARTE PROPERTY

JAMES TOWNSHIP

CLAIM 1242984



41P09NW2006 2.22505 JAMES

210

SCALE

1:500

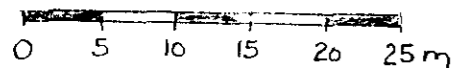

LEGEND

- road
- trenching limits
- old trail
- outcrop
- 0.7 m depth of overburden
- jointing; strike/dip
- 17/30cm concentration of jointing
- circular jointing
- sample location
- GPS point location
- pit
- epidote
- quartz
- calcite
- aplite
- hematite
- chalcopyrite
- silver

GPS Co-ordinates:
 Pit 1: N 47° 42.117'
 W 80° 18.308'
 PIT 3: N 47° 42.146'
 W 80° 18.302'

LACARTE PROPERTY

James Township Larder Lake Mining Division

GEOLOGY MAP

Claim L 1242984

NOVEMBER 2001 DRAWN BY: E.M.BASA FIGURE 3

