



41P09SE0006 10 CANE

010

Diamond Drilling

Township OF CANE

Report N^o: 10

Work performed by: WINDY HILL MINING CORP. LTD.

Claim N ^o	Hole N ^o	Footage	Date	Note
T 43970	# 1	127'	Dec/58	
	# 2	157'	Jan/59	
	# 3	200'	Jan- Feb/59	
	# 4	214'	Feb- Mar/59	
	# 5	304'	Oct/59	
	# 6	385'	Oct/59	
	# 25	36'	June/60	
	# 26	106'	May/60	
	# 27	44'	June/60	
# 28	111'	May- June/60		

Notes:

T 44294 40 DAYS	T 44307 40 DAYS	T 43522 40 DAYS.	T 43523 40 DAYS
T 44295 40 DAYS		T 43970 58 DAYS	T 43969 40 DAYS.
T 44296 40 DAYS			
T 44297 40 DAYS			
T 44298 40 DAYS	T 44291 40 DAYS	T 44290 40 DAYS	T 44308 40 DAYS
T 44299 40 DAYS	T 44293 40 DAYS	T 44292 40 DAYS	T 44289 40 DAYS.



DIAMOND DRILLING ON
CLAIM T 43970. AS.
PER ATTACHED
SKETCH.

M.H.

WINDY HILL MINING CORP.
ROGER GAREAU CLAIMS.
CANE TWP.

April 15/59.

McHill Land Plg.

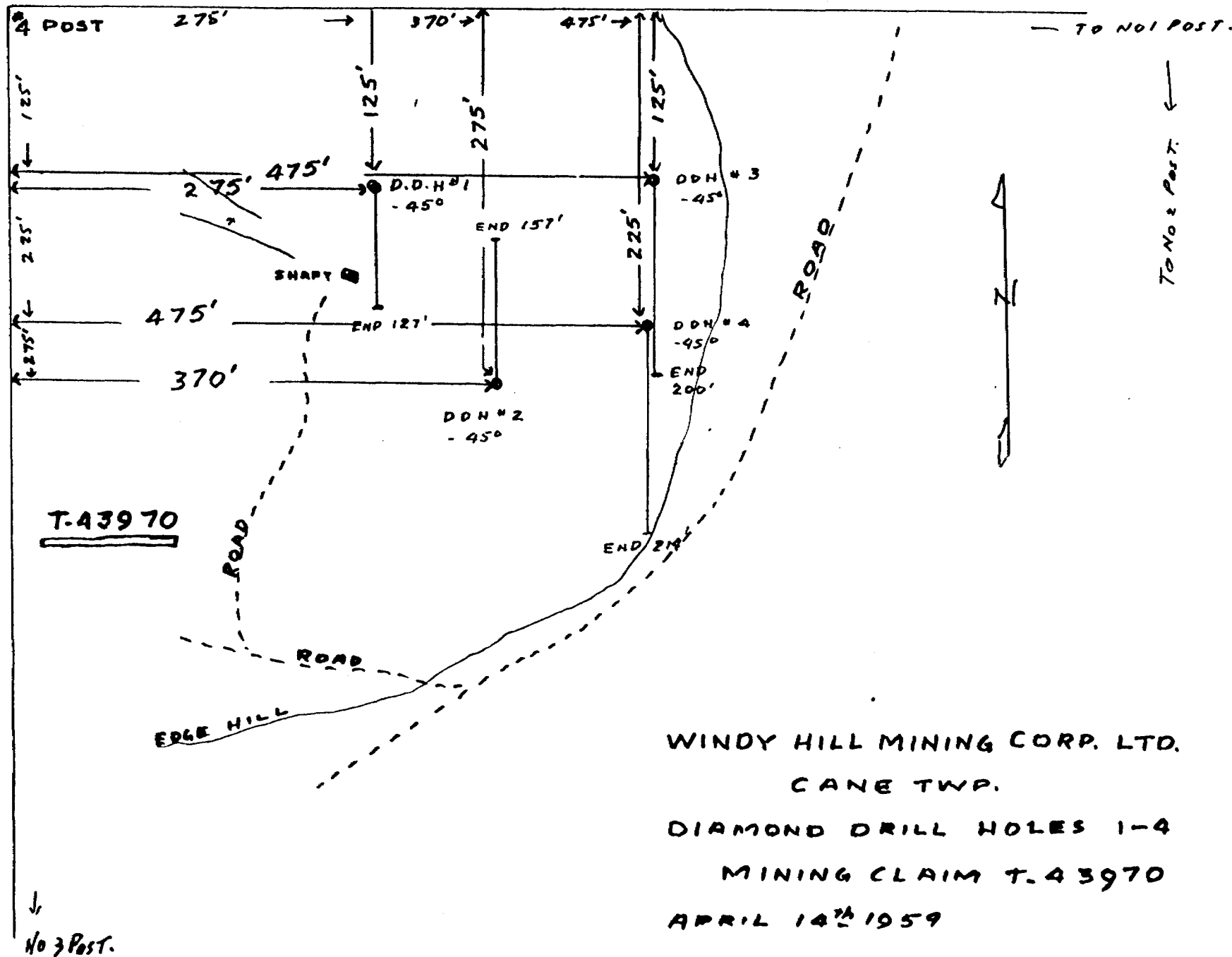

M. C. Newland. P. Eng.

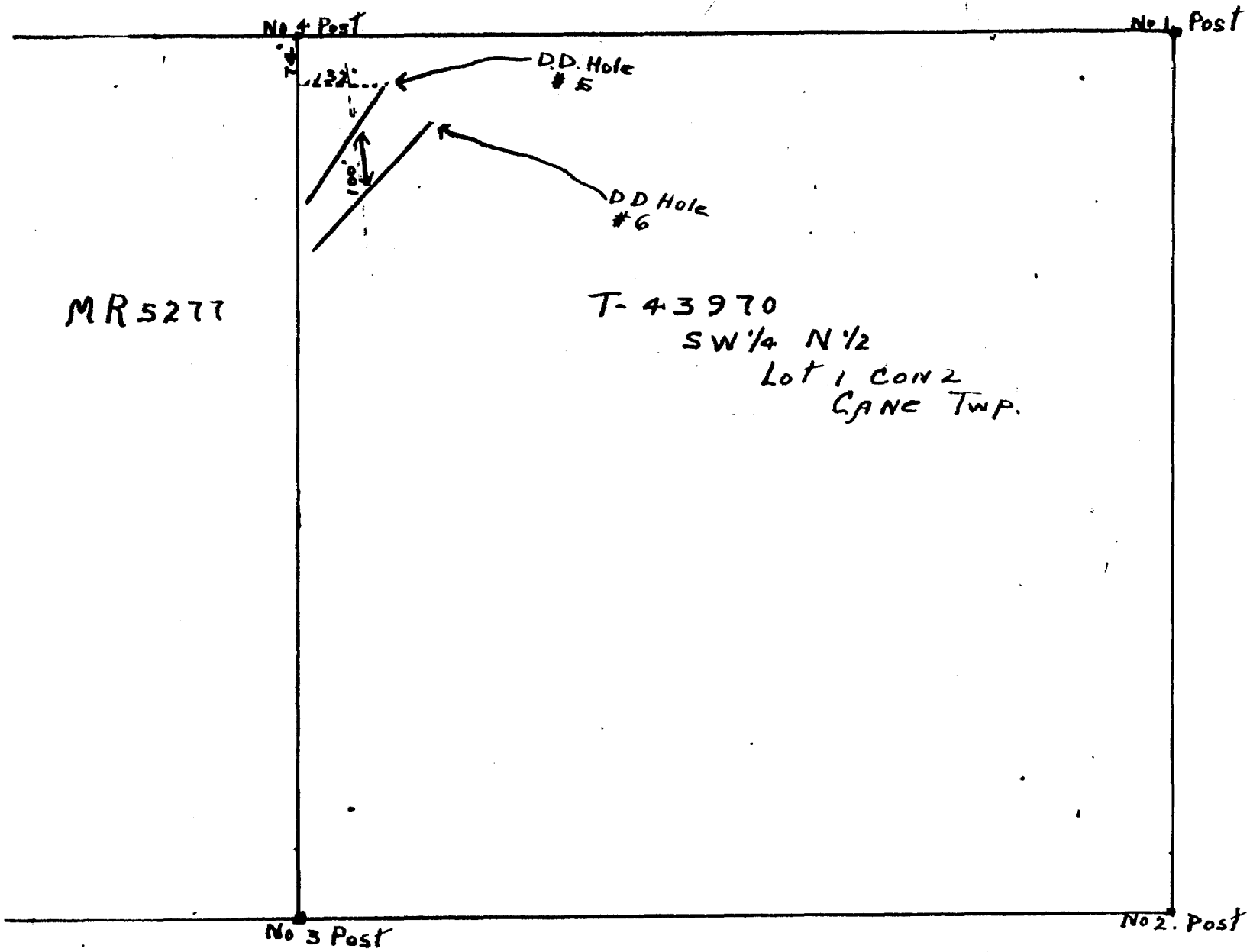

MR 5277

T-43970
SW 1/4 N 1/2
Lot 1 CON 2
CANE TWP.

Oct 24th. 1959.
Scale 1" = 220'

Drawn by J. G. Pollard

DIAMOND DRILL LOG

D.D.HOLE NO. 1

PAGE 1

LOCATION on Claim T.43970

WINDY HILL MINING CORP.LTD.

DEPTH OF HOLE 127'

COLLAR 275' East, 125' South
No. 4 Corner Post

Cane Township

SIZE OF CORE "AXT"

BEARING Due South

STARTED December 12, 1958.

DIP -45°

COMPLETED December 20, 1958

FROM	TO	DESCRIPTION	SAMPLE NO.	CORE FT.	OZ. PER TON		PER CENT				
					AG.	AU.	FE	S	CU.	NI.	
0	5	Casing									
5	52.5	Diabase									
52.5	53.5	Aplite (52.5-53.5')	#62	12"	Trace						
53.5	100	Diabase									
100	101.5	Aplite aprite (100-101.5)	65	1 1/2"	Trace						
101.5	109.5	Diabase									
109.5	110	Diabase Aplite (109.5-110)	63	6"	Trace						
110	127	Diabase									
	127.0	END OF HOLE									



DRILLED BY: Grexton Diamond Drilling Co.

LOGGED BY:

M. C. Helstead

M. C. Helstead

DIAMOND DRILL LOG

D.D.HOLE NO. 2

PAGE 1

LOCATION on Claim T.43970

COLLAR 370' East, 275' South
of Post No. 4

BEARING Due North

DIP -45°

WINDY HILL MINING CORP. LTD.

Cane Township

DEPTH OF HOLE 157.0'

SIZE OF CORE "AXT"

STARTED January 10, 1959.

COMPLETED January 20, 1959.

FROM	TO	DESCRIPTION	SAMPLE NO.	CORE FT.	OZ. PER TON		PER CENT				
					AG.	AU.	FE	S	CU.	NI.	
0	157	Diabase									

DRILLED BY: Grexton Diamond Drilling Co.

LOGGED BY: M. C. Halstead

M. C. Halstead

diamond Drill Log

LOCATION on Claim T.43970

WINDY HILL MINING CORP. LTD.

DEPTH OF HOLE 200'

COLLAR 475' East and 125' South
No. 4 Post.

Cane Township

SIZE OF CORE "AXT"

BEARING Due South

STARTED January 22, 1959.

DIP -45°

COMPLETED February 5, 1959.

FROM	TO	DESCRIPTION	SAMPLE NO.	CORE FT.	OZ. PER TON		PER CENT				
					AU.	AG.	FE	S	CU	NI	
0	10	Casing									
10	17	Pink quartzite									
17	198	Diabase									
198	199	Aplite	#64	1 1/2"	Tract						
199	200	Diabase									
	200.0	END OF HOLE									

DRILLED BY: Grexton Diamond Drilling Co.

LOGGED BY: M. C. Halstead

M. C. Halstead

DIAMOND DRILL LOG

LOCATION on Claim T.43970

WINDY HILL MINING CORP. LIMITED

DEPTH OF HOLE 214'

COLLAR 475' East and 225' South
of Post No. 4

Cane Township

SIZE OF CORE "AAT"

BEARING Due South

STARTED February 7, 1959.

DIP -45°

COMPLETED March 1, 1959.

FROM	TO	DESCRIPTION	SAMPLE NO.	CORE FT.	OZ. PER TON		PER CENT	
0	5	Casing						
5	19	quartzite Pink						
19	32	Fine grained diabase						
32	214	Fine grained diabase.						
	214.0	END OF HOLE						

DRILLED BY: Grexton Diamond Drilling Co.

LOGGED BY: M. C. Halstead

M. C. Halstead

DIAMOND DRILL LOG

PROPERTY

Chipp-Windy Hill Mining Corp

D. D. HOLE NO. 5

PAGE 1

LOCATION Claim T-43970 - SW 1/4 N 1/2 Lot 2 Con 2 CANE TWP.

COLLAR: LAT. _____

DEP. _____

ELEV. _____

BEARING S 55 W

DIP 45°

DEPTH OF HOLE 304'

STARTED Oct 8th. 1959

COMPLETED Oct 12th. 1959

DRILLED BY Universal D.D. Co Ltd
Port Credit, Ont

FROM	TO	DESCRIPTION	SAMPLE NO.	CORE FT.
0	20	CASING		
20.	26.	Diabase (Nipissing) med. grained. pale green Felspar		
26.	26.4	Diabase altered. siliceous - 2 calcite seams at each end. 4" apart. cut 30°		
26.4	34.9	Diabase, med. grained. at 33.5, calcite 1/16" cut 30° also calcite 1/16" at 34'		
34.9	35.0	Diabase, calcite & epidote - Calcite blue, epidote throughout this section		
35.0	42.0	Diabase, med. grained. - dense - calcite seam 1/8" at 42' cut 20°		
42.0	42.5	Diabase with 3 calcite seams each 1/8" with minute inclusions diabase - no mineral		
42.5	75.0	Diabase - med. grained dense ditto		
75.0	99.5	Aplite altered - no defined fracture at either end. - at 101.5 - longitudinal fracture 3", with thin seam calcite		
99.5	102.0	well min. along fracture Fe S ₂ + some Cu Fe S ₂ . fracturing cut 45°		
102.0	131.0	Diabase med grained. dense coarse		
131.0	135.	Diabase - varied texture - fairly coarse longitudinal fracture		
135.	153.0	Diabase - med. grained - dense. - at 142' longitudinal fracture 8" in fracture thin seam Calcite. - fair dev.		
153.0	153.5	Diabase - sheared. thin seam calcite - green cut 5°		
153.5	169.0	Diabase - medium grained - dense		

DIAMOND DRILL LOG

Continued

D. D. HOLE NO. 5PROPERTY ChippPAGE 2

LOCATION _____

COLLAR: LAT. _____

DEP. _____

ELEV. _____

BEARING _____

DIP _____

DEPTH OF HOLE _____

STARTED _____

COMPLETED _____

DRILLED BY _____

FROM	TO	DESCRIPTION	SAMPLE NO.	CORE FT.
169.0	169.4	Diabase - sheared. thin seam calcite green		Cut 20'
169.4	217.0	Diabase - med. grained. - dense		
217.0	224.0	Diabase - varied texture - pink feldspar		
224.0	269.0	Diabase - med. grained. dense		
269.0	269.2	Diabase - epitomized - dense.		
269.2	304.0	Diabase - med grained - dense		



DIAMOND DRILL LOG

PROPERTY Chipp-Windy-Hill Mining CorpD. D. HOLE NO. 6PAGE 1LOCATION Claim T-43970 - SW 1/4 N 1/2 L01 CON2 Cane Twp

COLLAR: LAT. _____

DEP. _____

ELEV. _____

BEARING S 45 WDIP 45°DEPTH OF HOLE 385STARTED Oct. 14th. 1959COMPLETED Oct 18th. 1959DRILLED BY Universal D.D. Co LtdPort Credit, Ont.

FROM	TO	DESCRIPTION	SAMPLE NO.	CORE FT.
0	21.0	CASING		
21.0	21.2	Quartzite		
21.2	36.5	Diabase (Nipissing) 1st 4 ft. fine grained basal med. grained.		
36.5	36.6	Calcite + schistified diabase. sprinkling Fe S ₂		
36.6	102.0	Diabase. med. grained - dense - at 53' & 58' fractured along fractures thin films Hematite cut 20°		
102.0	103.0	Diabase - schistified - no min - no chlorite		
103.0	118.5	Diabase - med. grained - dense		
118.5	123.0	Quartzite fill slight min cufe s ₂		
123.0	150.0	Diabase - varied texture, fairly coarse - dense - feldspar pale green & pale pink.		
150.0	225	Diabase - varied texture - 175' to 175' 4 longitudinal, fracture thin seam calcite greenish		
225	268	Diabase - varied texture med. to coarse - pale green & pink feldspar at 238 longitudinal fracture		
268	268.1	Quartz - pink cut 45°		
268.1	273.0	Diabase. med to coarse - pale green & pink feldspar		

DIAMOND DRILL LOG

Continuation

D. D. HOLE NO. 6

PROPERTY _____

PAGE 2

LOCATION _____

COLLAR: LAT. _____

DEP. _____

ELEV. _____

BEARING _____

DIP _____

DEPTH OF HOLE _____

STARTED _____

COMPLETED _____

DRILLED BY _____

FROM	TO	DESCRIPTION	SAMPLE NO.	CORE FT.
273.0	273.2	Diabase coarse pink feldspar, impregnated Hematite		
273.2	300.0	Diabase med. impregnated epidote throughout.		
300.0	325.0	Diabase varied texture, med to coarse-dense, mostly green feldspar at 308 reddish feldspar. at 322.5 band epidote Cut normal		
325	335.5	Diabase - med, dense		
335.5	335.6	Calcite + altered diabase, some Hematite - cut 45°		
335.6	385.0	Diabase, med grained dense - pale greenish feldspar. <u>FINIS</u>		

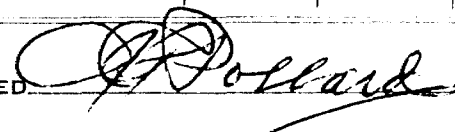

N (MS)

CANE TWP
Claim T 43523
NE 1/4 N 1/2 Lot 1
CON 2

T 43522



500'

CANE TWP
Claim T 43970
S.W. 1/4 N 1/2 Lot 1
CON 2

450'

T 43969

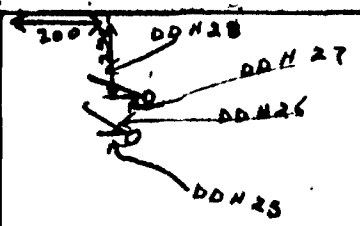

200'

DDH 25

JUNE 17, 1960
Scale 1" = 50'
DRAWN BY J. B. POLLARD

DIAMOND DRILL LOG

PROPERTY Windy Hill Mining Corp Ltd
W.B. Chipp

D. D. HOLE NO. 25
 PAGE 1

LOCATION CANE Twp Claim T 43970

COLLAR: LAT. _____

DEP. _____

ELEV. _____

BEARING S 80 W

DIP 45 deg

DEPTH OF HOLE 36

STARTED JUNE 3, 1960

COMPLETED JUNE 3 1960

DRILLED BY Cleutley Bros
N. Cabolt. Ont.

FROM	TO	DESCRIPTION	SAMPLE NO.	CORE FT.
0	28.0	Diabase (Nipissing) alternate fine & medium dense		
28.0	29.2	Aplite - altered. weathered mostly pitted.		
29.2	36.0	Diabase - alternate medium & coarse Gray Felspar - dense		

June 17/60 SIGNED R. Pollard

DIAMOND DRILL LOG

PROPERTY

Windy Hill Mining Corp Ltd.
W.G. Chapp

D. D. HOLE NO. 26

PAGE 1

LOCATION

CANE Twp. Claim T 43970

COLLAR: LAT.

SW 1/4 N 1/2 Lot 1 Cont 2

DEP.

ELEV.

BEARING

DIP

N 58 W.

35 deg

DEPTH OF HOLE

STARTED

COMPLETED

DRILLED BY

May 27th 1960

FROM	TO	DESCRIPTION	SAMPLE NO.	CORE FT.
0	16.8	Diabase (Nipissing) medium grained - dense		
16.8	17.5	Aplite + Calcite - narrow stringers - cut obliquely -		
17.5	35.0	Diabase - medium grained dense		
35.0	36.7	aplite - dense isolated min Ca fcs a few flakes Ag		
36.7	37.4	Diabase - altered siliceous impregnated epidote		
37.4	93.8	Diabase - medium grained - dense		
93.8	93.9	aplite - decomposed or pitted - no mineral		
93.9	105.0	Diabase - medium grained.		
105.0	106.0	Diabase - coarse - Gray Felspar.		

SIGNED

June 15/60

R. Pollard

DIAMOND DRILL LOG

PROPERTY Windy Hill Mining Corp Ltd.
W.C. Chipp.D. D. HOLE NO. 27PAGE 1LOCATION CANE Twp Claim T43970

COLLAR: LAT. _____

DEP. _____

ELEV. _____

BEARING S 49. WDIP 4.5 degDEPTH OF HOLE 49.0 ft.STARTED JUNE 9, 1960COMPLETED JUNE 9, 1960DRILLED BY Cloutier Bros.
N. Cobalt, Ont.

FROM	TO	DESCRIPTION	SAMPLE NO.	CORE FT.
0	2.5	Casing		
2.5	36.5	Diabase (Dipissing) medium grained few fractures		
36.5	37.5	Diabase sheared very little chlorite		
37.5	49.0	Diabase medium grained gray Felspar - dense		

JUNE 17/60 SIGNED

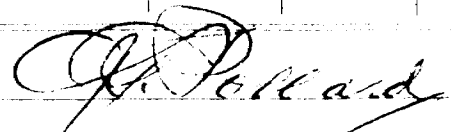

DIAMOND DRILL LOG

D. D. HOLE NO. 28

PROPERTY _____

PAGE 1LOCATION CANE Twp. Claim T93970COLLAR: LAT. SW 1/4 N 1/2 Lot 1 Con 2.

DEP. _____

ELEV. _____

BEARING W "0"DIP 35 degDEPTH OF HOLE 111.0 ft.STARTED May 31st 1960COMPLETED June 2nd 1960DRILLED BY Cloutier Bros
N. Cobalt, Ont.

FROM	TO	DESCRIPTION	SAMPLE NO.	CORE FT.
0	2.0	CASING		
2.0	42.0	Diabase (Nipissing) medium grained. stress plane fracture		
42.0	44.5	Diabase - longitudinal fracturing slight dev. chlorite		
44.5	59.7	Diabase - medium grained - dense		
59.7	60.0	Apl. to & Schisted Diabase - No mineral		
60.0	93.5	Diabase - medium grained - dense		
93.5	100.0	Diabase - coarse grained - Gray Felspar		
100.0	111.0	Diabase - medium grained - dense		

JUNE 15/60

SIGNED

J. A. Pollard