



41P10NE0708 14 LAWSON

010

LAWSON TOWNSHIP REPORT #14

This file contains work performed by Wm. Pollack & Son Ltd.
on claim:

L.213037

Hole #1;

Sept. 13, 1970

(1)

(1) # 163/70

Sept. 15, 1976

DIAMOND DRILLING Sept. 10, 11, 12

DRILL OPERATORS Reg Lawrence Tomstown
(Con 6th Ingram twp)
Ed Briscoe 5th ave
Englehart Ont
John Pollock Englehart Ont (Sept 12, 13)

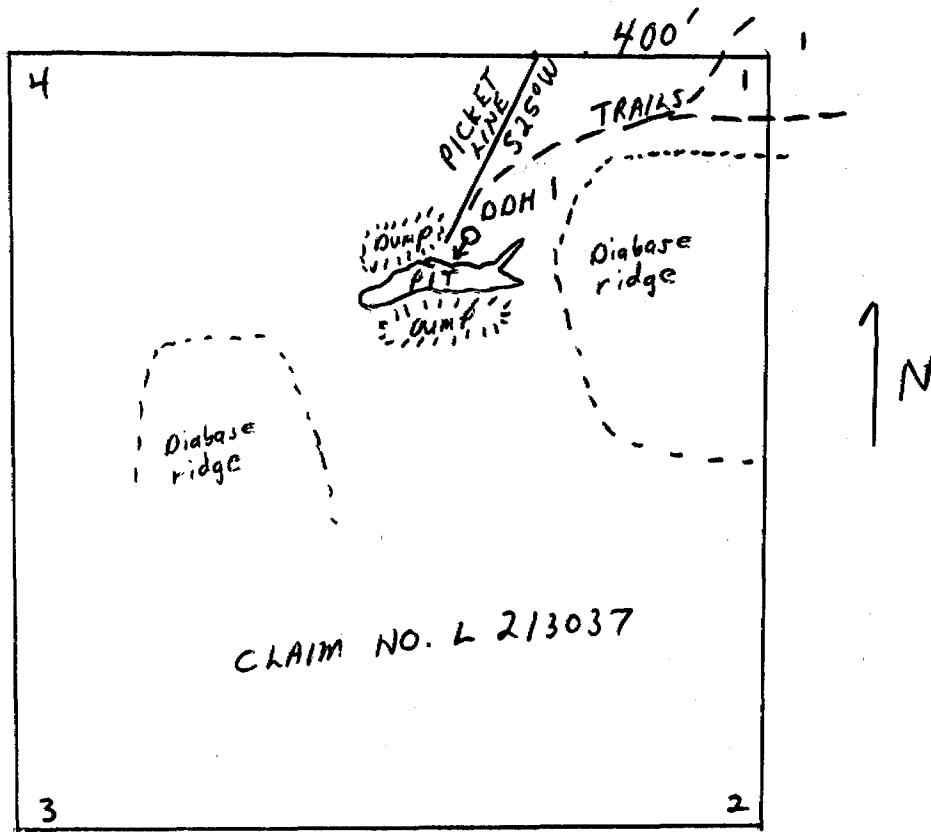

Scale 1" = 330'



THE MINING ACT - DEPARTMENT OF MINES
DIAMOND DRILLING LOG

Start a new page for every new hole, but fill in top portion of form only on first page for each hole.

FILL IN ON EVERY PAGE

HOLE NO. **072** PAGE NO. **one**

DRILLING COMPANY None		COLLAR ELEVATION	BEARING OF HOLE FROM TRUE NORTH	TOTAL FOOTAGE 70'	DIP OF HOLE AT collar 60°	LOCATION OF HOLE IN RELATION TO A FIXED POINT ON THE CLAIM West 400' of #1 Post on claim line then South 25°W for 350' on Picket line	MAP REFERENCE NO. M 213	CLAIM NO. 2213037
DATE HOLE STARTED Sept 10, 1970	DATE COMPLETED Sept. 13 1970	DATE LOGGED Sept 13, 14	LOGGED BY John Pollock		ft	PROPERTY NAME Eby or Scott Barite claim	LOCATION (Tp., Lot, Con. OR Lat. and Long.) LAWSON TWP	
EXPLORATION CO., OWNER OR OPTIONEE Wm. Pollock & Son Ltd Englehart Ont		DATE SUBMITTED Sept. 15, 1970	SUBMITTED BY (Signature) John Pollock		ft			
					ft			

FOOTAGE		ROCK TYPE	DESCRIPTION Colour, grain size, texture, minerals, alteration, etc.	PLANAR FEATURE ANGLE *	CORE SPECIMEN FOOTAGE +	YOUR SAMPLE NUMBER	SAMPLE FOOTAGE		SAMPLE LENGTH	ASSAYS +		
FROM	TO						FROM	TO		cu	ba	ag
0	5	nipissing diabase	dark greyish colour with red grains, medium grained									
5.5	5.8	" "	aplite stringers 1/8" in width in typical diabase matrix	45°		1	5.4	5.8	4"			
5.8	8.0	" "										
8.0	10.0	nipissing diabase	contains black disseminated sulphides rock is brittle									
10.0	12.6	" "										
12.6	14.5	nipissing diabase	disseminated sulphides, pyrite present, rock is black & brittle									
14.5	25.0	nipissing diabase	dark greyish colour with red grains possibly granophyre									
25.0	27.0	altered diabase	dark green, fine grained, blebs of a white mineral, pyrite present		1.	2	25.0	25.4	4"			
27.0	30.0	nipissing diabase										
30.0	32.4	" diabase	fine threads of aplite, pyrite present in small quantities									
32.4	35.3	altered diabase	black rock, pyrite conspicuous, calcopyrite in small blebs									
35.3	40.4	altered "	black rock, calcite, quartz, present, calcopyrite and pyrite									
40.4	41.0	aplite	aplite in a coarse mixture with barite predominating, calcopyrite									
41.0	42.3	barite	white crystalline barite, no impurities, iridescence on crystal faces			3	42.0	42.2	2"			
42.3	43.3	barite	core lost due to grinding									
43.3	43.6	barite	small pieces of core recovered									
43.6	45.0	aplite	rock is green due to presence of aplite; barite and calcopyrite, pyrite									
45.0	47.2	diabase										
47.2	50.2	altered diabase	dark green, fine grained, considerable calcopyrite, barite blebs			4	47.2	50.2	3'			
50.2	55.0	diabase	somewhat coarser than material previous encountered									
55.0	60.0	diabase	aplite stringers present 1/16" inch wide, white mineral present									
60.0	70.0	diabase	same as beginning of hole except colour lighter grey		2.	5	60.0	60.3	3"			

* For features such as foliation, bedding, schistosity, measured from the long axis of the core.

+ Additional credit available. See Assessment Work Regulations.



41P10NE070B 14 LAWSON

300

Separate form is required for each type of work to be recorded.

ONTARIO

THE MINING ACT REPORT OF WORK

To the Recorder of HARDER LAKE Mining Division
I, JOHN POLLOCK K17508
name of Recorded Holder Miner's Licence
BOX 250 ENGLEHART ONT

do hereby report the performance of 17 1/2 + 2 day days of DIAMOND DRILLING
for core specimens type of work
not before reported to be applied on the following contiguous claims

Claim No.	Days	Claim No.	Days	Claim No.	Days
L213037	17 1/2 + 2 = 19 1/2				

All the work was performed on Mining Claim (s) L 213037 Lawson Twp
(In the case of geological and/or geophysical survey (s) where more than 18 claims are involved attach a schedule)

READ CAREFULLY: THE FOLLOWING INFORMATION IS REQUIRED BY THE MINING RECORDER.

- For Manual Work, Stripping or Opening up of Mines, Sinking Shafts or Other Actual Mining Operations - Names and addresses of the men who performed the work and the dates and hours of their employment.
- For Diamond and other Core Drilling - Footage, No. and angle of holes and diameter of core. Name and address of owner or operator of drill. Dates when drilling was done. Signed core log and sketch in duplicate.
- For Compressed Air or Other Power Driven or Mechanical Equipment
Type of drill or equipment. Names and addresses of men engaged in operating equipment and the dates and hours of their employment.
- For Power Stripping - Type of equipment. Name and address of owner or operator. Amount expended. Dates on which work was done. Proof of actual cost must be submitted within 30 days of recording.
- With each of the above types of work sketches are required to show the location and extent of the work in relation to the nearest claim post. In the case of diamond or other core drilling the sketch must be submitted in duplicate.
- For Geological and Geophysical Survey - The names and addresses of men employed as well as dates. Type of instrument used in the case of geophysical survey. Reports and maps in duplicate must be filed with the Minister within 60 days of recording.
- For Land Survey - the name and address of Ontario Land surveyor.

The Required Information is as Follows: (Attach a list if this space is insufficient)

Drilling done Sept 10, 11, 12 + 14, 1970
70' of 7/8 core drilled at a 60° angle
with a Packback Diamond Drill serial # 8674
owned by Wm. Pollock & Son Ltd 1st Street
Englehart Ont. DRILL OPERATORS: Reg F. Lawrence, 6th Con
Ingram TWP
Ed BRISCOE Englehart Ont
Date Sept. 15 1970
John Pollock
Signature of Recorded Holder or Agent

The Mining Act
Certificate Verifying Report of Work
I, JOHN W POLLOCK
BOX 250 ENGLEHART ONT
(Post Office Address)

hereby certify:
1. That I have a personal and intimate knowledge of the facts set forth in the report of work annexed here-
to, having performed the work or witnessed same during and/or after its completion.
2. That the annexed report is true.
Dated Sept 15 1970
John Pollock
Signature

RECORDED - SEP 15 1970
REC. No.

THE PENALTY FOR MAKING A FALSE STATEMENT IN THIS REPORT AND/OR CERTIFICATE IS \$500. OR SIX MONTHS IMPRISONMENT OR BOTH