



Larry Bowen
R.R. # 2
Thornloe, Ontario
POJ 1S0

TECHNICAL REPORT

Haultain Township # 1214012
TRAIL CUTTING

Saturday, February 6, 1999

- Larry and Walter went in on snowmachines to cut trail to access Claims
- 8 hours x 2 men x \$150.00 per man = \$ 300.00 (16 hours)
- 2 snowmachines x \$100.00 each = \$200.00
- Truck 175 km. x \$0.30 per km. = \$52.50

Saturday, February 20, 1999

- Larry, Frank and Walter went in on snowmachines to cut trail to access claim.
- 8 hours x 3 men x \$150.00 per man = \$450.00 (24 hours)
- Truck 175 km. x \$0.30 per km. = \$52.50

Monday, April 5, 1999

- Larry took plugger into claims
- Cut trail to access claims
- 8 hours x 1 man x \$150.00 = \$150.00 (8 hours)
- 1 snowmachine x \$100.00 = \$100.00
- Truck 175 km. x \$0.30 per km. = \$52.50

RECEIVED
SEP 21 1999
GEOSCIENCE ASSESSMENT
OFFICE

PROVINCIAL RECORDING
OFFICE - SUDBURY
RECEIVED
SEP 21 1999
A.M. 11:05 P.M.
7 8 9 10 11 12 1 2 3 4 5 6

PROSPECTING

Sunday, May 16, 1999

2 19704

- Larry went into claims on a property visit. Did prospecting. In the center of mining claims he found an old pit. On the South showing, approximately 400 feet SW, he found another showing.
- 8 hours x 1 man x \$150.00 = \$150.00 (8 hours)
- 1 boat rental x \$45.00 = \$45.00
- Truck x 175 km. x \$0.30 per km. = \$52.50
- 1 ATV and Trailer x \$65.00 = \$65.00

Saturday, September 18, 1999

- Larry went into claims to do prospecting lines -- base line West 0+00W to 0+800W, 0+025N to 0+800N and 0+025N to 0+400N.
- 1 man x \$150.00 = \$150.00 (8 hours)
- Truck x 175 km. x \$0.30 per km. = \$52.50
- 1 ATV and Trailer x \$65.00 = \$65.00
- 1 Boat and motor x \$ 45.00 = \$45.00

MOBILIZING CAMP

Saturday, May 29, 1999

- Larry and Davey took equipment into claims to start camp set up.
- 8 hours x 2 men x \$150.00 = \$300.00 (16 hours)
- 1 boat x \$45.00 = \$45.00
- 1 ATV and Trailer \$65.00 = \$65.00
- Truck x 175 km. x \$0.30 per km. = \$52.50

Sunday, June 6, 1999

- Larry, Davey and Denis took more equipment into the camp.
- 8 hours x 3 men x \$150.00 = \$450.00 (24 hours)
- 1 boat x \$45.00 = \$45.00
- 1 ATV and Trailer x \$65.00 = \$65.00
- Truck x 175 km. x \$0.30 per km. = \$52.50

Monday, June 21, 1999

- Larry, Davey and Denis took supplies and equipment into camp. Ready to start line cutting on Tuesday morning.
- 8 hours x 3 men x \$150.00 = \$450.00 (24 hours)
- 1 boat and motor x \$45.00 = \$45.00
- 1 ATV and Trailer x \$65.00 = \$65.00
- Truck x 175 km. x \$0.30 per km. = \$52.50

LINE CUTTING

Tuesday, June 22, 1999 – Friday, June 25, 1999

- 8 hours x 4 days x 2 men = 64 hours (Breakdown as follows:
- \$275.00 per man for the 4 days = \$550.00)
- 1 boat and motor x \$45.00 = \$45.00
- 1 ATV and Trailer x \$65.00 = \$65.00
- Truck x 175 km. x \$0.30 per km. = \$52.50

EQUIPMENT COST

Snowmachine:

- 5 days x 5 snowmachines x \$100.00 = \$500.00 (5 days x 8 hours = 40 hours)

Boat and Motor:

-6 days x 6 uses of boat and motor x \$45.00 = \$270.00 (6 days x 4 hours = 24 hrs./day)

ATV and Trailer:

- 6 days x 6 uses of ATV and Trailer = \$390.00 (6 days x 4 = 24 hrs. x \$65.00/day)

Date: Sept 18/99

Signature: Bowen

Witness: Kay Klerve

PROSPECTING

- Line 0+025N Gravel
- Line 0+050N Gravel
- Line 0+075N Gravel
- Line 0+100N Gravel
- Line 0+125N Swamp (cider)
- Line 0+150N Swamp
- Line 0+175N Swamp
- Line 0+200N Swamp
- Line 0+225N Swamp and Creek
- Line 0+250N Swamp
- Line 0+275N Swamp
- Line 0+300N Swamp
- Line 0+325N Outcrop (Diabase Medium Texture)
- Line 0+350N Outcrop (Diabase Medium Texture)
- Line 0+375N Outcrop (Diabase Medium Texture)
- Line 0+400N Outcrop (Diabase Medium Texture)
- Line 0+425N Outcrop (Diabase Medium Texture)
- Line 0+450N Swamp
- Line 0+475N Swamp
- Line 0+500N Swamp
- Line 0+525N Swamp
- Line 0+550N Outcrop (Diabase Medium Texture Fracture)
- Line 0+575N Outcrop (Diabase Medium Texture Fracture)
- Line 0+600N Outcrop (Diabase Medium Texture)
- Line 0+625N Outcrop (Diabase Medium Texture)
- Line 0+650N Outcrop (Diabase Medium Texture)
- Line 0+675N Outcrop (Diabase Medium Texture)
- Line 0+700N Outcrop (Diabase Medium Texture)
- Line 0+725N Outcrop (Diabase Medium Texture)
- Line 0+750N Outcrop (Diabase Medium Texture)
- Line 0+775N Outcrop (Diabase Medium Course Texture)
- Line 0+800N Outcrop (Diabase Medium Course Texture)

- B.L 0+00W Gravel
- B.L 0+25W Gravel
- B.L 0+50W Gravel
- B.L 0+75W Gravel
- B.L 0+100W Gravel
- B.L 0+125W Gravel
- B.L 0+150W Swamp
- B.L 0+175W Swamp
- B.L 0+200W Swamp
- B.L 0+225W Swamp
- B.L 0+250W Swamp
- B.L 0+275W Swamp
- B.L 0+300W Swamp
- B.L 0+325W Swamp
- B.L 0+350W Swamp
- B.L 0+375W Swamp
- B.L 0+400W Outcrop (Diabase medium texture and till)
- B.L 0+425W Outcrop (Diabase medium texture and till)
- B.L 0+450W Outcrop (Diabase medium texture and till)
- B.L 0+475W Outcrop (Diabase medium texture and till)
- B.L 0+500W Outcrop (Diabase medium texture and till)
- B.L 0+525W Outcrop (Diabase medium texture and till)
- B.L 0+550W Outcrop (Diabase medium texture and till)
- B.L 0+575W Outcrop (Diabase medium texture and till)
- B.L 0+600W Outcrop (Diabase medium texture and till)
- B.L 0+625W Outcrop (Diabase medium texture and till)
- B.L 0+650W Outcrop (Diabase medium texture and till)
- B.L 0+675W Outcrop (Diabase medium texture and till)
- B.L 0+700W Outcrop (Diabase medium texture and till)
- B.L 0+725W Outcrop (Diabase medium texture and till)
- B.L 0+750W Outcrop (Diabase medium texture and till)
- B.L 0+775W Outcrop (Diabase medium texture and till)
- B.L 0+800W Outcrop (Diabase medium texture and till)

- Line 2W 0+025 N Gravel
- Line 2W 0+050N Gravel
- Line 2W 0+075N Gravel
- Line 2W 0+100N Gravel
- Line 2W 0+125N Gravel
- Line 2W 0+150N Outcrop Diabase
- Line 2W 0+175N Outcrop Diabase
- Line 2W 0+200N Outcrop Diabase
- Line 2W 0+225N Outcrop Diabase
- Line 2W 0+250N Gravel
- Line 2W 0+275N Gravel
- Line 2W 0+300N Gravel
- Line 2W 0+325N Swamp
- Line 2W 0+350N Swamp
- Line 2W 0+375N Pond
- Line 2W 0+400N Swamp
-

2.19704

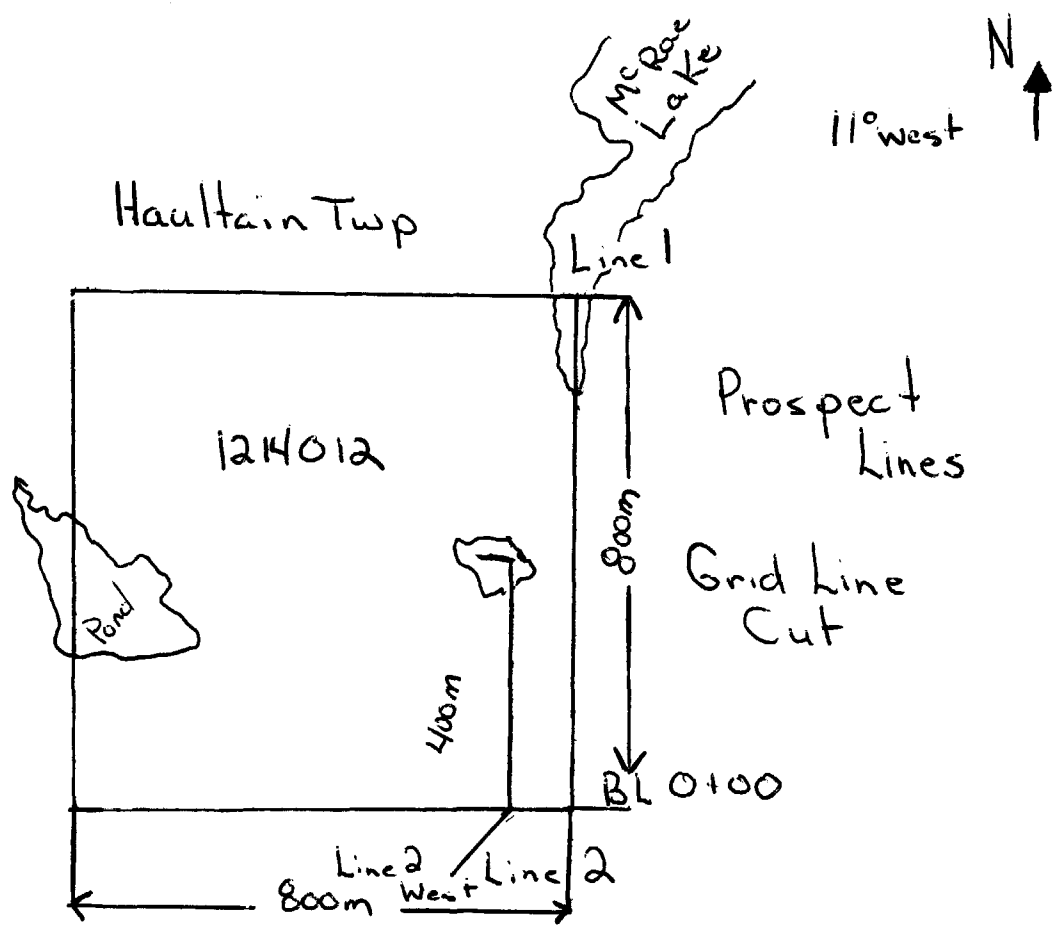

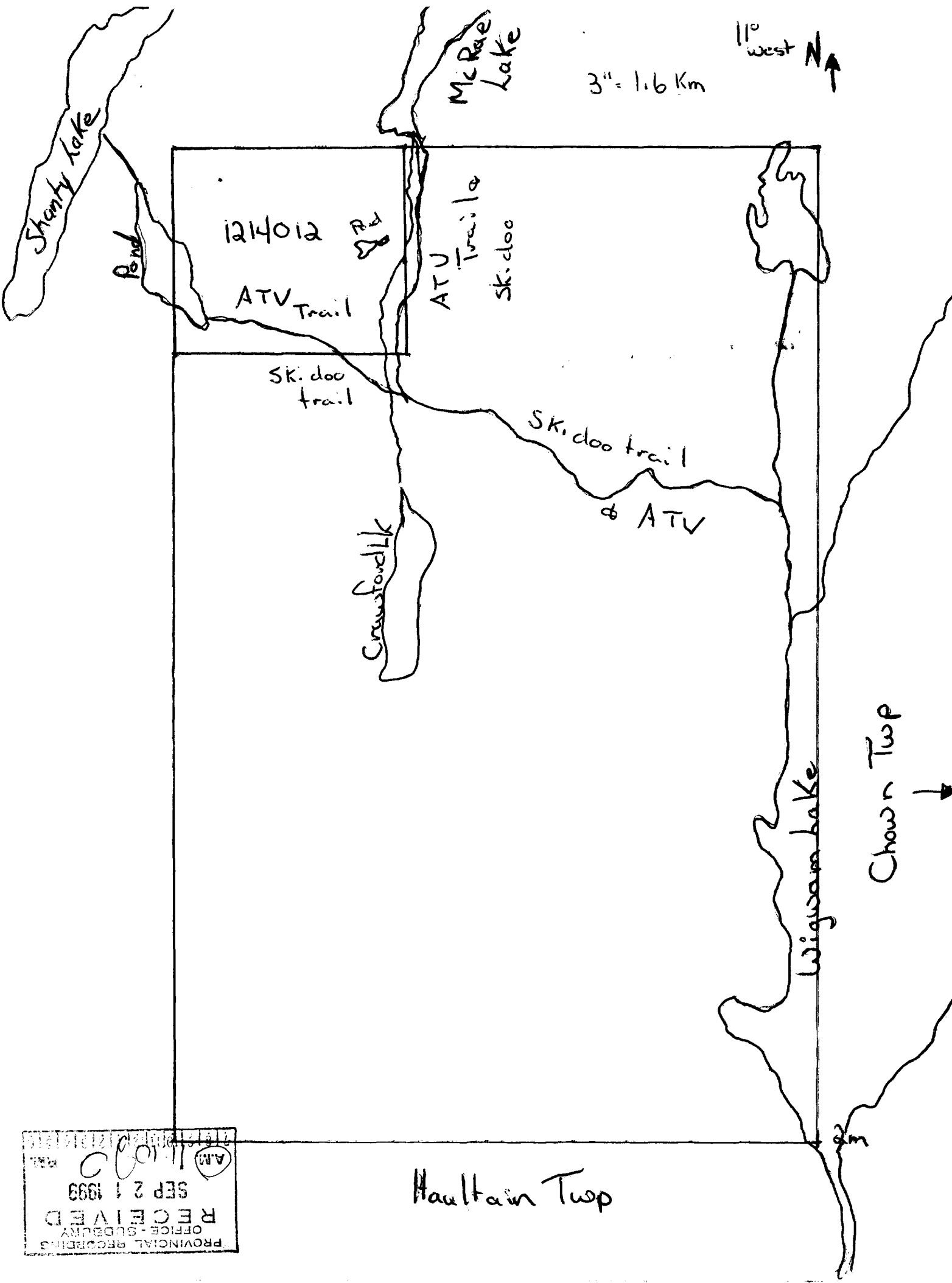

PROVINCIAL RECORDS
 OFFICE - SUDBURY
 RECEIVED
 SEP 21 1998
 AM
 11:00

Legend: Scale = 1:5,000

Swamp Sp

Gravel Till & Sand - GR

Forest Ft

Outcrop Oc - diabase, medium grain

Pits & Trenches

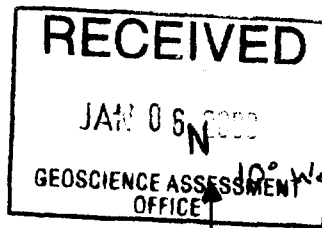

Old camp

Line #1
O+800N

Mc Rae Lake

*4 post

#1 post

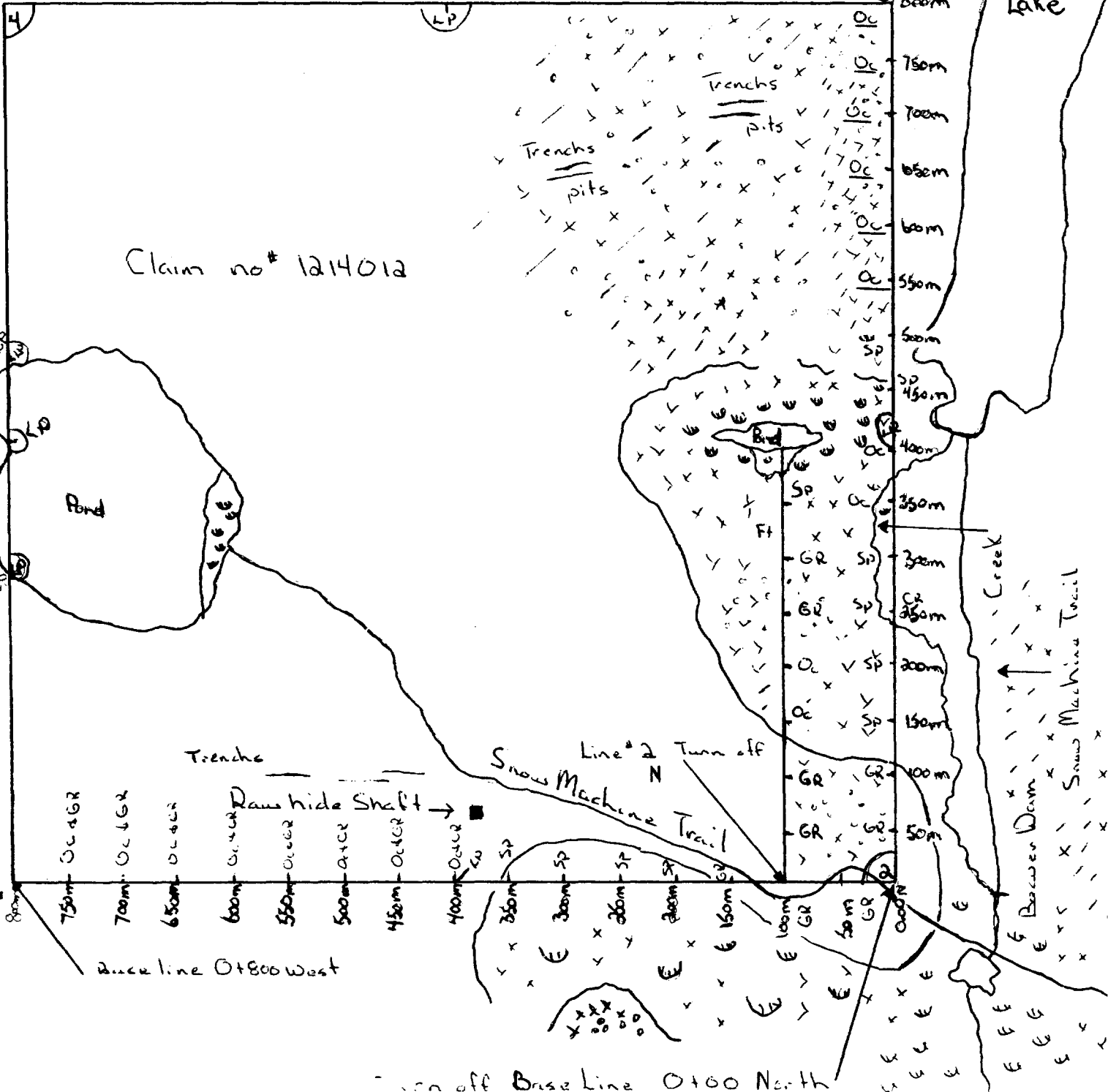

Claim no # 1214012

Pond

Trenches

Line #2 Turn off
Snow Machine Trail

Raw hide Shaft

Creek

Bowser Dam
Snow Machine Trail

Line #1 O+800 West

Turn off Base Line O+100 North

26#

800m

750m

700m

650m

600m

550m

500m

450m

400m

350m

300m

260m

200m

150m

100m

50m

0+00N

800m

750m

700m

650m

600m

550m

500m

450m

400m

350m

300m

250m

200m

150m

100m

800m

750m

700m

650m

600m

550m

500m









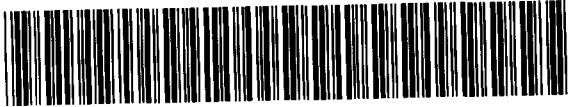

41P10NE2006 2.19704 HAULTAIN 900

Subsection 65(2) and 66(3) of the Mining Act. Under section 8 of the Mining Act, assessment work and correspond with the mining land holder. Questions about the Mining Act, Subsection 65(2) and 66(3), R.S.O. 1990, should be directed to the Ministry of Northern Development and Mines, 3rd Floor, 933 Ramsey Lake Road, Sudb

Instructions: - For work performed on Crown Lands before recording a claim, use form 0240.
- Please type or print in ink.

2.19704

1. Recorded holder(s) (Attach a list if necessary)

Name <u>Mr. LARRY Bowen</u>	Client Number <u>301406</u>
Address <u>RR# 2</u>	Telephone Number
<u>Thornloe, Ontario, POJ-150</u>	Fax Number
Name	Client Number
Address	Telephone Number
	Fax Number

2. Type of work performed: Check (✓) and report on only ONE of the following groups for this declaration.

Geotechnical: prospecting, surveys, assays and work under section 18 (regs)	Physical: drilling stripping, trenching and associated assays	Rehabilitation
Work Type <u>Prospecting</u> <u>Trail Cutting</u> <u>Line Cutting</u>	<u>Photo's</u> <u>Enclosed</u>	Office Use
Dates Work Performed From <u>6</u> Day <u>02</u> Month <u>99</u> Year To <u>18</u> Day <u>09</u> Month <u>99</u> Year		Commodity
Global Positioning System Data (if available)	Township/Area <u>Haultain</u>	Total \$ Value of Work Claimed <u>4808</u>
	M or G-Plan Number	NTS Reference
		Mining Division <u>Larder Lake</u>
		Resident Geologist District <u>Kickland Lake</u>

Please remember to: - obtain a work permit from the Ministry of Natural Resources as required;
- provide proper notice to surface rights holders before starting work;
- complete and attach a Statement of Costs, form 0212;
- provide a map showing contiguous mining lands that are linked for assigning work;
- include two copies of your technical report.

3. Person or companies who prepared the technical report (Attach a list if necessary)

Name <u>LARRY Bowen</u>	Telephone Number <u>647-8668</u>
Address <u>Thornloe RR#2</u>	Fax Number
Name	Telephone Number
Address	Fax Number
Name <u>LARRY Bowen</u>	Telephone Number <u>647-8668</u>
Address <u>Thornloe RR#2</u>	Fax Number

RECEIVED
LARDER LAKE
MINING DIVISION
SEP 20 1999

RECEIVED
SEP 21 1999
GEOSCIENCE ASSESSMENT OFFICE

4. Certification by Recorded Holder or Agent

I, LARRY Bowen (Print Name), do hereby certify that I have personal knowledge of the facts set forth in this Declaration of Assessment Work having caused the work to be performed or witnessed the same during or after its completion and, to the best of my knowledge, the annexed report is true.

Signature of Recorded Holder or Agent <u>LARRY Bowen</u>	Date <u>Sept 18/99</u>
Agent's Address <u>RR#2 Thornloe Ont, POJ-150</u>	Telephone Number <u>705-647-8668</u>
	Fax Number

Deemed December 19/1999

PROVINCIAL RECORDING OFFICE - SUDBURY
RECEIVED
SEP 21 1999
A.M. 11:10 P.M.
718 919 0011 718 915 16

Personal information collected on this form is obtained under the authority of subsection 6 (1) of the Assessment Work Regulation 6/96. Under section 8 of the Mining Act, this information is a public record. This information will be used to review the assessment work and correspond with the mining land holder. Questions about this collection should be directed to a Provincial Mining Recorder, Ministry of Northern Development and Mines, 3rd Floor, 933 Ramsey Lake Road, Sudbury, Ontario, P3E 6B5.

2-19704

Work Type	Units of work Depending on the type of work, list the number of hours/day worked, metres of drilling, kilometres of grid line, number of samples, etc.	Cost Per Unit of work	Total Cost
Trail Cutting	③ Days x ② men x \$150.00 ② hours per day x ⑥ men	48 hours	\$ 900.00
Line Cutting	④ Days x ② men ② Km x \$275.00 per km ⑧ hours x ② men x ④ days	64 hours	\$ 550.00
Prospecting	② Days x ② men x \$150.00 ⑧ hours x ① man x ② days	16 hours	\$ 300.00
Associated Costs (e.g. supplies, mobilization and demobilization).			
Mobilizing Camp	⑧ men x \$150.00 ③ days x ⑧ hours per man	64 hours	\$ 1200.00
- Equipment Cost (Repart Encland)			\$ 1160.00
Transportation Costs			
⑨ trips to Aultain x 175 Km per trip with truck	1575 Km x .30¢		\$ 472.50
Food and Lodging Costs			
Food.			\$ 225.00

RECEIVED
LARDER LAKE
MINING DIVISION

Total Value of Assessment Work \$4807.50

SEP 20 1999
10:03 AM

Calculations of Filing Discounts:

1. Work filed within two years of performance is claimed at 100% of the above Total Value of Assessment Work.
2. If work is filed after two years and up to five years after performance, it can only be claimed at 50% of the Total Value of Assessment Work. If this situation applies to your claims, use the calculation below:

TOTAL VALUE OF ASSESSMENT WORK x 0.50 = Total \$ value of worked claimed.

Note:
- Work older than 5 years is not eligible for credit.
- A recorded holder may be required to verify expenditures claimed in this statement of costs within 30 days of a request for verification and/or correction/clarification. If verification and/or correction/clarification is not made, the Minister may reject all or part of the assessment work submitted.

RECEIVED
SEP 21 1999
GEOSCIENCE ASSESSMENT
OFFICE

Certification verifying costs:

I, Larry Bowen (please print full name), do hereby certify, that the amounts shown are as accurate as may reasonably be determined and the costs were incurred while conducting assessment work on the lands indicated on the accompanying Declaration of Work form as Larry Bowen (recorded holder, agent, or state company, position with signing authority) I am authorized to make this certification.

Signature: Larry Bowen Date: Sept 18/99

Geoscience Assessment Office
933 Ramsey Lake Road
6th Floor
Sudbury, Ontario
P3E 6B5

Telephone: (888) 415-9845
Fax: (877) 670-1555

January 11, 2000

LARRY NELSON BOWEN
LOT 8, CON 1 HILLIARD R.R. #2
THORNLOE, ONTARIO
P0J-1S0

Visit our website at:
www.gov.on.ca/MNDM/MINES/LANDS/mlsmnpge.htm

Dear Sir or Madam:

Submission Number: 2.19704

Status

Subject: Transaction Number(s): W9980.00501 Approval After Notice

We have reviewed your Assessment Work submission with the above noted Transaction Number(s). The attached summary page(s) indicate the results of the review. **WE RECOMMEND YOU READ THIS SUMMARY FOR THE DETAILS PERTAINING TO YOUR ASSESSMENT WORK.**

If the status for a transaction is a 45 Day Notice, the summary will outline the reasons for the notice, and any steps you can take to remedy deficiencies. The 90-day deemed approval provision, subsection 6(7) of the Assessment Work Regulation, will no longer be in effect for assessment work which has received a 45 Day Notice. Allowable changes to your credit distribution can be made by contacting the Geoscience Assessment Office within this 45 Day period, otherwise assessment credit will be cut back and distributed as outlined in Section #6 of the Declaration of Assessment work form.

Please note any revisions must be submitted in **DUPLICATE** to the Geoscience Assessment Office, by the response date on the summary.

If you have any questions regarding this correspondence, please contact LUCILLE JEROME by e-mail at lucille.jerome@ndm.gov.on.ca or by telephone at (705) 670-5858.

Yours sincerely,



ORIGINAL SIGNED BY
Blair Kite
Supervisor, Geoscience Assessment Office
Mining Lands Section

Work Report Assessment Results

Submission Number: 2.19704

Date Correspondence Sent: January 11, 2000

Assessor: LUCILLE JEROME

Transaction Number	First Claim Number	Township(s) / Area(s)	Status	Approval Date
W9980.00501	1214012	HAULTAIN	Approval After Notice	January 10, 2000

Section:

9 Prospecting PROSP

The revisions outlined in the Notice dated November 25, 1999, have been addressed. Assessment work credit has been approved as outlined on the Declaration of Assessment Work Form that accompanied this submission.

Correspondence to:

Resident Geologist
Kirkland Lake, ON

Recorded Holder(s) and/or Agent(s):

LARRY NELSON BOWEN
THORNLOE, ONTARIO

Assessment Files Library
Sudbury, ON
