



41P10SE0601 2.1271 CHARTERS

010

Diamond Drill Hole Logs
and Sections

Charters, Twp.

1973

DIAMOND DRILL RECORD

PROPERTY CHARTERS-DONOVAN-LEITH TOWNSHIPS HOLE NO. 3-10

Sheet Number 1 Section From To Started Sept. 19/1972
 Latitude 2686.5 Datum Completed Sept. 20/1972
 Departure 4167.0 Bearing N36-33W (Azimuth 323-27) Ultimate Depth 107.5'
 Elevation 87.0 Dip -45° Proposed Depth 95.0'

88.1271

DEPTH FEET	FORMATION	Sample No.	From	To	Width	Assays Ag. Oz./T
0-10.0'	Casing					
10.0'-107.5'	Reddish coarse diabase (Gabro type) hard & solid - Not Presiding					
11.8'	1/4" dark material in solid diabase @ 50° Sparse mineralization Several rusty slips in section " "	104	11.0'	12.0'	1.0'	0.1
12.8'-12.9'	Dark slips with some min. Fe? in finer grained diabase	105	12.7'	13.3'	0.6'	0.4
14.2'-15.5'	Dark rusty slips @ 50° in fairly dark diabase Some min.	106	14.0'	14.7'	0.7'	0.1
21.0'	Rusty slips, broken up core, some mineralization					
19.5'-19.8'	Dark slips @ 50° Some min. Grey diabase	107	19.4'	20.1'	0.7'	0.2
<u>NOTE:</u>	Lost H ₂ O @ 25.5' No sludges past this footage					
25.3'-25.8'	Rusty slip	108	25.3'	25.8'	0.8'	Nil
42.5'-43.5'	Series of slips @ 55° in slightly altered diabase Sparse mineralization	109	42.5'	43.5'	1.0'	0.2
<u>NOTE:</u>	@ 46.5' rounded pieces of diabase					
47.5'-48.5'	A number of slips @ 60° Sparse mineralization	110	47.5'	48.5'	1.0'	Trace
49.5'-50.0'	Slip @ 30° Some dark min. Fairly solid diabase	111	49.5'	50.0'	0.5'	0.1
51.0'	Rubbed calcite slip @ 60° Some min. Altered diabase	112	50.6'	51.1'	0.5'	0.1
52.0'-53.5'	2 dark slips @ 30° at both ends of section Greyish medium grained diabase Some pitting	113	52.0'	53.5'	1.5'	0.1

TFC

DRILLED BY N. Maricotte Diamond Drilling Ltd.

SIGNED

G. Swantree

DIAMOND DRILL RECORD

PROPERTY CHARTERS-DONOVAN-LEITH TOWNSHIPS HOLE NO. S-10

Sheet Number 2 Section From To Started

Latitude Datum Completed

Departure Bearing Ultimate Depth

Elevation Dip Proposed Depth

DEPTH FEET	FORMATION	Sample No.	From	To	Width	Assays Ag. Oz./T
53.7'-54.7'	Several dark slips 45°-50° Some mineralization Some pitting in diabase	114	53.7'	54.7'	1.0'	Trace
55.7'-56.0'	Dark slip @ 45° Sparse min., not much change in diabase	115	55.7'	56.0'	0.3'	Trace
61.5'-62.0'	2 dark slips @ 45° in altered diabase Sparse mineralization Some pitting in diabase	116	61.5'	62.0'	0.5'	0.2
65.3'-66.0'	Noticeable pitting in diabase, also several slips @ 50° Sparse mineralization	117	65.3'	66.0'	0.7'	0.1
68.0'	½" altered diabase Slip @ 60° Would appear some vein material rubbed off on both sides	118	67.8'	68.1'	0.3'	Nil
71.5'-72.0'	Greenish diabase Some pitting & slips @ 45°	119	71.5'	72.0'	0.5'	0.4
73.0'-73.5'	Green-red diabase, very brittle Sparse mineralization 2 calcite slips @ 60° Noticeable rubbing	120	73.0'	73.5'	0.5'	Trace
80.0'-80.5'	Several slips @ 50° Some pitting in diabase No visible min.	121	80.0'	80.5'	0.5'	0.2
82.3'-83.1'	Slip @ 30° beginning of section, calcite thread @ 82.8' followed by 2 slips @ 60° Sparse mineralization	122	82.3'	83.1'	0.8'	0.1
89.5'-90.0'	Couple slips @ 30° & 60° Broken up core centre of section Sparse mineralization Some pitting	123	89.5'	90.0'	0.5'	0.2
91.0'-92.0'	Several slips @ 30° & 45° Two white threads of calcite middle of sect., spotted & soft diabase (much feldspar)	124	91.0'	92.0'	1.0'	0.2

DRILLED BY N. Maricotte Diamond Drilling Ltd.

SIGNED

G. Swartner

DIAMOND DRILL RECORD

PROPERTY CHARTERS-DONOVAN-LEITH TOWNSHIPS HOLE NO. 8-10

Sheet Number 3 Section From To Started

Latitude Datum Completed

Departure Bearing Ultimate Depth

Elevation Dip Proposed Depth

DEPTH FEET	FORMATION	Sample No.	From	To	Width	Assays Ag.Oz./T
100.0'-100.5'	Pitted green-reddish diabase, also slip @ 60° Sparse mineralization	125	100.0'	100.5'	0.5'	0.6
102.0'-102.5'	Slips @ 60° & pitted diabase as above	126	102.0'	102.5'	0.5'	0.3
102.5'-103.0'	Several broken up slips & broken core diabase as above	127	102.5'	103.0'	0.5'	0.3
106.0'-106.5'	Slip @ 30° Sparse mineralization	128	106.0'	106.5'	0.5'	Trace
END OF HOLE 107.5'						

TFC

DRILLED BY N. Morissette Diamond Drilling Ltd.

SIGNED

G. Shantree

DIAMOND DRILL RECORD

 PROPERTY CHARTERS-DONOVAN-LEITH TOWNSHIPS

 HOLE NO. 8-11

Sheet Number 1 Section From To Started Sept. 22/1972
 Latitude 2707.6 Datum Completed Sept. 23/1972
 Departure 1206.8 Bearing N43-16W (Azimuth 316-44) Ultimate Depth 105.0'
 Elevation 86.6 Dip -30° Proposed Depth 70.0'

DEPTH FEET	FORMATION	Sample No.	From	To	Width	Assays Ag. Os. / T
0-22.0'	Casing					
22.0'-105.0'	Grey fairly coarse diabase except as stated below					
23.5'-23.6'	Two slips @ 60° Some soft material apparently rubbed off Sparse mineralization	141	23.3'	23.8'	0.5'	Trace
24.6'	Dark slip @ 45° Some vein material removed (ground)	142	24.5'	24.8'	0.3'	0.4
27.3'	Dark slip @ 45° Some fine dark min. Little chalc. pyrite	143	27.2'	27.4'	0.2'	Nil
29.7'	Kusty slip fairly rough @ 60° Some mineralization					
30.5'	Kusty slip @ 30° Some broken core, weathered & leached Fault?	144	30.3'	30.8'	0.5'	0.4
31.6'	Dark slip @ 60° Sparse mineralization					
39.0'	" " @ 60° " "					
39.0'	" " @ 45° " "					
39.5'	Green slip @ 45° followed by altered but solid diabase	145	39.5'	40.2'	0.7'	Trace
43.5'	Greenish slip @ 60° Sparse mineralization					
44.5'	" " @ 60° " "					
46.0'-46.5'	Flat slip @ 20° " "	146	46.0'	46.7'	0.7'	0.2
47.0'	Serpentine slip @ 45°					
50.0'	Green calcite slip @ 45° Sparse mineralization Several irregular calcite threads at end of section	147	49.7'	51.0'	1.3'	0.3

TFC

DRILLED BY

M. Morissette Diamond Drilling Ltd.

SIGNED

G. Shawcross

DIAMOND DRILL RECORD

PROPERTY CHARTERS-DONOVAN-LEITH TOWNSHIPS HOLE NO. 9-11

Sheet Number 2 Section From To Started

Latitude Datum Completed

Departure Bearing Ultimate Depth

Elevation Dip Proposed Depth

DEPTH FEET	FORMATION	Sample No.	From	To	width	Assay Ag.Oz./T
51.5'	Dark slip @ 45°					
52.0'	<u>Klobs of Fe?</u>					
53.3'-53.7'	Green calcite slips @ 45° Sparse mineralisation in fairly soft dark diabase	148	53.3'	53.8'	0.5'	0.2
54.6'-55.6'	Altered diabase with some pitting Sparse mineralisation	149	54.6'	55.6'	1.0'	0.3
56.5'	White calcite thread @ 45°					
56.7'	Slip @ 45° (minor) followed by altered diabase with scattered blobs of white calcite Some min. Fe?	150	56.7'	57.7'	1.0'	0.4
58.8'	Minor slip @ 45° with some mineralisation					
59.0'-59.5'	Well mineralized section Chalco-Co.+PbS Also some threads of white calcite <u>Promising</u>	151	58.6'	60.0'	1.4'	0.4
NOTE: Most likely structure below trench						
61.0'	White calcite thread @ 60°					
62.5'	1/8" calcite with heavy Co. arsenides @ 45° Also some blobs of white calcite	152	62.2'	62.7'	0.5'	0.3
74.0'	Slip @ 45° (some soft material rubbed off) Some min.	153	73.7'	74.2'	0.5'	0.1
75.0'-75.7'	Coarse altered diabase with blobs of Ca.+Fe? Mineralisation	154	75.0'	75.7'	0.7'	0.3
77.5'-77.7'	Dark dense vein material Sparse mineralisation in normal diabase	155	77.4'	77.9'	0.5'	0.1

DRILLED BY N. Morissette Diamond Drilling Ltd.

SIGNED G. Shawtner

DIAMOND DRILL RECORD

PROPERTY CHARTERS-DONOVAN-LEITH TOWNSHIPS HOLE NO. 8-11

Sheet Number 3 Section From To Started

Latitude Datum Completed

Departure Bearing Ultimate Depth

Elevation Dip Proposed Depth

DEPTH FEET	FORMATION	Sample No.	From	To	Width	Assays
						Ag.Oz./T
91.5'-92.3'-93.0'-94.7'-95.8'	Minor slips @ 45°					
	<p><u>NOTE:</u> Altered diabase showed quite a lot of Quarts & Fe mineralization - not too attractive for Ag. - lack of Ca.</p> <p style="text-align: center;">END OF HOLE 105.0'</p>					

TPC

DRILLED BY N. Morissette Diamond Drilling Ltd.

SIGNED

G. Swarner

DIAMOND DRILL RECORD

PROPERTY CHARTERS-DONOVAN-LEITH TOWNSHIPS

HOLE NO. 8-12

Sheet Number 1 Section From To Started Sept. 25/1972
 Latitude 2898.4 Datum Completed Sept. 28/1972
 Departure 4443.3 Bearing N25-00W (Azimuth 335-00) Ultimate Depth 200.0'
 Elevation 36.2 Dip -30° Proposed Depth 175.0'

DEPTH FEET	FORMATION	Sample No.	From	To	Width	Assays Ag. Oz./T
0.0'-10.0'	Casing					
10.0'-200.0'	Grey medium grained diabase - fairly loose					
12.0'	Chloritic slip @ 30° Some mineralization					
13.3'	Dark material slip @ 45° Sparse "					
15.0'	Rusty slip @ 45°					
16.3'	Rusty joint @ 45°					
16.5'	Broken up core with some traces of Ca. @ 45°	163	16.2'	17.7'	1.5'	1.6
17.2'	White calcite thread @ 60°					
17.6'	Rusty slip @ 30° followed by broken core for 4"					
19.6'	Green calcite slip @ 45°					
20.0'	Noticeable white calcite slips @ 45° Core lively & broken up Sparse mineralization	164	19.5'	21.0'	1.5'	1.5
21.5'-22.0'	Broken up core & series of slips at flat angle					
23.5'	Chloritic slip with signs of Ca. @ 45° in altered & mineralized diabase, also some white threads of Ca. @ 45°	165	23.0'	24.0'	1.0'	1.7
24.7'-25.0'	Slips @ 45°					
25.3'	Slips @ 45° with 1/4" indicated calcite, broken up core	166	24.7'	25.7'	1.0'	4.2
27.3'	Green calcite @ 60° Core split in half throughout section Sparse mineralization	167	26.3	27.3'	1.0'	1.6

TFC

N. Morissette Diamond Drilling Ltd.

DRILLED BY

SIGNED

G. Shantier

DIAMOND DRILL RECORD

PROPERTY CHARTERS-DONOVAN-LEITH TOWNSHIPS HOLE NO. 8-12

Sheet Number 2 Section From To Started

Latitude Datum Completed

Departure Bearing Ultimate Depth

Elevation Dip Proposed Depth

DEPTH FEET	FORMATION	Sample No.	From	To	Width	Assays Ag. Oz./T
28.5'	Green (Actinolite) slips @ 50° Core reduced in dia. @ 28.0'					
29.0'	<u>1/2" banded dark quartz stringer @ 30° No mineralization</u>					
29.5'-30.5'	Series of slips from 30°-45° Also broken up ground, altered diabase Fault?	168	30.0'	31.0'	1.0'	1.6
31.0'	Broken up core showing slips					
32.5'	Actinolite slips @ 30°					
33.0'	Rusty slip @ 50° showing some Chalco slips @ 34.5'-35.0' & 35.5' @ 45° Sparse mineralization	169	32.5'	33.5'	1.0'	0.9
36.1'-36.7'	Flat slip with fine mineralization, some chloritic material	170	36.1'	37.3'	1.2'	0.7
37.3'	Rusty slip (weathered) traces of Ca. @ 45° Sparse min.					
41.0'	<u>Actinolite slip @ 30° followed by dirty rusty diabase (broken up) Noticeable leaching Sparse mineralization</u> <u>Fault</u>	171	40.8'	41.5'	0.7'	1.0
42.0'-42.5'	Rusty slips @ 45° broken up core between	172	42.0'	42.5'	0.5'	1.0
45.7'	Decayed & broken up Ca. perhaps 1/2" wide in pitted & soft diabase Some mineralization	173	45.5'	46.0'	0.5'	1.2
48.5'-49.0'	Series of dark slips @ 45° with some mineralization	174	48.5'	49.0'	0.5'	1.7
51.8'	Calcite slip @ 45° Sparse mineralization	175	51.8'	52.5'	0.7'	1.7
52.2	Blobs of white ca., also ca. slip @ 52.5' Sparse min.					

TFC

DRILLED BY N. Morissette Diamond Drilling Ltd.

SIGNED G. Shantler

DIAMOND DRILL RECORD

PROPERTY CHARTERS-DUNOVAN-LEITH TOWNSHIPS HOLE NO. 9-12

Sheet Number 3 Section From To Started

Latitude Datum Completed

Departure Bearing Ultimate Depth

Elevation Dip Proposed Depth

DEPTH FEET	FORMATION	Sample No.	From	To	Width	Assays Ag.Oz./T
58.0'	Several green-white calcite slips @ 45° in soft pitted diabase Some mineralization	176	57.5'	58.5'	1.0'	0.9
65.0'	Actinolite slip @ 45° (1/16") some pitting in diabase) Sparse mineralization)	177	64.5'	66.0'	1.5'	Nil
66.0'	Mud seam @ 45° broken up core)					
68.5'	Rough flat slips @ 69.0' - 1/4" Actinolite in broken up diabase Sparse mineralization	178	68.5'	69.5'	1.0'	0.9
NOTE:	There were series of slips coated with chloritic material at various angles that may produce alidge assays through entire hole					
93.8'-94.6'	Fine mineralization (Fe) in fine grained diabase Thread of calcite	179	93.8'	94.6'	0.8'	1.3
98.0'	Green calcite slip @ 30°					
84.0'-108.0'	Grey medium grained diabase much more solid than all previous footage, However, general slips at steeper angle					
110.0'	Flat slip @ 15° Some Fe					
112.5'	1/4" Actinolite slip @ 45° followed by minor slips (chloritic) Some sparse mineralization	180	112.0'	113.0'	1.0'	2.0
113.5'	Indication of Act. slip @ 45° in broken core, some min., CP?	181	113.5'	114.5'	1.0'	2.6

N. Morissette Diamond Drilling Ltd.

DRILLED BY

SIGNED

G. Shantner

DIAMOND DRILL RECORD

PROPERTY CHARTERS-DONOVAN-LEITH TOWNSHIPS HOLE NO. S-12

Sheet Number 4 Section From To Started

Latitude Datum Completed

Departure Bearing Ultimate Depth

Elevation Dip Proposed Depth

DEPTH FEET	FORMATION	Sample No.	From	To	Width	Assays	
						Ag.	Os./T
115.0'	Minor slip @ 45° Fine mineralization Fe? } Leached out calcite @ 50° Sparse mineralization } Several inches crushed core diabase	182	115.0'	116.0'	1.0'		Trace
117.5'	Green calcite slip & chlorite @ 40° followed by auxiliary } slips in pitted diabase (very soft) }	183	118.0'	119.0'	1.0'		1.0
122.5'	Minor Actinolite slip @ 45° in solid diabase						
125.5'	1/8" green calcite @ 60° Some rubbing followed minor crack in diabase @ 30° with some fine min. and chalcoc pyrite	184	125.2'	125.8'	0.6'		1.1
126.5'-128.0'	Series of slips @ 30°-45° before major fault between <u>129.0' to 130.0' @ 45°</u> Some core short between this interval	185	126.5	128.0	1.5'		Trace
		186	128.0'	129.0'	1.0'		Trace
130.0'-131.5'	<u>About 6" of core short</u>						
131.5'-133.5'	<u>About 6" of core short</u>	187	131.5'	133.0'	1.5'		0.2
	<u>NOTE:</u> Fault slips continued to 134.0'						
133.5'-134.0'	1/16" green calcite @ 45°						
138.5'-139.5'	Chloritic & some calcite slips @ 45°						
<u>NOTE:</u> 144.0'-148.0'	Some leaching in diabase, also minor serpentine slips						
148.0'	1/8" Co. arsenides followed by white patches of calcite	188	147.8'	148.3'	0.5'		1.3
154.5'-155.5'	White threads of calcite in solid diabase @ 45°						

TFC

DRILLED BY N. Morissette Diamond Drilling Ltd.

SIGNED

G. Shantley

DIAMOND DRILL RECORD

PROPERTY CHARTERS-DONOVAN-LEITH TOWNSHIPS HOLE NO. S-12

Sheet Number 5 Section From To Started

Latitude Datum Completed

Departure Bearing Ultimate Depth

Elevation Dip Proposed Depth

DEPTH FEET	FORMATION	Sample No.	From	To	Width	Assays Ag. Oz./T
<u>157.5'</u>	<u>Fault. 1" Actinolite @ 60° fairly solid - no movement</u>					
159.0'	Minor slip @ 45° Sparse mineralization					
160.0'-162.0'	White threads of calcite in solid diabase @ 45°					
164.5'-165.5'	Numerous chlorite (calcite) slips 45°-60° Soft diabase Some pitting Sparse mineralization	189	164.5'	165.5'	1.0'	0.8
<u>170.5'</u>	<u>½" Aplite veinlet with approx. 50% dark calcite @ 50° & some chalco mineralization</u>	190	170.4'	170.8'	0.4'	0.9
<u>NOTE:</u>	Could be "C" North Trench Vein West End					
171.0'	<u>½" dark calcite veinlet in fairly solid diabase @ 40°</u> Sparse mineralization	191	170.8'	171.2'	0.4'	0.1
176.0'-178.0'	Fairly promising slips @ 45° in lively diabase Sludges could assay					
182.5'	Slip with aplite indication @ 45°					
190.5'; 192.0'; 196.0'	Slips @ 45°					
	END OF HOLE 200.0'					
<u>GENERAL NOTE:</u>	No significant calcite veins have been cut. However, the entire hole shows some faulting and quite attractive diabase.					

TFC

DRILLED BY N. Morissette Diamond Drilling Ltd.

SIGNED

G. Shaw

DIAMOND DRILL RECORD

 PROPERTY CHARTERS-DONOVAN-LEITH TOWNSHIPS

 HOLE NO. 8-13

 Sheet Number 1

Section From To

 Started Sept. 28/72

 Latitude 2977.1

Datum

 Completed Sept. 29/1972

 Departure 4506.0

 Bearing N18-00W (Azimuth 342-00)

 Ultimate Depth 93.0'

 Elevation 35.4

 Dip -30°

 Proposed Depth 100.0'

DEPTH FEET	FORMATION	Sample No.	From	To	Width	Assays Ag, Cu, T
0.0'-6.0'	Casing					
11.7'	Rusty slip @ 45°					
11.8'	Dark dense material (slip) @ 45°	204	11.5'	12.0'	0.5'	Trace
12.0'	Dark slip @ 45°					
12.0'	Rusty slip @ 45°					
18.0'	Rusty slip @ 45°					
20.7'	Greenish slip @ 55°					
28.6'	Greenish slip (serpentine) @ 45°					
6.0'-31.0'	Grey medium grained diabase fairly solid					
36.0'	Dark slip @ 45° Some fine mineralization	214	35.7'	36.2'	0.5'	Trace
37.0'	Calcite slip with little Chalco followed by a ring of dark dense material (no definite angle) Some broken core at end of section	215	36.7'	37.4'	0.7'	0.1
38.2'	<u>1/4" Actinolite @ 45° with little calcite</u> Sparse min.	216	38.0'	38.4'	0.4'	Trace
	Solid diabase					
40.5'	<u>1/4" Actinolite @ 45° with little calcite</u> Solid diabase					
41.0'-41.5'	Broken up Actinolite (fault material) Some core may be missing (broken up)	217	41.0'	41.5'	0.5'	Trace
42.5'	Rusty crack @ 45°					

TFC

 DRILLED BY N. Morissette Diamond Drilling Ltd.

 SIGNED G. Swartz

DIAMOND DRILL RECORD

PROPERTY CHARTERS-DONOVAN-LEITH TOWNSHIPS HOLE NO. S-13

Sheet Number 2 Section From To Started

Latitude Datum Completed

Departure Bearing Ultimate Depth

Elevation Dip Proposed Depth

DEPTH FEET	FORMATION	Sample No.	From	To	Width	Assays Ag./Oz./T
44.5'-45.5'	Broken up rusty diabase (<u>Fault zone</u>)	218	44.5	45.5'	1.0'	Trace
45.5'-47.0'	Rusty broken diabase & some actinolite. Appears good portion of core missing (<u>Fault zone</u>)	219	45.5'	47.0'	1.5'	Trace
47.0'-49.5'	Reddish & altered diabase (faulted) with much pitting (<u>Fault zone</u>)	220	47.0'	49.5'	2.5'	0.2
49.5'-50.6'	Faulted diabase, less reddish (<u>Fault zone</u>)	221	49.5'	50.5'	1.0'	Trace
	Serpentine slip @ 50.0' @ 50°)					
	" " @ 50.6' @ 45° } 1/8" - 1/4"					
50.6'-52.0'	Much rusty material, also diabase badly broken up. Section actually short approx. 1.0' Leached & pitted diabase (<u>Fault zone</u>)	222	50.5'	52.0'	1.5'	Trace
52.0'-54.5'	Same as above. Short of core approx. 1.0' (<u>Fault zone</u>)	223	52.0'	54.5'	2.5'	0.3
54.5'-93.0'	Grey medium grained diabase slips & fairly lively diabase					
57.0'	1/16" dirty calcite @ 60°					
76.0'	Serpentine slip @ 30°					
84.0'	1/2" Actinolite with some white ca. @ 30° Some red min. (Fe?)	224	83.8'	84.2'	0.4'	Trace
84.5'	Chlorite slip @ 30°					
91.5'	" " @ 30°					
	END OF HOLE 93.0'					

DIAMOND DRILL RECORD

PROPERTY CHARTERS-ROBSON-LKITH TOWNSHIPS (LILY POND)

HOLE NO. S-16

Sheet Number 1 Section From To Started Oct. 11/1972
 Latitude 2846. Datum Completed Oct. 12/1972
 Departure 6073. Bearing S88 - 30N (Azimuth 268-30) Ultimate Depth 157.0'
 Elevation 111.4 Dip -37° Proposed Depth 150.0'

DEPTH FEET	FORMATION	Sample No.	From	To	Width
0-5.0'	Casing				
5.0'-10.0'	"A" core - grey coarse diabase				
11.5'	Rusty crack mesh leaching (calcite) @ 45° Sparse min.	287	11.2'	11.7'	0.5'
12.8'	" " @ 45° Some rubbed off material				
17.8'	" " Slips & broken core @ 30°-40° Some soft mat.	288	17.5'	18.0'	0.5'
10.0'-23.0'	Diabase as above				
23.0'-36.0'	Grey fine grained diabase				
<u>24.5'</u>	Leached threads of calcite @ 60° Signs of Co. bloom?	289	24.3'	24.7'	0.4'
36.0'-38.0'	Reddish diabase medium grained				
38.0'-45.0'	Fine to medium grained grey diabase				
45.0'-64.0'	Reddish diabase medium grained with white calcite spots (aplite appearance)				
<u>46.0'</u>	Brown & white calcite $\frac{1}{2}$ " with aplite edges @ 45° Some chalc pyrite mineralisation ?	290	45.4'	46.1'	0.7'
<u>48.3'</u>	$\frac{1}{2}$ " aplite with $\frac{1}{2}$ " dirty calcite between @ 45°	291	48.1'	48.5'	0.4'
53.0'	Weathered calcite slip @ 45°				
54.4'	1/8" partly decayed calcite @ 45° Some Fe (fine)				
60.5'	1/8" dark material (partly leached out) @ 45° Sparse min.	292	62.3'	62.6'	0.3'

TTC

N. Mariasotte Diamond Drilling Ltd.

DRILLED BY

SIGNED

DIAMOND DRILL RECORD

PROPERTY ~~CHARLES-DONOVAN-LEITH TOWNSHIPS~~ (LILY POND)..... HOLE NO. ~~S-16~~.....

Sheet Number 2..... Section From To Started

Latitude Datum Completed

Departure Bearing Ultimate Depth

Elevation Dip Proposed Depth

DEPTH FEET	FORMATION	Sample No.	From	To	Width	As Ag
64.0'-68.5'	Grey medium grained diabase					
68.6'	Irregular flat calcite (zig-zag) along core followed by a rough slip @ 45°	293	68.4'	68.9'	0.5'	M
<u>LOST H₂O @ 68.5'</u>	Some chalc. pyrite Fe + Co. ? mineralization					
68.5'-71.0'	Reddish rock aplite appearance					
71.0'-73.0'	Grey medium grained diabase					
73.0'-77.0'	Reddish coarse grained diabase					
74.0'	Flat slip @ 30° with dark min., also some pitting of diabase Fe ? mineralization	294	74.0'	74.6'	0.6'	O
77.0'-82.0'	Grey medium grained diabase					
82.0'-86.0'	Reddish coarse diabase with spots of calcite plus disseminated Co. ? + chalc. pyrite	300	83.5'	84.5'	1.0'	O
<u>87.0'</u>	8" vein material - aplite and pink calcite 90-90% Some chalc. pyrite plus perhaps fine disseminated Co.	301	86.7'	87.7'	1.0'	T
86.0'-92.0'	Grey medium grained diabase					
<u>92.5'</u>	2" aplite-calcite vein plus 2" of flat calcite before this section	302	92.2'	93.2'	1.0'	T
92.4'	4" dirty leached calcite @ 45° Some chalc. pyrite min. + ?					
<u>NOTE:</u>	Actual vein perhaps 2"-4" wide					

TFC

DRILLED BY N. Marinette Diamond Drilling Ltd.

SIGNED

DIAMOND DRILL RECORD

PROPERTY CHARTERS-DONOVAN-LATH TOWNSHIPS (LILY POND) HOLE NO. 8-16

Sheet Number 3 Section From To Started

Latitude Datum Completed

Departure Bearing Ultimate Depth

Elevation Dip Proposed Depth

DEPTH FEET	FORMATION	Sample No.	From	To	Width	Ass. Ag.
92.0'-94.0'	Reddish aplite appearance rock fine grained					
94.0'-127.0'	Grey medium grained diabase					
96.2'	1/2" dirty calcite @ 45° Sparse mineralization	303	96.0'	96.4'	0.4'	Tr
100.8'	Weathered crack @ 45°					
102.0'	1/2" calcite @ 45° in fairly reddish diabase Some Fe or GP	304	102.0'	102.3'	0.3'	Tr
102.8'	Calcite slip @ 45°					
104.0'	1/4" calcite stringer with aplite fringes @ 45°					
114.5'	Two white threads of calcite @ 45° - barren					
114.7'	1/16" white calcite slip @ 45°					
120.0'	Dark flat slip along core - no noticeable mineralization	305	119.5'	121.5'	2.0'	0.
127.0'-136.0'	Grey fine grained diabase More weathering & leaching					
131.0'-132.0'	Leached & altered & fine grained diabase Some min.	306	131.0'	132.0'	1.0'	Tr
132.0'-151.5'	Weathered & leached diabase Sparse mineralization	307	133.0'	133.5'	0.5'	Tr
	Several rusty slips (calcite?) @ 45° Some min. ?	308	148.8'	149.8'	1.0'	0.
	Several slips @ 45° in altered dirty diabase	309	151.0'	151.5'	0.5'	0.
END OF HOLE 157.0'						

TFC

DRILLED BY N. Marquette Diamond Drilling Ltd.

SIGNED

DIAMOND DRILL RECORD

PROPERTY CHARTERS-DONOVAN-LEITH TOWNSHIPS (LILY POND) HOLE NO. 8-18

Sheet Number 1 Section From To Started Oct. 15/1972
 Latitude 2742. Datum Completed Oct. 17/1972
 Departure 6090. Bearing S88 - 30W (Azimuth 268-30) Ultimate Depth 204.0'
 Elevation 106.9 Dip -38° Proposed Depth 200.0'

DEPTH FEET	FORMATION	Sample No.	From	To	Width	Assays Ag. Oz./T
0-16.0'	Casing					
16.0'-27.0'	Grey medium grained diabase turning to aplite (granophyre) towards end of section, weathered beginning of section.					
27.0'-32.0'	Granophyre (reddish rock) or aplite					
32.0'-45.0'	Greyish medium grained diabase except @ 33.5'-34.0' Aplite appearance with some chalco pyrite mineralization					
27.0'-28.0'	Leached out section with perhaps some specks of Co.	350	27.0'	28.0'	1.0'	Trace
<u>32.0'</u>	Leached out aplite & broken core with visible specularite Fe Also little chalco pyrite (<u>small fault</u>)					
45.0'-48.0'	Grey fine grained diabase with more noticeable chalco pyrite mineralization					
52.0'-53.0'	Leached out section and slip @ 45°	351	52.0'	53.0'	1.0'	Trace
48.0'-73.0'	Grey medium grained diabase - featureless. Slips generally @ 45°					
70.6'	Aplite sign & leached. Most likely ground part of same.					
73.0'-78.0'	More reddish diabase with patches of pink calcite with some chalco pyrite					
77.8'	Slip with specularite Fe @ 45°					
78.0'	Slip @ 45° with much chalco pyrite					

TFC

DRILLED BY N. Marquette Diamond Drilling Ltd.

SIGNED

DIAMOND DRILL RECORD

PROPERTY CHARTERS-DONOVAN-LEITH TOWNSHIPS (LIXX POND) HOLE NO. 8-18

Sheet Number 2 Section From To Started

Latitude Datum Completed

Departure Bearing Ultimate Depth

Elevation Dip Proposed Depth

DEPTH FEET	FORMATION	Sample No.	From	To	Width	Asses. Ag. O.
78.0'-100.0'	More greyish & coarse grained diabase, tight - featureless					
83.5'	1 1/2" irregular aplite patch in solid diabase					
84.8'	1/2" white-brown calcite @ 45° with few specks of chalcocite pyrite	352	84.5'	85.0'	0.5'	0.6
98.0'	White calcite slip @ 60°	} Sparse mineralization				
99.8'	" " " @ 60°					
100.0'	Rusty slip (calcite) @ 60°					
101.3'-101.8'	Leached out diabase (slips)	354	101.3'	101.9'	0.6'	Trace
105.0'	White calcite slip @ 60°					
108.0'	Reddish crack - broken core @ 60° in solid diabase					
112.5'	Rough reddish crack @ 45° Some chalcocite pyrite in diabase	355	112.0'	113.0'	1.0'	Trace
113.8'	1/16" white-pink calcite @ 45° with fair chalcocite pyrite	356	113.6'	113.9'	0.3'	Trace
116.0'	Reddish rough slip @ 45° with little CP in diabase	357	115.5'	116.0'	0.5'	0.2
117.0'	1/2" pink calcite @ 30° followed by altered diabase (brecciated)	358	116.5'	117.5'	1.0'	Trace
117.5'	Half core of pink calcite brecciated in reddish diabase	359	117.5'	118.5'	1.0'	0.2
<u>NOTE:</u>	Apparently this is cut at an acute angle, most likely near a fault or this could be a part of it.	360	118.5'	119.5'	1.0'	0.3
121.5'	Several rusty slips @ 45° Signs of some calcite Fine grained diabase also pitted	361	121.3'	121.8'	0.5'	0.2
126.3'	Leached out cracks in diabase @ 50°	362	126.1'	126.4'	0.3'	0.4

TFC

DRILLED BY N. Marinette Diamond Drilling Ltd.

SIGNED

DIAMOND DRILL RECORD

PROPERTY CHARTERS-DONOVAN-LEITH TOWNSHIPS (LILY POND) HOLE NO. 8-18

Sheet Number 3 Section From To Started

Latitude Datum Completed

Departure Bearing Ultimate Depth

Elevation Dip Proposed Depth

DEPTH FEET	FORMATION	Sample No.	From	To	Width	As Ag
129.3'-130.3'-132.5'	Calcite slips @ 45°					
134.6'	Crack in reddish diabase showing specularite Fe	363	134.5'	135.0'	0.5'	Tr
135.4'	6" calcite vein @ 40° with reddish fringes, Sparse min. } except for indication of MIS. End of section leached out } diabase (broken) showing specks of specularite Fe }	364	135.0'	136.5'	1.5'	M
<u>PROMISING</u>		365	136.5'	137.5'	1.0'	Tr
136.5'-137.0'		Cere split in half showing specularite Fe				
151.5'	Calcite vein reddish diabase beginning of section & end of section. <u>Vein approx. 6" wide.</u> Sparse min.	366	151.5'	152.5'	1.0'	M
<u>PROMISING</u>						
157.5'-161.5'	Fault zone. Broken up & leached out diabase. Some cere } lost in this section. Red. at end of sect. with spec. Fe. }	367	157.5'	159.0'	1.5'	T
<u>NOTE:</u>		Actual cere recovery 3'	368	159.0'	161.5'	1.5'
161.5'-167.0'	Leached & broken up cere	369	164.0'	165.5'	1.5'	O
<u>NOTE:</u>	Actual cere length 4'					
<u>LOST H₂O @ 160.0'-165.0' - No further sludges, hence these assays:</u>		370	165.5'	167.0'	1.5'	O
167.0'-168.0'	Same as above	371	167.0'	168.0'	1.0'	T
172.0'	1/16" white calcite @ 60°					
173.0'	Patches of calcite, with chalcoc pyrite	372	173.0'	174.0'	1.0'	O
173.5'	Slip leached @ 30° Decayed diabase					
	Leached diabase as above	373	175.0'	175.5'	0.5'	T

TIC

DRILLED BY N. Morissette Diamond Drilling Ltd.

SIGNED

DIAMOND DRILL RECORD

PROPERTY CHARTERS-DONOVAN-LEITH TOWNSHIPS (LILY POND) HOLE NO. 5-18

Sheet Number A Section From To Started

Latitude Datum Completed

Departure Bearing Ultimate Depth

Elevation Dip Proposed Depth

DEPTH FEET	FORMATION	Sample No.	From	To	Width
196.0'	Broken up and leached out diabase, rusty looking	374	177.0'	177.5'	0.5'
	Calcite slip @ 45°				
	Slips @ 30° & 45° followed by dirty diabase (brownish)	375	200.0'	202.0'	2.0'
	END OF HOLE 204.0'				
	<u>NOTE:</u> Would appear that the hole is near surface (see section, this is not so) or near a major fault.				

TFC

DRILLED BY N. Morissette Diamond Drilling Ltd.

SIGNED

DIAMOND DRILL RECORD

PROPERTY ~~CHARLES DONOVAN LETH TOWNSHIPS (LILY POND)~~ HOLE NO. 5-21

Sheet Number 1 Section From To Started Oct. 21
 Latitude 3046. Datum Completed Oct. 21
 Departure 6357. Bearing DUG WEST Ultimate Depth
 Elevation 107.7 Dip -40° Proposed Depth

DEPTH FEET	FORMATION	Sample No.	From	To
0-7.0'	Casing			
7.0'-10.5'	"A" core - grey coarse grained diabase			
10.5'-31.0'	"A" " - ditto -			
15.0'	rough rusty crack @ 30° Some leaching			
16.0'	Chlorite slip @ 30° showing blobs of pyrite			
21.6'	" " @ 30° Some fine pyrite mineralisation			
25.3'	" " plus rough crack @ 45° Some min.	427	25.0'	25.5'
29.0'	Calcite slip @ 45° Sparse mineralisation			
29.7' & 29.8'	Rusty slips (rough) @ 50°			
31.0'	Two slips @ 50° followed by a flat white calcite thread. Sparse mineralisation.			
31.0'-32.0'	Grey finer grained diabase			
<u>31.0'</u>	<u>1"</u> banded grey calcite in finer grained diabase. No noticeable mineralisation.	428	30.8'	31.1'
32.0'-34.0'	Grey coarse grained diabase			
34.0'-37.0'	Fine grained diabase			
34.6'	1/8" white calcite in solid diabase @ 45°			
<u>36.0'</u>	<u>1/4"</u> white banded calcite approx. angle 50°-60° in solid diabase - barren	429	35.7'	36.2'

TFC

M. Mariacette Diamond Drilling Ltd.

DRILLED BY _____

SIGNED _____

E. Shurt

DIAMOND DRILL RECORD

PROPERTY CHARTERS-DONOVAN-LATH TOWNSHIPS (LILY POND)

HOLE NO. 8-21

Sheet Number 2 Section From To Started

Latitude Datum Completed

Departure Bearing Ultimate Depth

Elevation Dip Proposed Depth

DEPTH FEET	FORMATION	Sample No.	From	To	Width	Ag
36.7'	1/8" white calcite @ 45° in solid diabase sparse min.	430	36.6'	36.8'	0.2'	(
39.2'	1" white calcite with a brown ring 1/8" thick @ 45° Sparse mineralisation	431	39.0'	39.3'	0.3'	1
37.0'-38.5'	Grey coarse grained diabase					
38.5'-40.0'	Fine grained grey diabase					
39.6'	1/8" white calcite slightly leached followed by a white calcite thread					
40.0'-75.0'	Very coarse grey diabase; slips show Fe staining - featureless					
41.8'; 42.0'	Slips @ 45° with hematite stains					
47.2'	1/2" dirty calcite slightly leached with some dark stains @ 45° Sparse min. Few specks of chalcocyanite in fairly solid diabase.	432	47.8'	48.5'	0.7'	(
48.5'	Chlorite slip @ 45° Hematite stain					
71.5'	6" broken & leached diabase. Some pitting in diabase to end of section.					
75.0'-92.0'	Finer grained diabase but fairly tight					
80.5'	White calcite thread irregular angle, also slip (pink ca.) @ 45°					

TFC

N. Morissette Diamond Drilling Ltd.

DRILLED BY

SIGNED

G. Swanson

DIAMOND DRILL RECORD

PROPERTY CHARTERS-LENOVAN-LEITH TOWNSHIPS (LILY POND) HOLE NO. S-21

Sheet Number 3 Section From To Started

Latitude Datum Completed

Departure Bearing Ultimate Depth

Elevation Dip Proposed Depth

DEPTH FEET	FORMATION	Sample No.	From	To	
81.0'	Calcite slip @ 45° with some chalcoc pyrite				
83.0'	- ditto - - ditto -				
88.0'	White calcite thread @ 45° - barren				
89.0';89.2'	Pink calcite slips @ 60° little fine chalcoc pyrite				
90.5';91.3'	- ditto - - barren				
93.5'	1/4" banded calcite black appearing slip @ 45° some fairly heavy chalcoc pyrite plus some disseminated in reddish diabase	433	93.0'	93.7'	(
94.7'	1/16" pink calcite (slip) @ 60° some chalcoc pyrite in diabase				
95.0'	- ditto - - ditto -				
92.0'-104.0'	Fairly coarse reddish diabase				
98.7'	Sign of some calcite with aplite on both sides some CP	434	98.6'	99.6')
99.4';99.5'	Brownish slips (weathered calcite) @ 45° sparse min.				
103.5'	Brown soft calcite slip @ 50° in reddish rock				
104.0'-114.0'	Grey finer grained diabase				
105.5'	Flat yellow crack @ 15°				
107.0';107.5';108.5';109.5'	- Soft yellow appearing slips @ 45°				
109.5'-111.0'	Core split into half & broken, also much leaching				

TIC

H. Morissette Diamond Drilling Ltd.

DRILLED BY

SIGNED

E. Shaw

DIAMOND DRILL RECORD

PROPERTY CHARTERS-DONOVAN-LEITH TOWNSHIPS (LILY POND) HOLE NO. 8-21

Sheet Number 4 Section From To Started

Latitude Datum Completed

Departure Bearing Ultimate Depth

Elevation Dip Proposed Depth

DEPTH FEET	FORMATION	Sample No.	From	To	Width
112.0'	1/4" chlorite-calcite ring @ 60° is fairly solid reddish diabase. Minor chlorite slips @ 112.2'; 112.5'				
114.3'; 114.4'	Minor yellow slips @ 60°				
114.0'-123.0'	"Red Rock" fairly fine with numerous slips at steep angles				
119.0'-120.0'	" " " " disseminated chalc. pyrite	435	119.0'	120.0'	1.0'
<u>NOTE:</u>	Core between 116.0'-118.0' almost split into half, with yellow staining.				
	END OF HOLE 123.0'				

110

M. Morissette Diamond Drilling Ltd.

DRILLED BY

SIGNED

E. Shanthor

Ministry of Natural Resources

TEMISKAMING TESTING LABORATORIES

DEPARTMENT OF MINING AND TECHNICAL SERVICES

COBALT, ONTARIO



ONTARIO

REPORT NUMBER

CB 122

Date Sept. 5, 1972.

Telephone: 878-8313

LABORATORY REPORT

Issued to: Mr. G. Shartner, Haileybury, Ont.

DESCRIPTION OF SAMPLE	SILVER OZ. PER TON	GOLD OZ. PER TON	GOLD VALUE PER TON
HOLE #1 { #001 SLUDGE 20'-30'	0.1		
002 " 30'-40'	Trace		
003 " 40'-50'	Trace		
004 " 50'-60'	Trace		
005 " 60'-65'	Trace		
HOLE #2 { 006 SLUDGE 25'-35'	0.6		
007 " 35'-45'	0.4		
008 " 45'-55'	Trace		
009 " 55'-70'	Nil		
010 " 70'-80'	1.3		
HOLE #3 { 011 SLUDGE 27'-37'	Trace		
012 " 37'-47'	Nil		
013 " 47'-57'	0.1		
014 " 57'-67'	0.2		
015 " 67'-77'	Nil		
016 " 77'-87'	Trace		
HOLE #4 { 017 SLUDGE 30'-40'	Trace		
018 " 40'-50'	Trace		
019 " 50'-60'	Nil		
020 " 60'-70'	Nil		
021 " 70'-80'	Nil		
022 " 80'-90'	0.5		
023 " 90'-100'	0.2		

Fees Received

..... J. L. Bisson
Manager M.

Except by special permission, reproduction of these results must include any qualifying remarks made by this department with reference to any sample.

Ministry of Natural Resources

TEMISKAMING TESTING LABORATORIES

~~GENERAL OFFICE OF THE MINISTRY OF NATURAL RESOURCES~~

COBALT, ONTARIO



REPORT NUMBER

CB 125

Telephone: 679-8313

LABORATORY REPORT

Date Sept. 6, 1972

Issued to: **Mr. G. Shartner, Haileybury, Ont.**

DESCRIPTION OF SAMPLE	SILVER OZ. PER TON	GOLD OZ. PER TON	GOLD VALUE PER TON
HOLE #1 { D.D. 024 SECT: 42.7'-43.5'	Trace ✓		
" 025 SECT: 54.0'-55.0'	Trace ✓		
HOLE #2 { " 026 SECT: 53.9'-54.1'	Trace ✓		
" 027 SECT: 74.3'-75.0'	Trace ✓		
HOLE #3 { " 028 SECT: 54.5'-56.0'	Nil ✓		
" 029 SECT: 71.5'-72.0'	Nil ✓		
HOLE #4 { " 030 SECT: 77.0'-77.4'	Nil ✓		
" 031 SECT: 88.0'-88.5'	Trace ✓		
" 032 SECT: 9.0'-92.0'	Nil ✓		

Fees Received

.....
Manager

J. L. Bisson
m.

Except by special permission, reproduction of these results must include any qualifying remarks made by this department with reference to any sample.

Ministry of Natural Resources

TEMISKAMING TESTING LABORATORIES

~~DEPARTMENT OF MINES AND TECHNICAL SURVEYS~~

COBALT, ONTARIO



REPORT NUMBER

CB 131

Date Sept. 12, 1972.

Telephone: 679-8313

LABORATORY REPORT

Issued to: Mr. G. Shartner, Gowganda, Ont.

DESCRIPTION OF SAMPLE	SILVER OZ. PER TON	GOLD OZ. PER TON	GOLD VALUE PER TON
#033 SLUDGE 6'-13'	Trace ✓		
034 SLUDGE 13'-20'	Trace ✓		
035 SLUDGE 20'-30'	0.5, ✓		
HOLE #5 036 SLUDGE 30'-40'	Trace ✓		
037 SLUDGE 40'-50'	Nil ✓		
038 SLUDGE 50'-60'	Nil ✓		
039 SLUDGE 60'-69'	Nil ✓		
HOLE #6 040 SLUDGE 6'-6'	Trace ✓		
041 SLUDGE 30'-30'	0.5 ✓		
HOLE #7 D.D. 067 SLUDGE 50'-70'	0.3 ✓		

Fees Received

Manager

J. L. Brisson
M.

Except by special permission, reproduction of these results must include any qualifying remarks made by this department with reference to any sample.



LABORATORY REPORT

Issued to: Mr. G. Shartner, Gowganda, Ont.

DESCRIPTION OF SAMPLE	SILVER OZ. PER TON	GOLD OZ. PER TON	GOLD VALUE PER TON
D.D. 042 SECT: 47.5' - 47.8'	1.2 ✓		
" 043 " 48.5' - 49'	0.4 ✓		
HOLE #5 044 " 52.5' - 52.9'	Trace ✓		
" 045 " 53.5' - 54.2'	Trace ✓		
" 046 " 64.0' - 64.5'	0.5 ✓		
" 047 SECT: 52.5' - 52.8'	Trace ✓		
" 048 " 55.0' - 55.4'	Trace ✓		
HOLE #6 049 " 59.0' - 59.4'	0.6 ✓		
" 050 " 63.0' - 63.3'	Trace ✓		
" # 051 SINDOR 30' - 40'	0.1 ✓		
#052 " 40' - 50'	Trace ✓		
#053 " 50' - 60'	4.2 ✓		
#054 " 60' - 70'	0.8 ✓		
" 055 SECT: 8 - 8'	Trace ✓		
" 056 " 14.0' - 16.0'	Trace ✓		
" 057 " 18.0' - 19.0'	0.1 ✓		
" 058 " 20.0' - 20.5'	0.2 ✓		
#059 " 20.0' - 20.5'	0.2 ✓		
HOLE #7 060 " 20' - 20'	Trace ✓		
#061 " 20' - 20'	Nil ✓		
#062 " 30' - 30'	Nil ✓		
#063 " 40' - 40'	Nil ✓		
#064 " 50' - 50'	0.1 ✓		
" 065 " 22.0' - 22.5'	Nil ✓		
" 066 " 22.0' - 22.5'	0.4 ✓		

Fees Received

Manager

J. L. Brisson
M.

Except by special permission, reproduction of these results must include any qualifying remarks made by this department with reference to any sample.

Ministry of Natural Resources

TEMISKAMING TESTING LABORATORIES

~~DEPARTMENT OF MINES AND TECHNICAL SURVEYS~~

COBALT, ONTARIO



REPORT NUMBER

CB 137

Date Sept. 18, 1972.

Telephone: 679-8313

LABORATORY REPORT

Issued to: Mr. Gus Shartner, Gowganda, Ont.

DESCRIPTION OF SAMPLE	SILVER OZ. PER TON	GOLD OZ. PER TON	GOLD VALUE PER TON
SECT: 18.4'-19.8' D.D. 068	1.6 ✓		
" 50.2'-50.9' " 073	1.4 ✓		
" 52.0'-52.5' " 074	2.8 ✓		
" 68.5'-68.8' " 075	0.8 ✓		
" 67.0'-67.5' " 076	0.2 ✓		
" 69.0'-69.5' " 077	0.6 ✓		
" 76.0'-76.5' " 078	Trace ✓		
" 81.0'-82.5' " 079	0.3 ✓		
" 91.5'-92.0' " 080	0.3 ✓		
SECT: 12.3'-12.8' " 081	0.2 ✓		
" 28.5'-28.9' " 082	1.4 ✓		
" 31.4'-31.9' " 083	2.2 ✓		
" 34.2'-34.7' " 084	5.8 ✓		
" 34.7'-35.2' " 085	11.8 ✓		
" 47.8'-48.3' " 086	4.2 ✓		
" 51.3'-51.8' " 087	0.4 ✓		
" 70.0'-70.7' " 088	0.9 ✓		
" 80.4'-80.8' " 089	0.7 ✓		
" 88.5'-88.8' " 090	1.2 ✓		

Fees Received

.....
 J. L. Brisson
 Manager M.

Except by special permission, reproduction of these results must include any qualifying remarks made by this department with reference to any sample.

Ministry of Natural Resources

TEMISKAMING TESTING LABORATORIES

COBALT, ONTARIO



ONTARIO

REPORT NUMBER

CB 138

Telephone: 679-8313

LABORATORY REPORT

Date Sept. 19, 1972.

Issued to: Mr. G. Shartner, Gowganda, Ont.

DESCRIPTION OF SAMPLE	SILVER OZ. PER TON	GOLD OZ. PER TON	GOLD VALUE PER TON
#069 SLUDGE - 12' to 20'	0.2		
070 " - 20' to 30'	0.6		
071 " - 30' - 40'	0.1		
HOLE #8 072 " - 40' - 50'	0.2		
091 " - 50' - 60'	0.7		
092 " - 60' - 70'	Trace		
093 " - 70' - 80'	0.9		
094 " - 80' - 90'	Trace		
095 " - 90' - 97'	0.5		
096 SLUDGE - 10' - 20'	0.1		
097 " - 20' - 30'	Nil		
HOLE #9 098 " - 30' - 40'	0.9		
099 " - 40' - 50'	0.4		
100 " - 50' - 60'	Trace	(OTHER 1/2 TO BE ASSAYED)	
101 " - 60' - 70'	0.7		
102 " - 70' - 80'	0.2		
103 " - 80' - 95'	0.3		

Fees Received

Manager *J. L. Brisson*

Except by special permission, reproduction of these results must include any qualifying remarks made by this department with reference to any sample.

Ministry of Natural Resources
 TEMISKAMING TESTING LABORATORIES
 COBALT, ONTARIO
 Telephone: 679-8313

LABORATORY REPORT

Issued to: The Grouse Syndicate, c/o Gus Shartner, Gowganda, Ont.

Date: Sept. 19, 1972

DESCRIPTION OF SAMPLE	SILVER OZ. PER TON	GOLD OZ. PER TON	GOLD VALUE PER TON
D.D. 104 SECT. 110-115.0	0.1		
105 " 12.7-13.3	0.4		
D.D. 106 " 14.0-14.7	0.1		
107 " 19.4-20.1	0.2		
108 " 25.3-25.8	Nil		
109 " 42.5-48.5	0.2		
110 " 47.5-49.5	Trace		
111 " 49.5-50.0	0.1		
112 " 50.6-51.1	0.1		
113 " 52.0-53.5	Trace		
114 " 53.7-54.7	Trace		
115 " 55.7-56.0	0.2		
116 " 61.5-62.0	0.1		
117 " 65.5-66.0	Nil		
HOLE #10 118 " 67.8-68.1	0.4		
119 " 71.5-72.0	Trace		
120 " 73.0-73.5	0.2		
121 " 80.0-80.5	0.1		
122 " 82.3-83.1	0.2		

Ministry of Natural Resources

TEMISKAMING TESTING LABORATORIES

~~DEPARTMENT OF MINES AND TECHNICAL SURVEYS~~

COBALT, ONTARIO



REPORT NUMBER

CB 143

Telephone: 679-8313

LABORATORY REPORT

Date Sept. 27, 1972

Issued to: The Grouse Syndicate, c/o Gus Shartner, Gowganda, Ont.

DESCRIPTION OF SAMPLE	SILVER OZ. PER TON	GOLD OZ. PER TON	GOLD VALUE PER TON
D.D. 104 SECT. 108-120	0.1 ✓		
D.D. 105 " 127-133	0.4 ✓		
106 " 140-147	0.1 ✓		
107 " 194-201	0.2 ✓		
108 " 253-258	Nil ✓		
109 " 425-435	0.2 ✓		
110 " 475-485	Trace ✓		
111 " 495-500	0.1 ✓		
112 " 506-511	0.1 ✓		
113 " 520-525	0.1 ✓		
114 " 537-547	Trace ✓		
115 " 557-560	Trace ✓		
HOLE #10 116 " 615-620	0.2 ✓		
117 " 653-663	0.1 ✓		
118 " 675-681	Nil ✓		
119 " 715-720	0.4 ✓		
120 " 730-735	Trace ✓		
121 " 800-805	0.2 ✓		
122 " 823-831	0.1 ✓		
123 " 895-900	0.2 ✓		
124 " 910-920	0.2 ✓		
125 " 1000-1005	0.6 ✓		
126 " 1020-1025	0.3 ✓		
127 " 1025-1030	0.3 ✓		
128 " 1020-1025	Trace ✓		
HOLE #9 #129 SIDGE - 50-60	Nil ✓		
HOLE #10 130 SIDGE - 10-20	0.4 ✓		
131 " 20-25.0	0.2 ✓		
132 SIDGE - 20-30	Nil ✓		
133 " - 30-40	0.3 ✓		
HOLE #11 134 " - 40-50	0.2 ✓		
135 " - 50-60	Trace ✓		
136 " - 60-70	Trace ✓		
137 " - 70-80	0.3 ✓		

Fees Received

J. L. Brisson
Manager

Except by special permission, reproduction of these results must include any qualifying remarks made by this department with reference to any sample.



Issued to: The Grouse Syndicate, c/o Gus Shartner, Gowanda, Ont.

DESCRIPTION OF SAMPLE	SILVER OZ. PER TON	GOLD OZ. PER TON	GOLD VALUE PER TON
HOLE # 11 { #No Number (138) 139 SLUDGE - 90'-100' 140 " - 100'-105'	0.2 ✓	(SLUDGE 80'-90')	
	Nil ✓		
	Trace ✓		
D.D. { 141 SECY: 28.9'-28.9' 142 " 24.5'-24.8' 143 " 27.2'-27.4' 144 " 30.3'-30.8' 145 " 39.5'-40.2' 146 " 46.0'-46.7' 147 " 49.7'-51.0' HOLE # 11 { 148 " 53.8'-53.8' 149 " 57.6'-55.6' 150 " 56.7'-57.7' 151 " 58.6'-41.0' 152 " 62.2'-62.7' 153 " 73.7'-74.2' 154 " 75.0'-75.7' 155 " 77.4'-77.9'	Trace ✓		
	0.4 ✓		
	Nil ✓		
	0.4 ✓		
	Trace ✓		
	0.2 ✓		
	0.3 ✓		
	0.2 ✓		
	0.3 ✓		
	0.4 ✓		
	0.4 ✓		
	0.3 ✓		
	0.1 ✓		
0.3 ✓			
0.1 ✓			

Fees Received

.....
 Manager J. L. Brisson
 M.

Except by special permission, reproduction of these results must include any qualifying remarks made by this department with reference to any sample.

Ministry of Natural Resources

TEMISKAMING TESTING LABORATORIES

~~DEPARTMENT OF MINES AND TECHNICAL SURVEYS~~
COBALT, ONTARIO



REPORT NUMBER

CB 153

Telephone: 679-8313

LABORATORY REPORT

Date Oct. 3, 1972.

Issued to: The Grouse Syndicate, c/o Mr. Gus Shartner, Gowganda, Ont.

DESCRIPTION OF SAMPLE	SILVER OZ. PER TON	GOLD OZ. PER TON	GOLD VALUE PER TON
D.D. 217 <small>SECT. 410'-415'</small>	Trace ✓		
218 " <small>415'-455'</small>	Trace ✓		
219 " <small>455'-470'</small>	Trace ✓		
HOLE #13 220 " <small>470'-495'</small>	0.2 ✓		
221 <small>SECT. 495'-505'</small>	Trace ✓		
222 " <small>505'-525'</small>	Trace ✓		
223 " <small>520'-545'</small>	0.3 ✓		
224 " <small>838'-842'</small>	Trace ✓		
#156 <small>SLUDGE: 10'-20'</small>	1.0 ✓		
157 " <small>20'-30'</small>	3.8 ✓		
158 " <small>30'-40'</small>	1.4 ✓		
HOLE #12 159 " <small>40'-50'</small>	0.7 ✓		
160 " <small>50'-60'</small>	1.3 ✓		
161 " <small>60'-70'</small>	0.6 ✓		
162 " <small>70'-80'</small>	0.2 ✓		
192 <small>SLUDGE: 80'-90'</small>	0.8 ✓		
193 " <small>90'-100'</small>	0.3 ✓		
194 " <small>100'-110'</small>	0.2 ✓		
195 " <small>110'-120'</small>	0.2 ✓		
196 " <small>120'-130'</small>	0.2 ✓		
197 " <small>130'-140'</small>	0.3 ✓		
HOLE #11 198 <small>SLUDGE: 140'-150'</small>	0.1 ✓		
199 " <small>150'-160'</small>	0.1 ✓		
200 " <small>160'-170'</small>	Trace ✓		
201 " <small>170'-180'</small>	0.6 ✓		
202 " <small>180'-190'</small>	Trace ✓		
203 " <small>190'-200'</small>	Trace ✓		
205 <small>SLUDGE: 20'-25'</small>	0.1 ✓		
206 " <small>25'-30'</small>	0.1 ✓		
HOLE #13 207 " <small>30'-40'</small>	Trace ✓		
208 " <small>40'-50'</small>	0.1 ✓		
209 " <small>50'-60'</small>	Trace ✓		

Fees Received

.....
Manager

J. L. Brisson
m

Except by special permission, reproduction of these results must include any qualifying remarks made by this department with reference to any sample.

Ministry of Natural Resources

TEMISKAMING TESTING LABORATORIES

MINISTÈRE DES RESSOURCES NATURELLES
LABORATOIRES D'ANALYSE

COBALT, ONTARIO



ONTARIO

REPORT NUMBER

CB 152

Date Oct. 3, 1972.

Telephone: 679-8313

LABORATORY REPORT

Date Oct. 3, 1972.

Issued to: The Grouse Syndicate, c/o Mr. Gus Shartner, Gowganda, Ont.

DESCRIPTION OF SAMPLE	SILVER OZ. PER TON	GOLD OZ. PER TON	GOLD VALUE PER TON
D.D. 165 SECT 29.6'-240'	1.7	✓	
166 " 247'-257'	4.2	✓	
HOLE #12 167 " 263'-273'	1.6	✓	
168 " 300'-310'	1.6	✓	
169 " 325'-335'	0.9	✓	
170 " 361'-371'	0.7	✓	
HOLE #12 172 SECT 42.6'-45.0'	1.0	✓	
180 SECT 112.0'-115.0'	2.0	✓	
HOLE #10 181 " 113.5'-114.5'	2.6	✓	
HOLE #10 184 SECT 125.2'-125.8'	1.1	✓	
HOLE #12 163 SECT 125.2'-125.8'	1.6	✓	
164 " 125.2'-125.8'	1.5	✓	
HOLE #12 171 SECT 140.8'-141.8'	1.0	✓	
173 SECT 45.5'-46.0'	1.2	✓	
174 " 49.5'-49.0'	1.7	✓	
175 " 51.8'-52.5'	1.7	✓	
HOLE #12 176 " 57.5'-58.5'	0.9	✓	
177 " 64.5'-65.5'	Nil	✓	
178 " 68.5'-69.5'	0.9	✓	
179 " 73.8'-74.8'	1.3	✓	
HOLE #10 182 SECT 15.0'-16.0'	Trace	✓	
183 " 118.0'-119.0'	1.8	✓	
185 SECT 124.5'-126.0'	Trace	✓	
186 " 149.0'-149.5'	Trace	✓	
187 " 15.0'-16.0'	0.2	✓	
HOLE #10 188 " 147.2'-147.8'	1.3	✓	
189 " 164.5'-165.5'	0.8	✓	
190 " 170.4'-171.5'	0.9	✓	
191 " 170.5'-171.5'	0.1	✓	
HOLE #12 204 SECT 211.0'-212.0'	Trace	✓	
214 " 211.0'-212.0'	Trace	✓	
HOLE #13 215 " 327.0'-328.0'	0.1	✓	
216 " 328.0'-329.0'	Trace	✓	

Fees Received

.....
 J. L. Brisson
 Manager m

Except by special permission, reproduction of these results must include any qualifying remarks made by this department with reference to any sample.

Ministry of Natural Resources

TEMISKAMING TESTING LABORATORIES

COBALT, ONTARIO



REPORT NUMBER

CB 154

Date Oct. 3, 1972.

Telephone: 679-8313

LABORATORY REPORT

Issued to: The Grouse Syndicate, c/o Gus Shartner, Gowanda, Ont.

DESCRIPTION OF SAMPLE	SILVER OZ. PER TON	GOLD OZ. PER TON	GOLD VALUE PER TON	
HOLE #13 { #210 GAUGE 1 - 60'-70'	Trace	✓		
211 " - 70'-80'	Trace	✓		
212 " - 80'-90'	Trace	✓ (PART ONE)		
213 " - 80'-95'	Trace	✓ (PART TWO)		

Fees Received

.....
Manager *J. L. Bussan*
M.

Except by special permission, reproduction of these results must include any qualifying remarks made by this department with reference to any sample.

Ministry of Natural Resources

TEMISKAMING TESTING LABORATORIES

COBALT, ONTARIO



REPORT NUMBER

CB 158

Date Oct. 10, 1972.

Telephone: 679-8313

LABORATORY REPORT

Issued to: The Grouse Syndicate, c/o Mr. Gus Shartner, Gowganda, Ont.

DESCRIPTION OF SAMPLE	SILVER OZ. PER TON	GOLD OZ. PER TON	GOLD VALUE PER TON
D.D. 234 <small>SECT: 250'-259'</small>	Trace		
" 235 " <small>290'-299'</small>	Trace		
" 236 " <small>298'-305'</small>	Trace		
" 237 " <small>403'-413'</small>	1.2		
" 238 " <small>413'-421'</small>	0.2		
" 239 <small>SECT: 510'-519'</small>	0.1		
" 240 " <small>555'-565'</small>	0.2		
" 241 " <small>552'-560'</small>	0.1		
" 242 " <small>620'-634'</small>	0.1		
" 243 " <small>634'-640'</small>	0.3		
" 244 <small>SECT: 640'-645'</small>	Trace		
" 245 " <small>714'-722'</small>	Trace		
" 246 " <small>745'-756'</small>	Trace		
" 247 " <small>765'-780'</small>	Trace		
" 248 " <small>785'-792'</small>	Trace		
" 249 <small>SECT: 790'-796'</small>	Trace		
" 250 " <small>815'-819'</small>	Trace		
" 251 " <small>840'-900'</small>	Trace		
" 252 " <small>907'-912'</small>	Trace		
" 253 " <small>917'-927'</small>	Trace		

Fees Received

.....
 Manager *J. L. Brisson*
 m.

Except by special permission, reproduction of these results must include any qualifying remarks made by this department with reference to any sample.

Ministry of Natural Resources

TEMISKAMING TESTING LABORATORIES

~~DEPARTMENT OF MINES AND TECHNICAL SURVEYING~~

COBALT, ONTARIO



REPORT NUMBER

CB 159

Date Oct. 11, 1972.

Telephone: 679-8313

LABORATORY REPORT

Issued to: The Grouse Syndicate, c/o Gus Shartner, Gowganda, Ont.

DESCRIPTION OF SAMPLE	SILVER OZ. PER TON	GOLD OZ. PER TON	GOLD VALUE PER TON
#225 SLUDGE - 19' + 30'	0.8		
226 " 30' + 46'	Trace		
227 " 48' + 50'	Trace		
228 " 50' - 60'	Trace		
DD.H. M 14 { 229 " 60' - 70'	Trace		
230 SLUDGE - 70' - 80'	Trace		
231 " 80' - 90'	Trace		
232 " 90' + 100'	Trace		
233 " 100' + 100'	Trace		

Fees Received

Manager

J. L. Brisson
M.

Except by special permission, reproduction of these results must include any qualifying remarks made by this department with reference to any sample.

Ministry of Natural Resources

TEMISKAMING TESTING LABORATORIES

~~DEPARTMENT OF MINES AND TECHNICAL SURVEYING~~

COBALT, ONTARIO



ONTARIO

REPORT NUMBER

CB 162

Date Oct. 16, 1972.

Telephone: 679-8313

LABORATORY REPORT

Issued to: The Grouse Syndicate, c/o Gus Shartner, Gowanda, Ont.

DESCRIPTION OF SAMPLE	SILVER OZ. PER TON	GOLD OZ. PER TON	GOLD VALUE PER TON
#257 SLUDGE 5'-10'	Trace		
258 " 10'-20'	Nil		
259 " 20'-30'	Nil		
HOLE #15 { 260 " 30'-40'	1.8		
261 " 50'-60'	0.8		
262 " 60'-70'	1.0		
263 " 70'-80'	0.5		
D.D. 254 SECT. 19.0'-19.3'	1.5		
HOLE #15 { 255 " 23.8'-24.1'	0.9		
256 " 26.2'-26.0'	0.3		
264 SECT. 29.5'-30.5'	Trace		
265 " 32.1'-32.6'	0.4		
266 " 39.6'-39.6'	0.7		
267 " 42.0'-43.0'	Trace		
268 " 43.5'-44.5'	Nil		
269 SECT. 50.5'-51.5'	0.4		
270 " 66.0'-67.0'	Trace		
271 " 70.0'-71.4'	1.1		
272 " 73.5'-74.5'	0.2		
273 " 78.8'-79.3'	Nil		
HOLE #15 { 274 SECT. 80.5'-81.3'	0.3		
275 " 82.5'-83.5'	0.1		
276 " 88.5'-89.5'	0.1		
277 " 92.5'-87.5'	Nil		
278 " 91.0'-92.0'	Trace		
279 SECT. 93.1'-94.0'	Nil		
280 " 94.0'-95.0'	Nil		
281 " 96.0'-97.0'	Trace		
282 " 97.0'-98.5'	Trace		
283 " 98.0'-99.0'	Trace		
284 SECT. 102.2'-102.2'	Trace		
285 " 107.8'-108.5'	0.4		
286 " 112.7'-113.7'	1.3		

Fees Received

.....
 Manager *J. L. Buisson*

Except by special permission, reproduction of these results must include any qualifying remarks made by this department with reference to any sample.



Issued to: The Grouse Syndicate, c/o Gus Shartner, Gowganda, Ont.

DESCRIPTION OF SAMPLE		SILVER OZ. PER TON	GOLD OZ. PER TON	GOLD VALUE PER TON
D.D. 287	SECT: 11.2' to 11.7'	0.3	✓	
288	" 17.5' to 18.0'	Trace	✓	
289	" 24.3' to 24.7'	Trace	✓	
290	" 45.4' to 46.1'	Trace	✓	
291	" 48.1' to 48.5'	Trace	✓	
292	" 62.3' to 62.6'	1.5	✓	
293	" 69.4' to 69.9'	Nil	✓	
294	" 74.0' to 74.6'	0.2	✓	

Fees Received

Manager

J. L. Brisson
M.

Except by special permission, reproduction of these results must include any qualifying remarks made by this department with reference to any sample.

Ministry of Natural Resources

TEMISKAMING TESTING LABORATORIES

~~BRIDGE ROAD, COBALT, ONTARIO~~

COBALT, ONTARIO



ONTARIO

REPORT NUMBER

CB 168

Date Oct. 20, 1972.

Telephone: 679-8313

LABORATORY REPORT

Issued to: The Grouse Syndicate, c/o Gus Shartner, Gowganda, Ont.

DESCRIPTION OF SAMPLE	SILVER OZ. PER TON	GOLD OZ. PER TON	GOLD VALUE PER TON
#295 SLUDGE - 5' to 20'	Trace		
296 " - 20' - 30'	Trace		
297 " - 30' - 40'	0.3		
298 " - 40' - 50'	0.2		
299 " - 50' - 60'	Trace		
D.D. 300 SECT: 83.6' - 84.5'	0.2		
301 " 86.7' - 87.7'	Trace		
302 " 92.2' - 93.2'	Trace		
303 " 96.0' - 96.4'	Trace		
304 " 102.0' - 102.3'	Trace		
305 " 119.5' - 121.5'	0.2		
306 " 131.0' - 132.0'	Trace		
307 " 133.0' - 133.5'	Trace		
308 " 148.8' - 149.8'	0.9		
309 " 151.0' - 151.5'	0.4		
#310 SLUDGE - 9' - 20'	Trace		
311 " - 20' - 30'	Trace		
312 " - 30' - 40'	Trace		
313 " - 40' - 50'	Nil		
314 " - 50' - 60'	0.3		
315 " - 60' - 70'	Trace		
316 " - 70' - 80'	Trace		
D.D. 317 SECT: 20.0' to 21.0'	Trace		
318 " 21.0' to 22.0'	Trace		
319 " 24.0' to 24.5'	Trace		
320 " 29.0' to 29.5'	Trace		
321 " 41.4' to 41.8'	Trace		
322 " 48.0' to 48.5'	Trace		
323 " 54.0' to 55.0'	Trace		
324 " 57.5' to 57.5'	Trace		
325 " 62.7' to 63.7'	0.1		
326 " 64.5' to 65.5'	0.2		
327 " 68.5' to 69.5'	0.3		

Fees Received

.....
 J. L. Brinn
 Manager m.

Except by special permission, reproduction of these results must include any qualifying remarks made by this department with reference to any sample.

Ministry of Natural Resources

TEMISKAMING TESTING LABORATORIES

~~DEPARTMENT OF MINES AND TECHNICAL SURVEYS~~

COBALT, ONTARIO



ONTARIO

REPORT NUMBER

CB 169

Date Oct. 20, 1972.

Telephone: 679-8313

LABORATORY REPORT

Issued to: The Grouse Syndicate, c/o Gus Shartner, Gowganda, Ont.

DESCRIPTION OF SAMPLE	SILVER OZ. PER TON	GOLD OZ. PER TON	GOLD VALUE PER TON
<i>D.O. N. No. 77</i> #328 SECT: 70.8' to 71.8'	Trace	✓	
329 " 81.0' to 81.0'	Trace	✓	
330 " 81.0' to 82.0'	Trace	✓	
<i>D.O. N. No. 17</i> 334 SLUDGE - 80' to 90'	0.3	✓	
335 " - 90' to 100'	0.2	✓	
336 SLUDGE - 17' - 30'	0.8	✓	
337 " - 30' - 40'	0.1	✓	
338 " - 40' - 50'	Trace	✓	
339 " - 50' - 60'	Trace	✓	
340 SLUDGE - 60' - 70'	Trace	✓	
341 " - 70' - 80'	0.1	✓	
<i>D.O. N. No. 16</i> 342 " - 80' - 90'	0.2	✓	
343 " - 90' - 100'	0.3	✓	
344 SLUDGE - 100' - 110'	0.1	✓	
345 " - 110' - 120'	0.2	✓	
346 " - 120' - 130'	0.5	✓	
347 " - 138' - 138'	Nil	✓	
348 SLUDGE - 138' - 148'	Trace	✓	
349 " - 148' - 158'	0.4	✓	

Fees Received

.....
 Manager *J.R. Buzin*
 M.

Except by special permission, reproduction of these results must include any qualifying remarks made by this department with reference to any sample.

Ministry of Natural Resources
 TEMISKAMING TESTING LABORATORIES



REPORT NUMBER

CB 170

DEPARTMENT OF MINES AND TECHNICAL SURVEYS
 COBALT, ONTARIO

Telephone: 679-8313

LABORATORY REPORT

Date Oct. 23, 1972.

Issued to: The Grouse Syndicate, c/o Gus Shartner, Gowganda, Ont.

DESCRIPTION OF SAMPLE	SILVER OZ. PER TON	GOLD OZ. PER TON	GOLD VALUE PER TON
D.D. 331 SECT 82.0' - 83.0'	Trace	✓	
O.M. No. 17 332 " 84.5' - 85.5'	0.7	✓	
333 " 93.0' - 93.5'	Trace	✓	
350 SECT 27.0' - 28.0'	Trace	✓	
351 " 52.0' - 53.0'	Trace	✓	
352 " 84.5' - 85.0'	0.6	✓	
353 " 91.6' - 100.1'	Trace	✓	
354 SECT 101.3' - 101.4'	Trace	✓	
355 " 112.0' - 113.0'	Trace	✓	
356 " 113.0' - 113.9'	Trace	✓	
357 " 115.6' - 116'	0.2	✓	
358 SECT 116.5' - 117.5'	Trace	✓	
359 " 117.5' - 118.5'	0.2	✓	
360 " 118.5' - 119.5'	0.3	✓	
361 " 121.3' - 121.8'	0.2	✓	
362 SECT 124.1' - 124.4'	0.4	✓	
363 " 134.5' - 135.0'	Trace	✓	
O.M. No. 18 364 " 136.0' - 136.5'	Nil	✓	
365 " 136.5' - 137.5'	Trace	✓	
366 SECT 151.5' - 152.5'	Nil	✓	
367 " 157.5' - 159.0'	Trace	✓	
368 " 159.0' - 161.0'	Nil	✓	
369 " 164.0' - 165.5'	0.2	✓	
370 " 165.5' - 167.0'	0.1	✓	
371 " 167.0' - 168.0'	Trace	✓	
372 " 173.0' - 174.0'	0.2	✓	
373 " 175.0' - 175.5'	Trace	✓	
374 " 177.0' - 177.5'	Trace	✓	
375 " 186.0' - 262.0'	Trace	✓	

Not Received

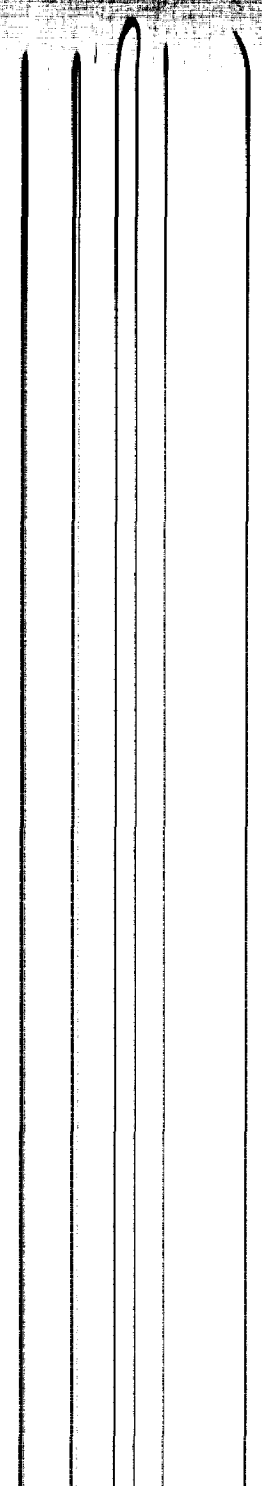

Ministry of Natural Resources

TEMISKAMING TESTING LABORATORIES

~~DEPARTMENT OF MINES AND TECHNICAL SURVEYS~~

COBALT, ONTARIO



ONTARIO

REPORT NUMBER

CB 170

Date Oct. 23, 1972.

Telephone: 679-8313

LABORATORY REPORT

Issued to: The Grouse Syndicate, c/o Gus Shartner, Gowganda, Ont.

DESCRIPTION OF SAMPLE	SILVER OZ. PER TON	GOLD OZ. PER TON	GOLD VALUE PER TON
D.D. 331 SECT. 82.0' - 83.0'	Trace ✓		
332 " 84.5' - 85.5'	0.7 ✓		
333 " 93.0' - 93.5'	Trace ✓		
350 SECT. 270' - 280'	Trace ✓		
351 " 52.0' - 53.0'	Trace ✓		
352 " 84.5' - 85.0'	0.6 ✓		
353 " 99.6' - 100.1'	Trace ✓		
354 SECT. 101.3' - 101.9'	Trace ✓		
355 " 112.0' - 113.0'	Trace ✓		
356 " 113.0' - 113.5'	Trace ✓		
357 " 115.6' - 116'	0.2 ✓		
358 SECT. 116.5' - 117.5'	Trace ✓		
359 " 117.5' - 118.5'	0.2 ✓		
360 " 118.5' - 119.5'	0.3 ✓		
361 " 121.5' - 121.8'	0.2 ✓		
362 SECT. 126.1' - 126.4'	0.4 ✓		
363 " 134.5' - 135.0'	Trace ✓		
364 " 135.0' - 136.5'	Nil ✓		
365 " 136.5' - 137.5'	Trace ✓		
366 SECT. 151.5' - 152.5'	Nil ✓		
367 " 157.5' - 159.0'	Trace ✓		
368 " 159.0' - 161.5'	Nil ✓		
369 " 164.1' - 165.5'	0.2 ✓		
370 SECT. 165.5' - 167.0'	0.1 ✓		
371 " 167.0' - 168.0'	Trace ✓		
372 " 173.0' - 174.0'	0.2 ✓		
373 " 175.0' - 175.5'	Trace ✓		
374 SECT. 177.0' - 177.5'	Trace ✓		
375 " 186.0' - 202.0'	Trace ✓		

Fees Received

.....
 J. L. Brisson
 Manager m.

Except by special permission, reproduction of these results must include any qualifying remarks made by this department with reference to any sample.

Ministry of Natural Resources

TEMISKAMING TESTING LABORATORIES

~~DEPARTMENT OF MINES AND TECHNICAL SURVEYS~~

COBALT, ONTARIO



ONTARIO

REPORT NUMBER

CB 173

Telephone: 679-8313

LABORATORY REPORT

Date Oct. 21, 1972.
30

Issued to: The Grouse Syndicate, c/o Mr. Gus Shartner, Gowganda, Ont.

DESCRIPTION OF SAMPLE	SILVER OZ. PER TON	GOLD OZ. PER TON	GOLD VALUE PER TON	Silver oz.
D.O.H. #20 #405 SLUDGE - 70' to 80'	0.4			D.O.H. #19 D.D. 395 SECT: 76.0' to 77.0' Trace ✓
D.O.H. #21 421 SLUDGE - 50' to 60'	Trace			D.O.H. #19 398 SECT: 81.5' to 82.5' Trace ✓
D.O.H. #19 379 SLUDGE - 40' to 50'	0.2			
380 " - 50' to 60'	0.1			
D.O.H. #19 383 SLUDGE - 80' to 90'	Trace			D.O.H. #20 408 SECT: 58.5' to 59.5' 0.2 ✓
D.O.H. #21 417 SLUDGE - 7' to 20'	Trace			
D.O.H. #19 381 SLUDGE - 60' to 70'	Trace			
D.O.H. #19 384 SLUDGE - 9' to 98'	0.2			
D.O.H. #20 401 SLUDGE - 30' to 40'	Trace			
402 " - 10' to 50'	Trace			
D.O.H. #20 399 SLUDGE - 10' to 20'	Trace			
400 " - 20' to 30'	Trace			
D.O.H. #20 403 SLUDGE - 50' to 60'	Trace			
406 SLUDGE - 80' to 90'	Trace			
D.O.H. #20 407 " - 90' to 97'	Trace			
D.O.H. #21 419 SLUDGE - 30' to 40'	Trace			
D.O.H. #20 404 SLUDGE - 60' to 70'	Trace			
D.O.H. #21 420 SLUDGE - 40' to 50'	1.8			
D.D. 388 SECT: - 43.0' to 43.5'	1.4			
D.O.H. #19 396 SECT: - 81.2' to 81.6'	1.1			
D.O.H. #19 392 SECT: - 56.5' to 56.9'	0.1			
D.O.H. #20 416 SECT: - 94.0' to 95.0'	0.1			
D.O.H. #19 390 SECT: - 47.5' to 48.5'	0.3			
D.O.H. #21 434 SECT: - 98.6' to 99.6'	Trace			
D.O.H. #19 389 SECT: - 46.5' to 47.5'	Trace			
D.O.H. #19 397 SECT: - 86.5' to 86.5'	Trace			
D.O.H. #20 411 SECT: - 76.0' to 76.3'	0.2			
D.O.H. #19 386 SECT: - 28.2' to 29.7'	Trace			
387 " - 38.5' to 39.5'	Trace			
D.O.H. #19 391 SECT: - 55.0' to 55.5'	Trace			
D.O.H. #19 393 SECT: - 63.4' to 64.4'	Trace			
394 " - 66.0' to 67.0'	Trace			
D.O.H. #19 385 SECT: - 22.5' to 23.0'	1.3			

Fees Received 36 Coupons, Cards 0033 & 0034.

Manager J. L. Brisson
M.

Except by special permission, reproduction of these results must include any qualifying remarks made by this department with reference to any sample.

Ministry of Natural Resources

TEMISKAMING TESTING LABORATORIES

DEPARTMENT OF MINES AND TECHNICAL SURVEYS
COBALT, ONTARIO



REPORT NUMBER

CB 175

Telephone: 679-8313

LABORATORY REPORT

Date Oct. 31, 1972.

Issued to: The Grouse Syndicate, c/o Mr. Gus Shartner, Gowganda, Ont.

DESCRIPTION OF SAMPLE	SILVER OZ. PER TON	GOLD OZ. PER TON	GOLD VALUE PER TON
D.D. 409 SECT: 68.5' to 65.0'	Trace		
D.O.H. #20 410 " 70.5' to 71.5'	Trace		
412 SECT: 77.5' to 78.5'	0.2		
D.O.H. #20 413 " 81.5' to 81.8'	Trace		
414 " 84.5' to 86.5'	Trace		
415 " 90.0' to 90.5'	Trace		
427 SECT: 250.0' to 265.5'	Trace		
428 " 30.0' to 31.1'	Trace		
429 " 36.7' to 38.2'	Trace		
D.O.H. #21 430 " 36.6' to 36.8'	0.5		
431 " 39.0' to 39.3'	Trace		
432 " 47.8' to 48.5'	0.4		
433 " 93.0' to 93.7'	Trace		
D.O.H. #21 435 SECT: 119.0' to 120.0'	Trace		
#376 SLUDGE - 6' to 20'	0.8		
D.O.H. #19 377 " - 20' to 30'	Trace		
378 " - 30' to 40'	Trace		
D.O.H. #11 382 SLUDGE - 70' to 80'	Trace		
D.O.H. #20 418 SLUDGE - 20' to 30'	0.2		
422 SLUDGE - 60' to 70'	0.1		
423 " - 70' to 80'	Trace		
D.O.H. #21 424 " - 90' to 100'	Trace		
425 " - 110' to 110'	0.3		
426 " - 110' to 125'	Trace		

Fees Received

Manager

J. L. Brissard
M.

Except by special permission, reproduction of these results must include any qualifying remarks made by this department with reference to any sample.

265418

CLAIM No 265419

265420

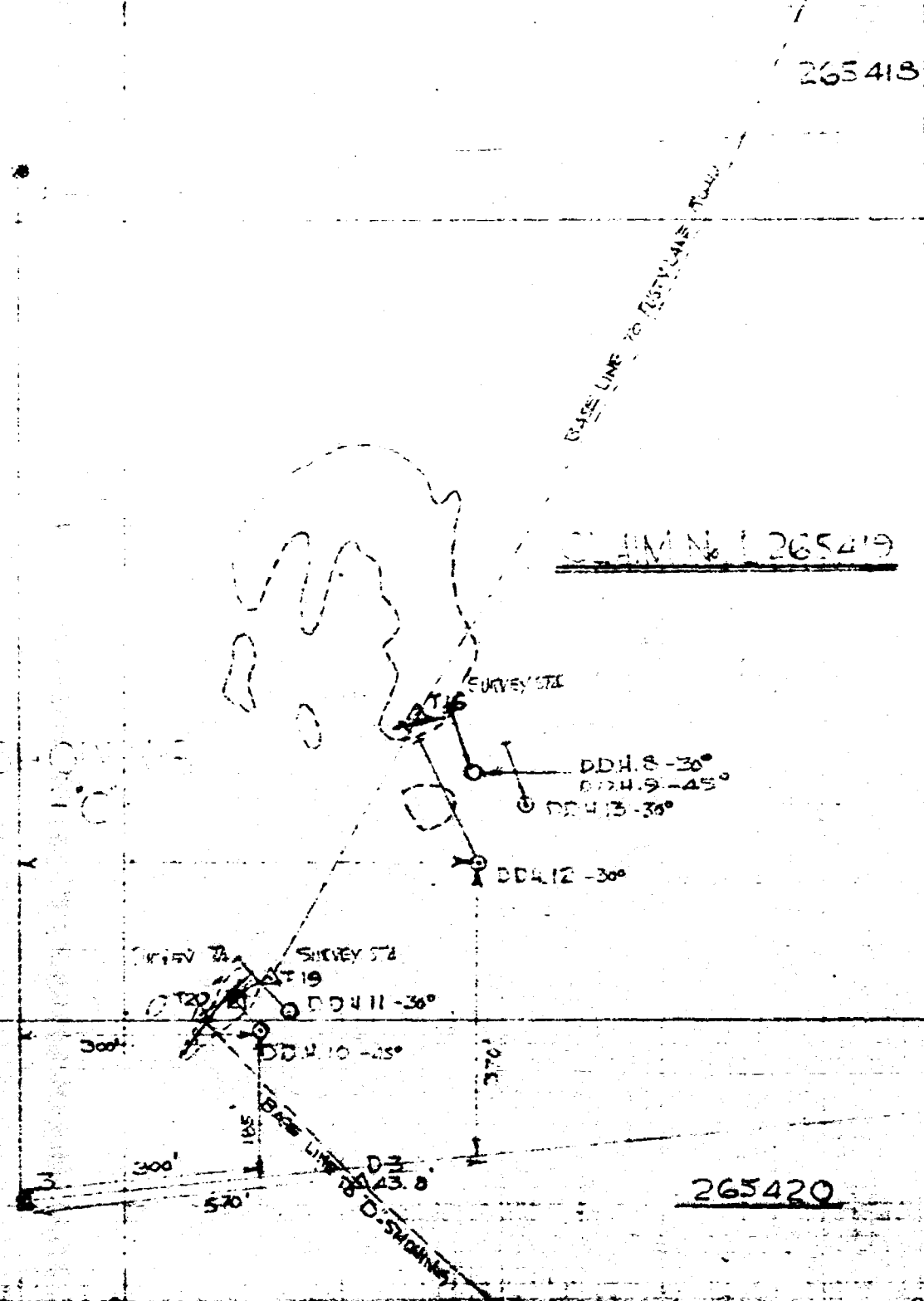

*Charters Twp
 Report # 99-73
 Gustave Hines*

CHARTERS TWP
LOCATION OF DDH^s No 8-9
APPROX SCALE:-1"=200'

5000

5000

DDH5-40°

DDH6-30°

DDH7-30°

5000

265417

265437

DDH3-45°

DDH4-60°

DDH11A
-38°

DDH1-30°

DDH2-45°

TRUSTY
LAKE

265436

265418

BASIS LINE

CONFIDENTIAL (CONFIDENTIAL)

4000

265419

265425

CONFIDENTIAL (CONFIDENTIAL)

3000

SECTION 10-1

DD Form 11

PLAN SECTION OF

SLUDGE CANALS

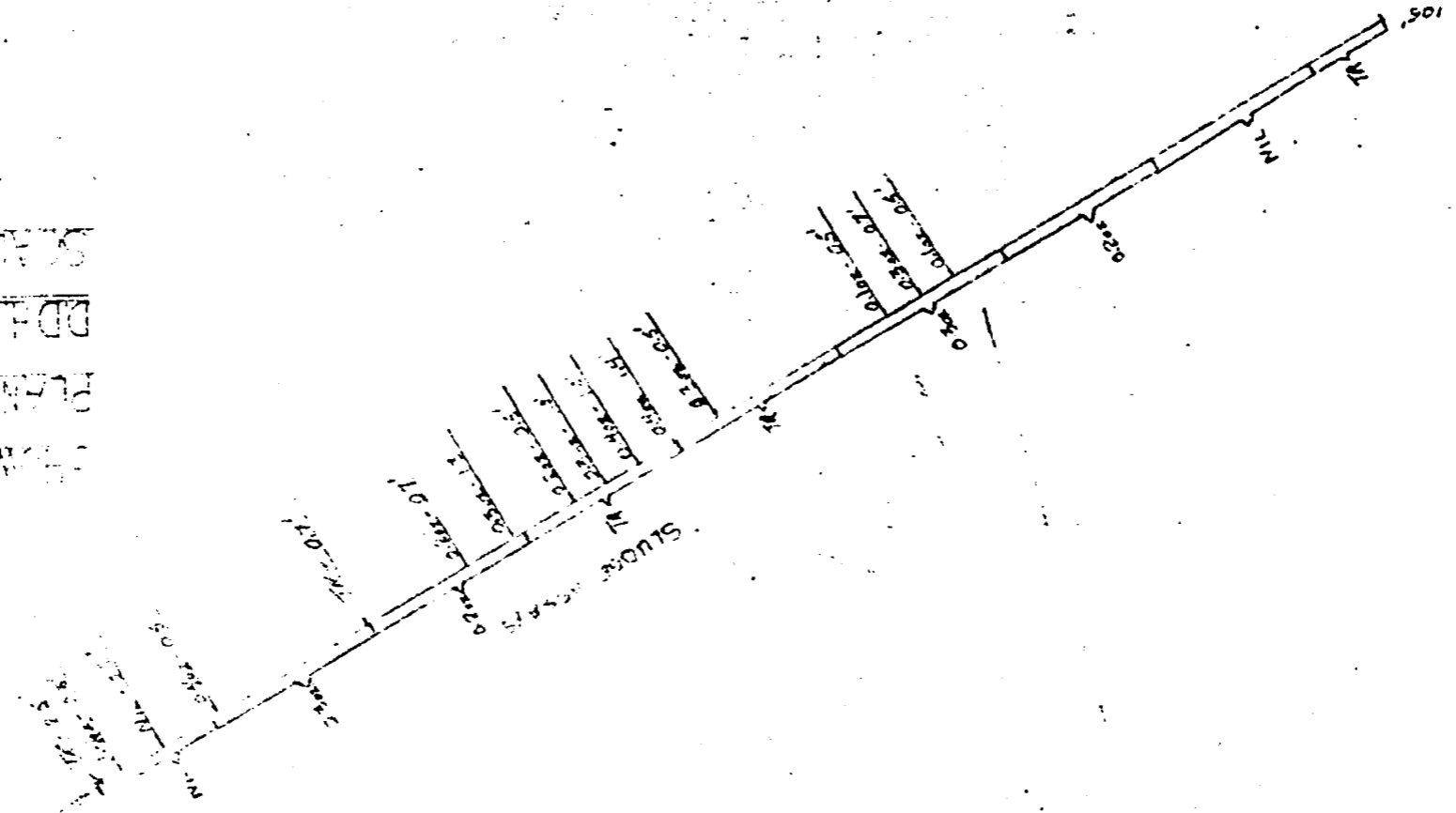

SECTION

PLAN

DD Form 11

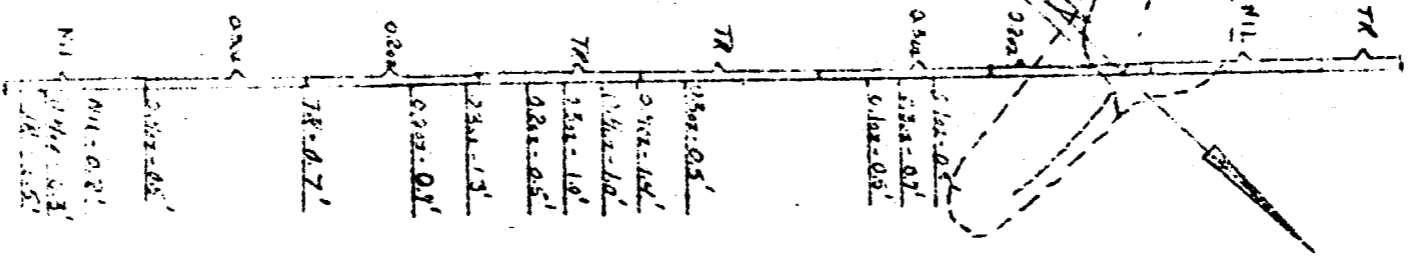

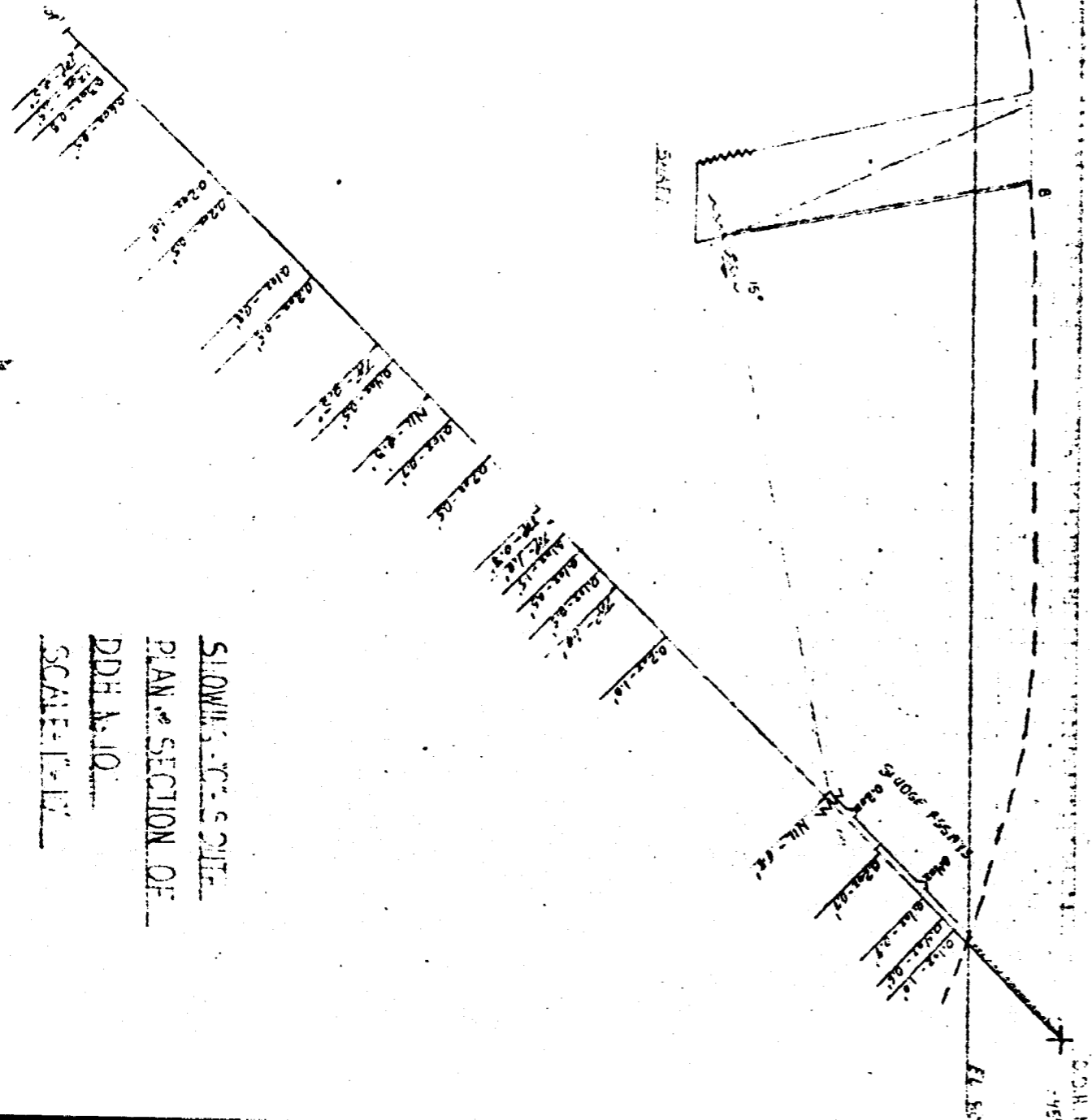

SECTION

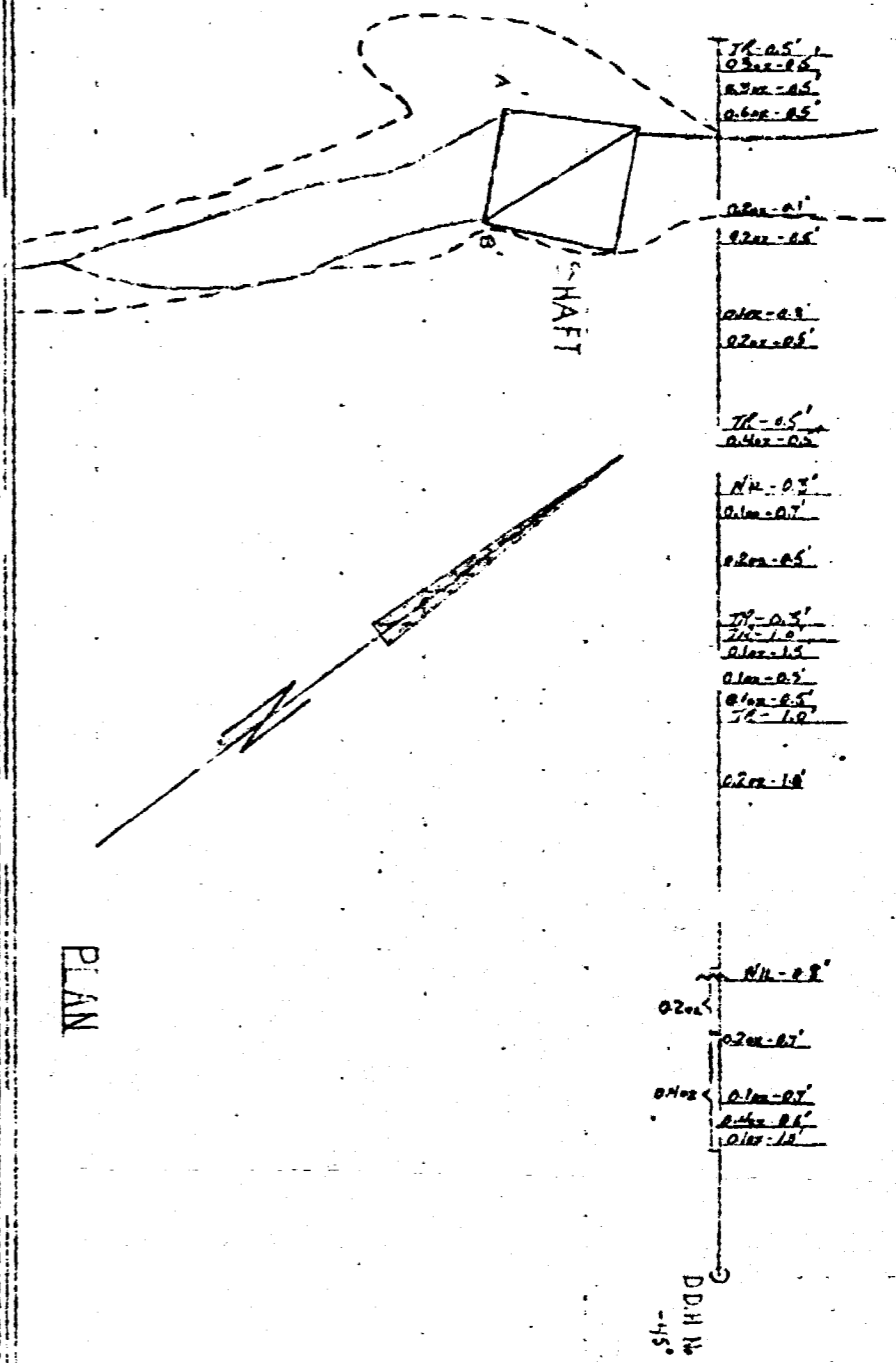

PLAN

SHOWING CROSS SECTION OF
PLAN SECTION OF
DDE AND
SCALE 1" = 10'

DDH 11
-45'

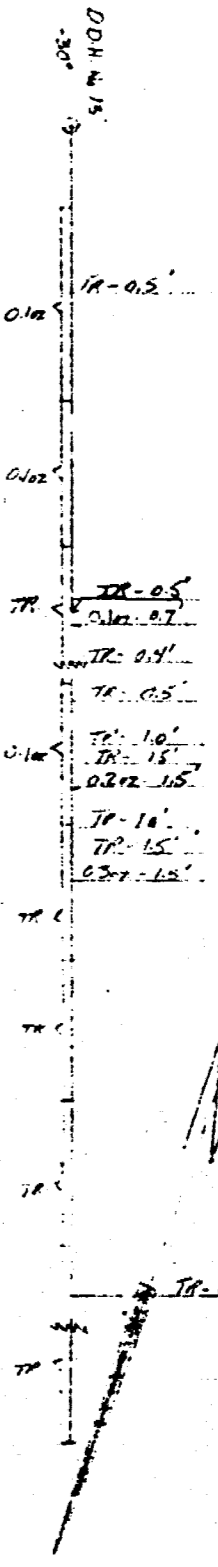

PL 11

SECTION

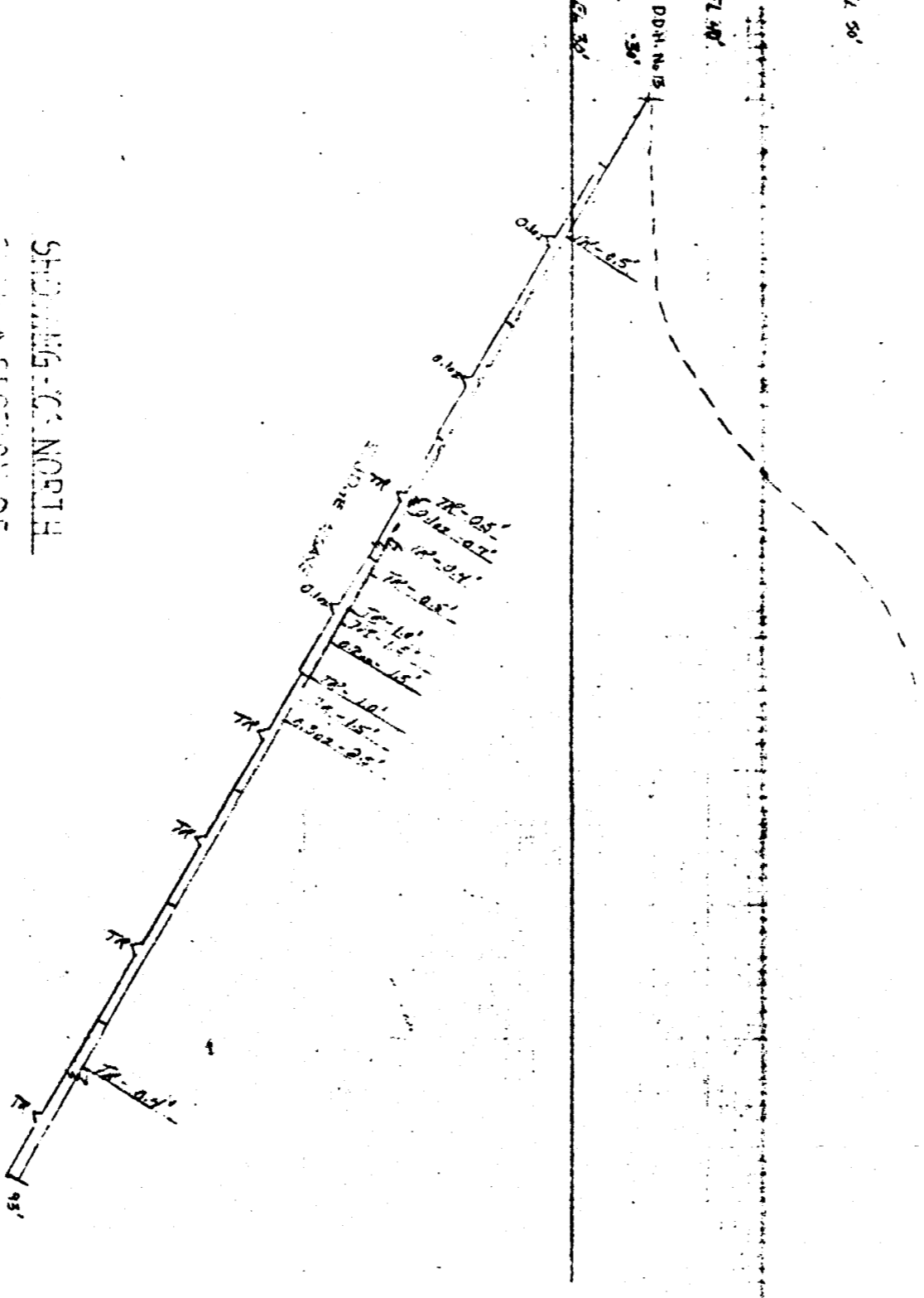

SHOULDER TO NORTH
 ELEM SECTION DE
 DDH No. 13
 SCALE 1"=10'

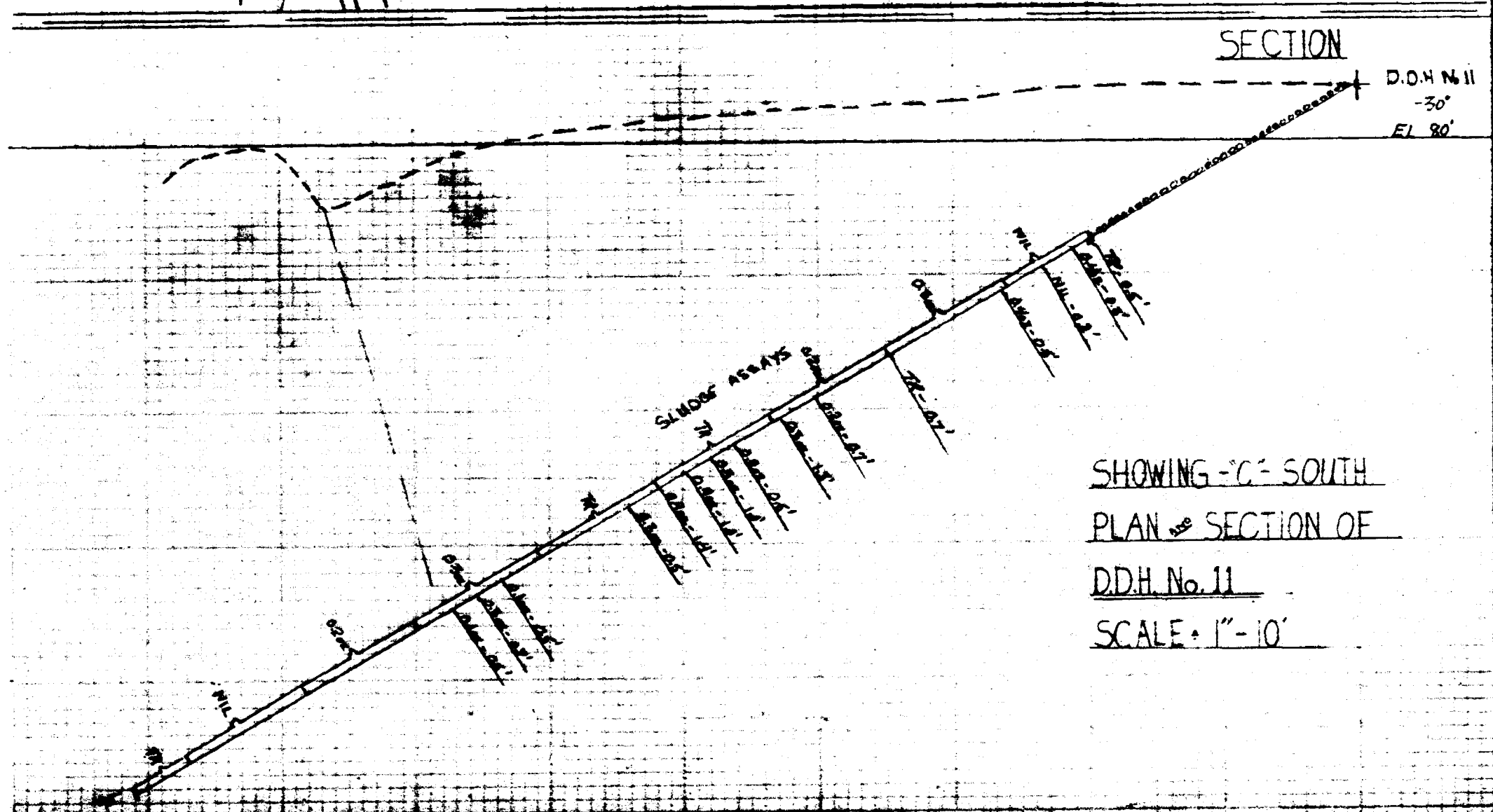
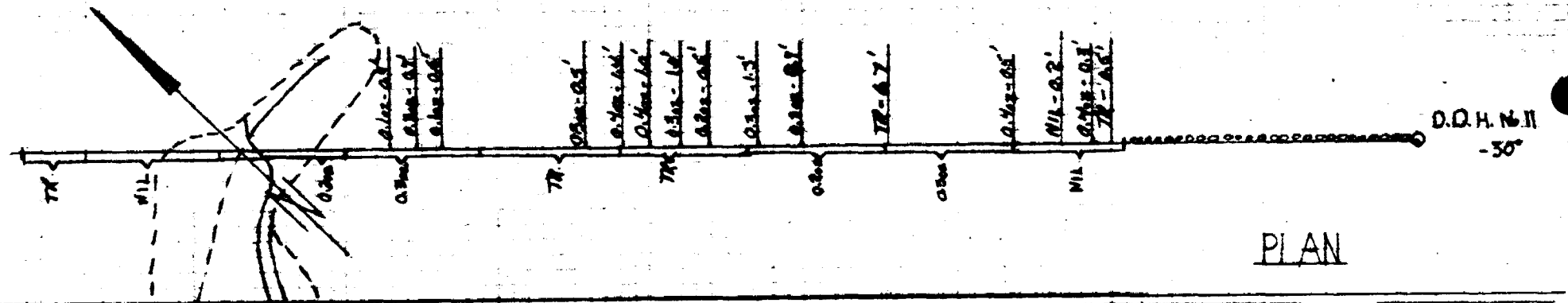

SHOWING "C" SOUTH
 PLAN AND SECTION OF
 D.D.H. No. 11
 SCALE = 1" = 10'

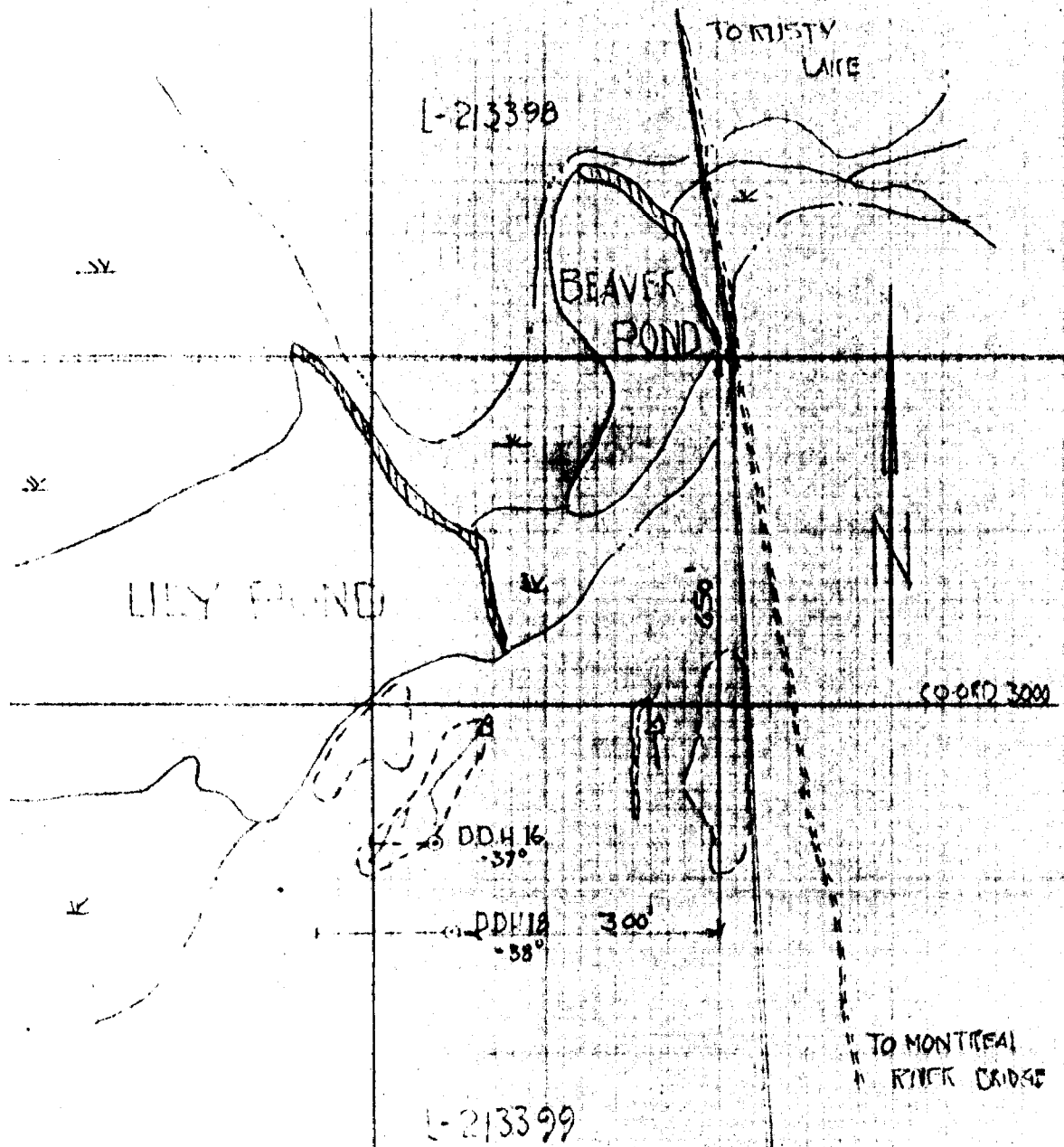

SKETCH SHOWING LOCATION OF
 DRILL HOLES Nos 5-16 AND 5-18
 SCALE - 1" = 200'

DATE 6/2/59

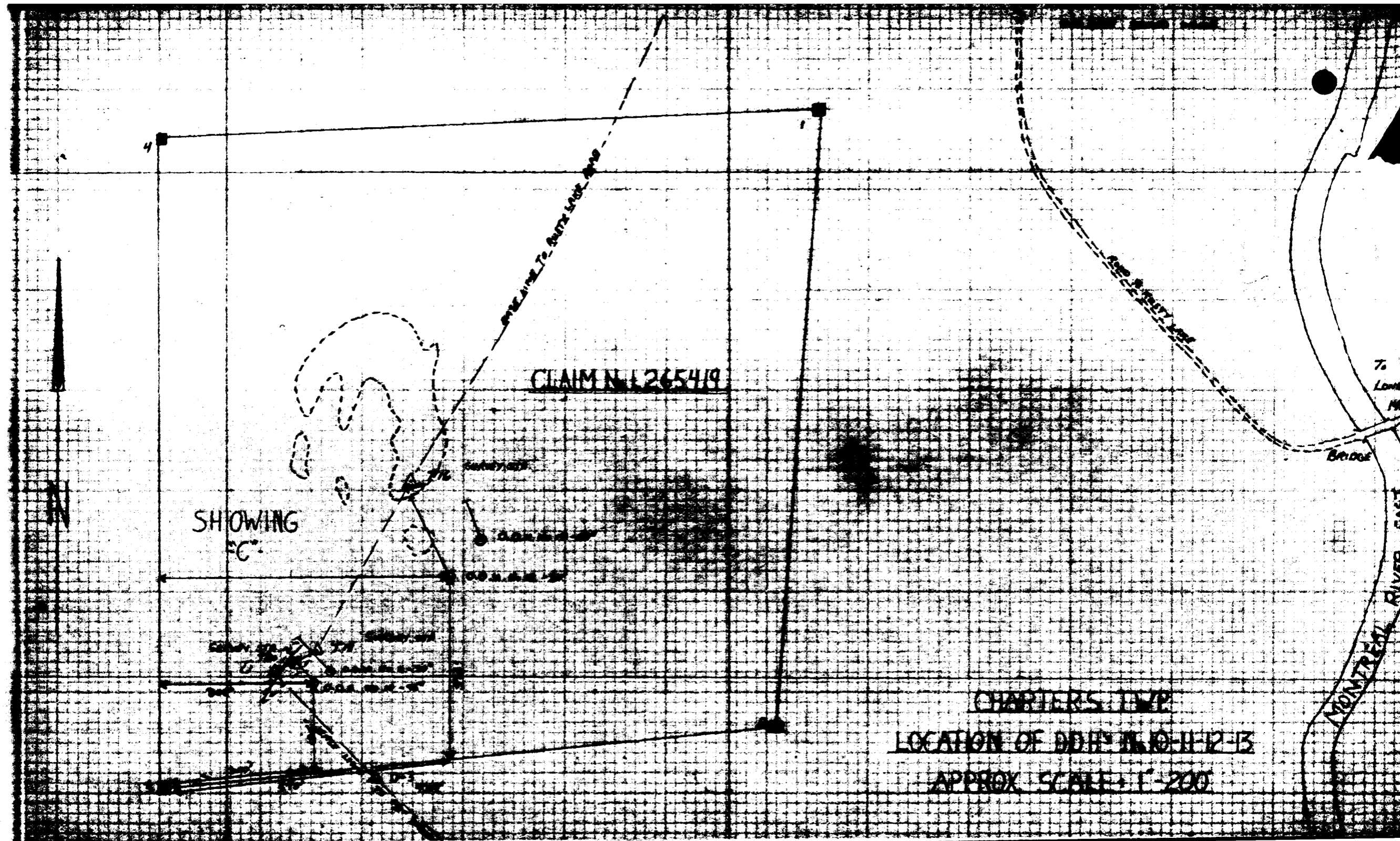

CLAIM N. 1265419

SHOWING
FC

CHARTERS IWP

LOCATION OF DDIP N. 10-11-12-13

APPROX SCALE 1" = 200'

MONTREAL RIVER EAST

Bridge

To Lower
Main

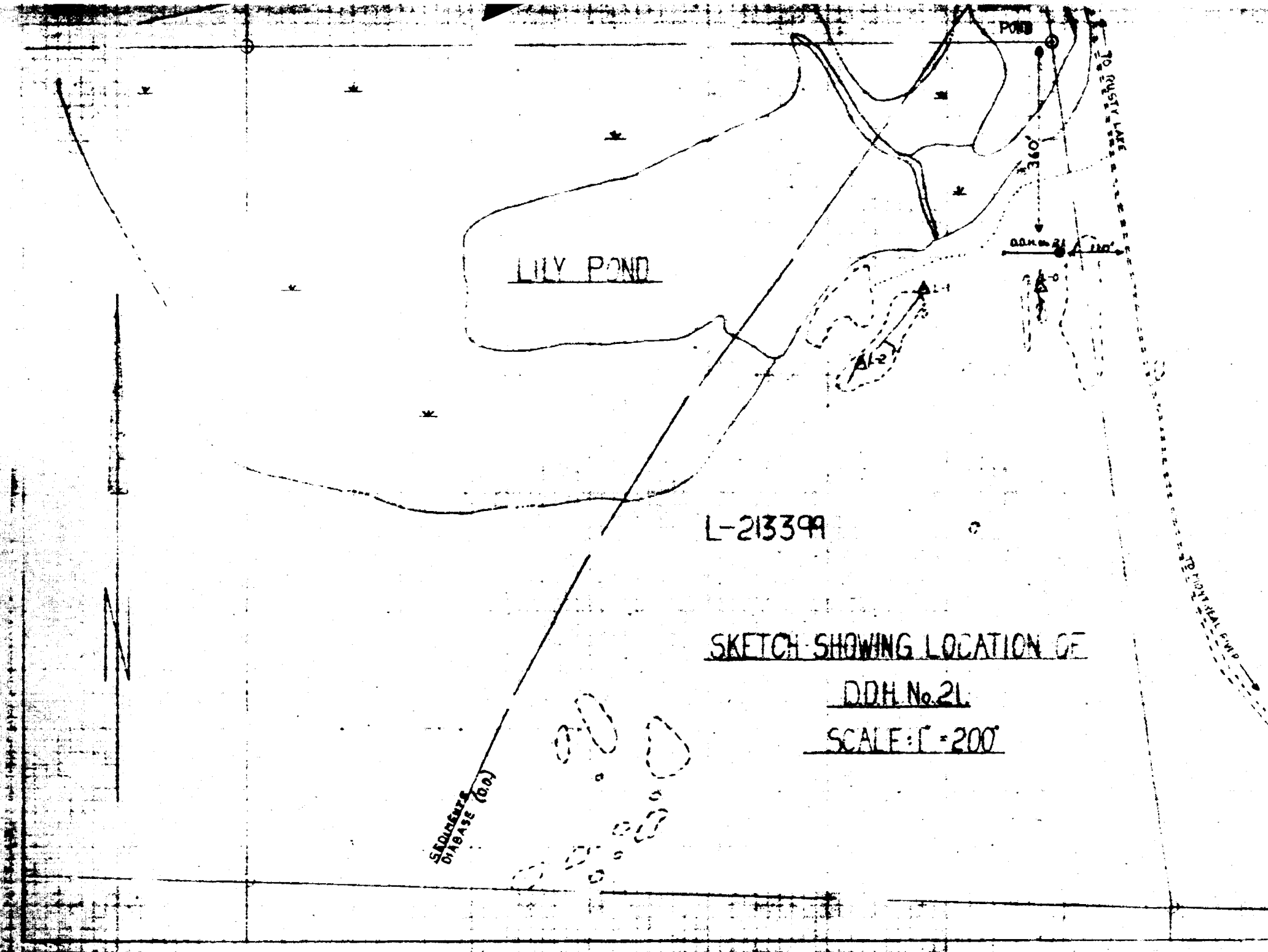

LILY POND

L-213399

SKETCH SHOWING LOCATION OF

DDH No. 21

SCALE: 1" = 200'

SADLER'S
DIABASE (D.D.)

TO RUSTY LAKE

ONE

DDH No. 21

TO RUSTY LAKE

POND



TECHNICAL ASSESSMENT WORK CREDITS

Recorder Holder

Gustave Shartner

Township or Area

Charters and Leith Townships

Type of Survey and number of Assessment Days Credits per claim

GEOPHYSICAL

Electromagneticdays

Magnetometerdays

Radiometricdays

Induced Polarizationdays

SECTION 86(18, 19 & 20) see across

GEOLOGICAL.....days

GEOCHEMICAL.....days

Man days

Airborne

Special Provision

Ground

NOTICE OF INTENT TO BE ISSUED

Credits have been reduced because of partial coverage of claims.

Credits have been reduced because of corrections to work dates and figures of applicant.

NO CREDITS have been allowed for the following mining claims as they were not sufficiently covered by the survey:

ASSAYING

- Diamond Drilling -

Location of (21) Drill Holes:

L. 213399

265417 to 19 inclusive

265436 - 37

Amount expended on assaying (399) core samples = \$798.00

Total assessment days credit allowed = 53

The above six mining claims may be grouped under Section 85 (6) for the purposes of recording the work credits of 53 days.

Leo Benier

Approved - October 5, 1973

The Mining Recorder may reduce the above credits if necessary in order that the total number of approved assessment days recorded on each claim does not exceed the maximum allowed as follows: Geophysical - 60; Geological - 40; Geochemical - 40;

SIS.M

CHARTERS 1b.

SIS.M

SIS.M

CHARTERS 1b.

SIS.M

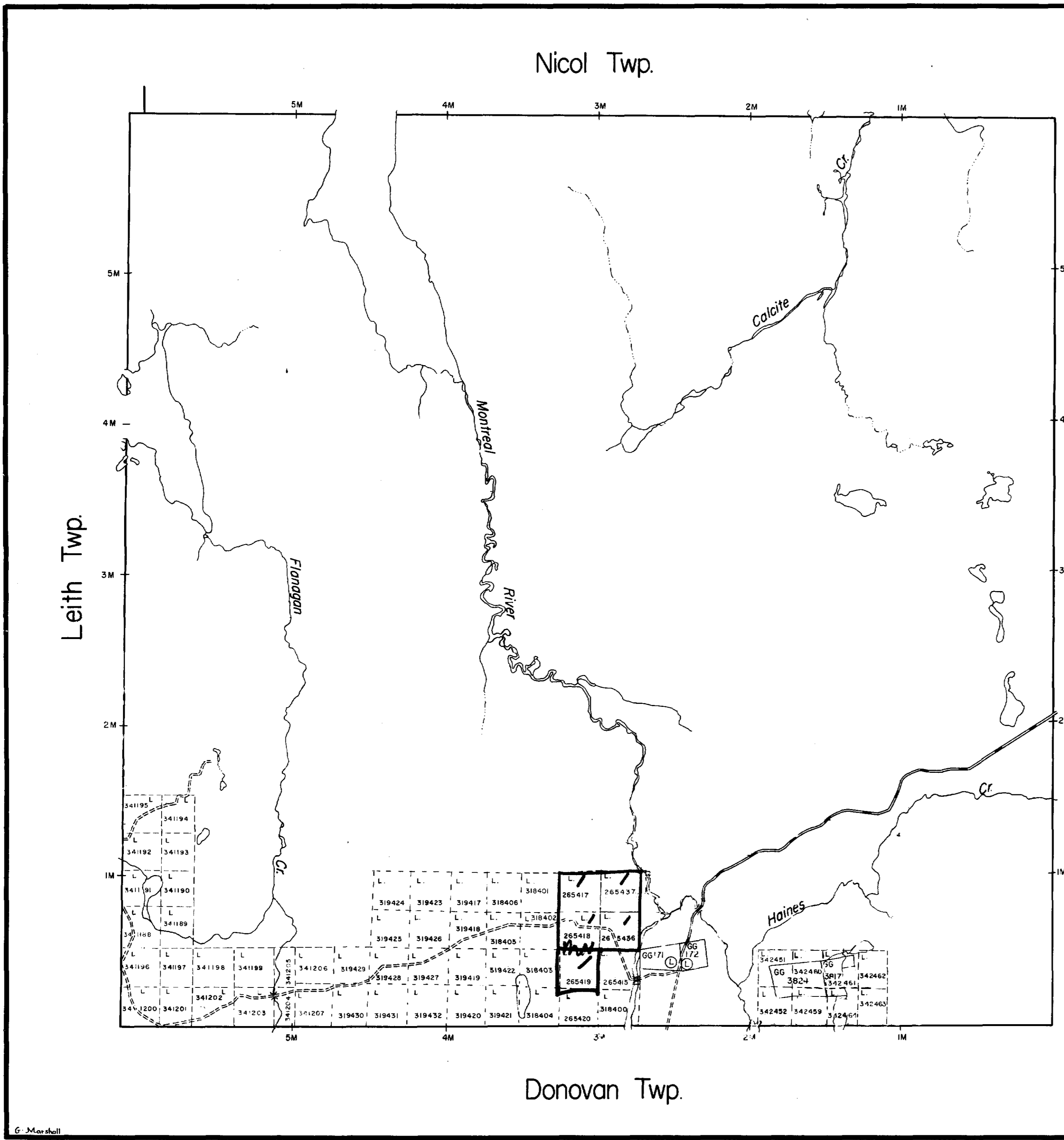

THE TOWNSHIP
OF
CHARTERS
DISTRICT OF
TIMISKAMING
LARDER LAKE
MINING DIVISION
SCALE: 1-INCH=40 CHAINS

LEGEND

PATENTED LAND	⊕
CROWN LAND SALE	C.S.
LEASES	⊙
LOCATED LAND	Loc.
LICENSE OF OCCUPATION	L.O.
MINING RIGHTS ONLY	M.R.O.
SURFACE RIGHTS ONLY	S.R.O.
ROADS	—
IMPROVED ROADS	—
KING'S HIGHWAYS	—
RAILWAYS	—
POWER LINES	—
MARSH OR MUSKEG	—
MINES	⋈

NOTES
400' Surface rights reservation around all lakes and rivers.

MINING LANDS -
DATE OF ISSUE
AUG 16 1973
MINISTRY
OF NATURAL RESOURCES

PLAN NO - M. 212
ONTARIO
MINISTRY OF NATURAL RESOURCES
SURVEYS AND MAPPING BRANCH

2.1271



W-521

LEITH TWP

W-521

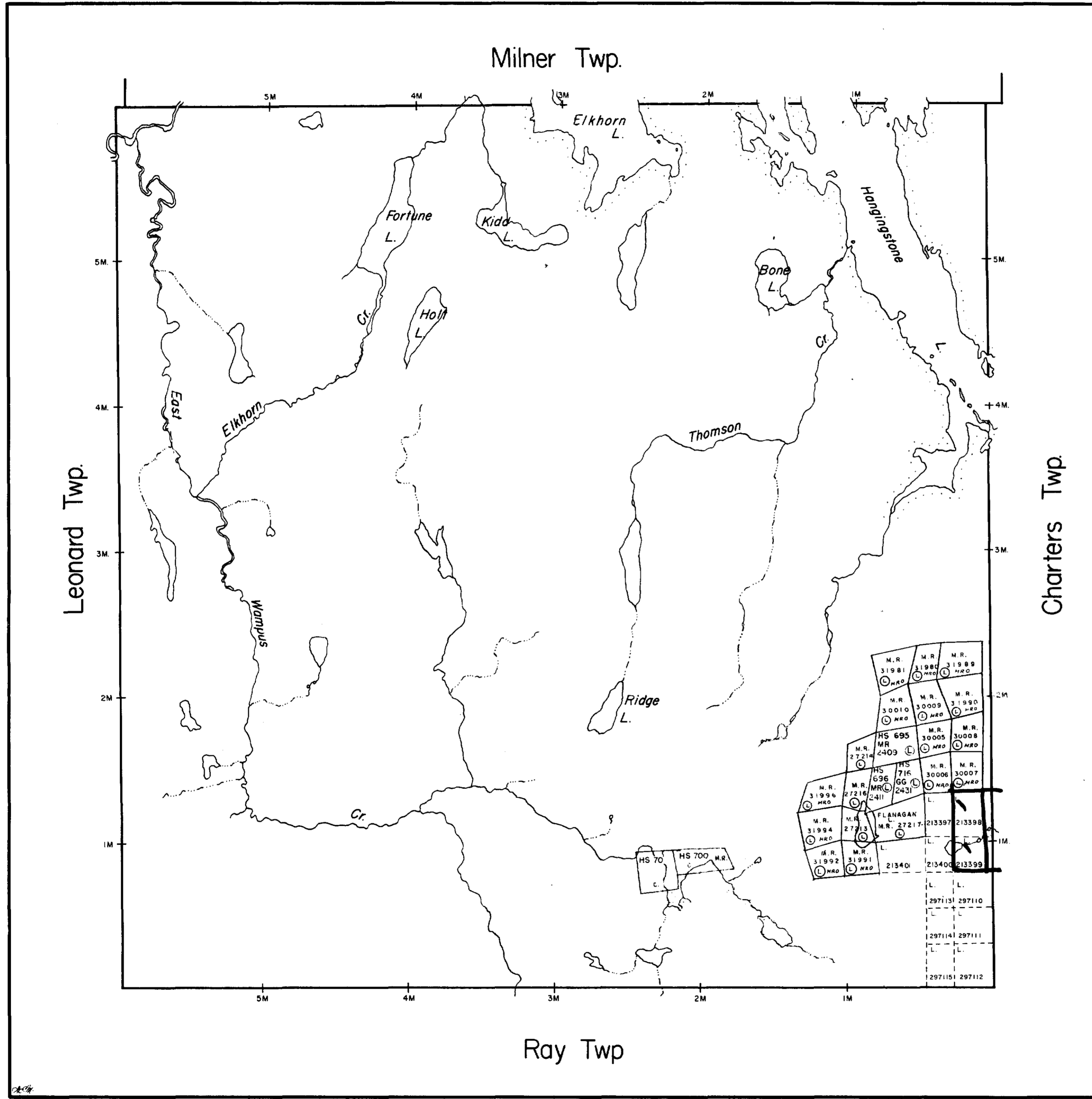

THE TOWNSHIP
OF
LEITH
DISTRICT OF
TIMISKAMING
LARDER LAKE
MINING DIVISION
SCALE: 1-INCH=40 CHAINS

LEGEND

PATENTED LAND	⊙
CROWN LAND SALE	C.S.
LEASES	⊙
LOCATED LAND	Loc.
LICENSE OF OCCUPATION	L.O.
MINING RIGHTS ONLY	M.R.O.
SURFACE RIGHTS ONLY	S.R.O.
ROADS	
IMPROVED ROADS	
KING'S HIGHWAYS	
RAILWAYS	
POWER LINES	
MARSH OR MUSKEG	
MINES	

NOTES

400' Surface rights reservation around all lakes and rivers.

- MINING LANDS -
DATE OF ISSUE
SEP 11 1973
MINISTRY
OF NATURAL RESOURCES

PLAN NO - M-231
ONTARIO
MINISTRY OF NATURAL RESOURCES
SURVEYS AND MAPPING BRANCH

W-521

LEITH TWP

W-521

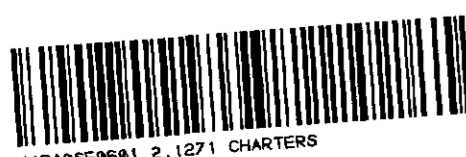

2.1271

D.D.H. No. 12

PLAN

SECTION

EL 90'

EL 80'

EL 70'

EL 60'

EL 50'

EL 40'

EL 30'

D.D.H. No. 12

-30'

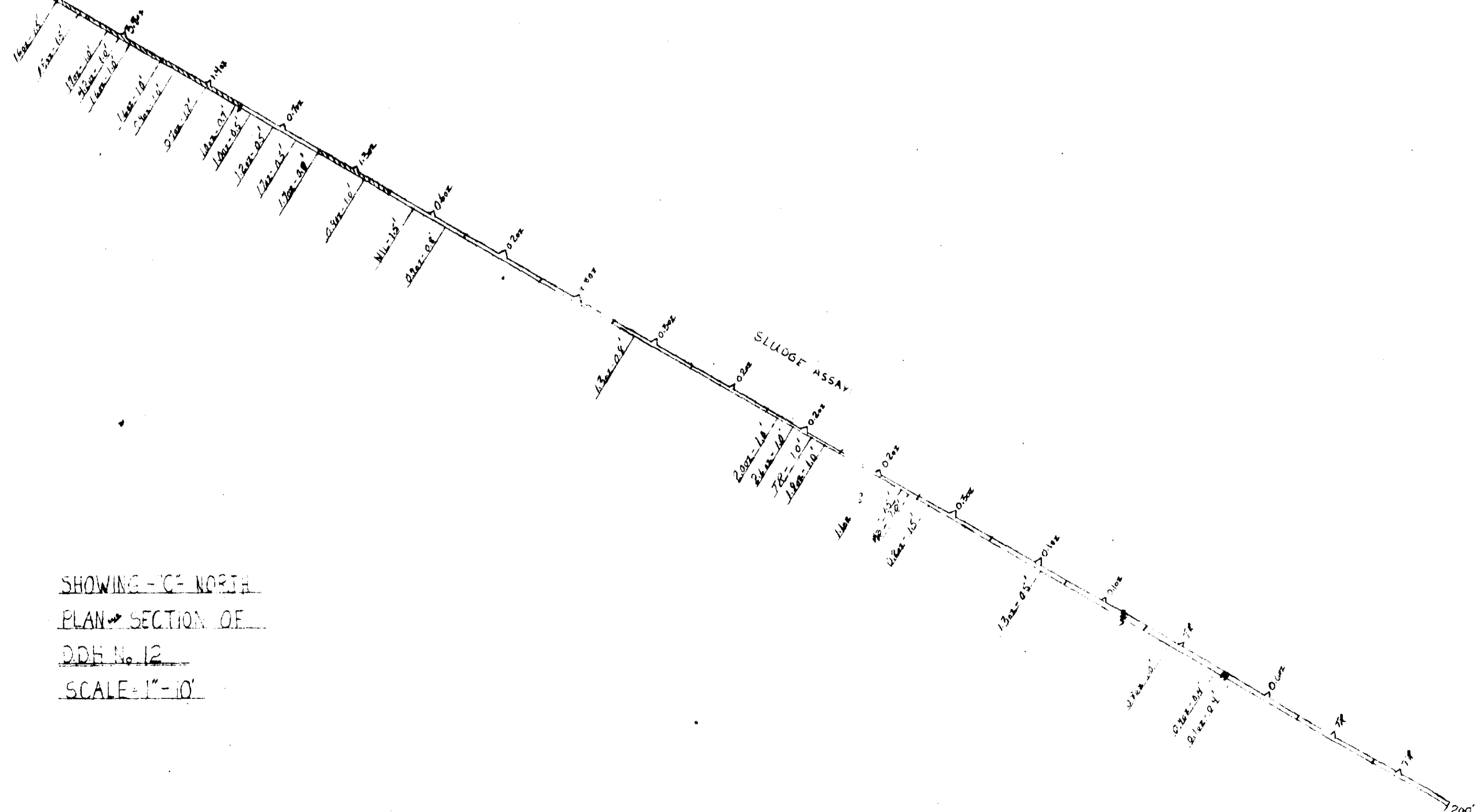

SHOWING -ICE NORTH
 PLAN SECTION OF
 D.D.H. No. 12
 SCALE - 1" = 10'

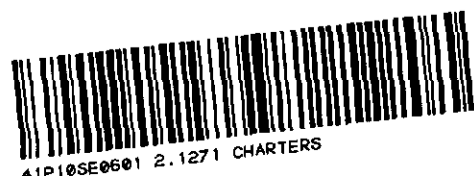

DDH. No 13
-30°

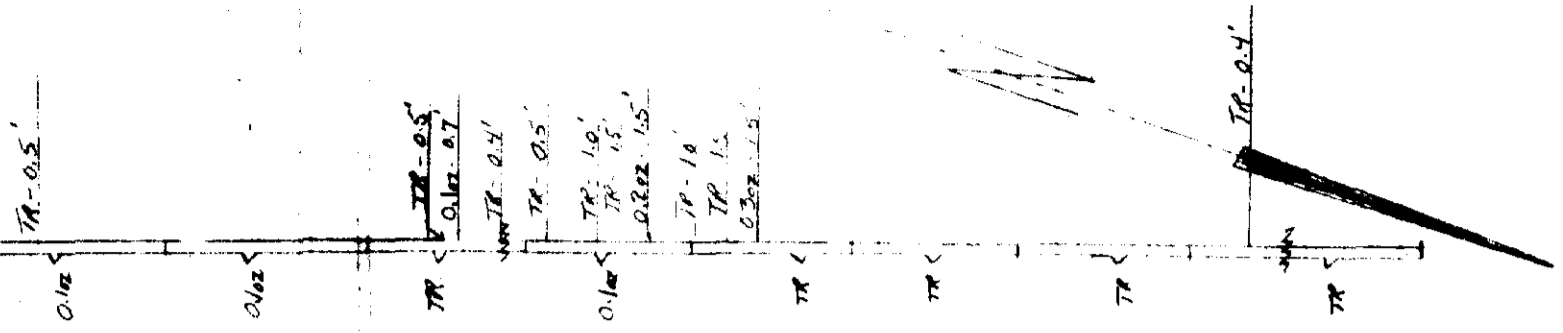

PLAN

SECTION

EL 60'

EL 50'

EL 40'

DDH. No 13
-30°

EL 30'

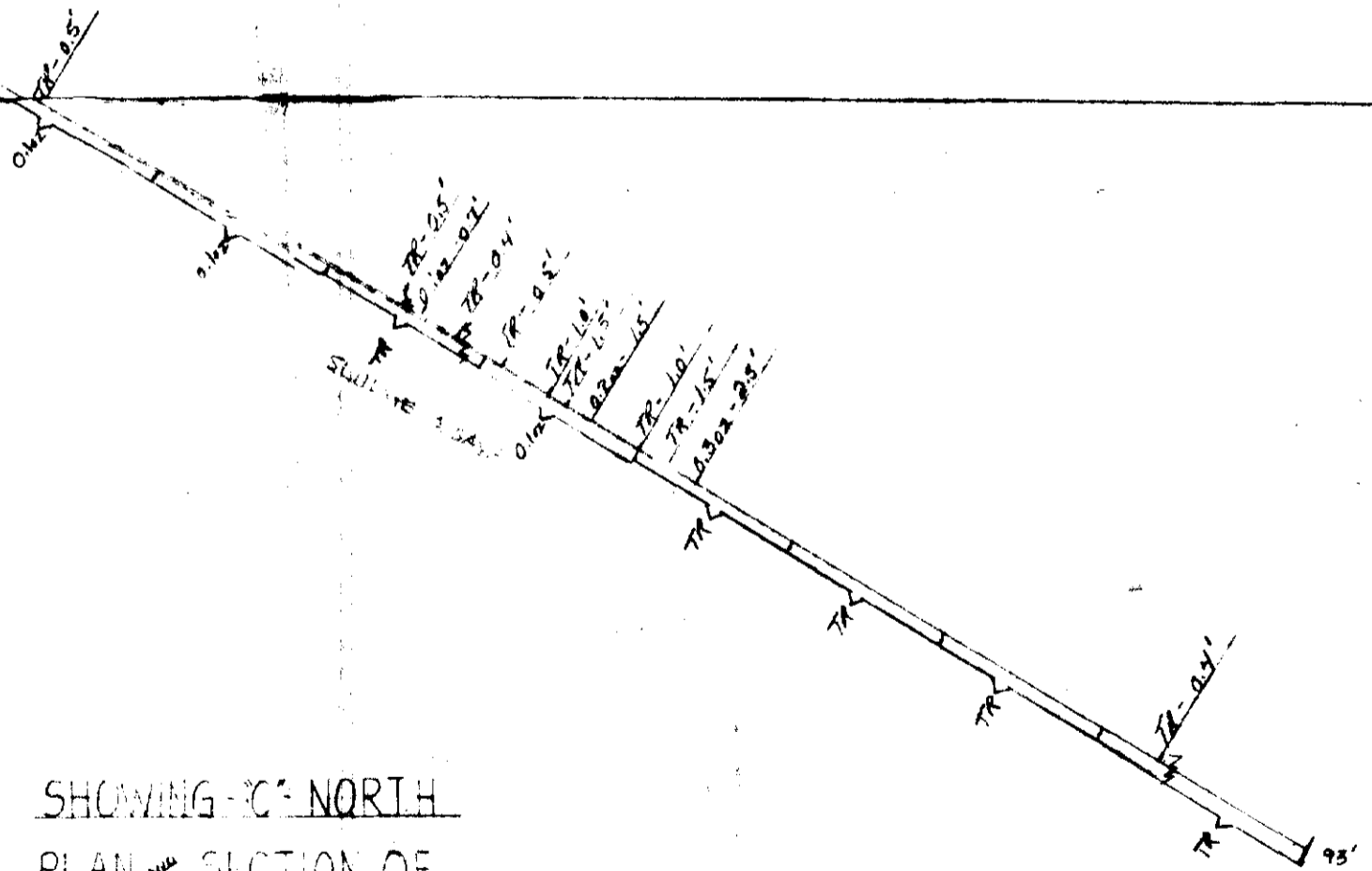

SHOWING -C- NORTH
 PLAN AND SECTION OF
 DDH. No 13
 SCALE 1"=10'



DDH No. 21
- 40'

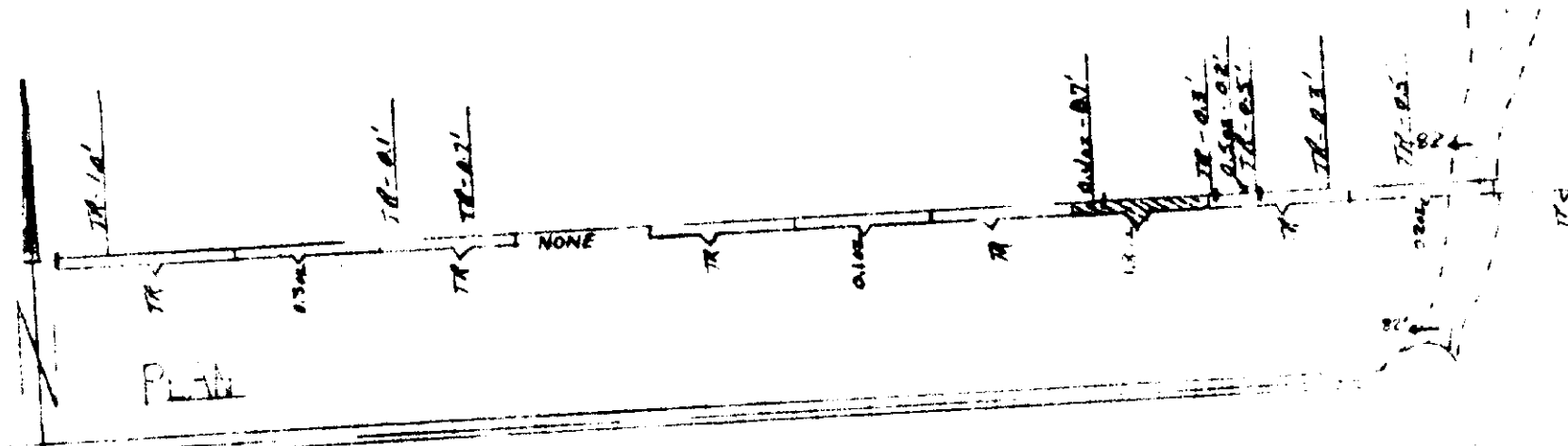

SECTION

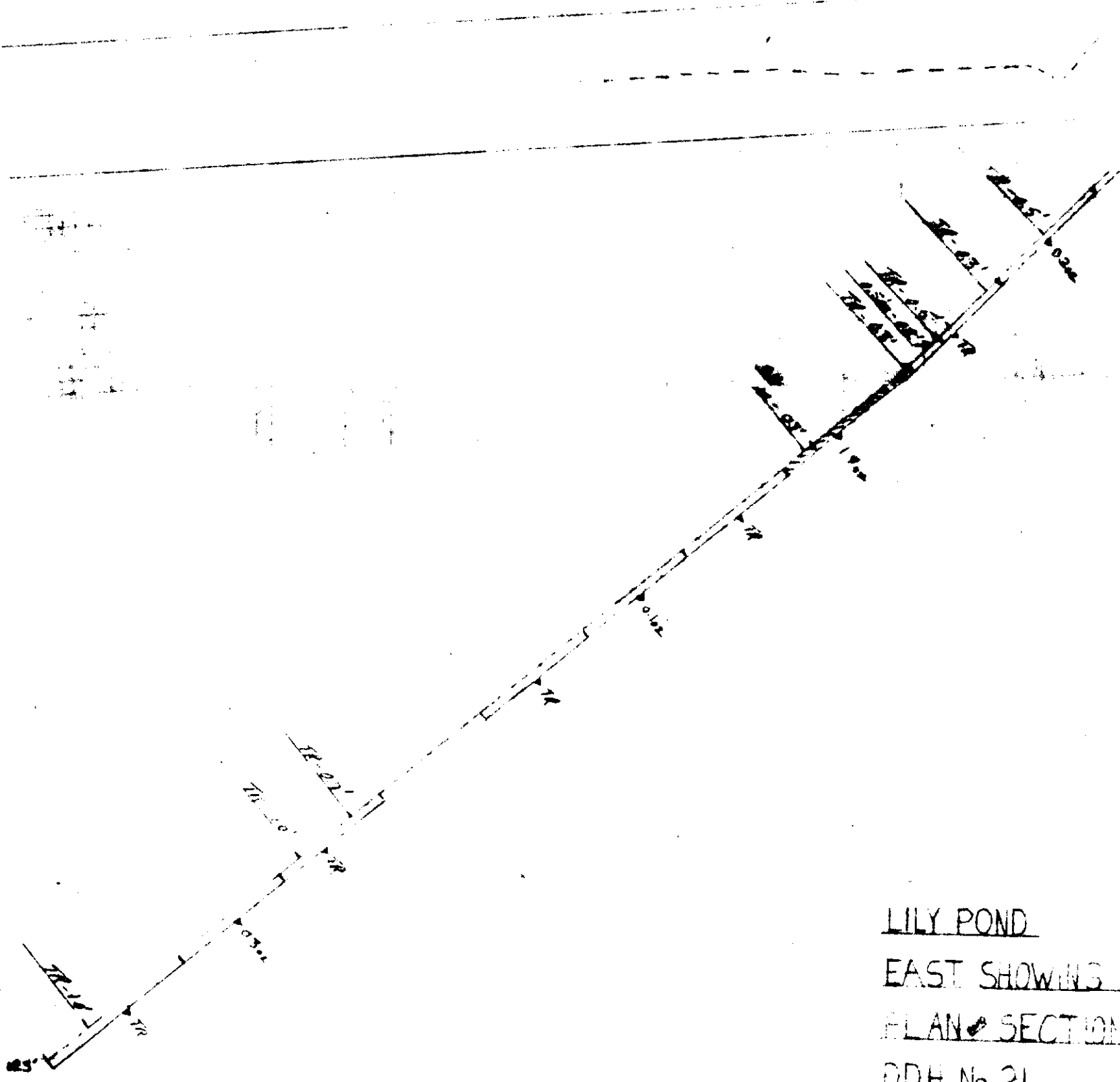

LILY POND
EAST SHOWING
PLAN & SECTION OF
DDH No. 21
SCALE: 1"=10'

