

DIAMOND DRILLING

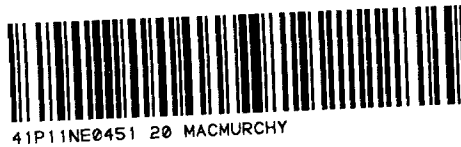

010

TOWNSHIP: MacMurchy

REPORT No.: 20

WORK PERFORMED BY: Albert Decker

<u>CLAIM No.</u>	<u>HOLE No.</u>	<u>FOOTAGE</u>	<u>DATE</u>	<u>NOTE</u>
L 341433	S-84-1	101	Oct/84	(1)

NOTES: (1) #461-84

DIAMOND DRILL RECORD

PROPERTY A. DECKER HOLE No. S-84-1 DECK
 SHEET NUMBER 1 F/W TO COL. IN FT. _____ LEVEL SURFACE
 LATITUDE South side west COLLAR EL. _____ WORK PLACE MAGMURCHY
 DEPARTURE END OF ASHBURN LAKE AZIMUTH ≈ N 45° E DEPTH 101'
 DATE OCT 6 1984 DIP 55° CORE TYPE 7/8" STANDARD HORIZ. PROJ. 58' HORIZ

DEPTH FEET	ROCK TYPE	ASSAY VALUES				Oz pe
		Sample No.	From	To	Width	
0.0'	INTERMEDIATE FELSIC VOLCANIC (ANDESITE?) well fractured, in threads of Qtz + occasional blebs of Py. 10-30° c/a. greyish olive light green. hem stain and abundant weathering on joint faces 3' 8mm white bull Qtz str ≈ 20° c/a.					
4.0' - 5.0'	Six 3-9mm white Qtz str ≈ 20-30° c/a. (4.0 - 6.0') Rock between str Brecciated in fragments 1mm - 1cm sharply angular to well rounded bonded by Qtz carbonate					
9'	1.5 cm white Qtz str ≈ 70° c/a					
13'	2.0 cm greenish white Qtz str ≈ 50° c/a					
15' - 23'	NUMEROUS threads + str of Qtz ≈ 30° c/a in occasional specs of sulfide mineral					

DRILLED BY A. DECKER SIGNED A Decker
PG - NL

DIAMOND DRILL RECORD

PROPERTY HOLE No. S-84-1 DEC
 SHEET NUMBER 2 /W TO COL. IN FT. LEVEL
 LATITUDE COLLAR EL. WORK PLACE
 DEPARTURE AZIMUTH DEPTH
 DATE OCT 6 1984 DIP CORE TYPE HORIZ. PROJ.

DEPTH FEET	ROCK TYPE	ASSAY VALUES			
		Sample No.	From	To	Width
	25' - 4cm greyish greenish white gtz veinlet ≈ 70° d/a				
	25.8' - 10cm whitish grey gtz carb str ≈ 70° d/a. w specs of Py				
	27' 3.5cm white bull gtz veinlet ≈ 70° d/a				
	29.5' two 9mm white gtz str ≈ 40° d/a				
	30-38' occasional threads and str 2mm to 9mm w specs of Py str ≈ 20° d/a				
	39-40.0' L.C.				
	41.0' 8mm grey + white gtz str ≈ 45° d/a w Py min. disp. Py in trains ≈ 45° d/a and 11 str.				

TPC - NL

DRILLED BY SIGNED A. Flecker

DIAMOND DRILL RECORD

PROPERTY HOLE No S-84-1 DECKER
 SHEET NUMBER 3 F/W TO COL. IN FT. LEVEL
 LATITUDE COLLAR EL. WORK PLACE
 DEPARTURE AZIMUTH DEPTH
 DATE 007 6 1984 DIP CORE TYPE HORIZ. PROJ.

DEPTH FEET	ROCK TYPE	ASSAY VALUES			
		Sample No.	From	To	Width
43' - 50'	mineralized zone. numerous gtz threads + strcs 20°-50°/A w abundant disc sulfide min through the veins + wall rock.				
51' - 53'	L.C.				
53' - 65'	Numerous threads + strcs of white gtz ≈ 20°/A				
72' - 73'	L.C.				
75' - 78'	disc py + po through the core.				

DRILLED BY

SIGNED

A. Decker

DIAMOND DRILL RECORD

PROPERTY HOLE No. S-84-1 DE
 SHEET NUMBER 4 F/W TO COL. IN FT. LEVEL
 LATITUDE COLLAR EL. WORK PLACE
 DEPARTURE AZIMUTH DEPTH
 DATE OCT 6 1984 DIP CORE TYPE HORIZ. PROJ.

DEPTH FEET	ROCK TYPE	ASSAY VALUES			
		Sample No.	From	To	Width
83'	1cm greyish green gtz str ~ 70° d/a in specs SULFIDE MIN.				
88-89'	L.C.				
93'-95'	several 7-9mm greenish white gtz str ~ 50° d/a in specs PY.				
97-101'	numerous threads + of carbonate strs all through the core ~ 6-80° d/a				
END OF HOLE 101'					

TPC - NL

DRILLED BY

SIGNED

A. Lecker



Ministry of Natural Resources Ontario



41P11NE0451 20 MACMURCHY

300 m is required for each type of work to be recorded.

961

THE MINING ACT REPORT OF WORK

To the Recorder of Larder Lake Mining Division

i, Albert Slecker name of Recorded Holder J4155 Prospector's Licence

Gawganda Ont. Post Office Address

do hereby report the performance of 101 days of DIAMOND DRILLING type of work

not before reported to be applied on the following contiguous claims

Table with 6 columns: Claim No., Days, Claim No., Days, Claim No., Days. Includes a stamp from the Ontario Geological Survey dated OCT 26 1984.

All the work was performed on Mining Claim (s) L 341433 (In the case of geological and/or geophysical survey (s) where more than 18 claims are involved attach a schedule)

READ CAREFULLY: THE FOLLOWING INFORMATION IS REQUIRED BY THE MINING RECORDER.

- For Manual Work, Stripping or Opening up of Mines, Sinking Shafts or Other Actual Mining Operations - Names and addresses of the men who performed the work and the dates and hours of their employment.
For Diamond and other Core Drilling - Footage, No. and angle of holes and diameter of core. Name and address of owner or operator of drill. Dates when drilling was done. Signed core log and sketch in duplicate.
For Compressed Air or Other Power Driven or Mechanical Equipment
Type of drill or equipment. Names and addresses of men engaged in operating equipment and the dates and hours of their employment.
For Power Stripping - Type of equipment. Name and address of owner or operator. Amount expended. Dates on which work was done. Proof of actual cost must be submitted within 30 days of recording.
With each of the above types of work sketches are required to show the location and extent of the work in relation to the nearest claim post. In the case of diamond or other core drilling the sketch must be submitted in duplicate.
For Geophysical, Geological, Geochemical Surveys and Expenditure Credits - the name of author of report. Covering dates of survey (linecutting & office). Type of instrument used. Total amount of expenditure. Technical reports, maps, expenditure breakdown, receipts must be filed in duplicate with the Minister within 60 days of recording.
For Land Survey - the name and address of Ontario Land surveyor.

The Required Information is as Follows: (Attach a list if this space is insufficient)

101' of diamond core drilling, 7/8" core operator, A. Slecker, Gawganda Ont. dip of hole 35 degrees. STARTED WORK SEPT 25/84, FINISHED OCT. 2. STRIKE OF HOLE N, 45 E.

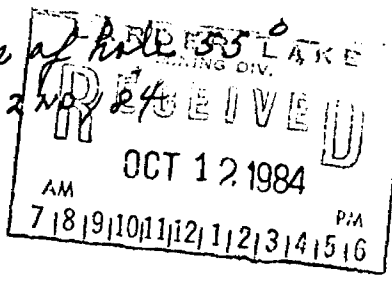

Date Oct 11th 1984

Albert Slecker Signature of Recorded Holder or Agent

The Mining Act Certificate Verifying Report of Work

i, Albert Slecker Gawganda Ont. (Post Office Address)

hereby certify:

- 1. That I have a personal and intimate knowledge of the facts set forth in the report of work annexed hereto, having performed the work or witnessed same during and/or after its completion.
2. That the annexed report is true.

Dated Oct 11th 1984

Albert Slecker Signature

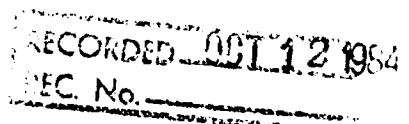

THE PENALTY FOR MAKING A FALSE STATEMENT IN THIS REPORT AND/OR CERTIFICATE IS \$500. OR SIX MONTHS IMPRISONMENT OR BOTH

385

THE TO

MACM

macMurchy
Twp DISTRICT
M842 SUD

LARDE
MINING

SCALE: 1-INCH

LEG

- PATENTED LAND
- CROWN LAND SAIF
- LEASES
- LOCATED LAND
- LICENSE OF OCCUPATION
- MINING RIGHTS ONLY
- SURFACE RIGHTS ONLY
- ROADS
- IMPROVED ROADS
- KING'S HIGHWAYS
- RAILWAYS
- POWER LINES
- MARSH OR MUSKFC
- MINES
- CANCELLED
- PATENTED S.R.O

NO

400' Surface Rights Fe
shores of all lakes

Township closed to stak
Section 38(f) of the M

Mining Leases shown thus
but Not Thrown Open For

Areas withdrawn fr
43 of the Mining A
Order No. File

(R) W.66/76 188517

Surface and Mining Rights
not affected by closure of
prospecting, staking out, so
The Mining Act, Order No M
2:00 pm

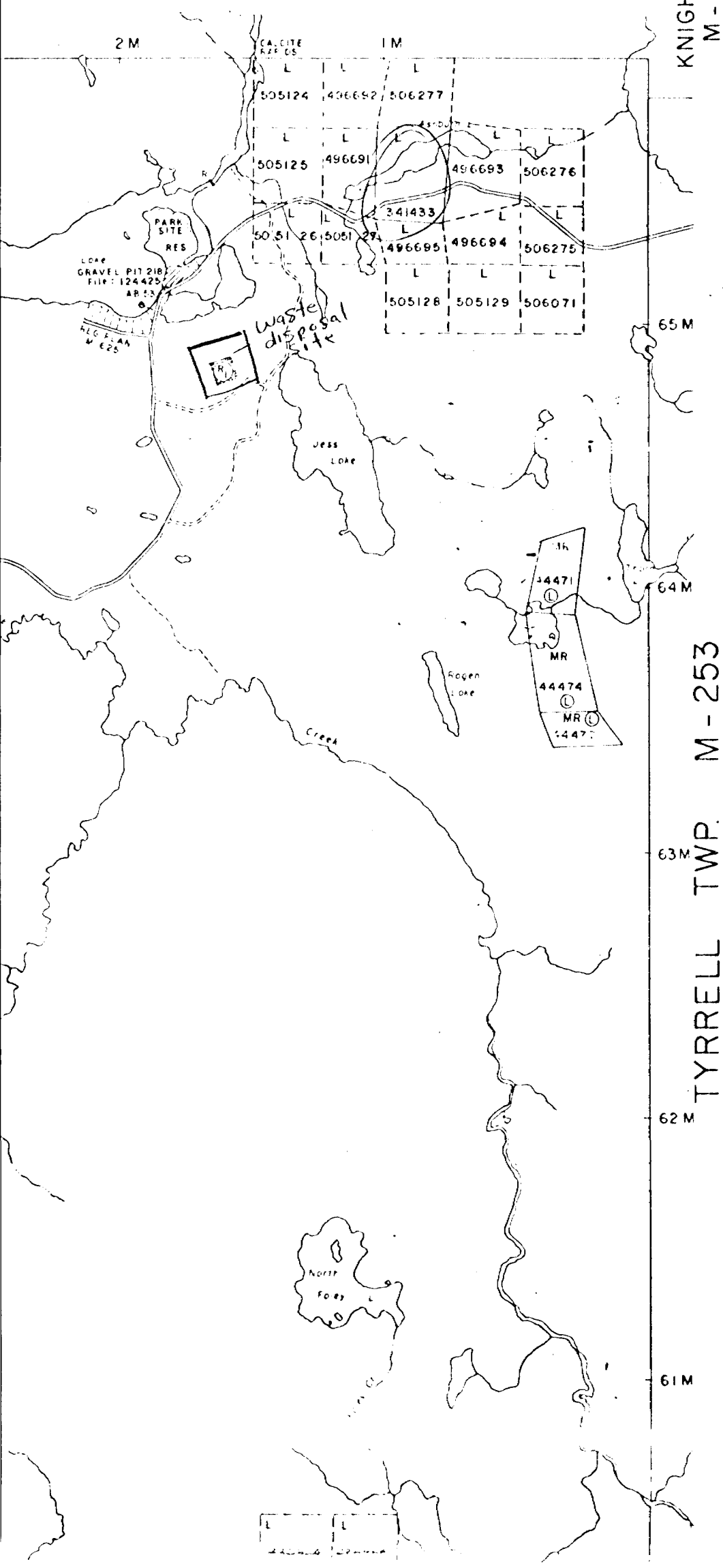

KNIGHT TWP.
M-228

TYRRELL TWP. M-253

65M

64M

63M

62M

61M

L L
L L