

41P11NW0427 11 CONNAUGHT

010

# Diamond Drilling

Township of Connaught

Report No: 11

Work performed by: Coniston Explorations & Holdings Limited

Claim No	Hole No	Footage	Date	Note
MR 36961	70-1	169'	Aug/70	(1)
	70-2	311'	Sept/70	(2)
	70-3	198'		
	70-4	407'		
	70-5	284'		
	70-6	275'		
MR 41956	72-1	230'	Nov/72	(3) (4)
	72-2	231'	Nov/72	(3) (4)
	72-3	306'	Nov/72	(3) (4)
MR 41956	72-4	252'	Nov/72	(3) (4)

### Notes:

- (1) 233/70
- (2) 165/71
- (3) 29/73 through 35/73
- (4) Meap Contract CG-36 See File #63.3306



MR 36961

DDH  
70-1  
43°

Baseline

MR 36960

255 296

255 524

Consistor Copper Mines Ltd  
Connaught Township

Detailed location sketch

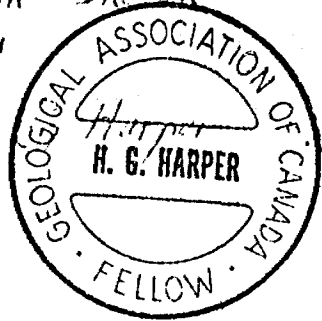

1297

1447

1227

107

# 233/70 Connaught Coy.  
Consistor Copper Mines Ltd

Lionheart Township      PROPERTY:      (Canton Copper Mining Ltd)  
 LATITUDE: 47°00'N      BEARING: South      DIP: -43°      STARTED: Aug 10/70      COMPLETED: Aug 16/70      HOLE NO. 70-1  
 DEPARTURE: L 66      V.D.      H.D.      DRILLED BY: G. H. Harper      DEPTH: 169'  
 ELEVATION:      LOCATION: (Claim) MR 36961 - 900' NW 1st 2.12.71      AXT.      LOGGED BY: Harper

FOOTAGE		SAMPLE FOOTAGES	SAMPLE No.	WIDTH FT.	ASSAY DATA														
0-8	Wasing																		
8.5	Andesite																		
20.2	Agglomerate																		
23	Chert																		
162.2	Andesite - mostly mass. minor px & silic - numerous narrow qtz-carb stringers																		
	157.5 - minor px in 1/32" seam																		
169+	Sulphide Zone? Silic blebs px 1' x 1/4" irregularly distributed in And CH = 70																		
	Hole stopped pending further geological & geophysical investigations																		
	Hole may be entering a significant sulphide zone																		

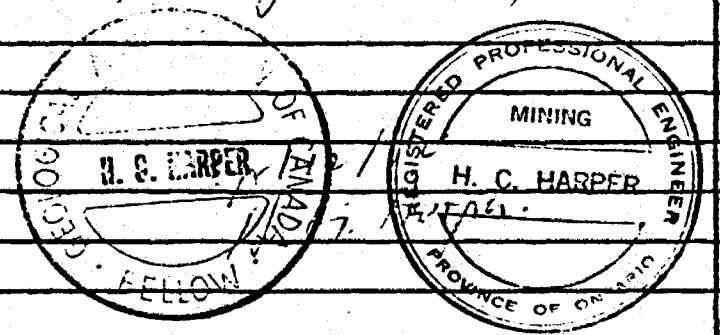

CONINGTON  
COPPER  
MINES  
LIMITED

CONNAUGHT  
TOWNSHIP

HILL HOLE  
LOCATION  
SKETCH

1" = 200'



BASELINE

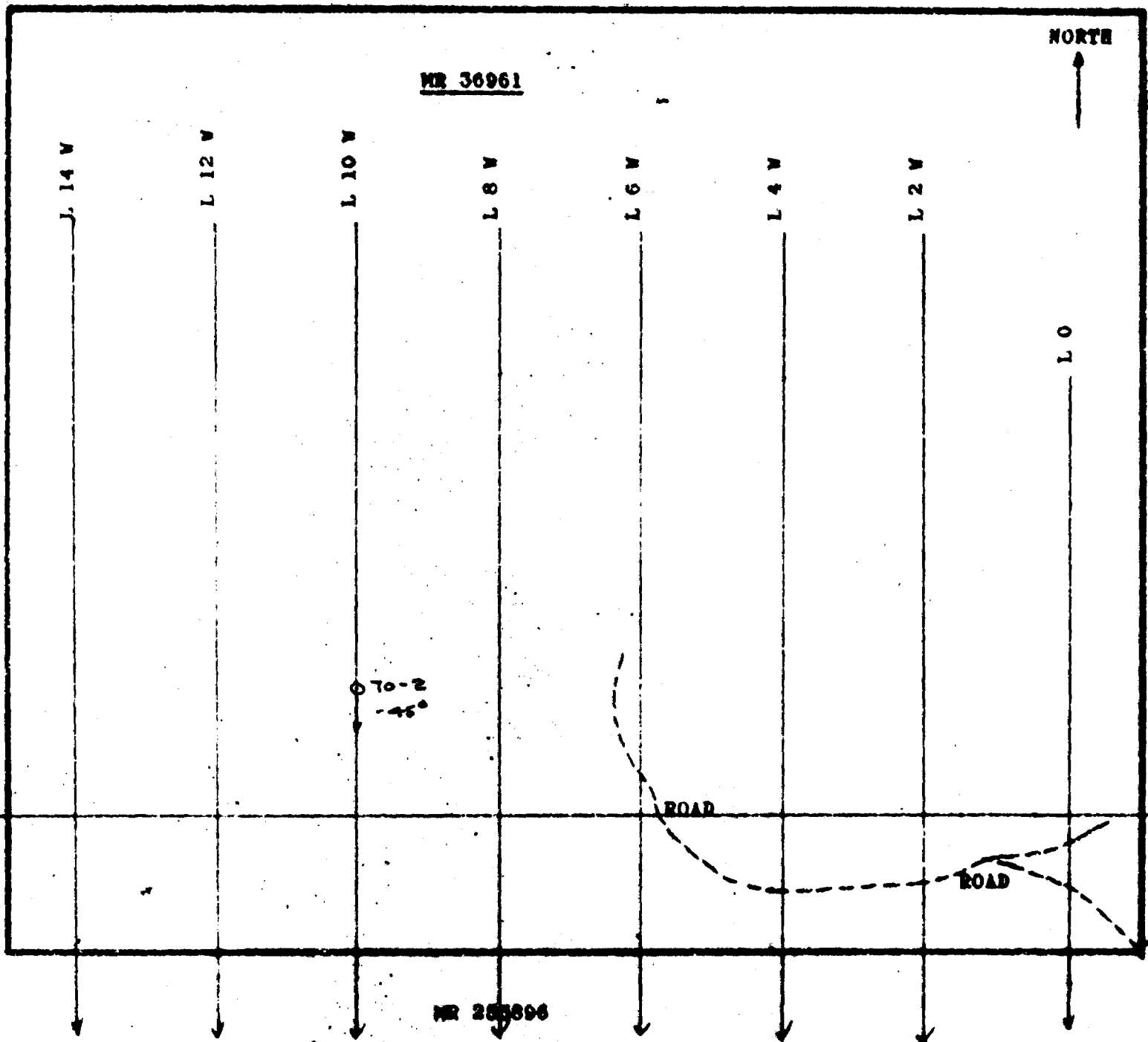

MR 25386

25386

PROPERTY: **Comiston Copper Mine Ltd.**  
 HOLE NO. **70-2**  
 COMMENCED: **Sept 14/70** COMPLETED: **Sept 25/70**  
 DEPTH: **311**  
 DRILLED BY: **George D.D. G. Welland**  
 LOGGED BY: **AXT**

FOOTAGE	DESCRIPTION	SAMPLE FOOTAGES	SAMPLE No.	WIDTH FT.	ASSAY DATA		
					An	Ag	% Cu
0-9	Casing / Hole cased in MINERAL - py, cpy, SiO <sub>2</sub>						
110	Aggl - rhyolitic, black frags streaks of py - low cpy - silicified & sericitized - must be sampled for Cu + Au - after 40' - mineralizat <sup>n</sup> fades						
136	Tuff - scatt frags - low scatt mineral 126' - 1 1/2" of 2% Cu						
164	Aggl - andesitic - less siliceous - 1/16" py streaks						
196.8	<b>MINERALIZED ZONE</b> - f. gr. aggl - black frags - chloritoid - rhyolitic - greenish, variable Well mineralized	164-170	3592	6.0			
	"	170-176	3593	6.0			
	cpy, bornite - native Cu or V.G.	176-180	3594	4.0			
	good mineral	180-184	3595	4.0			
	low	184-188	3596	4.0			
	moderate.	188-190	3597	2.0			
	fair cpy	190-194	3598	4.0			
	very low to Tr. cpy	194-196.8	3599	2.8			
240	Aggl - white frags - no sulphide						
311	Tuff - variable content of frags - andesitic greenish cart. <b>END OF HOLE</b>						
Intersections only are reasonable. No obvious fault or kink in wall to zone of formations.							

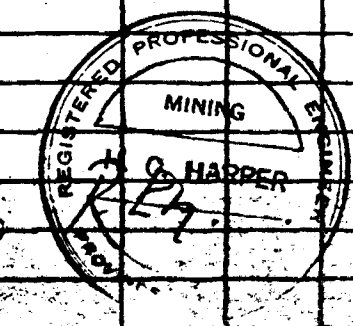
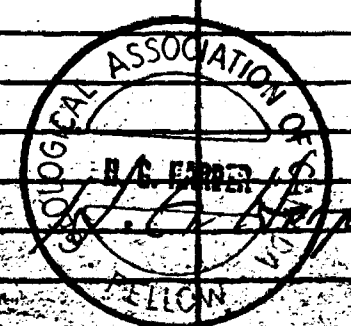

MINISTON  
COPPER  
MINES  
LIMITED

CONNAUGHT  
TOWNSHIP

DRILL HOLE  
LOCATION  
SKETCH

1" = 200'

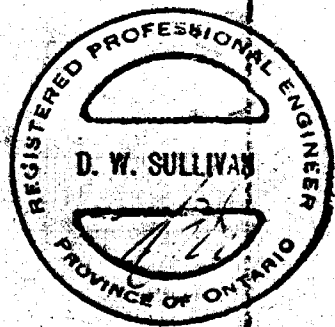

MR 25896

North

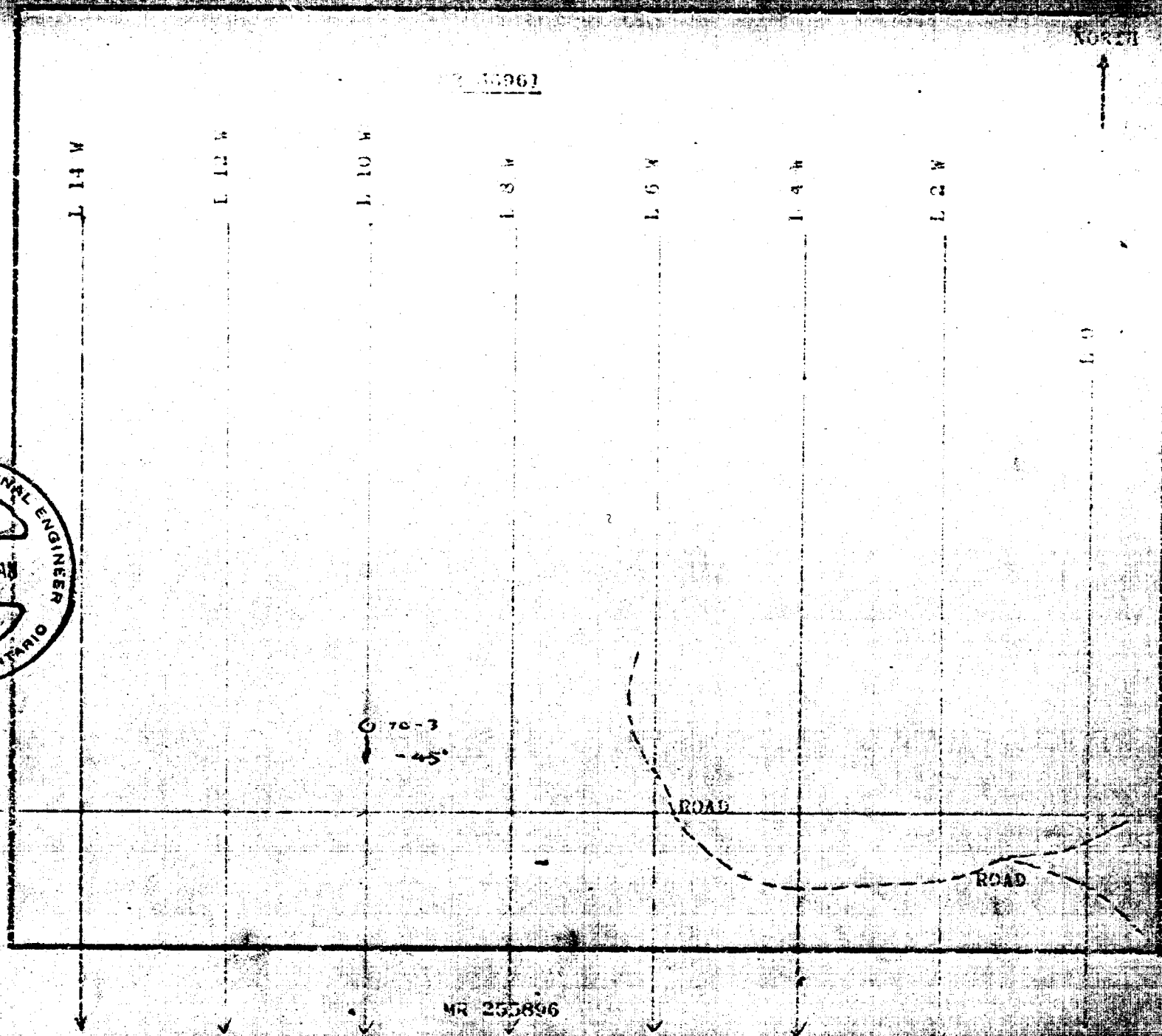

MR36960

MR 25896

DIAMOND DRILL RECORD

COLLAR:—  
 BIRTH 1+20N  
 EAST LINE 10W  
 ELEVATION  
 DIP 45° Grid South  
 LOCATION Cl. 36961

FOOTAGE	DIP	AZIMUTH	FOOTAGE	DIP	AZIMUTH
Color	45°				

PROPERTY LOANSTON COPPER MINES LTD. 127  
 LOCATION SECT 31  
 COUNTY CLATSOP  
 STATE OREGON  
 NUMBER OF HOLES 101  
 DATE 11/10/50  
 NAME OF OPERATOR Loanston

CONCORDANT TOWNSHIP

FOOTAGE		DESCRIPTION	CORE SAMPLE			ASSAYS				ANALYSIS	
FROM	TO		NUMBER	FOOTAGE	TOTAL	CU/TON	COBALT	Ag	Bi	Other	Other
0	8	Casing									
8	71.0	Agglomerate. Light col'd fragments. Some pink feldspar. Chloritic									
71	92	Tuff. Dk, m.g. Rhyolitic. Patchy sp. at B									
92	105	Agglomerate. Similar to 8'-71. Not as coarse grained. 1/2" veinlets sp. at 45° to C.A.									
105	113	Tuff. Dark greenish. Chloritic 105-109 Weakly stream sp. 109-113 Fair sp. At flat angle to horizon									
113	125	Agglomerate. Coarse frags. m.g.									
125	128	Tuff. Dark green. Minor sp. py, p.									
128	158	Tuff and Agglomerate. Interbedded. Dk green to gg. Weak py, sp.									
	171	Agglomerate. Grey. m.g.									
	198	Agglomerate. Tuffaceous. Dark fragments, some rhyolitic									

END OF HOLE



CONISTON  
COPPER  
MINES  
LIMITED

CONNAUGHT  
TOWNSHIP  
DRILL HOLE  
LOCATION  
SKETCH

1" = 200'

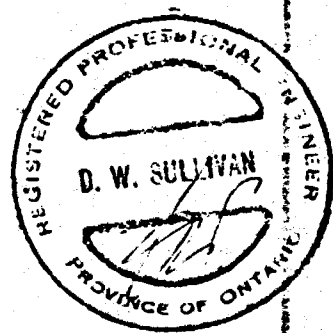

BASELINE

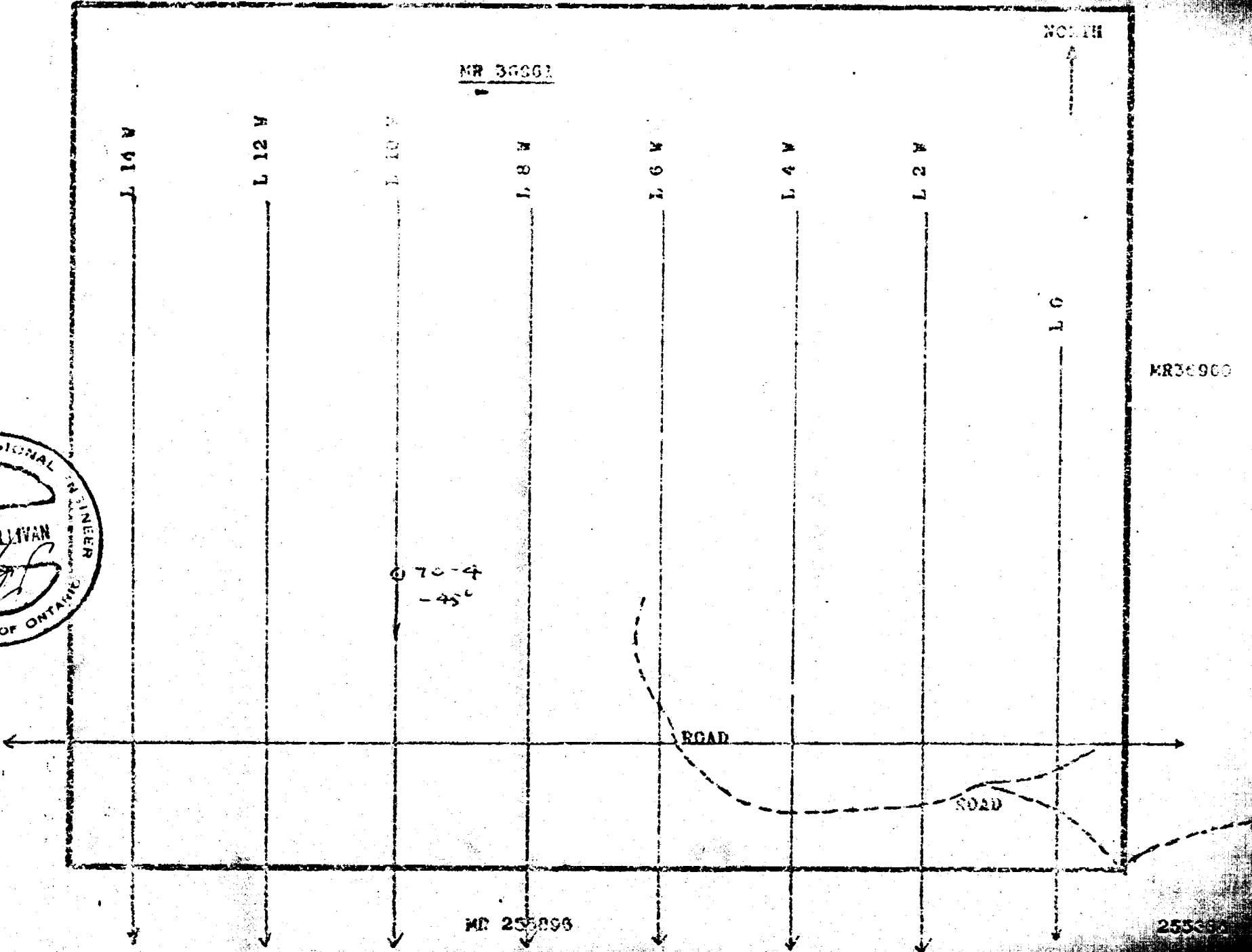

MR 38861

MR 25896

MR 38960

25896



DIAMOND DRILL RECORD

COLLAR:—  
 TH 2+55N  
 LINE 10W  
 ELEVATION  
 DIP 450 Grid South  
 LOCATION  
 C1. 36961

FOOTAGE	DIP	AZIMUTH	FOOTAGE	DIP	AZIMUTH
Collar	450	Grid South			

PROPERTY CONLTON COPPER MINES LTD  
CONNAUGHT TOWNSHIP  
ONTARIO

CORE SIZE AXT  
 COMMENCED Oct 8/1970  
 FINISHED OCT. 20/70  
 PURPOSE OF HOLE  
 HOLE NO. 70-4  
 SHEET NO. 1 of 2  
 LENGTH 407  
 LOGGED BY D. W. Sullivan  
P. Eng.

FOOTAGE		DESCRIPTION	CORE SAMPLE			ASSAYS				AVERAGES			
FROM	TO		NUMBER	FOOTAGE		OZ/TON Au	OZ/TON Ag	% Cu	% Zn	As/W	Ag/W	Cu/W	Zn/W
				FROM	TO								
0	8	CASING											
8	34	DIORITE. Pinkish											
34	42.5	RHYOLITE. Fragmental, sericitic. Minor sulphides.											
42.5	47	TUFFACEOUS AGGLOMERATE. m.g. to c.g.											
47	48	RHYOLITE Fragmental. Contact @ 45° at 48'											
48	57	TUFFACEOUS AGGLOMERATE. Coarse frags. blebs po, py. Patch good cpy at 50'	904	48'	50.5	2.5							
57	74	TUFFACEOUS AGGLOMERATE. Dark gy. Black frags, some rhyolite frags.											
74	84	AS ABOVE. Grey, c.g. Siliceous.											
84	170	TUFFACEOUS Agglomerate. m.g., sheared. Blebs cpy at 95.7, 98', 113, 136											
170	208.5	TUFFACEOUS AGGLOMERATE. f.g. Sheared Cubic xls pyrite.											
172		DIORITE.											
244.5		TUFFACEOUS AGGLOM. Light coloured											
256.5		TUFFACEOUS. Argillaceous. Much py, po occas. patch cpy	902	250	253.5	3.5							

Drilled by  
 Bruce Finwood  
 Drilling, Millard.

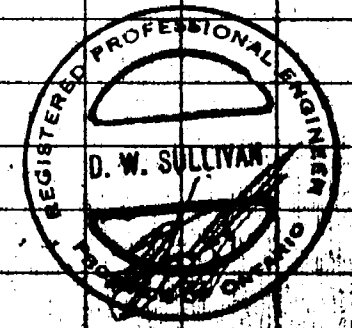

DIAMOND DRILL RECORD

COLLAR—  
 NORTH 2155N  
LINE 10W  
 ELEVATION \_\_\_\_\_  
 DIP \_\_\_\_\_  
 LOCATION Cl. 36961

FOOTAGE	DIP	AZIMUTH	FOOTAGE	DIP	AZIMUTH

PROPERTY Crown Consolidated

FOOTAGE		DESCRIPTION	CORRECTIONS		CORRECTIONS		CORRECTIONS		CORRECTIONS		CORRECTIONS		CORRECTIONS	
FROM	TO													
256.5	298	TUFF. Altered. f.g. Considerable py. Sheared at 25° to C.A. by zone of 2000.												
298	317	TUFFACEOUS AGGLOMERATE. Bedding at 40° to 50°.												
317	321	ARGILLACEOUS TUFF. Black, schistose. Cpy, py. Circ. Angk schist 45°	9.03	3102	30	5.8								
321	344	TUFF. Slightly altered												
344	407	LAPILLI TUFF. Fragments 5 to 10 mm.												
		END OF HOLE 407												
		<i>[Signature]</i>												

*[Handwritten notes and signatures in the right margin, including "Drilled by" and "Lapilli"]*

CONISTON  
COPPER  
MINES  
LIMITED

CONNAUGHT  
TOWNSHIP  
DRILL HOLE  
LOCATION  
SKETCH

1" = 200'

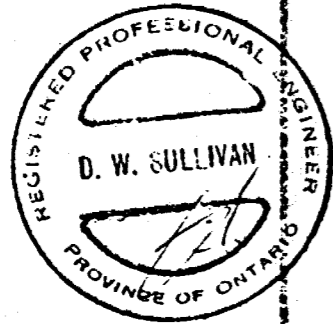

BASELINE

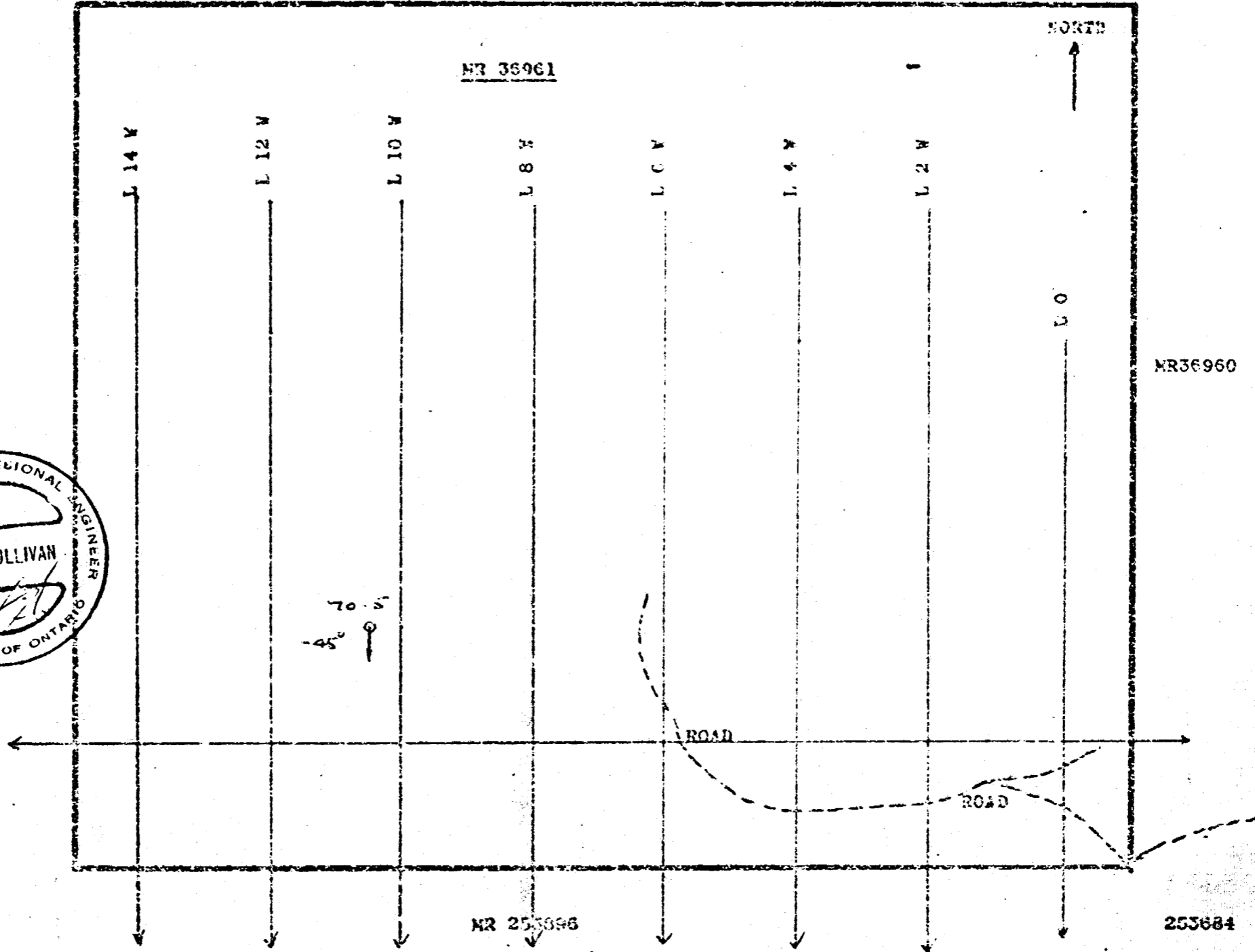

MR36960

DIAMOND DRILL RECORD

R:-  
 NORTH 175N  
10+50W  
 LOCATION  
 LOCATION C136961

FOOTAGE	DIP	AZIMUTH	FOOTAGE	DIP	AZIMUTH
Collar	45°				

PROPERTY COMISTON COPPER MINES LTD

CONNAUGHT TWP

CORE SIZE 1x HOLE NO. 70-5  
 COMMENCED \_\_\_\_\_ SHEET NO. \_\_\_\_\_  
 FINISHED \_\_\_\_\_ LENGTH \_\_\_\_\_  
 PURPOSE OF HOLE \_\_\_\_\_ LOGGED BY [Signature]  
Nov 4/70

FOOTAGE		DESCRIPTION	CORE SAMPLE			ASSAYS				AVERAGES				
FROM	TO		NUMBER	FOOTAGE FROM	FOOTAGE TO	TOTAL	OZ/TON Au	OZ/TON Ag	% Cu	% Zn	AuxW	AgxW	CuxW	ZnxW
0	6	Casing												
6	21	Rhyolite fragmental, greenish												
21	88	Tuffaceous Agglomerate. Sheared, light coloured.												
88	102.5	As above. Argillaceous, most cpy in argill.	905	88	93									
			906	93	98									
			907	98	102.5									
102.5	150	Tuffaceous Agglom. narrow band gy. fine grained tuff at 119-121												
150	153.5	Tuff. Vesicular. f.g. gray (2-V. runs with core)												
153.5	228	Tuffaceous Agglomerate. m.g. light. Occas. patch cpy, py. Fair cpy 182.5-183.5												
228	252	" " f.g. interbedded, vesicular												
252	259.5	" " m.g.												
259.5	284	" " m.g.												
END OF HOLE 284.														



CONISTON  
COPPER  
MINES  
LIMITED

CONNAUGHT  
TOWNSHIP  
DRILL HOLE  
LOCATION  
SKETCH

1" = 200'

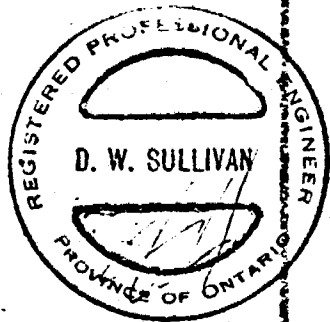

BASILINE

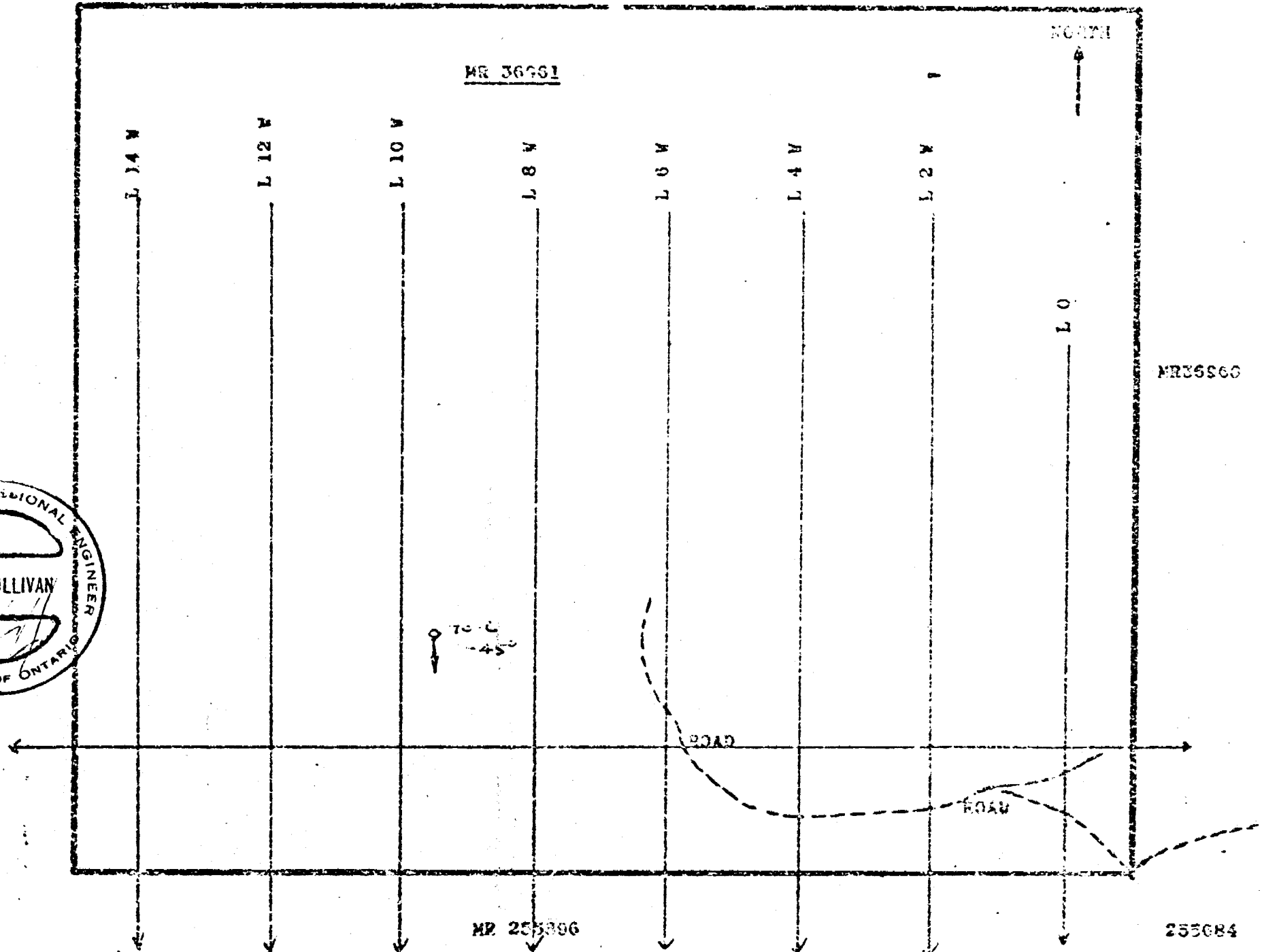

MR36660

DIAMOND DRILL RECORD

Collar: -  
 NORTH 1475 N  
 T. LINE 9+50 W  
 VATION \_\_\_\_\_  
 CATION C136961

FOOTAGE	DIP	AZIMUTH	FOOTAGE	DIP	AZIMUTH
Color	45°				

PROPERTY CONISTON COPPER MINES LTD  
CONNAUGHT TWP

CORE SIZE AXT  
 COMMENCED \_\_\_\_\_  
 FINISHED \_\_\_\_\_  
 PURPOSE OF HOLE \_\_\_\_\_

HOLE NO. 20-6  
 SHEET NO. \_\_\_\_\_  
 LENGTH \_\_\_\_\_  
 LOGGED BY D. W. Sullivan

FOOTAGE		DESCRIPTION	CORE SAMPLE			ASSAYS				AVERAGES				
FROM	TO		NUMBER	FOOTAGE FROM	FOOTAGE TO	FOOTAGE TOTAL	OZ/TON Au	OZ/TON AG.	% CU.	% ZN.	AuxW	Agw	CuxW	-ZnxW
0	8	Casing												
8	17	Diorite												
17	81	Tuffaceous agglomerate												
81	137	" " Patches cpy at 88' in the more argillaceous rock. Running with core.	908	975	101	3.5								
			909	112	117	5'								
			910	117	122	5'								
			911	122	128	6'								
137	180.5	Tuffaceous agglomerate												
180.5	275	Tuffaceous. Sheared, light gy. Fine dk sheared lapilli beds												
		End of hole 275'												

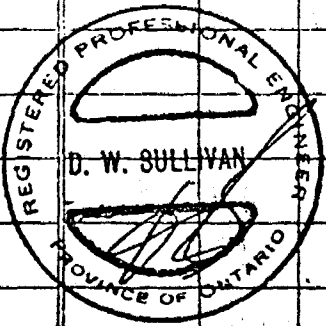

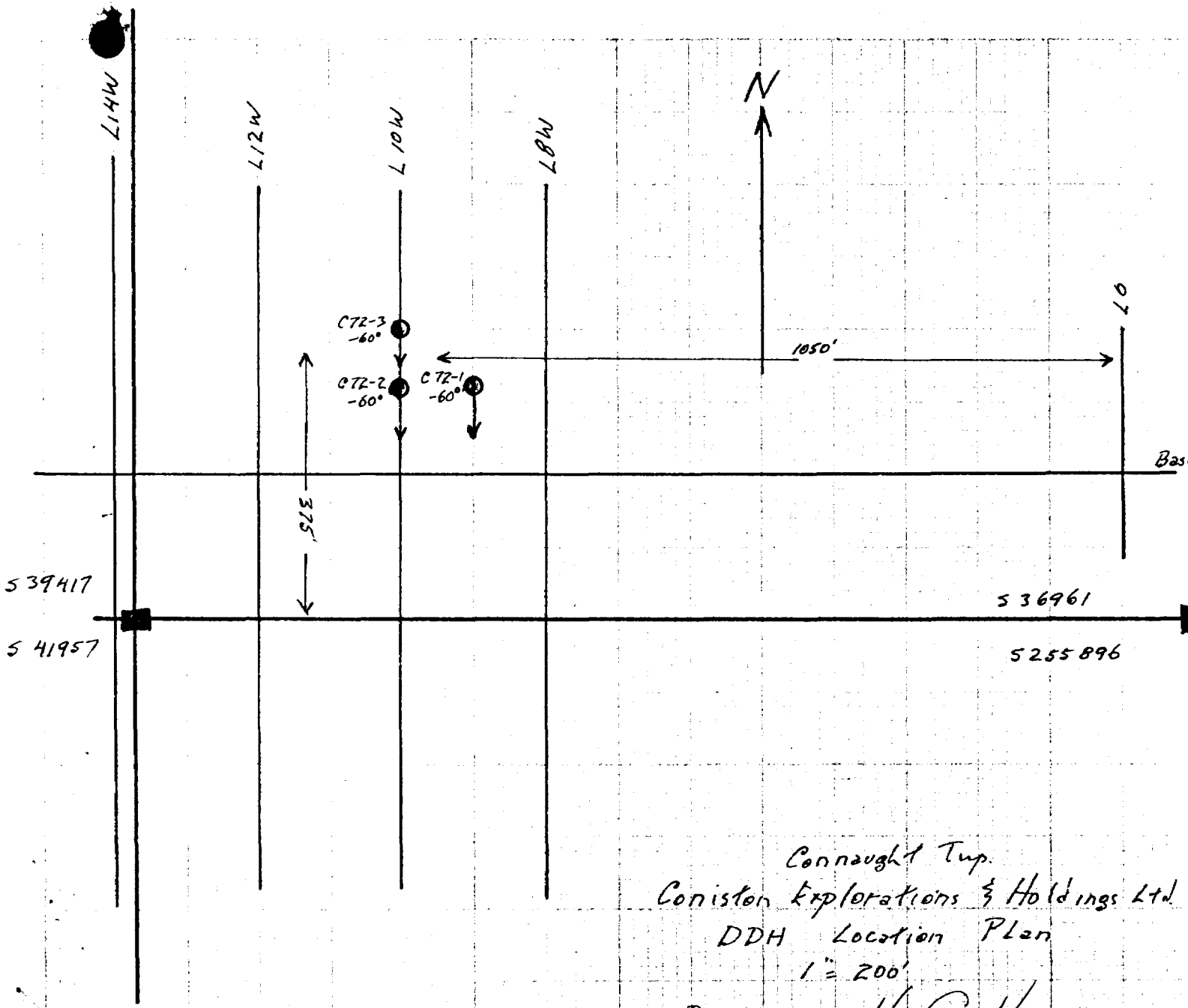

Connaught Twp.  
Report # 30-73  
Coniston Explorations &  
Holdings Ltd.

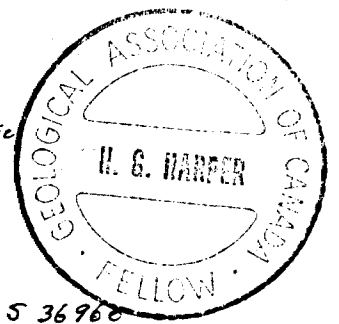

Connaught Twp.  
Coniston Explorations & Holdings Ltd.  
DDH Location Plan

1" = 200'  
Dec. 1972  
H. G. Harper



CONNAUGHT TWP.		PROPERTY: Coniston Explorations & Holdings Ltd			HOLE NO. G72-1	
LATITUDE: L11 W	BEARING: South	DIP: -60°	STARTED: Nov 19/72	COMPLETED: Nov 20/72		
DEPARTURE: 1+20 IV	V.D.	H.D.	DRILLED BY: Hosking D. D. Co		DEPTH: 230 ✓	
ELEVATION:	LOCATION: Claim <del>M</del> 3 6961 - 1100' feet NW #2 Post				LOGGED BY: Harper	

AQ.

FOOTAGE	DESCRIPTION	SAMPLE FOOTAGES	SAMPLE No.	WIDTH FT.	ASSAY DATA			
0-6	Casing							
121	Rhyolite Aggl & Breccia - white frags in dark groundmass - No mineral							
136	Zone of Intercalated thin flows, seds & Aggl fair py in some sections							
146	Dacite Tuff or Aggl - black frags in light grey groundmass - locally very rich in py							
230	Dacite Aggl & Breccia - irreg. black & grey frags in greyist to black groundmass 5-10% py							
END OF HOLE								
Core removed to Toronto for logging.								



DEC 21 72

H. C. Harper

**PROPERTY:** Connaught Exp. & Holdings Ltd.  
**HOLE NO.:** A72-2  
**ITUDE:**  $\angle$  11W    **BEARING:** South    **DIP:** -60    **STARTED:** Nov 21/72    **COMPLETED:** Nov 22/72  
**DEPARTURE:** 1+20N    **V.D.:**    **H.D.:**    **DRILLED BY:** Hosking D.D.C.    **DEPTH:** 231  
**ELEVATION:**    **LOCATION:** Claim 15, 36961 - 1100 feet NW #2 Post.    **LOGGED BY:** Harper

FOOTAGE	DESCRIPTION	SAMPLE FOOTAGES	SAMPLE No.	WIDTH FT.	ASSAY DATA			
0-13	Casing							
80.5	Diabase Dike - scatt low py cubes in host 5'							
117	Rhyolite Breccia - white frags in black groundmass 5-10% py in ovoids							
129	Rhyolite Flow - black - abundant py. <del>in the groundmass</del> minor breccia frags							
152	Rhyolite Breccia - black frags in light groundmass low py							
231	Rhyolite Tuff - cse white grains in a dark grey groundmass - ash bed - no mineral							

END OF HOLE

Core removed to Toronto for logging

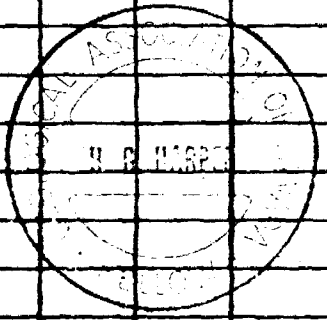
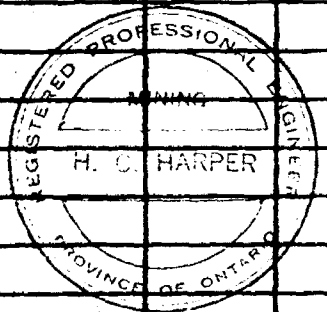

DEC 21 72

*H. C. Harper*

Longitude: <i>132W</i>		PROPERTY: <i>Caniston Holdings &amp; Exploration Ltd.</i>		HOLE NO. <i>C72-4</i>		
Bearing: <i>South</i>		DIP: <i>-45</i>		STARTED: <i>Nov 25/72</i> COMPLETED: <i>Nov 28/72</i>		
Departure: <i>700N</i>		V.D.		DRILLED BY: <i>Hosking D. D. Co</i>		
ELEVATION:		LOCATION: <i>MR 41956 - 1050 feet NW #2 Post.</i>				LOGGED BY: <i>Harper.</i>

FOOTAGE	DESCRIPTION	SAMPLE FOOTAGES	SAMPLE No.	WIDTH FT.	ASSAY DATA			
<i>C-17</i>	<i>Casing</i>							
<i>38</i>	<i>Diorite Dike - sharp lower contact. dark to black. f.g. Massive.</i>							
<i>197</i>	<i>Rhyolite Breccia or Aggl. Black, cse frags, partly re-cemented. light grey groundmass. Silicified zones 162-165 Oxidized Fracture - Water Seep? - Anomaly (?)</i>							
<i>223</i>	<i>Diorite Breccia - grey - small black frags</i>							
<i>244</i>	<i>Rhyolite Flow - or possibly a Welded Tuff - minor py in cubes</i>							
<i>258</i>	<i>Rhyolite Breccia - black - cse - numerous ovoids of py - minor hematite - possibly the start of more favourable horizons.</i>							
<i>END OF HOLE</i>								
<i>Care to Toronto for logging</i>								

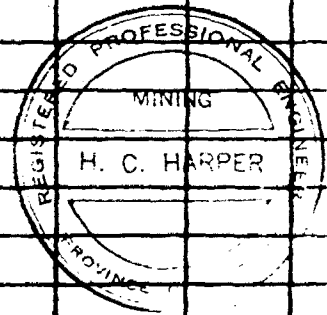

DEC 21 72

*H. C. Harper.*

PROPERTY: Connought Twp. Coniston Explorations & Holdings Ltd. HOLE NO. C72-3  
 LATITUDE: L12W BEARING: South DIP: -66° STARTED: Nov 23/72 COMPLETED: Nov 24/72  
 DEPARTURE: 200 N V.D. H.D. DRILLED BY: Hosking D.D.C. DEPTH: 306  
 ELEVATION: LOCATION: Claim ~~NR~~ 36961 - 1100 feet NW #2 Post. A.G. LOGGED BY: Harper.

FOOTAGE	DESCRIPTION	SAMPLE FOOTAGES	SAMPLE No.	WIDTH FT.	ASSAY DATA			
0-12	Casing							
10-12.5	Dacite Flow (?) dark grey - f. gr.							
53	Intercalated thin flows, tufts + aggl. beds. well altered. lower contact @ 30							
77.5	Rhyolite Flows - dark brown, f. gr. massive. siliceous - soatt. py - minor bx beds							
124	Rhyolite Tuff - white grain upto 1/4" in light grey ground mass							
168	Dacite Tuff - light grey color. Minor Bx							
212	Rhyolite Tuff - white frags in grey - as above							
215.5	Rhyolite Flow							
306	Agglomerate + minor Bx - Andesitic? - 5 to 10% py 260-265 Sand Seams - possible fault?							
END OF HOLE								
Core to Toronto for logging								



DEC 21 72

H. G. Harper

