



41P11NW8602 2.15129 CABOT

010

Report on Prospecting

**Jonsmith Project Cabot Township
November 30 1992**

T. Obradovich, Prospector

2.15129

INTRODUCTION

The following report describes a prospecting program carried out on the Jonsmith claims located in Cabot township, Larder Lake Mining District, Ontario. The project was funded under the Ontario Prospectors Assistance Program by way of a grant of \$ 10,000.00 to Thomas Obradovich, the author of this report. The O.P.A.P. grant number is O.P.92-467. Additional costs and equipment were provided by the author.

The project consisted of prospecting and sampling, magnetometer and VLF electromagnetometer surveys and linecutting and some stripping. A large 100 lb sample was also collected.

Linecutting was performed by Denis Mercier and Associates of Val d'Or Quebec. Detailed geophysics were performed by Randon Ferderber also of Val d'Or. Prospecting and sampling was done by Tom Obradovich with some assistance by Randon Ferderber. The work was performed between July 6, 1992 and September 25, 1992.

LOCATION

The property consists of one 16 unit claim located in north central Cabot township. (see fig 1 of this report)

The claim numbered 1182199 encompasses three small lakes the largest of which we refer to as Shaman Lake. Access is gained via old logging roads which branch off to the west of the Grassy Lake Road. The Grassy Lake Road extends from the end of Pine street in Timmins, Ontario south for a distance of 115 kilometres and ends at highway 560 just east of Shiningtree, Ontario. Approximately 16 km north of highway 560 off the Grassy Lake Road the west

Southwest road which terminates at Mattagami Lake passes through the northwest corner of the Jonsmith property. A rough rather grown in road can be taken south at kilometre 20 bisecting the claim group. The group of claims is at a latitude 47°42' longitude 81°25' NTS 41P/11, map plan no. M695.

LINECUTTING

Approximately 14 kilometres of fresh grid were cut and chained by Denis Mercier and associates. The baseline traverses the property at a bearing of N45°E for a distance of 1300 meters. Grid lines were established at 100 meter intervals along the baseline ending at tielines 5+00N and 5+00S or at claim boundaries. In addition to the new grid which covers the area of historic showings and high exploration potential an older grid was rehabilitated by brushing and ribboning for the purpose of reconnaissance prospecting. Most of this forementioned area was covered by esker with little or no outcrop. Additional detail lines were cut in areas to fill in geophysical data. (see map 1 for grid location)

HISTORY OF THE JONSMITH PROPERTY

In 1961, prospectors working for Jonsmith Mines Limited discovered quartz calcite veins carrying mineralization similar to the cobalt silver arsenides of the Cobalt camp. An assay of 5% cobalt and several ounces silver attracted the author to this property to investigate the possibility of a cobalt deposit.

Additional interest in the property was spawned by volcanigenic massive sulphide occurrences described by Jonsmith as well as prospector Ivan Dea in the 1970's. Good copper and gold values

Were reported by both parties. Mr. Dea's work was followed up by researching his hand written sketches and maps furnished by his widow.

PROSPECTING PROGRAM

The prospecting program carried out on the Jonsmith claims consisted of traversing the entire property, locating historic trenches, showings; hand-stripping and sampling. New showings and geophysical anomalies were investigated as well as extensions of old showings.

COBALT-SILVER

The original exploration focus was for the cobalt potential based on good values reported by Jonsmith Mines Ltd. The main trenches and showings were located with some difficulty, due to age and underbrush growth. The two main occurrences where the best results were sampled are located on line 4E+7+50S and L4E+9+75S. At L4E+9+75S a series of rather extensive trenches approximately thirty years old were located and believed to be the area referred to in the Jonsmith report.

The quartz calcite vein was opened up by hand mucking and brushing to reveal a narrow two inch vein running through the centre of the trench. The widest part of the vein may have been blasted out of the trench. No native silver or massive cobalt mineralization was encountered. The best cobalt assay was .05% in sample #13757 while the best silver assay was 7.41 oz/ton. Upon thorough examination of the area between trenches west of line 4E+7+50S and L4E+9+75S it appears that the vein hosted in Keewatin basalts

seems to be weakly mineralized and disappointing compared to results reported in the original

Jonsmith reports.

COPPER-GOLD ZONE

In the central portion of the claim group where previous showings had been reported, an extensive series of trenches trace a sulphide zone over a distance of 400 meters. Small massive sulphide lenses seem to align themselves in a north westerly trend between Shaman and middle lake to an area west of upper lake. Chalcopyrite, bornite and sphalerite were observed in the sulphide zone. The mineralized zone is packaged by foliated epidotized volcanic rock to the south and a dark chloritized alteration on the north contact.

This zone is electromagnetically presented in the Fraser filtered and profiled VLF maps included with this report on line 0+00 at 2+00N and line 1+00E + 1+50N. Although magnetite was observed in the sulphide zone, a strong northerly trending diabase unit seems to obscure any magnetic signature the zone may have. Significant gold and copper assays were gained from sampling this zone. A large representative sample from this zone numbered 13761 was taken from an area 25m west of L2W + 3+00N. The 100 lb bag was crushed, coned, and quartered at Swastika Laboratories by the author. After thorough mixing approximately 50 random spoon samples were submitted to the lab for a 1 assay ton sample. An assay of .102 oz Au/ton and 1.77% Cu/ton resulted from this sample. It is interesting to note that the larger sample taken of wall rock and alteration material returned such favourable values.

Sample 13768 was also a large representative sample and returned values of .076 oz/ton Au and 4.62% Cu/ton.

Samples taken from an area between lines 4+00E and 5+00E at 175S just west of the Shaman Lake access road revealed banded sulphide mineralized in silicified altered volcanic rocks. This is believed to be the area of an historic Pb-Zn-Cu showing. Evidence of some pitting was observed. A sample was submitted for I.C.A.P. multielement analysis. Sample 13769 returned anomalous Pb, Zn, Cu values. (see certificate T1973) This zone was very discontinuous and difficult to trace. Samples 13769 and 13770 submitted for regular assay returned low Cu and Zn values.

CONCLUSIONS AND RECOMMENDATIONS

The cobalt potential of the Jonsmith claims is minimal. After thorough examination of the areas of reported cobalt mineralization it is recommended that no further work on this commodity is warranted.

The base metal potential however, is quite interesting and should be pursued. The persistent sulphide mineralization is narrow but extensive. Gold related to copper mineralization is in significant concentrations. It is recommended that max-min surveys be carried out over the known zone in the winter to test the possible extensions into middle and Shaman Lakes. A deep diamond drill hole to a depth of 1000' could be drilled to test the zone at depth. If an anomaly is discovered, this hole could be followed up with a down the hole pulse E.M. survey to determine if any larger anomalous zones are near but do not surface.



41P11NW8602 2.15129 CABOT

020

REPORT ON GEOPHYSICAL SURVEYS
JONSMITH PROSPECT
CABOT TOWNSHIP
DISTRICT OF TIMISKAMING, ONT.
FOR
TOM O'BRADOVICH

S.J. Carmichael Consultants
Kirkland Lake, Ont.
Nov., 1992

Project OP92-467
NTS 41 P/12

Introduction

During the summer of 1992, ground geophysical surveys including VLF-EM and magnetometer surveys were completed over the Jonsmith Prospect located in the north portion of Cabot Township, District of Timiskaming, Cobalt Mining Division. The program included the cutting 3.1 km of baseline and tie line plus 8.4 km of grid line. The lines were then surveyed using a GEM Systems GSM-8 Proton Precision Magnetometer and a Geonics VLF-EM-16 instrument.

The surveys were made by R. Ferdeber, Val D'Or, Quebec.

Magnetometer Survey

Magnetometer readings were taken at 12.5m centres. Since diurnal drift was very minimal, no corrections were necessary. The results were then contoured at a scale of 100 nT below the 1,500 nT mark and at either 250 or 500 nT above the 1,500 nT mark.

Although the prevailing volcanic stratigraphy is roughly northeast-southwest, a series of moderately to highly magnetic features striking north-south has masked any possible magnetic trends associated with the volcanics.

The three magnetic units probably represent diabase dikes. Two of the dikes appear to converge just below the Middle Lake and cross the 5+00S tie line at 3+00W. Both the east and central magnetic highs exhibit flanking magnetic depressions, perhaps related to dipole effect. Two irregular magnetic anomalies, located at 4+00W, 2+00S and 5+00W, 0+50S may represent gabbroic intrusives unrelated to the diabase dikes.

VLF-EM Survey

VLF readings were taken at 25m centres using the Cutler, Maine transmitter at a frequency of 24.0 KHz. The baseline and tie lines were surveyed using the Annapolis My. transmitter at a frequency of 21.4 KHz. The readings were then profiled at a scale of 1cm=50% I.P. and Fraser Filtered and contoured at a scale of 10 units I.P. The results show a series of intermittent moderately strong northeast-southwest anomalies. The anomalies are cut by the north-south trending magnetic features and may represent pre-intrusive shearing/faulting or mineralization. None of the anomalies appear to be associated with a magnetic signature due to the extreme interference caused by the dikes.

The most interesting anomalies occur in the Shaman Lake area.

The anomaly located at the north end of the lake is shown as being folded back on itself, however it is more likely that two individual anomalies are present. The anomaly located at the east end of Shaman Lake likely underlies the entire lake and may give a strike length of 600m.

The lack of readings over the lake itself limits further interpretation and additional surveying over the Upper, Middle and Shaman Lakes is highly recommended in order to complete the picture.

The anomalies located on lines 5+00W, 3+50S and 0+00, 1+75N may be of sufficient strength to be verified by a Max Min II survey.

Recommendation For Further Work

At least five of the anomalies located appear to extend under the

series of Upper, Middle and Shaman Lakes and extending the lines over the lakes may be considered a first priority. Verification of the stronger anomalies by a Max Min II survey may be useful.

Regards

Stew Corns

Stew



Established 1928

Swastika Laboratories

A Division of Assayers Corporation Ltd.

Assaying - Consulting - Representation

Assay Certificate

2W-0969-RA1

Company: **T. OBRADOVICH**
Project: saaman
Attn:

Date: SEP-03-92

We hereby certify the following Assay of 13 ROCK samples submitted AUG-31-92 by .

Sample Number	Au oz/ton	Au check oz/ton	Ag oz/ton	Co %	Cu %	Zn %	ICP multi
13753	Nil						
13754	0.006				0.39		
13755	Nil						
13756	Nil						
13757	-		1.77	0.05		1.22	
13758	-		1.11	0.06		0.17	
13759	-		0.69	0.01		0.05	
13760	0.004				0.31		
13761	0.102	0.100			1.77		
13762	0.002				0.04		
13763	0.004				0.04		
13764	0.002		7.41	0.02	5.08	0.08	
13765	-		0.03	0.005			

Certified by Donna Gardner



Established 1928

Swastika Laboratories

A Division of Assayers Corporation Ltd.

Assaying - Consulting - Representation

Assay Certificate

2W-0979-RA1

Company: T. OBRADOVICH

Date: SEP-09-92

Project:

Attn:

We hereby certify the following Assay of 6 ROCK samples submitted SEP-04-92 by .

Sample Number	Au oz/ton	Au check oz/ton	Ag oz/ton	Co %	Cu %	Zn %	Multi element
13766	-		0.01	0.005			
13767	0.028				0.20		
13768	0.076	0.076			4.62		
13769	0.002				0.46		
13770	-				0.02	0.02	
13771	0.004				0.04		

Certified by *Dorina Gardina*

PLEASE RETURN THIS PORTION
WITH YOUR PAYMENT

STATEMENT OF ACCOUNT

*JONSMITH H
Assays*

STATEMENT DATE ACCOUNT NO.

09-30-92 250

STATEMENT DATE ACCOUNT NO.

09-30-92 250

AMOUNT REMITTED _____

IF PAYING BY INVOICE - PLEASE
CHECK INDIVIDUAL INVOICES PAID

DATE PAID	CHECK NO	AMOUNT
09-03-92	2771	254.66
09-09-92	2772	116.10
09-14-92	2773	62.86

INVOICE NO.	AMOUNT DUE	✓
2771	254.66	
2772	116.10	
2773	62.86	

AGE	Current	31-60	Over 60	TOTAL
AMOUNT				433.62

BALANCE DUE	TOTAL
433.62	433.62

TRINITY EXPLORATIONS

DOCUMENT No.

W9380 • 00191

DOCUMENT No.

W9380 • 00192

DOCUMENT No.

W9380 • 00193

Statement of Costs - "JonSmith Prospect" - Cabot Township

Summer - Fall, 1992 Program

Item - Description	Cost
A) Survey Costs (\$14,005.62)	
- linecutting (14.8 km cut @ \$250/km; 7.2 km brushed and flagged @ \$125/km; + 7% GST)	= \$4922
- prospecting (1 prospector @ 20 field days)	= \$3000
- geophysical (VLF, 2 stations: Geonics EM-16)	= \$1100
- geophysical (magnetic: total field; GEM GSM-8)	= \$1100
- geophysical consulting & report (S. Carmichael)	= \$300
- final prospecting report (2 days + maps 1 day)	= \$750
- 19 rock sample assays	= \$433.62
- equipment rentals (boat rental: 1 month)	= \$500
- drafting fees for maps (10 hours @ \$25/hour)	= \$250
- drafting supplies for sketches (mylar, etc.)	= \$50
- consumables (flagging, sample bags, topofill)	= \$100
- manual stripping, trenching, and sampling (5 days * 2 people)	= \$1500

B) Support Costs (\$3600)

- vehicle mileage (2000 km @ \$0.30/km)	= \$600
- food & accomodation (40 days total @ \$75/day)	= \$3000

Total Allowable for Assessment Credit: \$14,005.62 * 20% = \$2801.24; 14,005.62 + \$2801.24 = \$16,806.74

Subtotals: \$16,806.74

The above cost breakdown has been derived from information supplied by the author, Tom Obradovich, at my request.

Submitted by:

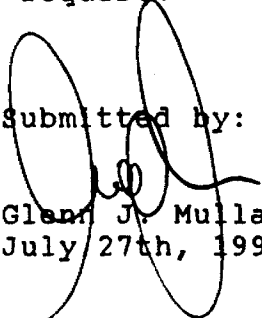

Glenn J. Mullan
July 27th, 1993

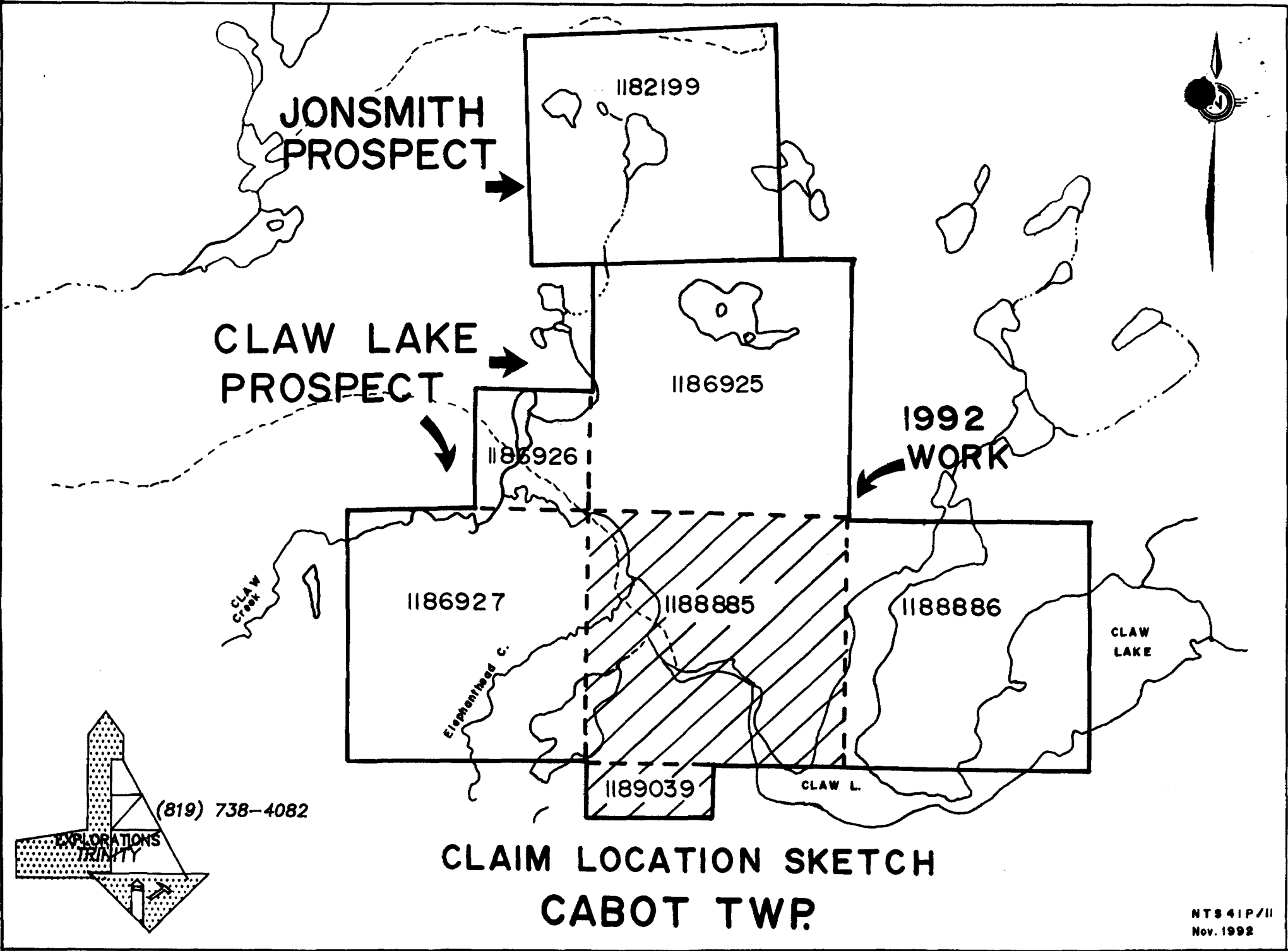

(819) 738-4082

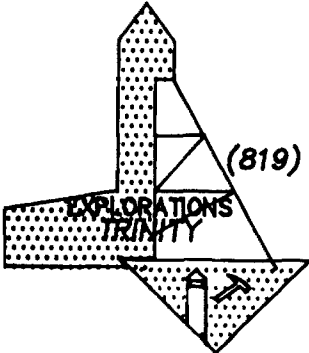

**CLAIM LOCATION SKETCH
CABOT TWP.**



41P11NW8602 2.15129 CABOT

900

Ministry of
Northern Development
and Mines

Ministère du
Développement du Nord
et des Mines

Geoscience Approvals Section
Willet Green Miller Centre
933 Ramsey Lake Road
6th Floor
Sudbury, Ontario
P3E 6B5

Telephone: (705) 670-5853
Fax: (705) 670-5863

Our File: 2.15129
Transaction #: W9380.00191
: W9380.00192
: W9380.00193

December 17, 1993

Mining Recorder
Ministry of Northern
Development and Mines
4 Government Road East
Kirkland Lake, Ontario
P2N 1A2

Dear Sir:

RE: APPROVAL OF ASSESSMENT WORK ON MINING CLAIM L1182199 IN CABOT TOWNSHIP.

The Assessment Credits for PROSPECTING, GEOPHYSICS, and ASSAYING, sections 9, 14 and 17 of the Mining Act Regulations, as listed on the above reports of work, have been approved as of DECEMBER 13, 1993.

please indicate this approval on the claim record sheets.

If you have any questions please call Clive Stephenson at (705) 670-5856.

Yours sincerely

Ron C. Gashinski
Senior Manager, Mining Lands Section
Mines and Minerals Division

CD
CDS/lS

cc: Resident Geologist
Kirkland Lake, Ontario

✓ Assessment Files Office
Toronto, Ontario

Report of Work Conducted After Recording Claim

Transaction Number **DOCUMENT NO.**
19380-00191

Mining Act

*Jongsmith Prospect
 M.V.F. Prospecting*

Information collected on this form is obtained under the authority of the Mining Act. This information will be used for correspondence. Questions about collection should be directed to the Provincial Manager, Mining Lands, Ministry of Northern Development and Mines, Fourth Floor, 159 Cedar Street, Toronto, Ontario, P3E 6A5, telephone (705) 670-7264.

2.15129

- Instructions:**
- Please type or print and submit in duplicate.
 - Refer to the Mining Act and Regulations for requirements of filing assessment work or consult the Mining Recorder.
 - A separate copy of this form must be completed for each Work Group.
 - Technical reports and maps must accompany this form in duplicate.
 - A sketch, showing the claims the work is assigned to, must accompany this form.

Recorded Holder(s) 50% Glenn J. Mullan + Tom Obroslavich 50%	Client No. 173 700
Address 2130 av. St-Philippe, Dubouison, Quebec J9P 4W7	Telephone No. (819) 738-4082
Geographic Division Larder Lake	Township/Area CABOT
Assessment Period From: July 6, 1992 (field work)	To: November 30, 1992 (report)

Work Performed (Check One Work Group Only)

Work Group	Type
Geotechnical Survey	Magnetic, VLF-em, Prospecting, line cutting
Physical Work, including Drilling	
Rehabilitation	
Other Authorized Work	
Assays	
Assignment from Reserve	

Total Assessment Work Claimed on the Attached Statement of Costs \$ **14874.42**

Note: The Minister may reject for assessment work credit all or part of the assessment work submitted if the recorded holder cannot verify expenditures claimed in the statement of costs within 30 days of a request for verification.

Persons and Survey Company Who Performed the Work (Give Name and Address of Author of Report)

Name	Address
Tom Obroslavich	75 Balsam Ave, Kirkland Lake, Ontario P0N 1W7
Brendan Ferdyber	*14-169 A av. Pomeroy, Val d'Or, Quebec J9P 2H1
Steve Carmichael	P.O. Box 271, Swastika, Ontario P0K 1T8
Denis Mercier & Associates (line cutting)	% 75 Balsam Ave, Kirkland Lake, Ontario P0N 1W7

Verification of Beneficial Interest * See Note No. 1 on reverse side

I certify that at the time the work was performed, the claims covered in this work report were recorded in the current holder's name or held under a beneficial interest by the current recorded holder.

Date: **July 27, 1993** Recorded Holder or Agent (Signature): *[Signature]* **G. Mullan**

Verification of Work Report

I certify that I have a personal knowledge of the facts set forth in this Work report, having performed the work or witnessed same during and/or after its completion and annexed report is true.

Name and Address of Person Certifying: **Glenn J. Mullan (as above)**

Response No.: **(819) 738-4082** Date: **July 27, 1993** Certified By (Signature): *[Signature]*

Recorder Office Use Only

Total Value Cr. Recorded: **\$14874**

Date Recorded: **August 11/93** Mining Recorder: *[Signature]*

Deemed Approval Date: **Nov 9/93** Date Approved: _____

Date Notice for Amendments Sent: _____

RECEIVED
LARDER LAKE
MINING DIVISION
AUG 11 1993
 TIME **Aug 11/93**

**Rapport sur les travaux exécutés
après l'enregistrement d'un claim**

Loi sur les mines

N° de transaction
DOCUMENT No.
9380-00192
Johanna Prospect
Assess

Les renseignements personnels contenus dans la présente formule sont recueillis en vertu de la Loi sur les mines et serviront à la correspondance. Adresser toute question sur la collecte de ces renseignements au chef provincial des terrains miniers, ministère du Développement du Nord et des Mines, 159, rue Cedar, 4^e étage, Sudbury (Ontario) P3E 6A5; téléphone : (705) 670-7264.

2.15129

- Directives :**
- Dactylographier ou écrire en lettres moulées.
 - Se reporter à la Loi sur les mines et aux règlements pour connaître les directives de dépôt des travaux d'évaluation ou consulter le registraire de claims.
 - Remplir une formule pour chaque groupe de travaux.
 - Joindre à la présente formule deux exemplaires des rapports techniques et des cartes.
 - Joindre à la présente formule une esquisse indiquant les claims ayant fait l'objet des travaux.

Titulaire(s) enregistré(s) <i>Glenn J. Mullen (50%) & Tom Obradovich (50%)</i>		N° de client <i>173 700</i>
Adresse <i>2130 av. St-Philippe, Dubouison, Québec, J9P 4M7</i>		N° de téléphone <i>(819) 738-4082</i>
Division des mines <i>Larder Lake</i>	Canton/province <i>Cobalt</i>	N° de plan M ou G <i>G-690</i>
Dates d'exécution des travaux du : <i>July 6, 1993 (field work)</i> au : <i>November 30, 1993 (report)</i>		

Travaux exécutés (cocher un seul groupe de travaux)

Groupe de travaux	Genre
<input type="checkbox"/> Levé géotechnique	
<input type="checkbox"/> Travaux physiques, y compris forage	
<input type="checkbox"/> Réhabilitation	
<input type="checkbox"/> Autres travaux autorisés	
<input checked="" type="checkbox"/> Essais	<i>Prospecting Core Samples, Trench Samples, Samples after stripping</i>
Valeur transférée de la réserve	<i>\$ 435.62</i>

Total des travaux d'évaluation réclamé sur le relevé des frais ci-joint *\$ 435.62*

Nota : Le ministre peut rejeter une partie ou la totalité des travaux d'évaluation présentes pour obtenir des crédits d'évaluation si le titulaire enregistré ne peut vérifier les dépenses réclamées sur le relevé des frais dans les trente jours suivant une demande de vérification.

Les personnes et la compagnie d'arpentage qui ont exécuté les travaux (donner le nom et l'adresse de l'auteur du rapport)

Nom	Adresse
<i>Tom Obradovich</i>	<i>75 Balsam Ave, Kirkland Lake, Ontario P2N 1W7</i>
<i>Randall Federber</i>	<i>*14-169 ave. Perreault, Val d'Or, Québec J9P 2M1</i>

(Joindre une annexe au besoin)

Certification d'intérêt bénéficiaire * Voir la note n° 1 au verso

Je certifie qu'au moment où les travaux ont été exécutés, les claims dont il est question dans le présent rapport étaient enregistrés au nom de leur titulaire actuel ou détenus à titre bénéficiaire par l'actuel titulaire enregistré.	Date <i>July 27, 1993</i>	Titulaire enregistré ou représentant (Signature) <i>G. Mullen</i>
--	------------------------------	--

Certification du rapport sur les travaux exécutés

Je certifie que j'ai une connaissance directe des faits exposés dans le présent rapport, pour avoir exécuté les travaux ou en avoir constaté l'exécution avant ou après leur achèvement. Je certifie aussi que le rapport ci-joint est exact.		
Nom et adresse du certificateur <i>Glenn J. Mullen (as above)</i>		
N° de téléphone <i>(819) 738-4082</i>	Date <i>July 27, 1993</i>	Certifié par (signature) <i>[Signature]</i>

Réservé au ministère

Valeur totale des crédits enregistrés <i>\$ 434</i>	Date d'enregistrement <i>August 11, 1993</i>	Registraire de claims <i>[Signature]</i>	Cachet reçu RECEIVED LARDER LAKE MINING DIVISION AUG 11 1993 TIME <u>9:00</u>
	Date de l'approbation prévue <i>7700 9193</i>	Date d'approbation	
	Date d'envoi de l'avis de modification		

Report of Work Conducted After Recording Claim

Mining Act

Transaction Number
DOCUMENT No. W 9380-00193

*Sons with Prospect
 Stuyvesant Prospecting*

Personal information collected on this form is obtained under the authority of the Mining Act. This information will be used for correspondence. Questions about this collection should be directed to the Provincial Manager, Mining Lands, Ministry of Northern Development and Mines, Fourth Floor, 159 Cedar Street, Sudbury, Ontario, P3E 6A5, telephone (705) 670-7264.

2.15129

- Instructions:**
- Please type or print and submit in duplicate.
 - Refer to the Mining Act and Regulations for requirements of filing assessment work or consult the Mining Recorder.
 - A separate copy of this form must be completed for each Work Group.
 - Technical reports and maps must accompany this form in duplicate.
 - A sketch, showing the claims the work is assigned to, must accompany this form.

Recorded Holder(s) Glenn J. Mullen (50%) & Tom Obradovich (50%)		Client No. 173,700
Address 2130 av. St-Philippe, Dubouison Quebec J4P 4W7		Telephone No. (819) 738-4082
Mining Division Larder Lake	Township/Area Cobalt	Mining Plan No. G-690
Dates Work Performed From: July 6, 1992 (field work)		To: November 30, 1992 (report)

Work Performed (Check One Work Group Only)

Work Group	Type
<input checked="" type="checkbox"/> Geotechnical Survey	
<input checked="" type="checkbox"/> Physical Work, Including Drilling	Manual Stripping + Prospecting
<input type="checkbox"/> Rehabilitation	
<input type="checkbox"/> Other Authorized Work	
<input type="checkbox"/> Assays	
<input type="checkbox"/> Assignment from Reserve	

RECEIVED
 AUG 13 1993
 MINING LANDS BRANCH

0/70/6.

Total Assessment Work Claimed on the Attached Statement of Costs \$ **1500.00**

Note: The Minister may reject for assessment work credit all or part of the assessment work submitted if the recorded holder cannot verify expenditures claimed in the statement of costs within 30 days of a request for verification.

Persons and Survey Company Who Performed the Work (Give Name and Address of Author of Report)

Name	Address
Tom Obradovich	75 Balsam Ave., Kirkland Lake, Ontario P2N 1W7
Randy Festerhake	*14-169A Ave. Perreault, Val d'Or, Quebec J4P 2H1

(attach a schedule if necessary)

Certification of Beneficial Interest * See Note No. 1 on reverse side

I certify that at the time the work was performed, the claims covered in this work report were recorded in the current holder's name or held under a beneficial interest by the current recorded holder.	Date July 27, 1993	Recorded Holder or Agent (Signature) <i>[Signature]</i> G. Mullen
--	------------------------------	---

Certification of Work Report

I certify that I have a personal knowledge of the facts set forth in this Work report, having performed the work or witnessed same during and/or after its completion and annexed report is true.		
Name and Address of Person Certifying Glenn J. Mullen (as above)		
Telephone No. (819) 738-4082	Date July 27, 1993	Certified By (Signature) <i>[Signature]</i>

For Office Use Only

Total Value Cr. Recorded \$1,500	Date Recorded August 11/93	Mining Recorder <i>[Signature]</i>	Received Stamp RECEIVED LARDER LAKE MINING DIVISION AUG 11 1993
	Deemed Approval Date Nov 9/93	Date Approved	TIME 9:00
	Date Notice for Amendments Sent		

TRINITY EXPLORATIONS

DOCUMENT NO.

W9380.00191

DOCUMENT NO.

W9380.00192

DOCUMENT NO.

W9380.00193

Statement of Costs - "JonSmith Prospect" - Cabot Township

Summer - Fall, 1992 Program

Item - Description	Cost
A) Survey Costs (\$14,005.62)	
- linecutting (14.8 km cut @ \$250/km; 7.2 km brushed and flagged @ \$125/km; + 7% GST)	= \$4922
- prospecting (1 prospector @ 20 field days)	= \$3000
- geophysical (VLF, 2 stations: Geonics EM-16)	= \$1100
- geophysical (magnetic: total field; GEM GSM-8)	= \$1100
- geophysical consulting & report (S. Carmichael)	= \$300
- final prospecting report (2 days + maps 1 day)	= \$750
- 19 rock sample assays	= \$433.62
- equipment rentals (boat rental: 1 month)	= \$500
- drafting fees for maps (10 hours @ \$25/hour)	= \$250
- drafting supplies for sketches (mylar, etc.)	= \$50
- consumables (flagging, sample bags, topofill)	= \$100
- manual stripping, trenching, and sampling (5 days * 2 people)	= \$1500
B) Support Costs (\$3600)	
- vehicle mileage (2000 km @ \$0.30/km)	= \$600
- food & accomodation (40 days total @ \$75/day)	= \$3000

Total Allowable for Assessment Credit: \$14,005.62 * 20% = \$2801.24; 14,005.62 + \$2801.24 = \$16,806.74

Subtotals: \$16,806.74

The above cost breakdown has been derived from information supplied by the author, Tom Obradovich, at my request.

Submitted by:

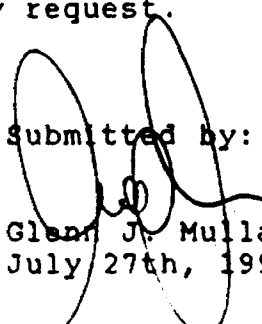
Glenn J. Mullan
July 27th, 1993

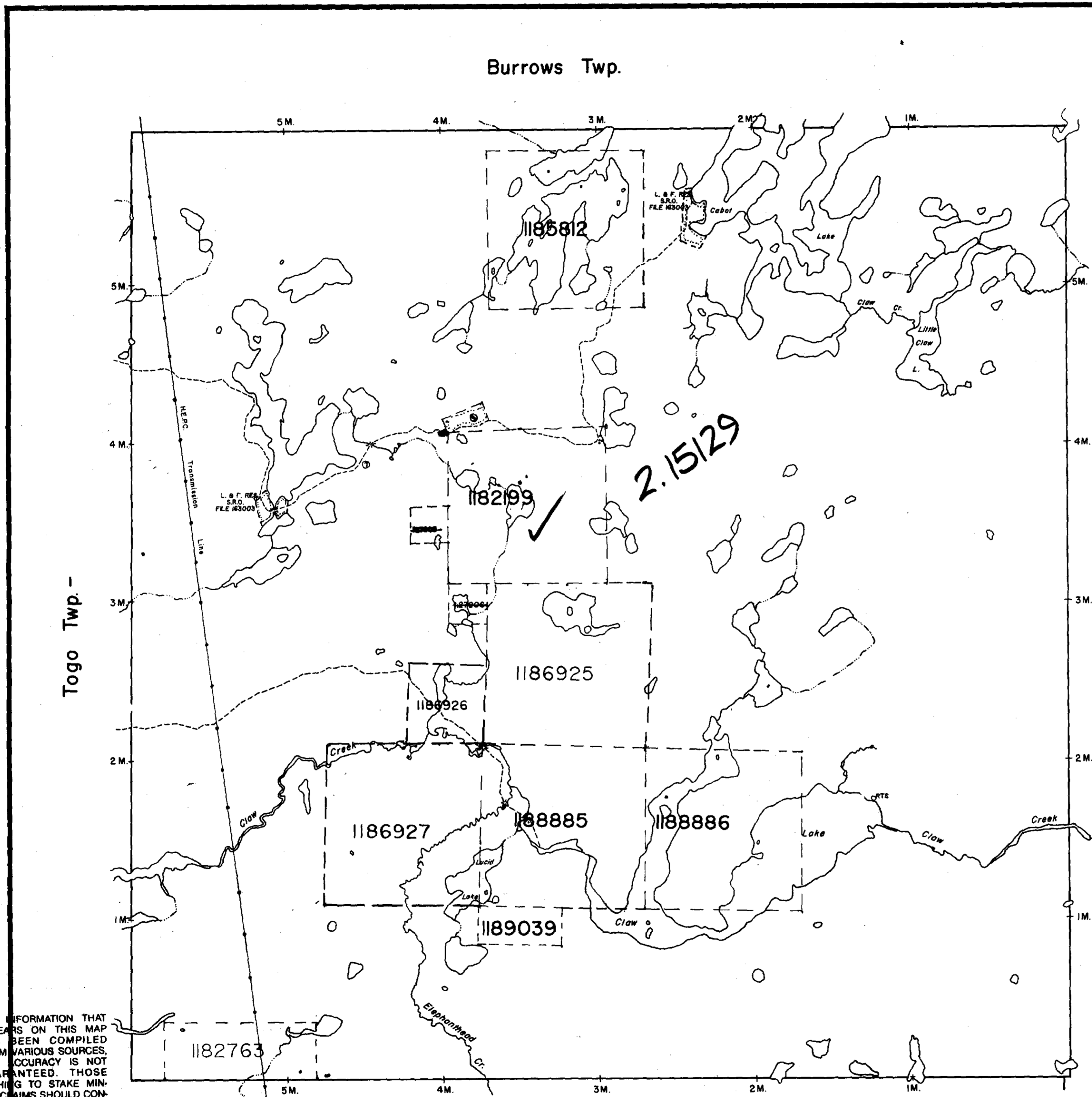

THE INFORMATION THAT APPEARS ON THIS MAP HAS BEEN COMPILED FROM VARIOUS SOURCES, AND ACCURACY IS NOT GUARANTEED. THOSE WISHING TO STAKE MINING CLAIMS SHOULD CONSULT WITH THE MINING RECORDER, MINISTRY OF NORTHERN DEVELOPMENT AND MINES, FOR ADDITIONAL INFORMATION ON THE STATUS OF THE LANDS SHOWN HEREON.



LEGEND

- HIGHWAY AND ROUTE No.
- OTHER ROADS
- TRAILS
- SURVEYED LINES:
 - TOWNSHIPS, BASE LINES, ETC.
 - LOTS, MINING CLAIMS, PARCELS, ETC.
- UNSURVEYED LINES:
 - LOT LINES
 - PARCEL BOUNDARY
 - MINING CLAIMS ETC.
- RAILWAY AND RIGHT OF WAY
- UTILITY LINES
- NON-PERENNIAL STREAM
- FLOODING OR FLOODING RIGHTS
- SUBDIVISION OR COMPOSITE PLAN RESERVATIONS
- ORIGINAL SHORELINE
- MARSH OR MUSKEG
- MINES
- TRAVERSE MONUMENT

DISPOSITION OF CROWN LANDS

TYPE OF DOCUMENT	SYMBOL
PATENT, SURFACE & MINING RIGHTS	●
" SURFACE RIGHTS ONLY	○
" MINING RIGHTS ONLY	◐
LEASE, SURFACE & MINING RIGHTS	■
" SURFACE RIGHTS ONLY	◼
" MINING RIGHTS ONLY	◻
LICENCE OF OCCUPATION	◄
ORDER-IN-COUNCIL	OC
RESERVATION	⊙
CANCELLED	⊗
SAND & GRAVEL	⊙
TRAPLINE CABIN	T

SCALE: 1 INCH = 40 CHAINS

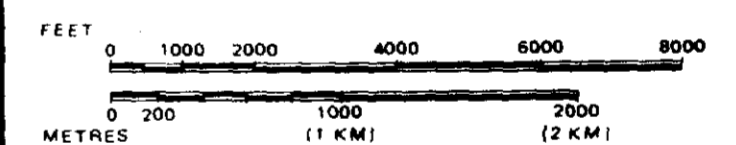

TOWNSHIP

CABOT

M.N.R. ADMINISTRATIVE DISTRICT DATE OF ISSUE
 TIMMINS AUG 11 1990
 MINING DIVISION LARDER LAKE
 LARDER LAKE MINING RECORDERS' OFFICE
 LAND TITLES / REGISTRY DIVISION
 SUDBURY



Ministry of Natural Resources
 Ministry of Northern Development and Mines

Date _____ Number **G-960**

NOTICE OF FORESTRY ACTIVITY

THIS TOWNSHIP/AREA FALLS WITHIN THE SHININGTREE MANAGEMENT UNIT AND MAY BE SUBJECT TO FORESTRY OPERATIONS. THE MNR UNIT FORESTER FOR THIS

AREA CAN BE CONTACTED AT P.O. BOX 129, LOW AVENUE, GOGAMA, ONTARIO, P0M 1W0

TELEPHONE 705-894-2000

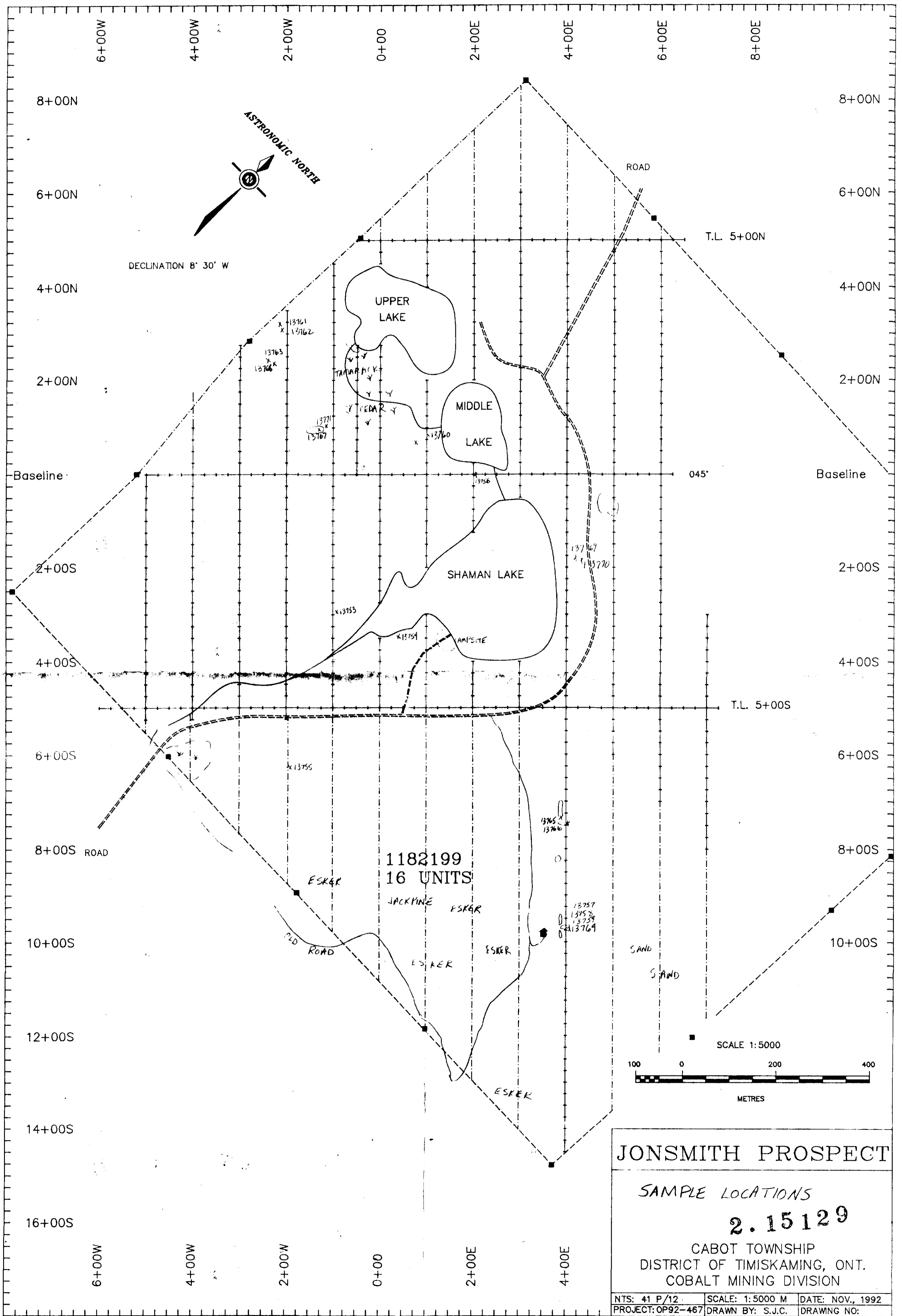

JONSMITH PROSPECT

SAMPLE LOCATIONS
2.15129

CABOT TOWNSHIP
DISTRICT OF TIMISKAMING, ONT.
COBALT MINING DIVISION

NTS: 41 P/12	SCALE: 1:5000 M	DATE: NOV., 1992
PROJECT: OP92-467	DRAWN BY: S.J.C.	DRAWING NO:



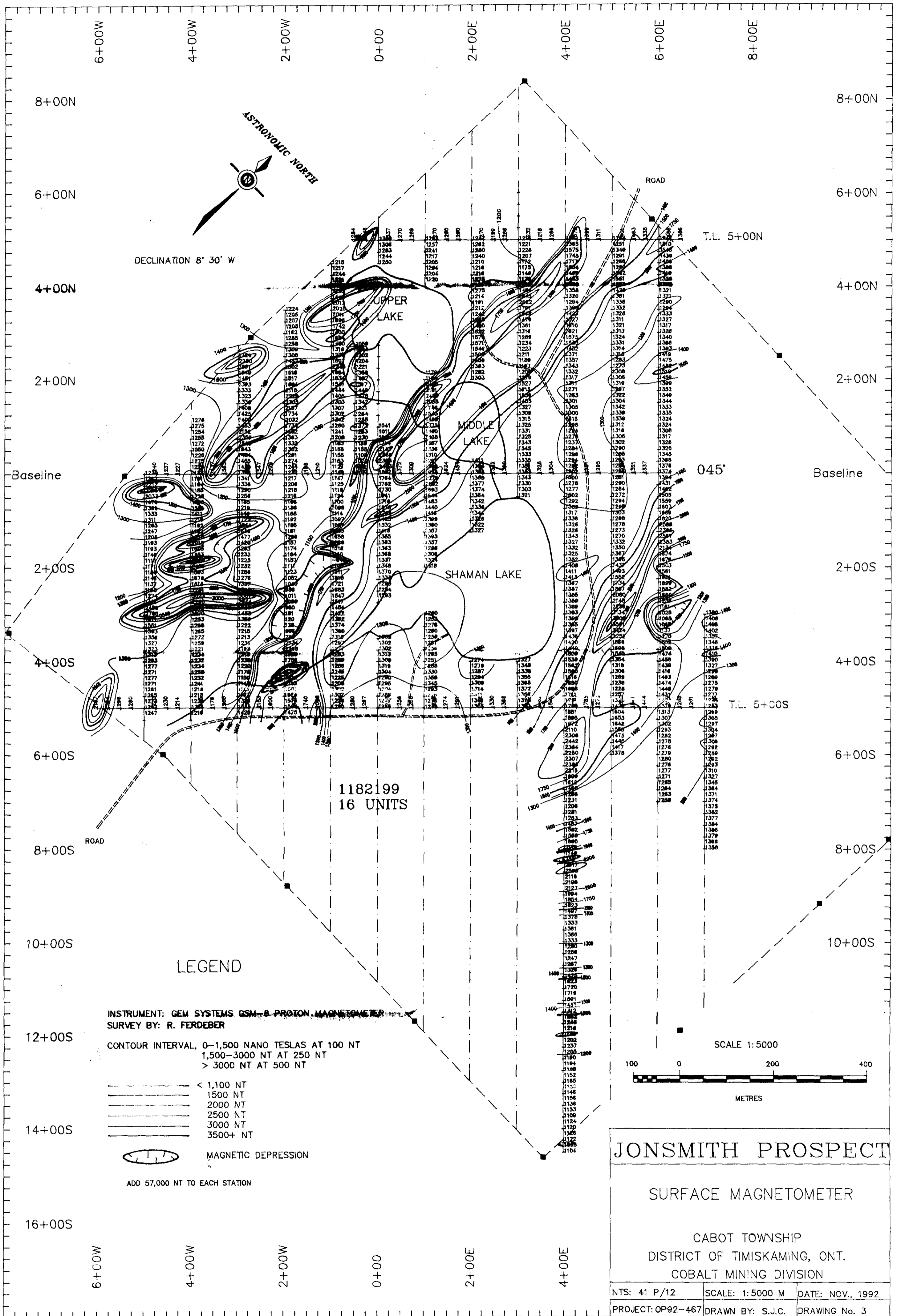

ASTRONOMIC NORTH
DECLINATION 8° 30' W

INSTRUMENT: GEM SYSTEMS GSM-8 PROTON MAGNETOMETER
SURVEY BY: R. FERDEBER
CONTOUR INTERVAL, 0-1,500 NANO TESLAS AT 100 NT
1,500-3000 NT AT 250 NT
> 3000 NT AT 500 NT

- < 1,100 NT
 - 1500 NT
 - 2000 NT
 - 2500 NT
 - 3000 NT
 - 3500+ NT
 - MAGNETIC DEPRESSION
- ADD 57,000 NT TO EACH STATION

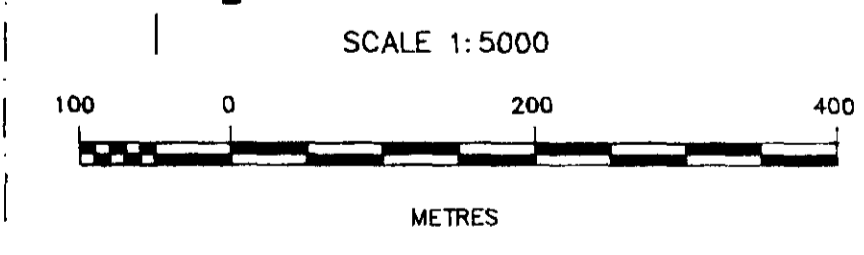

JONSMITH PROSPECT
SURFACE MAGNETOMETER
CABOT TOWNSHIP
DISTRICT OF TIMISKAMING, ONT.
COBALT MINING DIVISION

NTS: 41 P/12	SCALE: 1:5000 M	DATE: NOV., 1992
PROJECT: OP92-467	DRAWN BY: S.J.C.	DRAWING No. 3

2.15129



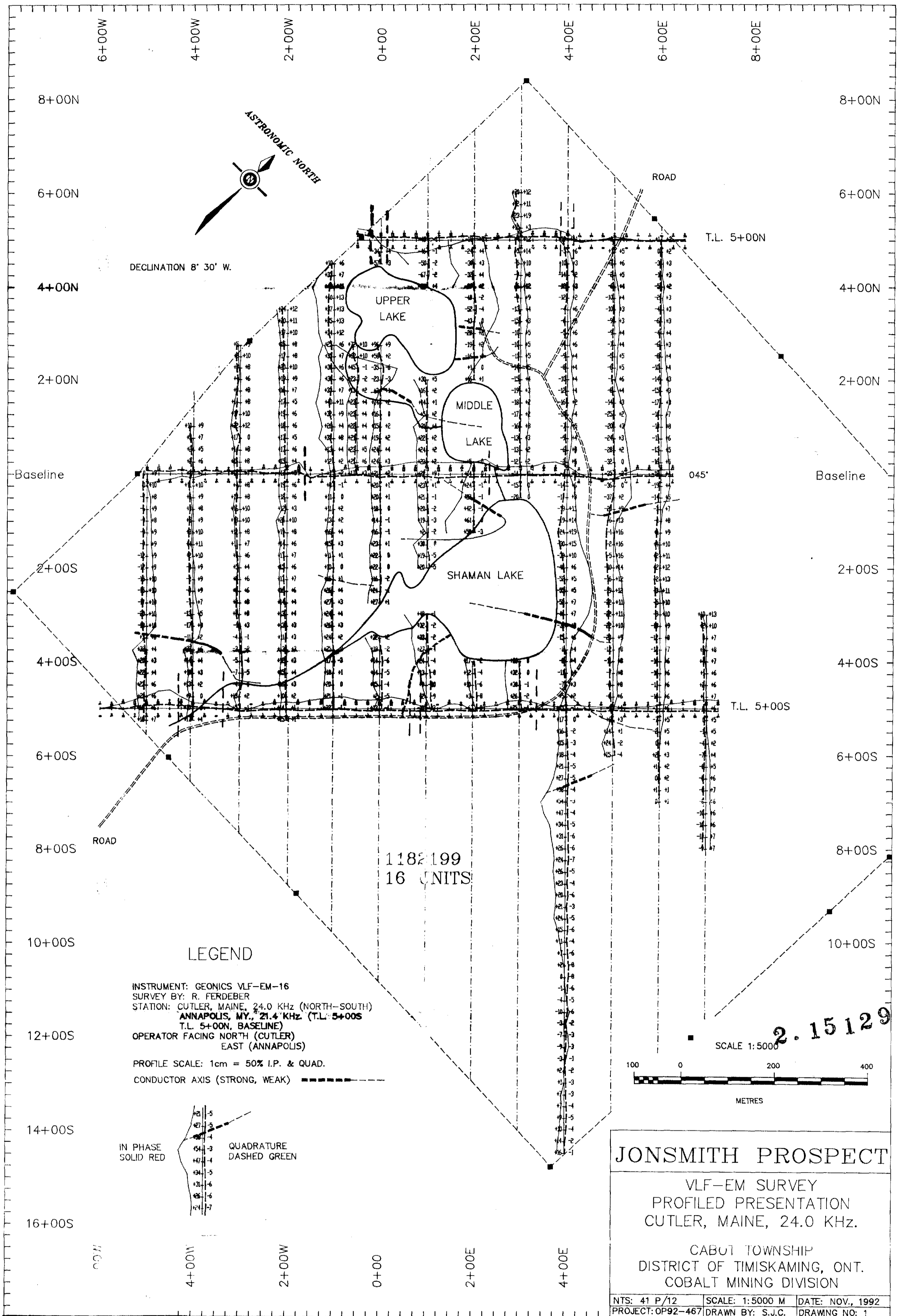

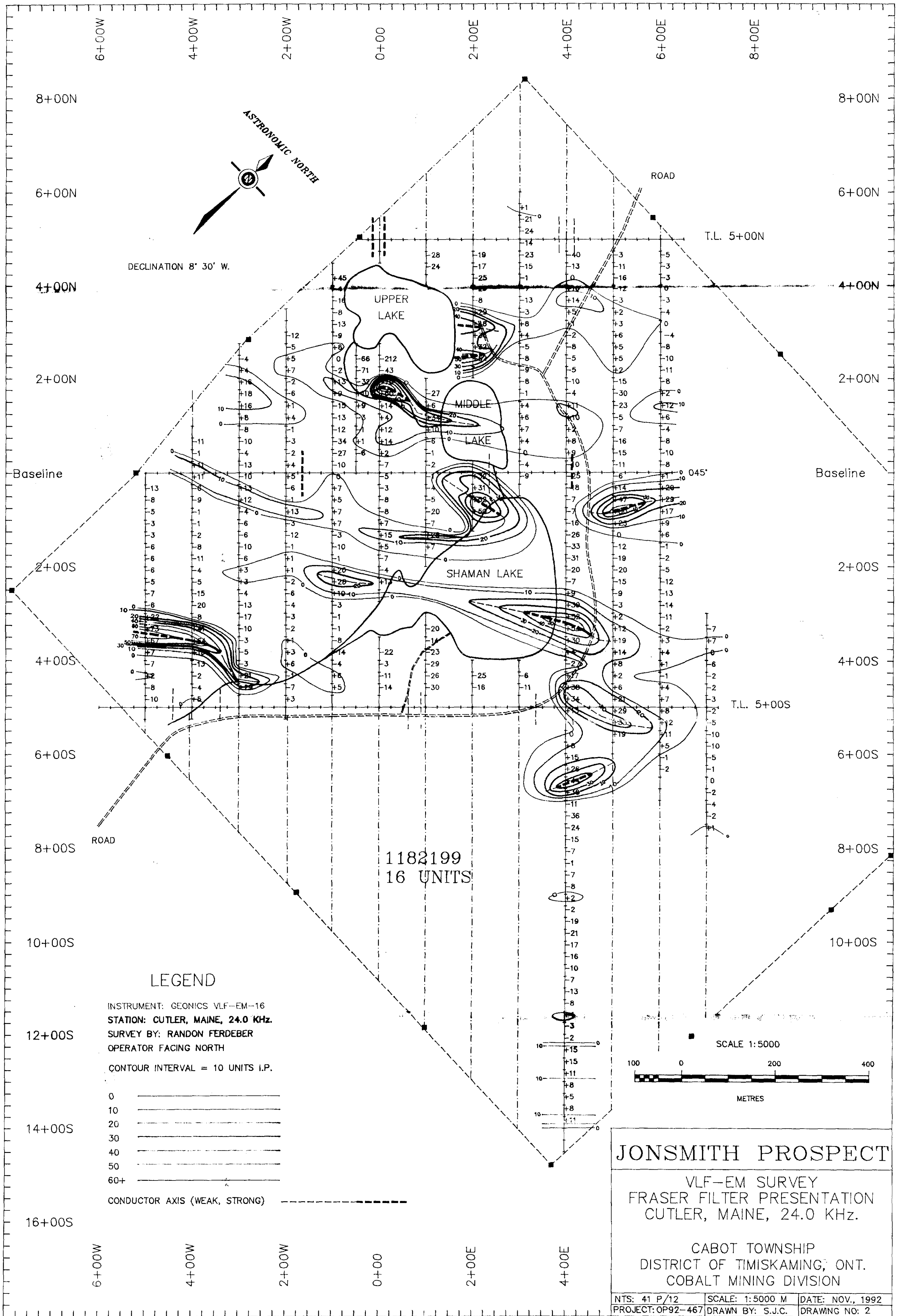

2.15129

