



41P11SE0086 2.17023 MACMURCHY

010

REPORT
on
STRIPPING/TRENCHING
and
SAMPLING
on
CLAIMS HELD BY ROBIN WHELAN
MacMURCHY TOWNSHIP, ONTARIO

2.17023

RECEIVED
JAN 21 1997
MINING LANDS BRANCH

*Anal. #
2.8489*

BRIAN H. MADILL
DECEMBER 1996

TABLE OF CONTENTS

- 1.0 INTRODUCTION
 - 1.1 PROPERTY DESCRIPTION
 - 1.2 ACCESS
- 2.0 GENERAL GEOLOGY
- 3.0 PREVIOUS WORK
- 4.0 EXPLORATION PROGRAM
- 5.0 RESULTS
- 6.0 CONCLUSIONS AND RECOMMENDATIONS
- 7.0 BIBLIOGRAPHY
- 8.0 CERTIFICATE OF QUALIFICATIONS

FIGURES

- 1) Claim Map (Plan No. G-988/1:20,000)
- 2) Geology Plan (Map 2365/1:31,680)
- 3) Sample Location Plan (1"=800')
- 4) Knox Vein Detail Grid (1"=100')
- 5) Plan of Stripped Areas (1"=400')
- 6) Sample Location Plan (1"=40')

APPENDIX 1 - Assay Certificate 6W-4989-RG1

APPENDIX 2 - Assay Certificate 6W-5263-RG1

1.0 INTRODUCTION

This report discusses the results of a Stripping, Trenching and Sampling Program conducted over two unpatented mining claims located in the southwest corner of MacMurchy Township, Larder Lake Mining Division.

1.1 PROPERTY DESCRIPTION

The property consists of five contiguous unpatented mining claims totalling approximately six units. These claims straddle the southwest shore of Knox Lake and are known as the Knox Lake Group. (see Figure 1)

The claim numbers are as follows:

L-1186201
L-1186375*
L-1186376
L-1200322*
L-1200323

(* Denotes claims where work was performed)

1.2 ACCESS

The Knox Lake Group can be accessed from Highway 560, west of Gowganda via the Bay Lumber Road. Travelling south along the Bay Lumber Road a distance of approximately 4 km to a fork in the road. The claims can be accessed by travelling west and north along a series of logging roads a distance of approximately 3 km to within walking distance of the Knox Vein on claim L-1200322.

2.0 GENERAL GEOLOGY

As indicated by the geology on O.D.H. Map 2365, MacMurchy and Tyrell Townships (see Figure 2) the southwest corner of MacMurchy Township is underlain by northwest trending felsic, intermediate and mafic metavolcanics cut by north-south trending diabase dykes of the Matachewan type. Gold deposits in the area occur in silicified carbonatized shears, or in quartz veins occupying shears or fractures.

3.0 PREVIOUS WORK

Exploration in the area dates to 1911 with the discovery of gold on the west shore of Wasapika Lake, on ground that became part of the Bilmac Gold Mines Limited Property. Intermittent exploration has been conducted on the property from 1919 to 1938 and reserves are estimated to be 250,000 tons of 0.34 oz/ton Au in quartz veins in a shear.

The Rhonda Mine, a past producer is located near the Churchill-MacMurchy Township line approximately 500 metres northwest of Violet Lake, Exploration on the Rhonda dates to 1912

and all production was in 1939 when 2727 oz Au and 4830 oz Au were recovered from 24,592 tons of ore.

Mayflower Mines Limited recorded work in the early 1970's on 17 claims in three groups partly on ground covered by this report. The work consisted of magnetic and V.L.F. electromagnetic, geological mapping, geochemical surveys and a three hole diamond drill program, of the three holes one was drilled on ground covered by this report. No significant mineralization was reported. O.D.M. Geoscience Report 152 and accompanying Map 2365 indicate that two holes were drilled by Grantland Gold Mines Limited in 1954 on the east side of Wasapika Lake between Wasapika Lake and Knox Lake. No reference to these holes was found in the Cobalt Residents Geologists Office assessment files or on the MacMurchy Township G.D.I.F.

In 1993, as part of an O.P.A.P. Grant (OPAP File OP93-664), a grid was established on mining claims L-1186375, L-1200322 and L-1200323 (see Figure 3) by J.M. Whelan. Magnetic and V.L.F. electromagnetic surveys were carried out. A small detailed grid was established on claim L-1200322 (see Figure 4) in the area of the Knox Vein. Two old trenches were cleaned out and enlarged using a gas plugger and explosives, as well two new areas southwest of the Knox Vein were blasted and sampled (see figure 3, Trench 2). Magnetic and electromagnetic surveys were carried out on the detailed grid over the Knox Vein.(see Figure 4)

4.0 EXPLORATION PROGRAM

During late November, 1996, an expanded program consisting of stripping, trenching, blasting and sampling was carried out over two areas, covering claims L-1186375 and L-1200322 (see Figure 5).

Area "A", on claim L-1186375 was exposed for an area 200 ft long by 125 ft wide to expose quartz-veining in a silicified, carbonatized shear with up to 5% pyrite in places. Area "B", on claim L-1200322 was stripped and exposed for an area 110 ft long by 40 ft wide to further expose the north vein of the Knox Veins. The Case Model 550 Excavator, with a 2.5 cu. yard bucket was used for the stripping and trenching. In area "B" four samples (N-01 to N-04) (see Figure 6) were taken from areas 3'x3' that were drilled using the Cobra Plugger, and blasted using stick powder and detonators.

On November 23, Robin Whelan and myself made a site visit to inspect the progress of the stripping and also to do some prospecting. A further five samples were collected. Three samples of an old trench that lies at grid coordinates L4+10'E/010'S and two samples of the north Knox Vein (see Figure 5). These are described as follows:

<u>Sample Number</u>	<u>Description</u>
09895	Quartz veins and stringers in andesitic shear, sericitic, silicified, pyrite.
09896	As above.
09897	Most quartz vein, abundant pyrite, some minor chalcopyrite.
09898*	Quartz vein in carbonatized, rusty shear, 1% fine pyrite.
09899*	As above.

(* Knox Vein)

5.0 RESULTS

Results of the five samples 09895 to 09899 (inclusive) are documented by assay certificate number 6W-4989-RG1 which accompanies this report.

Results of the four samples N-01 to N-04 (inclusive) are documented by assay certificate number 6W-5263-RG1 which accompanies this report.

Results of sample N-05 are pending at this point in time. Results will be forwarded as soon as possible.

6.0 CONCLUSIONS AND RECOMMENDATIONS

Results of the limited sampling program are encouraging. From a low of 5 ppb Au to a high of 804 ppb Au in nine samples would to me suggest further work.

It is recommended at this point that the stripped areas could be washed of dirt and mud in order that the areas be mapped in greater detail. Channel sampling across the shear zones to further test for their gold potential as determined by detail geology, would also be recommended.

7.0 REFERENCES

- 1993 - Whelan, J.M.: Report on exploration on claims held by Jim Whelan in MacMurchy Township. O.P.A.P. File OP93-664
- 1990 - O.G.S., Geological Data Inventory Folio: 518 compiled by the staff of the Resident Geologist Office, Cobalt, Ontario.
- 1979 - J.B. Gordon, H.L. Lovell, Jan de Grijs and R.F. Davis: Gold Deposits in Ontario, Part Z; O.G.S. Minerals Deposits Circular 18 pp. 74-76.
- 1977 - Carter, M.W.: Geology of MacMurchy and Tyrell Townships, Districts of Sudbury and Timiskaming; O.D.M. Geoscience Report 152; 69 pp., and Map 2365, 1:31680
- 1920 - Hopkins, P.E.: West Shining Tree Gold Area, in Ontario Department of Mines, Annual Report, Vol XXIX, Part III, pp. 28-82 and Map 29a, 1:31680

8.0 CERTIFICATE OF QUALIFICATIONS

STATEMENT OF QUALIFICATIONS

I, Brain H. Madill, with respect to this Geophysical Report, do hereby certify:

- 1) That I am a 1979 graduate of the Geological Engineering Technician's Program of Cambrian College, Sudbury, Ontario.
- 2) That I have continuously practiced my profession for the past sixteen years, and I am qualified to write this report.
- 3) That I have personally supervised the exploration program carried out under the auspicious of the report
- 4) That I currently reside at 142 Carter Avenue, Kirkland Lake, Ontario, P2N 2A2.

12/31/96
Date



Brian H. Madill

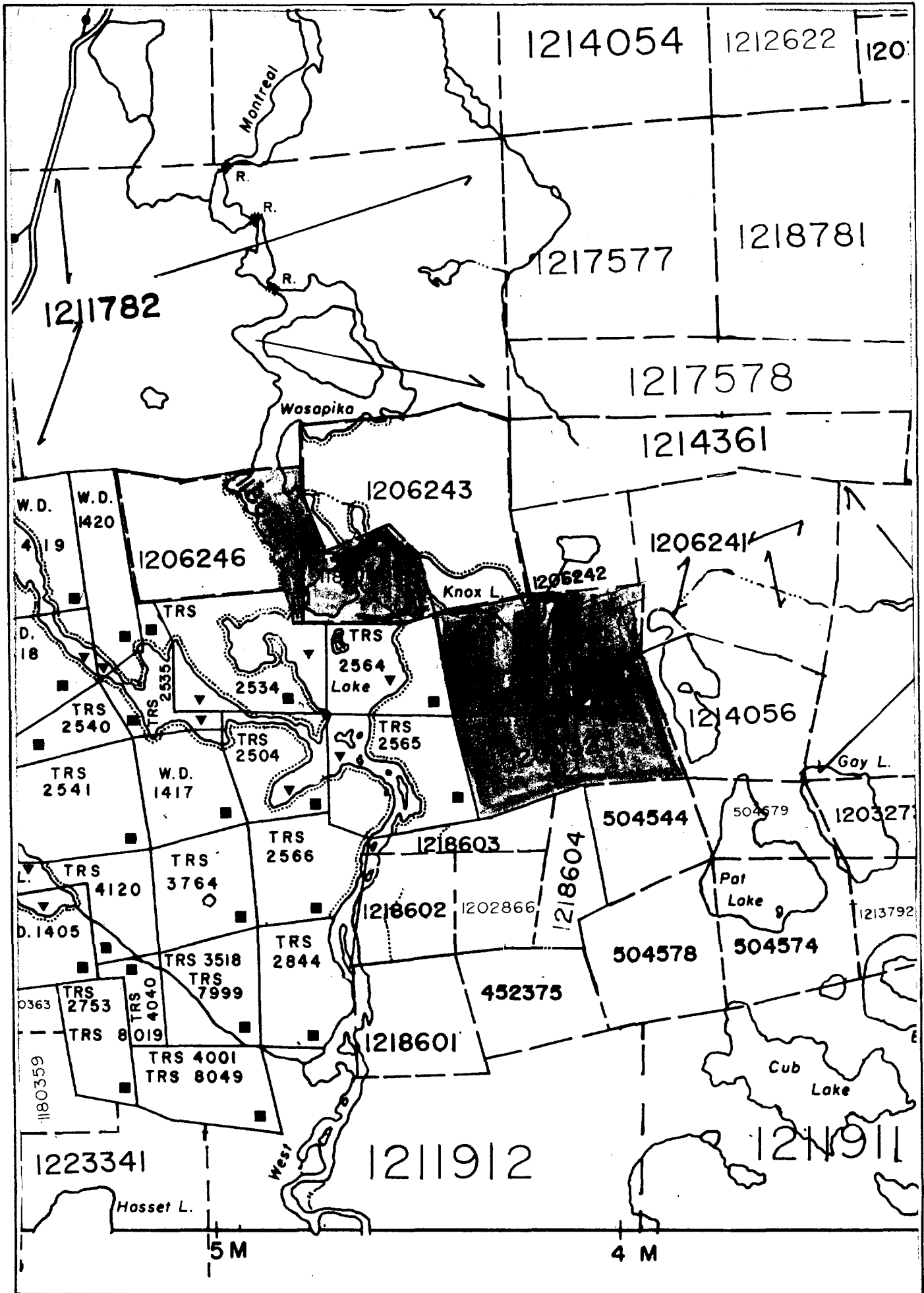
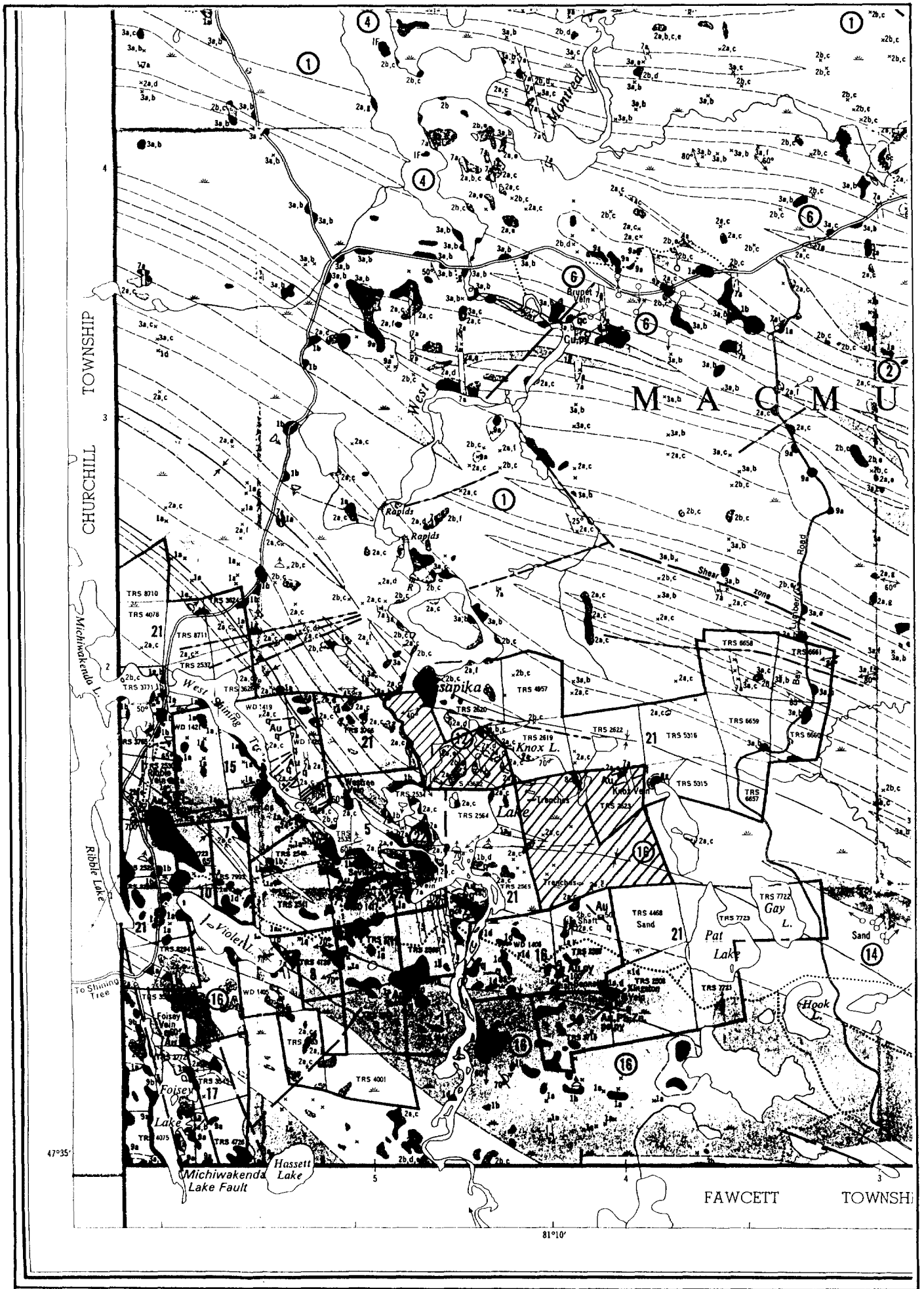

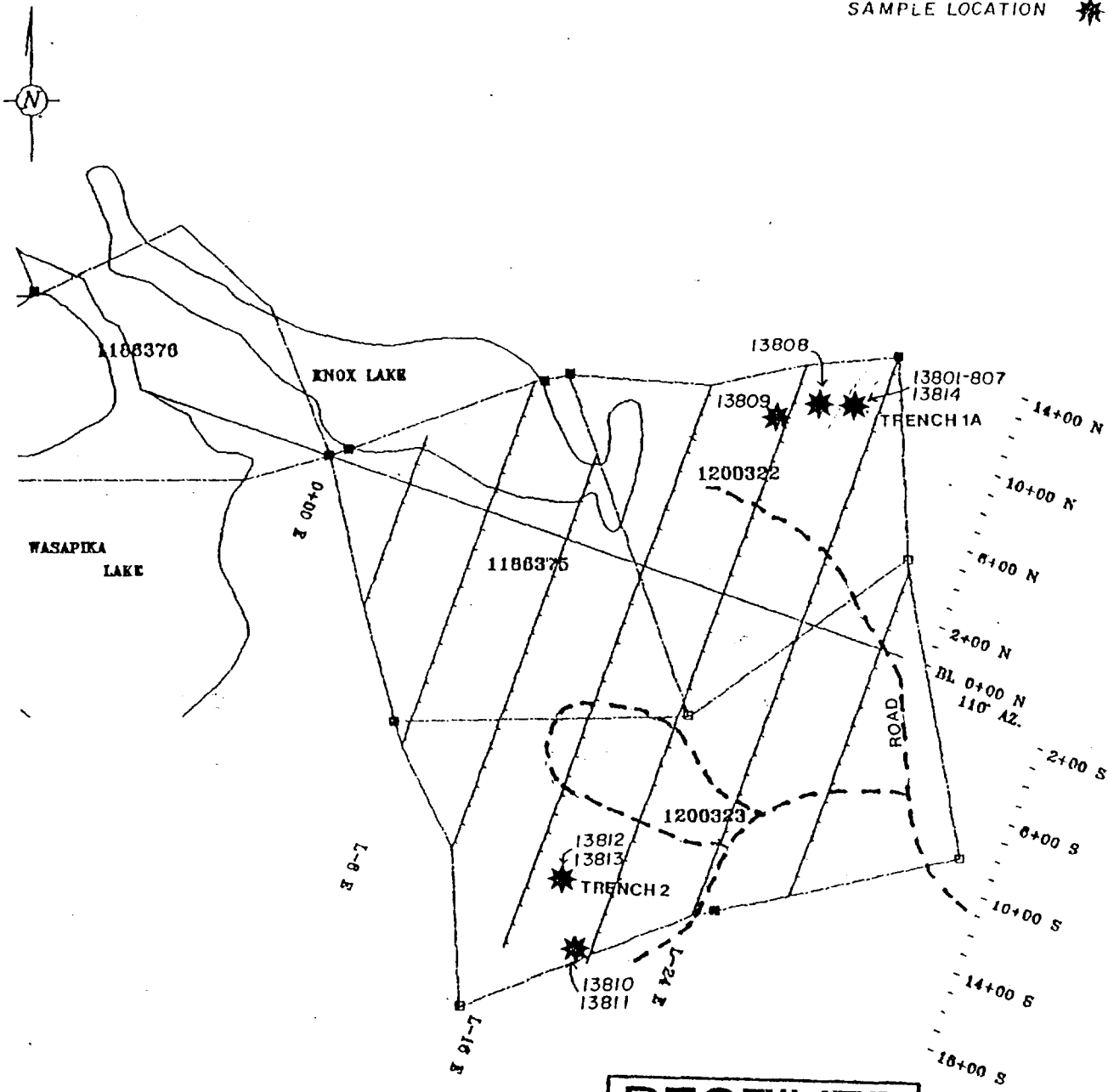

FIGURE: 1



(After MAP 2365. MacMurray and Tyrrell Townships) FIGURE 2

SAMPLE LOCATION 



RECEIVED
JUL 19 1994
RESIDENT GEOLOGIST
COBALT

MACMURCHY PROJECT, KNOX GROUP

MACMURCHY TOWNSHIP, LARDER LAKE MINING DIVISION ONTARIO, NTS 41P/11

SAMPLE LOCATION PLAN

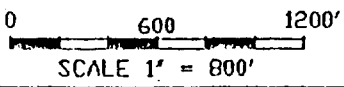
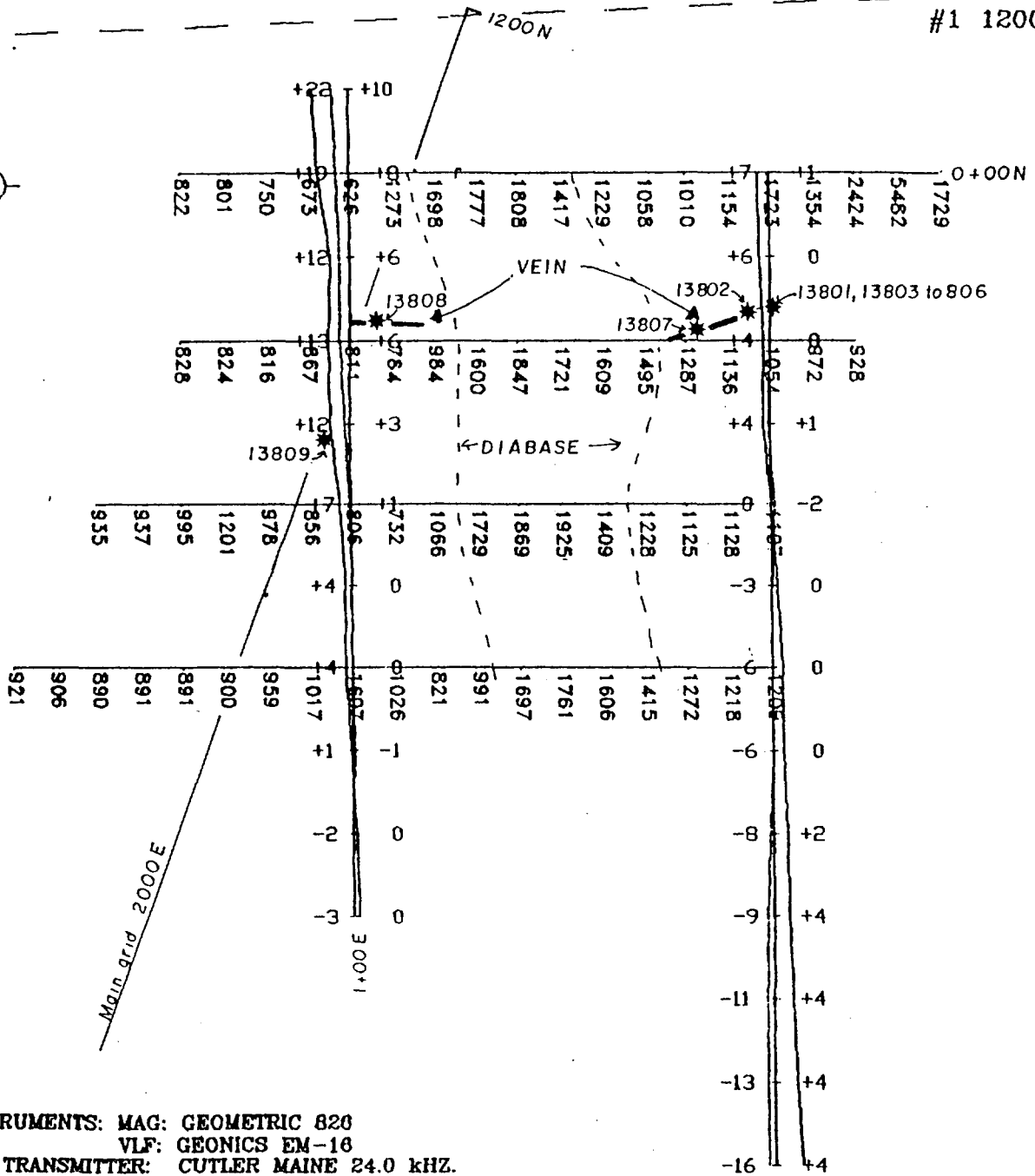
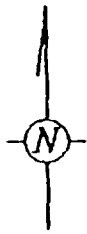

FIGURE: 3

#1 1200322



INSTRUMENTS: MAG: GEOMETRIC 820
 VLF: GEONICS EM-16
 VLF TRANSMITTER: CUTLER MAINE 24.0 KHZ.
 VERTICAL SCALE: 1" = 100%
 OPERATOR FACING NORTH
 MAG DATUM: 57000 nT.

* SAMPLE

KNOX VEIN DETAIL GRID
 CLAIM 1200322 MACMURCHY TOWNSHIP
 MAGNETIC & VLF-EM SURVEYS

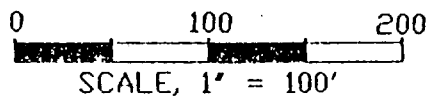
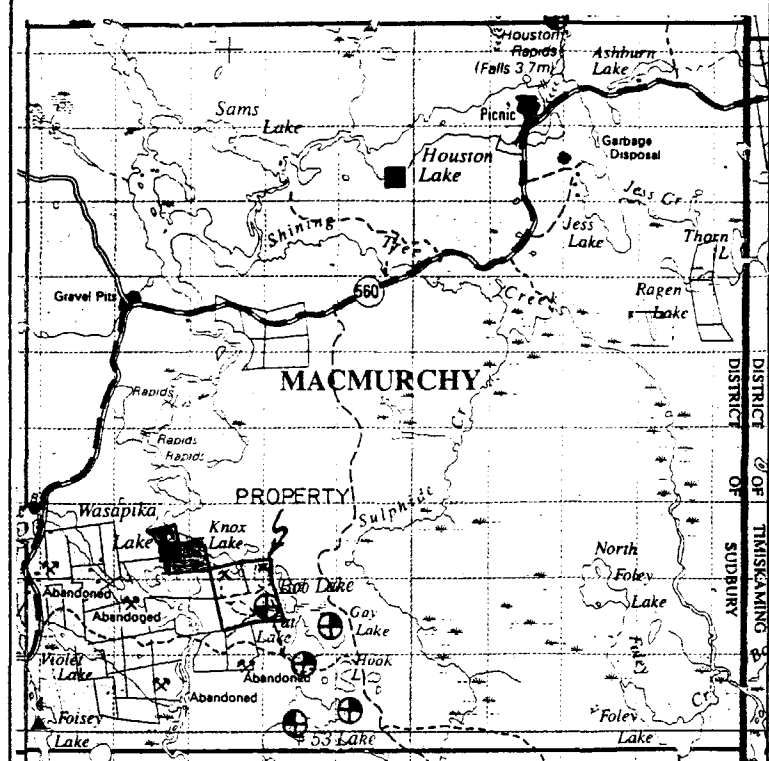
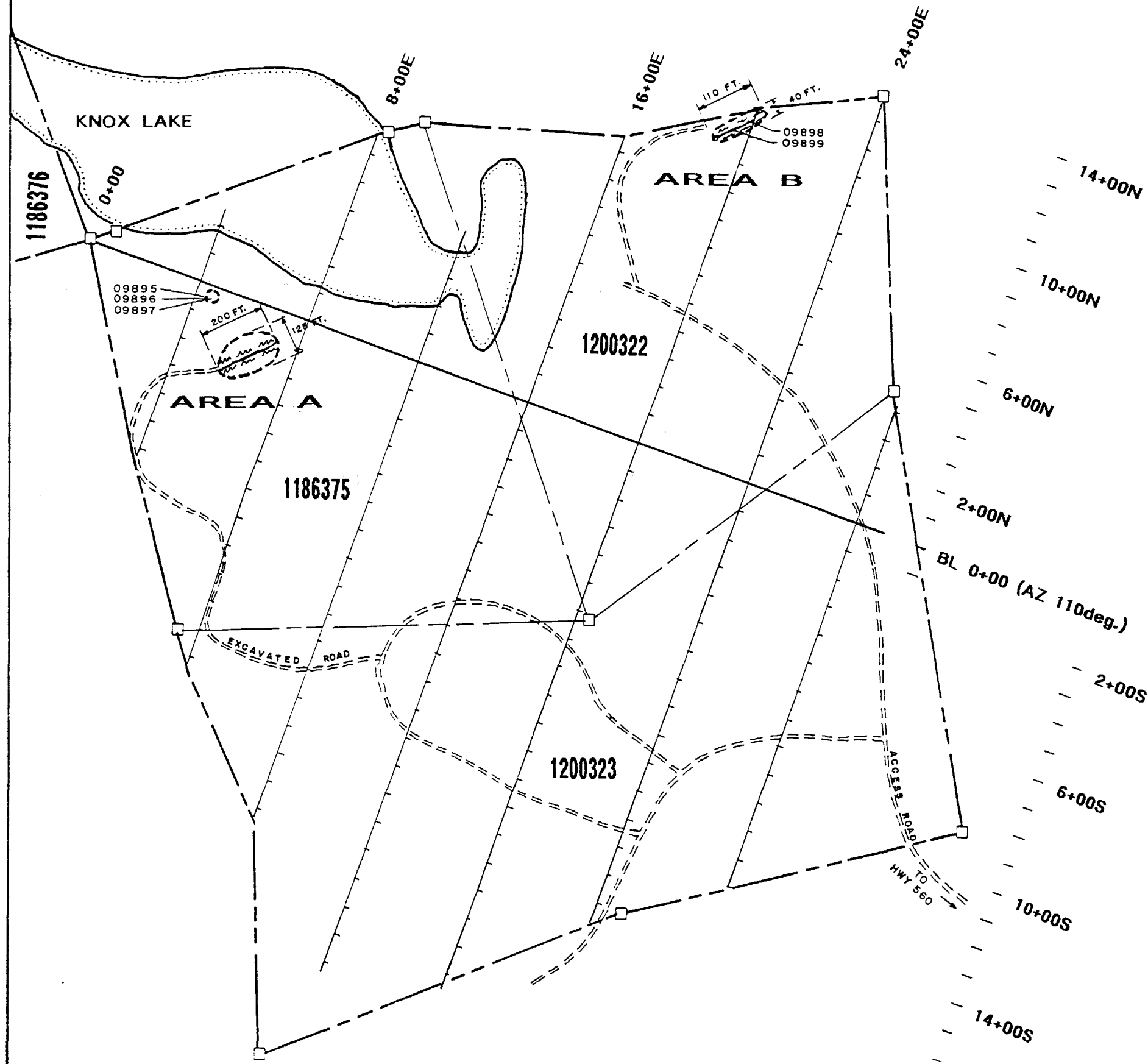

FIGURE: 4



LOCATION PLAN
0 1.0 2.0 3.0
(KMS)

MACMURCHY PROJECT
KNOX GROUP

PLAN of STIPPED AREAS
(MINING CLAIMS L-1186375 and L-1200322)
MACMURCHY TOWNSHIP, ONTARIO

N.T.S. 1	41 P/11	DATA BY: B. Madill
0 200 400 FEET		DRAWN BY: B. Madill
		DATE: December 1996

SAMPLE LOCATION PLAN



MAG. DECL.
09°00'W.

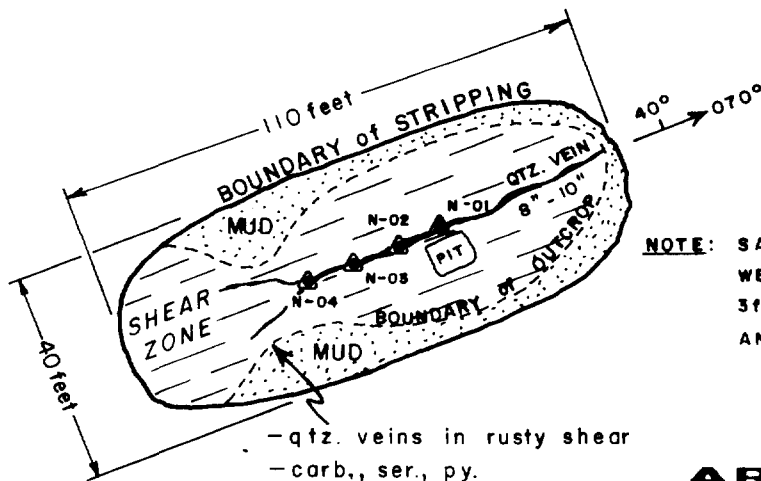

NOTE: SAMPLES N-01 to N-04
WERE TAKEN FROM AREAS
3ft X 3ft THAT WERE DRILLED
AND BLASTED.

AREA B

SCALE: 1 INCH = 40 FEET

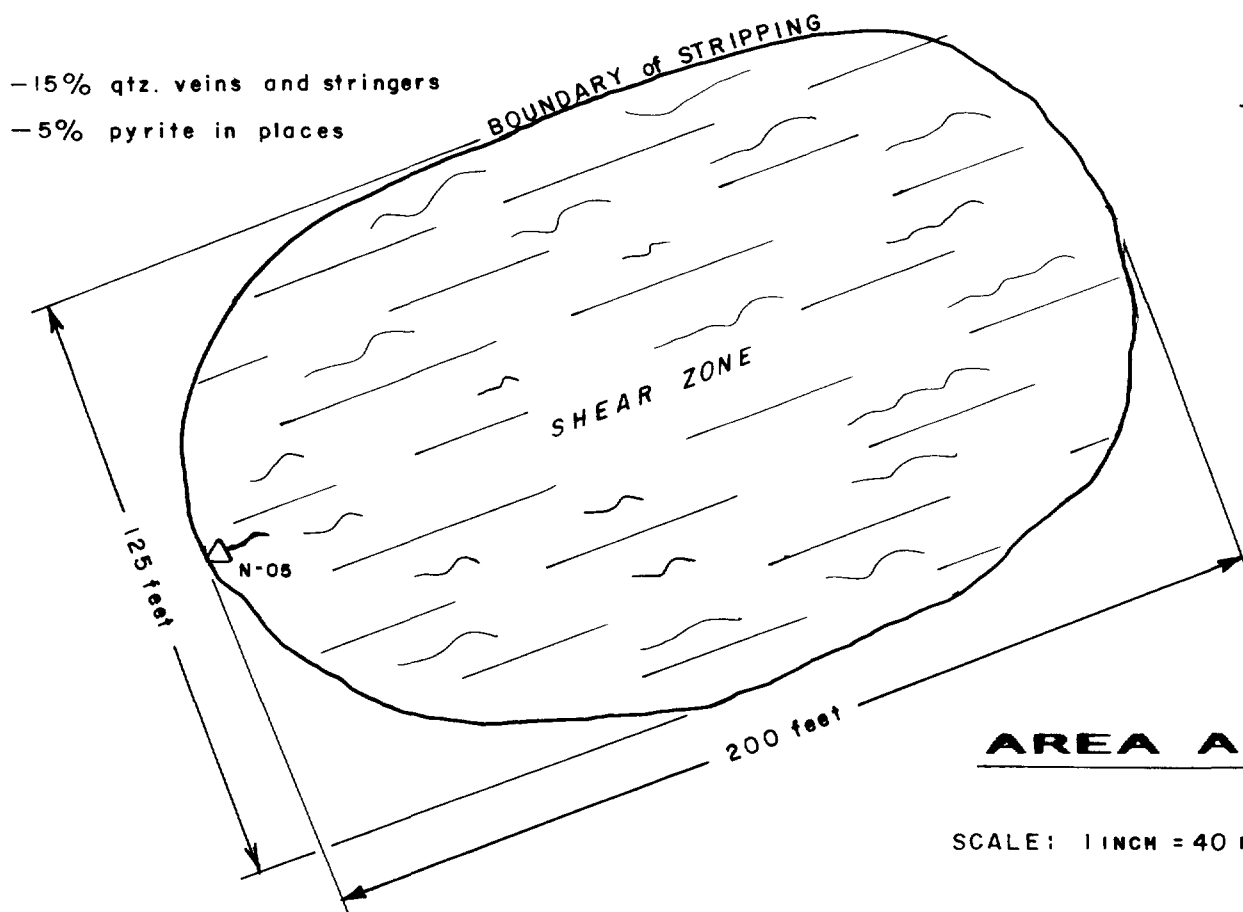

-15% qtz. veins and stringers
-5% pyrite in places

AREA A

SCALE: 1 INCH = 40 FEET

APPENDIX



Swastika Laboratories

A Division of TSL/Assayers Inc.

Assaying • Consulting • Representation

Established 1928

Geochemical Analysis Certificate

6W-4989-RG1

Company: **R. WHALEN**

Date: DEC-04-96

Project:

Attn: R. Whalen

We hereby certify the following Geochemical Analysis of 5 Grab samples submitted NOV-25-96 by .

Sample Number	Au PPB	Au Check PPB
09895	516	477
09896	5	-
09897	57	-
09898	240	264
09899	75	-

One assay ton portion used.

Certified by _____



Swastika Laboratories

A Division of TSL/Assayers Inc.

Assaying - Consulting - Representation

Established 1928

Geochemical Analysis Certificate

6W-5263-RG1

Company: **T. O'CONNOR**
Project: MacMurchy
Attn: T. O'Connor

Date: DEC-18-96

We hereby certify the following Geochemical Analysis of 4 Rock samples submitted DEC-11-96 by .

Sample Number	Au PPB	Au Check PPB
N-01/96	163	166
N-02/96	168	-
N-03/96	804	720
N-04/96	55	-

One assay ton portion used.

Certified by

P.O. Box 10, Swastika, Ontario P0K 1T0
Telephone (705) 642-3244 FAX (705) 642-3300

Personal information cc Mining Act, the informat Questions about this 933 Ramsey Lake Road



900

6(3) of the Mining Act. Under section 8 of the Act and correspond with the mining land holder. Northern Development and Mines, 6th Floor,

Instructions: - For work performed on Crown Lands before recording a claim, use form 0240.
- Please type or print in ink.

1. Recorded holder(s) (Attach a list if necessary)

Name	ROBIN CLOWATER WHELAN	Client Number	301171
Address	41 PREMIER AVENUE WEST	Telephone Number	(705) 568-8160
	KIRKLAND LAKE, ONTARIO P2N 2S7	Fax Number	as above
Name		Client Number	
Address		Telephone Number	
		Fax Number	

2. Type of work performed: Check (✓) and report on only ONE of the following groups for this declaration.

- Geotechnical: prospecting, surveys, assays and work under section 18 (regs) Physical: drilling, stripping, trenching and associated assays Rehabilitation

Work Type	PHYSICAL - STRIPPING; TRENCHING; BLASTING & SAMPLING	Office Use
Dates Work Performed	From 22 11 96 To 25 11 96	Commodity
Global Positioning System Data (if available)	Township/Area MACMURCHY TWP	Total \$ Value of Work Claimed 6067
	M or G-Plan Number G-988	NTS Reference
		Mining Division Larder Lake
		Resident Geologist District Coburn

Please remember to: - obtain a work permit from the Ministry of Natural Resources as required;
- provide proper notice to surface rights holders before starting work;
- complete and attach a Statement of Costs, form 0212;
- provide a map showing contiguous mining lands that are linked for assigning work;
- include two copies of your technical report.

3. Person or companies who prepared the technical report (Attach a list if necessary)

Name	BRIAN H. MADILL	Telephone Number	(705) 567-6137
Address	42 CARTER AVE., KIRKLAND LAKE P2N 2A2	Fax Number	(705) 567-4073
Name		Telephone Number	
Address		Fax Number	
Name		Telephone Number	
Address		Fax Number	

4. Certification by Recorded Holder or Agent

I, ROBIN CLOWATER WHELAN, do hereby certify that I have personal knowledge of the facts set forth in this Declaration of Assessment Work having caused the work to be performed or witnessed the same during or after its completion and, to the best of my knowledge, the annexed report is true.

Signature of Recorded Holder or Agent	<i>Robin Whelan</i>	Date	Jan 3/97
Agent's Address	41 PREMIER AVE, WEST, KIRKLAND LAKE, ONT.	Telephone Number	(705) 568-8160
		Fax Number	(705) 568-8160

Jan 3/97

5. work to be recorded and distributed. Work can only be assigned to claims that are contiguous (adj. the mining land where work was performed, at the time work was performed. A map showing the contiguous must accompany this form.

Mining Claim Number. Or if work was done on other eligible mining land, show in this column the location number indicated on the claim map.	Number of Claim Units. For other mining land, list hectares.	Value of work performed on this claim or other mining land.	Value of work applied to this claim.	Value of work assigned to other mining claims.	Bank. Value of work to be distributed at a future date.
eg TB 7827	16 ha	\$26,825	N/A	\$24,000	\$2,825
eg 1234567	12	0	\$24,000	0	0
eg 1234568	2	\$8,892	\$4,000	0	\$4,892
1 L-1186375 * ✓	1	3334.00	1125.00	1909	
2 L-1200322 * ✓	1	3333.00	1125.00	1907	
3 L-1200323 ✓	2		1600.00		
4 L-1186376 ✓	1		1016.00		
5 L-1186201 ✓	1		1200.00		
6					
7					
8					
9					
10					
11					
12					
13					
14					
15					
Column Totals		6067.00	6067.00	3810	

I, ROBIN CLOWATER WHELAN (Print Full Name), do hereby certify that the above work credits are eligible under subsection 7 (1) of the Assessment Work Regulation 6/96 for assignment to contiguous claims or for application to the claim where the work was done.

Signature of Recorded Holder or Agent Authorized in Writing

Robin Whelan

Date

Jan 3/97

6. Instructions for cutting back credits that are not approved.

Some of the credits claimed in this declaration may be cut back. Please check (✓) in the boxes below to show how you wish to prioritize the deletion of credits:

- 1. Credits are to be cut back from the Bank first, followed by option 2 or 3 or 4 as indicated.
- 2. Credits are to be cut back starting with the claims listed last, working backwards; or
- 3. Credits are to be cut back equally over all claims listed in this declaration; or
- 4. Credits are to be cut back as prioritized on the attached appendix or as follows (describe):

*1200322
1186375*

Note: If you have not indicated how your credits are to be deleted, credits will be cut back from the Bank first, followed by option number 2 if necessary.

For Office Use Only

Received Stamp
LAKESHORE
MUNICIPALITY

JAN 8 1997
3:48

Deemed Approved Date <i>6067 97apr3</i>	Date Notification Sent
Date Approved <i>97apr. 1</i>	Total Value of Credit Approved <i>6067</i>
Approved for Recording by Mining Recorder (Signature) <i>[Signature]</i>	

Statement of Costs
for Assessment Credit

Transaction Number (office use)

Personal information collected on this form is obtained under the authority of subsection 6(1) of the Assessment Work Regulation 6/96. Under section 8 of the Mining Act, the information is a public record. This information will be used to review the assessment work and correspond with the mining land holder. Questions about this collection should be directed to the Chief Mining Recorder, Ministry of Northern Development and Mines, 6th Floor, 933 Ramsey Lake Road, Sudbury, Ontario, P3E 6B5.

Work Type	Units of Work <small>Depending on the type of work, list the number of hours/days worked, metres of drilling, kilometres of grid line, number of samples, etc.</small>	Cost Per Unit of work	Total Cost
STRIPPING/TRENCHING	CASE MODEL 550 EXCAVATOR	\$ 100 ⁰⁰ /HR	\$ 3156.50
DRILLING	COBRA PLUGGER	\$ 100 ⁰⁰ /DAY	\$ 300.00
BLASTING	25 STICKS POWDER/DETONATORS	\$ 400/UNIT	\$ 100.00
SAMPLING	4 SAMPLES	\$ 11.50/SAMPLES	\$ 49.22
CONSULTING (INCLUDES REPORT)	2 DAYS	200 ⁰⁰ /DAY	\$ 400.00
LABOUR	1 MAN X 3 DAYS	\$ 300/DAY	\$ 300.00
	1 MAN X 5 DAYS	\$ 150/DAY	\$ 750.00
Associated Costs (e.g. supplies, mobilization and demobilization).			
Transportation Costs			
	TRUCK RENTAL (5 DAYS)	\$ 120.00/DAY	\$ 600.00
	GAS	(see receipts)	\$ 106.00
Food and Lodging Costs			
	ACCOMODATIONS (2 NIGHTS X 49.00/NIGHT)	\$ 49 ⁰⁰ /NIGHT	\$ 105.28
	25 ⁰⁰ /DAY X 8 DAYS (2 PERSONS)	\$ 25.00/DAY	\$ 200.00
Total Value of Assessment Work			\$ 6067.00

Calculations of Filing Discounts:

1. Work filed within two years of performance is claimed at 100% of the above Total Value of Assessment Work.
2. If work is filed after two years and up to five years after performance, it can only be claimed at 50% of the Total Value of Assessment Work. If this situation applies to your claims, use the calculation below:

TOTAL VALUE OF ASSESSMENT WORK \times 0.50 = Total \$ value of worked claimed.

Note:

- Work older than 5 years is not eligible for credit.
- A recorded holder may be required to verify expenditures claimed in this statement of costs within 45 days of a request for verification and/or correction/clarification. If verification and/or correction/clarification is not made, the Minister may reject all or part of the assessment work submitted.

Certification verifying costs:

I, Robin Clowater Whelan, do hereby certify, that the amounts shown are as accurate as may reasonably be determined and the costs were incurred while conducting assessment work on the lands indicated on the accompanying Declaration of Work form as RECORDED HOLDER I am authorized to make this certification.
(recorded holder, agent, or state company position with signing authority)

Signature <u>Robin Whelan</u>	Date <u>Jan 3/97</u>
----------------------------------	-------------------------

Declaration of Assessment Work Performed on Mining Land

Mining Act, Subsection 65(2) and 66(3), R.S.O. 1990

Transaction Number (office use) W 9780.00003
Assessment Files Research Imaging

Personal information collected on this form is obtained under the authority of subsections 65(2) and 66(3) of the Mining Act. Under section 8 of the Mining Act, the information is a public record. This information will be used to review the assessment work and correspond with the mining land holder. Questions about this collection should be directed to the Chief Mining Recorder, Ministry of Northern Development and Mines, 6th Floor, 933 Ramsey Lake Road, Sudbury, Ontario, P3E 6B5.

Instructions: - For work performed on Crown Lands before recording a claim, use form 0240.
- Please type or print in ink.

2.17023

1. Recorded holder(s) (Attach a list if necessary)

Name <u>ROBIN CLOWATER WHELAN</u>	Client Number <u>301171</u>
Address <u>41 PREMIER AVENUE WEST</u>	Telephone Number <u>(705) 568-8160</u>
<u>KIRKLAND LAKE, ONTARIO P2N 2S7</u>	Fax Number <u>as above</u>
Name	Client Number
Address	Telephone Number
	Fax Number

2. Type of work performed: Check (✓) and report on only ONE of the following groups for this declaration.

- Geotechnical: prospecting, surveys, assays and work under section 18 (regs) Physical: drilling, stripping, trenching and associated assays Rehabilitation

Work Type <u>PHYSICAL - STRIPPING; TRENCHING; BLASTING & SAMPLING</u>	Office Use
	Commodity
	Total \$ Value of Work Claimed <u>6067.00</u>
Dates Work Performed From <u>22</u> <u>11</u> <u>96</u> To <u>25</u> <u>11</u> <u>96</u> <small>Day Month Year Day Month Year</small>	NTS Reference
Global Positioning System Data (if available)	Mining Division <u>Harder Lake</u>
Township/Area <u>MACMURCHY TWP</u>	Resident Geologist District <u>Cobalt</u>
M or G-Plan Number <u>G-988</u>	

Please remember to: - obtain a work permit from the Ministry of Natural Resources as required;
- provide proper notice to surface rights holders before starting work;
- complete and attach a Statement of Costs, form 0212;
- provide a map showing contiguous mining lands that are linked for assigning work;
- include two copies of your technical report.

3. Person or companies who prepared the technical report (Attach a list if necessary)

Name <u>BRIAN H. MADILL</u>	Telephone Number <u>(705) 567-6137</u>
Address <u>42 CARTER AVE., KIRKLAND LAKE P2N 2A2</u>	Fax Number <u>(705) 567-4073</u>
Name	Telephone Number
Address	Fax Number
Name	Telephone Number
Address	Fax Number

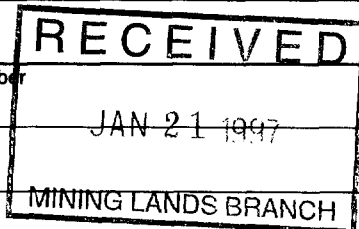

4. Certification by Recorded Holder or Agent

I, ROBIN CLOWATER WHELAN (Print Name), do hereby certify that I have personal knowledge of the facts set forth in this Declaration of Assessment Work having caused the work to be performed or witnessed the same during or after its completion and, to the best of my knowledge, the annexed report is true.

Signature of Recorded Holder or Agent <u>[Signature]</u>	Date <u>Jan 31 1997</u>
Agent's Address <u>41 PREMIER AVE, WEST, KIRKLAND LAKE, ONT.</u>	Telephone Number <u>(705) 568-8160</u>
	Fax Number <u>(705) 568-8160</u>

Deemed - April 03/97

5. **Work to be recorded and distributed.** Work can only be assigned to claims that are contiguous (adjacent) to the mining land where work was performed, at the time work was performed. A map showing the contiguous claims must accompany this form.

DOCUMENT NO. W 9780-00003

Personal information continues on next page.

Mining Claim Number. Or if work was done on other eligible mining land, show in this column the location number indicated on the claim map.		Number of Claim Units. For other mining land, list hectares.	Value of work performed on this claim or other mining land.	Value of work applied to this claim.	Value of work assigned to other mining claims.	Bank. Value of work to be distributed at a future date.
eg	TB 7827	16 ha	\$26, 825	N/A	\$24,000	\$2,825
eg	1234567	12	0	\$24,000	0	0
eg	1234568	2	\$ 8, 892	\$ 4,000	0	\$4,892
1	L-1186375 *	1	3334.00	1125.00	1909	
2	L-1200322	1	3333.00	1125.00	1907	
3	L-1200323	2		1600.00		
4	L-1186376	1		1016.00		
5	L-1186201	1		1200.00		
6						
7						
8						
9						
10						
11						
12						
13						
14						
15						
Column Totals			6067.00	6067.00		

I, ROBIN CLOWATER WHELAN (Print Full Name), do hereby certify that the above work credits are eligible under subsection 7 (1) of the Assessment Work Regulation 6/96 for assignment to contiguous claims or for application to the claim where the work was done.

Signature of Recorded Holder or Agent Authorized in Writing: [Signature] Date: _____

6. Instructions for cutting back credits that are not approved.

Some of the credits claimed in this declaration may be cut back. Please check (✓) in the boxes below to show how you wish to prioritize the deletion of credits:

- 1. Credits are to be cut back from the Bank first, followed by option 2 or 3 or 4 as indicated.
- 2. Credits are to be cut back starting with the claims listed last, working backwards; or
- 3. Credits are to be cut back equally over all claims listed in this declaration; or
- 4. Credits are to be cut back as prioritized on the attached appendix or as follows (describe):

1200322
1186375

RECEIVED
JAN 21 1997
MINING LANDS BRANCH

Note: If you have not indicated how your credits are to be deleted, credits will be cut back from the Bank first, followed by option number 2 if necessary.

For Office Use Only

Received Stamp [Stamp]	Deemed Approved Date	Date Notification Sent
	Date Approved	Total Value of Credit Approved
Approved for Recording by Mining Recorder (Signature)		

Statement of Costs
for Assessment Credit

Transaction Number (Official Use)
W 9780 • 00003

Personal information collected on this form is obtained under the authority of subsection 6(1) of the Assessment Work Regulation 6/96. Under section 8 of the Mining Act, the information is a public record. This information will be used to review the assessment work and correspond with the mining land holder. Questions about this collection should be directed to the Chief Mining Recorder, Ministry of Northern Development and Mines, 6th Floor, 933 Ramsey Lake Road, Sudbury, Ontario, P3E 6B5.

2.17023

Work Type	Units of Work <small>Depending on the type of work, list the number of hours/days worked, metres of drilling, kilometres of grid line, number of samples, etc.</small>	Cost Per Unit of work	Total Cost
STRIPPING/TRENCHING	CASE MODEL 550L EXCAVATOR	\$ 100.00/HR	\$ 3156.50
DRILLING	COBRA PLUGGER	\$ 100.00/DAY	\$ 300.00
BLASTING	25 STICKS POWDER/DETONATORS	\$ 400/UNIT	\$ 100.00
SAMPLING	4 SAMPLES	\$ 11.50/SAMPLE	\$ 49.22
CONSULTING (INCLUDES REPORT)	2 DAYS	200.00/DAY	\$ 400.00
LABOUR	1 MAN X 3 DAYS	\$ 100/DAY	\$ 300.00
	1 MAN X 5 DAYS	\$ 150/DAY	\$ 750.00
Associated Costs (e.g. supplies, mobilization and demobilization).			
Transportation Costs			
	TRUCK RENTAL (5 DAYS)	\$ 120.00/DAY	\$ 600.00
	GAS	(see receipts)	\$ 106.00
Food and Lodging Costs			
	ACCOMODATIONS (2 NIGHTS X 47.00/NIGHT)	\$ 47.00/NIGHT	\$ 105.28
	25.00/DAY X 8 DAYS (2 PERSONS)	\$ 25.00/DAY	\$ 200.00
Total Value of Assessment Work			\$ 6067.00

Calculations of Filing Discounts:

1. Work filed within two years of performance is claimed at 100% of the above Total Value of Assessment Work.
2. If work is filed after two years and up to five years after performance, it can only be claimed at 50% of the Total Value of Assessment Work. If this situation applies to your claims, use the calculation below:

TOTAL VALUE OF ASSESSMENT WORK × 0.50 = Total \$ value of worked claimed.

Note:

- Work older than 5 years is not eligible for credit.
- A recorded holder may be required to verify expenditures claimed in this statement of costs within 45 days of a request for verification and/or correction/clarification. If verification and/or correction/clarification is not made, the Minister may reject all or part of the assessment work submitted.

Certification verifying costs:

I, Robin Younger Whelan, do hereby certify, that the amounts shown are as accurate as may reasonably be determined and the costs were incurred while conducting assessment work on the lands indicated on the accompanying Declaration of Work form as RECORDED HOLDER I am authorized (recorded holder, agent, or state company position with signing authority) to make this certification.

RECEIVED
JAN 21 1997
MINING LANDS BRANCH

Signature: Robin Whelan Date: Jan 3/97

Personal information collected on this form is obtained under the authority of subsections 65(2) and 66(3) of the Mining Act. Under section 8 of the Mining Act, the information is a public record. This information will be used to review the assessment work and correspond with the mining land holder. Questions about this collection should be directed to the Chief Mining Recorder, Ministry of Northern Development and Mines, 6th Floor, 933 Ramsey Lake Road, Sudbury, Ontario, P3E 6B5.

2.17023

Instructions: - For work performed on Crown Lands before recording a claim, use form 0246.
 - Please type or print in ink.

1. Recorded holder(s) (Attach a list if necessary)

Name	Robin Clowater Whelan	Client Number	301171
Address	41 Premier Ave West Kirkland Lake, Ontario P2H 2S7	Telephone Number	(705) 568-8160
		Fax Number	as above
Name		Client Number	
Address		Telephone Number	
		Fax Number	

2. Type of work performed: Check (✓) and report on only ONE of the following groups for this declaration.

Geotechnical: prospecting, surveys, assays and work under section 18 (regs) Physical: drilling, stripping, trenching and associated assays Rehabilitation

Work Type	PROSPECTING / SAMPLING	Office Use
		Commodity
		Total \$ Value of Work Claimed
		530.00
Dates Work Performed	From 23 11 96 To 23 11 96	NTS Reference
	Day Month Year Day Month Year	
Global Positioning System Data (if available)	Township/Area	Mining Division
	McMurchy Twp	Larder Lake
	M or G-Plan Number	Resident Geologist District
	G-998	Cobalt

Please remember to: - obtain a work permit from the Ministry of Natural Resources as required;
 - provide proper notice to surface rights holders before starting work;
 - complete and attach a Statement of Costs, form 0212;
 - provide a map showing contiguous mining lands that are linked for assigning work;
 - include two copies of your technical report.

3. Person or companies who prepared the technical report (Attach a list if necessary)

Name	Brian H Madill	Telephone Number	(705) 567 6137
Address	142 Carter Ave Kirkland Lake P2H 3A2	Fax Number	(705) 567-9093
Name		Telephone Number	
Address		Fax Number	
Name		Telephone Number	
Address		Fax Number	

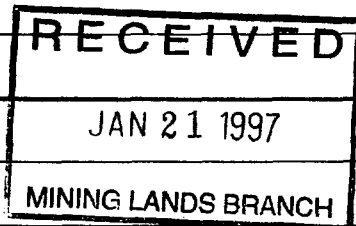

4. Certification by Recorded Holder or Agent

I, Robin Clowater Whelan, do hereby certify that I have personal knowledge of the facts set forth in this Declaration of Assessment Work having caused the work to be performed or witnessed the same during or after its completion and, to the best of my knowledge, the annexed report is true.

Signature of Recorded Holder or Agent	<i>Robin Whelan</i>	Date	Jan 3/97
Agent's Address	41 Premier Ave W Kirkland Lake Ont	Telephone Number	705 568 8160
		Fax Number	705 568-8160

Dumped - April 25 1997

5. Work to be recorded and distributed. Work can only be assigned to claims that are contiguous (adjoining) the mining land where work was performed, at the time work was performed. A map showing the contiguous claims must accompany this form.

Mining Claim Number. Or if work was done on other eligible mining land, show in this column the location number indicated on the claim map.	Number of Claim Units. For other mining land, list hectares.	Value of work performed on this claim or other mining land.	Value of work applied to this claim.	Value of work assigned to other mining claims.	Bank. Value of work to be distributed at a future date.
eg TB 7827	16 ha	\$26,825	N/A	\$24,000	\$2,825
eg 1234567	12	0	\$24,000	0	0
eg 1234568	2	\$8,892	\$4,000	0	\$4,892
1 1200392	1	520.00	520.00	2.17023	
2					
3					
4					
5					
6					
7					
8					
9					
10					
11					
12					
13					
14					
15					
Column Totals		520.00	520.00		

I, ROBIN CLOWATER WHELAN, do hereby certify that the above work credits are eligible under subsection 7 (1) of the Assessment Work Regulation 6/96 for assignment to contiguous claims or for application to the claim where the work was done.

Signature of Recorded Holder or Agent Authorized in Writing: Robin Whelan Date: Jan 3/97

6. Instructions for cutting back credits that are not approved.

Some of the credits claimed in this declaration may be cut back. Please check (✓) in the boxes below to show how you wish to prioritize the deletion of credits:

- 1. Credits are to be cut back from the Bank first, followed by option 2 or 3 or 4 as indicated.
- 2. Credits are to be cut back starting with the claims listed last, working backwards; or
- 3. Credits are to be cut back equally over all claims listed in this declaration; or
- 4. Credits are to be cut back as prioritized on the attached appendix or as follows (describe):

Note: If you have not indicated how your credits are to be deleted, credits will be cut back from the Bank first, followed by option number 2 if necessary.

For Office Use Only

Received Stamp MINING DIVISION JAN 3 1997 3:48	Deemed Approved Date <u>970213</u>	Date Notification Sent
	Date Approved	Total Value of Credit Approved
	Approved for Recording by Mining Recorder (Signature) <u>[Signature]</u>	

Value of work included

Personal information collected on this form is obtained under the authority of subsection 6(1) of the Assessment Work Regulation 6/96. Under section 8 of the Mining Act, the information is a public record. This information will be used to review the assessment work and correspond with the mining land holder. Questions about this collection should be directed to the Chief Mining Recorder, Ministry of Northern Development and Mines, 6th Floor, 933 Ramsey Lake Road, Sudbury, Ontario, P3E 6B5.

2.17023

Work Type	Units of Work <small>Depending on the type of work, list the number of hours/days worked, metres of drilling, kilometres of grid line, number of samples, etc.</small>	Cost Per Unit of work	Total Cost
PROSPECTING	1 DAY	\$ 200/DAY	\$ 200.00
ASSISTANT	1 DAY	\$ 100/DAY	\$ 100.00
SAMPLING	5 SAMPLES	\$ 11.50/SAMPLE	\$ 61.53
Associated Costs (e.g. supplies, mobilization and demobilization).			
Transportation Costs			
TRAVEL	360 kilometres (return trip)	\$ 0.30/Km	\$ 108.00
Food and Lodging Costs			
FOOD	1 DAY X 25 ⁰⁰ /DAY X 2 PERSONS	25 ⁰⁰ /DAY	\$ 50.00
Total Value of Assessment Work			\$ 520.00

Calculations of Filing Discounts:

1. Work filed within two years of performance is claimed at 100% of the above Total Value of Assessment Work.
2. If work is filed after two years and up to five years after performance, it can only be claimed at 50% of the Total Value of Assessment Work. If this situation applies to your claims, use the calculation below:

TOTAL VALUE OF ASSESSMENT WORK \times 0.50 = Total \$ value of worked claimed.

Note:

- Work older than 5 years is not eligible for credit.
- A recorded holder may be required to verify expenditures claimed in this statement of costs within 45 days of a request for verification and/or correction/clarification. If verification and/or correction/clarification is not made, the Minister may reject all or part of the assessment work submitted.

Certification verifying costs:

I, ROBIN WHELAN-CLOWATER (please print full name), do hereby certify, that the amounts shown are as accurate as may reasonably be determined and the costs were incurred while conducting assessment work on the lands indicated on the accompanying Declaration of Work form as RECORDED HOLDER (recorded holder, agent, or state company position with signing authority) I am authorized to make this certification.

Signature <i>Robin Whelan-Clowater</i>	Date Jan 3/97
---	------------------

March 11, 1997

Geoscience Assessment Office
933 Ramsey Lake Road
6th Floor
Sudbury, Ontario
P3E 6B5

Roy Spooner
Mining Recorder
4 Government Road East
Kirkland Lake, ON
P2N 1A2

Telephone: (705) 670-5853
Fax: (705) 670-5863

Dear Sir or Madam:

Submission Number: 2.17023

Status

Subject: Transaction Number(s): W9780.00004 Deemed Approval

We have reviewed your Assessment Work submission with the above noted Transaction Number(s). The attached summary page(s) indicate the results of the review. **WE RECOMMEND YOU READ THIS SUMMARY FOR THE DETAILS PERTAINING TO YOUR ASSESSMENT WORK.**

If the status for a transaction is a 45 Day Notice, the summary will outline the reasons for the notice, and any steps you can take to remedy deficiencies. The 90-day deemed approval provision, subsection 6(7) of the Assessment Work Regulation, will no longer be in effect for assessment work which has received a 45 Day Notice.

Please note any revisions must be submitted in **DUPLICATE** to the Geoscience Assessment Office, by the response date on the summary.

NOTE: This correspondence may affect the status of your mining lands. Please contact the Mining Recorder to determine the available options and the status of your claims.

If you have any questions regarding this correspondence, please contact Steve Beneteau by e-mail at beneteau_s@torv05.ndm.gov.on.ca or by telephone at (705) 670-5855.

Yours sincerely,



ORIGINAL SIGNED BY
Ron C. Gashinski
Senior Manager, Mining Lands Section
Mines and Minerals Division

Work Report Assessment Results

Submission Number: 2.17023

Date Correspondence Sent: March 11, 1997

Assessor: Steve Beneteau

Transaction Number	First Claim Number	Township(s) / Area(s)	Status	Approval Date
W9780.00004	1200322	MACMURCHY	Deemed Approval	March 11, 1997

Section:

9 Prospecting PROSP

Correspondence to:

Mining Recorder
Kirkland Lake, ON

Resident Geologist
Cobalt, ON

Assessment Files Library
Sudbury, ON

Recorded Holder(s) and/or Agent(s):

ROBIN CLOWATER WHELAN
KIRKLAND LAKE, ONTARIO

REFERENCES

AREAS WITHDRAWN FROM DISPOSITION

M.R.O. - MINING RIGHTS ONLY
 S.R.O. - SURFACE RIGHTS ONLY
 M+S. - MINING AND SURFACE RIGHTS

Description	Order No.	Date	Disposition	File
SEC 43/70	W-66/77	NOV/9/76	S.R.O.	188517
SEC 36/80	W-L2-90NER	APR 3/90	M+S	

PART OF ORDER W-L2-90 NER REOPENED BY ORDER C-ONT-08/92 NER/CR EFFECTIVE MARCH 18/92 AT 10:00 AM E.S.T.

PART OF ORDER W-L2-90 NER REOPENED BY ORDER C-ONT-07/92 NER/CR DATED MARCH 25/92 AT 9:45 AM E.S.T. THIS ORDER COMES INTO EFFECT AT 7:00 AM E.S.T. ON JUNE 1/92.

NOTES

NOTICE OF FORESTRY ACTIVITY
 THIS TOWNSHIP/AREA FALLS WITHIN THE SHININGTREE MANAGEMENT UNIT AND MAY BE SUBJECT TO FORESTRY OPERATIONS THE MNR UNIT FORESTER FOR THIS AREA CAN BE CONTACTED AT:
 P.O. BOX 129
 LOW AVENUE
 GOSAMA-ONTARIO
 POM-1W0
 705-894-2000

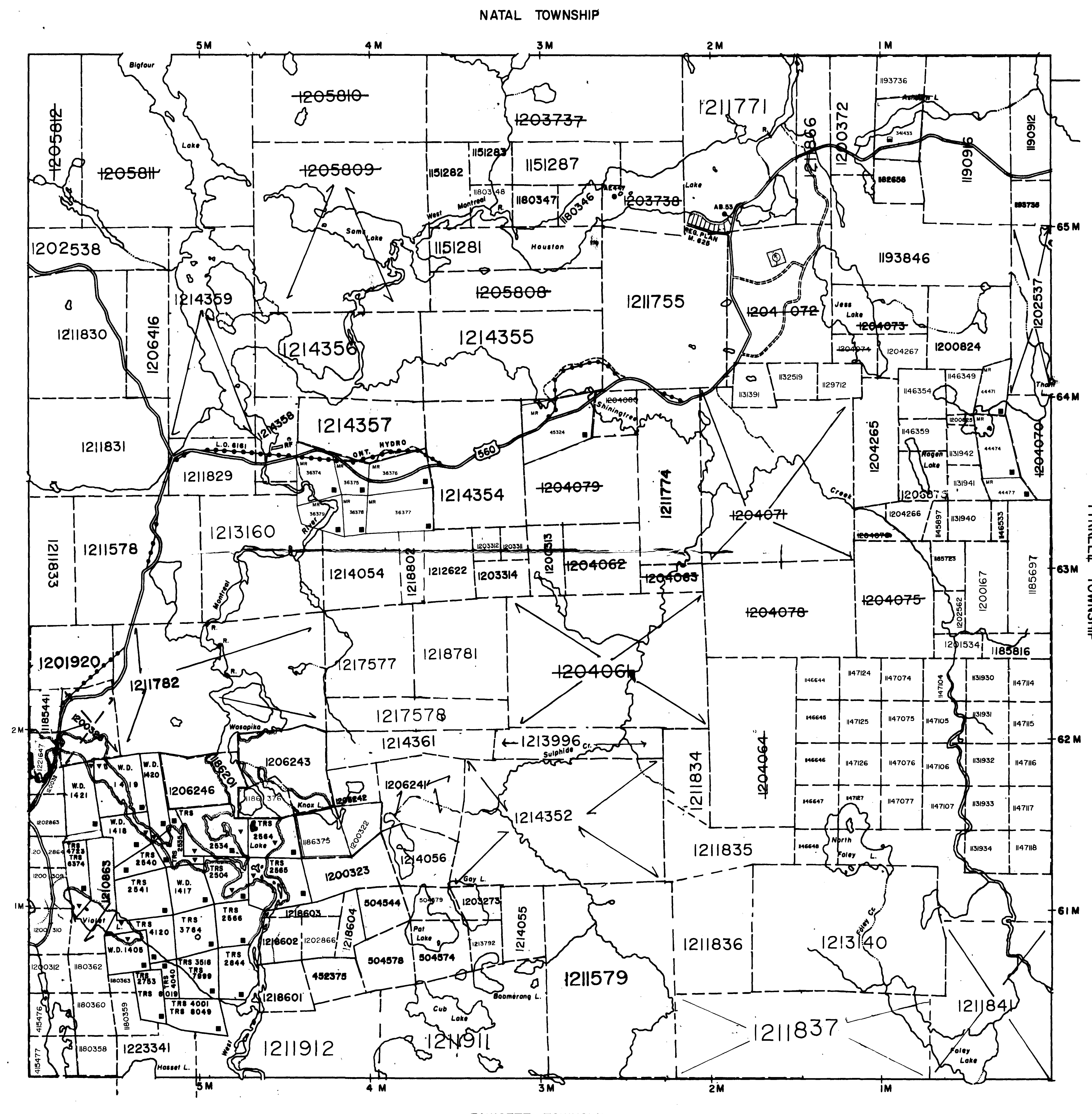

LEGEND

- HIGHWAY AND ROUTE No.
- OTHER ROADS
- TRAILS
- SURVEYED LINES:
- TOWNSHIPS, BASE LINES, ETC.
- LOTS, MINING CLAIMS, PARCELS, ETC.
- UNSURVEYED LINES:
- LOT LINES
- PARCEL BOUNDARY
- MINING CLAIMS ETC.
- RAILWAY AND RIGHT OF WAY
- UTILITY LINES
- NON-PERENNIAL STREAM
- FLOODING OR FLOODING RIGHTS
- SUBDIVISION OR COMPOSITE PLAN
- RESERVATIONS
- ORIGINAL SHORELINE
- MARSH OR MUSKEG
- MINES
- TRAVERSE MONUMENT

DISPOSITION OF CROWN LANDS

TYPE OF DOCUMENT	SYMBOL
PATENT, SURFACE & MINING RIGHTS	
" SURFACE RIGHTS ONLY	
" MINING RIGHTS ONLY	
LEASE, SURFACE & MINING RIGHTS	
" SURFACE RIGHTS ONLY	
" MINING RIGHTS ONLY	
LICENCE OF OCCUPATION	
ORDER-IN-COUNCIL	
RESERVATION	
CANCELLED	
SAND & GRAVEL	

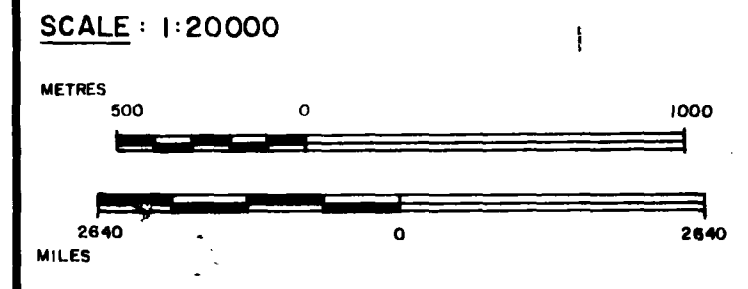

TOWNSHIP OPENED TO STAKING-ORDER MLOI-90 EFFECTIVE APRIL 3/90 AT 7:00 AM EST.
 GEOLOGY REFERENCE-COBALT RESIDENT GEOLOGIST

DOCUMENT No.
 W 9780 - 00003

pstrip ptrnch

TOWNSHIP
MACMURCHY
 M.N.R. ADMINISTRATIVE DISTRICT
TIMMINS
 MINING DIVISION
LARDER LAKE
 LAND TITLES / REGISTRY DIVISION
SUDBURY

Ministry of Natural Resources Ontario
 Ministry of Northern Development and Mines

Date: APRIL 1990
 Number: **G-988**
 CIRCULATED APRIL 26/95 CM

G-988

MACMURCHY TWP

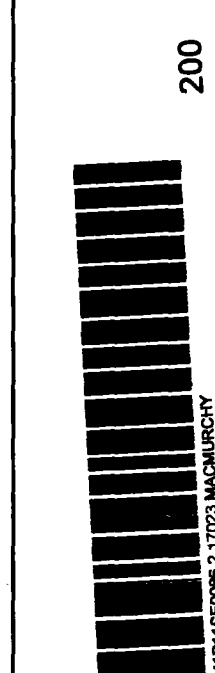

G-9

FAWCETT TOWNSHIP

ARCHIVED SEPT 1/95
 ARCHIVED JULY 24, 1996

REFERENCES

AREAS WITHDRAWN FROM DISPOSITION

Description	Order No.	Date	Disposition	File
(1) SEC 43/70	W 66/77	NOV 9/78	S.R.O.	188517
(2) SEC 36/80	W L2-50NER	APR 3/90	M+S	

ACT OF ORDER W.A. 7, 90 NEW RESIGNED BY ORDER U. 01-06/90 EFFECTIVE MARCH 19/90 AT 10:57 PM EST.

PART OF ORDER W.A. 7, 90 NEW RESIGNED BY ORDER O. 01-07/92 NEW RESIGNED MARCH 23/92 AT 4:45 AM EST. THIS ORDER COMES INTO EFFECT AT 7:00 AM EST. ON JUNE 1/92.

NOTES

NOTICE OF FORESTRY ACTIVITY
 THIS TOWNSHIP/AREA FALLS WITHIN THE SHINGTREE MANAGEMENT UNIT AND MAY BE SUBJECT TO FORESTRY OPERATIONS THE WMR UNIT FORESTER FOR THIS AREA CAN BE CONTACTED AT:
 P.O. BOX 129
 LOW AVENUE
 GOSAMA ON TARIO
 P.O.M. 1W0
 705-894 2000

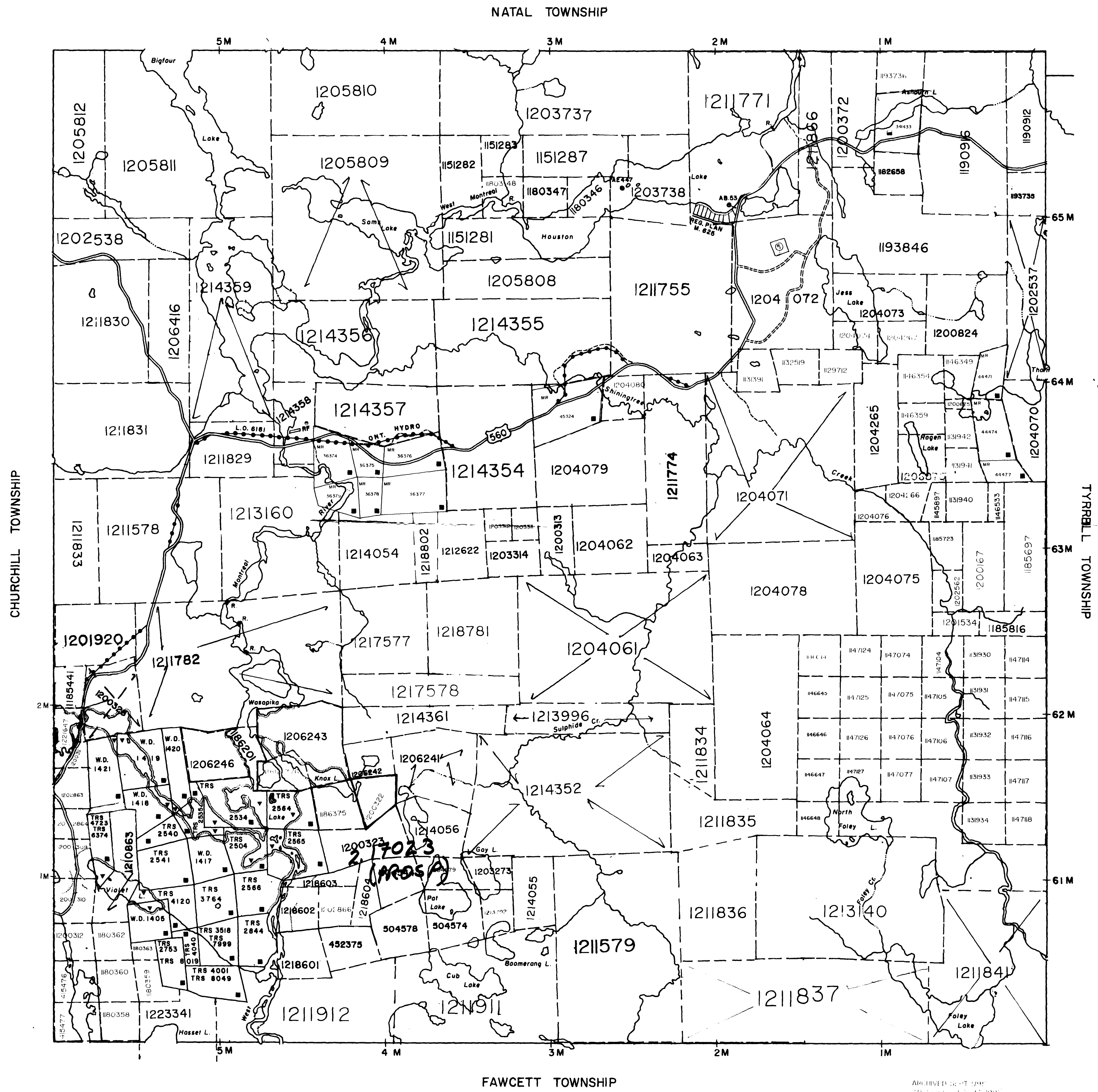

LEGEND

HIGHWAY AND ROUTE No.	
OTHER ROADS	
TRAILS	
SURVEYED LINES:	
TOWNSHIPS, BASE LINES, ETC.	
LOTS, MINING CLAIMS, PARCELS, ETC.	
UNSURVEYED LINES:	
LOT LINES	
PARCEL BOUNDARY	
MINING CLAIMS ETC.	
RAILWAY AND RIGHT OF WAY	
UTILITY LINES	
NON-PERENNIAL STREAM	
FLOODING OR FLOODING RIGHTS	
SUBDIVISION OR COMPOSITE PLAN	
RESERVATIONS	
ORIGINAL SHORELINE	
MARSH OR MUSKEG	
MINES	
TRAVERSE MONUMENT	

DISPOSITION OF CROWN LANDS

TYPE OF DOCUMENT	SYMBOL
PATENT, SURFACE & MINING RIGHTS	
.. SURFACE RIGHTS ONLY	
.. MINING RIGHTS ONLY	
LEASE, SURFACE & MINING RIGHTS	
.. SURFACE RIGHTS ONLY	
.. MINING RIGHTS ONLY	
LICENCE OF OCCUPATION	
RESERVATION	
CANCELLED	
SAND & GRAVEL	

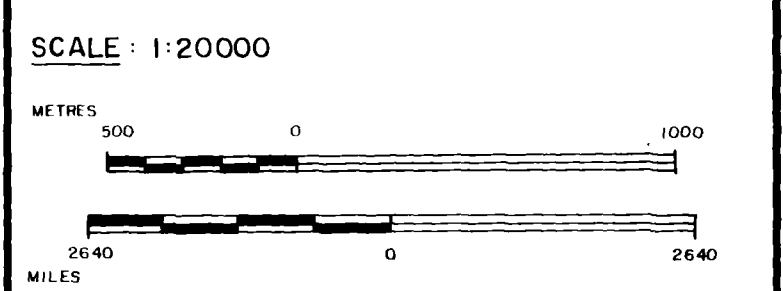

TOWNSHIP OFFERED TO STAKE ORDER M. 01.90 EFFECTIVE APRIL 5/90 AT 7:00 AM EST.

GEOLOGY REFERENCE LOCAL TREE DATA (G. 01.90)

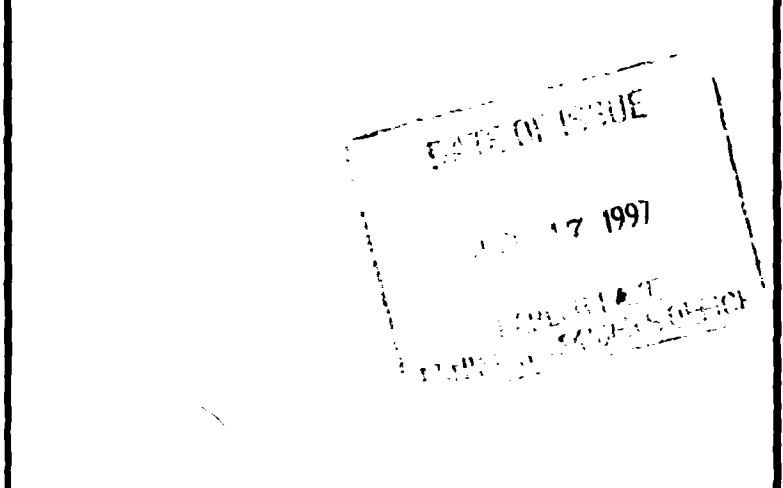

2.17023

TOWNSHIP
MACMURCHY
 M.N.R. ADMINISTRATIVE DISTRICT
 TIMMINS
 MINING DIVISION
 LARDER LAKE
 LAND TITLES / REGISTRY DIVISION
 SUDBURY

Ministry of Natural Resources Ontario
 Ministry of Northern Development and Mines

Date: APRIL 1990
 Number: **G-988**